

EAST RICHARDSON PONDS  
Adamstown Twp., Oxford County  
U.S.G.S. Oquossoc, Maine

Fishes

Brook trout	Minnows
Rainbow smelt	Lake chub
White sucker	Creek chub

Physical Characteristics

Upper Pond

Area - 85 acres	Temperatures
	Surface - 73°F
Maximum depth - 20 feet	19 feet - 57°F

Lower Pond

Area 54 acres	Temperatures
	Surface - 74°F
Maximum depth - 15 feet	14 feet - 68°F

Principal fishery - Brook trout

The East Richardson Ponds lie within the Richardson Lake Unit of Maine's Public Reserved Lands, and are accessible by a gravel road off Route 16. Water quality in both ponds is suitable for brook trout, though the quality of the habitat is reduced somewhat by the presence of suckers. A fly-fishing-only regulation is in effect to discourage the introduction of other competing fish species. Although yellow perch are present in downstream waters, the steep gradient of the outlet has prevented their movement into the ponds.

Surveyed - August, 1974  
(Revised, 1988)

Maine Department of Inland Fisheries and Wildlife  
Funded in part by Federal Aid in Restoration Act  
under Federal Project F-28-P  
L3296

# EAST RICHARDSON POND - UPPER

AREA 85 ACRES

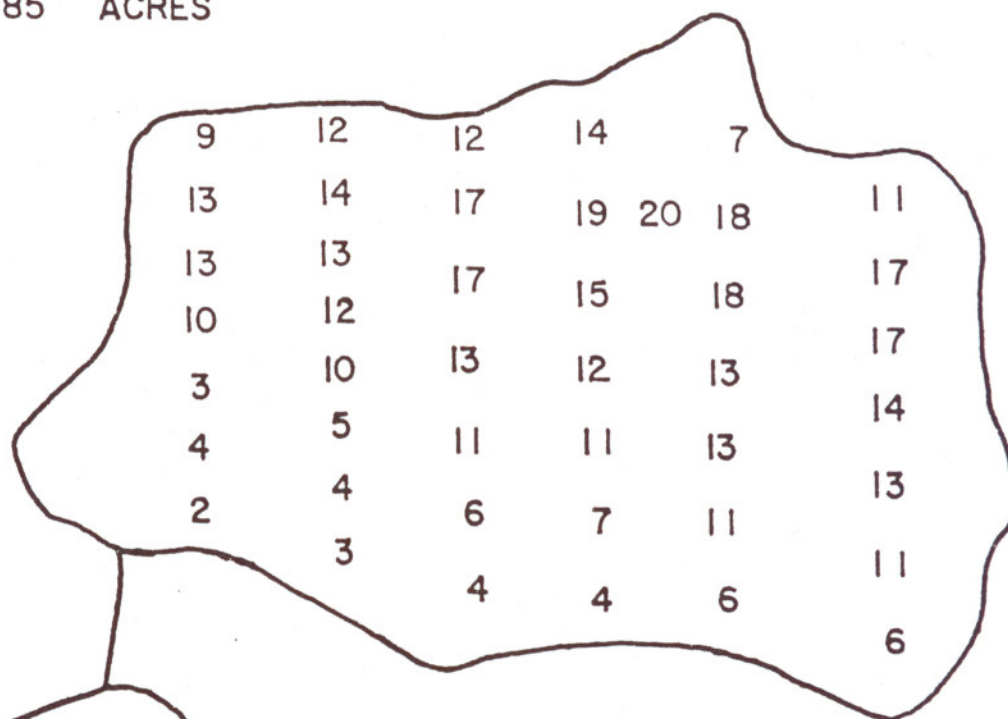

## EAST RICHARDSON POND - LOWER

AREA 54 ACRES

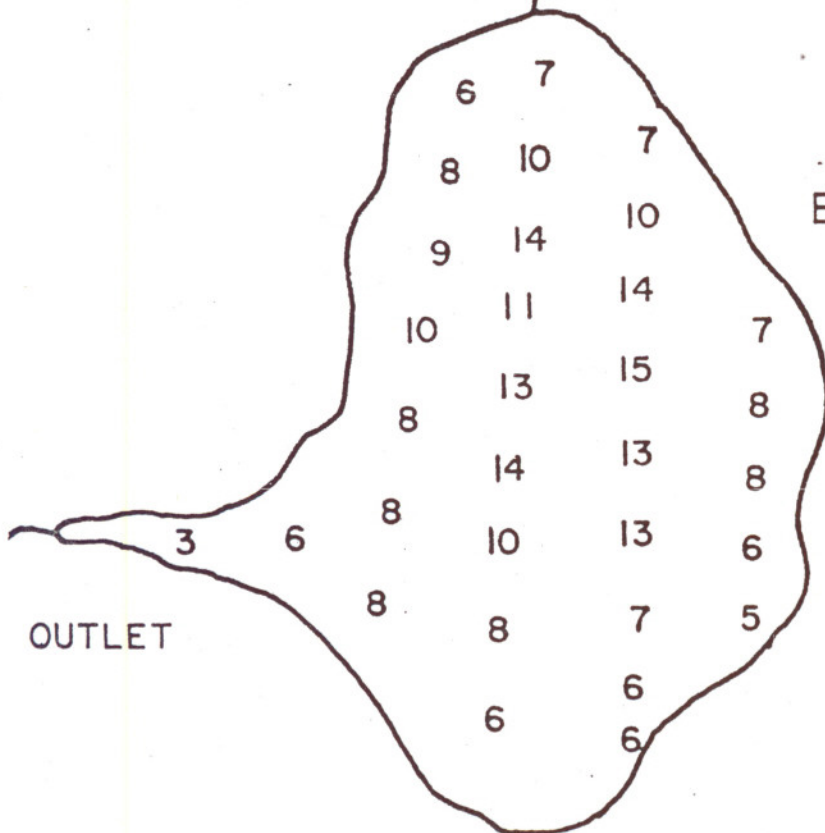

OUTLET

ADAMSTOWN (T4R2), OXFORD CO., ME.

