

~ ELEVATION ~

⚠ NOTES:

1. Precast Concrete Vertical Curb shall meet the requirements of Standard Specifications Section 609 - Curb.

2. Dimensions shown are designed to accommodate a 9" reveal bridge curb with a battered face. Dimensions shall be adjusted to fit other situations as required.

3. Unless otherwise indicated, payment will be included under the applicable Bridge Transition item. No separate payment will be made.

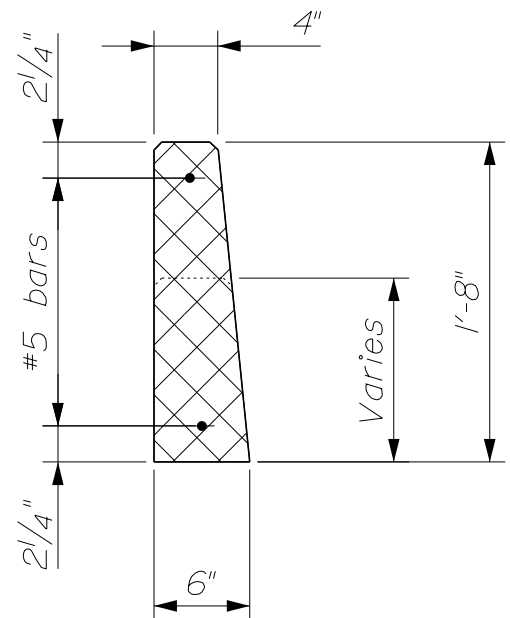

~ SECTION ~

PRECAST CONCRETE VERTICAL CURB

Supersedes 609(09)