

STATE OF MAINE DEPARTMENT OF TRANSPORTATION

**HOYLE
TANNER**
106 Lafayette Street, Unit 2D • Yarmouth, ME 04096
(207) 844-8102 • www.hoyletanner.com



HAYNESVILLE AROOSTOOK COUNTY BABCOCK BRIDGE

ROUTE 2A
BRIDGE NO. 6566

FEDERAL AID PROJECT NO. 1882310
PROJECT LENGTH: 0.02 MILES

PLAN LEGEND	
Town, County, State _____	Catch Basins <input type="checkbox"/> Existing <input type="checkbox"/> Proposed
Property Lines - - - - -	Manholes <input type="circle"/> Existing <input type="circle"/> Proposed
R/W Lines-Existing - - - - -	Proposed Underdrain _____
R/W Lines-Proposed - - - - -	Proposed Ditch - - - - -
Culvert-Existing _____	Existing Ditch - - - - -
Culvert Proposed _____	Utility Poles <input type="circle"/> Existing <input type="circle"/> Proposed
Curbing Existing Proposed	Fire Hydrants <input type="circle"/> Existing <input type="circle"/> Proposed
Type 1 _____	Existing Water Line _____
Type 3 _____	Existing San. Sewer _____
Type 5 _____	Existing San. Sewer Manhole <input type="circle"/>
Outline of Bodies of Water _____	Guardrail-Existing - - - - -
Exposed Bedrock _____	Guardrail-Proposed - - - - -
Buildings _____	Guardrail-Cable, Other _____
Trees <input type="circle"/> Conifer <input type="circle"/> Deciduous	Centerline-Existing _____
Tree Line _____	Centerline-Proposed _____
Clearing Limit Line - - - - -	Travelway-Existing _____
Railroad - - - - -	Travelway-Proposed _____
Boring <input type="circle"/> HB-XXX-###	Probe <input type="circle"/> P-#. #X
Pavement Core <input type="circle"/> PC-#	#.# = Depth
Test Pit <input type="square"/> TP-XXX-###	X = W (Weathered Rock)
	R (Refusal)
	NR (No Refusal)

INDEX OF SHEETS	
<u>Description</u>	<u>Sheet No.</u>
Title Sheet	1
Special Details	2

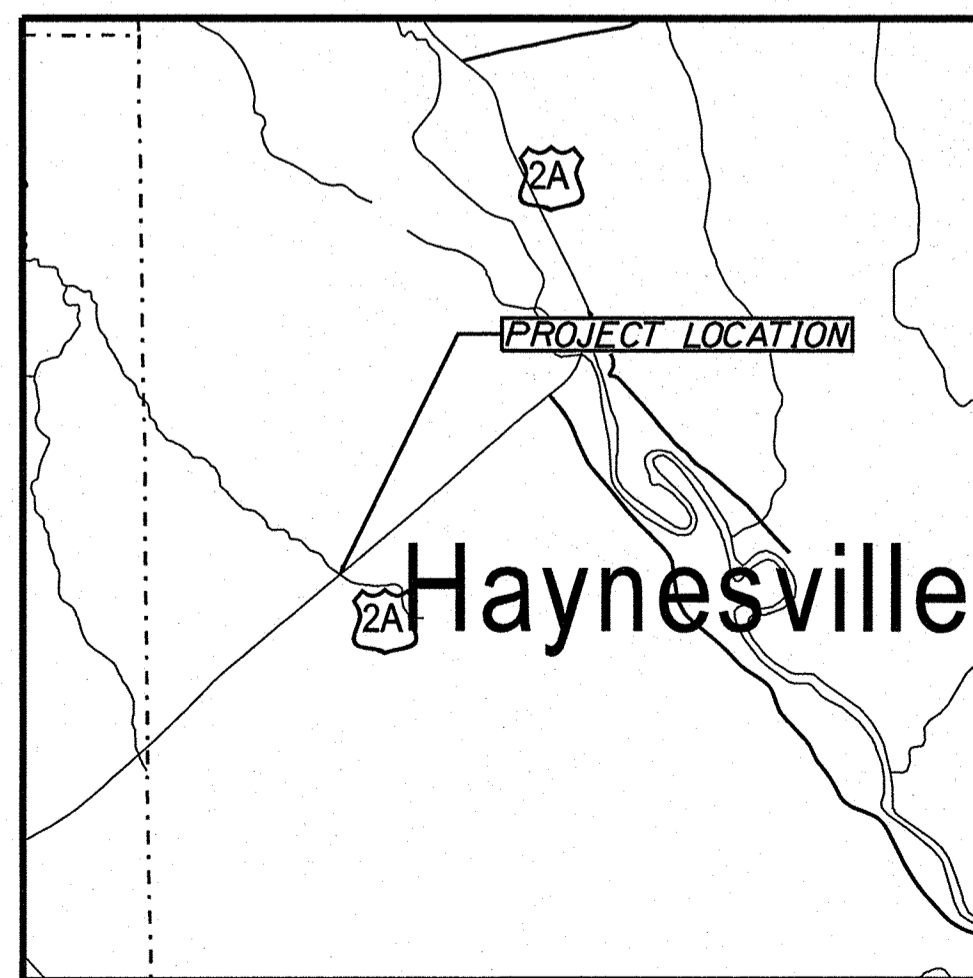
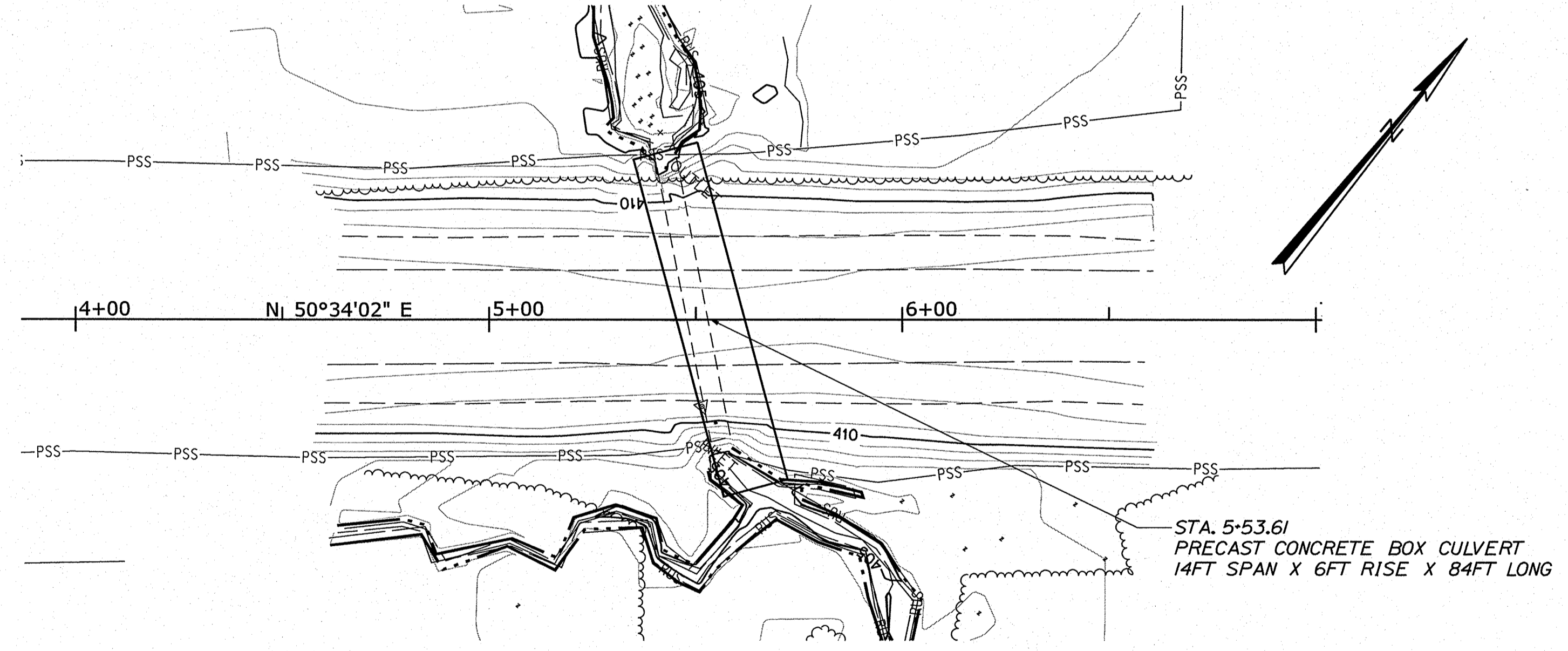

0 1 2
Scale in Miles
LOCATION MAP

TRAFFIC DATA	
Current (2022) AADT	425
Future (2042) AADT	500
DHV - % of AADT	11%
Design Hour Volume	52
% Heavy Trucks (AADT)	22%
% Heavy Trucks (DHV)	17%
Directional Distribution (DHV)	50%
18 kip Equivalent P 2.0	138
18 kip Equivalent P 2.5	132
Design Speed (mph)	55
Functional Class:	Major Urban Collector
Highway Corridor Priority:	4

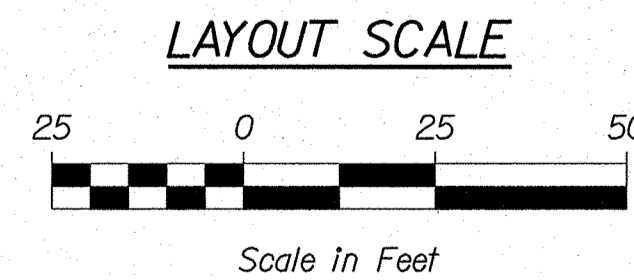

PROJECT LOCATION:	HAYNESVILLE, ROUTE 2A, LOCATED 1.33 MILES NORTH OF GLENWOOD PLT TOWN LINE.
PROGRAM AREA:	HIGHWAY PROGRAM
SCOPE OF WORK:	LARGE CULVERT REPLACEMENT

STATE OF MAINE DEPARTMENT OF TRANSPORTATION	APPROVED	DATE
COMMISSIONER: <i>[Signature]</i>	11-2-22	11-2-22
CHIEF ENGINEER: <i>[Signature]</i>		11-2-22

STATE OF MAINE DEPARTMENT OF TRANSPORTATION PROFESSIONAL ENGINEER OWEN KRALUS No. 13434	SIGNATURE	P.E. NUMBER	DATE
<i>[Signature]</i>	13434	OCTOBER 27, 2022	OCTOBER 27, 2022

PROJECT INFORMATION	
PROGRAM	HIGHWAY
PROJECT MANAGER	ROGER SOUCY
DESIGNER	OWEN KRALUS
CONSULTANT	HOYLE TANNER
PROJECT RESIDENT	
CONTRACTOR	
PROJECT COMPLETION DATE	

WIN 18823.10 FEDERAL AID PROJECT NO. 1882310

**HAYNESVILLE
ROUTE 2A**

TITLE SHEET

SHEET NUMBER

1

OF 2

Date: 10/27/2022

Username:

Division: BRIDGE

Filename: ... \MSTA001_Title_Prebuy.dgn

