

STATE OF MAINE DEPARTMENT OF TRANSPORTATION



SPECIFICATIONS

Design: Load and Resistance Factor Design per AASHTO LRFD Bridge Design Specifications, Tenth Edition 2024.

LIST OF DRAWINGS

Title Sheet	1
Estimated Quantities & General Construction Notes	2
General Plan	3
Typical Sections	4
Staged Construction Sections	5

FALMOUTH CUMBERLAND COUNTY STAPLES POINT BRIDGE OVER PRESUMPSCOT RIVER MIDDLE ROAD/ROUTE 9 FEDERAL AID PROJECT NO. 02930800 BRIDGE NO. 5278 PROJECT LENGTH 0.050 MILES

UTILITIES

Central Maine Power	Consolidated Communications
Charter Communications	Portland Water District
GoNetSpeed Communications	Town of Falmouth Sewer District

TRAFFIC DATA

Current (2026) AADT	3800
Future (2046) AADT	4560
DHV - % of AADT	11
Design Hour Volume	502
Heavy Trucks (% of AADT)	6
Heavy Trucks (% of DHV)	3
Directional Distribution (% of DHV)	58
18 kip Equivalent P 2.0	62
18 kip Equivalent P 2.5	59
Design Speed (mph)	35

MAINTENANCE OF TRAFFIC

Staged construction with alternating one-way traffic using temporary traffic signals.

WIN 029308.00

**FALMOUTH
STAPLES POINT BRIDGE
TITLE SHEET**

**SHEET NUMBER
1
OF 5**

STATE OF MAINE
DEPARTMENT OF TRANSPORTATION
APPROVED
COMMISSIONER: *[Signature]*
DATE: 5-14-26
CHIEF ENGINEER: *[Signature]*

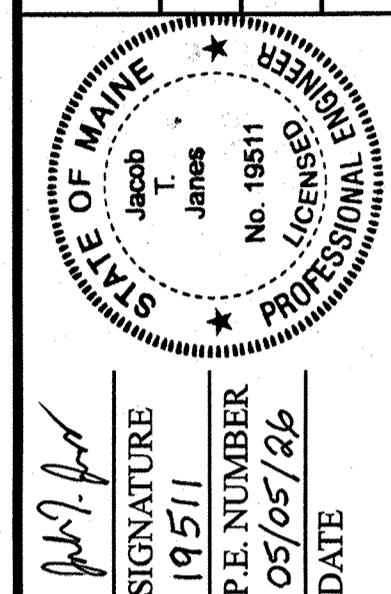

PROGRAM	BRIDGE PROGRAM
PROJECT MANAGER	SIMONE ZIMMERMAN
DESIGNER	JACOB JAMES
CONSULTANT	
PROJECT RESIDENT	
CONTRACTOR	
PROJECT COMPLETION DATE	

PROJECT LOCATION	Middle Road Located 1 Mile North of the Falmouth Town Line Lat./Long 43.71508°N 70.25260° W
OUTLINE OF WORK	Wearing Surface Replacment

ESTIMATED QUANTITIES			
ITEM NO.	DESCRIPTION	QUANTITY	UNIT
202.127	REMOVING OF EXISTING BITUMINOUS PAVEMENT (850 SY)	1	LS
202.202	REMOVING PAVEMENT SURFACE	180	SY
403.208	12.5 MM HOT MIX ASPHALT PAVEMENT	87	T
403.213	12.5 MM HOT MIX ASPHALT PAVEMENT BASE	84	T
409.15	BITUMINOUS TACK COAT - APPLIED	65	G
508.14	HIGH PERFORMANCE WATERPROOFING MEMBRANE (870 SY)	1	LS
515.21	PROTECTIVE COATING FOR CONCRETE SURFACES (224 SY)	1	LS
518.50	REPAIR OF UPWARD FACING SURFACES - TO REINFORCING STEEL < 8 INCHES	270	SF
518.51	REPAIR OF UPWARD FACING SURFACES - BELOW REINFORCING STEEL <8 INCHES	405	SF
518.80	CRACK REPAIR	20	LF
526.301	PORTABLE CONCRETE BARRER, TYPE I (1040 LF)	1	LS
527.34	WORK ZONE CRASH CUSHIONS	2	EA
627.18	12" SOLID WHITE PAVEMENT MARKING	24	LF
627.733	4" WHITE OR YELLOW PAINTED PAVEMENT MARKING LINE	867	LF
627.77	REMOVING PAVEMENT MARKINGS	450	SF
627.78	TEMPORARY 4" PAINTED PAVEMENT MARKING LINE, WHITE OR YELLOW	1250	LF
629.05	HAND LABOR, STRAIGHT TIME	40	HR
631.172	TRUCK - LARGE (INCLUDING OPERATOR)	10	HR
639.20	FIELD OFFICE TYPE C	1	EA
643.72	TEMPORARY TRAFFIC SIGNAL	1	LS
652.312	TYPE III BARRICADE	8	EA
652.33	DRUM	25	EA
652.34	CONE	50	EA
652.35	CONSTRUCTION SIGNS	250	SF
652.361	MAINTENANCE OF TRAFFIC CONTROL DEVICES	1	LS
652.38	FLAGGERS	100	HR
652.41	PORTABLE CHANGEABLE MESSAGE SIGN	2	EA
656.75	TEMPORARY SOIL EROSION AND WATER POLLUTION CONTROL	1	LS
659.10	MOBILIZATION	1	LS

GENERAL CONSTRUCTION NOTES

- Project information referred to below may be accessed at the following MaineDOT web address: <https://www.maine.gov/dot/doing-business/bid-opportunities>
- The existing bridge plans may be accessed at the MaineDOT web address. The plans are reproductions of the original drawings as prepared for the construction of the bridge. It is very unlikely that the plans will show any construction field changes or any alterations which may have been made to the bridge during its life span.
- All existing dimensions shown on the plans are taken from as-built drawings from 1950 to 1997 and are not guaranteed to be correct. All information based on or relating to the existing bridge shall be verified in the field by the contractor.
- Quantities included for pay items measured and paid for by Lump Sum are estimated quantities and are provided by MaineDOT for informational purposes only. Lump Sum pay items will be paid for at the Contract Bid amount, with no addition or reduction in payment to the Contractor if the actual final quantities are different from the MaineDOT provided estimated quantities, except as follows:
 - If a Lump Sum pay item is eliminated, the requirements of Standard Specifications Section 109.2, Elimination of Items, will take precedence.
 - If other Contract Documents specifically allow a change in payment for a Lump Sum pay item, those requirements will be followed.
 - If a design change results in changes to estimated quantities for Lump Sum pay items, price adjustments will be made in accordance with Standard Specifications Section 109.7, Equitable Adjustments to Compensation and Time.
- Reinforcing steel shall have a minimum concrete cover of 2" unless otherwise noted.
- Any damage to existing concrete or reinforcing steel resulting from the work performed shall be repaired or replaced by a method approved by the Resident at no cost to the Department.
- If the depth of deteriorated concrete is at/or below the reinforcing steel, then remove the concrete to a minimum depth of 1 inch below the reinforcing bar and not to exceed the depth of the existing 5" thick concrete slab. No concrete shall be removed from the top of the existing prestressed concrete box beams.
- All required pavement saw cuts are incidental to the contract. Sawcuts shall be 1/2" deep and filled with an Emulsified Sealing Compound approved by the Resident.
- Protective Coating for Concrete Surfaces shall be applied to the following areas:
 - All exposed surfaces of concrete curbs
 - Fascias down to the drip notch
 - All exposed surfaces of Concrete Transition Barriers

STATE OF MAINE DEPARTMENT OF TRANSPORTATION Federal Project No. 02930800 WIN 029308.00	
STAPLES POINT BRIDGE NO. 5278 CROSSING PRESUMPSHOT RIVER FALMOUTH	ESTIMATED QUANTITIES & GENERAL CONSTRUCTION NOTES
SHEET NUMBER 2 OF 5	SIGNATURE P.E. NUMBER DATE
PROJ. MANAGER: SIMONE ZIMMERMAN DESIGN-DETAILED: J. JAMES CHECKED/REVIEWED: G. GUSTAFSSON DESIGN-DETAILED: M. POULIN REVISIONS 1 REVISIONS 2 REVISIONS 3 REVISIONS 4 FIELD CHANGES	BY: J. JAMES DATE: 05/2026 M. POULIN DATE: 05/2026

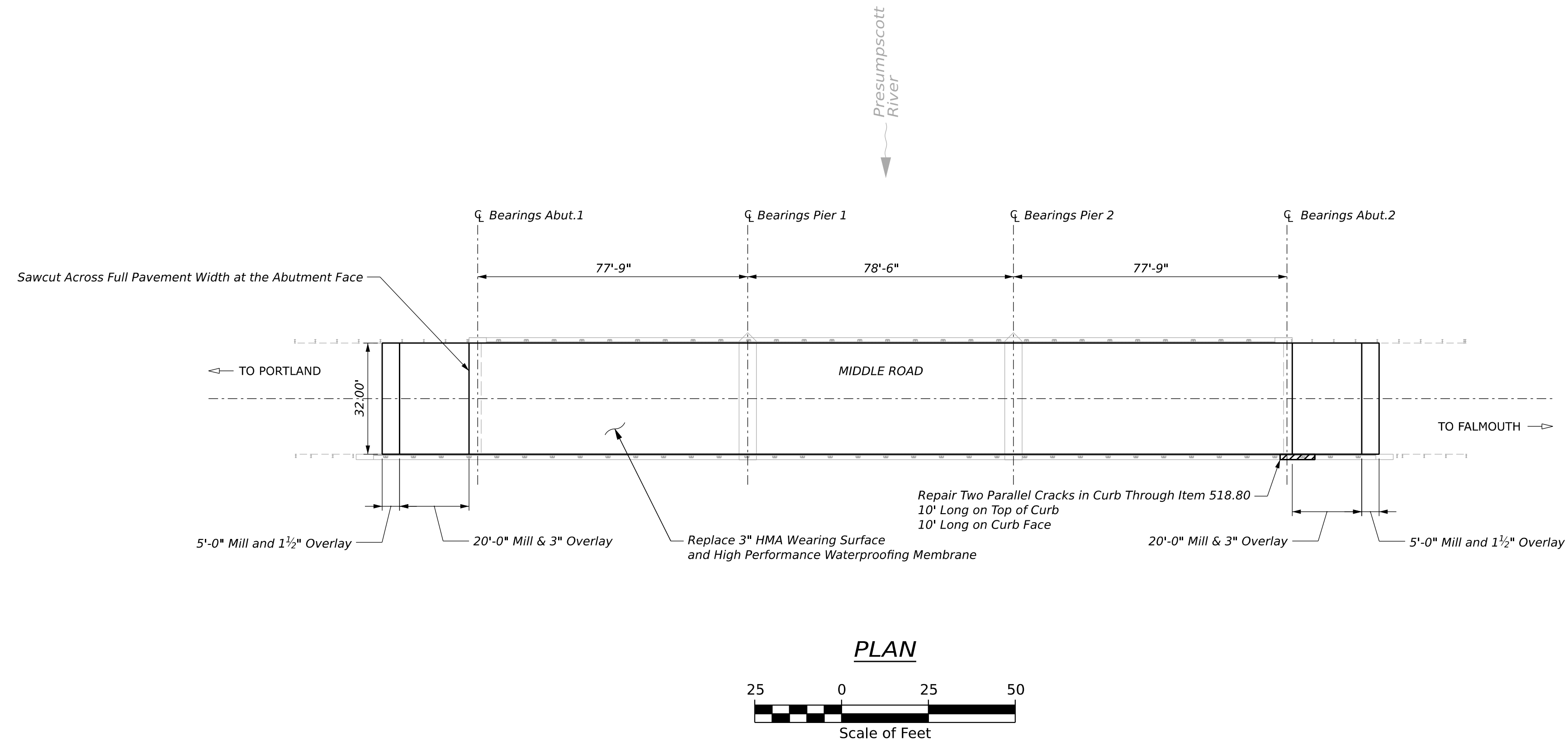

STATE OF MAINE
DEPARTMENT OF TRANSPORTATION
Federal Project No. 02930800
WIN 029308.00

PROJ. MANAGER	SIMONE ZIMMERMAN	BY	DATE
DESIGN-DETAILED	J. JAMES	J. JAMES	05/2026
CHECKED/REVIEWED	R. GUSTAFSSON	M. POULIN	05/2026
DESIGN-DETAILED			
REVISIONS 1			
REVISIONS 2			
REVISIONS 3			
REVISIONS 4			
FIELD CHANGES			

STAPLES POINT BRIDGE NO. 5278
CROSSING PRESUMPSCOTT RIVER
FALMOUTH
GENERAL PLAN

SHEET NUMBER
3
OF 5

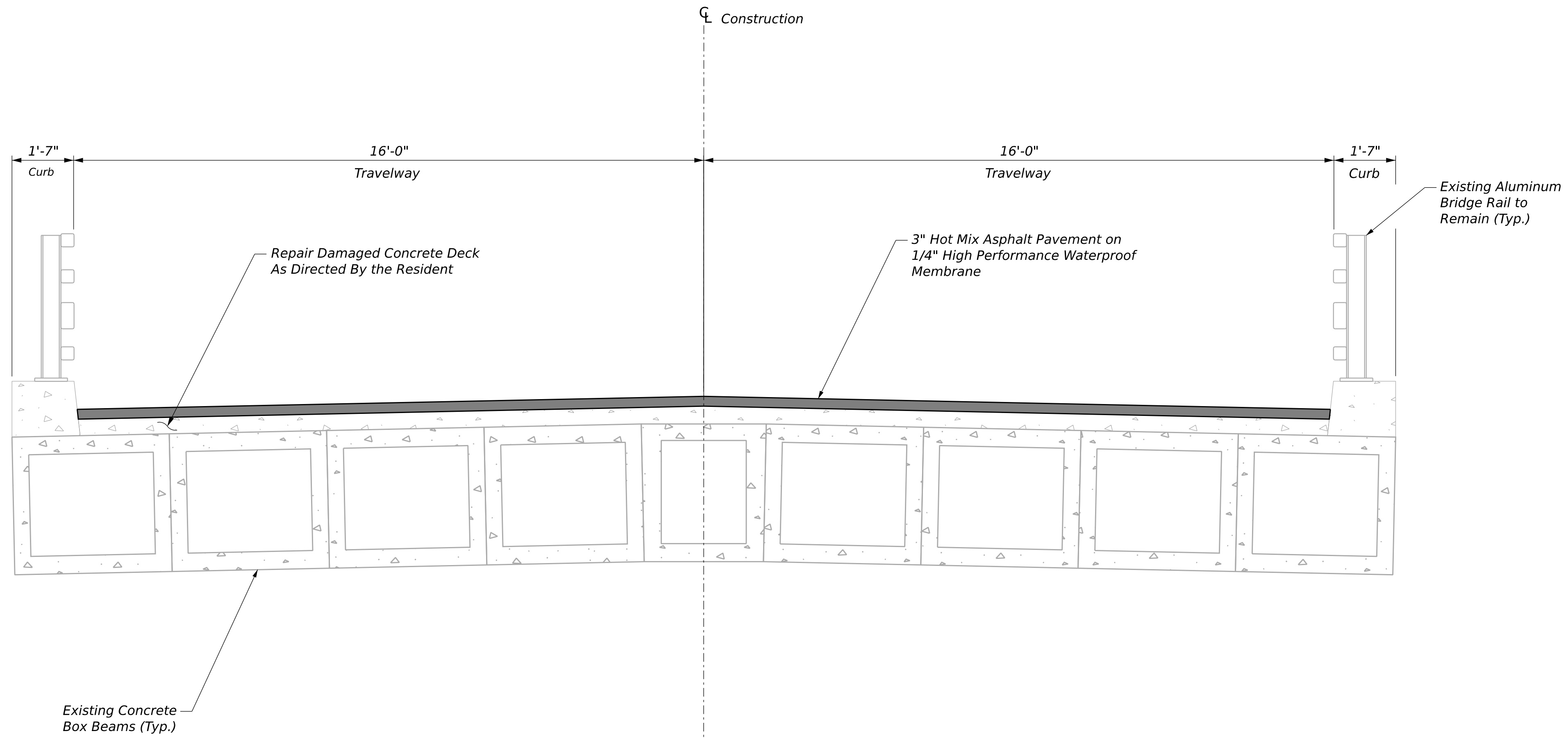

TYPICAL CROSS SECTION

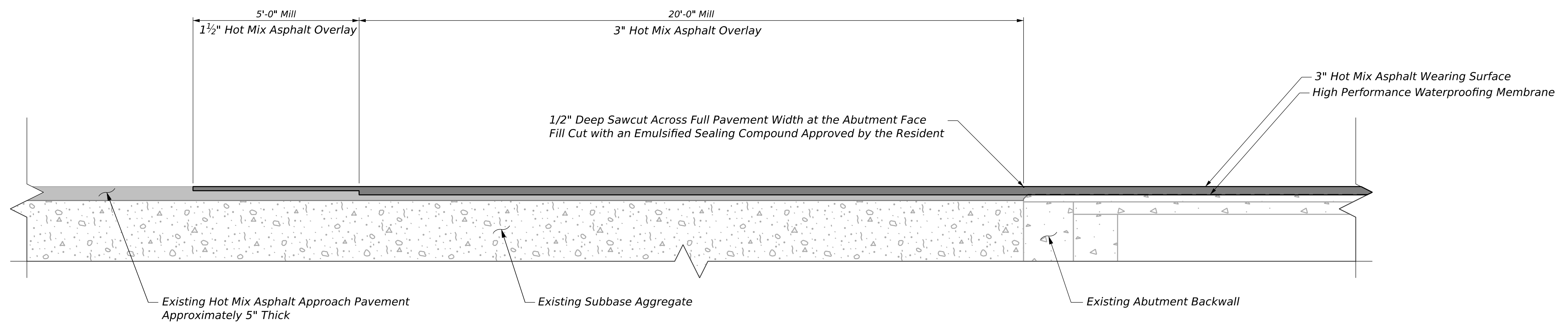

MILL AND OVERLAY SECTION

PROJ. MANAGER	DATE	BY	DATE
JIMMIE ZIMMERMAN	05/2026	J.JANES	05/2026
DESIGN-DETAILED		J.JANES	
CHECKED-REVIEWED		G.GUSTAFSON	
DESIGN-DETAILED		M.POLLIN	
DESIGN-DETAILED			
REVISIONS 1			
REVISIONS 2			
REVISIONS 3			
REVISIONS 4			
FIELD CHANGES			

SIGNATURE	P.E. NUMBER	DATE

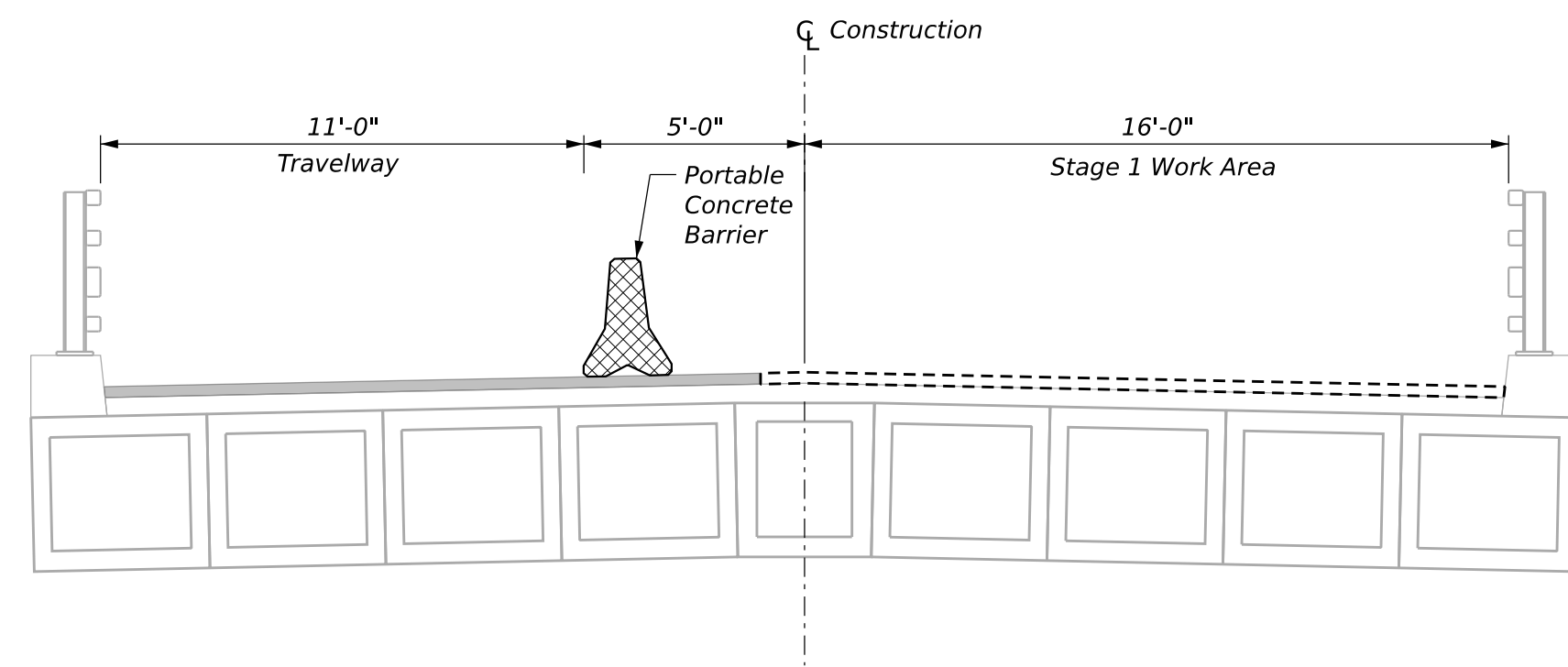

STAGE 1

Place temporary barrier to allow for alternating traffic on Left.
Remove the existing wearing surface and waterproofing membrane on Right.

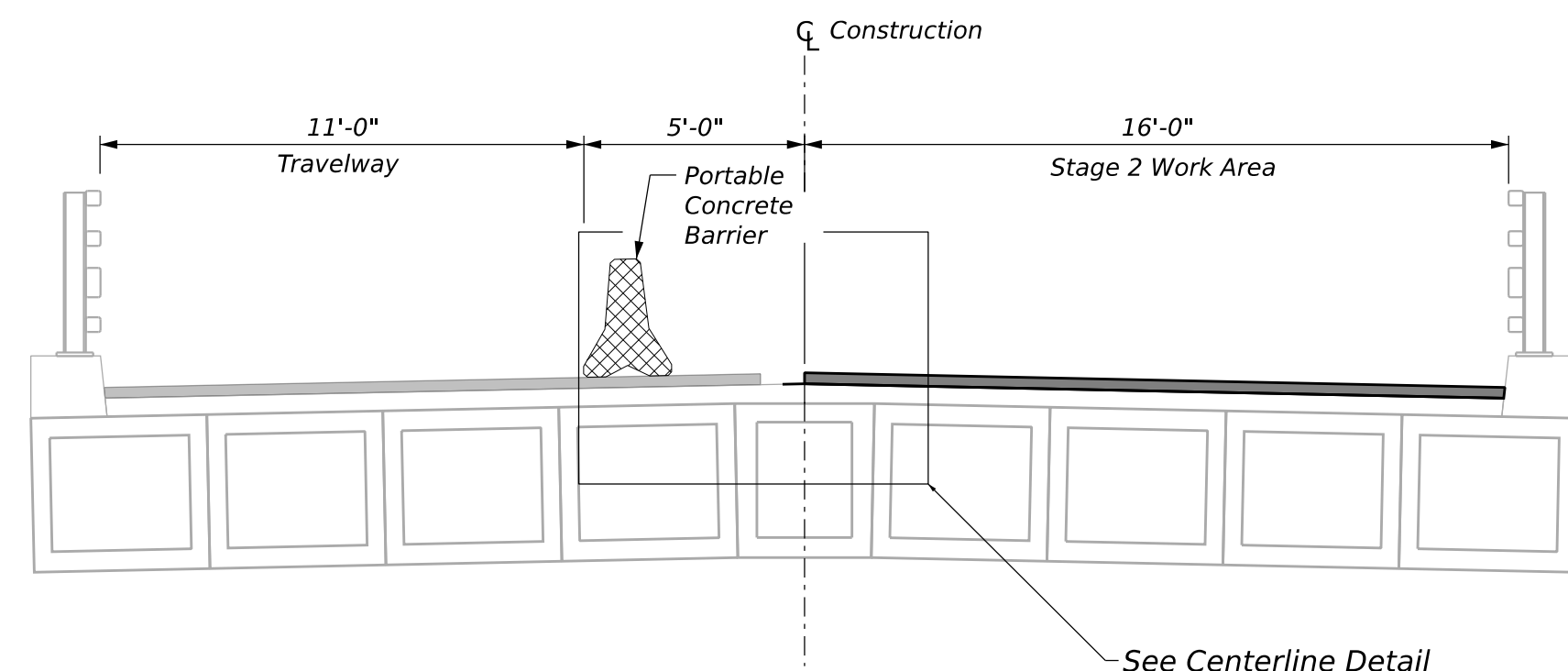

STAGE 2

Maintain the travelway for alternating traffic on Left.
Place new wearing surface and waterproofing membrane on Right.

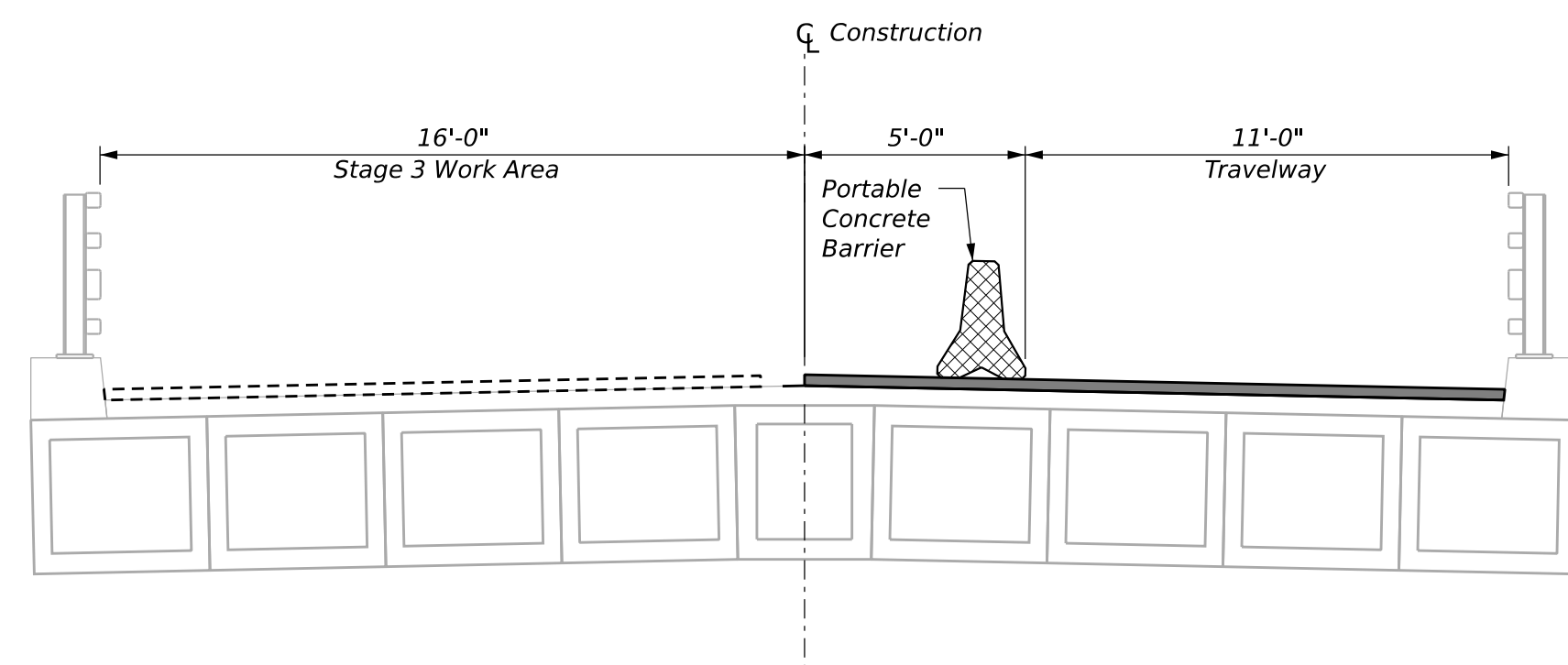

STAGE 3

Move temporary barriers to allow for alternating traffic on Right.
Remove the existing wearing surface and waterproofing membrane on the Left.

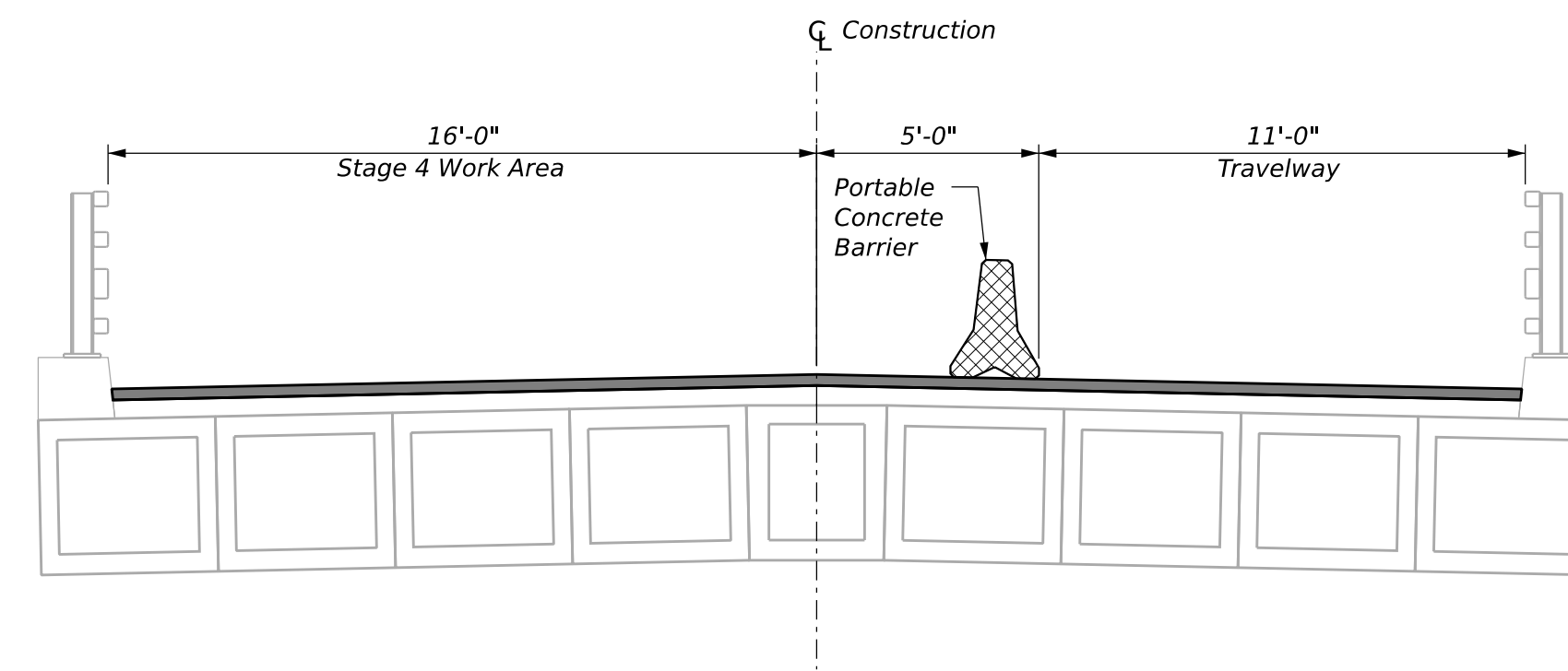

STAGE 4

Maintain the travelway for alternating traffic on the Right.
Place new wearing surface and waterproofing membrane on the Left.
Lap waterproofing membrane over previously placed membrane on the Right.

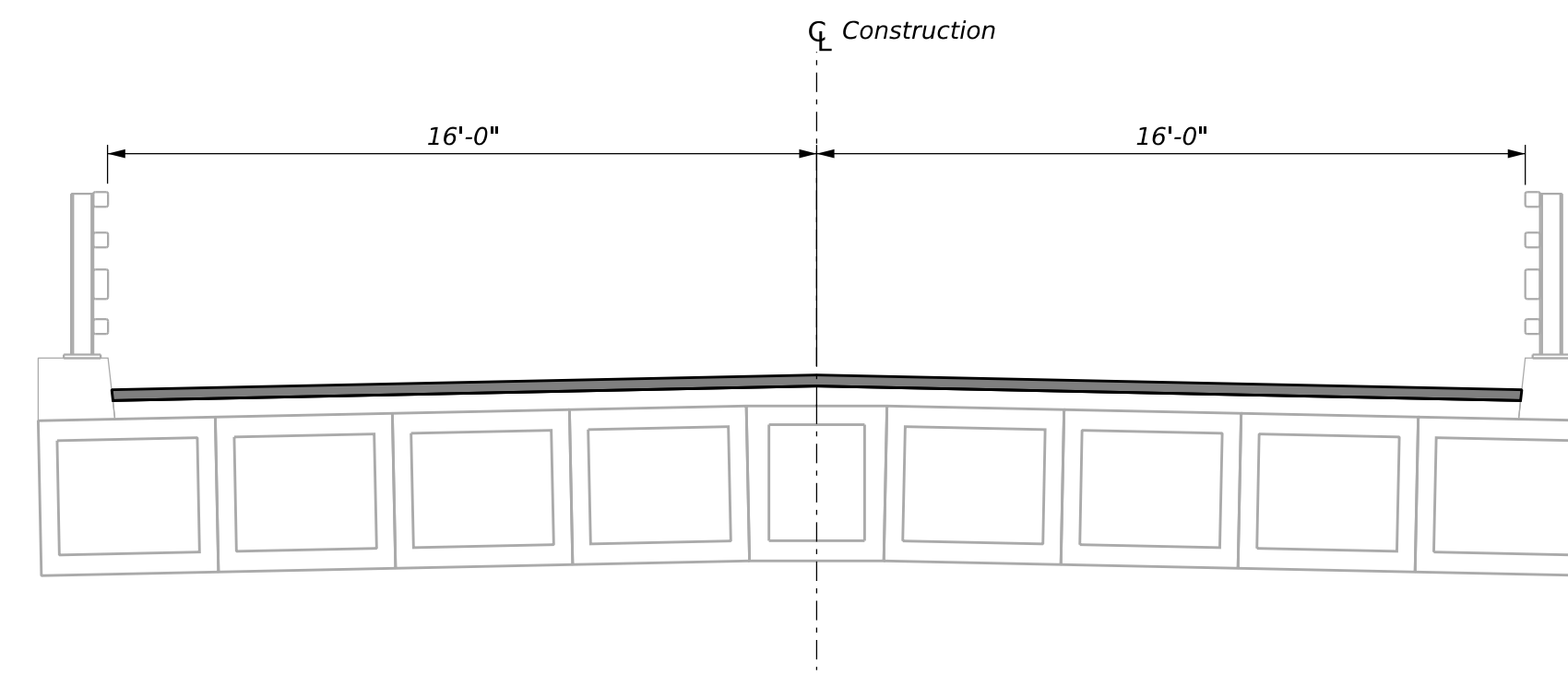

STAGE 5

Remove temporary barriers and open bridge to two-way traffic.

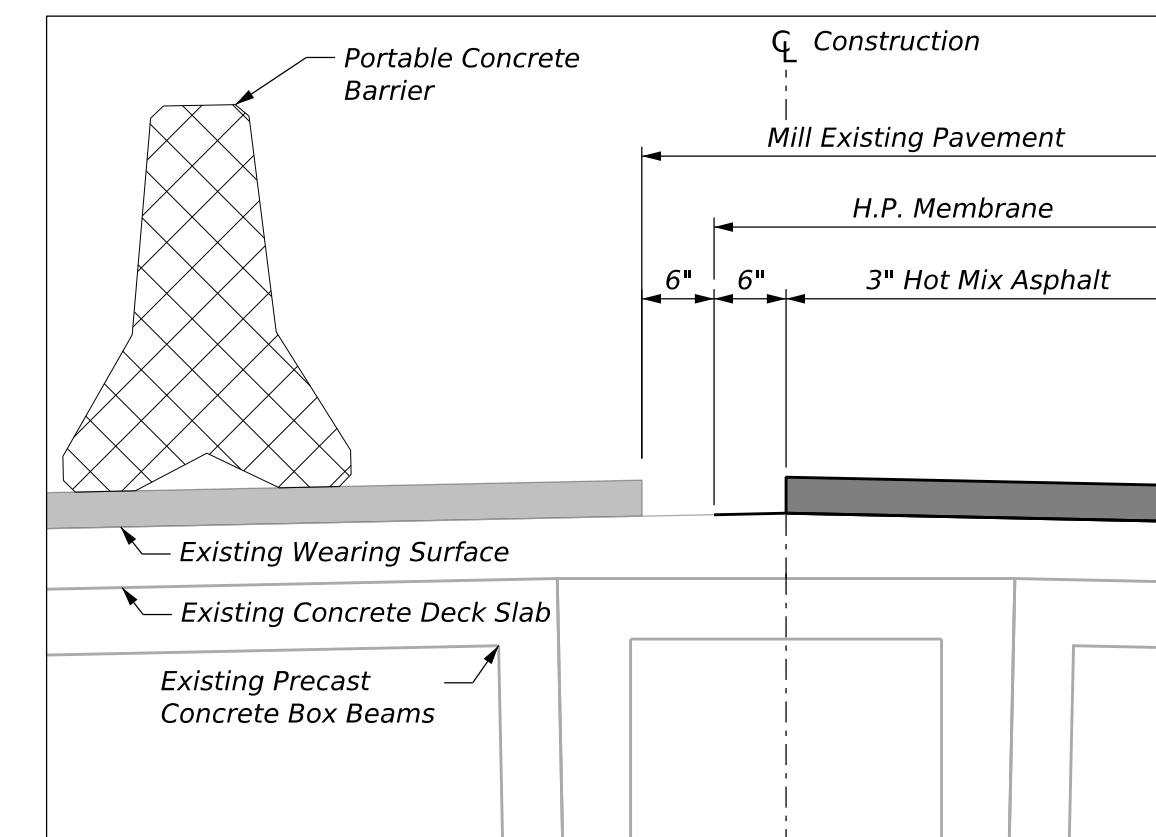

CENTERLINE DETAIL

STATE OF MAINE
DEPARTMENT OF TRANSPORTATION
Federal Project No. 02930800

WIN 029308.00

PROJ. MANAGER	DATE	BY	DATE
SIMONE ZIMMERMAN	05/2026	J. JANES	05/2026
DESIGN-DETAILED		J. JANES	
CHECKED-REVIEWED		G. GUSTAFSON	
DESIGN-DETAILED		M. POULIN	
REVISIONS 1			
REVISIONS 2			
REVISIONS 3			
REVISIONS 4			
FIELD CHANGES			

STAPLES POINT BRIDGE NO. 5278
CROSSING PRESUMPCOT RIVER
FALMOUTH

STAGED CONSTRUCTION SECTIONS

SHEET NUMBER

5

OF 5