

STATE OF MAINE DEPARTMENT OF TRANSPORTATION



AUGUSTA

KENNEBEC COUNTY

INTERSTATE 95 NORTHBOUND & SOUTHBOUND

FEDERAL PROJECT NO. 2749810

PROJECT LENGTH: 5.65 MILES

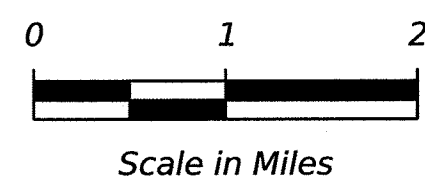
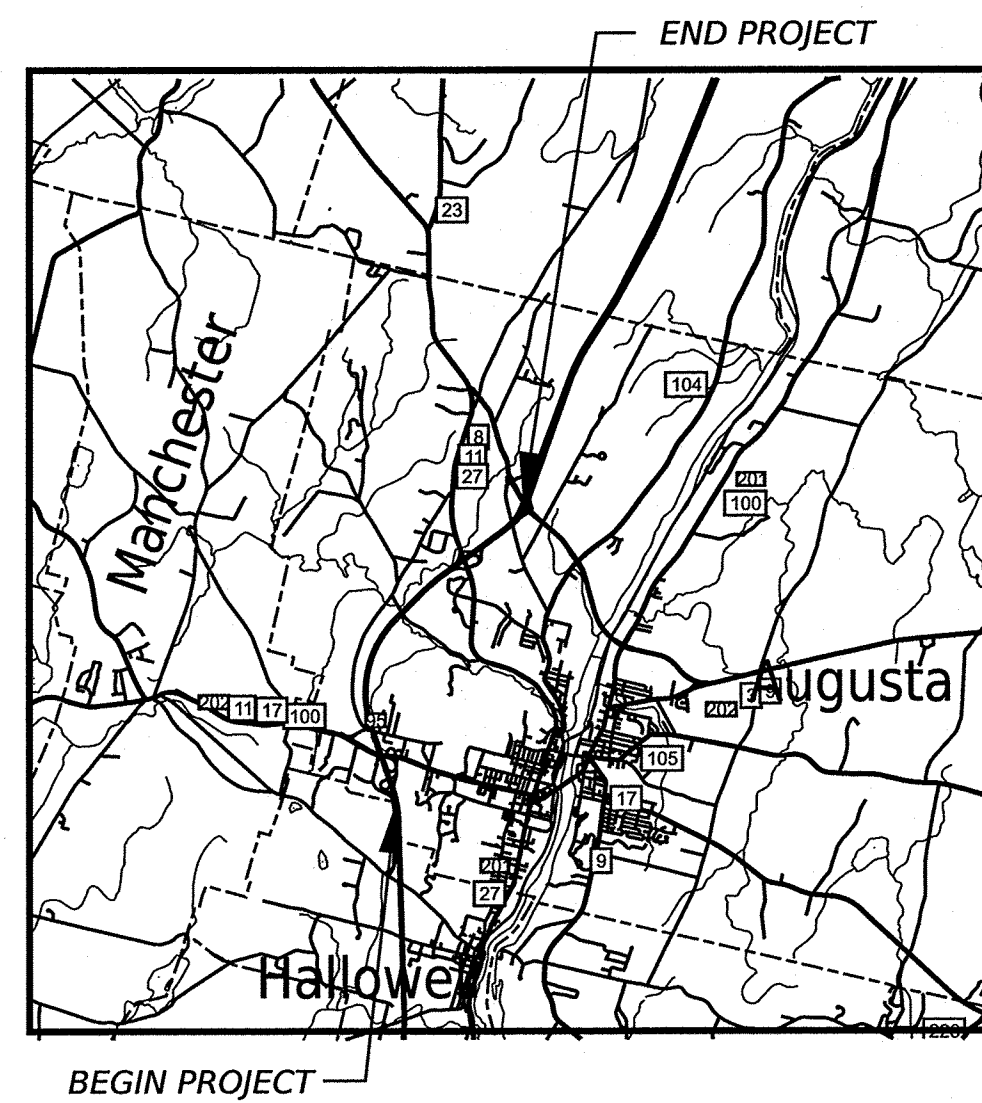

LOCATION MAP

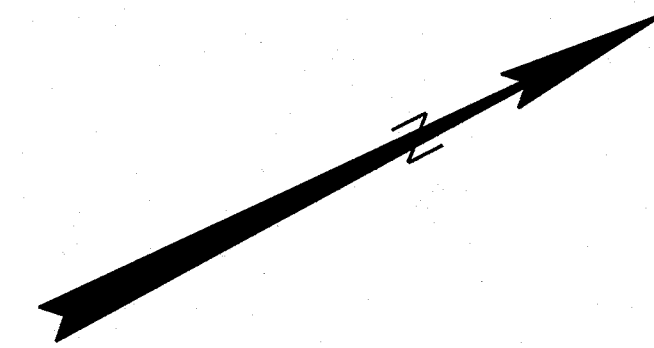
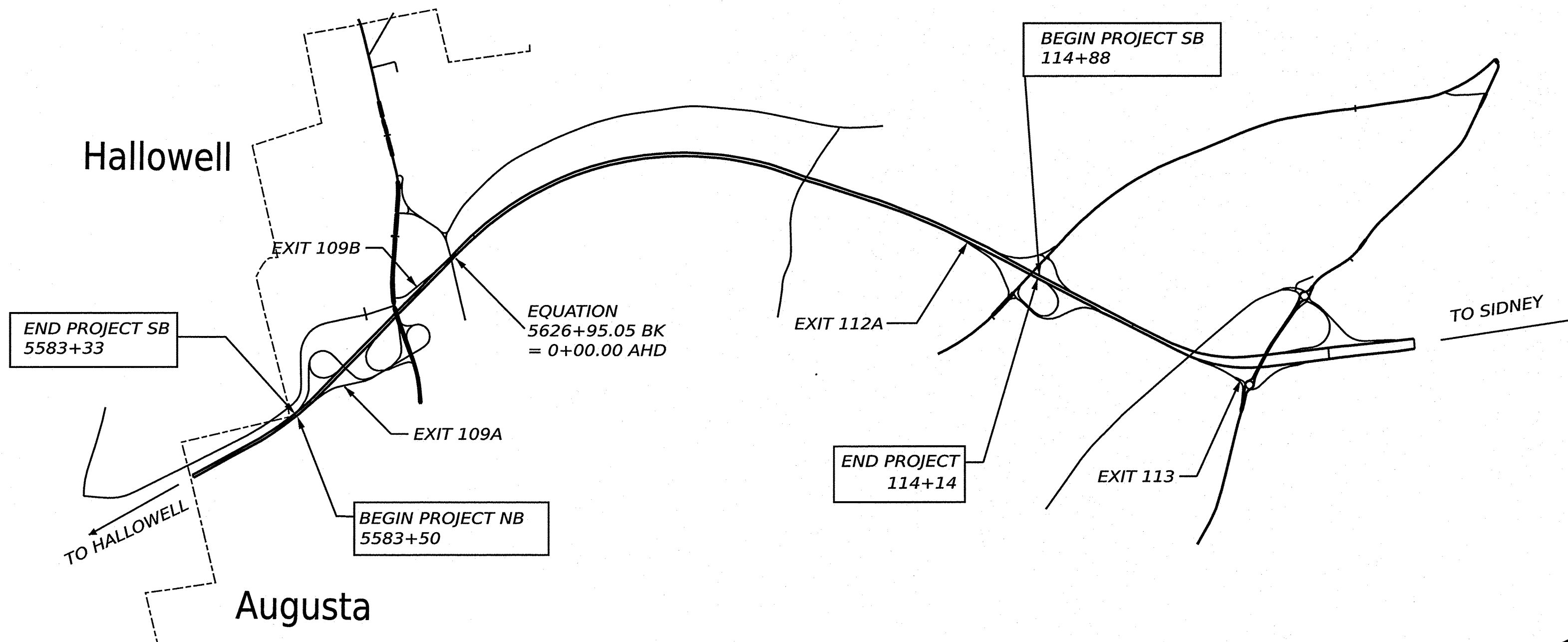

INDEX OF SHEETS	
Description	Sheet No.
Title Sheet	1
Typical Sections	2-5
Grading Plan	6
Geometric Curb Layout	7
Plan / Profile	8-9
Cross - Sections	10-17

STATE OF MAINE DEPARTMENT OF TRANSPORTATION	APPROVED	DATE
COMMISSIONER: <i>[Signature]</i>	COMMISSIONER: <i>[Signature]</i>	5/18/26
CHIEF ENGINEER: <i>[Signature]</i>	CHIEF ENGINEER: <i>[Signature]</i>	5-18-26

STATE OF MAINE Scott Shawin Smith Professional Engineer License No. 2321 5/11/26	SIGNATURE	P.E. NUMBER	DATE
PROGRAM	PROJECT MANAGER	DESIGNER	PROJECT RESIDENT
REGIONAL PROGRAM	SHAWIN SMITH	CONSULTANT	CONTRACTOR
PROJECT INFORMATION	PROJECT COMPLETION DATE		

PROGRAM	PROJECT MANAGER	DESIGNER	PROJECT RESIDENT	CONTRACTOR	PROJECT COMPLETION DATE
REGIONAL PROGRAM	SHAWIN SMITH	CONSULTANT	CONTRACTOR	PROJECT COMPLETION DATE	PROJECT COMPLETION DATE

FEDERAL PROJECT NO. 2749810

AUGUSTA
INTERSTATE 95 NORTHBOUND
& SOUTHBOUND

TITLE SHEET

SHEET NUMBER

1

OF 17

TRAFFIC DATA	I-95 (NB) N/O ONRAMP FROM SR 11/17/202	I-95 (SB) N/O OFFRAMP TO SR 11/17/202 (WB)	I-95 NB OFF RAMP TO SR 11/17/202 (EB/WB)	I-95 NB OFF RAMP TO SR 11/17/202 (EB/WB)
Current (2026) AADT	20580	20220	3950	6460
Future (2046) AADT	22640	22240	4350	7110
DHV - % of AADT	12%	11%	12%	13%
Design Hour Volume	2617	2446	522	924
% Heavy Trucks (AADT)	18%	17%	7%	6%
% Heavy Trucks (DHV)	10%	12%	4%	3%
Directional Distribution (DHV)	100%	100%	100%	100%
18-kip Equivalent P 2.0	2653	2970	222	294
18-kip Equivalent P 2.5	2527	2829	212	280
Design Speed (mph)	65	65	55	55
Corridor Priority	1	1	1	1

PROJECT LOCATION:	NORTHBOUND: BEGINNING 0.12 OF A MILE NORTH OF THE HALLOWELL TOWN LINE AND EXTENDING NORTH 3.26 MILES. SOUTHBOUND: BEGINNING 0.55 OF A MILE SOUTH OF OLD BELGRADE ROAD AND EXTENDING SOUTH 3.28 MILES. INCLUDES RAMPS & APPROACHES.
PROGRAM AREA:	REGIONAL PROGRAM
SCOPE OF WORK:	MILL & FILL

Username: mathieu.cutler Date: 5/11/2026

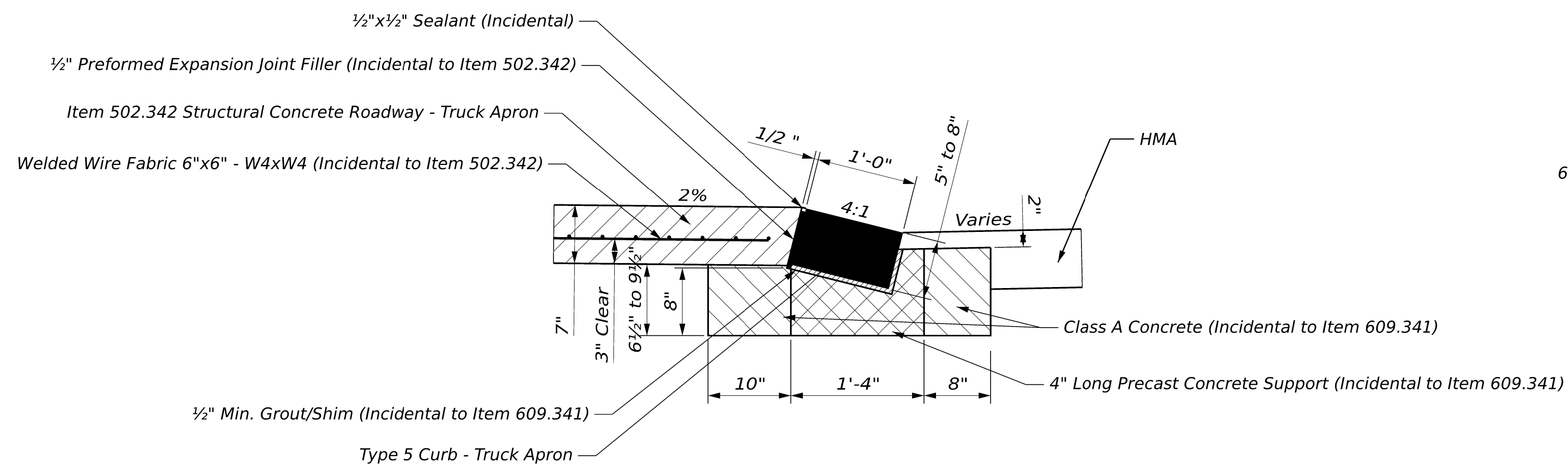

TRUCK APRON DETAIL

Not To Scale

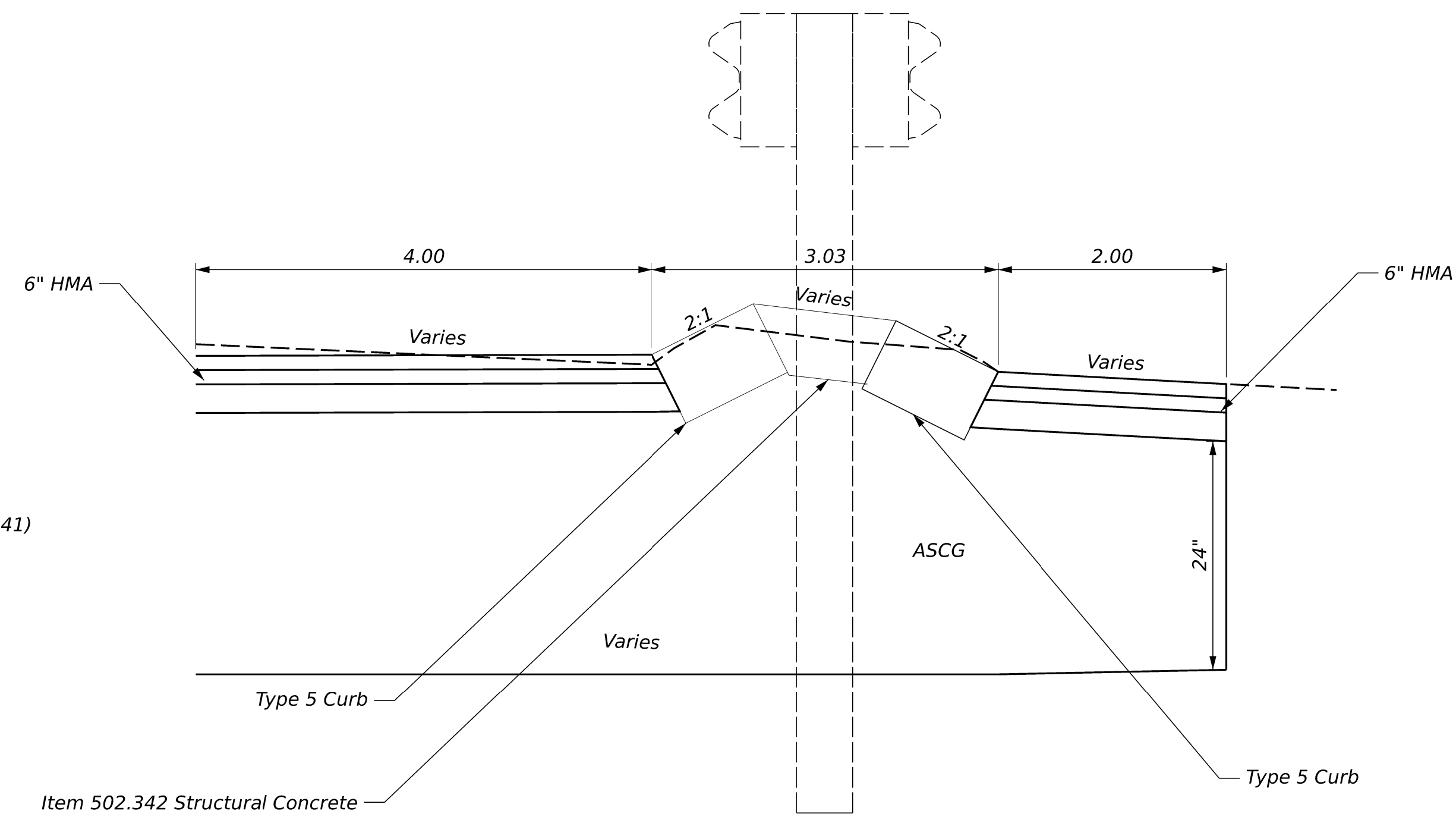

MEDIAN ISLAND DETAIL

Not To Scale

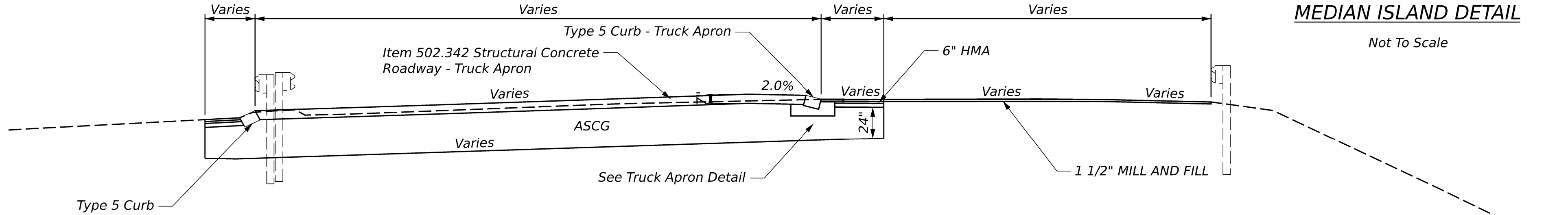

RAMP A TYPICAL

NOT TO SCALE

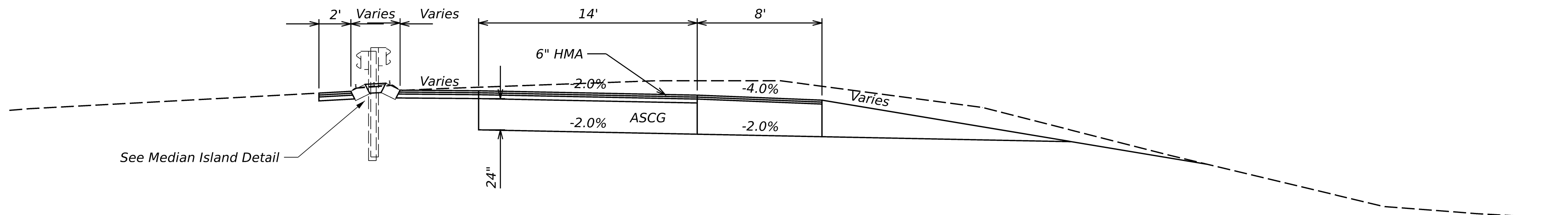

RAMP F TYPICAL - PARTIAL FULL DEPTH RECONSTRUCTION

NOT TO SCALE

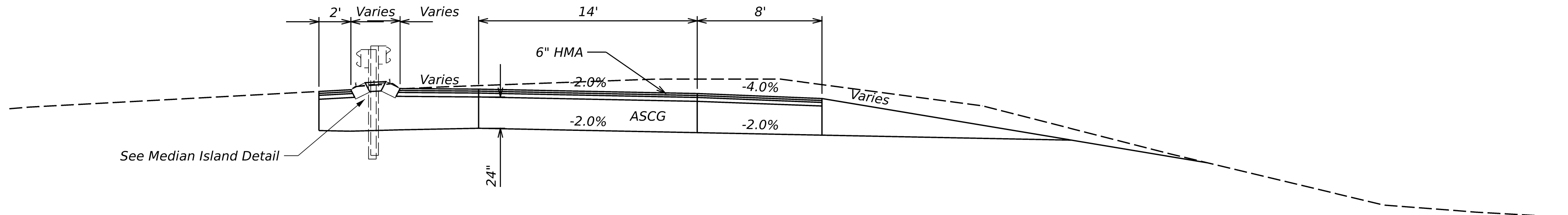

RAMP F TYPICAL - FULL DEPTH RECONSTRUCTION

NOT TO SCALE

PROJ. MANAGER	S. SMITH	DATE	
CHECKED-REVIEWED	S. LEONARDO	BY	
DESIGN-DETAILED		SIGNATURE	
DESIGN-REVIEWED		P.E. NUMBER	
DESIGN-DETAILED2		DATE	
REVISIONS 1			
REVISIONS 2			
REVISIONS 3			
REVISIONS 4			
FIELD CHANGES			

**AUGUSTA
EXIT 109 RAMP F
TYPICAL SECTIONS**

$\frac{3}{4}$ " MILL PASSING LANE
 $2 \frac{3}{4}$ " MILL TRAVEL LANE
 2" HMA BASE TRAVEL LANE
 $\frac{3}{4}$ " ULTRA-THIN BONDED WEARING COURSE

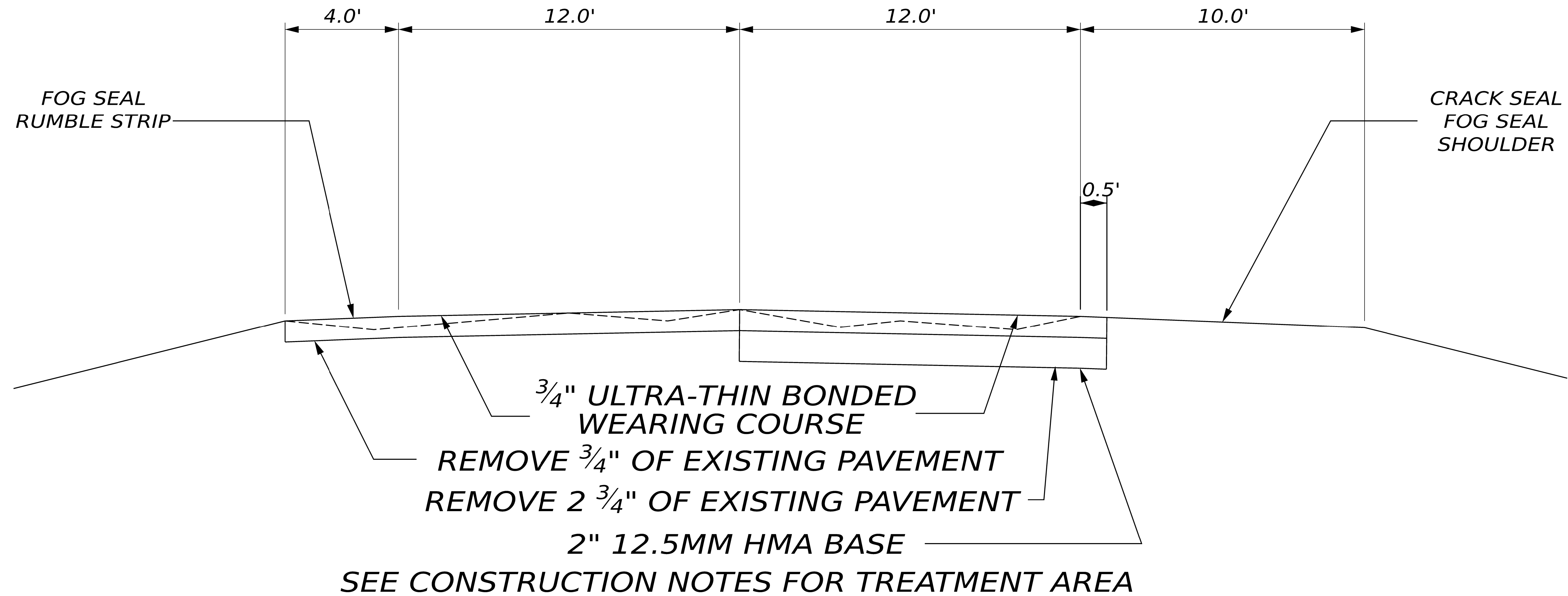

NOT TO SCALE

AUGUSTA
 INTERSTATE 95 NORTHBOUND
 & SOUTHBOUND
 TYPICAL SECTIONS

WIN 27498.10

STATE OF MAINE
 DEPARTMENT OF TRANSPORTATION
 2749810 HIGHWAY PLANS

SHEET NUMBER
 3 OF 17

RAMPS
MILL & FILL
MAINLINE ONLY

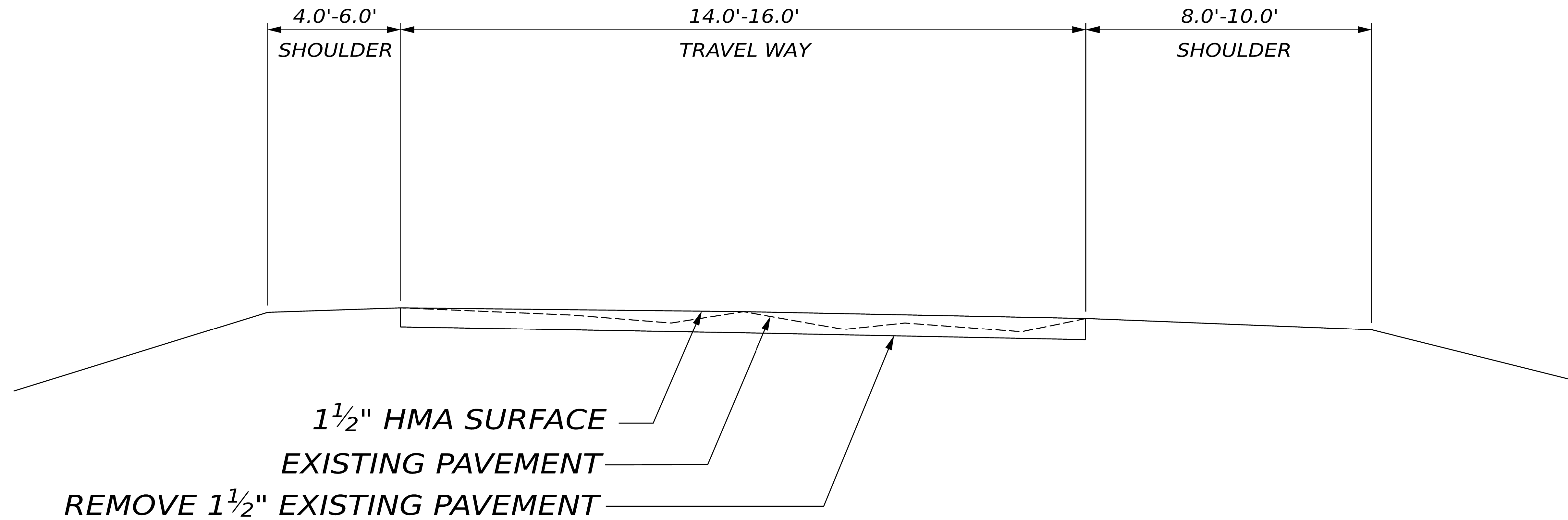

SEE CONSTRUCTION NOTES FOR TREATMENT AREA

NOT TO SCALE

AUGUSTA INTERSTATE 95 NORTHBOUND & SOUTHBOUND		STATE OF MAINE DEPARTMENT OF TRANSPORTATION	SHEET NUMBER 4 OF 17
TYPICAL SECTIONS	WIN 27498.10	2749810 HIGHWAY PLANS	

*1½" MILL & FILL
BRIDGE DECK*

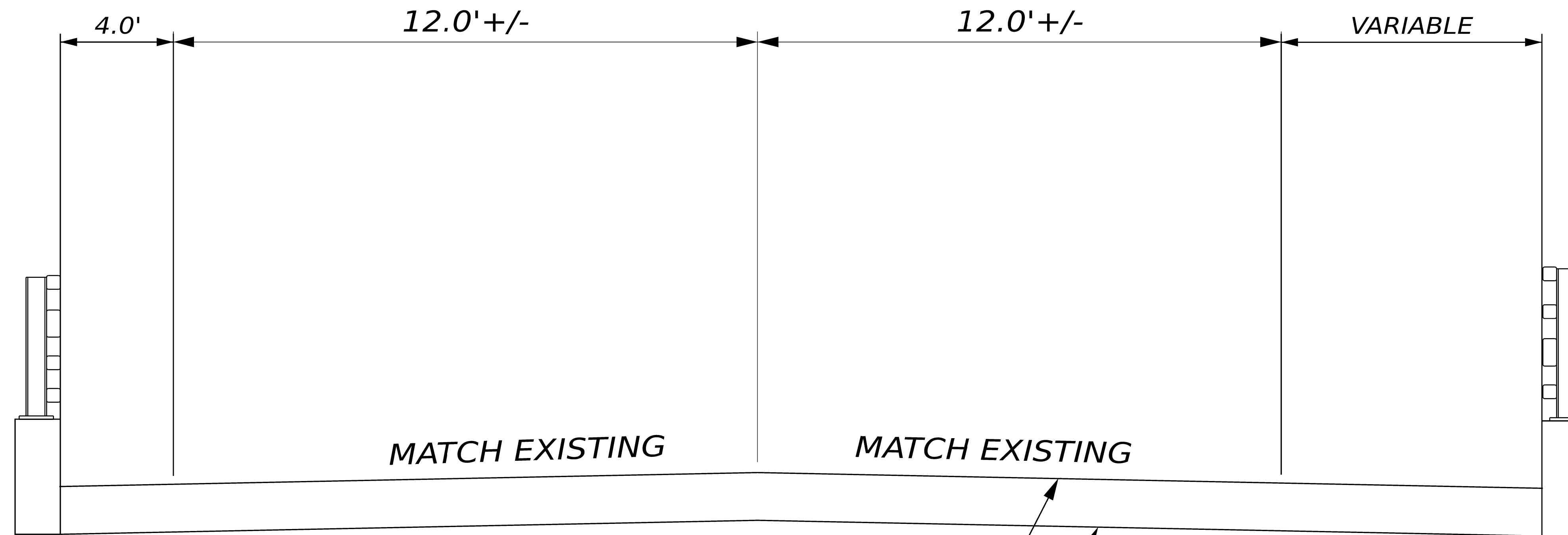

1½" 12.5MM HMA SURFACE

REMOVE 1½" OF EXISTING PAVEMENT

NOT TO SCALE

AUGUSTA
INTERSTATE 95 NORTHBOUND
& SOUTHBOUND

TYPICAL SECTIONS

WIN 27498.10

STATE OF MAINE
DEPARTMENT OF TRANSPORTATION

2749810

HIGHWAY PLANS

SHEET NUMBER

5 OF 17

LEGEND		
1+32.79	4+78.61	TRUCK APRON CURB
11+22.94	14+36.49	ON RAMP CURB

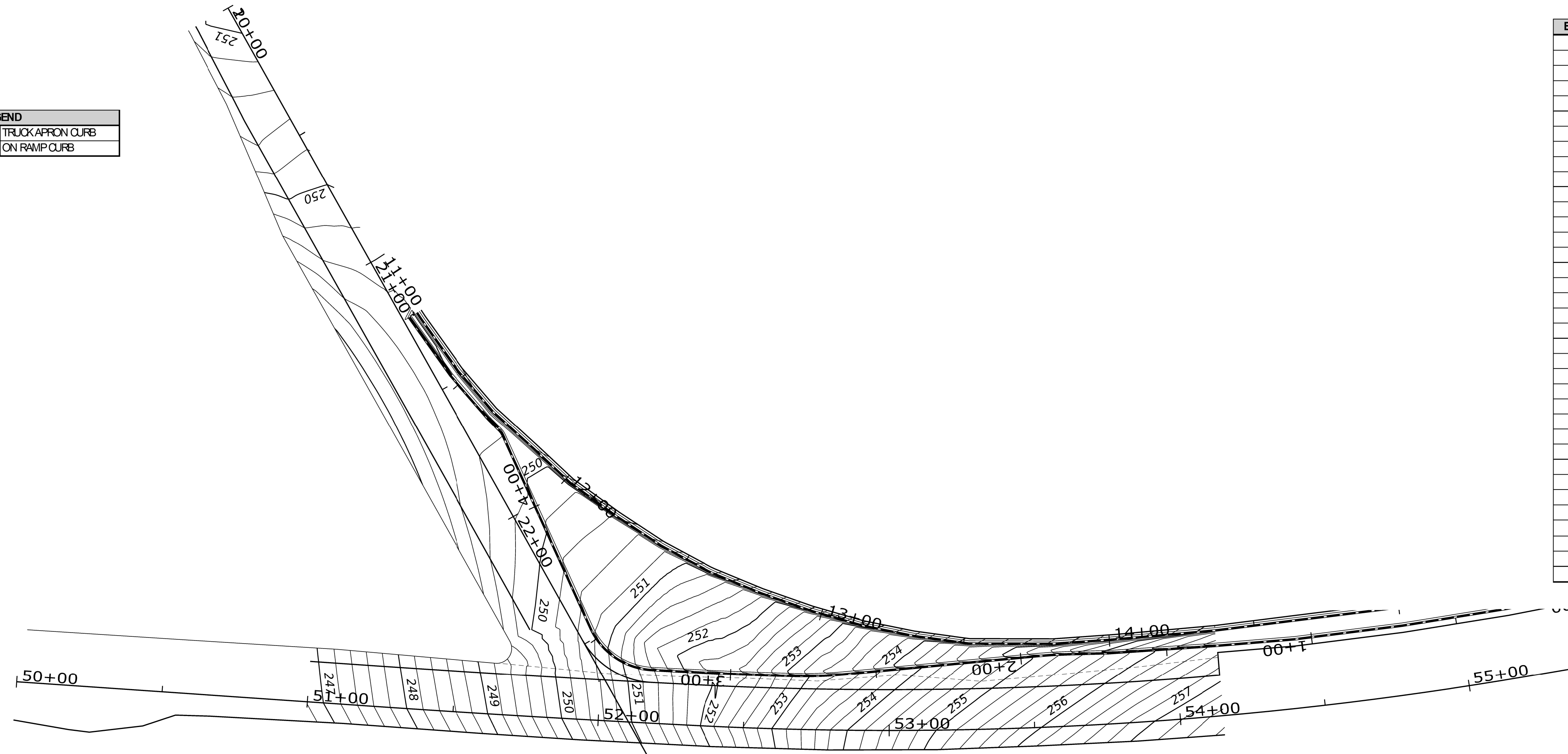

ELEVATIONS FOR APRON CURB	
1+32.79	256.46
1+40.00	256.30
1+50.00	256.08
1+60.00	255.85
1+70.00	255.61
1+80.00	255.37
1+90.00	255.13
2+00.00	254.89
2+10.00	254.64
2+20.00	254.39
2+30.00	254.12
2+40.00	253.84
2+50.00	253.56
2+60.00	253.28
2+70.00	253.10
2+80.00	252.75
2+90.00	252.38
3+00.00	252.08
3+10.00	251.93
3+20.00	251.62
3+30.00	251.27
3+40.00	250.91
3+50.00	250.61
3+60.00	250.42
3+70.00	250.28
3+80.00	250.14
3+90.00	250.00
4+00.00	249.86
4+10.00	249.74
4+20.00	249.64
4+30.00	249.58
4+40.00	249.55
4+50.00	249.55
4+60.00	249.56
4+70.00	249.58
4+78.61	249.60

ELEVATIONS FOR ON RAMP CURB	
11+22.94	249.61
11+30.00	249.58
11+40.00	249.54
11+50.00	249.48
11+60.00	249.38
11+70.00	249.35
11+80.00	249.39
11+90.00	249.50
12+00.00	249.67
12+10.00	249.81
12+20.00	249.95
12+30.00	250.12
12+40.00	250.30
12+50.00	250.55
12+60.00	250.80
12+70.00	251.10
12+80.00	251.42
12+90.00	251.81
13+00.00	252.21
13+10.00	252.66
13+20.00	253.03
13+30.00	253.34
13+40.00	253.70
13+50.00	254.08
13+60.00	254.36
13+70.00	254.61
13+80.00	254.86
13+90.00	255.09
14+00.00	255.33
14+10.00	255.56
14+20.00	255.79
14+30.00	256.02
14+36.49	256.17

ALIGNMENT DATA FOR TRUCK APRON CURB		
Station	X COORD	Y COORD
Element Linear		
1+05.72	540203.47	1132548.2
1+33.19	540176.1	1132545.89
3 S04°48'51.48"W		
27.47		
Element Linear		
1+33.19	540176.1	1132545.89
1+69.85	540139.61	1132542.27
3 S05°40'05.42"W		
36.66		
Element Linear		
1+69.85	540139.61	1132542.27
1+83.47	540126.13	1132540.34
3 S08°09'26.02"W		
13.62		
Element Circular		
1+83.47	540126.13	1132540.34
1+88.68	540120.97	1132539.6
	540104.85	1132688.82
1+93.89	540115.77	1132539.22
150		
03°58'53.41"	Left	
38°11'49.87"		
10.42		
5.21		
0.09		
Element Linear		
1+93.89	540115.77	1132539.22
2+60.51	540049.33	1132534.37
3 S04°10'32.60"W		
66.62		

ALIGNMENT DATA FOR TRUCK APRON CURB			
Station	X COORD	Y COORD	
Element Circular			
PC	2+60.51	540049.33	1132534.37
PI	2+69.52	540040.34	1132533.71
CC		540060.25	1132384.77
PCC	2+78.51	540031.5	1132531.99
R	150		
Δ	06°52'33.22"	Right	
D	38°11'49.87"		
L	18		
T	9.01		
E	0.27		
Element Circular			
PCC	2+78.51	540031.5	1132531.99
PI	2+94.07	54016.22	1132529.00
CC		540277.25	1131273.76
PCC	3+09.63	540001.03	1132525.65
R	1282		
Δ	01°23'27.58"	Right	
D	04°28'09.30"		
L	31.12		
T	15.56		
E	0.09		
Element Circular			
PCC	3+09.63	540001.03	1132525.65
PI	3+18.36	539992.51	1132523.77
CC		541289.92	1126684.15
PCC	3+27.08	539984	1132521.87
R	5982		
Δ	00°10'01.54"	Right	
D	00°57'28.09"		
L	17.45		
T	8.72		
E	0.01		

ALIGNMENT DATA FOR TRUCK APRON CURB			
Station	X COORD	Y COORD	
Element Circular			
PCC	3+27.08	539984	1132521.87
PI	3+42.24	539969.21	1132518.56
CC		539989.46	1132497.47
PT	3+54.33	539965.3	1132503.91
R	25		
Δ	62°27'01.40"	Right	
D	229°10'59.22"		
L	27.25		
T	15.16		
E	4.24		
Element Linear			
PT	3+54.33	539965.3	1132503.91
PC	4+26.95	539946.58	1132433.75
BEARING S75°03'36.34"W			
L	72.62		
Element Circular			
PC	4+26.95	539946.58	1132433.75
PI	4+27.83	539946.35	1132432.9
CC		539941.75	1132435.04
PT	4+28.69	539945.85	1132432.17
R	5		
Δ	19°58'36.41"	Left	
D	65°54'56.12"		
L	1.74		
T	0.88		
E	0.08		
Element Linear			
PT	4+28.69	539945.85	1132432.17
PI	4+34.51	539942.52	1132427.4
BEARING S55°04'59.93"W			
L	5.82		

ALIGNMENT DATA FOR TRUCK APRON CURB			
Station	X COORD	Y COORD	
Element Linear			
PI	4+34.51	539942.52	1132427.4
PI	4+54.18	539932.27	1132410.62
BEARING S58°36'06.77"W			
L	19.67		
Element Linear			
PI	4+54.18	539932.27	1132410.62
PI	4+78.46	539921.67	1132388.77
BEARING S64°07'25.57"W			
L	24.28		
Element Linear			
PI	4+78.46	539921.67	1132388.77
END	4+94.59	539915.51	1132373.86
BEARING S67°33'07.36"W			
L	16.14		

ALIGNMENT DATA FOR ON RAMP CURB		
Station	X COORD	Y COORD
Element Linear		
10+00.00	539878.45	1132273.52
10+36.41	539890.73	1132307.8
3 N70°17'47.23"E		
36.41		
Element Circular		
10+36.41	539890.73	1132307.8
10+48.20	539894.7	1132318.89
	540220.23	1132189.79
10+59.97	539899.41	1132329.69
350		
03°51'22.03"	Left	
16°22'12.80"		
23.56		
11.78		
0.2		
Element Linear		
10+59.97	539899.41	1132329.69
11+23.88	539924.95	1132388.28
3 N66°26'25.20"E		
63.91		
Element Circular		
11+23.88	539924.95	1132388.28
11+24.74	539925.3	1132389.06
	540199.41	1132268.6
11+25.59	539925.64	1132389.84
299.42		
Element Linear		
00°19'38.27"	Left	
19°08'09.06"		
1.71		
0.86		
0		

ALIGNMENT DATA FOR ON RAMP CURB			
Station	X COORD	Y COORD	Element Linear
PI	11+25.59	539925.64	1132389.84
PI	11+47.47	539935.22	1132409.5
BEARING N64°01'11.02"E			
L	21.87		
Element Linear			
PI	11+47.47	539935.22	1132409.5
PI	11+65.98	539944.77	1132425.37
BEARING N58°56'53.12"E			
L	18.52		
Element Linear			
PI	11+65.98	539944.77	1132425.37
PI	11+85.02	539956.5	1132440.36
BEARING N51°57'46.87"E			
L	19.04		
Element Linear			
PI	11+85.02	539956.5	1132440.36
PI	12+02.12	539966.88	1132453.95
BEARING N52°37'34.63"E			
L	17.1		
Element Linear			
PI	12+02.12	539966.88	1132453.95
PI	12+21.80	539980.72	1132467.95
BEARING N45°20'56.50"E			
L	19.68		
Element Linear			
PI	12+21.80	539980.72	1132467.95
PI	12+40.16	539994.17	1132480.44
BEARING N42°52'23.28"E			
L	18.36		

ALIGNMENT DATA FOR ON RAMP CURB			
Station	X COORD	Y COORD	Element Linear
PI	12+40.16	539994.17	1132480.44
PI	12+59.27	540009.28	1132492.15
BEARING N37°46'32.44"E			
L	19.11		
Element Linear			
PI	12+59.27	540009.28	1132492.15
PI	12+78.19	540025.33	1132502.16
BEARING N31°57'09.95"E			
L	18.92		
Element Linear			
PI	12+78.19	540025.33	1132502.16
PI	12+96.40	540041.28	1132510.96
BEARING N28°53'22.10"E			
L	18.21		
Element Linear			
PI	12+96.40	540041.28	1132510.96
PI	13+14.57	540057.66	1132518.81
BEARING N25°35'29.96"E			
L	18.16		
Element Linear			
PI	13+14.57	540057.66	1132518.81
PI	13+32.59	540074.48	1132525.27
BEARING N21°01'22.75"E			
L	18.02		
Element Linear			
PI	13+32.59	540074.48	1132525.27
PI	13+51.89	540092.96	1132531.04
BEARING N17°20'23.72"E			
L	19.31		

ALIGNMENT DATA FOR ON RAMP CURB			
Station	X COORD	Y COORD	Element Linear
PI	13+51.89	540093	1132531
PI	13+80.77	540121.4	1132536
BEARING N09°43'37.96"E			
L	28.88		
Element Linear			
PI	13+80.77	540121.4	1132536
PI	14+02.14	540142.7	1132538
BEARING N05°32'27.44"E			
L	21.36		
Element Linear			
PI	14+02.14	540142.7	1132538
PI	14+36.80	540177.2	1132541
BEARING N04°28'40.87"E			
L	34.66		

Username: mathieu.cutler Date: 4/28/2026

STATE OF MAINE	DEPARTMENT OF TRANSPORTATION	SIGNATURE	DATE
WIN	027498.10	P.E. NUMBER	DATE
PROJECT MANAGER	S. SMITH	BY	DATE
DESIGN-DETAILED	S. LEONARDO	CHECKED-REVIEWED	
DESIGN-REVIEWED		DESIGN-DETAILED	
REVISIONS 1		REVISIONS 1	
REVISIONS 2		REVISIONS 2	
REVISIONS 3		REVISIONS 3	
REVISIONS 4		REVISIONS 4	
FIELD CHANGES			

AUGUSTA
EXIT 109 RAMP F
GRADING PLAN

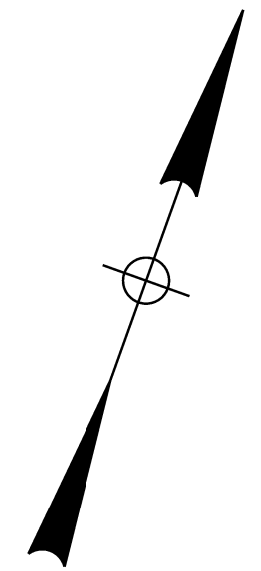
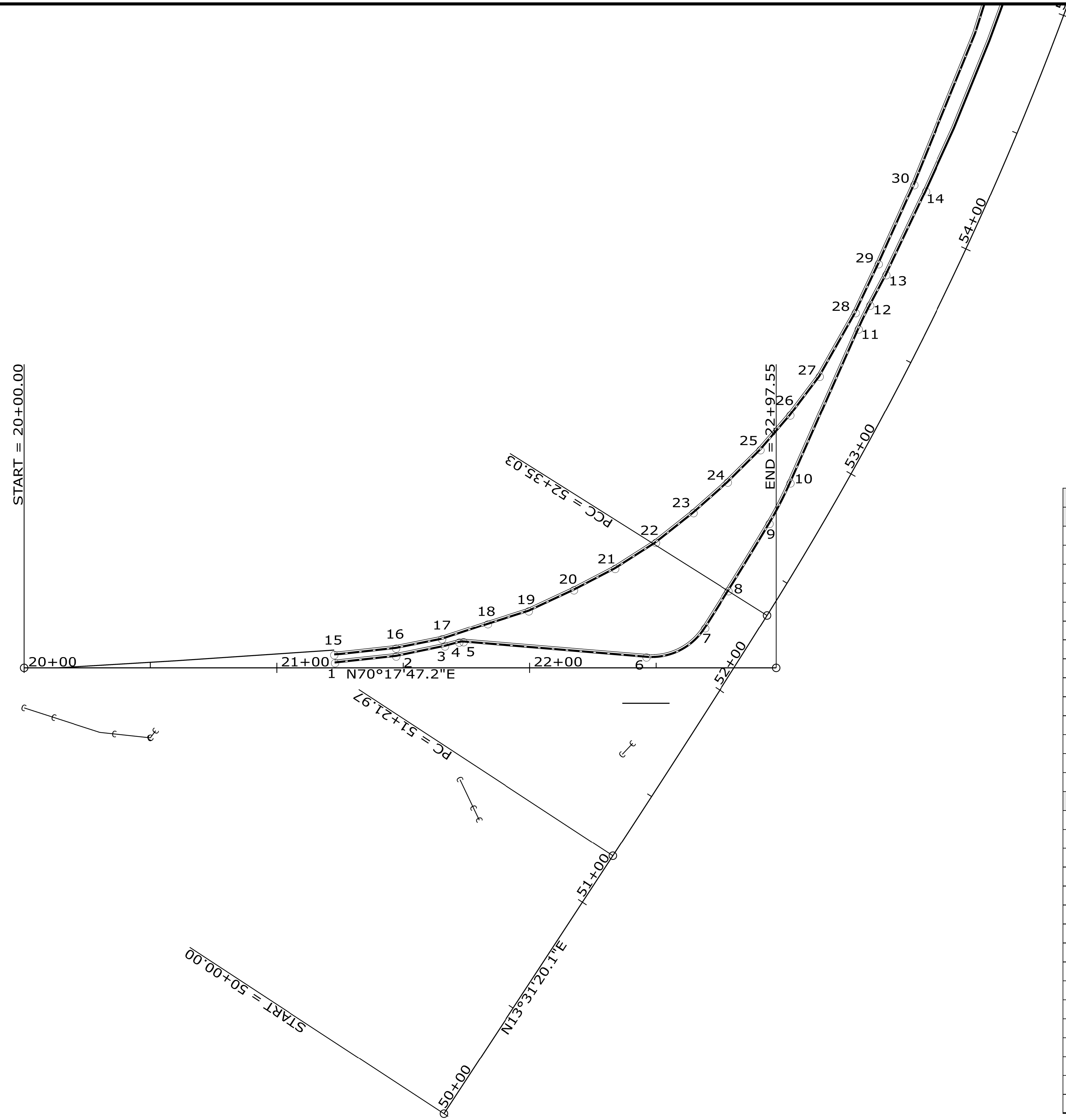

PT	STATION	OFFSET	NORTHING	EASTING
CONTROL POINTS FOR APRON CURB				
1	21+23.08	1.84' LT	539921.68	1132388.77
2	21+47.22	4.45' LT	539932.27	1132410.62
3	21+66.48	8.43' LT	539942.52	1132427.40
4	21+72.09	9.96' LT	539945.85	1132432.17
5	21+73.82	10.12' LT	539946.58	1132433.75
6	22+46.19	4.09' LT	539965.30	1132503.92
7	52+17.53	18.00' LT	539984.00	1132521.87
8	52+35.03	18.00' LT	540001.03	1132525.65
9	52+66.59	18.00' LT	540031.50	1132531.99
10	52+84.82	18.95' LT	540049.33	1132534.37
11	53+52.35	24.28' LT	540115.77	1132539.22
12	53+62.97	24.44' LT	540126.13	1132540.34
13	53+76.84	24.04' LT	540139.61	1132542.27
14	54+14.20	23.85' LT	540176.10	1132545.89
CONTROL POINTS FOR CURB LT				
15	21+22.78	5.03' LT	539924.58	1132387.41
16	21+47.17	7.60' LT	539935.22	1132409.50
17	21+65.32	11.25' LT	539944.78	1132425.37
18	21+83.39	17.23' LT	539956.50	1132440.36
19	21+99.68	22.42' LT	539966.88	1132453.95
20	22+17.53	30.73' LT	539980.72	1132467.95
21	22+33.83	39.18' LT	539994.17	1132480.44
22	52+35.90	52.49' LT	540009.28	1132492.15
23	52+54.39	46.03' LT	540025.33	1132502.16
24	52+72.34	40.50' LT	540041.28	1132510.96
25	52+90.40	35.74' LT	540057.66	1132518.81
26	53+08.53	32.17' LT	540074.48	1132525.27
27	53+28.14	29.29' LT	540092.96	1132531.04
28	53+57.66	28.26' LT	540121.43	1132535.92
29	53+79.50	28.64' LT	540142.69	1132537.98
30	54+14.94	29.13' LT	540177.24	1132540.69

ITEM 609.34 VERTICAL CURB TYPE 5						
PT. - PT.	RADIUS	LENGTH	STATION	OFFSET	NORTHING	EASTING
TANGENT, CURVE, & CENTERPOINT DATA FOR APRON CURB						
1 - 2		24.279				
2 - 3		19.667				
3 - 4		5.818				
12 - 13		13.62				
13 - 14		36.66				
TANGENT, CURVE, & CENTERPOINT DATA FOR CURB LT						
15 - 16		24.527				
16 - 17		18.517				
17 - 18		19.035				
18 - 19		17.097				
19 - 20		19.684				
20 - 21		18.358				
21 - 22		19.111				
22 - 23		18.923				
23 - 24		18.211				
24 - 25		18.163				
25 - 26		18.076				
26 - 27		19.307				
27 - 28		28.879				
28 - 29		21.363				
29 - 30		34.355				

ITEM 609.341 CURB TYPE 5 - TRUCK APRON						
PT. - PT.	RADIUS	LENGTH	STATION	OFFSET	NORTHING	EASTING
TANGENT, CURVE, & CENTERPOINT DATA FOR APRON CURB						
4 - 5	5	1.74	21+73.10	-0.050	539946.35	1132432.896
5 - 6		72.62				
6 - 7	25	27.25	22+48.27	-29.000	539969.21	1132518.558
7 - 8	5982	17.45	65+41.59	-5887.609	539992.51	1132523.771
8 - 9	1282	31.12	55+19.90	-1300.000	540016.23	1132529.003
9 - 10	150	18.00	52+66.59	-168.000	540040.34	1132533.714
10 - 11		66.62				
11 - 12	150	10.42	53+59.74	125.525	540120.97	1132539.601

STATE OF MAINE
DEPARTMENT OF TRANSPORTATION

WIN
027498.10
HIGHWAY PLANS

PROJ. MANAGER
S. SMITH

CHECKED/REVIEWED
S. LEONARDO

DESIGN/DATE/02

DESIGN/DATE/03

REVISIONS 1

REVISIONS 2

REVISIONS 3

REVISIONS 4

FIELD CHANGES

**AUGUSTA
EXIT 109 RAMP F
CURB LAYOUT**

SIGNATURE

P.E. NUMBER

DATE

SHEET NUMBER

7

OF 17

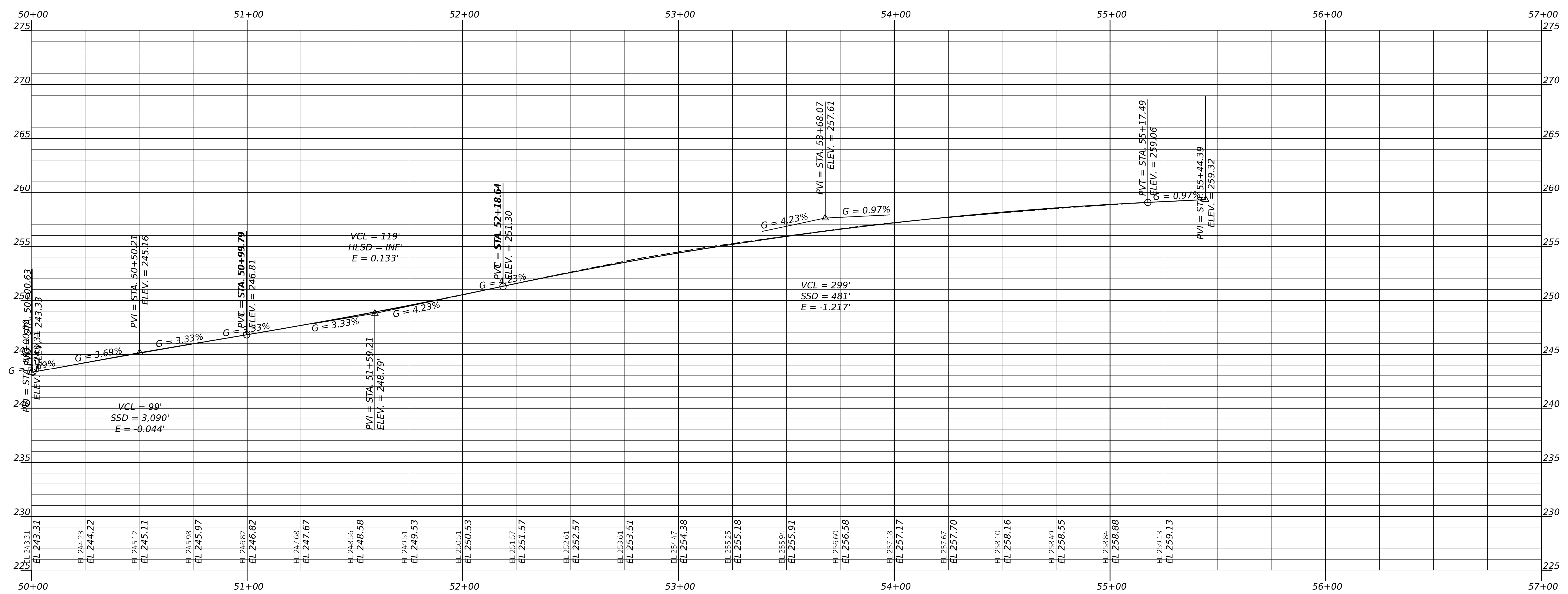
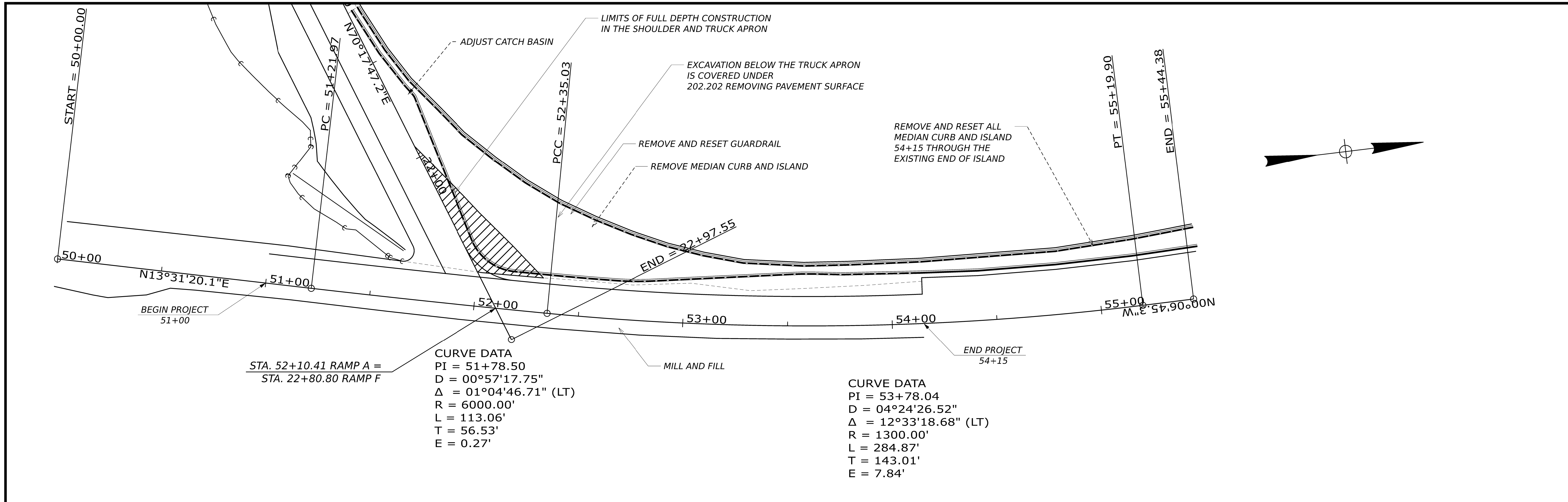

STATE OF MAINE DEPARTMENT OF TRANSPORTATION		SIGNATURE	P.E. NUMBER	DATE
AUGUSTA EXIT 109 RAMP F		RAMP A PLAN & PROFILE		
SHEET NUMBER		OF 17		
WIN 027498.10		HIGHWAY PLANS		

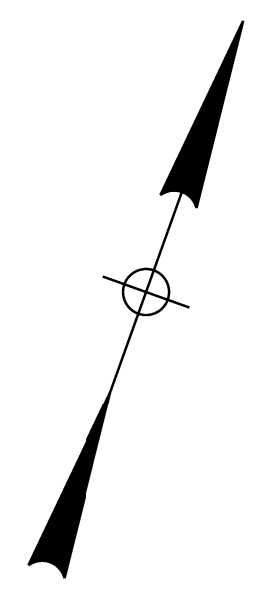
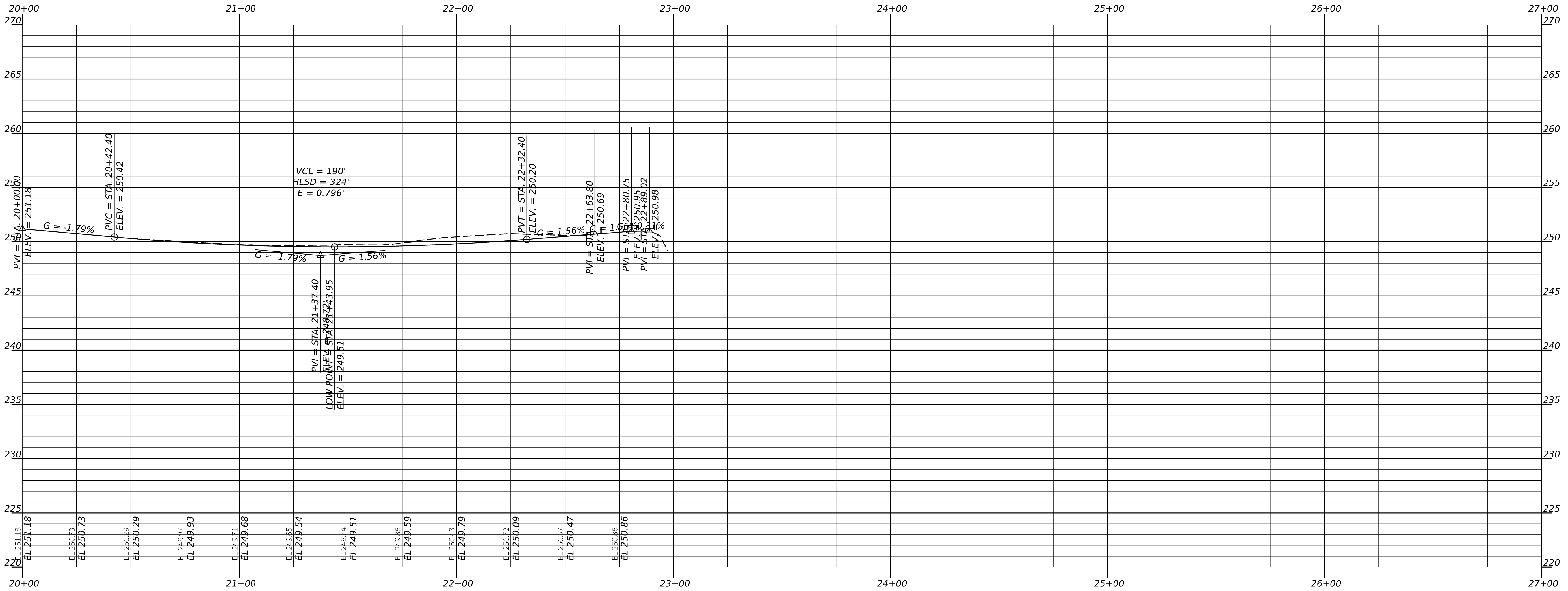
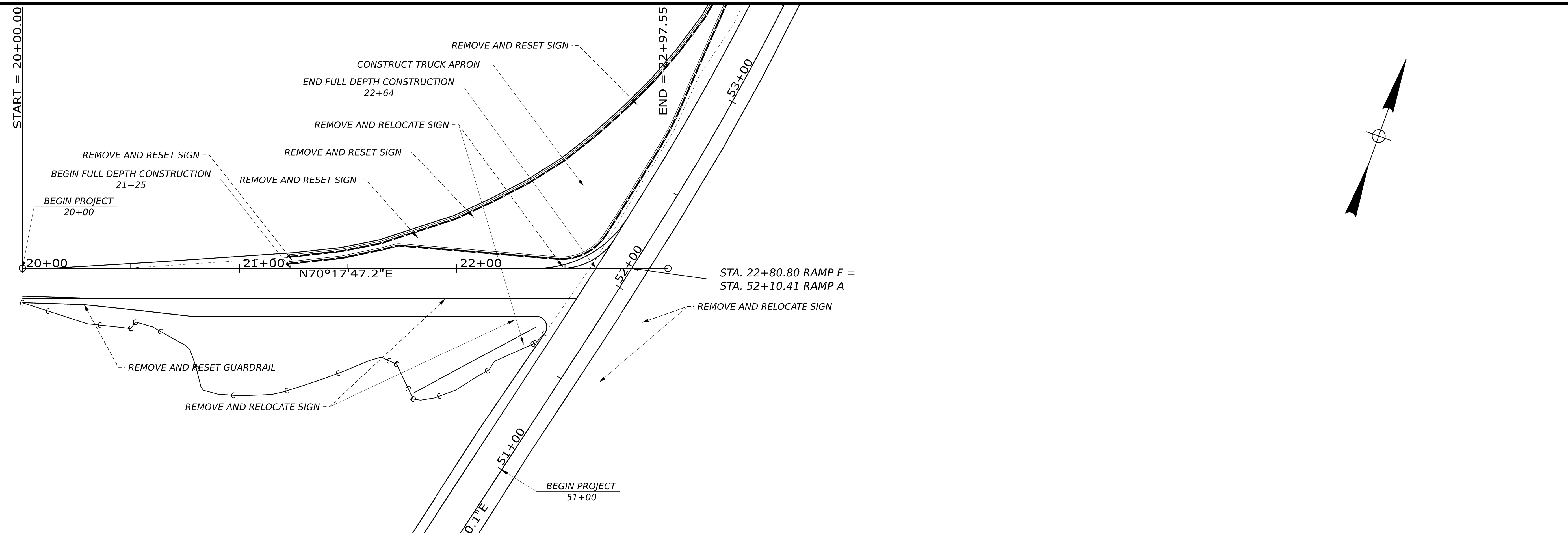

STATE OF MAINE DEPARTMENT OF TRANSPORTATION		SIGNATURE
		P.E. NUMBER
		DATE
AUGUSTA EXIT 109 RAMP F RAMP F PLAN & PROFILE		
SHEET NUMBER 9		
OF 17		
WIN 027498.10		HIGHWAY PLANS

Username: mathieu.cutler Date: 4/28/2026

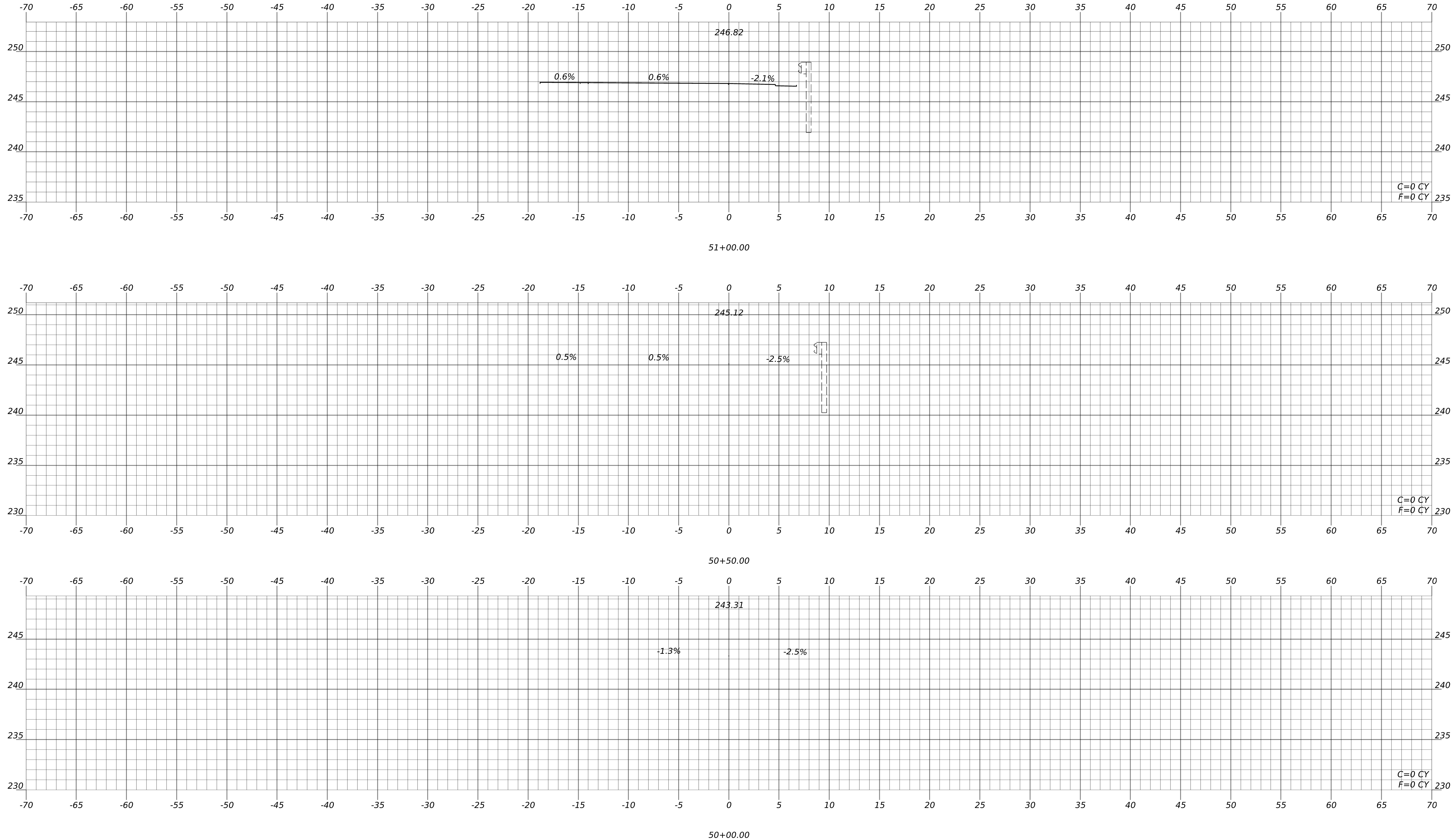

STATE OF MAINE
DEPARTMENT OF TRANSPORTATION

WIN
027498.10
HIGHWAY PLANS

SIGNATURE

P.E. NUMBER

DATE

DATE

BY

S. SMITH
S. LEONARDO

PROJ. MANAGER

DESIGN-DETAILED

CHECKED-REVIEWED

DESIGN-DETAILED02

DESIGN-DETAILED03

REVISIONS 1

REVISIONS 2

REVISIONS 3

REVISIONS 4

FIELD CHANGES

AUGUSTA
EXIT 109 RAMP F

RAMP A CROSS SECTIONS

SHEET NUMBER

10

OF 17

Username: mathieu.cutler Date: 4/28/2026

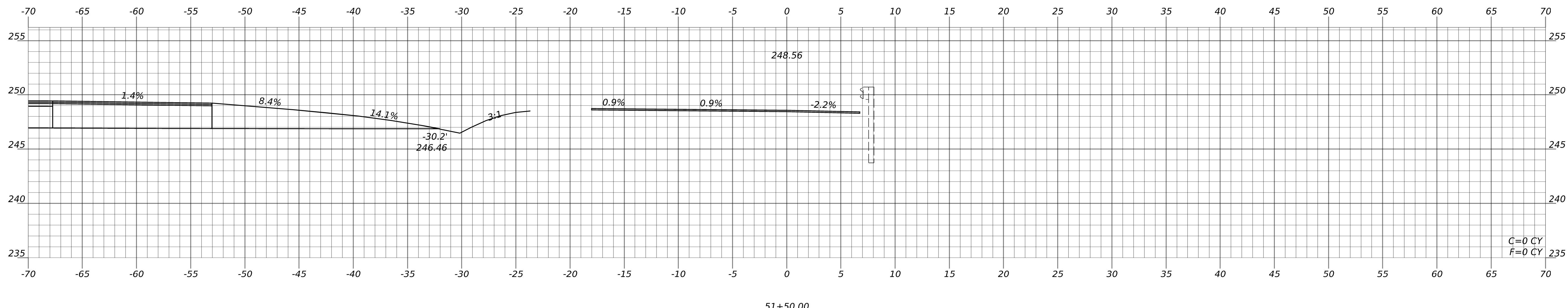
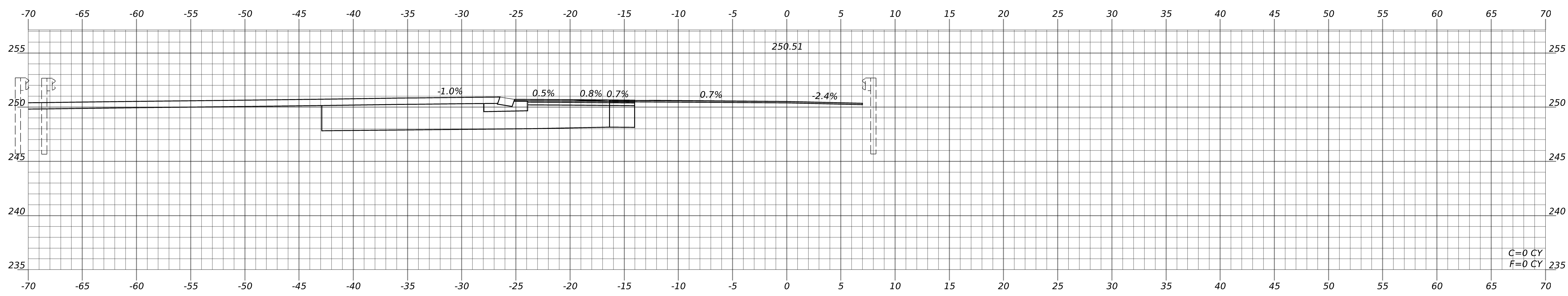
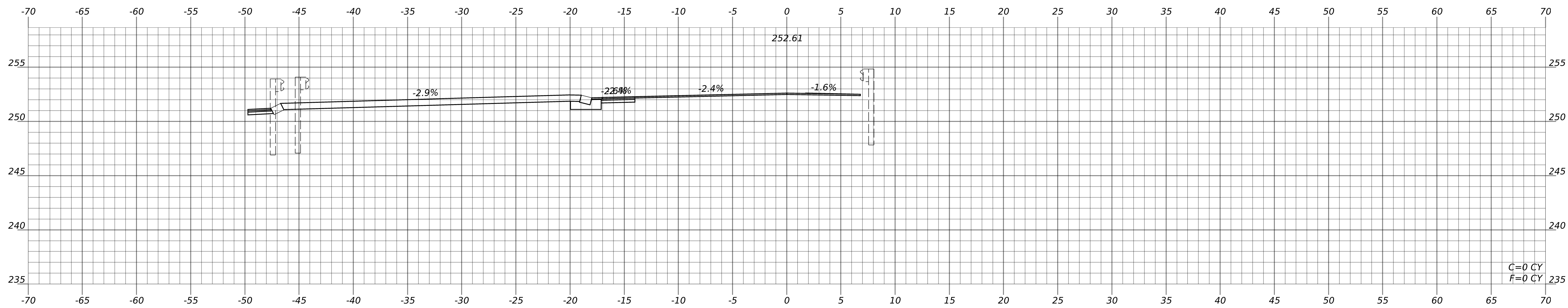

STATE OF MAINE DEPARTMENT OF TRANSPORTATION		WIN 027498.10 HIGHWAY PLANS
	SIGNATURE	P.E. NUMBER
DATE	BY	DATE
S. SMITH	S. LEONARDO	
DESIGN-REVIEWED	DESIGN-REVIEWED	DESIGN-REVIEWED
DESIGN-REVIEWED	DESIGN-REVIEWED	DESIGN-REVIEWED
REVISIONS 1	REVISIONS 2	REVISIONS 3
REVISIONS 4	REVISIONS 5	REVISIONS 6
FIELD CHANGES		
AUGUSTA EXIT 109 RAMP F RAMP A CROSS SECTIONS		
SHEET NUMBER		
11		
OF 17		

Username: mathieu.cutler Date: 4/28/2026

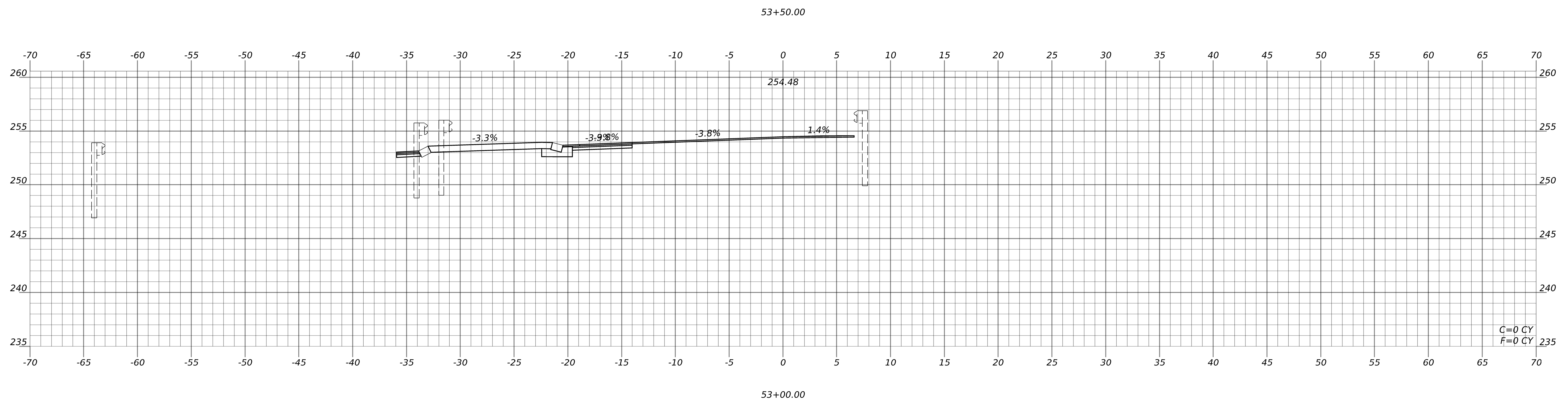
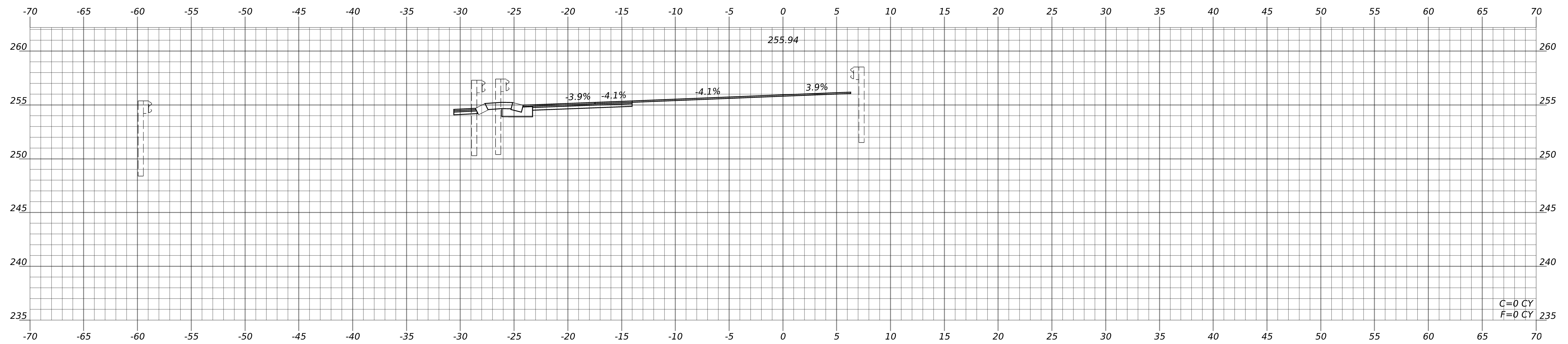

PROJ. MANAGER	BY	DATE	SIGNATURE
S. SMITH	S. SMITH		
S. LEONARDO	S. LEONARDO		
DESIGN-DETAILED			
CHECKED-REVIEWED			
DESIGN-DETAILED02			
DESIGN-DETAILED03			
REVISIONS 1			
REVISIONS 2			
REVISIONS 3			
REVISIONS 4			
FIELD CHANGES			

AUGUSTA
EXIT 109 RAMP F
RAMP A CROSS SECTIONS

Username: mathieu.cutler Date: 4/28/2026

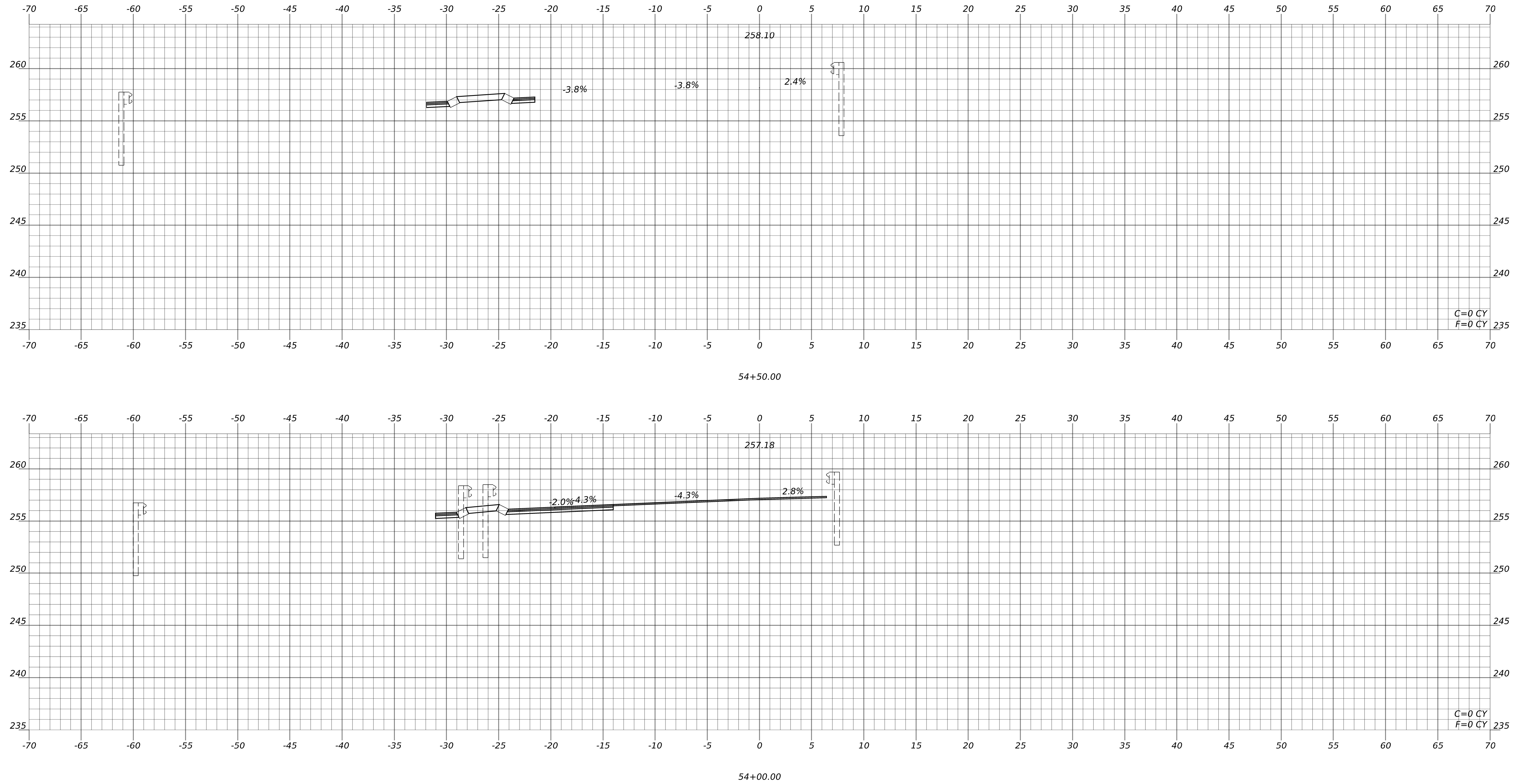

STATE OF MAINE
DEPARTMENT OF TRANSPORTATION

WIN
027498.10
HIGHWAY PLANS

SIGNATURE

P.E. NUMBER

DATE

BY

DATE

S. SMITH
S. LEONARDO

DESIGN-REVIEWED

CHECKED-REVIEWED

DESIGN-DETAILED02

DESIGN-DETAILED03

REVISIONS 1

REVISIONS 2

REVISIONS 3

REVISIONS 4

FIELD CHANGES

AUGUSTA
EXIT 109 RAMP F
RAMP A CROSS SECTIONS

SHEET NUMBER

13

OF 17

Username: mathieu.cutler Date: 4/28/2026

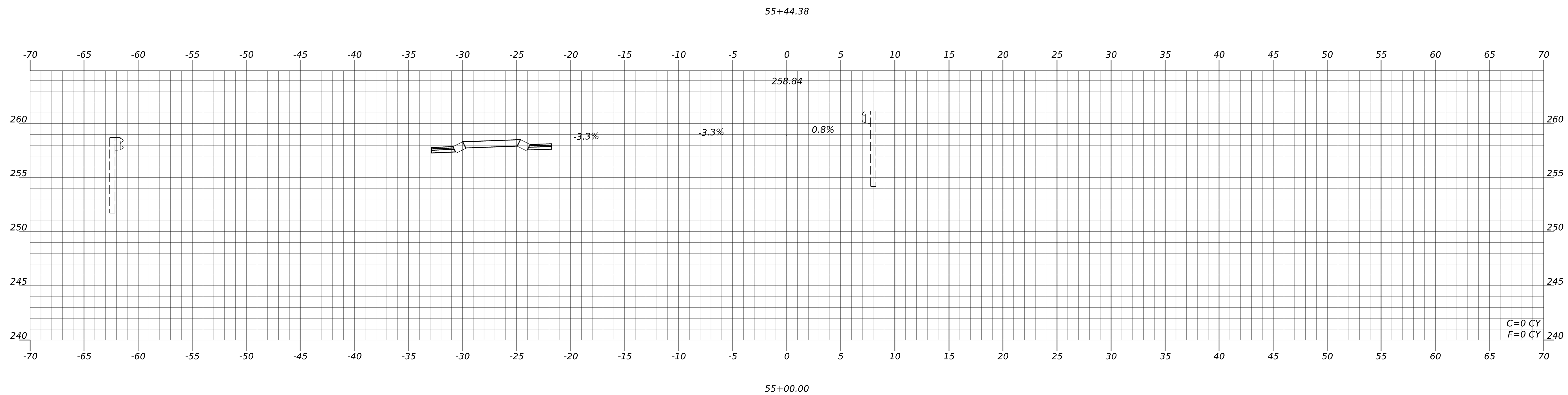
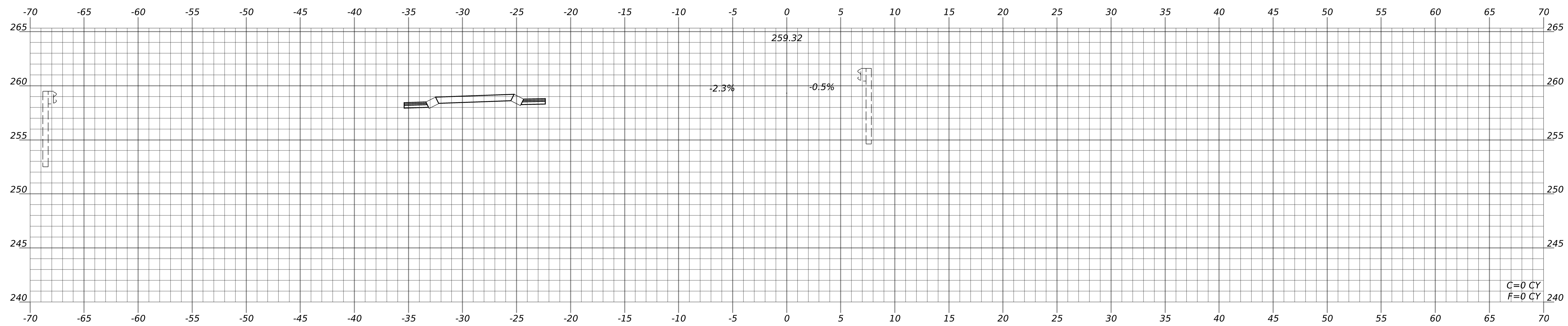

STATE OF MAINE
DEPARTMENT OF TRANSPORTATION

WIN
027498.10
HIGHWAY PLANS

SIGNATURE

DATE

BY

S. SMITH
S. LEONARDO

PROJ. MANAGER

DESIGN-REVIEWED

CHECKED-REVIEWED

DESIGN-REVIEWED

DESIGN-REVIEWED

REVISIONS 1

REVISIONS 2

REVISIONS 3

REVISIONS 4

FIELD CHANGES

P.E. NUMBER

DATE

AUGUSTA
EXIT 109 RAMP F

RAMP A CROSS SECTIONS

SHEET NUMBER

14

OF 17

Username: mathieu.cutler Date: 4/28/2026

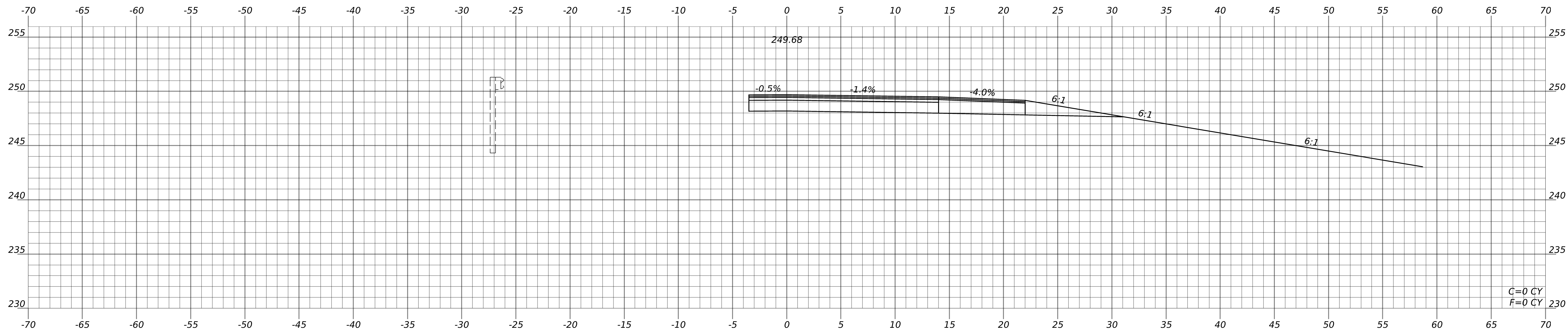

21+00.00

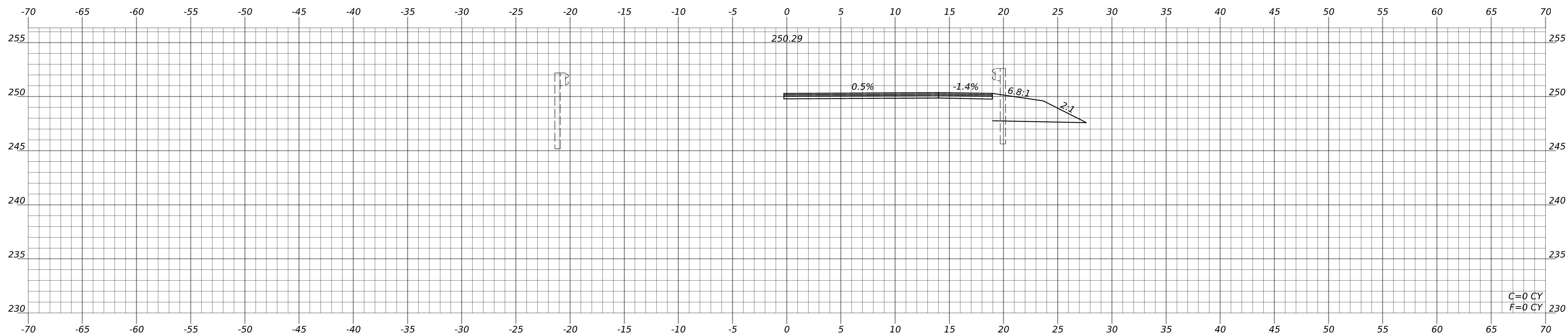

20+50.00

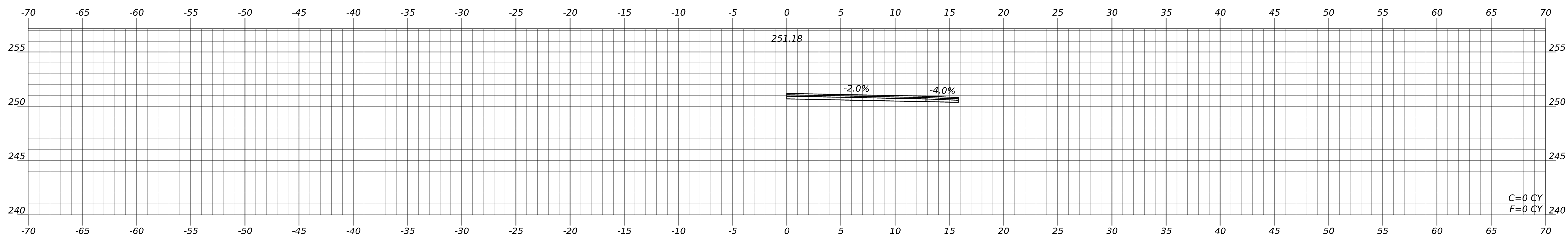

20+00.00

STATE OF MAINE DEPARTMENT OF TRANSPORTATION		WIN 027498.10 HIGHWAY PLANS
	SIGNATURE	P.E. NUMBER
		DATE
	S. SMITH	
	S. LEONARDO	
	DESIGN-REVIEWED	
	DESIGN-REVIEWED	
	DESIGN-REVIEWED	
	REVISIONS 1	
	REVISIONS 2	
	REVISIONS 3	
	REVISIONS 4	
	FIELD CHANGES	
AUGUSTA EXIT 109 RAMP F		
RAMP F CROSS SECTIONS		
SHEET NUMBER		
15		
OF 17		

Username: mathieu.cutler Date: 4/28/2026

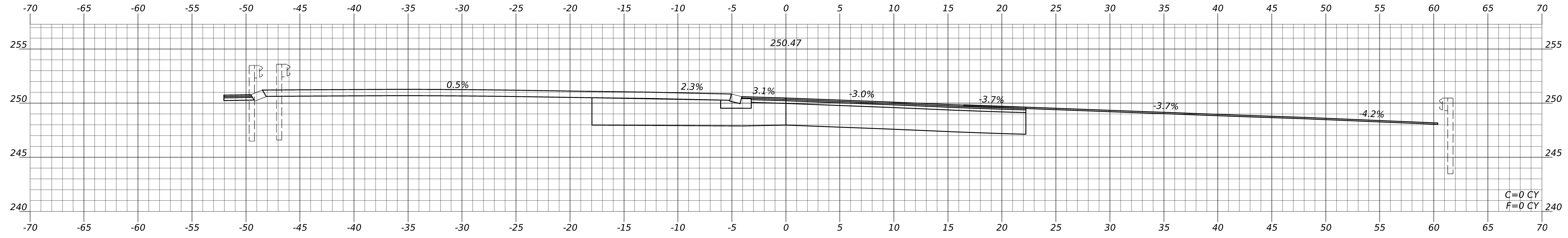

22+50.00

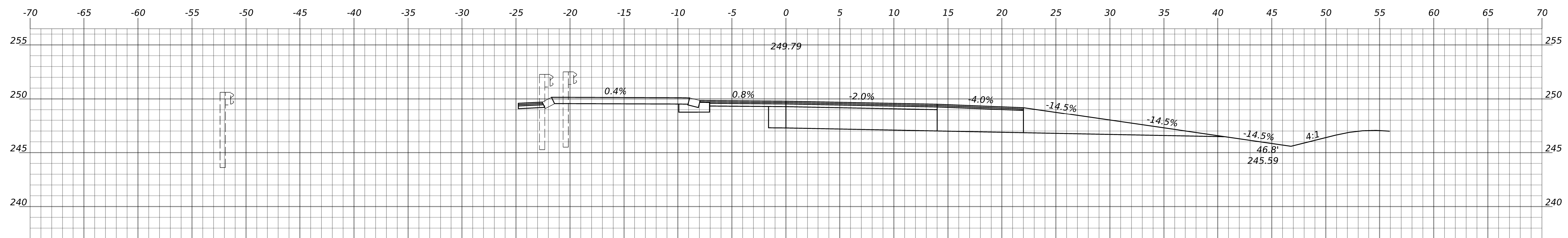

22+00.00

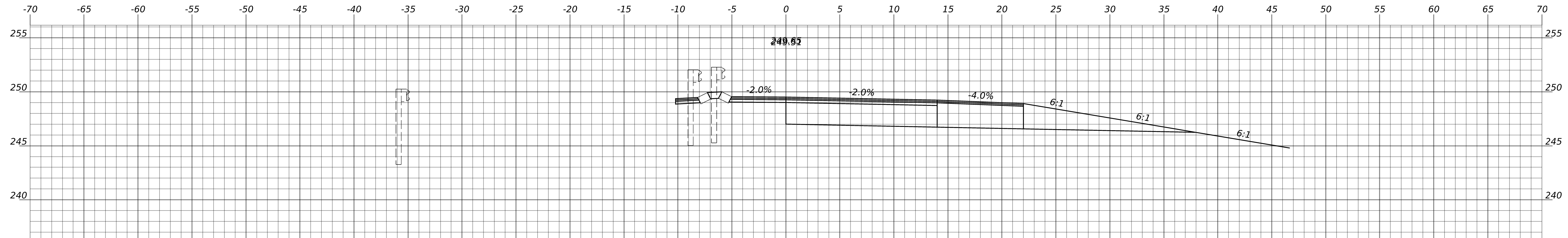

21+50.00

PROJ. MANAGER	BY	DATE	SIGNATURE	P.E. NUMBER	DATE
S. SMITH	S. SMITH				
S. LEONARDO	S. LEONARDO				
DESIGN-REVIEWED					
CHECKED-REVIEWED					
DESIGN-REVIEWED					
DESIGN-REVIEWED					
REVISIONS 1					
REVISIONS 2					
REVISIONS 3					
REVISIONS 4					
FIELD CHANGES					

**AUGUSTA
EXIT 109 RAMP F
RAMP F CROSS SECTIONS**

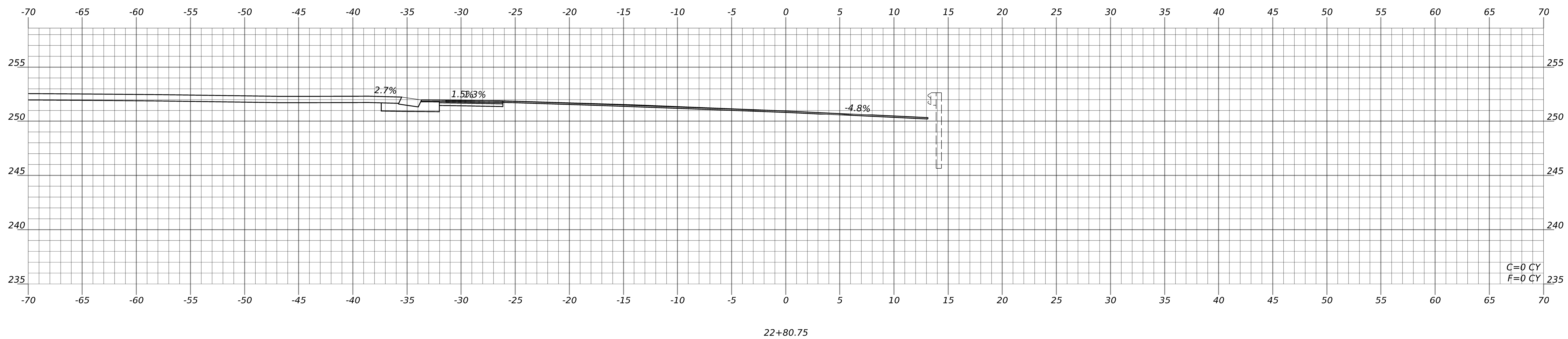

STATE OF MAINE
DEPARTMENT OF TRANSPORTATION

WIN 027498.10 HIGHWAY PLANS

SIGNATURE

DATE

BY

S. SMITH

S. LEONARDO

DESIGN-DETAILED

CHECKED-REVIEWED

DESIGN-DETAILED02

DESIGN-DETAILED03

REVISIONS 1

REVISIONS 2

REVISIONS 3

REVISIONS 4

FIELD CHANGES

DATE

P.E. NUMBER

DATE

DATE

DATE

DATE

DATE

DATE

DATE

DATE

DATE

**AUGUSTA
EXIT 109 RAMP F
RAMP F CROSS SECTIONS**

SHEET NUMBER

17

OF 17