

STATE OF MAINE
DEPARTMENT OF TRANSPORTATION

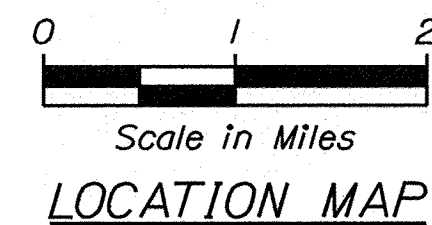

LIMERICK
YORK COUNTY
ROUTE II
STATE PROJECT NO. 27304.00
PROJECT LENGTH: 0.01 MILES

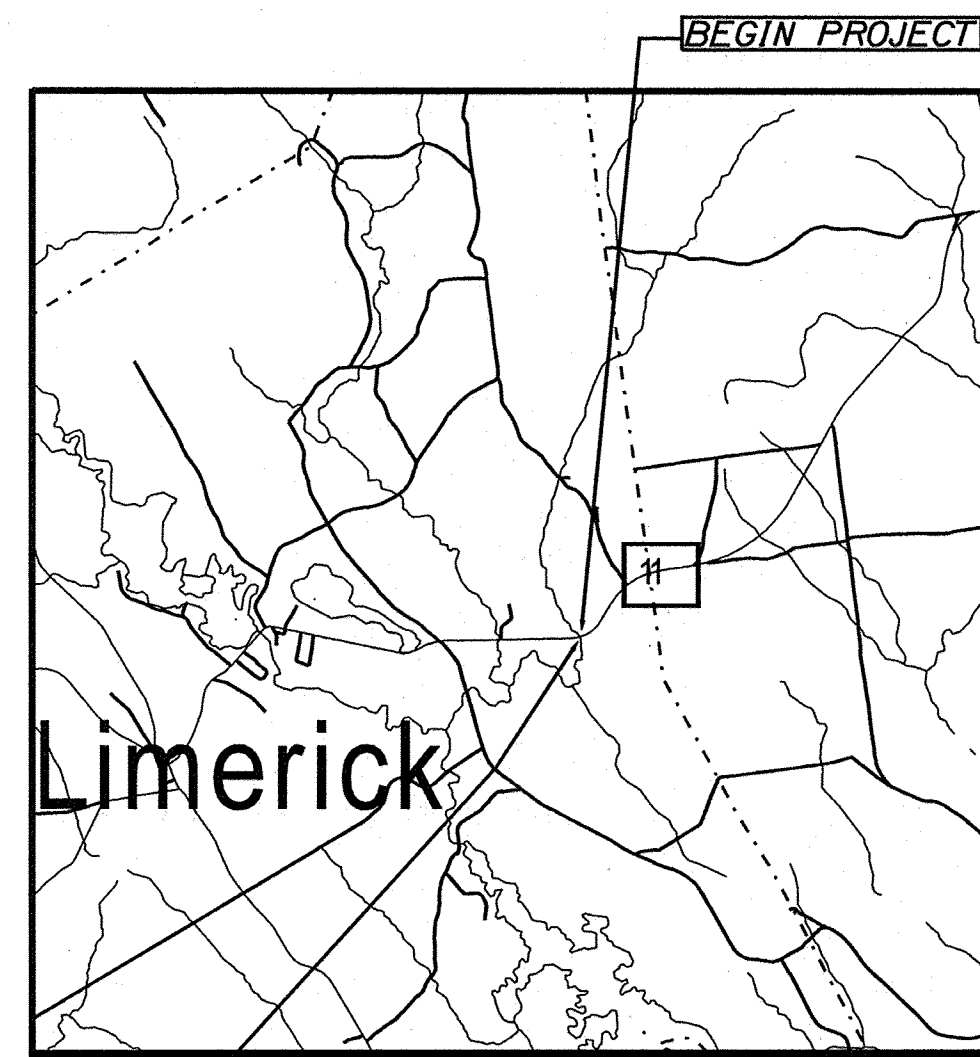
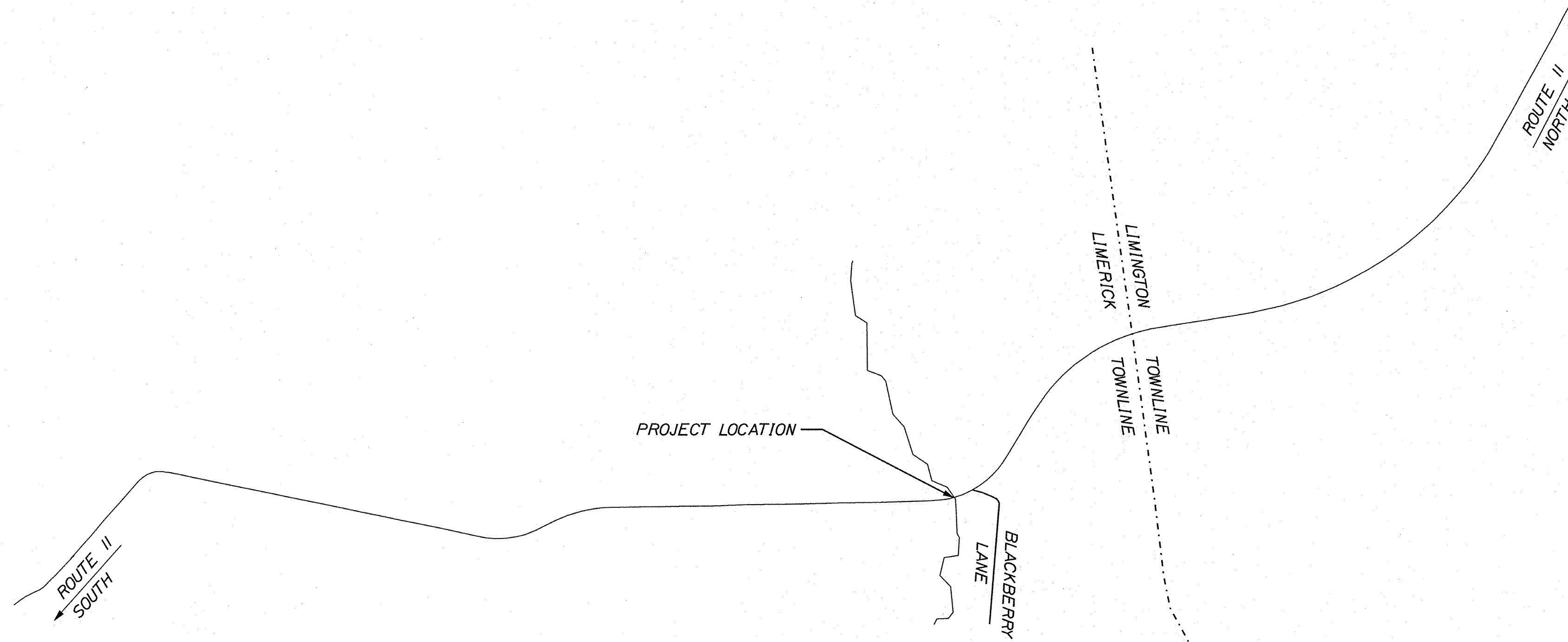

PROJECT LOCATION:	LARGE CULVERT (#46145) LOCATED 0.48 OF A MILE SOUTHWEST OF THE LIMINGTON TOWN LINE.
PROGRAM AREA:	MAINTENANCE PROGRAM
SCOPE OF WORK:	LARGE CULVERT

WIN 27304.00 STATE PROJECT NO. 27304.00

LIMERICK
ROUTE 11
TITLE SHEET

SHEET NUMBER
1
OF 1

PROGRAM	MAINTENANCE
PROJECT MANAGER	ROB BETZ
DESIGNER	
CONSULTANT	
PROJECT RESIDENT	
CONTRACTOR	
PROJECT COMPLETION DATE	

[Signature]
SIGNATURE
13222
P.E. NUMBER
5/14/2023
DATE

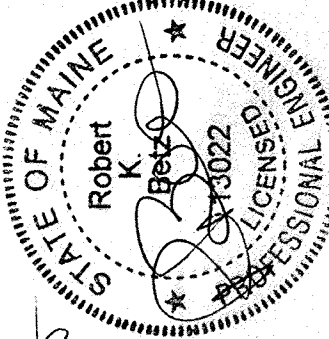

STATE OF MAINE
DEPARTMENT OF TRANSPORTATION
APPROVED
COMMISSIONER: *[Signature]*
CHIEF ENGINEER: *[Signature]*
DATE
5-4-23
5-4-2023

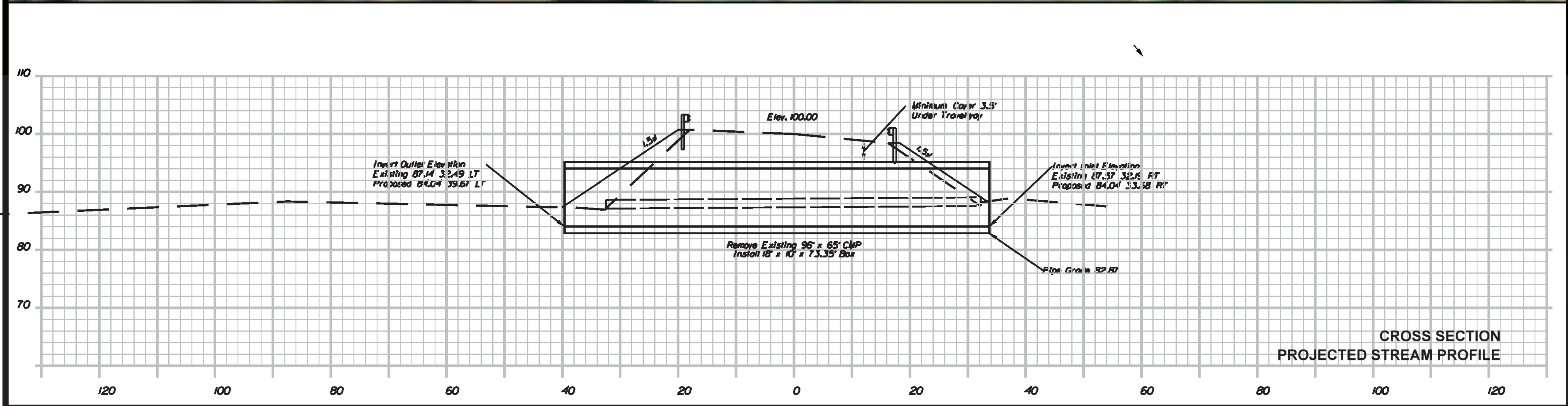
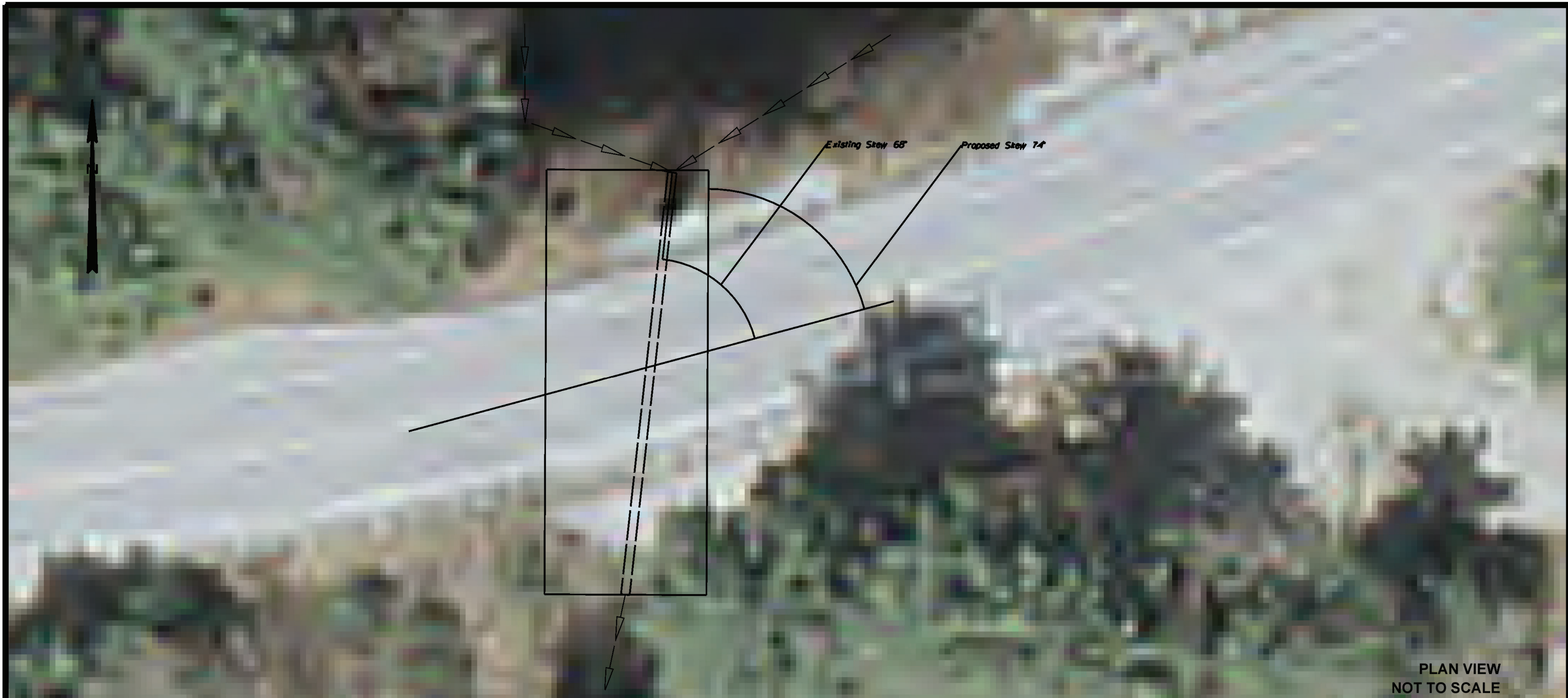

CONSTRUCTION PLANS

LC-46145

STATE OF MAINE
DEPARTMENT OF TRANSPORTATION

WIN 27304.00