

# STATE OF MAINE DEPARTMENT OF TRANSPORTATION



## WARREN KNOX COUNTY ROUTE 90 STATE PROJECT NO. 26396.00 CAMDEN ROAD BRIDGE BRIDGE # 6690 PROJECT LENGTH: 0.03 MILE

Description	Sheet No.
Title Sheet	1
General Notes, Typical Section and Quantities	2
Special Detail- Bridge Structure	3
Boring Location Plan & Interpretive Subsurface Profile	4
Boring Logs	5
Plan & Profile	6
Cross Sections	7-12
Right of Way Map	13

PLAN LEGEND	
Town, County, State	-----
Property Lines	-----
R/W Lines-Existing	-----
R/W Lines-Proposed	-----
Culvert-Existing	-----
Culvert Proposed	-----
Curbing Existing	-----
Curbing Proposed	-----
Type 1	-----
Type 3	-----
Type 5	-----
Outline of Bodies of Water	-----
Exposed Bedrock	-----
Buildings	-----
Trees	-----
Tree Line	-----
Clearing Limit Line	-----
Railroad	-----
Catch Basins	Existing <span style="display: inline-block; width: 10px; height: 10px; border: 1px solid black;"></span> Proposed <span style="display: inline-block; width: 10px; height: 10px; background-color: black;"></span>
Manholes	Existing <span style="display: inline-block; width: 10px; height: 10px; border: 1px solid black; border-radius: 50%;"></span> Proposed <span style="display: inline-block; width: 10px; height: 10px; background-color: black; border-radius: 50%;"></span>
Proposed Underdrain	----->
Proposed Ditch	----->
Existing Ditch	----->
Utility Poles	Existing <span style="display: inline-block; width: 10px; height: 10px; border: 1px solid black; border-radius: 50%;"></span> Proposed <span style="display: inline-block; width: 10px; height: 10px; background-color: black; border-radius: 50%;"></span>
Fire Hydrants	Existing <span style="display: inline-block; width: 10px; height: 10px; border: 1px solid black; border-radius: 50%;"></span> Proposed <span style="display: inline-block; width: 10px; height: 10px; background-color: black; border-radius: 50%;"></span>
Existing Water Line	-----
Existing San. Sewer	-----
Existing San. Sewer Manhole	-----
Guardrail-Existing	-----
Guardrail-Proposed	-----
Guardrail-Cable, Other	-----
Centerline-Existing	-----
Centerline-Proposed	-----
Travelway-Existing	-----
Travelway-Proposed	-----
Probe	P-#. #X
	#. # = Depth
	X = W (Weathered Rock)
	R (Refusal)
	NR (No Refusal)
Boring	HB-XXX-###
Pavement Core	PC-#
Test Pit	TP-XXX-###

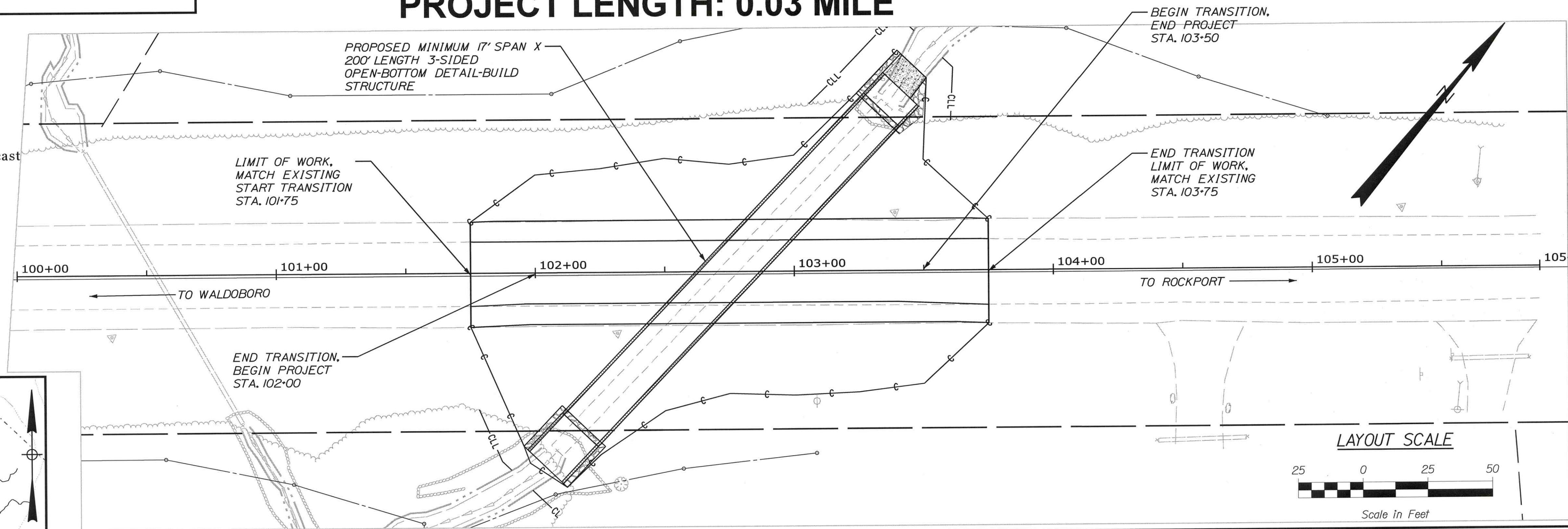

**Structural Concrete:**  
 Precast Concrete shall be Class P  
 Note: The maximum permeability for precast shall be 3000 coulombs  
 All other concrete shall be Class A unless otherwise noted  
 Design Stress:  $f'c = 4,000$  psi  
 All steel hardware shall be galvanized per ASTM A153

**Reinforcing Steel:**  
 Shall meet ASTM A 615/A 615M, Grade 60  
 Design Stress =  $f_y = 60,000$  psi  
 ASTM F3125, Grade A325

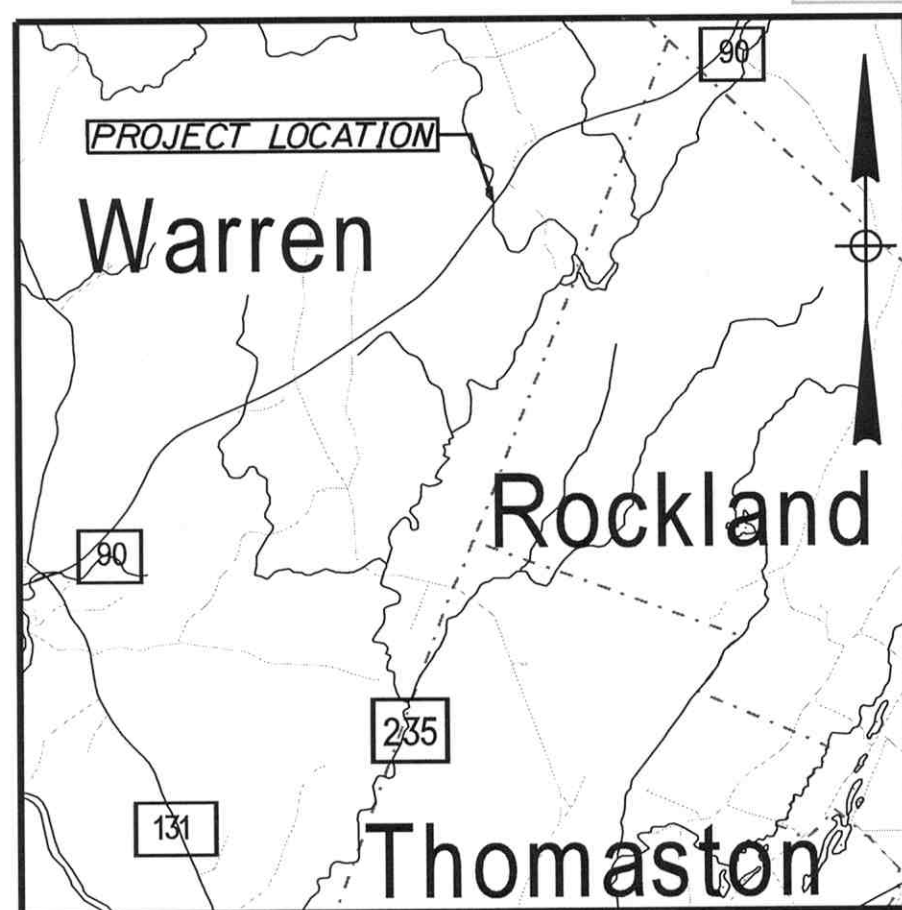

TRAFFIC DATA	
Current (2024) AADT	6510
Future (2044) AADT	7160
DHV - % of AADT	12%
Design Hour Volume	828
% Heavy Trucks (AADT)	10%
% Heavy Trucks (DHV)	7%
Directional Distribution (DHV)	57%
18 kip Equivalent P 2.0	369
18 kip Equivalent P 2.5	351
Design Speed (mph)	55 MPH
Functional Class	Minor Arterial
Corridor Priority	2

<b>PROJECT LOCATION:</b>	LOCATED APPROXIMATELY 1.19 MILES NORTH OF BILLINGS ROAD
<b>PROGRAM AREA:</b>	HIGHWAY PROGRAM
<b>SCOPE OF WORK:</b>	LARGE CULVERT REPLACEMENT

STATE OF MAINE DEPARTMENT OF TRANSPORTATION

APPROVED

COMMISSIONER: *[Signature]* DATE: 1-18-24

CHIEF ENGINEER: *[Signature]* DATE: 1-16-2024

STATE OF MAINE  
 SHANE C. KELLY  
 No. 15681  
 PROFESSIONAL ENGINEER

SIGNATURE: *[Signature]*  
 P.E. NUMBER: 15681  
 DATE: 01/12/2024

PROJECT INFORMATION

HIGHWAY PROGRAM: DOUG COOMBS  
 PROJECT MANAGER: SHANE KELLY  
 DESIGNER: SHANE KELLY  
 CONSULTANT:  
 PROJECT RESIDENT CONTRACTOR:  
 PROJECT COMPLETION DATE:

WIN 26396.00

26396.00

WARREN ROUTE 90

TITLE SHEET

SHEET NUMBER

1

OF 13

Date: 1/12/2024  
 Username: skelly  
 Division: HIGHWAY  
 Filename: ...MSTA\SHEETS\001\_Title.dgn

**GENERAL NOTES**

1. PAVEMENT THICKNESSES SHOWN ON THE TYPICAL SECTIONS ARE INTENDED TO BE NOMINAL
2. CLEARING LIMITS SHALL BE 10 FEET BEYOND AND PARALLEL TO THE CONSTRUCTION SLOPE LINES OR AS SHOWN ON THE PLANS UNLESS OTHERWISE AUTHORIZED BY THE RESIDENT.
3. ALL CLEARING SHALL BE CONSIDERED INCIDENTAL TO THE CONTRACT AND NO SEPARATE PAYMENT WILL BE MADE. THE ACTUAL LINES FOR CLEARING SHALL BE ESTABLISHED IN THE FIELD BY THE CONTRACTOR AS INDICATED ON THE PLANS AND APPROVED BY THE RESIDENT.
4. GRUBBING IN FILL AREAS HAS BEEN SHOWN ON THE CROSS SECTIONS AND THE QUANTITIES NOTED. THESE LIMITS ARE APPROXIMATE AND HAVE BEEN USED FOR ESTIMATING PURPOSES ONLY. ACTUAL GRUBBING LIMITS MAY VARY BASED ON FIELD CONDITIONS AS DIRECTED BY THE RESIDENT.
5. ALL WASTE MATERIAL NOT USED ON THE PROJECT SHALL BE DISPOSED OFF THE PROJECT IN ACCEPTABLE WASTE AREAS REVIEWED BY THE RESIDENT. GRADING, SEEDING AND MULCHING OF WASTE AREAS SHALL BE CONSIDERED INCIDENTAL.
6. REQUIRED DITCH PROTECTION SHOWN ON THE PLANS OR IN THE CONSTRUCTION NOTES IS FOR ESTIMATING PURPOSES ONLY. THE ACTUAL TYPE AND LOCATION OF DITCH PROTECTION MAY BE ALTERED BY THE RESIDENT.
7. GRANULAR BORROW USED TO BACKFILL MUCK EXCAVATION OR IN LOW WET AREAS TO 1 FOOT ABOVE WATER LEVEL OR OLD GROUND SHALL MEET REQUIREMENTS FOR GRANULAR BORROW MATERIAL FOR UNDERWATER BACKFILL AS SPECIFIED IN STANDARD SPECIFICATION 703.19.
8. EXISTING INSLOPES IN PROPOSED FILL AREAS SHALL BE BENCHED BY EXCAVATING STEPS OF SUFFICIENT WIDTH TO PERMIT PLACING AND COMPACTING THE FILL MATERIAL ALONG WITH THE MATERIAL REMOVED.
9. WHEN SUPER ELEVATION EXCEEDS THE SLOPE OF THE LOW SIDE SHOULDER, THE LOW SIDE SHOULDER WILL HAVE SAME SLOPE AS THE TRAVELWAY.
10. CROSS SLOPES FOR NORMAL AND SUPERELEVATED SECTIONS WILL BE STRAIGHT UNLESS OTHERWISE DIRECTED BY THE DEPARTMENT.
11. THE ALGEBRAIC DIFFERENCE BETWEEN TRAVELWAY AND SHOULDER CROSS SLOPE SHALL NOT EXCEED 8 PERCENT.
12. NO EXISTING DRAINAGE SHALL BE ABANDONED, REMOVED OR PLUGGED WITHOUT PRIOR APPROVAL OF THE RESIDENT.
13. INLETS AND OUTLETS OF ALL CULVERTS SHALL BE RIPRAPPED UNLESS OTHERWISE NOTED ON THE PLANS OR DIRECTED BY THE RESIDENT.
14. LOAM HAS BEEN ESTIMATED FOR DISTURBED LAWN AREAS. ACTUAL PLACEMENT OF THE LOAM SHALL BE AS NOTED ON THE PLANS OR DESIGNATED BY THE RESIDENT.
15. UNLESS OTHERWISE NOTED SEEDING METHOD NO. 1 SHALL BE UTILIZED ON ALL LAWNS AND DEVELOPED AREAS; SEEDING METHOD NO. 2 SHALL BE UTILIZED ON ALL OTHER AREAS.
16. LOAM SHALL BE PLACED TO A NOMINAL DEPTH OF 4 INCHES IN LAWN AREAS AND 2 INCHES IN ALL OTHER AREAS UNLESS OTHERWISE NOTED OR DIRECTED.
17. ANY DAMAGE TO THE SLOPES CAUSED BY THE CONTRACTOR'S EQUIPMENT, PERSONNEL, OR OPERATION SHALL BE REPAIRED TO THE SATISFACTION OF THE RESIDENT. ALL WORK, EQUIPMENT, AND MATERIALS REQUIRED TO MAKE REPAIRS SHALL BE AT THE CONTRACTOR'S EXPENSE.
18. THE PROJECT GEOTECHNICAL REPORT TITLED "GEOTECHNICAL DESIGN REPORT FOR THE CONSTRUCTION OF CAMDEN ROAD BRIDGE", SOILS REPORT 2024-03, JANUARY 5, 2024 CAN BE ACCESSED AT THE MAINE DOT WEBSITE [HTTP://WWW.MAINE.GOV/MDOT/CONTRACTORS/](http://www.maine.gov/mdot/contractors/).
19. GEOTECHNICAL INFORMATION FURNISHED OR REFERRED TO IN THE BID DOCUMENTS IS FOR THE USE OF THE BIDDERS. NO ASSURANCE IS GIVEN THAT THE INFORMATION OR INTERPRETATIONS WILL BE REPRESENTATIVE OF THE ACTUAL SUBSURFACE CONDITIONS THROUGHOUT THE CONSTRUCTION SITE. MAINE DOT WILL NOT BE RESPONSIBLE FOR ANY INTERPRETATIONS OR CONCLUSION DRAWN FROM THE GEOTECHNICAL INFORMATION. THE BORING LOGS PROVIDED IN THE BID DOCUMENTS (IF ANY) PRESENT FACTUAL AND INTERPRETIVE SUBSURFACE INFORMATION COLLECTED AT DISCRETE LOCATIONS. DATA PROVIDED MAY NOT BE REPRESENTATIVE OF THE SUBSURFACE CONDITIONS BETWEEN BORING LOCATIONS.
20. AREAS ON THE PROJECT REQUIRING FILL WILL COME FROM SUITABLE SITES SUCH AS EXCAVATION, DITCH AND INSLOPE OR EQUIPMENT RENTAL AREAS.
21. NO SEPARATE PAYMENT FOR SUPERINTENDENT OR FOREMAN WILL BE MADE FOR THE SUPERVISION OF EQUIPMENT AND LAYOUT OF WORK BEING PAID FOR UNDER THE EQUIPMENT RENTAL ITEMS.
22. FINAL STRIPING FOR THE PROJECT SHALL BE DONE BY THE CONTRACTOR PER THE STRIPING LAYOUT IN THE CONTRACT DOCUMENTS OR AS PROVIDED BY THE DEPARTMENT. PAYMENT SHALL BE MADE UNDER APPROPRIATE CONTRACT ITEMS.

ESTIMATED QUANTITIES			
ITEM NO.	DESCRIPTION	QUANTITY	UNIT
203.20	COMMON EXCAVATION	875	CY
203.25	GRANULAR BORROW	305	CY
203.33	SPECIAL FILL	220	CY
206.061	STRUCTURAL EARTH EXCAVATION- DRAINAGE & MINOR STRUCTURES BELOW GRADE	10	CY
304.10	AGGREGATE SUBBASE COURSE- GRAVEL	750	CY
403.2081	HOT MIX ASPHALT 12.5 MM HMA SURFACE (POLYMER-MODIFIED)	100	TONS
403.213	HOT MIX ASPHALT 12.5 MM HMA BASE BITUMINIOUS TACK	160	TONS
409.15	COAT	45	GAL
508.13	SHEET WATERPROOFING MEMBRANE (385SY)	1	LS
511.07	COFFERDAM: UPSTREAM	1	LS
511.07	COFFERDAM: DOWNSTREAM	1	LS
531.51	BRIDGE STRUCTURE- DETAIL BUILD	1	LS
610.08	PLAIN RIPRAP	40	CY
610.210	STREAM CHANNEL ROCK	125	CY
610.212	STREAMBED ROCK FEATURES	10	CY
613.319	EROSION CONTROL BLANKET	50	SY
615.07	LOAM	100	CY
618.14	SEEDING METHOD NUMBER 2	15	UN
619.12	MULCH	15	UN
619.14	EROSION CONTROL MIX	10	CY
620.58	EROSION CONTROL GEOTEXTILE	50	SY
627.733	4" WHITE OR YELLOW PAINTED PAVEMENT MARKING LINE	600	LF
629.05	HAND LABOR, STRAIGHT TIME	10	HR
631.12	ALL PURPOSE EXCAVATOR (INCLUDING OPERATOR)	10	HR
631.172	LARGE TRUCK (INCLUDING OPERATOR)	10	HR
639.19	FIELD OFFICE TYPE B	1	EA
643.72	TEMPORARY TRAFFIC SIGNAL	1	LS
652.312	BARRICADE TYPE III	4	EA
652.33	DRUM	50	EA
652.34	CONE	100	EA
652.35	CONSTRUCTION SIGN	500	SF
652.36	MAINTENANCE OF TRAFFIC CONTROL DEVICES	150	CD
652.38	FLAGGER	100	HR
652.41	PORTABLE CHANGEABLE MESSAGE SIGN	2	EA
652.61	STAGED CONSTRUCTION AND TRAFFIC CONTROL	1	LS
656.75	TEMPORARY SOIL EROSION AND WATER POLLUTION CONTROL	1	LS
659.10	MOBILIZATION	1	LS

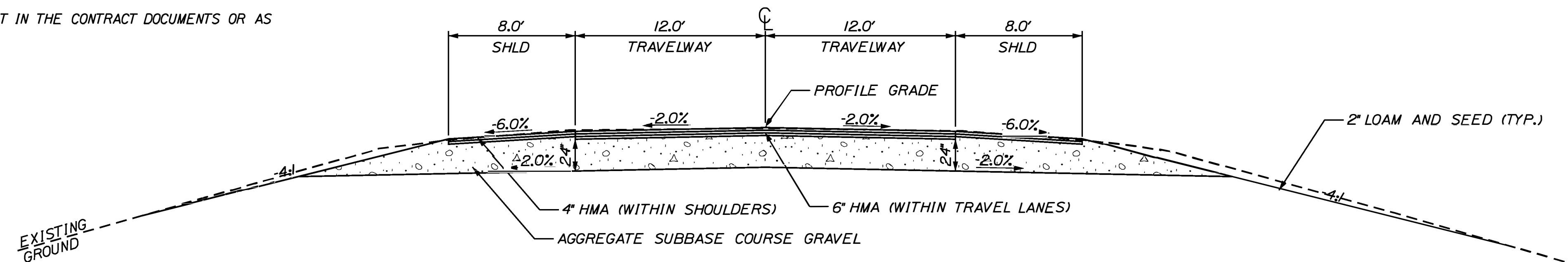

**TYPICAL FULL CONSTRUCTION SECTION**  
STATION 102+00 TO STA. 103+50

STATE OF MAINE		DEPARTMENT OF TRANSPORTATION		26396.00		WIN		26396.00		HIGHWAY PLANS	
WARREN ROUTE 90		GENERAL NOTES, TYPICAL SECTION AND ESTIMATE QUANTITIES		DATE 01/03/24		SIGNATURE		P.E. NUMBER		DATE	
SHEET NUMBER		2		BY S. KELLY		D. COOMBS		PROJ. MANAGER		FIELD CHANGES	
OF 13											

Filename: ... \002\_GeneralNote & Typical Sections.dwg Division: HIGHWAY  
 Username: skelly  
 Date: 1/4/2024



Date: 1/19/2024

Username: Cody A. Russell

Division: GEOTECH

Filename: ... \GEOTECH\STA\002\_BLP&IS\1.dgn

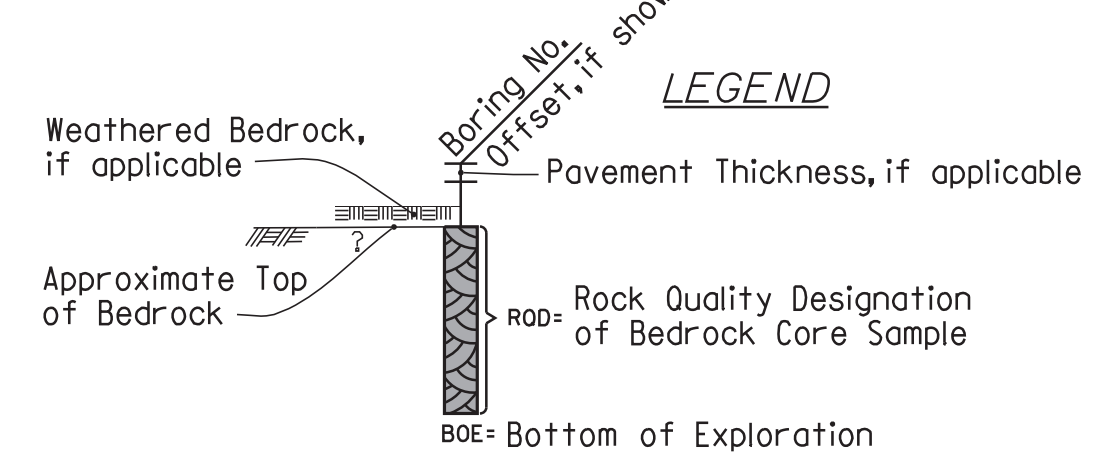
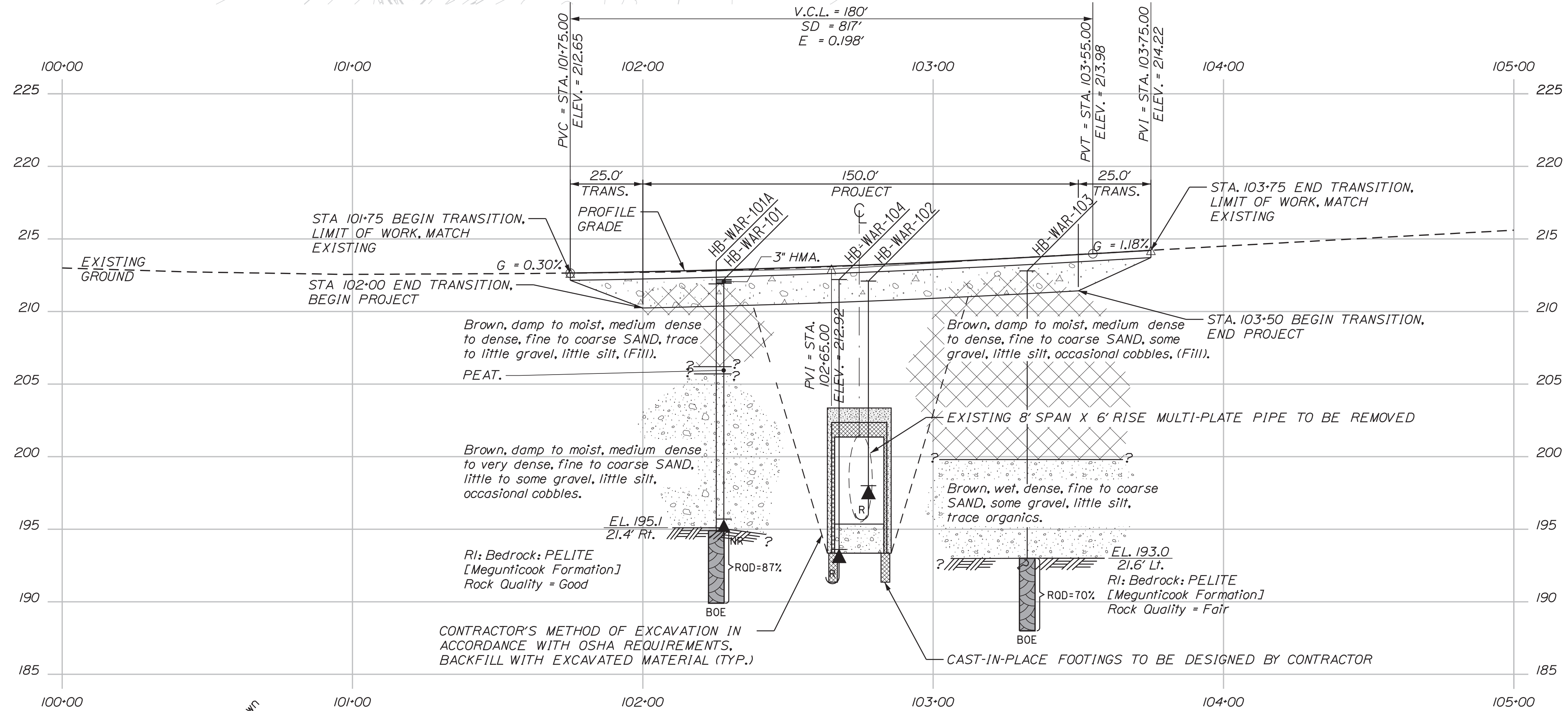
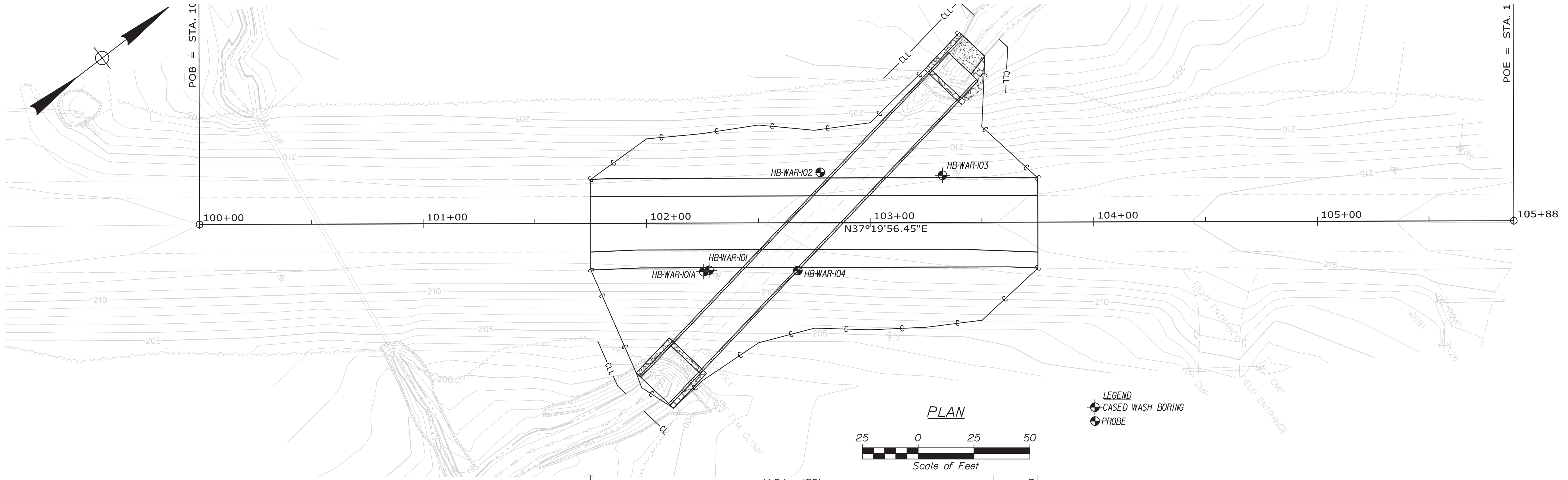

Note: This generalized interpretive soil profile is intended to convey trends in subsurface conditions. The boundaries between strata are approximate and idealized, and have been developed by interpretations of widely spaced explorations and samples. Actual soil and bedrock transitions may vary and are probably more erratic. For more specific information refer to the exploration logs.

STATE OF MAINE  
DEPARTMENT OF TRANSPORTATION  
2639600  
WIN  
26396.00  
HIGHWAY PLANS

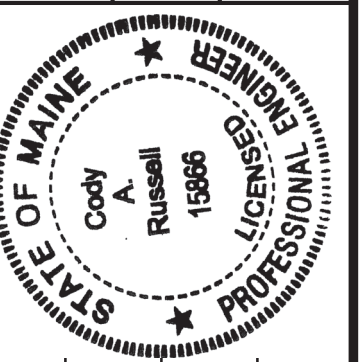

Cody A. Russell  
SIGNATURE  
15866  
P.E. NUMBER  
1/19/2024  
DATE

PROJ. MANAGER	DATE	BY
DESIGN DETAILED		
CHECKED/REVIEWED	JAN 2024	T. WHITE
DESIGNS DET AILED 03		C. RUSSELL
DESIGNS DET AILED 03		
REVISIONS 1		
REVISIONS 2		
REVISIONS 3		
REVISIONS 4		
FIELD CHANGES		

WARREN  
ROUTE 90  
BORING LOCATION PLAN &  
INTERPRETIVE SUBSURFACE PROFILE

SHEET NUMBER

4

OF 13



Date: 1/3/2024

Username: skelly

Division: HIGHWAY

Filename: ... \SHEETS\004\_Planandprofile.dgn

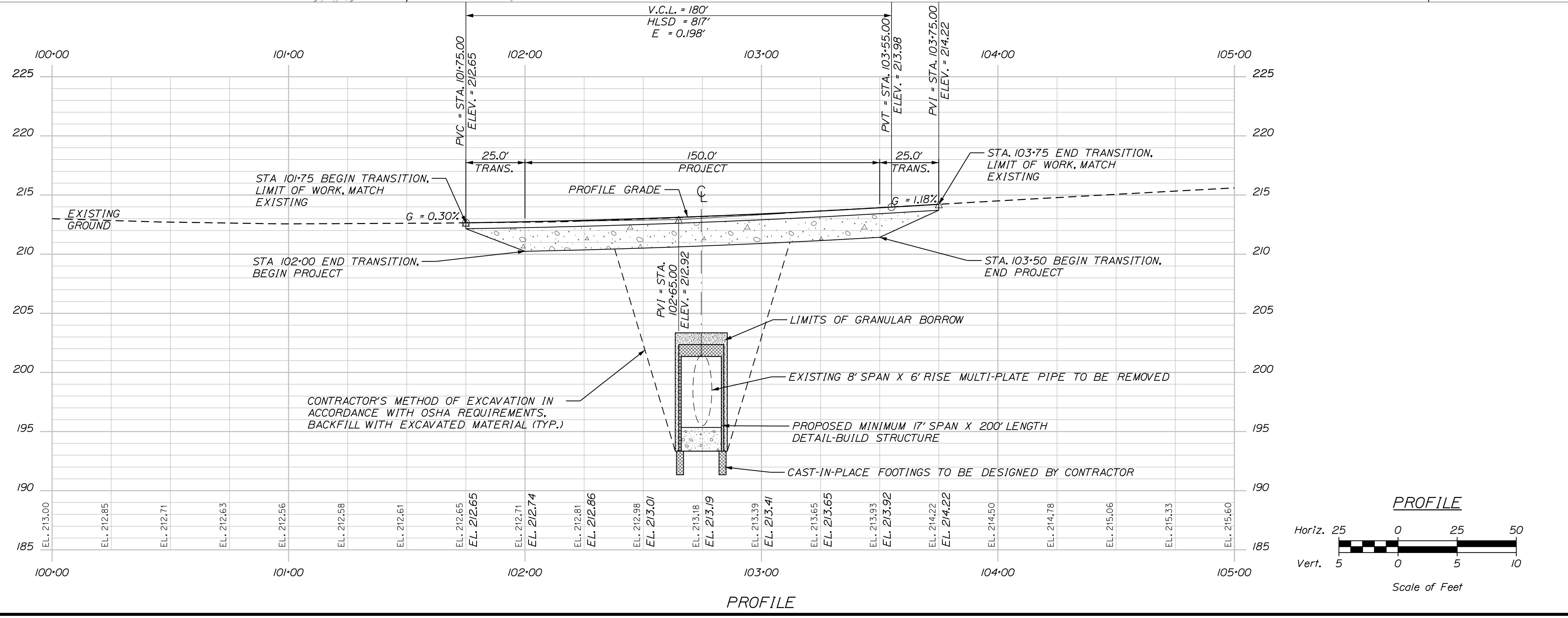
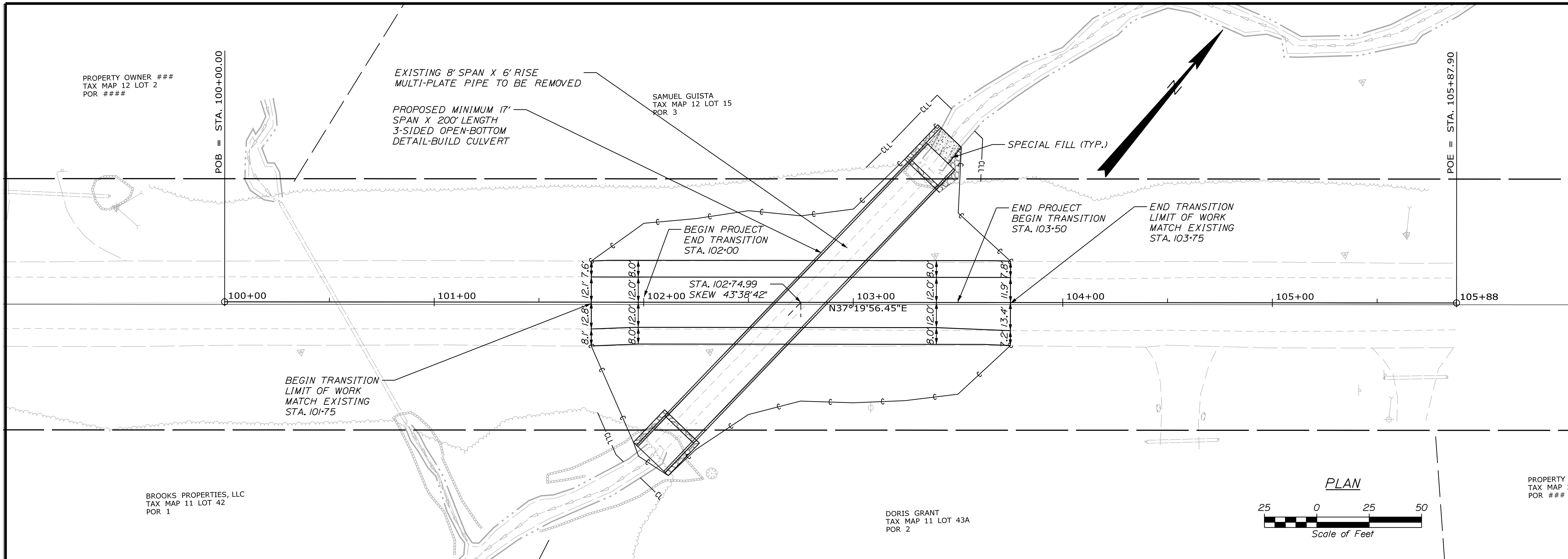

STATE OF MAINE		DEPARTMENT OF TRANSPORTATION	
		26396.00	
		WIN 26396.00	
		HIGHWAY PLANS	
PROJ. MANAGER	DATE	SIGNATURE	DATE
D. COOMBS	01/03/24		
CHECKED-REVIEWED		P.E. NUMBER	
DESIGN-REVIEWED			
DESIGNS DET AILED			
DESIGNS DET AILED			
REVISIONS 1			
REVISIONS 2			
REVISIONS 3			
REVISIONS 4			
FIELD CHANGES			
WARREN ROUTE 90		PLAN & PROFILE	
SHEET NUMBER		6	
		OF 13	

Date: 1/3/2024

Username: skelly

Division: HIGHWAY

Filename: ... \HIGHWAY\MSTA\SHEETS\XSECT.dgn

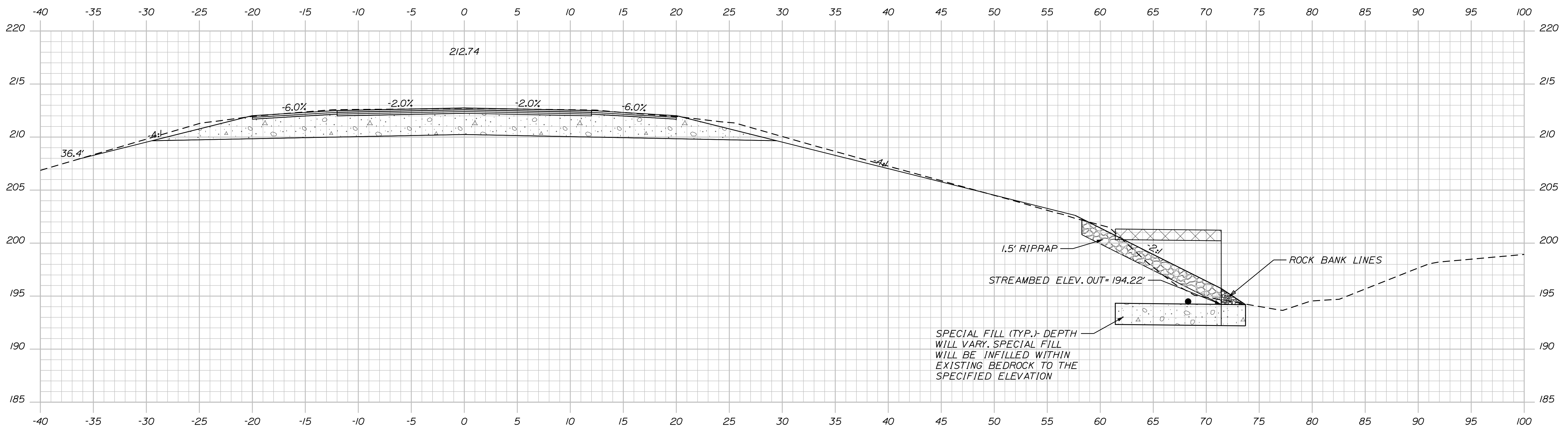

102+00.00 (END TRANSITION, BEGIN PROJECT, OUTLET LOCATION)

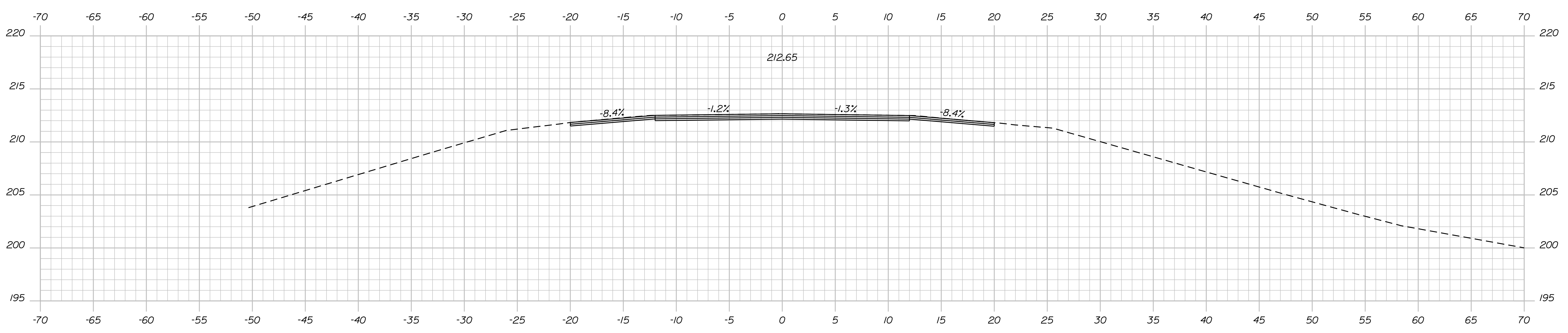

101+75.00 (BEGIN TRANSITION, LIMITS OF WORK, MATCH EXISTING)

STATE OF MAINE  
DEPARTMENT OF TRANSPORTATION

26396.00

WIN  
26396.00

HIGHWAY PLANS

SIGNATURE

P.E. NUMBER

DATE

PROJ. MANAGER	DATE
D. COOMBS	01/03/24
CHECKED-REVIEWED	
DESIGN DETAILED	
DESIGN DETAILED	
REVISIONS 1	
REVISIONS 2	
REVISIONS 3	
REVISIONS 4	
FIELD CHANGES	

WARREN  
ROUTE 90

CROSS SECTIONS

SHEET NUMBER

7

OF 13

Date: 1/3/2024

Username: skelly

Division: HIGHWAY

Filename: ... \HIGHWAY\MSTA\SHEETS\XSECT.dgn

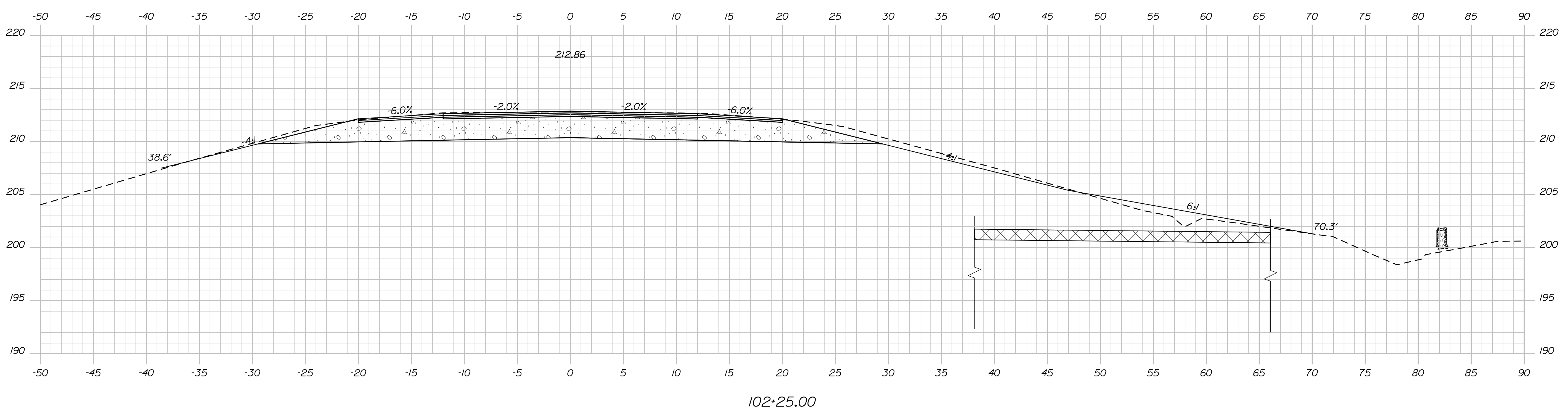
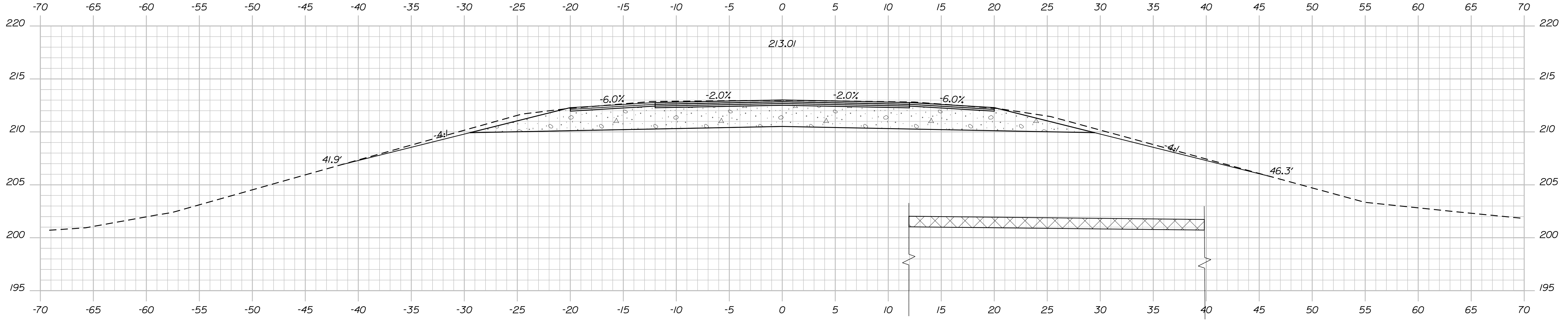

STATE OF MAINE  
DEPARTMENT OF TRANSPORTATION  
26396.00  
WIN  
26396.00  
HIGHWAY PLANS

SIGNATURE  
P.E. NUMBER  
DATE

PROJ. MANAGER	DATE
D. COOMBS	01/03/24
CHECKED-REVIEWED	
DESIGNED-Detailed	
DESIGNED-Detailed	
REVISIONS 1	
REVISIONS 2	
REVISIONS 3	
REVISIONS 4	
FIELD CHANGES	

WARREN  
ROUTE 90  
CROSS SECTIONS

SHEET NUMBER  
8  
OF 13

Date: 1/3/2024

Username: skelly

Division: HIGHWAY

Filename: ... \HIGHWAY\MSTA\SHEETS\XSECT.dgn

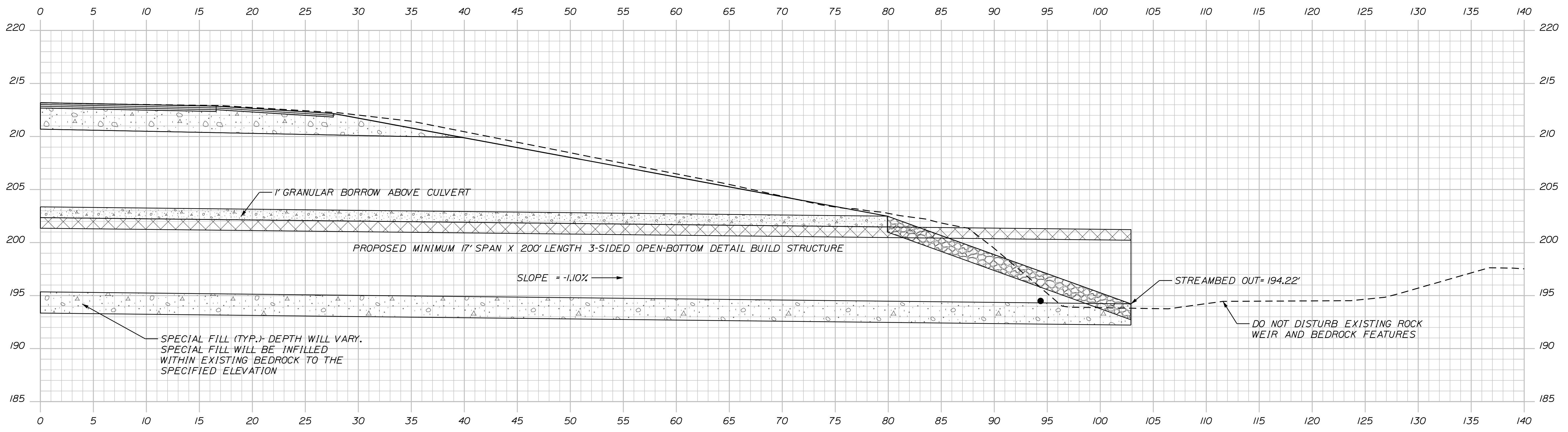

102+74.55 (SKEW 43°38'42")

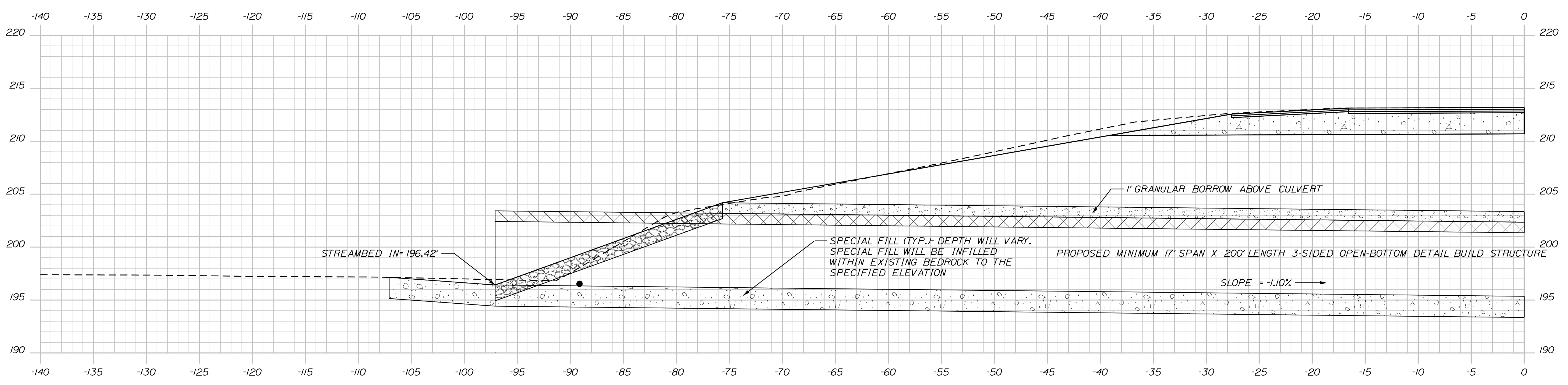

102+74.55 (SKEW 43°38'42")

STATE OF MAINE  
DEPARTMENT OF TRANSPORTATION  
26396.00  
WIN  
26396.00  
HIGHWAY PLANS

DATE: 01/03/24  
BY: S. KELLY  
D. COOMBS  
PROJ. MANAGER  
DESIGN-DETAILED  
CHECKED-REVIEWED  
DESIGN-DETAILED  
DESIGN-DETAILED  
REVISIONS 1  
REVISIONS 2  
REVISIONS 3  
REVISIONS 4  
FIELD CHANGES

SIGNATURE  
P.E. NUMBER  
DATE

WARREN  
ROUTE 90  
CROSS SECTIONS

SHEET NUMBER  
9  
OF 13

Date: 1/3/2024

Username: skelly

Division: HIGHWAY

Filename: ... \HIGHWAY\MSTA\SHEETS\XSECT.dgn

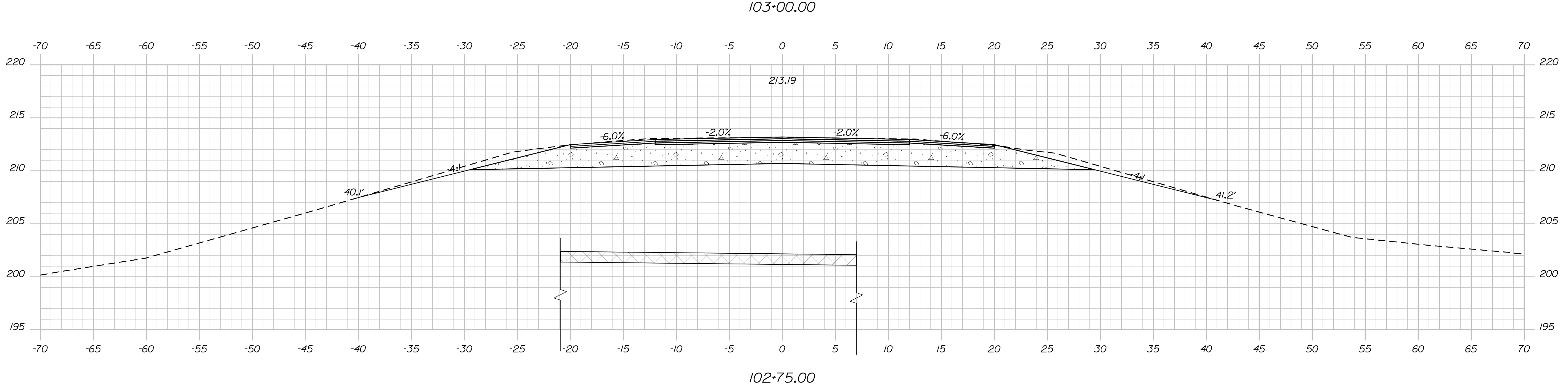
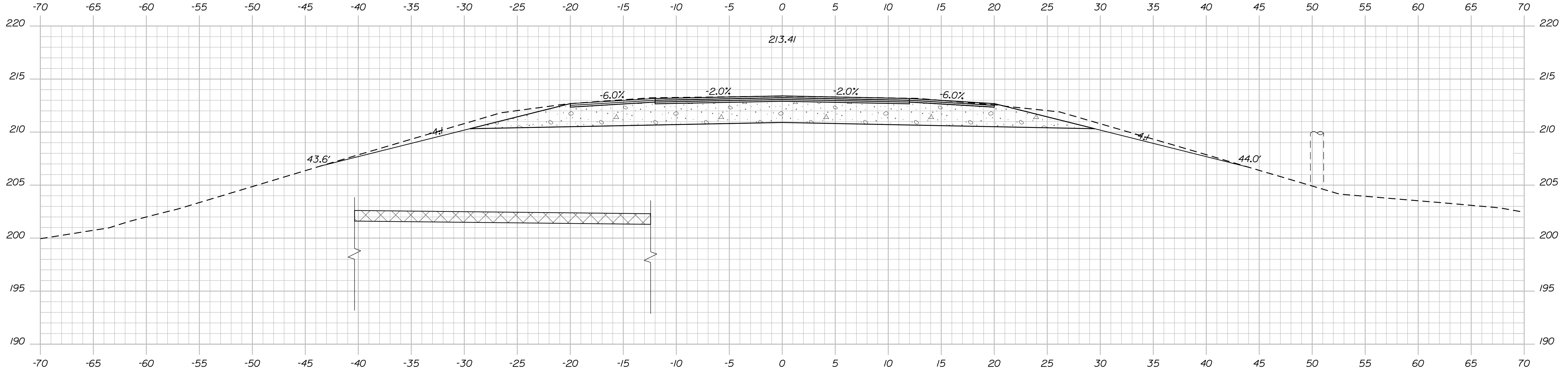

STATE OF MAINE  
DEPARTMENT OF TRANSPORTATION  
26396.00  
WIN  
26396.00  
HIGHWAY PLANS

SIGNATURE  
P.E. NUMBER  
DATE

PROJ. MANAGER	BY	DATE
D. COOMBS	S. KELLY	01/03/24
DESIGN DETAILED		
CHECKED/REVIEWED		
DESIGN DETAILED		
DESIGN DETAILED		
REVISIONS 1		
REVISIONS 2		
REVISIONS 3		
REVISIONS 4		
FIELD CHANGES		

WARREN  
ROUTE 90  
CROSS SECTIONS

SHEET NUMBER  
**10**  
OF 13

Date: 1/3/2024

Username: skelly

Division: HIGHWAY

Filename: ... \HIGHWAY\MSTA\SHEETS\XSECT.dgn

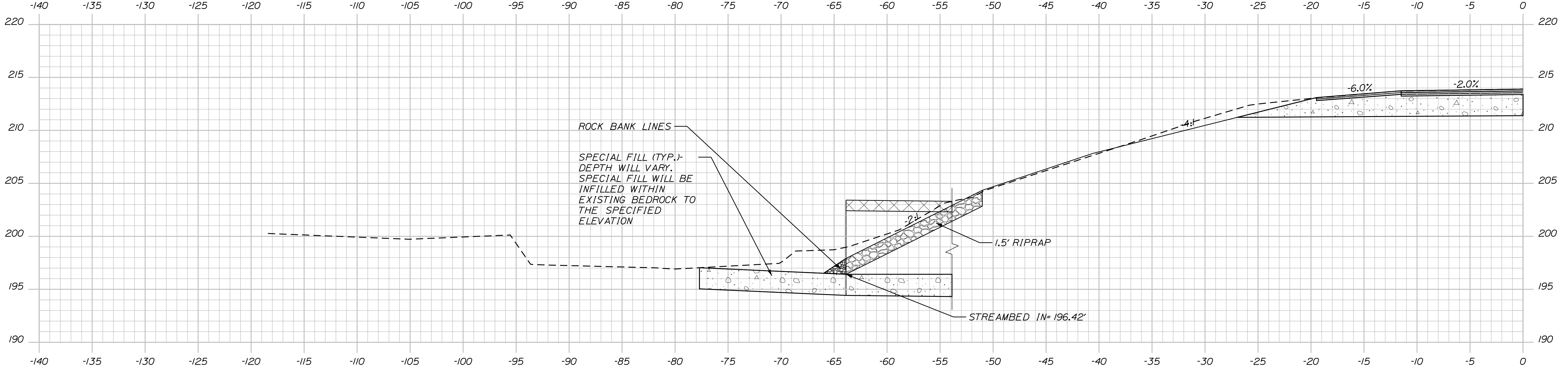

103+47.80 (INLET LOCATION)

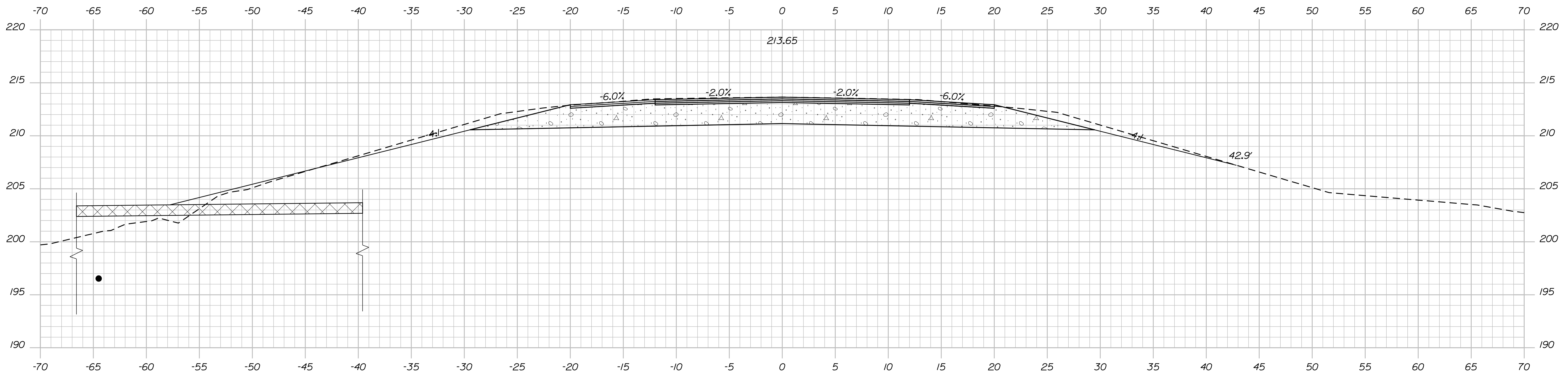

103+25.00

STATE OF MAINE  
DEPARTMENT OF TRANSPORTATION  
26396.00  
WIN  
26396.00  
HIGHWAY PLANS

SIGNATURE  
P.E. NUMBER  
DATE

PROJ. MANAGER	D. COOMBS	BY	DATE
DESIGN-DETAILED		S. KELLY	01/03/24
CHECKED-REVIEWED			
DESIGN-DETAILED			
REVISIONS 1			
REVISIONS 2			
REVISIONS 3			
REVISIONS 4			
FIELD CHANGES			

WARREN  
ROUTE 90  
CROSS SECTIONS

SHEET NUMBER  
**11**  
OF 13

Date: 1/3/2024

Username: skelly

Division: HIGHWAY

Filename: ... \HIGHWAY\MSTA\SHEETS\XSECT.dgn

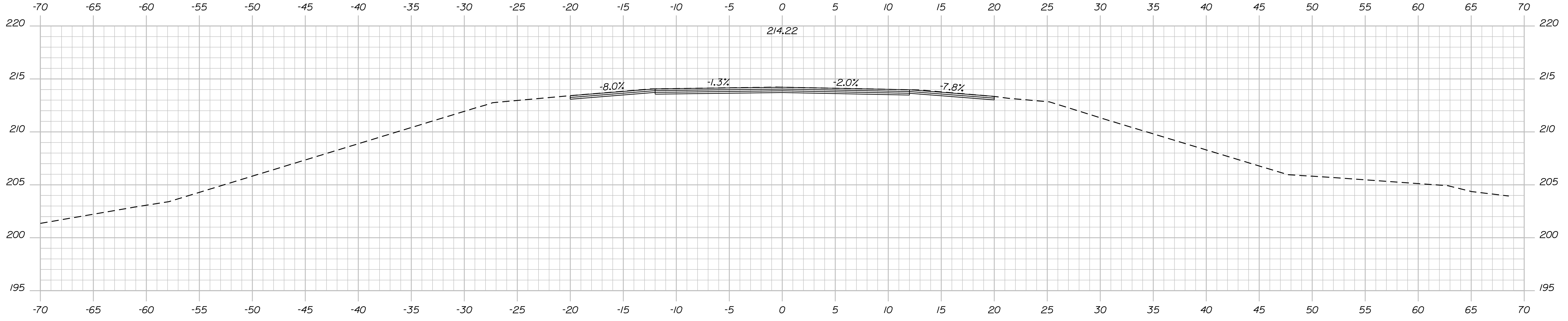

103+75.00 (END TRANSITION, LIMIT OF WORK, MATCH EXISTING)

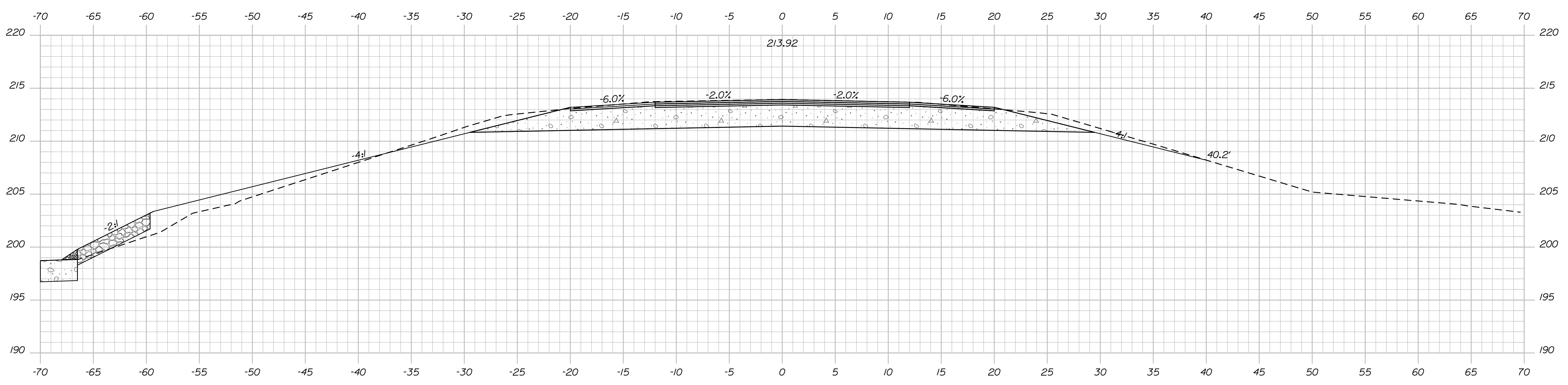

103+50.00 (END PROJECT, BEGIN TRANSITION)

STATE OF MAINE  
DEPARTMENT OF TRANSPORTATION  
26396.00  
WIN  
26396.00  
HIGHWAY PLANS

SIGNATURE  
P.E. NUMBER  
DATE

PROJ. MANAGER	D. COOMBS	BY	DATE
DESIGN-DETAILED		S. KELLY	01/03/24
CHECKED-REVIEWED			
DESIGN-DETAILED			
DESIGN-DETAILED			
REVISIONS 1			
REVISIONS 2			
REVISIONS 3			
REVISIONS 4			
FIELD CHANGES			

WARREN  
ROUTE 90  
CROSS SECTIONS

SHEET NUMBER  
**12**  
OF 13

Town, County, State \_\_\_\_\_  
 Approx. Property Lines \_\_\_\_\_  
 Existing Right of Way \_\_\_\_\_  
 Limits of Wrought Portion \_\_\_\_\_  
 Control Of Access \_\_\_\_\_  
 New Right of Way \_\_\_\_\_  
 New Easement \_\_\_\_\_  
 New Temporary Rights \_\_\_\_\_  
 New R/W Within Existing R/W \_\_\_\_\_

New R/W Along Existing R/W  
 Building \_\_\_\_\_  
 Trees Conifer \_\_\_\_\_  
 Tree Line \_\_\_\_\_  
 Water Edge \_\_\_\_\_  
 Ledge \_\_\_\_\_  
 Fence \_\_\_\_\_  
 Sign \_\_\_\_\_

Clearing Limit Line \_\_\_\_\_  
 Bush Line \_\_\_\_\_  
 Rock/Boulder \_\_\_\_\_  
 Barb Wire \_\_\_\_\_  
 Well \_\_\_\_\_

Sanitary Sewer \_\_\_\_\_  
 Telephone Line \_\_\_\_\_  
 Electric Line \_\_\_\_\_  
 Water Line \_\_\_\_\_  
 Underdrain Line \_\_\_\_\_  
 Gas Line \_\_\_\_\_  
 Guardrail \_\_\_\_\_  
 Culvert \_\_\_\_\_

Proposed \_\_\_\_\_  
 Traveled Way \_\_\_\_\_  
 Ditch \_\_\_\_\_  
 Catch Basin \_\_\_\_\_  
 Manhole \_\_\_\_\_  
 Sewer Manhole \_\_\_\_\_  
 Utility Pole \_\_\_\_\_  
 Fire Hydrant \_\_\_\_\_  
 Curbing \_\_\_\_\_

Cut Line \_\_\_\_\_  
 Stonewall \_\_\_\_\_  
 Baseline \_\_\_\_\_  
 Monument \_\_\_\_\_  
 Iron Rod Found \_\_\_\_\_  
 Replacement Pin Set \_\_\_\_\_

Fill Line \_\_\_\_\_  
 Retaining Wall \_\_\_\_\_  
 Traverse Point \_\_\_\_\_  
 Pipe Found \_\_\_\_\_

THIS PLAN WAS PREPARED IN CONNECTION WITH THE DEPARTMENT'S ACQUISITION OF REAL PROPERTY FOR TRANSPORTATION PURPOSES. IT CANNOT BE USED TO ESTABLISH LEGAL BOUNDARIES BETWEEN ADJACENT PROPERTY OWNERS.

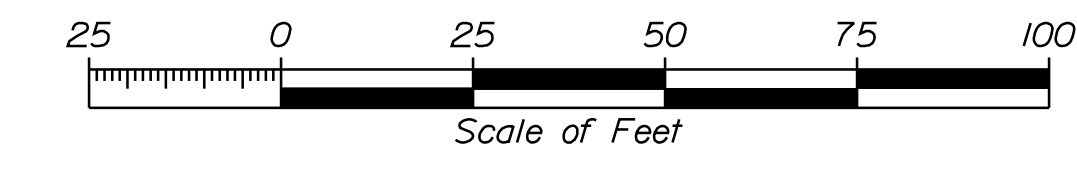

STATE OF MAINE  
 REGISTRY OF DEEDS  
 COUNTY \_\_\_\_\_  
 RECEIVED \_\_\_\_\_  
 at \_\_\_\_\_ h \_\_\_\_\_ m \_\_\_\_\_ M and  
 recorded in Plan Bk \_\_\_\_\_, Pg. \_\_\_\_\_  
 Attest: \_\_\_\_\_ REGISTER

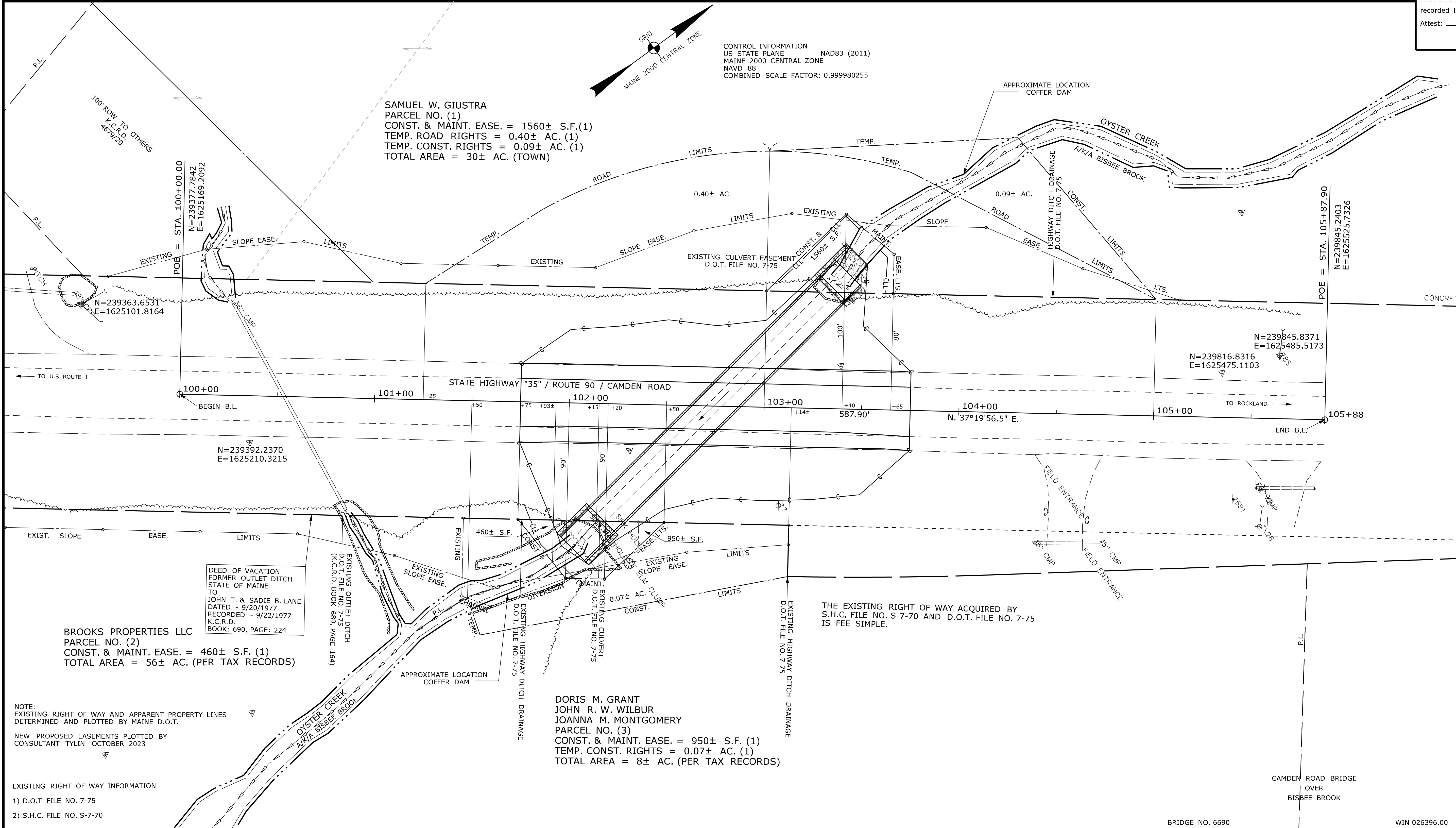

Date: \$date\$

Username: \$user\$

Division: \$wkgroup\$

Filename: \$file\$

ITEM	TECH	CHECKED
EXISTING CONDITION PLAN	JDF	GILL
FINAL RIGHT OF WAY	TYLIN	JDF
AREAS	TYLIN	JDF

STATE OF MAINE  
 DEPARTMENT OF TRANSPORTATION  
 16 STATE HOUSE STATION - AUGUSTA, ME 04333-0016 - 207-624-3460  
 WARREN  
 RIGHT OF WAY MAP

NO.	DATE	REVISIONS DESCRIPTION	BY	PLAN FILED IN PLAN BOOK				PAGE COUNTY RECORD									
				NO.	GRANTOR	INSTRUMENT	DATE	BOOK	PAGE	INSTRUMENT	DATE	BOOK	PAGE				

BRUCE A. VAN NOTE  
 COMMISSIONER  
 JOYCE NOEL TAYLOR  
 CHIEF ENGINEER  
 DATE \_\_\_\_\_

STATE HIGHWAY "35"  
 ROUTE 90/CAMDEN ROAD  
 WARREN KNOX COUNTY  
 FEDERAL AID PROJECT NO. 2639600  
 NOVEMBER 2023 RIGHT-OF-WAY MAP  
 SCALE 1" = 25' SHEET 1 OF 1  
 D.O.T. FILE NO. 7-181

SHEET NUMBER  
**13**  
 OF 13