

STATE OF MAINE DEPARTMENT OF TRANSPORTATION



SPECIFICATIONS

Design: Load and Resistance Factor Design per AASHTO LRFD Bridge Design Specifications, Tenth Edition 2024.

DESIGN LOADING

Live Load..... HL - 93 Modified for Strength I

TRAFFIC DATA

Current (2022) AADT.....	1,040
Future (2042) AADT.....	1,140
DHV - % of AADT.....	12%
Design Hour Volume.....	137
Heavy Trucks (% of AADT).....	10%
Heavy Trucks (% of DHV).....	11%
Directional Distribution (% of DHV).....	51%
18 kip Equivalent P 2.0.....	81
18 kip Equivalent P 2.5.....	77
Design Speed (mph).....	40

HYDROLOGIC DATA

Drainage Area.....	3.3 sq mi
Design Discharge (Q50).....	335 cfs
Check Discharge (Q100).....	390 cfs
Headwater Elevation (Q1.1).....	187.62 ft
Headwater Elevation (Q10).....	189.18 ft
Headwater Elevation (Q50).....	189.76 ft
Headwater Elevation (Q100).....	190.02 ft
Discharge Velocity (Q1.1).....	0.69 fps
Discharge Velocity (Q10).....	1.76 fps
Discharge Velocity (Q50).....	2.41 fps
Discharge Velocity (Q100).....	2.70 fps

MATERIALS

Concrete:
Precast..... Class "P"

Reinforcing:
Plain Reinforcing Steel..... ASTM A615, Grade 60

BASIC DESIGN STRESSES

Concrete:
Class "P"..... f 'c = 5,000 psi

Reinforcing:
Plain Reinforcing Steel..... f y = 60,000 psi

MONMOUTH KENNEBEC COUNTY BAILEY FLAT BRIDGE OVER MUD MILLS STREAM COBBOSSEE ROAD FEDERAL AID PROJECT NO. 2615600 PROJECT LENGTH 0.09 mi. BRIDGE NO. 3671

LIST OF DRAWINGS

Title Sheet.....	1
Estimated Quantities & General Notes.....	2
General Plan.....	3
Profile.....	4
Boring Location Plan.....	5
Interpretive Subsurface Profile.....	6
Boring Logs.....	7
Typical Sections.....	8
Cross Sections.....	9-15
Precast Concrete Box Culvert Details.....	16-17
Culvert Mounted Guardrail Details.....	18
Detour Plan.....	19
Sign Summary.....	20
Right of Way Map.....	21

UTILITIES

Central Maine Power
Consolidated Communications of Northern New England
Monmouth Sanitary Sewer District

MAINTENANCE OF TRAFFIC

Road closure with off-site detour.



<u>PROJECT LOCATION</u>	Bailey Flat Bridge (#3671) over Mud Mills Stream. Located 0.73 of a mile north of Gilman Road.
<u>OUTLINE OF WORK</u>	Replacement of Bailey Flat Bridge (#3671) in Monmouth with 450' of approach work.

STATE OF MAINE
DEPARTMENT OF TRANSPORTATION
APPROVED
ACTING COMMISSIONER: [Signature]
DATE: 11-21-25
CHIEF ENGINEER: [Signature]

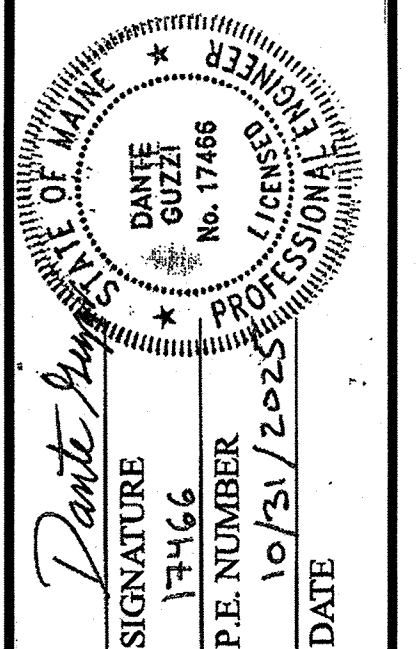

PROJECT INFORMATION
PROGRAM
BRIDGE
TREXOR/GLEASON
PROJECT MANAGER
DATE/GLEASON
DESIGNER
HNTB
CONSULTANT
PROJECT RESIDENT
CONTRACTOR
PROJECT COMPLETION DATE

**MONMOUTH
BAILEY FLAT BRIDGE
TITLE SHEET**

**SHEET NUMBER
1
OF 21**

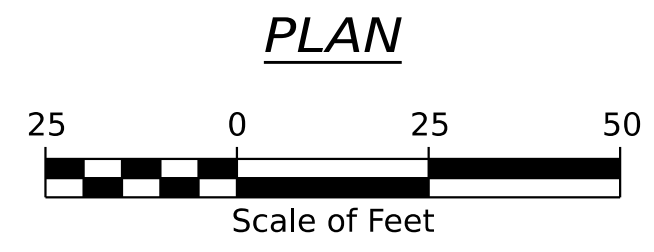
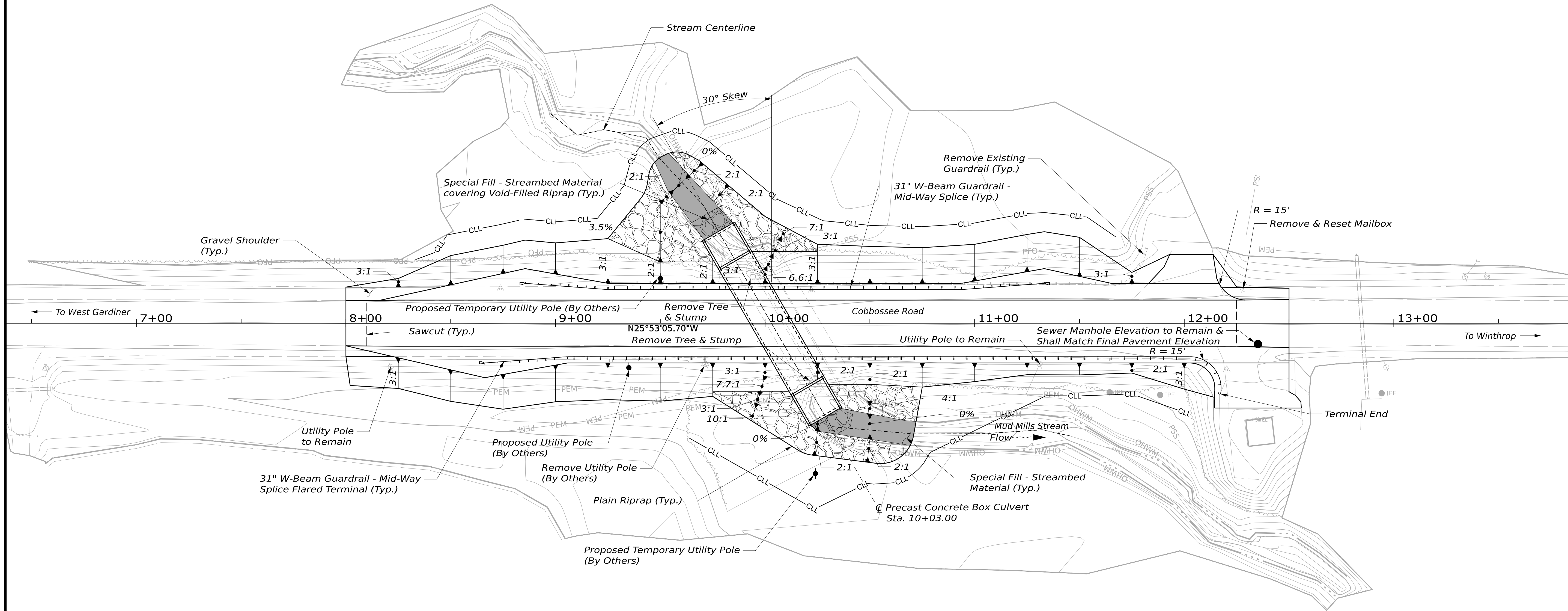

PROJ. MANAGER	DATE	BY	DATE	SIGNATURE	P.E. NUMBER	DATE
Trevor Gleason	10/2025	E. Raymond	10/2025			
DESIGN-DETAILED		E. Raymond				
CHECKED-REVIEWED		E. Davidson				
DESIGN-DETAILED02						
DESIGN-DETAILED03						
REVISIONS 1						
REVISIONS 2						
REVISIONS 3						
REVISIONS 4						
FIELD CHANGES						

**BAILEY FLAT BRIDGE BRIDGE NO. 3671
CROSSING MUD MILLS STREAM
MONMOUTH**

GENERAL PLAN



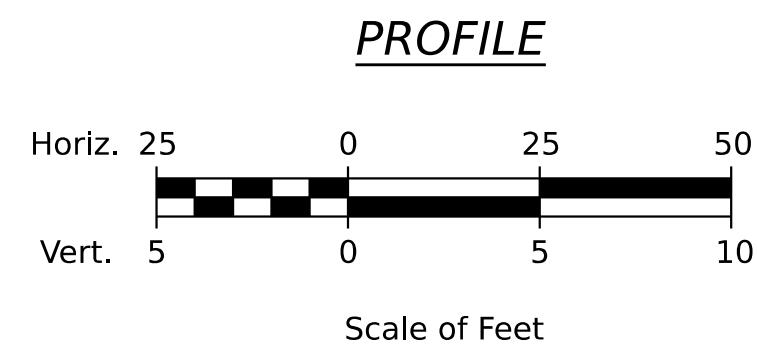
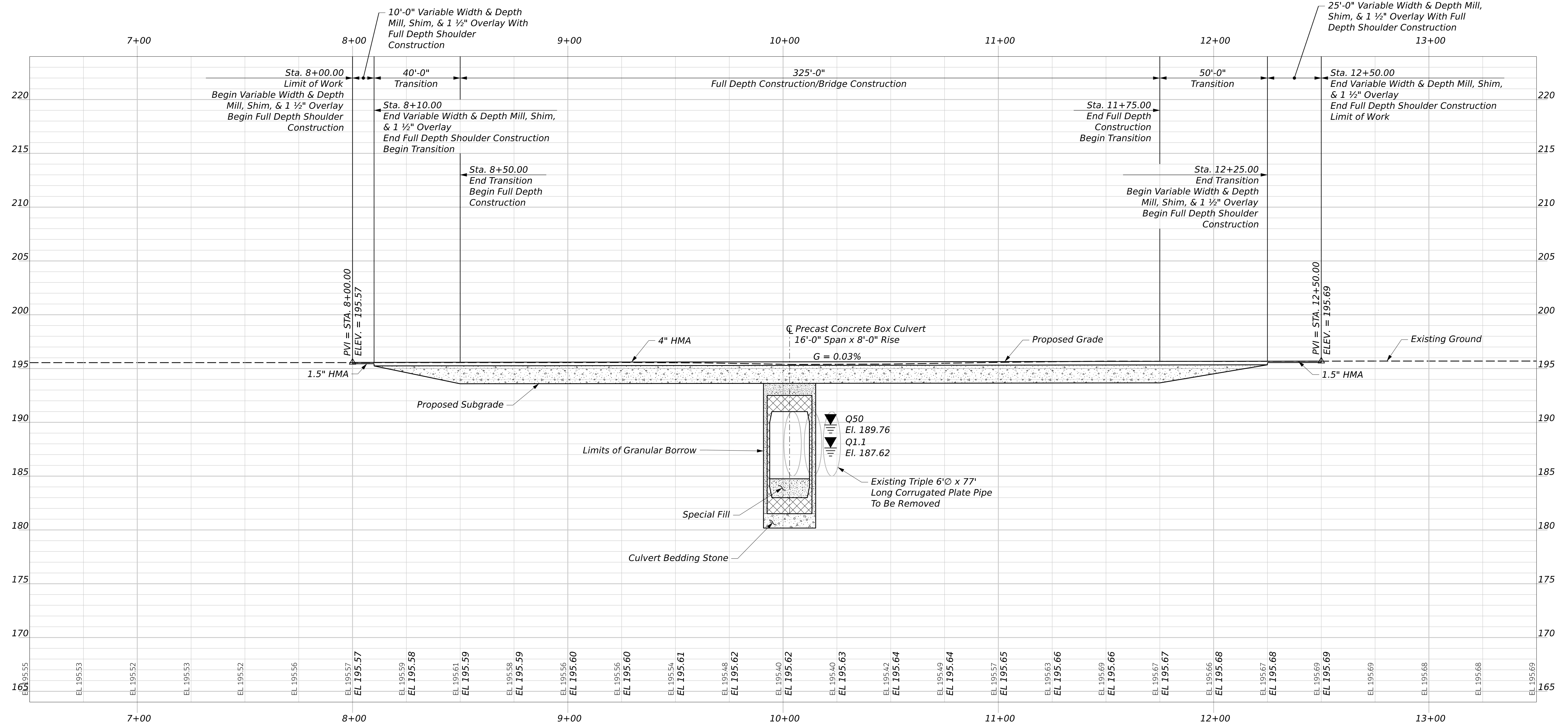

PROJ. MANAGER	DATE	BY	SIGNATURE	P.E. NUMBER	DATE
Trevor Gleason	10/2025	E. Raymond			
DESIGN-DETAILED	10/2025	E. Davidson			
CHECKED-REVIEWED		J. O'Neil			
DESIGN-DETAILED02					
DESIGN-DETAILED03					
REVISIONS 1					
REVISIONS 2					
REVISIONS 3					
REVISIONS 4					
FIELD CHANGES					

**BAILEY FLAT BRIDGE BRIDGE NO. 3671
CROSSING MUD MILLS STREAM
MONMOUTH**

SHEET NUMBER

4

OF 21

PROFILE



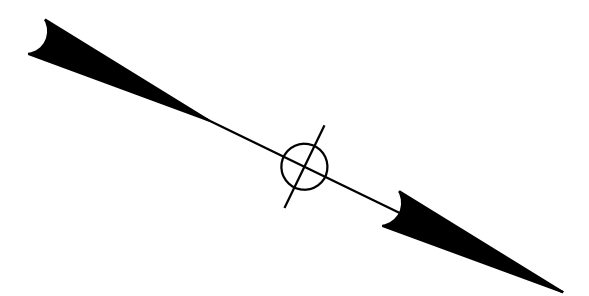
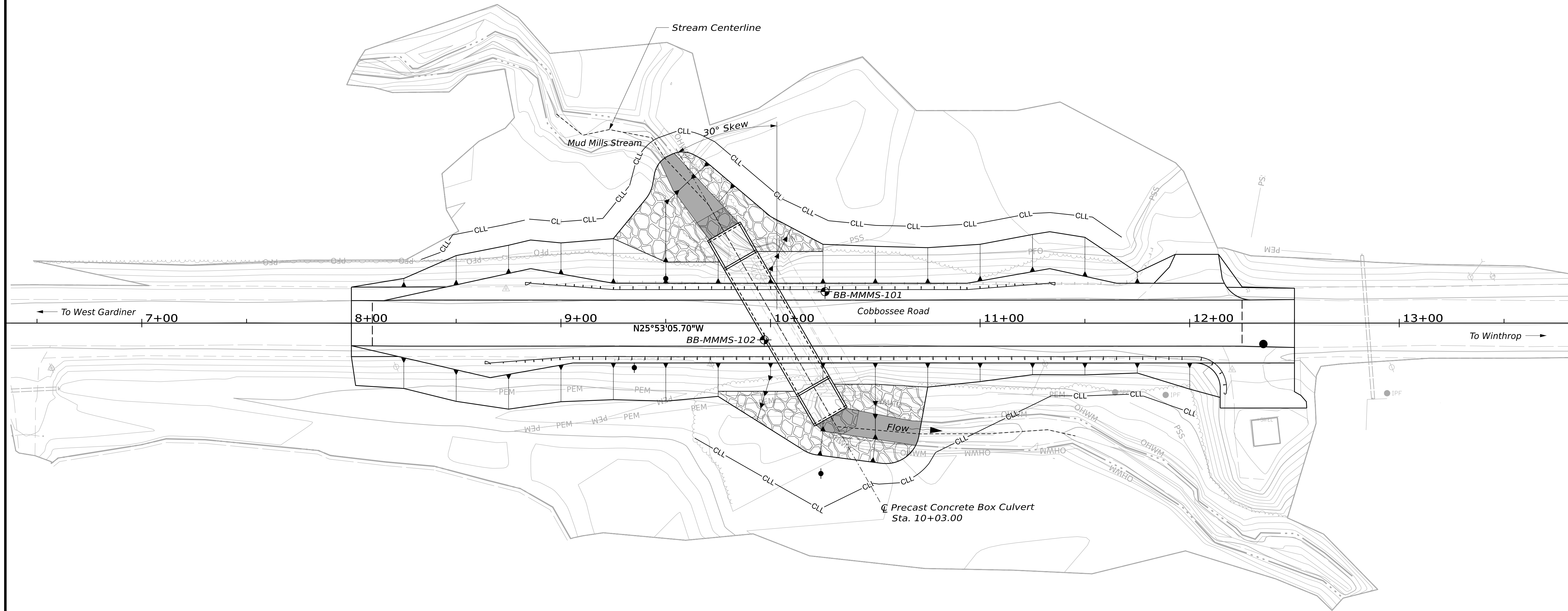

LEGEND

⊕ BB-MMMS-XXX Indicates borings performed by New England Boring Contractors of Hermon, Maine between October 10, and October 11, 2022 and observed by Schonewald Engineering Associates.

PLAN



STATE OF MAINE
DEPARTMENT OF TRANSPORTATION
Federal Project No. 2615600
WIN 026156.00

PROJ. MANAGER	DATE	BY	DATE
Trevor Gleason	10/2025	E. Bauschell	10/2025
DESIGN-DETAILED		M. Rowell	
CHECKED-REVIEWED		D. Guzzi	
DESIGN-DETAILED02		J. Oland	
DESIGN-DETAILED03			
REVISIONS 1			
REVISIONS 2			
REVISIONS 3			
REVISIONS 4			
FIELD CHANGES			

BAILEY FLAT BRIDGE BRIDGE NO. 3671
CROSSING MUD MILLS STREAM
MONMOUTH
BORING LOCATION PLAN

SHEET NUMBER
5
OF 21



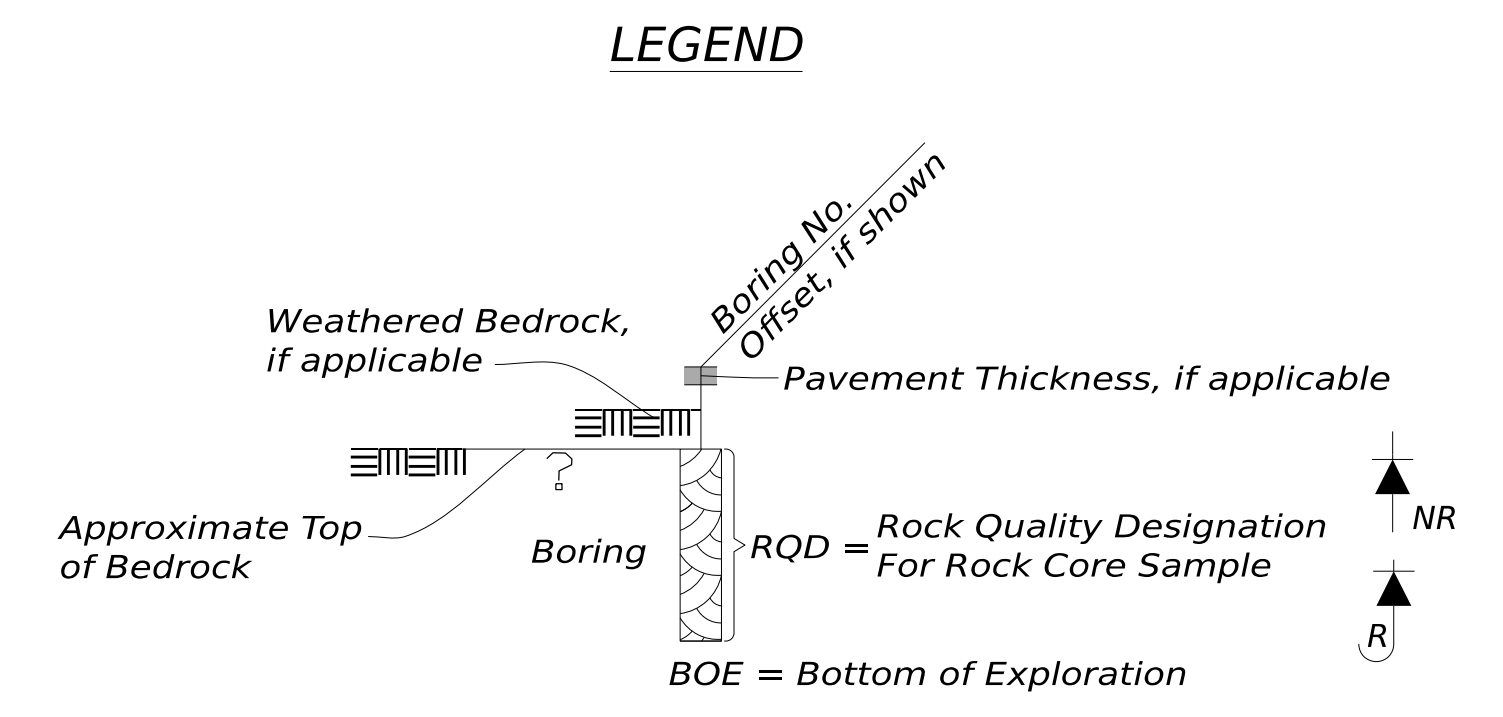
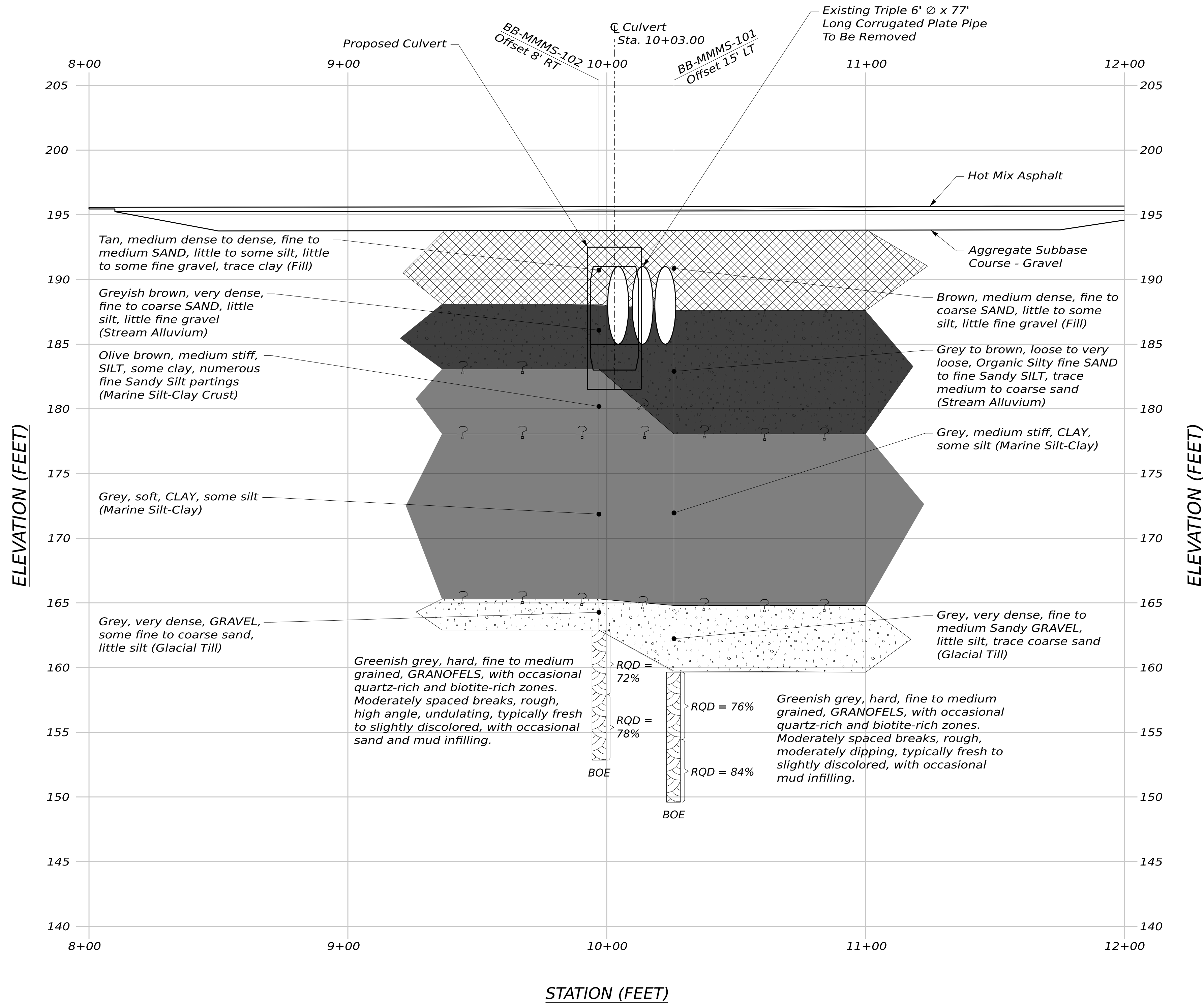

NOTES:
 1. This generalized interpretive soil profile is intended to convey trends in subsurface conditions. The boundaries between strata are approximate and idealized, and have been developed by interpretations of widely spaced explorations and samples. Actual soil transitions may vary and are probably more erratic. For more specific information refer to the exploration logs.

DATE	SIGNATURE	P.E. NUMBER	DATE
10/20/25			
10/20/25			

PROJ. MANAGER	BY	DATE
Trevor Gleason	E. Bouskela	10/20/25
CHECKED-REVIEWED	M. Rowell	10/20/25
DESIGNED-DETAILED	D. Guah	10/20/25
DESIGNED-DETAILED		
REVISIONS 1		
REVISIONS 2		
REVISIONS 3		
REVISIONS 4		
FIELD CHANGES		

**BAILEY FLAT BRIDGE BRIDGE NO. 3671
 CROSSING MUD MILLS STREAM
 MONMOUTH
 INTERPRETIVE
 SUBSURFACE PROFILE**



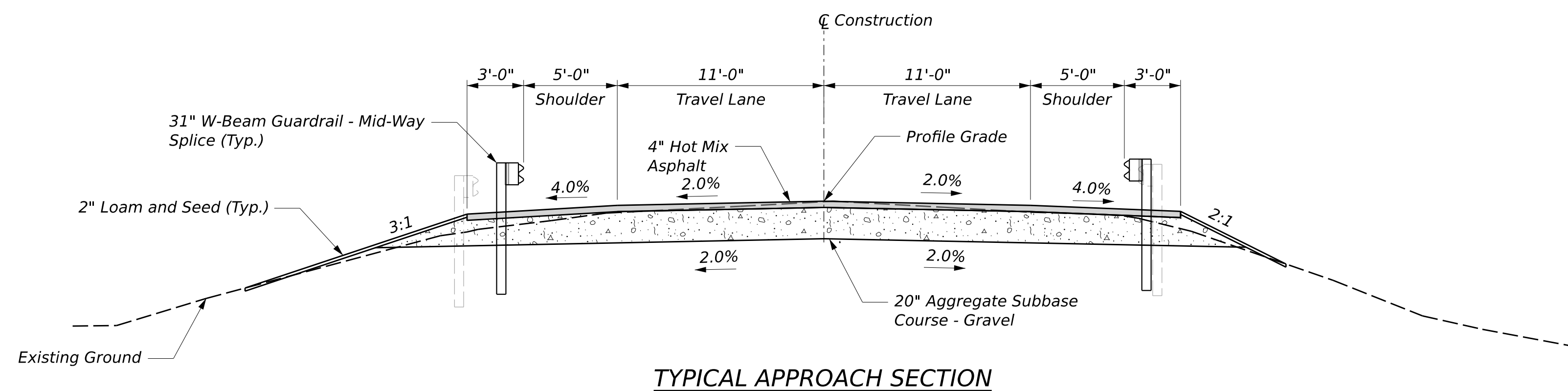

TYPICAL APPROACH SECTION

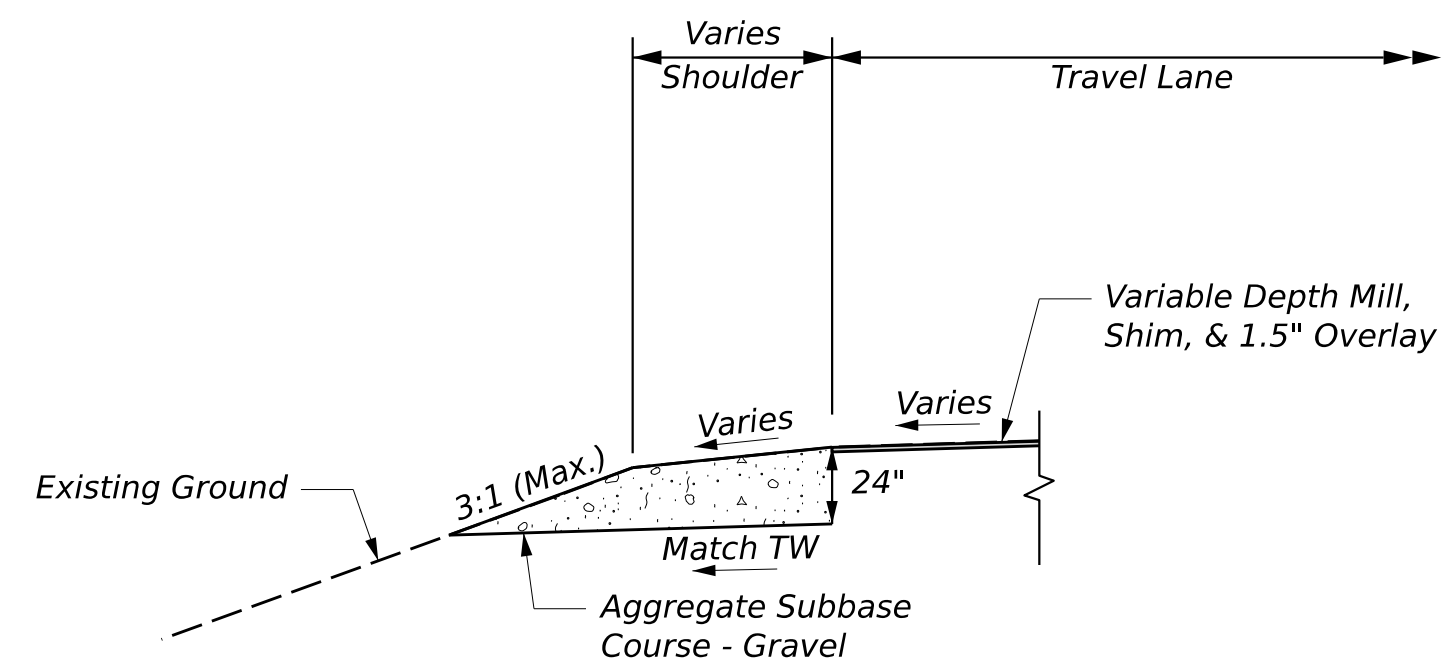

GRAVEL SHOULDER SECTION

Left Shoulder	Left Travel Lane	Station	Right Travel Lane	Right Shoulder
Match Existing	Match Existing	8+00	Match Existing	Match Existing
-22.9%	-4.3%	8+25	-2.0%	-8.7%
-9.8%	-3.1%	8+50	-2.0%	-7.1%
-7.9%	-2.0%	8+75	-2.0%	-5.6%
-5.9%	-2.0%	9+00	-2.0%	-4.0%
-4.0%	-2.0%	9+25	-2.0%	-4.0%
-4.0%	-2.0%	11+25	-2.0%	-4.0%
-5.5%	-2.0%	11+50	-2.0%	-4.0%
-7.0%	-2.0%	11+75	-2.0%	-4.0%
-8.5%	-3.0%	12+00	-2.0%	-4.0%
-10.0%	-4.0%	12+25	-3.1%	-4.0%
Match Existing	Match Existing	12+50	Match Existing	Match Existing

STATE OF MAINE
DEPARTMENT OF TRANSPORTATION
Federal Project No. 2615600

SIGNATURE
P.E. NUMBER
DATE

PROJ. MANAGER	DATE	BY	TRACER
DESIGN-DETAILED	10/2025	E. Raymond	E. Raymond
CHECKED-REVIEWED	10/2025	J. O'Neil	E. Davidson
DESIGN-DETAILED02			
DESIGN-DETAILED03			
REVISIONS 1			
REVISIONS 2			
REVISIONS 3			
REVISIONS 4			
FIELD CHANGES			

BAILEY FLAT BRIDGE NO. 3671
CROSSING MUD MILLS STREAM
MONMOUTH
TYPICAL SECTIONS

SHEET NUMBER
8
OF 21



PROJ. MANAGER	Trevor Gleason
DESIGN-DETAILED	E. Raymond
CHECKED-REVIEWED	J. O'Neil
DESIGN-DETAILED02	
DESIGN-DETAILED03	
REVISIONS 1	
REVISIONS 2	
REVISIONS 3	
REVISIONS 4	
FIELD CHANGES	

DATE	10/20/25
BY	E. Raymond
DATE	10/20/25
BY	J. O'Neil
DATE	
BY	
DATE	
BY	
DATE	
BY	
DATE	

BAILEY FLAT BRIDGE BRIDGE NO. 3671
CROSSING MUD MILLS STREAM
MONMOUTH
CROSS SECTIONS

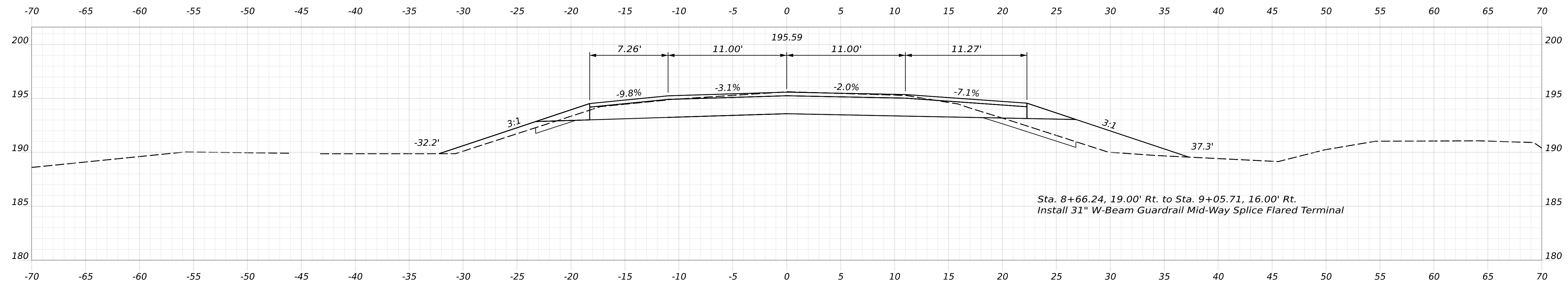

Sta. 8+50.00
End Transition
Begin Full Depth Construction

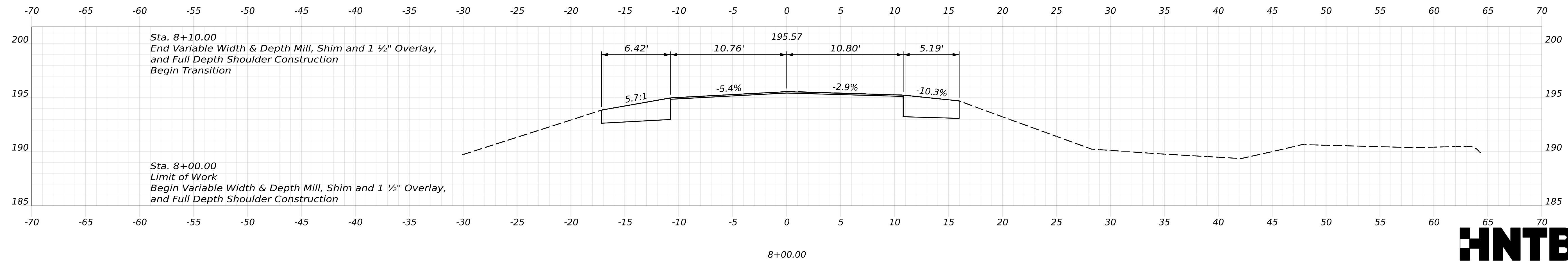
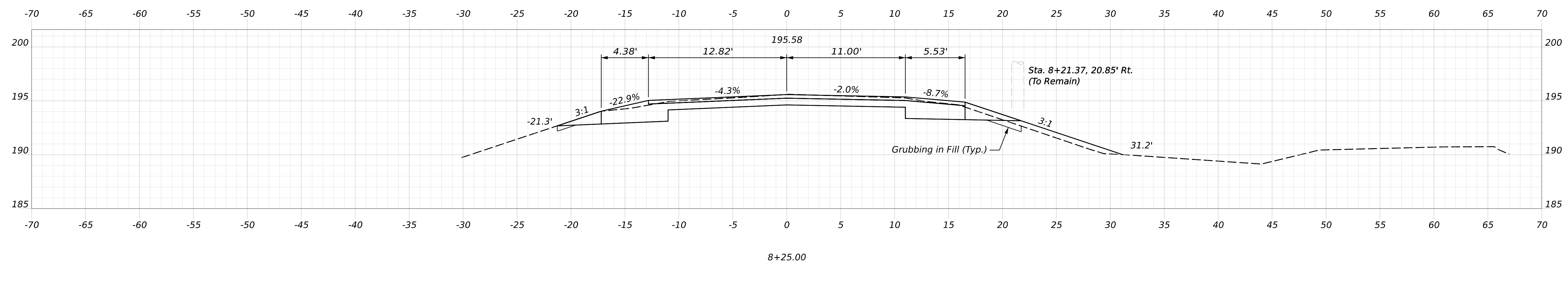

Sta. 8+10.00
End Variable Width & Depth Mill, Shim and 1 1/2" Overlay,
and Full Depth Shoulder Construction
Begin Transition

Sta. 8+00.00
Limit of Work
Begin Variable Width & Depth Mill, Shim and 1 1/2" Overlay,
and Full Depth Shoulder Construction



Username: dguzzo Date: 10/31/2025

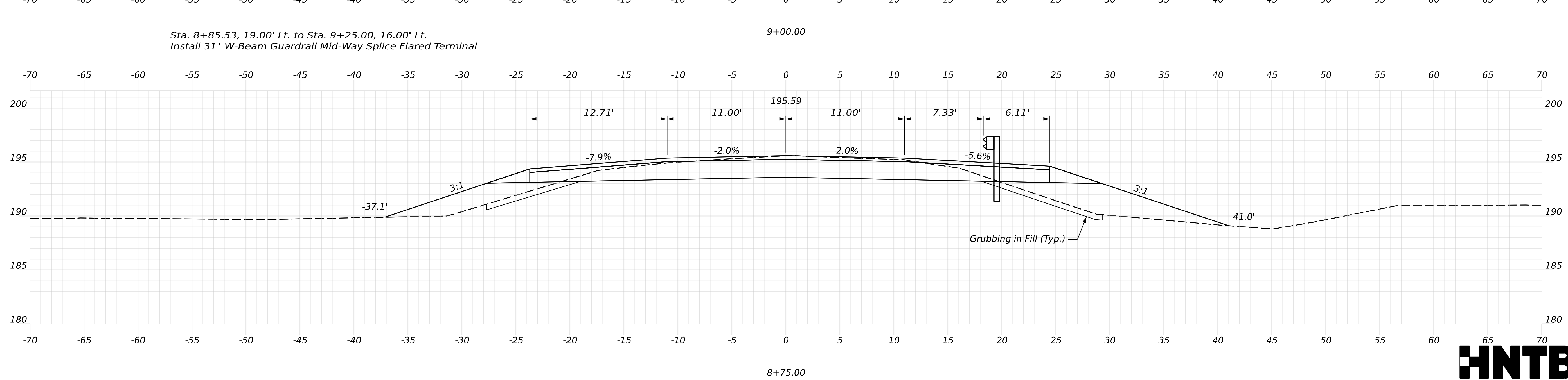
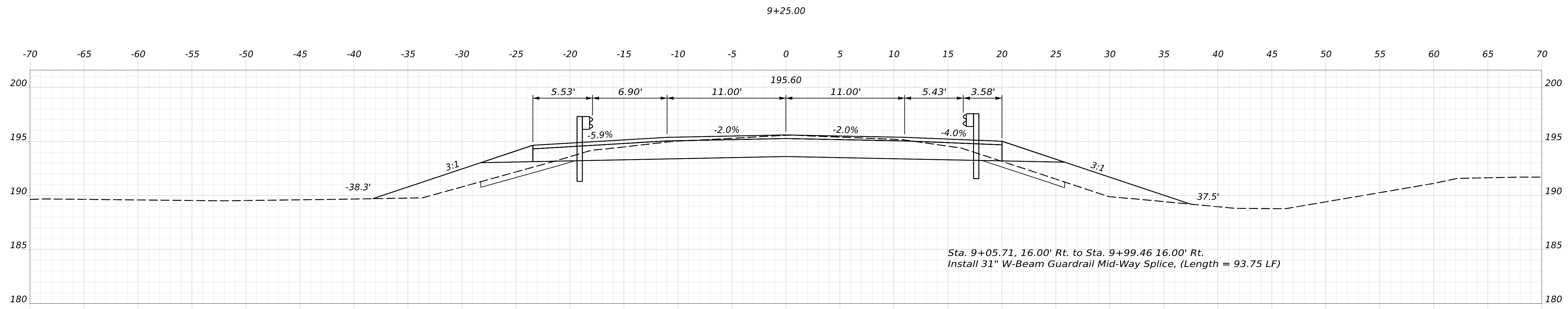
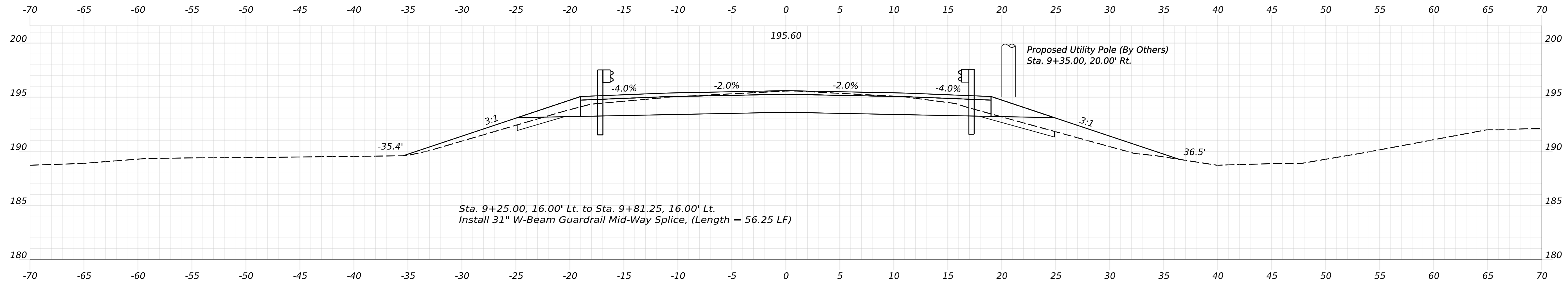

STATE OF MAINE
DEPARTMENT OF TRANSPORTATION
Federal Project No. 2615600
WIN 026156.00

DATE	SIGNATURE	P.E. NUMBER	DATE
10/2025			
10/2025			

PROJ. MANAGER	BY	DATE
Trevor Gleason	E. Raymond	10/2025
DESIGN-DETAILED	E. Raymond	10/2025
CHECKED-REVIEWED	J. O'Neil	10/2025
DESIGN-DETAILED02		
DESIGN-DETAILED03		
REVISIONS 1		
REVISIONS 2		
REVISIONS 3		
REVISIONS 4		
FIELD CHANGES		

BAILEY FLAT BRIDGE BRIDGE NO. 3671
CROSSING MUD MILLS STREAM
MONMOUTH
CROSS SECTIONS

SHEET NUMBER
10
OF 21

Sta. 10+06.25, 16.00' Lt. to Sta. 10+93.75, 16.00' Lt.
Install 31" W-Beam Guardrail - Mid-Way Splice, (Length = 87.50 LF)

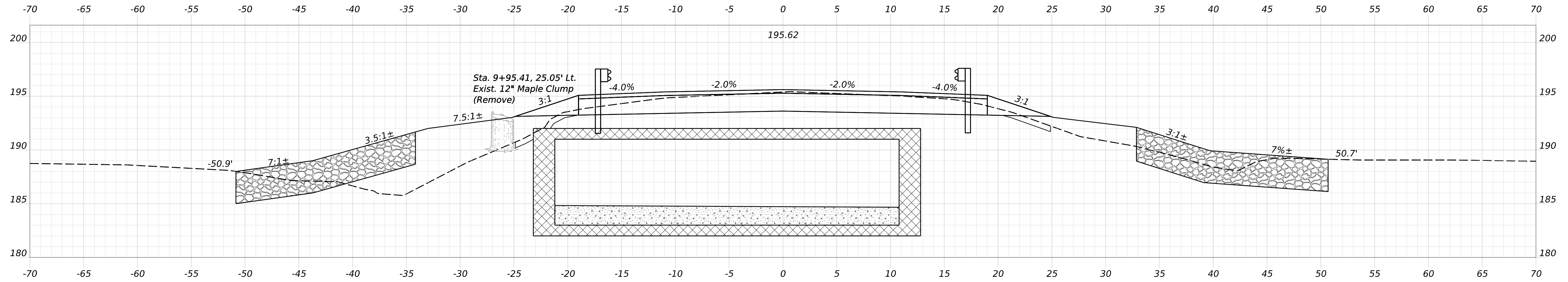

Sta. 9+81.25, 16.00' Lt. to Sta. 10+06.25, 16.00' Lt.
Install Guardrail - Single Rail Culvert Mounted, (Length = 25.00 LF)

Sta. 9+99.46, 16.00' Rt. to Sta. 10+24.46, 16.00' Rt.
Install Guardrail - Single Rail Culvert Mounted, (Length = 25.00 LF)

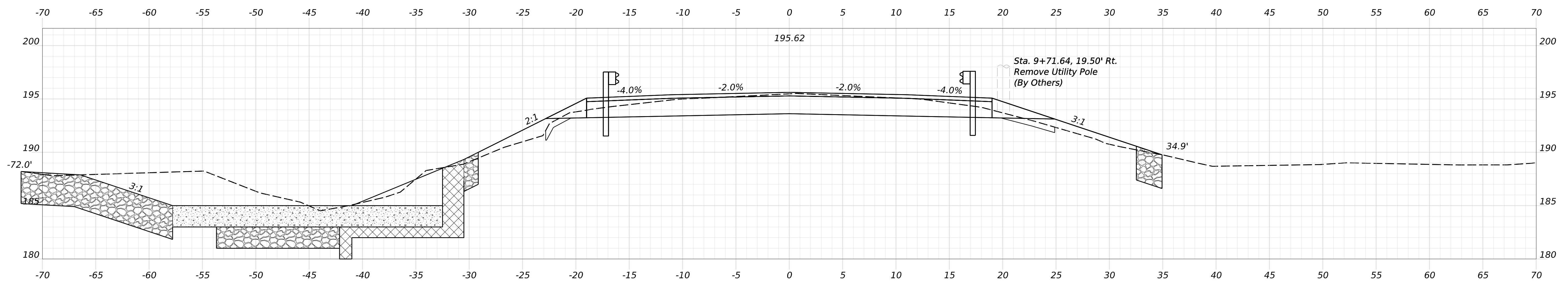

Proposed Temporary Utility Pole
(By Others)
Sta. 9+50.00, 20.00' Lt.

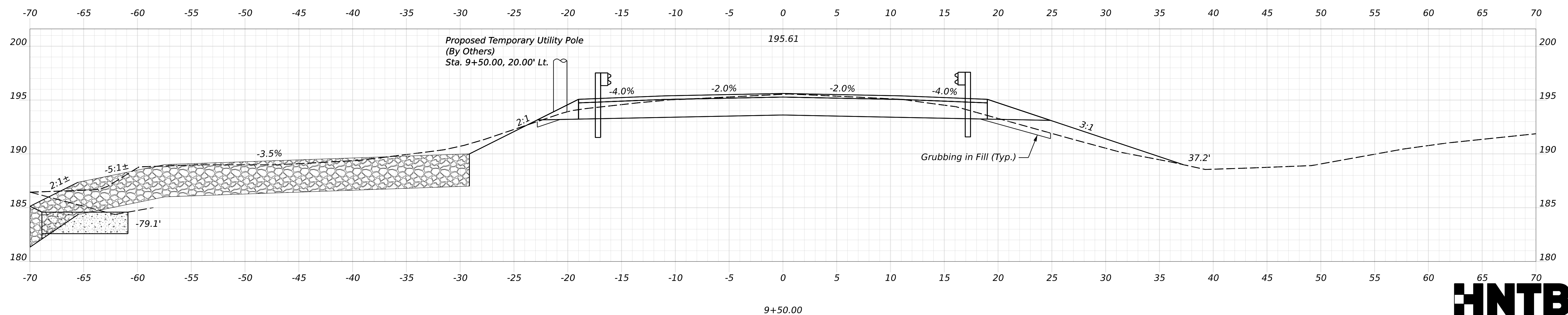

DATE	BY	SIGNATURE	P.E. NUMBER	DATE
10/2025	E. Raymond			
10/2025	J. O'Neil			

PROJ. MANAGER	DESIGN-DETAILED	CHECKED-REVIEWED	DESIGN-DETAILED	REVISIONS 1	REVISIONS 2	REVISIONS 3	REVISIONS 4	FIELD CHANGES
Trevor Gleason	E. Raymond	E. Raymond	E. Raymond					

BAILEY FLAT BRIDGE BRIDGE NO. 3671
CROSSING MUD MILLS STREAM
MONMOUTH

CROSS SECTIONS

SHEET NUMBER

11

OF 21



Username: dguzzi Date: 10/31/2025

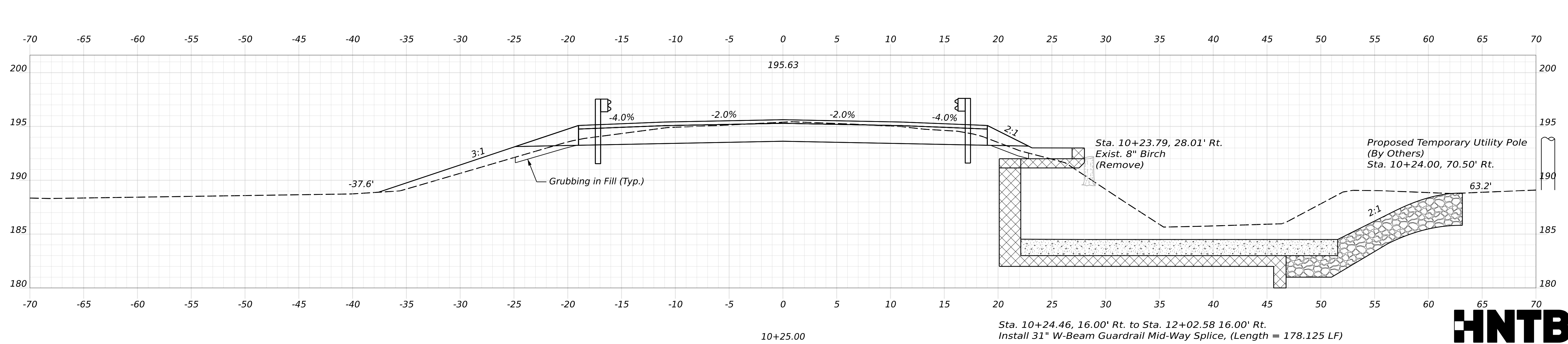
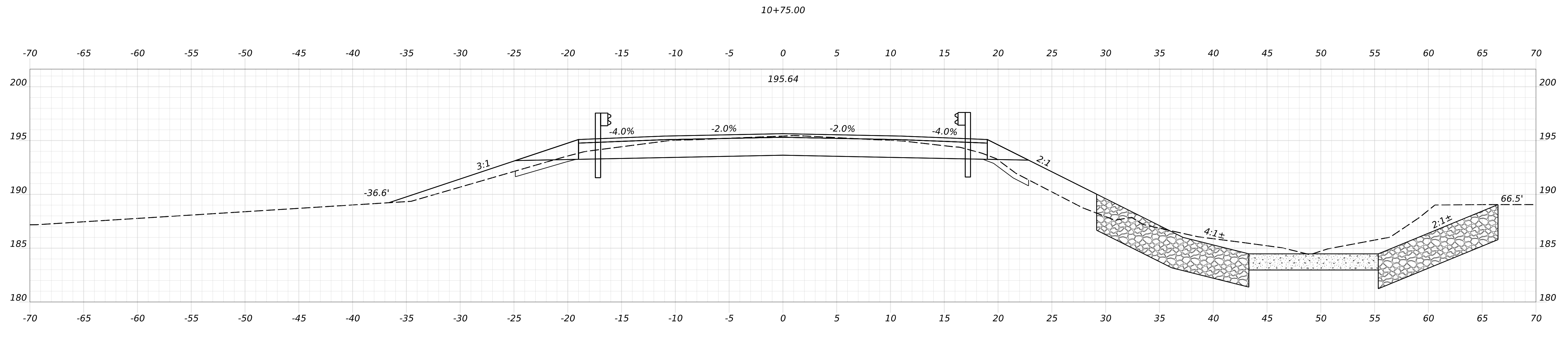
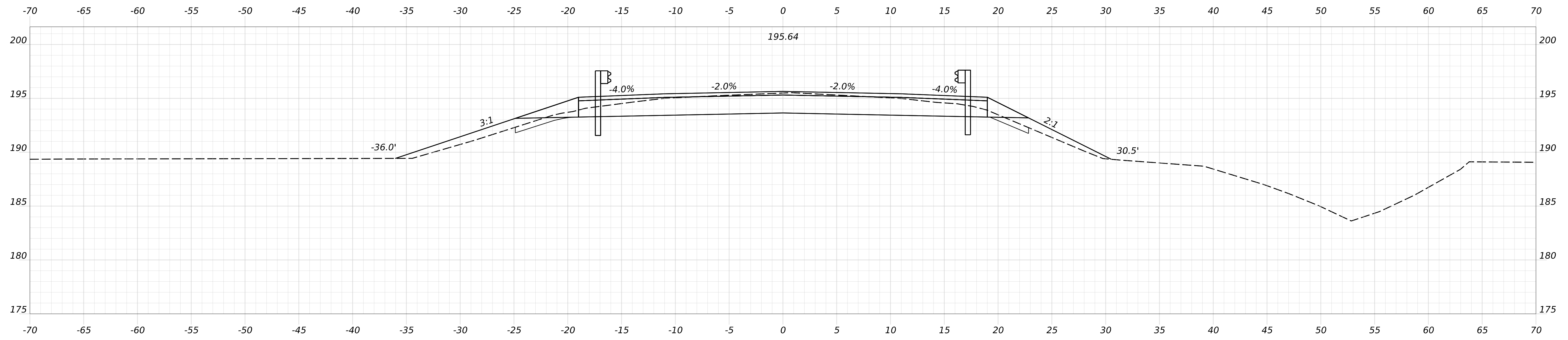

STATE OF MAINE
DEPARTMENT OF TRANSPORTATION
Federal Project No. 2615600
WIN 026156.00

DATE	SIGNATURE	P.E. NUMBER	DATE
10/2025			
10/2025			

PROJ. MANAGER	BY	DATE
Trevor Gleason	E. Raymond	10/2025
DESIGN-DETAILED	E. Raymond	10/2025
CHECKED-REVIEWED	J. O'Neil	10/2025
DESIGN-DETAILED02		
DESIGN-DETAILED03		
REVISIONS 1		
REVISIONS 2		
REVISIONS 3		
REVISIONS 4		
FIELD CHANGES		

BAILEY FLAT BRIDGE BRIDGE NO. 3671
CROSSING MUD MILLS STREAM
MONMOUTH
CROSS SECTIONS

SHEET NUMBER
12
OF 21

Username: dguzzi Date: 10/31/2025

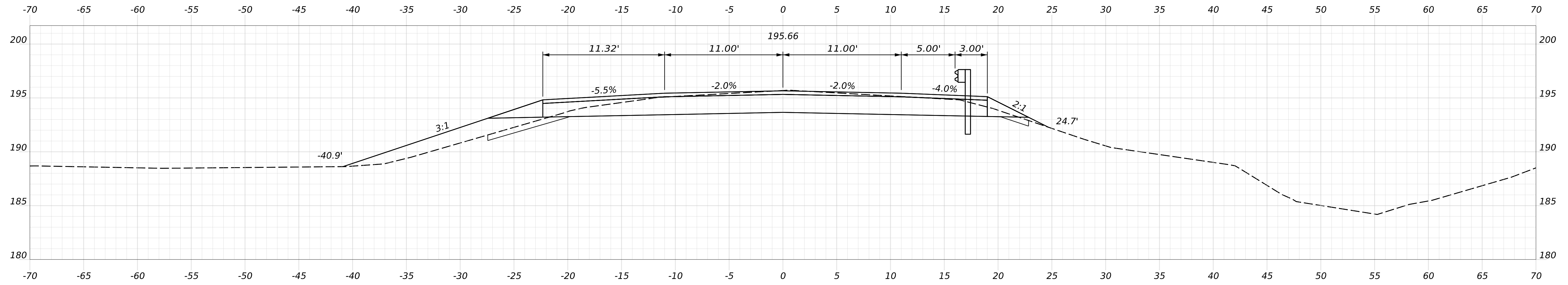

11+50.00

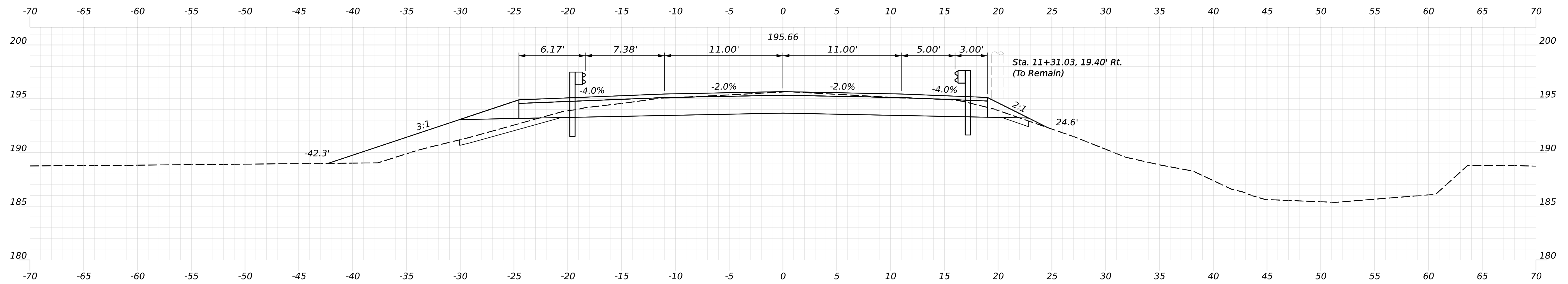

11+25.00

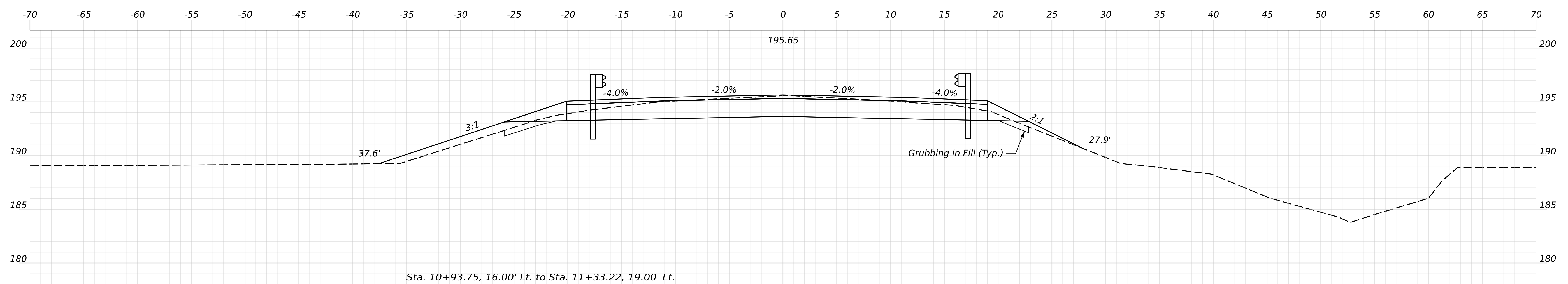

11+00.00

STATE OF MAINE
DEPARTMENT OF TRANSPORTATION
Federal Project No. 2615600
WIN 026156.00

PROJ. MANAGER	DATE	BY	DATE
Trevor Gleason	10/2025	E. Raymond	10/2025
DESIGN-DETAILED		E. Raymond	
CHECKED-REVIEWED		J. O'Neil	
DESIGN-DETAILED2			
DESIGN-DETAILED3			
REVISIONS 1			
REVISIONS 2			
REVISIONS 3			
REVISIONS 4			
FIELD CHANGES			

SIGNATURE	P.E. NUMBER	DATE

BAILEY FLAT BRIDGE BRIDGE NO. 3671
CROSSING MUD MILLS STREAM
MONMOUTH
CROSS SECTIONS

SHEET NUMBER
13
OF 21



Username: dguzzi Date: 10/31/2025

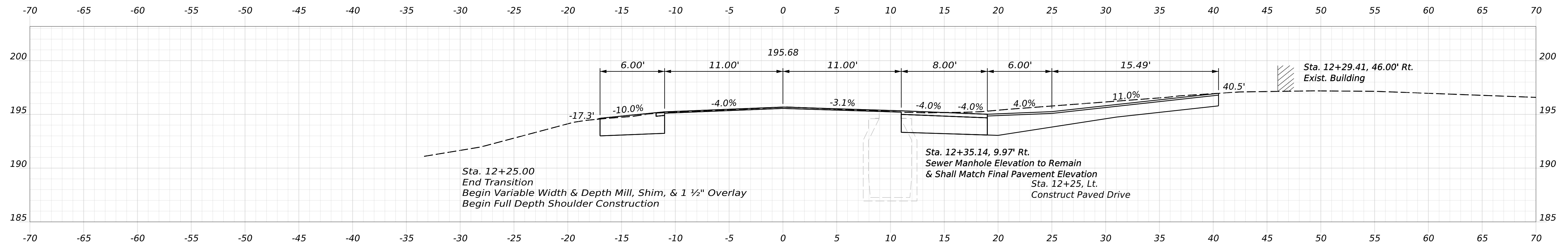

12+25.00

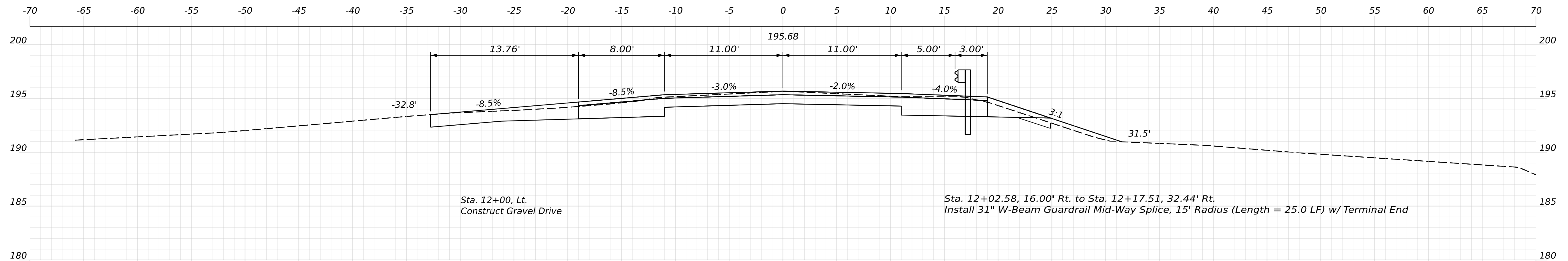

12+00.00

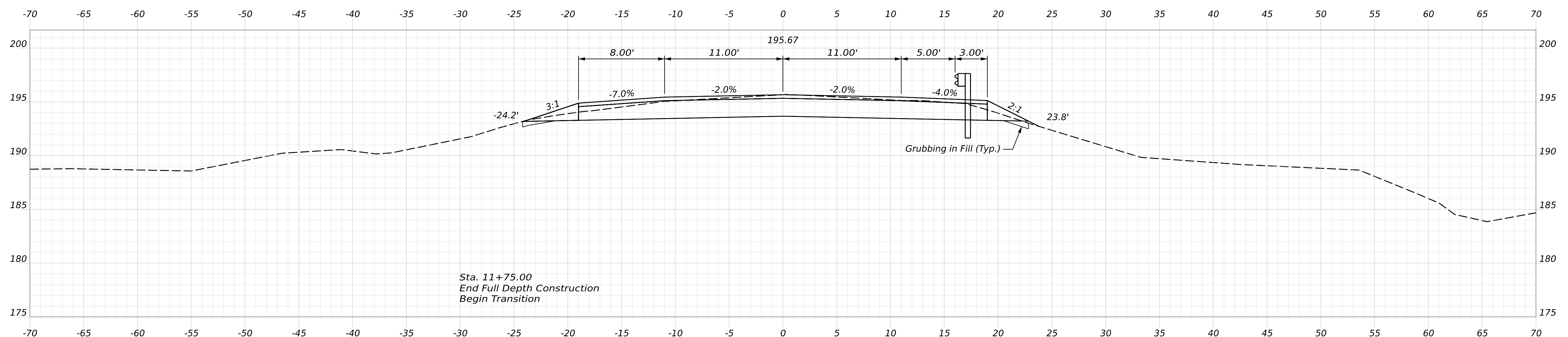

11+75.00



STATE OF MAINE
DEPARTMENT OF TRANSPORTATION
Federal Project No. 2615600
WIN 026156.00

PROJ. MANAGER	DATE	BY	DATE	SIGNATURE	P.E. NUMBER	DATE
Trevor Gleason	10/2025	E. Raymond	10/2025			
DESIGN-DETAILED		E. Raymond				
CHECKED-REVIEWED		J. O'Neil				
DESIGN-DETAILED02						
DESIGN-DETAILED03						
REVISIONS 1						
REVISIONS 2						
REVISIONS 3						
REVISIONS 4						
FIELD CHANGES						

BAILEY FLAT BRIDGE BRIDGE NO. 3671
CROSSING MUD MILLS STREAM
MONMOUTH
CROSS SECTIONS

SHEET NUMBER
14
OF 21

Date: 10/31/2025

Username: dguzzi

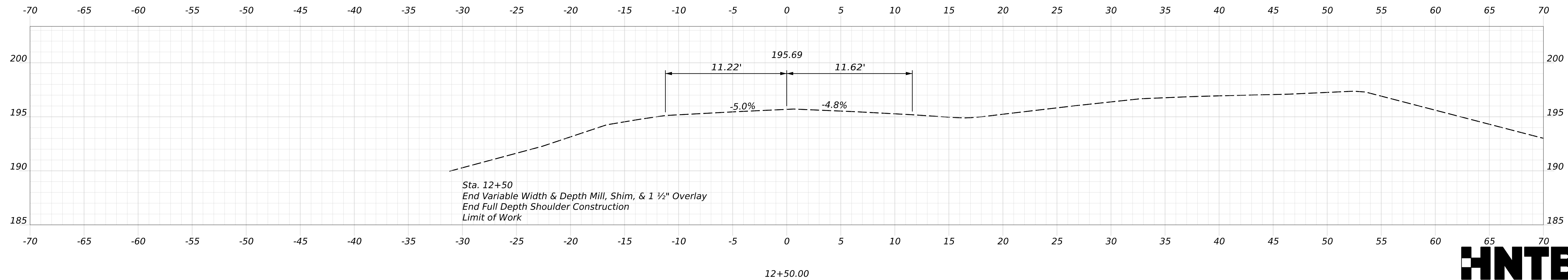

STATE OF MAINE
DEPARTMENT OF TRANSPORTATION
Federal Project No. 2615600

SIGNATURE
P.E. NUMBER
DATE

PROJ. MANAGER	TREVOR GLEASON	BY	DATE
DESIGN-DETAILED	E. Raymond	E. Raymond	10/2025
CHECKED-REVIEWED	E. Davidson	J. O'Neil	10/2025
DESIGN-DETAILED02			
DESIGN-DETAILED03			
REVISIONS 1			
REVISIONS 2			
REVISIONS 3			
REVISIONS 4			
FIELD CHANGES			

BAILEY FLAT BRIDGE BRIDGE NO. 3671
CROSSING MUD MILLS STREAM
MONMOUTH
CROSS SECTIONS

SHEET NUMBER
15
OF 21

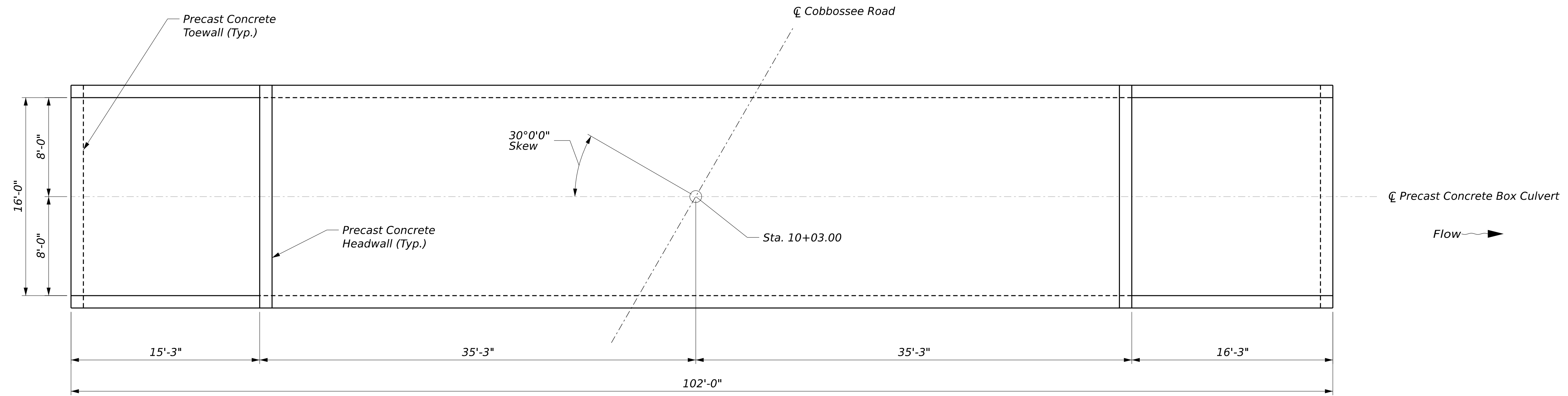
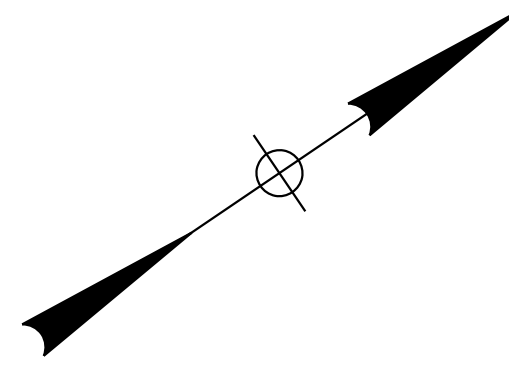

PRECAST CONCRETE BOX CULVERT PLAN

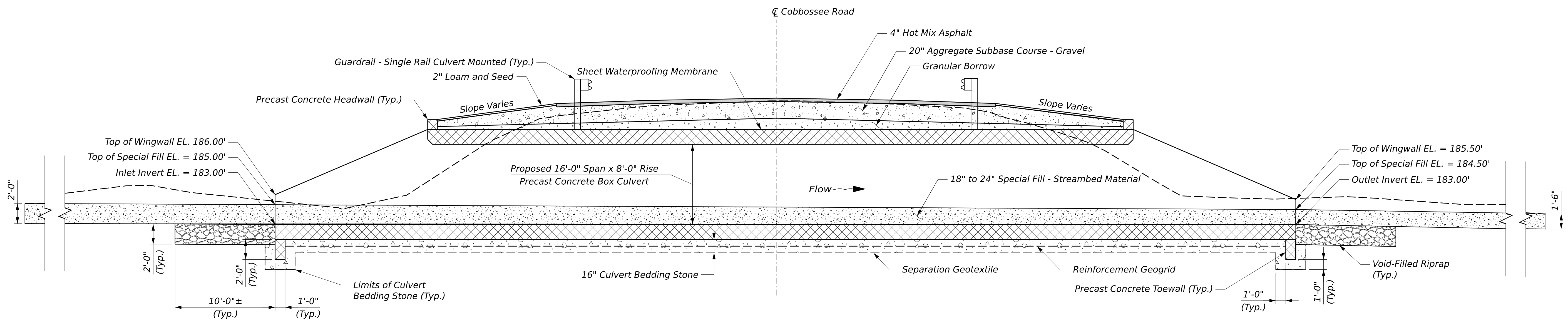

LONGITUDINAL SECTION ALONG STREAM CENTERLINE

STATE OF MAINE
DEPARTMENT OF TRANSPORTATION
Federal Project No. 2615600

WIN 026156.00

PROJ. MANAGER	Trevor Gleason	DATE	10/2025
DESIGN-DETAILED	D. Guzzi	CHECKED-REVIEWED	E. Bausakal
CHECKED-REVIEWED	T. Pulin	DESIGN-DETAILED	J. Oland
DESIGN-DETAILED		REVISIONS 1	
REVISIONS 1		REVISIONS 2	
REVISIONS 2		REVISIONS 3	
REVISIONS 3		REVISIONS 4	
REVISIONS 4		FIELD CHANGES	

SIGNATURE	P.E. NUMBER	DATE

BAILEY FLAT BRIDGE BRIDGE NO. 3671
CROSSING MUD MILLS STREAM
MONMOUTH
PRECAST CONCRETE
BOX CULVERT DETAILS I

SHEET NUMBER

16

OF 21



Date: 10/31/2025

Username: dguzzi

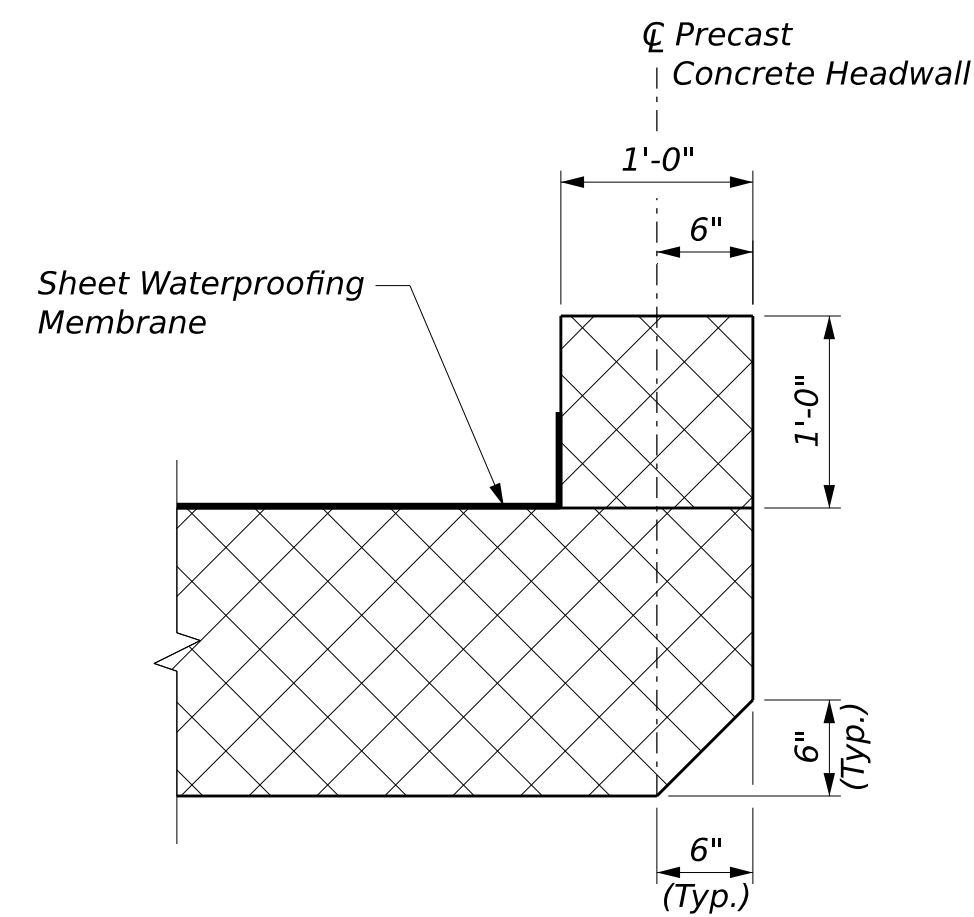

PRECAST CONCRETE HEADWALL DETAIL

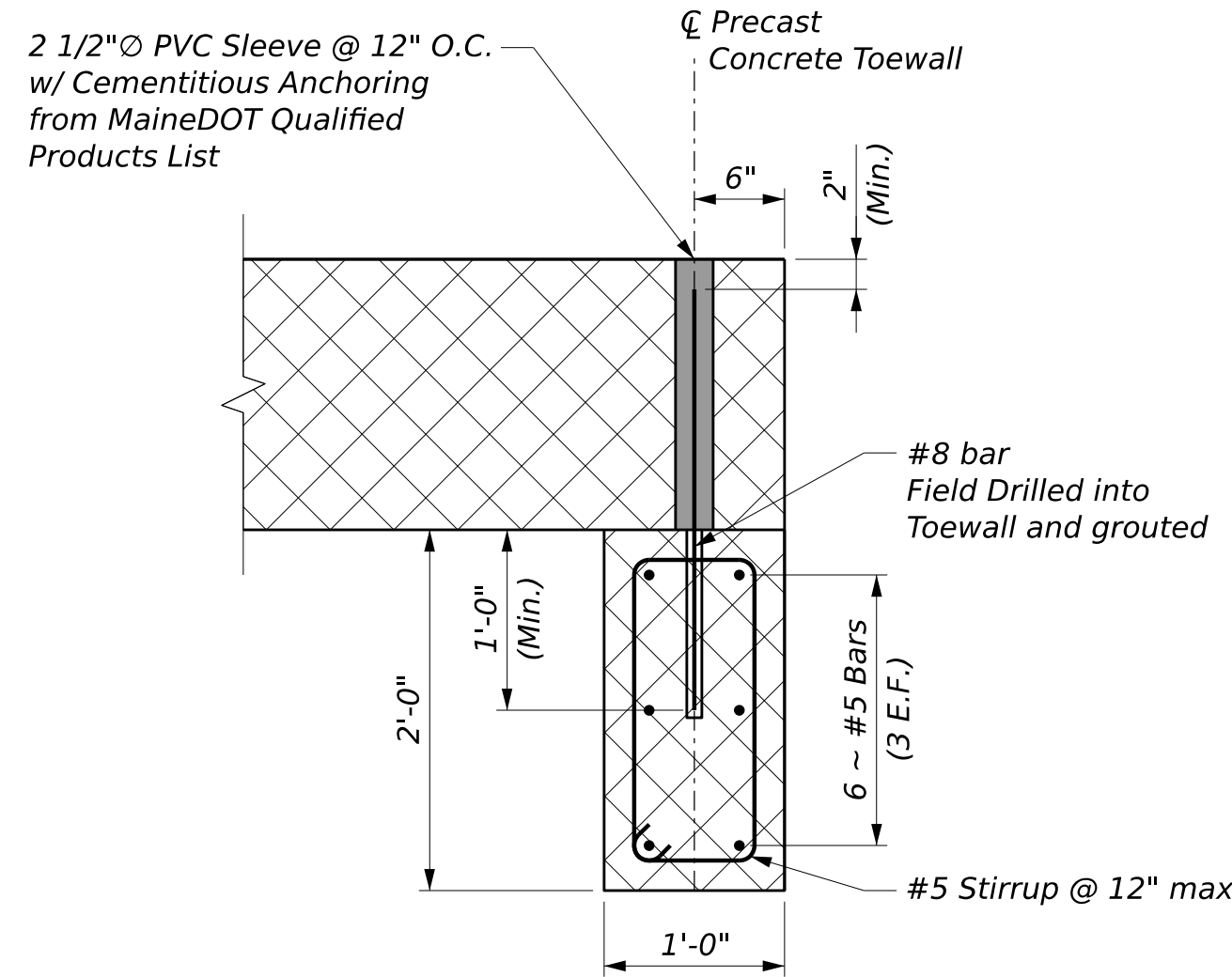

PRECAST CONCRETE TOEWALL DETAIL

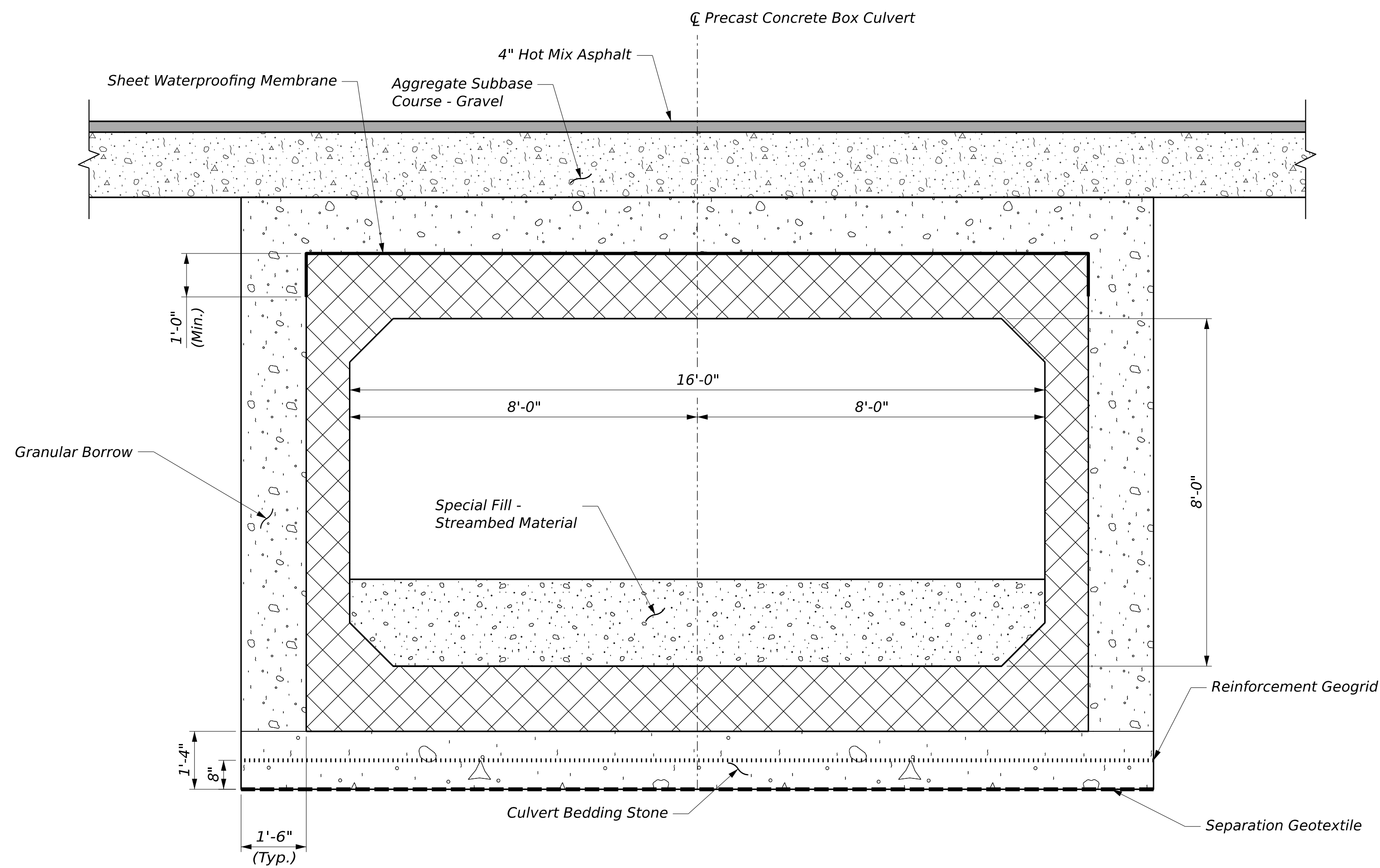

TYPICAL PRECAST CONCRETE BOX TRANSVERSE SECTION

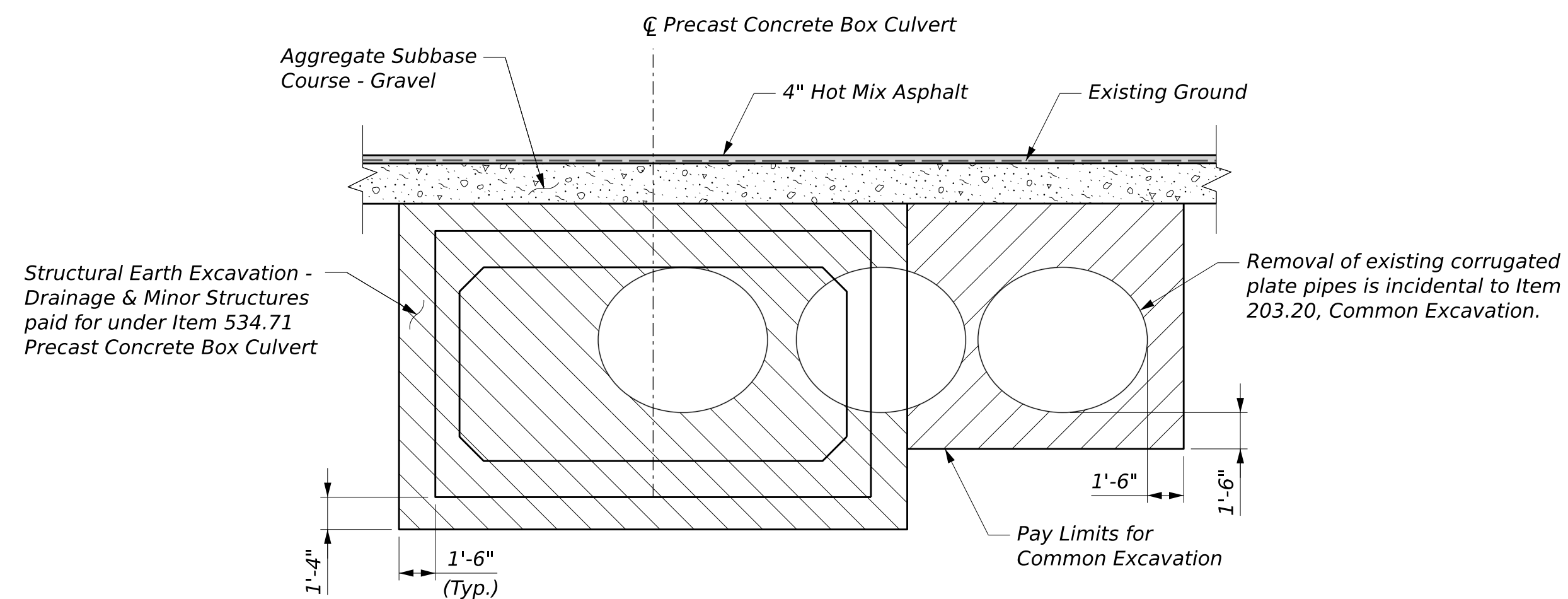

EXCAVATION PAY LIMITS

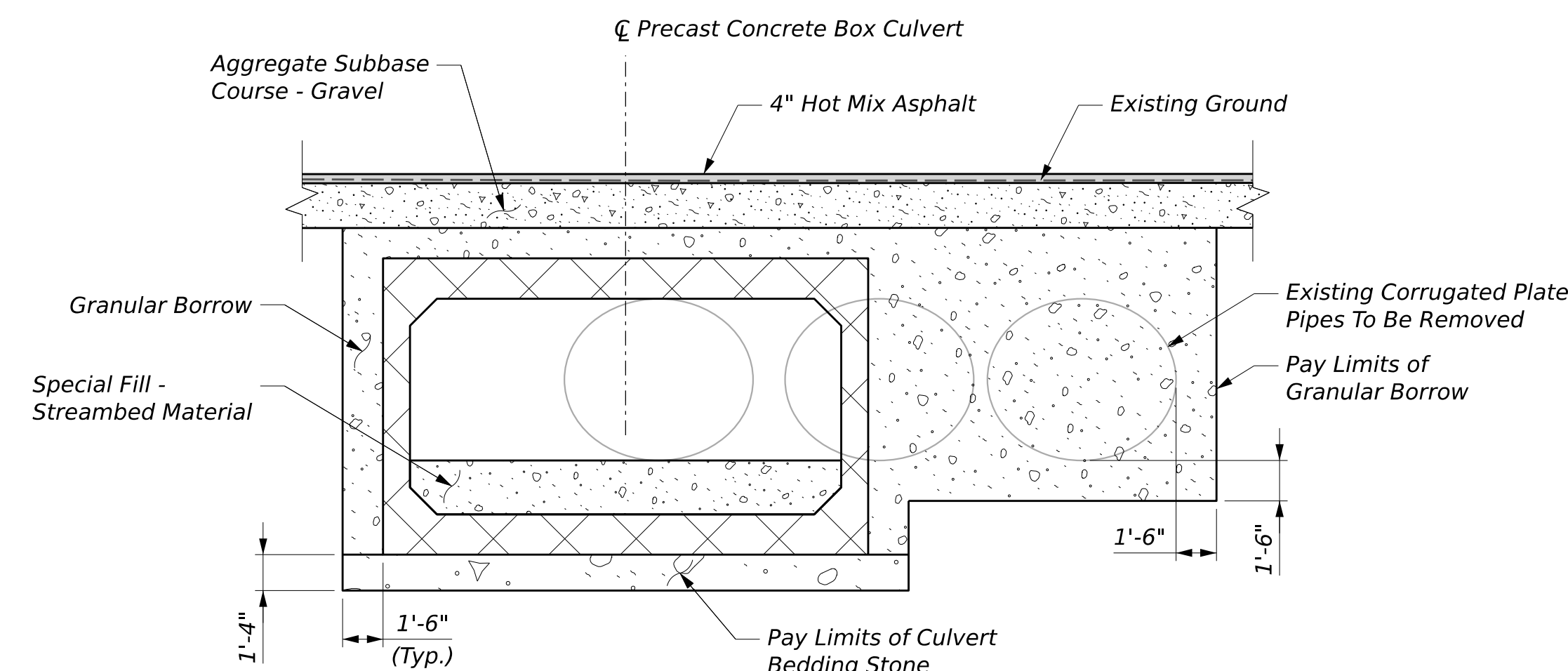

BACKFILL PAY LIMITS

PRECAST CONCRETE BOX CULVERT NOTES

- In accordance with Standard Specifications Subsection 534.04, Precast Structural Concrete, the Contractor shall submit design calculations for the precast structure to the Department for review. The calculations shall include a demonstration that the factored bearing pressures at the Strength Limit and Service Limit States do not exceed the factored geotechnical bearing resistances provided in the project geotechnical design report.
- The native soil subgrade shall be excavated using a smooth-edged bucket to avoid disturbance of the subgrade. The Contractor shall not operate heavy equipment over the excavated subgrade to minimize subgrade disturbance. Limit vibration-induced disturbance to the saturated subgrade. If the subgrade is disturbed or weakened, the Contractor shall excavate the disturbed material and replace with compacted Granular Borrow for Underwater Backfill to the subgrade level at the Contractor's expense.
- The Separation Geotextile shall be hand-deployed onto the prepared native soil subgrade prior to installing the Culvert Bedding Stone. Adjoining sections of the geotextile shall be overlapped by a minimum of 2 feet. The Culvert Bedding Stone shall be placed in maximum 6-inch-thick lifts and each lift compacted with several passes of a walk-behind roller or large plate compactor.
- Sheet Waterproofing Membrane shall extend a minimum of 6" up the backface of the headwalls.

STATE OF MAINE
DEPARTMENT OF TRANSPORTATION
Federal Project No. 2615600
WIN 026156.00

PROJ. MANAGER	BY	DATE	SIGNATURE	P.E. NUMBER	DATE
Trevor Gleason	E. Bauschell	10/2025			
D. Guzzi	T. Pavin	10/2025			
CHECKED-REVIEWED					
DESIGN-DETAILS					
REVISIONS 1					
REVISIONS 2					
REVISIONS 3					
REVISIONS 4					
FIELD CHANGES					

BAILEY FLAT BRIDGE BRIDGE NO. 3671
CROSSING MUD MILLS STREAM
MONMOUTH
PRECAST CONCRETE BOX
CULVERT DETAILS II

SHEET NUMBER
17
OF 21



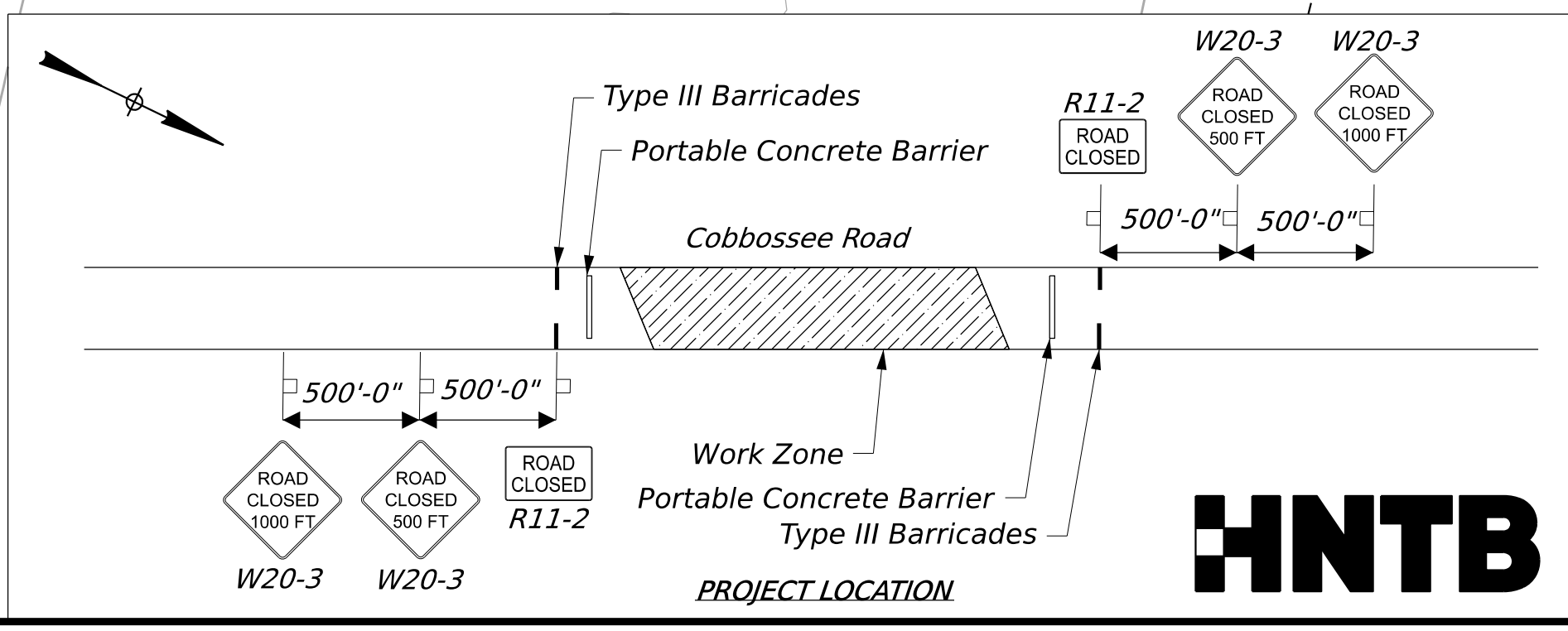
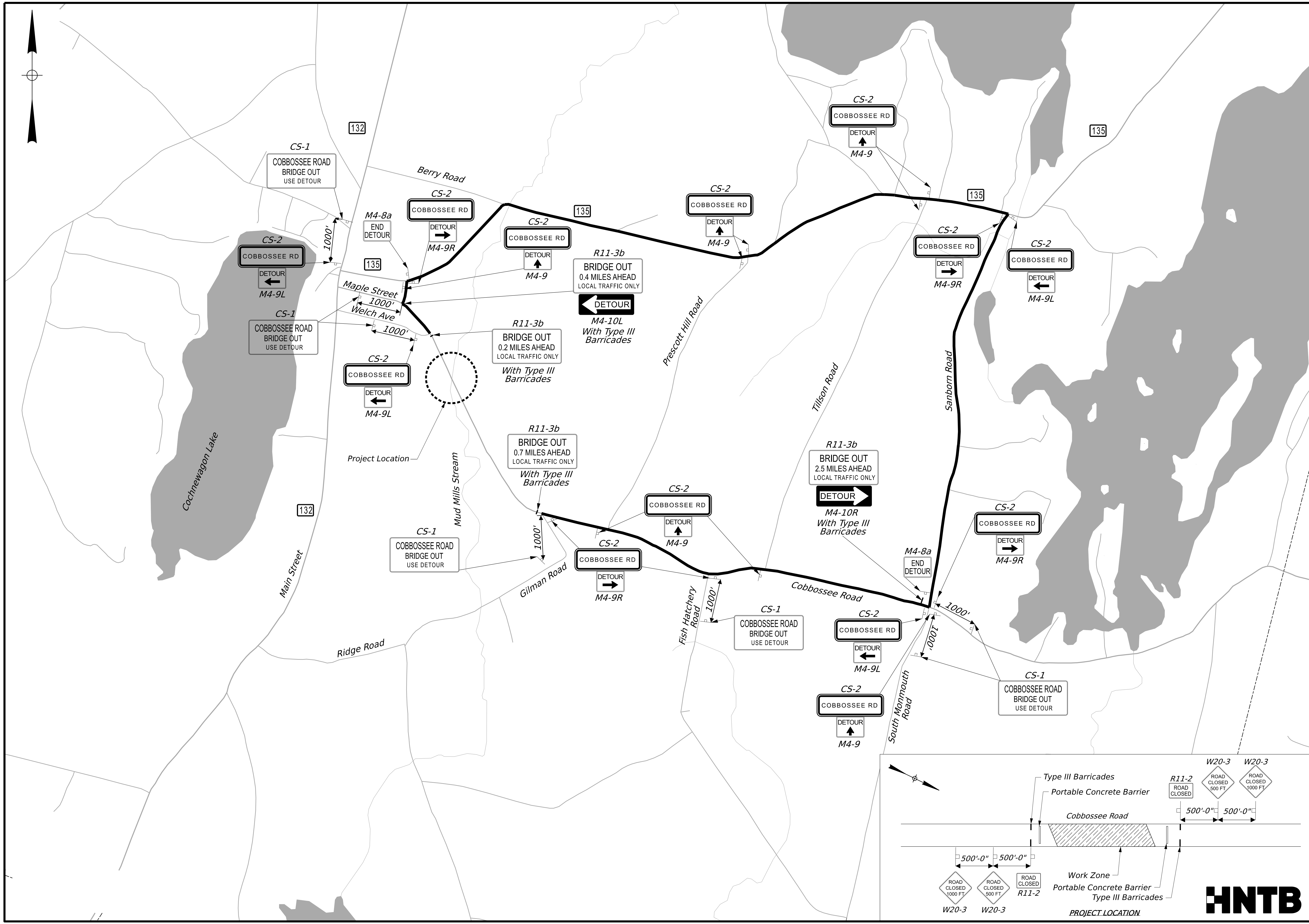
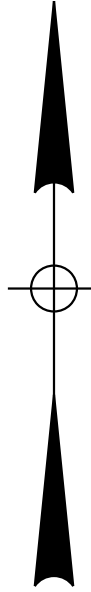

Username: dguzzi Date: 10/31/2025

STATE OF MAINE DEPARTMENT OF TRANSPORTATION		Federal Project No. 2615600		WIN 026156.00																																																	
BAILEY FLAT BRIDGE NO. 3671 CROSSING MUD MILLS STREAM MONMOUTH		DETOUR PLAN		SHEET NUMBER																																																	
19		OF		21																																																	
<table border="1" style="width: 100%; border-collapse: collapse;"> <thead> <tr> <th>PROJ. MANAGER</th> <th>DATE</th> <th>BY</th> <th>DATE</th> </tr> </thead> <tbody> <tr> <td>Trevor Gleason</td> <td>10/2025</td> <td>C. Tobin</td> <td>10/2025</td> </tr> <tr> <td>CHECKED-REVIEWED</td> <td>E. Davidson</td> <td>J. Oland</td> <td>10/2025</td> </tr> <tr> <td>DESIGNED-DETAILED</td> <td></td> <td></td> <td></td> </tr> <tr> <td>REVISIONS 1</td> <td></td> <td></td> <td></td> </tr> <tr> <td>REVISIONS 2</td> <td></td> <td></td> <td></td> </tr> <tr> <td>REVISIONS 3</td> <td></td> <td></td> <td></td> </tr> <tr> <td>REVISIONS 4</td> <td></td> <td></td> <td></td> </tr> <tr> <td>FIELD CHANGES</td> <td></td> <td></td> <td></td> </tr> </tbody> </table>		PROJ. MANAGER	DATE	BY	DATE	Trevor Gleason	10/2025	C. Tobin	10/2025	CHECKED-REVIEWED	E. Davidson	J. Oland	10/2025	DESIGNED-DETAILED				REVISIONS 1				REVISIONS 2				REVISIONS 3				REVISIONS 4				FIELD CHANGES				<table border="1" style="width: 100%; border-collapse: collapse;"> <thead> <tr> <th>SIGNATURE</th> <th>P.E. NUMBER</th> <th>DATE</th> </tr> </thead> <tbody> <tr> <td> </td> <td> </td> <td> </td> </tr> </tbody> </table>		SIGNATURE	P.E. NUMBER	DATE				<table border="1" style="width: 100%; border-collapse: collapse;"> <thead> <tr> <th>SIGNATURE</th> <th>P.E. NUMBER</th> <th>DATE</th> </tr> </thead> <tbody> <tr> <td> </td> <td> </td> <td> </td> </tr> </tbody> </table>		SIGNATURE	P.E. NUMBER	DATE			
PROJ. MANAGER	DATE	BY	DATE																																																		
Trevor Gleason	10/2025	C. Tobin	10/2025																																																		
CHECKED-REVIEWED	E. Davidson	J. Oland	10/2025																																																		
DESIGNED-DETAILED																																																					
REVISIONS 1																																																					
REVISIONS 2																																																					
REVISIONS 3																																																					
REVISIONS 4																																																					
FIELD CHANGES																																																					
SIGNATURE	P.E. NUMBER	DATE																																																			
SIGNATURE	P.E. NUMBER	DATE																																																			

IDENTIFICATION NUMBER	SIZE OF SIGN		TEXT	TEXT DIMENSIONS (INCHES)			NUMBER OF SIGNS REQUIRED	COLOR		TOTAL AREA IN SQUARE FEET
	WIDTH	HEIGHT		LETTER HEIGHT	VERTICAL SPACING	ARROW RTE. MKR.		BACK-GROUND	LEGEND BORDER	
CS-1	48"	24"		4"C 4"C 4"C	3" 3"		7	ORANGE	BLACK	8.00 (56.00)
CS-2	42"	12"		4"C			17	ORANGE	BLACK	3.50 (59.50)
M4-8a	24"	18"		TEXT DIMENSIONS SHALL CONFORM TO "STANDARD HIGHWAY SIGNS"			2	ORANGE	BLACK	3.00 (6.00)
M4-9	30"	24"					8	ORANGE	BLACK	5.00 (40.00)
M4-9L	30"	24"					4	ORANGE	BLACK	5.00 (20.00)
M4-9R	30"	24"					5	ORANGE	BLACK	5.00 (25.00)
M4-10L	48"	18"					1	ORANGE	BLACK	6.00 (6.00)
M4-10R	48"	18"					1	ORANGE	BLACK	6.00 (6.00)

Notes:

1. Sign locations are approximate and to be verified in the field by the Contractor and approved by the Resident.

2. Information shown reflects signage for detour plans only. Additional signage may be necessary for other maintenance of traffic activities. See 652 SP for additional information.

IDENTIFICATION NUMBER	SIZE OF SIGN		TEXT	TEXT DIMENSIONS (INCHES)			NUMBER OF SIGNS REQUIRED	COLOR		TOTAL AREA IN SQUARE FEET
	WIDTH	HEIGHT		LETTER HEIGHT	VERTICAL SPACING	ARROW RTE. MKR.		BACK-GROUND	LEGEND BORDER	
R11-2	48"	30"		TEXT DIMENSIONS SHALL CONFORM TO "STANDARD HIGHWAY SIGNS"			2	ORANGE	BLACK	10.00 (20.00)
R11-3b (0.2) (0.4) (0.7) (2.5)	60"	30"					1 1 1 1	ORANGE	BLACK	12.50 (12.50) (12.50) (12.50)
W20-3 (500 FT) (1000 FT)	48"	48"					2 2	ORANGE	BLACK	16.00 (32.00) (32.00)

STATE OF MAINE
DEPARTMENT OF TRANSPORTATION
Federal Project No. 2615600
WIN 026156.00

PROJ. MANAGER
DESIGN-DETAILED
CHECKED-REVIEWED
DESIGN-DETAILED02
REVISIONS 1
REVISIONS 2
REVISIONS 3
REVISIONS 4
FIELD CHANGES

BY
Trevor Gleason
C. Tobin
E. Dowdon
J. Oland

DATE
10/20/25
10/20/25

SIGNATURE
P.E. NUMBER
DATE

BAILEY FLAT BRIDGE BRIDGE NO. 3671
CROSSING MUD MILLS STREAM
MONMOUTH

SIGN SUMMARY

SHEET NUMBER

20

OF 21



PLAN LEGEND

Town, County, State _____	New R/W Along Existing R/W _____	Existing _____	Proposed _____	Existing _____	Proposed _____	Existing _____	Proposed _____
Approx. Property Lines _____	Building _____ Clearing Limit Line - CLL _____	Sanitary Sewer _____	SA _____	Traveled Way _____	_____	Cut Line _____	Fill Line _____
Existing Right of Way _____	Trees Conifer _____ Deciduous _____	Com. Line UG _____	UG COMM _____	Ditch _____	_____	Stonewall _____	Retaining Wall _____
Limits of Wrought Portion LIMITS OF WROUGHT PORTION	Tree Line _____ Bush Line _____	Electric Line _____	UG POW _____	Catch Basin _____	_____	Baseline _____	_____
Control Of Access _____	Water Edge _____	Water Line _____	WL _____	Manhole _____	_____	_____	_____
New Right of Way _____	Ledge _____ Rock/Boulder _____ Flag Pole _____	Underdrain Line _____	_____	Sewer Manhole _____	_____	_____	_____
New Easement _____	Fence Chain Link _____ Barb Wire _____ Stockade _____	Gas Line _____	GAS _____	Utility Pole _____	_____	Monument _____	Traverse Point _____
New Temporary Rights TEMP. CONST. LIMITS	Sign _____ Well _____ Mailbox _____	Guardrail _____	_____	Fire Hydrant _____	_____	Iron Rod Set _____	Pipe Found _____
New R/W Within Existing R/W _____		Culvert _____	_____	Curbing _____	_____		

THIS PLAN WAS PREPARED IN CONNECTION WITH THE DEPARTMENT'S ACQUISITION OF REAL PROPERTY FOR TRANSPORTATION PURPOSES. IT CANNOT BE USED TO ESTABLISH LEGAL BOUNDARIES BETWEEN ADJUTING PROPERTY OWNERS.

STATE OF MAINE
REGISTRY OF DEEDS
COUNTY OF _____
RECEIVED _____, 20____
AT _____ HRS. _____ MINS. _____ M.
AND RECORDED IN _____
PLAN BOOK (OR FILE NO.) _____, PAGE _____
ATTEST: _____
REGISTER

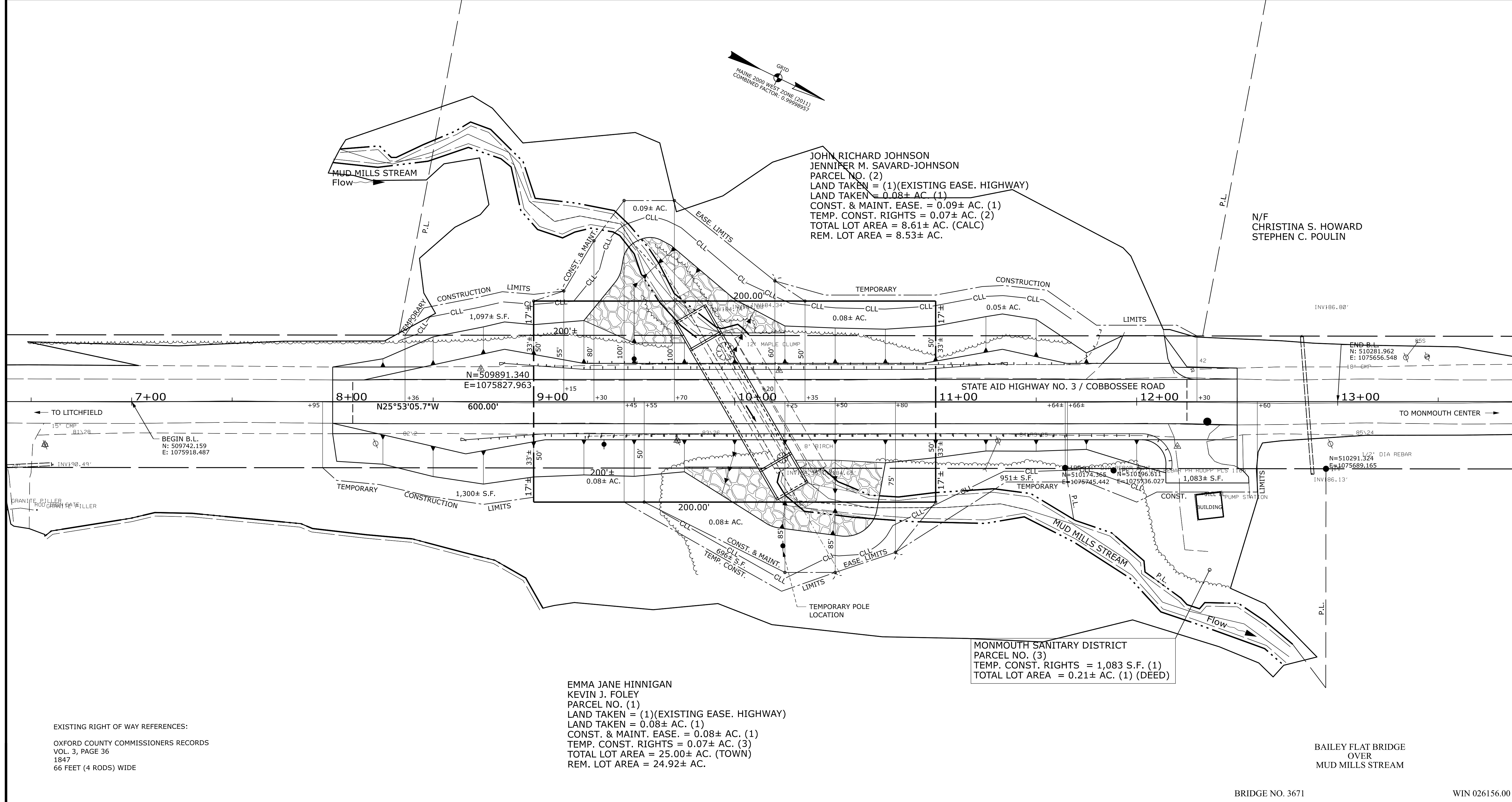
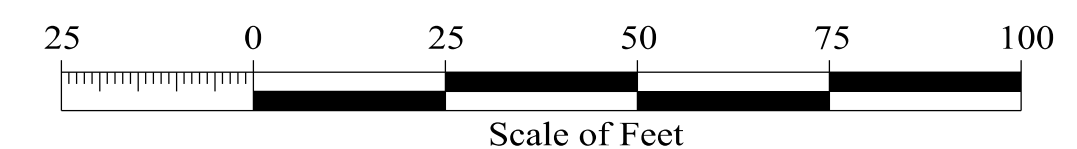

CHECKED	J.F.	VHB	K.D.M.
TECH	K.D.M.	VHB	VHB
ITEM	EXISTING CONDITION PLAN	FINAL RIGHT OF WAY	AREAS

STATE OF MAINE
DEPARTMENT OF TRANSPORTATION
16 STATE HOUSE STATION - AUGUSTA,
ME 04333-0016 - 207-624-3460
MONMOUTH
RIGHT OF WAY MAP

REVISIONS			PLAN FILED IN PLAN BOOK				COUNTY RECORD					
NO.	DATE	DESCRIPTION	NO.	GRANTOR	PAGE	INSTRUMENT	DATE	BOOK	PAGE	DATE	BOOK	PAGE

DALE F. DOUGHTY
ACTING COMMISSIONER
WILLIAM A. PULVER
CHIEF ENGINEER
DATE _____

STATE AID HIGHWAY NO. 3
COBBOSSEE ROAD
MONMOUTH KENNEBEC COUNTY
FEDERAL AID PROJECT NO. 2615600
NOVEMBER 2025 RIGHT-OF-WAY MAP
SCALE 1" = 25' SHEET 21 OF 21
D.O.T FILE NO. 6-510

SHEET NUMBER
21
OF 21

Username: jennifer.hartman Date: 11/13/2025