

STATE OF MAINE DEPARTMENT OF TRANSPORTATION



ST. GEORGE KNOX COUNTY SEAL HARBOR BRIDGE ROUTE 73 BRIDGE NO. 6679 STATE PROJECT NO. 25515.00 PROJECT LENGTH: 0.05 MILES

Description	Sheet No.
Title Sheet	1
General Notes, Typical Section, and Estimated Quantities	2
Special Detail - Polymer Coated Steel Pipe	3
Boring Location Plan	4
Interpretive Subsurface Profile	5
Boring Logs	6
Plan/Profile	7
Detour Plan	8
Cross Sections	9-17
Right of Way Map	18

PLAN LEGEND	
Town, County, State	_____
Property Lines	-----
R/W Lines-Existing	-----
R/W Lines-Proposed	-----
Culvert-Existing	-----
Culvert Proposed	-----
Curbing Existing	-----
Curbing Proposed	-----
Type 1	-----
Type 3	-----
Type 5	-----
Outline of Bodies of Water	-----
Exposed Bedrock	-----
Buildings	-----
Trees Conifer	-----
Trees Deciduous	-----
Tree Line	-----
Clearing Limit Line	-----
Railroad	-----
Catch Basins Existing	▣
Catch Basins Proposed	■
Manholes Existing	○
Manholes Proposed	●
Proposed Underdrain	-----
Proposed Ditch	-----
Existing Ditch	-----
Utility Poles Existing	◇
Utility Poles Proposed	◆
Fire Hydrants Existing	⊙
Fire Hydrants Proposed	⊕
Existing Water Line	-----
Existing San. Sewer	-----
Existing San. Sewer Manhole	⊙
Guardrail-Existing	-----
Guardrail-Proposed	-----
Guardrail-Cable, Other	-----
Centerline-Existing	-----
Centerline-Proposed	-----
Travelway-Existing	-----
Travelway-Proposed	-----
Boring	⊕ HB-XXX-###
Pavement Core	● PC-#
Test Pit	▣ TP-XXX-###
Probe	⊕ P-#. #X
	## = Depth
	X = W (Weathered Rock)
	R (Refusal)
	NR (No Refusal)

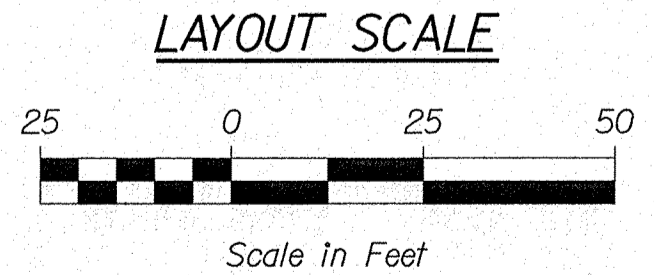
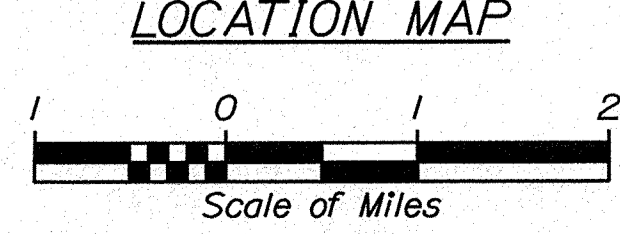
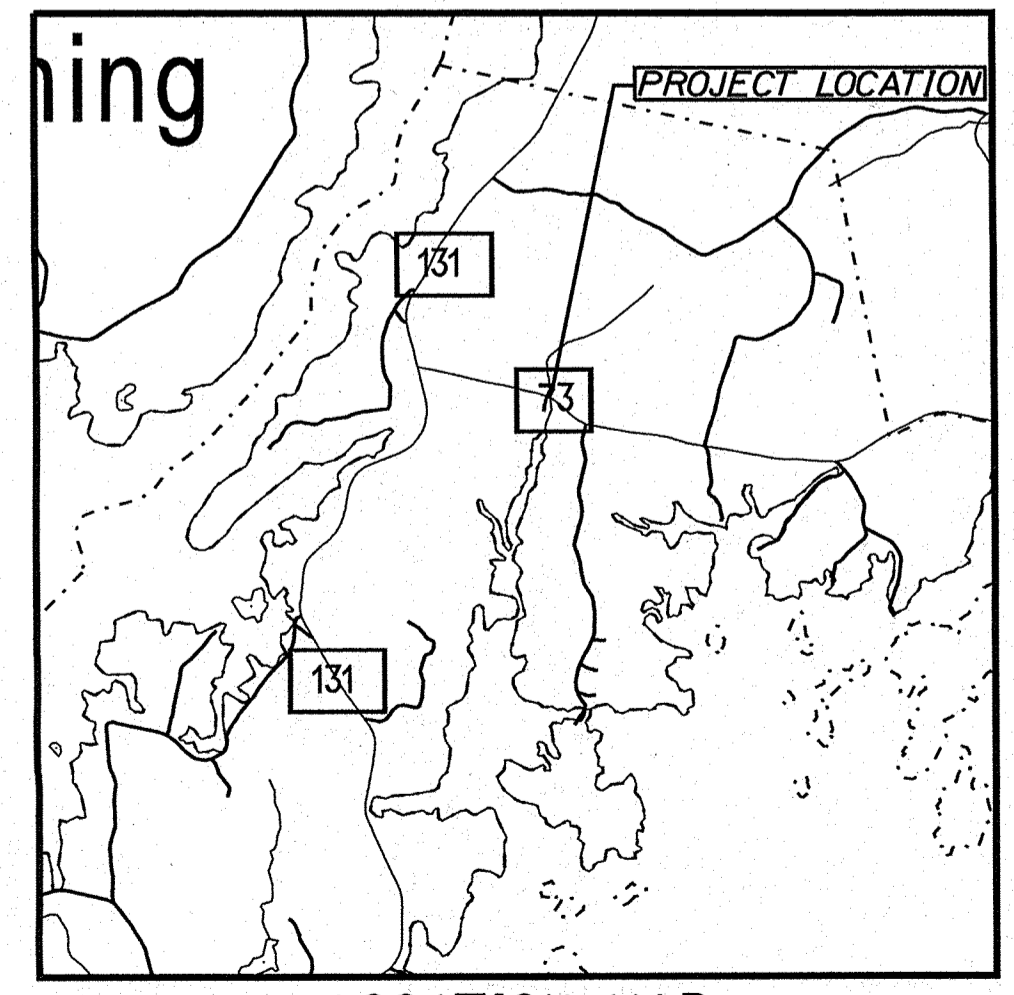
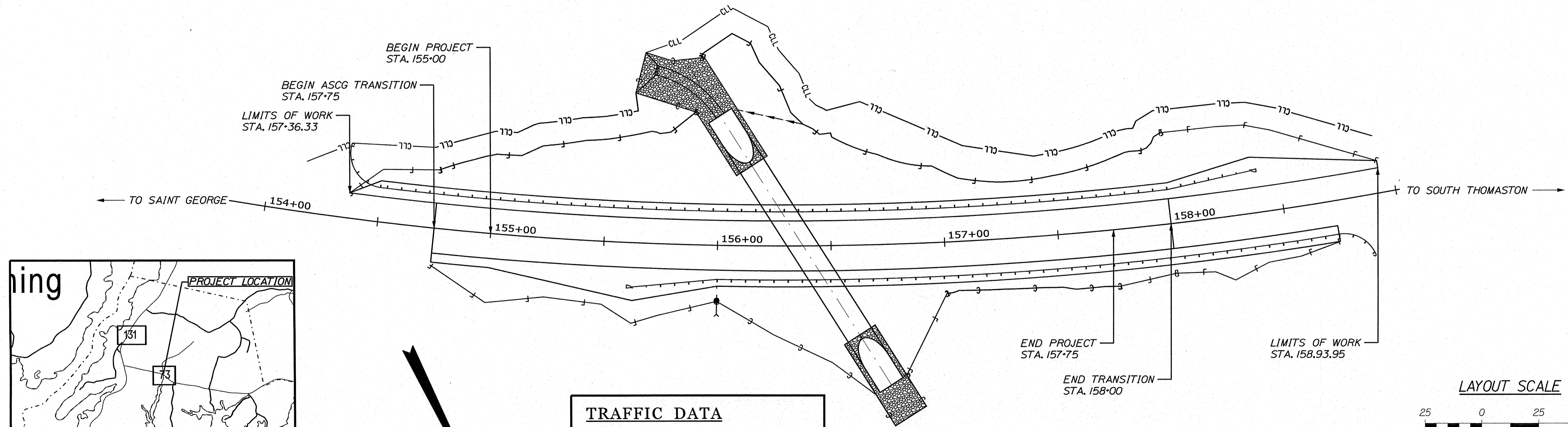

TRAFFIC DATA	
Current (2023) AADT	1240
Future (2035) AADT	1320
DHV - % of AADT	12%
Design Hour Volume	158
% Heavy Trucks (AADT)	6%
% Heavy Trucks (DHV)	4%
Directional Distribution (DHV)	59%
18-kip Equivalent P 2.0	16
18-kip Equivalent P 2.5	16
Design Speed (mph)	50
Corridor Priority	3

PROJECT LOCATION:	LARGE CULVERT #46906 ON RTE. 73 IN ST. GEORGE 0.3 MILES WEST OF CLARK ISLAND ROAD
PROGRAM AREA:	REGIONAL PROGRAM
SCOPE OF WORK:	LARGE CULVERT REPLACEMENT

STATE OF MAINE DEPARTMENT OF TRANSPORTATION	APPROVED	DATE
COMMISSIONER: <i>[Signature]</i>	<i>[Signature]</i>	2-24-23
CHIEF ENGINEER: <i>[Signature]</i>	<i>[Signature]</i>	2-22-23

STATE OF MAINE DEPARTMENT OF TRANSPORTATION	DATE
SIGNATURE: <i>[Signature]</i>	1/3/23
P.E. NUMBER: 13557	
DATE: 1/19/23	

PROJECT INFORMATION	
PROGRAM	HIGHWAY
PROJECT MANAGER	D. COOMBS
DESIGNER	J. BANES
CONSULTANT	
PROJECT RESIDENT	
CONTRACTOR	
PROJECT COMPLETION DATE	

STATE PROJECT NO. 25515.00

ST GEORGE
ROUTE 73
TITLE SHEET

SHEET NUMBER
1
OF 18

GENERAL NOTES

- PAVEMENT THICKNESSES SHOWN ON THE TYPICAL SECTIONS ARE INTENDED TO BE NOMINAL.
- CLEARING LIMITS SHALL BE 10 FEET BEYOND AND PARALLEL TO THE CONSTRUCTION SLOPE LINES OR AS SHOWN ON THE PLANS UNLESS OTHERWISE AUTHORIZED BY THE RESIDENT.
- ALL CLEARING SHALL BE CONSIDERED INCIDENTAL TO THE CONTRACT AND NO SEPARATE PAYMENT WILL BE MADE. THE ACTUAL LINES FOR CLEARING SHALL BE ESTABLISHED IN THE FIELD BY THE CONTRACTOR AS INDICATED ON THE PLANS AND APPROVED BY THE RESIDENT.
- GRUBBING IN FILL AREAS HAS BEEN SHOWN ON THE CROSS SECTIONS AND THE QUANTITIES NOTED. THESE LIMITS ARE APPROXIMATE AND HAVE BEEN USED FOR ESTIMATING PURPOSES ONLY. ACTUAL GRUBBING LIMITS MAY VARY BASED ON FIELD CONDITIONS AS DIRECTED BY THE RESIDENT.
- ALL WASTE MATERIAL NOT USED ON THE PROJECT SHALL BE DISPOSED OF OFF THE PROJECT IN ACCEPTABLE WASTE AREAS REVIEWED BY THE RESIDENT. GRADING, SEEDING AND MULCHING OF WASTE AREAS SHALL BE CONSIDERED INCIDENTAL.
- GRANULAR BORROW USED TO BACKFILL MUCK EXCAVATION OR IN LOW WET AREAS TO 1 FOOT ABOVE WATER LEVEL OR OLD GROUND SHALL MEET REQUIREMENTS FOR GRANULAR BORROW MATERIAL FOR UNDERWATER BACKFILL AS SPECIFIED IN STANDARD SPECIFICATION 703.19.
- EXISTING INSLOPES IN PROPOSED FILL AREAS SHALL BE BENCHED BY EXCAVATING STEPS OF SUFFICIENT WIDTH TO PERMIT PLACING AND COMPACTING THE FILL MATERIAL ALONG WITH THE MATERIAL REMOVED.
- WHEN SUPER ELEVATION EXCEEDS THE SLOPE OF THE LOW SIDE SHOULDER, THE LOW SIDE SHOULDER WILL HAVE SAME SLOPE AS THE TRAVELWAY.
- CROSS SLOPES FOR NORMAL AND SUPERELEVATED SECTIONS WILL BE STRAIGHT UNLESS OTHERWISE DIRECTED BY THE DEPARTMENT.
- THE ALGEBRAIC DIFFERENCE BETWEEN TRAVELWAY AND SHOULDER CROSS SLOPE SHALL NOT EXCEED 8 PERCENT.
- NO EXISTING DRAINAGE SHALL BE ABANDONED, REMOVED OR PLUGGED WITHOUT PRIOR APPROVAL OF THE RESIDENT.
- INLETS AND OUTLETS OF ALL CULVERTS SHALL BE RIPRAPPED UNLESS OTHERWISE NOTED ON THE PLANS OR DIRECTED BY THE RESIDENT.
- GUARDRAIL END TREATMENTS SHALL BE INSTALLED CONCURRENTLY WITH THE PLACEMENT OF EACH SECTION OF BEAM GUARDRAIL.
- ALL EXISTING GUARDRAIL REMOVED AND NOT REUSED ON THE PROJECT WILL BECOME PROPERTY OF THE CONTRACTOR. REMOVAL AND DISPOSAL SHALL BE CONSIDERED INCIDENTAL TO THE GUARDRAIL ITEMS.
- LOAM HAS BEEN ESTIMATED FOR DISTURBED LAWN AREAS. ACTUAL PLACEMENT OF THE LOAM SHALL BE AS NOTED ON THE PLANS OR DESIGNATED BY THE RESIDENT.
- UNLESS OTHERWISE NOTED SEEDING METHOD NO. 1 SHALL BE UTILIZED ON ALL LAWNS AND DEVELOPED AREAS; SEEDING METHOD NO. 2 SHALL BE UTILIZED ON ALL OTHER AREAS.
- ANY DAMAGE TO THE SLOPES CAUSED BY THE CONTRACTOR'S EQUIPMENT, PERSONNEL, OR OPERATION SHALL BE REPAIRED TO THE SATISFACTION OF THE RESIDENT. ALL WORK, EQUIPMENT, AND MATERIALS REQUIRED TO MAKE REPAIRS SHALL BE AT THE CONTRACTOR'S EXPENSE.
- THE PROJECT GEOTECHNICAL REPORT TITLED "GEOTECHNICAL DESIGN REPORT FOR THE CONSTRUCTION OF SEAL HARBOR BRIDGE", SOILS REPORT 2022-36, DECEMBER 21, 2022 CAN BE ACCESSED AT THE MAINE DOT WEBSITE [HTTP://WWW.MAINE.GOV/MDOT/CONTRACTORS/](http://www.maine.gov/mdot/contractors/).
- GEOTECHNICAL INFORMATION FURNISHED OR REFERRED TO IN THE BID DOCUMENTS IS FOR THE USE OF THE BIDDERS. NO ASSURANCE IS GIVEN THAT THE INFORMATION OR INTERPRETATIONS WILL BE REPRESENTATIVE OF THE ACTUAL SUBSURFACE CONDITIONS THROUGHOUT THE CONSTRUCTION SITE. MAINE DOT WILL NOT BE RESPONSIBLE FOR ANY INTERPRETATIONS OR CONCLUSION DRAWN FROM THE GEOTECHNICAL INFORMATION. THE BORING LOGS PROVIDED IN THE BID DOCUMENTS (IF ANY) PRESENT FACTUAL AND INTERPRETIVE SUBSURFACE INFORMATION COLLECTED AT DISCRETE LOCATIONS. DATA PROVIDED MAY NOT BE REPRESENTATIVE OF THE SUBSURFACE CONDITIONS BETWEEN BORING LOCATIONS.
- AREAS REQUIRING FILL ON THE PROJECT WILL COME FROM SUITABLE EXCAVATION FROM EXCAVATION, DITCH AND INSLOPE OR EQUIPMENT RENTAL AREAS.
- NO SEPARATE PAYMENT FOR SUPERINTENDENT OR FOREMAN WILL BE MADE FOR THE SUPERVISION OF EQUIPMENT AND LAYOUT OF WORK BEING PAID FOR UNDER THE EQUIPMENT RENTAL ITEMS.
- THE EXISTING CULVERT SHALL BE REMOVED AND BECOME PROPERTY OF THE CONTRACTOR. REMOVAL AND DISPOSAL OF THE EXISTING CULVERT SHALL BE CONSIDERED INCIDENTAL TO ITEM NO. 603.40781.
- FINAL STRIPING FOR THE PROJECT SHALL BE DONE BY THE CONTRACTOR PER THE STRIPING LAYOUT IN THE CONTRACT DOCUMENTS OR AS PROVIDED BY THE DEPARTMENT. PAYMENT SHALL BE MADE UNDER APPROPRIATE CONTRACT ITEMS.

ESTIMATED QUANTITIES			
ITEM NO.	DESCRIPTION	QUANTITY	UNIT
203.20	COMMON EXCAVATION	1,640	CY
203.25	GRANULAR BORROW	640	CY
203.55	CULVERT BEDDING STONE	190	CY
304.10	AGGREGATE SUBBASE COARSE GRAVEL - TYPE D	820	CY
403.208	HOT MIX ASPHALT, 12.5MM SURFACE	120	T
403.211	HOT MIX ASPHALT, SHIMMING	20	T
403.213	HOT MIX ASPHALT, 12.5MM BASE	200	T
409.15	TACK	40	G
511.07	COFFERDAM - UPSTREAM	1	LS
511.07	COFFERDAM - DOWNSTREAM	1	LS
603.40781	144" DIA. POLYMER COATED CORRUGATED STEEL PIPE - STATE SUPPLIED (140 LF)	1	LS
606.1301	31" W-BM GR, MID-WAY SPLICE - SINGLE FACED	425	LF
606.1304	31" W-BM GR, MID-WAY SPLICE - OVER 15 RAD	25	LF
606.1305	31" W-BM GR, MID-WAY SPLICE - FLARED TERMINAL REFLECTORIZED	2	EA
606.353	FLEXIBLE GUARDRAIL MARKER	8	EA
610.08	PLAIN RIPRAP	110	CY
615.10	DIRTY BORROW	100	CY
618.14	SEEDING METHOD NUMBER 2	3	UN
619.12	MULCH	3	UN
620.58	EROSION CONTROL GEOTEXTILE	160	SY
620.65	REINFORCEMENT GEOGRID	330	SY
627.733	4" WHITE OR YELLOW PAINTED PAVEMENT MARK LINE	1,300	LF
629.05	HAND LABOR, STRAIGHT TIME	40	HR
631.12	ALL PURPOSE EXCAVATOR (INCLUDING OPERATOR)	40	HR
631.172	TRUCK - LARGE (INCLUDING OPERATOR)	40	HR
631.18	CHAINSAW RENTAL (INCLUDING OPERATOR)	10	HR
639.19	FIELD OFFICE TYPE B	1	EA
652.312	BARRICADE TYPE III	6	EA
652.33	DRUM	30	EA
652.34	CONE	100	EA
652.35	CONSTRUCTION SIGNS	320	SF
652.36	MAINTAINANCE OF TRAFFIC CONTROL DEVICES	30	CD
652.38	FLAGGER	250	HR
652.41	PORTABLE CHANGEABLE MESSAGE SIGN	2	EA
656.75	TEMPORARY SOIL EROSION AND WATER POLLUTION CONTROL PLAN	1	LS
659.10	MOBILIZATION	1	LS

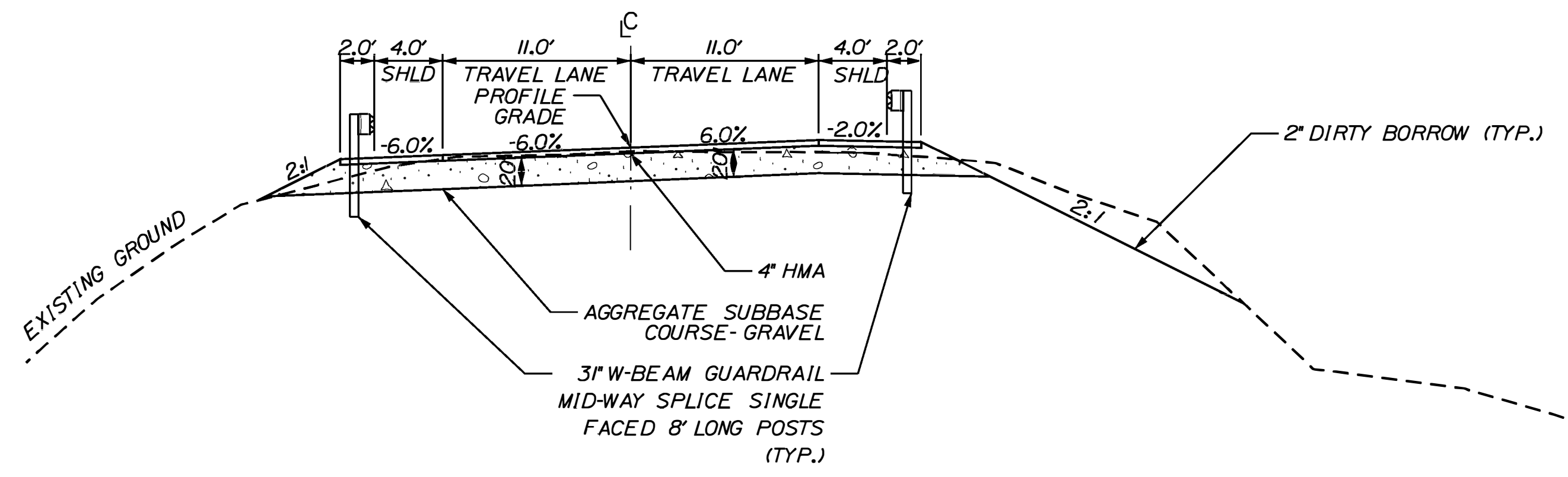

TYPICAL FULL CONSTRUCTION SECTION

STATION 155+00 TO 157+75
NOT TO SCALE

STATE OF MAINE
DEPARTMENT OF TRANSPORTATION
25515.00
WIN 25515.00
BRIDGE NO. 6679
HIGHWAY PLANS

PROJ. MANAGER
D. COOMBS
BY
J. BAINES
DATE
NOV 2022

DESIGN-DETAILED
CHECKED-REVIEWED
DESIGNS-DETAILED
DESIGNS-DETAILED
REVISIONS 1
REVISIONS 2
REVISIONS 3
REVISIONS 4
FIELD CHANGES

SIGNATURE
P.E. NUMBER
DATE

ST. GEORGE
ROUTE 73

GENERAL NOTES, TYPICAL SECTION
AND ESTIMATED QUANTITIES

SHEET NUMBER
2
OF 18

Date: 1/23/2023

Username: James.Baines

Division: HIGHWAY

Filename: ... \MSTA\003_Culvert Details.dgn

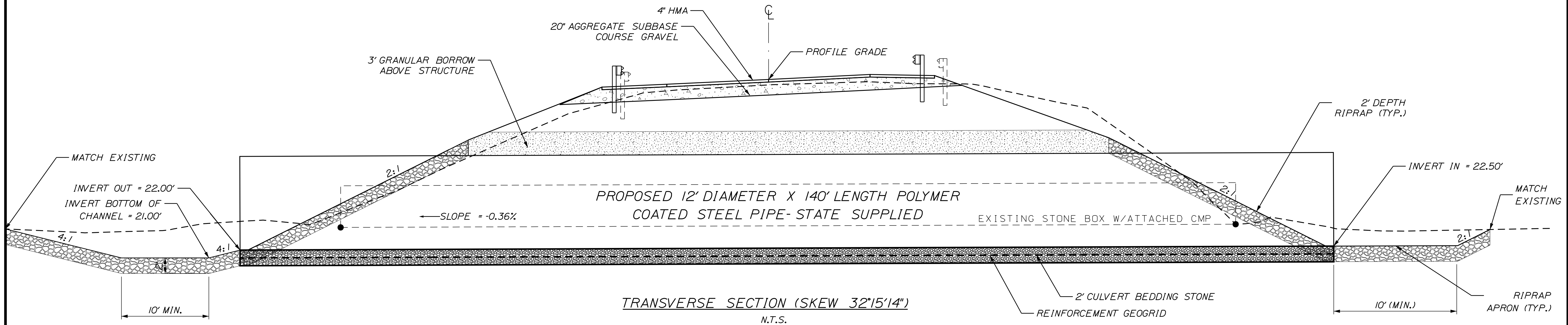
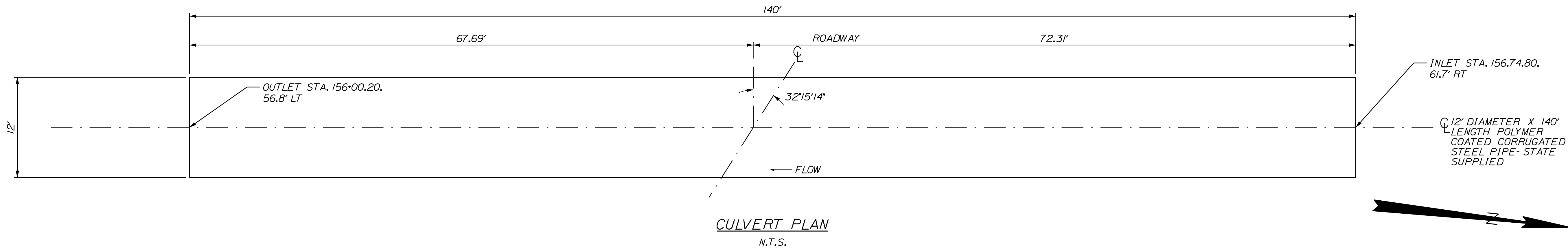

CULVERT NOTES

1. THE PIPE SHALL BE BEDDED ON A 2' THICK GEOTEXTILE WRAPPED, CULVERT BEDDING STONE WITH A LAYER OF GEOGRID AT THE CENTER. PAYMENT WILL BE MADE UNDER THE APPROPRIATE ITEM NUMBERS.
2. STABILIZATION GEOTEXTILE SHALL BE OVERLAPPED BY A MINIMUM OF 3'.
3. THE REINFORCEMENT GEOGRID SHALL MEET THE REQUIREMENTS OF SPECIAL PROVISION 620.
4. COFFERDAMS ARE TO BE PLACED AT BOTH THE DOWNSTREAM AND UPSTREAM ENDS OF THE STRUCTURE TO ALLOW WATER TO BE PUMPED AND REMOVED DURING CONSTRUCTION OF THE STEEL STRUCTURAL PLATE PIPE.
5. THE FURNISHING AND PLACING OF BACKFILL MATERIAL BETWEEN THE GRANULAR BORROW PAY LIMIT AND THE NORMAL SUBGRADE LINE WILL NOT BE PAID FOR DIRECTLY BUT SHALL BE CONSIDERED INCIDENTAL TO THE WORK. A MINIMUM OF 3.5' OF SUITABLE MATERIAL MUST BE PLACED APPROPRIATELY OVER THE PIPE BEFORE RUNNING EQUIPMENT OVER THE TOP. BACKFILL MATERIAL SHALL BE FROM SUITABLE EXCAVATION WITHIN PROJECT LIMITS, AS DIRECTED BY THE RESIDENT.
6. RIPRAP WILL BE USED TO INSLOPE AROUND THE CULVERT ENDS AT BOTH THE INLET AND OUTLET. SEE PLAN AND PROFILE FOR LOCATIONS.
7. ALL EXCAVATION AND BACKFILL FOR THE PROPOSED 12' DIAMETER X 140' LENGTH POLYMER COATED STEEL PIPE-STATE SUPPLIED SHALL BE INCIDENTAL TO ITEM 603.40781

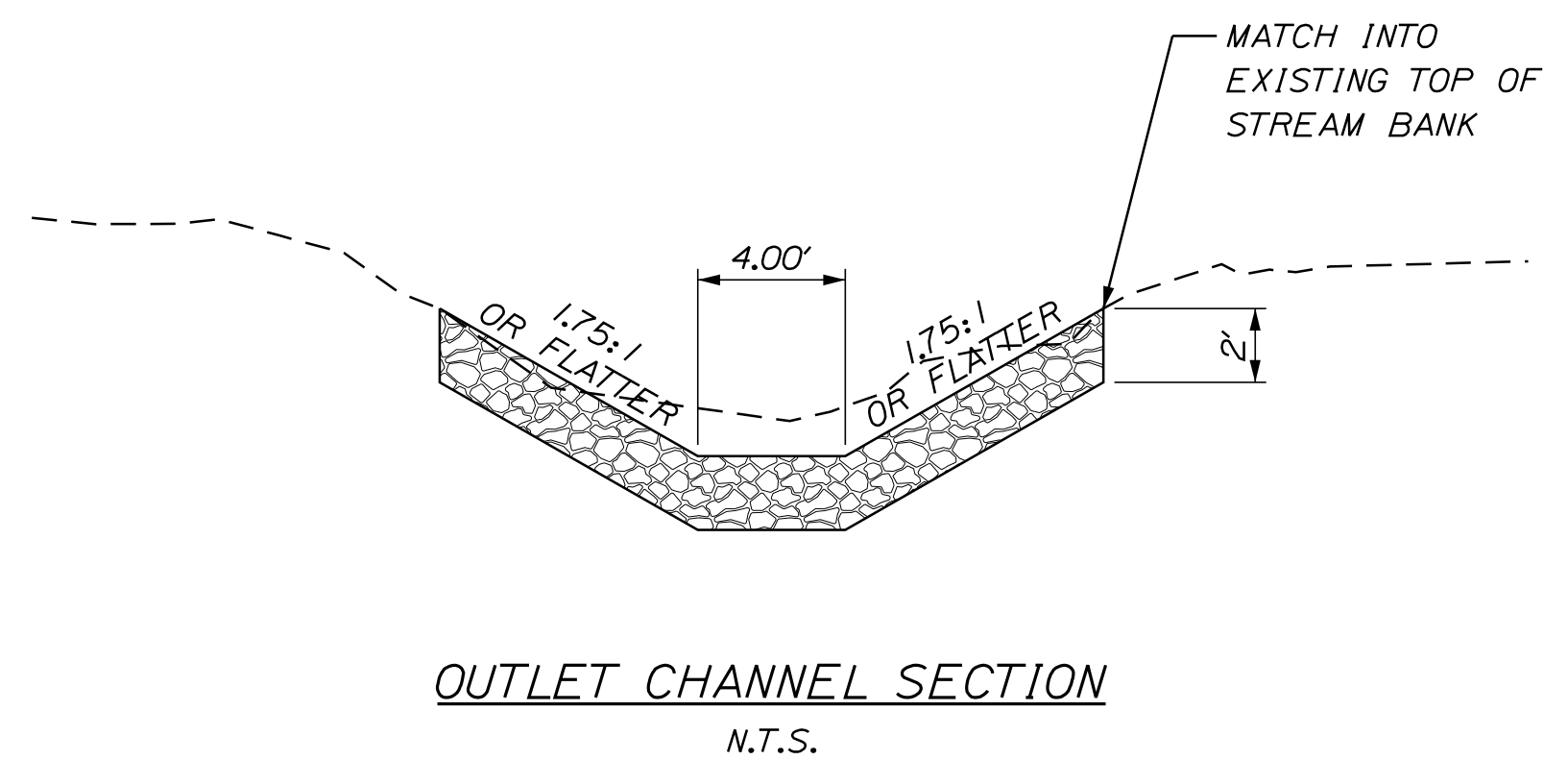
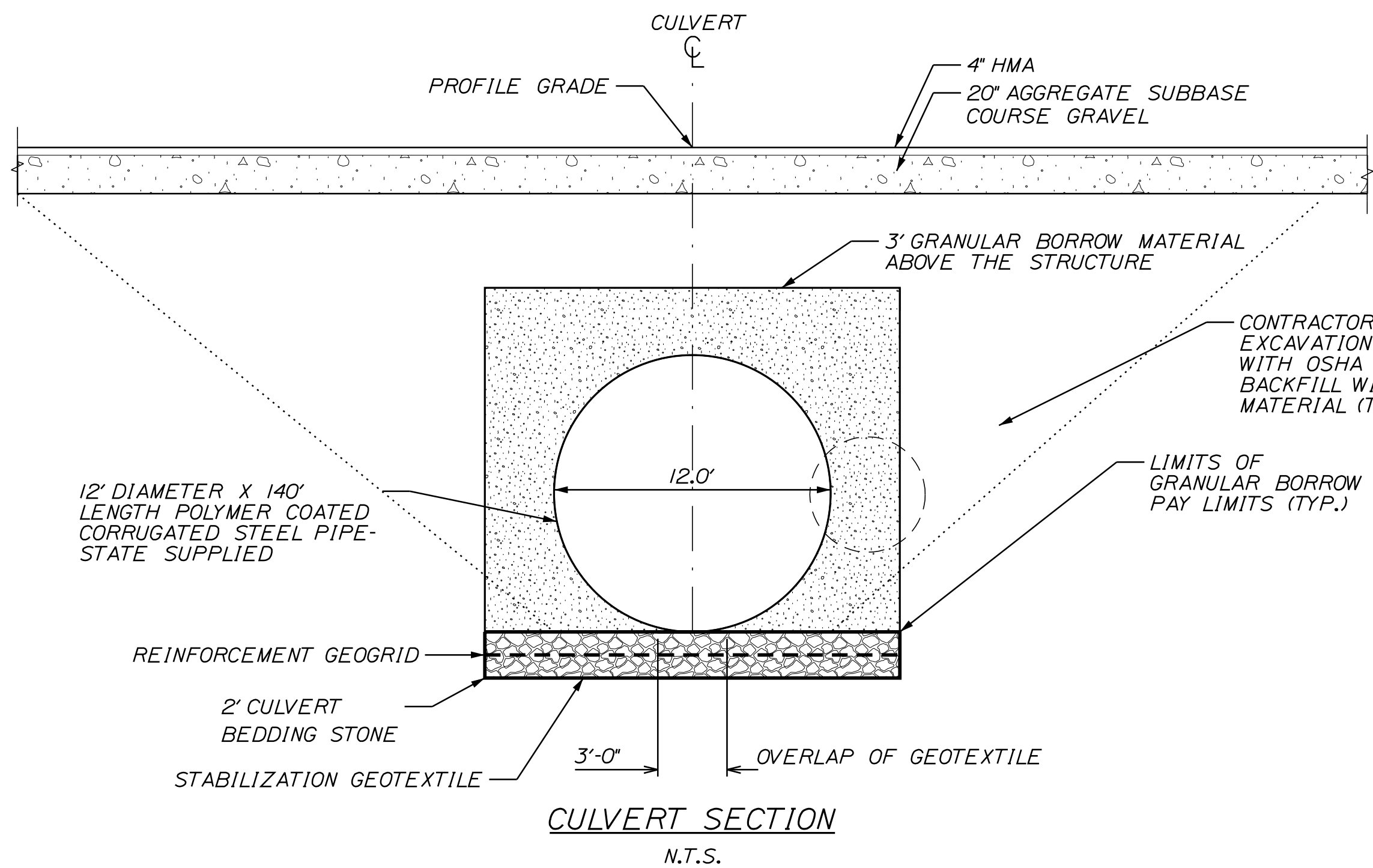

STATE OF MAINE DEPARTMENT OF TRANSPORTATION	25515.00	WIN	25515.00	HIGHWAY PLANS
		BRIDGE NO. 6679		

PROJ. MANAGER	DESIGN-DETAILED	CHECKED-REVIEWED	DATE	SIGNATURE	P.E. NUMBER	DATE
D. COOMBS	J. BAINES		NOV 2022			

ST. GEORGE
ROUTE 73
SPECIAL DETAIL-
POLYMER COATED STEEL PIPE

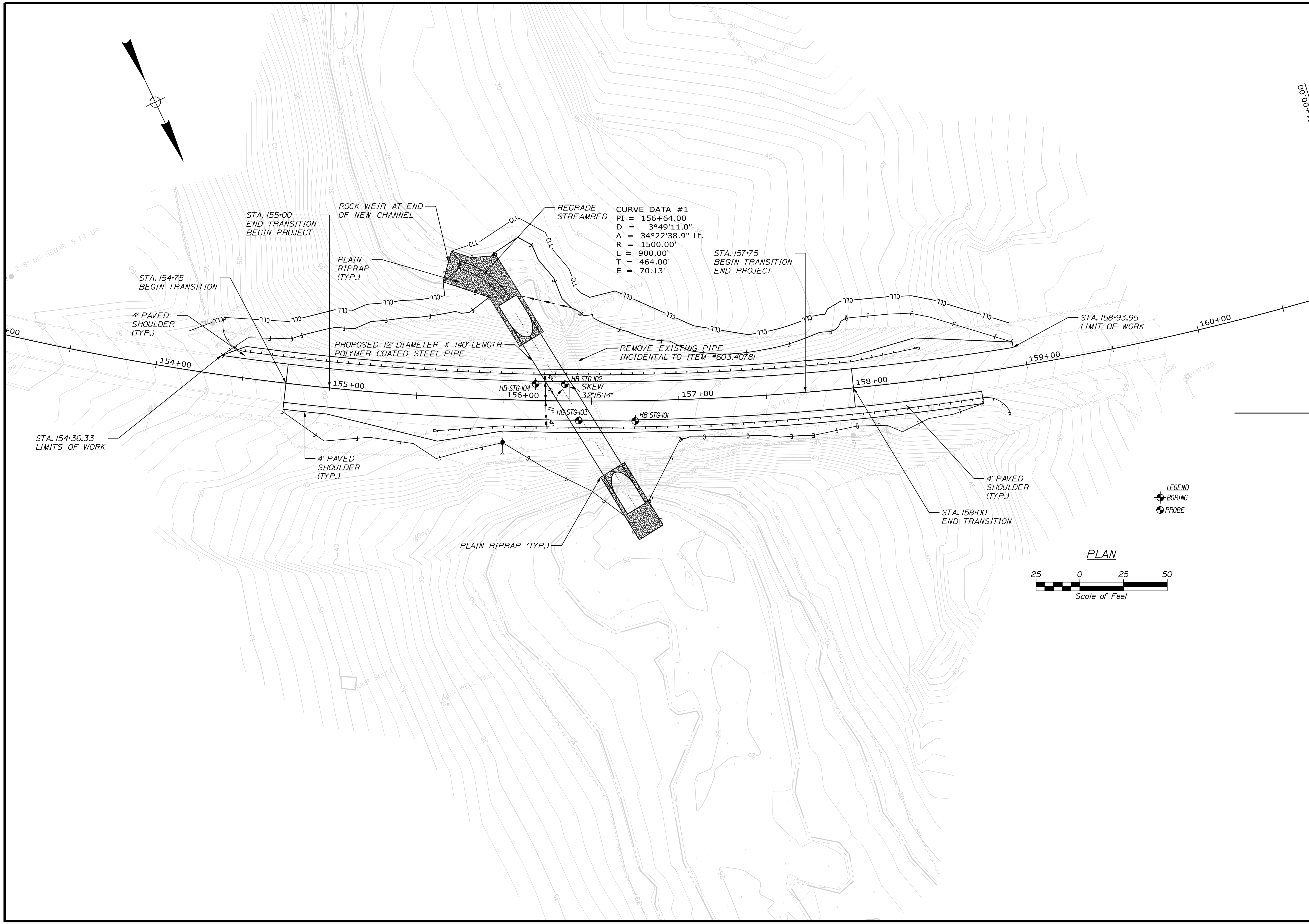

STATE OF MAINE DEPARTMENT OF TRANSPORTATION		25515.00
BRIDGE NO. 6679		WIN 25515.00
ST. GEORGE ROUTE 73		HIGHWAY PLANS
BORING LOCATION PLAN		SHEET NUMBER
2		OF 3

PROJ. MANAGER	BY	DATE	SIGNATURE
DESIGN DETAILED	C. RUSSELL	DEC 2022	
CHECKED/REVIEWED	T. WHITE		
DESIGNS DETAILED			
REVISIONS 1			P.E. NUMBER
REVISIONS 2			DATE
REVISIONS 3			
REVISIONS 4			
FIELD CHANGES			

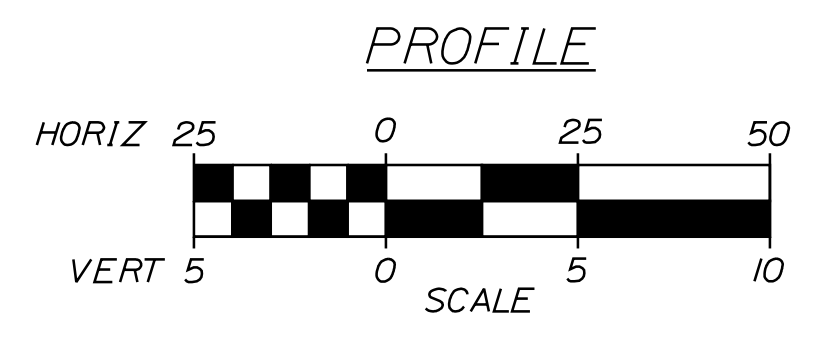
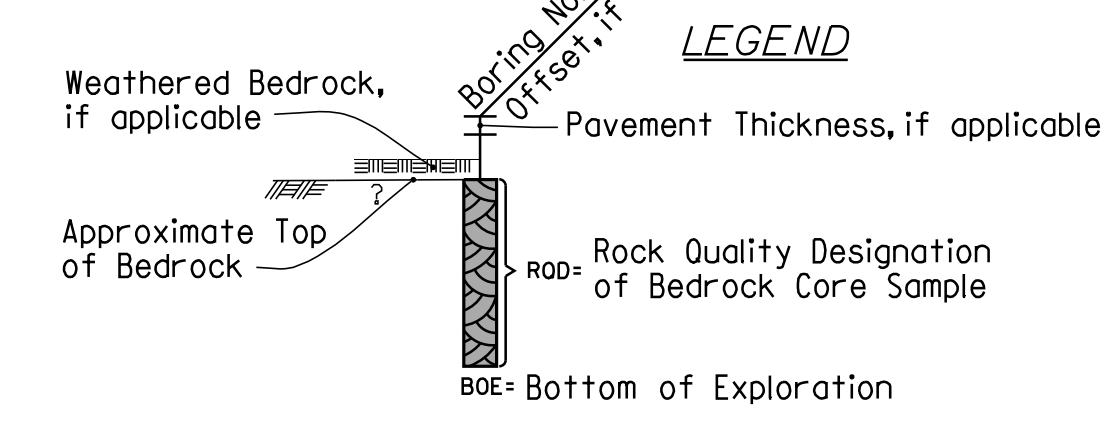
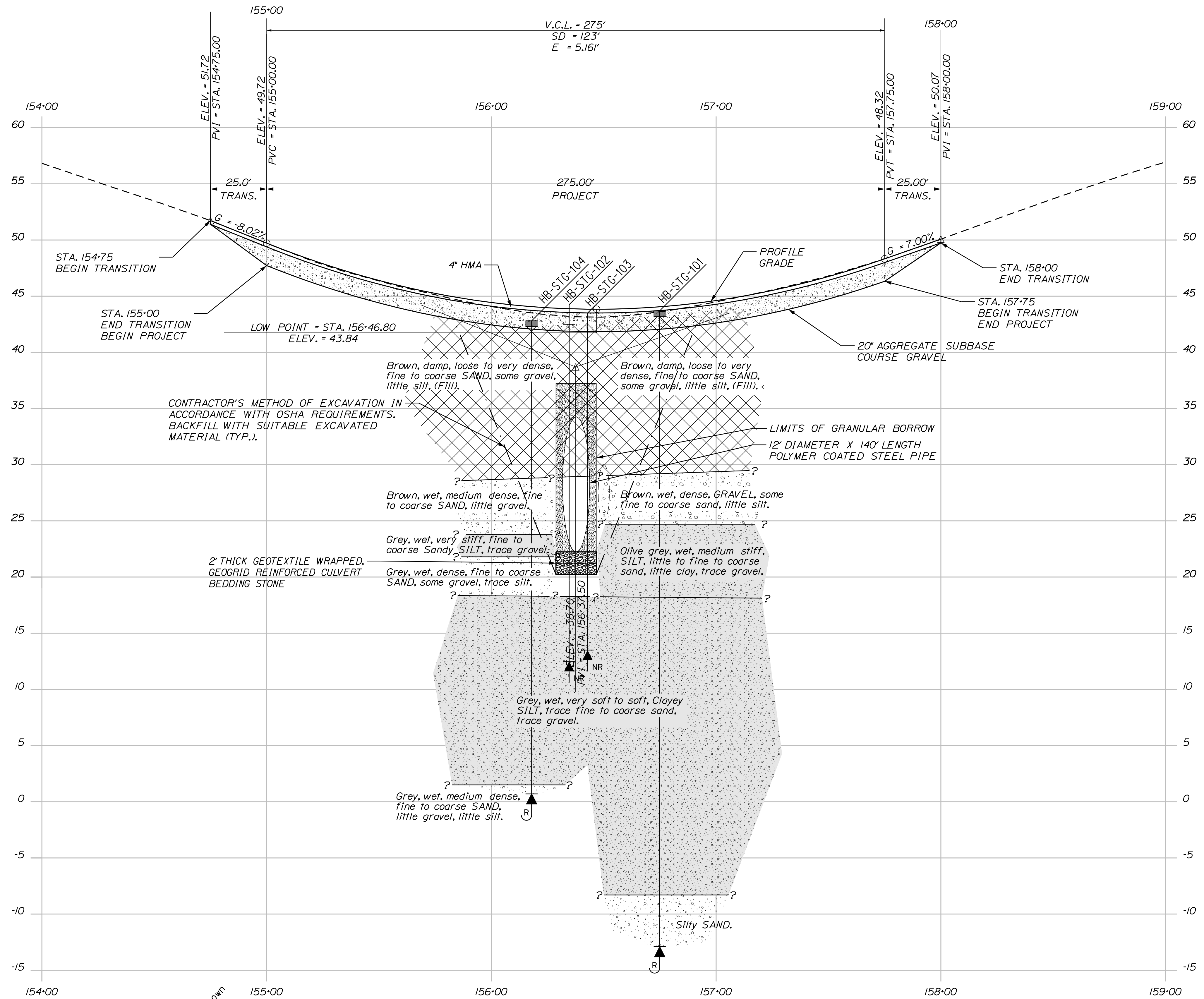

Note: This generalized interpretive soil profile is intended to convey trends in subsurface conditions. The boundaries between strata are approximate and idealized, and have been developed by interpretations of widely spaced explorations and samples. Actual soil and bedrock transitions may vary and are probably more erratic. For more specific information refer to the exploration logs.

DESIGNED	DATE	SIGNATURE
CHECKED	DEC 2022	
DESIGNED		P.E. NUMBER
REVISIONS 1		DATE
REVISIONS 2		
REVISIONS 3		
REVISIONS 4		
FIELD CHANGES		

PROJ. MANAGER	BY	DATE
C. RUSSELL	T. WHITE	DEC 2022

ST. GEORGE
ROUTE 73
INTERPRETIVE SUBSURFACE PROFILE

Date: 1/23/2023

Username: James.Baines

Division: HIGHWAY

Filename: ... \HIGHWAY\MSTA007_HDPlan1.dgn

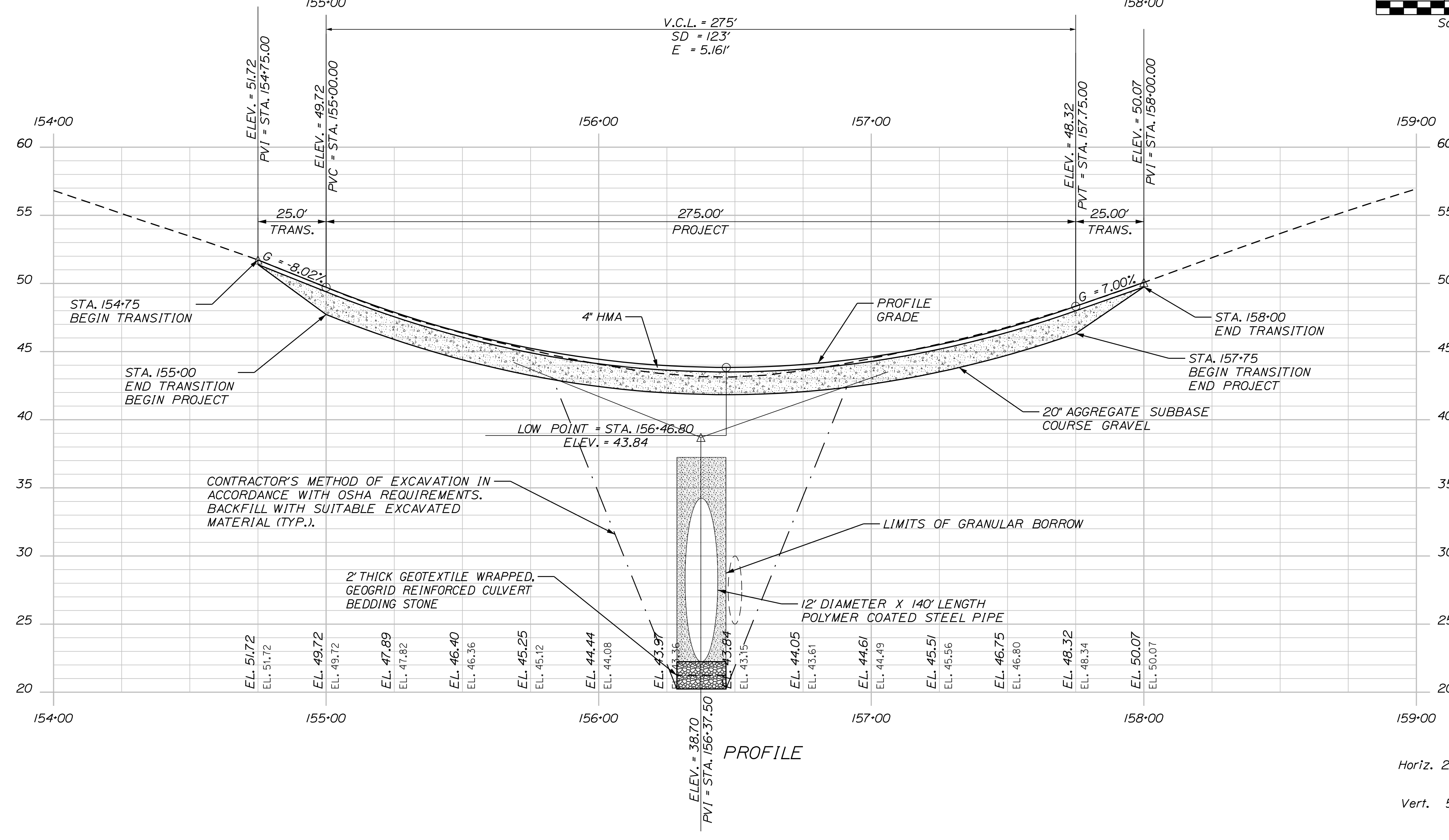
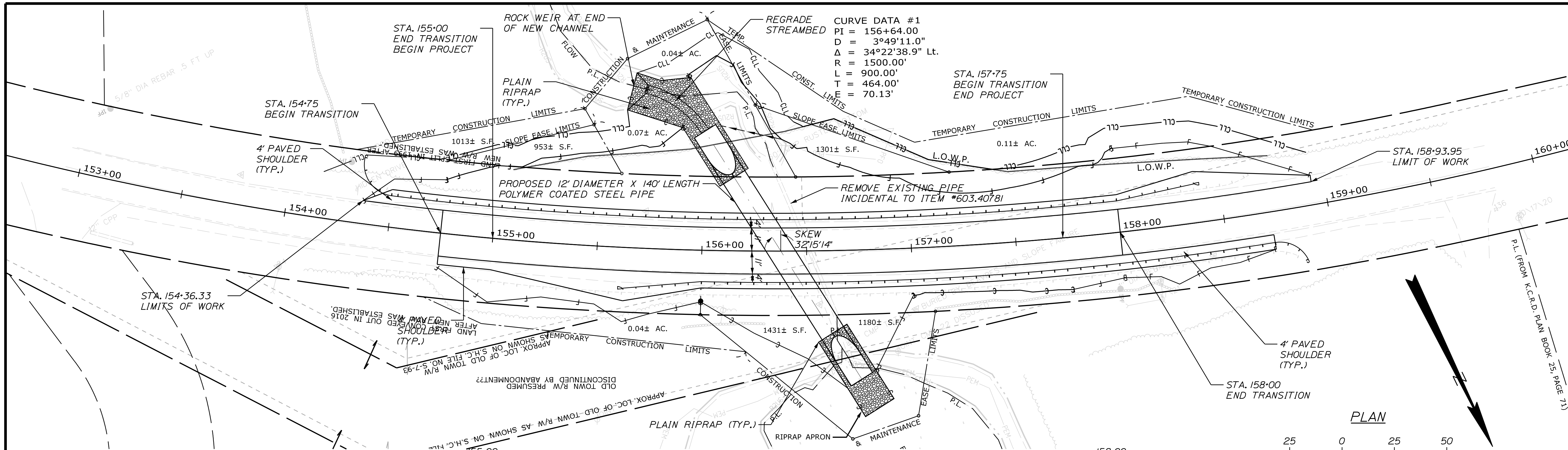

STATE OF MAINE DEPARTMENT OF TRANSPORTATION		25515.00
BRIDGE NO. 6679		WIN 25515.00
HIGHWAY PLANS		
	SIGNATURE	P.E. NUMBER
	DATE	DATE
	BY	DATE
	D. COOMBS	NOV 2022
	DESIGN-REVIEWED	-
	DESIGN-REVIEWED	-
	DESIGN-REVIEWED	-
	REVISIONS 1	-
	REVISIONS 2	-
	REVISIONS 3	-
	REVISIONS 4	-
	FIELD CHANGES	-
ST. GEORGE ROUTE 73 PLAN/PROFILE		
SHEET NUMBER		
7		
OF 18		

1 6 9

2 7 10

3 8 11

4 12 18

5 13 17

14 16

15 18

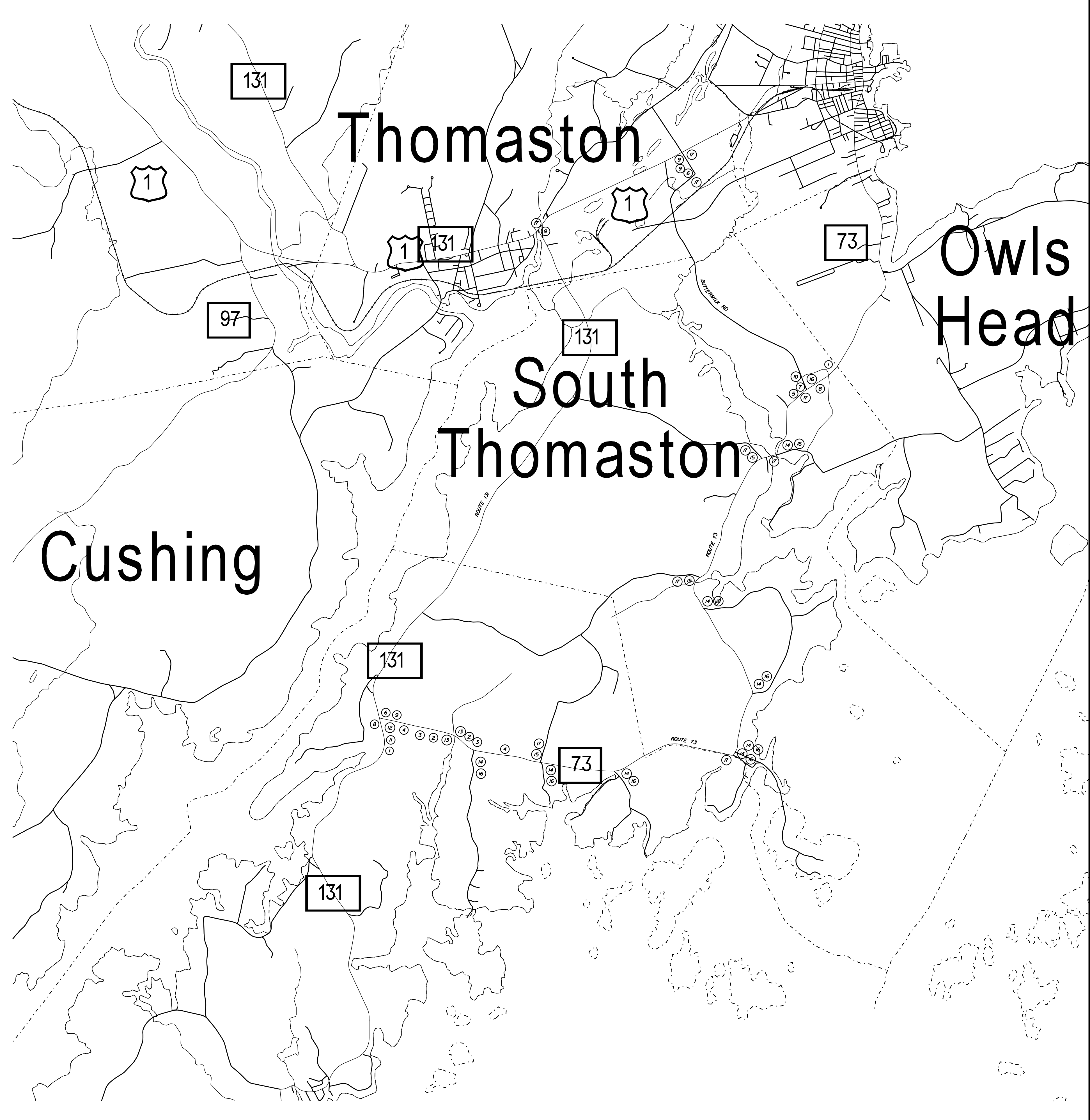

STATE OF MAINE
DEPARTMENT OF TRANSPORTATION

025515.00
WIN 25515.00
HIGHWAY PLANS

PROJ. MANAGER	D. COOMBS	BY	J. BAINES	DATE	NOV 2022
DESIGN-DETAILED		CHECKED-REVIEWED		SIGNATURE	
DESIGNS-DETAILED		DESIGNS-DETAILED		P.E. NUMBER	
REVISIONS 1		REVISIONS 1		DATE	
REVISIONS 2		REVISIONS 2			
REVISIONS 3		REVISIONS 3			
REVISIONS 4		REVISIONS 4			
FIELD CHANGES					

ST. GEORGE
ROUTE 73

DETOUR PLAN

SHEET NUMBER
8
OF 18

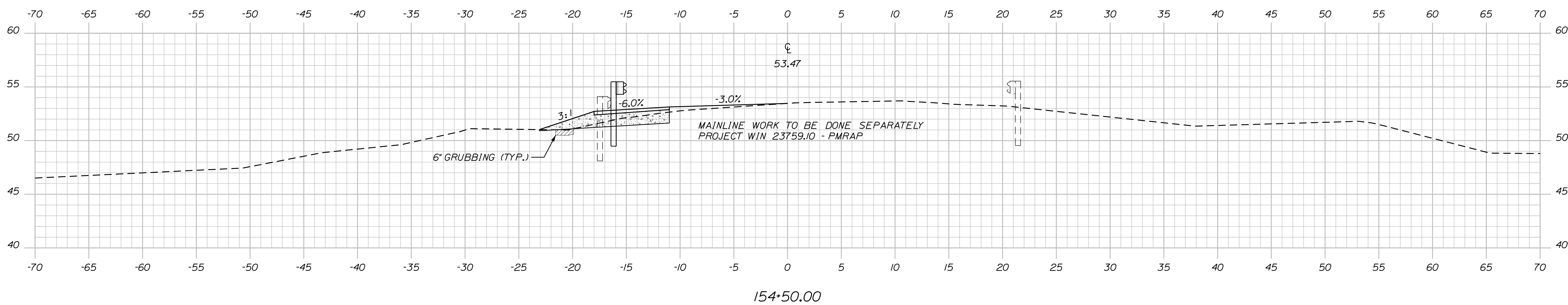
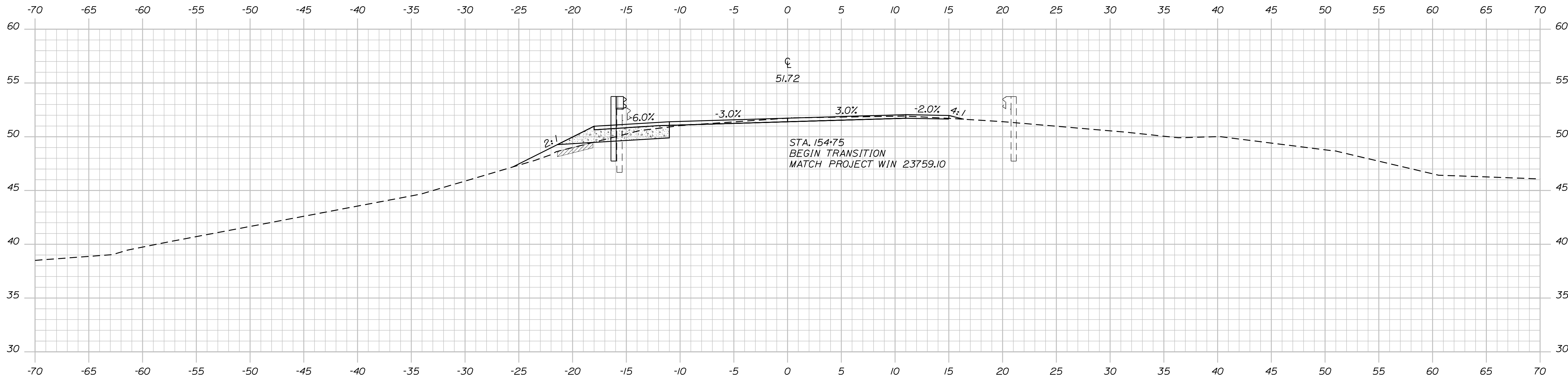

STATE OF MAINE
DEPARTMENT OF TRANSPORTATION

25515.00

WIN
WIN 25515.00

HIGHWAY PLANS

SIGNATURE

P.E. NUMBER

DATE

DATE

BY

PROJ. MANAGER
DESIGN-DETAILED
CHECKED-REVIEWED
DESIGN-DETAILED
DESIGN-DETAILED
REVISIONS 1
REVISIONS 2
REVISIONS 3
REVISIONS 4
FIELD CHANGES

ST. GEORGE
ROUTE 73

CROSS SECTIONS

SHEET NUMBER

9

OF 18

Date: 1/23/2023

Username: James.Baines

Division: HIGHWAY

Filename: ... \MSTAD10_XSECT_155+00_002.dgn

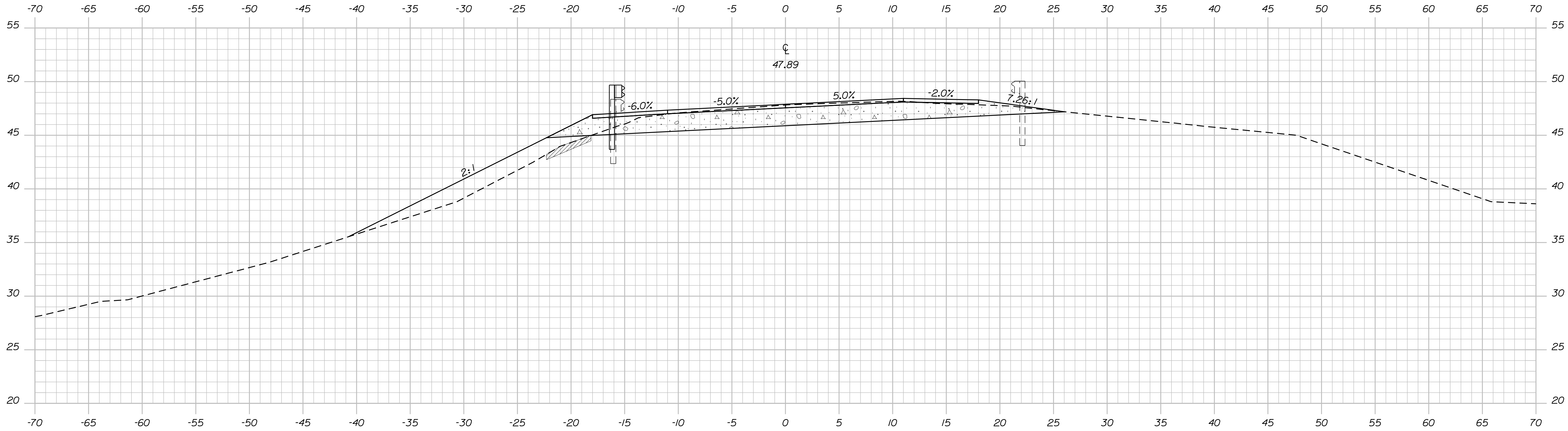

155+25.00

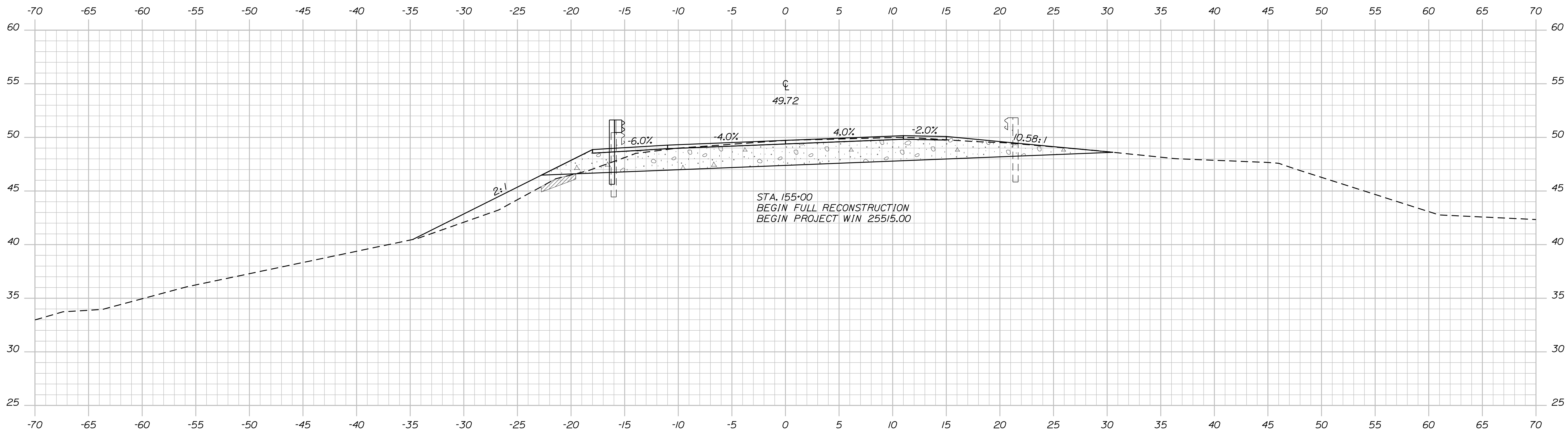

155+00.00

STATE OF MAINE
DEPARTMENT OF TRANSPORTATION

25515.00

WIN
WIN 25515.00

HIGHWAY PLANS

SIGNATURE

P.E. NUMBER

DATE

PROJ. MANAGER	PROJ. MANAGER'S	BY	DATE
DESIGN DETAILED	DESIGNER	DESIGNER	DATE
CHECKED/REVIEWED	CHECKER	CHECKER	DATE
DESIGN DETAILED	DESIGNER	DESIGNER	DATE
DESIGN DETAILED	DESIGNER	DESIGNER	DATE
REVISIONS 1	DESIGNER	DESIGNER	DATE
REVISIONS 2	DESIGNER	DESIGNER	DATE
REVISIONS 3	DESIGNER	DESIGNER	DATE
REVISIONS 4	DESIGNER	DESIGNER	DATE
FIELD CHANGES	FIELD CHANGES	FIELD CHANGES	FIELD CHANGES

ST. GEORGE
ROUTE 73

CROSS SECTIONS

SHEET NUMBER

10

OF 18

Date: 1/23/2023

Username: James.Baines

Division: HIGHWAY

Filename: ... \MSTAN011_XSECT_155+50_003.dgn

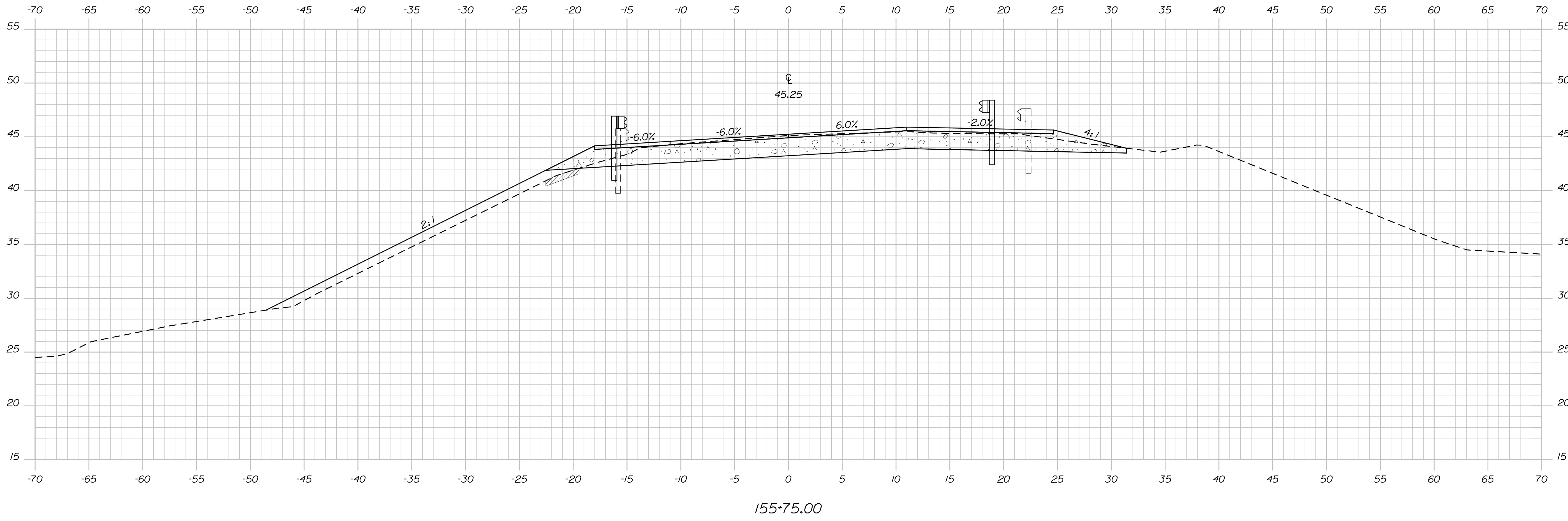

155+75.00

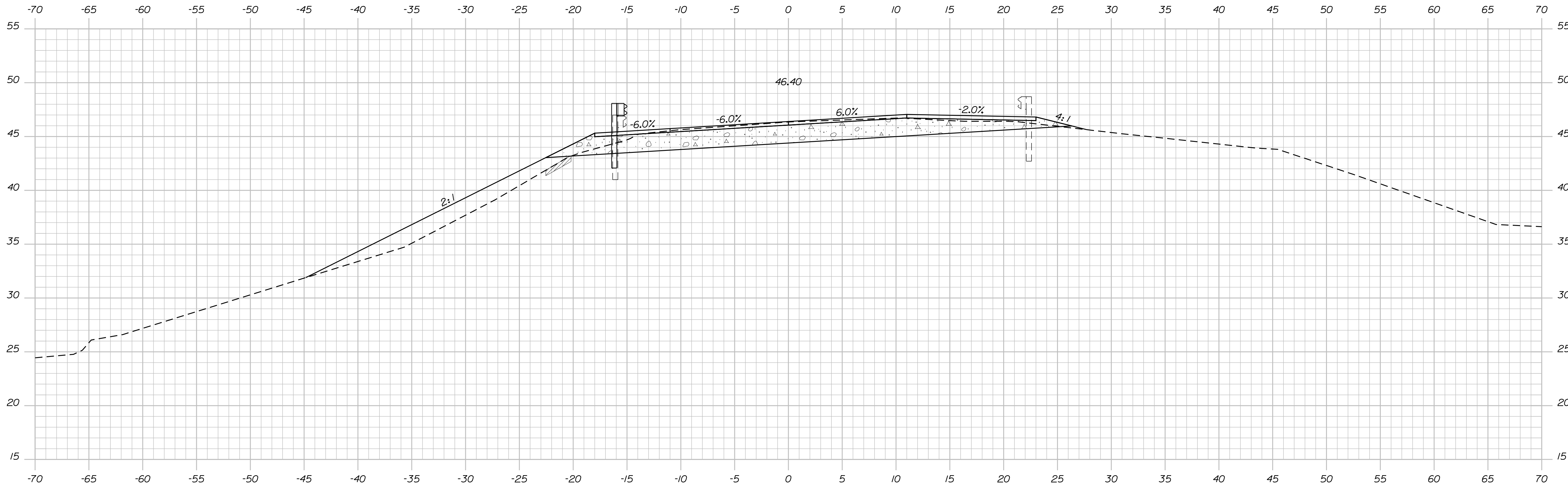

155+50.00

STATE OF MAINE
DEPARTMENT OF TRANSPORTATION
25515.00

SIGNATURE
P.E. NUMBER
DATE

PROJ. MANAGER	BY	DATE
DESIGN DETAILED	DESIGNER	DATE
CHECKED/REVIEWED	DESIGNER	DATE
DESIGN DETAILED	DESIGNER	DATE
REVISIONS 1	DESIGNER	DATE
REVISIONS 2	DESIGNER	DATE
REVISIONS 3	DESIGNER	DATE
REVISIONS 4	DESIGNER	DATE
FIELD CHANGES	DESIGNER	DATE

ST. GEORGE
ROUTE 73
CROSS SECTIONS

SHEET NUMBER
11
OF 18

Date: 1/23/2023

Username: James.Baines

Division: HIGHWAY

Filename: ... \MSTAO13_XSECT_156+37_005.dgn

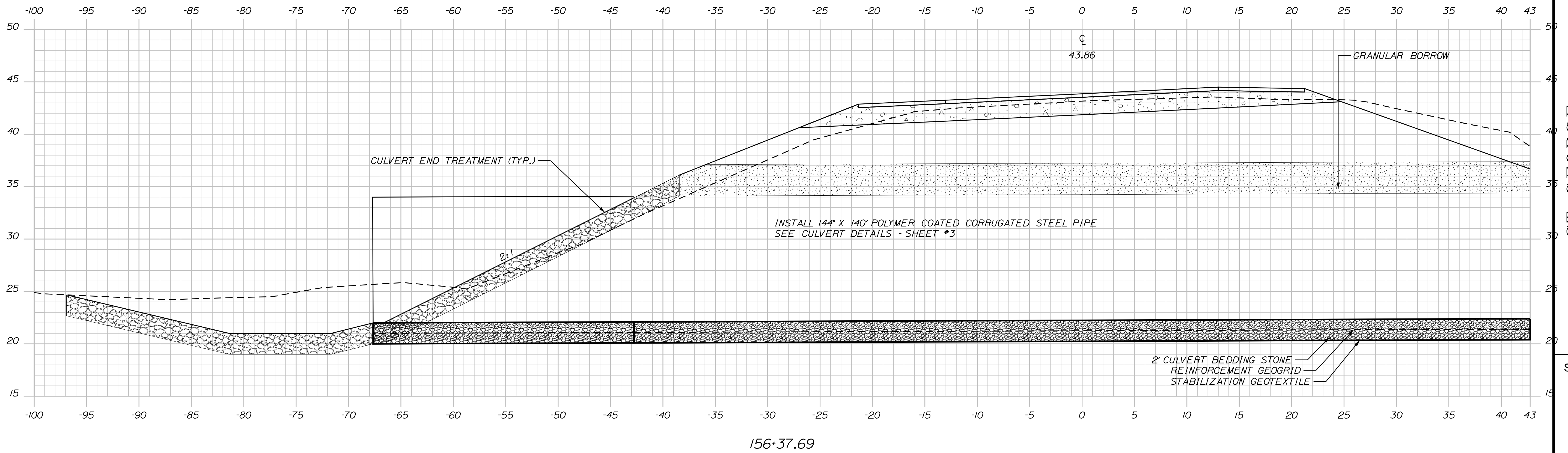
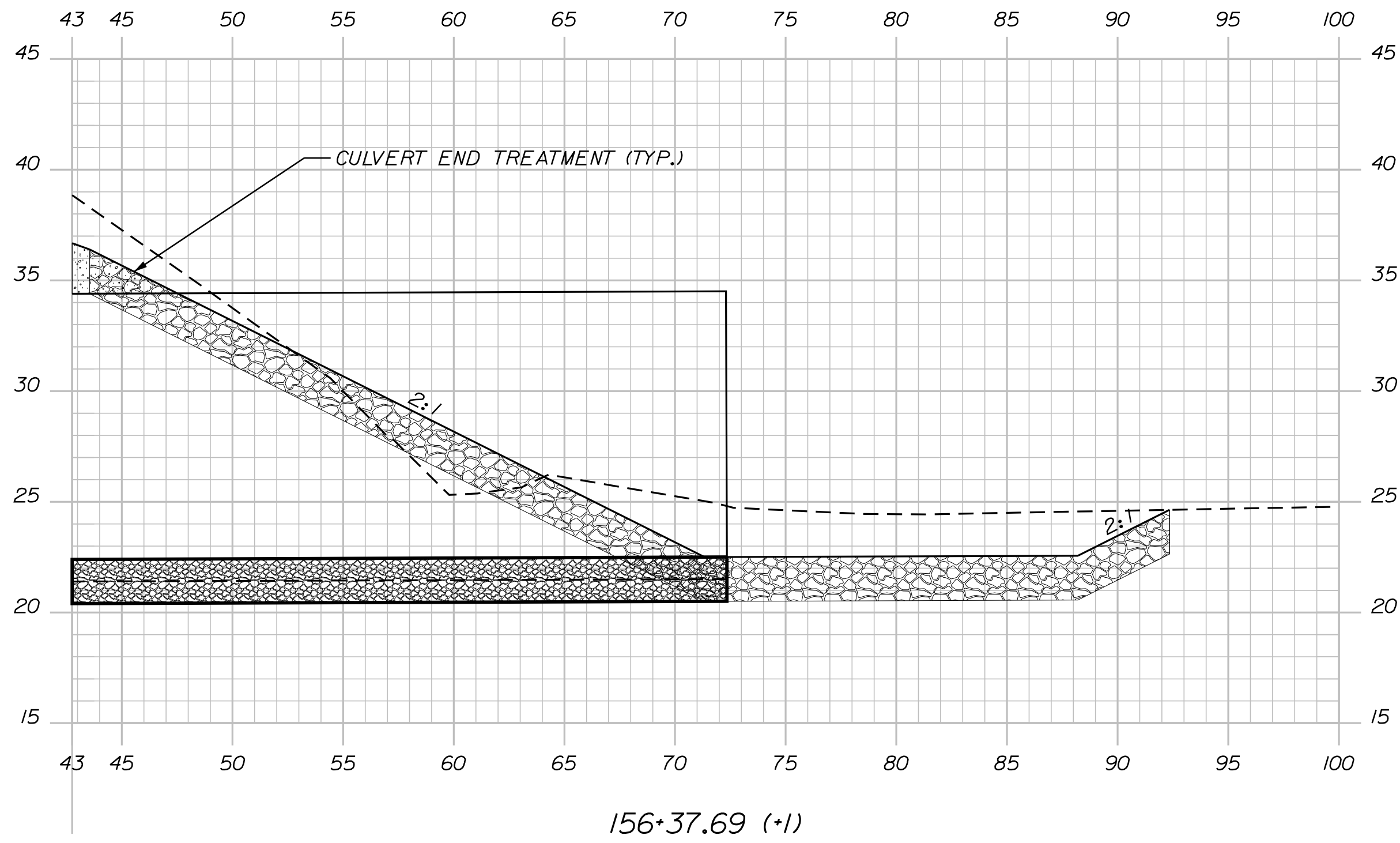

156+37.69

STATE OF MAINE
DEPARTMENT OF TRANSPORTATION
25515.00

PROJ. MANAGER	DESIGN-DETAILED	CHECKED-REVIEWED	DESIGN-DETAILED	DESIGN-DETAILED	REVISIONS 1	REVISIONS 2	REVISIONS 3	REVISIONS 4	FIELD CHANGES	BY	DATE	SIGNATURE	P.E. NUMBER	DATE

ST. GEORGE
ROUTE 73
CROSS SECTIONS

SHEET NUMBER
13
OF 18

Date: 1/23/2023

Username: James.Baines

Division: HIGHWAY

Filename: ... \MSTAO14_XSECT_156+50_006.dgn

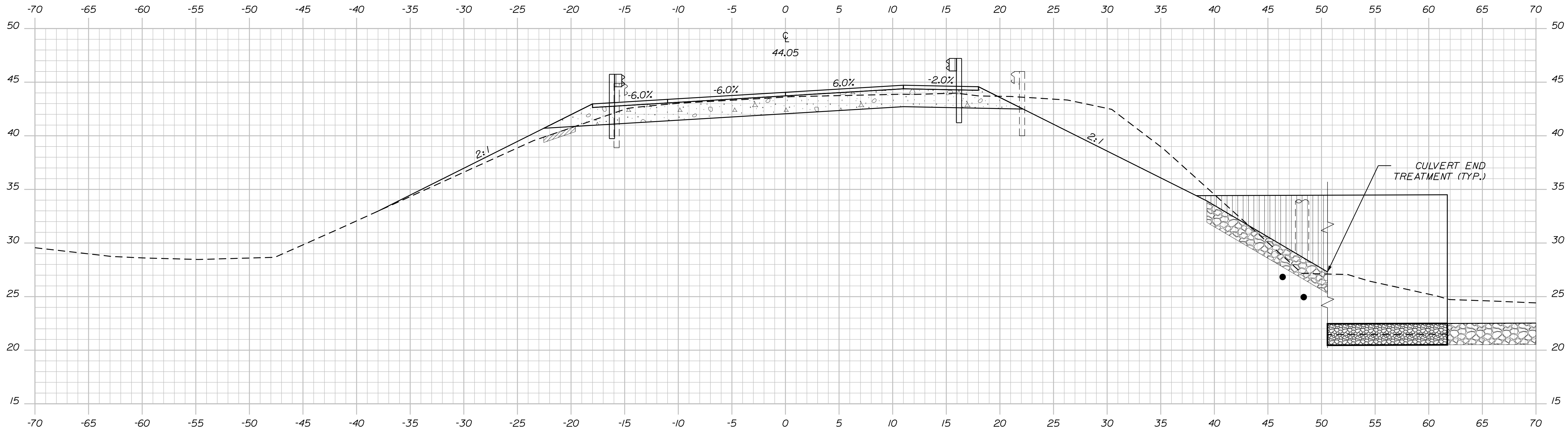

156+75.00

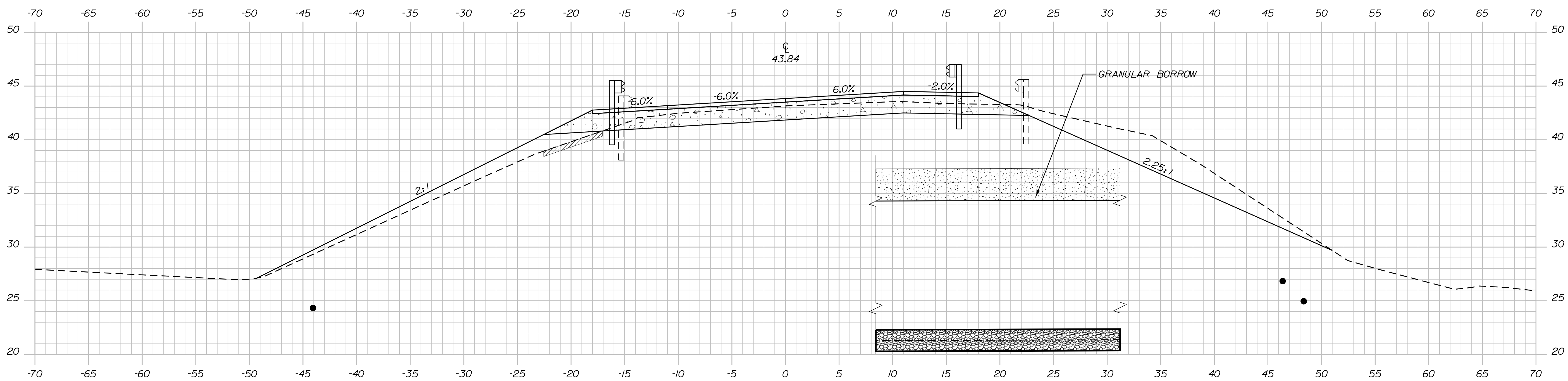

156+50.00

STATE OF MAINE
DEPARTMENT OF TRANSPORTATION

25515.00

WIN
WIN 25515.00

HIGHWAY PLANS

SIGNATURE

P.E. NUMBER

DATE

DATE

BY

DESIGNER

CHECKED

DESIGNED

REVISIONS 1

REVISIONS 2

REVISIONS 3

REVISIONS 4

FIELD CHANGES

ST. GEORGE
ROUTE 73

CROSS SECTIONS

SHEET NUMBER

14

OF 18

Date: 1/23/2023

Username: James.Baines

Division: HIGHWAY

Filename: ... \MSTAO15_XSECT_157+00_007.dgn

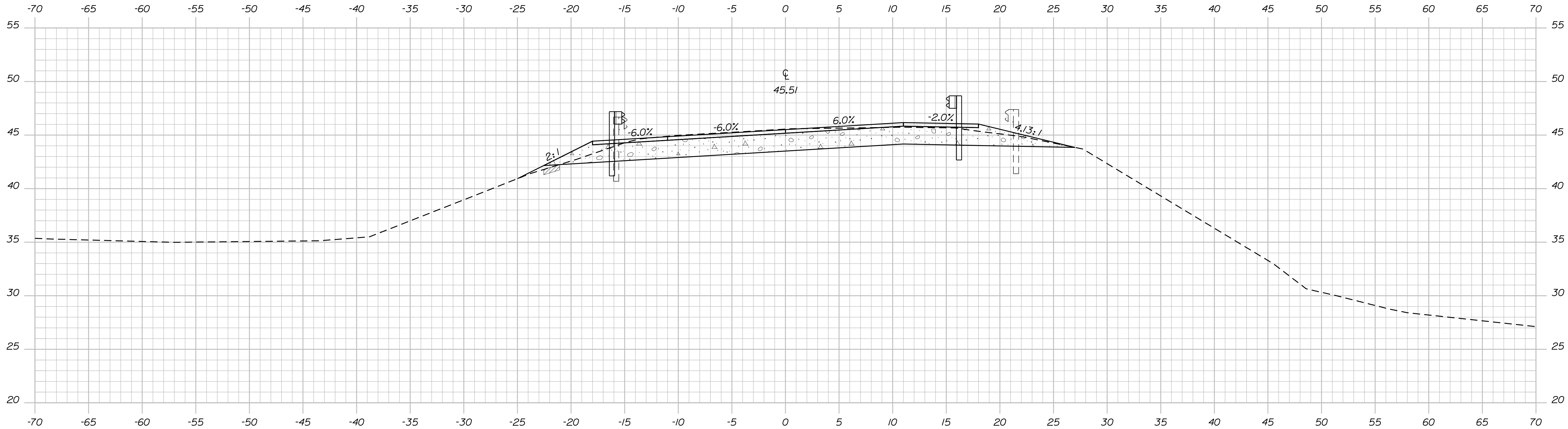

157+25.00

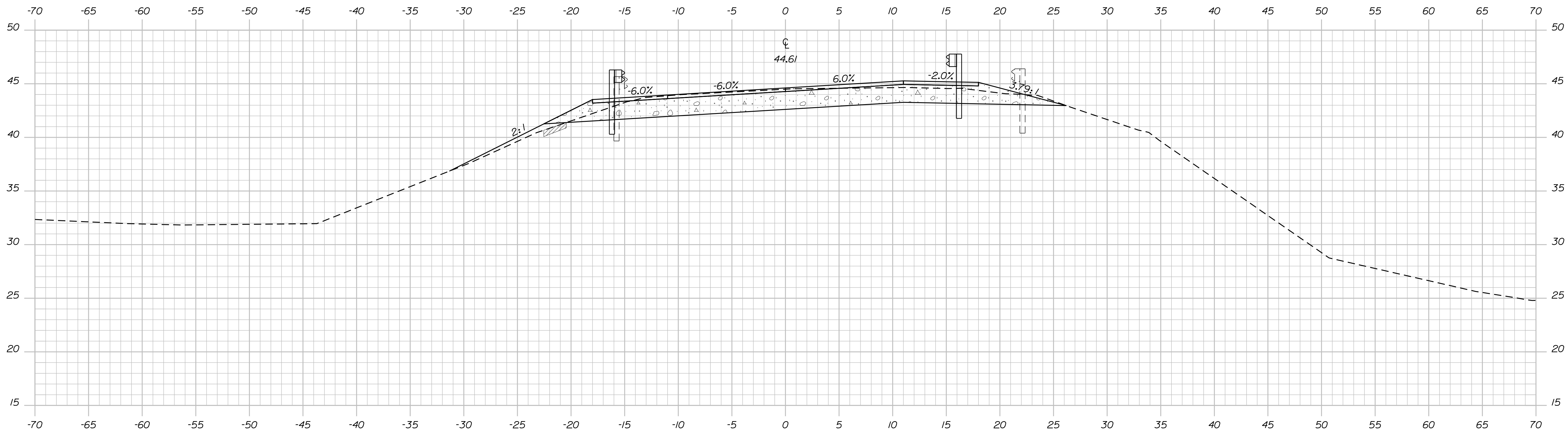

157+00.00

STATE OF MAINE
DEPARTMENT OF TRANSPORTATION

25515.00

WIN
WIN 25515.00

HIGHWAY PLANS

SIGNATURE

P.E. NUMBER

DATE

DATE

BY

DESIGNER

CHECKED

DESIGNED

REVISIONS

REVISIONS

REVISIONS

REVISIONS

FIELD CHANGES

ST. GEORGE
ROUTE 73

CROSS SECTIONS

SHEET NUMBER

15

OF 18

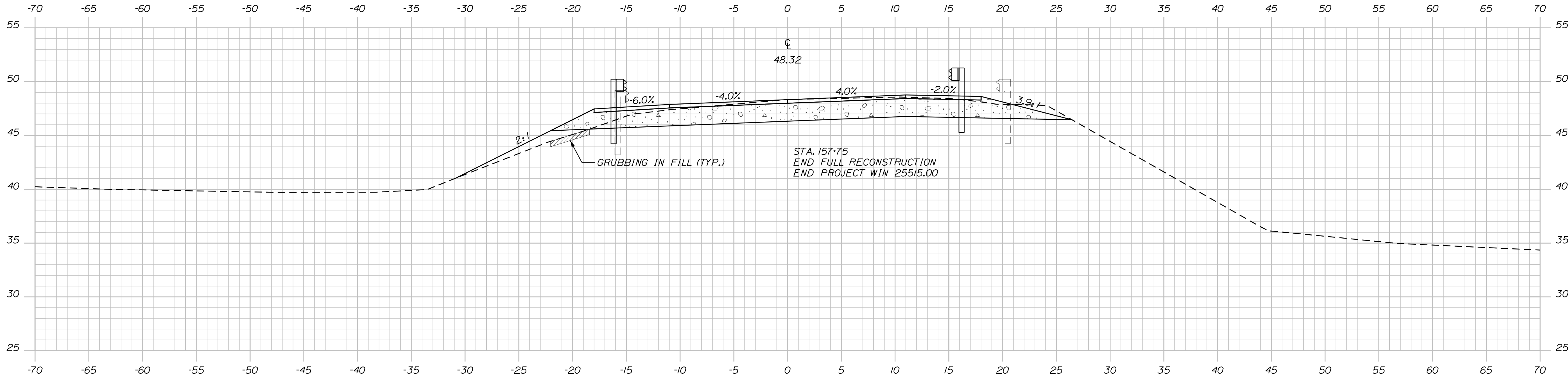

157+75.00

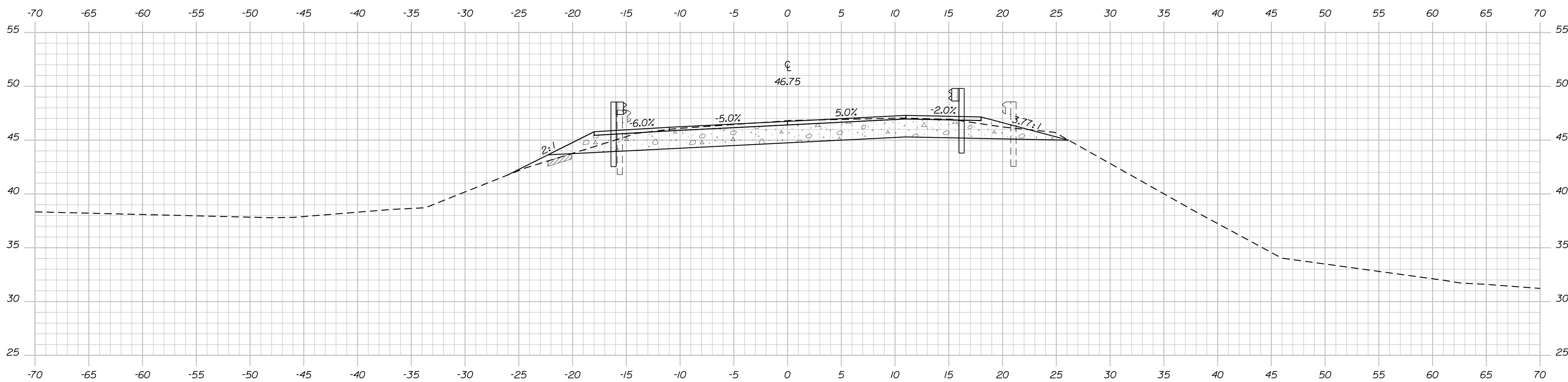

157+50.00

STATE OF MAINE
DEPARTMENT OF TRANSPORTATION

25515.00

WIN
WIN 25515.00

HIGHWAY PLANS

SIGNATURE

P.E. NUMBER

DATE

DATE

BY

PROJ. MANAGER

CHECKED

DESIGN

REVISIONS 1

REVISIONS 2

REVISIONS 3

REVISIONS 4

FIELD CHANGES

DESIGN-REVIEWED

DESIGN-DETAILED

DESIGN-DETAILED

DESIGN-DETAILED

DESIGN-DETAILED

DESIGN-DETAILED

DESIGN-DETAILED

DESIGN-DETAILED

DESIGN-DETAILED

DESIGN-DETAILED

ST. GEORGE
ROUTE 73

CROSS SECTIONS

SHEET NUMBER

16

OF 18

Date: 1/23/2023

Username: James.Baines

Division: HIGHWAY

Filename: ... \MSTAO17_XSECT_158+00_009.dgn

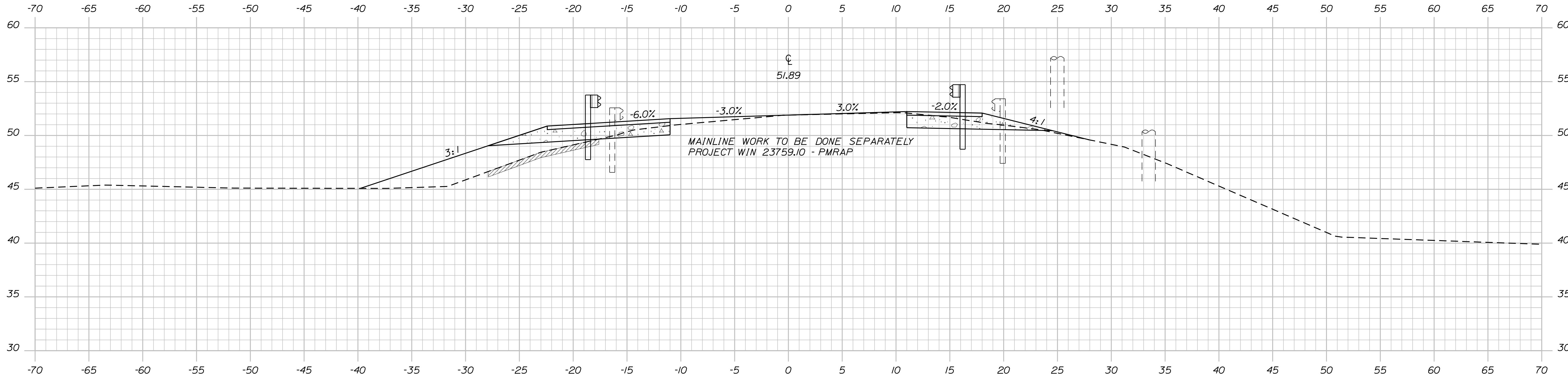

158+25.00

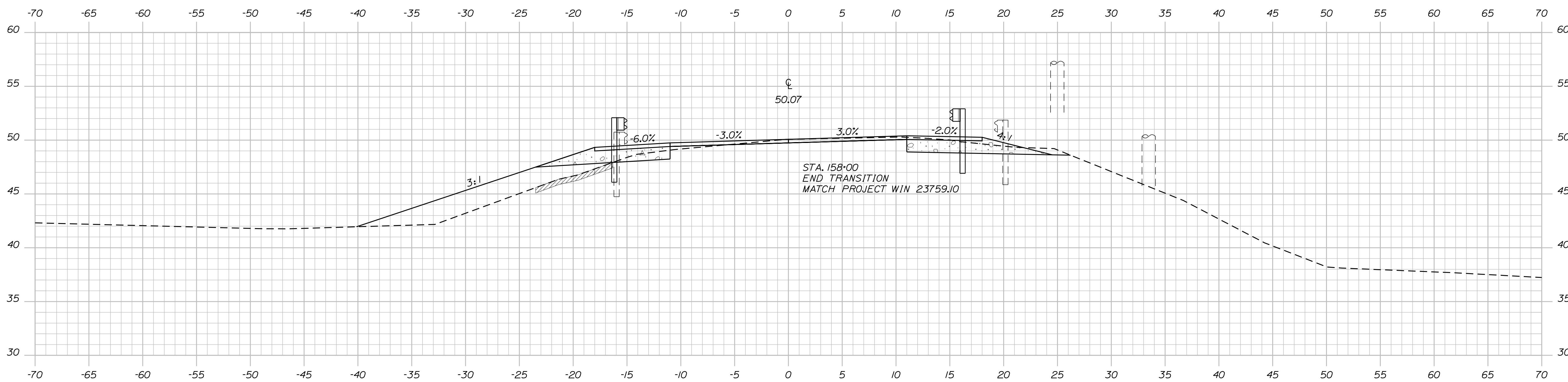

158+00.00

STATE OF MAINE
DEPARTMENT OF TRANSPORTATION
25515.00
WIN
WIN 25515.00
HIGHWAY PLANS

PROJ. MANAGER	DESIGN-DETAILED	CHECKED-REVIEWED	DESIGN-DETAILED	DESIGN-DETAILED	REVISIONS 1	REVISIONS 2	REVISIONS 3	REVISIONS 4	FIELD CHANGES

BY	DATE	SIGNATURE

P.E. NUMBER	DATE

ST. GEORGE
ROUTE 73
CROSS SECTIONS

SHEET NUMBER
17
OF 18

Town, County, State _____
 Approx. Property Lines _____ P.L.
 Existing Right of Way _____
 Limits of Wrought Portion _____ L.O.W.P.
 Control Of Access _____ C.O.A.
 New Right of Way _____
 New Easement _____
 New Temporary Rights _____
 New R/W Within Existing R/W _____

New R/W Along Existing R/W
 Building _____
 Trees Conifer _____ Deciduous _____
 Clearing Limit Line _____
 Bush Line _____
 Water Edge _____
 Ledge _____
 Fence CHAIN LINK _____ BARB WIRE _____ STOCKADE _____
 Sign _____ Well _____ Mailbox _____
 Rock/Boulder _____ Flag Pole _____

PLAN LEGEND

Sanitary Sewer	Existing	Proposed
Telephone Line	Existing	Proposed
Electric Line	Existing	Proposed
Water Line	Existing	Proposed
Underdrain Line	Existing	Proposed
Gas Line	Existing	Proposed
Guardrail	Existing	Proposed
Culvert	Existing	Proposed
Traveled Way	Existing	Proposed
Ditch	Existing	Proposed
Catch Basin	Existing	Proposed
Manhole	Existing	Proposed
Sewer Manhole	Existing	Proposed
Utility Pole	Existing	Proposed
Fire Hydrant	Existing	Proposed
Curbing	Existing	Proposed

Cut Line _____
 Stonewall _____
 Baseline _____
 Monument _____
 Iron Rod Found _____ IRF
 Replacement Pin Set _____
 Fill Line _____
 Retaining Wall _____
 Traverse Point _____
 Pipe Found _____ IPF

THIS PLAN WAS PREPARED IN CONNECTION WITH THE DEPARTMENT'S ACQUISITION OF REAL PROPERTY FOR TRANSPORTATION PURPOSES. IT CANNOT BE USED TO ESTABLISH LEGAL BOUNDARIES BETWEEN ABUTTING PROPERTY OWNERS.

Scale of Feet
 0 25 50 75 100

STATE OF MAINE
 REGISTRY OF DEEDS

COUNTY _____
 RECEIVED _____
 at _____ h _____ m _____ M and
 recorded in Plan Bk _____, Pg. _____
 Attest: _____ REGISTER

Date: 1/23/2023

Username: James.Baines

Division: HIGHWAY

Filename: ... \000\ROW\MSTA001_RWP\PLAN1.dgn

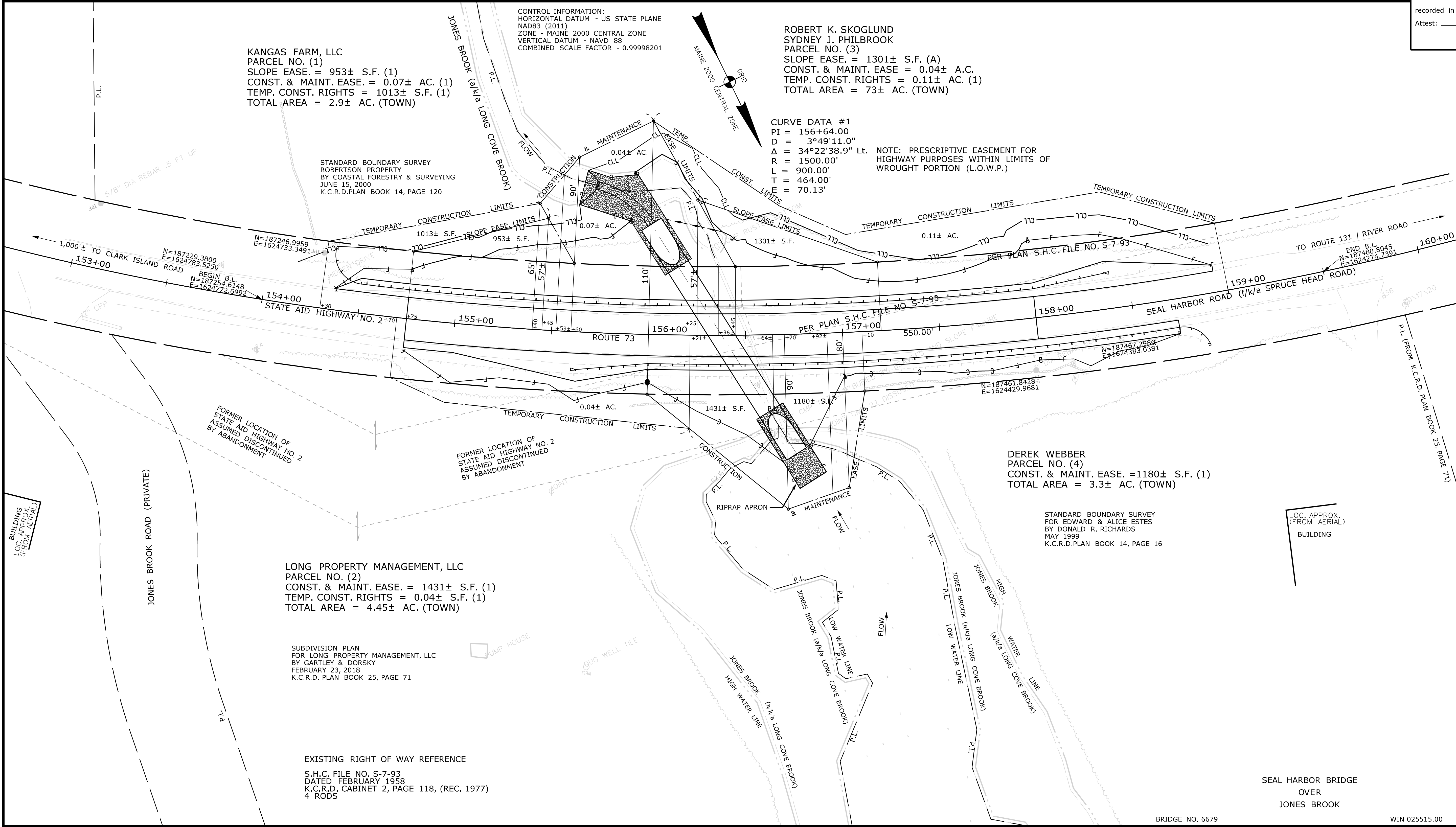

**PRELIMINARY
 PLAN**

ITEM	TECH	CHECKED
EXISTING CONDITION PLAN	JDF	SAN
FINAL RIGHT OF WAY	JDF	SAN
AREAS	JDF	SAN

STATE OF MAINE
 DEPARTMENT OF TRANSPORTATION
 16 STATE HOUSE STATION - AUGUSTA, ME 04333-0016 - 207-624-3460
 SAINT GEORGE
 RIGHT OF WAY MAP

REVISIONS			PLAN FILED IN PLAN BOOK				COUNTY RECORD				BRUCE A. VAN NOTE COMMISSIONER JOYCE NOEL TAYLOR CHIEF ENGINEER DATE _____
NO.	DATE	DESCRIPTION	BY	NO.	GRANTOR	PAGE	INSTRUMENT	DATE	BOOK	PAGE	

STATE AID HIGHWAY NO. 2
 ROUTE 73 / SEAL HARBOR ROAD
 SAINT GEORGE KNOX COUNTY
 STATE PROJECT NO. 25515.00

JANUARY 2023
 SCALE 1" = 25'

RIGHT-OF-WAY MAP
 SHEET 1 OF 1

D.O.T. FILE NO. 7-175

BRIDGE NO. 6679 WIN 025515.00

SEAL HARBOR BRIDGE
 OVER
 JONES BROOK

SHEET NUMBER
1
 OF _____