

STATE OF MAINE DEPARTMENT OF TRANSPORTATION



AUBURN ANDROSCOGGIN COUNTY ROUTE 202 STATE PROJECT NO. 25391.00 PROJECT LENGTH: 0.02 MILES

<u>INDEX OF SHEETS</u>	
<u>Description</u>	<u>Sheet No.</u>
Title Sheet	1
Estimated Quantities - General Notes	2
Special Details- Culvert Slipline	3
Plan / Profile	4
Cross - Sections	5-6
Right of Way Map	7

<u>PLAN LEGEND</u>			
Town, County, State	-----	Catch Basins	Existing Proposed
Property Lines	-----	Manholes	Existing Proposed
R/W Lines-Existing	-----	Proposed Underdrain	-----
R/W Lines-Proposed	-----	Proposed Ditch	-----
Culvert-Existing	-----	Existing Ditch	-----
Culvert Proposed	-----	Utility Poles	Existing Proposed
Curbing Existing Proposed	-----	Fire Hydrants	Existing Proposed
Type 1	-----	Existing Water Line	-----
Type 3	-----	Existing San. Sewer	-----
Type 5	-----	Existing San. Sewer Manhole	-----
Outline of Bodies of Water	-----	Guardrail-Existing	-----
Exposed Bedrock	-----	Guardrail-Proposed	-----
Buildings	-----	Guardrail-Cable, Other	-----
Trees	Conifer Deciduous	Centerline-Existing	-----
Tree Line	-----	Centerline-Proposed	-----
Clearing Limit Line	-----	Travelway-Existing	-----
Railroad	-----	Travelway-Proposed	-----
Boring	HB-XXX-###	Probe	P-#. #X
Pavement Core	PC-#	#, # = Depth	X = W (Weathered Rock)
Test Pit	TP-XXX-###		R (Refusal)
			NR (No Refusal)

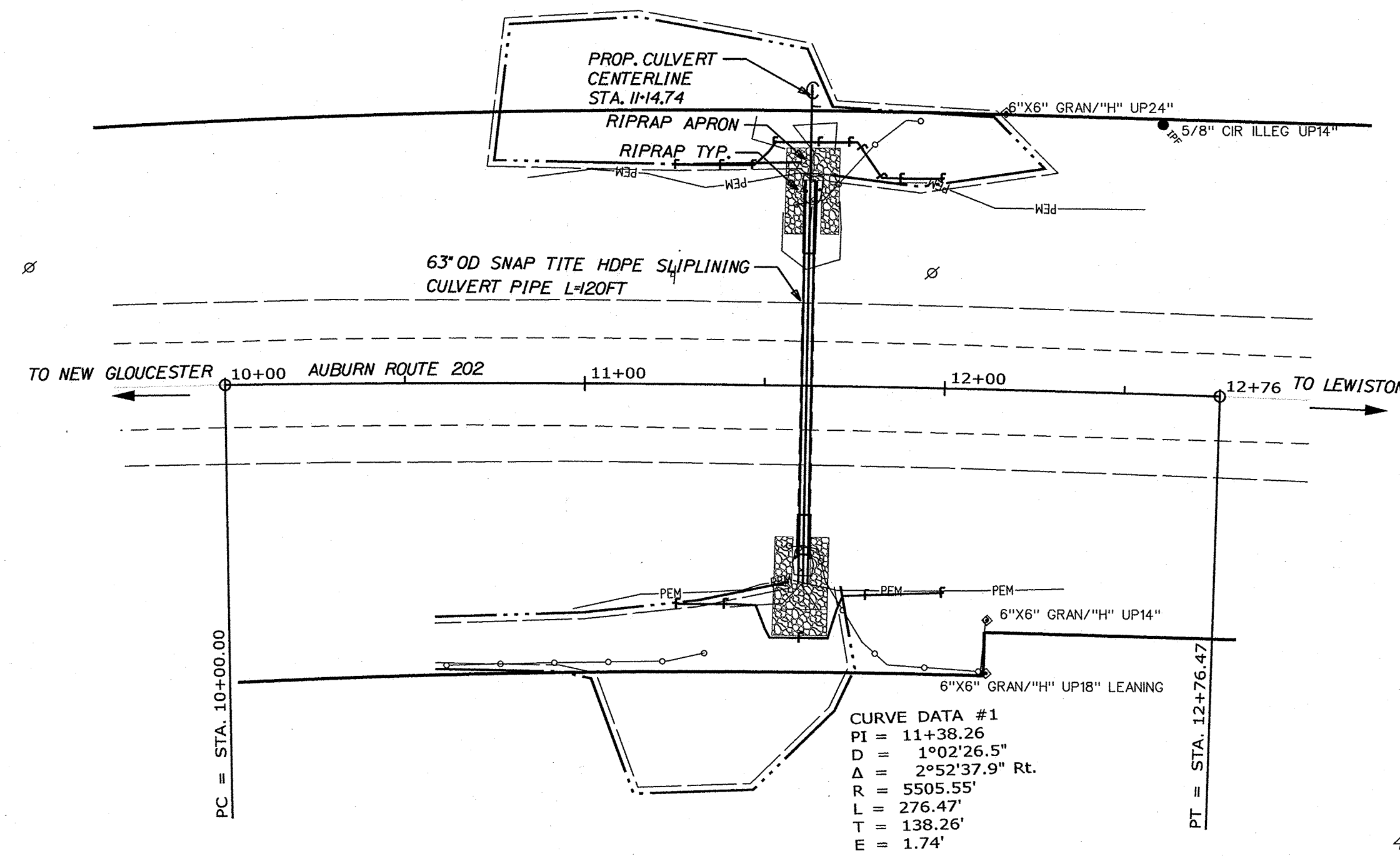
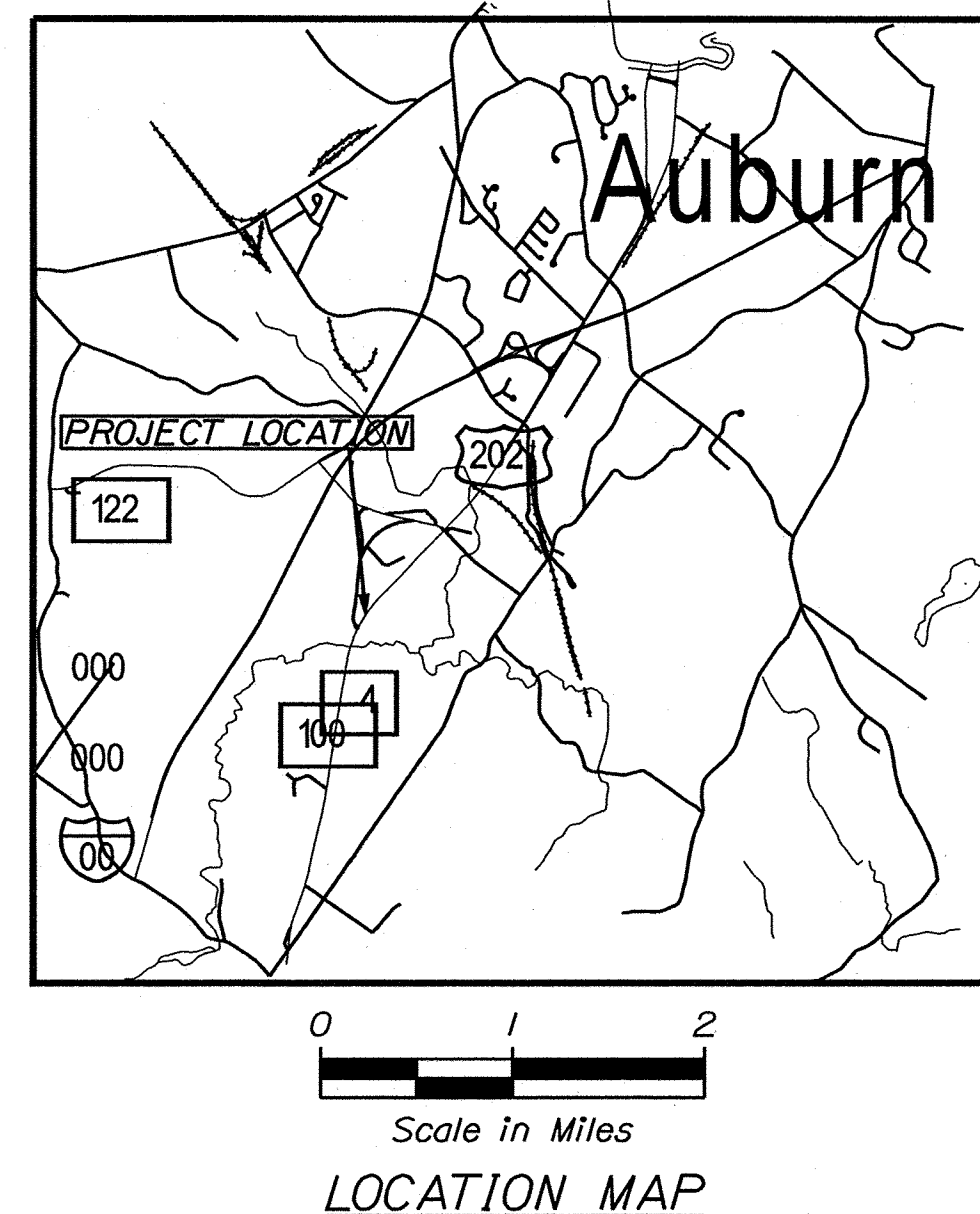

<u>TRAFFIC DATA</u>	
Current (2023) AADT	8750
Future (2035) AADT	9280
DHV - % of AADT	11
Design Hour Volume	1021
% Heavy Trucks (AADT)	9
% Heavy Trucks (DHV)	6
Directional Distribution (DHV)	51
18-kip Equivalent P 2.0	349
18-kip Equivalent P 2.5	332
Design Speed (mph)	50
Corridor Priority	2

<u>PROJECT LOCATION:</u>	Large Culvert LC-135116 located on Route 202, 0.19 mile north of Eastman Lane in Auburn Maine Longitude - 70.283477, Latitude 44.018851
<u>PROGRAM AREA:</u>	Regional Program
<u>SCOPE OF WORK:</u>	Large Culvert Rehabilitation

STATE OF MAINE DEPARTMENT OF TRANSPORTATION	APPROVED	DATE 4/25/23
COMMISSIONER: <i>[Signature]</i>	CHIEF ENGINEER: <i>[Signature]</i>	4/25/23
SIGNATURE <i>[Signature]</i> 7/15	P.E. NUMBER 3-21-2023	DATE
PROGRAM REGIONAL	PROJECT MANAGER LARRY HAMILTON	DESIGNER EYTAYO ADANDE KINTI
CONSULTANT	PROJECT RESIDENT	CONTRACTOR
PROJECT INFORMATION	REGIONAL	PROJECT COMPLETION DATE
WIN 25391.00 STATE PROJECT NO 25391.00 AUBURN ROUTE 202 TITLE SHEET		
SHEET NUMBER		
1		
OF 1		

Filename: ... \00\HIGHWAY\MSTA\001_Title.dgn Division: HIGHWAY Date: 3/21/2023 Username: Eytayo.AdandeKinti

Filename: ... \003_Special Details- Culvert Sliplining.dwg Division: HIGHWAY
 Username: Eytayo.Adankikini Date: 4/8/2022

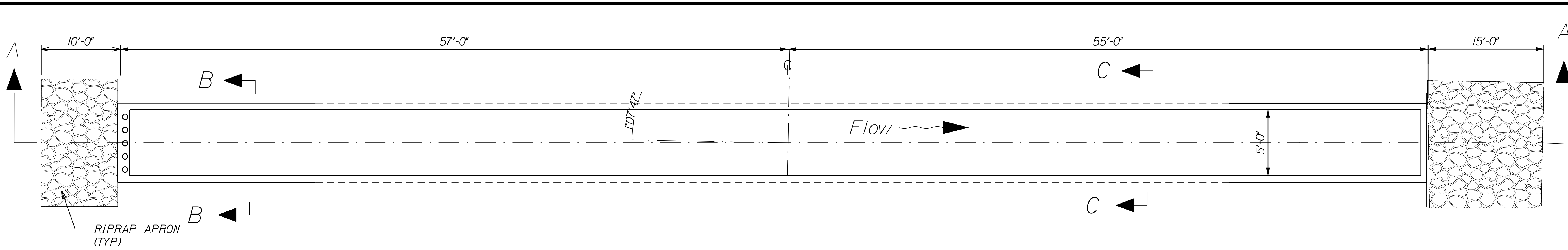

PLAN

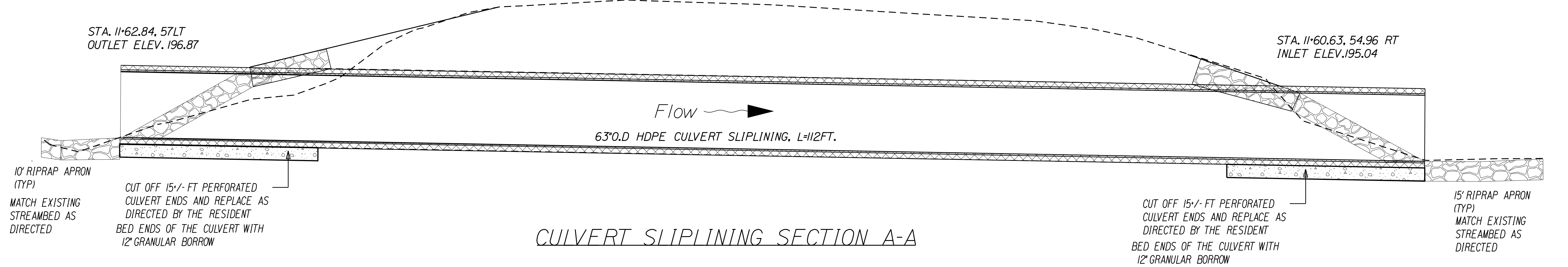

CULVERT SLIPLINING SECTION A-A

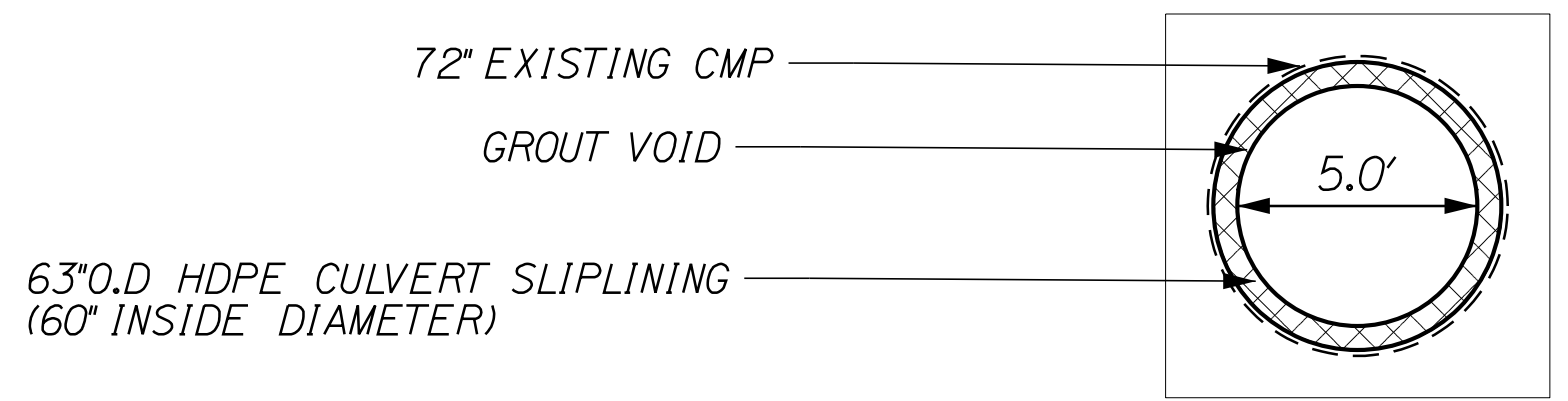

CULVERT SLIPLINING SECTION C-C

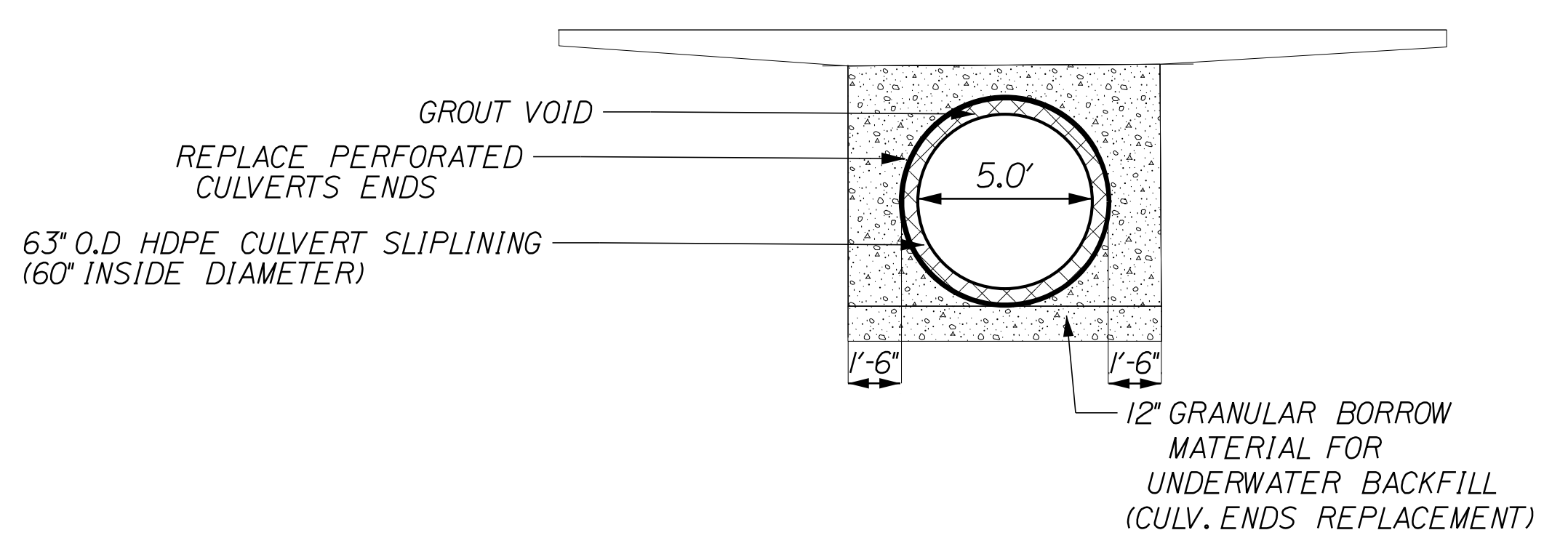

CULVERT SLIPLINING SECTION B-B

CULVERT SLIPLINING

1. THE END STRUCTURE UNITS SHALL BE DESIGNED TO CARRY CONSTRUCTION LOADINGS WITH A MINIMUM FILL COVER OF 18" OVER THE TOP OF THE UNITS.
2. THE CONSTRUCTION, HANDLING, AND ASSEMBLY OF THE CULVERT UNITS SHALL BE IN ACCORDANCE WITH STANDARD SPECIFICATION SECTION 502 CULVERT SLIPLINING, AND WITH THE MANUFACTURER'S SPECIFICATIONS AS APPLICABLE.
3. THE PIPE ENDS PIPE SHALL BE BEDDED ON A 1-FOOT LAYER OF COMPACTED GRANULAR BORROW MATERIAL FOR UNDERWATER BACKFILL.
4. COFFERDAMS ARE TO BE PLACED AT BOTH THE DOWNSTREAM AND UPSTREAM ENDS OF THE STRUCTURE PIPE TO ALLOW CONSTRUCTION OF THE CULVERT IN DRY.
5. THE FENCE SHALL BE CAREFULLY REMOVED FROM ITS EXISTING LOCATION AND REINSTALLED AT THE SAME LOCATION AT THE END OF THE CONSTRUCTION IN ACCORDANCE WITH THE SPECIFICATION SECTION 607. THE ACCEPTED WORK WILL BE PAID FOR WITH RENTAL ITEMS.

NOT TO SCALE

STATE OF MAINE DEPARTMENT OF TRANSPORTATION		25391.00	
AUBURN ROUTE 202		WIN 25391.00	
SPECIAL DETAILS CULVERT SLIPLINE		HIGHWAY PLANS	
PROJ. MANAGER	DATE	SIGNATURE	P.E. NUMBER
DESIGN-DETAILED	BY	DATE	DATE
CHECKED-REVIEWED	BY	DATE	DATE
DESIGN-DETAILED	BY	DATE	DATE
REVISIONS 1	BY	DATE	DATE
REVISIONS 2	BY	DATE	DATE
REVISIONS 3	BY	DATE	DATE
REVISIONS 4	BY	DATE	DATE
FIELD CHANGES	BY	DATE	DATE
SHEET NUMBER		3	
		OF 7	

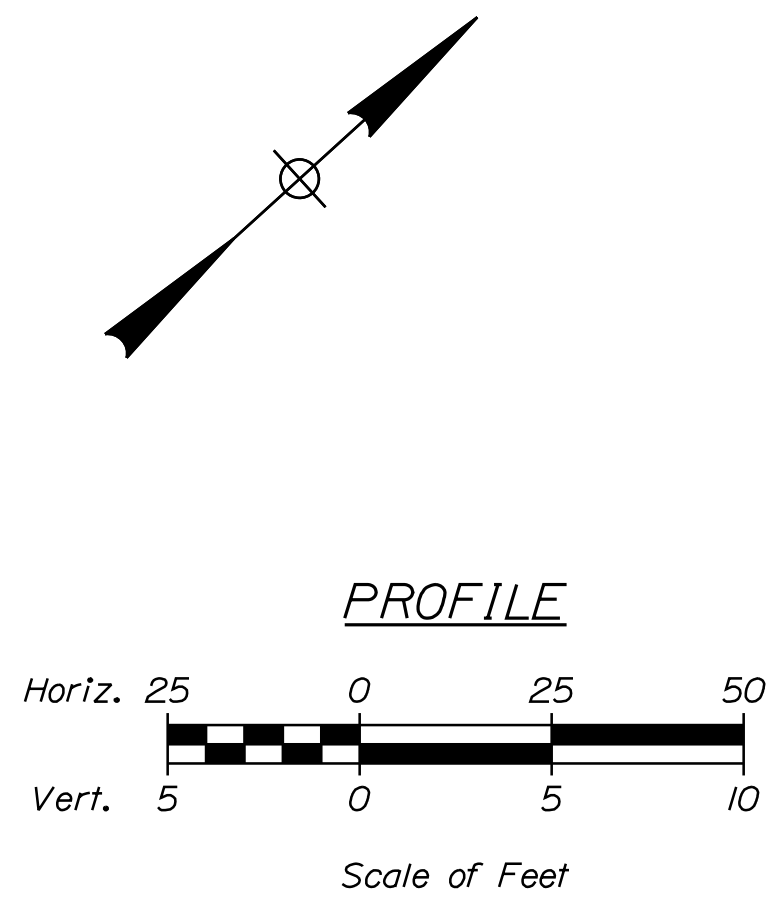
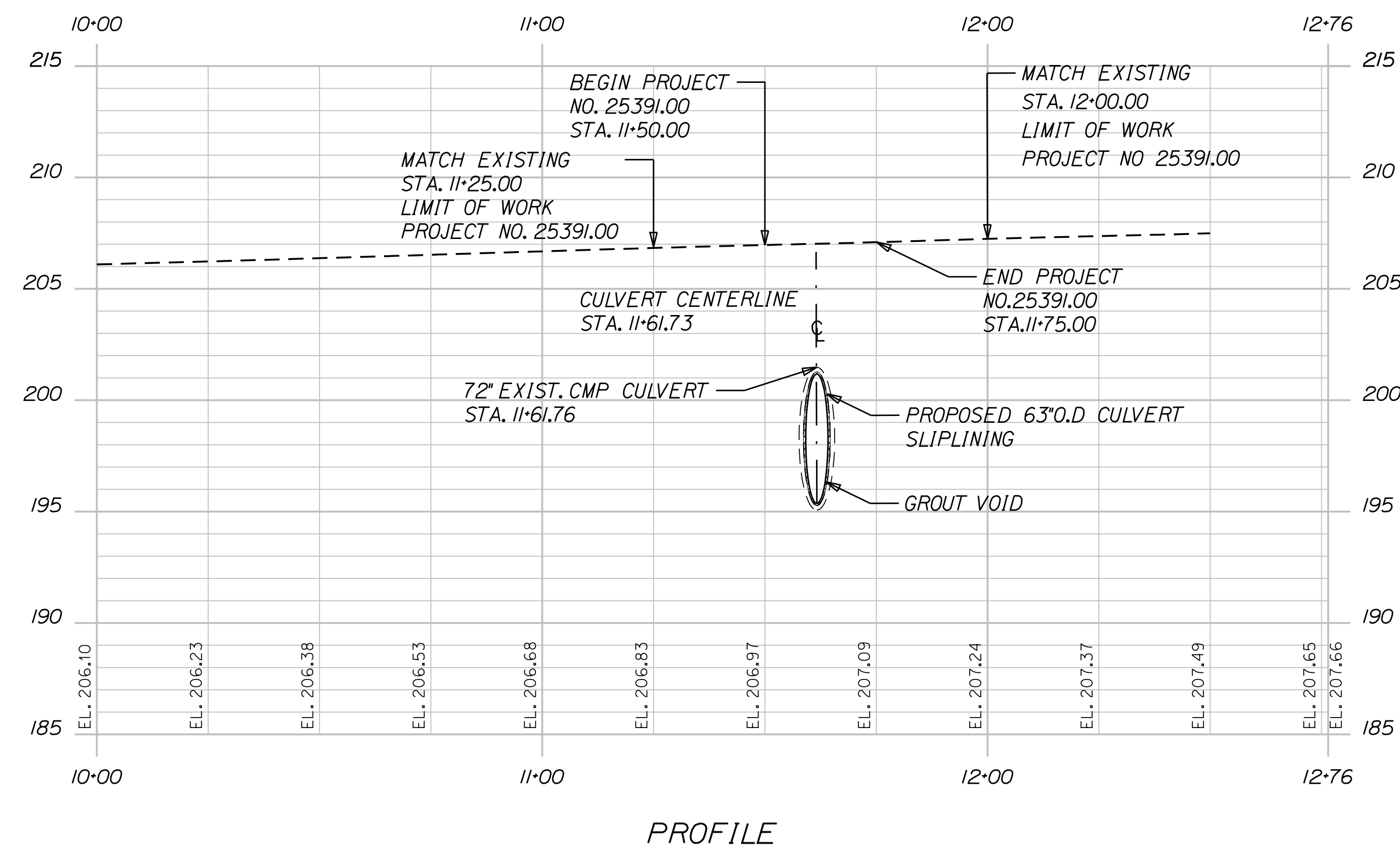
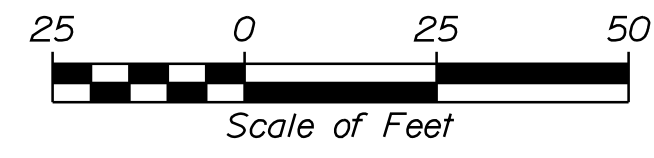
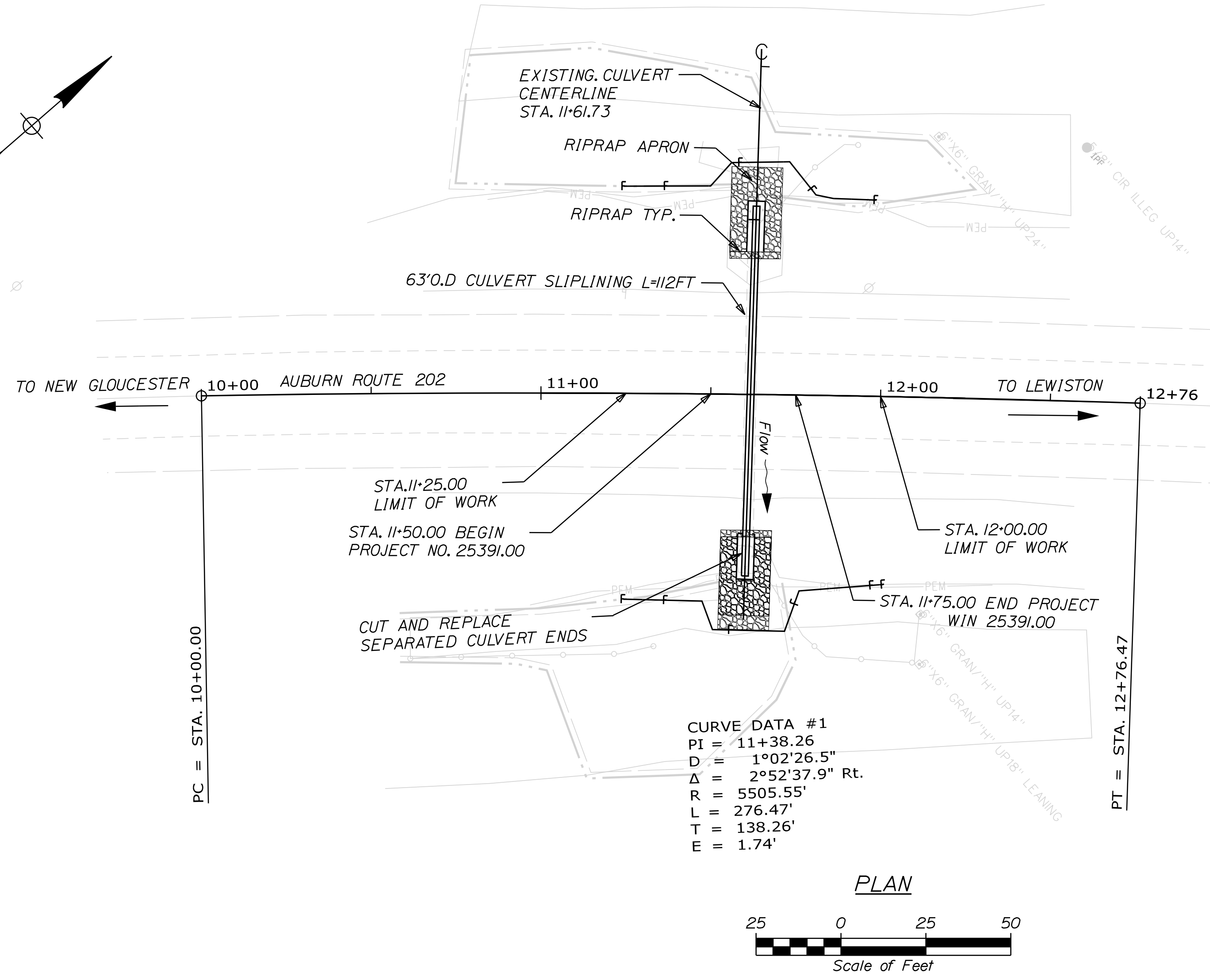
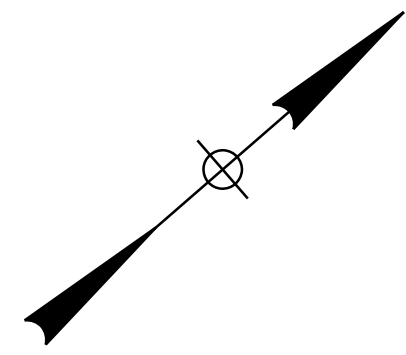

STATE OF MAINE
DEPARTMENT OF TRANSPORTATION
025391.00
WIN
25391.00
HIGHWAY PLANS

DESIGN-DETAILED	BY	DATE	SIGNATURE	P.E. NUMBER	DATE
CHECKED-REVIEWED	LARRY ADK				
DESIGN-DETAILED2					
DESIGN-DETAILED3					
REVISIONS 1					
REVISIONS 2					
REVISIONS 3					
REVISIONS 4					
FIELD CHANGES					

**AUBURN
ROUTE 202**

PLAN / PROFILE

SHEET NUMBER
4
OF 7

Filename: ... \HIGHWAY\MSTAN007_RWPLAN1.dgn Division: HIGHWAY Username: Eytayo.Adondekinti Date: 4/8/2022

<p>Town, County, State _____</p> <p>Approx. Property Lines _____ P.L.</p> <p>Existing Right of Way _____</p> <p>Limits of Wrought Portion _____ L.O.W.P.</p> <p>Control Of Access _____ C.O.A.</p> <p>New Right of Way _____</p> <p>New Easement _____</p> <p>New Temporary Rights _____</p> <p>New R/W Within Existing R/W _____</p>	<p>PLAN LEGEND</p> <table border="0"> <tr> <td>Existing</td> <td>Proposed</td> </tr> <tr> <td>Sanitary Sewer</td> <td>Telephone Line</td> </tr> <tr> <td>Electric Line</td> <td>Travelled Way</td> </tr> <tr> <td>Water Line</td> <td>Ditch</td> </tr> <tr> <td>Underdrain Line</td> <td>Catch Basin</td> </tr> <tr> <td>Gas Line</td> <td>Manhole</td> </tr> <tr> <td>Guardrail</td> <td>Sewer Manhole</td> </tr> <tr> <td>Culvert</td> <td>Utility Pole</td> </tr> <tr> <td></td> <td>Fire Hydrant</td> </tr> <tr> <td></td> <td>Curbing</td> </tr> </table>	Existing	Proposed	Sanitary Sewer	Telephone Line	Electric Line	Travelled Way	Water Line	Ditch	Underdrain Line	Catch Basin	Gas Line	Manhole	Guardrail	Sewer Manhole	Culvert	Utility Pole		Fire Hydrant		Curbing	<table border="0"> <tr> <td>Cut Line</td> <td>Fill Line</td> </tr> <tr> <td>Stonewall</td> <td>Retaining Wall</td> </tr> <tr> <td>Baseline</td> <td>10+00</td> <td>11+00</td> <td>12+00</td> </tr> <tr> <td>Monument</td> <td>Iron Rod Found</td> <td>Replacement Pin Set</td> <td>Traverse Point</td> <td>Pipe Found</td> </tr> </table>	Cut Line	Fill Line	Stonewall	Retaining Wall	Baseline	10+00	11+00	12+00	Monument	Iron Rod Found	Replacement Pin Set	Traverse Point	Pipe Found	<p>THIS PLAN WAS PREPARED IN CONNECTION WITH THE DEPARTMENT'S ACQUISITION OF REAL PROPERTY FOR TRANSPORTATION PURPOSES. IT CANNOT BE USED TO ESTABLISH LEGAL BOUNDARIES BETWEEN ABUTTING PROPERTY OWNERS.</p> <div style="text-align: center;"> <p>Scale of Feet</p> </div>	<p>STATE OF MAINE REGISTRY OF DEEDS</p> <p>COUNTY _____</p> <p>RECEIVED _____</p> <p>at _____ h _____ m _____ M and</p> <p>recorded in Plan Bk _____, Pg. _____</p> <p>Attest: _____ REGISTER</p>
Existing	Proposed																																				
Sanitary Sewer	Telephone Line																																				
Electric Line	Travelled Way																																				
Water Line	Ditch																																				
Underdrain Line	Catch Basin																																				
Gas Line	Manhole																																				
Guardrail	Sewer Manhole																																				
Culvert	Utility Pole																																				
	Fire Hydrant																																				
	Curbing																																				
Cut Line	Fill Line																																				
Stonewall	Retaining Wall																																				
Baseline	10+00	11+00	12+00																																		
Monument	Iron Rod Found	Replacement Pin Set	Traverse Point	Pipe Found																																	

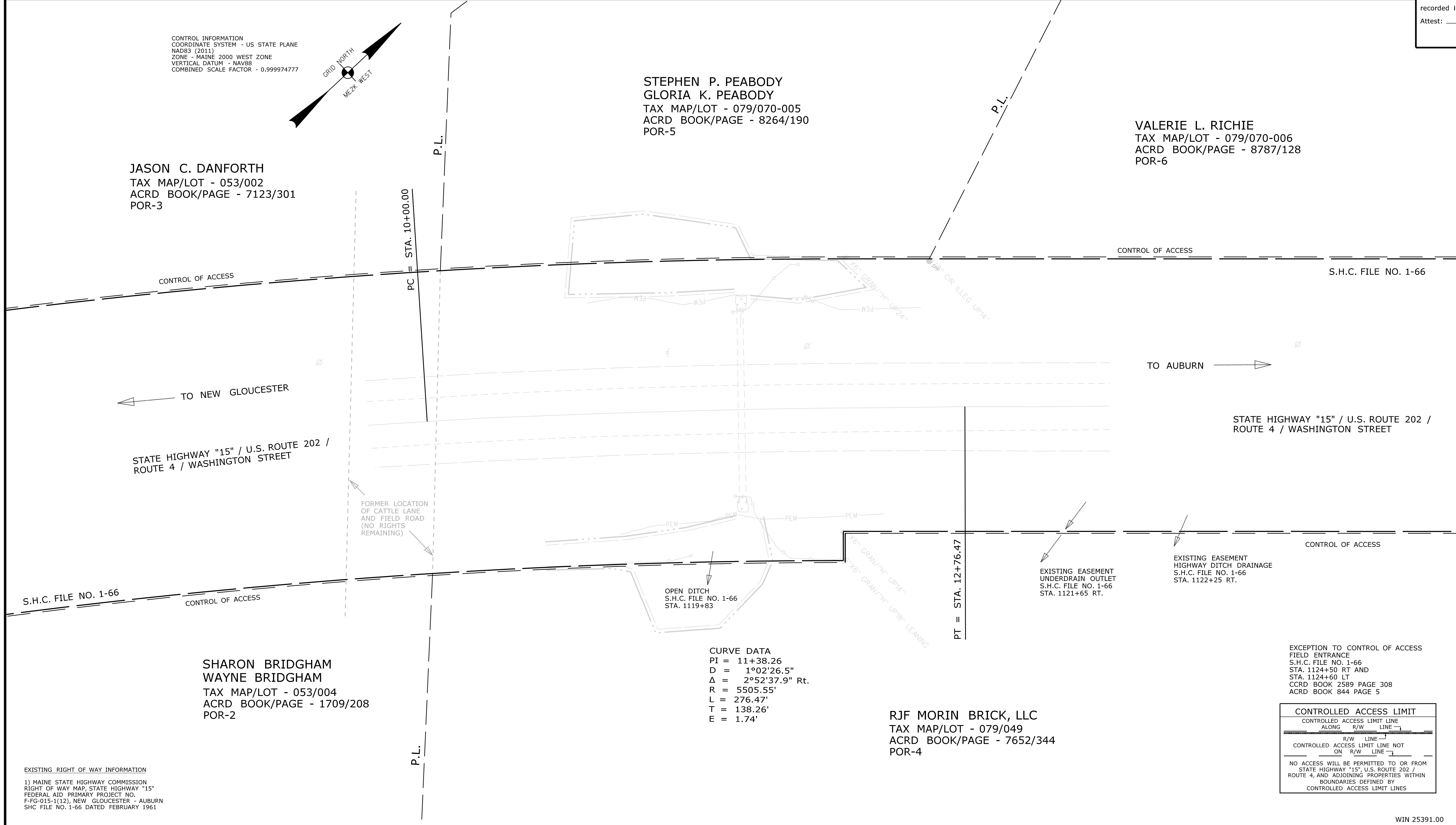

PRELIMINARY PLAN

ITEM	CONDITION	PLAN	TECH	CHECKED
EXISTING	RIGHT OF WAY	AREAS	GWA	CWK

STATE OF MAINE
DEPARTMENT OF TRANSPORTATION
16 STATE HOUSE STATION - AUGUSTA, ME 04333-0016 - 207-624-3460
AUBURN
RIGHT OF WAY MAP

NO.	DATE	REVISIONS DESCRIPTION	BY	PLAN FILED IN PLAN BOOK	PAGE	COUNTY RECORD	DATE	BOOK	PAGE	BRUCE A. VAN NOTE
										COMMISSIONER JOYCE NOEL TAYLOR CHIEF ENGINEER
										DATE

STATE HIGHWAY "15"
U.S. ROUTE 202 / ROUTE 4 / WASHINGTON STREET
AUBURN
ANDROSCOGGIN COUNTY
STATE PROJECT NO. 25391.00

SHEET NUMBER
7
OF 7

JANUARY 2022	RIGHT-OF-WAY MAP	DOT FILE NO. TBD
SCALE 1" = 25'	SHEET 1 OF 1	

WIN 25391.00