

PLAN LEGEND		
Town, County, State	-----	
Property Lines	-----	
R/W Lines-Existing	-----	
R/W Lines-Proposed	-----	
Culvert-Existing	-----	
Culvert Proposed	-----	
Curbing	Existing Proposed	
Type 1	-----	
Type 3	-----	
Type 5	-----	
Outline of Bodies of Water	-----	
Exposed Bedrock	-----	
Buildings	-----	
Trees	Conifer Deciduous	
Tree Line	-----	
Clearing Limit Line	-----	
Railroad	-----	
Catch Basins	Existing Proposed	
Manholes	Existing Proposed	
Proposed Underdrain	-----	
Proposed Ditch	-----	
Existing Ditch	-----	
Utility Poles	Existing Proposed	
Fire Hydrants	Existing Proposed	
Existing Water Line	-----	
Existing San. Sewer	-----	
Existing San. Sewer Manhole	-----	
Guardrail-Existing	-----	
Guardrail-Proposed	-----	
Guardrail-Cable, Other	-----	
Centerline-Existing	-----	
Centerline-Proposed	-----	
Travelway-Existing	-----	
Travelway-Proposed	-----	
Boring	HB-XXX-###	
Pavement Core	PC-#	
Test Pit	TP-XXX-###	
Probe	P-#.X	
	#.# = Depth	
	X = W (Weathered Rock)	
	R (Refusal)	
	NR (No Refusal)	

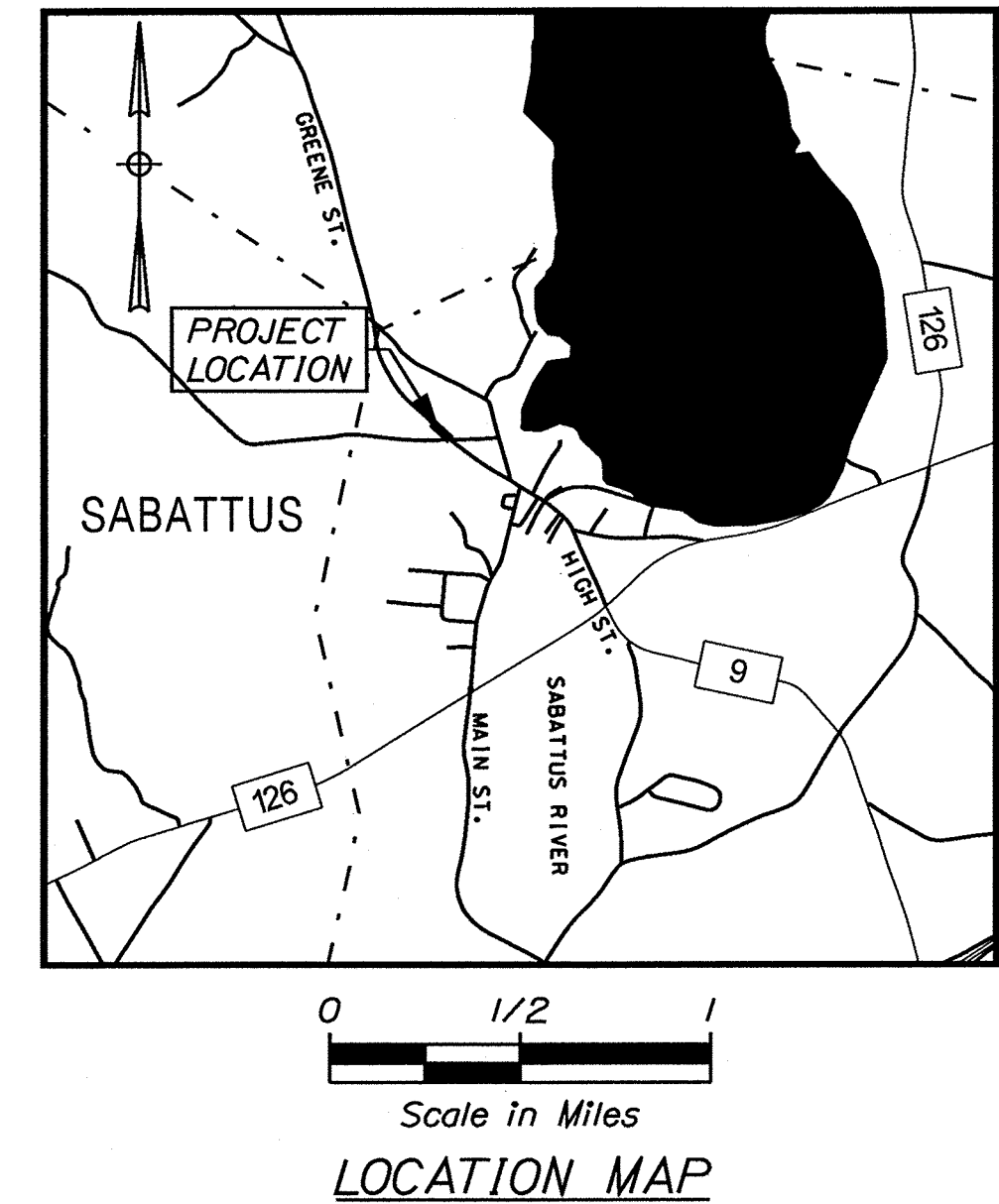

TRAFFIC DATA	
GREENE STREET (12/20 YEAR)	
Current (2023) AADT	1560
Future (2035/2043) AADT	1650/1720
DHV - % of AADT	13%
Design Hour Volume	215/224
% Heavy Trucks (AADT)	7%
% Heavy Trucks (DHV)	2%
Directional Distribution (DHV)	64%
18 kip Equivalent P 2.0	29/31
18 kip Equivalent P 2.5	28/30
Design Speed (mph)	25 MPH
Functional Class	Major Collector
Corridor Priority	4

STATE OF MAINE
DEPARTMENT OF TRANSPORTATION



SABATTUS
ANDROSCOGGIN COUNTY

GREENE STREET

WIN 24353.00

PROJECT LENGTH : 0.02 MILES

DRAINAGE IMPROVEMENTS

STA. 101+12.75
LIMIT OF WORK
MATCH EXISTING

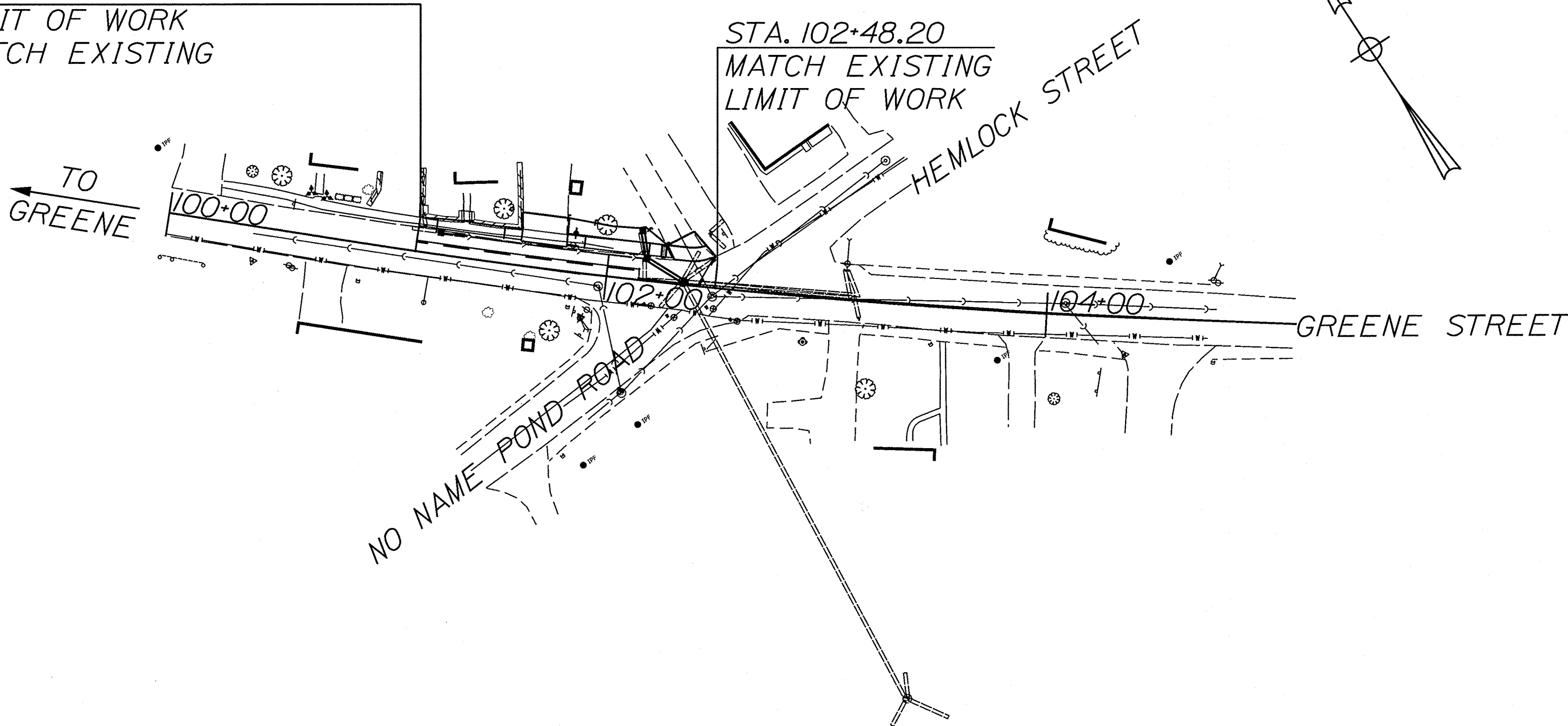

PLAN

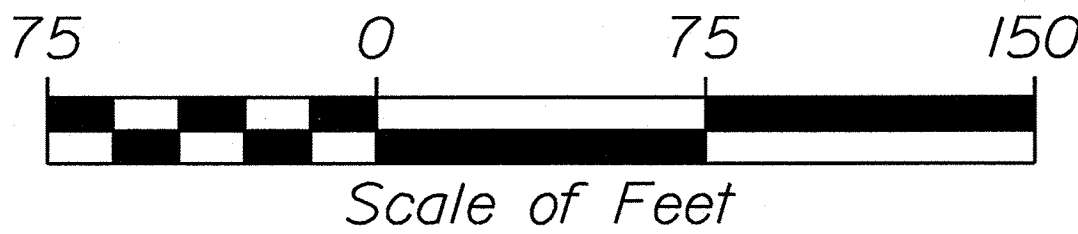

INDEX OF SHEETS	
Description	Sheet No.
Title Sheet	1
Typical Sections	2
Drainage Summary	3
General Notes	4
Construction Notes and Estimated Quantities	5
Plan/Profile	6
Cross Sections	7-8

PROJECT LOCATION:	Beginning approximately 200 feet west of Hemlock Street and extending east 0.02 miles to Hemlock Street.
PROGRAM AREA:	Regional Program
SCOPE OF WORK:	Drainage Improvements

STATE OF MAINE DEPARTMENT OF TRANSPORTATION	APPROVED	DATE
COMMISSIONER: [Signature]	6-28-24	6-28-24
CHIEF ENGINEER: [Signature]		



SIGNATURE	P.E. NUMBER	DATE
[Signature]	16231	6/26/24

PROJECT INFORMATION	
PROGRAM	REGIONAL
PROJECT MANAGER	R. HODGMAN
DESIGNER	
CONSULTANT	
PROJECT RESIDENT	
CONTRACTOR	
PROJECT COMPLETION DATE	

SABATTUS DRAINAGE IMPROVEMENTS
TITLE SHEET

SHEET NUMBER
1
OF 8

WIN 24353.00

- NOTES:
- THE PAVEMENT AND SUBBASE DEPTHS SHOWN ON THE PLANS ARE INTENDED TO BE NOMINAL.
 - WHEN SUPERELEVATION EXCEEDS THE SLOPE OF THE LOW SIDE SHOULDER, THE LOW SIDE SHOULDER SHALL HAVE THE SAME SLOPE AS THE TRAVELWAY.
 - CROSS SLOPES FOR BOTH NORMAL AND SUPERELEVATED SECTIONS FOR ALL COURSES OF SUBBASE AND PAVEMENT SHALL BE STRAIGHT.
 - THE STATIONING UNDER EACH TYPICAL IS APPROXIMATE.
 - PAVEMENT AND GRAVEL DEPTH WITHIN PROPOSED CROSS TRENCH AREAS SHALL MATCH THE TYPICAL SECTIONS OR SHALL MATCH THE EXISTING PAVEMENT AND GRAVEL DEPTH, WHICHEVER IS GREATER.

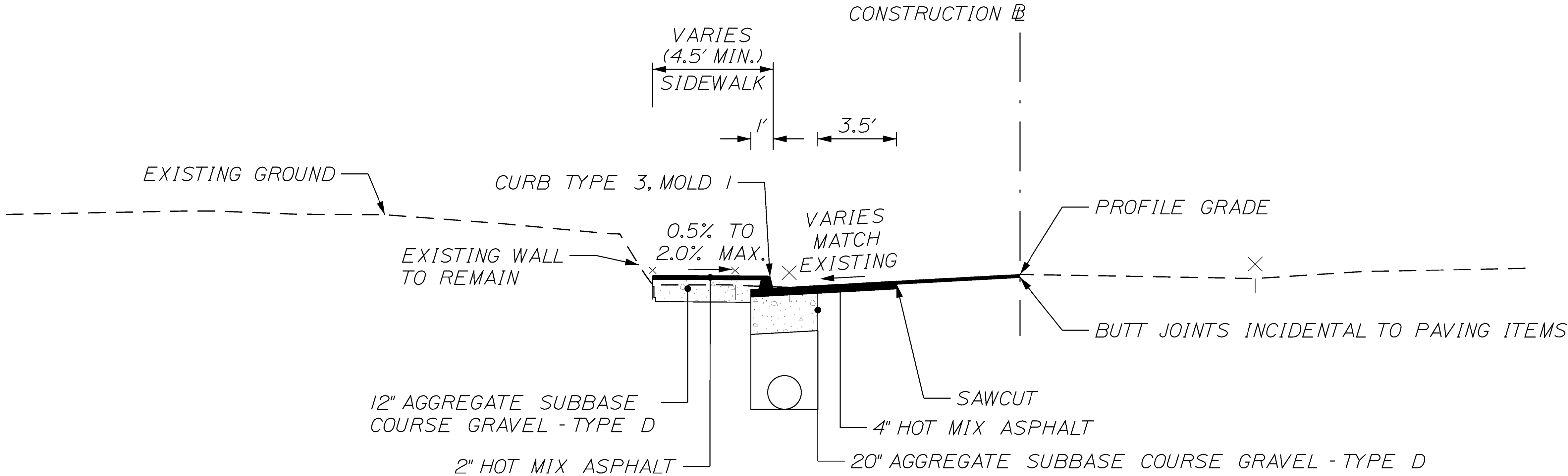

GREENE STREET
TYPICAL SECTION
STA. 101+13 TO STA. 102+48

STATE OF MAINE		DEPARTMENT OF TRANSPORTATION	
024353.00		WIN 024353.00	
HIGHWAY PLANS			
SABATTUS DRAINAGE IMPROVEMENTS		SHEET NUMBER	
TYPICALS SECTIONS		2	
OF 8			
PROJ. MANAGER	R. HOODMAN	BY	DATE
CHECKED-REVIEWED			MARCH 2022
DESIGN-DETAILED			SIGNATURE
DESIGN-DETAILED			P.E. NUMBER
REVISIONS 1			DATE
REVISIONS 2			
REVISIONS 3			
REVISIONS 4			
FIELD CHANGES			

GENERAL NOTES:

1. PAVEMENT THICKNESSES SHOWN ON THE TYPICAL SECTIONS ARE INTENDED TO BE NOMINAL.

2. CONTRACTOR SHALL CONSTRUCT ALL SIDEWALKS, RAMPS AND LANDINGS TO BE ADA COMPLIANT IN ACCORDANCE WITH THE MAINEDOT'S LATEST STANDARD DETAILS AND RELATED NOTES. THESE STANDARD DETAILS AND NOTES APPLY TO ALL SIDEWALK TYPES (BITUMINOUS, CONCRETE, BRICK, ETC). CONTRACTOR SHALL VERIFY THAT ALL GRADES AND SLOPES ARE ADA COMPLIANT PRIOR TO PLACEMENT OF THE SURFACE MATERIAL AND SHALL COORDINATE WITH THE DEPARTMENT ON ANY NON-COMPLIANT LOCATIONS (PRIOR TO PLACEMENT OF SURFACE MATERIAL). CONTRACTOR SHALL ALSO VERIFY THAT ALL GRADES AND SLOPES ARE ADA COMPLIANT AFTER PLACEMENT OF THE SURFACE MATERIAL. FAILURE TO CONSTRUCT SIDEWALKS, RAMPS AND LANDINGS TO BE ADA COMPLIANT WITHOUT EXCEPTION DOCUMENTATION MAY RESULT IN REJECTION OF WORK BY THE DEPARTMENT. CONTRACTOR SHALL REBUILD ALL REJECTED WORK AREAS AT NO ADDITIONAL COST TO THE PROJECT. CONTRACTOR SHALL PLAN THE WORK ACCORDINGLY.

3. THE CONTRACTOR SHALL MAINTAIN PEDESTRIAN ACCESS AND RELATED ADA ACCOMMODATIONS THROUGH THE JOB SITE DURING CONSTRUCTION. PAYMENT SHALL BE INCIDENTAL TO ITEM 652.36 MAINTENANCE OF TRAFFIC CONTROL DEVICES.

4. DETECTABLE WARNING FIELDS SHALL BE 24 INCHES WIDE AND EXTEND THE FULL WIDTH OF THE RAMP OPENINGS. ACTUAL PAYMENT FOR ITEM 608.26 SHALL INCLUDE ANY CUTTING OF THE DETACTABLE WARNING FIELDS AND ALL CONCRETE WORK REQUIRED BY THE DETAILS.

5. ALL CLEARING SHALL BE CONSIDERED INCIDENTAL TO THE CONTRACT AND NO SEPARATE PAYMENT WILL BE MADE. THE ACTUAL LINES FOR CLEARING SHALL BE ESTABLISHED IN THE FIELD BY THE CONTRACTOR AS INDICATED ON THE PLANS AND APPROVED BY THE RESIDENT.

6. DRIVEWAY FILL SIDE SLOPES SHALL BE THE SAME AS THE FILL SIDE SLOPES WITHOUT GUARDRAIL UNLESS OTHERWISE NOTED ON THE PLANS.

7. ALL WASTE MATERIAL NOT USED ON THE PROJECT SHALL BE DISPOSED OF OFF THE PROJECT IN ACCEPTABLE WASTE AREAS REVIEWED BY THE RESIDENT. GRADING, SEEDING AND MULCHING OF WASTE AREAS SHALL BE CONSIDERED INCIDENTAL.

8. ALL JOINTS BETWEEN EXISTING AND PROPOSED HOT BITUMINOUS PAVEMENT SHALL BE SAWCUT AND VERTICAL AS NOTED OR DIRECTED.

9. ALL WORK TO CONFORM TO CURRENT MAINE DEPARTMENT OF TRANSPORTATION STANDARD SPECIFICATIONS AND STANDARD DETAILS, LATEST EDITION.

10. RESIDENTIAL PAVED ENTRANCES SHALL BE CONSTRUCTED WITH 2 INCHES OF HOT MIX ASPHALT AND 12 INCHES OF AGGREGATE SUBBASE COURSE GRAVEL.

11. GRAVEL ENTRANCES SHALL BE CONSTRUCTED WITH 14 INCHES OF AGGREGATE SUBBASE COURSE GRAVEL OR 11 INCHES OF AGGREGATE SUBBASE COURSE GRAVEL AND 3 INCHES OF UNTREATED AGGREGATE SURFACE COURSE UNLESS OTHERWISE NOTED IN THE PLANS OR DIRECTED BY THE RESIDENT.

12. A 3-FOOT PAVED LIP SHALL BE PLACED AT ALL UNPAVED ENTRANCES UNLESS OTHERWISE NOTED IN THE PLANS OR DIRECTED BY THE RESIDENT.

13. ALL PAVED WALKS SHALL BE CONSTRUCTED WITH 12 INCHES OF AGGREGATE SUBBASE COURSE GRAVEL AND 2 INCHES OF HOT MIX ASPHALT UNLESS OTHERWISE NOTED IN THE PLANS OR DIRECTED BY THE RESIDENT.

14. PAVEMENT CUT LINES SHALL BE NEAT, CLEAN AND STRAIGHT AS DIRECTED BY THE RESIDENT. PAYMENT FOR CUTTING OF EXISTING PAVEMENT SHALL BE INCIDENTAL TO 403 ITEMS.

15. ANY NECESSARY CLEANING OF EXISTING PAVEMENT PRIOR TO PAVING (OR MILLING) SHALL BE INCIDENTAL TO THE RELATED PAVING (OR MILLING) ITEMS. THIS INCLUDES KILLING AND REMOVAL OF ALL VEGETATIVE MATTER.

16. ANY NECESSARY FINE GRADING OR RECOMPACTION OF EXISTING GRAVEL SHALL NOT BE PAID FOR DIRECTLY AND SHALL BE CONSIDERED INCIDENTAL TO ITEM 304.10.

17. EXISTING CULVERTS AND CATCH BASINS WILL BE CLEANED AS DIRECTED BY THE RESIDENT UNDER THE APPROPRIATE PAY ITEMS.

18. NO EXISTING DRAINAGE SHALL BE ABANDONED, REMOVED OR PLUGGED WITHOUT PRIOR APPROVAL OF THE RESIDENT.

19. THE CULVERT SIZES SHOWN ON THE PLANS AND CROSS SECTIONS ARE FOR SMOOTH-LINE PIPES.

20. THE CULVERT SIZES SHOWN ON THE PLANS AND CROSS SECTIONS ARE FOR SMOOTH-LINED PIPES.

21. CATCH BASIN AND RIM ELEVATIONS NOTED ON THE PLANS ARE THE TOP OF GRATE ELEVATIONS AT THE CENTER OF THE GRATE. CATCH BASIN OFFSET LOCATIONS ARE MEASURED TO THE CENTER OF GRATE.

22. ANY NECESSARY CUTTING OF EXISTING PIPES TO FIT IN AREAS OF PROPOSED CATCH BASINS WILL NOT BE PAID FOR SEPARATELY AND WILL BE CONSIDERED INCIDENTAL TO STANDARD SPECIFICATIONS SECTION 604, MANHOLES, INLETS AND CATCH BASINS.

23. ANY NECESSARY CUTTING OR CORING OF EXISTING CATCH BASINS TO ALLOW FOR PROPOSED PIPE CONNECTIONS WILL NOT BE PAID FOR SEPARATELY AND WILL BE CONSIDERED INCIDENTAL TO STANDARD SPECIFICATIONS SECTION 603, PIPE CULVERTS AND STORM DRAINS OR STANDARD SPECIFICATIONS SECTION 605, UNDERDRAINS.

24. AT THE DIRECTION OF THE RESIDENT OR AS NOTED ON THE PLANS, INVERTS INTO AND OUT OF PROPOSED DRAINAGE STURCTURES WITH APPROXIMATE OR UNSPECIFIED INVERT INFORMATION SHALL BE CORED ON SITE TO ALLOW FOR FIELD ADJUSTMENT OF PROPOSED INVERTS TO MEET THE REQUIREMENTS OF THE FIELD CONDITIONS. PAYMENT FOR ON-SITE CORING OF PROPOSED CATCH BASINS SHALL BE INCIDENTAL TO 604 ITEMS.

25. ALL WORK SHALL BE DONE IN ACCORDANCE WITH THE MAINE DEPARTMENT OF TRANSPORTATION'S BEST MANAGEMENT PRACTICES FOR EROSION CONTROL & SEDIMENT CONTROL, LATEST EDITION.

26. BACKING UP BITUMINOUS OR CONCRETE SLIPFORM CURB IS INCIDENTAL TO THE CURB ITEMS. IN AREAS WHERE NEW BITUMINOUS OR CONCRETE SLIPFORM CURB IS DESIGNATED TO REPLACE EXISTING, THE REMOVAL OF THE OLD BITUMINOUS OR CONCRETE SLIPFORM CURB SHALL BE INCIDENTAL TO THE NEW CURB. IF CALLED FOR ON THE PLANS OR DIRECTED BY THE RESIDENT, LOAM OR DIRTY BORROW WILL BE PAID FOR SEPARATELY.

27. LOAM HAS BEEN ESTIMATED FOR DISTURBED LAWN AREAS. ACTUAL PLACEMENT OF THE LOAM SHALL BE AS NOTED ON THE PLANS OR DESIGNATED BY THE RESIDENT.

28. UNLESS OTHERWISE NOTED SEEDING METHOD NO. 1 SHALL BE UTILIZED ON ALL LAWNS AND DEVELOPED AREAS; SEEDING METHOD NO. 2 SHALL BE UTILIZED ON ALL OTHER AREAS.

29. LOAM SHALL BE PLACED TO A NOMINAL DEPTH OF 4 INCHES UNLESS OTHERWISE NOTED OR DIRECTED.

30. DRIVEWAY ACCESS SHALL BE MAINTAINED AT ALL TIMES.

31. CONTRACTOR SHALL NOT PARK, IMPEDE ACCESS, OR STORE EQUIPMENT/MATERIAL ON ADJACENT TOWN OR PRIVATELY OWNED LAND WITHOUT WRITTEN CONSENT FROM THE TOWN OR LAND OWNER.

32. THE CONTRACTOR WILL BE RESPONSIBLE FOR MAINTAINING ALL EXISTING MAILBOXES TO ENSURE THAT THE MAIL WILL BE DELIVERABLE. PAYMENT FOR THIS WORK WILL BE CONSIDERED INCIDENTAL TO THE CONTRACT.

33. IT IS THE CONTRACTOR'S RESPONSIBILITY TO FAMILIARIZE THEMSELVES WITH THE EXISTING CONDITIONS PRIOR TO BIDDING.

34. THE CONTRACTOR SHALL COMPLETE THE WORK WITHIN THE RIGHT-OF-WAY, AND WILL BE RESPONSIBLE IF THEY TRESPASS ON PRIVATE PROPERTY.

35. PROPERTY LINE AND R.O.W. MONUMENTS SHALL NOT BE DISTURBED BY CONSTRUCTION. IF DISTURBED, THEY SHALL BE RESET TO THEIR ORIGINAL LOCATIONS AT THE CONTRACTOR'S EXPENSE, BY A MAINE PROFESSIONAL LAND SURVEYOR.

36. ANY DAMAGE TO THE SLOPES CAUSED BY THE CONTRACTOR'S EQUIPMENT, PERSONNEL, OR OPERATION SHALL BE REPAIRED TO THE SATISFACTION OF THE RESIDENT. ALL WORK, EQUIPMENT, AND MATERIALS REQUIRED TO MAKE REPAIRS SHALL BE AT THE CONTRACTOR'S EXPENSE.

37. AREAS ON THE PROJECT REQUIRING FILL WILL COME FROM SUITABLE SITES SUCH AS EXCAVATION, DITCH AND INSLOPE OR EQUIPMENT RENTAL AREAS.

38. NO SEPARATE PAYMENT FOR SUPERINTENDENT OR FOREMAN WILL BE MADE FOR THE SUPERVISION OF EQUIPMENT AND LAYOUT OF WORK BEING PAID FOR UNDER THE EQUIPMENT RENTAL ITEMS.

39. "UNDETERMINED LOCATIONS" SHALL BE DETERMINED BY THE RESIDENT.

40. THE LOCATION OF THE EXISTING UTILITIES AND DRAINAGE SHOWN ON THE PLANS WERE COMPILED FROM FIELD SURVEY. LOCATIONS ARE APPROXIMATE AND NOT GUARANTEED TO BE ACCURATE, NOR IS IT GUARANTEED THAT ALL UTILITIES ARE SHOWN. NO SEPARATE OR ADDITIONAL COMPENSATION WILL BE ALLOWED TO THE CONTRACTOR DUE TO ANY VARIANCE BETWEEN THE DATA SHOWN ON THE PLANS AND THE ACTUAL FIELD CONDITIONS ENCOUNTERED.

41. PAYMENT FOR REMOVING AND RESETTNG OF EXISTING SIGNS SHALL BE INCIDENTAL TO ITEM 203.20 COMMON EXCAVATION.

STATE OF MAINE DEPARTMENT OF TRANSPORTATION	024353.00		WIN 024353.00		HIGHWAY PLANS	
SABATTUS DRAINAGE IMPROVEMENTS	PROJ. MANAGER	R. HOODMAN	BY	DATE	SIGNATURE	P.E. NUMBER
	CHECKED-DETAILED			MARCH 2022		
GENERAL NOTES	DESIGN-DETAILED					
	DESIGN-DETAILED					
	REVISIONS 1					
	REVISIONS 2					
	REVISIONS 3					
	REVISIONS 4					
	FIELD CHANGES					
SHEET NUMBER						
4						
OF 8						

DRIVEWAYS AND ENTRANCES		
STATION	DESCRIPTION	OPENING
101+70	LT. PAVED RESIDENTIAL ENTRANCE	21 FT
102+35	LT. GRAVEL RESIDENTIAL ENTRANCE	19 FT

ITEM 202.15 - REMOVE EXISTING MH OR CB
STATION
STA. 101+22.69, 10.1' LT.
STA. 102+16.67, 11.4' LT.

ITEM 609.21 - SLIPFORM CONCRETE CURB
STATION
STA. 101+13.00 TO 101+21.00, LT STA. 201+20.00 TO 201+36.00, RT
STA. 101+80.00 TO 102+29.00, LT

ITEM 608.26 - CURB RAMP DETECTABLE WARNING FIELD SF
102+25 LT. 12.0

Item	Item Description	Unit	Quantity
202.15	REMOVING MANHOLE OR CATCH BASIN	EA	2
203.20	COMMON EXCAVATION	CY	60
304.10	AGGREGATE SUBBASE COURSE - GRAVEL	CY	50
403.210	HOT MIX ASPHALT, 9.5 MM NOMINAL MAXIMUM SIZE	T	45
409.15	BITUMINOUS TACK COAT, APPLIED	G	10
603.132	8 INCH CULVERT PIPE OPTION III	LF	5
603.159	12 INCH CULVERT PIPE OPTION III	LF	10
603.179	18 INCH CULVERT PIPE OPTION III	LF	16
604.092	CATCH BASIN TYPE B1-C	EA	1
604.096	60" CATCH BASIN TYPE B1-C	EA	1
604.247	CATCH BASIN TYPE F5-C	EA	1
605.13	18 INCH UNDERDRAIN TYPE C	LF	90
608.26	CURB RAMP DETECTABLE WARNING FIELD	SF	12
609.21	CONCRETE SLIPFORM CURB	LF	95
615.07	LOAM	CY	12
618.13	SEEDING METHOD NUMBER 1	UN	1
619.12	MULCH	UN	1
631.32	CULVERT CLEANER (INCLUDING OPERATORS)	HR	4
652.33	DRUM	EA	5
652.34	CONE	EA	15
652.35	CONSTRUCTION SIGNS	SF	100
652.36	MAINTENANCE OF TRAFFIC CONTROL DEVICES	CD	10
652.38	FLAGGERS	HR	200
656.75	TEMPORARY SOIL EROSION AND WATER POLLUTION CONTROL	LS	1
659.10	MOBILIZATION	LS	1

SABATTUS
DRAINAGE IMPROVEMENTS
CONSTRUCTION NOTES AND
ESTIMATED QUANTITIES

SHEET NUMBER

5

OF 8

STATE OF MAINE
DEPARTMENT OF TRANSPORTATION

024353.00

WIN
024353.00
HIGHWAY PLANS

PROJ. MANAGER
DESIGN-DETAILED
CHECKED-REVIEWED
DESIGN-DETAILED
DESIGN-DETAILED
REVISIONS 1
REVISIONS 2
REVISIONS 3
REVISIONS 4
FIELD CHANGES

BY
R. HOODMAN

DATE
MARCH 2022

SIGNATURE

P.E. NUMBER

DATE

Date:6/20/2024

Username: Taylor.Hamilton

Division: HIGHWAY

Filename: ... \006_HDPlan01.dgn

\$FILE1\$

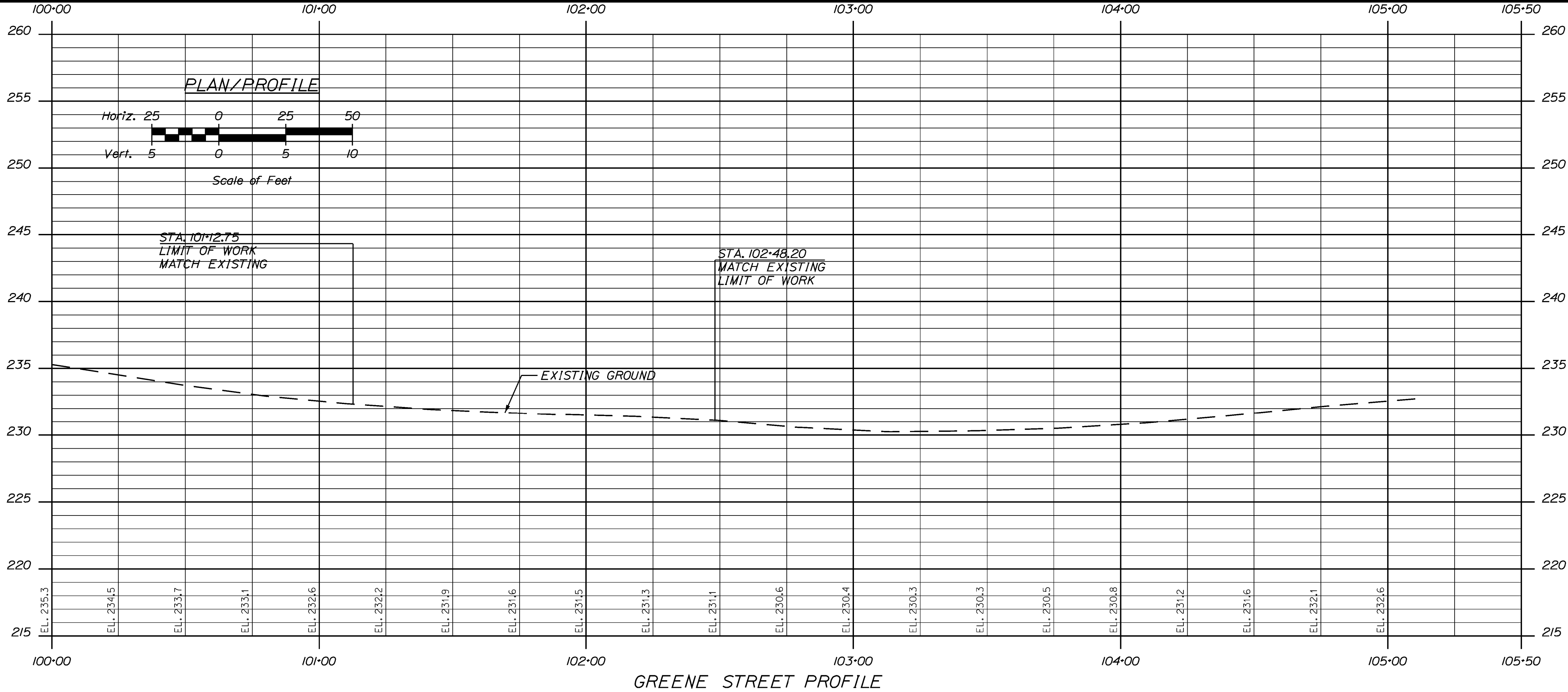
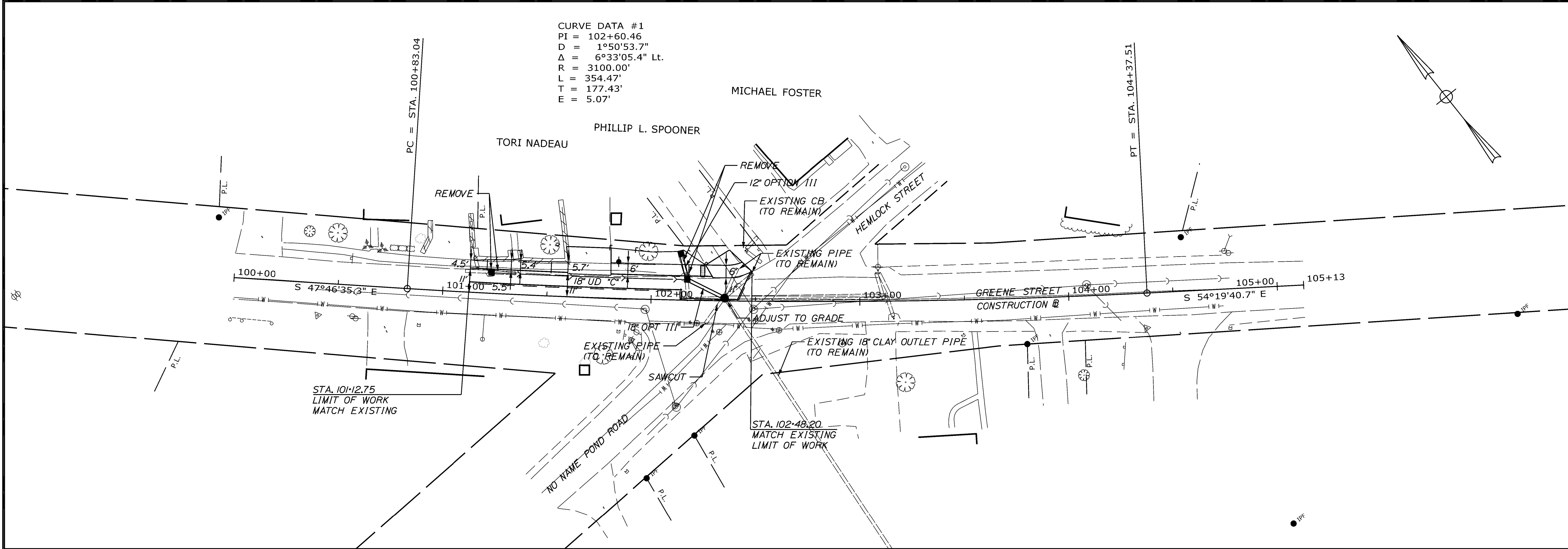

PROJ. MANAGER	BY	DATE	SIGNATURE
R. HOODMAN		MARCH 2022	
CHECKED-REVIEWED			P.E. NUMBER
DESIGN-DETAILED			DATE
DESIGN-DETAILED			
REVISIONS 1			
REVISIONS 2			
REVISIONS 3			
REVISIONS 4			
FIELD CHANGES			

\$FILES\$

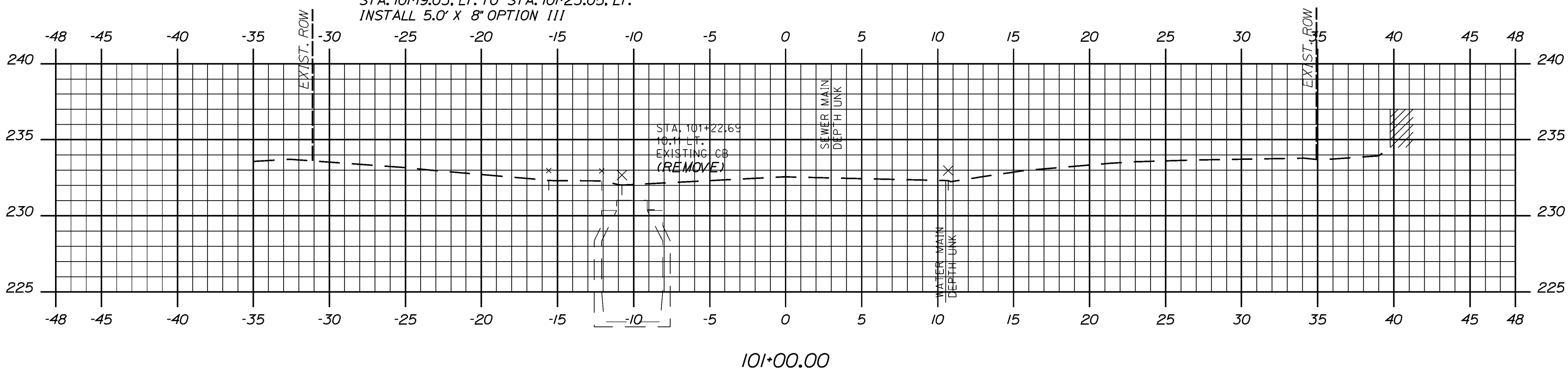
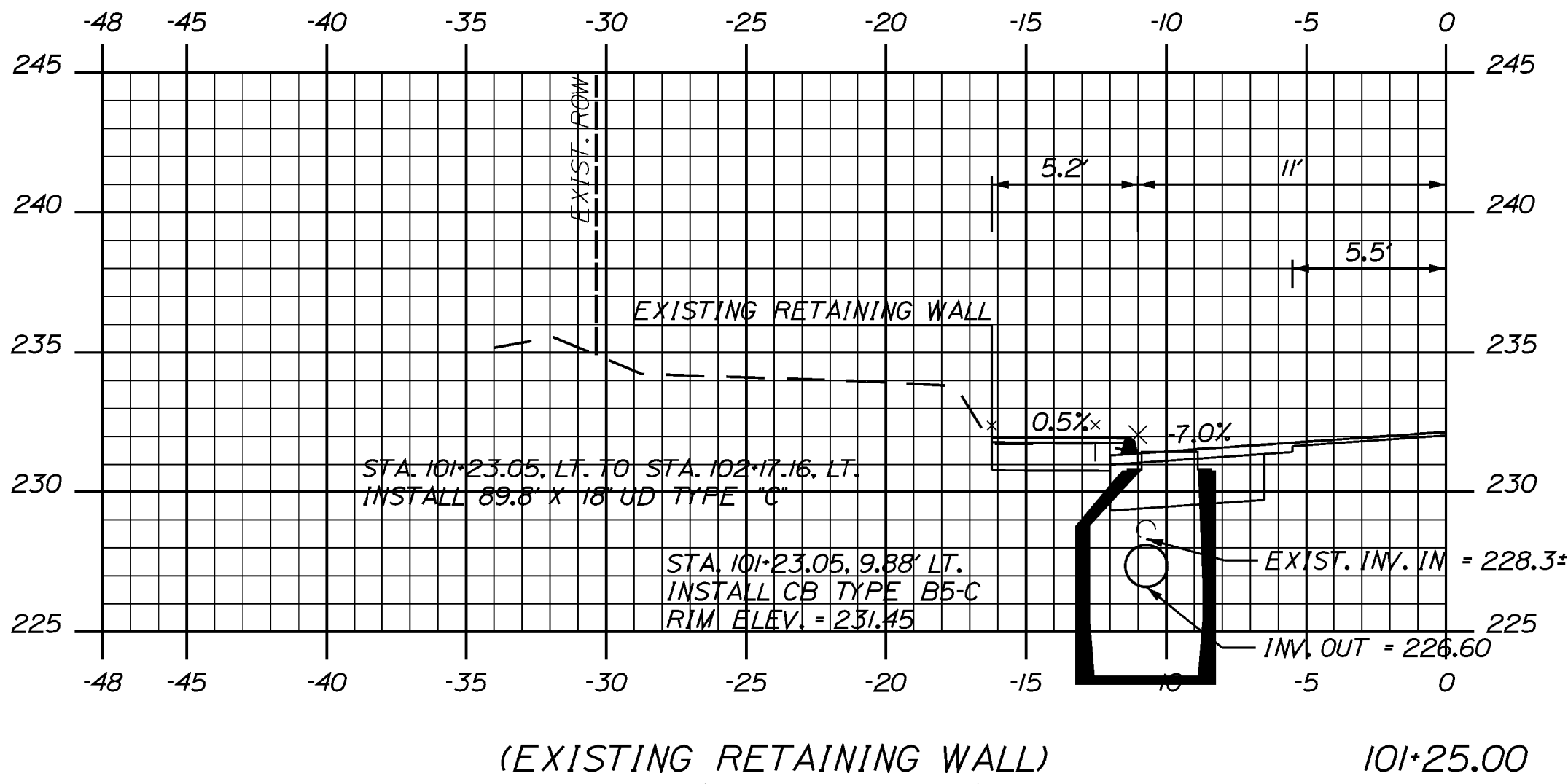
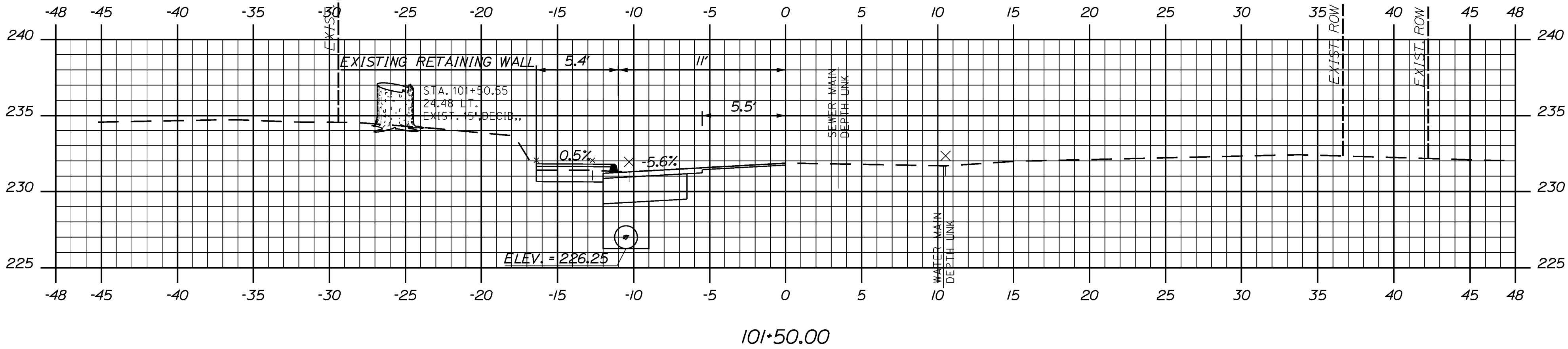
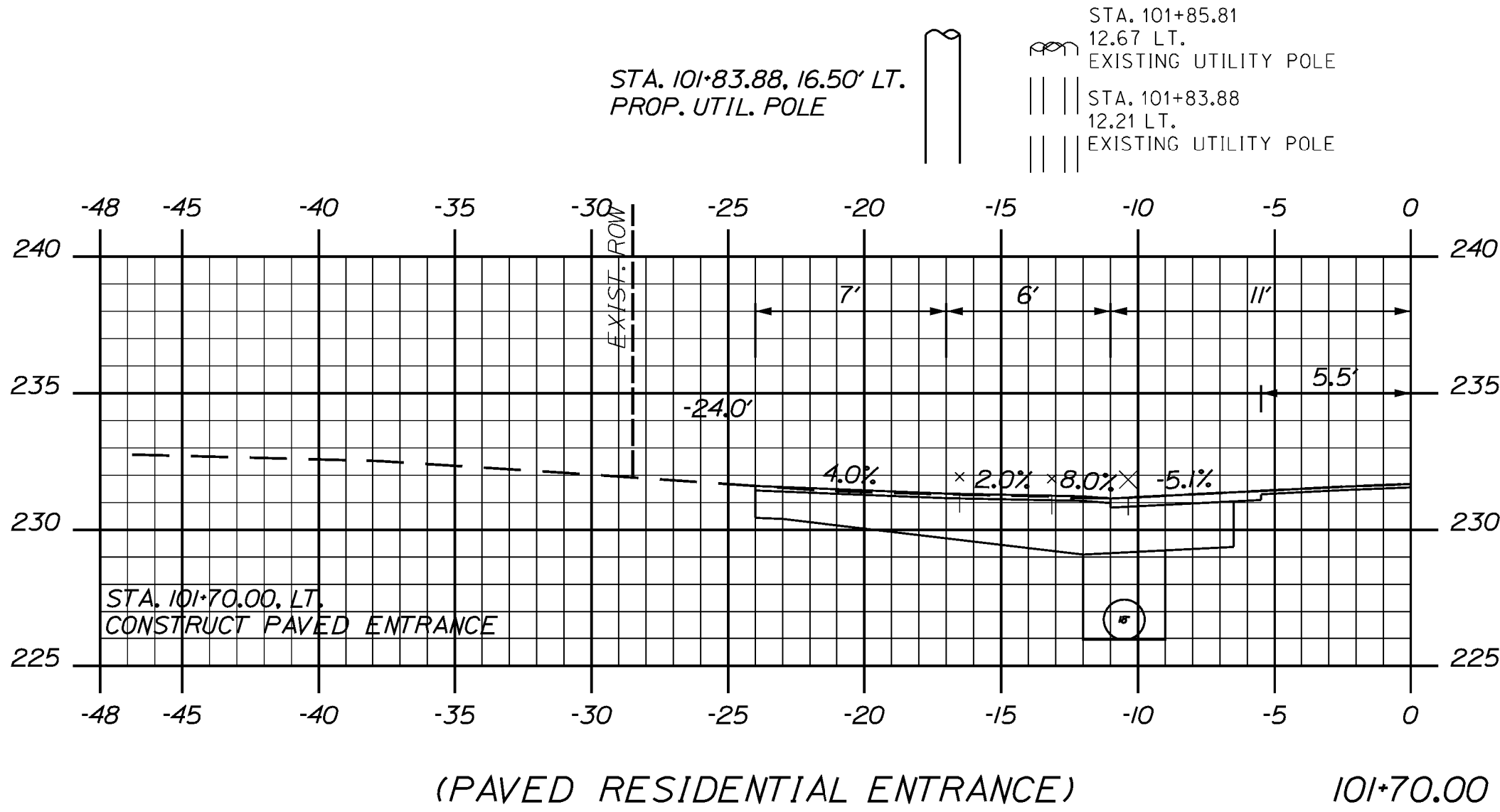
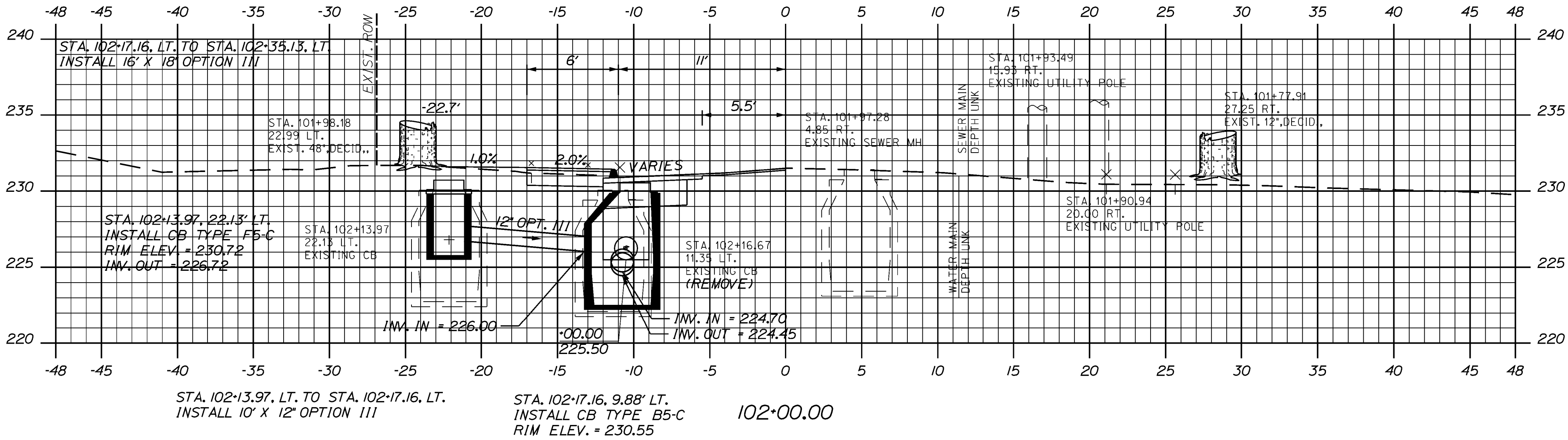

Sta. 101+00.00 to Sta. 102+00.00

OF 8	SHEET NUMBER	SABATTUS DRAINAGE IMPROVEMENTS	PROJ. MANAGER	R. HODGMAN	BY	DATE	SIGNATURE	STATE OF MAINE	
			DESIGN-DETAILED	-----	-----	MARCH 2022		DEPARTMENT OF TRANSPORTATION	
			CHECKED-REVIEWED	-----	-----	-----			
			DESIGN2-DETAILED2	-----	-----	-----			
			DESIGN3-DETAILED3	-----	-----	-----			
		CROSS SECTIONS	REVISIONS 1	-----	-----	-----	P.E. NUMBER	024353.00	
			REVISIONS 2	-----	-----	-----	DATE	WIN	
			REVISIONS 3	-----	-----	-----		024353.00	
			REVISIONS 4	-----	-----	-----		HIGHWAY PLAN	
			FIELD CHANGES	-----	-----	-----			

\$FILEL\$

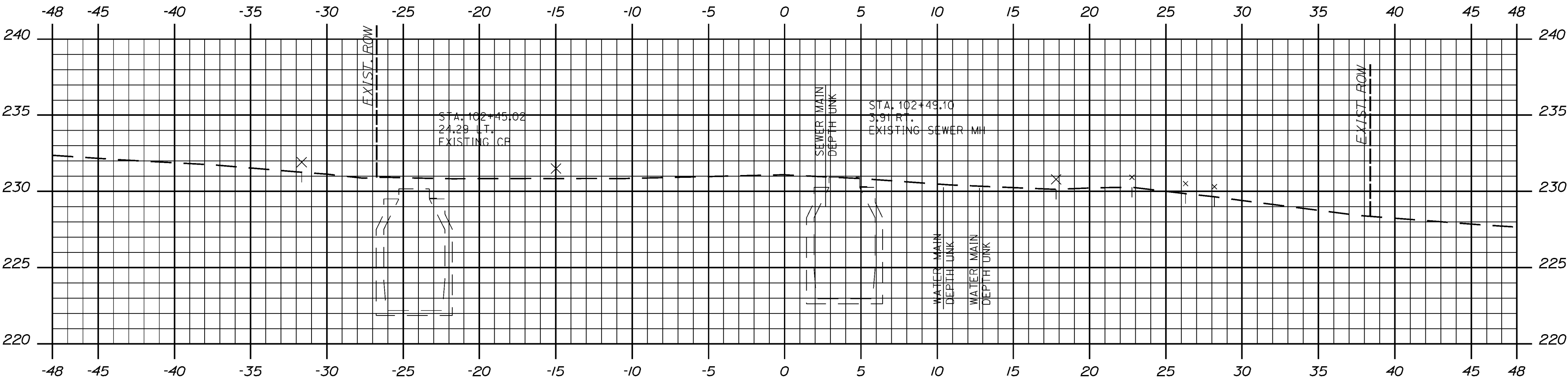

STA. 102+48.20
MATCH EXISTING
LIMIT OF WORK

102+50.00

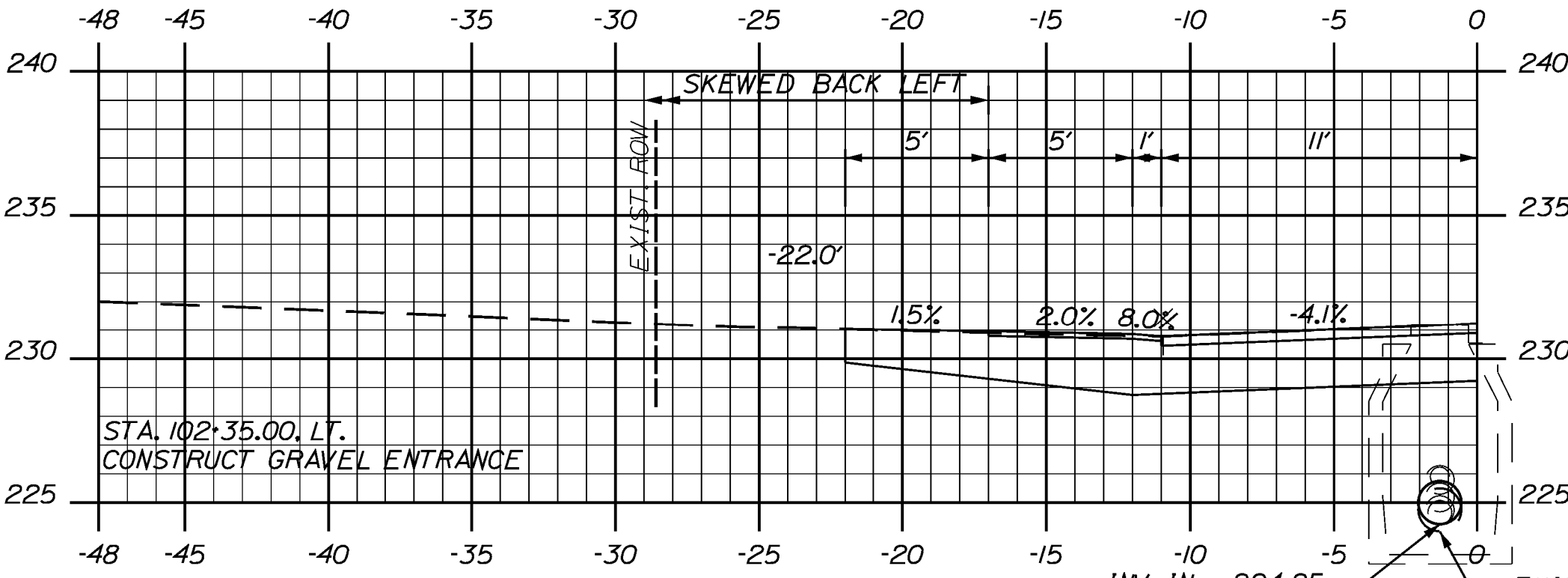

(GRAVEL RESIDENTIAL ENTRANCE)

102+35.00

Sta. 102+35.00 to Sta. 102+50.00

OF 8

8

SHEET NUMBER

SABATTUS
DRAINAGE IMPROVEMENTS

CROSS SECTIONS

PROJ. MANAGER	R. HODGMAN	BY	DATE
DESIGN-DETAILED	-----	-----	MARCH 2022
CHECKED-REVIEWED	-----	-----	-----
DESIGN2-DETAILED2	-----	-----	-----
DESIGN3-DETAILED3	-----	-----	-----
REVISIONS 1	-----	-----	-----
REVISIONS 2	-----	-----	-----
REVISIONS 3	-----	-----	-----
REVISIONS 4	-----	-----	-----
FIELD CHANGES	-----	-----	-----

SIGNATURE

P.E. NUMBER

DATE

STATE OF MAINE
DEPARTMENT OF TRANSPORTATION

024353.00

WIN
024353.00

HIGHWAY PLANS