

STATE OF MAINE DEPARTMENT OF TRANSPORTATION



SOUTH BRISTOL LINCOLN COUNTY ROUTE 129 FEDERAL PROJECT NO. 2425300 PROJECT LENGTH: 0.04 MILES

PLAN LEGEND

Town, County, State	Catch Basins	Existing	Proposed
Property Lines	Manholes	Existing	Proposed
R/W Lines-Existing	Proposed Underdrain		
R/W Lines-Proposed	Proposed Ditch		
Culvert-Existing	Existing Ditch		
Culvert Proposed	Utility Poles	Existing	Proposed
Curbing Existing	Fire Hydrants	Existing	Proposed
Type 1	Existing Water Line		
Type 3	Existing San. Sewer		
Type 5	Existing San. Sewer Manhole		
Outline of Bodies of Water	Guardrail-Existing		
Exposed Bedrock	Guardrail-Proposed		
Buildings	Guardrail-Cable, Other		
Trees Conifer	Centerline-Existing		
Tree Line	Centerline-Proposed		
Clearing Limit Line	Travelway-Existing		
Railroad	Travelway-Proposed		
Boring	Probe	P-#. #X	
Pavement Core		#.# = Depth	
Test Pit		X = W (Weathered Rock)	
		R (Refusal)	
		NR (No Refusal)	

INDEX OF SHEETS

Description	Sheet No.
Title Sheet	1
Typical Sections	2
General Notes and Estimated Quantities	3
Special Details	4
Boring Location Plan & Interpretive	
Subsurface Profile with Boring Logs	5
Plan and Profile	6
Cross Sections	7-16
Detour Plan	17
Right of Way Map	18

STATE OF MAINE DEPARTMENT OF TRANSPORTATION	APPROVED	DATE
COMMISSIONER:	<i>[Signature]</i>	10-28-22
CHIEF ENGINEER:	<i>[Signature]</i>	10-27-22

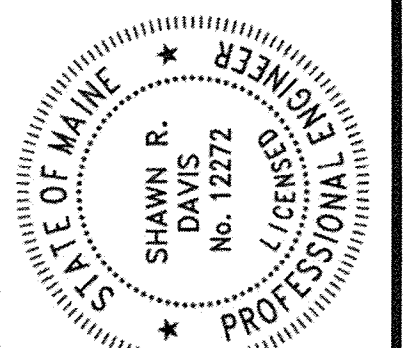

PROJECT INFORMATION	PROGRAM	HIGHWAY
PROJECT MANAGER	DOUG COOMBS	
DESIGNER	SHAWN DAVIS	
CONSULTANT	TYLIN	
PROJECT RESIDENT		
CONTRACTOR		
PROJECT COMPLETION DATE		

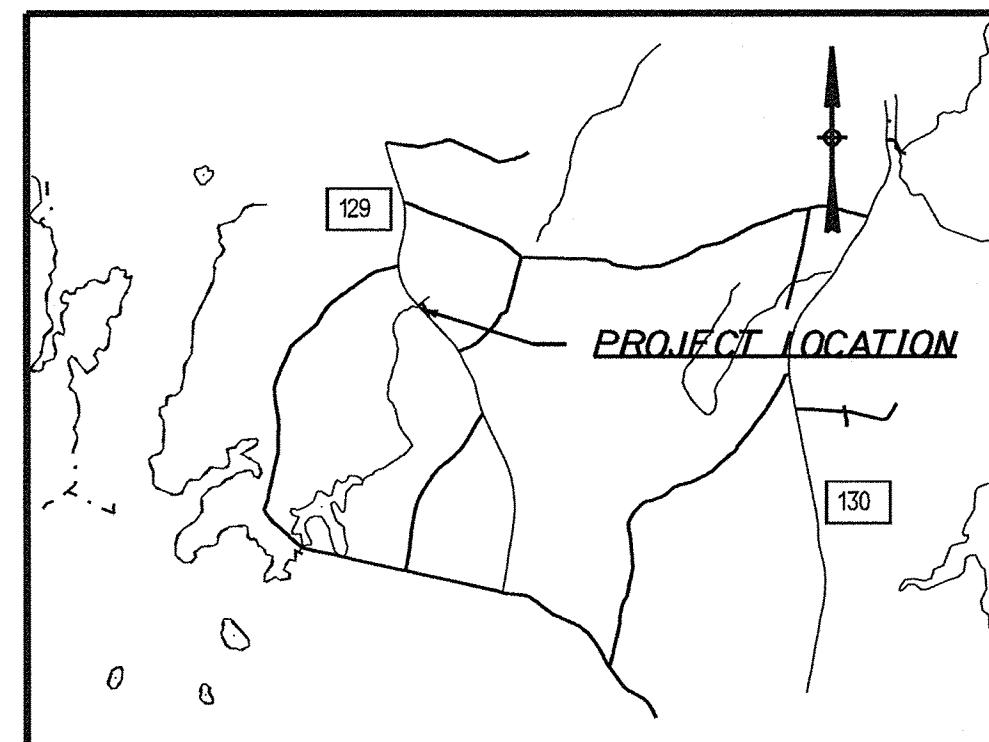
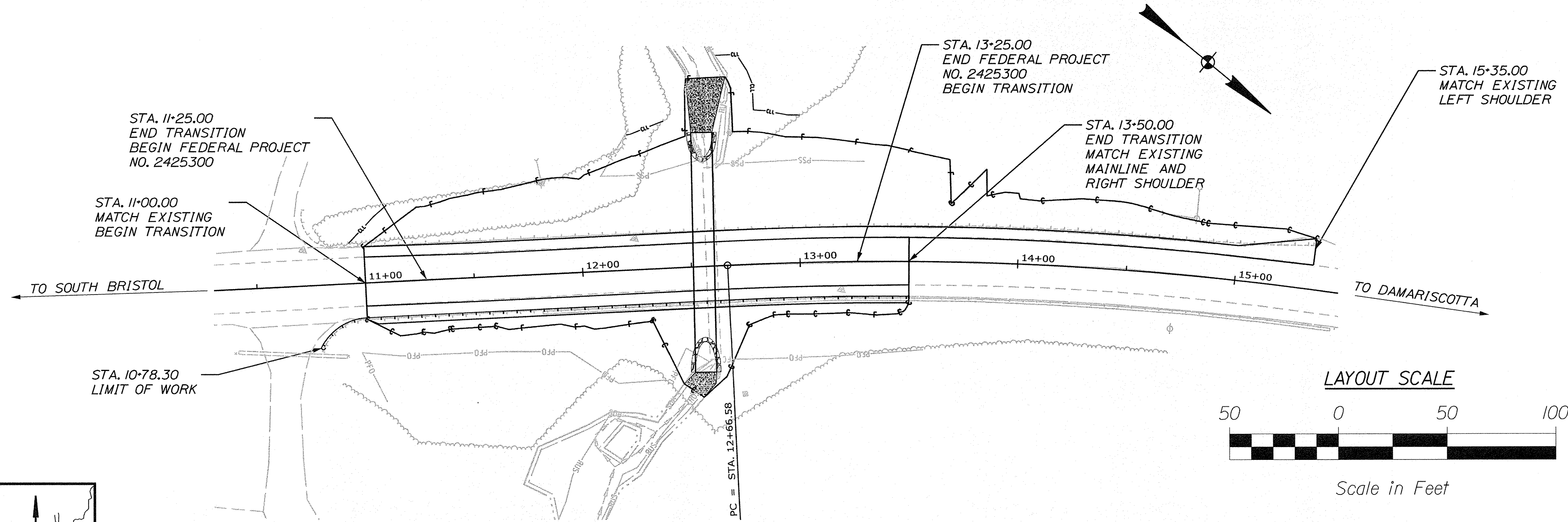

SCALE = 1 INCH : 1 MILE
LOCATION MAP

TRAFFIC DATA

Current (2023) AADT	1750
Future (2043) AADT	2100
DHV - % of AADT	13%
Design Hour Volume	273
% Heavy Trucks (AADT)	7%
Directional Distribution (DHV)	54%
Design Speed (mph)	55
Functional Class	Major Collector
Corridor Priority	4

PROJECT LOCATION:	LARGE CULVERT REPLACEMENT (890444) LOCATED ON ROUTE 129 IN SOUTH BRISTOL, APPROXIMATELY 0.18 MILES SOUTH OF CLARKS COVE ROAD
PROGRAM AREA:	HIGHWAY PROGRAM
SCOPE OF WORK:	LARGE CULVERT REPLACEMENT

TYLIN INTERNATIONAL

WIN 24253.00 2425300

SOUTH BRISTOL
ROUTE 129
TITLE SHEET

SHEET NUMBER
1
OF 18

Date: 10/25/2022

Username:

Division: HIGHWAY

Filename: ... \00\HIGHWAY\MSTA\001_Title.dgn

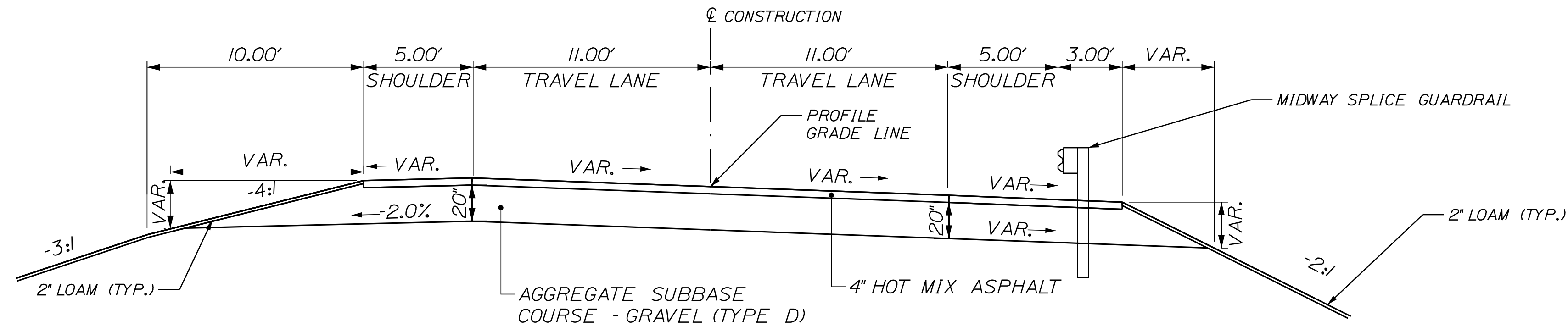

FULL RECONSTRUCTION

N.T.S.
SUPERELEVATED

AGGREGATE SUBBASE COURSE GRAVEL		
LEFT SHOULDER	12' TRAVEL LANES	RIGHT SHOULDER
STATION TO STATION	STATION TO STATION	STATION TO STATION
11+25 TO 13+25	11+25 TO 13+25	11+25 TO 13+25

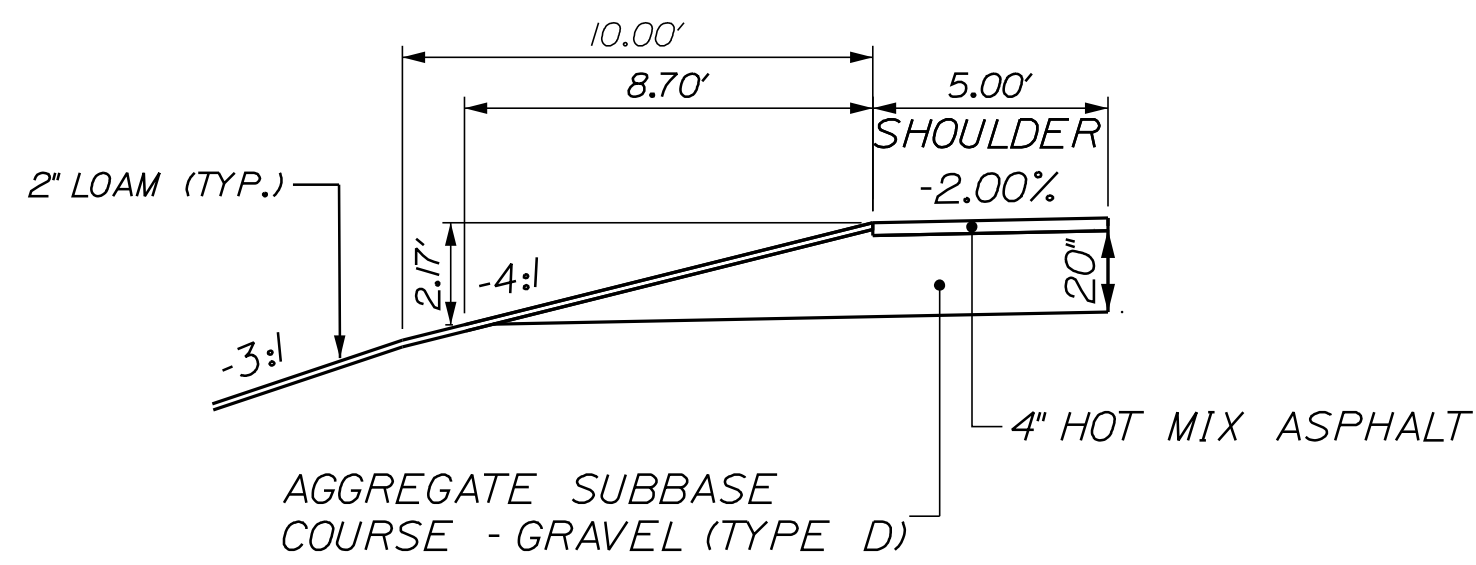

SHOULDER RECONSTRUCTION

SUPERELEVATION TABLE

ROUTE 129				
LT. SHOULDER	LT. TRAVEL LANE	STATION	RT. TRAVEL LANE	RT. SHOULDER
MATCH EXISTING				
MATCH	MATCH	11+00	MATCH	MATCH
-4.00%	-0.38%	11+50	-2.00%	-5.50%
-4.00%	1.55%	12+00	-2.00%	-4.00%
-2.53%	3.47%	12+50	-3.47%	-4.00%
-2.00%	5.20%	13+00	-5.20%	-5.20%
-2.00%	MATCH	13+50	MATCH	MATCH
-2.00%	MATCH	14+00	MATCH	MATCH
-2.00%	MATCH	14+50	MATCH	MATCH
-2.00%	MATCH	15+00	MATCH	MATCH
MATCH	MATCH	15+50	MATCH	MATCH

SIGNATURE

P.E. NUMBER

DATE

DATE

BY

S. DAVIS

PROJ. MANAGER

DESIGN DETAILED

CHECKED/REVIEWED

DESIGN DETAILED

DESIGN DETAILED

REVISIONS 1

REVISIONS 2

REVISIONS 3

REVISIONS 4

FIELD CHANGES

SHEET NUMBER

SOUTH BRISTOL
ROUTE 129
TYPICAL SECTIONS

2

OF 18

GENERAL NOTES:

- PAVEMENT THICKNESS SHOWN ON THE TYPICAL SECTIONS ARE INTENDED TO BE NOMINAL.
- ALL CLEARING SHALL BE CONSIDERED INCIDENTAL TO THE CONTRACT AND NO SEPARATE PAYMENT WILL BE MADE. THE ACTUAL LINES FOR CLEARING SHALL BE ESTABLISHED IN THE FIELD BY THE CONTRACTOR AS INDICATED ON THE PLANS AND APPROVED BY THE RESIDENT.
- ALL INSLOPE AND DITCHES IN CUT AREAS SHALL BE GRADED AS SHOWN ON THE TYPICALS OR FLATTER, OR AS DIRECTED BY THE RESIDENT.
- ALL WASTE MATERIAL NOT USED ON THE PROJECT SHALL BE DISPOSED OFF THE PROJECT IN ACCEPTABLE WASTE AREAS REVIEWED BY THE RESIDENT. GRADING, SEEDING AND MULCHING OF WASTE AREAS SHALL BE CONSIDERED INCIDENTAL.
- WHEN SUPERELEVATION EXCEEDS THE SLOPE OF THE LOW-SIDE SHOULDER, THE LOW-SIDE SHOULDER WILL HAVE THE SAME SLOPE AS THE TRAVELWAY.
- CROSS SLOPES FOR NORMAL AND SUPERELEVATED SECTIONS WILL BE STRAIGHT UNLESS OTHERWISE DIRECTED BY THE DEPARTMENT.
- THE ALGEBRAIC DIFFERENCE BETWEEN TRAVELWAY AND SHOULDER CROSS SLOPE SHALL NOT EXCEED 8 PERCENT.
- LOAM SHALL BE PLACED TO A NOMINAL DEPTH OF 4 INCHES IN LAWN AREAS AND 2 INCHES IN ALL OTHER AREAS UNLESS OTHERWISE NOTED OR DIRECTED.
- ANY DAMAGE TO THE SLOPES CAUSED BY THE CONTRACTOR'S EQUIPMENT, PERSONNEL, OR OPERATION SHALL BE REPAIRED TO THE SATISFACTION OF THE RESIDENT. ALL WORK, EQUIPMENT, AND MATERIALS REQUIRED TO MAKE REPAIRS SHALL BE AT THE CONTRACTOR'S EXPENSE.
- THE PROJECT GEOTECHNICAL REPORT TITLED "GEOTECHNICAL DESIGN REPORT FOR THE REPLACEMENT OF LARGE CULVERT #890444", SOILS REPORT 2022-24, 10/7/2022 CAN BE ACCESSED AT THE MAINEDOT WEBSITE [HTTP://WWW.MAINE.GOV/MDOT/CONTRACTORS/](http://www.maine.gov/mdot/contractors/).
- GEOTECHNICAL INFORMATION FURNISHED OR REFERRED TO IN THE BID DOCUMENTS IS FOR THE USE OF THE BIDDERS. NO ASSURANCE IS GIVEN THAT THE INFORMATION OR INTERPRETATIONS WILL BE REPRESENTATIVE OF THE ACTUAL SUBSURFACE CONDITIONS THROUGHOUT THE CONSTRUCTION SITE. MAINEDOT WILL NOT BE RESPONSIBLE FOR ANY INTERPRETATIONS OR CONCLUSION DRAWN FROM THE GEOTECHNICAL INFORMATION. THE BORING LOGS PROVIDED IN THE BID DOCUMENTS (IF ANY) PRESENT FACTUAL AND INTERPRETIVE SUBSURFACE INFORMATION COLLECTED AT DISCRETE LOCATIONS. DATA PROVIDED MAY NOT BE REPRESENTATIVE OF THE SUBSURFACE CONDITIONS BETWEEN BORING LOCATIONS.
- AREAS REQUIRING FILL ON THE PROJECT WILL COME FROM SUITABLE EXCAVATION FROM EXCAVATION, DITCH AND INSLOPE OR EQUIPMENT RENTAL AREAS.
- NO SEPARATE PAYMENT FOR SUPERINTENDENT OR FOREMAN WILL BE MADE FOR THE SUPERVISION OF EQUIPMENT AND LAYOUT OF WORK BEING PAID FOR UNDER THE EQUIPMENT RENTAL ITEMS.
- EXISTING INSLOPES IN PROPOSED FILL AREAS SHALL BE BENCHED BY EXCAVATING STEPS OF SUFFICIENT WIDTH TO PERMIT PLACING AND COMPACTING THE FILL MATERIAL ALONG WITH THE MATERIAL REMOVED.
- ALL EXISTING GUARDRAIL REMOVED AND NOT REUSED ON THE PROJECT WILL BECOME THE PROPERTY OF THE CONTRACTOR. REMOVAL AND DISPOSAL SHALL BE CONSIDERED INCIDENTAL TO THE GUARDRAIL ITEMS.
- CONNECTIONS FOR PROPOSED GUARDRAIL TO EXISTING GUARDRAIL WILL BE CONSIDERED INCIDENTAL TO STANDARD SPECIFICATIONS SECTION 606, GUARDRAIL.
- UNLESS OTHERWISE NOTED SEEDING METHOD NO. 1 SHALL BE UTILIZED ON ALL LAWNS AND DEVELOPED AREAS; SEEDING METHOD NO. 2 SHALL BE UTILIZED ON ALL OTHER AREAS.
- FINAL STRIPING FOR THE PROJECT SHALL BE DONE BY THE CONTRACTOR PER THE STRIPING LAYOUT IN THE CONTRACT DOCUMENTS OR AS PROVIDED BY THE DEPARTMENT. PAYMENT SHALL BE MADE UNDER APPROPRIATE CONTRACT ITEMS.

ESTIMATED QUANTITIES			
ITEM NO.	DESCRIPTION	QUANTITY	UNIT
203.20	COMMON EXCAVATION	975	CY
203.25	GRANULAR BORROW	270	CY
203.33	SPECIAL FILL	110	CY
203.55	CULVERT BEDDING STONE	105	CY
304.10	AGGREGATE SUBBASE COURSE - GRAVEL	800	CY
403.208	HOT MIX ASPHALT, 12.5 MM NOMINAL MAXIMUM SIZE	95	TON
403.213	HOT MIX ASPHALT, 12.5 MM NOMINAL MAXIMUM SIZE (BASE AND INTERMEDIATE BASE COURSE)	155	TON
409.15	BITUMINOUS TACK COAT, APPLIED	35	G
511.07	COFFERDAM, UPSTREAM	1	LS
511.07	COFFERDAM, DOWNSTREAM	1	LS
603.408	117'S x 79'R PIPE ARCH OPTION III	110	LF
606.1301	3' W-BEAM GUARDRAIL - MID-WAY SPLICE (STEEL POST, 8" OFFSET BLOCKS, SINGLE FACED)	250	LF
606.1304	3' W-BEAM GUARDRAIL - MID-WAY SPLICE (STEEL POST, 8" OFFSET BLOCKS, OVER 15')	25	LF
606.265	TERMINAL END - SINGLE RAIL - GALVANIZED STEEL	1	EA
606.353	REFLECTORIZED FLEXIBLE GUARDRAIL MARKER	2	EA
610.08	PLAIN RIPRAP	60	CY
610.212	STREAMBED ROCK FEATURES	35	CY
615.07	LOAM	85	CY
618.14	SEEDING METHOD NUMBER 2	14	UN
619.12	MULCH	14	UN
620.54	STABILIZATION/REINFORCEMENT GEOTEXTILE	160	SY
620.58	EROSION CONTROL GEOTEXTILE	115	SY
620.65	REINFORCEMENT GEOGRID	160	SY
627.733	4" WHITE OR YELLOW PAINTED PAVEMENT MARKING LINE	940	LF
629.05	HAND LABOR, STRAIGHT TIME	10	HR
631.12	ALL PURPOSE EXCAVATOR (INCLUDING OPERATOR)	10	HR
631.172	LARGE TRUCK (INCLUDING OPERATOR)	10	HR
639.19	FIELD OFFICE TYPE B	1	EA
652.312	TYPE III BARRICADE	2	EA
652.33	DRUM	4	EA
652.34	CONE	25	EA
652.35	CONSTRUCTION SIGN	200	SF
652.36	MAINTENANCE OF TRAFFIC CONTROL DEVICES	30	CD
652.38	FLAGGERS	310	HR
652.41	PORTABLE CHANGEABLE MESSAGE SIGN	2	EA
656.75	TEMPORARY SOIL EROSION AND WATER POLLUTION CONTROL	1	LS
659.10	MOBILIZATION	1	LS

STATE OF MAINE
DEPARTMENT OF TRANSPORTATION
2425300
WIN
24253.00
HIGHWAY PLANS

SIGNATURE
P.E. NUMBER
DATE

PROJ. MANAGER	S. DAVIS	BY	DATE
DESIGN-DETAILED			
CHECKED-REVIEWED			
DESIGN-DETAILED			
DESIGN-DETAILED			
REVISIONS 1			
REVISIONS 2			
REVISIONS 3			
REVISIONS 4			
FIELD CHANGES			

SOUTH BRISTOL
ROUTE 129
GENERAL NOTES AND
ESTIMATED QUANTITIES

SHEET NUMBER
3
OF 18



Date: 10/25/2022

Username:

Division: HIGHWAY

Filename: ... \MSTA\... \SpecialDetail.dgn

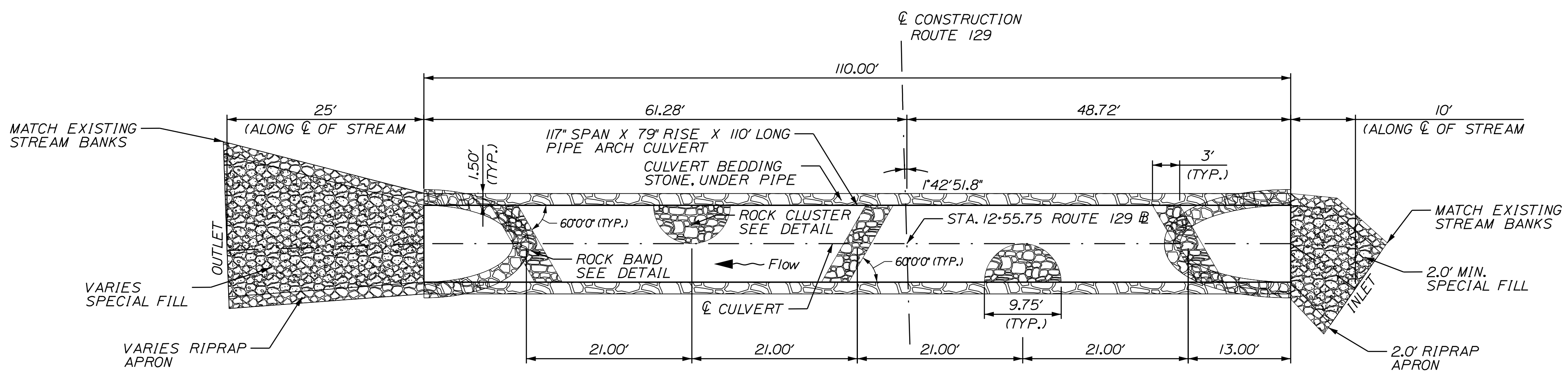

PIPE ARCH PLAN VIEW
NOT TO SCALE

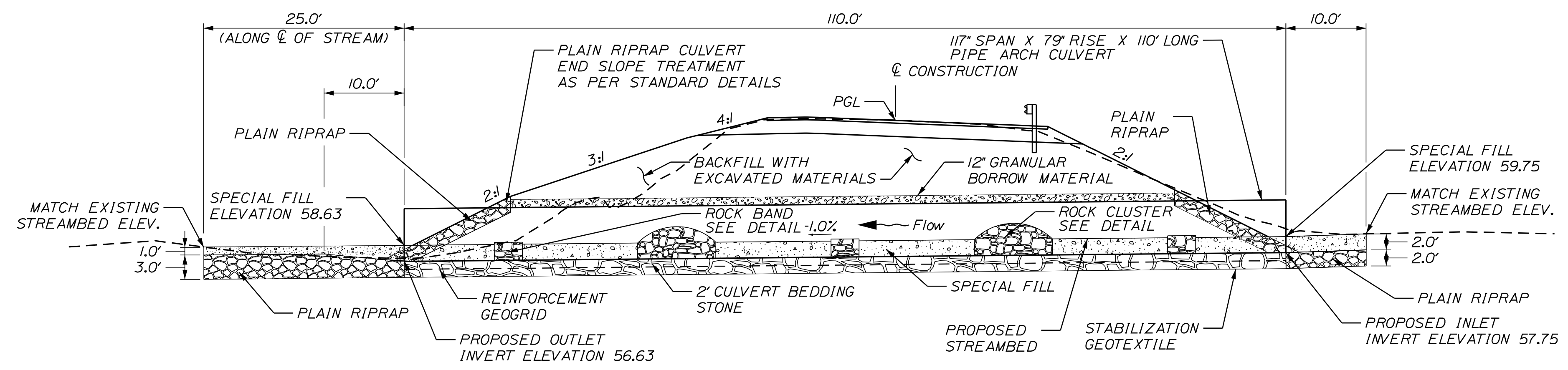

PIPE ARCH TRANSVERSE SECTION (ALONG CULVERT/STREAM CL)
NOT TO SCALE

PIPE ARCH CULVERT NOTES:

1. THE PIPE ARCH CULVERT SHALL BE BEDDED ON A 2 FOOT THICK LAYER OF CULVERT BEDDING STONE (UNDERDRAIN BACKFILL MATERIAL, TYPE C) WITH A LAYER OF REINFORCEMENT GEOGRID AT THE CENTER. THE CULVERT BEDDING STONE SHALL BE WRAPPED IN STABILIZATION GEOTEXTILE. PAYMENT WILL BE MADE UNDER THE APPROPRIATE CONTRACT ITEMS.
2. THE REINFORCEMENT GEOGRID SHALL MEET THE REQUIREMENTS OF SPECIAL PROVISION 620.
3. THE STABILIZATION GEOTEXTILE SHALL BE OVERLAPPED A MINIMUM OF 3 FEET.
4. THE CLAYEY SILT AT THE BEDDING ELEVATION SHOULD BE EXCAVATED USING A SMOOTH-EDGED BACKHOE BUCKET TO MINIMIZE DISTURBANCE TO THE SOILS AT THE SITE. ANY DISTURBED SOILS AT THE BEDDING ELEVATION RESULTING FROM EXCAVATION ACTIVITIES SHOULD BE REMOVED BY HAND PRIOR TO PLACEMENT OF THE GEOTEXTILE WRAPPED, GEOGRID REINFORCED, CRUSHED STONE MAT.
5. COFFERDAMS ARE TO BE PLACED AT BOTH THE DOWNSTREAM AND UPSTREAM ENDS OF THE PIPE ARCH TO ALLOW WATER TO BE PUMPED AND REMOVED DURING CONSTRUCTION OF THE PIPE ARCH.
6. RIPRAP WILL BE USED TO INSLOPE AROUND THE CULVERT ENDS AT BOTH THE INLET AND OUTLET. SEE PLAN FOR LOCATIONS.
7. THE CULVERT SHALL BE LINED WITH A MINIMUM OF 2.0 FEET OF SPECIAL FILL IN ACCORDANCE WITH SPECIAL PROVISION 203.
8. VOIDS IN RIPRAP APRONS SHALL BE INFILLED WITH SPECIAL FILL WATERED-IN AND TAMPED.
9. THE FURNISHING AND PLACING OF BACKFILL MATERIAL BETWEEN THE GRANULAR BORROW PAY LIMIT AND THE NORMAL SUBGRADE LINE WILL NOT BE PAID FOR DIRECTLY BUT SHALL BE CONSIDERED INCIDENTAL TO THE WORK. BACKFILL MATERIAL SHALL BE FROM SUITABLE EXCAVATION WITHIN PROJECT LIMITS, IF AVAILABLE, AND SHALL BE GRANULAR MATERIAL AS DIRECTED BY THE RESIDENT.
10. INLET AND OUTLET GRADING SHALL BE COORDINATED WITH THE MAINE DOT HYDROLOGY SECTION. THE CONTRACTOR SHALL GIVE THE RESIDENT A MINIMUM OF 48 HOURS NOTICE BEFORE INLET AND OUTLET GRADING MAY BEGIN. RIPRAP AND SPECIAL FILL SHALL BE PAID FOR UNDER THE APPROPRIATE ITEMS.

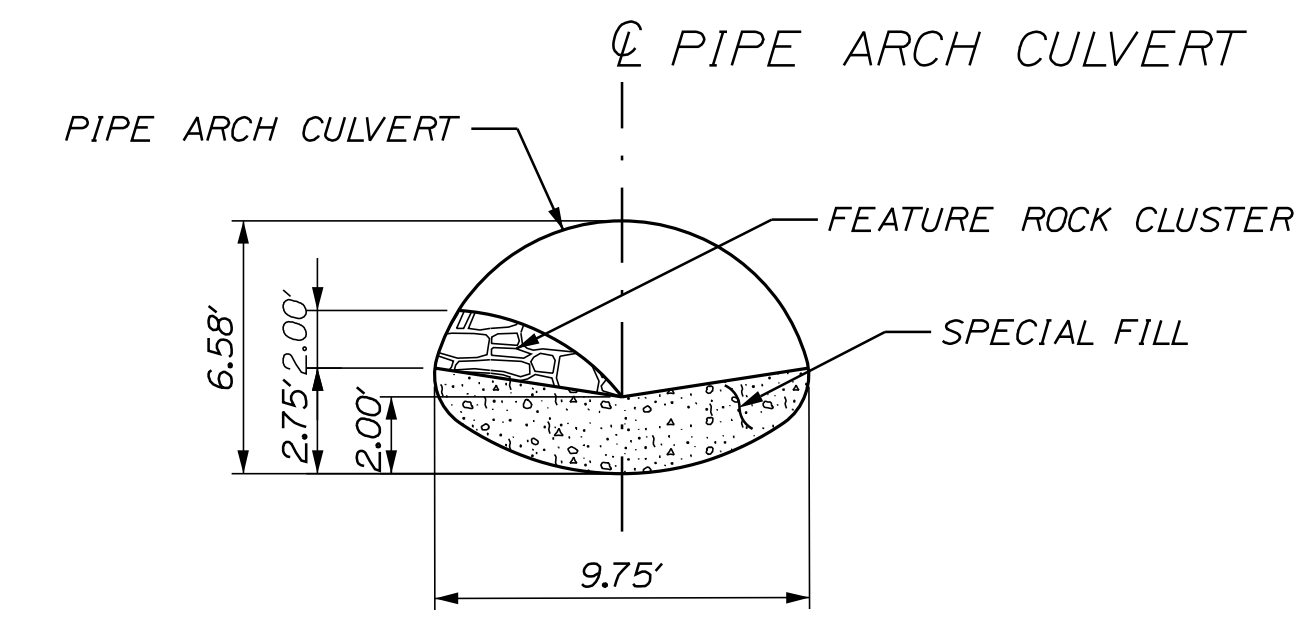

STREAM BED ROCK FEATURES: ROCK CLUSTER
INSIDE OF CULVERT
PAID UNDER ITEM 610.212 "STREAMBED ROCK FEATURES"
NOT TO SCALE

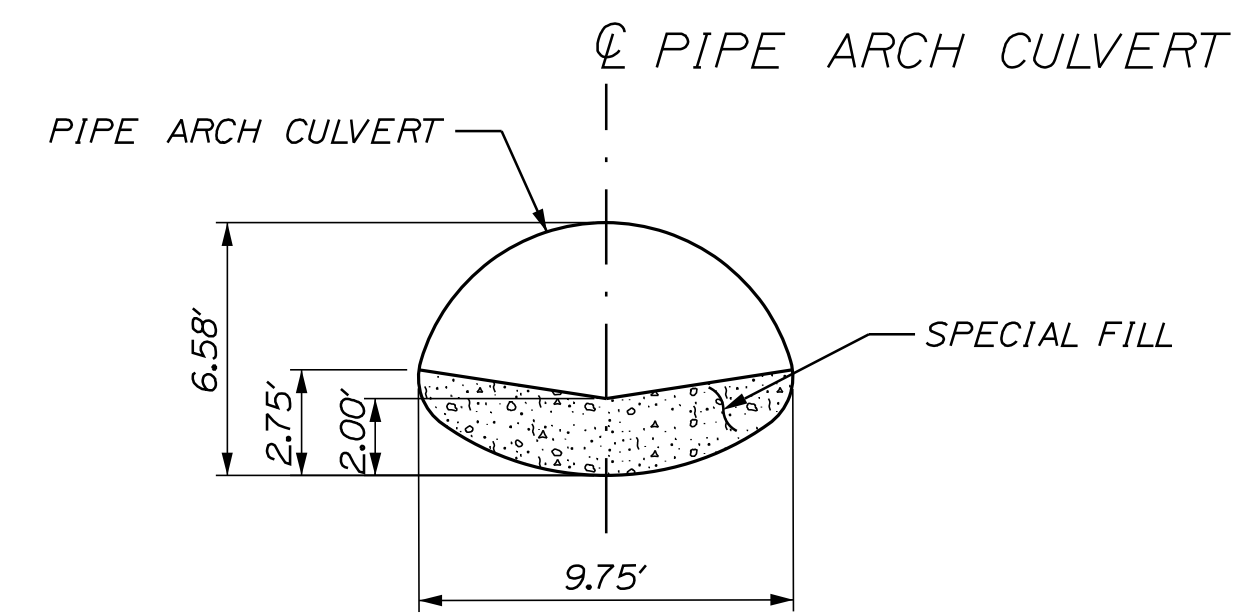

SPECIAL FILL DETAIL
INSIDE OF CULVERT
NOT TO SCALE

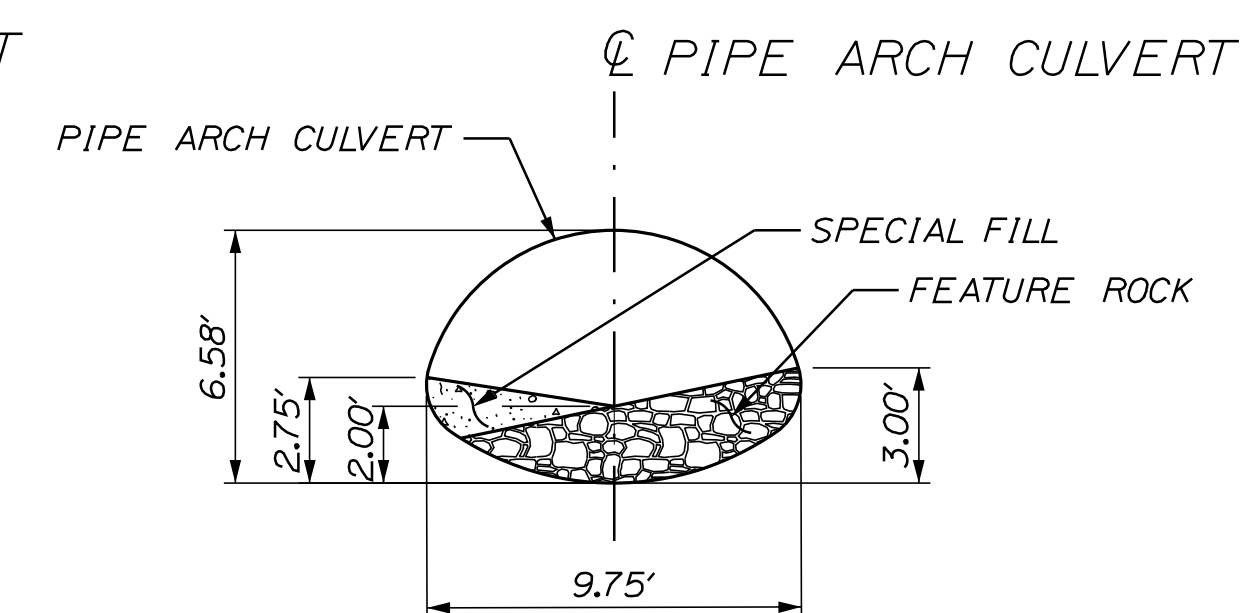

STREAM BED ROCK FEATURES: ROCK BAND
INSIDE OF CULVERT
PAID UNDER ITEM 610.212 "STREAMBED ROCK FEATURES"
NOT TO SCALE

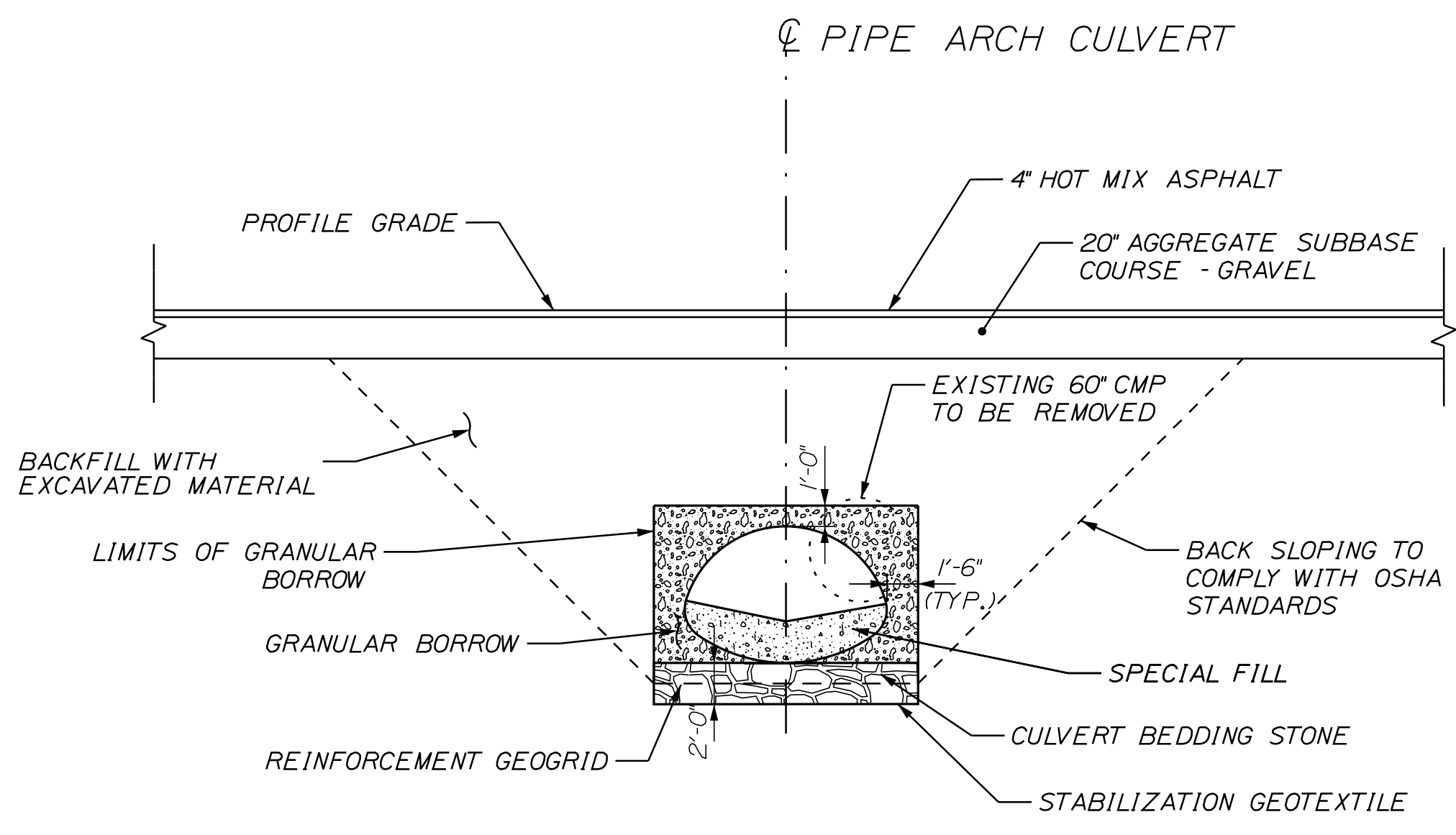

PIPE ARCH TYPICAL SECTION
NOT TO SCALE

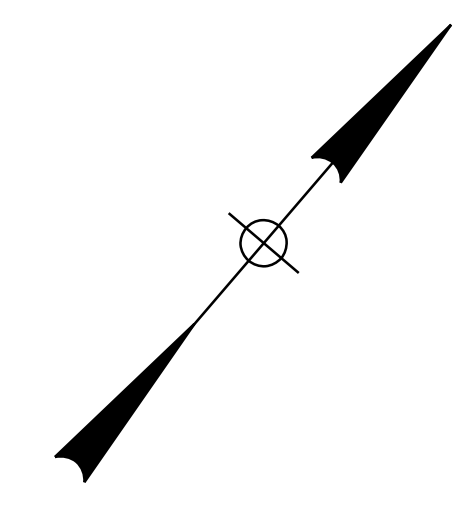

PROJ. MANAGER	DESIGN-DETAILED	CHECKED-REVIEWED	DESIGN-DETAILED	DESIGN-DETAILED	REVISIONS 1	REVISIONS 2	REVISIONS 3	REVISIONS 4	FIELD CHANGES
S. DAVIS									
DATE									
BY									
SIGNATURE									
P.E. NUMBER									
DATE									



Date: 10/25/2022

Username:

Division: HIGHWAY

Filename: ... \MSTA\..._HDPlanProfile.dgn

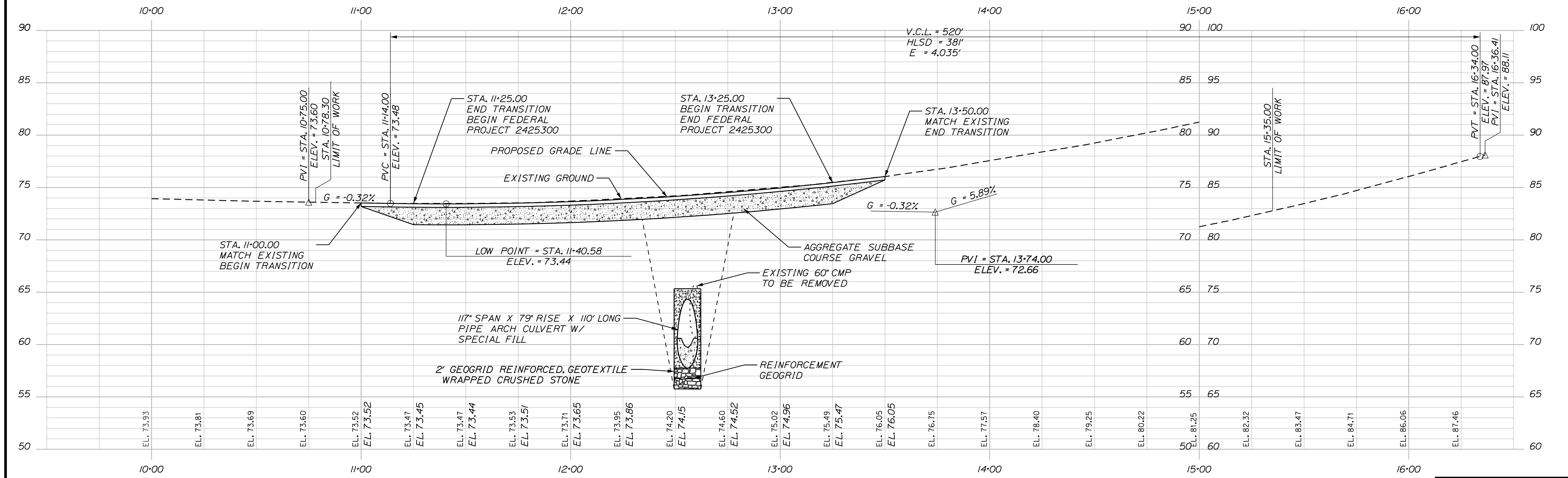
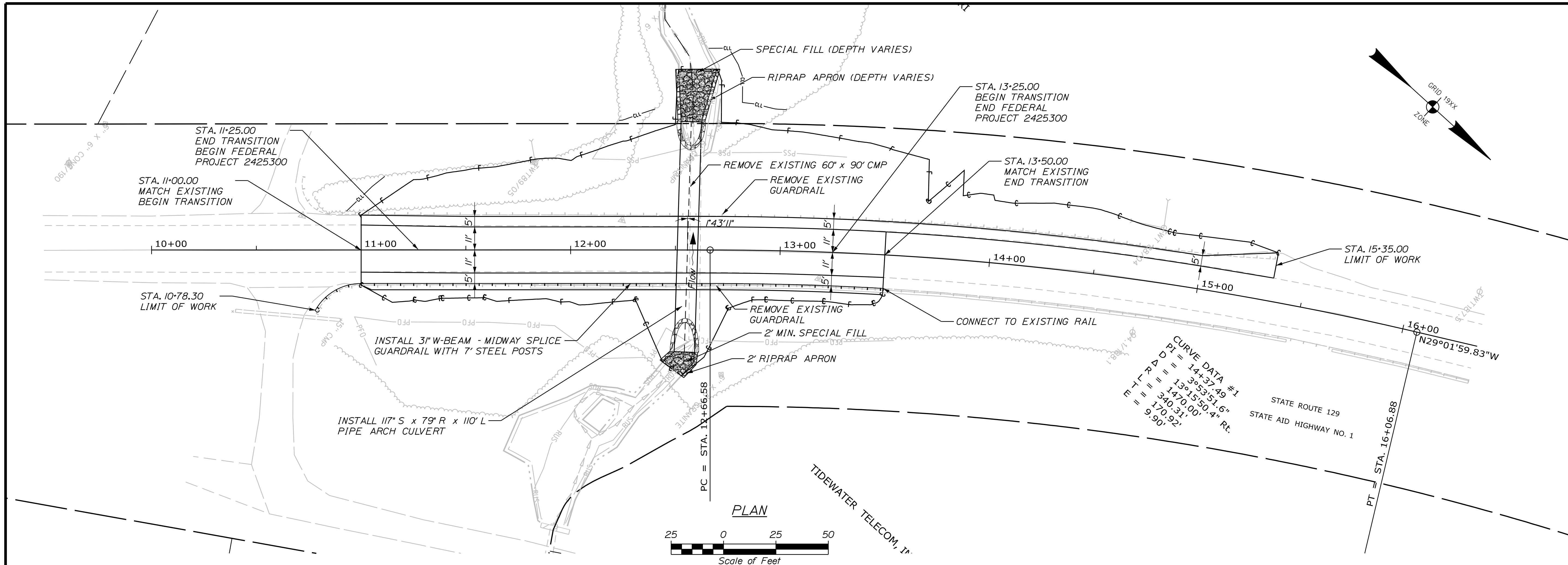

STATE OF MAINE
DEPARTMENT OF TRANSPORTATION
2425300
WIN
24253.00
HIGHWAY PLANS

PROJ. MANAGER	DATE	BY	DATE
S. DAVIS			
DESIGN-DETAILED			
CHECKED-REVIEWED			
DESIGN-DETAILED			
DESIGN-DETAILED			
REVISIONS 1			
REVISIONS 2			
REVISIONS 3			
REVISIONS 4			
FIELD CHANGES			

SOUTH BRISTOL
ROUTE 129
PLAN AND PROFILE

SHEET NUMBER

6

OF 18



Date: 10/25/2022

Username:

Division: HIGHWAY

Filename: ... \HIGHWAY\MSTA\... \XSections.dgn

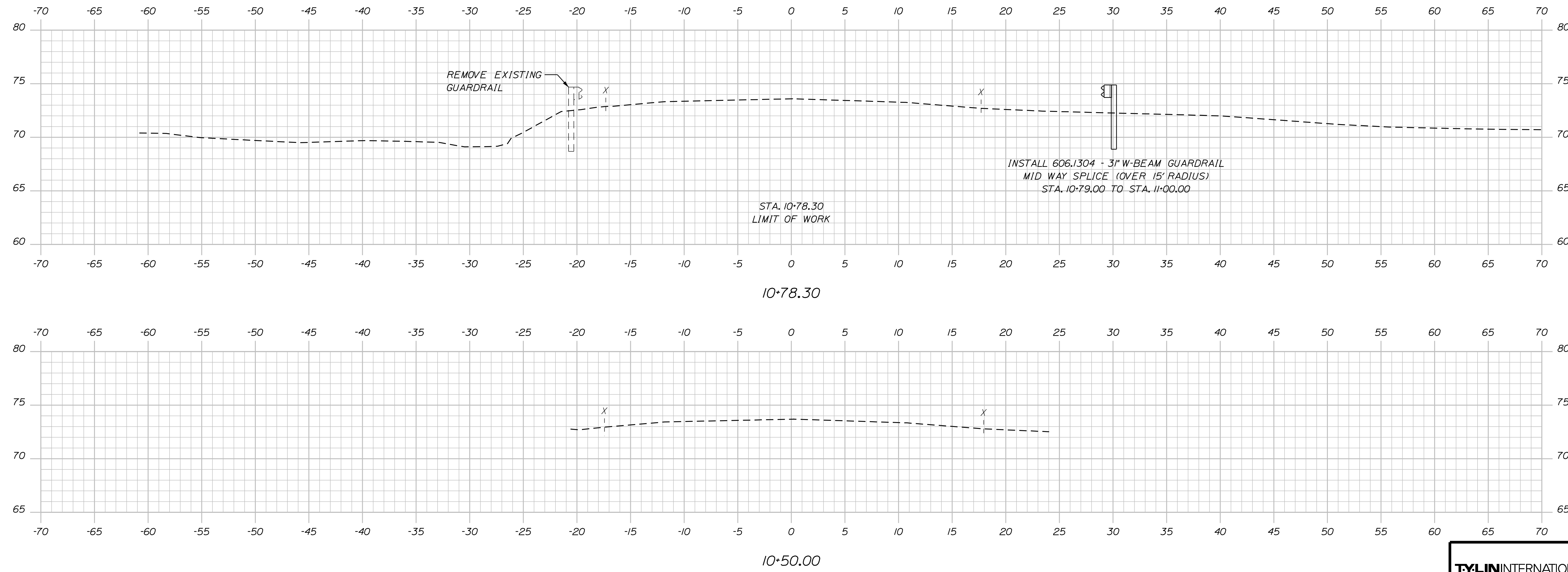

STATE OF MAINE
DEPARTMENT OF TRANSPORTATION
2425300
WIN
24253.00
HIGHWAY PLANS

PROJ. MANAGER	DATE
CHECKED/REVIEWED	SIGNATURE
DESIGN/TAILED	P.E. NUMBER
REVISIONS 1	DATE
REVISIONS 2	
REVISIONS 3	
REVISIONS 4	
FIELD CHANGES	

SOUTH BRISTOL
ROUTE 129
CROSS SECTIONS

SHEET NUMBER
7
OF 18



Date: 10/25/2022

Username:

Division: HIGHWAY

Filename: ... \HIGHWAY\MSTAxxx_XSections.dgn

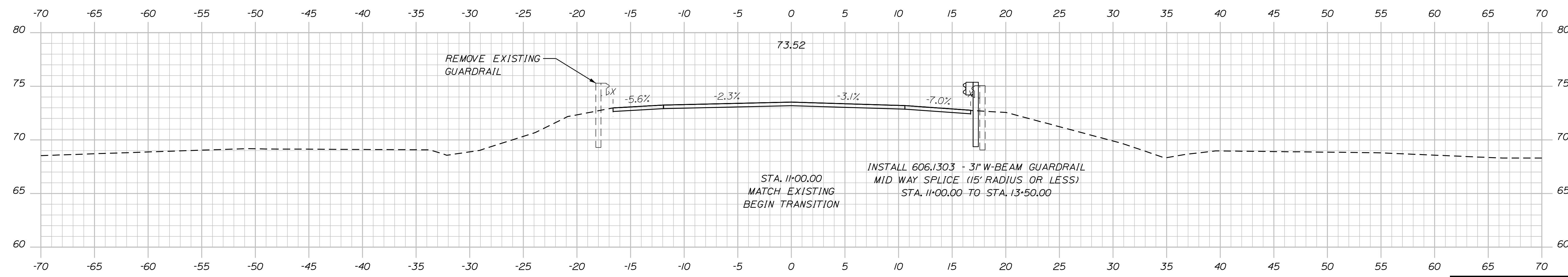
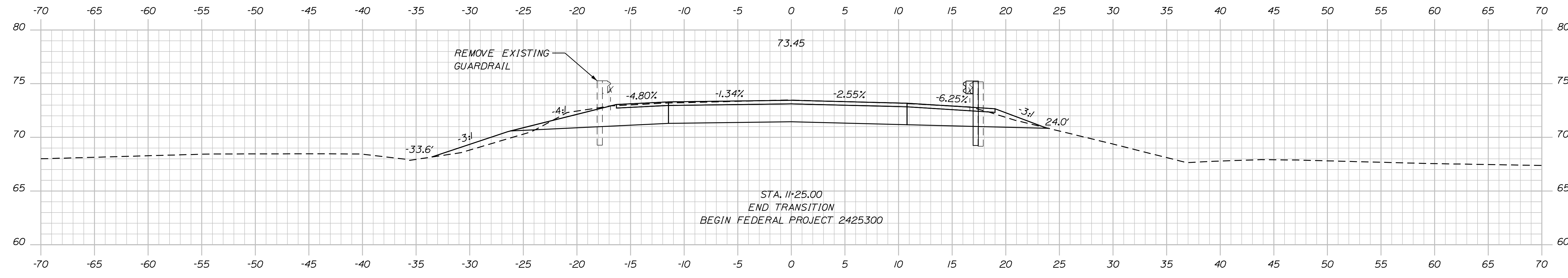

STATE OF MAINE
DEPARTMENT OF TRANSPORTATION
2425300
WIN
24253.00
HIGHWAY PLANS

DATE	SIGNATURE
BY	P.E. NUMBER
S. DAVIS	DATE

PROJ. MANAGER	DESIGN DETAILED	REVISIONS 1
CHECKED/REVIEWED	DESIGN DETAILED	REVISIONS 2
DESIGN DETAILED	DESIGN DETAILED	REVISIONS 3
REVISIONS 1	REVISIONS 2	REVISIONS 4
REVISIONS 2	REVISIONS 3	FIELD CHANGES
REVISIONS 3	REVISIONS 4	
REVISIONS 4		

SOUTH BRISTOL
ROUTE 129
CROSS SECTIONS

SHEET NUMBER
8
OF 18



Sta. 11+00.00 to Sta. 11+25.00

Date: 10/25/2022

Username:

Division: HIGHWAY

Filename: ... \HIGHWAY\MSTAxxx_XSections.dgn

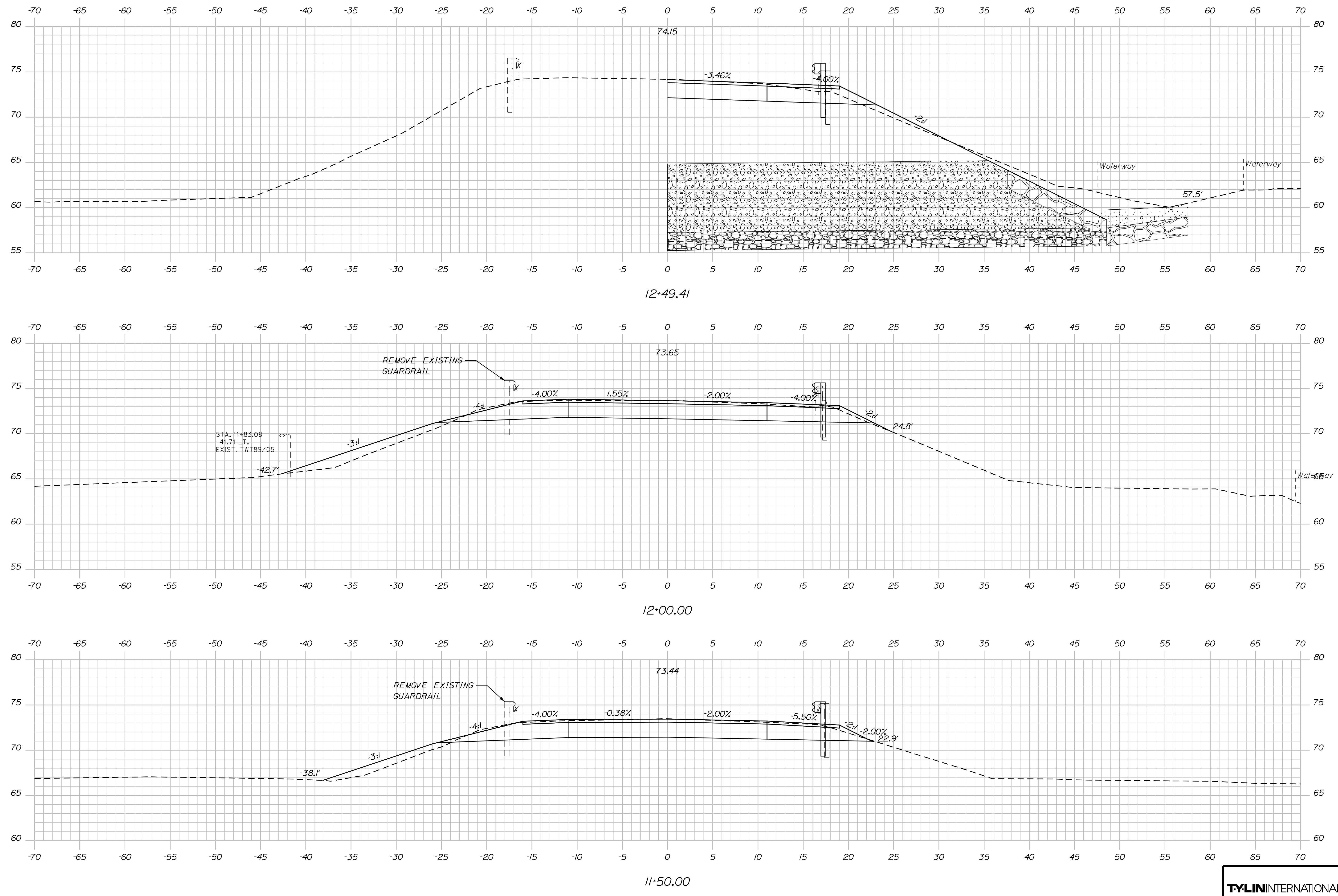

STATE OF MAINE
DEPARTMENT OF TRANSPORTATION
2425300
WIN
24253.00
HIGHWAY PLANS

PROJ. MANAGER	DATE	BY	S. DAVIS	DATE
DESIGN DETAILED				
CHECKED-REVIEWED				
DESIGN DETAILED				
DESIGN DETAILED				
REVISIONS 1				
REVISIONS 2				
REVISIONS 3				
REVISIONS 4				
FIELD CHANGES				

SOUTH BRISTOL
ROUTE 129
CROSS SECTIONS

SHEET NUMBER
9
OF 18

TYLIN INTERNATIONAL

Sta. 11+50.00 to Sta. 12+49.41

Date: 10/25/2022

Username:

Division: HIGHWAY

Filename: ... \HIGHWAY\MSTA\... \XSections.dgn

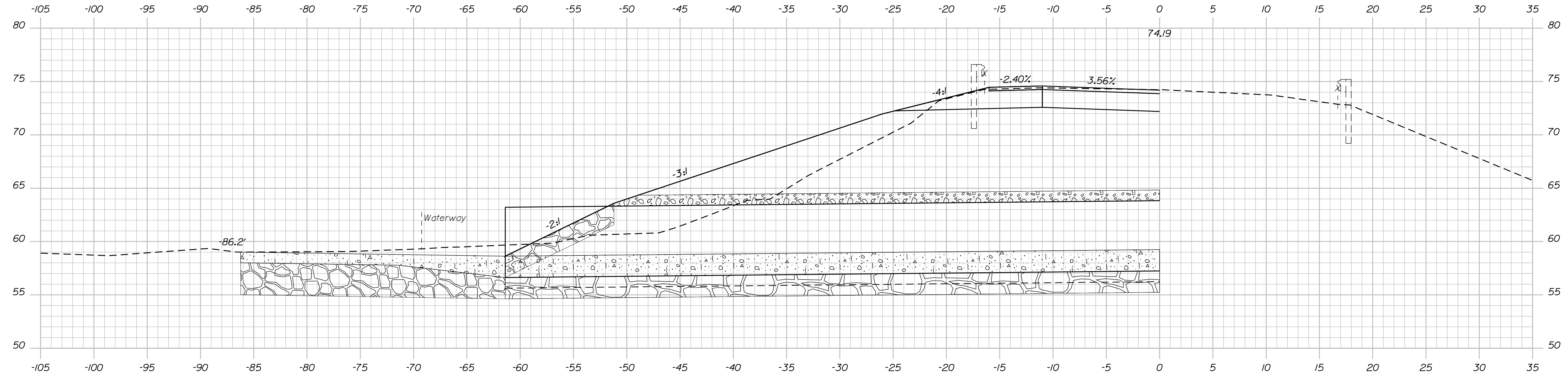

12+52.71

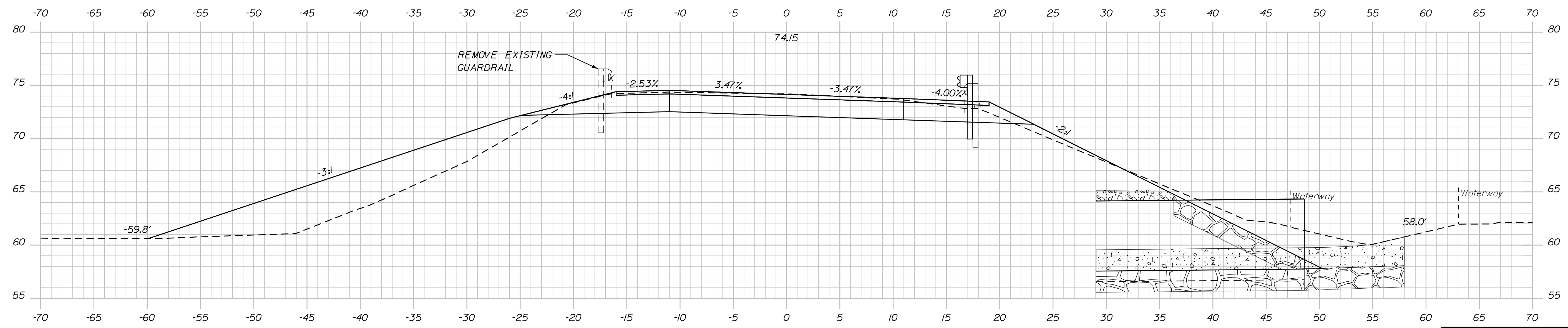

12+50.00



STATE OF MAINE
DEPARTMENT OF TRANSPORTATION
2425300
WIN
24253.00
HIGHWAY PLANS

PROJ. MANAGER	DATE
CHECKED-REVIEWED	SIGNATURE
DESIGN DETAILED	P.E. NUMBER
DESIGN DETAILED	DATE
REVISIONS 1	
REVISIONS 2	
REVISIONS 3	
REVISIONS 4	
FIELD CHANGES	

PROJ. MANAGER	DATE
CHECKED-REVIEWED	SIGNATURE
DESIGN DETAILED	P.E. NUMBER
DESIGN DETAILED	DATE
REVISIONS 1	
REVISIONS 2	
REVISIONS 3	
REVISIONS 4	
FIELD CHANGES	

SOUTH BRISTOL
ROUTE 129
CROSS SECTIONS

SHEET NUMBER
10
OF 18

Date: 10/25/2022

Username:

Division: HIGHWAY

Filename: ... \HIGHWAY\MSTA\... \XSections.dgn

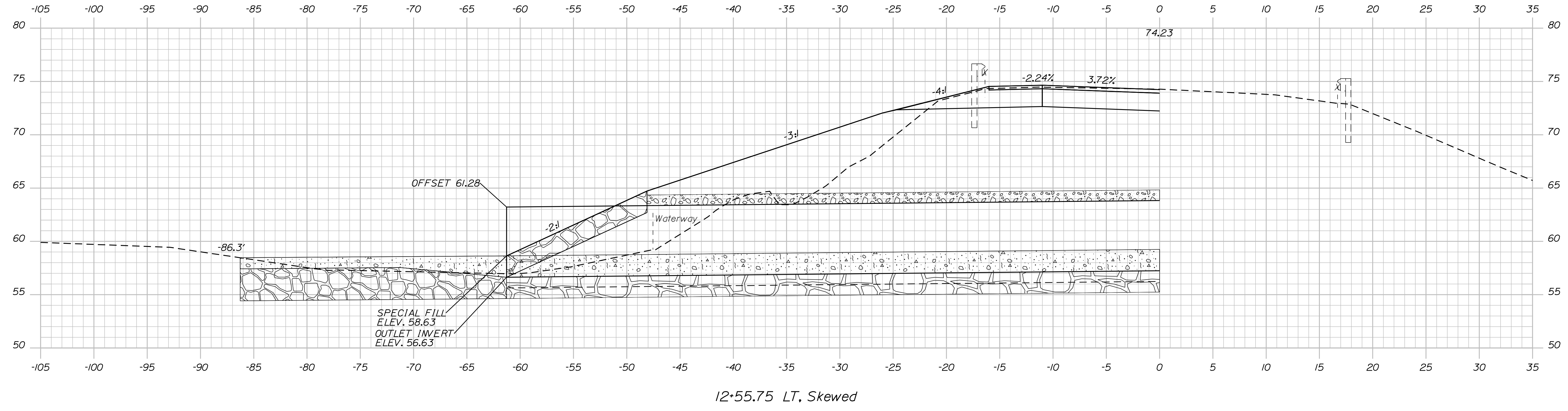

12+55.75 LT, Skewed

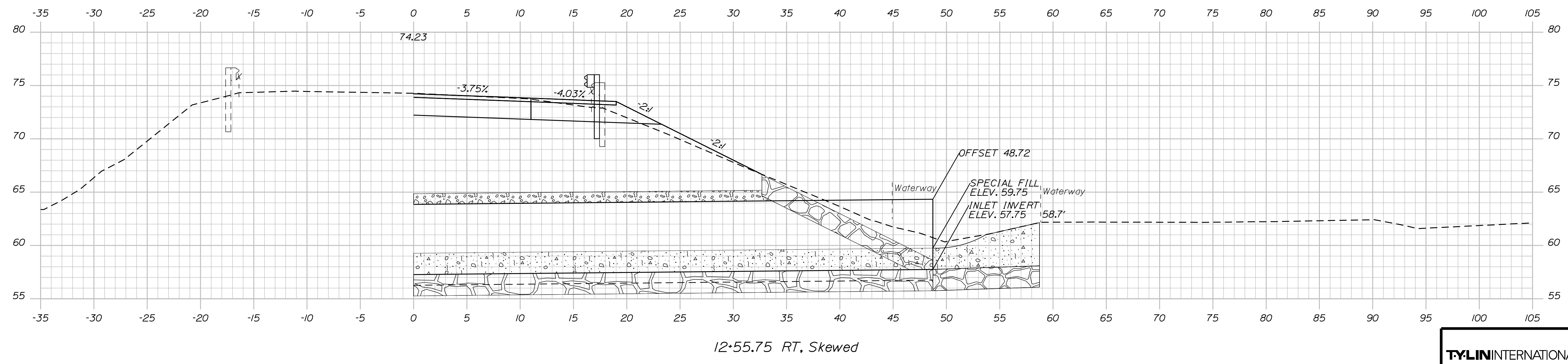

12+55.75 RT, Skewed

STATE OF MAINE
DEPARTMENT OF TRANSPORTATION
2425300
WIN
24253.00
HIGHWAY PLANS

PROJ. MANAGER	DATE
CHECKED/REVIEWED	SIGNATURE
DESIGN/DETAILS	P.E. NUMBER
REVISIONS 1	DATE
REVISIONS 2	
REVISIONS 3	
REVISIONS 4	
FIELD CHANGES	

PROJ. MANAGER	DATE
CHECKED/REVIEWED	SIGNATURE
DESIGN/DETAILS	P.E. NUMBER
REVISIONS 1	DATE
REVISIONS 2	
REVISIONS 3	
REVISIONS 4	
FIELD CHANGES	

SOUTH BRISTOL
ROUTE 129
CROSS SECTIONS

SHEET NUMBER
11
OF 18



Date: 10/25/2022

Username:

Division: HIGHWAY

Filename: ... \HIGHWAY\MSTA\... \XSections.dgn

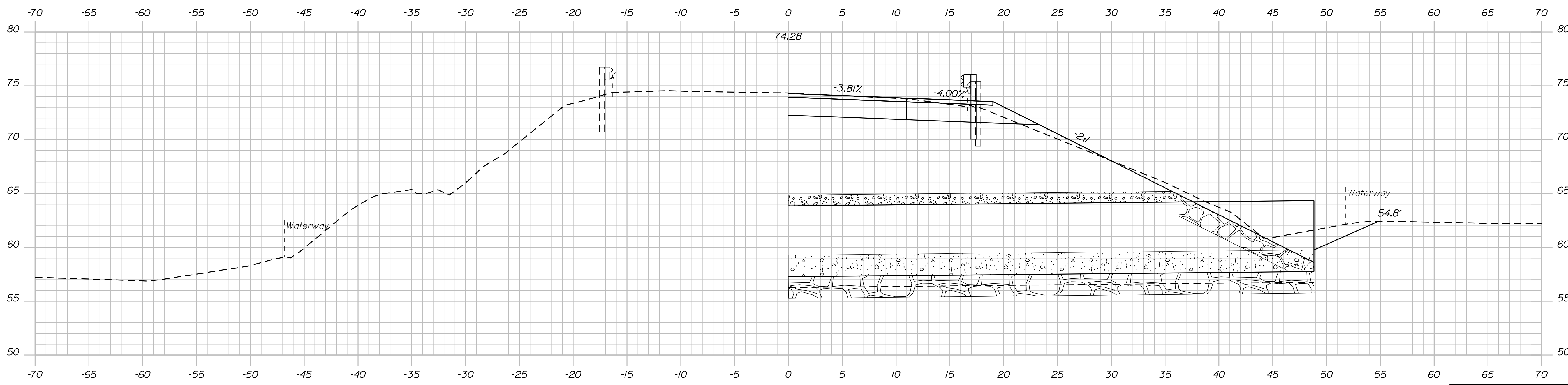
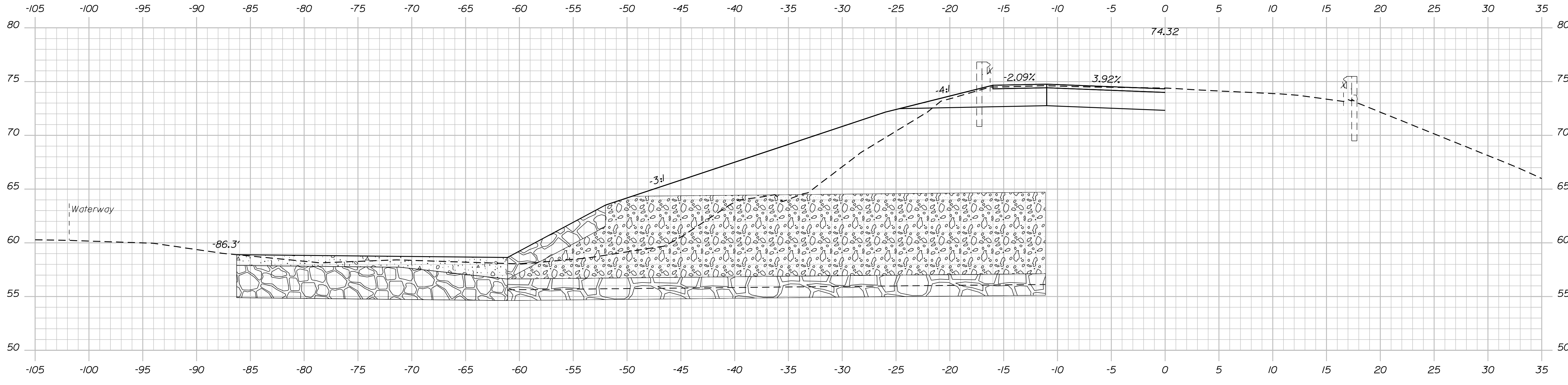

TYLIN INTERNATIONAL

STATE OF MAINE
DEPARTMENT OF TRANSPORTATION
2425300
WIN
24253.00
HIGHWAY PLANS

PROJ. MANAGER	S. DAVIS	BY	DATE
DESIGN/DETAILED			
CHECKED/REVIEWED			
DESIGN/DETAILED			
REVISIONS 1			
REVISIONS 2			
REVISIONS 3			
REVISIONS 4			
FIELD CHANGES			

SOUTH BRISTOL
ROUTE 129
CROSS SECTIONS

SHEET NUMBER
12
OF 18

Date: 10/25/2022

Username:

Division: HIGHWAY

Filename: ... \HIGHWAY\MSTA\...XSections.dgn

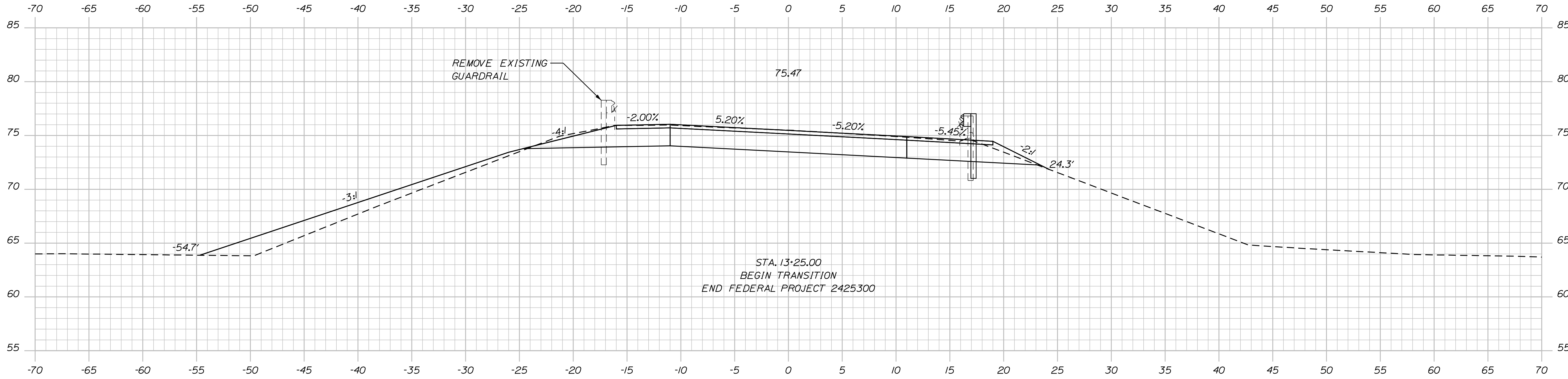

13+25.00

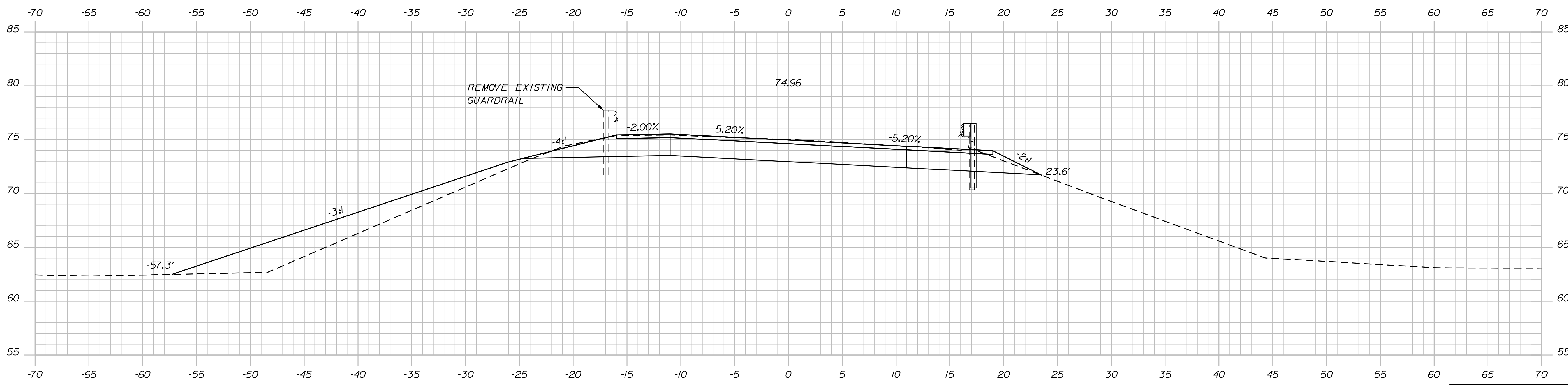

13+00.00

STATE OF MAINE
DEPARTMENT OF TRANSPORTATION
2425300
WIN
24253.00
HIGHWAY PLANS

PROJ. MANAGER	DATE	SIGNATURE
CHECKED-REVIEWED	BY	P.E. NUMBER
DESIGN DETAILED	S. DAVIS	DATE
DESIGN DETAILED		
REVISIONS 1		
REVISIONS 2		
REVISIONS 3		
REVISIONS 4		
FIELD CHANGES		

DESIGN DETAILED	DATE	SIGNATURE
CHECKED-REVIEWED	BY	P.E. NUMBER
DESIGN DETAILED	S. DAVIS	DATE
DESIGN DETAILED		
REVISIONS 1		
REVISIONS 2		
REVISIONS 3		
REVISIONS 4		
FIELD CHANGES		

SOUTH BRISTOL
ROUTE 129
CROSS SECTIONS

SHEET NUMBER

13

OF 18



Sta. 13+00.00 to Sta. 13+25.00

Date: 10/25/2022

Username:

Division: HIGHWAY

Filename: ... \HIGHWAY\MSTAxxx_XSections.dgn

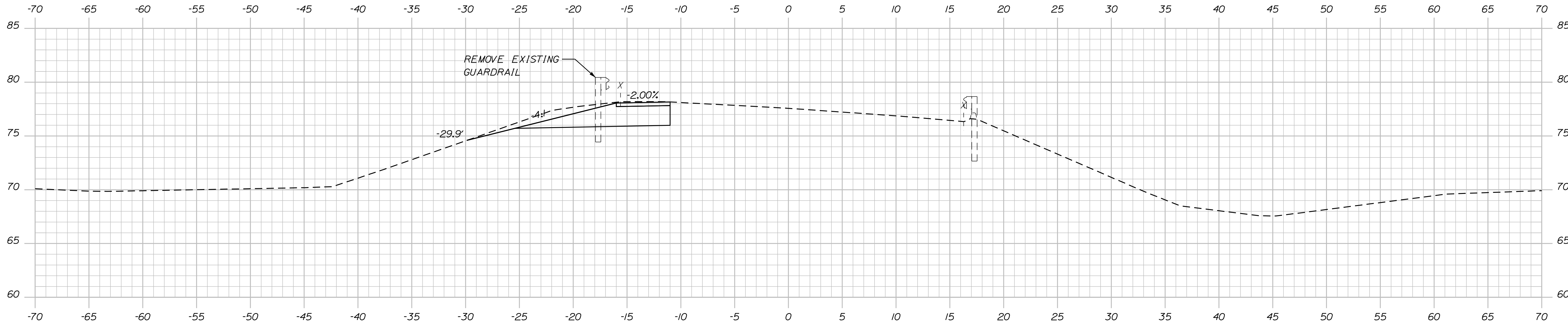

14+00.00

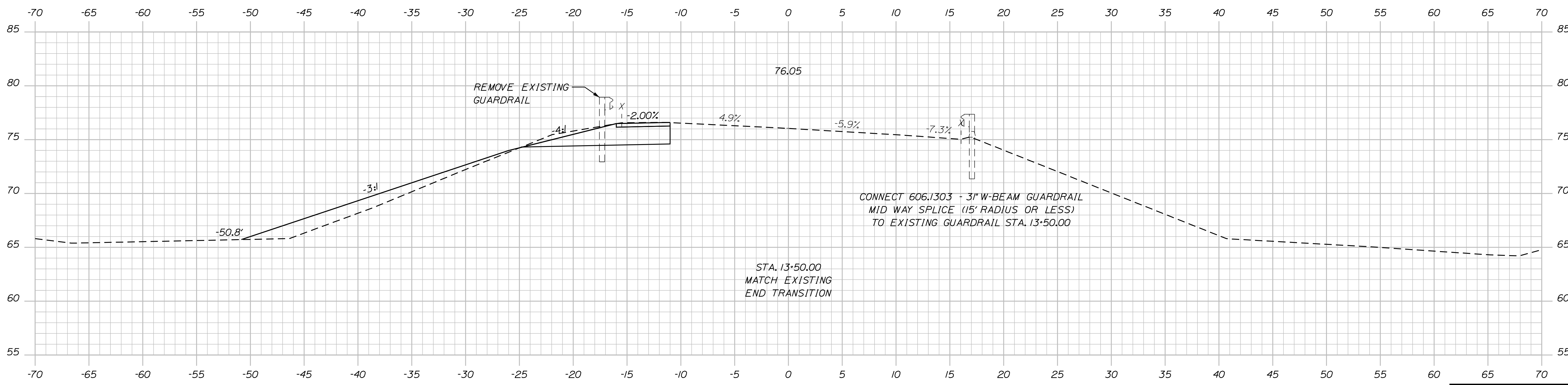

13+50.00

TYLIN INTERNATIONAL

STATE OF MAINE
DEPARTMENT OF TRANSPORTATION
2425300
WIN
24253.00
HIGHWAY PLANS

DESIGN/DATE	SIGNATURE
CHECKED/REVIEWED	P.E. NUMBER
DESIGNED/DATE	DATE
DESIGNED/DATE	
REVISIONS 1	
REVISIONS 2	
REVISIONS 3	
REVISIONS 4	
FIELD CHANGES	

PROJ. MANAGER	DATE
S. DAVIS	
BY	

SOUTH BRISTOL
ROUTE 129
CROSS SECTIONS

SHEET NUMBER
14
OF 18

Sta. 13+50.00 to Sta. 14+00.00

Date: 10/25/2022

Username:

Division: HIGHWAY

Filename: ... \HIGHWAY\MSTA\... \XSections.dgn

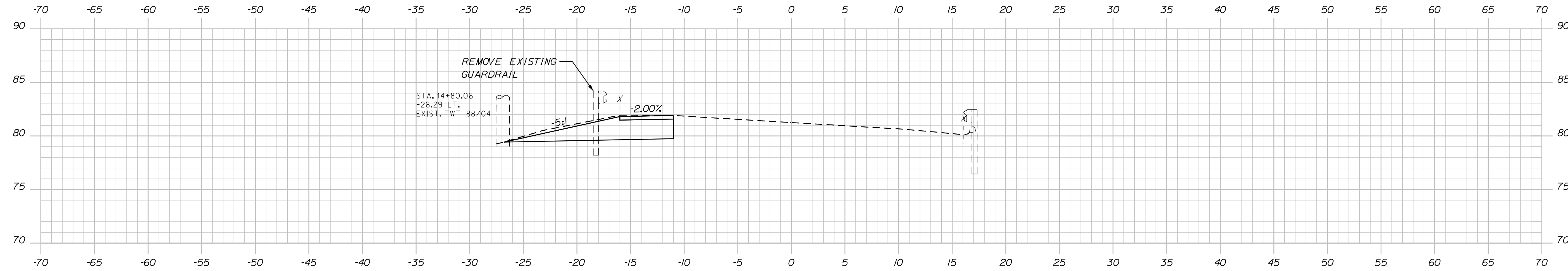

15+00.00

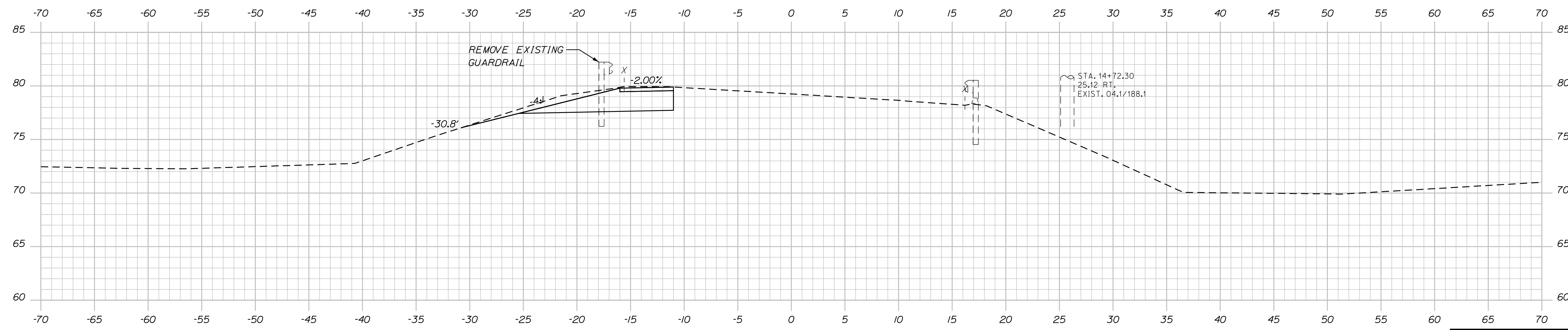

14+50.00

TYLIN INTERNATIONAL

STATE OF MAINE
DEPARTMENT OF TRANSPORTATION
2425300
WIN
24253.00
HIGHWAY PLANS

PROJ. MANAGER	DATE	BY	SIGNATURE
S. DAVIS			
DESIGN DETAILED			
CHECKED-REVIEWED			
DESIGN DETAILED			
DESIGN DETAILED			
REVISIONS 1			
REVISIONS 2			
REVISIONS 3			
REVISIONS 4			
FIELD CHANGES			

SOUTH BRISTOL
ROUTE 129
CROSS SECTIONS

SHEET NUMBER

15

OF 18

Sta. 14+50.00 to Sta. 15+00.00

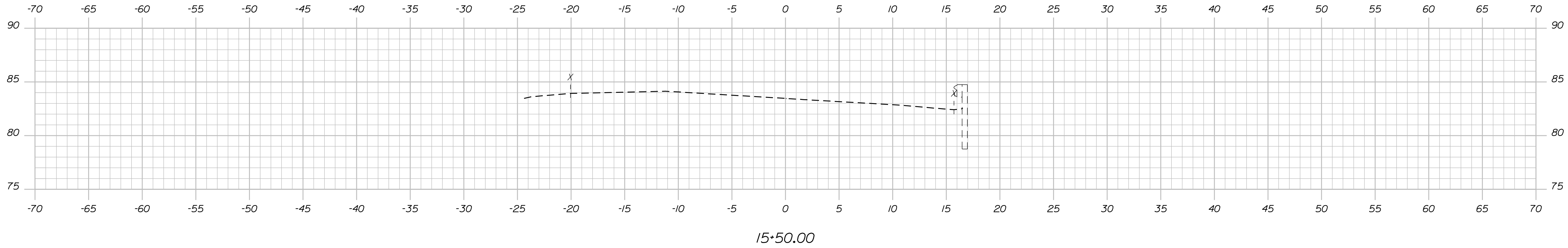

15+50.00

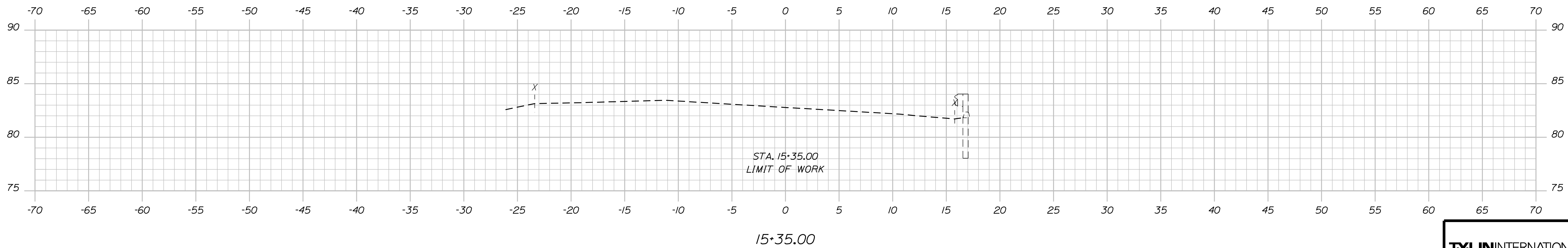

15+35.00

STA. 15+35.00
LIMIT OF WORK



STATE OF MAINE
DEPARTMENT OF TRANSPORTATION
2425300
WIN
24253.00
HIGHWAY PLANS

SIGNATURE
P.E. NUMBER
DATE

PROJ. MANAGER	S. DAVIS	BY	DATE
DESIGN DETAILED			
CHECKED/REVIEWED			
DESIGN DETAILED			
DESIGN DETAILED			
REVISIONS 1			
REVISIONS 2			
REVISIONS 3			
REVISIONS 4			
FIELD CHANGES			

SOUTH BRISTOL
ROUTE 129
CROSS SECTIONS

SHEET NUMBER

16

OF 18

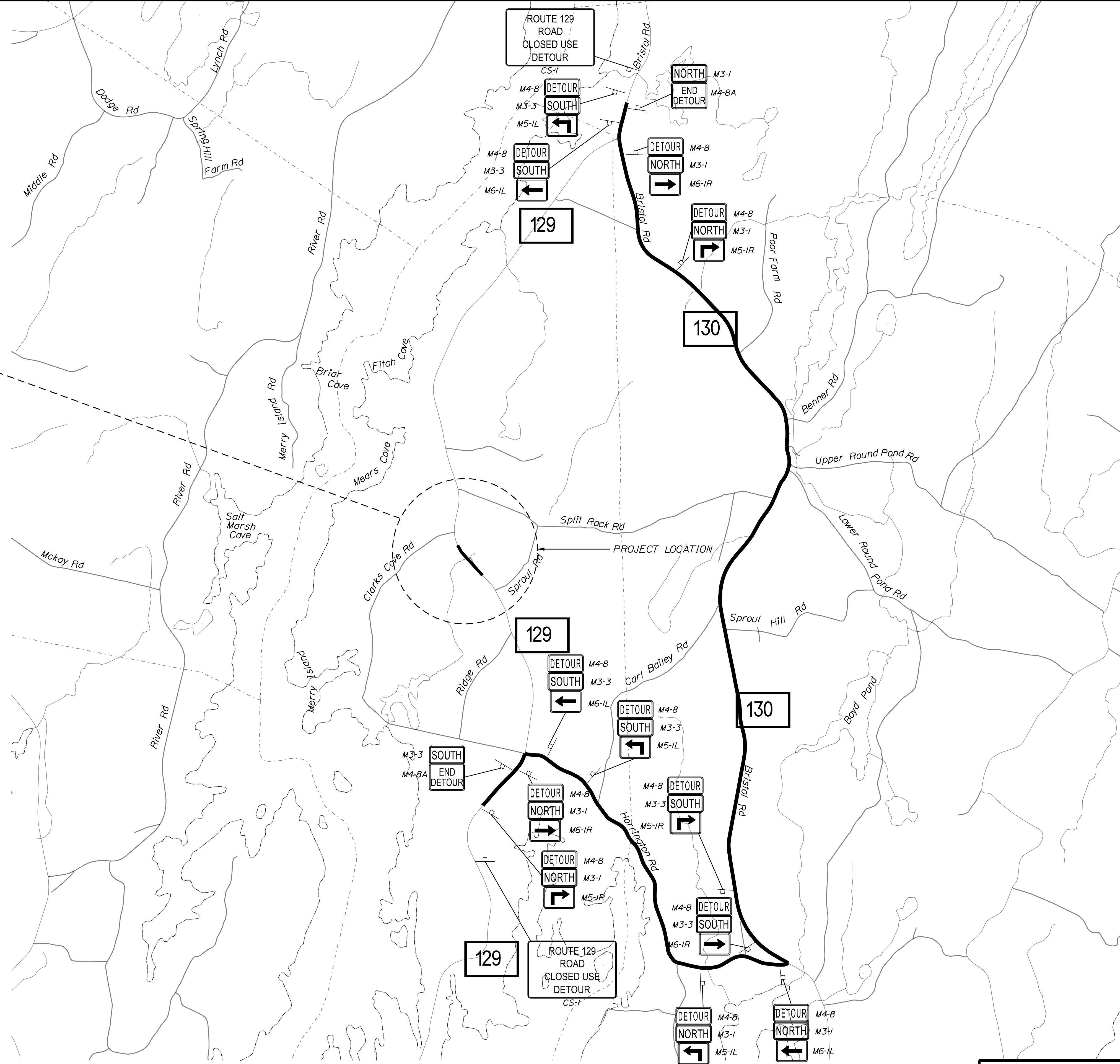
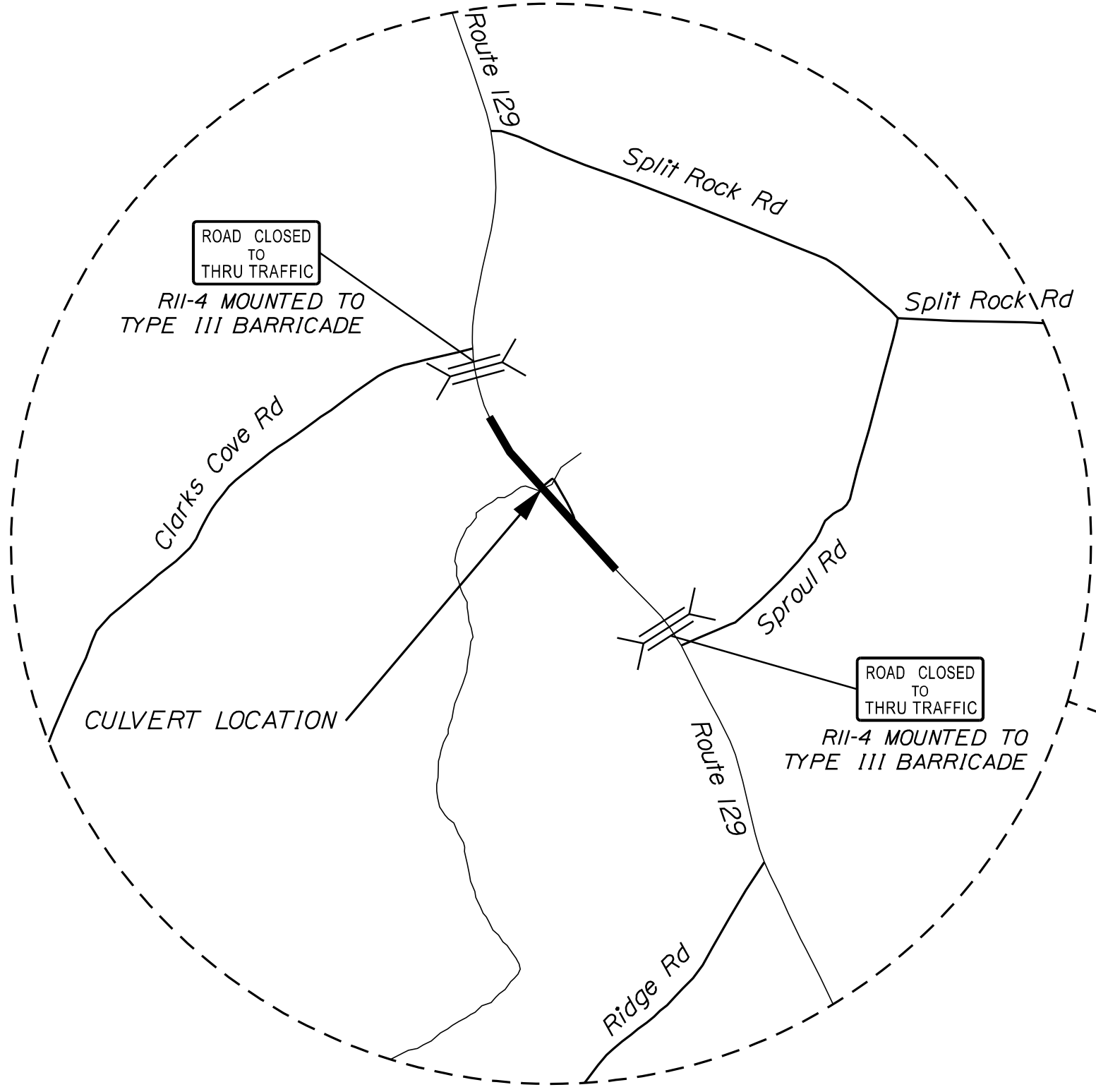

TYLIN INTERNATIONAL

STATE OF MAINE
DEPARTMENT OF TRANSPORTATION
2425300
WIN 24253.00
HIGHWAY PLANS

DESIGN/REVIEWED	DATE	SIGNATURE
CHECKED/REVIEWED		
DESIGN/TAILED		
DESIGN/TAILED		
REVISIONS 1		P.E. NUMBER
REVISIONS 2		DATE
REVISIONS 3		
REVISIONS 4		
FIELD CHANGES		

PROJ. MANAGER	BY	DATE
S. DAVIS		

SOUTH BRISTOL
ROUTE 129
DETOUR PLAN

SHEET NUMBER
17
OF 18

Town, County, State _____
 Approx. Property Lines _____ P.L.
 Existing Right of Way _____
 Limits of Wrought Portion _____ L.O.W.P.
 Control Of Access _____ C.O.A.
 New Right of Way _____
 New Easement _____
 New Temporary Rights _____
 New R/W Within Existing R/W _____

New R/W Along Existing R/W
 Building _____
 Trees Conifer _____
 Tree Line _____
 Water Edge _____
 Ledge _____
 Fence CHAIN LINK _____
 Sign _____
 Clearing Limit Line _____
 Bush Line _____
 Rock/Boulder _____
 Barb Wire _____
 Well _____
 Deciduous _____
 Flag Pole _____
 STOCKADE _____
 MAILBOX _____
 Mailbox _____

PLAN LEGEND

Sanitary Sewer	Existing	Proposed	Traveled Way	Existing	Proposed
Telephone Line	Existing	Proposed	Ditch	Existing	Proposed
Electric Line	Existing	Proposed	Catch Basin	Existing	Proposed
Water Line	Existing	Proposed	Manhole	Existing	Proposed
Underdrain Line	Existing	Proposed	Sewer Manhole	Existing	Proposed
Gas Line	Existing	Proposed	Utility Pole	Existing	Proposed
Guardrail	Existing	Proposed	Fire Hydrant	Existing	Proposed
Culvert	Existing	Proposed	Curbing	Existing	Proposed

Cut Line _____
 Stonewall _____
 Baseline _____
 Monument _____
 Iron Rod Found _____ IRF
 Replacement Pin Set _____
 Fill Line _____
 Retaining Wall _____
 Traverse Point _____
 Pipe Found _____ IPF

THIS PLAN WAS PREPARED IN CONNECTION WITH THE DEPARTMENT'S ACQUISITION OF REAL PROPERTY FOR TRANSPORTATION PURPOSES. IT CANNOT BE USED TO ESTABLISH LEGAL BOUNDARIES BETWEEN ABUTTING PROPERTY OWNERS.

Scale of Feet
 0 25 50 75 100

STATE OF MAINE
 REGISTRY OF DEEDS

COUNTY _____
 RECEIVED _____,
 at _____ h _____ m _____ M and
 recorded in Plan Bk _____, Pg. _____
 Attest: _____ REGISTER

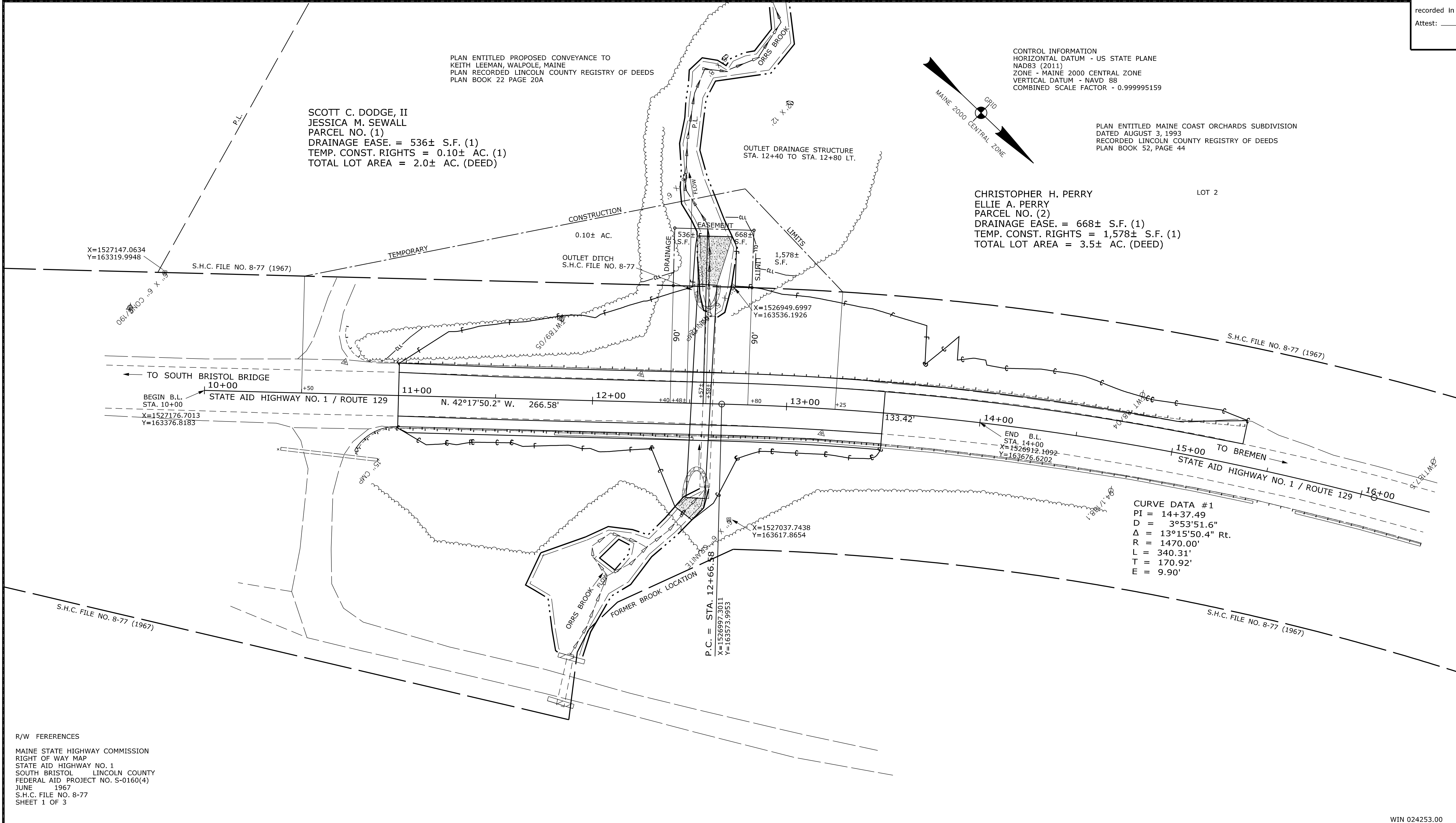

R/W FERERENCES

MAINE STATE HIGHWAY COMMISSION
 RIGHT OF WAY MAP
 STATE AID HIGHWAY NO. 1
 SOUTH BRISTOL LINCOLN COUNTY
 FEDERAL AID PROJECT NO. S-0160(4)
 JUNE 1967
 S.H.C. FILE NO. 8-77
 SHEET 1 OF 3

REVISIONS			PLAN FILED IN PLAN BOOK				PAGE COUNTY RECORD						
NO.	DATE	DESCRIPTION	BY	NO.	GRANTOR	INSTRUMENT	DATE	BOOK	PAGE	COND.	DATE	BOOK	PAGE
							09-26-22	5936	57				

BRUCE A. VAN NOTE
 COMMISSIONER
 JOYCE NOEL TAYLOR
 CHIEF ENGINEER

DATE _____

STATE AID HIGHWAY NO. 1
 ROUTE 129
 SOUTH BRISTOL LINCOLN COUNTY
 FEDERAL AID PROJECT NO. 2425300

JUNE 2022
 SCALE 1" = 25'

RIGHT-OF-WAY MAP
 SHEET 1 OF 1

D.O.T. FILE NO. 8-207

SHEET NUMBER
18
 OF 18

ITEM	TECH	CHECKED
EXISTING CONDITION PLAN	JDF	PNS
FINAL RIGHT OF WAY	JDF	PNS
AREAS	JDF	PNS

STATE OF MAINE
 DEPARTMENT OF TRANSPORTATION
 16 STATE HOUSE STATION - AUGUSTA, ME 04333-0016 - 207-624-3460
 SOUTH BRISTOL
 RIGHT OF WAY MAP

Date: \$date\$
 Username: \$user\$
 Division: \$wkgroup\$
 Filename: \$file\$

WIN 024253.00