

STATE OF MAINE DEPARTMENT OF TRANSPORTATION



CASCO CUMBERLAND COUNTY ROUTE 302 FEDERAL PROJECT NO. 2424900 PROJECT LENGTH: 0.02 MILES

Description	Sheet No.
Title Sheet	1
Estimated Quantities - General Notes	2
Special Detail - Culvert Sliplining	3
Plan / Profile	4
Right of Way	5

PLAN LEGEND	
Town, County, State	-----
Property Lines	-----
R/W Lines-Existing	-----
R/W Lines-Proposed	-----
Culvert-Existing	-----
Culvert Proposed	-----
Curbing Existing	-----
Curbing Proposed	-----
Type 1	-----
Type 3	-----
Type 5	-----
Outline of Bodies of Water	-----
Exposed Bedrock	-----
Buildings	-----
Trees	-----
Tree Line	-----
Clearing Limit Line	-----
Railroad	-----
Catch Basins	Existing Proposed
Manholes	Existing Proposed
Proposed Underdrain	-----
Proposed Ditch	-----
Existing Ditch	-----
Utility Poles	Existing Proposed
Fire Hydrants	Existing Proposed
Existing Water Line	-----
Existing San. Sewer	-----
Existing San. Sewer Manhole	-----
Guardrail-Existing	-----
Guardrail-Proposed	-----
Guardrail-Cable, Other	-----
Centerline-Existing	-----
Centerline-Proposed	-----
Travelway-Existing	-----
Travelway-Proposed	-----
Boring	HB-XXX-###
Pavement Core	PC-#
Test Pit	TP-XXX-###
Probe	P-#. #X
	#, #* = Depth
	X = W (Weathered Rock)
	R (Refusal)
	NR (No Refusal)

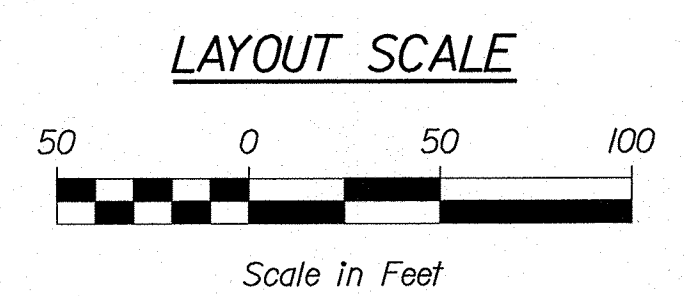
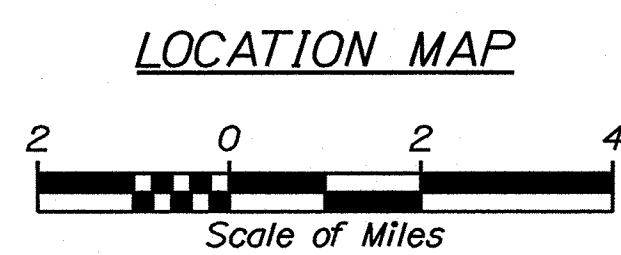
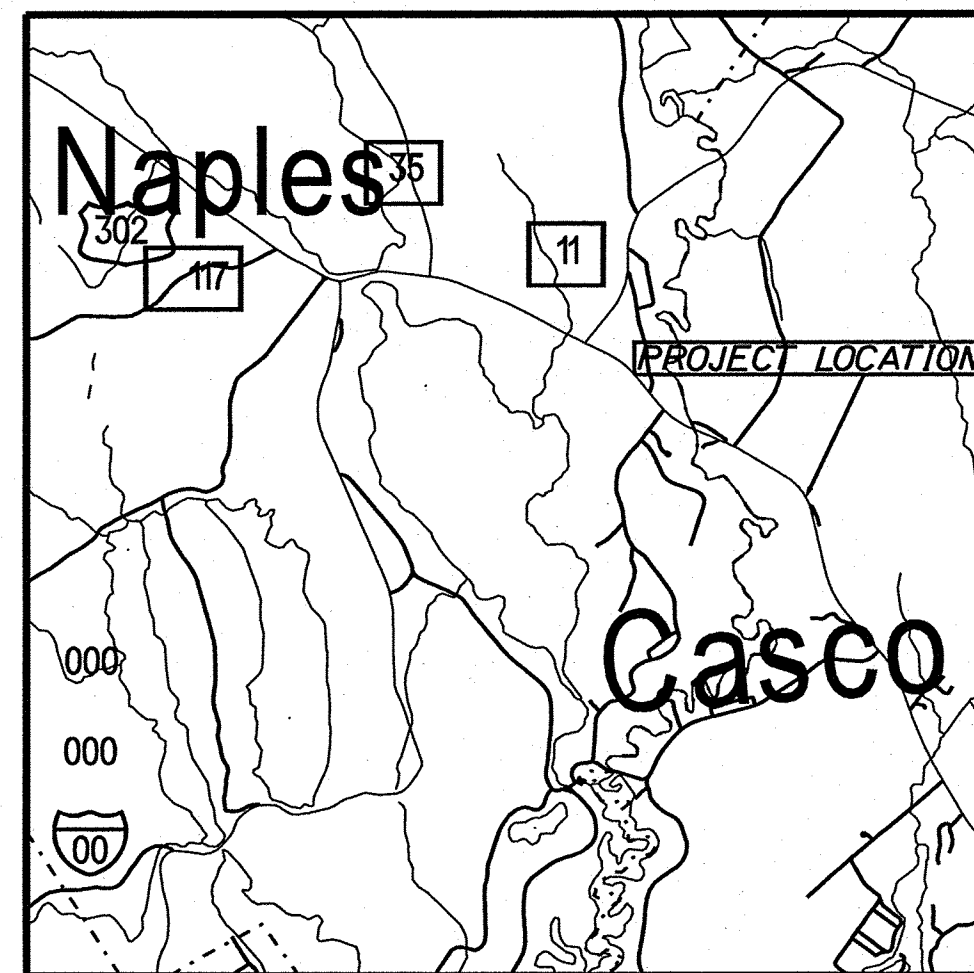
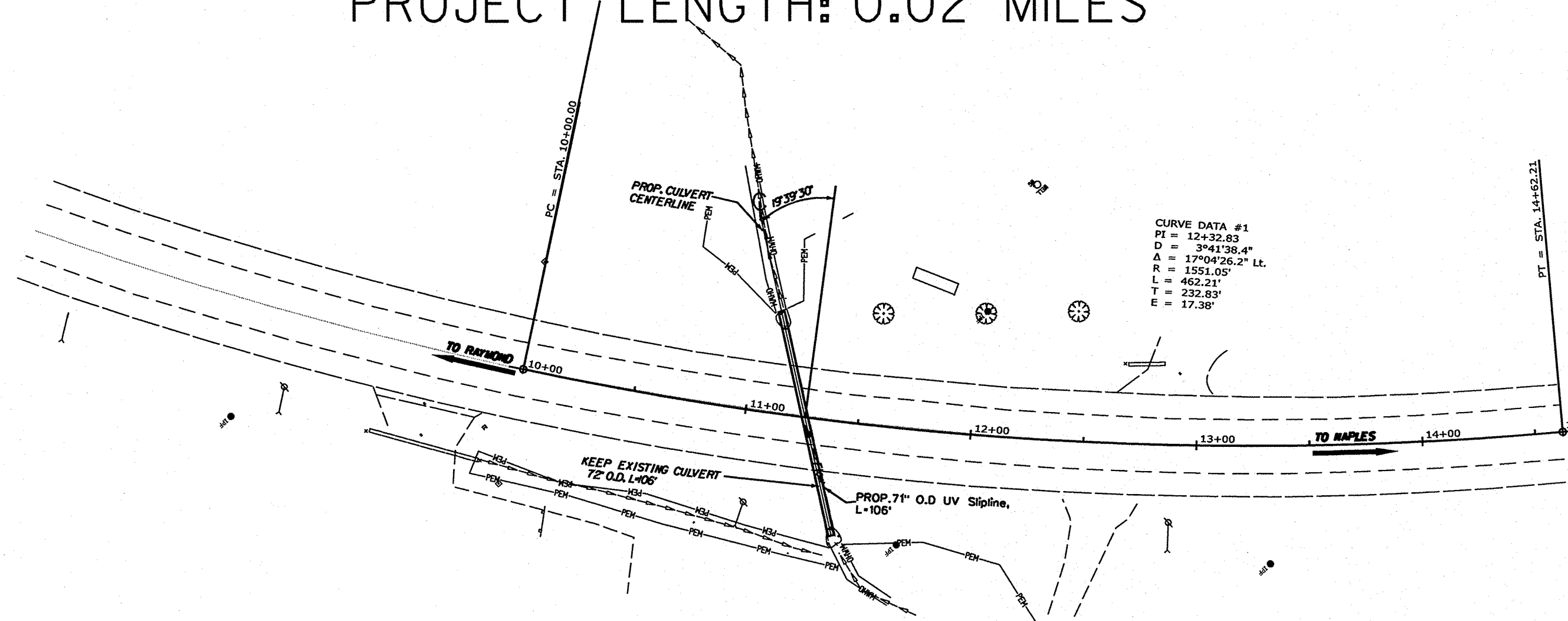

TRAFFIC DATA	
Current (2025) AADT	9260
Future (2037) AADT	9820
DHV - % of AADT11
Design Hour Volume	1080
% Heavy Trucks (AADT)	5
% Heavy Trucks (DHV)	2
Directional Distribution (DHV)65
18-kip Equivalent P 2.0	372
18-kip Equivalent P 2.5	354
Design Speed (mph)	50
Corridor Priority	1

PROJECT LOCATION:	CASCO, ROUTE 302. LARGE CULVERT 46309 LOCATED 0.1 OF MILE NORTH OF BRAMBLE HILL RD
PROGRAM AREA:	REGIONAL PROGRAM
SCOPE OF WORK:	LARGE CULVERT REHABILITATION

STATE OF MAINE DEPARTMENT OF TRANSPORTATION	APPROVED	DATE
COMMISSIONER	[Signature]	3-5-26
CHIEF ENGINEER	[Signature]	3-3-26

STATE OF MAINE DEPARTMENT OF TRANSPORTATION REGISTERED PROFESSIONAL ENGINEER
SIGNATURE
P.E. NUMBER
DATE

PROJECT INFORMATION	
PROGRAM	REGIONAL PROGRAM
PROJECT MANAGER	RYAN HODGMAN
DESIGNER	EYITAYO ADANDE KINTI
CONSULTANT	
PROJECT RESIDENT	
CONTRACTOR	
PROJECT COMPLETION DATE	

CASCO US ROUTE 302 TITLE SHEET

SHEET NUMBER
1
OF 5

WIN 24249.00 FEDERAL PROJECT NO. 2424900

Filename: ... \00\HIGHWAY\MSTAV001_Title.dgn Division: HIGHWAY User: Eytayo.Adandekinti Date: 2/3/2026

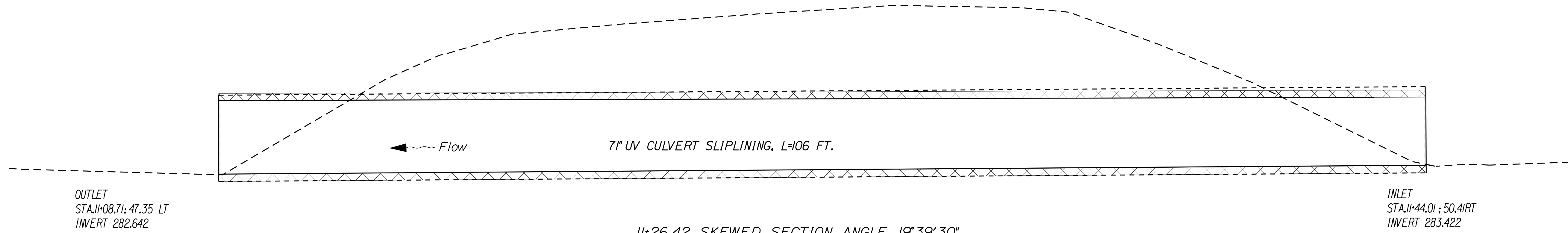

11+26.42 SKEWED SECTION ANGLE 19°39'30"
CULVERT SLIPLINING CROSS SECTION
 N.T.S

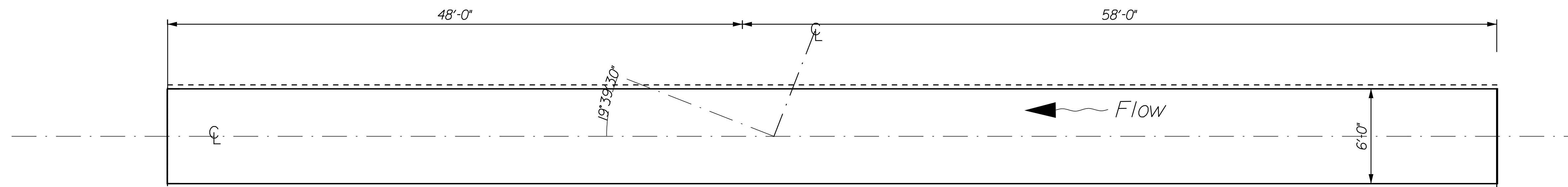

PLAN
 N.T.S

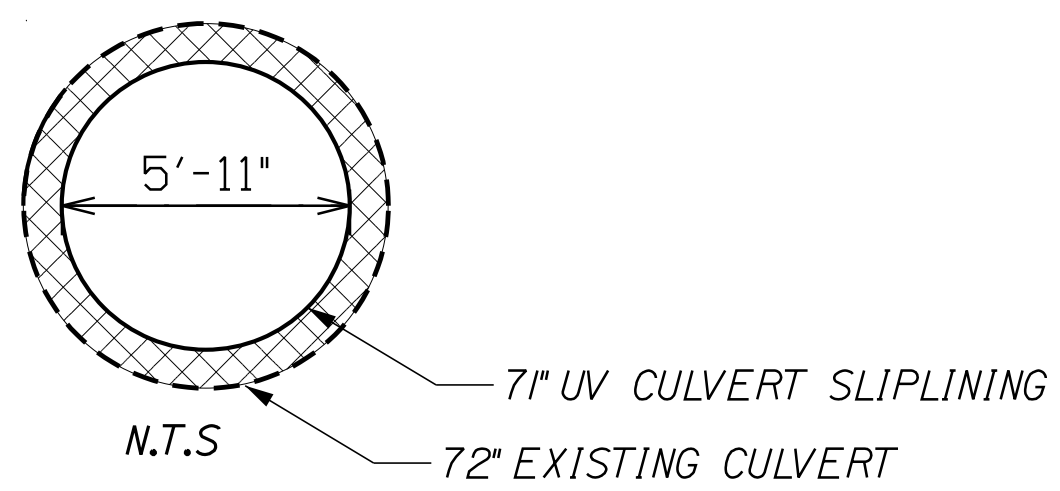

CURED UV LINER
 LINER INFLATED AND
 UV LIGHT TRAIN INSERTED

CULVERT SLIPLINING SECTION
 N.T.S

CULVERT SLIPLINING

COFFERDAMS ARE TO BE PLACED AT BOTH THE DOWNSTREAM AND UPSTREAM ENDS OF THE "STRUCTURE PIPE" TO ALLOW CONSTRUCTION OF THE CULVERT IN DRY.

STATE OF MAINE DEPARTMENT OF TRANSPORTATION	2424900
WIN	24249.00
HIGHWAY PLANS	

PROJ. MANAGER	Ryan, HODDGMAN	BY	Eytayo Adanekinti	DATE	
CHECKED-REVIEWED	Eytayo Adanekinti	SIGNATURE			
DESIGN-REVIEWED		P.E. NUMBER			
DESIGN-DETAILED		DATE			
REVISIONS 1					
REVISIONS 2					
REVISIONS 3					
REVISIONS 4					
FIELD CHANGES					

CASCO
 US ROUTE 302
 SPECIAL DETAIL
 CULVERT SLIPLINING

SHEET NUMBER

3

OF 5

NOT TO SCALE

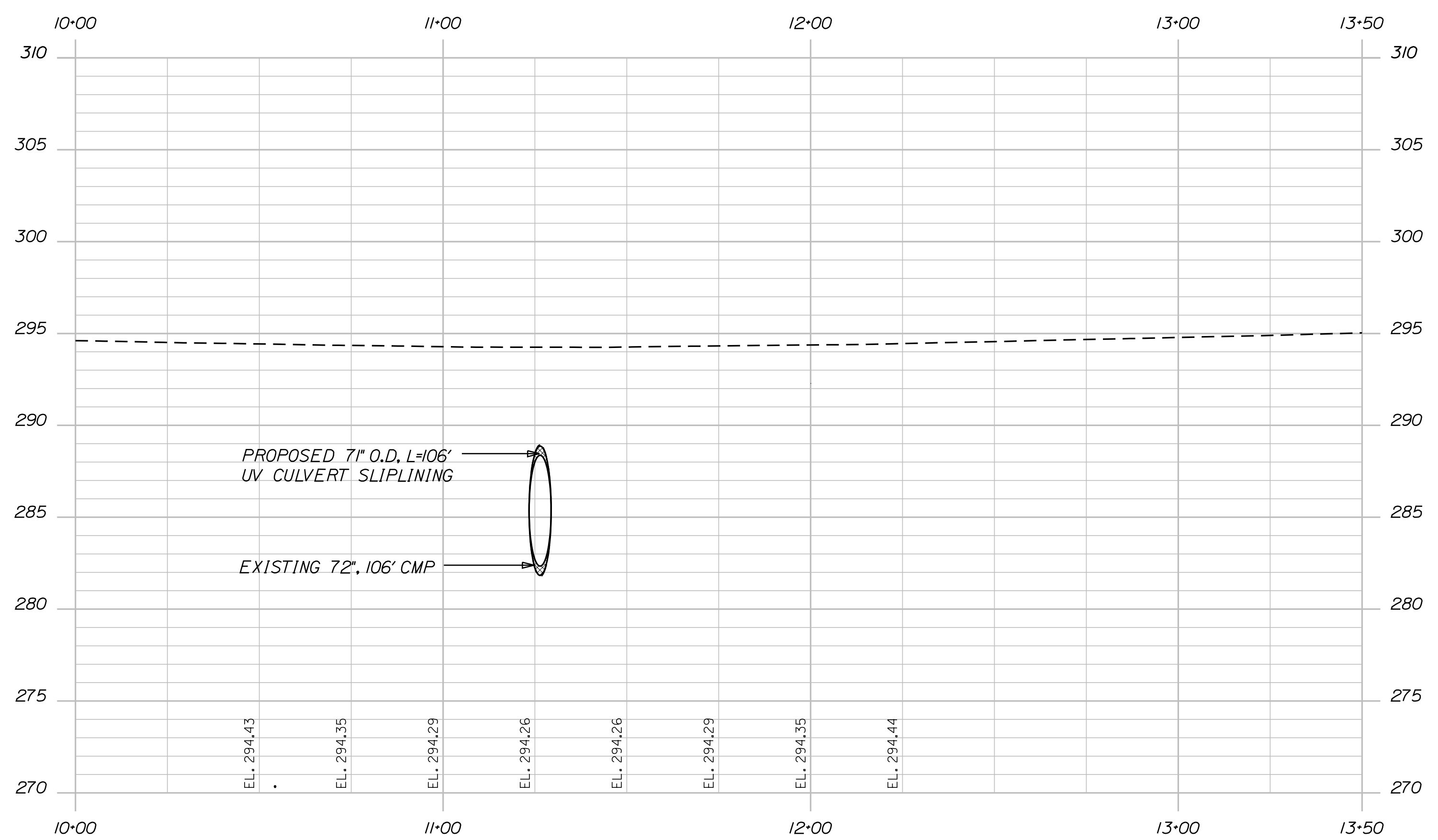
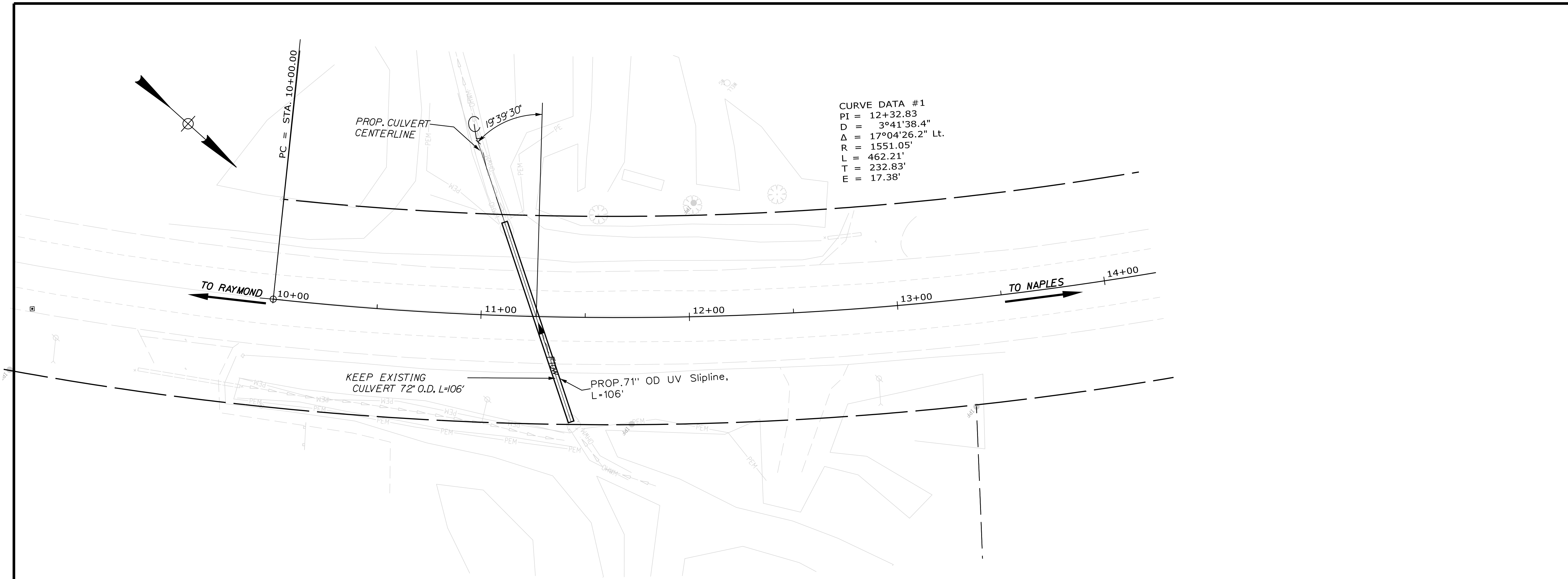

PROFILE

STATE OF MAINE DEPARTMENT OF TRANSPORTATION		2424900	WIN 24249.00	HIGHWAY PLANS
CASCOCASCO US ROUTE 302		PLANS & PROFILE		
SHEET NUMBER		4		
OF 5				

PROJ. MANAGER Rym. HODDAMAN	BY Eytayo Adk	DATE MAR 2025	
DESIGN-DETAILED	CHECKED-REVIEWED	DESIGN-DETAILED	SIGNATURE
DESIGN-DETAILED	DESIGN-DETAILED	DESIGN-DETAILED	P.E. NUMBER
REVISIONS 1	REVISIONS 2	REVISIONS 3	DATE
REVISIONS 4	REVISIONS 4	REVISIONS 4	DATE
FIELD CHANGES			

Filename: ... \HIGHWAY\MSTA005_RWPLAN1.dgn Division: HIGHWAY Username: Eytayo.Adandekinti Date: 2/3/2026

<p>Town, County, State _____ Approx. Property Lines _____ Existing Right of Way _____ Limits of Wrought Portion _____ Control Of Access _____ New Right of Way _____ New Easement _____ New Temporary Rights _____ New R/W Within Existing R/W _____</p>	<p>New R/W Along Existing R/W _____ Building _____ Trees Conifer _____ Tree Line _____ Water Edge _____ Ledge _____ Fence CHAIN LINK _____ Sign _____</p>	<p>Clearing Limit Line _____ Bush Line _____ Rock/Boulder _____ Flag Pole _____ BARB WIRE _____ STOCKADE _____ WELL _____ Mailbox _____</p>	<p>PLAN LEGEND</p> <p>Existing Proposed</p> <p>Sanitary Sewer _____ Telephone Line _____ Electric Line _____ Water Line _____ Underdrain Line _____ Gas Line _____ Guardrail _____ Culvert _____</p> <p>Traveled Way _____ Ditch _____ Catch Basin _____ Manhole _____ Sewer Manhole _____ Utility Pole _____ Fire Hydrant _____ Curbing _____</p>	<p>Cut Line _____ Stonewall _____ Baseline _____ Monument _____ Iron Rod Found _____ Replacement Pin Set _____</p> <p>Fill Line _____ Retaining Wall _____ Traverse Point _____ Pipe Found _____</p>	<p>THIS PLAN WAS PREPARED IN CONNECTION WITH THE DEPARTMENT'S ACQUISITION OF REAL PROPERTY FOR TRANSPORTATION PURPOSES. IT CANNOT BE USED TO ESTABLISH LEGAL BOUNDARIES BETWEEN ADJACENT PROPERTY OWNERS.</p> <p style="text-align: center;">25 0 25 50 75 100 Scale of Feet</p>	<p style="text-align: center;">STATE OF MAINE REGISTRY OF DEEDS</p> <p>COUNTY _____ RECEIVED _____, at _____ h _____ m _____ M and recorded in Plan Bk _____, Pg. _____ Attest: _____ REGISTER</p>
--	--	--	---	--	--	---

CONTROL INFORMATION
 HORIZONTAL DATUM - US STATE PLANE
 NAD83 (2011)
 ZONE - MAINE 2000 WEST ZONE
 VERTICAL DATUM - NAVD 88
 COMBINED SCALE FACTOR - 0.999972716

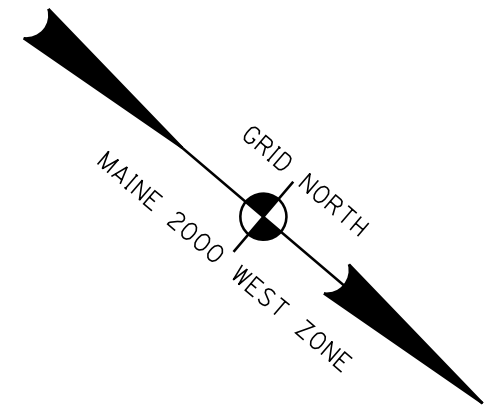

PLAN OF LAND
 WATKINS ESTATE "WEST SIDE" FOR HEIRS OF
 MARTHA E. GLASSFORD, MILDRED DINGLEY
 BY SAWYER ENGINEERING & SURVEYING INC.
 DATE 5/7/02, PLAN NO. 102-34B
 C.C.R.D. PLAN BOOK 202, PAGE 538

HENRY PERLEY WATKINS, JR.
 TAX MAP/LOT: 3/12
 DEED BOOK/PAGE: 18405/234
 POR-1

CURVE DATA #1
 PI = 12+32.83
 D = 3°41'38.4"
 Δ = 17°04'26.2" Lt.
 R = 1551.05'
 L = 462.21'
 T = 232.83'
 E = 17.38'

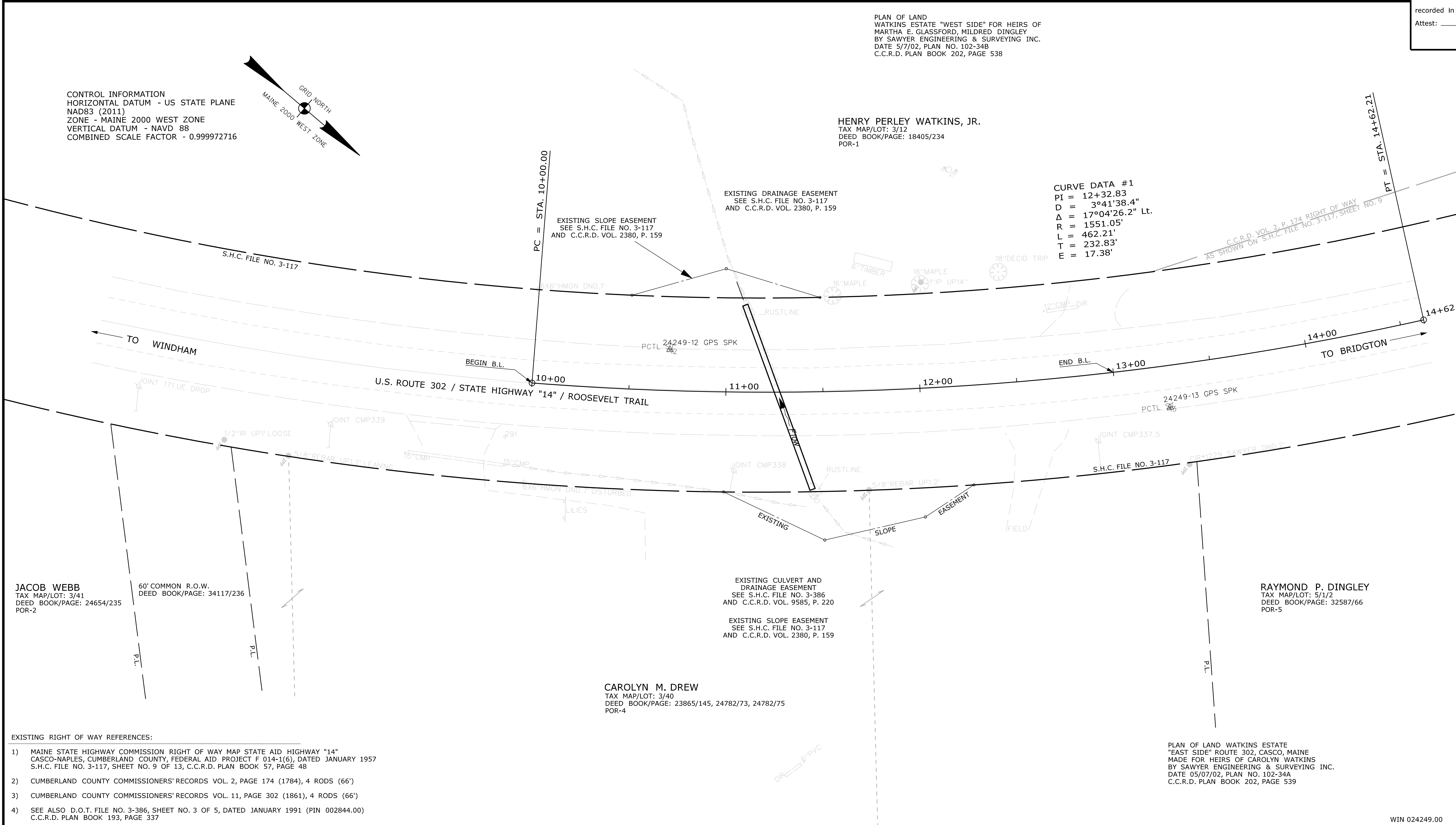

- EXISTING RIGHT OF WAY REFERENCES:**
- 1) MAINE STATE HIGHWAY COMMISSION RIGHT OF WAY MAP STATE AID HIGHWAY "14" CASCO-NAPLES, CUMBERLAND COUNTY, FEDERAL AID PROJECT F 014-1(6), DATED JANUARY 1957 S.H.C. FILE NO. 3-117, SHEET NO. 9 OF 13, C.C.R.D. PLAN BOOK 57, PAGE 48
 - 2) CUMBERLAND COUNTY COMMISSIONERS' RECORDS VOL. 2, PAGE 174 (1784), 4 RODS (66')
 - 3) CUMBERLAND COUNTY COMMISSIONERS' RECORDS VOL. 11, PAGE 302 (1861), 4 RODS (66')
 - 4) SEE ALSO D.O.T. FILE NO. 3-386, SHEET NO. 3 OF 5, DATED JANUARY 1991 (PIN 002844.00) C.C.R.D. PLAN BOOK 193, PAGE 337

PRELIMINARY PLAN

ITEM	TECH	CHECKED
EXISTING CONDITION PLAN	TJP/ENS	CWK
FINAL RIGHT OF WAY		
AREAS		

**STATE OF MAINE
 DEPARTMENT OF TRANSPORTATION**
 16 STATE HOUSE STATION - AUGUSTA, ME 04333-0016 - 207-624-3460
 CASCO
 RIGHT OF WAY MAP

NO.	DATE	REVISIONS DESCRIPTION	BY	PLAN FILED IN PLAN BOOK				PAGE COUNTY RECORD									
				NO.	GRANTOR	INSTRUMENT	DATE	BOOK	PAGE	INSTRUMENT	DATE	BOOK	PAGE				

BRUCE A. VAN NOTE
 COMMISSIONER
 JOYCE NOEL TAYLOR
 CHIEF ENGINEER

**OFFICE USE ONLY
 PLAN NOT TO BE RECORDED**

DATE _____

STATE HIGHWAY "14"
 U.S. ROUTE 302 / ROOSEVELT TRAIL
 CASCO CUMBERLAND COUNTY
 STATE PROJECT NO. 024249.00

JULY 2025
 SCALE 1" = 25'

RIGHT-OF-WAY MAP
 SHEET 1 OF 1

SHEET NUMBER
5
 OF 5

WIN 024249.00