

STATE OF MAINE DEPARTMENT OF TRANSPORTATION



STATEWIDE UPGRADES OF CHANGEABLE MESSAGE SIGNS PROJECT NO: 2423900 SEVEN LOCATIONS

- Site 1 (I-295 NB at MM 2.1, South Portland)
- Site 2 (I-295 SB at MM 8.0, Portland)
- Site 3 (I-95 NB at MM 108.3 Winthrop Street Bridge, Hallowell)
- Site 4 (I-95 NB at MM 169.1 Cook Road Bridge, Carmel)
- Site 5 (I-95 NB at MM 179.0, Hampden)
- Site 6 (I-95 SB at MM 189.0 Chase Road Bridge, Bangor)
- Site 7 (I-95 SB at MM 118.1 Dinsmore Road Bridge, Sidney)

INDEX OF SHEETS

| | |
|---|------|
| Title Sheet..... | 1 |
| Location Maps..... | 2 |
| Estimated Quantities & General Notes..... | 3 |
| Sign Details..... | 4-7 |
| Site Plans 1-7..... | 8-14 |

PROJECT NO: 2423900

WIN 024239.00

STATEWIDE UPGRADES
OF
CHANGEABLE MESSAGE SIGNS

SHEET NUMBER

1

OF 14

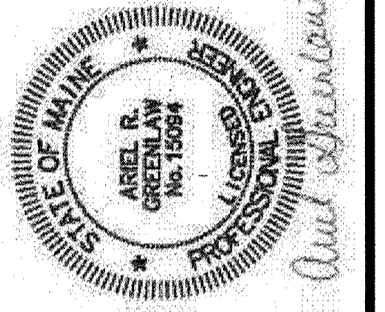

| | |
|-------------|-------------------|
| SIGNATURE | ABEL R. GREEN |
| P.E. NUMBER | 15094 |
| DATE | November 10, 2022 |

| | | |
|--|----------|------------|
| STATE OF MAINE DEPARTMENT OF TRANSPORTATION | APPROVED | DATE |
| COMMISSIONER: <i>[Signature]</i> | | 11-27-22 |
| CHIEF ENGINEER: <i>[Signature]</i> | | 11-17-2022 |

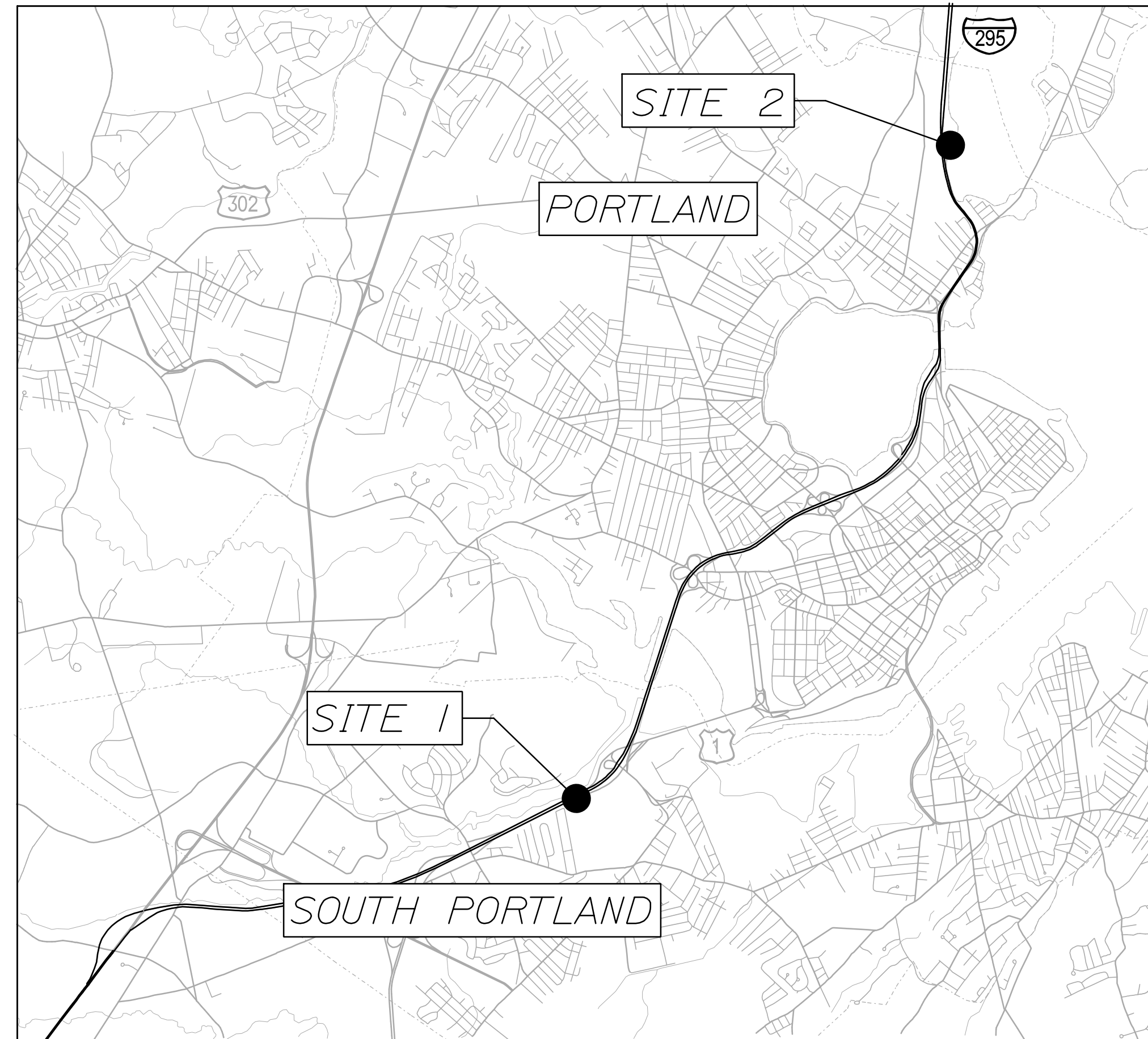

PORTLAND AREA LOCATION MAP
N.T.S.

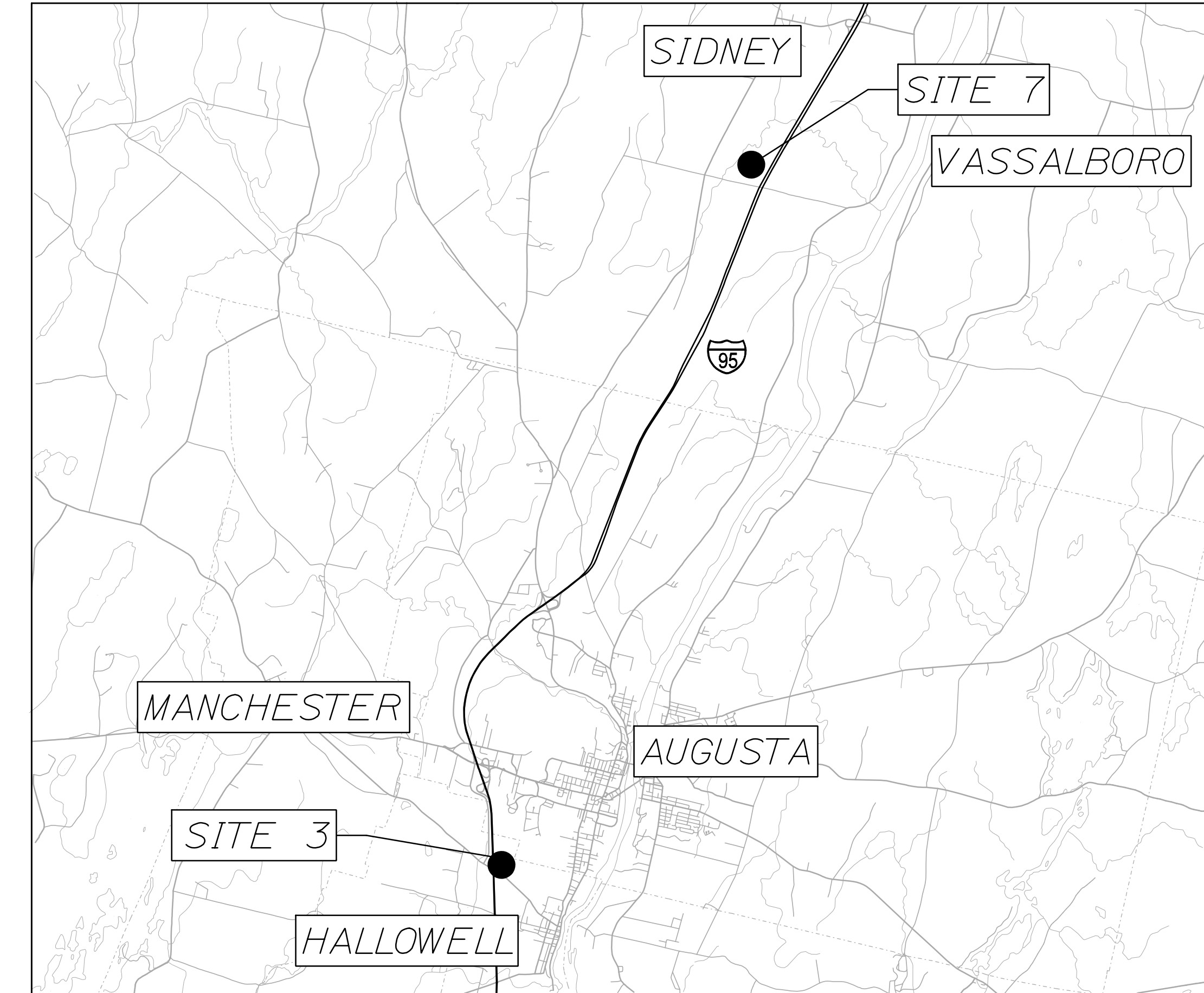

AUGUSTA AREA LOCATION MAP
N.T.S.

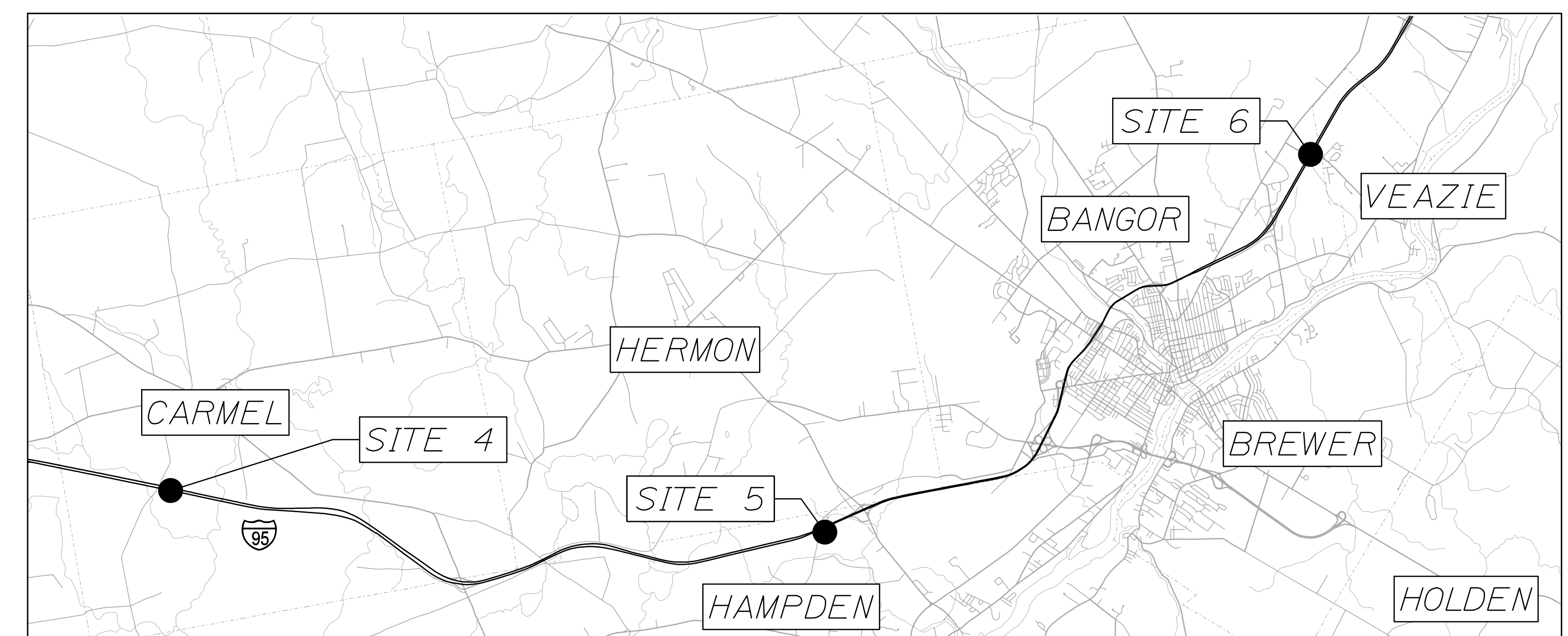

BANGOR AREA LOCATION MAP
N.T.S.

SITE LOCATION AND SCOPE OF WORK

- Site 1 (I-295 NB at MM 2.1, South Portland - CMS Replacement, Co-Locate CCTV PTZ Camera with Radar on Existing Pole)
- Site 2 (I-295 SB at MM 8.0, Portland - CMS Replacement, Co-Locate CCTV PTZ Camera with Radar on Existing Pole)
- Site 3 (I-95 NB at MM 108.3, Winthrop Street Bridge, Hallowell - CMS Replacement, Install CCTV PTZ Camera on New Pole)
- Site 4 (I-95 NB at MM 169.1, Cook Road Bridge, Carmel - CMS, Structural Support and Foundation Removal)
- Site 5 (I-95 NB at MM 179.0, Hampden - CMS Replacement, Install CCTV PTZ Camera on New Pole)
- Site 6 (I-95 SB at MM 189.0, Chase Road Bridge, Bangor - CMS Replacement, Install CCTV PTZ Camera on New Pole)
- Site 7 (I-95 SB at MM 118.1, Dinsmore Rd Bridge, Sidney - Foundation, Relocate Structural Support, Install CMS and CCTV PTZ Camera on New Pole)

| | | | | | |
|--|-----------------|---------|---------------|------------------|--|
| STATE OF MAINE DEPARTMENT OF TRANSPORTATION | | 2423900 | | WIN 024239.00 | |
| PROJ. MANAGER | DESIGN DETAILED | WJL | WJL | DATE | |
| CHECKED/REVIEWED | WJL | ARG | ARG | DATE | |
| DESIGN DETAILED | WJL | ARG | ARG | DATE | |
| REVISIONS 1 | | | | DATE | |
| REVISIONS 2 | | | | DATE | |
| REVISIONS 3 | | | | DATE | |
| REVISIONS 4 | | | | DATE | |
| FIELD CHANGES | | | | DATE | |
| STATEWIDE UPGRADES OF CHANGEABLE MESSAGE SIGNS | | | LOCATION MAPS | | |
| SHEET NUMBER | | | 2 | | |
| | | | OF 14 | | |



| ITEM NO. | DESCRIPTION | ESTIMATED QUANTITIES | | | | | | | | UNIT |
|----------|---|----------------------|-----------------|-----------------|-----------------|-----------------|-----------------|-----------------|----------------|------|
| | | SITE 1 QUANTITY | SITE 2 QUANTITY | SITE 3 QUANTITY | SITE 4 QUANTITY | SITE 5 QUANTITY | SITE 6 QUANTITY | SITE 7 QUANTITY | TOTAL QUANTITY | |
| 202.01 | Removal of Changeable Message Sign | 1 | 1 | 1 | 1 | 1 | 1 | 0 | 6 | EA |
| 203.20 | Common Excavation | 0 | 0 | 0 | 0 | 0 | 0 | 5 | 5 | CY |
| 206.061 | Structural Earth Excavation - Drainage & Minor Structures Below Grade | 0 | 0 | 0 | 0 | 0 | 0 | 7 | 7 | CY |
| 304.10 | Aggregate Subbase Coarse - Gravel | 0 | 0 | 0 | 0 | 0 | 0 | 5 | 5 | CY |
| 615.072 | Loam, Seed, Mulch | 0.16 | 0.16 | 0.16 | 0.04 | 0.16 | 0.16 | 0.16 | 1 | LS |
| 626.11 | Precast Concrete Junction Box | 0 | 0 | 1 | 0 | 1 | 3 | 3 | 8 | EA |
| 626.22 | Non-Metallic Conduit | 0 | 0 | 80 | 0 | 60 | 60 | 400 | 600 | LF |
| 626.36 | Remove or Modify Concrete Foundation | 0 | 0 | 0 | 1 | 0 | 0 | 0 | 1 | EA |
| 626.501 | Spread Footing Foundation | 0 | 0 | 0 | 0 | 0 | 0 | 9 | 9 | CY |
| 629.05 | Hand Labor Straight Time | 2 | 2 | 2 | 2 | 2 | 2 | 2 | 14 | HR |
| 631.12 | All-Purpose Excavator (Including Operator) | 0 | 0 | 0 | 2 | 0 | 0 | 2 | 4 | HR |
| 631.13 | Bulldozer (Including Operator) | 0 | 0 | 0 | 0 | 0 | 0 | 4 | 4 | HR |
| 631.15 | Roller, Earth and Base (Including Operator) | 0 | 0 | 0 | 0 | 0 | 0 | 4 | 4 | HR |
| 631.172 | Truck - Large (Including Operator) | 2 | 2 | 2 | 2 | 2 | 2 | 2 | 14 | HR |
| 643.931 | 40' Wood Utility Pole | 0 | 0 | 1 | 0 | 1 | 1 | 1 | 4 | EA |
| 645.155 | Changeable Message Sign | 1 | 1 | 1 | 0 | 1 | 1 | 1 | 6 | EA |
| 652.39 | Work Zone Traffic Control | 0.14 | 0.14 | 0.14 | 0.14 | 0.14 | 0.14 | 0.16 | 1 | LS |
| 654.211 | Closed Circuit Television | 1 | 1 | 1 | 0 | 1 | 1 | 1 | 6 | EA |
| 656.75 | Temporary Soil Erosion & Water Pollution | 0 | 0 | 0 | 0 | 0 | 0 | 1 | 1 | LS |
| 659.10 | Mobilization | 0.14 | 0.14 | 0.14 | 0.14 | 0.14 | 0.14 | 0.16 | 1 | LS |

GENERAL CONSTRUCTION NOTES

- Approval of Traffic Control Plans by MaineDOT is required prior to beginning any site work. Site #3 is located on Maine Turnpike Authority property. Access to the site shall be from Winthrop Street. Access from the Maine Turnpike is not permitted without a work permit. Payment for work to be under item 652.39 Work Zone Traffic Control.
- Plans are not based on survey. Contractor shall verify all site information prior to commencing any work.
- The following abbreviations can be found on the site plans:
 CCTV = Closed Circuit Television
 CMS = Changeable Message Sign
 PTZ = Pan Tilt Zoom
 OHET = Overhead Electric and Telephone
 MM = Mile Marker
- Removal of stumps and grubbing paid for as Common Excavation (Item 203.20).
- The location of the existing utilities and drainage are not shown on the Plans. Contractor shall coordinate with Digsafe and appropriate authorities to determine utility locations prior to beginning any work. See Utility 104 Special Provisions for utility representatives and contact information.
- Any necessary fine grading or recompaction of existing gravel shall not be paid for directly and shall be considered incidental to Aggregate Subbase Course - Gravel (Item 304.10).
- Any damage to the existing roads, slopes or pipes caused by the Contractor's equipment, personnel or operation shall be repaired to the satisfaction of the Resident at the Contractor's expense.
- Contractor shall note that some sites may have portable changeable message signs in use. MaineDOT will remove these signs prior to the construction activity. Contractor shall notify Resident 48 hrs in advance of site mobilization.
- Installation of guy wires to support proposed utility/service poles shall be considered incidental to CCTV (Item 654.211).

- Per "utility accommodation rules", section #10 underground installations, 5. Electric supply lines: utilizing PVC conduit (for power service) within highway right-of-way shall be encased (surround) in concrete prior to disconnect/breaker: all conduits shall be installed with 36" minimum cover depth.
- All utility splices will be made in the cabinets or junction boxes meeting MaineDOT Specifications.
- The Contractor is responsible for furnishing and installing power meters if required. All work shall conform with the local utility requirements. This work will be incidental to Changable Message Sign (Item 645.155).
- Junction boxes shall be installed every 300 ft. minimum in conduit runs. Payment shall be made under standard item 626.11.
- Existing changeable message signs shall be removed and disposed of by contractor in accordance with Maine Department of Environmental Protection rules and regulations.
- Coaxial communication drops shown are approximate and shall be confirmed during utility coordination.
- CCTV Systems and Changable Message Sign Devices shall be integrated into New England Compass 511. It is the responsibility of the Contractor to ensure that communication can be made to and from the devices.
- CCTV Systems shall be installed such that upstream and downstream traffic can both be observed. If relocation is required to improve pan tilt zoom capabilities, this work shall be incidental to CCTV System (Item 654.211).
- All CCTV PTZ Cameras shall be Axis Q 6074-E. No approved equal cameras are acceptable for installation.

STATE OF MAINE
DEPARTMENT OF TRANSPORTATION
2423900
WIN
024239.00

DATE 11/22
BY WIL ARG
SIGNATURE
P.E. NUMBER
DATE

PROJ. MANAGER
DESIGN-DETAILED WIL
CHECKED-REVIEWED JSM
DESIGN-DETAILED
REVISIONS 1
REVISIONS 2
REVISIONS 3
FIELD CHANGES 4

STATEWIDE UPGRADES
OF
CHANGEABLE MESSAGE SIGNS
&
ESTIMATED QUANTITIES &
GENERAL NOTES

SHEET NUMBER
3
OF 14



Date: 11/29/2022

Username:

Division:

Filename: 004_specsigndetails.dgn

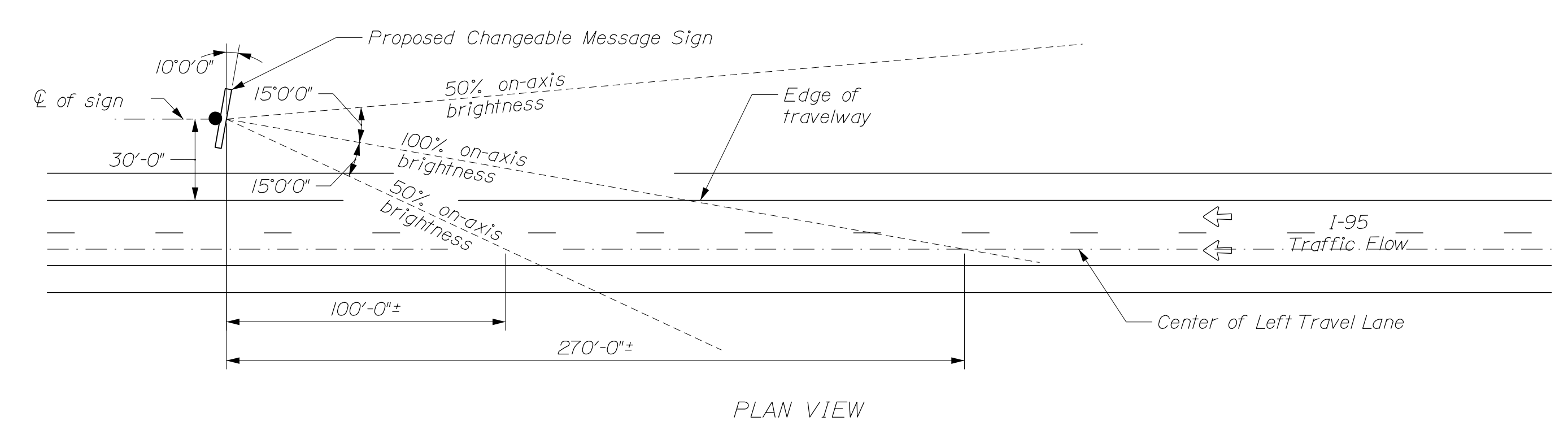
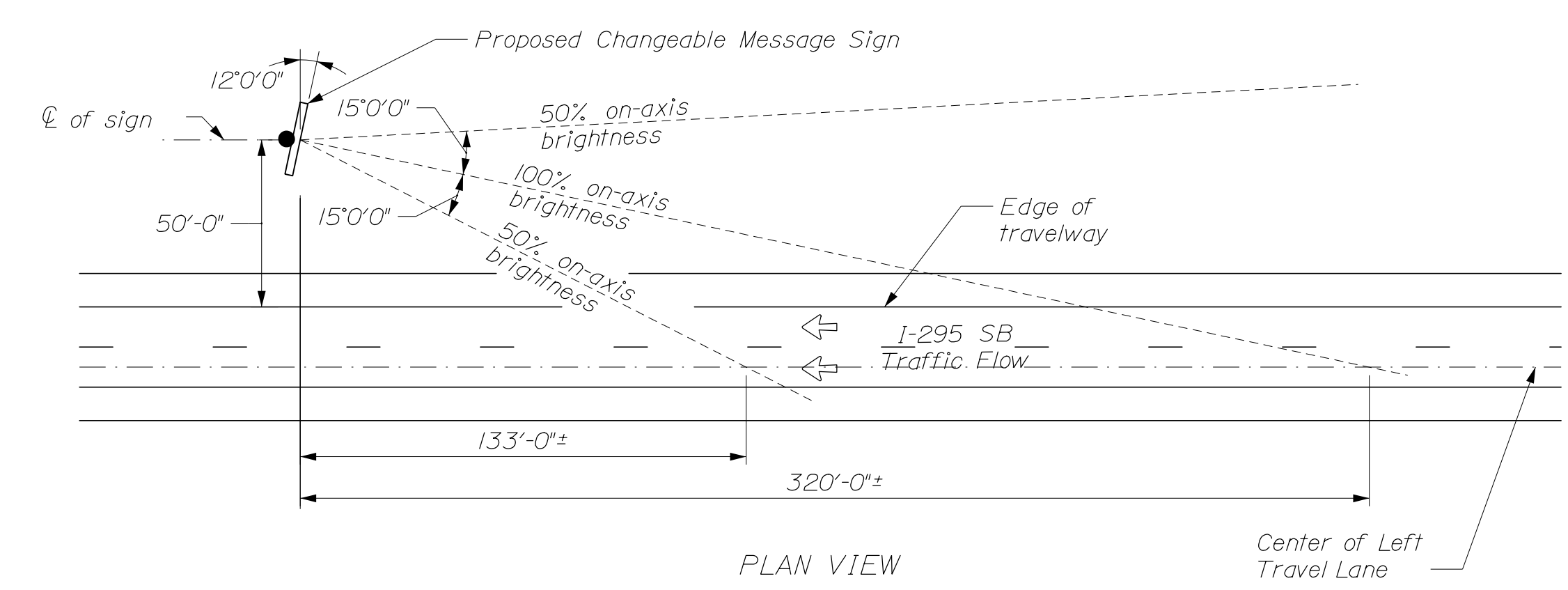
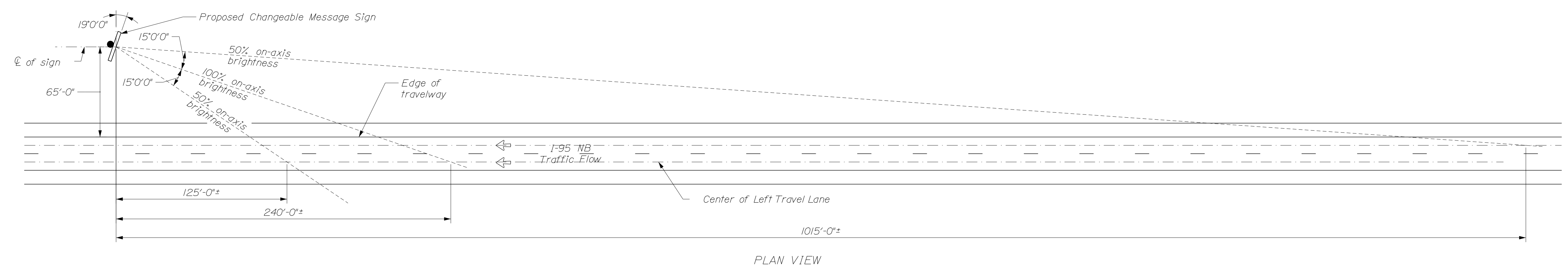
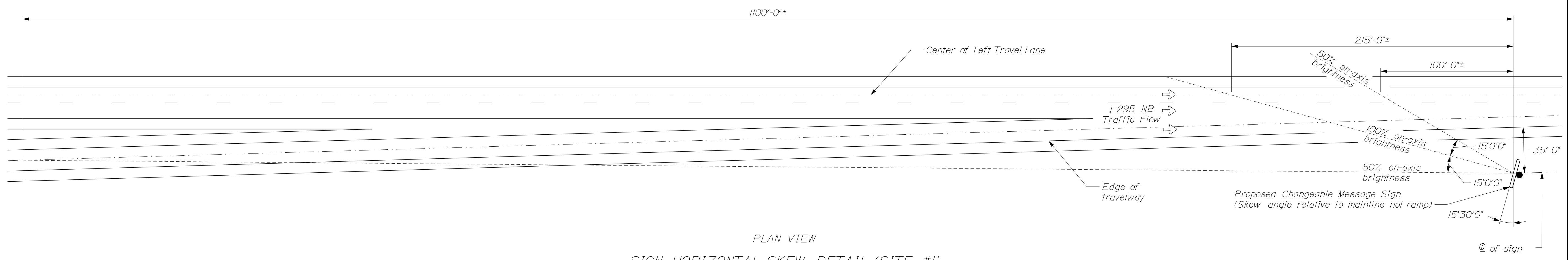

NOTES:

1. Contractor shall be responsible for the correct orientation of the sign. The cone of vision criteria for placement of the sign is diagrammatic. Contractor shall verify site condition and correct height of the sign. Calculation certifying that the optimum viewing of the signs is achieved, at distances defined in these details, shall be submitted to the Resident for approval prior to installation of the sign.

STATE OF MAINE
DEPARTMENT OF TRANSPORTATION
2423900
WIN
024239.00

| PROJ. MANAGER | BY | DATE | SIGNATURE | P.E. NUMBER | DATE |
|------------------|-----|-------|-----------|-------------|------|
| DESIGN DETAILED | WJL | 11/22 | | | |
| CHECKED/REVIEWED | WJL | 11/22 | | | |
| DESIGN DETAILED | ARG | | | | |
| DESIGN DETAILED | | | | | |
| REVISIONS 1 | | | | | |
| REVISIONS 2 | | | | | |
| REVISIONS 3 | | | | | |
| REVISIONS 4 | | | | | |
| FIELD CHANGES | | | | | |

STATEWIDE UPGRADES
OF
CHANGEABLE MESSAGE SIGNS
SIGN SPECIAL DETAILS I

SHEET NUMBER
4
OF 14



Date: 11/29/2022

Username:

Division:

Filename: 005_specsigndetails.dgn

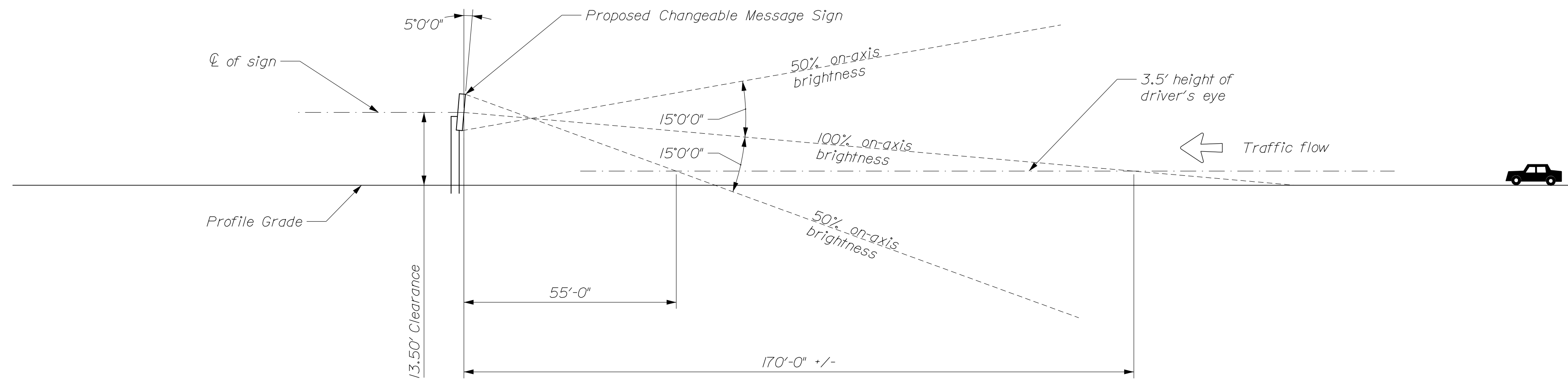

PROFILE VIEW
SIGN VERTICAL TILT DETAIL

NOTES:

1. Graphic shown assumes level roadway grade. Contractor shall determine the roadway profile grade at a distance of 900± in advance of the sign. If roadway approach grade is not level, Contractor shall adjust sign vertical tilt 1° forward or backward for every 1° of roadway slope. For example, if roadway approaching the sign slopes up at 2°, then sign tilt shall be adjusted 2° forward resulting in an overall sign tilt of 7°. If roadway slopes down at 1° approaching the sign, then the sign tilt shall be adjusted 1° backward resulting in an overall sign tilt of 4°. Coordinate work with the Resident.

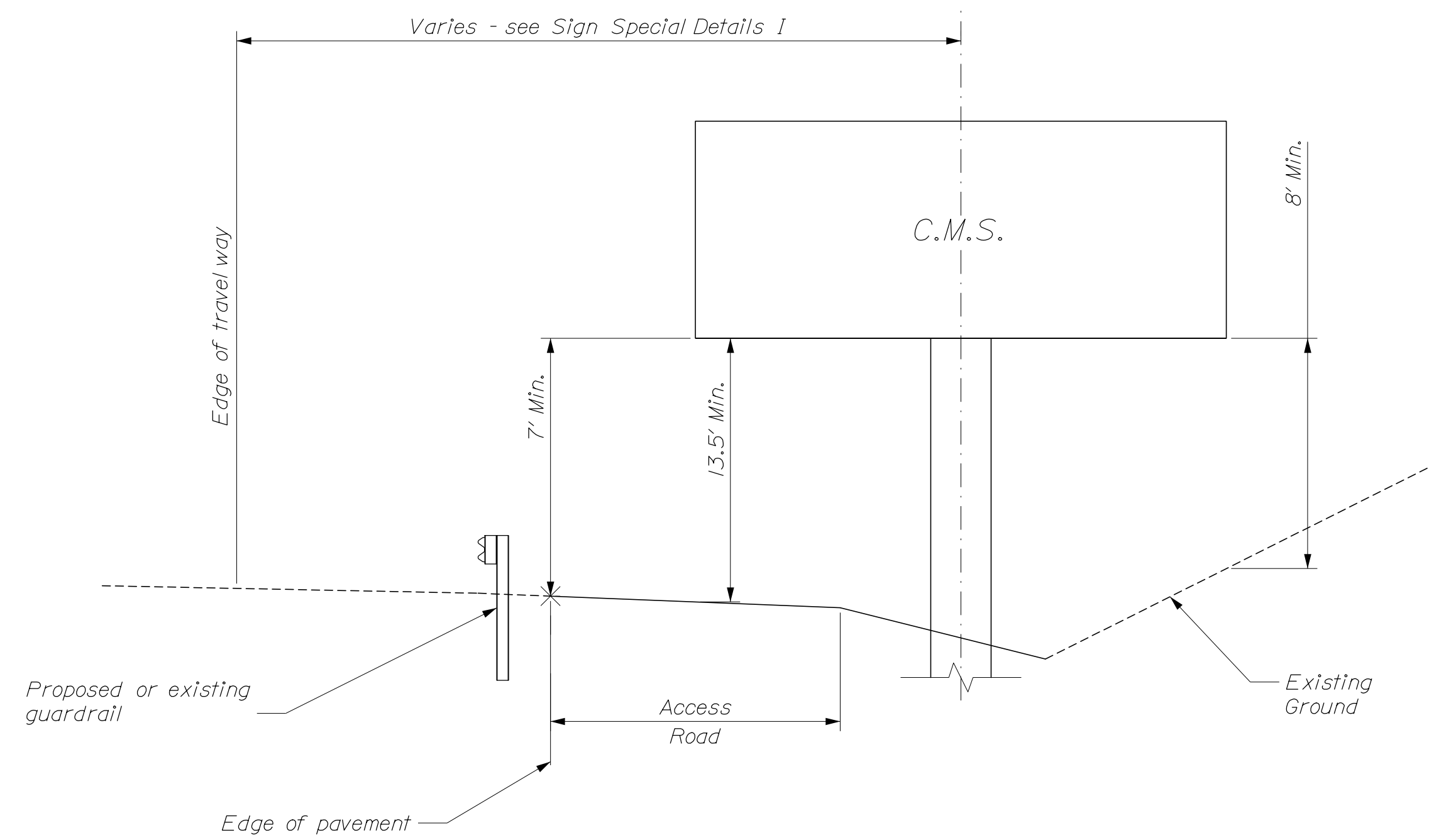

SIGN HEIGHT DETAIL

NOTES:

1. The sign height shall be verified by the Resident in the field. The Contractor shall gather existing ground topography necessary to determine the cross section at each sign location.
2. Contractor shall submit shop drawings for proposed sign height at Site 7 to Resident for review and approval. Payment for work shall be incidental to Pay Item 645.155.

STATE OF MAINE
DEPARTMENT OF TRANSPORTATION

2423900

WIN
024239.00

DATE
11/22
11/22

SIGNATURE

P.E. NUMBER

DATE

BY
WIL
ARG

PROJ. MANAGER
DESIGN DETAILED
CHECKED-REVIEWED
DESIGN DETAILED
DESIGN DETAILED
REVISIONS 1
REVISIONS 2
REVISIONS 3
REVISIONS 4
FIELD CHANGES

WIL
ARG

WIL
ARG

WIL
ARG

WIL
ARG

WIL
ARG

WIL
ARG

WIL
ARG

WIL
ARG

WIL
ARG

WIL
ARG

WIL
ARG

WIL
ARG

WIL
ARG

WIL
ARG

WIL
ARG

WIL
ARG

WIL
ARG

WIL
ARG

WIL
ARG

WIL
ARG

WIL
ARG

STATEWIDE UPGRADES
OF
CHANGEABLE MESSAGE SIGNS

SHEET NUMBER

5

OF 14

HNTB

FOUNDATION NOTES

1. All reinforcing steel shall be uncoated and comply with ASTM 615, Grade 60.
2. Steel anchor bolts and hardware shall be galvanized in accordance with ASTM A153.
3. A qualified geotechnical consultant shall be present to monitor materials used during construction and confirm that soil conditions and construction methods are consistent with the Schonewald Engineering Associates Geotechnical Engineering report of November 2022.

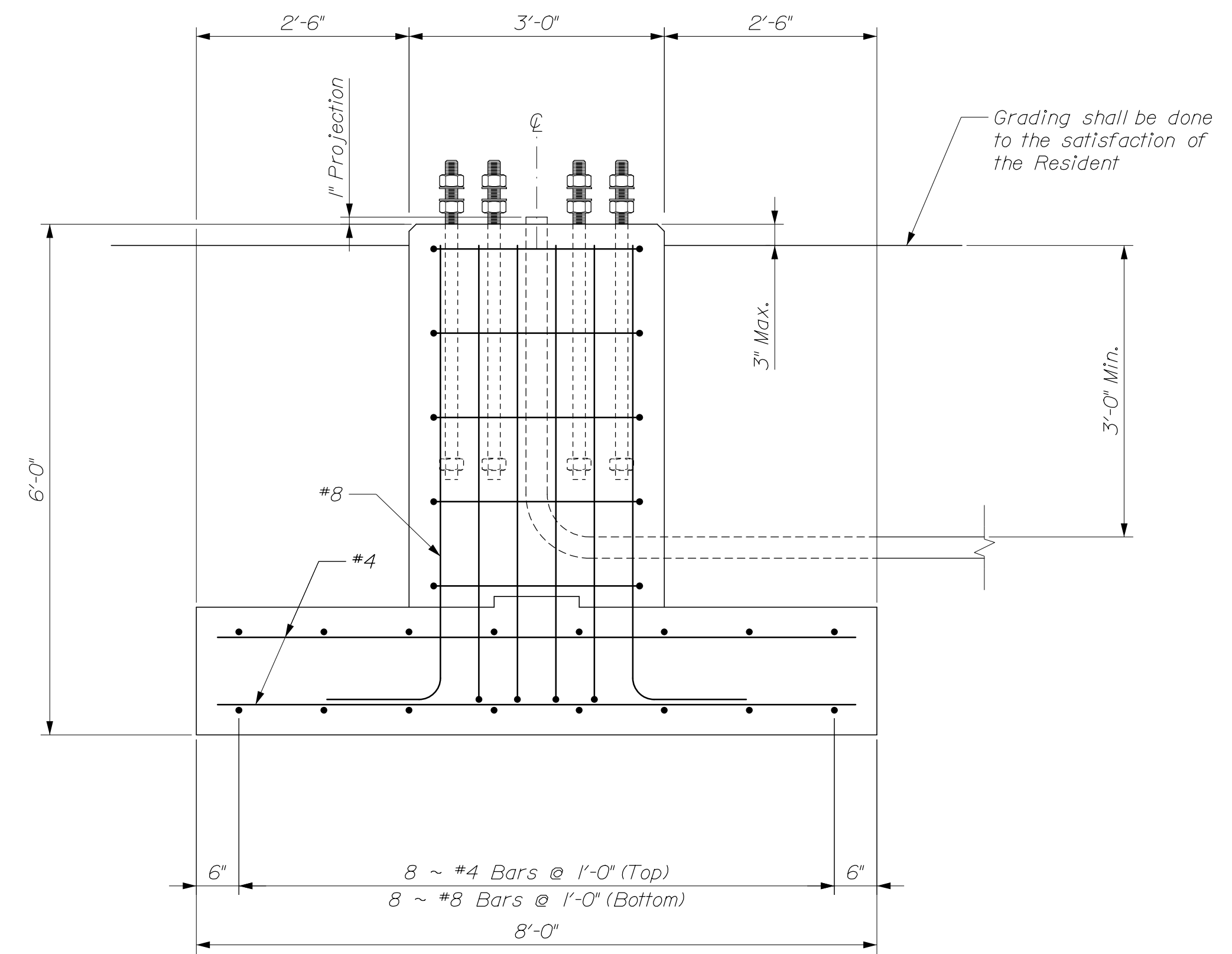
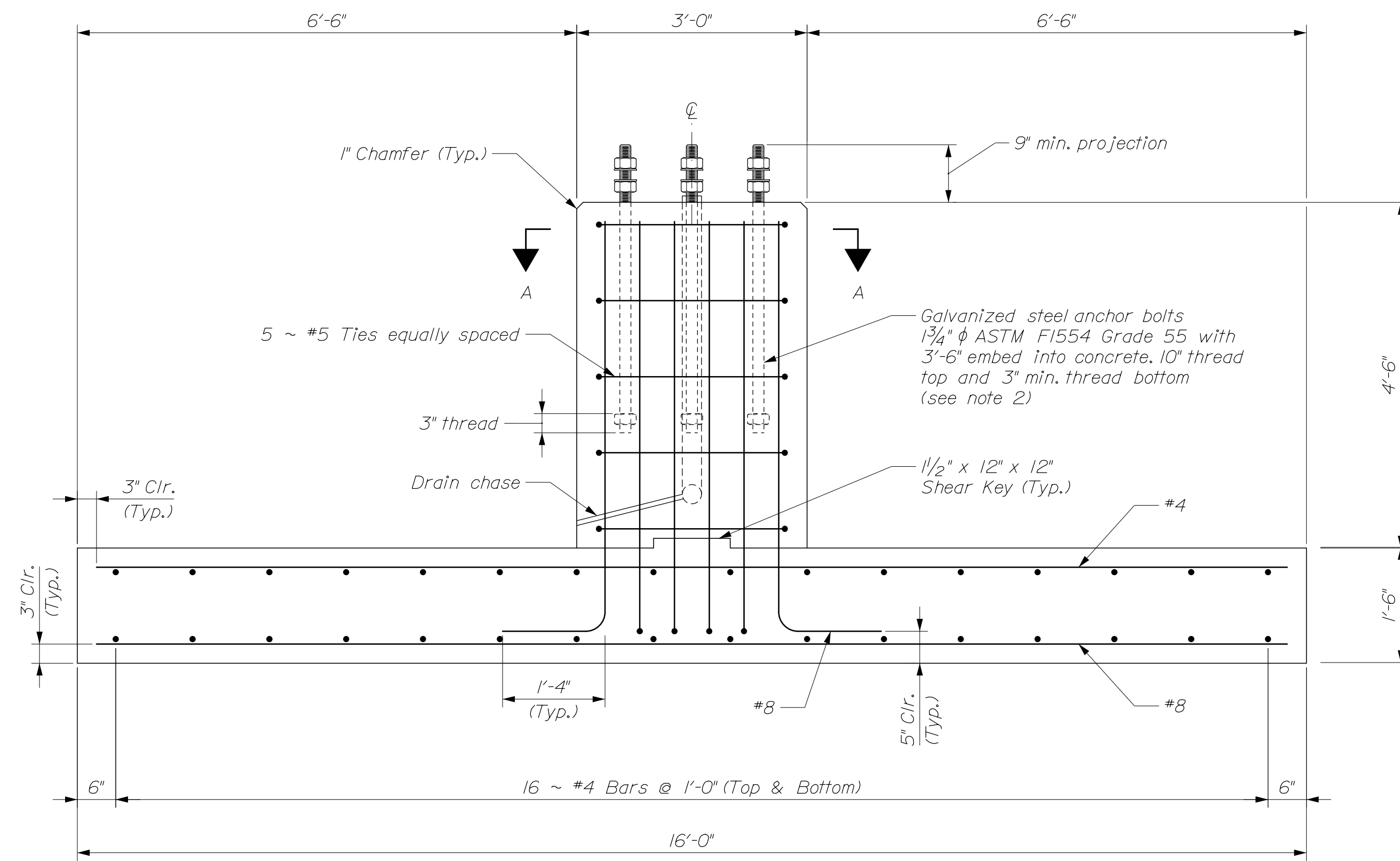
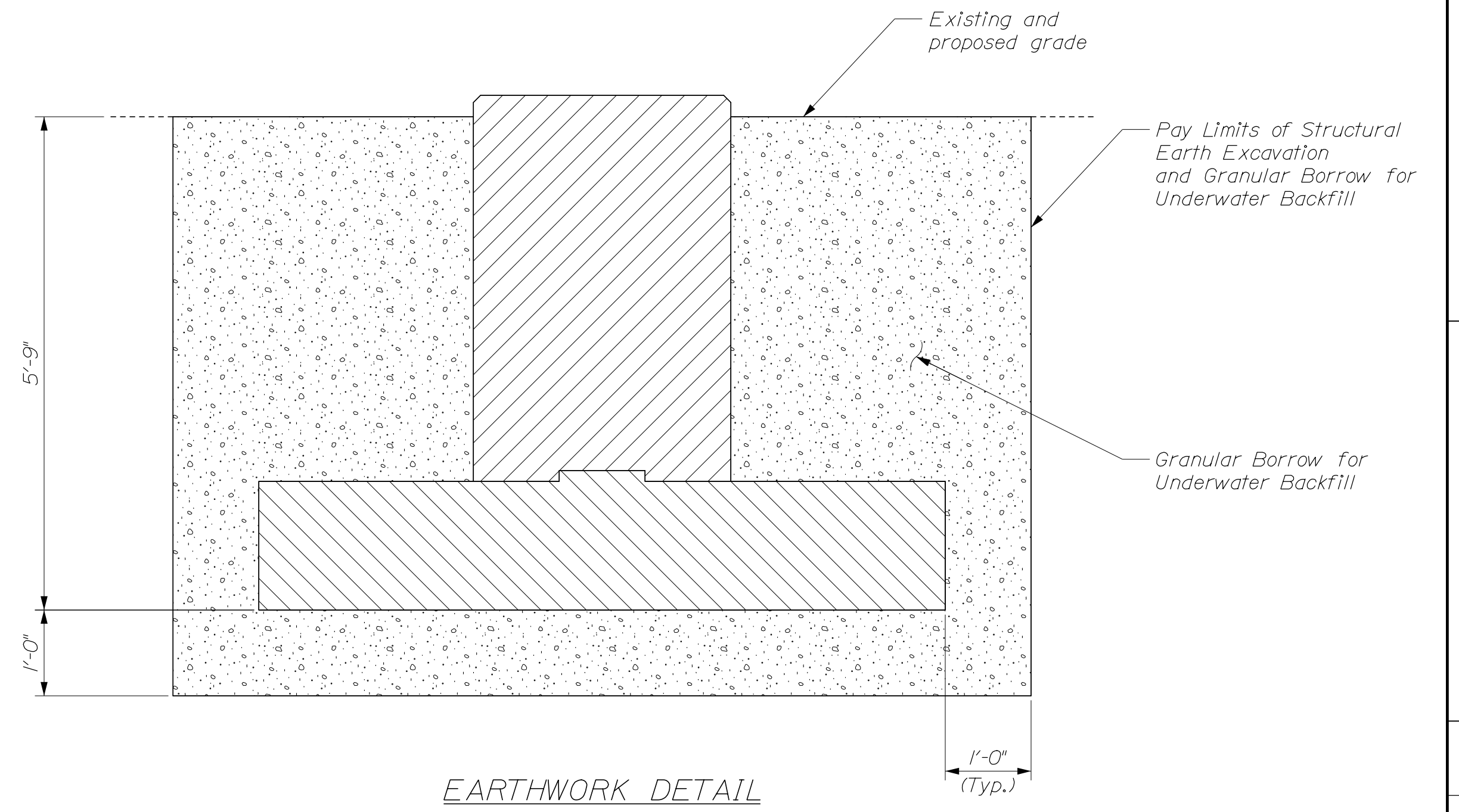
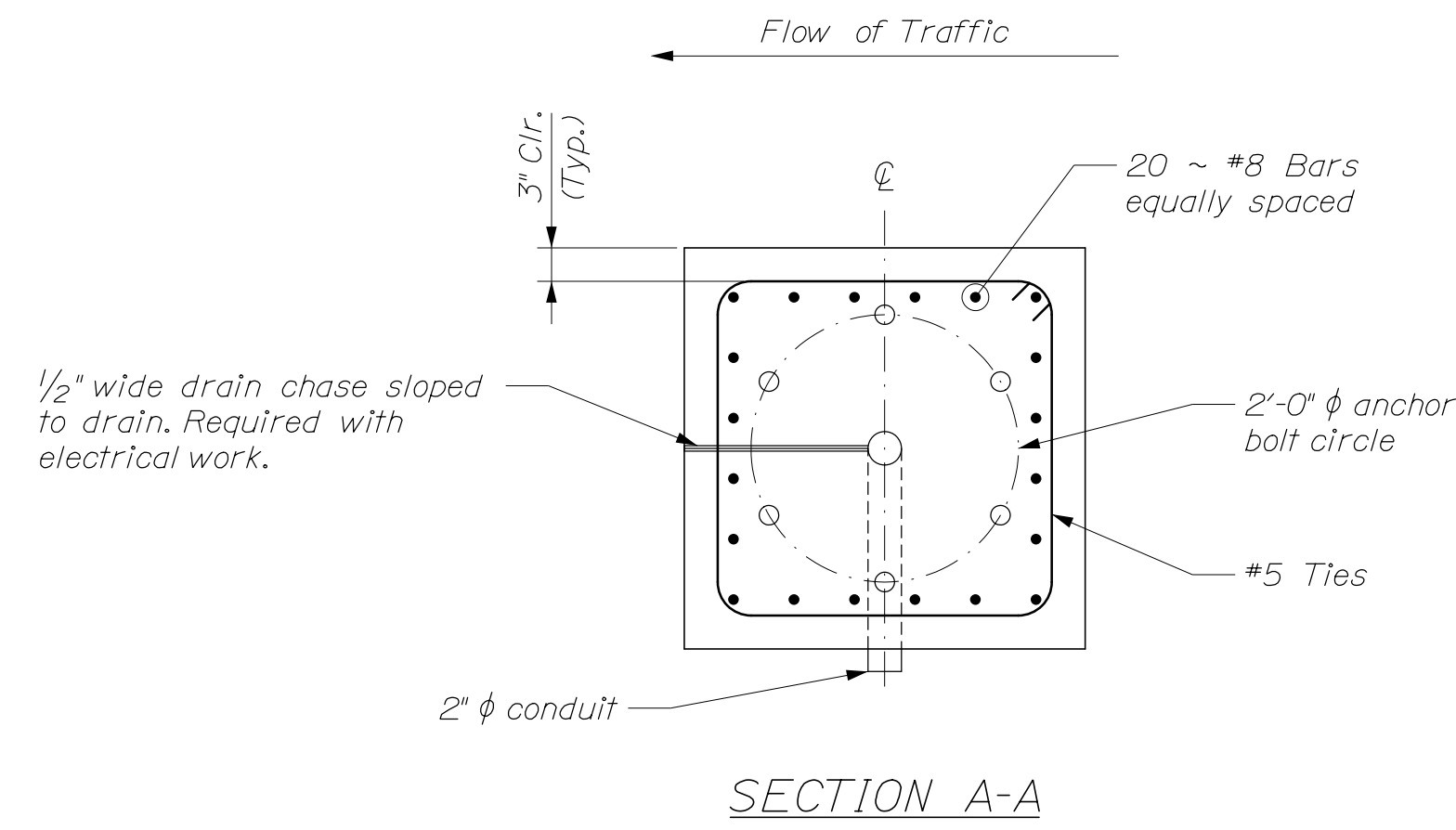

Date: 11/29/2022

Username:

Division:

Filename: 006_specsfounddetails.dgn

STATE OF MAINE
DEPARTMENT OF TRANSPORTATION
2423900
WIN
024239.00

| DATE | BY | PROJ. MANAGER | DESIGNED | CHECKED | DESIGNED | REVISIONS | FIELD CHANGES |
|-------|-----|---------------|----------|---------|----------|-----------|---------------|
| 11/22 | JSM | JSM | DC | DC | DC | 1 | |
| 11/22 | JKO | | | | | 2 | |
| | | | | | | 3 | |
| | | | | | | 4 | |

| DATE | BY | PROJ. MANAGER | DESIGNED | CHECKED | DESIGNED | REVISIONS | FIELD CHANGES |
|------|----|---------------|----------|---------|----------|-----------|---------------|
| | | | | | | 1 | |
| | | | | | | 2 | |
| | | | | | | 3 | |
| | | | | | | 4 | |

STATEWIDE UPGRADES
OF
CHANGEABLE MESSAGE SIGNS
SIGN SPECIAL DETAILS III

SHEET NUMBER

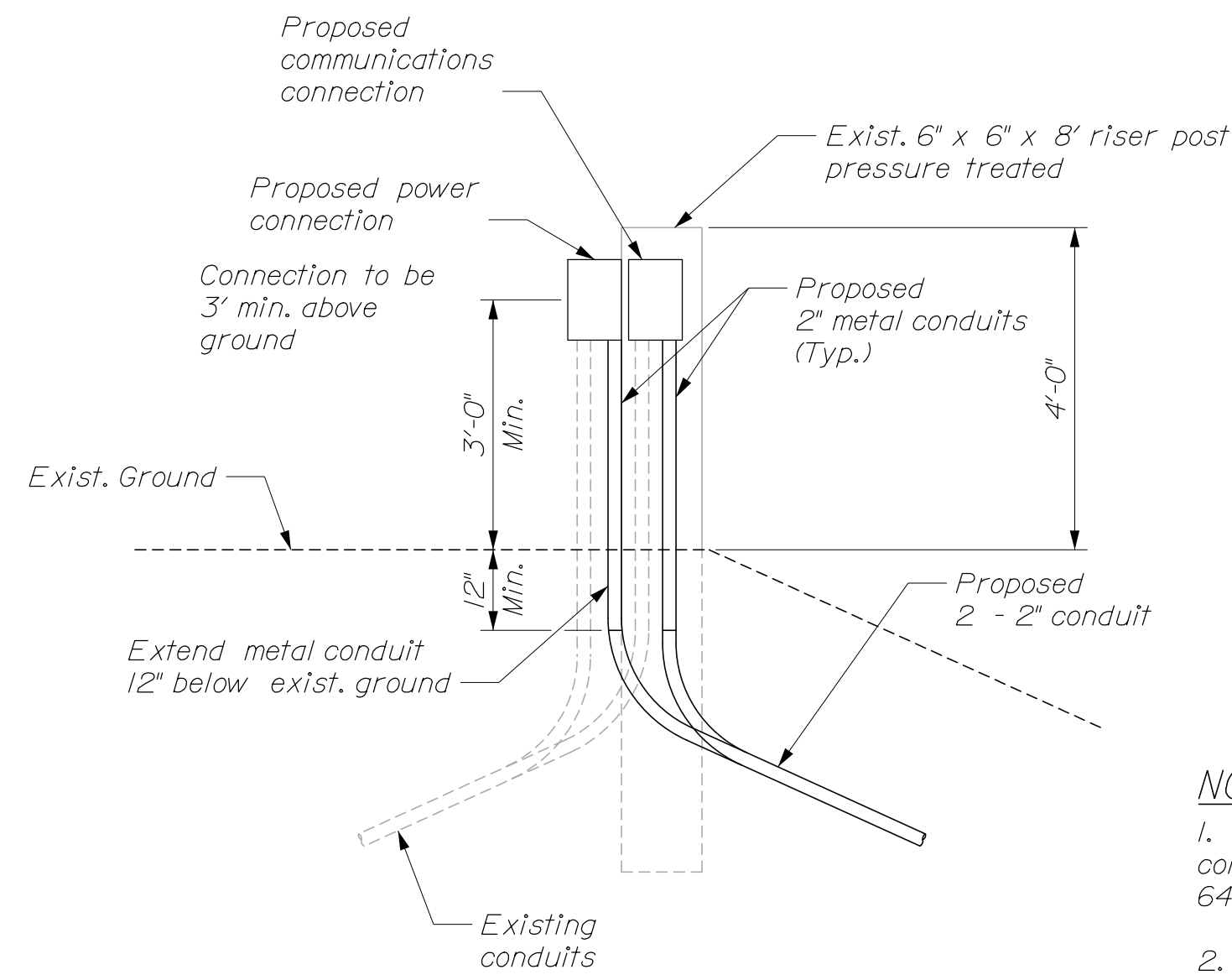

NOTES:

1. Payment for metal conduit and connections shall be under Item 645.155.
2. See Special Provision 645.155, Changeable Message Sign

CMS CONNECTIONS ON EXISTING RISER POST

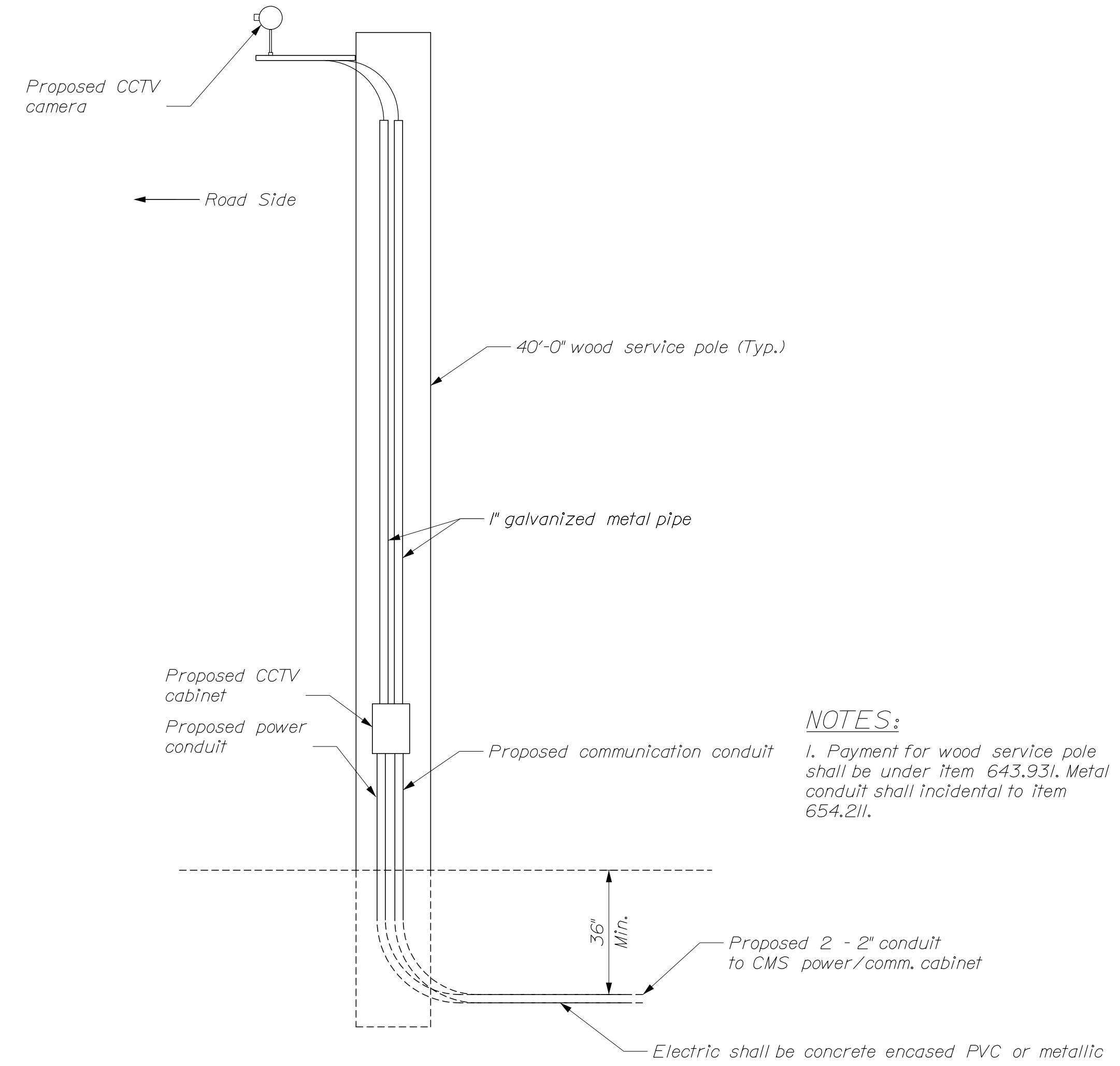

NOTES:

1. Payment for wood service pole shall be under item 643.931. Metal conduit shall incidental to item 654.211.

CAMERA POLE AND CONDUIT DETAIL

STATE OF MAINE
DEPARTMENT OF TRANSPORTATION
2423900
WIN
024239.00

| DATE | BY | PROJ. MANAGER | SIGNATURE |
|-------|-----|---------------|-------------|
| 11/22 | WJL | WJL | |
| 11/22 | ARG | ARG | |
| | | | P.E. NUMBER |
| | | | DATE |

| DATE | BY | PROJ. MANAGER | SIGNATURE |
|-------|-----|---------------|-------------|
| 11/22 | WJL | WJL | |
| 11/22 | ARG | ARG | |
| | | | P.E. NUMBER |
| | | | DATE |

STATEWIDE UPGRADES
OF
CHANGEABLE MESSAGE SIGNS
SIGN SPECIAL DETAILS IV

SHEET NUMBER
7
OF 14



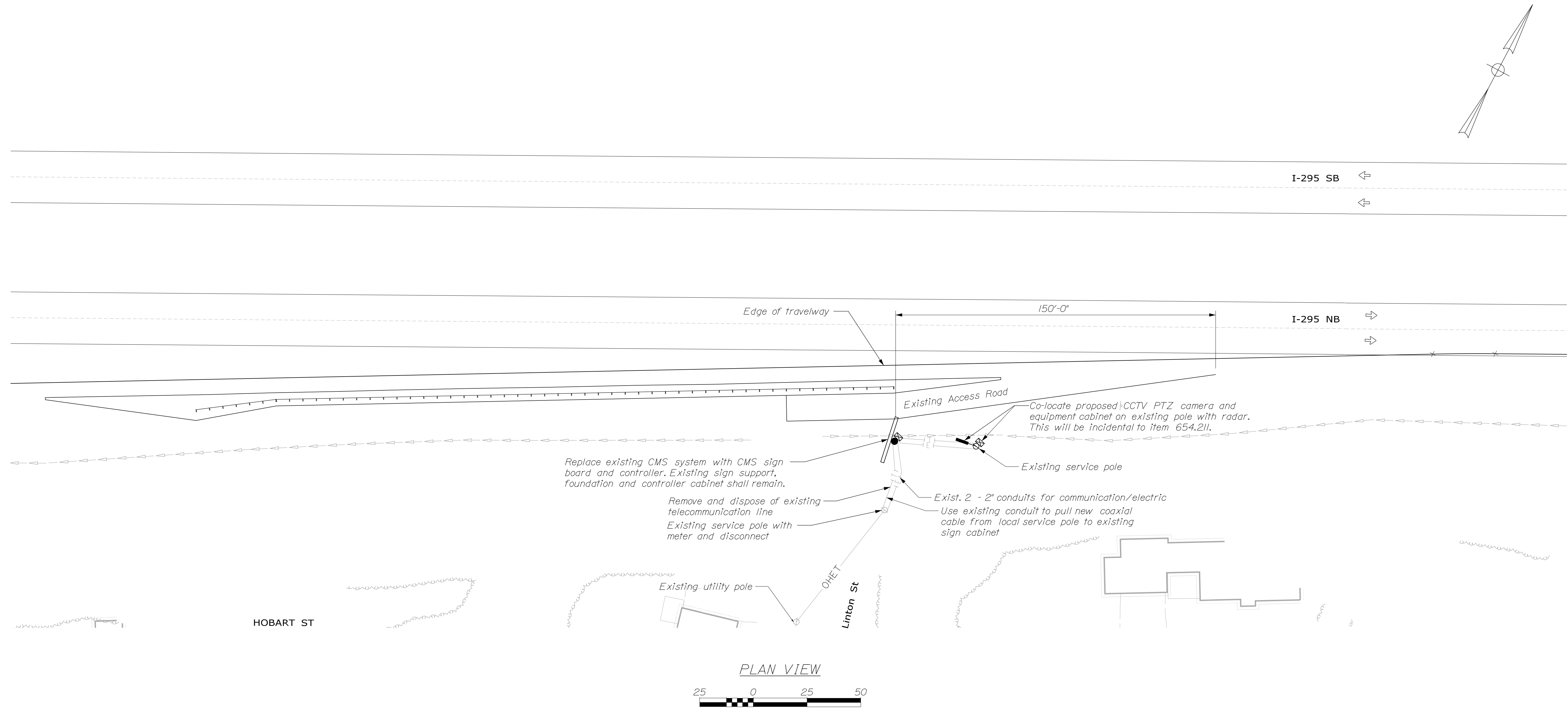

PLAN VIEW



NOTES:

1. Verify that radar is in working and operable order upon completion of the installation of CCTV PTZ camera.



STATE OF MAINE
DEPARTMENT OF TRANSPORTATION
2423900
WIN
024239.00

| PROJ. MANAGER | BY | DATE | SIGNATURE | | P.E. NUMBER | | DATE | |
|------------------|-----|------|-----------|-----|-------------|--|------|--|
| | | | WJL | ARG | | | | |
| DESIGN DETAILED | WJL | | | | | | | |
| CHECKED/REVIEWED | JSM | | | | | | | |
| DESIGN DETAILED | | | | | | | | |
| REVISIONS | 1 | | | | | | | |
| REVISIONS | 2 | | | | | | | |
| REVISIONS | 3 | | | | | | | |
| REVISIONS | 4 | | | | | | | |
| FIELD CHANGES | | | | | | | | |

STATEWIDE UPGRADES
OF
CHANGEABLE MESSAGE SIGNS
SITE 1: MM 2.1, I-295 NB
SOUTH PORTLAND

SHEET NUMBER

8

OF 14

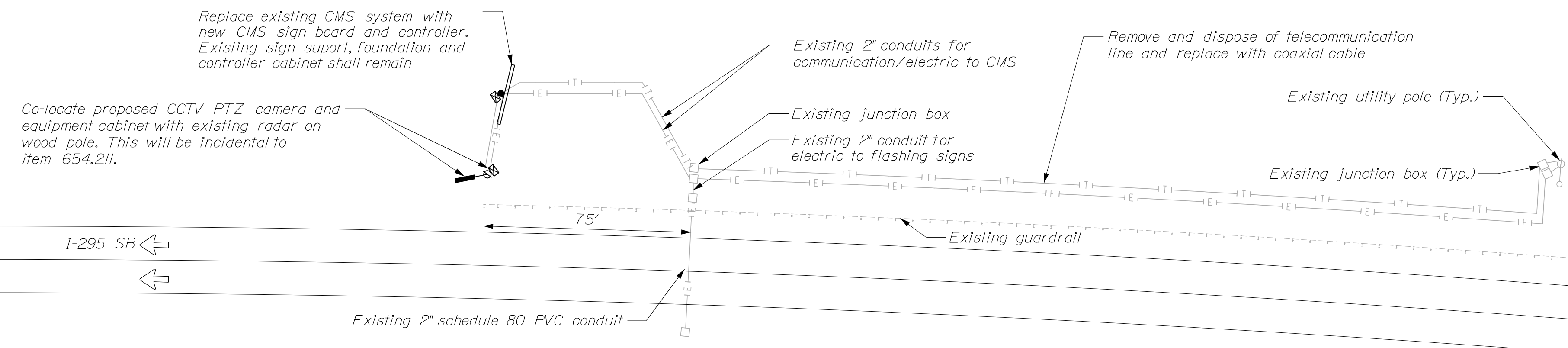
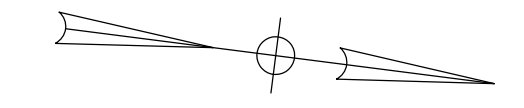

NOTES:
 1. Verify that radar is in working and operable order upon completion of the installation of CCTV PTZ camera.



LEGEND
 — Existing features
 — Proposed work

STATE OF MAINE
 DEPARTMENT OF TRANSPORTATION
 2423900
 WIN
 024239.00

| DATE | SIGNATURE | P.E. NUMBER | DATE |
|-------|-----------|-------------|------|
| 11/22 | | | |
| 11/22 | | | |

| PROJ. MANAGER | BY | DATE |
|------------------|-----|-------|
| DESIGN DETAILED | WJL | 11/22 |
| CHECKED-REVIEWED | WJL | 11/22 |
| DESIGN DETAILED | ARG | |
| DESIGN DETAILED | | |
| REVISIONS 1 | | |
| REVISIONS 2 | | |
| REVISIONS 3 | | |
| REVISIONS 4 | | |
| FIELD CHANGES | | |

STATEWIDE UPGRADES
 OF
 CHANGEABLE MESSAGE SIGNS
 SITE 2: MM 8.0, I-295 SB
 PORTLAND

SHEET NUMBER
 9
 OF 14



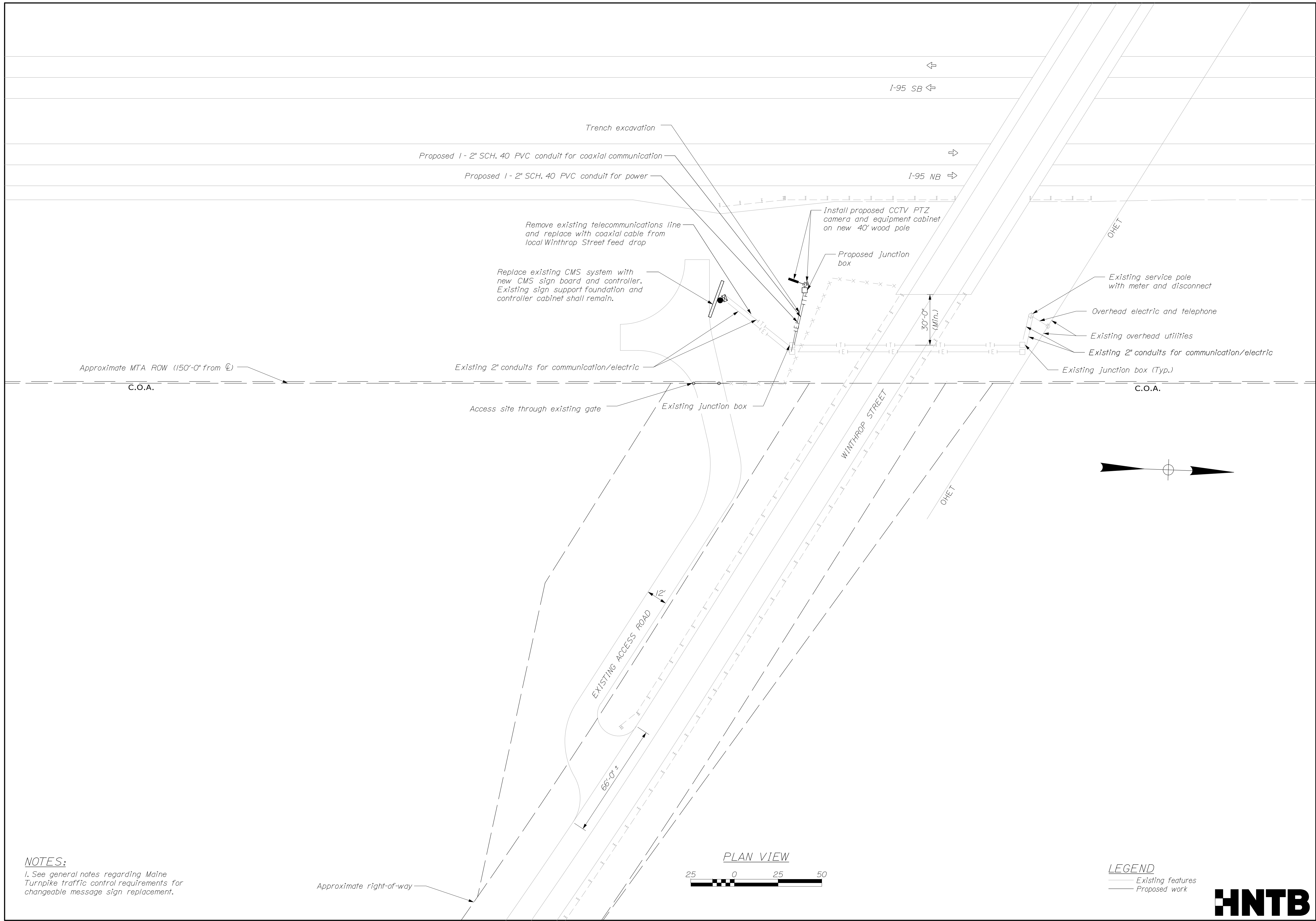

NOTES:
 1. See general notes regarding Maine Turnpike traffic control requirements for changeable message sign replacement.

Approximate right-of-way

PLAN VIEW



LEGEND
 — Existing features
 — Proposed work



| | | | | | |
|---|-------|---------------------------|-------|------------------|-------------|
| STATE OF MAINE DEPARTMENT OF TRANSPORTATION | | 2423900 | | WIN 024239.00 | |
| STATEWIDE CHANGES OF CHANGEABLE MESSAGE SIGNS | | SITE 3: MM 108.3, I-95 NB | | HALLOWELL | |
| SHEET NUMBER | | 10 | | OF 14 | |
| PROJ. MANAGER | DATE | BY | DATE | SIGNATURE | P.E. NUMBER |
| DESIGNED: DETAILED: WJL | 11/22 | WJL | 11/22 | | |
| CHECKED: REVIEWED: JSM | | ARG | | | |
| DESIGNS: DETAILED: JSM | | | | | |
| REVISIONS: 1 | | | | | |
| REVISIONS: 2 | | | | | |
| REVISIONS: 3 | | | | | |
| REVISIONS: 4 | | | | | |
| FIELD CHANGES | | | | | |

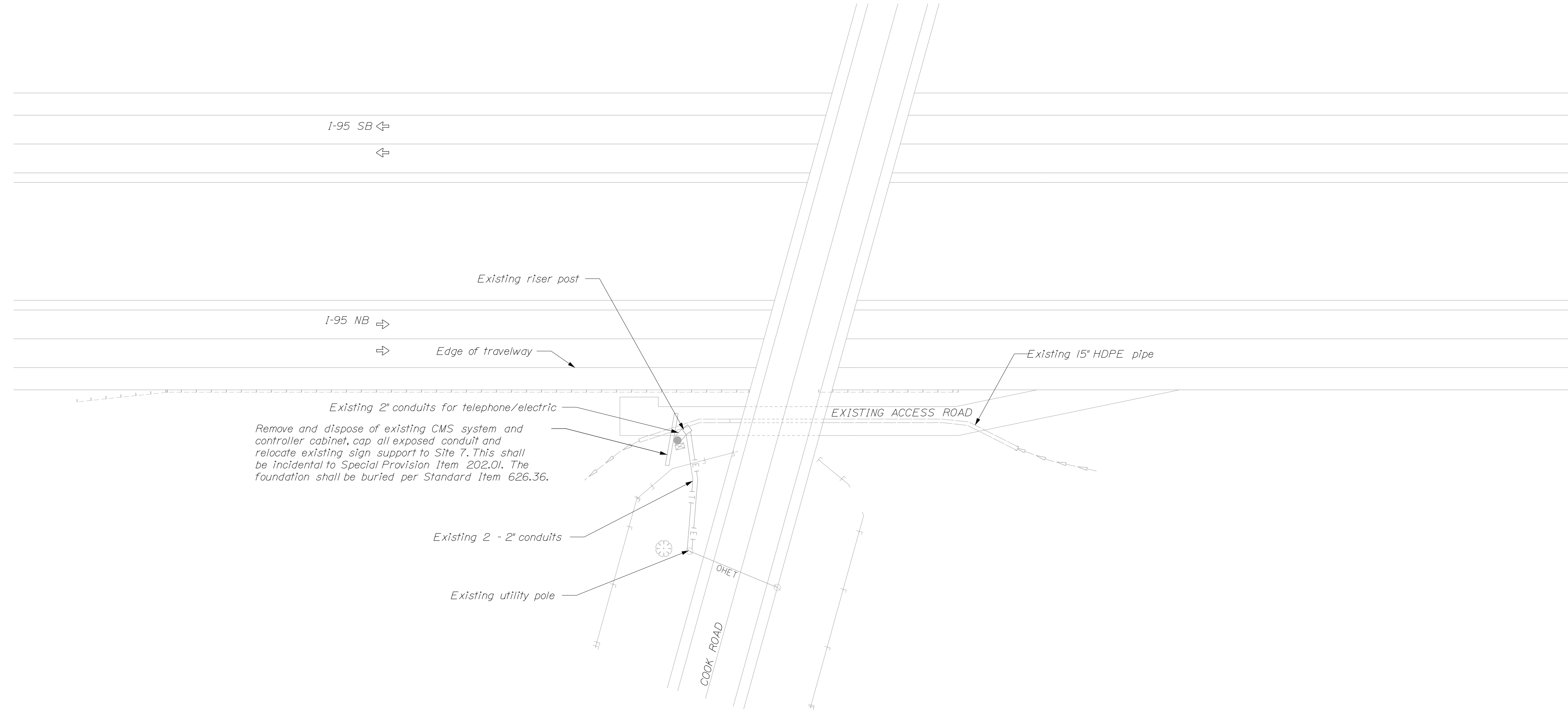

PLAN VIEW

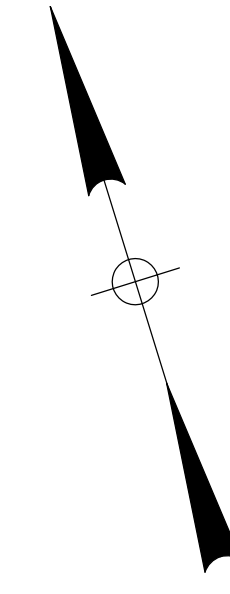

NOTES:

1. Remove existing foundation per Standard Detail 626(04).

LEGEND

- Existing features
- Proposed work



STATE OF MAINE
DEPARTMENT OF TRANSPORTATION

2423900

WIN
024239.00

SIGNATURE

P.E. NUMBER

DATE

DATE

DATE

DATE

DATE

DATE

DATE

DATE

DATE

DATE

DATE

DATE

DATE

DATE

DATE

DATE

DATE

DATE

DATE

DATE

DATE

DATE

DATE

DATE

DATE

DATE

DATE

DATE

DATE

DATE

DATE

STATEWIDE CHANGES
OF
CHANGEABLE MESSAGE SIGNS
SITE 4: MM 169.5, I-95 NB
CARMEL

SHEET NUMBER

11

OF 14

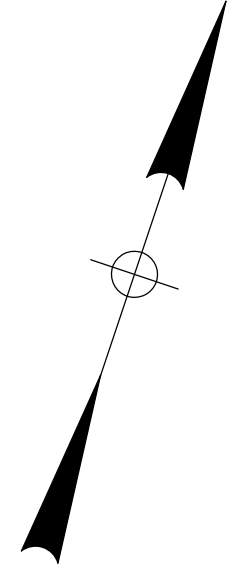

I-95 SB ←

I-95 NB →

ETW

EXISTING ACCESS ROAD

MM 179 SIGN

Edge of travelway

Exist. guardrail

Existing 30 MPH impact attenuator

Replace existing CMS system with new CMS sign board and controller. Existing sign support, foundation and controller cabinet shall remain.

Remove and dispose of existing telecommunications line and replace with coaxial cable

O/HET

Existing overhead electric/telephone to service pole

Existing 2" conduits

Proposed 1 - 2" SCH. 40 PVC conduit for power

Proposed junction box

Install proposed CCTV PTZ Camera and equipment cabinet on new utility pole

Proposed 1 - 2" SCH. 40 PVC conduit for coaxial communications

Existing service pole

Existing junction box

45'-0"

PLAN VIEW



LEGEND

- Existing features
- Proposed work



STATE OF MAINE
DEPARTMENT OF TRANSPORTATION
2423900
WIN
024239.00

| PROJ. MANAGER | BY | DATE | SIGNATURE | P.E. NUMBER | DATE |
|------------------|-----|-------|-----------|-------------|------|
| DESIGN-DETAILED | WJL | 11/22 | | | |
| CHECKED-REVIEWED | WJL | 11/22 | | | |
| DESIGN-DETAILED | ARG | | | | |
| DESIGN-DETAILED | | | | | |
| REVISIONS 1 | | | | | |
| REVISIONS 2 | | | | | |
| REVISIONS 3 | | | | | |
| REVISIONS 4 | | | | | |
| FIELD CHANGES | | | | | |

STATEWIDE UPGRADES
OF
CHANGEABLE MESSAGE SIGNS
SITE 5: MM 179.0, I-95 NB
HAMPDEN

SHEET NUMBER
12
OF 14

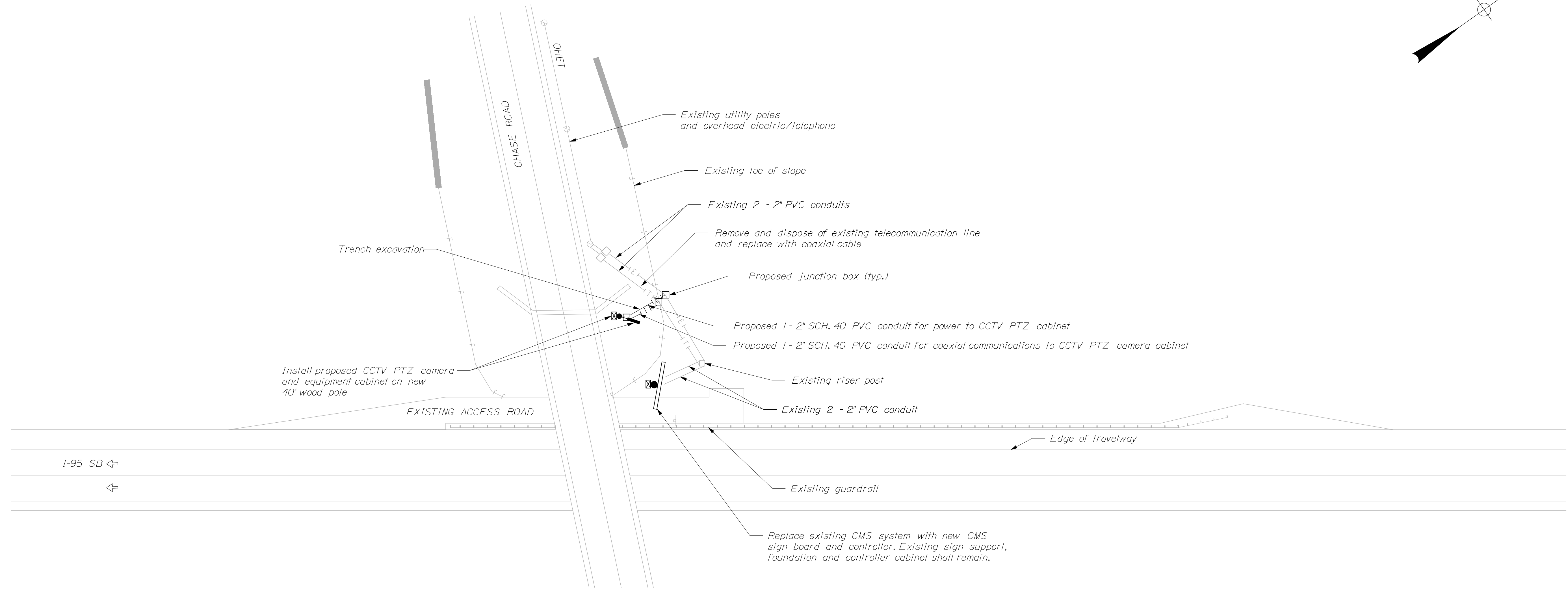

LEGEND
 — Existing features
 — Proposed work



| | | | | | |
|--|-------|---------|--------------|------------------|-------------|
| STATE OF MAINE DEPARTMENT OF TRANSPORTATION | | 2423900 | | WIN 024239.00 | |
| PROJ. MANAGER | DATE | BY | DATE | SIGNATURE | P.E. NUMBER |
| DESIGN/DETAILED | 11/22 | WJL | 11/22 | | |
| CHECKED/REVIEWED | | ARG | | | |
| DESIGN/REVIEWED | | | | | |
| DESIGN/DETAILED | | | | | |
| REVISIONS 1 | | | | | |
| REVISIONS 2 | | | | | |
| REVISIONS 3 | | | | | |
| REVISIONS 4 | | | | | |
| FIELD CHANGES | | | | | |
| STATEWIDE UPGRADES OF CHANGEABLE MESSAGE SIGNS | | | SHEET NUMBER | | |
| SITE 6: MM 189.0, I-95 SB BANGOR | | | 13 | | |
| | | | OF 14 | | |



NOTES:

- Contractor shall submit a shop drawing for proposed changeable message sign location. It shall include a cross section of the existing ground and roadway with proposed sign offset and height information for resident review and approval prior to the work commencing.
- Per Contractor method, the Contractor shall install an access road for the relocation of the sign support and future maintenance activities. The Contractor may put in a culvert and ditch crossing if needed to access the site. The access road shall be incidental to item 645.155.



LEGEND
 — Existing features
 — Proposed work



STATE OF MAINE
 DEPARTMENT OF TRANSPORTATION
2423900
 WIN
 024239.00

| PROJ. MANAGER | BY | DATE | SIGNATURE | P.E. NUMBER | DATE |
|------------------|-----|-------|-----------|-------------|------|
| DESIGN DETAILED | WJL | 11/22 | | | |
| CHECKED-REVIEWED | WJL | 11/22 | | | |
| DESIGN DETAILED | ARG | | | | |
| DESIGN DETAILED | | | | | |
| REVISIONS 1 | | | | | |
| REVISIONS 2 | | | | | |
| REVISIONS 3 | | | | | |
| REVISIONS 4 | | | | | |
| FIELD CHANGES | | | | | |

STATEWIDE UPGRADES
 OF
 CHANGEABLE MESSAGE SIGNS
 SITE 7: MM 118.1, I-95 SB
 SIDNEY

SHEET NUMBER
14
 OF 14