

STATE OF MAINE DEPARTMENT OF TRANSPORTATION



PALMYRA SOMERSET COUNTY ROUTE 2 FEDERAL PROJECT NO. 2420900 PROJECT LENGTH: 0.06 MILES

PLAN LEGEND

Town, County, State	_____	Catch Basins	▣ Existing	▣ Proposed
Property Lines	-----	Manholes	○ Existing	● Proposed
R/W Lines-Existing	-----	Proposed Underdrain	-----	
R/W Lines-Proposed	-----	Proposed Ditch	-----	
Culvert-Existing	-----	Existing Ditch	-----	
Culvert Proposed	-----	Utility Poles	⊕ Existing	⊕ Proposed
Curbing	Existing Proposed	Fire Hydrants	⊙ Existing	⊙ Proposed
Type 1	-----	Existing Water Line	-----	
Type 3	-----	Existing San. Sewer	-----	
Type 5	-----	Existing San. Sewer Manhole	⊙	
Outline of Bodies of Water	-----	Guardrail-Existing	-----	
Exposed Bedrock	-----	Guardrail-Proposed	-----	
Buildings	-----	Guardrail-Cable, Other	-----	
Trees	Conifer Deciduous	Centerline-Existing	-----	
Tree Line	-----	Centerline-Proposed	-----	
Clearing Limit Line	-----	Travelway-Existing	-----	
Railroad	-----	Travelway-Proposed	-----	
Boring	HB-XXX-###	Probe	P-#. #X	
Pavement Core	PC-#	#. # = Depth		
Test Pit	TP-XXX-###	X = W (Weathered Rock)		
		R (Refusal)		
		NR (No Refusal)		

INDEX OF SHEETS

Description	Sheet No.
Title Sheet	1
Typical Sections	2
Estimated Quantities	3
General Notes	4
Construction Notes	5
Geometric Plan	6
Plan / Profile	7
Cross - Sections	8-11
Right of Way Map	12

STATE OF MAINE DEPARTMENT OF TRANSPORTATION	APPROVED	DATE
COMMISSIONER: _____	_____	6-8-22
CHIEF ENGINEER: _____	_____	6-7-2022

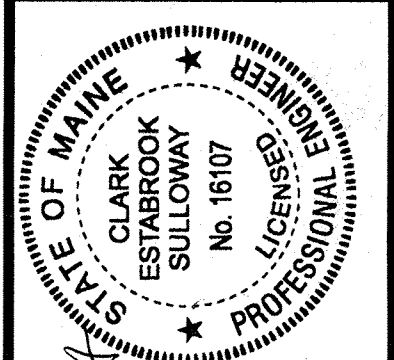

PROGRAM	PROJECT INFORMATION
HIGHWAY PROGRAM	PROGRAM
PROJECT MANAGER	PROJECT MANAGER
ROBOE MOULTON	ROBOE MOULTON
DESIGNER	DESIGNER
CLARK SULLOWAY	CLARK SULLOWAY
CONSULTANT	CONSULTANT
PROJECT RESIDENT	PROJECT RESIDENT
CONTRACTOR	CONTRACTOR
PROJECT COMPLETION DATE	PROJECT COMPLETION DATE

PROGRAM	PROJECT INFORMATION
HIGHWAY PROGRAM	PROGRAM
PROJECT MANAGER	PROJECT MANAGER
ROBOE MOULTON	ROBOE MOULTON
DESIGNER	DESIGNER
CLARK SULLOWAY	CLARK SULLOWAY
CONSULTANT	CONSULTANT
PROJECT RESIDENT	PROJECT RESIDENT
CONTRACTOR	CONTRACTOR
PROJECT COMPLETION DATE	PROJECT COMPLETION DATE

PALMYRA
ROUTE 2
TITLE SHEET

SHEET NUMBER
1
OF 12

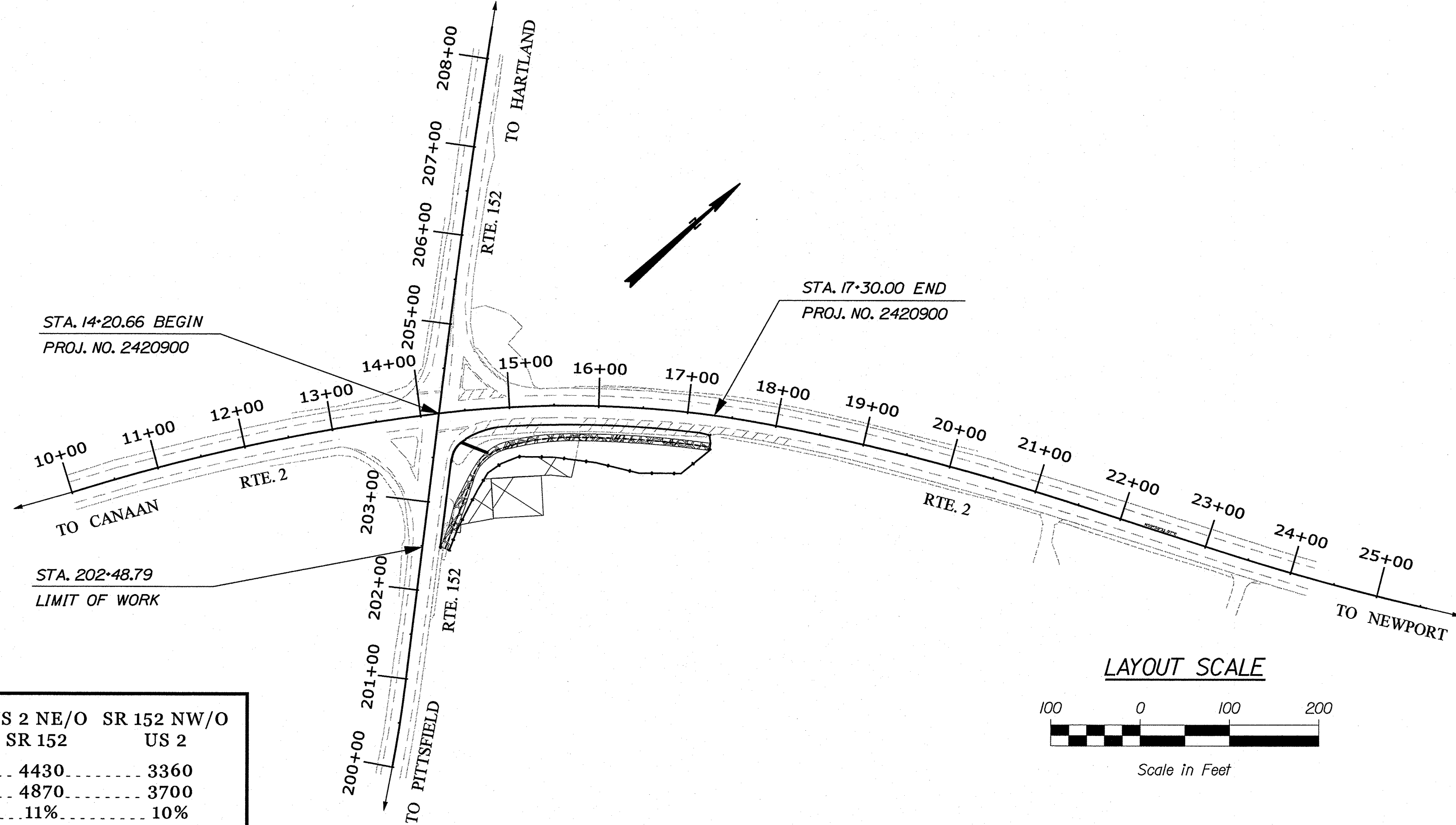
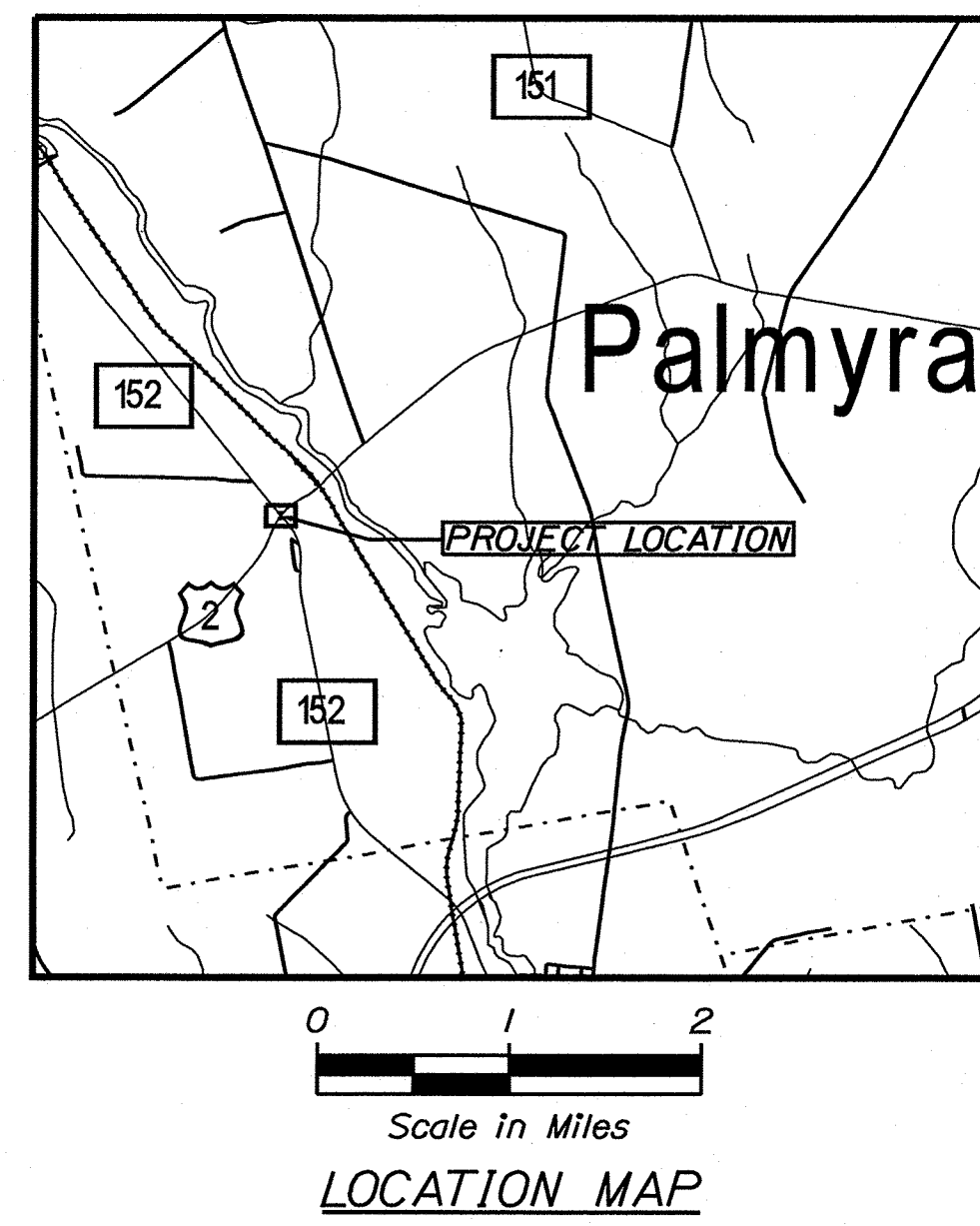

TRAFFIC DATA	US 2 NE/O SR 152	SR 152 NW/O US 2
Current (2022) AADT	4430	3360
Future (2042) AADT	4870	3700
DHV - % of AADT	11%	10%
Design Hour Volume	536	370
% Heavy Trucks (AADT)	13%	17%
% Heavy Trucks (DHV)	10%	14%
Directional Distribution (DHV)	58%	58%
18-kip Equivalent P2.0	471	471
18-kip Equivalent P2.5	449	449
Design Speed (mph)	45	35
Corridor Priority	1	4

PROJECT LOCATION:	INTERSECTION OF ROUTE 2 AND ROUTE 152
PROGRAM AREA:	HIGHWAY PROGRAM
SCOPE OF WORK:	HIGHWAY SAFETY AND SPOT IMPROVEMENTS

WIN 24209.00 FEDERAL PROJECT NO. 2420900

Date: 5/17/2022

Username: Clark.E.Sulloway

Division: HIGHWAY

Filename: ...\\000\HIGHWAY\MSTA1001_Title.dgn

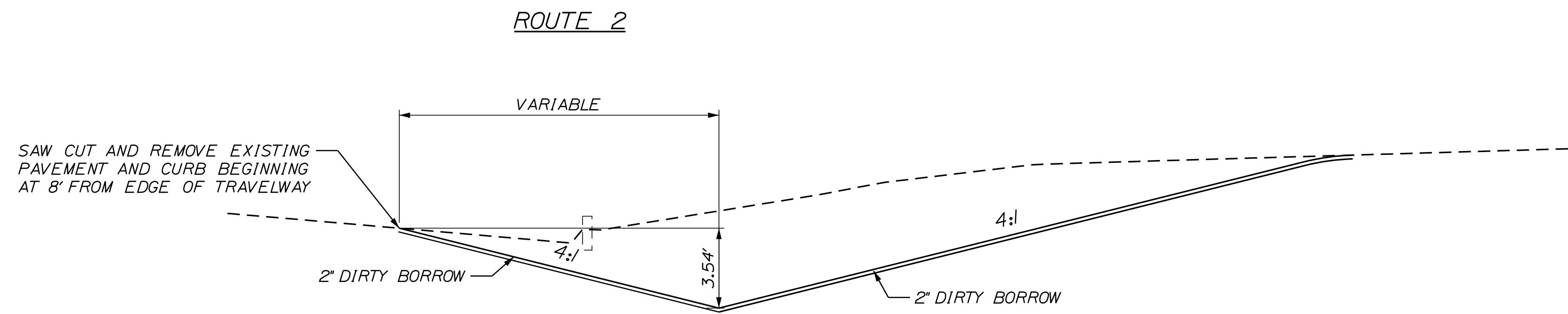

INSLOPE WITH DITCH
STATION TO STATION
14+47.46 TO 17+50.00

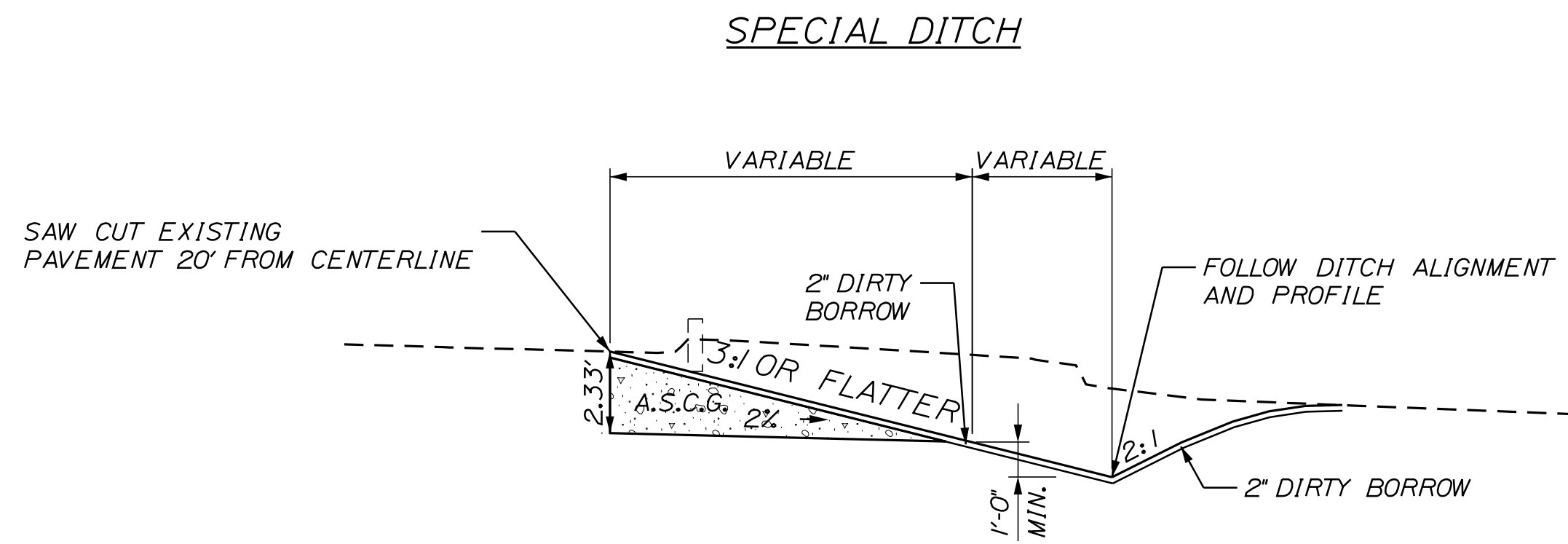

INSLOPE WITH DITCH
STATION TO STATION
300+50.00 TO 300+91.36

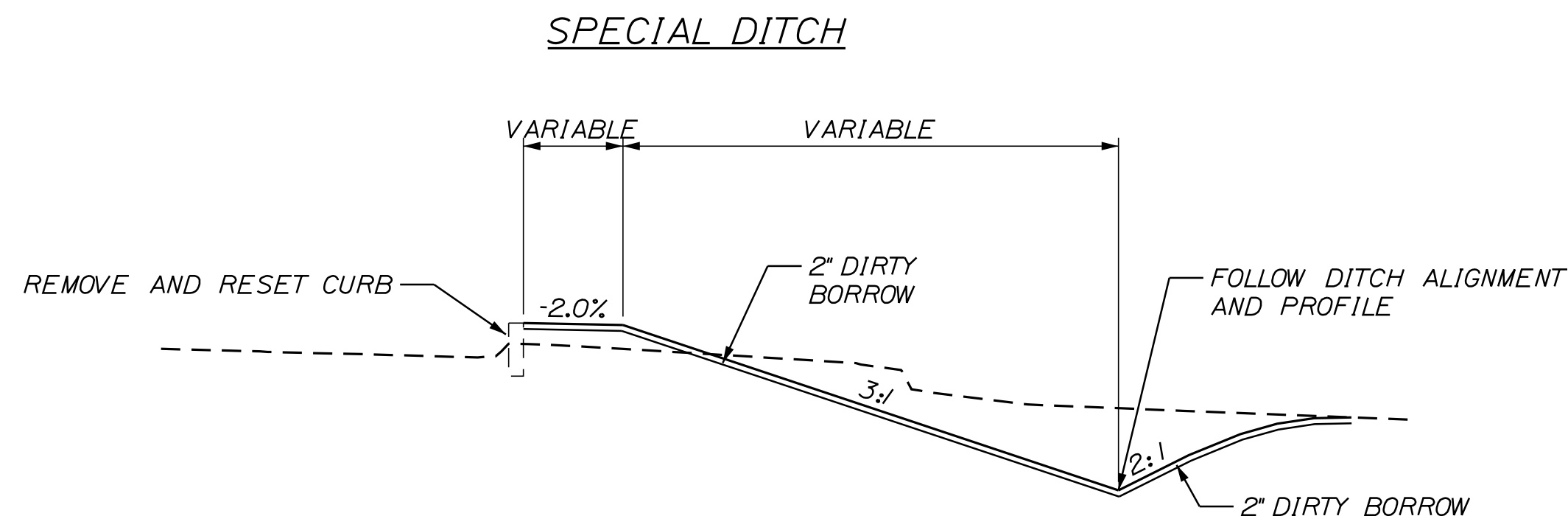

EXISTING CURB WITH DITCH
STATION TO STATION
300+91.36 TO 14+47.46

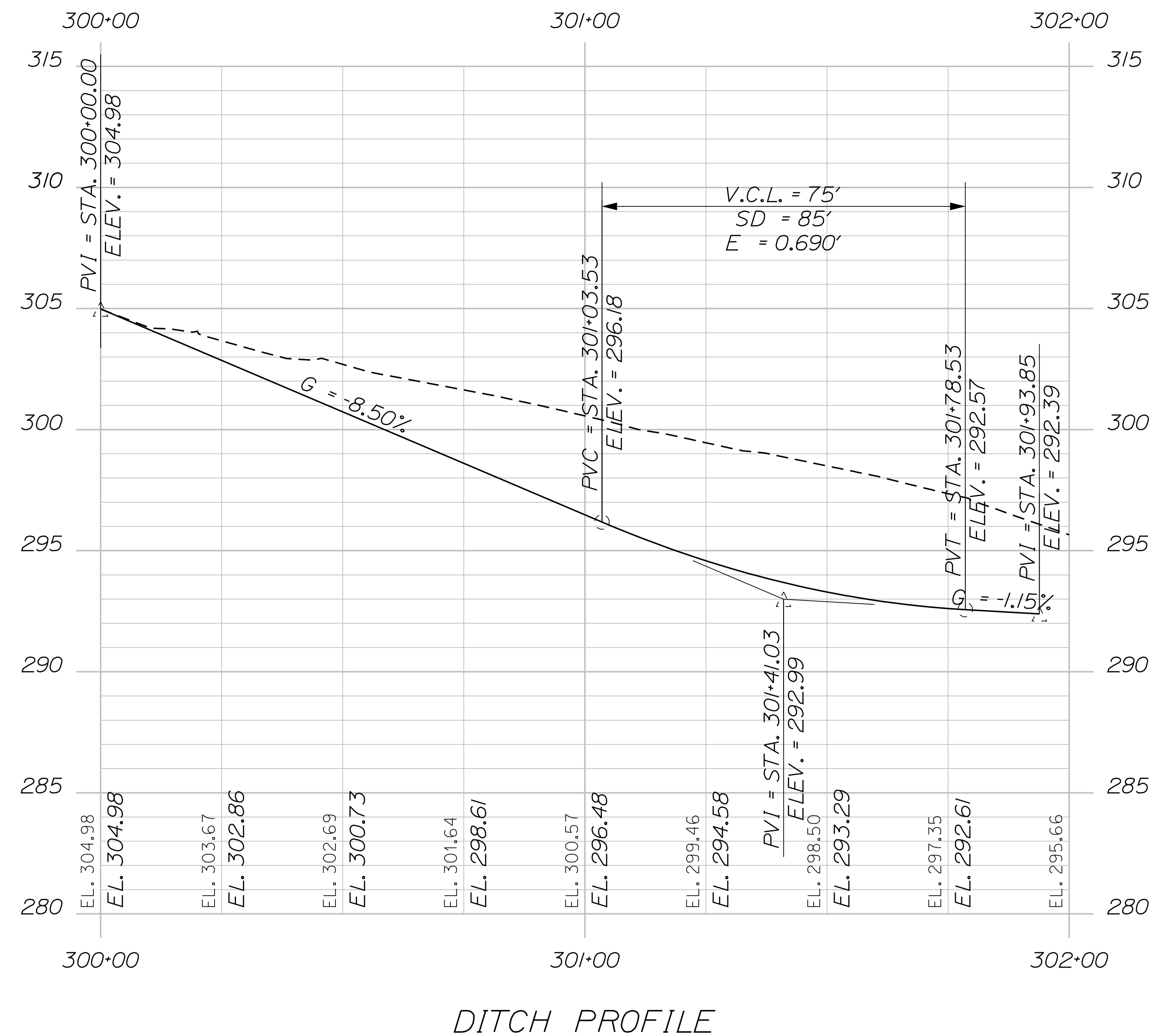

NOT TO SCALE

PROJ. MANAGER	R. Moulton	BY	DATE
DESIGN-DETAILED	C. SULLOWAY		
CHECKED-REVIEWED			
DESIGN-DETAILED		SIGNATURE	
REVISIONS 1		P.E. NUMBER	
REVISIONS 2		DATE	
REVISIONS 3			
REVISIONS 4			
FIELD CHANGES			

PALMYRA
ROUTE 2
TYPICAL SECTIONS

SHEET NUMBER

2

ITEM NO.	DESCRIPTION	QUANTITY	UNIT
202.08	REMOVING BUILDING NO. 1	1	LS
202.15	REMOVE MANHOLE OR CATCH BASIN	1	EA
203.20	COMMON EXCAVATION	1,025	CY
304.10	AGGREGATE SUBBASE COURSE - GRAVEL	35	CY
603.179	18 INCH CULVERT PIPE OPT. III	30	LF
604.182	CLEAN EXISTING CATCH BASIN AND MANHOLE	1	EA
609.234	TERMINAL CURB TYPE 1 - 4 FOOT	2	EA
609.38	RESET CURB TYPE 1	24	LF
610.18	STONE DITCH PROTECTION	175	CY
615.10	DIRTY BORROW	110	CY
618.14	SEEDING METHOD NUMBER 2	16	UN
619.12	MULCH	16	UN
629.05	HAND LABOR, STRAIGHT TIME	30	HR
631.18	CHAIN SAW RENTAL (INCLUDING OPERATOR)	30	HR
645.106	DEMOUNT REGULATORY, WARNING, CONFIRMATION AND ROUTE MARKING ASSEMBLY SIGNS	1	EA
645.116	REINSTALL REGULATORY, WARNING, CONFIRMATION AND ROUTE MARKING ASSEMBLY SIGN	1	EA
645.292	REGULATORY, WARNING, CONFIRMATION AND ROUTE MARKING ASSEMBLY SIGN	7	SF
652.33	DRUM	10	EA
652.34	CONE	50	EA
652.35	CONSTRUCTION SIGNS	335	SF
652.36	MAINTENANCE OF TRAFFIC CONTROL DEVICES	25	CD
652.38	FLAGGER	660	HR
656.75	TEMPORARY SOIL EROSION AND POLLUTION CONTROL	1	LS
659.10	MOBILIZATION	1	LS

STATE OF MAINE
DEPARTMENT OF TRANSPORTATION
2420900
WIN
024209.00
HIGHWAY PLANS

PROJ. MANAGER	R. MOULTON	BY	DATE
DESIGN-DETAILED	C. SULLOWAY		
CHECKED-REVIEWED			
DESIGN-DETAILED			
REVISIONS 1			
REVISIONS 2			
REVISIONS 3			
REVISIONS 4			
FIELD CHANGES			

PALMYRA
ROUTE 2
ESTIMATED QUANTITIES

SHEET NUMBER
3
OF 12

1. ALL INSLOPE AND DITCHES IN CUT AREAS SHALL BE GRADED AS SHOWN ON THE TYPICALS OR FLATTER, OR AS DIRECTED BY THE RESIDENT.
2. THE CONTRACTOR SHALL PLAN AND CONDUCT WORK SO THAT UPON COMPLETION OF THE PROJECT THERE IS NO DROP-OFF FROM THE EDGE OF THE SHOULDER PAVEMENT.
3. ALL WASTE MATERIAL NOT USED ON THE PROJECT SHALL BE DISPOSED OF OFF THE PROJECT IN ACCEPTABLE WASTE AREAS REVIEWED BY THE RESIDENT. GRADING, SEEDING AND MULCHING OF WASTE AREAS SHALL BE CONSIDERED INCIDENTAL.
4. REQUIRED DITCH PROTECTION SHOWN ON THE PLANS OR IN THE CONSTRUCTION NOTES IS FOR ESTIMATING PURPOSES ONLY. THE ACTUAL TYPE AND LOCATION OF DITCH PROTECTION MAY BE ALTERED BY THE RESIDENT.
5. EXISTING CULVERTS AND CATCH BASINS WILL BE CLEANED AS DIRECTED BY THE RESIDENT UNDER THE APPROPRIATE PAY ITEMS.
6. NO EXISTING DRAINAGE SHALL BE ABANDONED, REMOVED OR PLUGGED WITHOUT PRIOR APPROVAL OF THE RESIDENT.
7. INLETS AND OUTLETS OF ALL CULVERTS SHALL BE RIPRAPPED UNLESS OTHERWISE NOTED ON THE PLANS OR DIRECTED BY THE RESIDENT.
8. ANY NECESSARY CUTTING OF EXISTING PIPES TO FIT IN AREAS OF PROPOSED CATCH BASINS WILL NOT BE PAID FOR SEPARATELY AND WILL BE CONSIDERED INCIDENTAL TO STANDARD SPECIFICATIONS SECTION 604, MANHOLES, INLETS AND CATCH BASINS.
9. ANY NECESSARY CUTTING OF EXISTING CATCH BASINS TO ALLOW FOR PROPOSED PIPE CONNECTIONS WILL NOT BE PAID FOR SEPARATELY AND WILL BE CONSIDERED INCIDENTAL TO STANDARD SPECIFICATIONS SECTION 603, PIPE CULVERTS AND STORM DRAINS OR STANDARD SPECIFICATIONS SECTION 605, UNDERDRAINS.
10. AS DIRECTED BY THE RESIDENT, ALL EXISTING UNDERDRAIN OUTLETS SHALL BE LOCATED, CLEANED OUT AND DITCHED AS REQUIRED OR REPLACED AS NECESSARY. PAYMENT WILL BE MADE UNDER APPROPRIATE CONTRACT ITEMS.
11. IN AREAS WHERE CURB TYPE 1 WILL BE RESET, THE EXISTING CURB SUITABLE FOR USE AS TERMINAL ENDS SHALL BE CUT, IF NECESSARY, AND UTILIZED AS SUCH AND WILL BE PAID FOR UNDER STANDARD SPECIFICATIONS ITEM 609.38, RESET CURB TYPE 1. REQUIRED CUTTING WILL BE PAID UNDER FORCE ACCOUNT PROCEDURES.
12. DIRTY BORROW HAS BEEN ESTIMATED FOR ALL DISTURBED SLOPE AREAS OTHER THAN LAWN AREAS. ACTUAL PLACEMENT OF THE DIRTY BORROW SHALL BE AS NOTED ON THE PLANS OR DESIGNATED BY THE RESIDENT.
13. UNLESS OTHERWISE NOTED SEEDING METHOD NO. 1 SHALL BE UTILIZED ON ALL LAWNS AND DEVELOPED AREAS; SEEDING METHOD NO. 2 SHALL BE UTILIZED ON ALL OTHER AREAS.
14. DIRTY BORROW SHALL BE PLACED TO A NOMINAL DEPTH OF 2 INCHES UNLESS OTHERWISE NOTED OR DIRECTED.
15. THE CONTRACTOR WILL BE RESPONSIBLE FOR MAINTAINING ALL EXISTING MAILBOXES TO ENSURE THAT THE MAIL WILL BE DELIVERABLE. PAYMENT FOR THIS WORK WILL BE CONSIDERED INCIDENTAL TO THE CONTRACT.
16. THE CONTRACTOR WILL BE RESPONSIBLE FOR MAINTAINING ALL EXISTING OPERATIONAL BUSINESS DIRECTIONAL SIGNS (OBDS) TO ENSURE THAT THEY ARE VISIBLE TO THE TRAVELING PUBLIC. PAYMENT FOR THIS WORK WILL BE CONSIDERED INCIDENTAL TO THE CONTRACT.
17. ANY DAMAGE TO THE SLOPES CAUSED BY THE CONTRACTOR'S EQUIPMENT, PERSONNEL, OR OPERATION SHALL BE REPAIRED TO THE SATISFACTION OF THE RESIDENT. ALL WORK, EQUIPMENT, AND MATERIALS REQUIRED TO MAKE REPAIRS SHALL BE AT THE CONTRACTOR'S EXPENSE.
18. PLANS OF PREVIOUSLY CONSTRUCTED PROJECTS ARE AVAILABLE ON REQUEST. THESE PROJECTS ARE: PROJECT NO. STP-1275(500)X
19. AREAS ON THE PROJECT REQUIRING FILL WILL COME FROM SUITABLE SITES SUCH AS EXCAVATION, DITCH AND INSLOPE OR EQUIPMENT RENTAL AREAS.
20. NO SEPARATE PAYMENT FOR SUPERINTENDENT OR FOREMAN WILL BE MADE FOR THE SUPERVISION OF EQUIPMENT AND LAYOUT OF WORK BEING PAID FOR UNDER THE EQUIPMENT RENTAL ITEMS.

STATE OF MAINE
DEPARTMENT OF TRANSPORTATION
2420900
WIN 024209.00
HIGHWAY PLANS

PROJ. MANAGER	R. Moulton	BY	DATE
DESIGN DETAILED	C. Sullivan		
CHECKED-REVIEWED			
DESIGNS DETAILED			
REVISIONS 1			
REVISIONS 2			
REVISIONS 3			
REVISIONS 4			
FIELD CHANGES			

PALMYRA
ROUTE 2
GENERAL NOTES

SHEET NUMBER
4
OF 12

ITEM 202.08 REMOVE BUILDING NO. 1

LOCATION

STA. 15+00.00, RT.

ALL DEBRIS INCLUDING BUT NOT LIMITED TO TIRES, PILES OF METAL, ABANDONED TRUCK, SHALL BE REMOVED FROM SITE AND DISPOSED OF PROPERLY. PAYMENT SHALL BE INCIDENTAL TO ITEM 202.08 REMOVING BUILDING NO. 1

ITEM 202.15 REMOVE MANHOLE OR CATCH BASIN

LOCATION

STA. 202+81.56, 25.7' RT.

ITEM 603.179 18" CULVERT PIPE OPTION III

LOCATION

LENGTH (LF)

STA. 14+41.84, 33.8' RT. TO STA. 14+70.48, 48.5' RT. 30

CONNECT TO EXISTING BASIN

ITEM 609.234 TERMINAL CURB TYPE 1 - 4 FOOT

LOCATION

QUANTITY (EA)

STA. 203+51.56, 20.7' RT. 1

STA. 203+72.28, 29.9' RT. 1

ITEM 609.38 RESET CURB TYPE 1

BEGIN LOCATION

END LOCATION

LENGTH (FT)

STA. 203+51.56, 20.7' RT. STA. 203+72.28, 29.9' RT. 24

ITEM 610.18 STONE DITCH PROTECTION

Location

STA. 202+48.79, 48.8' RT. TO STA. 14+80.88, 49.8' RT.

ITEM 613.319 EROSION CONTROL BLANKET

Location

STA. 14+80.06 TO STA. 17+30.72, RT.

ITEM 629.05 HAND LABOR, STRAIGHT TIME

ITEM 631.18 CHAIN SAW RENTAL (INCLUDING OPERATOR)

TRIM TREES TO RIGHT-OF-WAY AS DIRECTED BY RESIDENT USING CHAIN SAW AND HAND LABOR RENTAL ITEMS.

ITEM 645.106 DEMOUNT REGULATORY, WARNING, CONFIRMATION AND ROUTE MARKER ASSEMBLY SIGN

TYPE

LOCATION

R1-1, STOP STA. 203+54.34, RT.

ITEM 645.116 REINSTALL REGULATORY, WARNING, CONFIRMATION AND ROUTE MARKER ASSEMBLY SIGN

TYPE

LOCATION

R1-1, STOP STA. 203+54.34, RT.

NOTE: ADD RED REFLECTIVE STRIP TO SIGN POST IN ACCORDANCE TO MUTCD SECTION 2A TO BOTH EXISTING STOP SIGNS ON RT. AND LT. INCIDENTAL TO ITEM 645.116

ITEM 645.106 REGULATORY, WARNING, CONFIRMATION AND ROUTE MARKER ASSEMBLY SIGNS TYPE II

TYPE

LOCATION

W3-1, STOP AHEAD ROUTE 152, LT. (ACROSS FROM EXISTING STOP AHEAD SIGN ON RT.)

NOTE: ADD YELLOW REFLECTIVE STRIP TO SIGN POST IN ACCORDANCE TO MUTCD SECTION 2A TO BOTH STOP AHEAD SIGNS ON RT. AND LT. INCIDENTAL TO ITEM 645.106

Date: 5/17/2022

Username: Clark.E.Sullivan

Division: HIGHWAY

Filename: ... \MSTA\005_ConstructionNotes.dgn

STATE OF MAINE
DEPARTMENT OF TRANSPORTATION
2420900
WIN
024209.00
HIGHWAY PLANS

PROJ. MANAGER	R. MOUTON	BY	DATE
DESIGN-DETAILED	C. SULLOWAY		
CHECKED-REVIEWED			
DESIGN-DETAILED			
REVISIONS 1			
REVISIONS 2			
REVISIONS 3			
REVISIONS 4			
FIELD CHANGES			

PALMYRA
ROUTE 2
CONSTRUCTION NOTES

SHEET NUMBER
5
OF 12

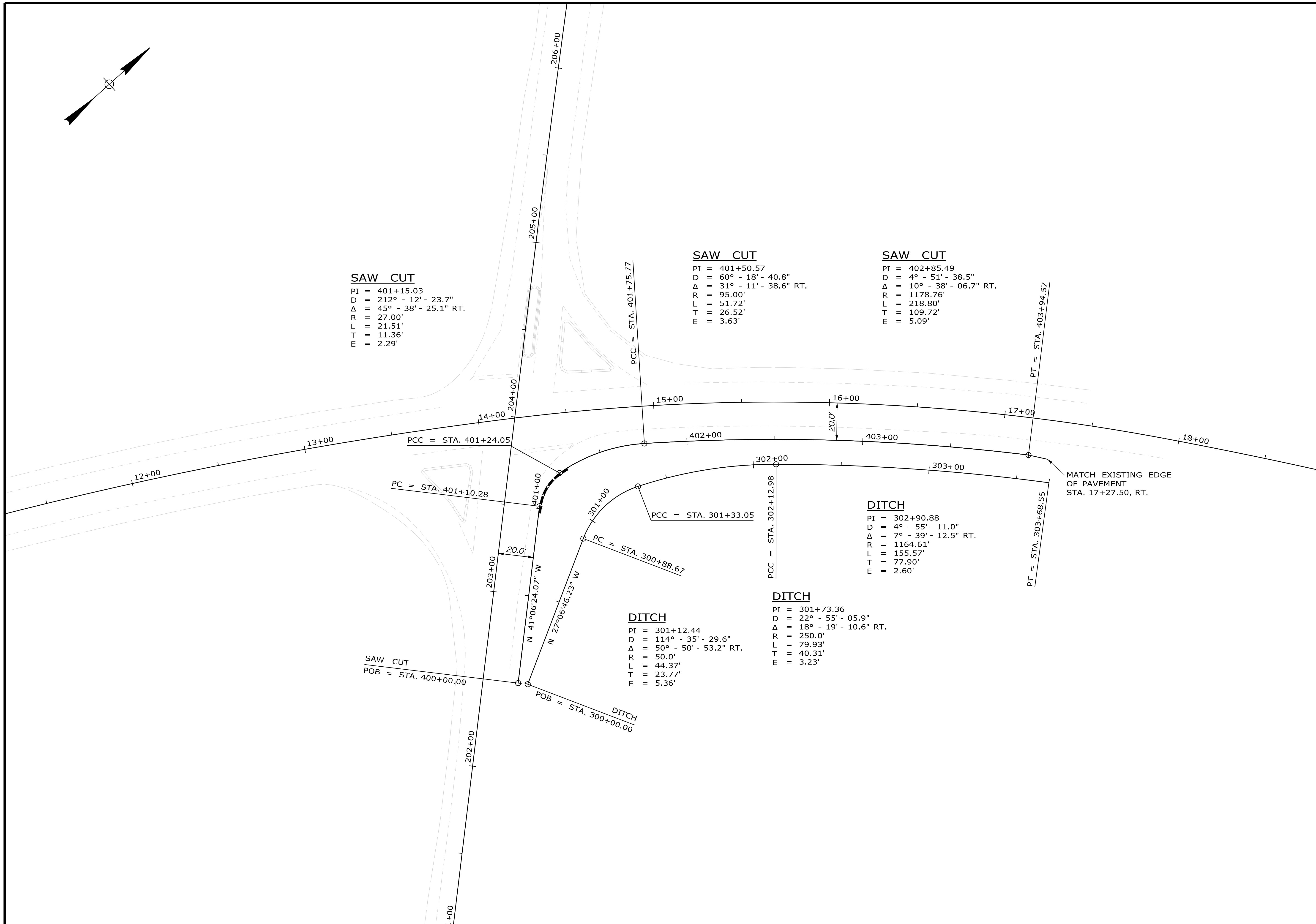
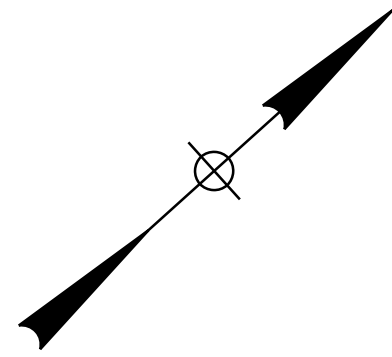

SAW CUT
 PI = 401+15.03
 D = 212° - 12' - 23.7"
 Δ = 45° - 38' - 25.1" RT.
 R = 27.00'
 L = 21.51'
 T = 11.36'
 E = 2.29'

SAW CUT
 PI = 401+50.57
 D = 60° - 18' - 40.8"
 Δ = 31° - 11' - 38.6" RT.
 R = 95.00'
 L = 51.72'
 T = 26.52'
 E = 3.63'

SAW CUT
 PI = 402+85.49
 D = 4° - 51' - 38.5"
 Δ = 10° - 38' - 06.7" RT.
 R = 1178.76'
 L = 218.80'
 T = 109.72'
 E = 5.09'

DITCH
 PI = 301+12.44
 D = 114° - 35' - 29.6"
 Δ = 50° - 50' - 53.2" RT.
 R = 50.0'
 L = 44.37'
 T = 23.77'
 E = 5.36'

DITCH
 PI = 301+73.36
 D = 22° - 55' - 05.9"
 Δ = 18° - 19' - 10.6" RT.
 R = 250.0'
 L = 79.93'
 T = 40.31'
 E = 3.23'

DITCH
 PI = 302+90.88
 D = 4° - 55' - 11.0"
 Δ = 7° - 39' - 12.5" RT.
 R = 1164.61'
 L = 155.57'
 T = 77.90'
 E = 2.60'

STATE OF MAINE DEPARTMENT OF TRANSPORTATION		2420900	
WIN		HIGHWAY PLANS	
024209.00			
	PROJ. MANAGER	R. Moulton	BY
	CHECKED-REVIEWED	C. Sullivan	DATE
	DESIGN DETAILED		SIGNATURE
	REVISIONS 1		P.E. NUMBER
	REVISIONS 2		DATE
	REVISIONS 3		
	REVISIONS 4		
	FIELD CHANGES		
PALMYRA ROUTE 2 GEOMETRIC PLAN			
SHEET NUMBER			
6			
OF 12			

Date: 5/17/2022

Username: Clark.E.Sullivan

Division: HIGHWAY

Filename: ... \MSTAD008_XSECT_300+00_001.dgn

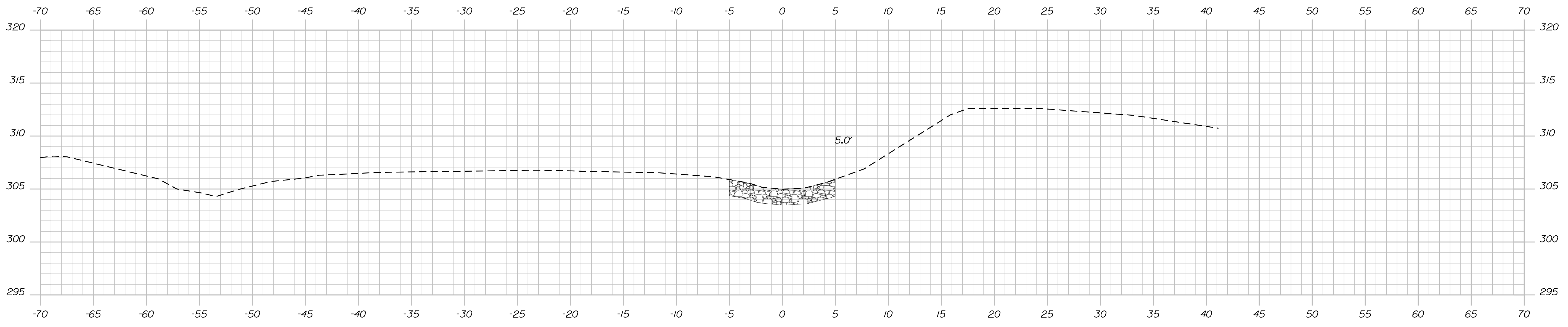
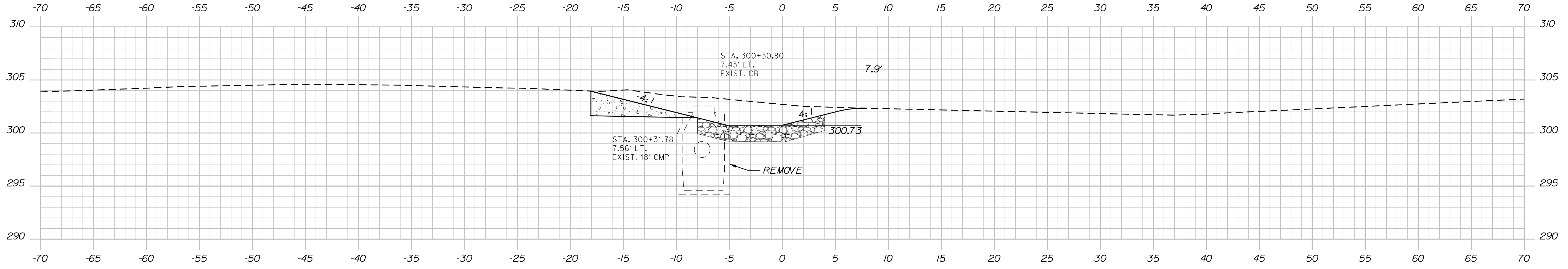
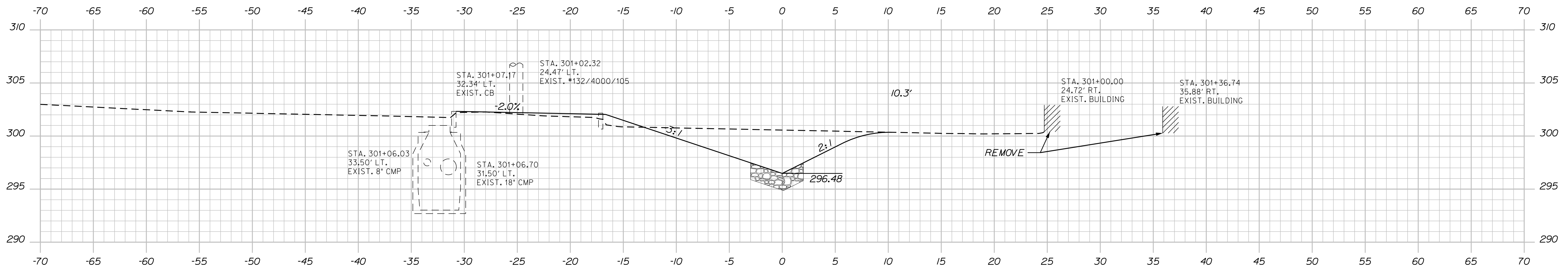

STA. 200+48.79
LIMIT OF WORK

STATE OF MAINE
DEPARTMENT OF TRANSPORTATION
2420900
WIN 024209.00
HIGHWAY PLANS

PROJ. MANAGER	R. Moulton	BY	DATE
CHECKED-REVIEWED	C. SULLOWAY		
DESIGN-DETAILED			
DESIGNS DETAILED			
REVISIONS 1			
REVISIONS 2			
REVISIONS 3			
REVISIONS 4			
FIELD CHANGES			

PALMYRA
SPECIAL DITCH SECTION
CROSS SECTIONS

SHEET NUMBER
8
OF 12

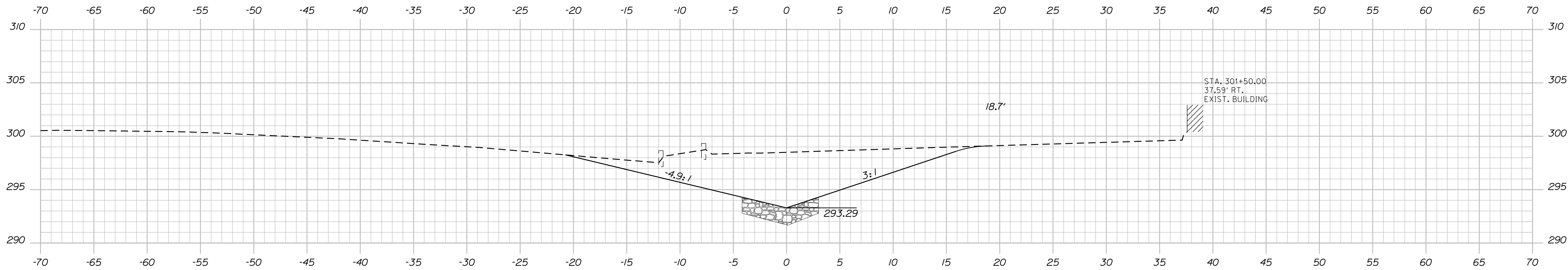

301+50.00

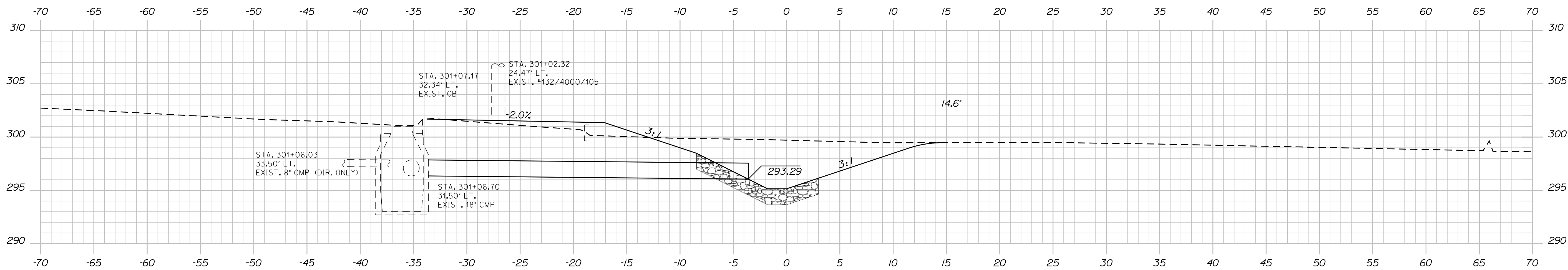

301+19.28 (SKEWED)

STA. 301+07.17, 32.3' LT. (EXISTING BASIN)
 TO STA. 301+17.66, 2.5' LT.
 INSTALL 18" X 30' CULV. PIPE OPT. 111

STATE OF MAINE
 DEPARTMENT OF TRANSPORTATION
 2420900
 WIN 024209.00
 HIGHWAY PLANS

PROJ. MANAGER	R. MULLTON	BY	DATE
CHECKED-REVIEWED	C. SULLOWAY		
DESIGN DETAILED		SIGNATURE	
REVISIONS 1		P.E. NUMBER	
REVISIONS 2		DATE	
REVISIONS 3			
REVISIONS 4			
FIELD CHANGES			

PALMYRA
 SPECIAL DITCH SECTION
 CROSS SECTIONS

SHEET NUMBER
 9
 OF 12

Date: 5/17/2022

Username: Clark.E.Sullivan

Division: HIGHWAY

Filename: ... \MSTAD10_XSECT_15+50_001.dgn

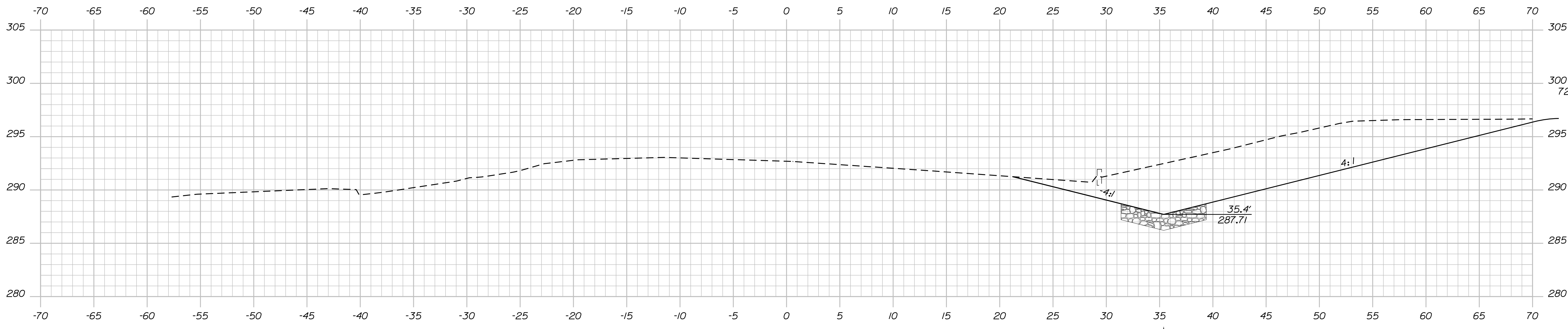

16+50.00

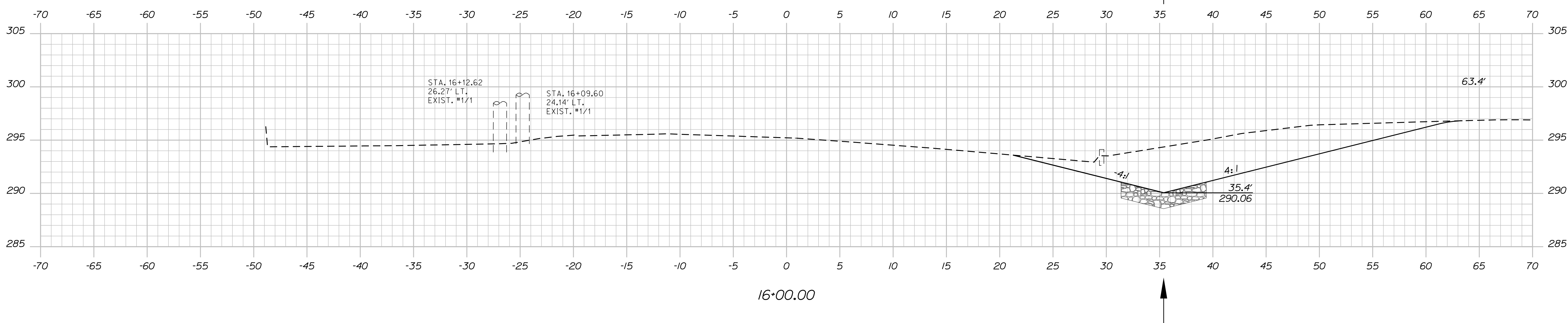

16+00.00

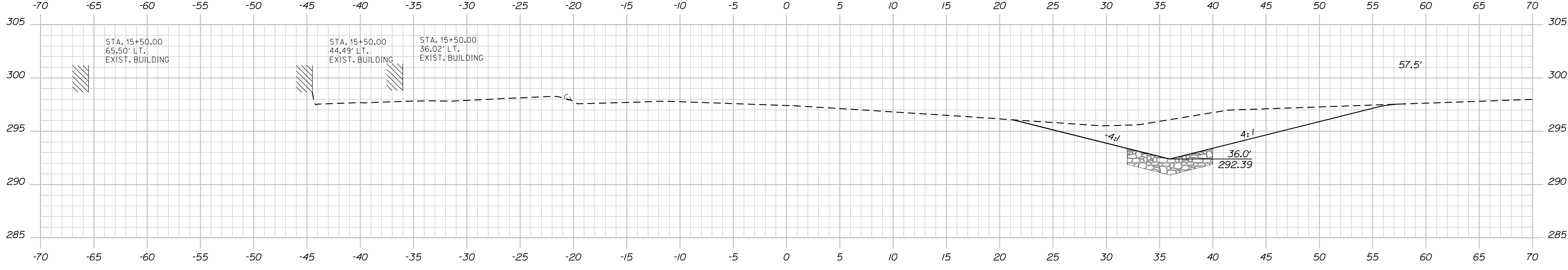

15+50.00

STA. 14+20.66 BEGIN
PROJ. NO. 2420900

STATE OF MAINE
DEPARTMENT OF TRANSPORTATION
2420900
WIN
024209.00
HIGHWAY PLANS

DESIGN-DETAILED	BY	DATE
CHECKED-REVIEWED	R. MOULTON	
DESIGN-DETAILED	C. SULLOWAY	
REVISIONS 1		
REVISIONS 2		
REVISIONS 3		
REVISIONS 4		
FIELD CHANGES		

SIGNATURE	P.E. NUMBER	DATE

PALMYRA
ROUTE 2
CROSS SECTIONS

SHEET NUMBER
10
OF 12

Sta. 15+50.00 to Sta. 16+50.00

Date: 5/17/2022

Username: Clark.E.Sullivan

Division: HIGHWAY

Filename: ... \MSTA\011_XSECT_17+00_002.dgn

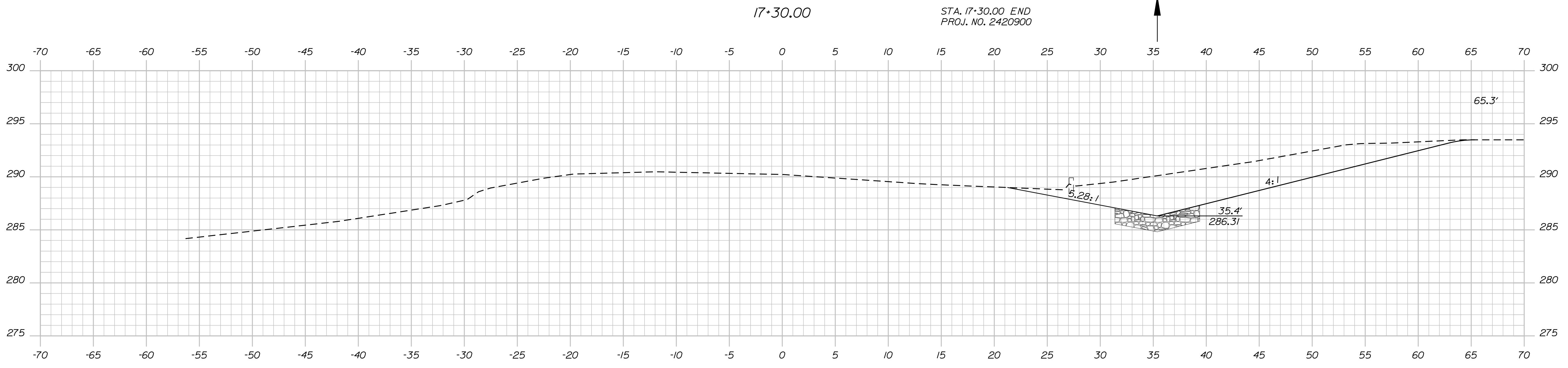
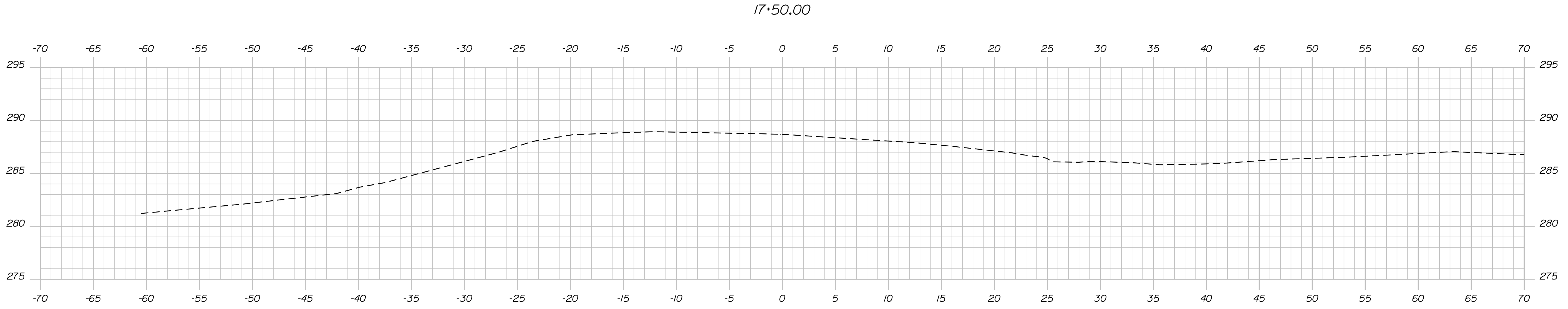
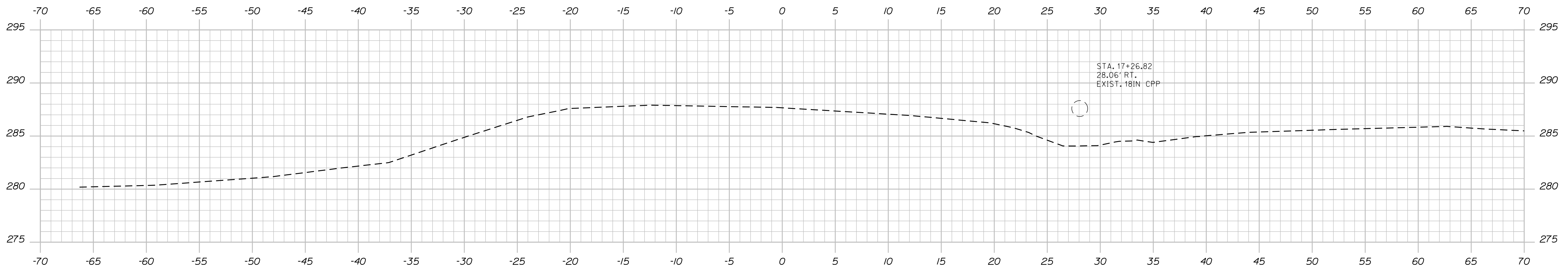

STATE OF MAINE
DEPARTMENT OF TRANSPORTATION
2420900
WIN 024209.00
HIGHWAY PLANS

DESIGN-DETAILED	DATE
CHECKED-REVIEWED	SIGNATURE
DESIGNS-DETAILED	P.E. NUMBER
REVISIONS 1	DATE
REVISIONS 2	
REVISIONS 3	
REVISIONS 4	
FIELD CHANGES	

PROJ. MANAGER	BY
R. Moulton	C. SULLOWAY

PALMYRA
ROUTE 2
CROSS SECTIONS

SHEET NUMBER
11
OF 12

PLAN LEGEND	
Town, County, State _____ Approx. Property Lines _____ Existing Right of Way _____ Limits of Wrought Portion _____ Control Of Access _____ New Right of Way _____ New Easement _____ New Temporary Rights _____ New R/W Within Existing R/W _____	New R/W Along Existing R/W _____ Building _____ Trees Conifer _____ Tree Line _____ Water Edge _____ Ledge _____ Fence _____ Sign _____ Clearing Limit Line _____ Bush Line _____ Rock/Boulder _____ Flag Pole _____ CHAIN LINK _____ BARB WIRE _____ WELL _____ STOCKADE _____ MALLBOX _____ Sanitary Sewer _____ Telephone Line _____ Electric Line _____ Water Line _____ Underdrain Line _____ Gas Line _____ Guardrail _____ Culvert _____ Existing _____ Proposed _____ Traveled Way _____ Ditch _____ Catch Basin _____ Manhole _____ Sewer Manhole _____ Utility Pole _____ Fire Hydrant _____ Curbing _____ Existing _____ Proposed _____ Cut Line _____ Stonewall _____ Baseline _____ Monument _____ Iron Rod Found _____ Replacement Pin Set _____ Fill Line _____ Retaining Wall _____ Traverse Point _____ Pipe Found _____

THIS PLAN WAS PREPARED IN CONNECTION WITH THE DEPARTMENT'S ACQUISITION OF REAL PROPERTY FOR TRANSPORTATION PURPOSES. IT CANNOT BE USED TO ESTABLISH LEGAL BOUNDARIES BETWEEN ABUTTING PROPERTY OWNERS.

Scale of Feet: 0, 25, 50, 75, 100

CONTROL INFORMATION
 HORIZONTAL DATUM - U.S. STATE PLANE NAD83(2011)
 ZONE - MAINE 2000 CENTRAL ZONE
 VERTICAL DATUM - NAVD 88
 COMBINED FACTOR - 0.9999716

STATE OF MAINE
 REGISTRY OF DEEDS

COUNTY _____
 RECEIVED _____
 at _____ h _____ m _____ M and
 recorded in Plan Bk _____, Pg. _____
 Attest: _____ REGISTER

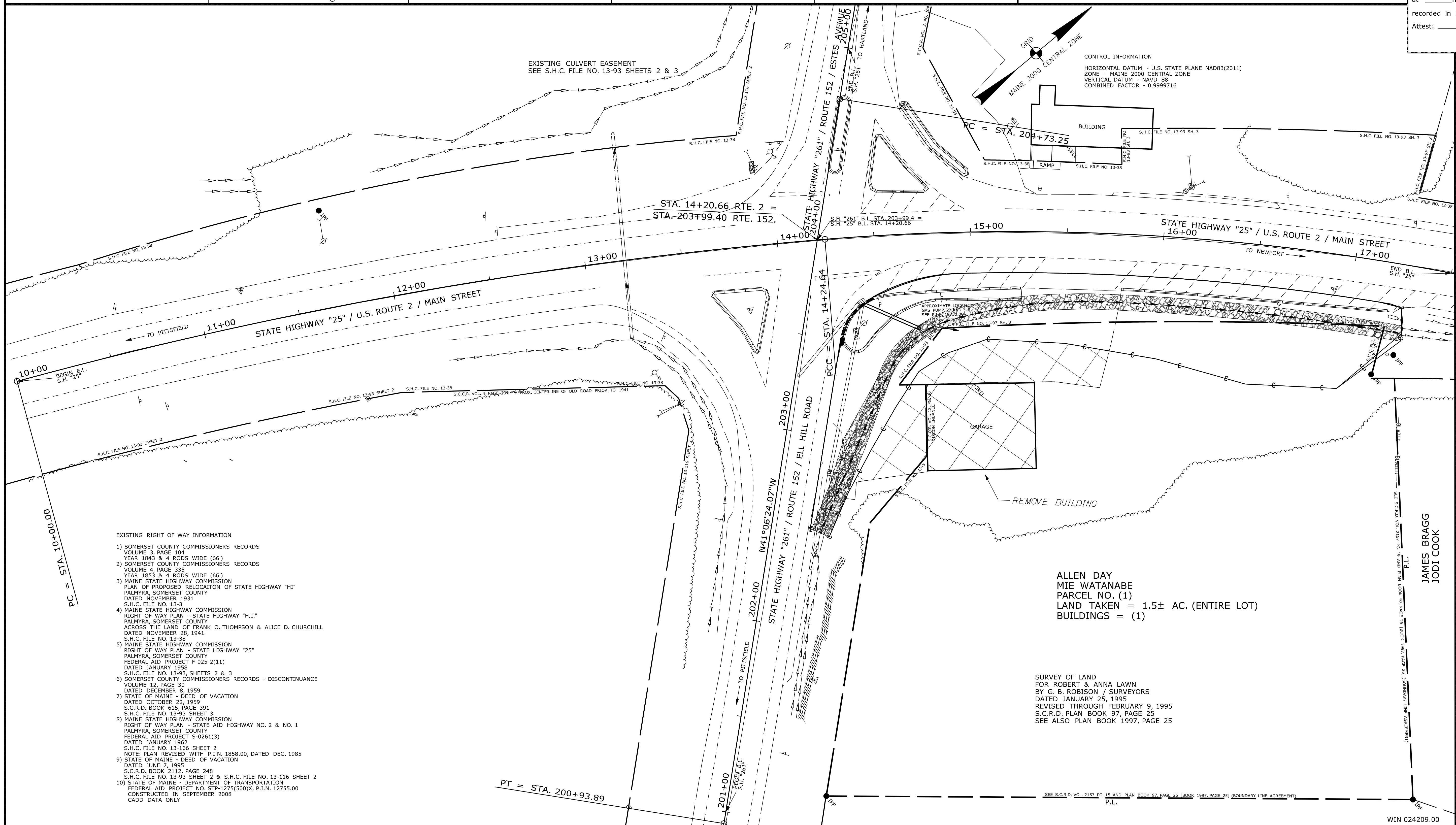

- EXISTING RIGHT OF WAY INFORMATION
- SOMERSET COUNTY COMMISSIONERS RECORDS VOLUME 3, PAGE 104 YEAR 1843 & 4 RODS WIDE (66')
 - SOMERSET COUNTY COMMISSIONERS RECORDS VOLUME 4, PAGE 335 YEAR 1853 & 4 RODS WIDE (66')
 - MAINE STATE HIGHWAY COMMISSION PLAN OF PROPOSED RELOCATION OF STATE HIGHWAY "HI" PALMYRA, SOMERSET COUNTY DATED NOVEMBER 1931 S.H.C. FILE NO. 13-3
 - MAINE STATE HIGHWAY COMMISSION RIGHT OF WAY PLAN - STATE HIGHWAY "H.I." PALMYRA, SOMERSET COUNTY ACROSS THE LAND OF FRANK O. THOMPSON & ALICE D. CHURCHILL DATED NOVEMBER 28, 1941 S.H.C. FILE NO. 13-38
 - MAINE STATE HIGHWAY COMMISSION RIGHT OF WAY PLAN - STATE HIGHWAY "25" PALMYRA, SOMERSET COUNTY FEDERAL AID PROJECT F-025-2(11) DATED JANUARY 1958 S.H.C. FILE NO. 13-38 SHEETS 2 & 3
 - SOMERSET COUNTY COMMISSIONERS RECORDS - DISCONTINUANCE VOLUME 12, PAGE 30 DATED DECEMBER 9, 1959
 - STATE OF MAINE - DEED OF VACATION DATED OCTOBER 22, 1959 S.C.R.D. BOOK 615, PAGE 391 S.H.C. FILE NO. 13-93 SHEET 3
 - MAINE STATE HIGHWAY COMMISSION RIGHT OF WAY PLAN - STATE AID HIGHWAY NO. 2 & NO. 1 PALMYRA, SOMERSET COUNTY FEDERAL AID PROJECT 5-0261(3) DATED JANUARY 1962 S.H.C. FILE NO. 13-166 SHEET 2 NOTE: PLAN REVISED WITH P.I.N. 1858.00, DATED DEC. 1985
 - STATE OF MAINE - DEED OF VACATION DATED JUNE 7, 1995 S.C.R.D. BOOK 2112, PAGE 248 S.H.C. FILE NO. 13-93 SHEET 2 & S.H.C. FILE NO. 13-116 SHEET 2
 - STATE OF MAINE - DEPARTMENT OF TRANSPORTATION FEDERAL AID PROJECT NO. STP-1275(500)X, P.I.N. 12755.00 CONSTRUCTED IN SEPTEMBER 2008 CADD DATA ONLY

ALLEN DAY
 MIE WATANABE
 PARCEL NO. (1)
 LAND TAKEN = 1.5± AC. (ENTIRE LOT)
 BUILDINGS = (1)

SURVEY OF LAND FOR ROBERT & ANNA LAWN BY G.B. ROBISON / SURVEYORS DATED JANUARY 25, 1995 REVISED THROUGH FEBRUARY 9, 1995 S.C.R.D. PLAN BOOK 97, PAGE 25 SEE ALSO PLAN BOOK 1997, PAGE 25

ITEM	TECH	CHECKED
EXISTING CONDITION PLAN	G.L.L.	
FINAL RIGHT OF WAY	J.D.F.	
AREAS	J.D.F.	

STATE OF MAINE
 DEPARTMENT OF TRANSPORTATION
 16 STATE HOUSE STATION - AUGUSTA, ME 04333-0016 - 207-624-3460
 PALMYRA
 RIGHT OF WAY MAP

REVISIONS			PLAN FILED IN PLAN BOOK				PAGE COUNTY RECORD			
NO.	DATE	DESCRIPTION	BY	NO.	GRANTOR	PAGE	INSTRUMENT	DATE	BOOK	PAGE

BRUCE A. VAN NOTE
 COMMISSIONER
 JOYCE NOEL TAYLOR
 CHIEF ENGINEER

DATE _____

STATE HIGHWAYS "25" & "261"
 U.S. ROUTE 2 / MAIN ST. / ROUTE 152 / ELL HILL ROAD
 PALMYRA SOMERSET COUNTY
 FEDERAL AID PROJECT NO. 2420900

NOVEMBER 2021 RIGHT-OF-WAY MAP
 SCALE 1" = 25' SHEET 1 OF 1

D.O.T. FILE NO. 13-402

SHEET NUMBER
12
 OF 12

Date: \$date\$
 Username: \$user\$
 Division: \$wkgroup\$
 Filename: \$file\$