

STATE OF MAINE DEPARTMENT OF TRANSPORTATION



JACKSON WALDO COUNTY GREAT FARM BRIDGE OVER GREAT FARM BROOK ROUTE 7 (MOOSEHEAD TRAIL) FEDERAL AID PROJECT NO. 2356700 PROJECT LENGTH 0.095 mi. BRIDGE NO. 3128

SPECIFICATIONS

Design: Load and Resistance Factor Design per AASHTO LRFD Bridge Design Specifications, Ninth Edition 2020.

DESIGN LOADING

Live Load HL - 93 Modified for Strength I

TRAFFIC DATA

Current (2018) AADT	1570
Future (2038) AADT	1880
DHV - % of AADT	11%
Design Hour Volume	210
Heavy Trucks (% of AADT)	10%
Heavy Trucks (% of DHV)	10%
Directional Distribution (% of DHV)	74%
18 kip Equivalent P 2.0	59
18 kip Equivalent P 2.5	56
Design Speed (mph)	50

HYDROLOGIC DATA

Drainage Area	6.4 sq mi
Design Discharge (Q50)	714.8 cfs
Check Discharge (Q100)	837.5 cfs
Headwater Elevation (Q1.1)	428.51 ft
Headwater Elevation (Q25)	431.24 ft
Headwater Elevation (Q50)	431.65 ft
Headwater Elevation (Q100)	432.09 ft
Discharge Velocity (Q1.1)	5.56 fps
Discharge Velocity (Q50)	11.04 fps
Discharge Velocity (Q100)	11.63 fps

MATERIALS

Concrete:	
Precast	Class "P"
All Other	Class "A"
Reinforcing Steel	ASTM A615/A615M, Grade 60
Welded Wire Reinforcement	ASTM A1064/A1064M

BASIC DESIGN STRESSES

Concrete	f 'c = 4000 psi
Precast Concrete	f 'c = 5000 psi
Reinforcing Steel	f y = 60,000 psi
Welded Wire Reinforcing	f y = 65,000 psi

LIST OF DRAWINGS

Title Sheet	1
Estimated Quantities and General Construction Notes	2
General Plan	3
Profile	4
Boring Location Plan and Interpretive Subsurface Profile	5
Boring Logs	6
Highway Approach Cross - Sections	7-16
Precast Concrete Box Culvert Details	17-19
Right of Way Map	20

UTILITIES

Central Maine Power
Consolidated Communications Of Maine

MAINTENANCE OF TRAFFIC

Maintain one lane of alternating traffic on a temporary bridge using traffic signals.

<u>PROJECT LOCATION</u>	Great Farm Bridge (#3128) over Great Farm Brook. Located 0.12 of a mile south of Great Farm Road. Latitude 44°-35'-48" N - Longitude 69°-08'-28" W
<u>PROGRAM AREA</u>	Highway Bridges - Traditional
<u>OUTLINE OF WORK</u>	Bridge Replacement

STATE OF MAINE
DEPARTMENT OF TRANSPORTATION
APPROVED
COMMISSIONER: <i>[Signature]</i>
DATE: 11-3-21
CHIEF ENGINEER: <i>[Signature]</i>

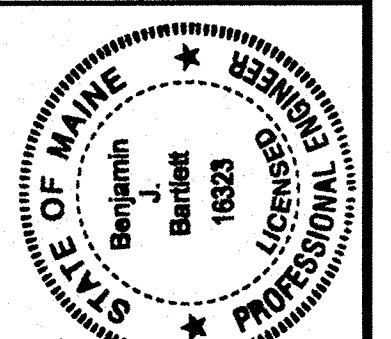

<i>[Signature]</i>
SIGNATURE
16323
P.E. NUMBER
10/12/2021
DATE

PROJECT INFORMATION
PROGRAM: BRIDGE
PROJECT MANAGER: MARK PARLIN
DESIGNER: BEN BARTLETT
CONSULTANT
PROJECT RESIDENT
CONTRACTOR
PROJECT COMPLETION DATE

WIN 23567.00

02356700

JACKSON
GREAT FARM BRIDGE
TITLE SHEET

SHEET NUMBER
1
OF 20

Date:10/8/2021
Username: Richard.Moyer
Division: BRIDGE
Filename:\00\BRIDGE\MSTA\001_Title.dgn

ESTIMATED QUANTITIES			
ITEM NO.	DESCRIPTION	QUANTITY	UNIT
202.19	REMOVING EXISTING BRIDGE (270 CY)	1	LS
202.202	REMOVING PAVEMENT SURFACE	420	SY
203.20	COMMON EXCAVATION	720	CY
203.2318	DISPOSAL OF SPECIAL WASTE	400	T
203.24	COMMON BORROW	10	CY
203.25	GRANULAR BORROW	730	CY
203.33	SPECIAL FILL	284	CY
206.061	STRUCTURAL EARTH EXCAVATION - BELOW GRADE	25	CY
304.10	AGGREGATE SUBBASE COURSE - GRAVEL	910	CY
403.208	HOT MIX ASPHALT 12.5 MM HMA SURFACE	169	T
403.211	HOT MIX ASPHALT (SHIMMING)	5	T
403.213	HOT MIX ASPHALT 12.5 MM BASE	222	T
409.15	BITUMINOUS TACK COAT - APPLIED	90	G
461.131	TEMPORARY PAVEMENT	120	T
508.13	SHEET WATERPROOFING MEMBRANE (225 SY)	1	LS
510.10	SPECIAL DETOUR 16' RDWY WIDTH TRAVELWAY NOT SEPARATED	1	LS
511.07	COFFERDAM: UPSTREAM	1	LS
511.07	COFFERDAM: DOWNSTREAM	1	LS
513.22	CRUSHED STONE SLOPE PROTECTION	88	SY
515.21	PROTECTIVE COATING FOR CONCRETE SURFACES (58 SY)	1	LS
526.301	PORTABLE CONCRETE BARRIER TYPE 1 (60 LF)	1	LS
527.34	WORK ZONE CRASH CUSHIONS	2	UN
534.71	PRECAST CONCRETE BOX CULVERT (364 CY)	1	LS
606.1301	3" W-BEAM GUARDRAIL, MID-WAY SPLICE - SINGLE FACED	400	LF
606.1305	3" W-BEAM GUARDRAIL, MID-WAY SPLICE - FLARED TERMINAL	4	EA
606.353	REFLECTORIZED FLEXIBLE GUARDRAIL MARKER	8	EA
607.246	RELOCATE & RESET FENCE	1	LS
610.08	PLAIN RIPRAP	251	CY
610.16	HEAVY RIPRAP	32	CY
610.18	STONE DITCH PROTECTION	5	CY
610.210	STREAM CHANNEL ROCK	224	CY
610.212	STREAMBED ROCK FEATURES	44	CY
613.319	EROSION CONTROL BLANKET	123	SY
615.07	LOAM	61	CY
618.14	SEEDING METHOD NUMBER 2	10	UN
619.12	MULCH	10	UN
619.14	EROSION CONTROL MIX	121	CY
620.58	EROSION CONTROL GEOTEXTILE	365	SY
627.733	4" WHITE OR YELLOW PAINTED PAVEMENT MARKING LINE	1500	LF
627.77	REMOVING PAVEMENT MARKINGS	367	SF
627.78	TEMPORARY 4" PAINTED PAVEMENT MARK LINE WHITE OR YELLOW	1100	LF
629.05	HAND LABOR, STRAIGHT TIME	10	HR
631.12	ALL PURPOSE EXCAVATOR (INCLUDING OPERATOR)	10	HR
631.172	TRUCK - LARGE (INCLUDING OPERATOR)	10	HR
639.19	FIELD OFFICE TYPE B	1	EA
643.72	TEMPORARY TRAFFIC SIGNAL	1	LS
652.312	TYPE III BARRICADE	4	EA
652.33	DRUM	25	EA
652.34	CONE	50	EA
652.35	CONSTRUCTION SIGNS	400	SF
652.361	MAINTENANCE OF TRAFFIC CONTROL DEVICES	1	LS
652.38	FLAGGER	360	HR
656.75	TEMPORARY SOIL EROSION & WATER POLLUTION CONTROL	1	LS
659.10	MOBILIZATION	1	LS

GENERAL CONSTRUCTION NOTES

- For easements, construction limits and right of way lines, refer to Right of Way Map.
- The clearing limits as shown on the plans are approximate. The exact limits will be established in the field by the Resident. Payment for clearing will be considered incidental to Contract items.
- All utility facilities shall be adjusted by the respective utilities unless otherwise noted.
- Do not excavate for Aggregate Subbase Course where existing material is suitable as determined by the Resident.
- In areas where the Resident directs the Contractor not to excavate to the subgrade line shown on the plans, payment for removing existing pavement, grubbing, shaping, ditching, and compacting the existing subbase and layers of new subbase 6 inches or less thick will be made under appropriate equipment rental items.
- All embankment material and backfill for the box placed below the pavement subbase shall be Granular Borrow meeting the requirements of Subsection 703.19, Material for Underwater Backfill.
- Place loam 2 inches deep on all new or reconstructed sideslopes or as directed by the Resident.
- Erosion Control Mix may be substituted in those areas normally receiving loam and seed as directed by the Resident. Placement shall be in accordance with Standard Specifications Section 619, Mulch. Payment will be made under Item No. 619.14, Erosion Control Mix.
- Place a 24-in. wide strip of Erosion Control Blanket on the sideslopes along the top of the riprap and behind the guardrail.
- A MASH compliant guardrail end treatment shall be installed concurrently with the placement of each section of beam guardrail.
- Extended-use Erosion Control Blanket, seeded gutters, riprap downspouts, and other gutters lined with Stone Ditch Protection shall be constructed after paving and shoulder work is completed, where it is apparent that runoff will cause continual erosion. Payment will be made under the appropriate Contract items.
- Protective Coating for Concrete Surfaces shall be applied to the following areas:
 - Concrete headwalls, including to one foot inside the box;
 - Exposed tops of vertical walls and to one foot below the ground on the back side;
 - Exposed faces of vertical walls and to one foot inside the box.
- Project information referred to below may be accessed at the following MaineDOT web address: <http://www.maine.gov/mdot/contractors/>.
- The existing bridge plans may be accessed at the MaineDOT web address. The plans are reproductions of the original drawings as prepared for the construction of the bridge. It is very unlikely that the plans will show any construction field changes or any alterations which may have been made to the bridge during its life span.
- The hydrologic report of the bridge site may be accessed at the MaineDOT web address. The hydrologic report is based on MaineDOT's interpretation of the information obtained for the subject site. No assurance is given that the information or the conclusions of the report will be representative of actual conditions at the time of construction.

16. The project geotechnical report titled: GEOTECHNICAL DESIGN REPORT For the Replacement of: GREAT FARM BRIDGE, STATE ROUTE 7 OVER GREAT FARM BROOK, JACKSON, MAINE, Soils Report 2021-06, March 15, 2021 may be accessed at the MaineDOT web address.

17. Geotechnical information furnished or referred to in this plan set is for the use of the Bidders and the Contractor. No assurance is given that the information or interpretations will be representative of actual subsurface conditions at the construction site. MaineDOT will not be responsible for the Bidders' or Contractor's interpretations of, or conclusions drawn from, the geotechnical information. The boring logs contained in the plan set present factual and interpretive subsurface information collected at discrete locations. Data provided may not be representative of the subsurface conditions between the boring locations.

18. Quantities included for pay items measured and paid for by Lump Sum are estimated quantities and are provided by MaineDOT for informational purposes only. Lump Sum pay items will be paid for at the Contract Bid amount, with no addition or reduction in payment to the Contractor if the actual final quantities are different from the MaineDOT provided estimated quantities, except as follows:

- If a Lump Sum pay item is eliminated, the requirements of Standard Specifications Section 109.2, Elimination of Items, will take precedence.
- If other Contract Documents specifically allow a change in payment for a Lump Sum pay item, those requirements will be followed.
- If a design change results in changes to estimated quantities for Lump Sum pay items, price adjustments will be made in accordance with Standard Specifications Section 109.7, Equitable Adjustments to Compensation.

19. Existing signs within the Project limits shall be removed and reset as directed by the Resident. Payment for removal and reinstallation of existing signs will be considered incidental to the Contract. No separate payment will be made.

20. The existing bridge shall be removed by and become the property of the Contractor. The steel portions of the existing bridge may be coated with a lead-based paint system. The Contractor is responsible for the containment, proper management and disposal of all lead-contaminated hazardous waste generated by the process of demolishing the bridge. The Contractor is responsible for implementing appropriate OSHA mandated personal protection standards related to this process. Once the existing bridge is removed, the Contractor is solely responsible for the care, custody, and control of the components of the existing bridge and any hazardous waste generated as a result of the storage, recycling, or disposal of the bridge components, including lead-coated steel. The Contractor shall recycle or reuse the steel in accordance with the Maine Department of Environmental Protection's "Maine Hazardous Waste Management Regulations," Chapter 850. A copy of this regulation is available at MaineDOT's offices on Child Street in Augusta. Payment for all labor, materials, equipment, and other costs required to remove and dispose of the existing bridge will be considered incidental to the bridge removal pay item.

21. Structural Earth Excavation shall be incidental to Item 534.71 Precast Concrete Box Culvert and subject to the requirements of Standard Specifications Section 206.

STATE OF MAINE
DEPARTMENT OF TRANSPORTATION
02356700
WIN 23567.00
BRIDGE NO. 3128
BRIDGE PLANS

PROJ. MANAGER: M. PARLIN
DESIGN-DETAILED: B. BARTLETT
CHECKED-REVIEWED: R. MYERS
DESIGNS DETAILED:
REVISIONS 1
REVISIONS 2
REVISIONS 3
FIELD CHANGES
DATE: SEP 2021
SIGNATURE:
P.E. NUMBER:
DATE:

GREAT FARM BRIDGE
GREAT FARM BROOK
WALDO COUNTY
JACKSON

ESTIMATED QUANTITIES & GENERAL CONSTRUCTION NOTES

SHEET NUMBER
2
OF 20

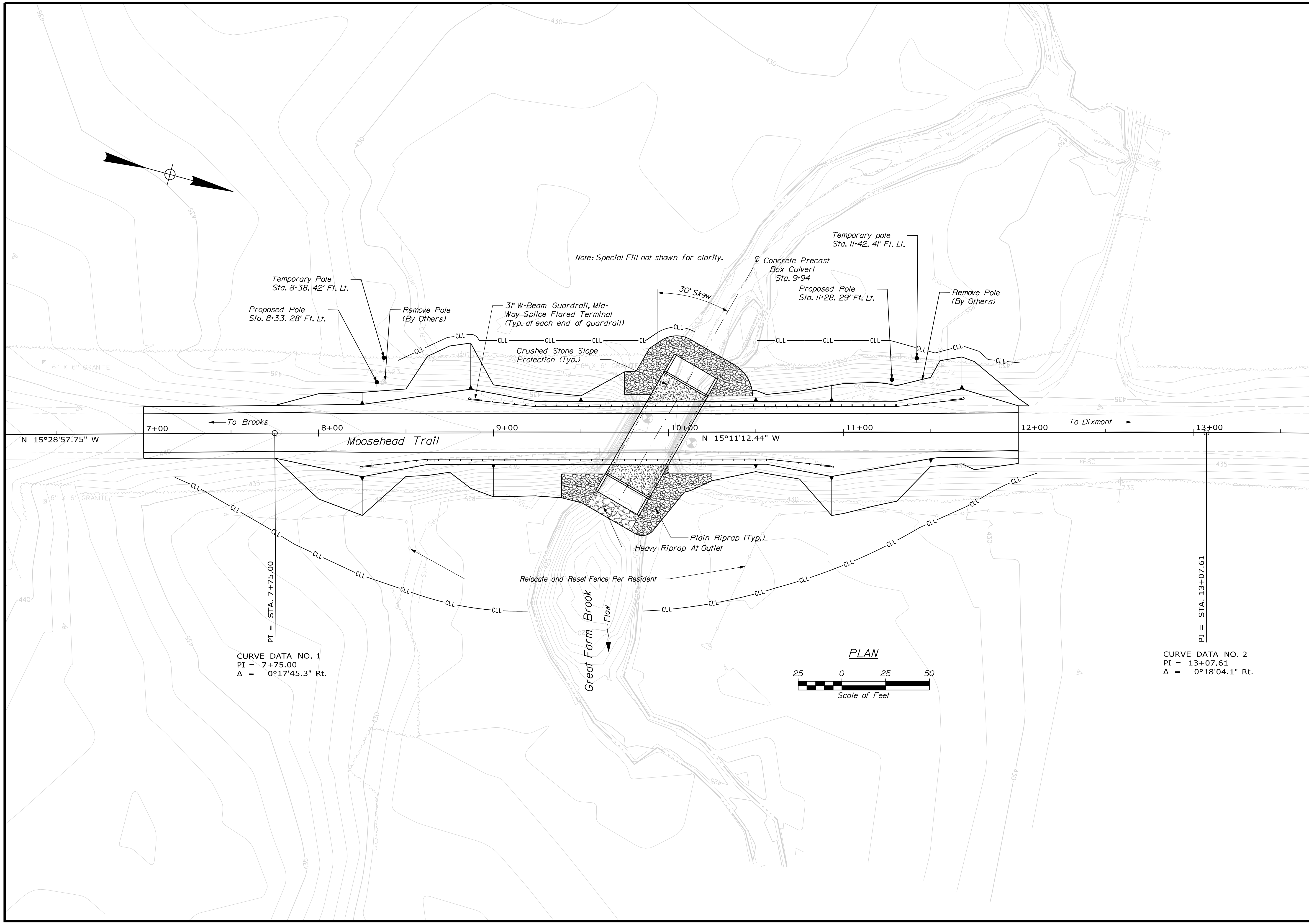

STATE OF MAINE
DEPARTMENT OF TRANSPORTATION
02356700
WIN
23567.00
BRIDGE NO. 3128
BRIDGE PLANS

DATE	SIGNATURE	P.E. NUMBER	DATE
SEP 2021			

PROJ. MANAGER	BY	DATE
M. PARLIN	D. SHAW	SEP 2021

GREAT FARM BRIDGE
GREAT FARM BROOK
WALDO COUNTY
JACKSON
GENERAL PLAN

SHEET NUMBER
3
OF 20

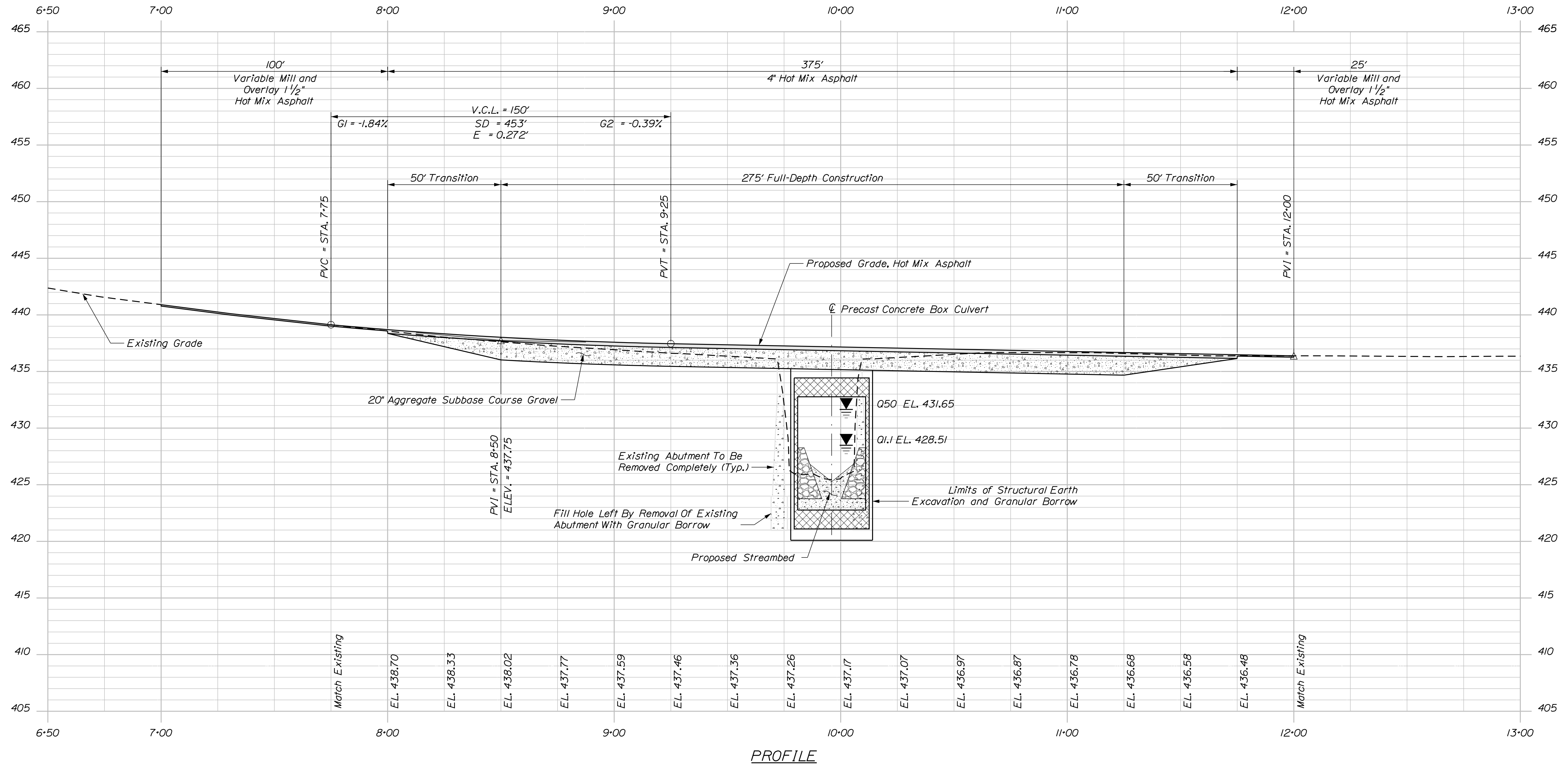

DESIGN/REVIEWED	B. BARTLETT	DATE	SEP. 2021
CHECKED/REVIEWED	D. SHAW	SIGNATURE	
DESIGN/DETAILED	R. MYERS	P.E. NUMBER	
REVISIONS 1		DATE	
REVISIONS 2			
REVISIONS 3			
REVISIONS 4			
FIELD CHANGES			

PROJ. MANAGER	M. PARLIN
DESIGN/DETAILED	B. BARTLETT
CHECKED/REVIEWED	D. SHAW
DESIGN/DETAILED	R. MYERS
REVISIONS 1	
REVISIONS 2	
REVISIONS 3	
REVISIONS 4	
FIELD CHANGES	

JACKSON
GREAT FARM BRIDGE
GREAT FARM BROOK
WALDO COUNTY
PROFILE

Date: 10/13/2021

Username: Richard.Mayer

Filename: ... \BRIDGE\MSTA\007_XSECT_6+75.dgn Division: BRIDGE

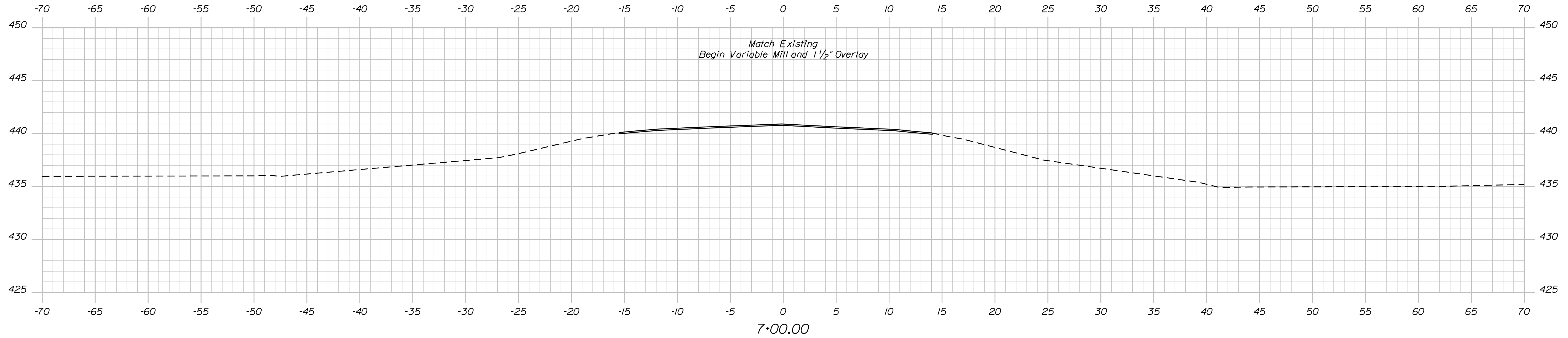

7+00.00

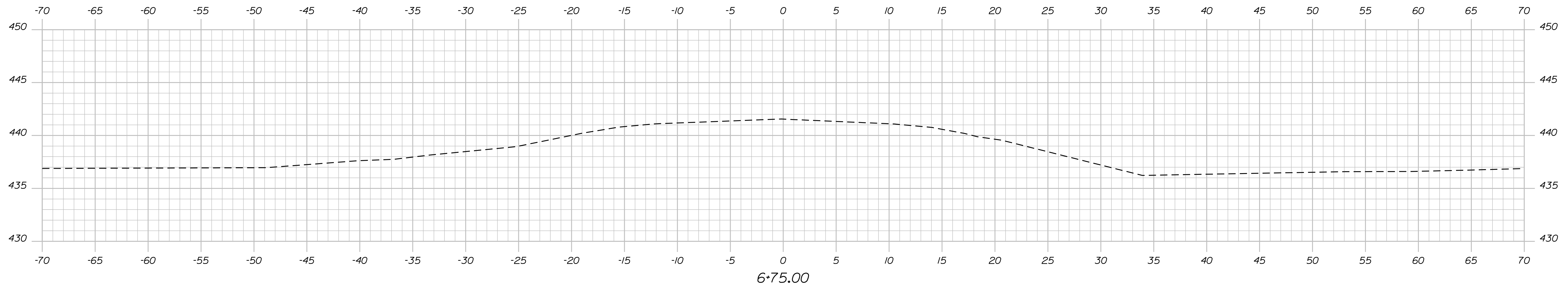

6+75.00

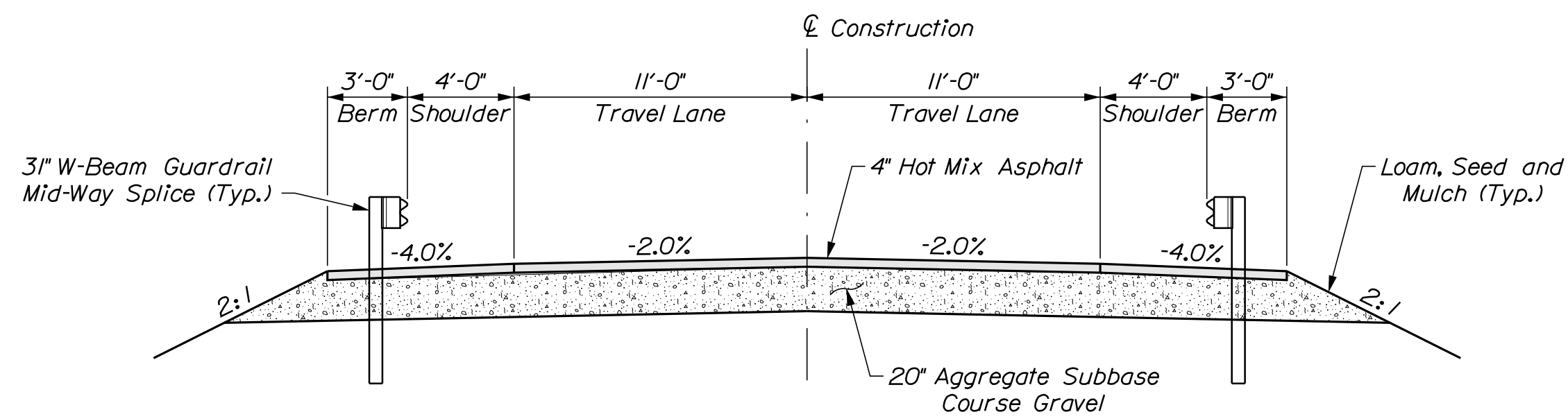

PROPOSED TYPICAL APPROACH SECTION

STATE OF MAINE
DEPARTMENT OF TRANSPORTATION

02356700

WIN

BRIDGE NO. 3128

BRIDGE PLANS

SIGNATURE

P.E. NUMBER

DATE

DATE

BY

M. PARIN

DESIGN-DETAILED

CHECKED-REVIEWED

DESIGN-DETAILED

REVISIONS 1

REVISIONS 2

REVISIONS 3

REVISIONS 4

FIELD CHANGES

DATE

BY

D. SHAW

DESIGN-DETAILED

CHECKED-REVIEWED

DESIGN-DETAILED

REVISIONS 1

REVISIONS 2

REVISIONS 3

REVISIONS 4

FIELD CHANGES

DATE

BY

R. MYERS

DESIGN-DETAILED

CHECKED-REVIEWED

DESIGN-DETAILED

REVISIONS 1

REVISIONS 2

REVISIONS 3

REVISIONS 4

FIELD CHANGES

JACKSON
GREAT FARM BRIDGE
GREAT FARM BROOK
WALDO COUNTY

CROSS SECTIONS

SHEET NUMBER

7

OF 20

Date: 10/13/2021

Username: Richard.Mayer

Filename: ... \BRIDGE\WSTA\008_XSECT_7+50.dgn Division: BRIDGE

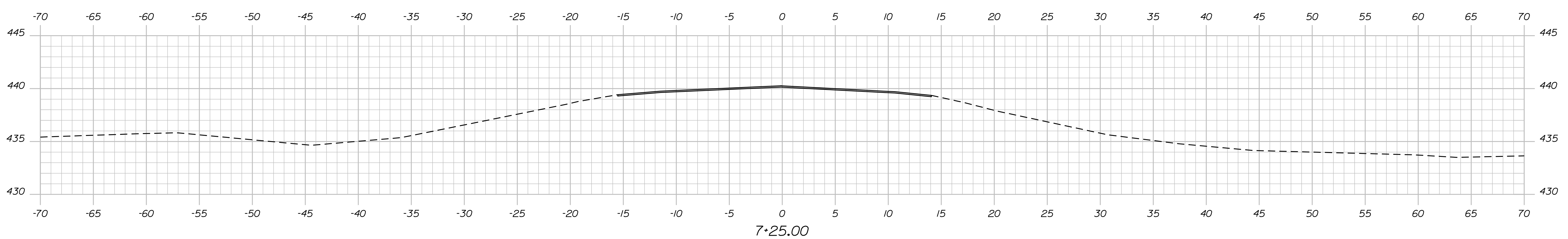
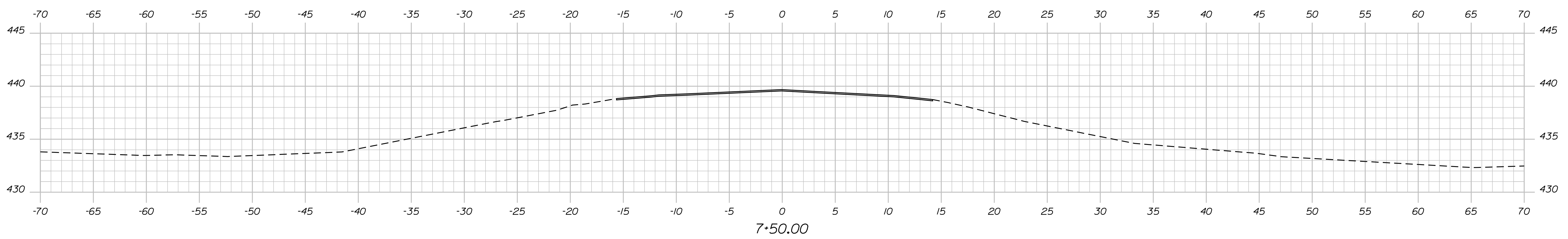
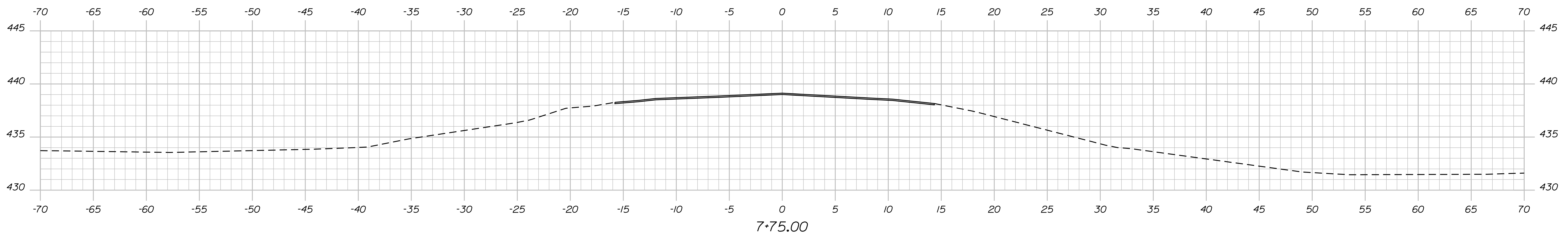
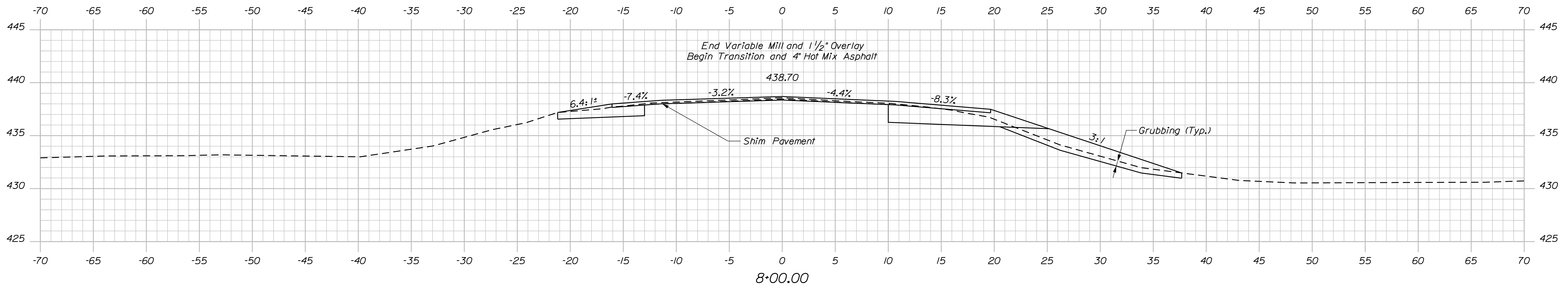

STATE OF MAINE
DEPARTMENT OF TRANSPORTATION
02366700
WIN 23567.00
BRIDGE NO. 3128 BRIDGE PLANS

PROJ. MANAGER	M. PARLIN	DATE	SEP. 2021
DESIGN-DETAILED	B. BARTLETT	BY	D. SHAW
CHECKED-REVIEWED	R. MYERS	DATE	
DESIGN-DETAILED		SIGNATURE	
REVISIONS 1		P.E. NUMBER	
REVISIONS 2		DATE	
REVISIONS 3			
REVISIONS 4			
FIELD CHANGES			

GREAT FARM BRIDGE
GREAT FARM BROOK
WALDO COUNTY
JACKSON

CROSS SECTIONS

SHEET NUMBER
8
OF 20

Date: 10/13/2021

Username: Richard.Mayer

Filename: ... \BRIDGE\WSTA\09_XSECT_8+25.dgn Division: BRIDGE

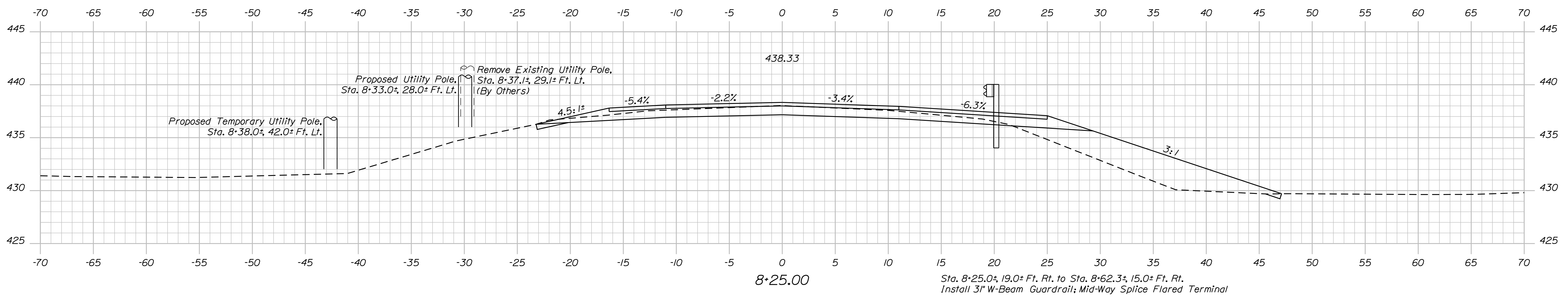
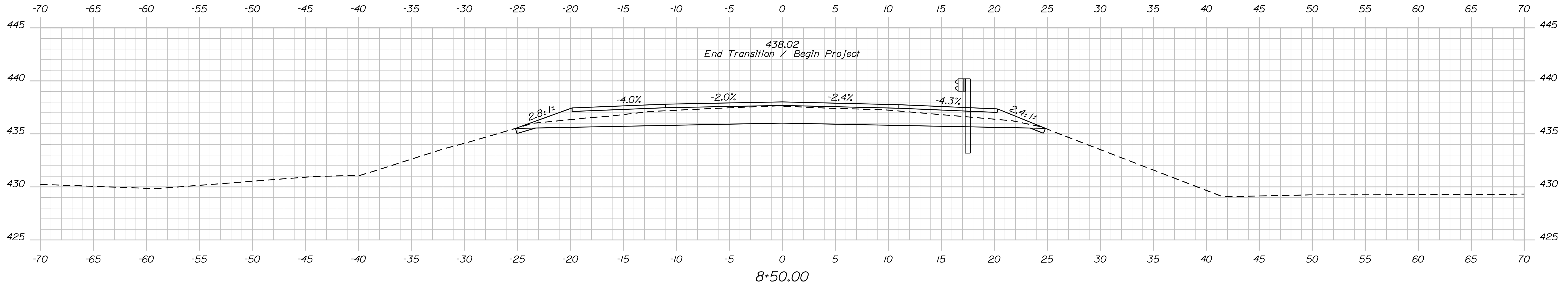
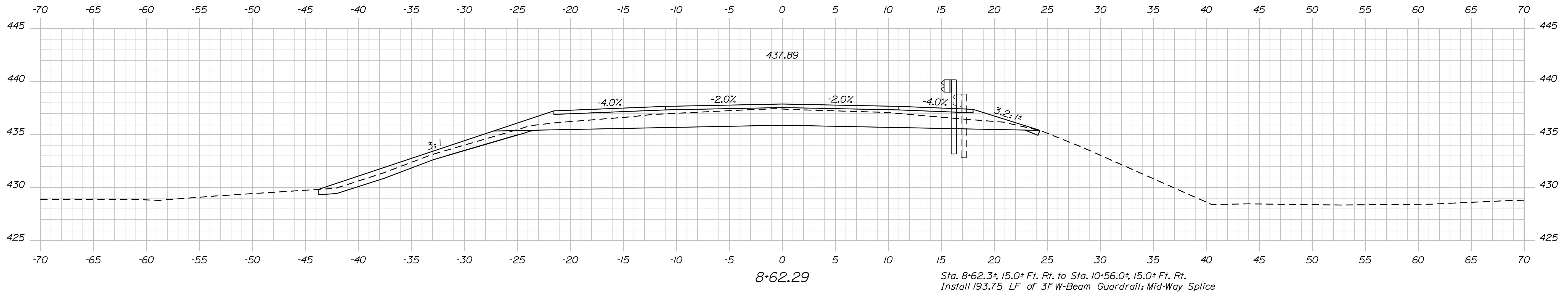

STATE OF MAINE
DEPARTMENT OF TRANSPORTATION
02366700
WIN
23567.00
BRIDGE NO. 3128
BRIDGE PLANS

PROJ. MANAGER	M. PARLIN	DATE	SEP. 2021
CHECKED/REVIEWED	B. BARTLETT / D. SHAW	BY	
DESIGNED/DETAILED	R. MYERS	SIGNATURE	
REVISIONS 1		P.E. NUMBER	
REVISIONS 2		DATE	
REVISIONS 3			
REVISIONS 4			
FIELD CHANGES			

GREAT FARM BRIDGE
GREAT FARM BROOK
WALDO COUNTY
JACKSON

CROSS SECTIONS

SHEET NUMBER
9
OF 20

Date: 10/13/2021

Username: Richard.Mayer

Filename: ... \BRIDGE\MSTA\10...XSECT_8+75.dgn Division: BRIDGE

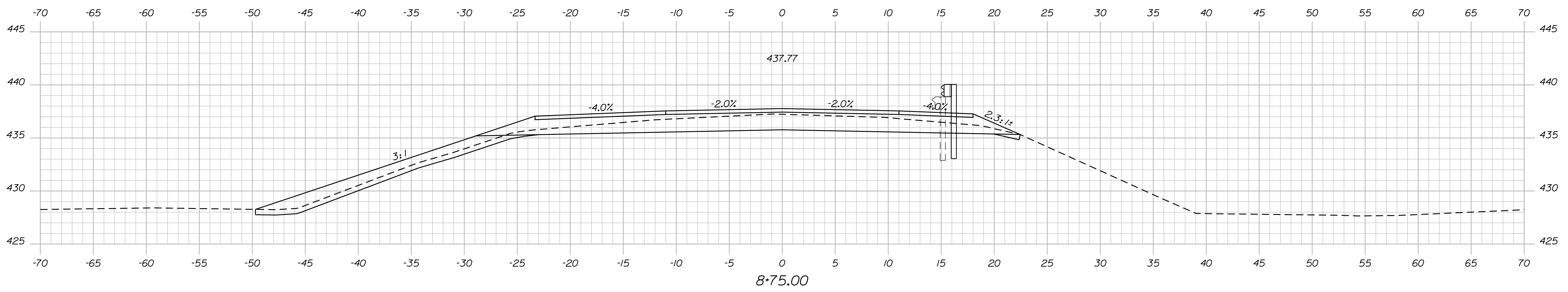
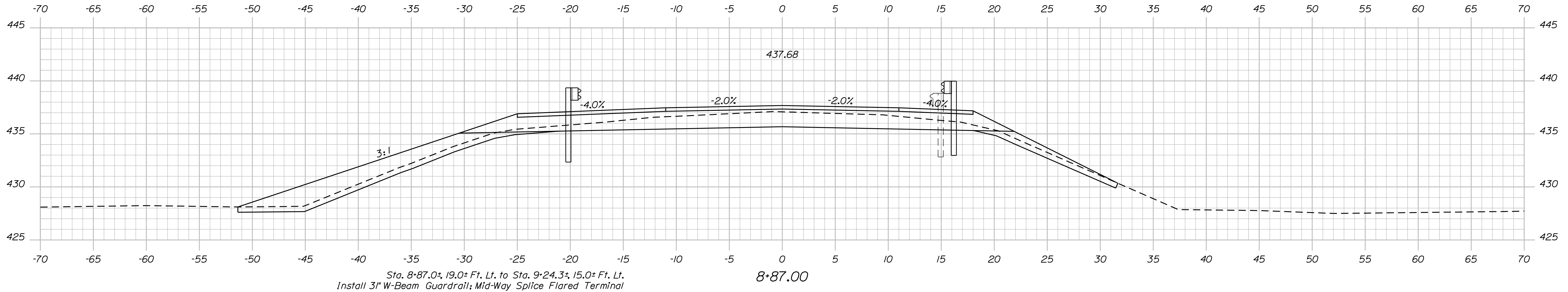
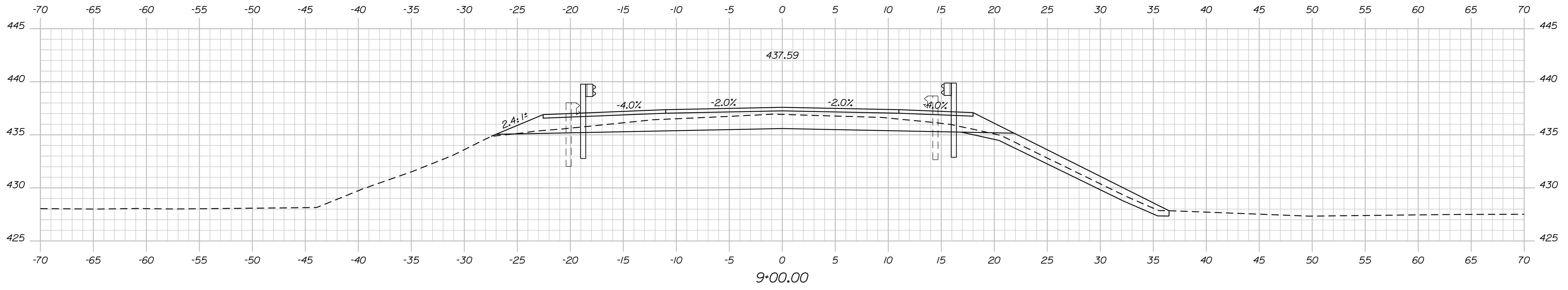

STATE OF MAINE
DEPARTMENT OF TRANSPORTATION
02366700
WIN
23567.00
BRIDGE NO. 3128
BRIDGE PLANS

PROJ. MANAGER	M. PARLIN	DATE	SEP 2021
DESIGN DETAILED	B. BARTLETT	BY	D. SHAW
CHECKED/REVIEWED	R. MYERS	SIGNATURE	
DESIGN DETAILED		P.E. NUMBER	
REVISIONS 1		DATE	
REVISIONS 2			
REVISIONS 3			
REVISIONS 4			
FIELD CHANGES			

GREAT FARM BRIDGE
GREAT FARM BROOK
WALDO COUNTY
JACKSON

CROSS SECTIONS

SHEET NUMBER
10
OF 20

Date: 10/13/2021

Username: Richard.Mayer

Filename: ... \BRIDGE\MSTA\011_XSECT_9-24.dgn Division: BRIDGE

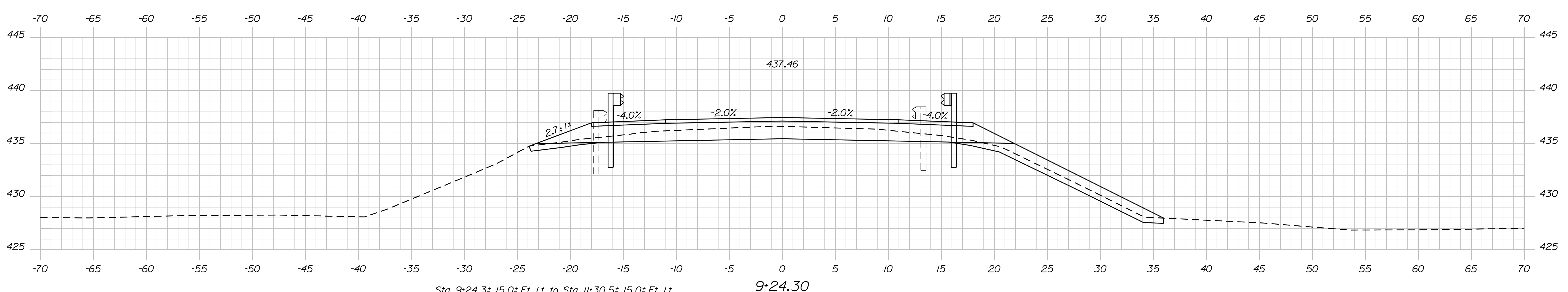
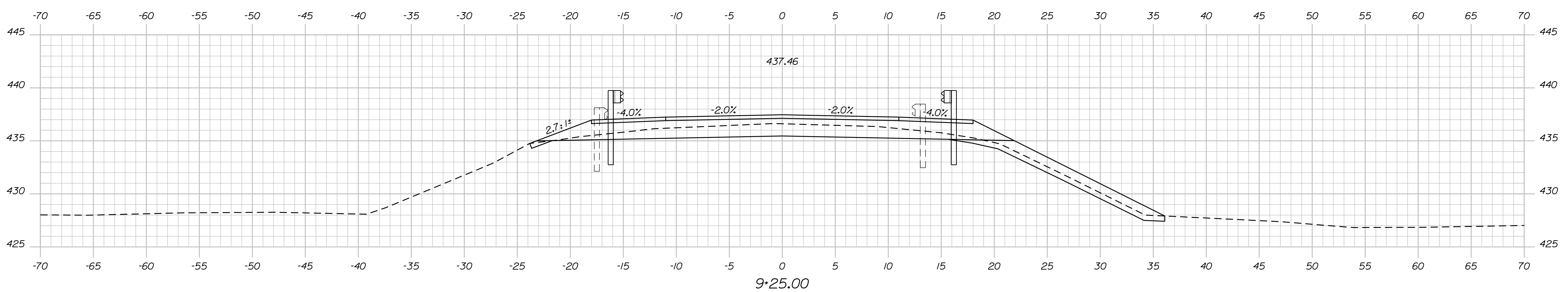
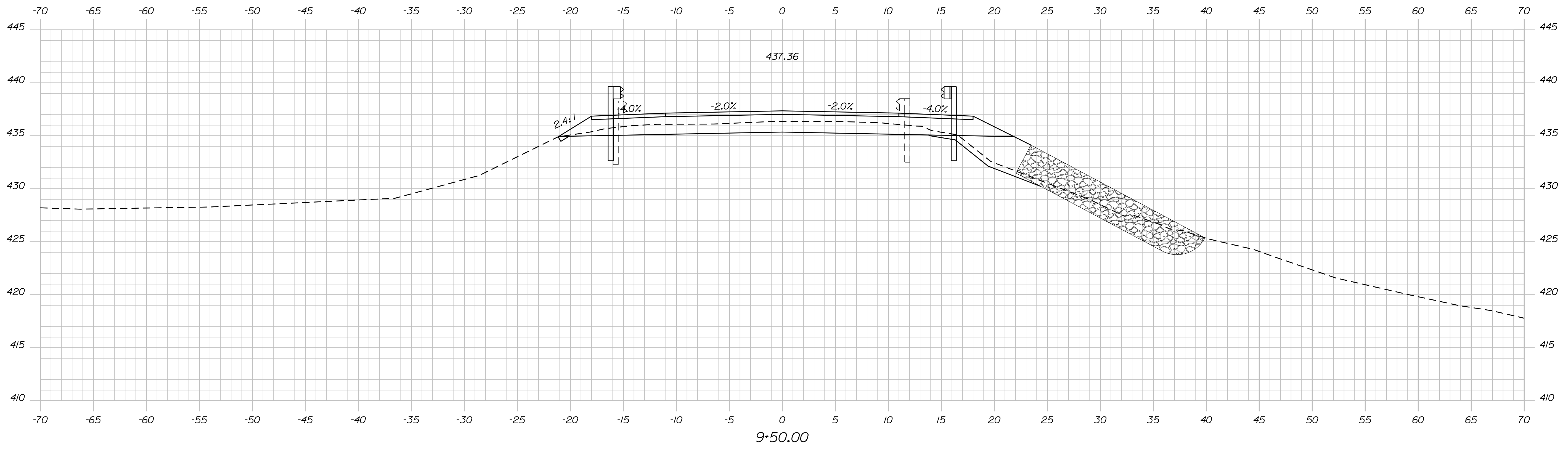

Sta. 9+24.3±, 15.0± Ft. Lt. to Sta. 11+30.5±, 15.0± Ft. Lt.
 Install 206.25 LF of 31" W-Beam Guardrail; Mid-Way Splice

STATE OF MAINE
 DEPARTMENT OF TRANSPORTATION
 02366700
 WIN
 23567.00
 BRIDGE NO. 3128
 BRIDGE PLANS

DESIGNER: M. PARLIN
 CHECKED: B. BARTLETT
 DESIGNED: R. MYERS
 REVISIONS: 1, 2, 3, 4
 FIELD CHANGES

DATE: SEP 2021
 BY: D. SHAW
 SIGNATURE: _____
 P.E. NUMBER: _____
 DATE: _____

GREAT FARM BRIDGE
 GREAT FARM BROOK
 WALDO COUNTY
 JACKSON
 CROSS SECTIONS

SHEET NUMBER
 11
 OF 20

Sta. 9+24.30 to Sta. 9+50.00

Date: 10/13/2021

Username: Richard.Mayer

Filename: ... \BRIDGE\MSTA\012_XSECT_9+75.dgn Division: BRIDGE

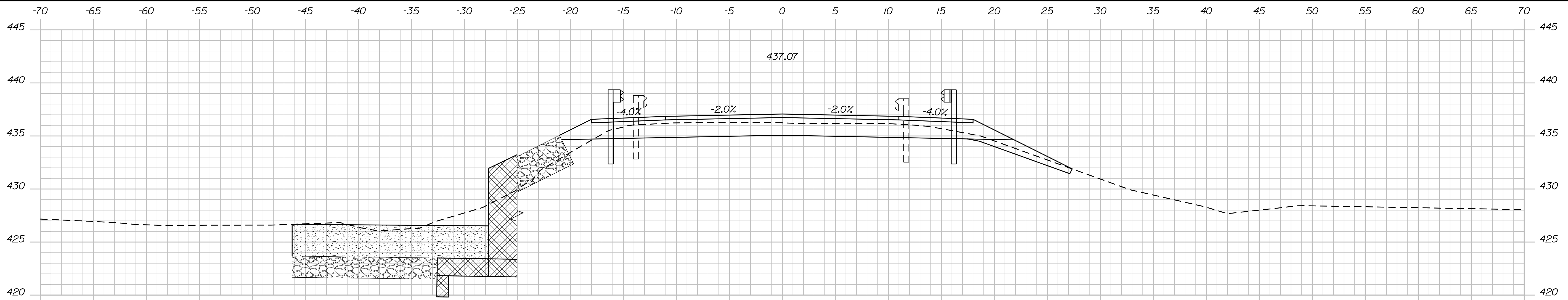

10+25.00

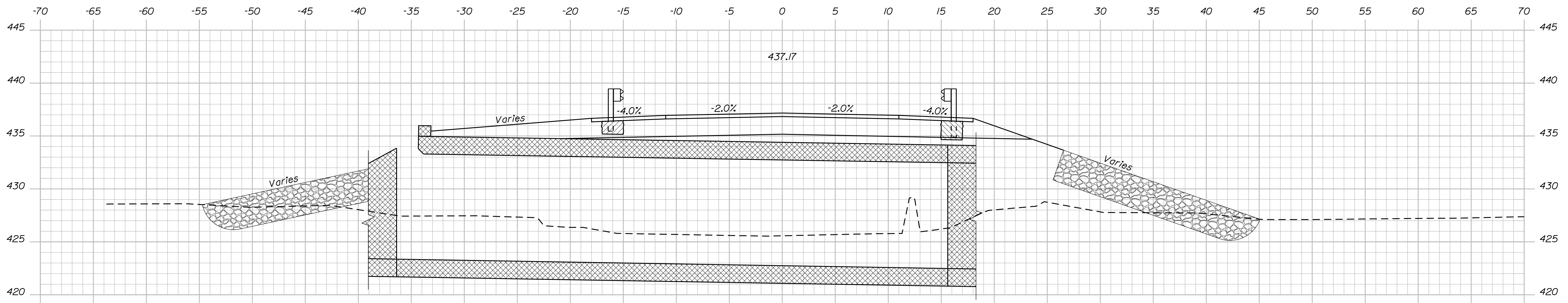

10+00.00

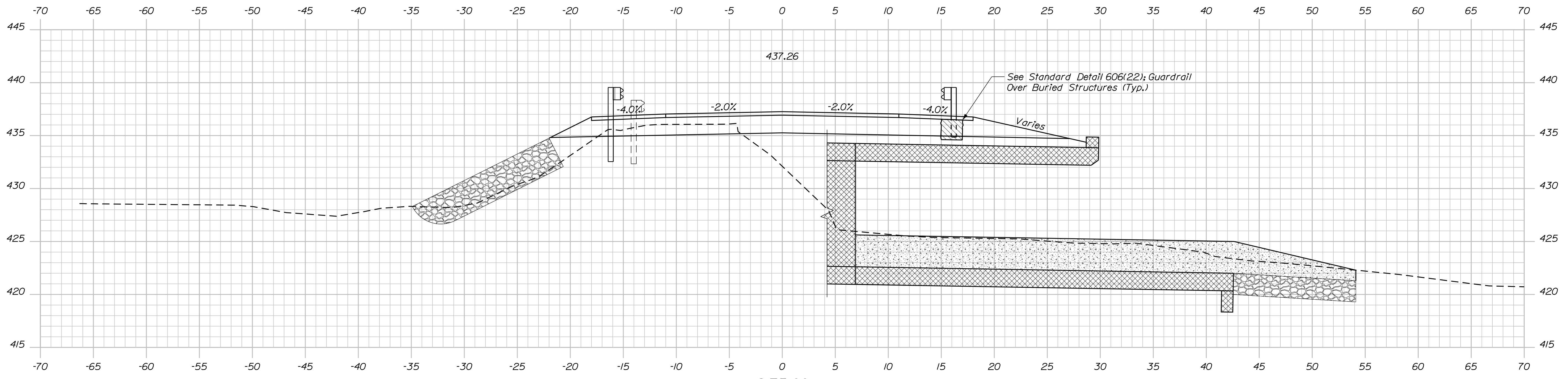

9+75.00

STATE OF MAINE
DEPARTMENT OF TRANSPORTATION
02366700
WIN
23567.00
BRIDGE NO. 3128
BRIDGE PLANS

PROJ. MANAGER	BY	DATE	SIGNATURE	P.E. NUMBER	DATE
DESIGN DETAILED	M. PARLIN	SEP 2021			
CHECKED/REVIEWED	B. BARTLETT				
DESIGN DETAILED	D. SHAW				
DESIGN DETAILED	R. MYERS				
REVISIONS 1					
REVISIONS 2					
REVISIONS 3					
REVISIONS 4					
FIELD CHANGES					

GREAT FARM BRIDGE
GREAT FARM BROOK
WALDO COUNTY
JACKSON
CROSS SECTIONS

SHEET NUMBER
12
OF 20

Date: 10/13/2021

Username: Richard.Mayer

Division: BRIDGE

Filename: ... \MSTA\013_XSECT_10+50.dgn

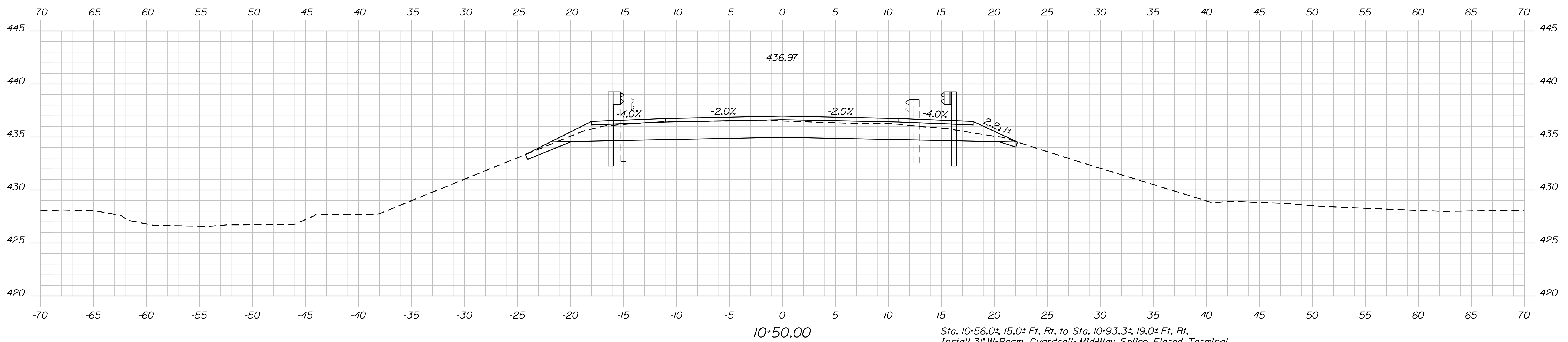
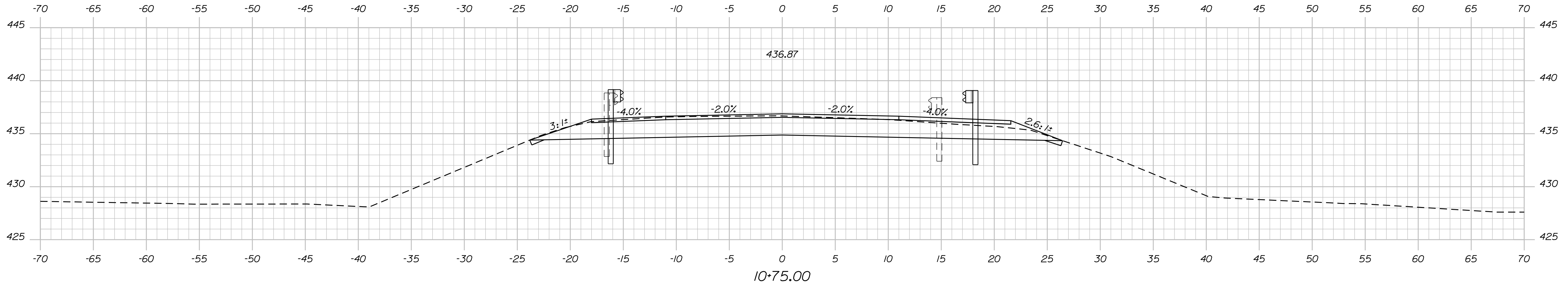

STATE OF MAINE
DEPARTMENT OF TRANSPORTATION

02356700

WIN

23567.00

BRIDGE NO. 3128
BRIDGE PLANS

SIGNATURE

P.E. NUMBER

DATE

PROJ. MANAGER	M. PARLIN	BY	DATE
DESIGN-DETAILED	B. BARTLETT	D. SHAW	SEP. 2021
CHECKED-REVIEWED	R. MYERS		
DESIGN-DETAILED			
DESIGN-DETAILED			
REVISIONS 1			
REVISIONS 2			
REVISIONS 3			
REVISIONS 4			
FIELD CHANGES			

GREAT FARM BRIDGE
GREAT FARM BROOK
WALDO COUNTY
JACKSON

CROSS SECTIONS

SHEET NUMBER

13

OF 20

Date: 10/13/2021

Username: Richard.Mayer

Division: BRIDGE

Filename: ... \MSTAO14_XSECT_10+93.dgn

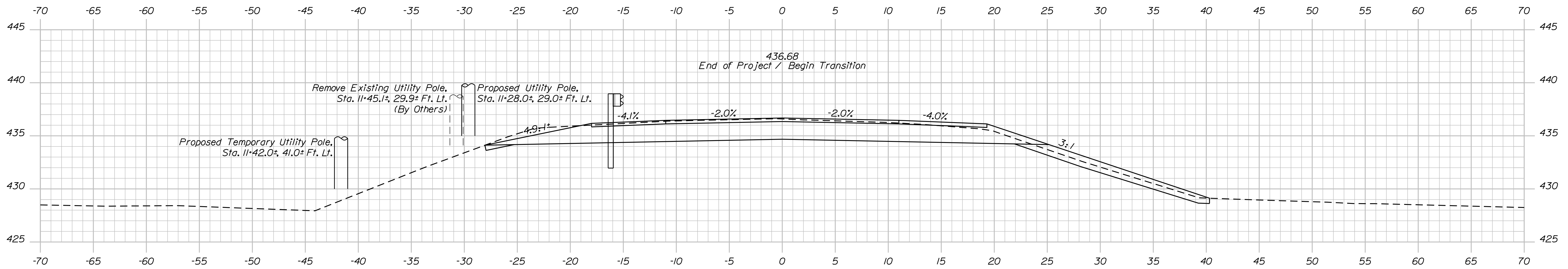

Sta. 11+30.4±, 15.0± Ft. Lt. to Sta. 11+67.8±, 19.0± Ft. Lt.
Install 31" W-Beam Guardrail; Mid-Way Splice Flared Terminal
11+25.00

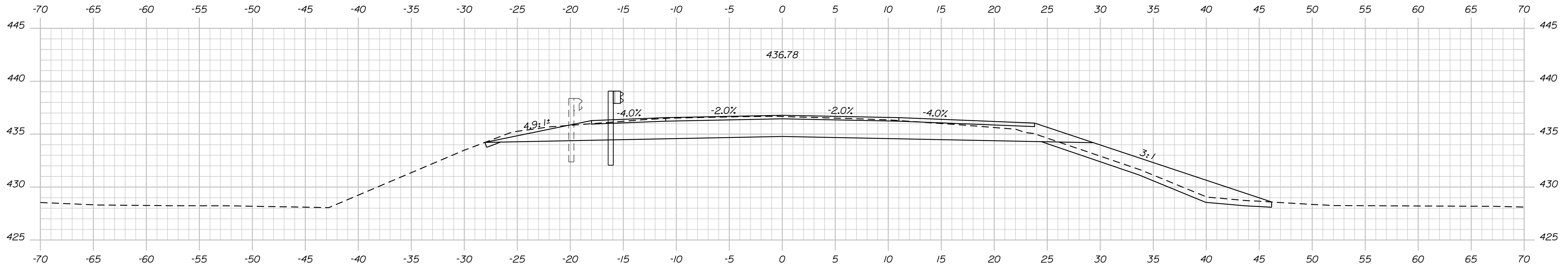

11+00.00

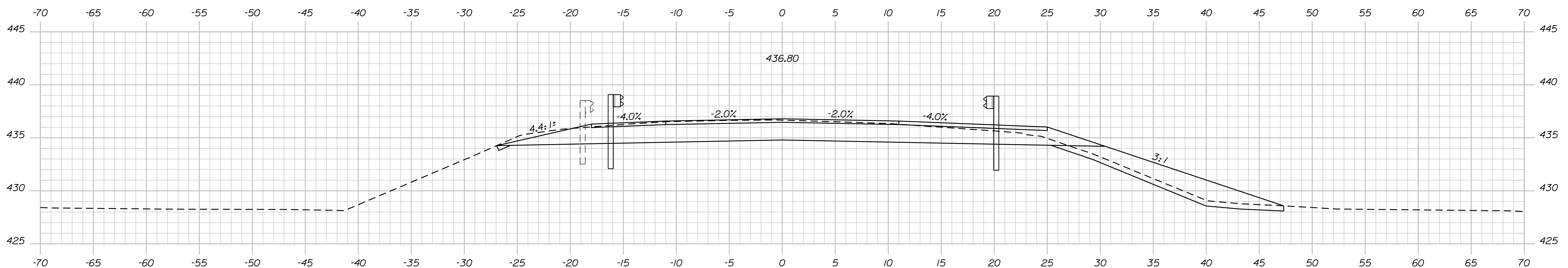

10+93.30

STATE OF MAINE DEPARTMENT OF TRANSPORTATION		02356700	
		WIN 23567.00	
		BRIDGE NO. 3128 BRIDGE PLANS	
	SIGNATURE		P.E. NUMBER
DATE	BY	M. PARLIN	DATE
SEP 2021	D. SHAW	R. MYERS	
DESIGN DETAILED	CHECKED/REVIEWED	DESIGN DETAILED	REVISIONS 1
B. BARTLETT	R. MYERS	DESIGN DETAILED	REVISIONS 2
REVISIONS 1	REVISIONS 3	REVISIONS 4	FIELD CHANGES
GREAT FARM BRIDGE GREAT FARM BROOK WALDO COUNTY		JACKSON	
CROSS SECTIONS		SHEET NUMBER	
14		OF 20	

Date: 10/13/2021

Username: Richard.Mayer

Division: BRIDGE

Filename: ... \MSTAO16_XSECT_11+50.dgn

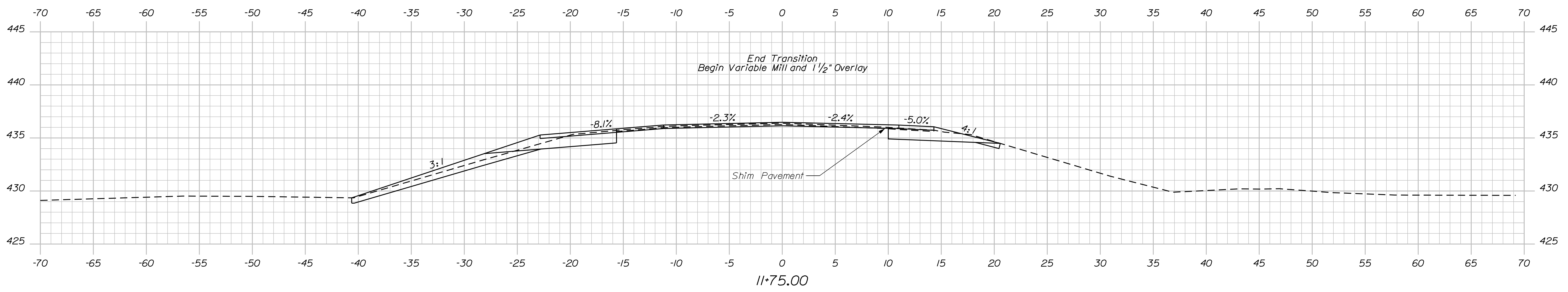
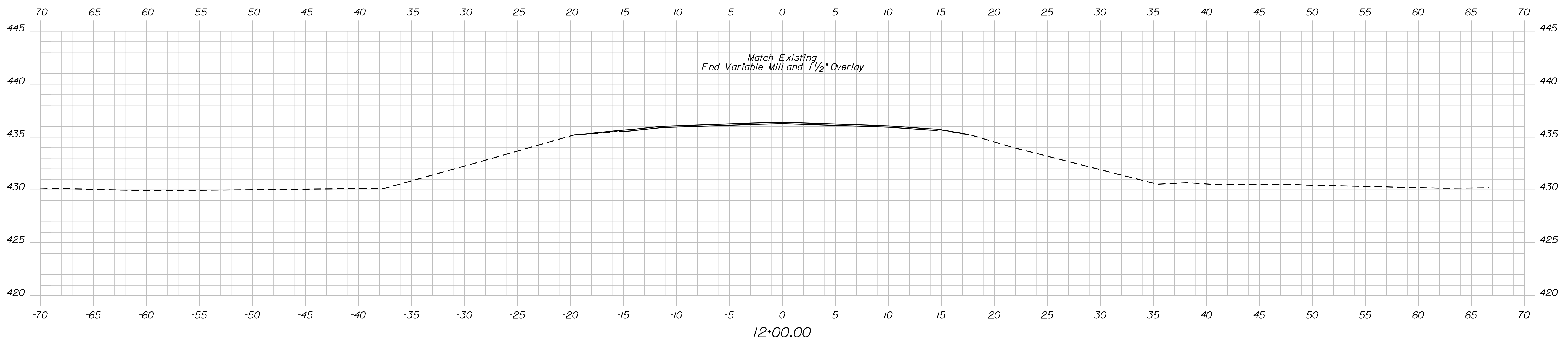
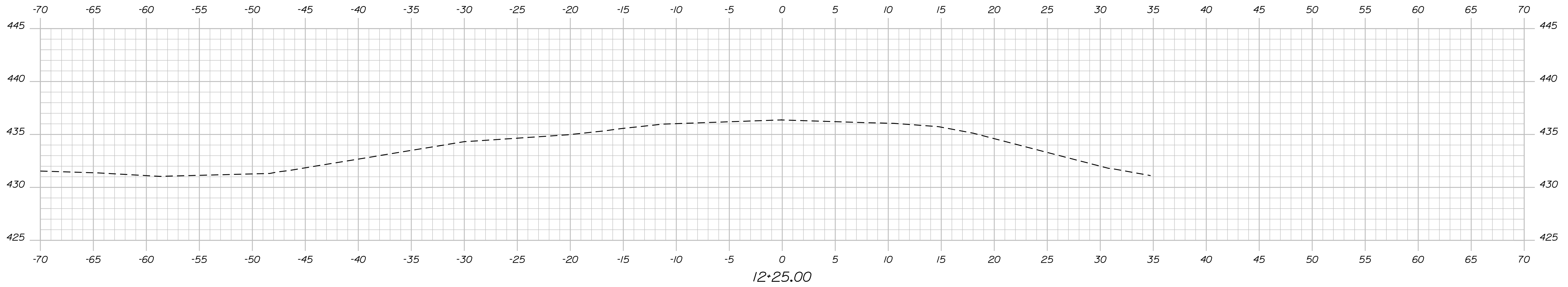

STATE OF MAINE
DEPARTMENT OF TRANSPORTATION
02366700
WIN
23567.00
BRIDGE NO. 3128
BRIDGE PLANS

PROJ. MANAGER	M. PARLIN	DATE	SEP 2021
DESIGN-DETAILED	B. BARTLETT	BY	D. SHAW
CHECKED-REVIEWED	R. MYERS	SIGNATURE	
DESIGN-DETAILED		P.E. NUMBER	
REVISIONS 1		DATE	
REVISIONS 2			
REVISIONS 3			
REVISIONS 4			
FIELD CHANGES			

GREAT FARM BRIDGE
GREAT FARM BROOK
WALDO COUNTY
JACKSON

CROSS SECTIONS

SHEET NUMBER
16
OF 20

Date: 10/13/2021

Username: Richard.Mayer

Division: BRIDGE

Filename: ... \BRIDGE\MSTA\017_Btypical.dgn

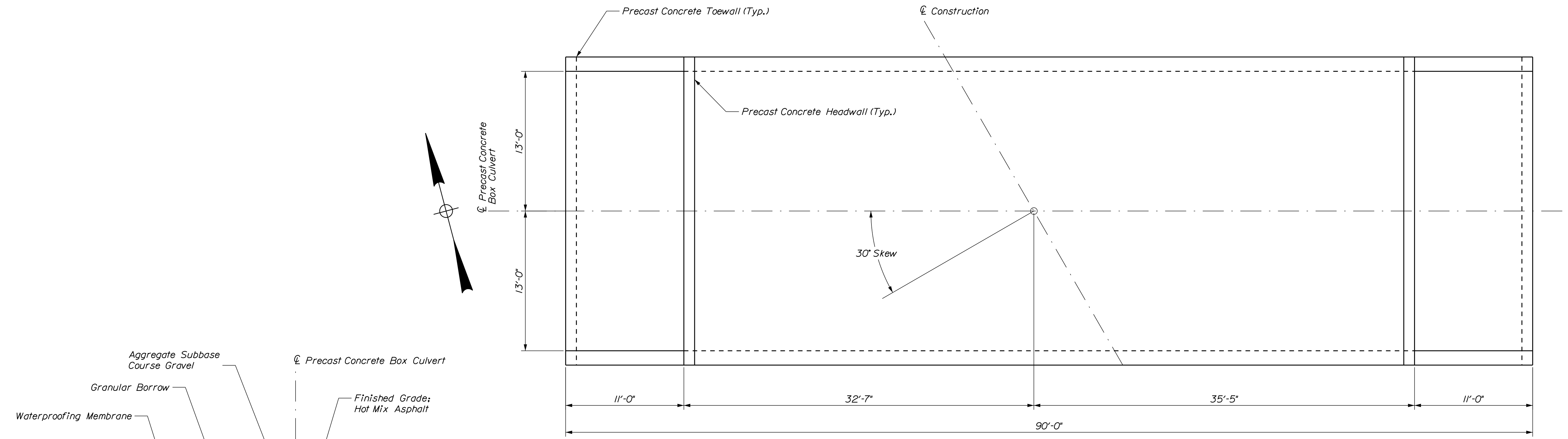

PRECAST CONCRETE BOX PLAN

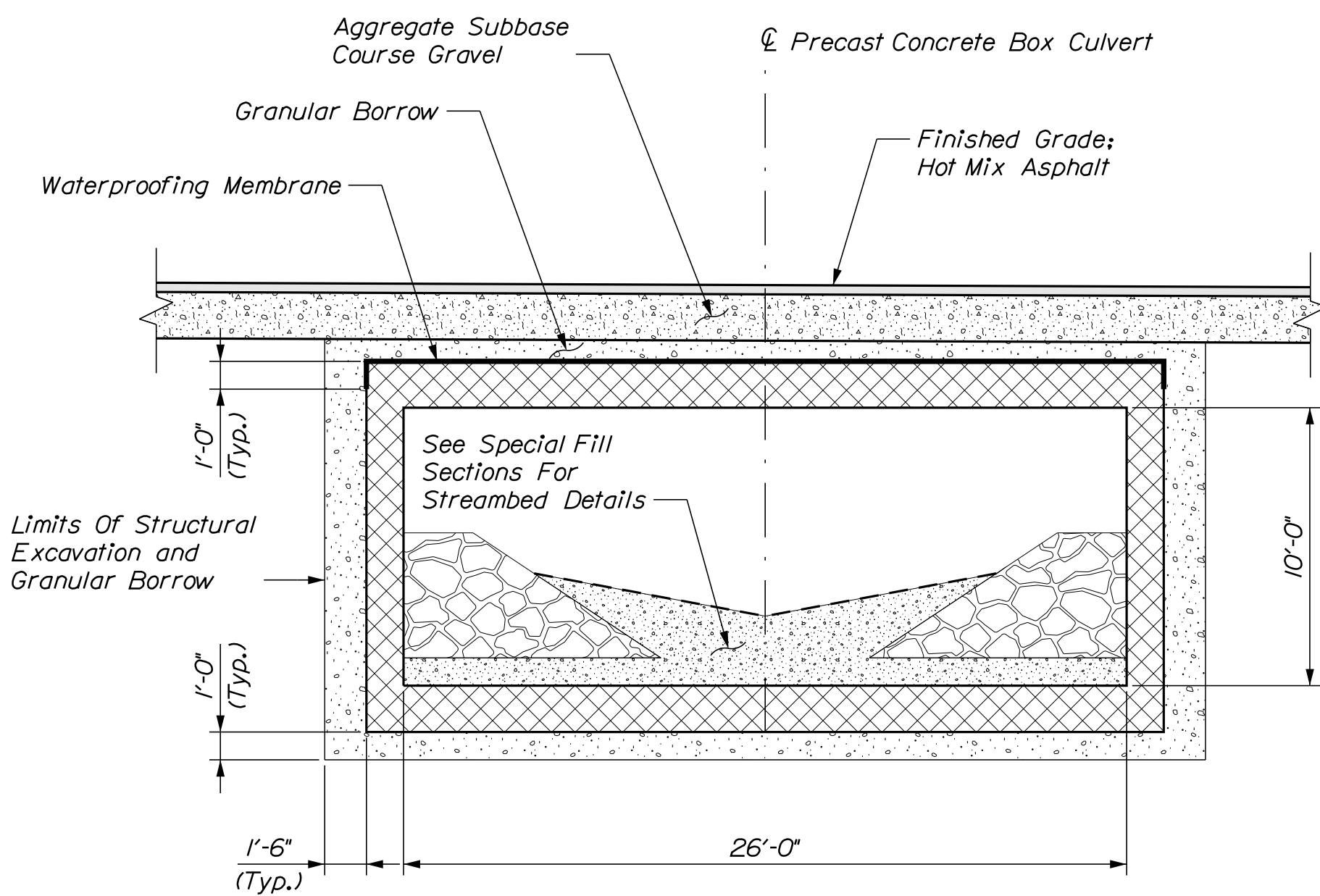

TYPICAL PRECAST CONCRETE BOX TRANSVERSE SECTION

PRECAST CONCRETE BOX NOTES

1. The precast units shall be designed to carry construction loadings with a minimum fill cover of 18 inches over the top of the units.
2. The construction, handling, and assembly of the precast units shall be in accordance with Special Provisions Section 534, Precast Structural Concrete, and with the manufacturer's specifications as applicable.
3. Install standard membrane waterproofing over the top and to 12 inches down the exterior sides of the precasts.

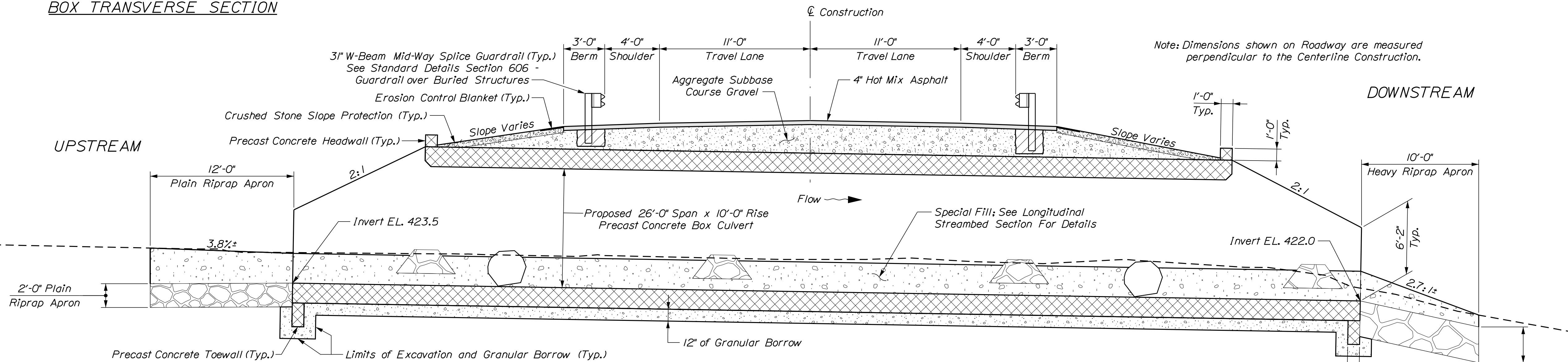

LONGITUDINAL SECTION AT CENTERLINE OF CONCRETE BOX

STATE OF MAINE
DEPARTMENT OF TRANSPORTATION
02356700
WIN
23567.00
BRIDGE NO. 3128
BRIDGE PLANS

PROJ. MANAGER
CHECKED-REVIEWED
DESIGN-DETAILED
DESIGN-DETAILED
REVISIONS 1
REVISIONS 2
REVISIONS 3
FIELD CHANGES

DATE
BY
M. PARLIN
D. SHAW
R. MYERS

GREAT FARM BRIDGE
GREAT FARM BROOK
WALDO COUNTY
JACKSON
PRECAST CONCRETE BOX
CULVERT DETAILS

SHEET NUMBER
17
OF 20

Date: 10/13/2021

Username: Richard.Mayer

Division: BRIDGE

Filename: ... \MSTA\018_StreambedPlan.dgn

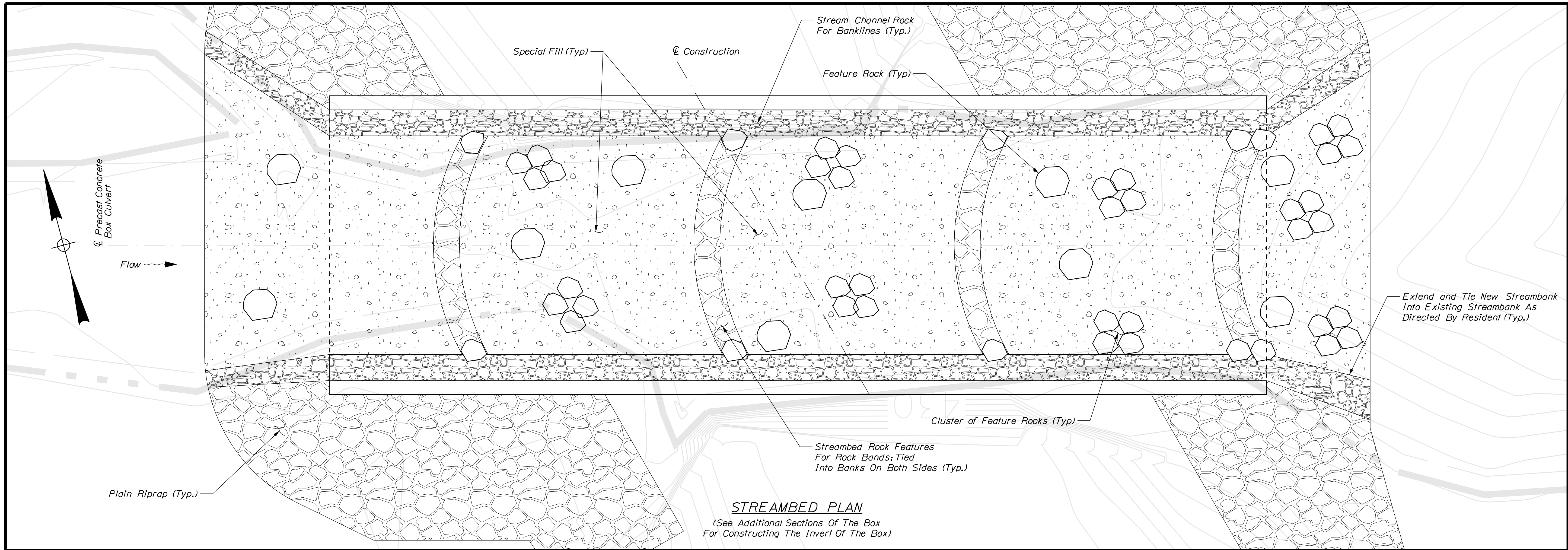

STREAMBED PLAN
 (See Additional Sections Of The Box For Constructing The Invert Of The Box)

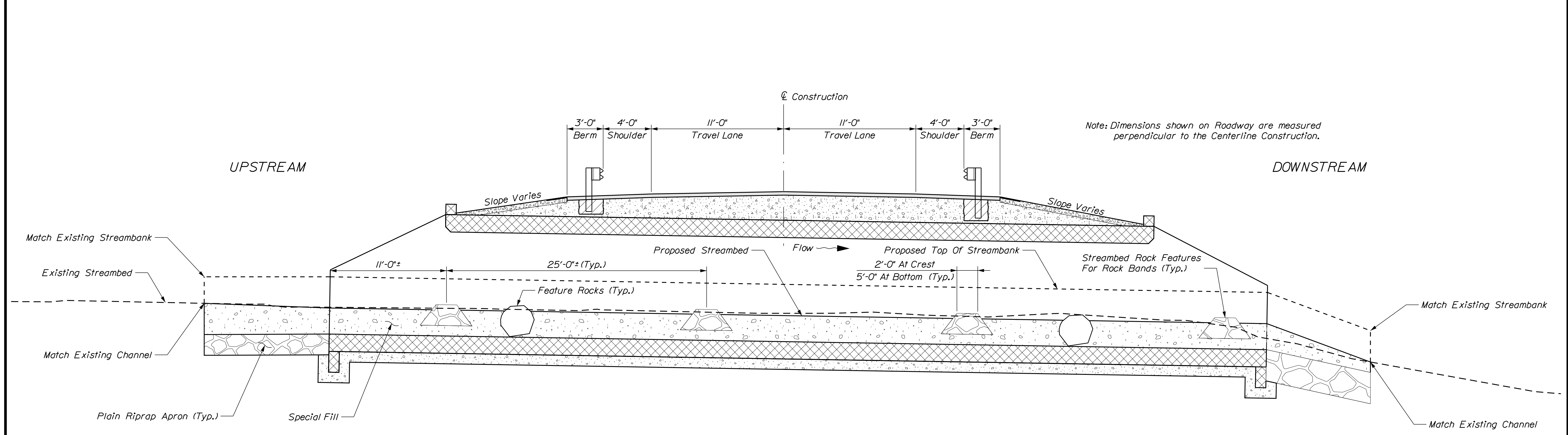

LONGITUDINAL STREAMBED SECTION

Note: Dimensions shown on Roadway are measured perpendicular to the Centerline Construction.

STATE OF MAINE
 DEPARTMENT OF TRANSPORTATION
 02366700
 WIN 23567.00
 BRIDGE NO. 3128
 BRIDGE PLANS

PROJ. MANAGER	M. PARLIN	DATE	SEP 2021
DESIGN DETAILED	B. BARTLETT	BY	D. SHAW
CHECKED/REVIEWED	R. MYERS	DESIGN REVIEWED	R. MYERS
DESIGN DETAILED		DESIGN DETAILED	
REVISIONS 1		SIGNATURE	
REVISIONS 2		P.E. NUMBER	
REVISIONS 3		DATE	
REVISIONS 4			
FIELD CHANGES			

GREAT FARM BRIDGE
 GREAT FARM BROOK
 WALDO COUNTY
 JACKSON

STREAMBED PLAN AND LONGITUDINAL SECTION

SHEET NUMBER
18
 OF 20

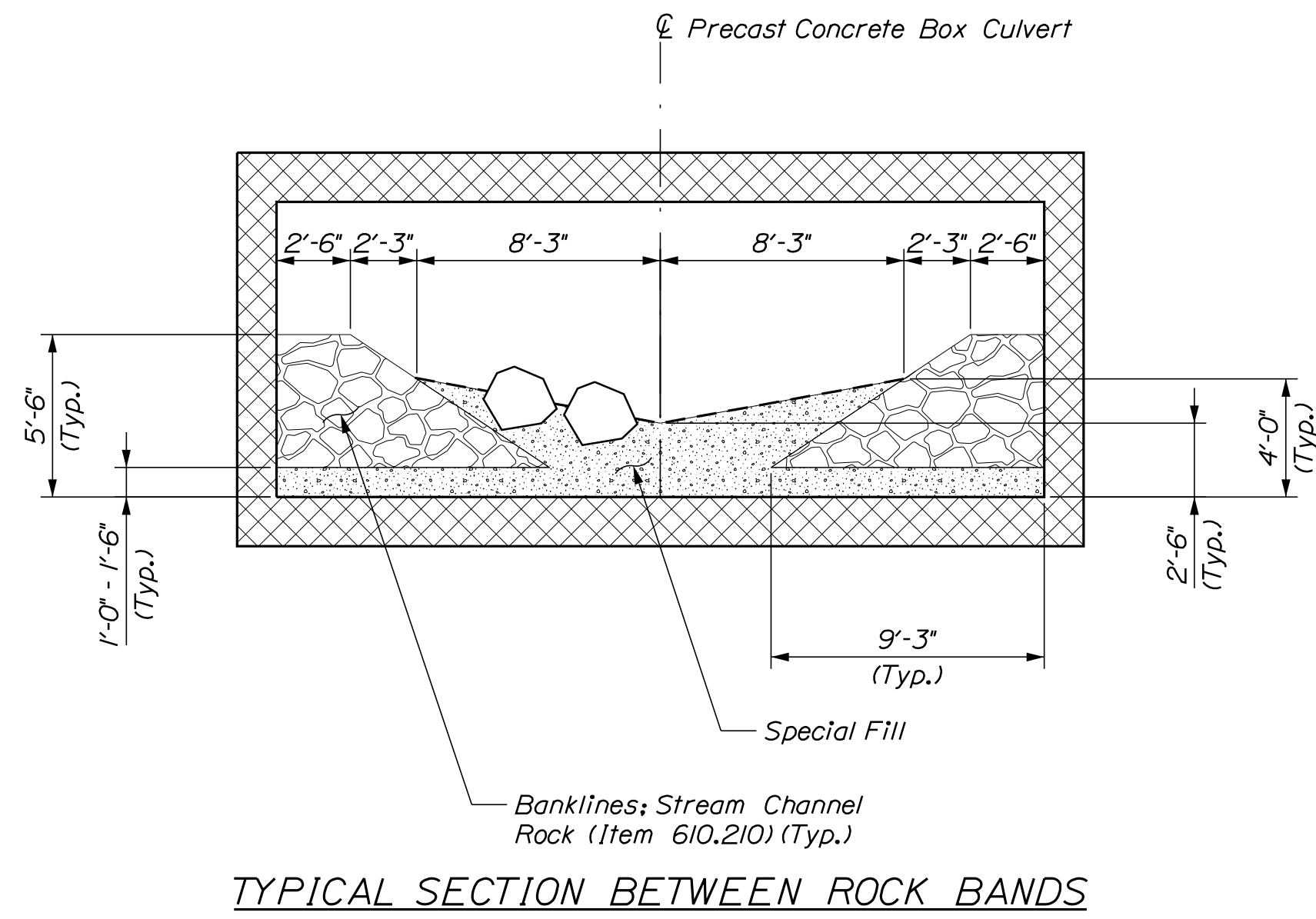

TYPICAL SECTION BETWEEN ROCK BANDS

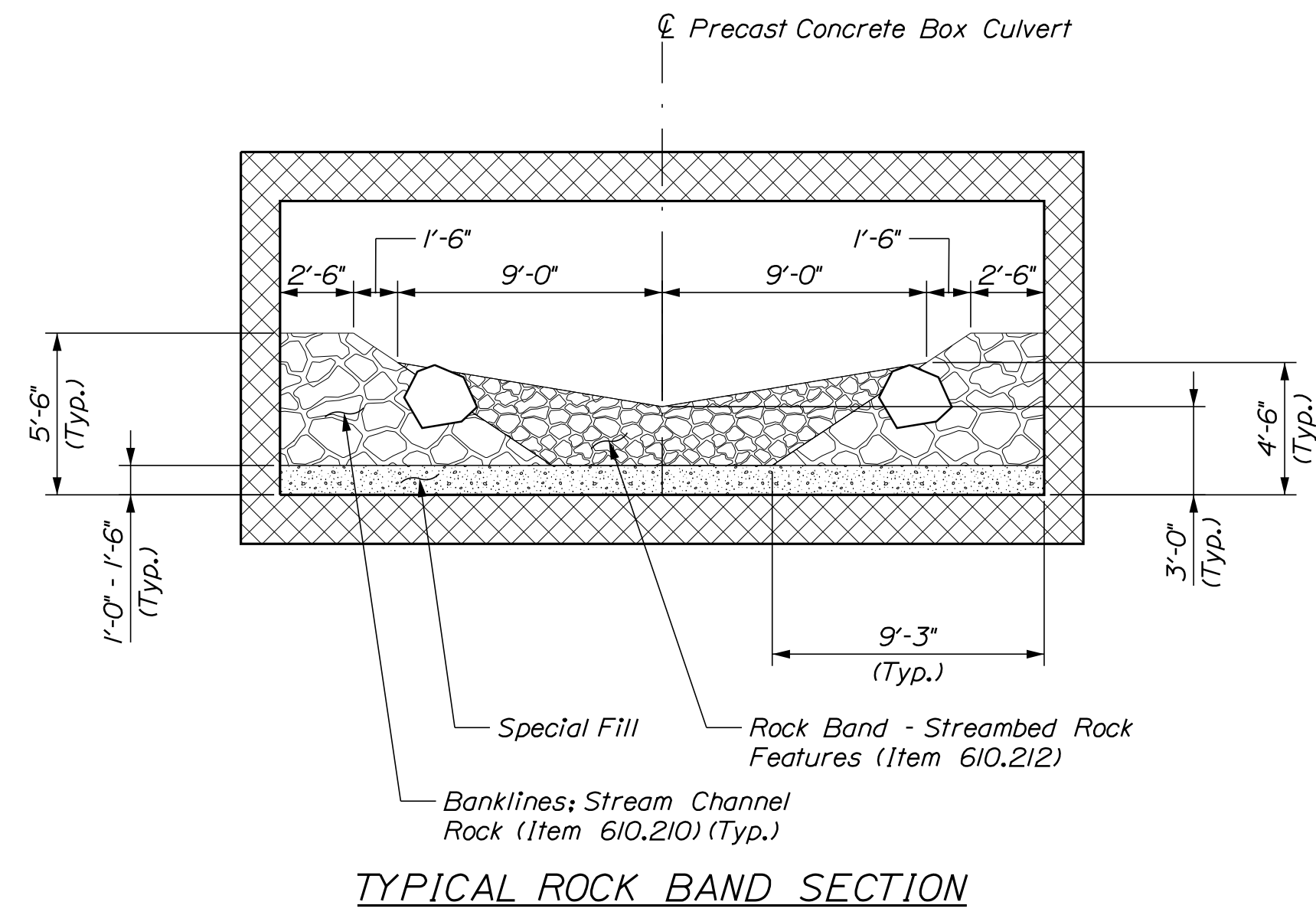

TYPICAL ROCK BAND SECTION

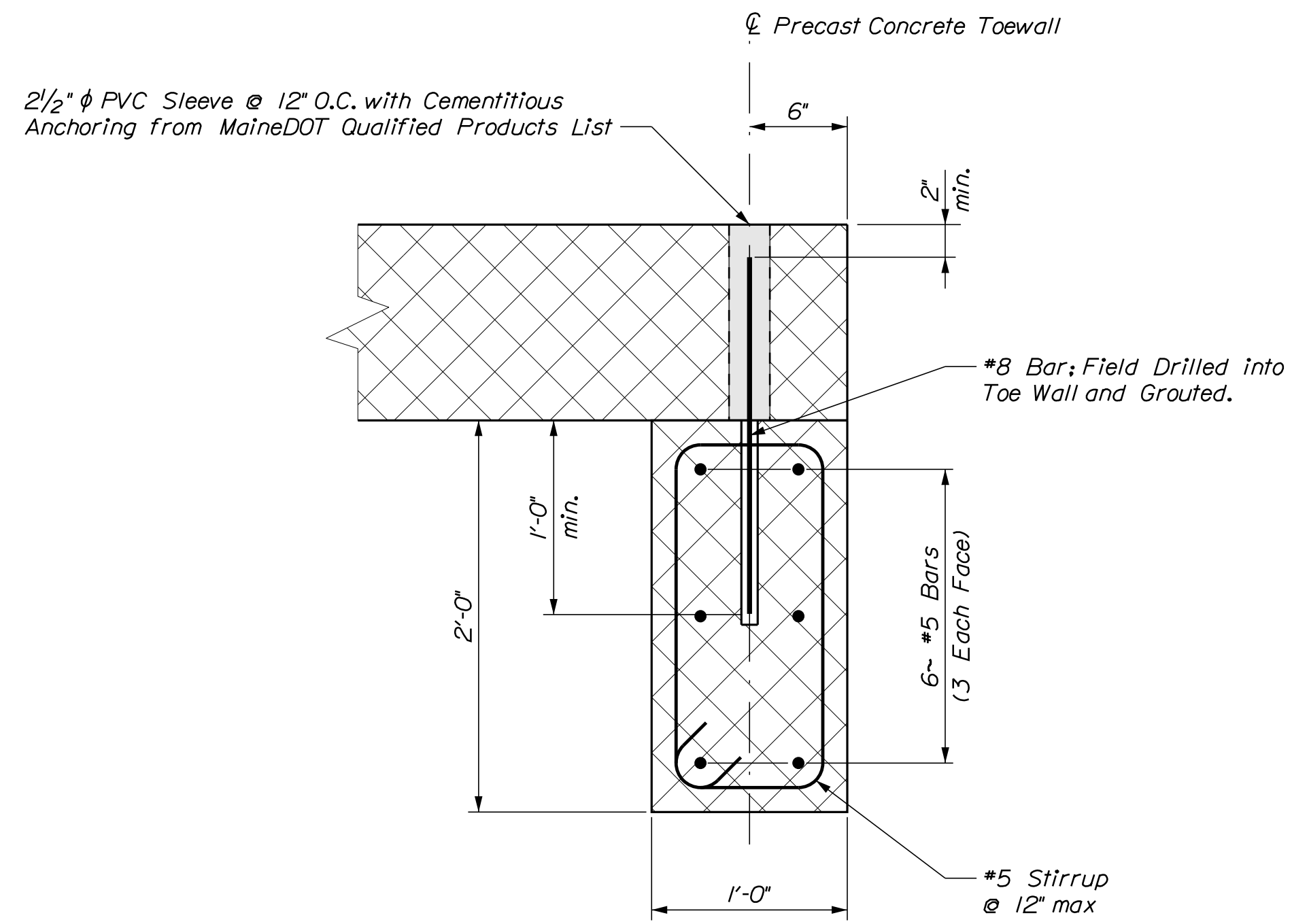

PRECAST CONCRETE TOEWALL DETAIL

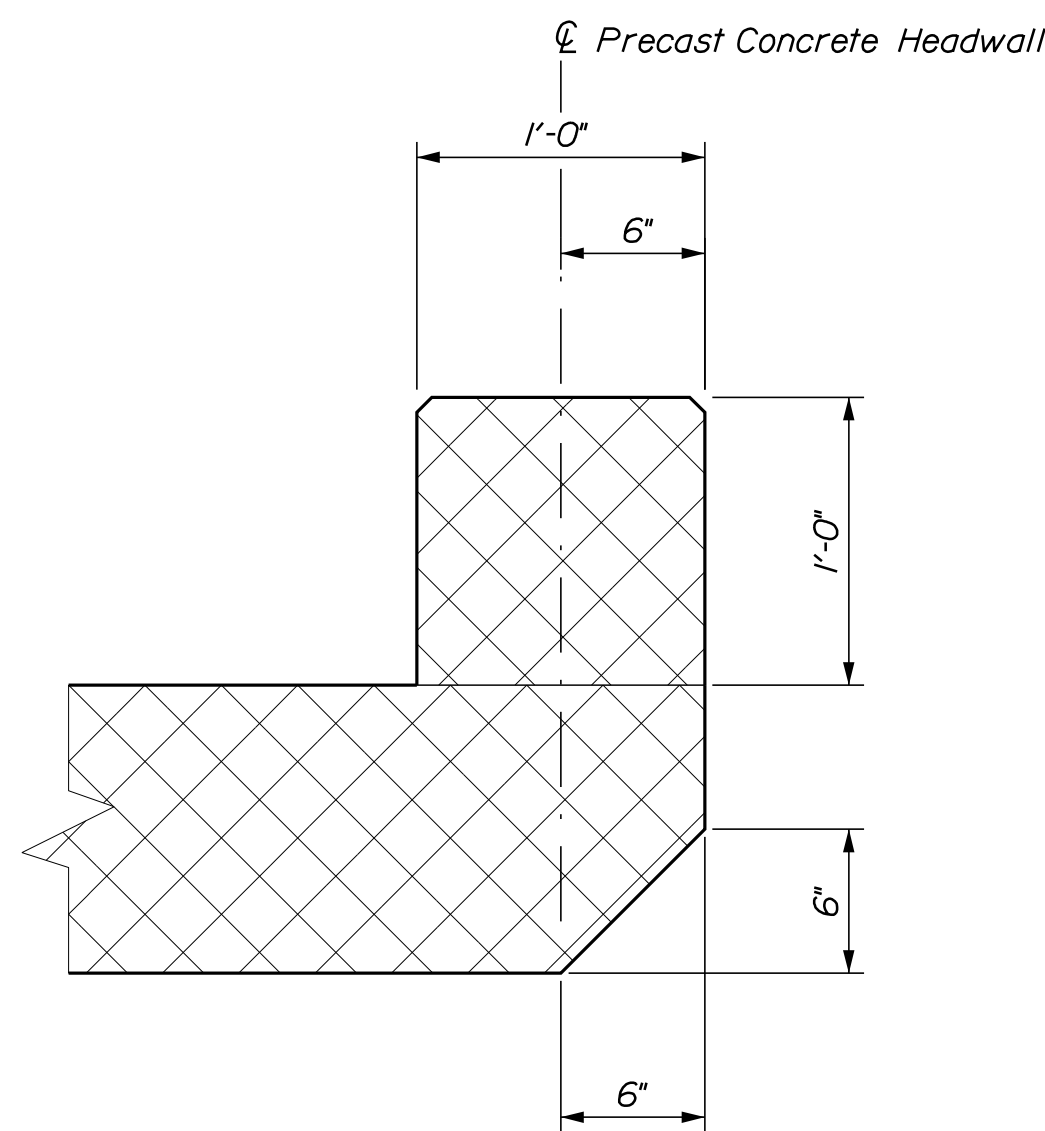

PRECAST CONCRETE HEADWALL DETAIL

PROJ. MANAGER	DATE
CHECKED/REVIEWED	SEP. 2021
DESIGN/REVIEWED	
DESIGN/REVIEWED	
REVISIONS 1	
REVISIONS 2	
REVISIONS 3	
REVISIONS 4	
FIELD CHANGES	

BY	SIGNATURE
D. SHAW	
R. MYERS	
	P.E. NUMBER
	DATE

GREAT FARM BRIDGE
GREAT FARM BROOK
WALDO COUNTY
JACKSON
TYPICAL SECTIONS

SHEET NUMBER

19

OF 20

Date: 10/13/2021

Username: Richard.Moyer

Division: BRIDGE

Filename: ... \00\ROW\MSTA\020_RWPLAN1.dgn

Town, County, State	_____
Approx. Property Lines	P.L. _____
Existing Right of Way	_____
Limits of Wrought Portion	L.O.W.P. _____
Control Of Access	C.O.A. _____
New Right of Way	_____
New Easement	_____
New Temporary Rights	_____
New R/W Within Existing R/W	_____

New R/W	Along Existing R/W		
Building	Clearing Limit Line		
Trees	Conifer	Deciduous	
Tree Line	Bush Line		
Water Edge	Ledge	Rock/Boulder	Flag Pole
Fence	CHAIN LINK	BARB WIRE	STOCKADE
Sign	Well	Mallbox	

PLAN LEGEND	
Existing	Proposed
Sanitary Sewer	_____
Telephone Line	_____
Electric Line	_____
Water Line	_____
Underdrain Line	_____
Gas Line	_____
Guardrail	_____
Culvert	_____
Traveled Way	_____
Ditch	_____
Catch Basin	_____
Manhole	_____
Sewer Manhole	_____
Utility Pole	_____
Fire Hydrant	_____
Curbing	_____

Cut Line	_____
Stonewall	_____
Baseline	_____
Monument	_____
Iron Rod Found	_____
Replacement Pin Set	_____
Fill Line	_____
Retaining Wall	_____
Traverse Point	_____
Pipe Found	_____

THIS PLAN WAS PREPARED IN CONNECTION WITH THE DEPARTMENT'S ACQUISITION OF REAL PROPERTY FOR TRANSPORTATION PURPOSES. IT CANNOT BE USED TO ESTABLISH LEGAL BOUNDARIES BETWEEN ADJACENT PROPERTY OWNERS.

STATE OF MAINE
REGISTRY OF DEEDS

COUNTY _____
RECEIVED _____,
at _____ h _____ m _____ M and
recorded in Plan Bk _____, Pg. _____
Attest: _____ REGISTER

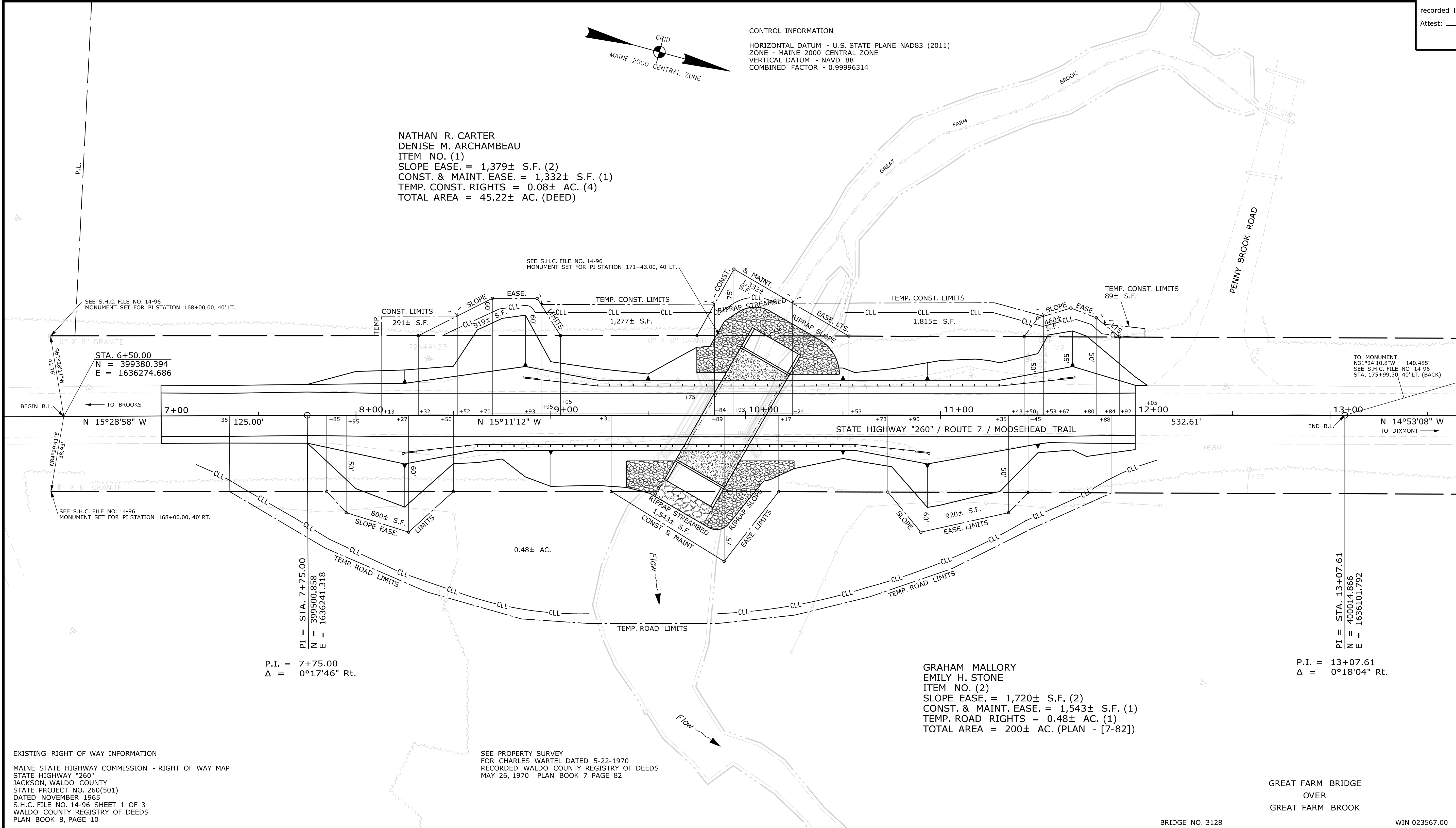

TECH	CHECKED
D.W.B. <td>G.L.L.</td>	G.L.L.
ITEM	PLAN
EXISTING CONDITION	PLAN
FINAL RIGHT OF WAY	PLAN
AREAS	AREAS
STATE OF MAINE DEPARTMENT OF TRANSPORTATION 16 STATE HOUSE STATION - AUGUSTA, ME 04333-0016 - 207-024-3460 JACKSON RIGHT OF WAY MAP	
SHEET NUMBER 20 OF 20	

REVISIONS			PLAN FILED IN PLAN BOOK				PAGE COUNTY RECORD						
NO.	DATE	DESCRIPTION	BY	NO.	GRANTOR	INSTRUMENT	DATE	BOOK	PAGE	COND.	DATE	BOOK	PAGE

BRUCE A. VAN NOTE
COMMISSIONER
JOYCE NOEL TAYLOR
CHIEF ENGINEER

DATE _____

To the best of my knowledge and belief, this map constitutes an accurate graphical representation of the Highway Right of Way lines shown hereon. Other boundary lines, including lines between abutters, are approximate and for general reference only. See sheet 1 of this plan set for reference coordinates.

STATE HIGHWAY "260"
ROUTE 7 / MOOSEHEAD TRAIL
JACKSON WALDO COUNTY
FEDERAL AID PROJECT NO. 2356700

APRIL 2021
SCALE 1" = 25'

RIGHT-OF-WAY MAP
SHEET 1 OF 1

D.O.T. FILE NO. 14-221