

STATE OF MAINE DEPARTMENT OF TRANSPORTATION



ATHENS SOMERSET COUNTY "BRIGHTON ROAD" ROUTE 151

STATE PROJECT NO. 023513.00
PROJECT LENGTH : 0.02 MILES
BRIDGE NO. 6579

PLAN LEGEND	
Town, County, State	Centerline-Existing
Property Lines	Centerline-Proposed
R/W Lines-Existing	Travelway-Existing
R/W Lines-Proposed	Travelway-Proposed
Culvert-Existing	Railroad
Culvert Proposed	Catch Basins
Curbing Existing	Manholes
Curbing Proposed	Proposed Underdrain
Type 1	Proposed Ditch
Type 3	Existing Ditch
Type 5	Utility Poles
Outline of Bodies of Water	Fire Hydrants
Boring	Existing Water Line
Pavement Core	Existing San. Sewer
Test Pit	Existing San. Sewer Manhole
Probe	Guardrail-Existing
	Guardrail-Proposed
	Guardrail-Cable, Other
	Exposed Bedrock
	Buildings
	Trees
	Tree Line
	Clearing Limit Line

INDEX OF SHEETS	
Description	Sheet No.
Title Sheet	1
General Notes, Construction Notes & Typical Section	2
Boring Location Plan and Interpretive Subsurface Profile with Boring Logs	3
Plan / Profile	4
Culvert Details	5
Streambed Details	6
Cross - Sections	7-9
Right of Way Map	10

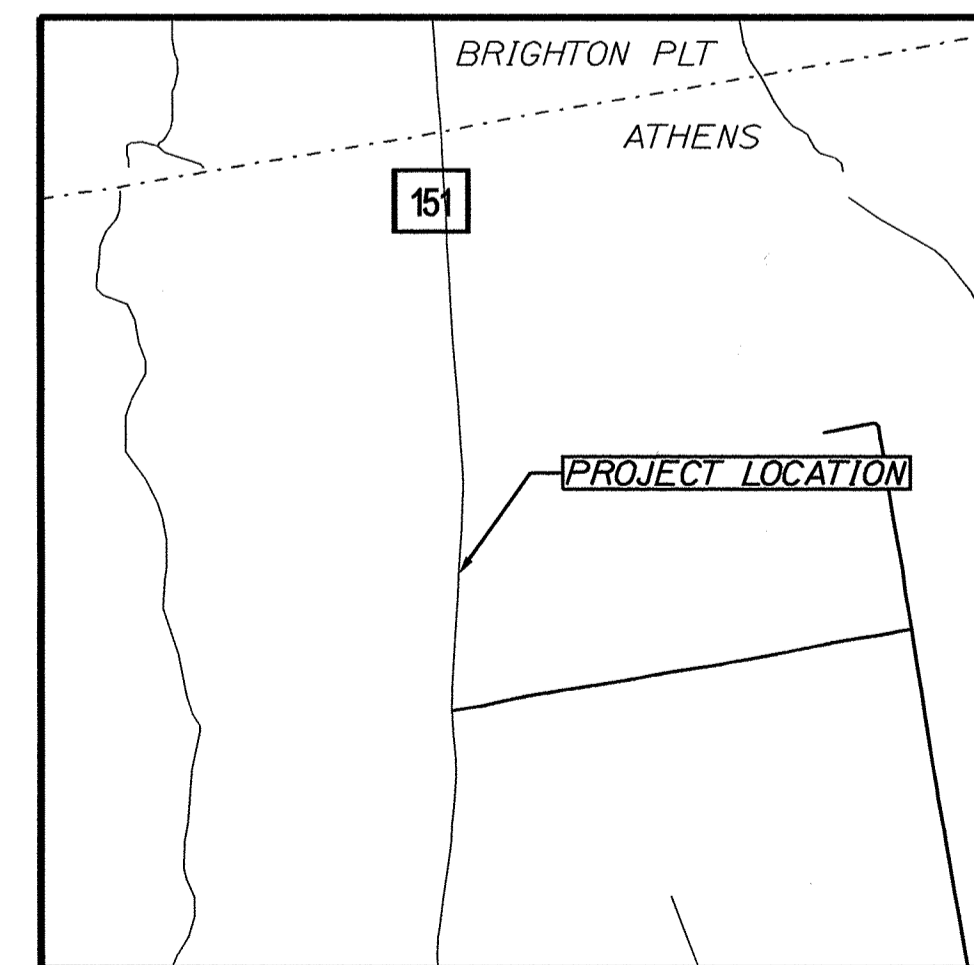
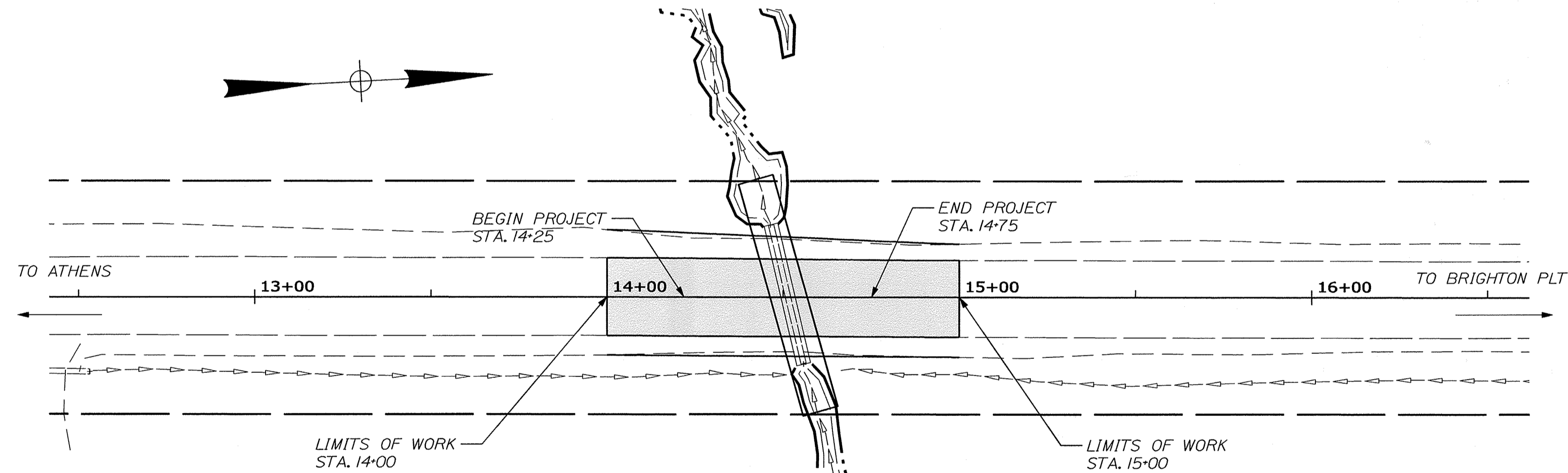

Scale in Miles
0 1/2 1
LOCATION MAP

TRAFFIC DATA	
Current (2018) AADT	350
Future (2030) AADT	390
DHV - % of AADT	11%
Design Hour Volume	43
% Heavy Trucks (AADT)	17%
Directional Distribution (DHV)	54%
Design Speed (mph)	50
Functional Class	Major Collector
Corridor Priority	4

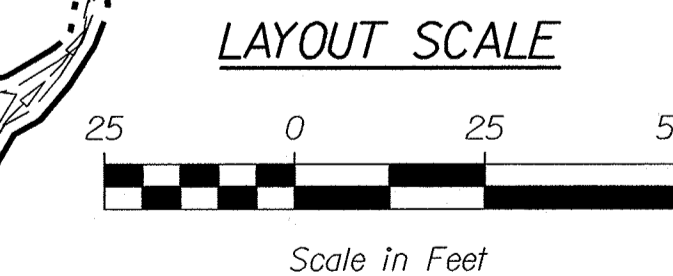

PROJECT LOCATION:	0.37 of a mile north of the junction of Route 151 and Leavett Road.
PROGRAM AREA:	Highway Program
SCOPE OF WORK:	Rehabilitation Large Culvert Replacement

STATE OF MAINE DEPARTMENT OF TRANSPORTATION	DATE
APPROVED	6/4/18
COMMISSIONER	6-4-18
CHIEF ENGINEER	6-4-18

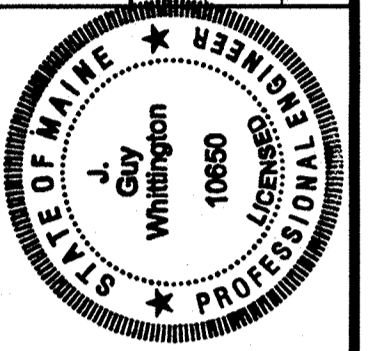

Signature	10650	DATE
PROJECT MANAGER	DESIGNER	CONTRACTOR
DESIGNER	CONTRACTOR	DATE

PROJECT INFORMATION	
PROGRAM	HIGHWAY PROGRAM
PROJECT MANAGER	J.S. WHITTINGTON
DESIGNER	L. KANDIKO
PROJECT RESIDENT	
CONTRACTOR	
PROJECT COMPLETION DATE	

ATHENS
ROUTE 151
TITLE SHEET

SHEET NUMBER
1
OF 10

WIN 23513.00 023513.00

GERNERAL NOTES

CONSTRUCTION NOTES

1. ALL CLEARING SHALL BE CONSIDERED INCIDENTAL TO THE CONTRACT AND NO SEPARATE PAYMENT WILL BE MADE. THE ACTUAL LINES FOR CLEARING SHALL BE ESTABLISHED IN THE FIELD BY THE CONTRACTOR AS INDICATED ON THE PLANS AND APPROVED BY THE RESIDENT.
2. ALL INSLOPE AND DITCHES IN CUT AREAS SHALL BE GRADED AS SHOWN ON THE TYPICALS OR FLATTER, OR AS DIRECTED BY THE RESIDENT.
3. ALL WASTE MATERIAL NOT USED ON THE PROJECT SHALL BE DISPOSED OF OFF THE PROJECT IN ACCEPTABLE WASTE AREAS REVIEWED BY THE RESIDENT. GRADING, SEEDING AND MULCHING OF WASTE AREAS SHALL BE CONSIDERED INCIDENTAL.
4. DIRTY BORROW HAS BEEN ESTIMATED FOR ALL DISTURBED SLOPE AREAS OTHER THAN LAWN AREAS. ACTUAL PLACEMENT OF THE DIRTY BORROW SHALL BE AS NOTED ON THE PLANS OR DESIGNATED BY THE RESIDENT.
5. DIRTY BORROW SHALL BE PLACED TO A NOMINAL DEPTH OF 2 INCHES UNLESS OTHERWISE NOTED OR DIRECTED.
6. ANY DAMAGE TO THE SLOPES CAUSED BY THE CONTRACTOR'S EQUIPMENT, PERSONNEL, OR OPERATION SHALL BE REPAIRED TO THE SATISFACTION OF THE RESIDENT. ALL WORK, EQUIPMENT, AND MATERIALS REQUIRED TO MAKE REPAIRS SHALL BE AT THE CONTRACTOR'S EXPENSE.
7. THE PROJECT GEOTECHNICAL REPORT TITLED "GEOTECHNICAL DESIGN REPORT FOR THE CONSTRUCTION OF: BRIGHTON ROAD BRIDGE, ROUTE 151, ATHENS, MAINE", SOILS REPORT 2018-12, DATE CAN BE ACCESSED AT THE MAINEDOT WEBSITE [HTTP://WWW.MAINE.GOV/MDOT/CONTRACTORS/](http://www.maine.gov/mdot/contractors/).
8. GEOTECHNICAL INFORMATION FURNISHED OR REFERRED TO IN THE BID DOCUMENTS IS FOR THE USE OF THE BIDDERS. NO ASSURANCE IS GIVEN THAT THE INFORMATION OR INTERPRETATIONS WILL BE REPRESENTATIVE OF THE ACTUAL SUBSURFACE CONDITIONS THROUGHOUT THE CONSTRUCTION SITE. MAINEDOT WILL NOT BE RESPONSIBLE FOR ANY INTERPRETATIONS OR CONCLUSION DRAWN FROM THE GEOTECHNICAL INFORMATION. THE BORING LOGS PROVIDED IN THE BID DOCUMENTS (IF ANY) PRESENT FACTUAL AND INTERPRETIVE SUBSURFACE INFORMATION COLLECTED AT DISCRETE LOCATIONS. DATA PROVIDED MAY NOT BE REPRESENTATIVE OF THE SUBSURFACE CONDITIONS BETWEEN BORING LOCATIONS.
9. AREAS REQUIRING FILL ON THE PROJECT WILL COME FROM SUITABLE EXCAVATION FROM EXCAVATION, DITCH AND INSLOPE OR EQUIPMENT RENTAL AREAS.
10. NO SEPARATE PAYMENT FOR SUPERINTENDENT OR FOREMAN WILL BE MADE FOR THE SUPERVISION OF EQUIPMENT AND LAYOUT OF WORK BEING PAID FOR UNDER THE EQUIPMENT RENTAL ITEMS.

1. JOINTS BETWEEN EXISTING AND PROPOSED PAVEMENT SHALL BE SAW CUT. PAYMENT WILL BE CONSIDERED INCIDENTAL TO THE PAVING ITEMS.
2. DREDGE MATERIAL HAS BEEN CALCULATED TO BE APPROXIMATELY 120CY. THIS IS INCLUDED FOR ESTIMATION PURPOSES ONLY. THE CONTRACTOR SHALL REUSE THIS MATERIAL ON SITE. IT MAY BE USED IN THE SPECIAL FILL PROVIDED IT MEETS THE REQUIREMENTS OF SPECIAL PROVISION 203.33 - SPECIAL FILL. IF THE MATERIAL IS NOT SUITABLE FOR THIS USE, IT MAY BE USED IN PLACE OF LOAM AS DIRECTED BY THE RESIDENT. NO ADDITIONAL PAYMENT WILL BE MADE FOR THIS WORK.
- 534.71 PRECAST CONCRETE BOX SECTION
 - CONSTRUCTED IN ACCORDANCE WITH SECTION 534.
 - THE FOLLOWING SHALL BE CONSIDERED INCIDENTAL TO THIS ITEM:
 - EXCAVATION BELOW SUBGRADE
 - REMOVAL OF EXISTING DRAINAGE

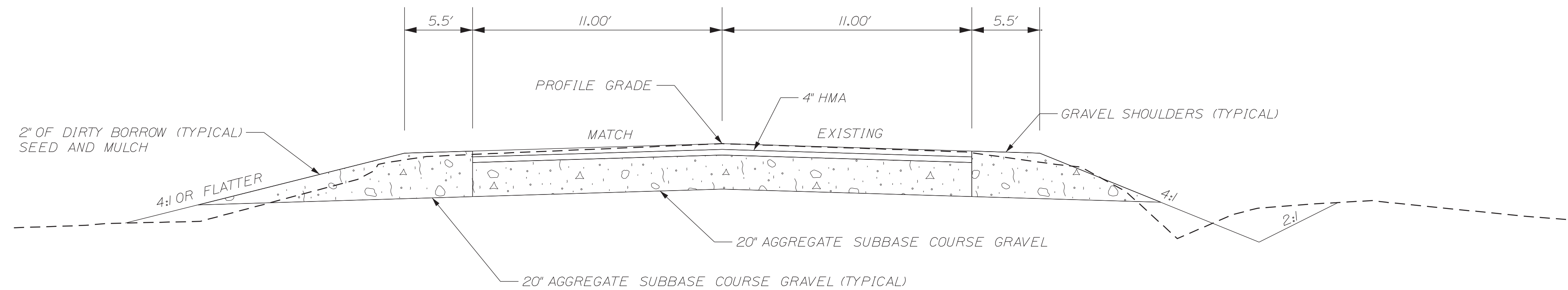

TYPICAL SECTION
NOT TO SCALE

STATE OF MAINE
DEPARTMENT OF TRANSPORTATION
02513.00
WIN
23513.00
HIGHWAY PLANS

PROJ. MANAGER	G. WHITTINGTON	BY	DATE
DESIGN DETAILED	L. KANDIKO		
CHECKED/REVIEWED			SIGNATURE
DESIGNS DETAILED			P.E. NUMBER
REVISIONS 1			DATE
REVISIONS 2			
REVISIONS 3			
REVISIONS 4			
FIELD CHANGES			

ATHENS
ROUTE 151
GENERAL NOTES, CONSTRUCTION NOTES & TYPICAL SECTION

SHEET NUMBER
2
OF 10

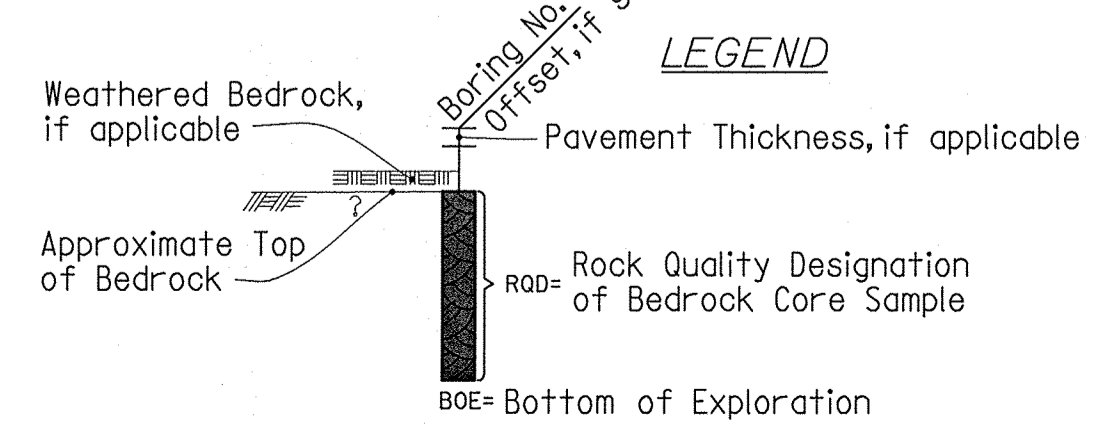
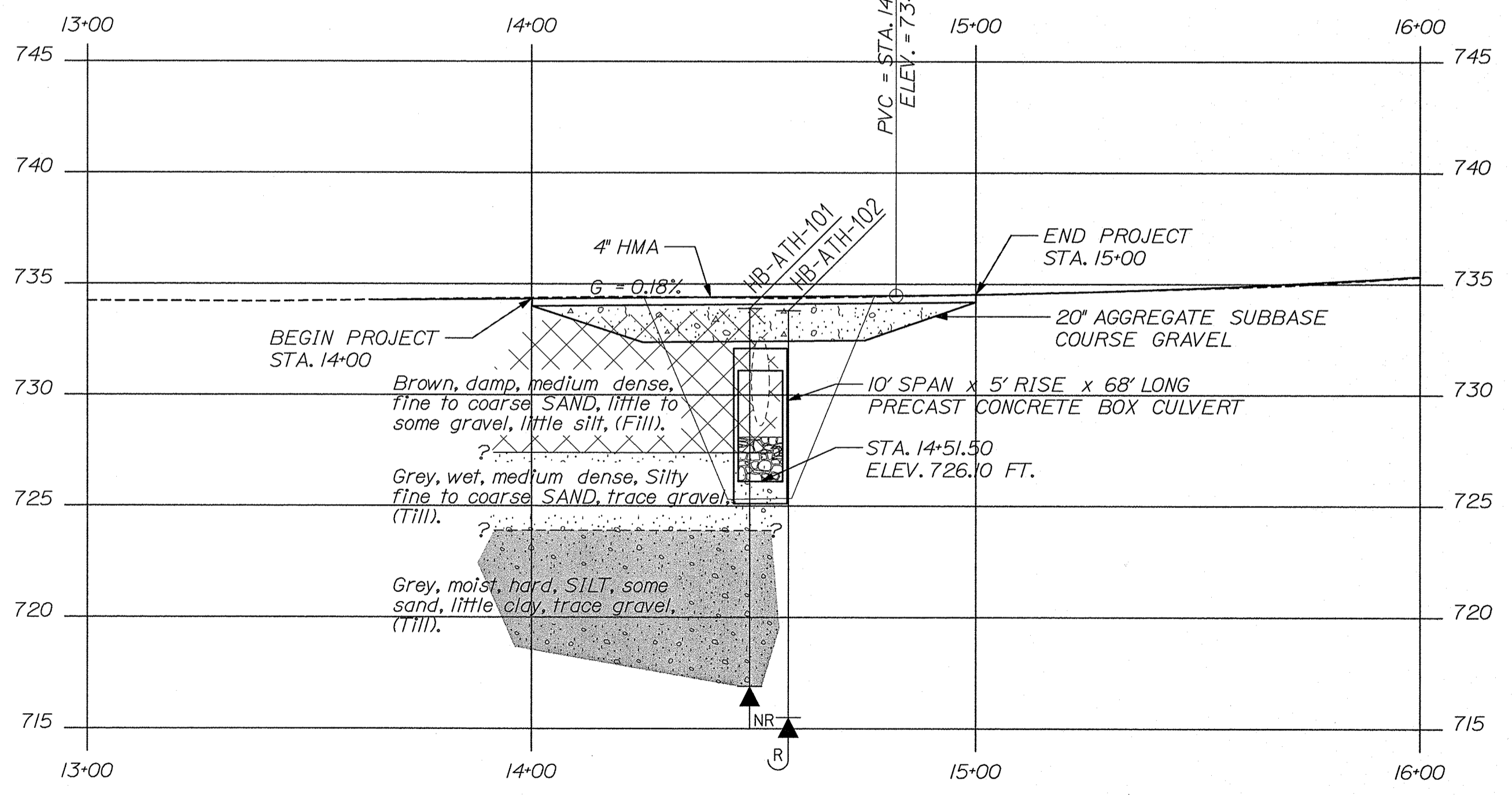
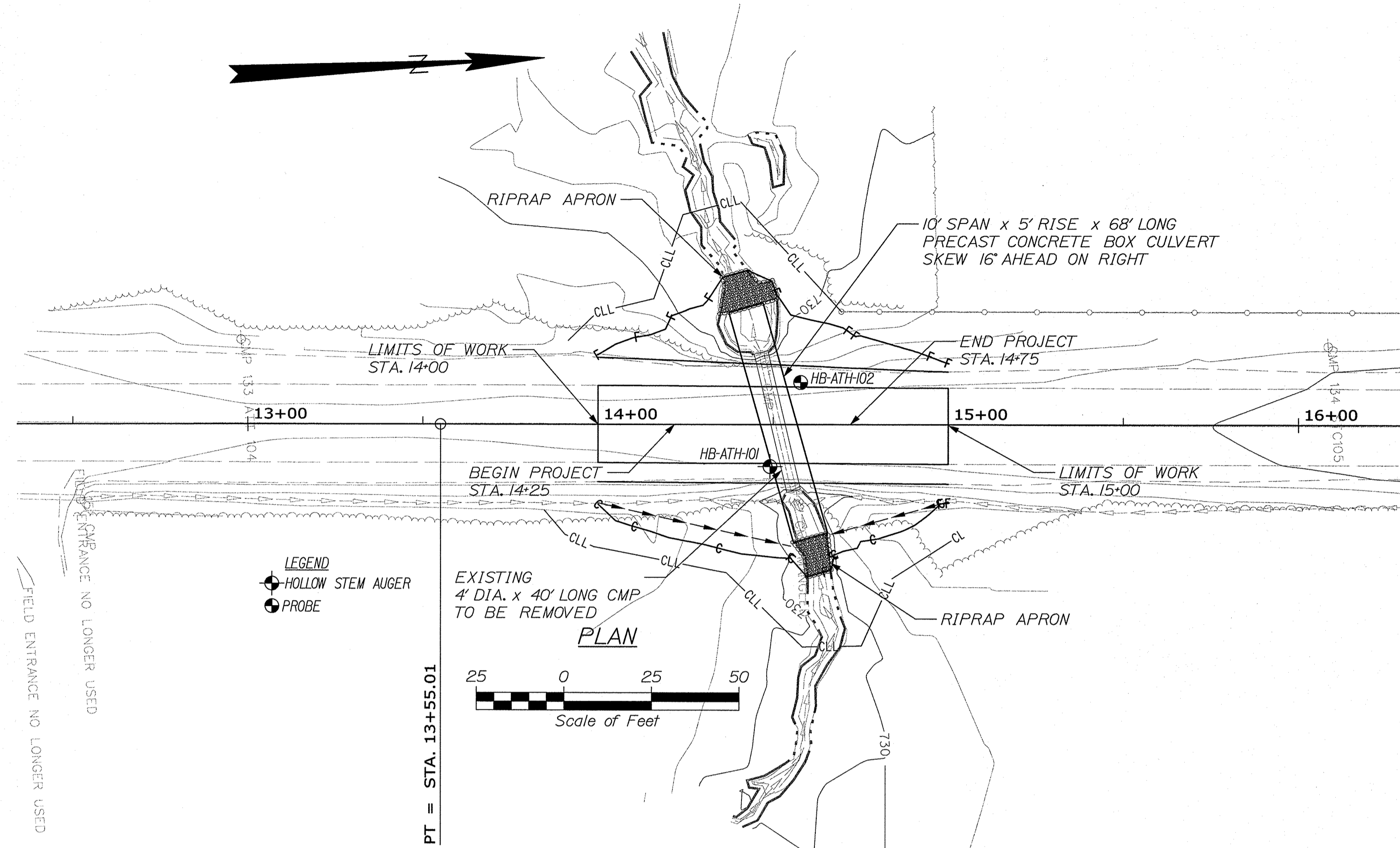

Note: This generalized interpretive soil profile is intended to convey trends in subsurface conditions. The boundaries between strata are approximate and idealized, and have been developed by interpretations of widely spaced explorations and samples. Actual soil and bedrock transitions may vary and are probably more erratic. For more specific information refer to the exploration logs.

Maine Department of Transportation Soil/Borehole Exploration Log US CUSTOMARY UNITS		Project: Large Culvert Replacement on Route 151 Location: Athens, Maine		Boring No.: HB-ATH-101																																																																							
Driller: S. W. Cole	Elevation (ft.): 733.9	Auger ID/OD: 2-75-6-25"	WIN: 23513.00																																																																								
Operator: Roncomb, Lyndard	Date: NAY088	Sampler: Standard Split Spoon																																																																									
Logged By: B. Willard	Rig Type: Dierich D-50 Truck	Home Wt./Fall: 160w/30"																																																																									
Date Start/Finish: 1/29/2018: 08:30-11:00	Drilling Method: Hollow Stem Auger	Core Barrel: N/A																																																																									
Boring Location: 14+49.1, 12.0 ft Rt.	Casing ID/OD: N/A	Water Level: None Observed																																																																									
Home Efficiency Factor: 0.75	Home Type: Automatic	Hydraulic ID: 2"	Rock & Cores: 0																																																																								
<table border="1"> <thead> <tr> <th>Sample No.</th> <th>Pen./Rec. (ft.)</th> <th>Sample Depth (ft.)</th> <th>Blow 1/8" in. (blows/ft.)</th> <th>Pen. (lb-ft)</th> <th>Moisture (%)</th> <th>SG</th> <th>Grain Size</th> <th>Visual Description and Remarks</th> <th>Laboratory Testing Results and Unified Class</th> </tr> </thead> <tbody> <tr> <td>10</td> <td>6/6</td> <td>2.00 - 2.50</td> <td>50</td> <td></td> <td></td> <td></td> <td></td> <td>Brown, damp, very dense, fine to coarse SAND, little silt, little gravel, (FIll). Frost to 3.0 ft bgs.</td> <td>GH500776 A-1-0, SM NC=13.85</td> </tr> <tr> <td>20/A</td> <td>24/14</td> <td>5.00 - 7.00</td> <td>8/11/6/5</td> <td>19</td> <td>25</td> <td></td> <td></td> <td>20 (5.0-6.5 ft bgs) Brown, damp, medium dense, fine to coarse SAND, some gravel, little silt, (FIll).</td> <td>GH500777 A-1-0, SM NC=10.29</td> </tr> <tr> <td>20/B</td> <td>24/14</td> <td>7.00 - 10.00</td> <td>12/17/18/19</td> <td>35</td> <td>46</td> <td></td> <td></td> <td>20/B (6.5-7.0 ft bgs) Grey, wet, medium dense, silty fine to coarse SAND, trace gravel, (TIll).</td> <td>GH500778 A-1, SM NC=15.71</td> </tr> <tr> <td>30</td> <td>24/24</td> <td>10.00 - 12.00</td> <td>12/17/18/19</td> <td>35</td> <td>46</td> <td></td> <td></td> <td>Grey, moist, hard, SILT, some sand, little clay, trace gravel, (TIll).</td> <td>GH500779 A-1, CL NC=9.65</td> </tr> <tr> <td>40</td> <td>24/24</td> <td>15.00 - 17.00</td> <td>7/15/18/20</td> <td>33</td> <td>43</td> <td></td> <td></td> <td>Grey, moist, hard, SILT, some sand, little clay, trace gravel, (TIll).</td> <td>GH500780 A-1, CL NC=10.45</td> </tr> <tr> <td colspan="9">Bottom of Exploration at 17.0 feet below ground surface. NO REFUSAL</td> <td></td> </tr> </tbody> </table>						Sample No.	Pen./Rec. (ft.)	Sample Depth (ft.)	Blow 1/8" in. (blows/ft.)	Pen. (lb-ft)	Moisture (%)	SG	Grain Size	Visual Description and Remarks	Laboratory Testing Results and Unified Class	10	6/6	2.00 - 2.50	50					Brown, damp, very dense, fine to coarse SAND, little silt, little gravel, (FIll). Frost to 3.0 ft bgs.	GH500776 A-1-0, SM NC=13.85	20/A	24/14	5.00 - 7.00	8/11/6/5	19	25			20 (5.0-6.5 ft bgs) Brown, damp, medium dense, fine to coarse SAND, some gravel, little silt, (FIll).	GH500777 A-1-0, SM NC=10.29	20/B	24/14	7.00 - 10.00	12/17/18/19	35	46			20/B (6.5-7.0 ft bgs) Grey, wet, medium dense, silty fine to coarse SAND, trace gravel, (TIll).	GH500778 A-1, SM NC=15.71	30	24/24	10.00 - 12.00	12/17/18/19	35	46			Grey, moist, hard, SILT, some sand, little clay, trace gravel, (TIll).	GH500779 A-1, CL NC=9.65	40	24/24	15.00 - 17.00	7/15/18/20	33	43			Grey, moist, hard, SILT, some sand, little clay, trace gravel, (TIll).	GH500780 A-1, CL NC=10.45	Bottom of Exploration at 17.0 feet below ground surface. NO REFUSAL									
Sample No.	Pen./Rec. (ft.)	Sample Depth (ft.)	Blow 1/8" in. (blows/ft.)	Pen. (lb-ft)	Moisture (%)	SG	Grain Size	Visual Description and Remarks	Laboratory Testing Results and Unified Class																																																																		
10	6/6	2.00 - 2.50	50					Brown, damp, very dense, fine to coarse SAND, little silt, little gravel, (FIll). Frost to 3.0 ft bgs.	GH500776 A-1-0, SM NC=13.85																																																																		
20/A	24/14	5.00 - 7.00	8/11/6/5	19	25			20 (5.0-6.5 ft bgs) Brown, damp, medium dense, fine to coarse SAND, some gravel, little silt, (FIll).	GH500777 A-1-0, SM NC=10.29																																																																		
20/B	24/14	7.00 - 10.00	12/17/18/19	35	46			20/B (6.5-7.0 ft bgs) Grey, wet, medium dense, silty fine to coarse SAND, trace gravel, (TIll).	GH500778 A-1, SM NC=15.71																																																																		
30	24/24	10.00 - 12.00	12/17/18/19	35	46			Grey, moist, hard, SILT, some sand, little clay, trace gravel, (TIll).	GH500779 A-1, CL NC=9.65																																																																		
40	24/24	15.00 - 17.00	7/15/18/20	33	43			Grey, moist, hard, SILT, some sand, little clay, trace gravel, (TIll).	GH500780 A-1, CL NC=10.45																																																																		
Bottom of Exploration at 17.0 feet below ground surface. NO REFUSAL																																																																											
<p>Stratification lines represent approximate boundaries between soil types; transitions may be gradual.</p> <p>* Water level readings have been made at times and under conditions stated. Groundwater fluctuations may occur due to conditions other than those present at the time measurements were made.</p>																																																																											

Maine Department of Transportation Soil/Borehole Exploration Log US CUSTOMARY UNITS		Project: Large Culvert Replacement on Route 151 Location: Athens, Maine		Boring No.: HB-ATH-102																															
Drilling Contractor: S. W. Cole	Elevation (ft.): 733.9	Auger ID/OD: 5" Bore	WIN: 23513.00																																
Operator: Roncomb, Lyndard	Date: NAY088	Sampler: N/A																																	
Logged By: B. Willard	Rig Type: Dierich D-50 Truck	Home Wt./Fall: N/A																																	
Date Start/Finish: 1/29/2018: 08:30-11:00	Drilling Method: Solid Stem Auger	Core Barrel: N/A																																	
Boring Location: 14+57.8, 12.0 ft Lt.	Casing ID/OD: N/A	Water Level: None Observed																																	
<table border="1"> <thead> <tr> <th>Sample No.</th> <th>Pen./Rec. (ft.)</th> <th>Sample Depth (ft.)</th> <th>Blow 1/8" in. (blows/ft.)</th> <th>Pen. (lb-ft)</th> <th>Moisture (%)</th> <th>SG</th> <th>Grain Size</th> <th>Visual Description and Remarks</th> <th>Laboratory Testing Results and Unified Class</th> </tr> </thead> <tbody> <tr> <td colspan="9">Probe, no soil samples taken.</td> <td></td> </tr> <tr> <td colspan="9">Bottom of Exploration at 18.3 feet below ground surface. NO REFUSAL</td> <td></td> </tr> </tbody> </table>						Sample No.	Pen./Rec. (ft.)	Sample Depth (ft.)	Blow 1/8" in. (blows/ft.)	Pen. (lb-ft)	Moisture (%)	SG	Grain Size	Visual Description and Remarks	Laboratory Testing Results and Unified Class	Probe, no soil samples taken.										Bottom of Exploration at 18.3 feet below ground surface. NO REFUSAL									
Sample No.	Pen./Rec. (ft.)	Sample Depth (ft.)	Blow 1/8" in. (blows/ft.)	Pen. (lb-ft)	Moisture (%)	SG	Grain Size	Visual Description and Remarks	Laboratory Testing Results and Unified Class																										
Probe, no soil samples taken.																																			
Bottom of Exploration at 18.3 feet below ground surface. NO REFUSAL																																			
<p>Stratification lines represent approximate boundaries between soil types; transitions may be gradual.</p> <p>* Water level readings have been made at times and under conditions stated. Groundwater fluctuations may occur due to conditions other than those present at the time measurements were made.</p>																																			

**STATE OF MAINE
DEPARTMENT OF TRANSPORTATION**

2351300

**WIN
23513.00**

**ATHENS
ROUTE 151**

**BORING LOCATION PLAN &
INTERPRETIVE SUBSURFACE PROFILE
WITH BORING LOGS**

SHEET NUMBER

3

OF 10

HIGHWAY PLANS

PROF. MANAGER: U.G. WHITTINGTON

DESIGN-DETAILED: L. KANDIKO

CHECKED-REVIEWED: T. WHITE

DESIGN-DETAILED: K. MAGUIRE

DESIGN-DETAILED: J. WHITE

REVISIONS: 1

REVISIONS: 2

REVISIONS: 3

REVISIONS: 4

FIELD CHANGES:

SIGNATURE: *Kate Maguire*

P.E. NUMBER: 7120

DATE: 4/26/2018

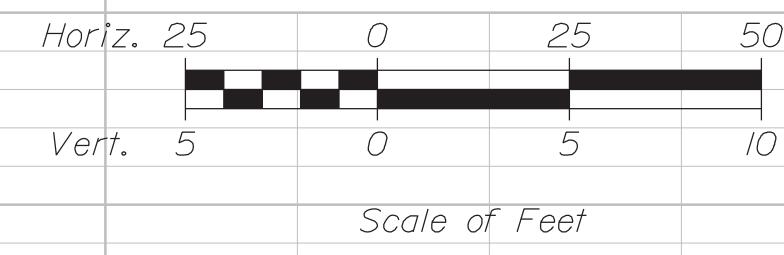
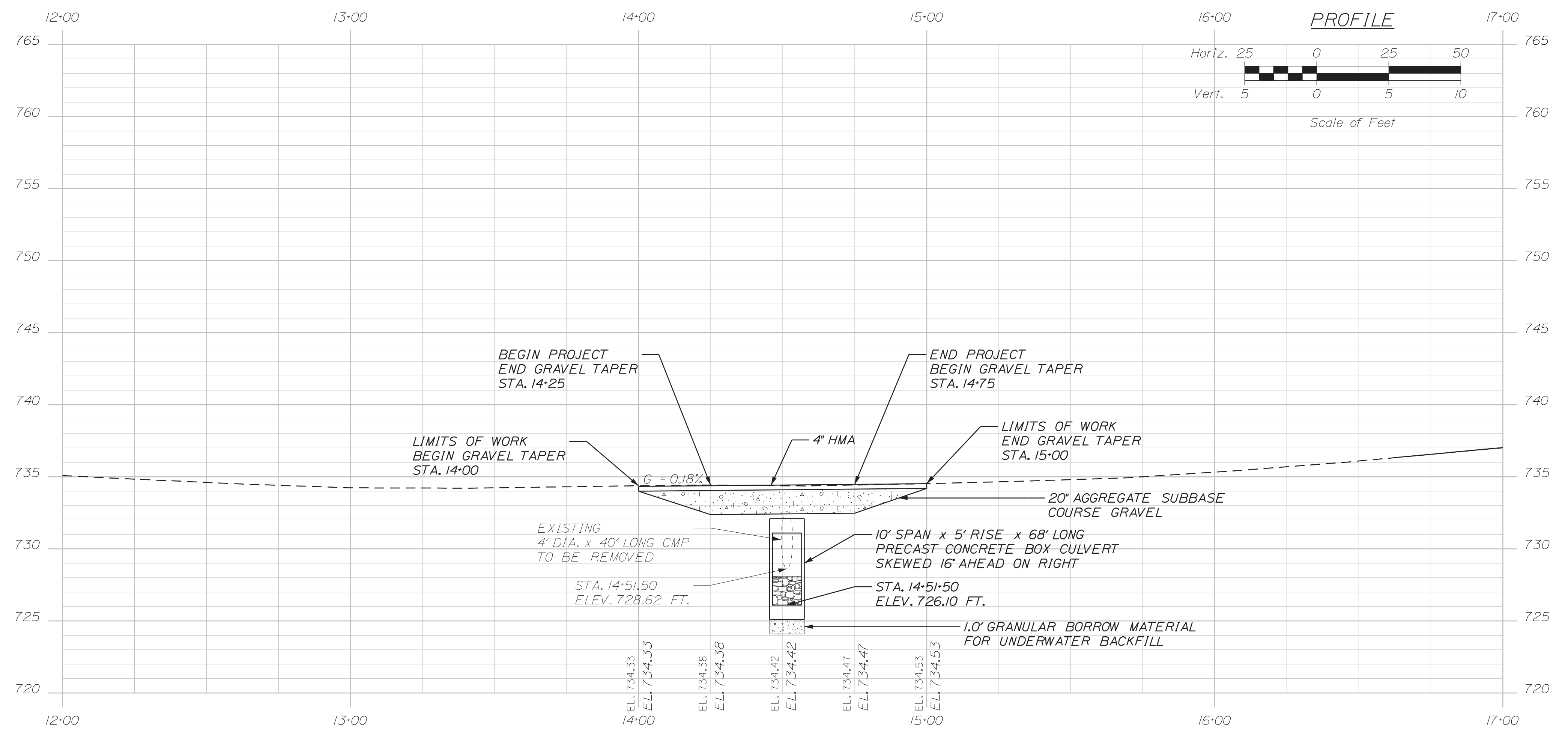
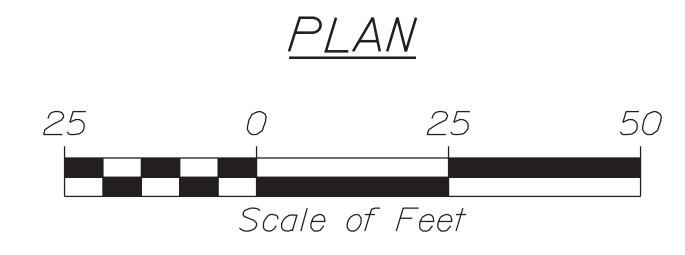
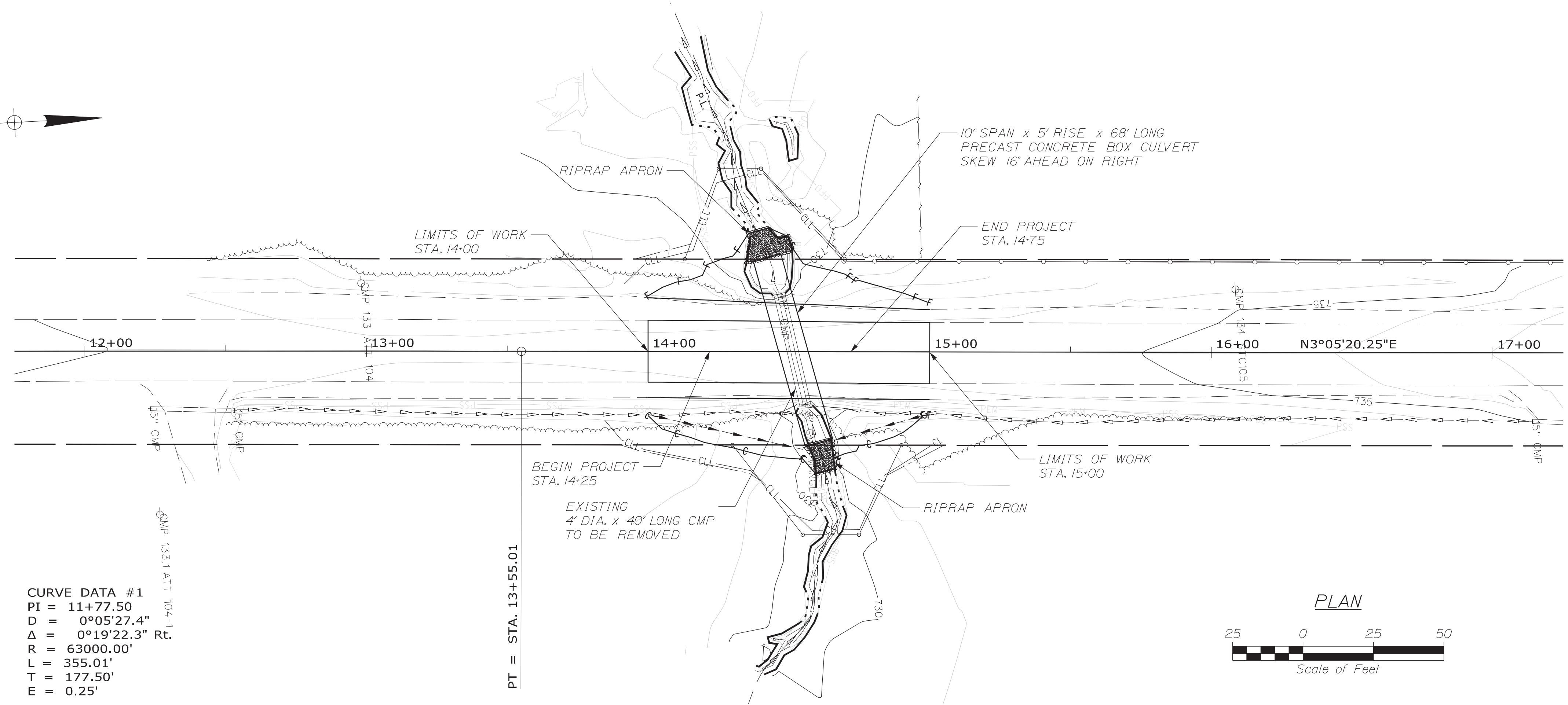
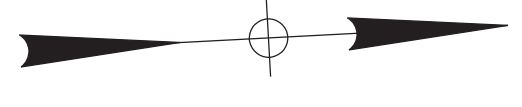

PROFILE

DESIGN/REVISION	DATE	BY
DESIGNED		
CHECKED		
DESIGNED		
REVISIONS		
REVISIONS		
REVISIONS		
REVISIONS		
FIELD CHANGES		

ATHENS
ROUTE 151
PLANS

Filename: ... \MSTAN005_CulvertDetail.dgn
 Division: HIGHWAY
 Username: Lindsey.J.Kandiko
 Date: 5/9/2018

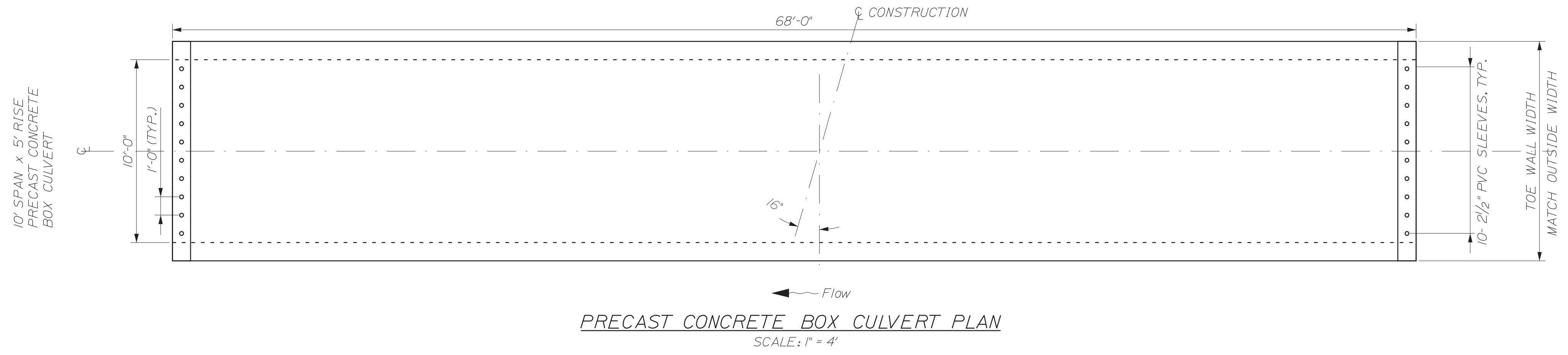

PRECAST CONCRETE BOX CULVERT PLAN
 SCALE: 1" = 4'

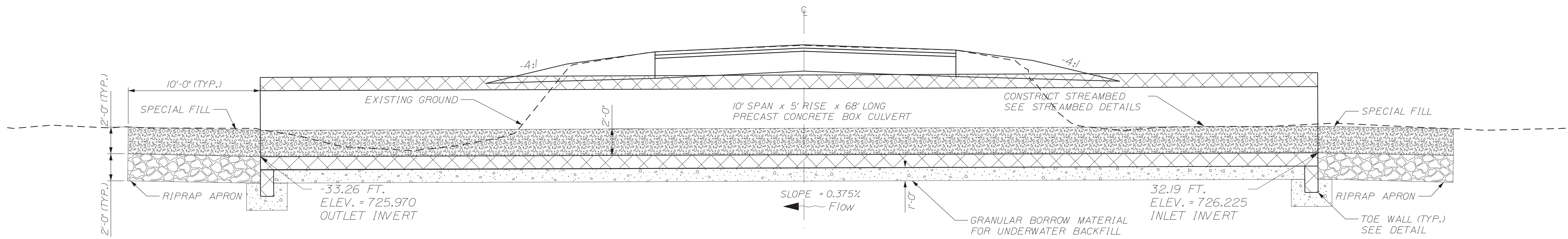

LONGITUDINAL PRECAST CONCRETE BOX CULVERT SECTION
 NOT TO SCALE

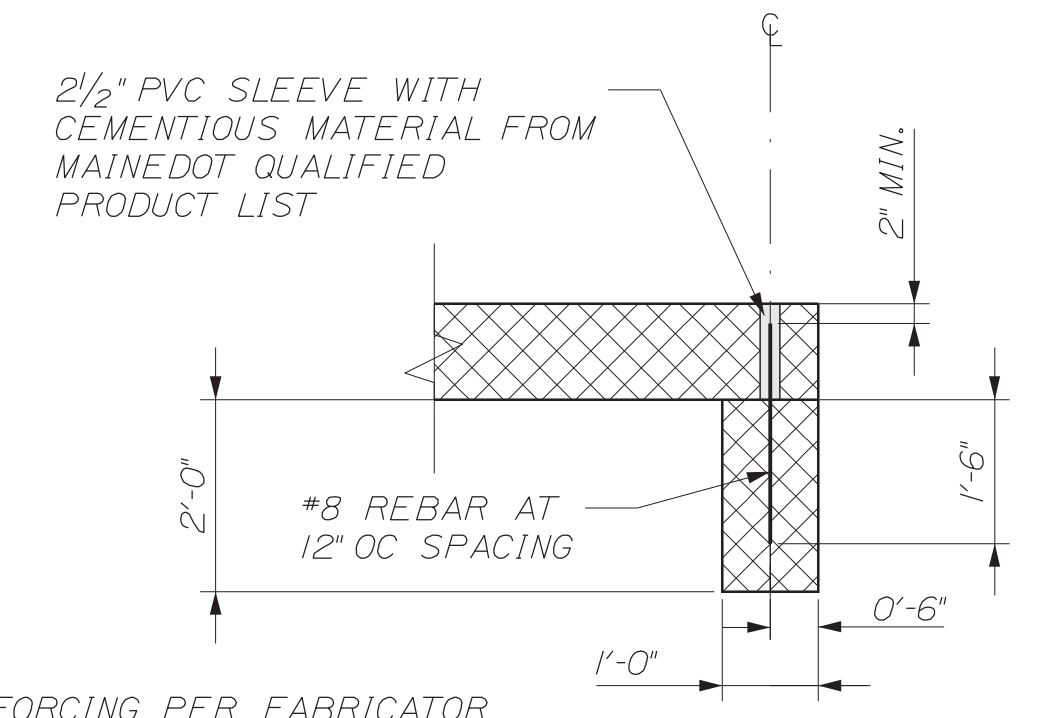

PRECAST CONCRETE TOE WALL DETAIL
 NOT TO SCALE

TOE WALL NOTES

1. TOE WALL REINFORCING PER FABRICATOR

CULVERT NOTES

1. INSTALL STANDARD MEMBRANE WATERPROOFING OVER THE TOP AND TO AT LEAST 12 INCHES DOWN THE EXTERIOR SIDES OF PRECAST UNITS.
2. CONSTRUCTION, HANDLING, AND ASSEMBLY OF THE PRECAST UNITS SHALL BE IN ACCORDANCE WITH THE MANUFACTURER'S SPECIFICATIONS AS APPLICABLE.
3. THE PRECAST UNIT SHALL BE DESIGNED BY THE MANUFACTURER TO CARRY CONSTRUCTION LOADINGS WITH A MINIMUM FILL COVER OF 18" OVER THE TOP OF THE UNIT.
4. THE PRECAST CULVERT BOX SECTIONS SHALL BE ASSEMBLED SUCH THAT ANY SHORTER LENGTH SECTION SHALL BE IN THE CENTER OF THE CONSTRUCTED CULVERT.
5. THE PRECAST CONCRETE BOX CULVERT SHALL BE BEDDED ON A 1-FOOT LAYER OF COMPACTED GRANULAR BORROW MATERIAL FOR UNDERWATER BACKFILL.
6. A "CLAMSHELL" BOX CULVERT SHALL BE USED. THE "CLAMSHELL" SHALL BE DIVIDED SUCH THAT THE BOTTOM SECTION WILL HAVE 3'-6" OF THE CULVERT'S HEIGHT.
7. THE CULVERT SHALL BE LINED WITH 2 FEET OF SPECIAL FILL IN ACCORDANCE WITH SPECIAL PROVISION 203 AND BANKLINES IN ACCORDANCE WITH SPECIAL PROVISION 610.
8. VOIDS IN RIPRAP APRON SHALL BE INFILLED WITH SPECIAL FILL, WATER-IN AND TAMPED.

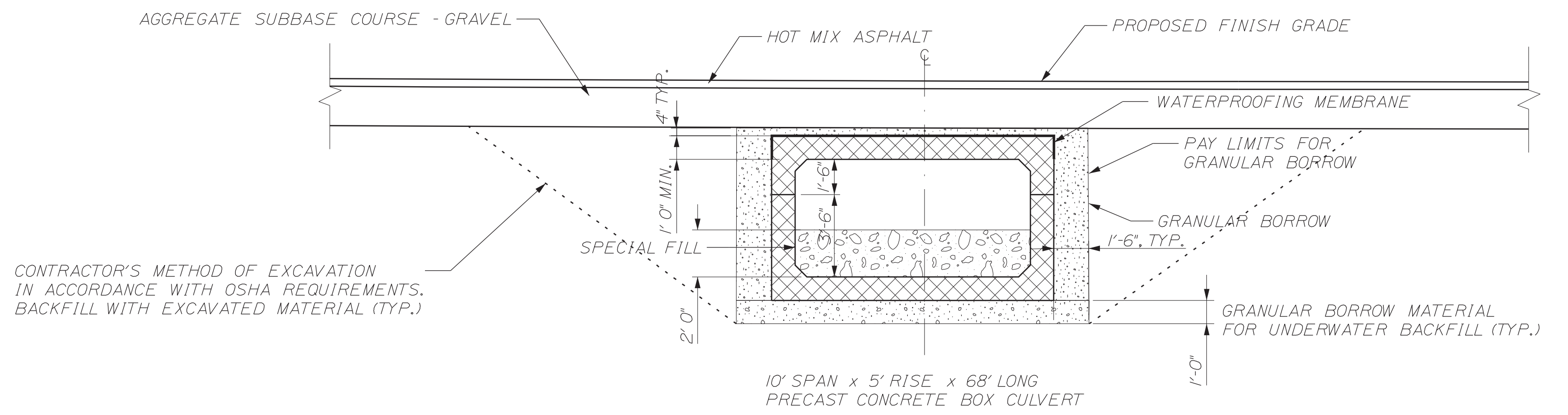

TYPICAL PRECAST CONCRETE BOX CULVERT SECTION
 NOT TO SCALE

STATE OF MAINE
 DEPARTMENT OF TRANSPORTATION
 023513.00
 WIN
 23513.00
 HIGHWAY PLANS

PROJ. MANAGER	G. WHITTINGTON	BY	DATE	SIGNATURE	P.E. NUMBER	DATE
DESIGNED/DETAILED	L. KANDIKO					
CHECKED/REVIEWED						
DESIGNED/DETAILED						
REVISIONS	1					
REVISIONS	2					
REVISIONS	3					
REVISIONS	4					
FIELD CHANGES						

ATHENS
 ROUTE 151
 CULVERT DETAILS

SHEET NUMBER
 5
 OF 10

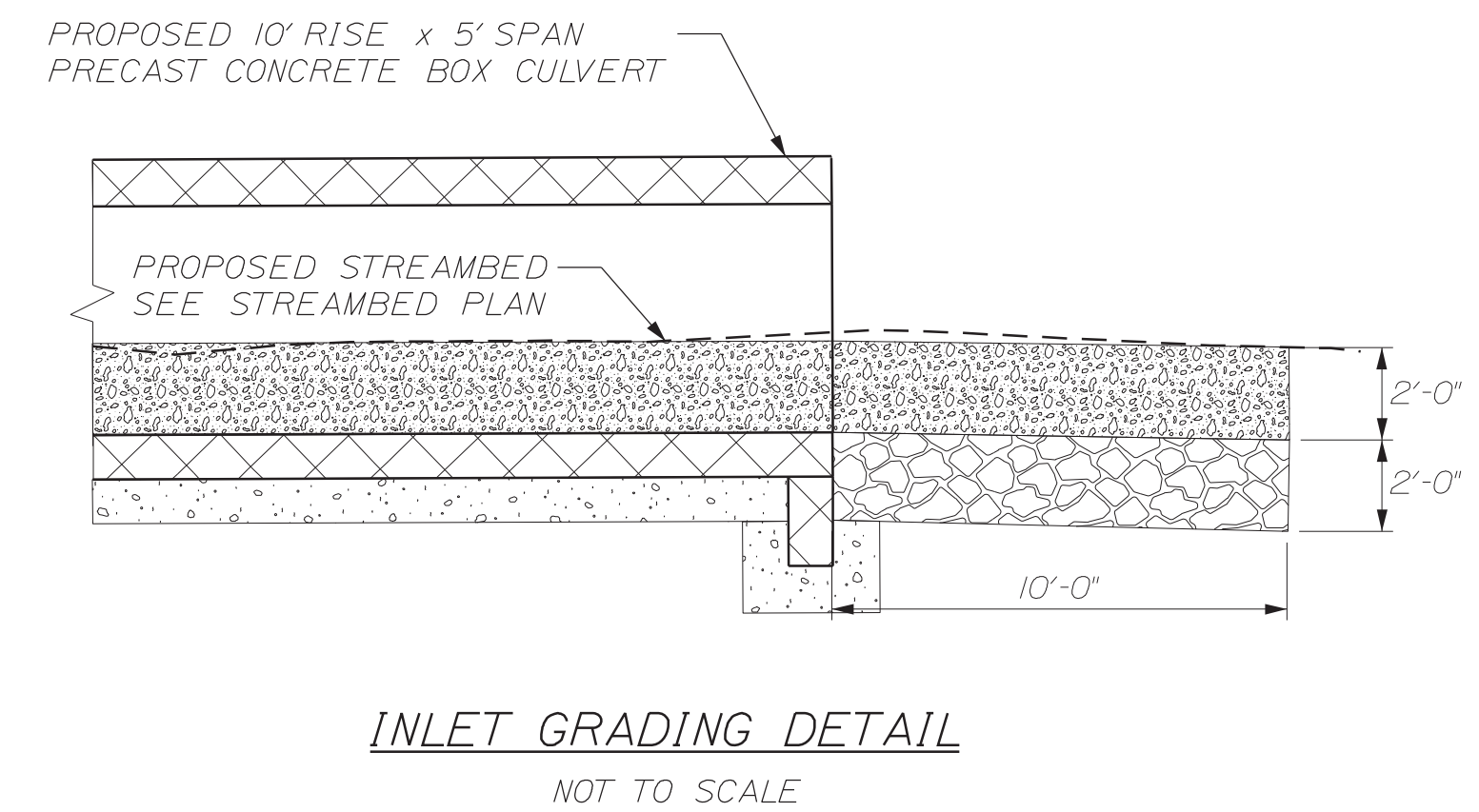
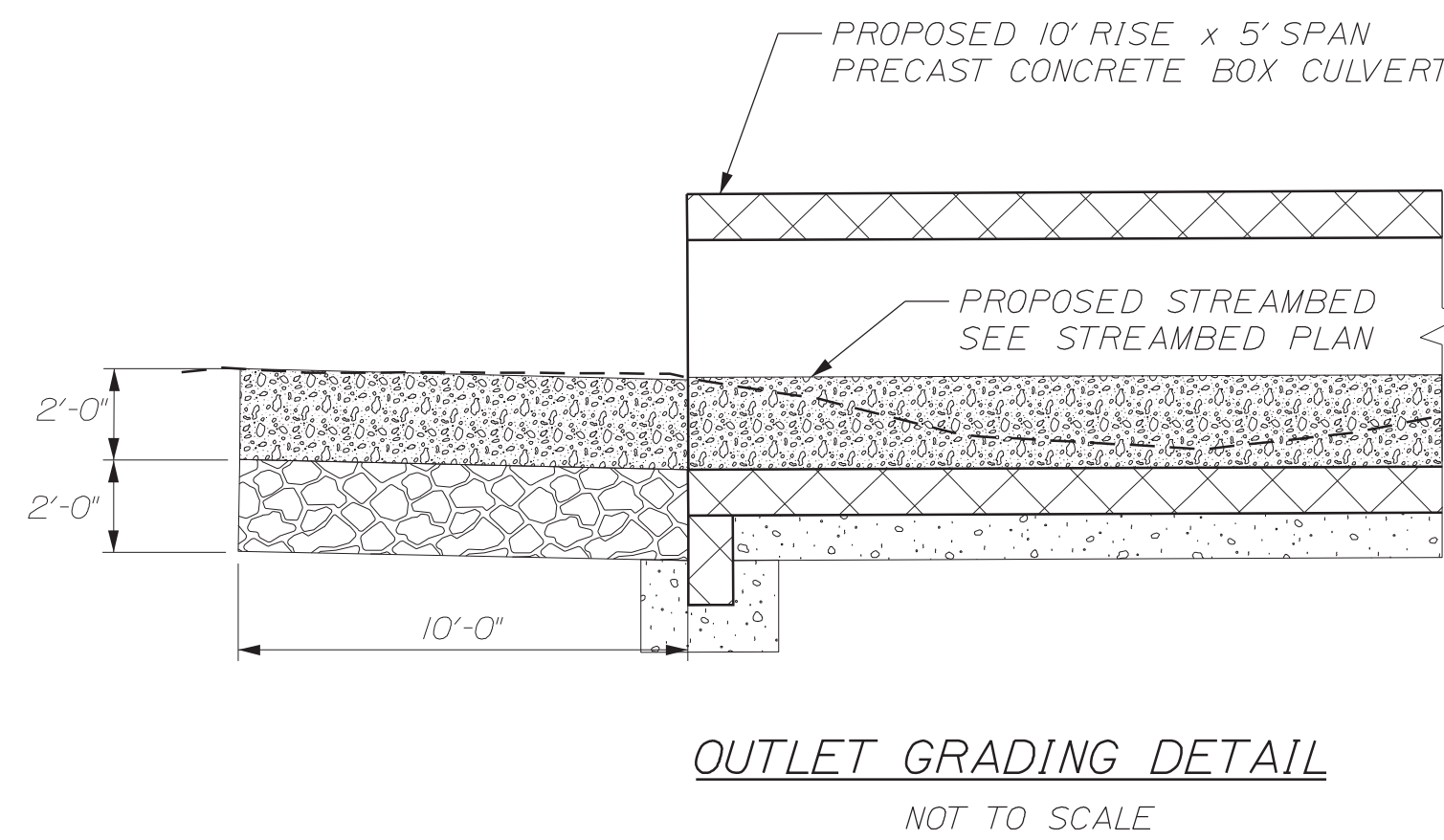
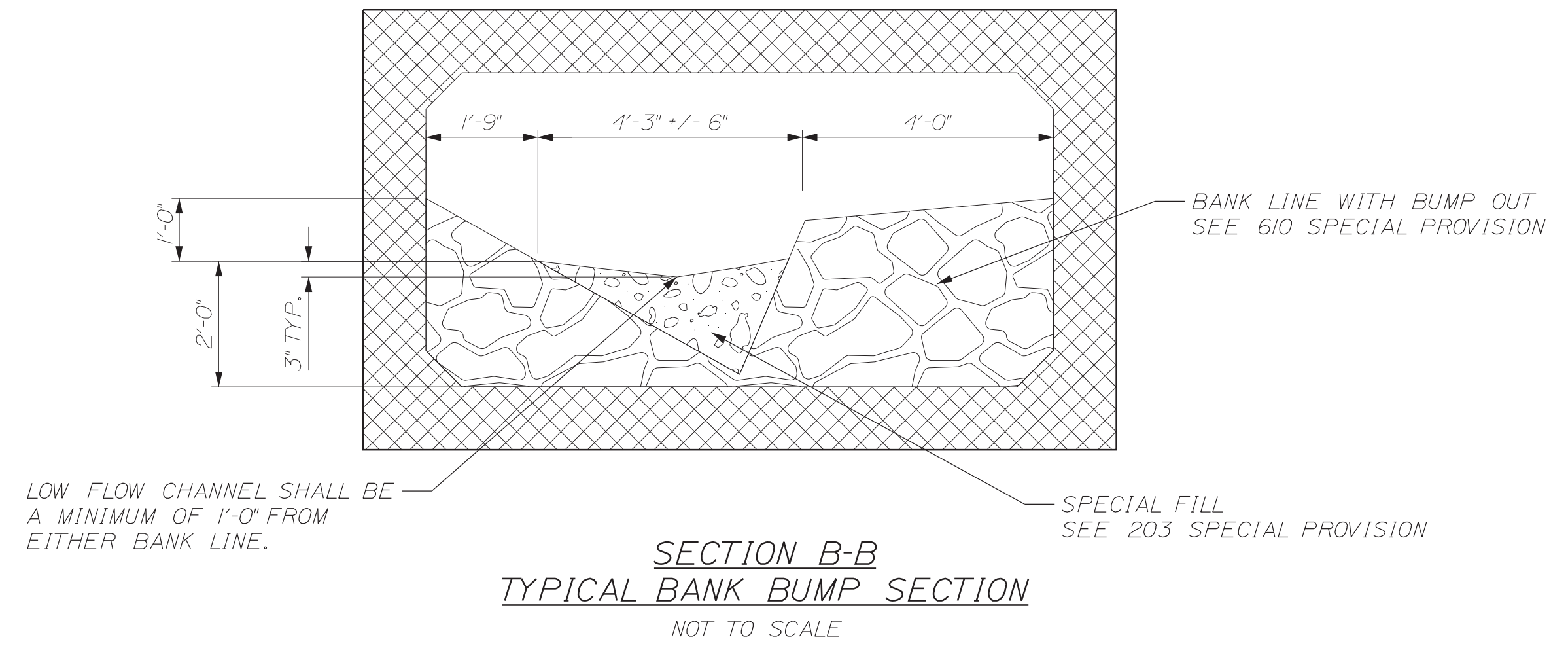
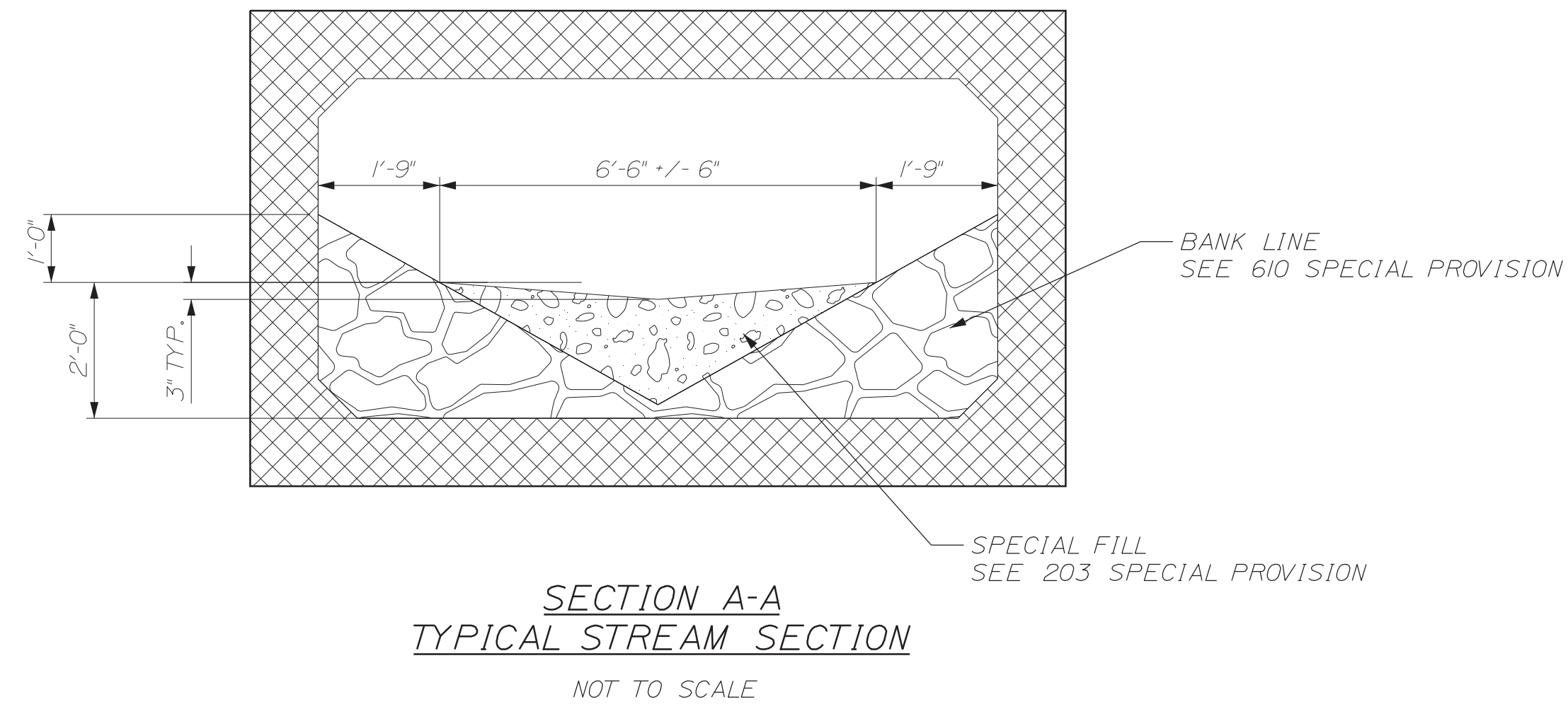
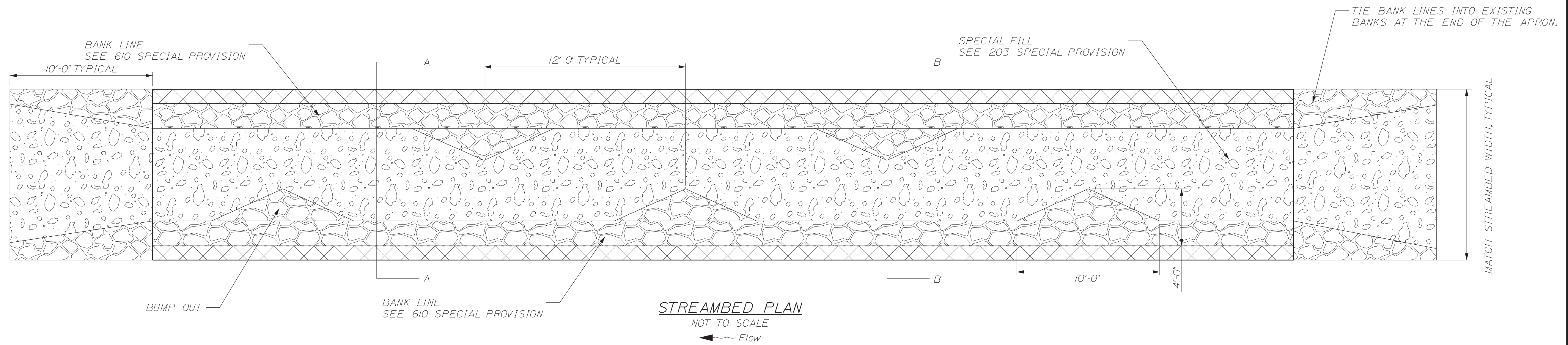

STREAMBED NOTES

1. BANK LINES SHALL BE CONSTRUCTED IN ACCORDANCE TO SPECIAL PROVISION 610 - STREAM CHANNEL ROCK
2. SPECIAL FILL SHALL BE CONSTRUCTED IN ACCORDANCE TO SPECIAL PROVISION 203 - SPECIAL FILL
3. SPECIAL FILL SHALL BE PLACED IN THE CULVERT SO AS TO NOT DAMAGE THE CULVERT. ANY DAMAGE SHALL BE REPAIRED TO THE SATISFACTION OF THE RESIDENT AT THE CONTRACTOR'S EXPENSE.
4. THE CONTRACTOR SHALL RELEASE THE COFFERDAMS IN A MANNER SO AS TO NOT DAMAGE OR MOVE THE STREAMBED MATERIAL. ANY DAMAGE SHALL BE REPAIRED AT THE CONTRACTOR'S EXPENSE.
5. PAYMENT FOR ANY NECESSARY GRADING AT THE INLET OR OUTLET WILL BE CONSIDERED INCIDENTAL TO ITEM 203 - SPECIAL FILL.
6. DIMENSIONS WITHOUT TOLERANCES ARE INTENDED TO BE NOMINAL. NO FINE GRADING OF THE STREAMBED WILL BE REQUIRED.

STATE OF MAINE
DEPARTMENT OF TRANSPORTATION
023513.00
WIN
23513.00
HIGHWAY PLANS

DESIGN/DETAIL	BY	DATE	SIGNATURE	P.E. NUMBER	DATE
DESIGN/REVIEWED	L. KANDIKO				
DESIGN/REVIEWED					
REVISIONS					
REVISIONS					
REVISIONS					
REVISIONS					
FIELD CHANGES					

ATHENS
ROUTE 151
STREAMBED DETAILS

SHEET NUMBER
6
OF 10

Filename: ... \MSTAN007_XSECT_13+50_003.dgn Division: HIGHWAY Username: Lindsey.J.Kandiko Date: 5/9/2018

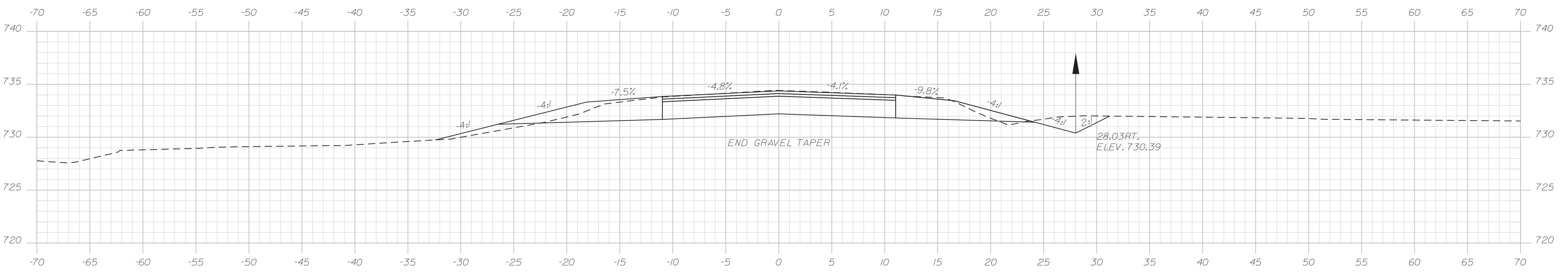

14+25.00

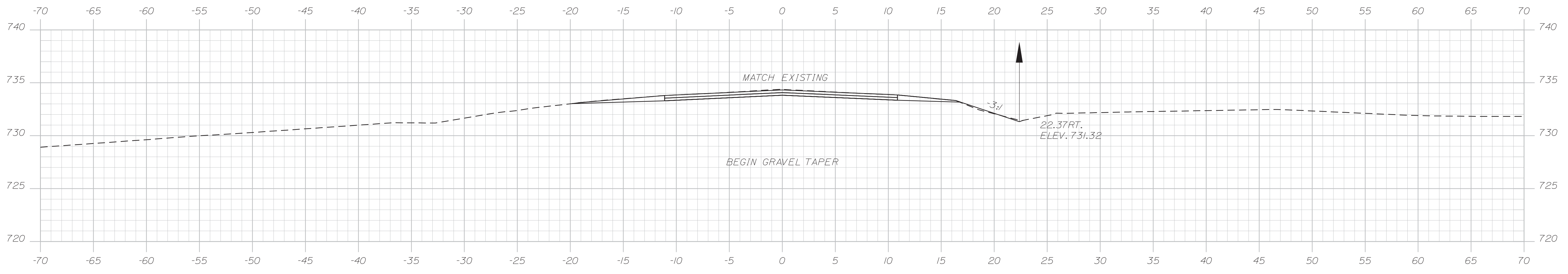

14+00.00

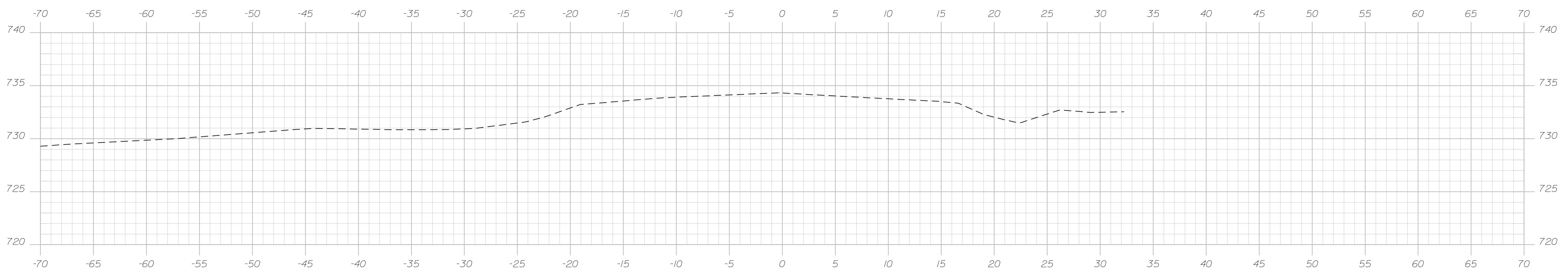

13+75.00

STATE OF MAINE
DEPARTMENT OF TRANSPORTATION
023513.00
WIN
23513.00
HIGHWAY PLANS

SIGNATURE	P.E. NUMBER	DATE

PROJ. MANAGER	DATE
G. WHITTINGTON	

BY

DESIGN DETAILED	CHECKED/REVIEWED	DESIGNS DETAILED	REVISIONS 1	REVISIONS 2	REVISIONS 3	REVISIONS 4	FIELD CHANGES
L. KANDIKO							

ATHENS
ROUTE 151
CROSS SECTIONS

SHEET NUMBER
7
OF 10

Filename: ... \MST\A008_XSECT_14+25_004.dgn Division: HIGHWAY Username: Lindsey.J.Kandiko Date: 5/9/2018

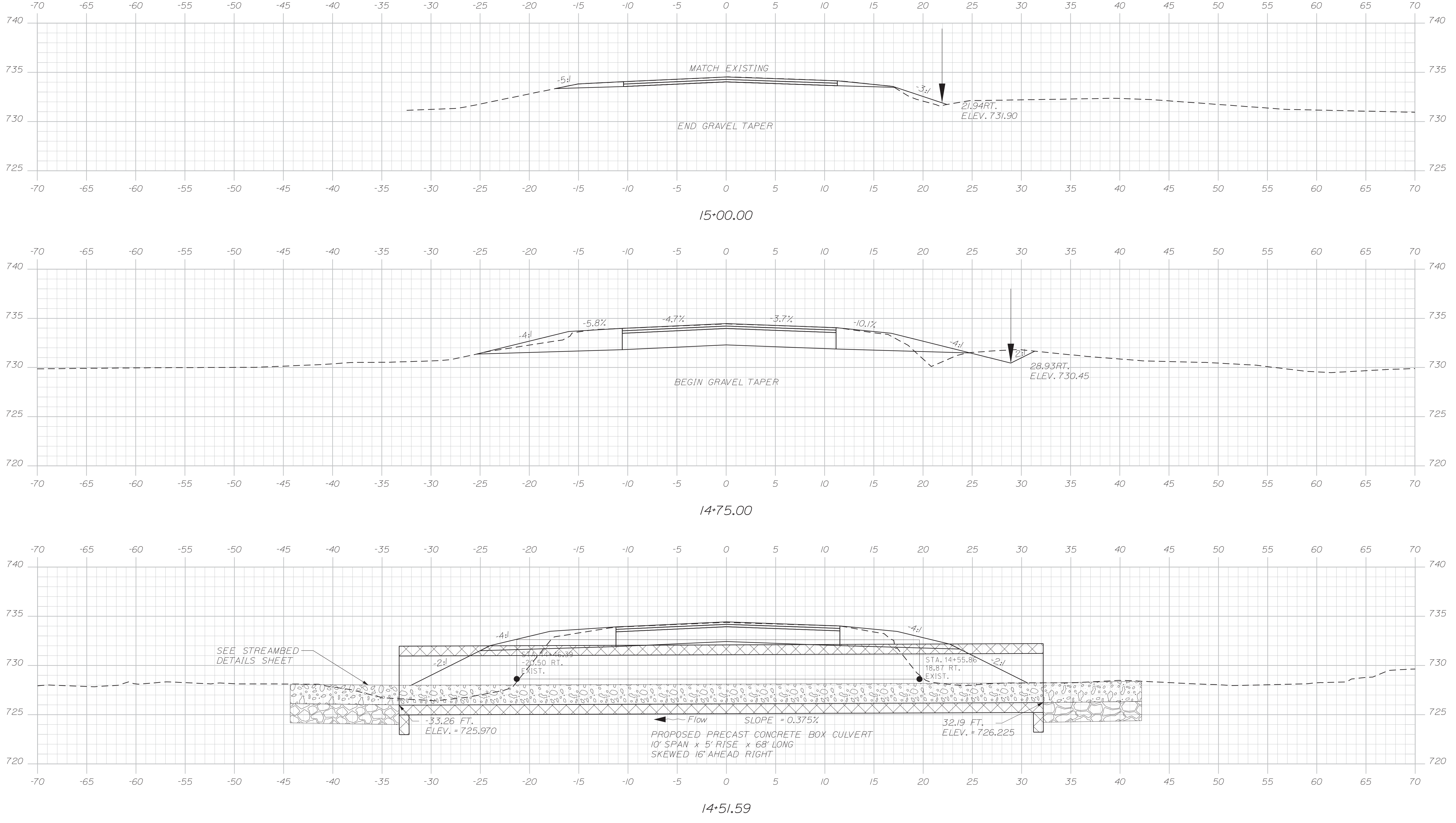

STATE OF MAINE DEPARTMENT OF TRANSPORTATION		023513.00	WIN 23513.00	HIGHWAY PLANS
	SIGNATURE	P.E. NUMBER	DATE	
PROJ. MANAGER G. WHITTINGTON	BY	DATE	DATE	FIELD CHANGES
DESIGN/DETAILED L. KANDIKO	CHECKED/REVIEWED	DESIGN/DETAILED	REVISIONS 1	REVISIONS 2
DESIGN/DETAILED	REVISIONS 3	REVISIONS 4		
ATHENS ROUTE 151		CROSS SECTIONS		
SHEET NUMBER		8		
		OF 10		

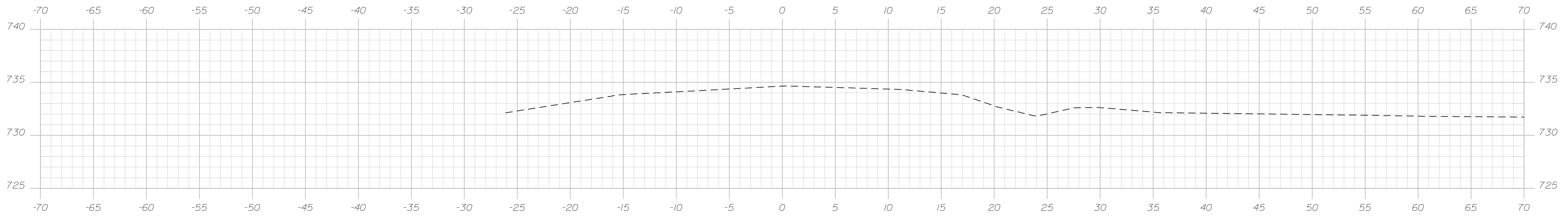

15+25.00

STATE OF MAINE
DEPARTMENT OF TRANSPORTATION
023513.00

WIN
23513.00
HIGHWAY PLANS

PROJ. MANAGER	G. WHITTINGTON	BY	DATE
CHECKED/REVIEWED	L. KANDIKO		
DESIGNS DETAILED			
REVISIONS 1			
REVISIONS 2			
REVISIONS 3			
REVISIONS 4			
FIELD CHANGES			

ATHENS
ROUTE 151
CROSS SECTIONS

SHEET NUMBER
9
OF 10

