

STATE OF MAINE DEPARTMENT OF TRANSPORTATION



HERMON PENOBSCOT ROUTE 2 \ ANNIS ROAD FEDERAL AID PROJECT NO. 2287900 PROJECT LENGTH : 0.25 MILES

PLAN LEGEND

Town, County, State	-----	Catch Basins	▣ Existing	▣ Proposed
Property Lines	-----	Manholes	○ Existing	● Proposed
R/W Lines-Existing	-----	Proposed Underdrain	-----	
R/W Lines-Proposed	-----	Proposed Ditch	-----	
Culvert-Existing	-----	Existing Ditch	-----	
Culvert Proposed	-----	Utility Poles	◇ Existing	◆ Proposed
Curbing	Existing Proposed	Fire Hydrants	⊙ Existing	⊙ Proposed
Type 1	-----	Existing Water Line	-----	
Type 3	-----	Existing San. Sewer	-----	
Type 5	-----	Existing San. Sewer Manhole	⊙	
Outline of Bodies of Water	-----	Guardrail-Existing	-----	
Exposed Bedrock	-----	Guardrail-Proposed	-----	
Buildings	-----	Guardrail-Cable, Other	-----	
Trees	☙ Conifer ☘ Deciduous	Centerline-Existing	-----	
Tree Line	-----	Centerline-Proposed	-----	
Clearing Limit Line	-----	Travelway-Existing	-----	
Railroad	-----	Travelway-Proposed	-----	
Boring	HB-XXX-###	Probe	⊙ P-#.X	
Pavement Core	● PC-#	#.# = Depth		
Test Pit	▣ TP-XXX-###	X = W (Weathered Rock)		
		R (Refusal)		
		NR (No Refusal)		

INDEX OF SHEETS

Description	Sheet No.
Title Sheet	1
Typical Sections	2
Estimated Quantities and Earthwork Summary	3
General Notes	4
Construction Notes	5
Striping and Geometric Plan	6
Plan / Profile	7-10
Cross - Sections	11-23
Right of Way Map	24-26

STATE OF MAINE DEPARTMENT OF TRANSPORTATION	DATE 6-22-2020
APPROVED	
COMMISSIONER	
CHIEF ENGINEER	

STATE OF MAINE DEPARTMENT OF TRANSPORTATION CLARK ESTABROOK SULLOWAY No. 16107 LICENSED PROFESSIONAL ENGINEER	DATE 5-27-2020
SIGNATURE	P.E. NUMBER

PROJECT INFORMATION	HIGHWAY PROGRAM
PROGRAM	R. MOULTON
PROJECT MANAGER	C. SULLOWAY
DESIGNER	CONSULTANT
PROJECT RESIDENT	CONTRACTOR
CONTRACTOR	PROJECT COMPLETION DATE

HERMON
ROUTE 2 \ ANNIS ROAD
TITLE SHEET

SHEET NUMBER
1
OF 26

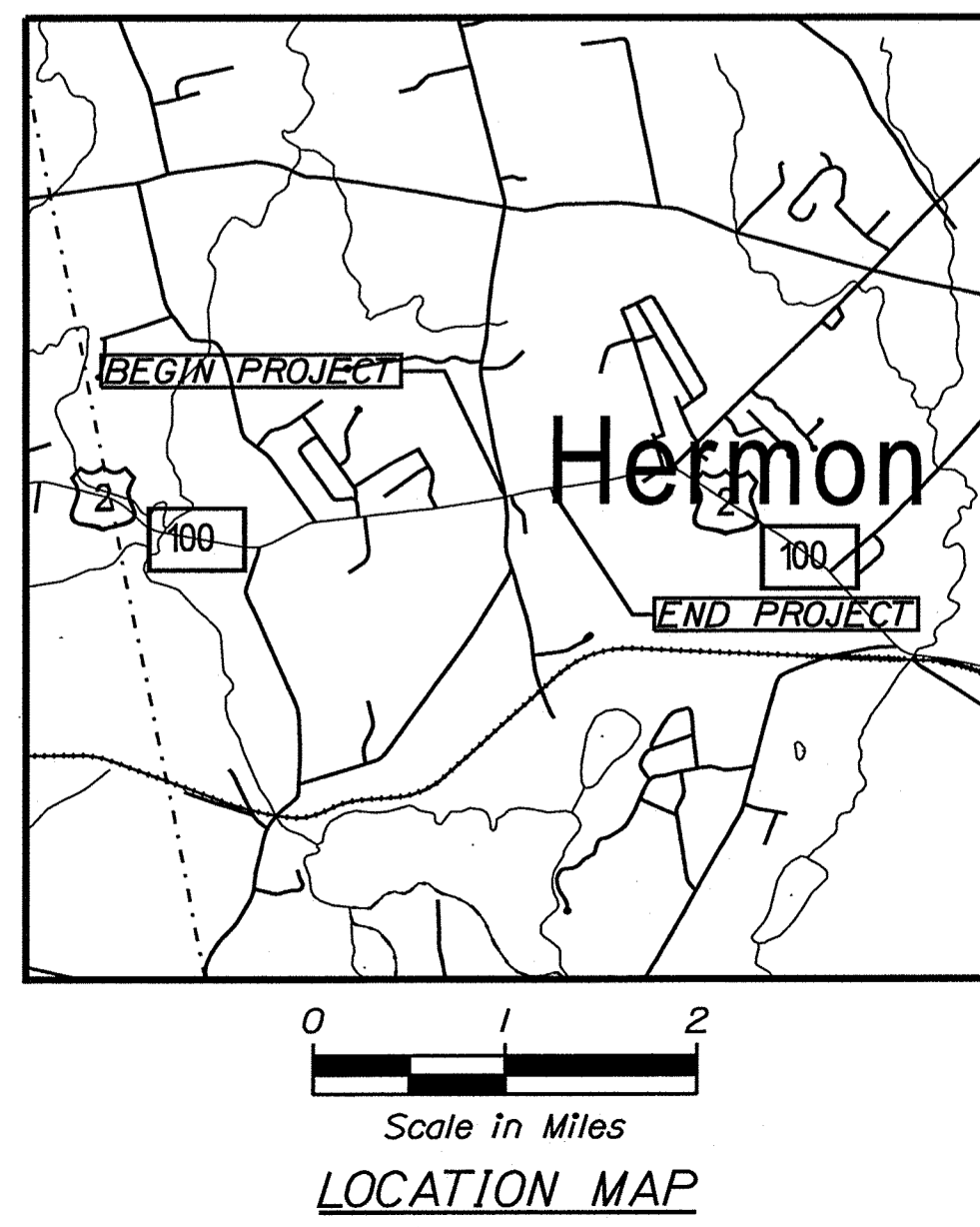
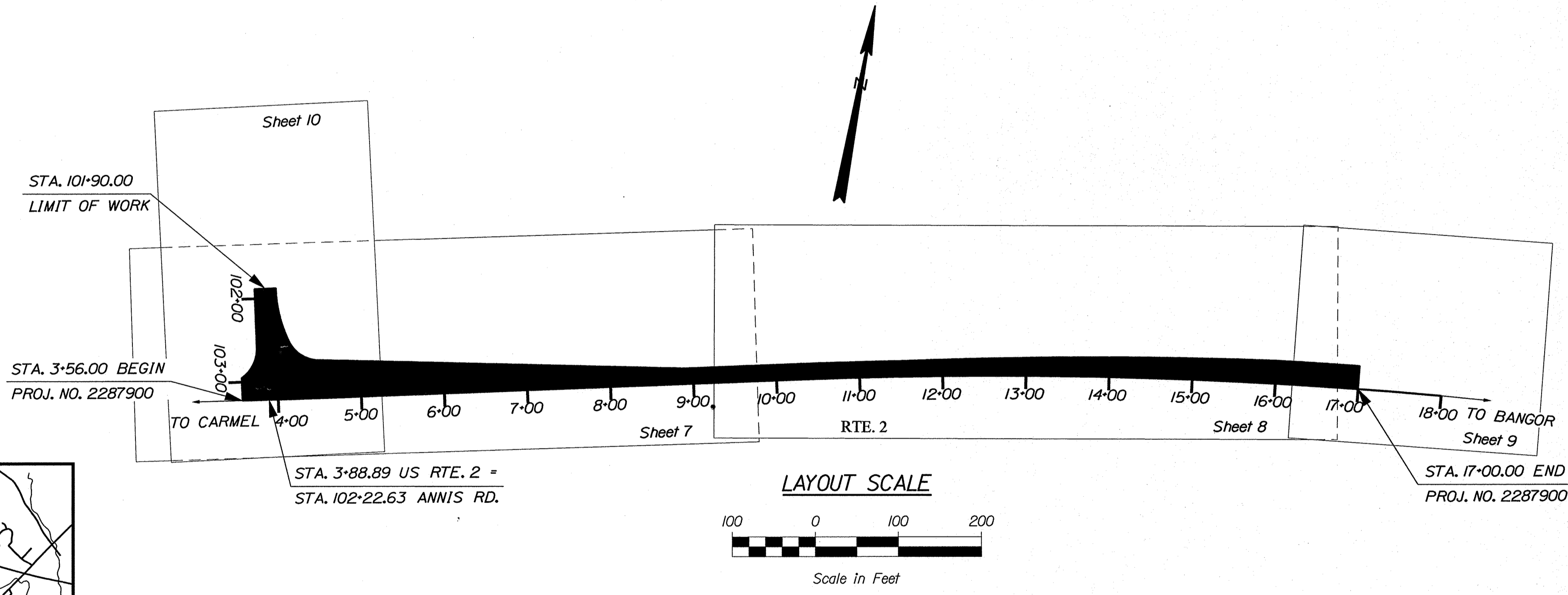

TRAFFIC DATA

Current (2020) AADT	9390
Future (2040) AADT	10330
DHV - % of AADT	12%
Design Hour Volume	1240
% Heavy Trucks (AADT)	5%
Directional Distribution (DHV)	70%
Design Speed (mph)	45
Functional Class: Major/Urban Collector	
Corridor Priority	3

PROJECT LOCATION:	INTERSECTION OF ROUTE 2 AND ANNIS ROAD
PROGRAM AREA:	HIGHWAY PROGRAM
SCOPE OF WORK:	INTERSECTION IMPROVEMENTS W/ SIGNAL

22879.00 FEDERAL AID PROJECT NO. 2287900

Filename: ...:\00\HIGHWAY\MSTAV\001_Title.dgn Division: HIGHWAY User: Clark.E.Suloway Date: 5/27/2020

Filename: ... \HIGHWAY\MSTA\002_Typical.dgn
 Division: HIGHWAY
 Username: Clark.E.Sullivan
 Date: 6/5/2020

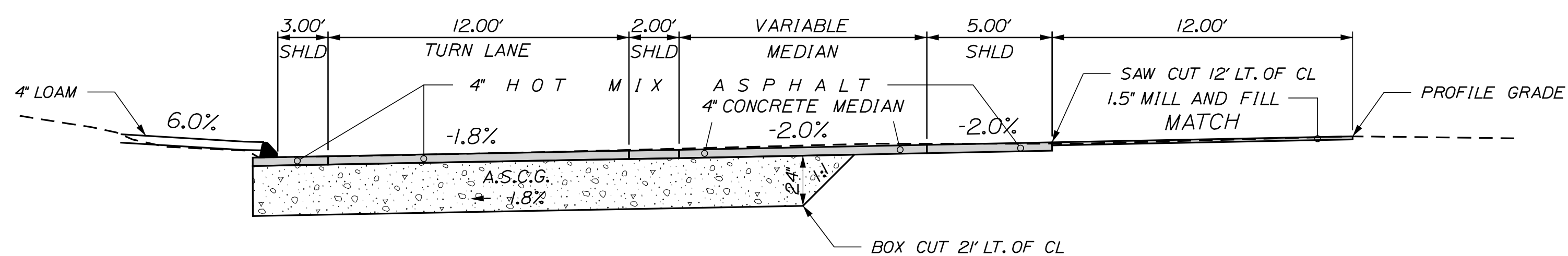

ROUTE 2 SEPARATED TURN LANE

TURN LANE WITH MEDIAN
STATION TO STATION
4+25.00 TO 5+65.85

NOTE:

1. THE PAVEMENT, BASE AND SUBBASE DEPTHS AS SHOWN ON THE PLANS ARE INTENDED TO BE NOMINAL.
2. WHEN SUPERELEVATION EXCEEDS THE SLOPE OF THE LOW SIDE SHOULDER, THE LOW SIDE SHOULDER SHALL HAVE THE SAME SLOPE AS THE TRAVELWAY.
3. CROWNS FOR BOTH NORMAL AND SUPERELEVATION SECTIONS FOR ALL COURSES OF SUBBASE AND PAVEMENT SHALL BE STRAIGHT.
4. THE GRAVEL QUANTITY CALCULATION IS BASED ON A 2" LOAM OR DIRTY BORROW DEPTH. THE ACTUAL DEPTH MAY VARY. SEE THE GENERAL NOTES.
5. THE ALGEBRAIC DIFFERENCE BETWEEN THE SHOULDER AND TRAVELWAY CROSS SLOPES "ROLLOVER" SHALL NOT EXCEED 8%.
6. THE STATIONING SHOWN UNDER EACH TYPICAL IS APPROXIMATE.

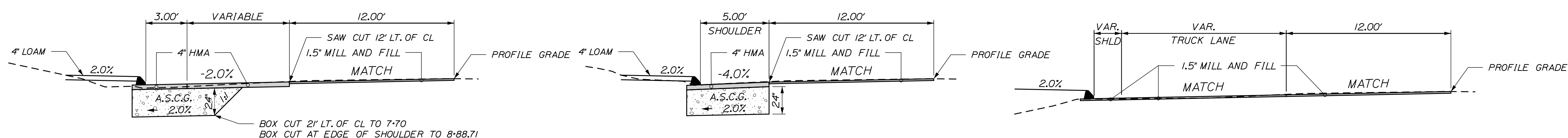

ROUTE 2 MAINLINE AND TURN LANE TAPER

TURN LANE TAPER
STATION TO STATION
5+65.85 TO 8+88.71

ROUTE 2 MAINLINE AND FULL DEPTH SHOULDER

FULL DEPTH SHOULDER
STATION TO STATION
8+88.71 TO 11+50.00

ROUTE 2 MAINLINE AND TRUCK LANE

MILL AND FILL TRUCK LANE AND SHOULDER
STATION TO STATION
11+50.00 TO 16+18.00

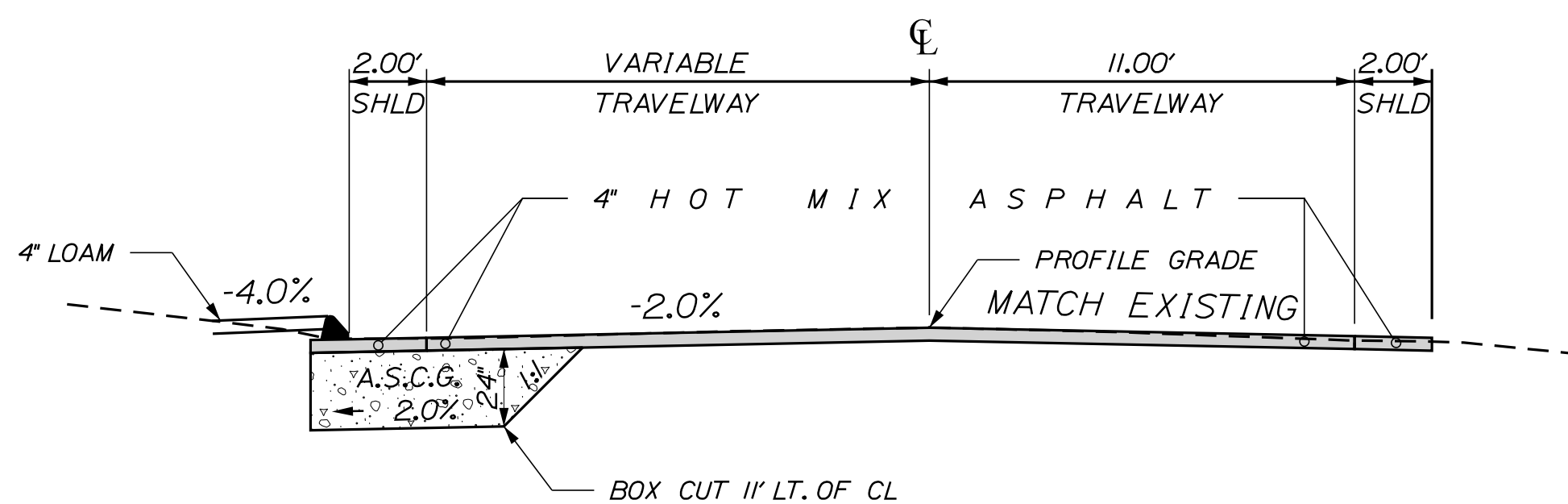

ANNIS ROAD MAINLINE AND FULL DEPTH SHOULDER

ANNIS ROAD MAINLINE AND SHOULDER
STATION TO STATION
101+90.00 TO 102+79.00

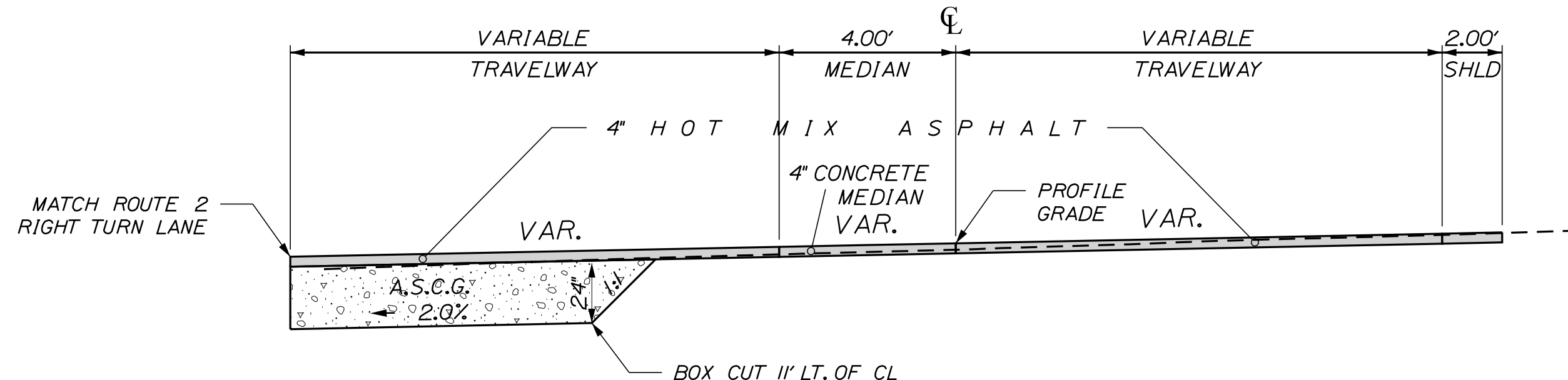

ANNIS ROAD MAINLINE WITH MEDIAN

ANNIS ROAD MAINLINE WITH MEDIAN
STATION TO STATION
102+79.00 TO 103+05.70

STATE OF MAINE
 DEPARTMENT OF TRANSPORTATION
 2287900
 WIN 228795.00
 HIGHWAY PLANS

PROJ. MANAGER	RHOBE	MOUTON	BY	DATE
DESIGN-DETAILED	C. SULLOWAY			
CHECKED-REVIEWED				
DESIGN-DETAILED				
REVISIONS 1				
REVISIONS 2				
REVISIONS 3				
REVISIONS 4				
FIELD CHANGES				

HERMON
 ROUTE 2 \ ANNIS ROAD
 TYPICAL SECTIONS

SHEET NUMBER
 2
 OF 26

NOT TO SCALE

ESTIMATED QUANTITIES			
ITEM NO.	DESCRIPTION	QUANTITY	UNIT
201.23	REMOVING SINGLE TREE TOP ONLY	3	EA
201.24	REMOVING STUMP	3	EA
202.08	REMOVING BUILDING NO. 1	1	LS
202.20	REMOVING BITUMINOUS CONCRETE PAVEMENT	765	SY
202.202	REMOVING PAVEMENT SURFACE	2,400	SY
203.20	COMMON EXCAVATION	1,025	CY
304.10	AGGREGATE SUBBASE COURSE - GRAVEL	770	CY
403.2081	HOT MIX ASPHALT 12.5 MM SURFACE (POLYMER MODIFIED)	340	TON
403.213	HOT MIX ASPHALT 12.5 MM BASE	320	TON
409.15	BITUMINOUS TACK COAT - APPLIED	50	GAL
502.341	STRUCTURAL CONCRETE ROADWAY MEDIAN	15	CY
604.092	CATCH BASIN TYPE B1-C	1	EA
604.16	ALTER CATCH BASIN TO MANHOLE	1	EA
604.18	ADJUSTING MANHOLE OR CATCH BASIN TO GRADE	2	EA
604.182	CLEAN EXISTING CATCH BASIN AND MANHOLE	2	EA
605.09	6 INCH UNDERDRAIN TYPE B	528	LF
605.11	12 INCH UNDERDRAIN TYPE C	226	LF
606.356	UNDERDRAIN DELINEATOR POST	5	EA
609.31	CURB TYPE 3	1,200	LF
615.07	LOAM	155	CY
618.13	SEEDING METHOD NUMBER 1	13	UN
627.733	4 INCH WHITE OR YELLOW PAINTED PAVEMENT MARKING LINE	2,550	LF
627.75	WHITE OR YELLOW PAVEMENT AND CURB MARKING	205	SF
627.78	TEMP 4 INCH PAINT PAVEMENT MARKING LINE	4,535	LF
629.05	HAND LABOR STRAIGHT TIME	10	HR
631.12	ALL PURPOSE EXCAVATOR	10	HR
631.172	TRUCK - LARGE (INCLUDING OPERATOR)	20	HR
631.2	TRUCK - LARGE (INCLUDING OPERATOR)	10	HR
631.32	CULVERT CLEANER (INCLUDING OPERATOR)	10	HR
639.19	FIELD OFFICE TYPE B	1	EA
643.60	FLASHING BEACON AT: ROUTE 2/ANNIS RD.	1	LS
645.106	DEMOUNT REGULATORY, WARNING, CONFIRMATION AND ROUTE MARKING ASSEMBLY SIGNS	2	EA
645.116	REINSTALL REGULATORY, WARNING, CONFIRMATION AND ROUTE MARKING ASSEMBLY SIGN	2	EA
645.292	REGULATORY, WARNING, CONFIRMATION AND ROUTE MARKING ASSEMBLY SIGNS, TYPE II	4.5	SF
652.33	DRUM	10	EA
652.34	CONE	75	EA
652.35	CONSTRUCTION SIGNS	335	SF
652.36	MAINTENANCE OF TRAFFIC CONTROL DEVICES	88	CD
652.38	FLAGGER	3,300	HR
656.75	TEMPORARY SOIL EROSION AND POLLUTION CONTROL	1	LS
659.10	MOBILIZATION	1	LS

EARTHWORK SUMMARY

COMMON EXCAVATION FOR ESTIMATE

COMMON EXCAVATION (FROM MODEL OR PLANS)	1025
TOTAL COMMON EXCAVATION	1025

FILL FOR BORROW CALCULATIONS

COMMON FILL (FROM MODEL OR PLANS)	153
TOTAL FILL	153

ROCK EXCAVATION FOR ESTIMATE

TOTAL ROCK EXCAVATION	0
------------------------------	----------

AVAILABLE COMMON EXCAVATION FOR BORROW CALCULATIONS

ALL DEDUCTIONS:	
GRUBBING IN CUT	97
PAVEMENT SALVAGE (CUT & FILL)	70
TOTAL DEDUCTIONS	167
TOTAL AVAILABLE COMMON EXCAVATION (-) TOTAL DEDUCTIONS	858
TOTAL AVAILABLE STRUCTURAL EXCAVATION (UNDERDRAIN ONLY)	234
TOTAL AVAILABLE NON-ROCK EXCAVATION	1092

COMPUTATION OF WASTE STORAGE & WASTE MATERIAL

TOTAL AVAILABLE WASTE STORAGE AREA (FROM CROSS SECTIONS)	0
GRUBBING IN CUT	97
TOTAL WASTE MATERIAL	97
TOTAL WASTE MATERIAL TO BE UTILIZED*	0
TOTAL WASTE MATERIAL TO BE WASTED	97

COMPUTATION FOR GRANULAR BORROW FOR ESTIMATE

TOTAL GRANULAR BORROW	0
------------------------------	----------

COMPUTATION FOR SURPLUS MATERIAL OR COMMON BORROW FOR ESTIMATE

TOTAL AVAILABLE NON-ROCK EXCAVATION	1092	x 0.90	= 983
TOTAL WASTE MATERIAL TO BE UTILIZED	0	x 0.90	= 0
TOTAL AVAILABLE EXCAVATION	983		
BORROW NEEDED = TOTAL FILL (-) TOTAL AVAILABLE EXCAVATION	0		
IF NO BORROW IS NEEDED, SURPLUS MATERIAL = AVAILABLE EXCAVATION (-) TOTAL FILL, (+)			
TOTAL WASTE MATERIAL TO BE WASTED	927		

SURPLUS MATERIAL

SURPLUS MATERIAL	927 CY
GRANULAR BORROW IN LOW WET AREAS	0
GRANULAR BORROW TO MAINTAIN TRAFFIC	0
BORROW NEEDED (-) REQUIRED GRANULAR BORROW WITHIN FILL	0

COMMON BORROW	0 CY
----------------------	-------------

STATE OF MAINE
DEPARTMENT OF TRANSPORTATION
2287900
WIN
228795.00
HIGHWAY PLANS

PROJ. MANAGER	DATE
RHOBE MOULTON	
C. SULLOWAY	
CHECKED-REVIEWED	SIGNATURE
DESIGN-DETAILED	
DESIGN-DETAILED2	P.E. NUMBER
REVISIONS 1	
REVISIONS 2	DATE
REVISIONS 3	
REVISIONS 4	
FIELD CHANGES	

HERMON
ROUTE 2 \ ANNIS ROAD
ESTIMATED QUANTITIES

SHEET NUMBER
3
OF 26

GENERAL NOTES

1. CLEARING LIMITS SHALL BE 10 FEET BEYOND AND PARALLEL TO THE CONSTRUCTION SLOPE LINES OR AS SHOWN ON THE PLANS UNLESS OTHERWISE AUTHORIZED BY THE RESIDENT.
2. ALL CLEARING SHALL BE CONSIDERED INCIDENTAL TO THE CONTRACT AND NO SEPARATE PAYMENT WILL BE MADE. THE ACTUAL LINES FOR CLEARING SHALL BE ESTABLISHED IN THE FIELD BY THE CONTRACTOR AS INDICATED ON THE PLANS AND APPROVED BY THE RESIDENT.
3. GRUBBING IN FILL AREAS HAS BEEN SHOWN ON THE CROSS SECTIONS AND THE QUANTITIES NOTED. THESE LIMITS ARE APPROXIMATE AND HAVE BEEN USED FOR ESTIMATING PURPOSES ONLY. ACTUAL GRUBBING LIMITS MAY VARY BASED ON FIELD CONDITIONS AS DIRECTED BY THE RESIDENT.
4. PRIOR TO REMOVING ANY PAVEMENT OR PLACING ANY SHIM PAVEMENT, THE ROADWAY WILL BE INSPECTED FOR POSSIBLE SUBSURFACE BOULDERS, WHICH WILL BE REMOVED AS DIRECTED BY THE RESIDENT. PAYMENT WILL BE MADE UNDER APPROPRIATE CONTRACT RENTAL ITEMS. BACKFILL WILL BE PLACED TO SUBGRADE WITH MATERIAL CONSISTENT WITH THE SURROUNDING MATERIAL. AGGREGATE SUBBASE COURSE GRAVEL WILL BE PLACED FROM SUBGRADE TO FINISH GRADE AND WILL BE PAID UNDER THE APPROPRIATE ITEM.
5. ALL INSLOPE AND DITCHES IN CUT AREAS SHALL BE GRADED AS SHOWN ON THE TYPICALS OR FLATTER, OR AS DIRECTED BY THE RESIDENT.
6. THE CONTRACTOR SHALL PLAN AND CONDUCT WORK SO THAT UPON COMPLETION OF THE PROJECT THERE IS NO DROP-OFF FROM THE EDGE OF THE SHOULDER PAVEMENT.
7. ALL WASTE MATERIAL NOT USED ON THE PROJECT SHALL BE DISPOSED OF OFF THE PROJECT IN ACCEPTABLE WASTE AREAS REVIEWED BY THE RESIDENT. GRADING, SEEDING AND MULCHING OF WASTE AREAS SHALL BE CONSIDERED INCIDENTAL.
8. GRANULAR BORROW USED TO BACKFILL MUCK EXCAVATION OR IN LOW WET AREAS TO 1 FOOT ABOVE WATER LEVEL OR OLD GROUND SHALL MEET REQUIREMENTS FOR GRANULAR BORROW MATERIAL FOR UNDERWATER BACKFILL AS SPECIFIED IN STANDARD SPECIFICATIONS ITEM 703.19, GRANULAR BORROW.
9. EXISTING INSLOPES IN PROPOSED FILL AREAS SHALL BE BENCHED BY EXCAVATING STEPS OF SUFFICIENT WIDTH TO PERMIT PLACING AND COMPACTING THE FILL MATERIAL ALONG WITH THE MATERIAL REMOVED.
10. ANY NECESSARY CLEANING OF EXISTING PAVEMENT PRIOR TO PAVING (OR MILLING) SHALL BE INCIDENTAL TO THE RELATED PAVING (OR MILLING) ITEMS. THIS INCLUDES KILLING AND REMOVAL OF ALL VEGETATIVE MATTER.
11. PRIOR TO SURFACE PAVING, EXISTING CULVERTS TO REMAIN SHALL BE CLEANED AS DIRECTED BY THE RESIDENT. PAYMENT WILL BE MADE UNDER STANDARD SPECIFICATIONS ITEM 631.32, CULVERT CLEANER (INCLUDING OPERATOR).
12. EXISTING CULVERTS AND CATCH BASINS WILL BE CLEANED AS DIRECTED BY THE RESIDENT UNDER THE APPROPRIATE PAY ITEMS.
13. NO EXISTING DRAINAGE SHALL BE ABANDONED, REMOVED OR PLUGGED WITHOUT PRIOR APPROVAL OF THE RESIDENT.
14. INLETS AND OUTLETS OF ALL CULVERTS SHALL BE RIPRAPPED UNLESS OTHERWISE NOTED ON THE PLANS OR DIRECTED BY THE RESIDENT.
15. FLAT TOPS FOR CATCH BASINS ARE NOT ALLOWED UNLESS NOTED ON THE PLANS OR DIRECTED BY THE RESIDENT.
16. PLASTIC END CAPS SHALL BE PLACED ON THE INLET END OF ALL DEAD-END 6-INCH TYPE B UNDERDRAIN AND SHALL BE CONSIDERED INCIDENTAL TO THIS ITEM.
17. ANY NECESSARY CUTTING OF EXISTING PIPES TO FIT IN AREAS OF PROPOSED CATCH BASINS WILL NOT BE PAID FOR SEPARATELY AND WILL BE CONSIDERED INCIDENTAL TO STANDARD SPECIFICATIONS SECTION 604, MANHOLES, INLETS AND CATCH BASINS.
18. ANY NECESSARY CUTTING OF EXISTING CATCH BASINS TO ALLOW FOR PROPOSED PIPE CONNECTIONS WILL NOT BE PAID FOR SEPARATELY AND WILL BE CONSIDERED INCIDENTAL TO STANDARD SPECIFICATIONS SECTION 603, PIPE CULVERTS AND STORM DRAINS OR STANDARD SPECIFICATIONS SECTION 605, UNDERDRAINS.
19. A DELINEATOR POST (STANDARD SPECIFICATIONS ITEM 606.356, UNDERDRAIN DELINEATOR POST) WILL BE INSTALLED AT EACH END OF EACH RUN OF BITUMINOUS CURB.
20. LOAM HAS BEEN ESTIMATED FOR DISTURBED LAWN AREAS. ACTUAL PLACEMENT OF THE LOAM SHALL BE AS NOTED ON THE PLANS OR DESIGNATED BY THE RESIDENT.
21. LOAM SHALL BE PLACED TO A NOMINAL DEPTH OF 4 INCHES IN LAWN AREAS AND 2 INCHES IN ALL OTHER AREAS UNLESS OTHERWISE NOTED OR DIRECTED.
22. ANY BASE PAVEMENT NOT SURFACED BEFORE WINTER WILL REQUIRE TEMPORARY PAVEMENT MARKINGS OF PAINT, BOTH YELLOW CENTERLINE AND WHITE EDGE LINES AND WILL BE CONSIDERED PART OF STANDARD SPECIFICATIONS ITEM 627.78, TEMPORARY PAVEMENT MARKING LINE, WHITE OR YELLOW.
23. THE CONTRACTOR WILL BE RESPONSIBLE FOR MAINTAINING ALL EXISTING MAILBOXES TO ENSURE THAT THE MAIL WILL BE DELIVERABLE. PAYMENT FOR THIS WORK WILL BE CONSIDERED INCIDENTAL TO THE CONTRACT
24. THE CONTRACTOR WILL BE RESPONSIBLE FOR MAINTAINING ALL EXISTING OPERATIONAL BUSINESS DIRECTIONAL SIGNS (OBDS) TO ENSURE THAT THEY ARE VISIBLE TO THE TRAVELING PUBLIC. PAYMENT FOR THIS WORK WILL BE CONSIDERED INCIDENTAL TO THE CONTRACT.
25. ANY DAMAGE TO THE SLOPES CAUSED BY THE CONTRACTOR'S EQUIPMENT, PERSONNEL, OR OPERATION SHALL BE REPAIRED TO THE SATISFACTION OF THE RESIDENT. ALL WORK, EQUIPMENT, AND MATERIALS REQUIRED TO MAKE REPAIRS SHALL BE AT THE CONTRACTOR'S EXPENSE.
26. AREAS ON THE PROJECT REQUIRING FILL WILL COME FROM SUITABLE SITES SUCH AS EXCAVATION, DITCH AND INSLOPE OR EQUIPMENT RENTAL AREAS.
27. NO SEPARATE PAYMENT FOR SUPERINTENDENT OR FOREMAN WILL BE MADE FOR THE SUPERVISION OF EQUIPMENT AND LAYOUT OF WORK BEING PAID FOR UNDER THE EQUIPMENT RENTAL ITEMS.
28. "UNDETERMINED LOCATIONS" SHALL BE DETERMINED BY THE RESIDENT.
29. FINAL STRIPING FOR THE PROJECT SHALL BE DONE BY THE CONTRACTOR PER THE STRIPING LAYOUT IN THE CONTRACT DOCUMENTS OR AS PROVIDED BY THE DEPARTMENT. PAYMENT SHALL BE MADE UNDER APPROPRIATE CONTRACT ITEMS.
30. THE CONTRACTOR WILL PLACE APPROPRIATELY-MARKED STAKES AT THE FOLLOWING LOCATIONS ON THE PROJECT: STRIPING PATTERN CHANGES, CROSS-SLOPE CHANGES, AND EVERY 500 FEET FOR STATIONING. THE CONTRACTOR WILL PAINT EVERY FULL STATION (100 FEET) ON THE EXISTING ROADWAY AND WILL TRANSFER THE PAINTED STATIONING THROUGH ALL INTERMEDIATE LIFTS (NOT SURFACE). APPROPRIATELY-SIZED STRIPING PATTERN CHANGES WILL BE PAINTED ON SURFACE. STATIONING CONTROL MUST BE PLACED BEFORE WORK CAN COMMENCE. CROSS-SLOPE AND STRIPING CHANGE CONTROLS MUST BE PLACED BEFORE PAVING CAN COMMENCE.
31. ALL HMA FOR PATCHING AROUND ADJUSTED, ALTERED, OR REBUILT UTILITY STRUCTURES SHALL BE A 9.5 MM OR 12.5 MM MAINEDOT APPROVED MIX DESIGN. EXCLUDING WATER AND GAS GATE VALVES, THE CONTRACTOR SHALL SAW CUT THE EXISTING PAVEMENT FOR THE PATCH AT LEAST TWO FEET AWAY FROM THE NEAREST EDGE OF THE STRUCTURE. THE CONTRACTOR SHALL PLACE HMA IN LIFTS OF 2 INCHES OR LESS, AS DIRECTED BY THE RESIDENT, AND COMPACT THE HMA USING A MINIMUM OF A 150-POUND PLATE COMPACTOR. HMA FOR PATCHING AROUND ADJUSTED, ALTERED, OR REBUILT UTILITY STRUCTURES IS CONSIDERED INCIDENTAL TO THE RESPECTIVE PAY ITEM FOR ADJUST, ALTER, OR REBUILD UTILITY STRUCTURE.

STATE OF MAINE DEPARTMENT OF TRANSPORTATION	2287900	WIN 22879.00	HIGHWAY PLANS
HERMON ROUTE 2\ANNIS ROAD	SHEET NUMBER	GENERAL NOTES	
4	OF 26		

Date: 6/5/2020

Username: Clark.E.Sullivan

Division: HIGHWAY

Filename: ... \MSTA\004_GeneralNotes.dgn

*NOTE: STRIPING FOR CENTERLINE AND EDGE OF TRAVELWAY NOT SHOWN ON THE STRIPING PLAN SHALL BE DONE IN ACCORDANCE WITH THE TYPICAL SECTIONS AND AS DIRECTED BY THE RESIDENT.

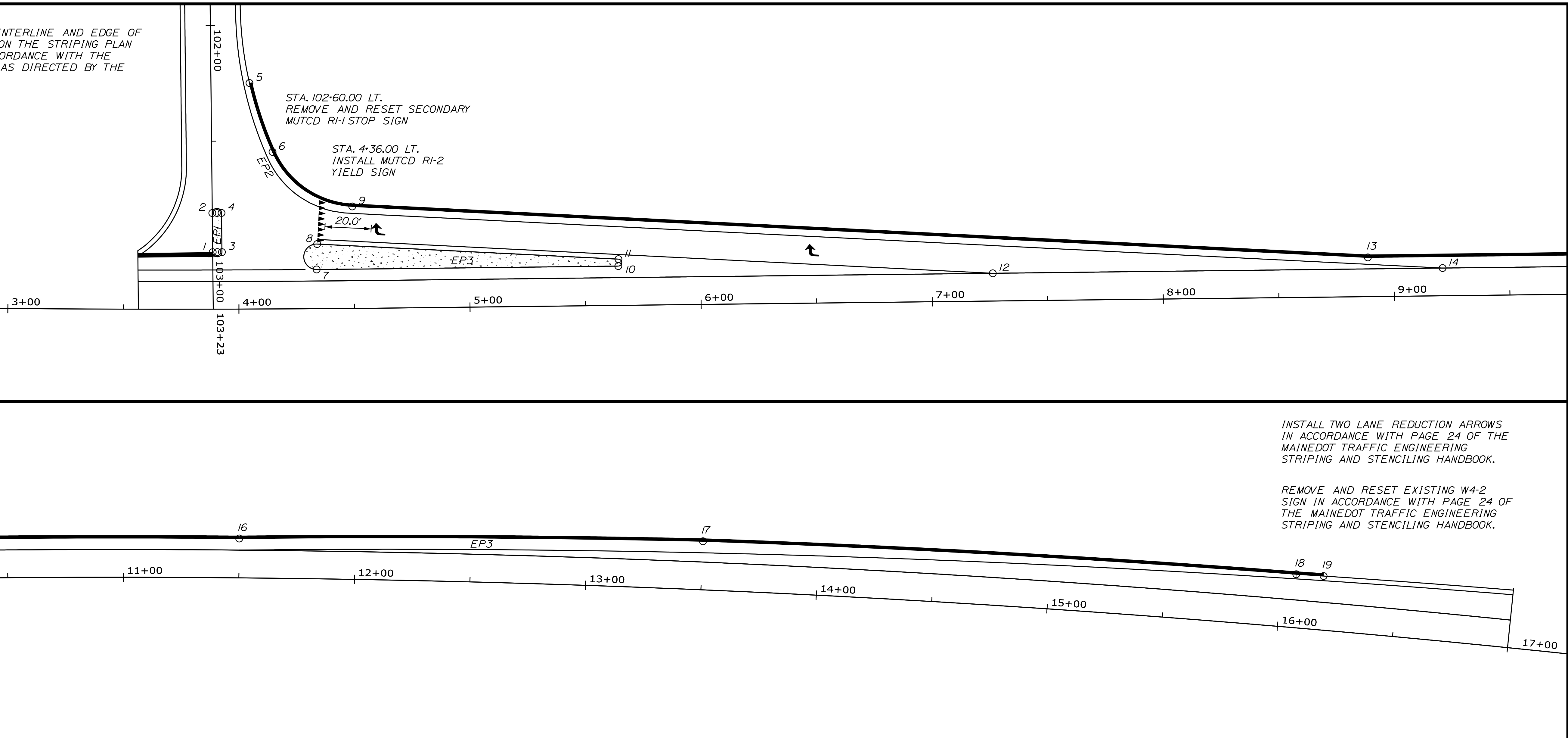
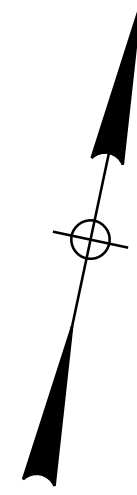

CURVE & CENTER POINT DATA FOR EP2						
PT. to PT.	RADIUS	LENGTH	STATION	OFFSET	X COORD	Y COORD
5-6	160.00'	31.48'	101+90.99	172.9' LT.	1691312.94	477008.67
6-9	40.00'	43.97'	102+38.92	63.0' LT.	1691216.11	476937.93

CURVE & CENTER POINT DATA FOR EP3						
PT. to PT.	RADIUS	LENGTH	STATION	OFFSET	X COORD	Y COORD
7-8	5.50'	17.60'	4+33.72	22.5' LT.	1691211.86	476873.94
10-11	1.50'	4.62'	5+64.35	18.5' LT.	1691340.10	476898.61

CURVE & CENTER POINT DATA FOR EP4						
PT. to PT.	RADIUS	LENGTH	STATION	OFFSET	X COORD	Y COORD
15-16	6027.34'	124.67'	18+65.23	6010.3' RT.	1693112.04	471117.62
16-17	6021.71'	200.68'	19+83.56	5989.2' RT.	1693228.17	471148.16
17-18	6021.83'	257.14'	19+13.51	5996.4' RT.	1693159.03	471135.38
18-19	5973.88'	11.85'	19+80.75	5944.5' RT.	1693221.73	471192.52

ANNIS ROAD CONCRETE ISLAND				
POINT	STATION	OFFSET	X COORD	Y COORD
CONTROL POINTS FOR EPN				
1	102+98.00	0.0' LT.	1691167.51	476866.54
2	102+98.00	4.0' LT.	1691163.82	476883.06
3	102+81.07	0.0' LT.	1691171.41	476867.41
4	102+81.07	4.0' LT.	1691167.72	476883.93

CURB				
POINT	STATION	OFFSET	X COORD	Y COORD
CONTROL POINTS FOR EPN				
5	102+25.00	16.66' LT.	1691167.85	476941.41
6	102+54.91	26.3' LT.	1691183.81	476914.33
9	4+49.41	44.09' LT.	1691222.46	476898.44
13	8+88.71	17.0' LT.	1691656.90	476968.26
15	10+25.65	17.0' LT.	1691790.54	476998.30
16	11+50.00	17.0' LT.	1691912.45	477024.38
17	13+50.00	21.0' LT.	1692108.97	477064.95
18	16+06.19	23.1' LT.	1692363.05	477104.37
19	16+18.00	23.4' LT.	1692374.78	477106.07

GORE				
POINT	STATION	OFFSET	X COORD	Y COORD
CONTROL POINTS FOR EPN				
12	7+26.35	12.0' LT.	1691499.59	476927.79
14	921.00	12.0' LT.	1691689.49	476970.47

ROUTE 2 CONCRETE ISLAND				
POINT	STATION	OFFSET	X COORD	Y COORD
CONTROL POINTS FOR EPN				
7	4+33.72	16.96' LT.	1691213.05	476868.57
8	4+34.03	27.95' LT.	1691210.99	476879.38
10	5+64.35	17.0' LT.	1691340.43	476897.15
11	5+64.44	20.0' LT.	1691339.86	476900.09

STATE OF MAINE
DEPARTMENT OF TRANSPORTATION
2287900
WIN
228795.00
HIGHWAY PLANS

PROJ. MANAGER	BY	DATE	SIGNATURE	P.E. NUMBER	DATE
HERMON	C. SULLOWAY				
DESIGN-DETAILED					
CHECKED-REVIEWED					
DESIGN-DETAILED					
DESIGN-DETAILED					
REVISIONS 1					
REVISIONS 2					
REVISIONS 3					
REVISIONS 4					
FIELD CHANGES					

HERMON
ROUTE 2 \ ANNIS ROAD
STRIPING AND GEOMETRIC PLAN

SHEET NUMBER
6
OF 26

Filename: ... \006_Geometric&StripingPlan.DGN
Division: HIGHWAY
Username: Clark.E.Sulloway
Date: 6/1/2020

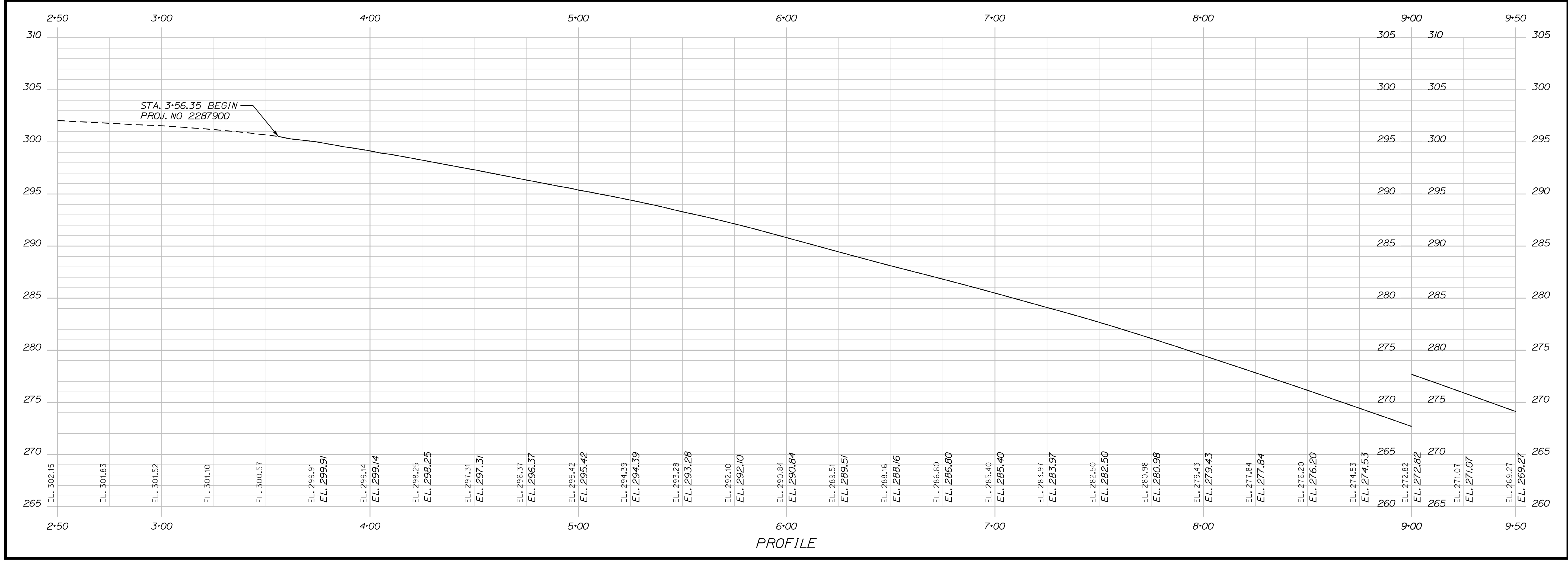
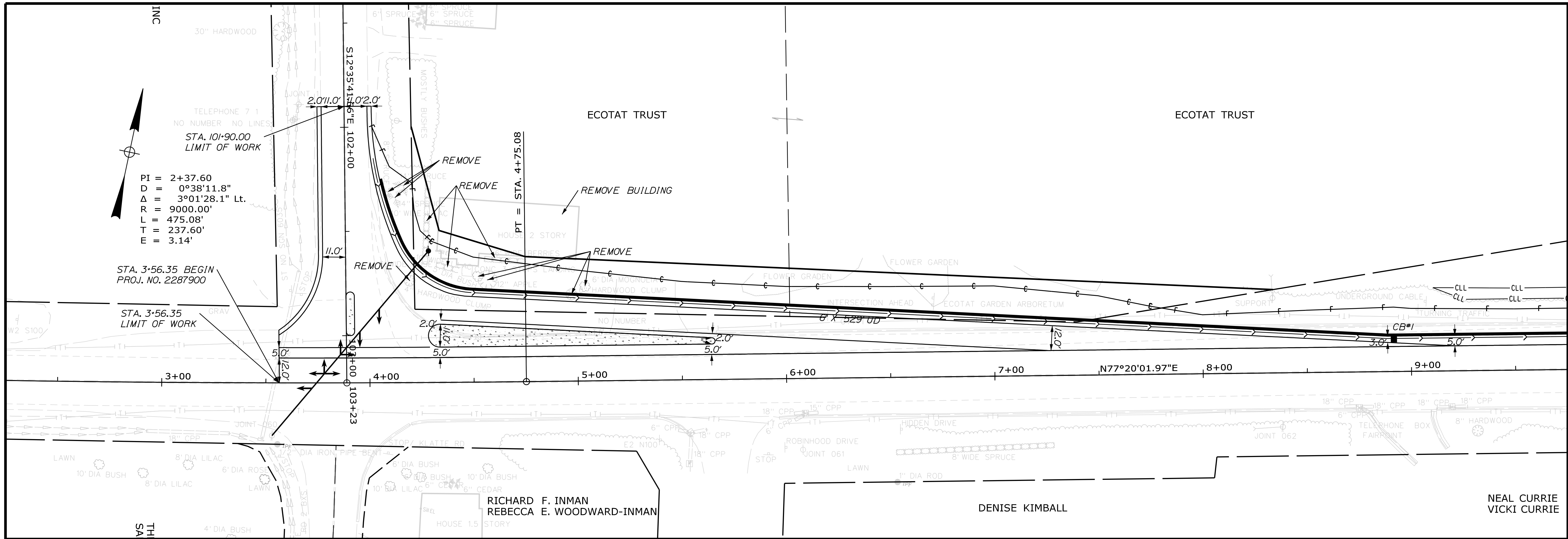

STATE OF MAINE DEPARTMENT OF TRANSPORTATION		2287900
HERMON ROUTE 2 \ ANNIS ROAD		WIN 22879.00
PLANS		HIGHWAY PLANS
SHEET NUMBER		2
OF 26		

PROJ. MANAGER	BY	DATE
HERMON	NEAL CURRIE	
CLARK E. SULLIVAN	VICKI CURRIE	

DESIGN/REVISION	SIGNATURE	P.E. NUMBER	DATE
DESIGN DETAILED			
CHECKED/REVIEWED			
DESIGN DETAILED			
REVISIONS 1			
REVISIONS 2			
REVISIONS 3			
REVISIONS 4			
FIELD CHANGES			

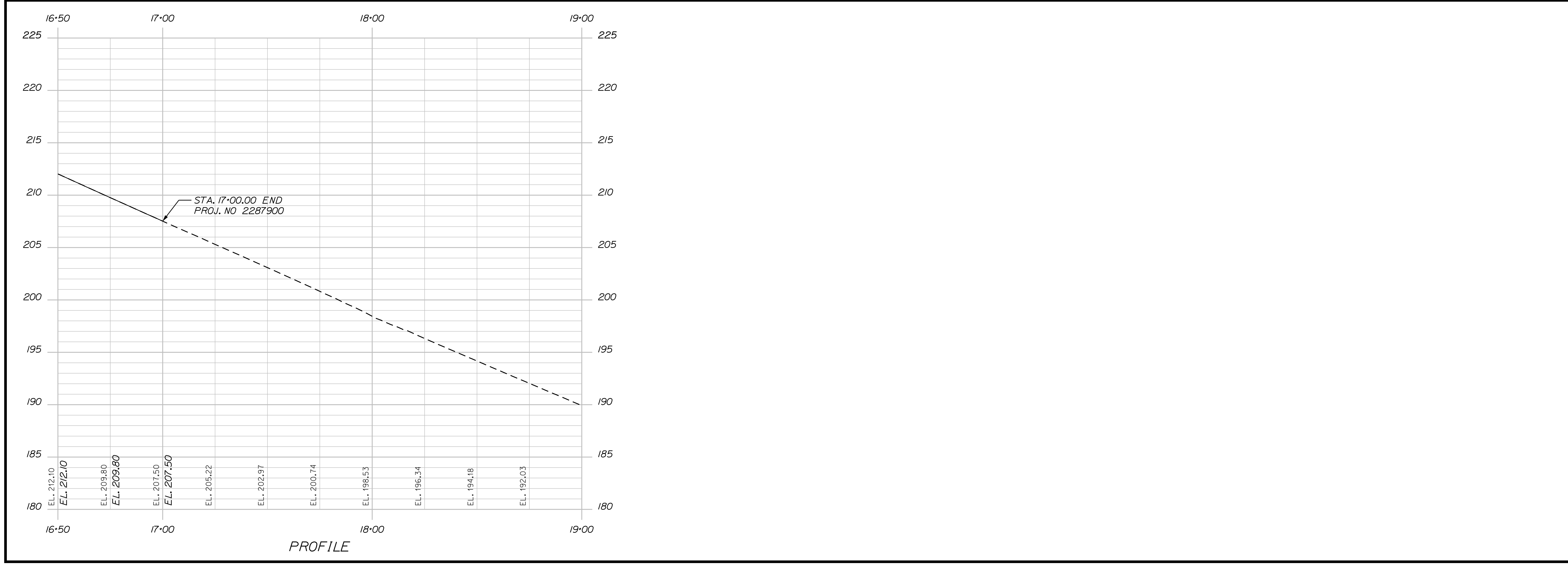
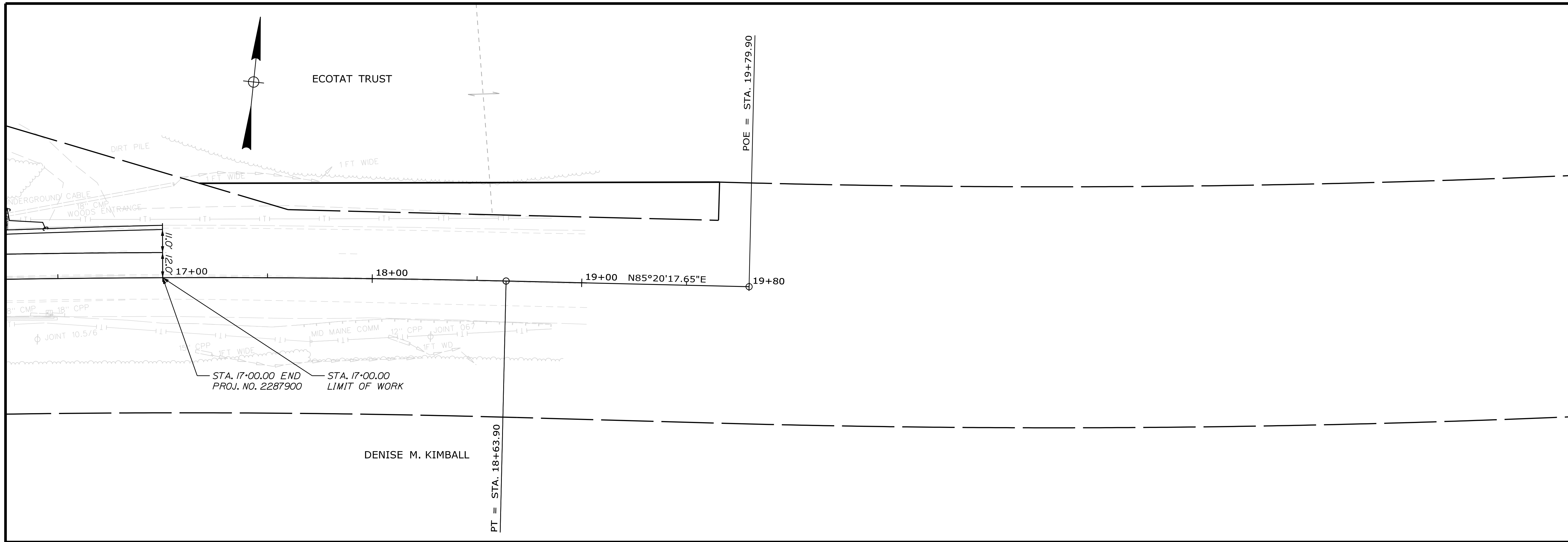

STATE OF MAINE DEPARTMENT OF TRANSPORTATION 2287900 WIN 22879.00 HIGHWAY PLANS
HERMON ROUTE 2 \ ANNIS ROAD PLANS
SHEET NUMBER 9 OF 26

PROJ. MANAGER	BY	DATE
RHODE MOULTON	C. SULLOWAY	
DESIGN-DETAILED		
CHECKED-REVIEWED		
DESIGN-DETAILED		
DESIGN-DETAILED		
REVISIONS 1		
REVISIONS 2		
REVISIONS 3		
REVISIONS 4		
FIELD CHANGES		

SIGNATURE	P.E. NUMBER	DATE

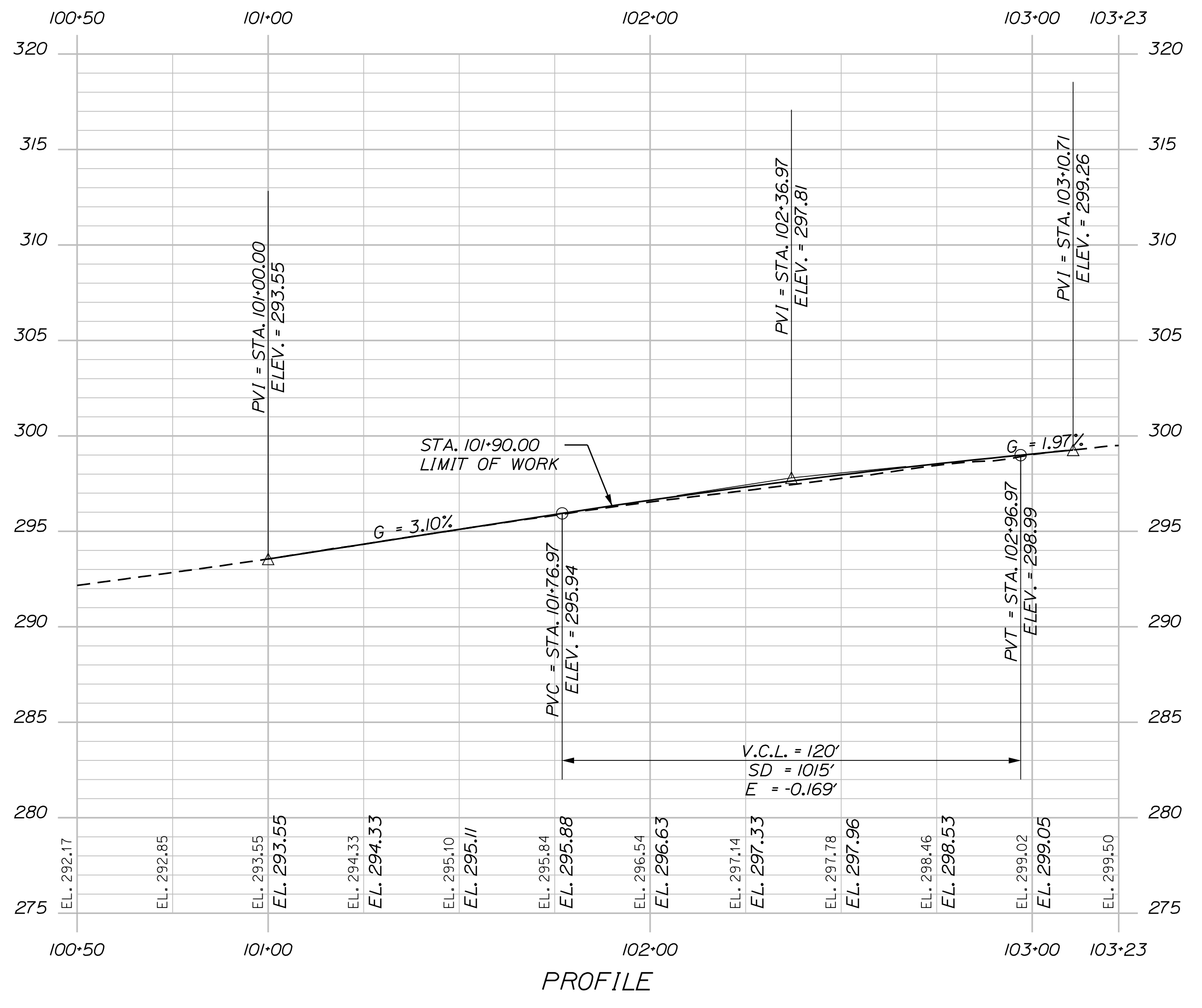

SHEET NUMBER

10

OF 26

HERMON
ROUTE 2 \ ANNIS ROAD
PROFILE

PROJ. MANAGER	RHOBE	MOULTON	BY	DATE
DESIGN-DETAILED	C. SULLOWAY			
CHECKED-REVIEWED				
DESIGN-DETAILED				
REVISIONS 1				
REVISIONS 2				
REVISIONS 3				
REVISIONS 4				
FIELD CHANGES				

SIGNATURE
P.E. NUMBER
DATE

STATE OF MAINE
DEPARTMENT OF TRANSPORTATION
2287900
WIN
22879.00
HIGHWAY PLANS

Date: 6/5/2020

Username: Clark.E.Sullivan

Division: HIGHWAY

Filename: ... \MSTAD01_XSECT_3+50_001.dgn

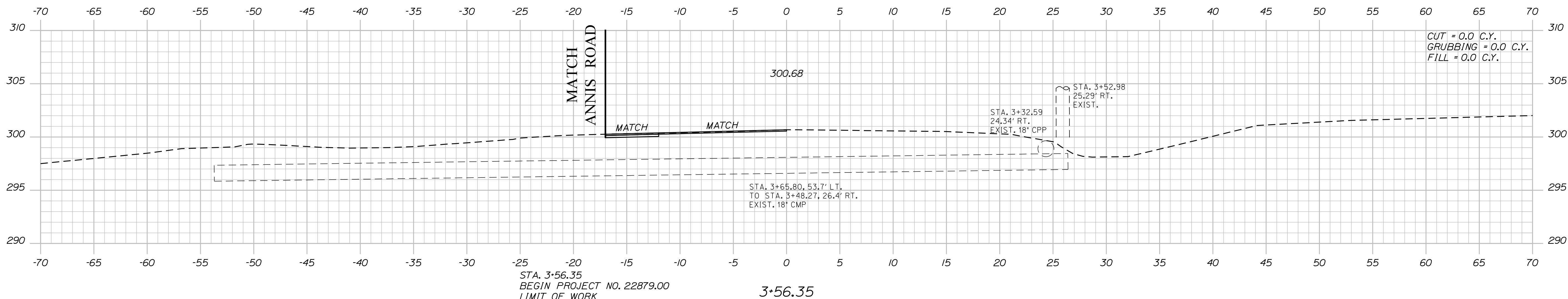
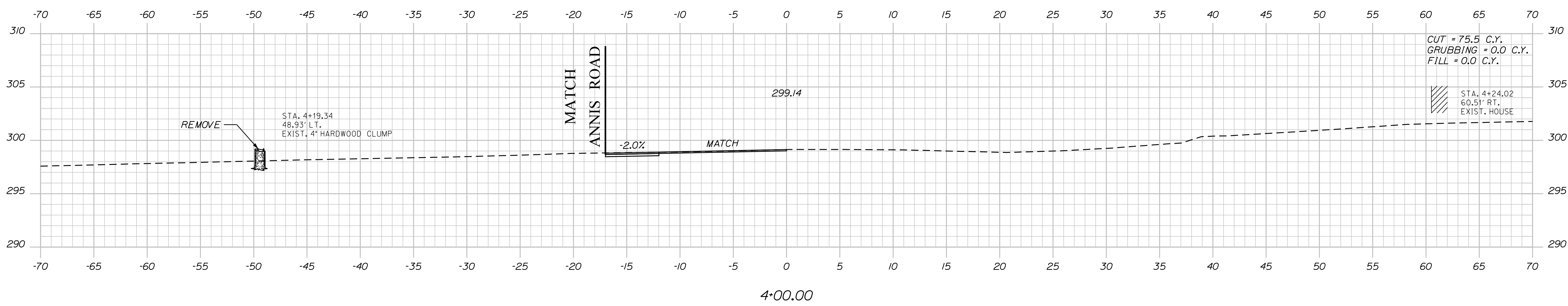
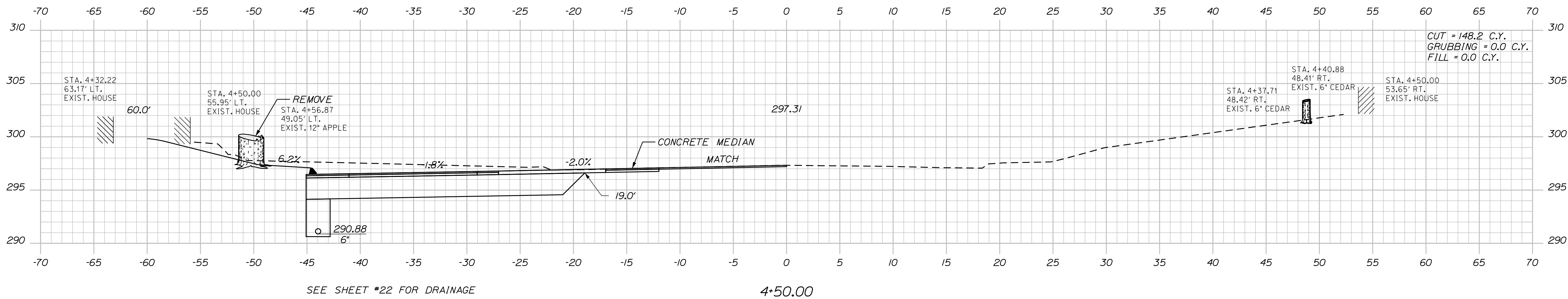

STA. 3+56.35
 BEGIN PROJECT NO. 22879.00
 LIMIT OF WORK

STATE OF MAINE DEPARTMENT OF TRANSPORTATION		2287900	
HERMON ROUTE 2 \ ANNIS ROAD		WIN 22879.00	
CROSS SECTIONS		HIGHWAY PLANS	
SHEET NUMBER		11	
OF 26		OF 26	

PROJ. MANAGER	BY	DATE	SIGNATURE	P.E. NUMBER	DATE
DESIGN-DETAILED	DESIGNER	DATE			
CHECKED-REVIEWED	CHECKER	DATE			
DESIGN-DETAILED	DESIGNER	DATE			
REVISIONS 1					
REVISIONS 2					
REVISIONS 3					
REVISIONS 4					
FIELD CHANGES					

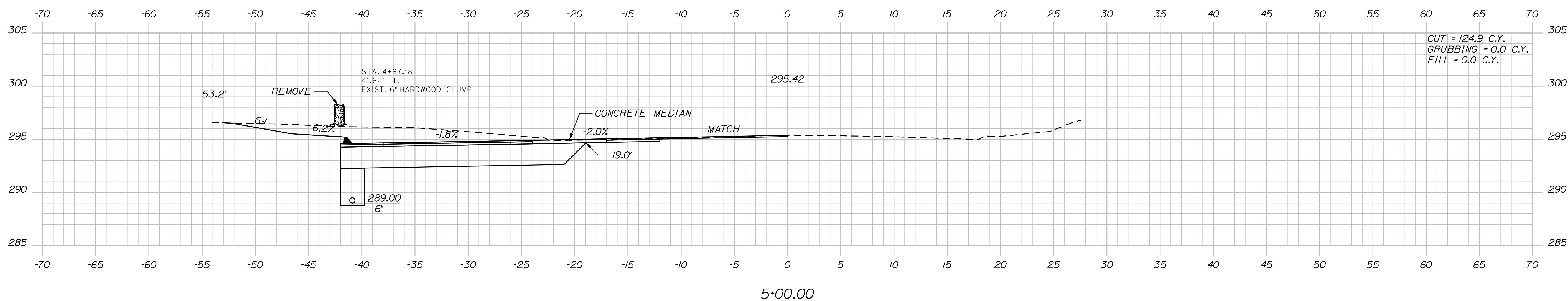
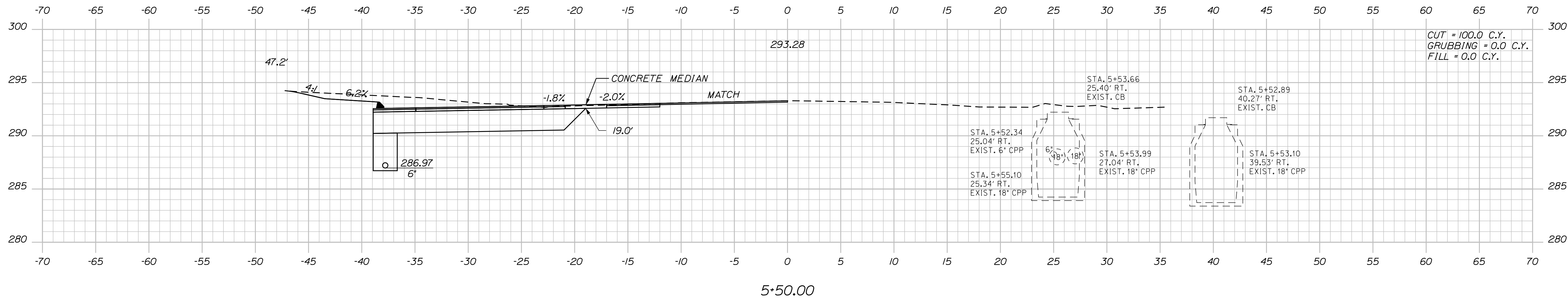
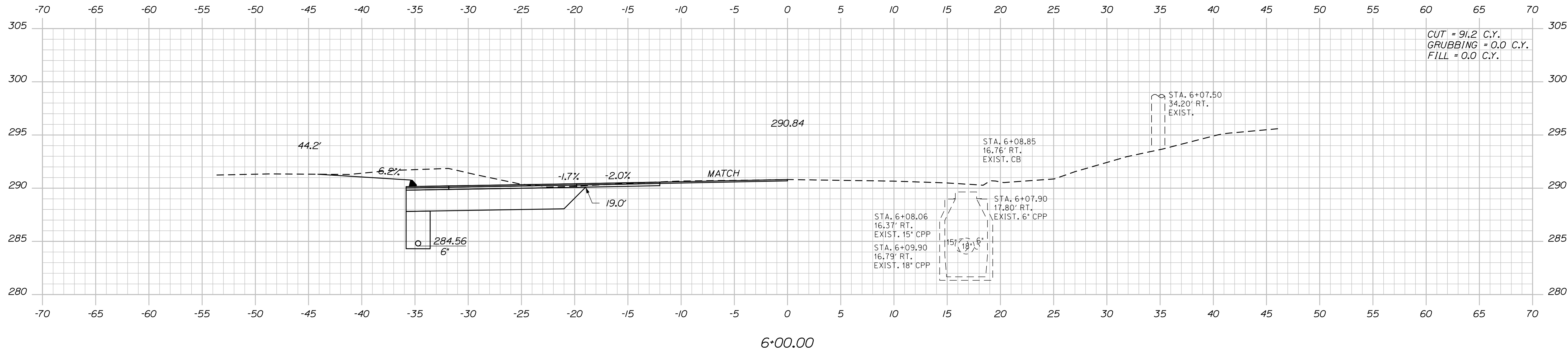

STATE OF MAINE
DEPARTMENT OF TRANSPORTATION

2287900

WIN

228795.00

HIGHWAY PLANS

PROJ. MANAGER	BY	DATE	SIGNATURE
DESIGN-DETAILED	DESIGNER	DATE	
CHECKED-REVIEWED	DESIGNER	DATE	
DESIGN-DETAILED	DESIGNER	DATE	
REVISIONS 1			
REVISIONS 2			
REVISIONS 3			
REVISIONS 4			
FIELD CHANGES			

HERMON
ROUTE 2 \ ANNIS ROAD

CROSS SECTIONS

SHEET NUMBER

12

OF 26

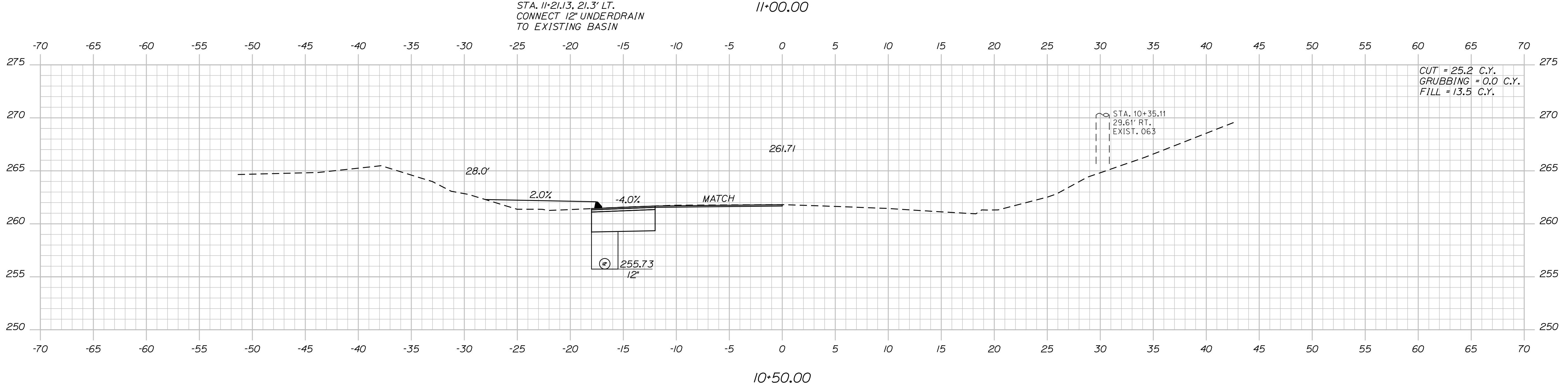
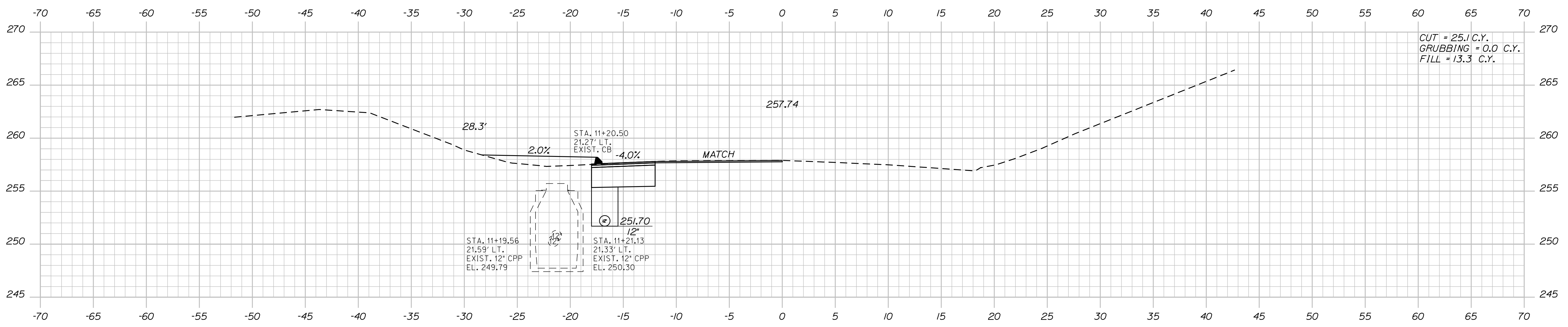
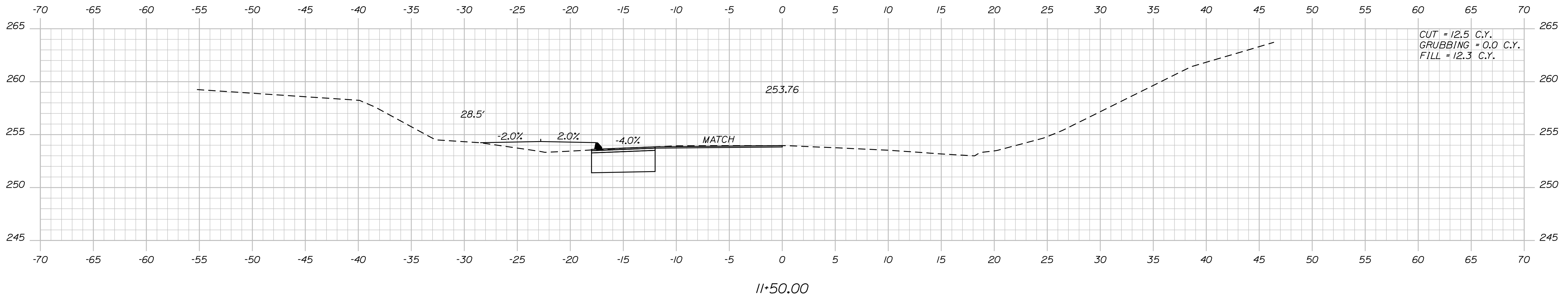

STATE OF MAINE
DEPARTMENT OF TRANSPORTATION
2287900
WIN
228795.00
HIGHWAY PLANS

PROJ. MANAGER	DESIGN-DETAILED	CHECKED-REVIEWED	DESIGN-DETAILED	DESIGN-DETAILED	REVISIONS 1	REVISIONS 2	REVISIONS 3	REVISIONS 4	FIELD CHANGES	BY	DATE	SIGNATURE

HERMON
ROUTE 2 \ ANNIS ROAD
CROSS SECTIONS

SHEET NUMBER
16
OF 26

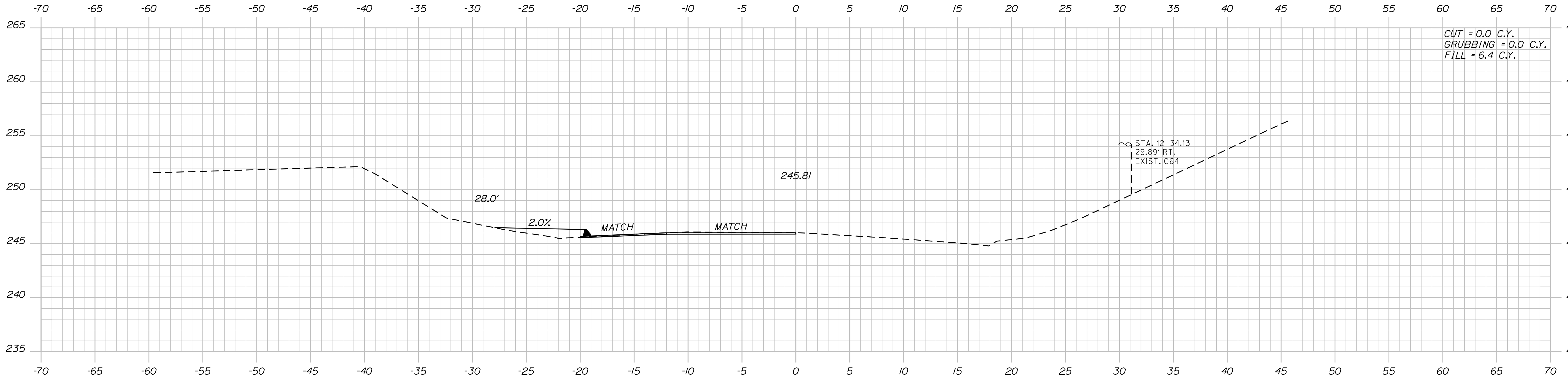

12+50.00

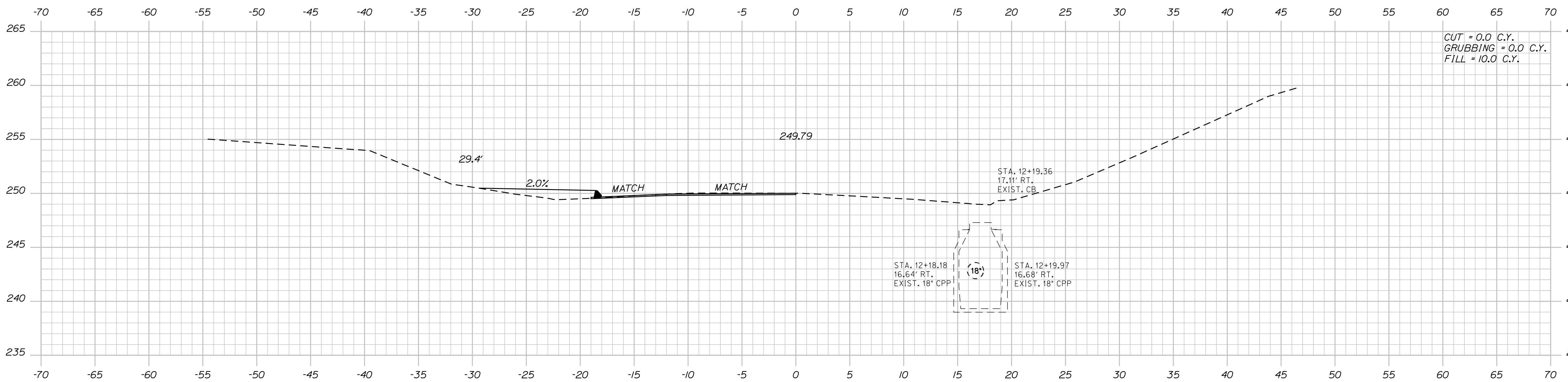

12+00.00

STATE OF MAINE
DEPARTMENT OF TRANSPORTATION

2287900

WIN

22879.00

HIGHWAY PLANS

SIGNATURE

P.E. NUMBER

DATE

DATE

BY

PROJ. MANAGER

CHECKED

DESIGN

DESIGN

REVISIONS

REVISIONS

REVISIONS

REVISIONS

FIELD CHANGES

1

2

3

4

1

17

OF 26

HERMON
ROUTE 2 \ ANNIS ROAD

CROSS SECTIONS

SHEET NUMBER

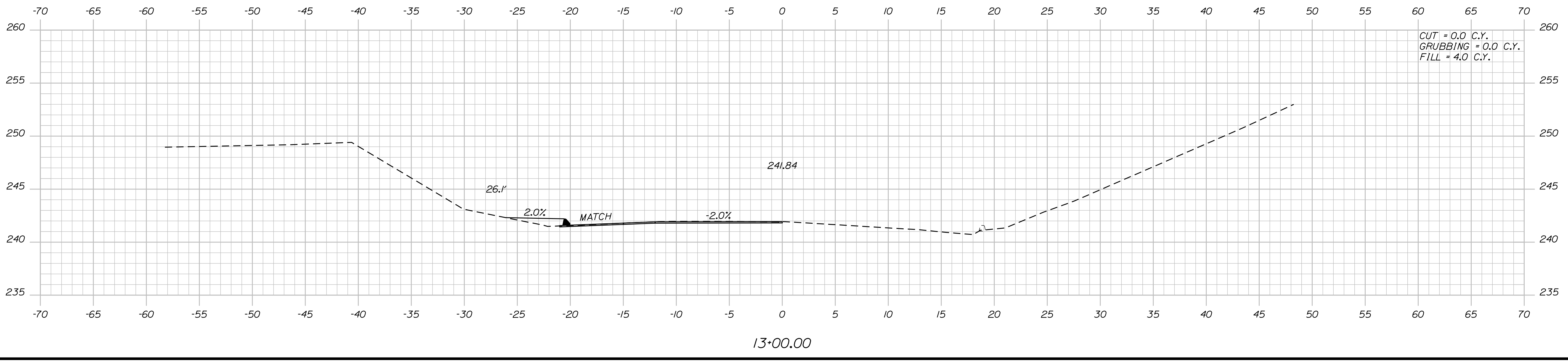
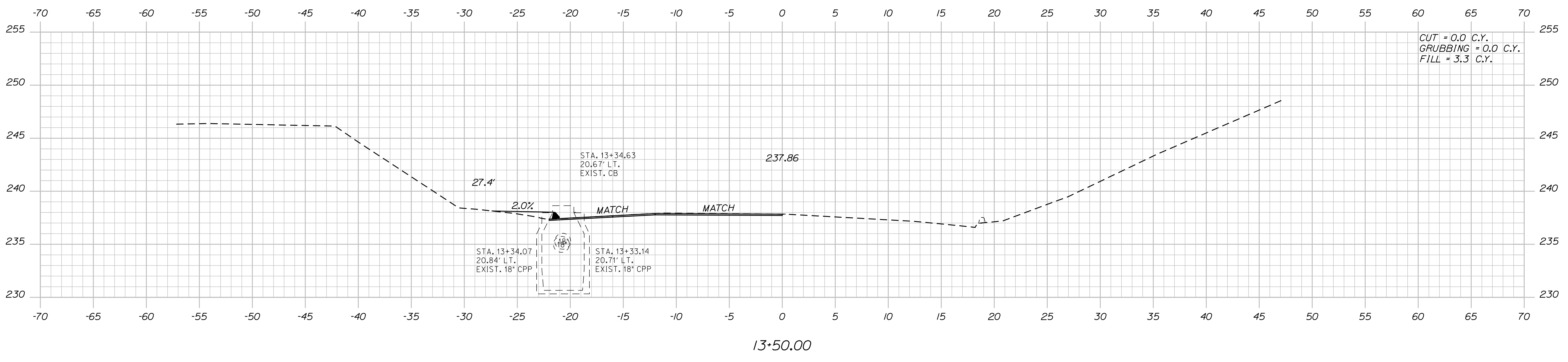
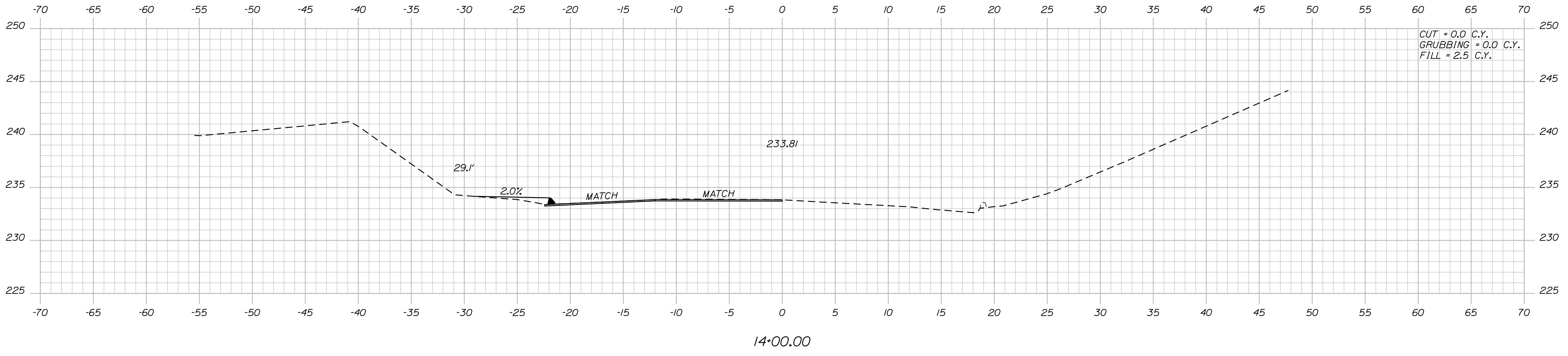

STATE OF MAINE
DEPARTMENT OF TRANSPORTATION
2287900
WIN
22879.00
HIGHWAY PLANS

PROJ. MANAGER	DESIGN-DETAILED	CHECKED-REVIEWED	DESIGN-DETAILED	DESIGN-DETAILED	REVISIONS 1	REVISIONS 2	REVISIONS 3	REVISIONS 4	FIELD CHANGES	PROJ. DATE	BY	DATE	SIGNATURE	P.E. NUMBER	DATE

HERMON
ROUTE 2 \ ANNIS ROAD
CROSS SECTIONS

SHEET NUMBER
18
OF 26

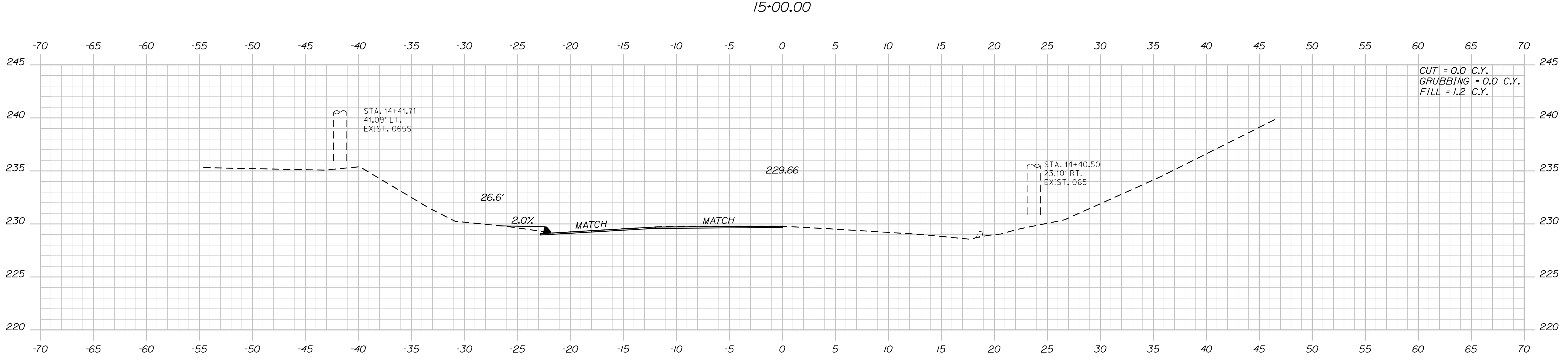
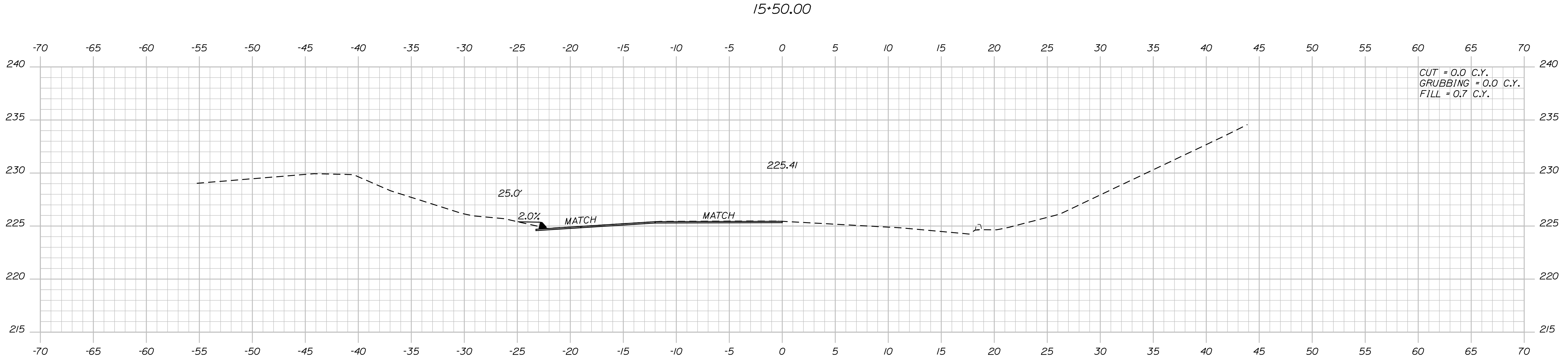
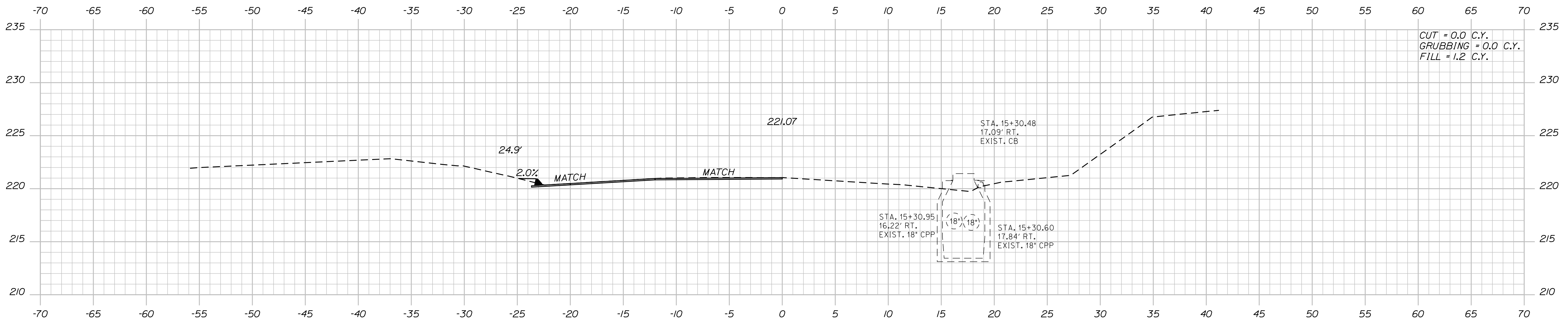

CUT = 0.0 C.Y.
GRUBBING = 0.0 C.Y.
FILL = 1.2 C.Y.

CUT = 0.0 C.Y.
GRUBBING = 0.0 C.Y.
FILL = 0.7 C.Y.

CUT = 0.0 C.Y.
GRUBBING = 0.0 C.Y.
FILL = 1.2 C.Y.

STATE OF MAINE		DEPARTMENT OF TRANSPORTATION		2287900		WIN		HIGHWAY PLANS	
HERMON		ROUTE 2 \ ANNIS ROAD		CROSS SECTIONS		SHEET NUMBER		19	
OF 26		Sta. 14+50.00 to Sta. 15+50.00		PROJ. MANAGER		BY		DATE	
DESIGN DETAILED		DESIGNED		CHECKED		REVIEWED		SIGNATURE	
DESIGN DETAILED		DESIGNED		CHECKED		REVIEWED		P.E. NUMBER	
REVISIONS 1		REVISIONS 2		REVISIONS 3		REVISIONS 4		DATE	
FIELD CHANGES		FIELD CHANGES		FIELD CHANGES		FIELD CHANGES		FIELD CHANGES	

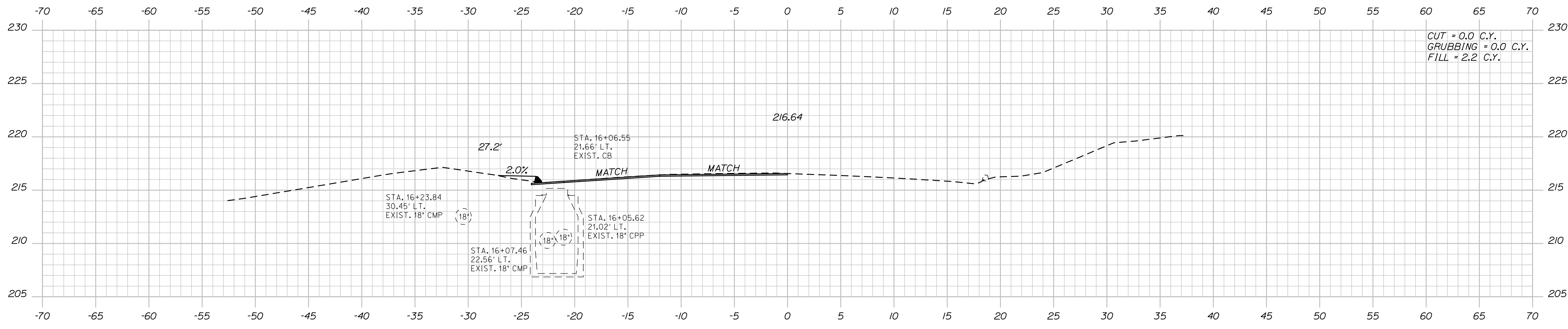
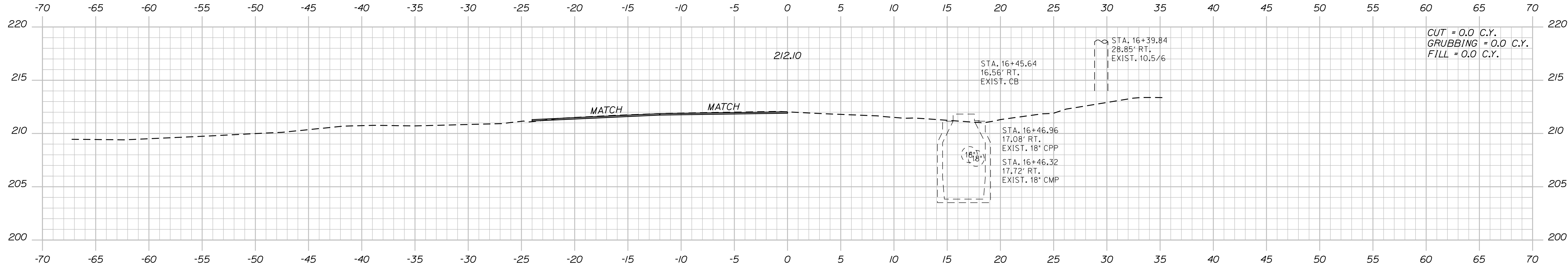

STATE OF MAINE
DEPARTMENT OF TRANSPORTATION
2287900
WIN
22879.00
HIGHWAY PLANS

PROJ. MANAGER	BY	DATE	SIGNATURE
CHECKED-REVIEWED	DESIGNER	DATE	
DESIGN-DET. AILED	DESIGNER	DATE	
REVISIONS 1	DESIGNER	DATE	
REVISIONS 2	DESIGNER	DATE	
REVISIONS 3	DESIGNER	DATE	
REVISIONS 4	DESIGNER	DATE	
FIELD CHANGES	DESIGNER	DATE	

HERMON
ROUTE 2 \ ANNIS ROAD
CROSS SECTIONS

SHEET NUMBER
20
OF 26

Town, County, State _____
 Approx. Property Lines _____ P.L.
 Existing Right of Way _____
 Limits of Wrought Portion _____ L.O.W.P.
 Control Of Access _____ C.O.A.
 New Right of Way _____
 New Easement _____
 New Temporary Rights _____
 New R/W Within Existing R/W _____

New R/W Along Existing R/W _____
 Building _____
 Trees Conifer _____
 Tree Line _____
 Water Edge _____
 Ledge _____
 Fence CHAIN LINK _____
 Sign _____
 Clearing Limit Line CLL _____
 Bush Line _____
 Rock/Boulder _____
 BARB WIRE _____
 Well _____
 Deciduous _____
 Flag Pole _____
 STOCKADE _____
 Mailbox _____

PLAN LEGEND

Sanitary Sewer	Existing	Proposed
Telephone Line	Existing	Proposed
Electric Line	Existing	Proposed
Water Line	Existing	Proposed
Underdrain Line	Existing	Proposed
Gas Line	Existing	Proposed
Guardrail	Existing	Proposed
Culvert	Existing	Proposed

Travelled Way	Existing	Proposed
Ditch	Existing	Proposed
Catch Basin	Existing	Proposed
Manhole	Existing	Proposed
Sewer Manhole	Existing	Proposed
Utility Pole	Existing	Proposed
Fire Hydrant	Existing	Proposed
Curbing	Existing	Proposed

Cut Line	Fill Line
Stonewall	Retaining Wall
Baseline 10+00	11+00
12+00	
Monument	Traverse Point
Iron Rod Found IRF	Pipe Found IPF
Replacement Pin Set	

STATE OF MAINE
 REGISTRY OF DEEDS

COUNTY RECEIVED _____
 at _____ h _____ m _____ M and recorded in
 Plan Book _____, Page _____
 Attest: _____ REGISTER

THIS PLAN WAS PREPARED IN CONNECTION WITH THE DEPARTMENT'S ACQUISITION OF REAL PROPERTY FOR TRANSPORTATION PURPOSES. IT CANNOT BE USED TO ESTABLISH LEGAL BOUNDARIES BETWEEN ADJACENT PROPERTY OWNERS.

25 0 25 50 75 100
 Scale of Feet

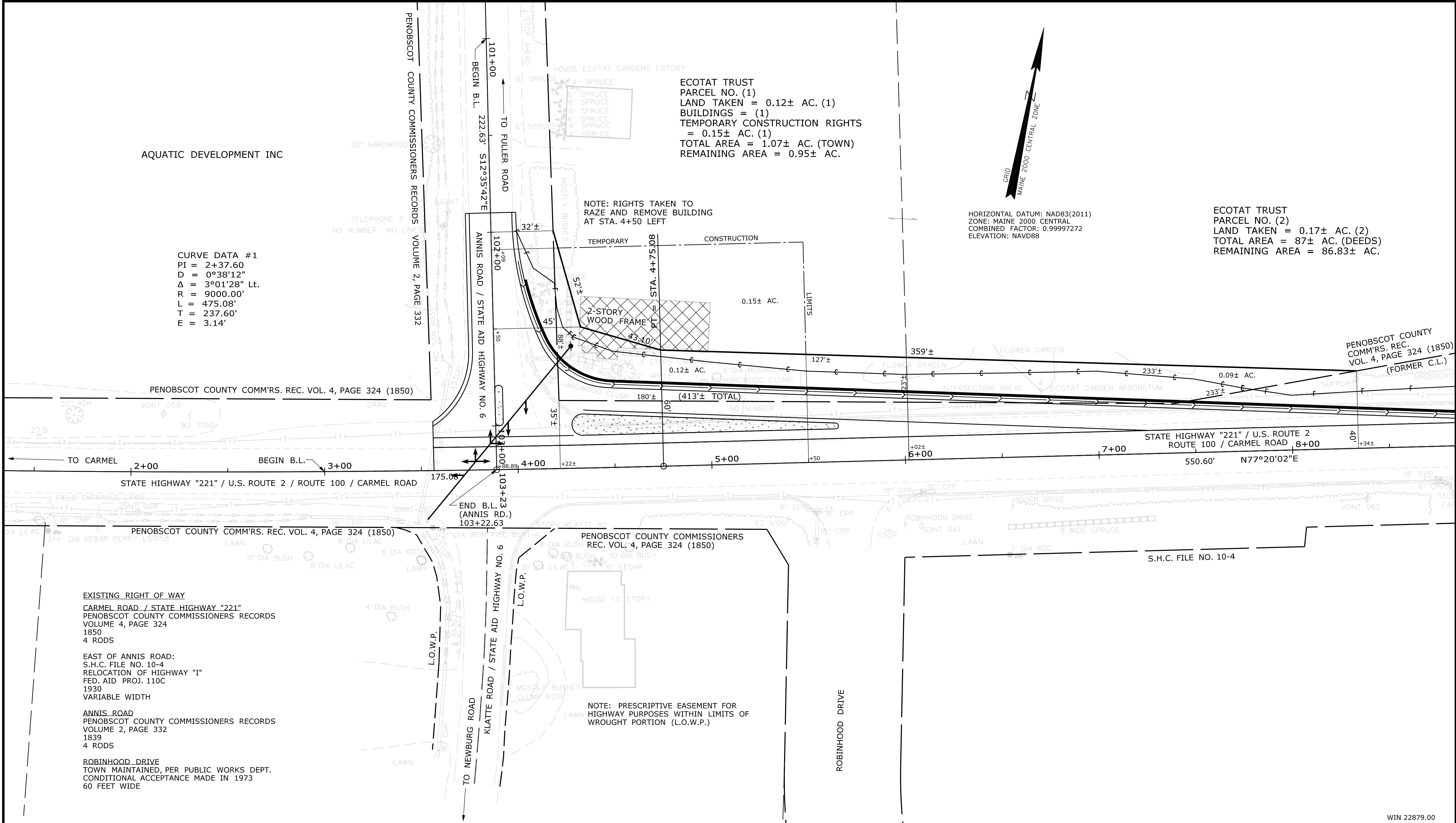

STATE OF MAINE DEPARTMENT OF TRANSPORTATION 16 STATE HOUSE STATION - AUGUSTA, ME 04333-0016 - 207-624-3460	HERMON RIGHT OF WAY MAP	TECH	CHECKED
		EXISTING CONDITION PLAN	B.S.
		FINAL RIGHT OF WAY	B.S.
		AREAS	B.S.

REVISIONS			PLAN FILED IN PLAN BOOK				PAGE COUNTY RECORD				
NO.	DATE	DESCRIPTION	BY	NO.	GRANTOR	INSTRUMENT	DATE	BOOK	PAGE		

BRUCE A. VAN NOTE
 COMMISSIONER
 JOYCE NOEL TAYLOR
 CHIEF ENGINEER

DATE _____

STATE HWY. "221" & STATE AID HWY. NO. 6
 U.S. RT. 2 / RT 100 / CARMEL ROAD & ANNIS ROAD
 HERMON PENOBSCOT COUNTY
 FEDERAL AID PROJECT NO. 2287900

DECEMBER 2019 RIGHT-OF-WAY MAP
 SCALE 1" = 25' SHEET 1 OF 3

D.O.T. FILE NO. 10-518

SHEET NUMBER
24
 OF 26

Date: 5/14/2020

Username: Benjamin.Singer

Division: ROW

Filename: ... \00\ROW\MSTA\001_RWPLAN1.dgn

WIN 22879.00

Town, County, State _____
 Approx. Property Lines _____
 Existing Right of Way _____
 Limits of Wrought Portion _____
 Control Of Access _____
 New Right of Way _____
 New Easement _____
 New Temporary Rights _____
 New R/W Within Existing R/W _____

New R/W Along Existing R/W _____
 Building _____
 Trees Conifer _____
 Tree Line _____
 Water Edge _____
 Ledge _____
 Fence CHAIN LINK _____
 Sign _____

Clearing Limit Line _____
 Deciduous _____
 Bush Line _____
 Rock/Boulder _____
 Flag Pole _____
 BARB WIRE _____
 STOCKADE _____
 WELL _____
 Mailbox _____

PLAN LEGEND
 Existing Proposed
 Sanitary Sewer _____
 Telephone Line _____
 Electric Line _____
 Water Line _____
 Underdrain Line _____
 Gas Line _____
 Guardrail _____
 Culvert _____
 Traveled Way _____
 Ditch _____
 Catch Basin _____
 Manhole _____
 Sewer Manhole _____
 Utility Pole _____
 Fire Hydrant _____
 Curbing _____

Cut Line _____
 Stonewall _____
 Baseline _____
 Monument _____
 Iron Rod Found _____
 Replacement Pin Set _____
 Fill Line _____
 Retaining Wall _____

 Traverse Point _____
 Pipe Found _____

STATE OF MAINE
 REGISTRY OF DEEDS
 COUNTY _____
 RECEIVED _____
 at _____ h _____ m _____ M and recorded in
 Plan Book _____, Page _____
 Attest: _____ REGISTER

THIS PLAN WAS PREPARED IN CONNECTION WITH THE DEPARTMENT'S ACQUISITION OF REAL PROPERTY FOR TRANSPORTATION PURPOSES. IT CANNOT BE USED TO ESTABLISH LEGAL BOUNDARIES BETWEEN ADJACENT PROPERTY OWNERS.

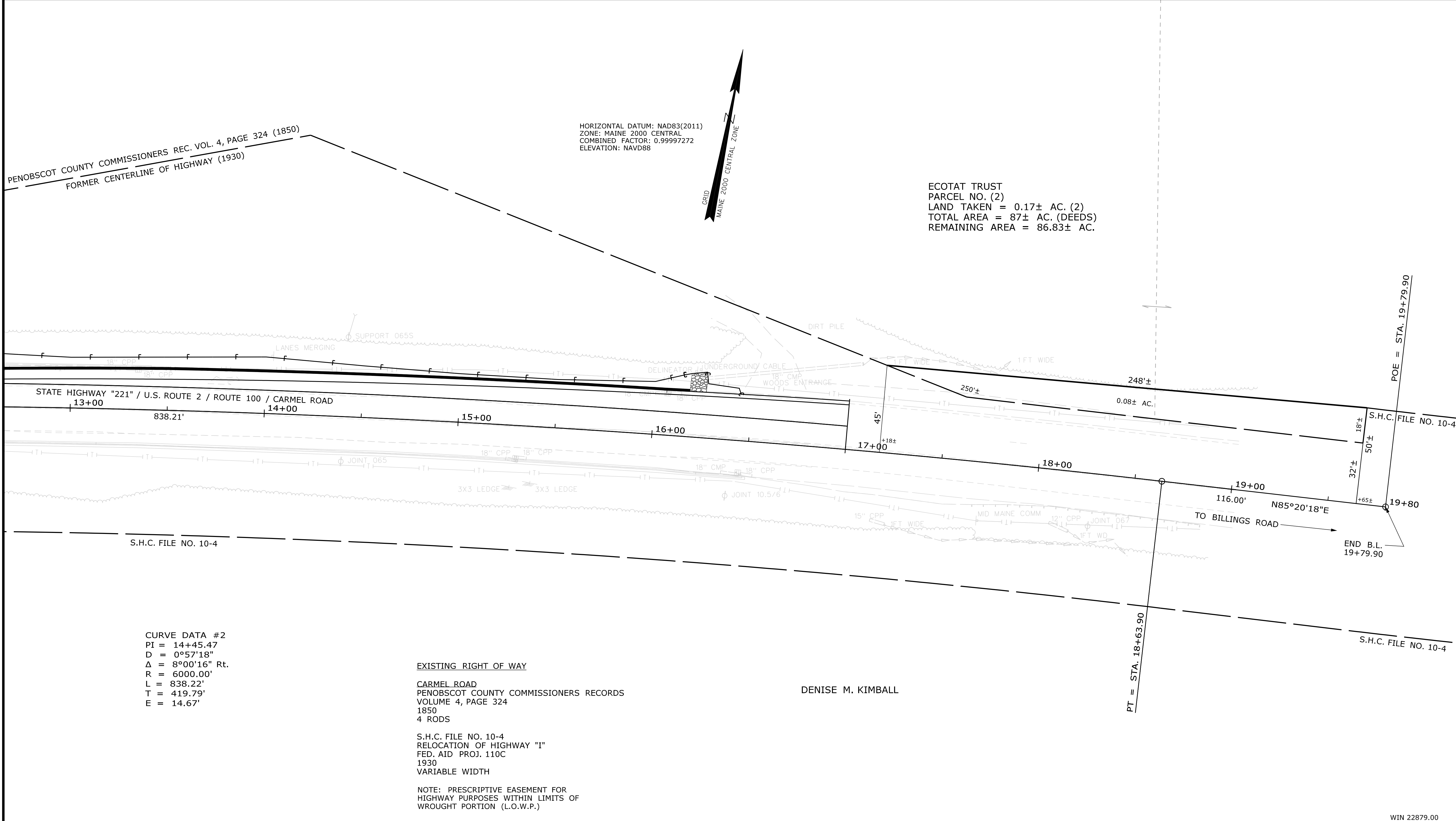

CURVE DATA #2
 PI = 14+45.47
 D = 0°57'18"
 Δ = 8°00'16" Rt.
 R = 6000.00'
 L = 838.22'
 T = 419.79'
 E = 14.67'

EXISTING RIGHT OF WAY
 CARMEL ROAD
 PENOBSCOT COUNTY COMMISSIONERS RECORDS
 VOLUME 4, PAGE 324
 1850
 4 RODS

S.H.C. FILE NO. 10-4
 RELOCATION OF HIGHWAY "1"
 FED. AID PROJ. 110C
 1930
 VARIABLE WIDTH

NOTE: PRESCRIPTIVE EASEMENT FOR
 HIGHWAY PURPOSES WITHIN LIMITS OF
 WROUGHT PORTION (L.O.W.P.)

ITEM	TECH	CHECKED
EXISTING CONDITION PLAN	B.S.	G.L.L.
FINAL RIGHT OF WAY	B.S.	G.L.L.
AREAS	B.S.	G.L.L.

STATE OF MAINE
 DEPARTMENT OF TRANSPORTATION
 16 STATE HOUSE STATION - AUGUSTA, ME 04333-0016 - 207-624-3460
 HERMON
 RIGHT OF WAY MAP

REVISIONS			PLAN FILED IN PLAN BOOK				PAGE COUNTY RECORD				
NO.	DATE	DESCRIPTION	BY	NO.	GRANTOR	INSTRUMENT	DATE	BOOK	PAGE		

BRUCE A. VAN NOTE
 COMMISSIONER
 JOYCE NOEL TAYLOR
 CHIEF ENGINEER

DATE _____

STATE HWY. "221" & STATE AID HWY. NO. 6
 U.S. RT. 2 / RT 100 / CARMEL ROAD & ANNIS ROAD
 HERMON PENOBSCOT COUNTY
 FEDERAL AID PROJECT NO. 2287900

DECEMBER 2019
 SCALE 1" = 25'

RIGHT-OF-WAY MAP
 SHEET 3 OF 3

D.O.T. FILE NO. 10-518

SHEET NUMBER
26
 OF 26

Filename: ... \00\ROW\MSTA\003_RWPLAN3.dgn Division: ROW Username: Benjamin.Singer Date: 5/14/2020