

STATE OF MAINE  
DEPARTMENT OF TRANSPORTATION



SPECIFICATIONS

Design: Load and Resistance Factor Design per AASHTO LRFD Bridge Design Specifications, Ninth Edition 2020.

MATERIALS

Concrete:  
Sidewalks ..... Class "A"

CORNISH  
YORK COUNTY  
LITTLE RIVER BRIDGE  
OVER  
LITTLE RIVER  
MAPLE STREET  
PROJECT NO. 022847.00  
PROJECT LENGTH 0.125 mi.  
BRIDGE NO. 2465

LIST OF DRAWINGS

Title Sheet .....	1
Estimated Quantities & General Construction Notes .....	2
General Plan .....	3
Project Details .....	4

UTILITIES

Central Maine Power	Consolidated Communications
Charter Communications	Cornish Sewer District

TRAFFIC DATA

Current (2024) AADT .....	8540
Future (2036) AADT .....	9050
DHV - % of AADT .....	10%
Design Hour Volume .....	905
Heavy Trucks (% of AADT) .....	10%
Heavy Trucks (% of DHV) .....	14%
Directional Distribution (% of DHV) .....	51%
18 kip Equivalent P 2.0 .....	365
18 kip Equivalent P 2.5 .....	348
Design Speed (mph) .....	25

MAINTENANCE OF TRAFFIC

Maintain one 11'-0" wide lane of alternating one - way traffic using traffic flaggers.

PROJECT LOCATION	Little River Bridge (#2465) over Little River. Located 0.25 Miles East of Route 117 Lat./Long. 43°80'49.4" N 70°80'41.4" W
PROGRAM AREA	Bridge Highway - Traditional
OUTLINE OF WORK	Bridge Slope Staiblization. Sidewalk and Curb Reset/Replacement.

STATE OF MAINE DEPARTMENT OF TRANSPORTATION	APPROVED	DATE
COMMISSIONER: <i>[Signature]</i>		10-30-23
CHIEF ENGINEER: <i>[Signature]</i>		10-30-23

<i>[Signature]</i>	SIGNATURE	P.E. NUMBER	DATE
<i>[Signature]</i>	17553	9/28/23	

PROJECT INFORMATION	BRIDGE	PROJECT MANAGER	DESIGNER	CONSULTANT	PROJECT RESIDENT	CONTRACTOR	PROJECT COMPLETION DATE
	BRIAN NICHOLS	ERIN BREWER					

CORNISH LITTLE RIVER BRIDGE	TITLE SHEET
--------------------------------	-------------

SHEET NUMBER
1
OF 4

02284700 WIN 022847.00

ESTIMATED QUANTITIES			
ITEM NO.	DESCRIPTION	QUANTITY	UNIT
202.128	REM OF EXIST CONC CURBS & SIDEWALKS (11 CY)	1	LS
203.20	COMMON EXCAVATION	10	CY
203.24	COMMON BORROW	10	CY
304.10	AGGR SUBB COURSE - GRAVEL	10	CY
403.208	HOT MIX ASPHALT 12.5 MM HMA SURFACE	4	T
409.15	BITUMINOUS TACK COAT - APPLIED	1	G
608.08	REINFORCED CONCRETE SIDEWALK	40	SY
609.11	VERT CURB TYPE I	28	LF
609.38	RESET CURB TYPE I	40	LF
610.08	PLAIN RIPRAP	40	CY
613.319	EROSION CONTROL BLANKET	10	SY
615.07	LOAM	2	CY
618.13	SEEDING METHOD NUMBER 1	1	UN
619.12	MULCH	1	UN
620.58	EROSION CONTROL GEOTEXTILE	74	SY
629.05	HAND LABOR, STRAIGHT TIME	40	HR
639.20	FIELD OFFICE TYPE C	1	EA
652.33	DRUM	10	EA
652.34	CONE	30	EA
652.35	CONSTRUCTION SIGNS	200	SF
652.361	MAINTENANCE OF TRAFFIC CONTROL DEVICES	1	LS
652.38	FLAGGER	200	HR
656.75	TEMP SOIL EROSION & WATER POLLUTION CTRL	1	LS
659.10	MOBILIZATION	1	LS

GENERAL CONSTRUCTION NOTES

1. The clearing limits as shown on the plans are approximate. The exact limits will be established in the field by the Resident. Payment for clearing will be considered incidental to Contract items.
2. Do not excavate for Aggregate Subbase Course where existing material is suitable as determined by the Resident.
3. Place riprap as shown in Project Drawings.
4. Place loam 2 inches deep on all new or reconstructed sideslopes or as directed by the Resident.
5. Areas of pavement removal shall be saw cut around its perimeter. Saw cutting will be considered incidental to related Contract items.
6. Project information referred to below may be accessed at the following MaineDOT web address: <http://www.maine.gov/mdot/contractors/>
7. The existing ROW Map dated August 1999, with revision on December 29, 2022 may be accessed at the MaineDOT web address.

8. Quantities included for pay items measured and paid for by Lump Sum are estimated quantities and are provided by MaineDOT for informational purposes only. Lump Sum pay items will be paid for at the Contract Bid amount, with no addition or reduction in payment to the Contractor if the actual final quantities are different from the MaineDOT provided estimated quantities, except as follows:
- a. If a Lump Sum pay item is eliminated, the requirements of Standard Specifications Section 109.2, Elimination of Items, will take precedence.
- b. If other Contract Documents specifically allow a change in payment for a Lump Sum pay item, those requirements will be followed.
- c. If a design change results in changes to estimated quantities for Lump Sum pay items, price adjustments will be made in accordance with Standard Specifications Section 109.7, Equitable Adjustments to Compensation and Time.

STATE OF MAINE  
DEPARTMENT OF TRANSPORTATION

02284700

WIN  
022847.00

BRIDGE NO. 2465  
BRIDGE PLANS

LITTLE RIVER BRIDGE  
LITTLE RIVER  
CORNISH  
YORK COUNTY

ESTIMATED QUANTITIES &  
GENERAL CONSTRUCTION NOTES

SHEET NUMBER  
2  
OF 4

PROJ. MANAGER	BRIAN NICHOLS	BY	DATE	SIGNATURE
DESIGN-DETAILED	EDB	MAC	9/20/23	
CHECKED-REVIEWED	GAS	BIN	9/20/23	
DESIGNS-DETAILED				
REVISIONS 1				
REVISIONS 2				P.E. NUMBER
REVISIONS 3				DATE
REVISIONS 4				
FIELD CHANGES				

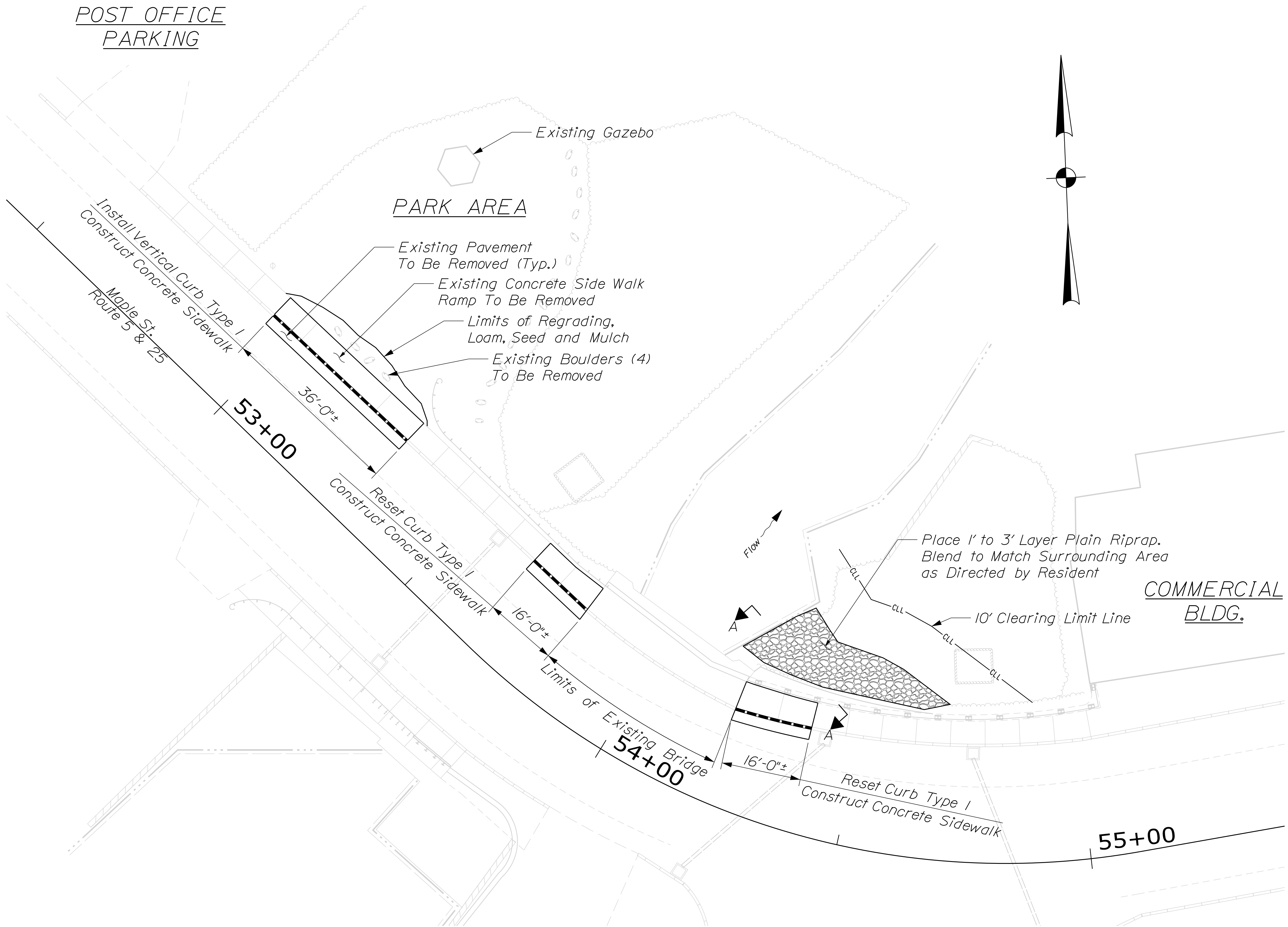

STATE OF MAINE DEPARTMENT OF TRANSPORTATION	DATE		BY		SIGNATURE	
	9/20/23		MAC		BIN	
	9/20/23		BIN		BIN	
02284700	P.E. NUMBER		DATE		DATE	
WIN 022847.00	BRIDGE NO. 2465		BRIDGE PLANS		BRIDGE PLANS	

LITTLE RIVER BRIDGE  
LITTLE RIVER  
CORNISH

YORK COUNTY

GENERAL PLAN

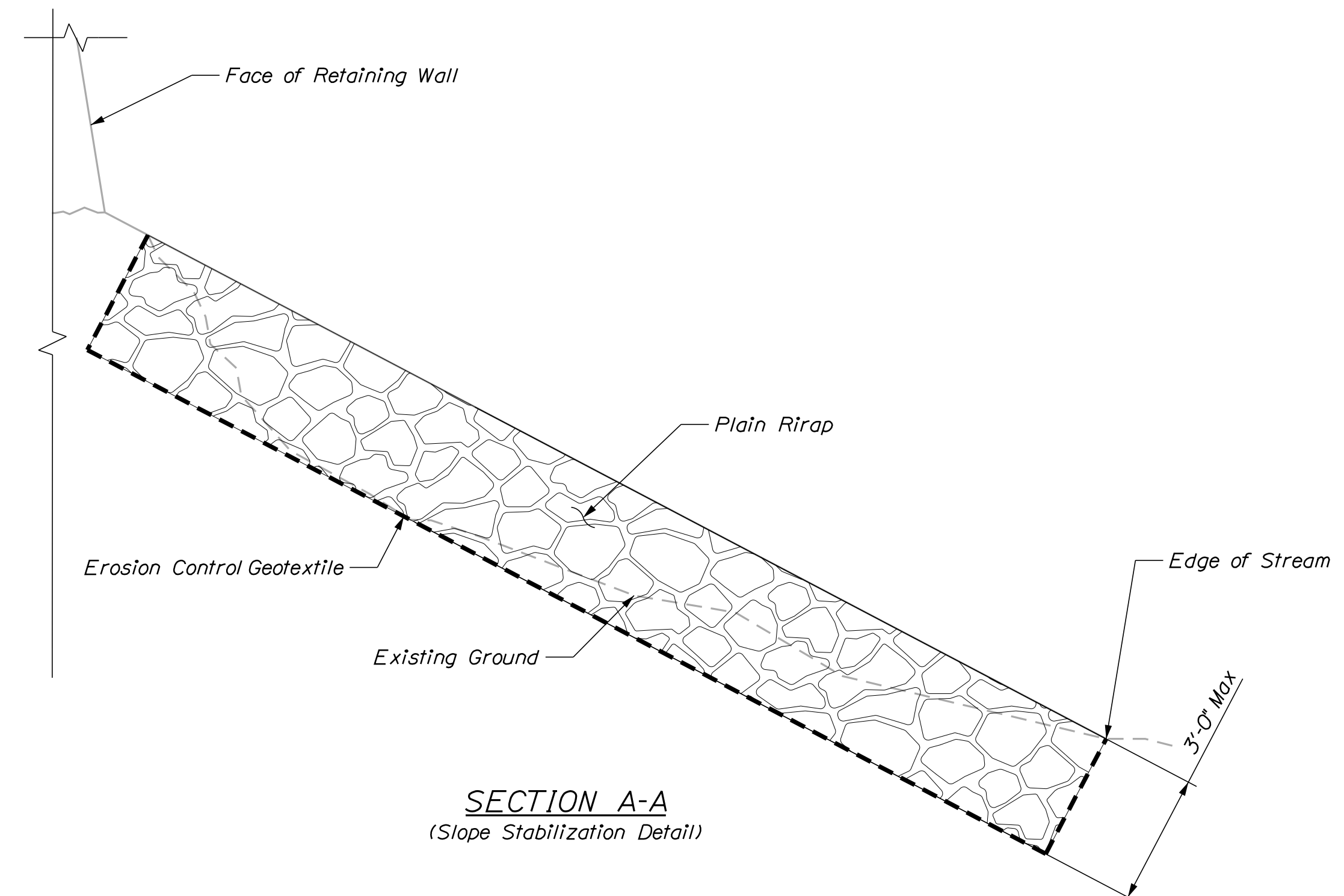
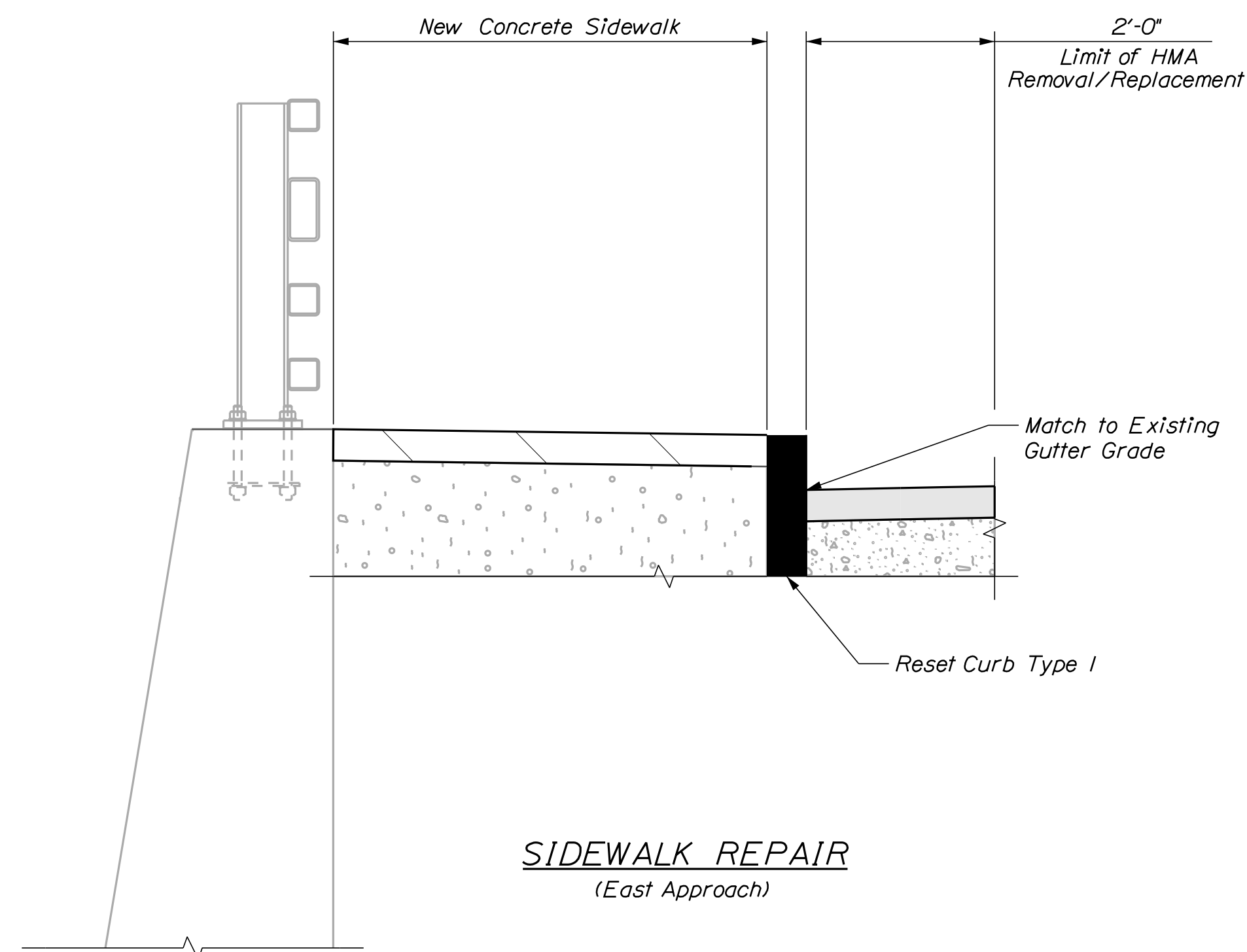
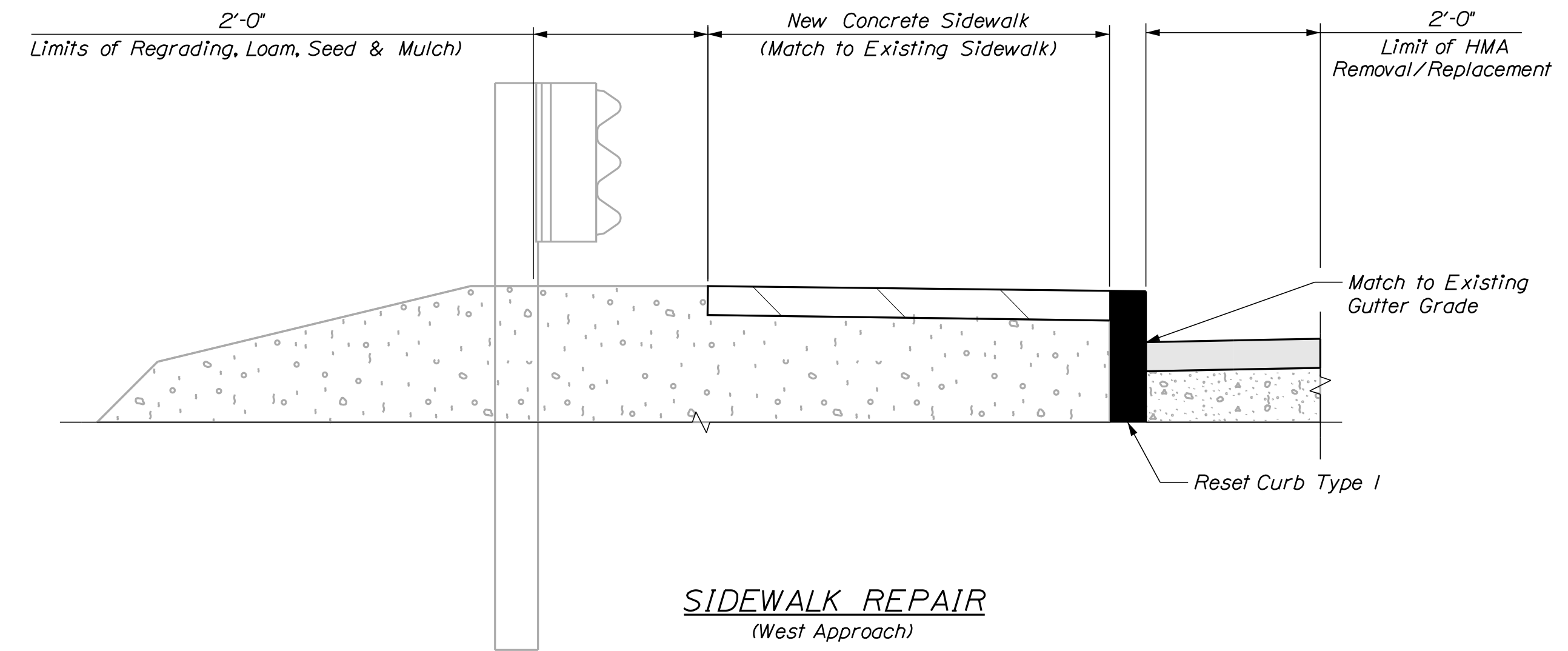
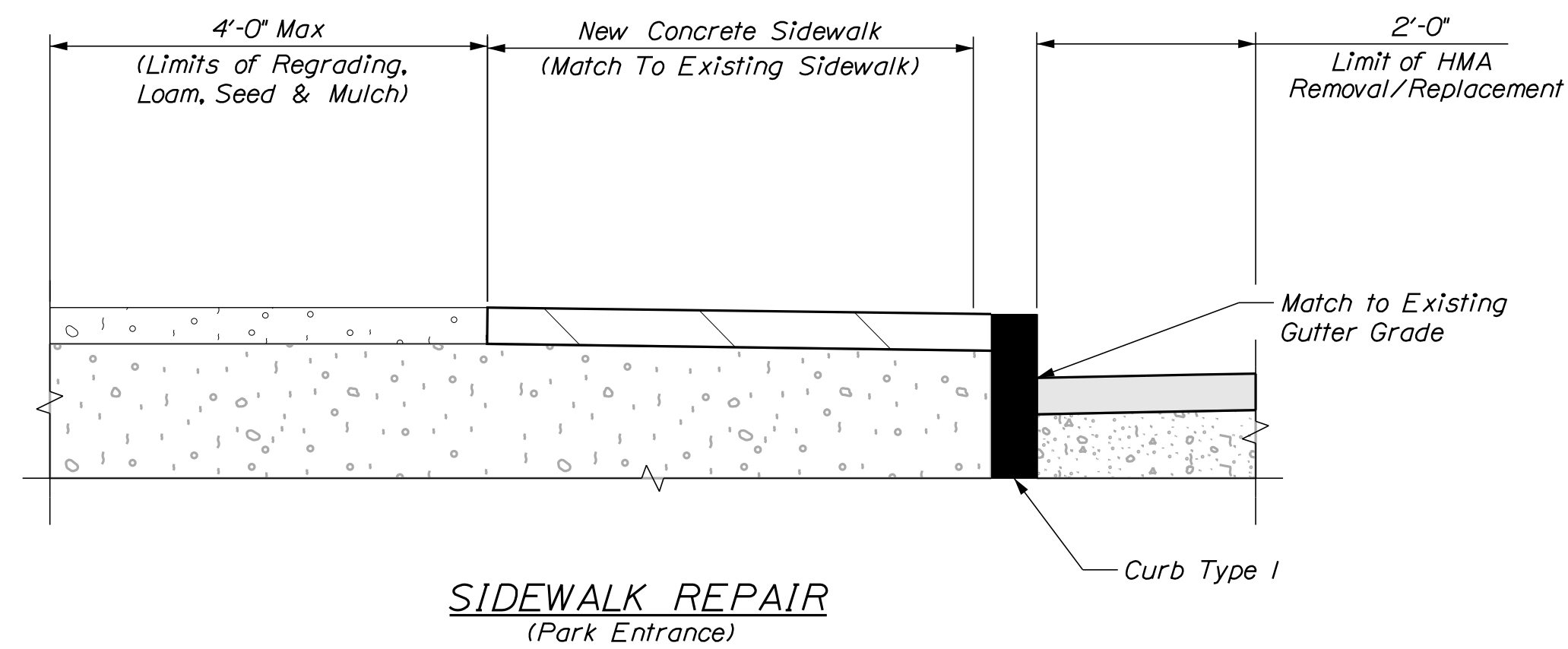

4 OF 4	SHEET NUMBER	LITTLE RIVER BRIDGE LITTLE RIVER CORNISH YORK COUNTY		PROJ. MANAGER	BRIAN NICHOLS	BY	DATE
				DESIGN-DETAILED	EDB	MAC	9/2023
	PROJECT DETAILS		CHECKED-REVIEWED	GAG	BUN	9/2023	SIGNATURE
			DESIGN2-DETAILED2				
			DESIGN3-DETAILED3				P.E. NUMBER
			REVISIONS 1				
			REVISIONS 2				
			REVISIONS 3				
			REVISIONS 4				DATE
			FIELD CHANGES				
STATE OF MAINE DEPARTMENT OF TRANSPORTATION							
		02284700					
		WIN 022847.00					
		BRIDGE NO. 2465					
		BRIDGE PLANS					