

STATE OF MAINE DEPARTMENT OF TRANSPORTATION



BRIDGTON CUMBERLAND COUNTY DAY BROOK BRIDGE ROUTE 117 STATE PROJECT NO. 22665.00 PROJECT LENGTH : 0.01 MILES BRIDGE NO. 6554

INDEX OF SHEETS	
Description	Sheet No.
Title Sheet	1
General Notes, Typical Section and Estimate Quantities	2
Special Details	3-4
Boring Location Plan and Interpretive Subsurface Profile With Boring Logs	5
Plan and Profile	6
Cross Sections	7-11
Detour Plan	12
Right of Way Map	13

PLAN LEGEND			
Town, County, State	-----	Catch Basins	Existing Proposed
Property Lines	-----	Manholes	Existing Proposed
R/W Lines-Existing	-----	Proposed Underdrain	----->
R/W Lines-Proposed	-----	Proposed Ditch	----->>
Culvert-Existing	-----	Existing Ditch	----->>
Culvert Proposed	-----	Utility Poles	Existing Proposed
Curbing Existing	-----	Fire Hydrants	Existing Proposed
Curbing Proposed	-----	Existing Water Line	-----
Type 1	-----	Existing San. Sewer	-----
Type 3	-----	Existing San. Sewer Manhole	-----
Type 5	-----	Guardrail-Existing	-----
Outline of Bodies of Water	-----	Guardrail-Proposed	-----
Exposed Bedrock	-----	Guardrail-Cable, Other	-----
Buildings	-----	Centerline-Existing	-----
Trees Conifer Deciduous		Centerline-Proposed	-----
Tree Line	-----	Travelway-Existing	-----
Clearing Limit Line	-----	Travelway-Proposed	-----
Railroad	-----		
Boring HB-XXX-###		Probe P-#.X	
Pavement Core PC-#		#, # = Depth	
Test Pit TP-XXX-###		X = W (Weathered Rock)	
		R (Refusal)	
		NR (No Refusal)	

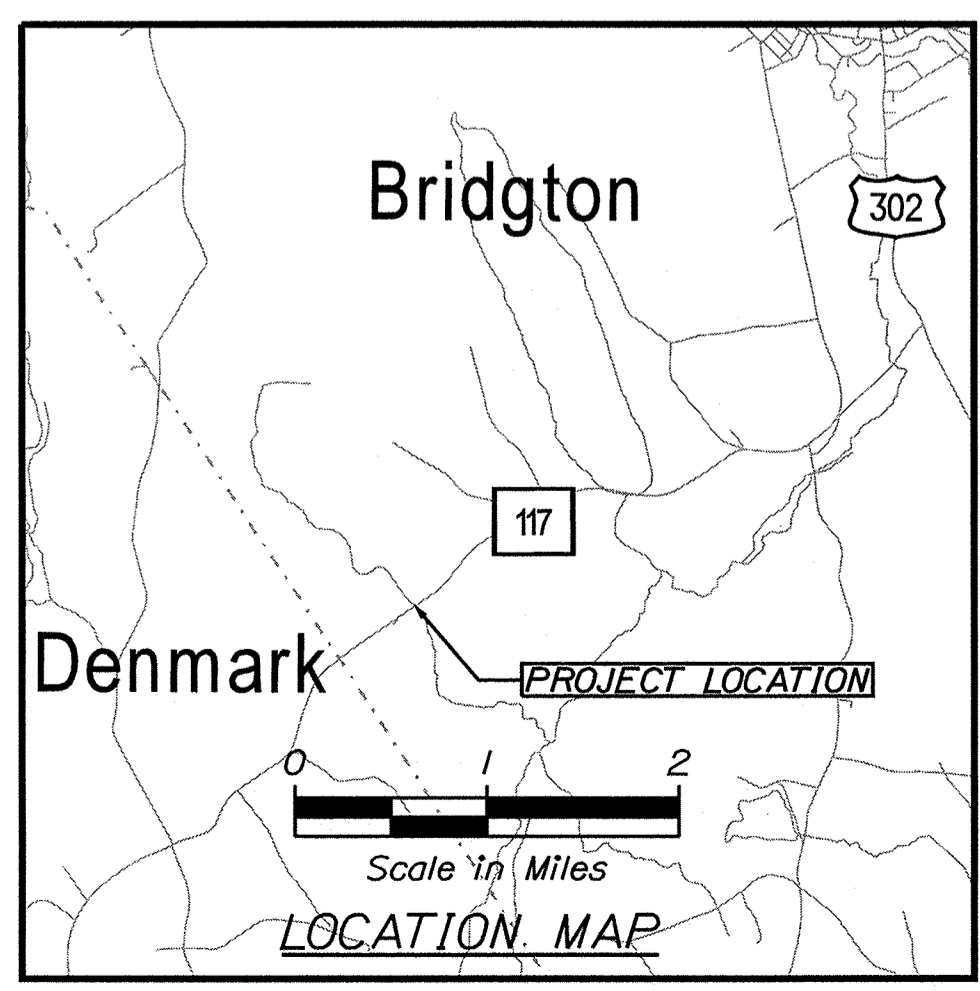
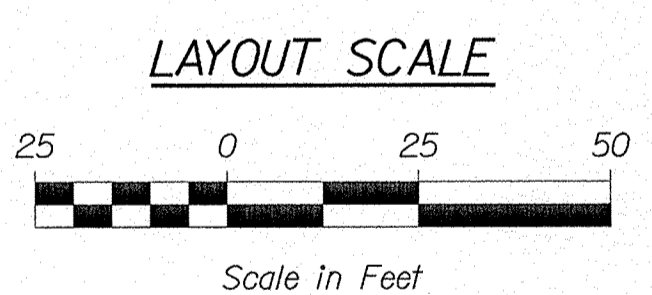
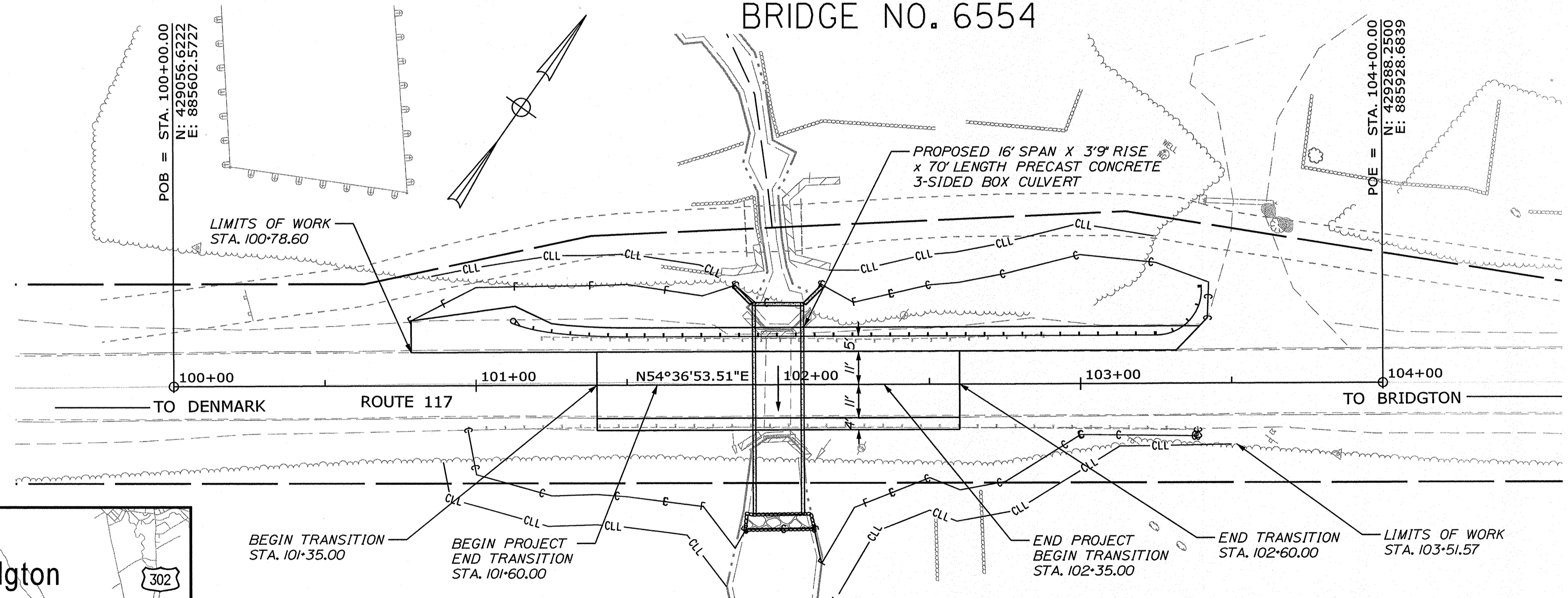

TRAFFIC DATA	
Current (2020) AADT	2,020
Future (2040) AADT	2,420
DHV - % of AADT	12%
Design Hour Volume	290
% Heavy Trucks (AADT)	7%
% Heavy Trucks (DHV)	2%
Directional Distribution (DHV)	597%
18 kip Equivalent P 2.0	84
18 kip Equivalent P 2.5	80
Design Speed (mph)	45
Functional Class:	Minor Collector
Highway Corridor Priority:	3

PROJECT LOCATION:	LOCATED APPROXIMATELY 0.49 MILES NORTHEAST OF THE DENMARK/BRIDGTON TOWN LINE ALONG ROUTE 117
PROGRAM AREA:	HIGHWAY PROGRAM
SCOPE OF WORK:	LARGE CULVERT REPLACEMENT

STATE OF MAINE DEPARTMENT OF TRANSPORTATION	APPROVED	DATE
COMMISSIONER:	7-2-2020	7-2-2020
CHIEF ENGINEER:		7-2-2020
	SIGNATURE	P.E. NUMBER
LARRY HAMILTON	/5681	06/24/2020
SHANE KELLY	SEBAGO TECHNICS, INC.	DATE
PROJECT RESIDENT	CONTRACTOR	PROJECT COMPLETION DATE
PROGRAM	HIGHWAY	
PROJECT MANAGER	DESIGNER	CONSULTANT
CONTRACTOR		

Date: 6/23/2020
 Username: skelly
 Division: HIGHWAY
 Filename: ...MSTA\SHEETS\001_Title.dgn

WIN 22665.00

BRIDGTON
 DAY BROOK BRIDGE
 TITLE SHEET
 SHEET NUMBER
1
 OF 13

GENERAL NOTES

1. PAVEMENT THICKNESSES SHOWN ON THE TYPICAL SECTIONS ARE INTENDED TO BE NOMINAL.
2. CLEARING LIMITS SHALL BE 10' BEYOND AND PARALLEL TO THE CONSTRUCTION SLOPES LINES OR AS SHOWN ON THE PLANS UNLESS OTHERWISE AUTHORIZED BY THE RESIDENT.
3. ALL CLEARING SHALL BE CONSIDERED INCIDENTAL TO THE CONTRACT AND NO SEPARATE PAYMENT WILL BE MADE. THE ACTUAL LINES FOR CLEARING SHALL BE ESTABLISHED IN THE FIELD BY THE CONTRACTOR AS INDICATED ON THE PLANS AND APPROVED BY THE RESIDENT.
4. ALL INSLOPE AND DITCHES IN CUT AREAS SHALL BE GRADED AS SHOWN ON THE TYPICALS OR FLATTER, OR AS DIRECTED BY THE RESIDENT.
5. THE CONTRACTOR SHALL PLACE SUITABLE EXISTING OR OTHER MATERIAL ACCEPTABLE TO THE RESIDENT ON ALL PAVEMENT EDGES TO ALLOW A DROP OFF NO GREATER THAN THE SURFACE PAVEMENT THICKNESS. THE MATERIAL SHALL BE GRADED TO MATCH EXISTING IN-SLOPE OR AS DIRECTED BY THE RESIDENT BEFORE SURFACE IS PLACED. THE CONTRACTOR WILL BE PAID UNDER APPROPRIATE EQUIPMENT RENTAL ITEMS. BORROW IS NOT AUTHORIZED UNTIL ALL ACCEPTABLE WASTE MATERIAL HAS BEEN UTILIZED. SEED AND MULCH WILL BE PAID FOR AT THE CONTRACT UNIT PRICE.
6. ALL WASTE MATERIAL NOT USED ON THE PROJECT SHALL BE DISPOSED OFF THE PROJECT IN ACCEPTABLE WASTE AREAS REVIEWED BY THE RESIDENT. GRADING, SEEDING AND MULCHING OF WASTE AREAS SHALL BE CONSIDERED INCIDENTAL.
7. REQUIRED DITCH PROTECTION SHOWN ON THE PLANS OR IN THE CONSTRUCTION NOTES IS FOR ESTIMATING PURPOSES ONLY. THE ACTUAL TYPE AND LOCATION OF DITCH PROTECTION MAY BE ALTERED BY THE RESIDENT.
8. GRANULAR BORROW USED TO BACKFILL MUCK EXCAVATION OR IN LOW WET AREAS TO 1 FOOT ABOVE WATER LEVEL OR OLD GROUND SHALL MEET REQUIREMENTS FOR GRANULAR BORROW MATERIAL FOR UNDERWATER BACKFILL AS SPECIFIED IN STANDARD SPECIFICATION 703.19.
9. EXISTING INSLOPES IN PROPOSED FILL AREAS STEEPER THAN 3:1 SHALL BE BENCHED BY EXCAVATING STEPS OF SUFFICIENT WIDTH TO PERMIT PLACING AND COMPACTING THE FILL MATERIAL ALONG WITH THE MATERIAL REMOVED.
10. CROSS SLOPES FOR NORMAL AND SUPERELEVATED SECTIONS WILL BE STRAIGHT UNLESS OTHERWISE DIRECTED BY THE RESIDENT.
11. NO EXISTING DRAINAGE SHALL BE ABANDONED, REMOVED OR PLUGGED WITHOUT PRIOR APPROVAL OF THE RESIDENT.
12. GUARDRAIL END TREATMENTS SHALL BE INSTALLED CONCURRENTLY WITH THE PLACEMENT OF EACH SECTION OF BEAM GUARDRAIL.
13. HOLES CREATED BY GUARDRAIL REMOVAL WILL BE FILLED AND COMPACTED WITH APPROVED MATERIALS AS DIRECTED BY THE RESIDENT. PAYMENT WILL BE CONSIDERED INCIDENTAL TO STANDARD SPECIFICATIONS SECTION 606, GUARDRAIL.
14. ALL EXISTING GUARDRAIL SHALL BE REMOVED AND BECOME THE PROPERTY OF THE CONTRACTOR. REMOVAL AND DISPOSAL SHALL BE CONSIDERED INCIDENTAL TO THE GUARDRAIL ITEMS.
15. TWO REFLECTORIZED FLEXIBLE G.R. MARKERS (ITEM 606.353) WILL BE INSTALLED AT EACH GUARDRAIL END.
16. LOAM HAS BEEN ESTIMATED FOR DISTURBED LAWN AREAS. ACTUAL PLACEMENT OF THE LOAM SHALL BE AS NOTED ON THE PLANS OR DESIGNATED BY THE RESIDENT.
17. SEEDING METHOD NO. 2 SHALL BE UTILIZED ON ALL AREAS.
18. LOAM SHALL BE PLACED AT A NOMINAL DEPTH OF 2 INCHES IN ALL AREAS.
19. THE CONTRACTOR WILL BE RESPONSIBLE FOR MAINTAINING ALL EXISTING MAILBOXES TO ENSURE MAIL WILL BE DELIVERABLE. PAYMENT FOR THIS WORK WILL BE CONSIDERED INCIDENTAL TO THE CONTRACT.
20. ANY DAMAGE TO THE SLOPES CAUSED BY THE CONTRACTOR'S EQUIPMENT, PERSONNEL OR OPERATION SHALL BE REPAIRED TO THE SATISFACTION OF THE RESIDENT. ALL WORK, EQUIPMENT AND MATERIALS REQUIRED TO MAKE REPAIRS SHALL BE AT THE CONTRACTOR'S EXPENSE.
21. THE PROJECT GEOTECHNICAL REPORT TITLED GEOTECHNICAL DESIGN REPORT FOR THE CONSTRUCTION OF DAY BROOK BRIDGE, SOILS REPORT 2020-20, DATED JUNE 22, 2020 CAN BE ACCESSED AT THE MAINEDOT WEBSITE.
22. GEOTECHNICAL INFORMATION FURNISHED OR REFERRED TO IN THE BID DOCUMENTS IS FOR THE USE OF THE BIDDERS. NO ASSURANCE IS GIVEN THAT THE INFORMATION OR INTERPRETATIONS WILL BE REPRESENTATIVE OF THE ACTUAL SUBSURFACE CONDITIONS THROUGHOUT THE CONSTRUCTION SITE. MAINEDOT WILL NOT BE RESPONSIBLE FOR ANY INTERPRETATIONS OR CONCLUSION DRAWN FROM THE GEOTECHNICAL INFORMATION. THE BORING LOGS PROVIDED IN THE BID DOCUMENTS PRESENT FACTUAL AND INTERPRETIVE SUBSURFACE INFORMATION COLLECTED AT DISCRETE LOCATIONS. DATA PROVIDED MAY NOT BE REPRESENTATIVE OF THE SUBSURFACE CONDITIONS BETWEEN BORING LOCATIONS.
23. AREAS ON THE PROJECT REQUIRING FILL WILL COME FROM SUITABLE SITES SUCH AS EXCAVATION, DITCH AND INSLOPE OR EQUIPMENT RENTAL AREAS.
24. NO SEPARATE PAYMENT FOR SUPERINTENDENT OR FOREMAN WILL BE MADE FOR THE SUPERVISION OF EQUIPMENT BEING PAID FOR UNDER THE EQUIPMENT RENTAL ITEMS.
25. STATIONS REFERENCED ARE APPROXIMATE.
26. FINAL STRIPING FOR THE PROJECT SHALL BE DONE BY THE CONTRACTOR PER THE STRIPING LAYOUT IN THE CONTRACT DOCUMENTS OR AS PROVIDED BY THE DEPARTMENT. PAYMENT SHALL BE MADE UNDER THE APPROPRIATE CONTRACT ITEMS.
27. THE EXISTING CULVERT INDICATED ON THE PLANS SHALL BE REMOVED AND BECOME THE PROPERTY OF THE CONTRACTOR. THIS SHALL BE CONSIDERED INCIDENTAL TO ITEM 534.71.
28. ROCK EXCAVATION MAY BE NECESSARY TO ACHIEVE PLANNED GRADES FOR THE PROJECT. IT IS EXPECTED THAT FRACTURE ROCK WILL BE EXCAVATED AND PAID AS STRUCTURAL EARTH EXCAVATION (PAY ITEM 206.061) AND SOUND ROCK REQUIRING BLASTING WILL BE PAID AS STRUCTURAL ROCK EXCAVATION (PAY ITEM 206.07).
29. BLASTING MAY BE REQUIRED TO ACHIEVE THE PLANNED GRADES FOR THE PROJECT. IF BLASTING IS REQUIRED, THE CONTRACTOR SHALL CONDUCT WORK IN ACCORDANCE WITH STANDARD SPECIFICATION SECTIONS 105.2.7- USE OF EXPLOSIVES AND 203.042- ROCK EXCAVATION AND BLASTING.

ESTIMATED QUANTITIES			
ITEM NO.	DESCRIPTION	QUANTITY	UNIT
203.20	COMMON EXCAVATION	490	CY
203.25	GRANULAR BORROW	120	CY
206.061	STR. EARTH EXCAVATION - DRAINAGE AND MINOR STRUCTURES	10	CY
206.07	STR. ROCK EXCAVATION - DRAINAGE AND MINOR STRUCTURES	10	CY
304.10	AGGREGATE SUBBASE COURSE - GRAVEL	385	CY
403.208	HOT MIX ASPHALT 12.5 MM HMA SURFACE	50	TONS
403.213	HOT MIX ASPHALT 12.5 MM HMA BASE	83	TONS
409.15	BITUMINOUS TACK COAT	18	GAL
502.21	STR CONC ABUT AND RET WALL	30	CY
503.12	REINFORCING STEEL, FABRICATED & DELIVERED	800	LB
503.13	REINFORCING STEEL, PLACING	800	LB
508.13	SHEET WATERPROOFING MEMBRANE	1	LS
511.07	COFFERDAM: UPSTREAM	1	LS
511.07	COFFERDAM: DOWNSTREAM	1	LS
512.081	FRENCH DRAIN	1	LS
534.71	PRECAST CONCRETE BOX CULVERT	1	LS
606.1301	3" W-BM GR MID-WAY SPLICE-SGL FACED	175	LF
606.1303	3" W-BM GR MID-WAY SPLICE-15' RAD OR LESS	25	LF
606.1305	3" W-BM GR MID-WAY SPLICE FLARED TERM	1	EA
610.08	PLAIN RIPRAP	10	CY
613.319	EROSION CONTROL BLANKET	25	SY
615.07	LOAM	48	CY
618.14	SEEDING METHOD NUMBER 2	8	UN
619.12	MULCH	8	UN
619.14	EROSION CONTROL MIX	5	CY
620.58	EROSION CONTROL GEOTEXTILE	12	SY
627.733	4" WHITE OR YELLOW PAINTED PAVEMENT MARKING LINE	500	LF
629.05	HAND LABOR, STRAIGHT TIME	10	HR
631.12	ALL PURPOSE EXCAVATOR (INCLUDING OPERATOR)	10	HR
631.172	LARGE TRUCK (INCLUDING OPERATOR)	10	HR
639.19	FIELD OFFICE TYPE B	1	EA
652.312	BARRICADE TYPE III	4	EA
652.33	DRUM	50	EA
652.34	CONE	100	EA
652.35	CONSTRUCTION SIGN	1,000	SF
652.36	MAINTENANCE OF TRAFFIC CONTROL DEVICES	40	CD
652.38	FLAGGER	300	HR
652.41	PORTABLE CHANGEABLE MESSAGE SIGN	4	EA
656.75	TEMPORARY SOIL EROSION AND WATER POLLUTION CONTROL	1	LS
659.10	MOBILIZATION	1	LS
674.10	PREFABRICATED CONCRETE MODULAR GRAVITY WALL	64	SF

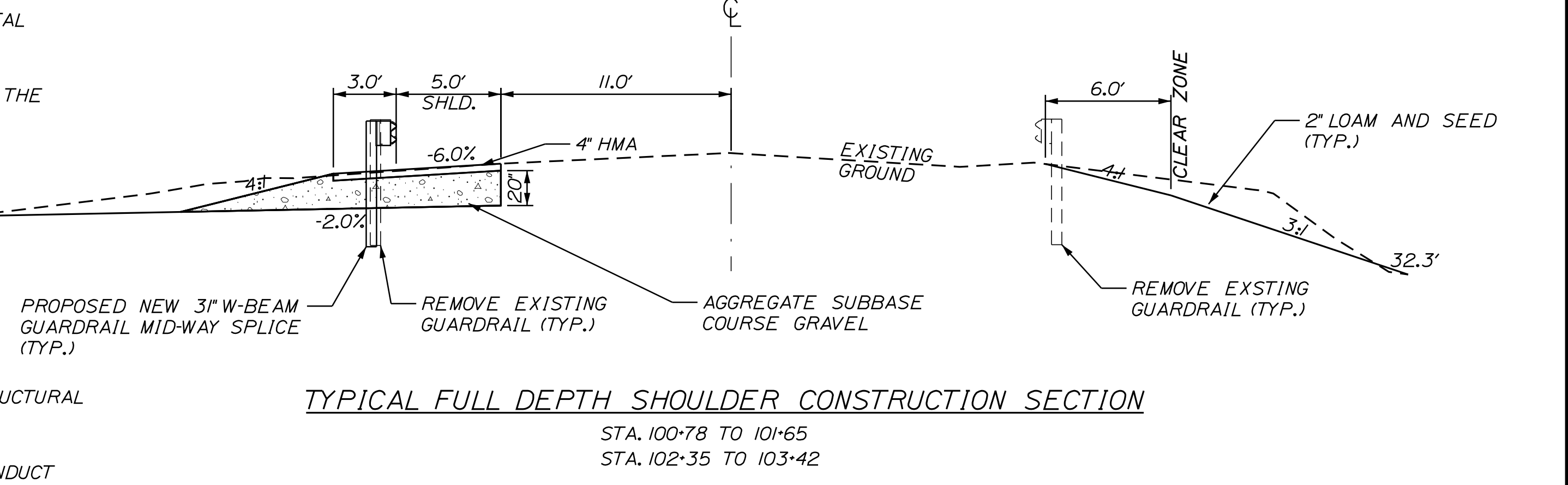
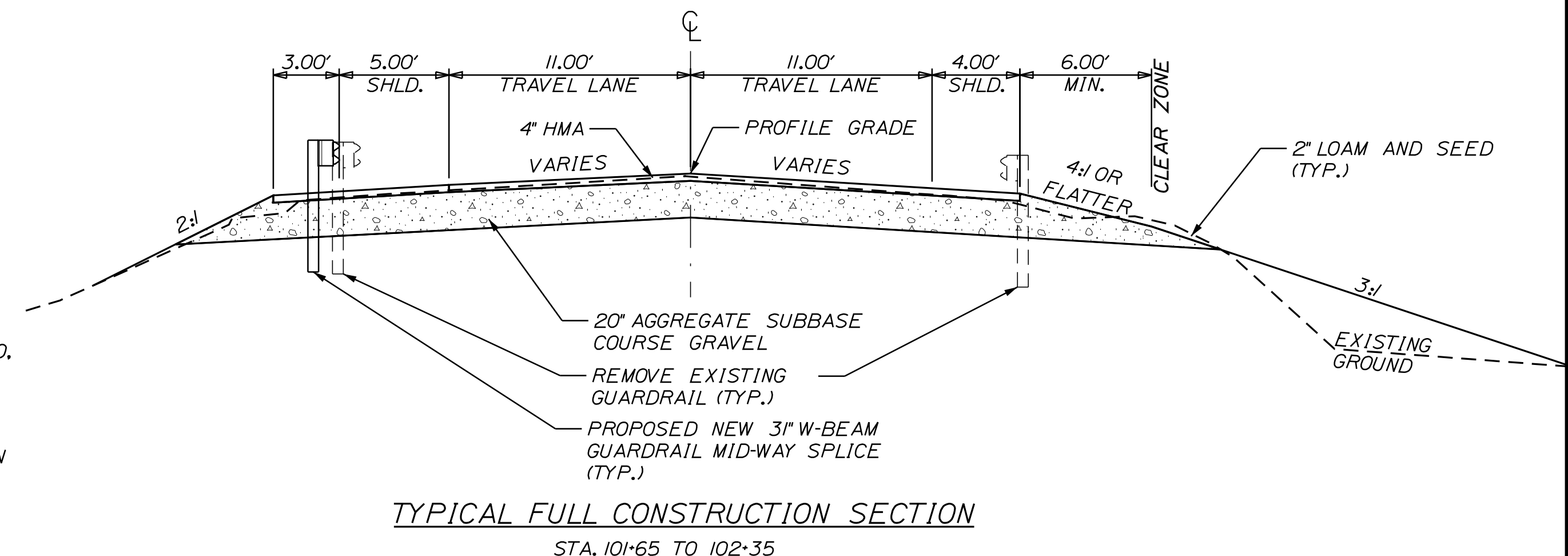

STATE OF MAINE
DEPARTMENT OF TRANSPORTATION

HIGHWAY PLANS

BRIDGE # 6554

WIN 22665.00

22665.00

L. HAMILTON
PROJ. MANAGER

S. KELLY
BY

B. LYON
DATE

06/24/20
DATE

06/24/20
DATE

15681
P.E. NUMBER

06/24/2020
DATE

DESIGN-DETAILED

CHECKED-REVIEWED

DESIGN-DETAILED

DESIGN-DETAILED

REVISIONS 1

REVISIONS 2

REVISIONS 3

REVISIONS 4

FIELD CHANGES

BRIDGTON
DAY BROOK BRIDGE

GENERAL NOTES, TYPICAL SECTION
AND ESTIMATED QUANTITIES

SHEET NUMBER

2

OF 13

Date: 6/23/2020

Username: skelly

Division: HIGHWAY

Filename: ... \MSTA\SHEETS\002_Typical.dgn

Date: 6/23/2020

Username: skelly

Division: HIGHWAY

Filename: ... \SHEETS\003_SpecialDetails.dgn

CULVERT NOTES

1. COFFERDAMS ARE TO BE PLACED AT BOTH THE DOWNSTREAM AND UPSTREAM ENDS OF THE STRUCTURE TO ALLOW WATER TO BE PUMPED AND REMOVED DURING CONSTRUCTION OF THE BOX CULVERT.
2. THE FURNISHING AND PLACING OF BACKFILL MATERIAL BETWEEN THE GRANULAR BORROW PAY LIMIT AND THE NORMAL SUBGRADE LINE WILL NOT BE PAID FOR DIRECTLY BUT SHALL BE CONSIDERED INCIDENTAL TO THE WORK. BACKFILL MATERIAL SHALL BE FROM SUITABLE EXCAVATION WITHIN PROJECT LIMITS, IF AVAILABLE, AND SHALL BE GRANULAR MATERIAL AS DIRECTED BY THE RESIDENT.
3. THE CONSTRUCTION HANDLING AND ASSEMBLY OF THE PRECAST UNITS SHALL BE IN ACCORDANCE WITH STANDARD SPECIFICATION 534 AND THE MANUFACTURER'S RECOMMENDATIONS.
4. INSTALL MEMBRANE WATERPROOFING OVER THE TOP AND 12" DOWN THE EXTERIOR SIDES OF THE PRECAST UNITS AND 12" UP THE HEADWALL.
5. THE FOUNDATION PEDESTAL WALL REINFORCING SHALL HAVE A MINIMUM COVER OF 3".
6. RIPRAP SHALL BE USED AROUND THE INSLOPE AT THE CULVERT OUTLET END. SEE PLANS FOR LOCATIONS.
7. CONSTRUCT 4 INCH DIAMETER WEEP HOLES IN THE CAST-IN-PLACE FOOTING AT A 10 FOOT MAXIMUM SPACING. THE EXACT LOCATION WILL BE DETERMINED BY THE RESIDENT.
8. CONSTRUCT FRENCH DRAINS BEHIND THE PEDESTAL WALLS IN ACCORDANCE WITH STANDARD SPECIFICATION SECTION 512 FRENCH DRAINS.
9. BEDROCK ELEVATIONS WILL VARY. ALL LOOSE AND WEATHERED ROCK SHALL BE CLEANED FROM THE BEARING SURFACE PRIOR TO FOOTING CONSTRUCTION. WHERE THE SLOPE OF THE BEDROCK IS STEEPER THAN 6H:4V THE BEDROCK SURFACE SHALL BE STEPPED OR BENCHED. THE CLEANLINESS AND CONDITION OF THE BEDROCK SURFACE SHALL BE CONFIRMED AND ACCEPTED BY THE RESIDENT PRIOR TO PLACING THE CAST-IN-PLACE CONCRETE FOOTINGS.
10. CLASS A CONCRETE SHALL BE USED FOR THE FOOTINGS AND PEDESTALS. METHOD OF ACCEPTANCE SHALL BE METHOD C.

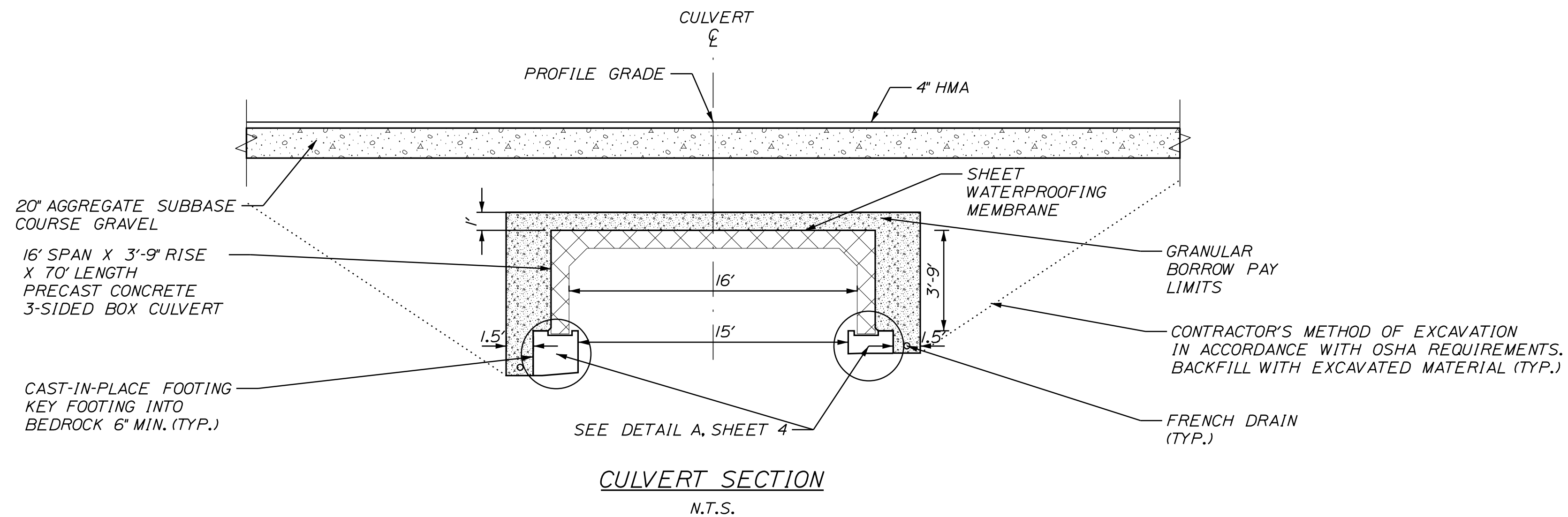
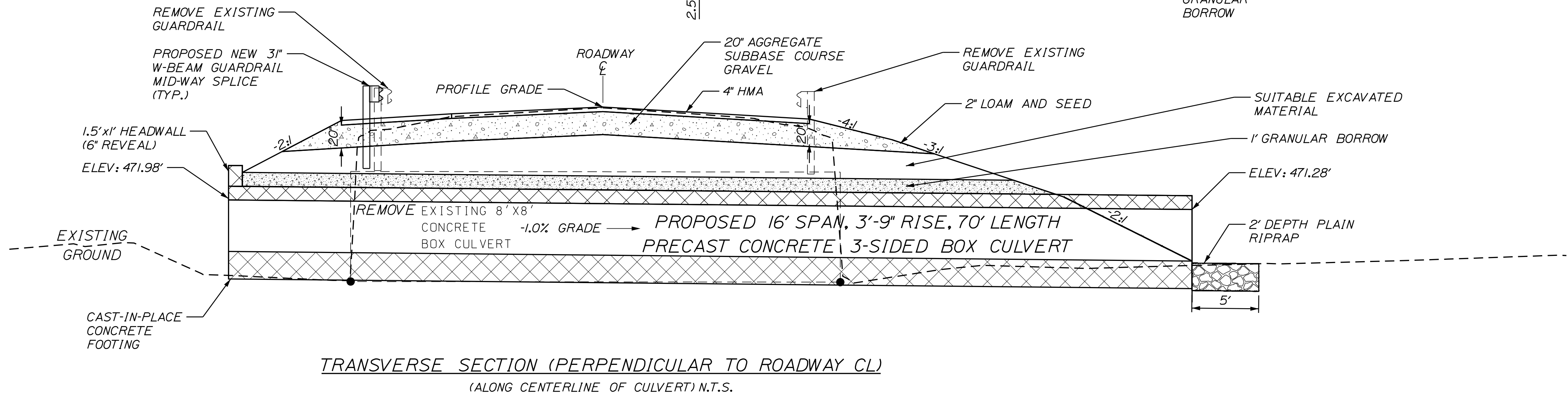
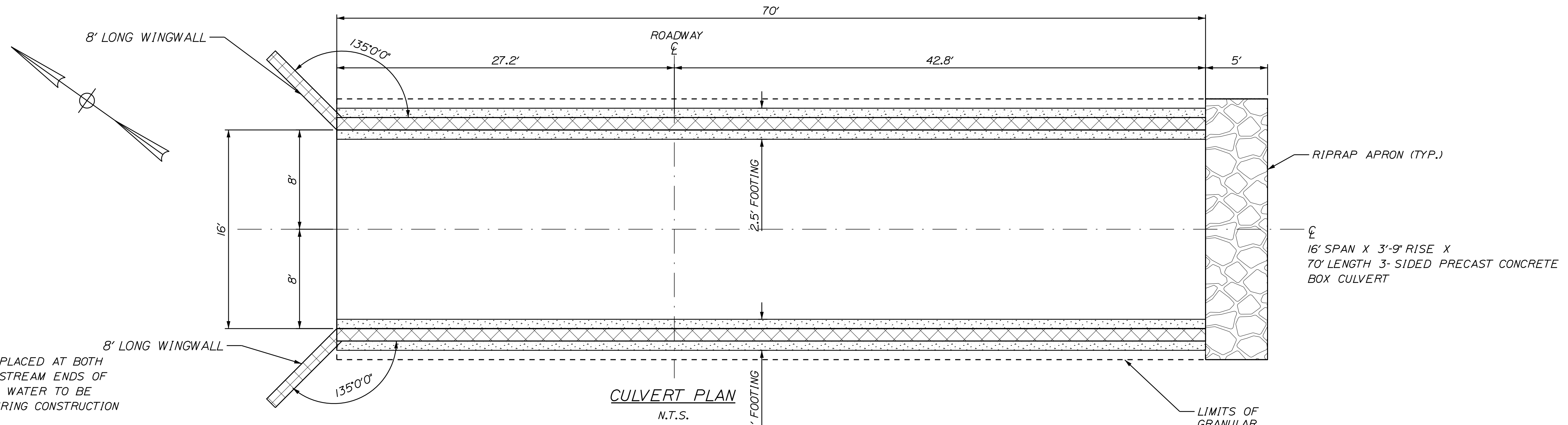

STATE OF MAINE
 DEPARTMENT OF TRANSPORTATION
 22665.00
 WIN
 22665.00
 BRIDGE # 6654
 HIGHWAY PLANS

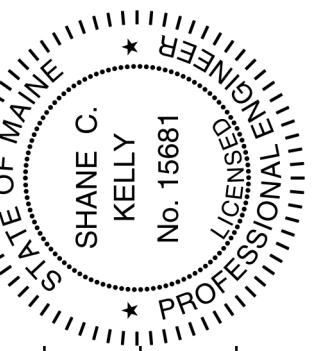

SIGNATURE
 P.E. NUMBER
 DATE

PROJ. MANAGER	BY	DATE
L. HAMILTON	S. KELLY	06/24/20
CHECKED/REVIEWED	B. LYON	06/24/20
DESIGN DETAIL		
DESIGN DETAIL		
REVISIONS 1		
REVISIONS 2		
REVISIONS 3		
REVISIONS 4		
FIELD CHANGES		

BRIDGTON
 DAY BROOK BRIDGE
 SPECIAL DETAILS

SHEET NUMBER
 3
 OF 13

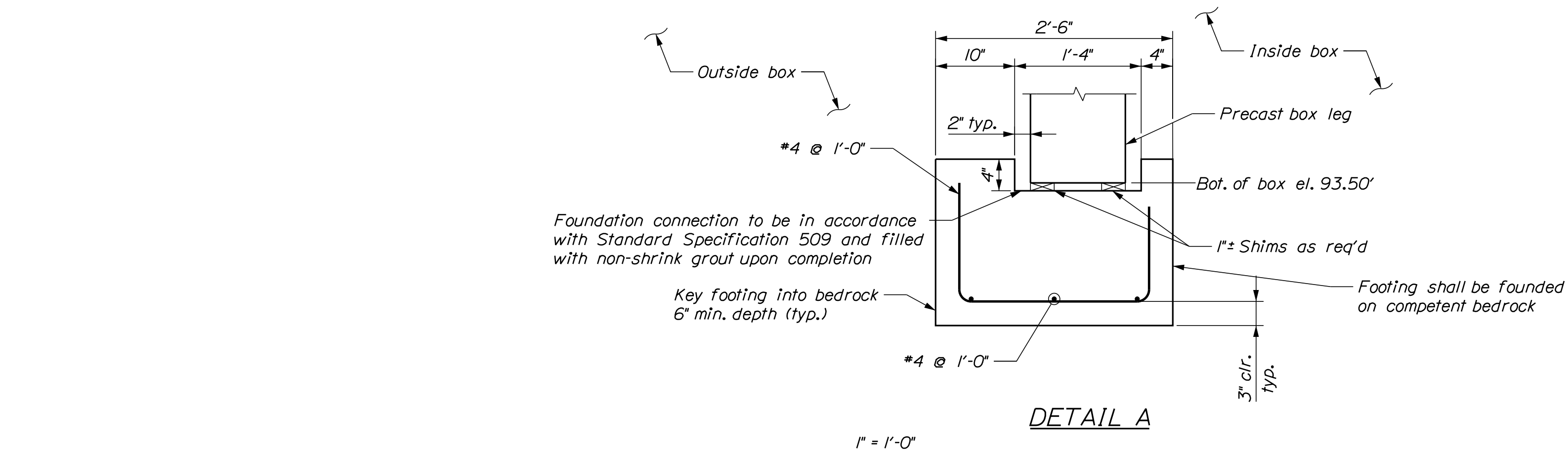

FOOTING NOTES

1. FOOTING HEIGHT WILL VARY AND MAY BE STEPPED BASED ON ACTUAL BEDROCK ELEVATIONS.

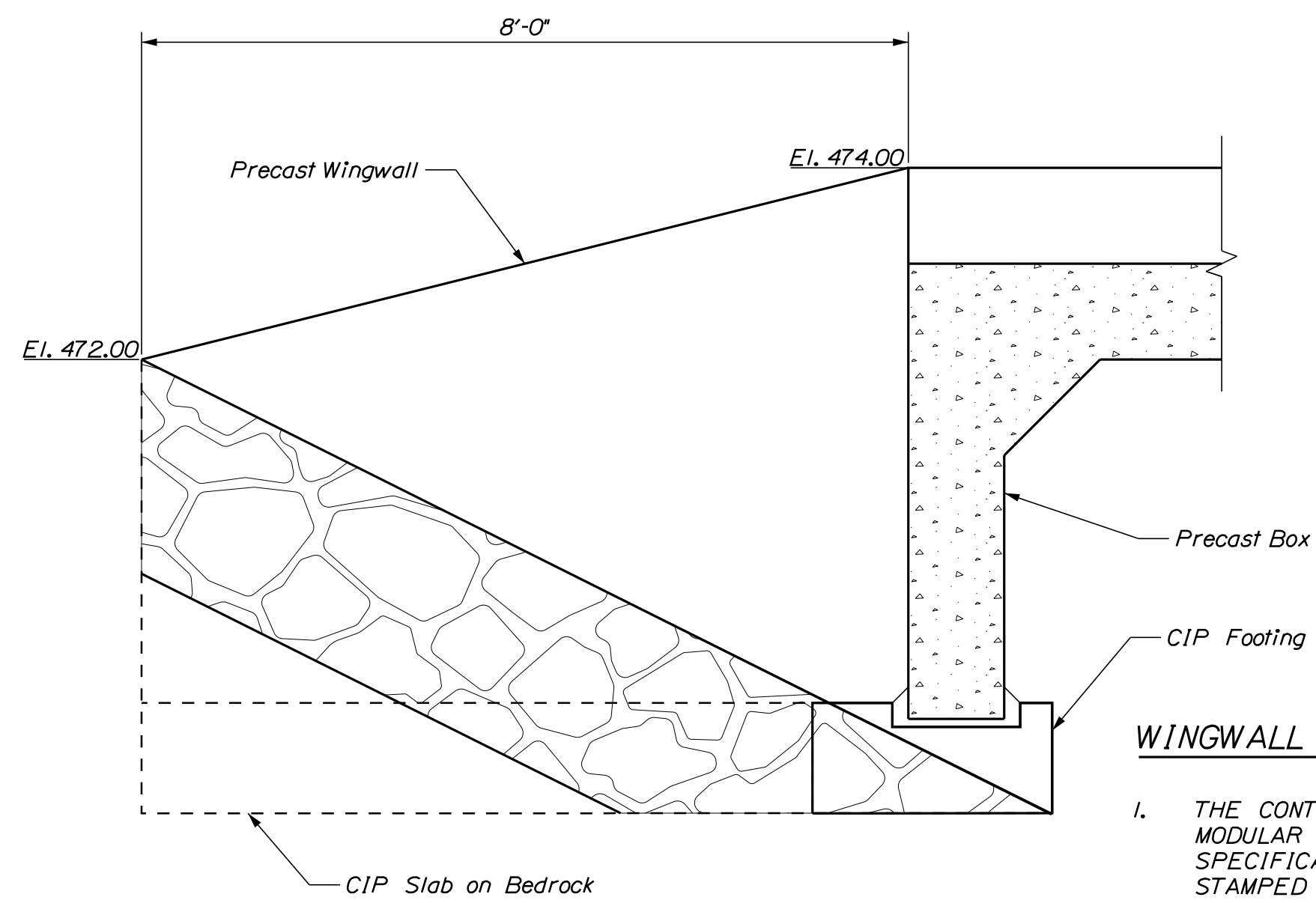

Wingwall A Elevation

N.T.S.
Note: Wingwall A shown, Wingwall B opposite hand

WINGWALL NOTES

1. THE CONTRACTOR SHALL PROVIDE A PRECAST CONCRETE MODULAR GRAVITY WALL IN ACCORDANCE WITH STANDARD SPECIFICATIONS 674. REQUIRED DESIGN SHALL BE STAMPED BY A PROFESSIONAL ENGINEER LICENSED IN THE STATE OF MAINE AND THE DESIGN AND SHOP DRAWINGS SHALL BE SUBMITTED TO THE RESIDENT FOR REVIEW. PLAN DETAILS ARE SHOWN FOR ESTIMATING PURPOSES ONLY.
2. THE PRECAST CONCRETE MODULAR GRAVITY WALL SYSTEM SHALL BE ON THE MAINE DOT QUALIFIED PRODUCTS LIST (QPL) OF PROPRIETARY RETAINING WALL SYSTEMS AND BE MANUFACTURED BY A LICENSED MANUFACTURER OF THE SELECTED PRODUCT.
3. BACKFILL AND FOUNDATION SOIL PARAMETERS FOR USE IN THE SUBMITTED DESIGN SHALL BE IN ACCORDANCE WITH STANDARD SPECIFICATION 674.
4. THE PRECAST CONCRETE MODULAR GRAVITY WALL SHALL BE DESIGNED IN ACCORDANCE WITH STANDARD SPECIFICATIONS SECTION 674 AND AASHTO LRFD BRIDGE DESIGN SPECIFICATIONS, 8TH EDITION, 2017. TRAFFIC LOADING SHALL BE INCLUDED IN THE WALL DESIGN.
5. FOR THE STRENGTH AND SERVICE LIMIT STATES THE APPLIED FACTORED BEARING PRESSURE FOR THE WALL SHALL NOT EXCEED THE FACTOR BEARING RESISTANCE OF 20 KSF.
6. PIPED DRAINAGE SHALL BE INCLUDED IN THE WALL DESIGN IN ACCORDANCE WITH STANDARD SPECIFICATIONS SECTION 674 AND THE MANUFACTURER'S RECOMMENDATIONS. DRAINAGE SHALL BE CONSIDERED INCIDENTAL TO CONSTRUCTION OF THE WALL.

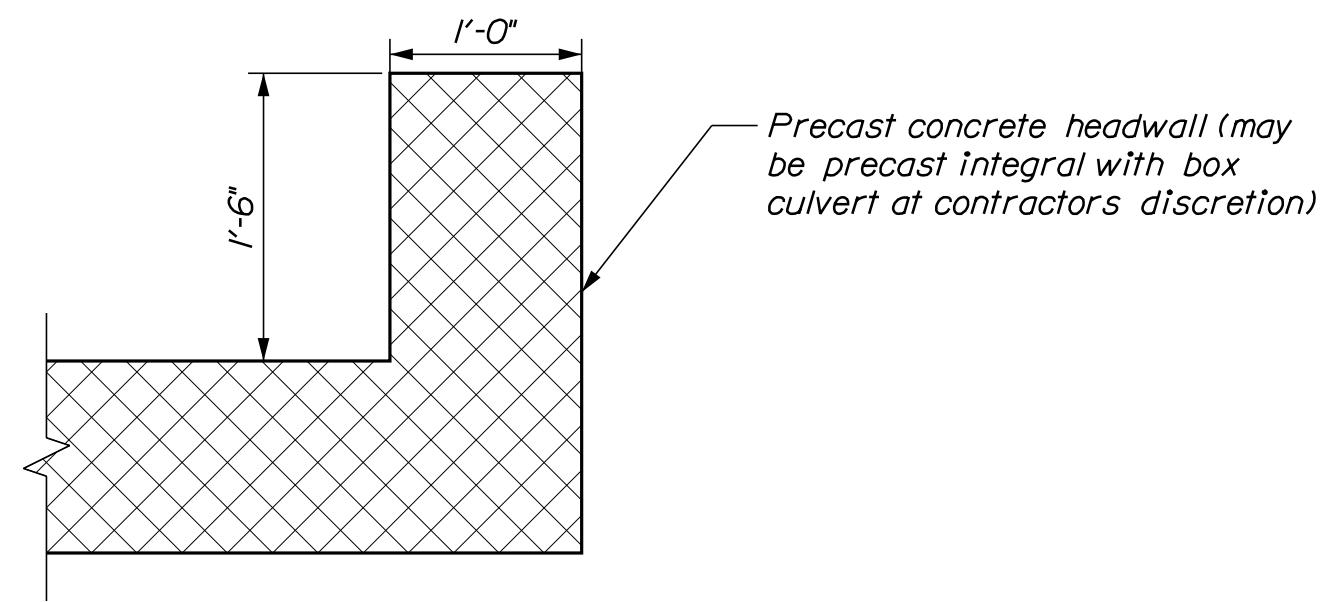

Precast Concrete Headwall Detail

N.T.S.

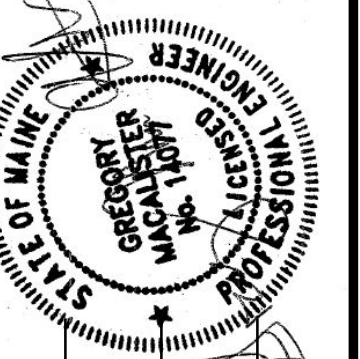

SIGNATURE
14077
P.E. NUMBER
06/24/2020
DATE

PROJ. MANAGER	BY	DATE
L. HAMILTON	S. MACALISTER	06/24/20
CHECKED-REVIEWED	B. LYON	06/24/20
DESIGN DETAILED		
DESIGN DETAILED		
REVISIONS 1		
REVISIONS 2		
REVISIONS 3		
REVISIONS 4		
FIELD CHANGES		

BRIDGTON
DAY BROOK BRIDGE
SPECIAL DETAILS

SHEET NUMBER

4

OF 13

DOROTHY I. SNOW

KAREN M. HAWKINS

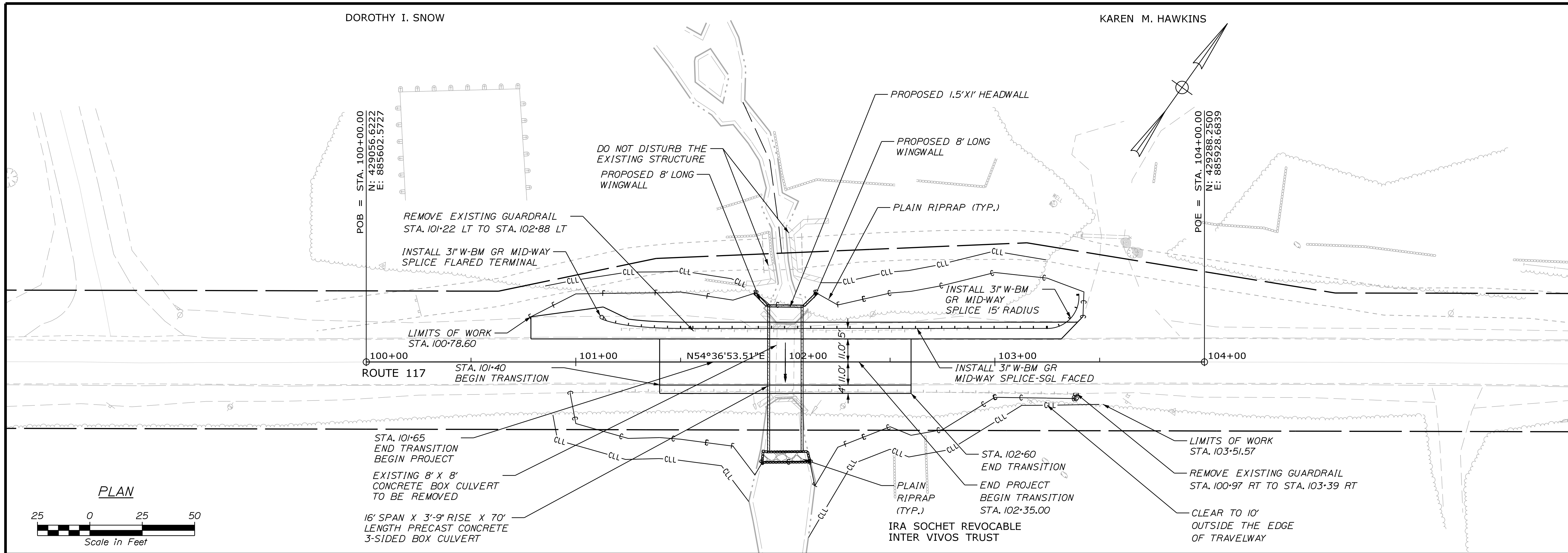

PLAN

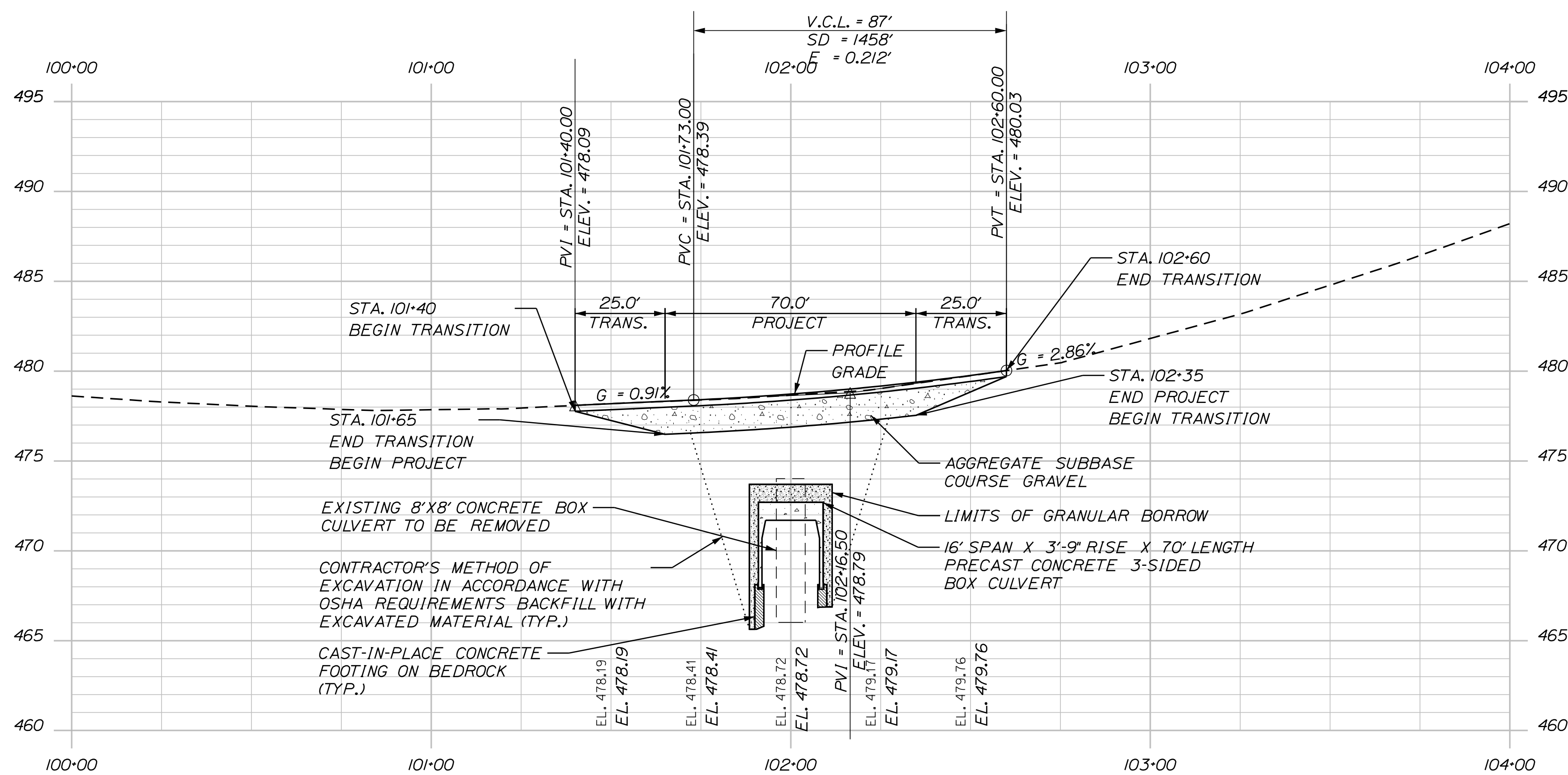

PROFILE

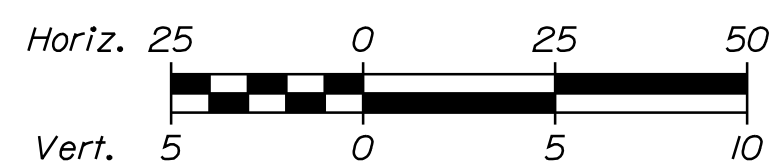

PROFILE

STATE OF MAINE
DEPARTMENT OF TRANSPORTATION
22665.00
WIN
22665.00
BRIDGE #6544
HIGHWAY PLANS

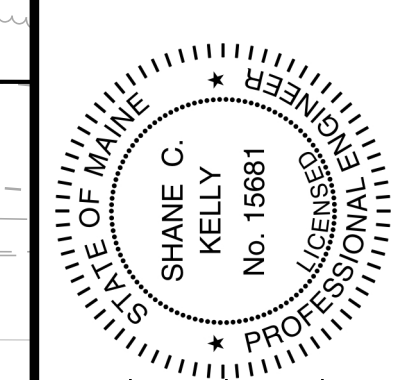

SIGNATURE
SHANE C. KELLY
No. 15681
P.E. NUMBER
06/24/2020
DATE

PROJ. MANAGER	BY	DATE
L. HAMILTON	S. KELLY	06/24/20
DESIGN DETAILED	B. LYON	06/24/20
CHECKED-REVIEWED		
DESIGN DETAILED		
DESIGN DETAILED		
REVISIONS 1		
REVISIONS 2		
REVISIONS 3		
REVISIONS 4		
FIELD CHANGES		

BRIDGTON
DAY BROOK BRIDGE
PLAN AND PROFILE

SHEET NUMBER

6

OF 13

Date: 6/24/2020

Username: skelly

Division: HIGHWAY

Filename: ... \MSTA\SHEETS\006_HDPlan.dgn

Date: 6/23/2020

Username: skelly

Division: HIGHWAY

Filename: ... \HIGHWAY\MSTA\SHEETS\Xsect.dgn

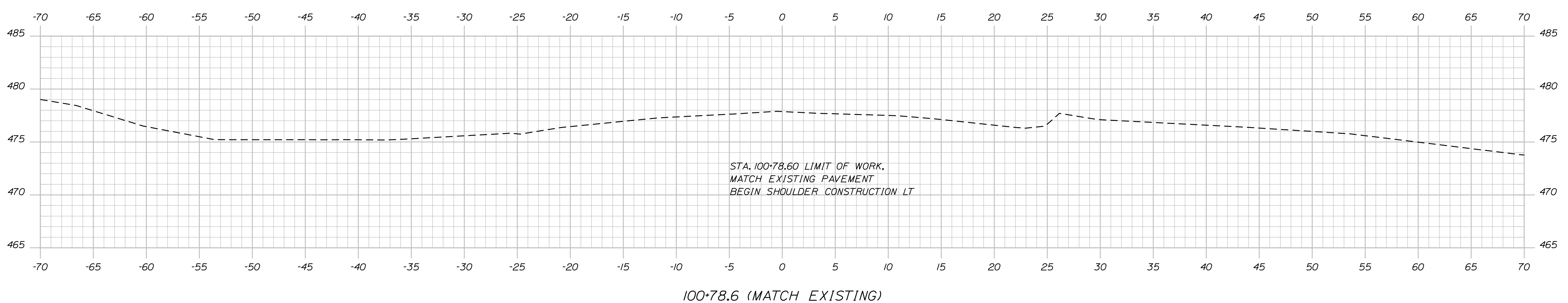
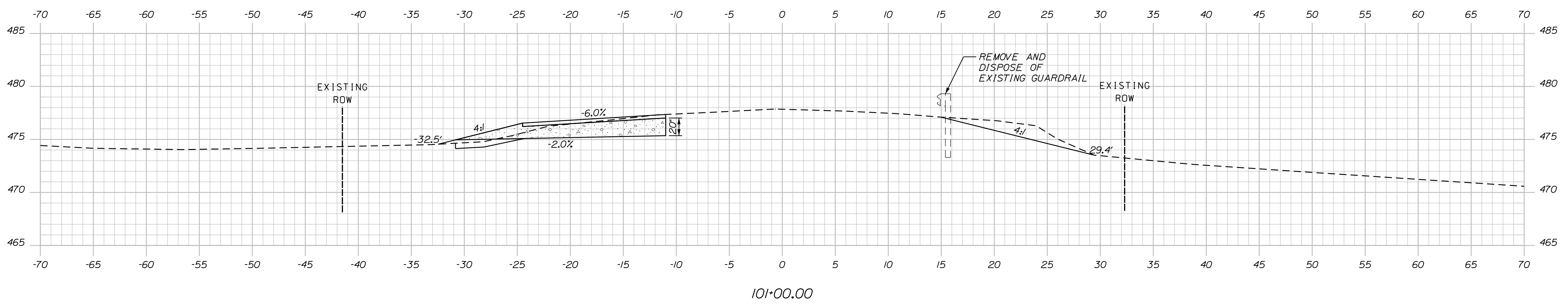
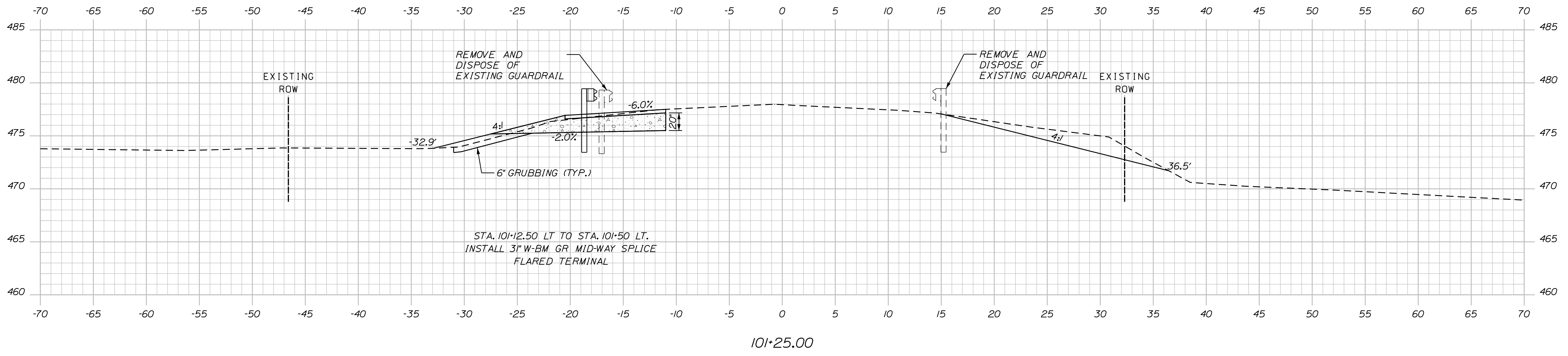

STATE OF MAINE
DEPARTMENT OF TRANSPORTATION
22665.00
WIN 22665.00
BRIDGE #6544
HIGHWAY PLANS

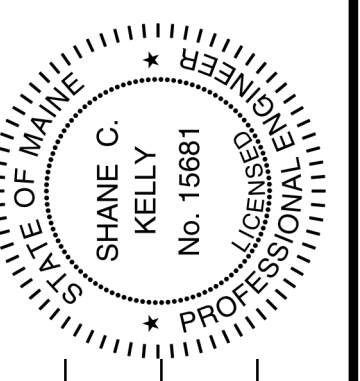

SIGNATURE: [Signature]
P.E. NUMBER: 15681
DATE: 06/24/2020

DATE	06/24/20
BY	S. KELLY
BY	B. LYON
L. HAMILTON	
PROJ. MANAGER	
DESIGN DETAILED	
CHECKED/REVIEWED	
DESIGN DETAILED	
DESIGN DETAILED	
REVISIONS 1	
REVISIONS 2	
REVISIONS 3	
REVISIONS 4	
FIELD CHANGES	

BRIDGTON
DAY BROOK BRIDGE
CROSS SECTIONS

SHEET NUMBER
7
OF 13

Date: 6/23/2020

Username: skelly

Division: HIGHWAY

Filename: ... \HIGHWAY\MSTA\SHEETS\Xsect.dgn

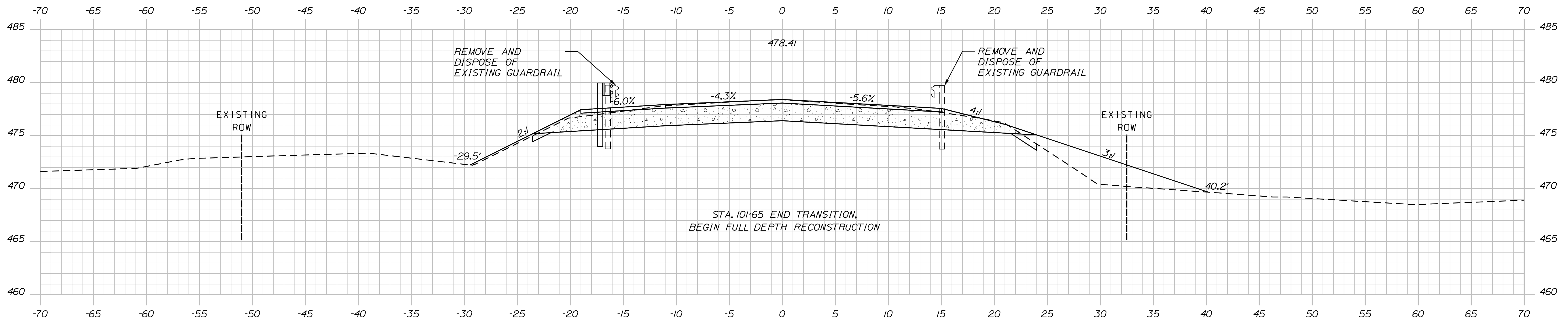

101+75.00

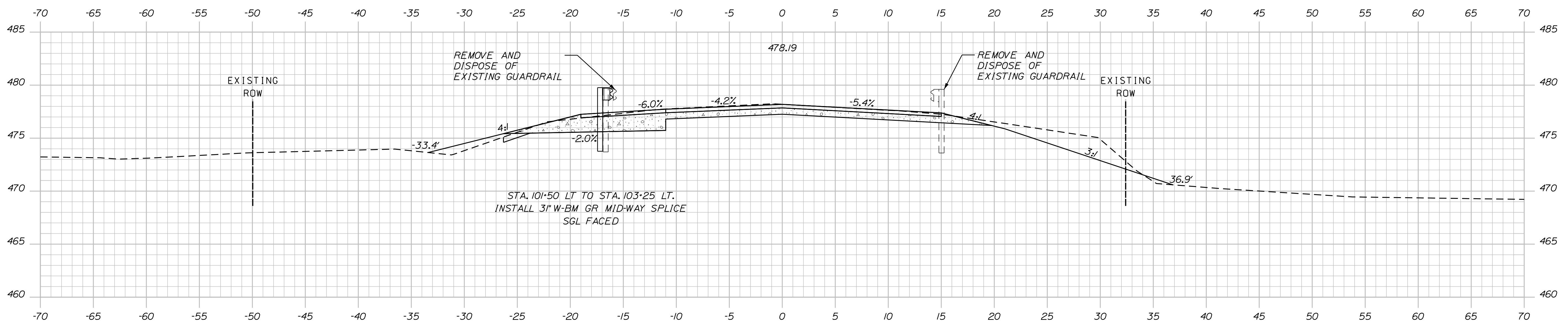

101+50.00

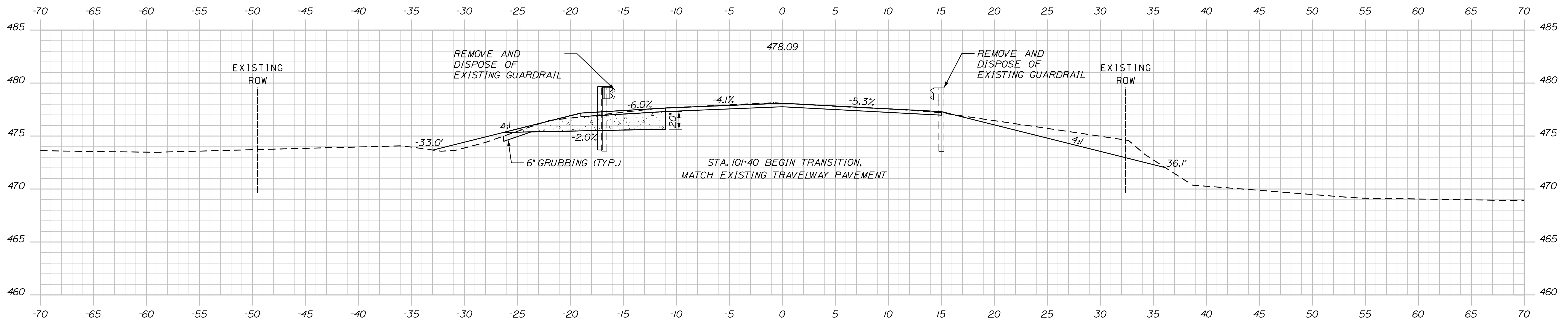

101+40.00

STATE OF MAINE
DEPARTMENT OF TRANSPORTATION

BRIDGE #6544
WIN
22665.00
HIGHWAY PLANS

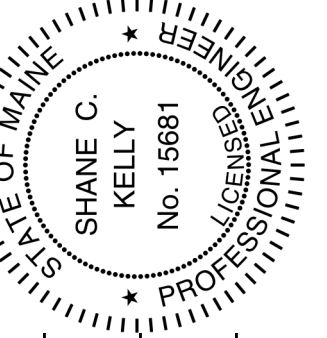

PROJ. MANAGER	DATE	SIGNATURE
CHECKED-REVIEWED	06/24/20	[Signature]
DESIGN-REVIEWED	06/24/20	
DESIGN-DETAILED		
REVISIONS 1		
REVISIONS 2		
REVISIONS 3		
REVISIONS 4		
FIELD CHANGES		

BY	DATE	SIGNATURE
S. KELLY	06/24/20	[Signature]
B. LYON	06/24/20	

BRIDGTON
DAY BROOK BRIDGE
CROSS SECTIONS

SHEET NUMBER

8

OF 13

Date: 6/23/2020

Username: skelly

Division: HIGHWAY

Filename: ... \HIGHWAY\MSTA\SHEETS\sect.dgn

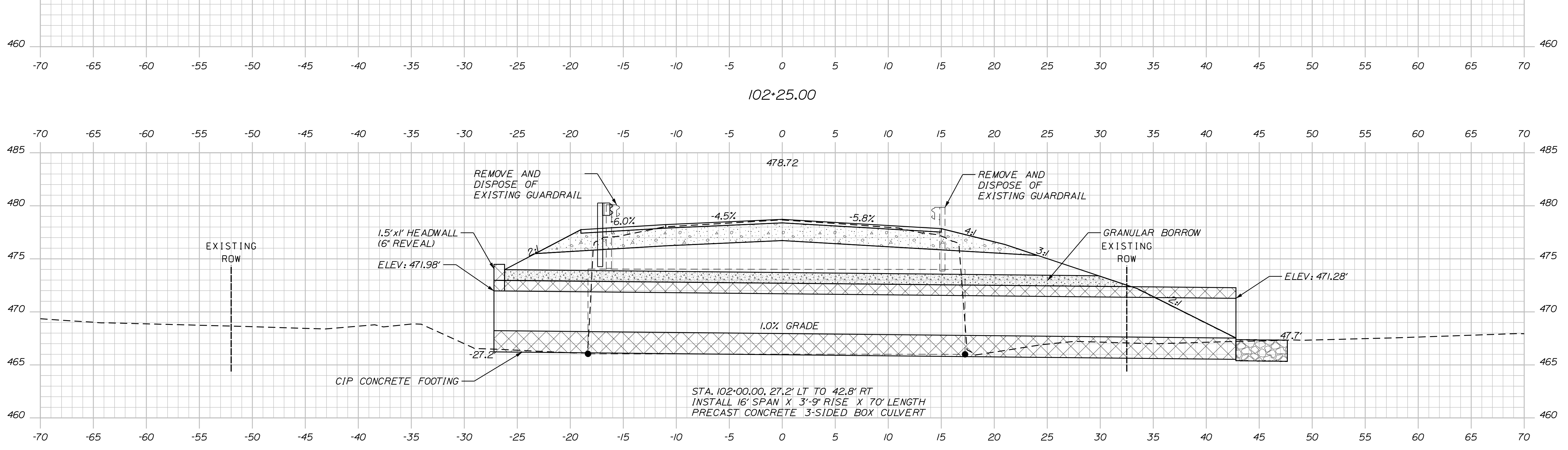
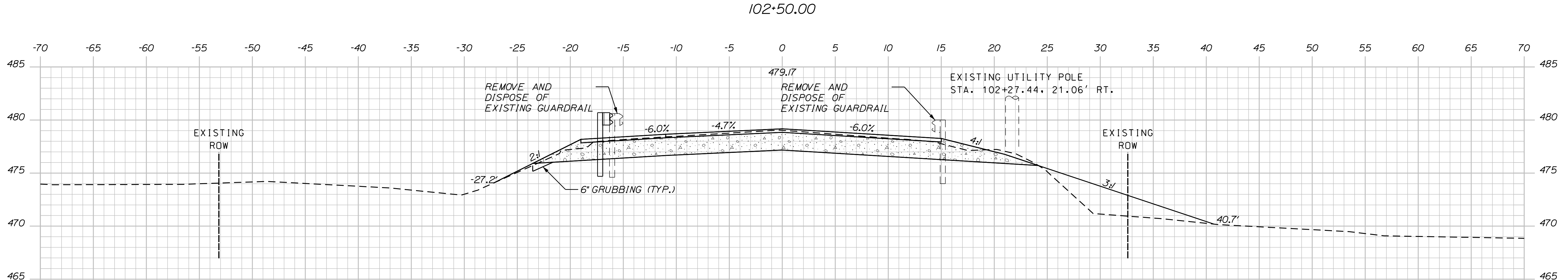
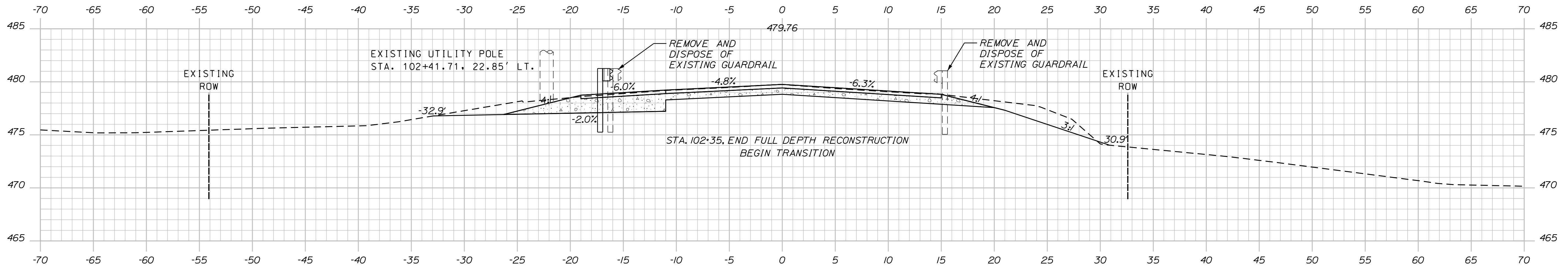

STATE OF MAINE
 DEPARTMENT OF TRANSPORTATION
 22665.00
 WIN 22665.00
 BRIDGE #6544 HIGHWAY PLANS

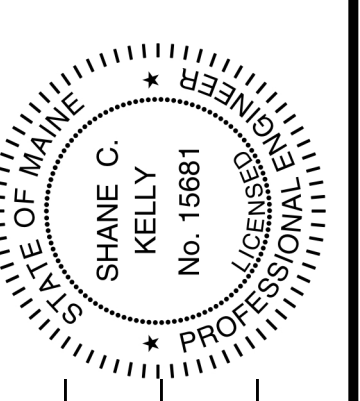

PROJ. MANAGER	L. HAMILTON	DATE	06/24/20
CHECKED-REVIEWED	S. KELLY	DATE	06/24/20
DESIGN-REVIEWED	B. LYON	SIGNATURE	(Signature)
DESIGN-REVIEWED		P.E. NUMBER	15681
REVISIONS 1		DATE	06/24/2020
REVISIONS 2			
REVISIONS 3			
REVISIONS 4			
FIELD CHANGES			

BRIDGTON
 DAY BROOK BRIDGE
 CROSS SECTIONS

SHEET NUMBER
 9
 OF 13

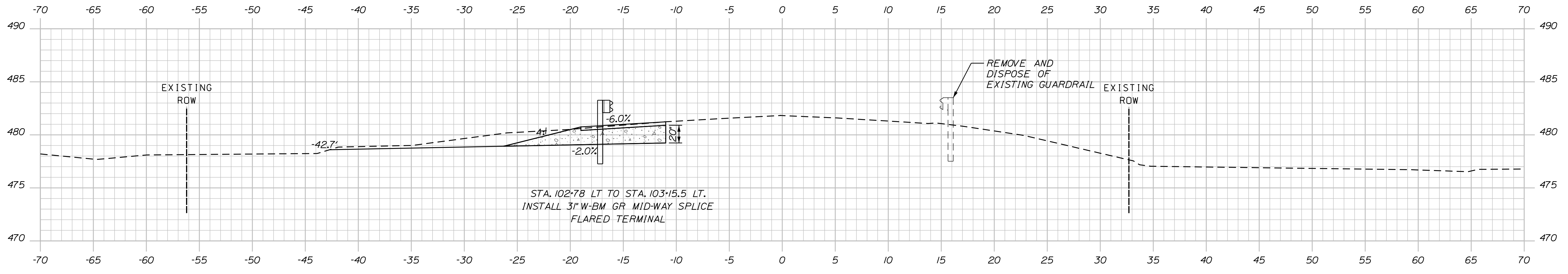

103+00.00

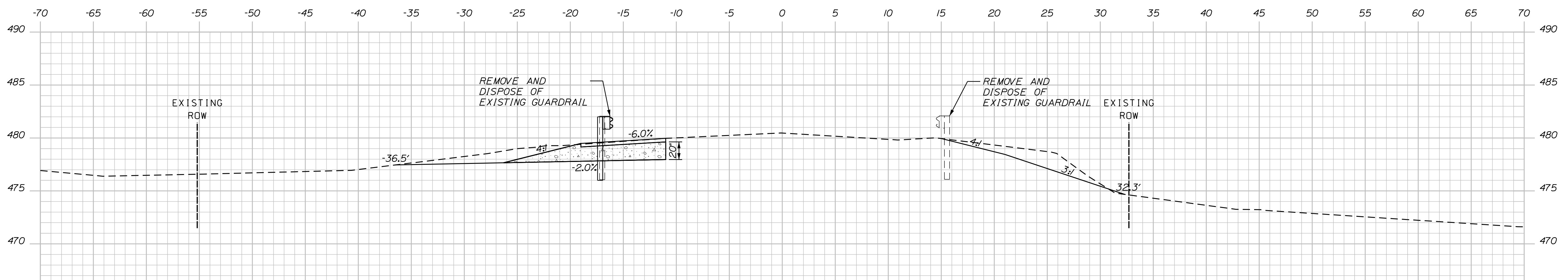

102+75.00

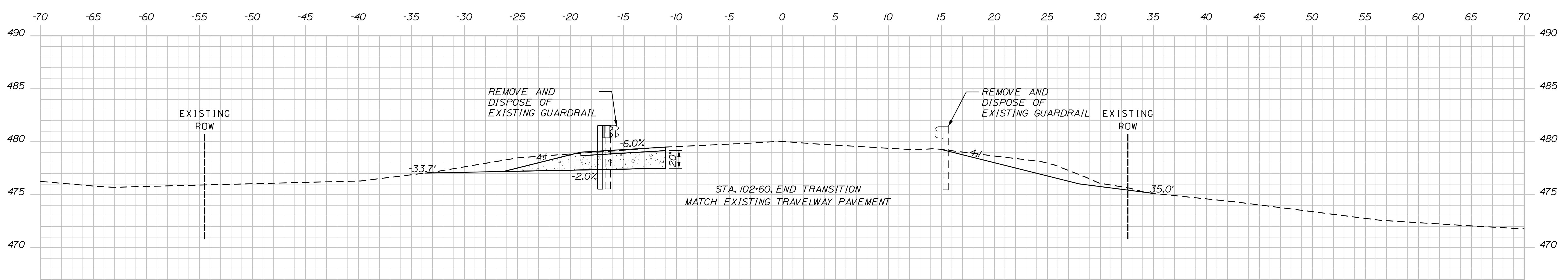

102+60.00

STATE OF MAINE
DEPARTMENT OF TRANSPORTATION
22665.00
WIN
22665.00
BRIDGE #6544
HIGHWAY PLANS

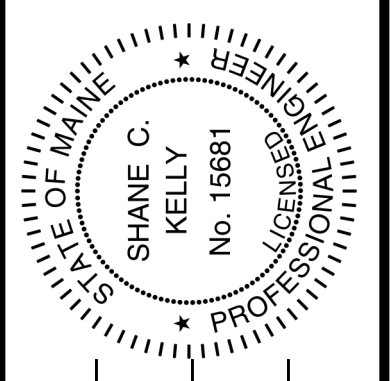

PROJ. MANAGER	L. HAMILTON	DATE	06/24/20
CHECKED-REVIEWED	S. KELLY	DATE	06/24/20
DESIGN-REVIEWED	B. LYON	SIGNATURE	(Signature)
DESIGN-REVIEWED		P.E. NUMBER	15681
REVISIONS 1		DATE	06/24/2020
REVISIONS 2			
REVISIONS 3			
REVISIONS 4			
FIELD CHANGES			

BRIDGTON
DAY BROOK BRIDGE
CROSS SECTIONS

SHEET NUMBER
10
OF 13

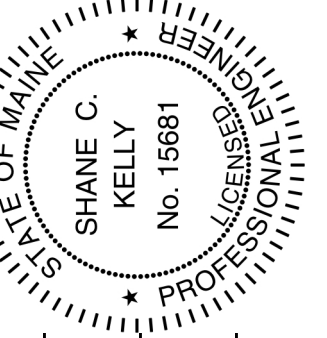

SIGNATURE
P.E. NUMBER
DATE

PROJ. MANAGER	DATE
L. HAMILTON	06/24/20
CHECKED-REVIEWED	06/24/20
DESIGN-REVIEWED	
DESIGN-REVIEWED	
DESIGN-REVIEWED	
REVISIONS 1	
REVISIONS 2	
REVISIONS 3	
REVISIONS 4	
FIELD CHANGES	

BRIDGTON
DAY BROOK BRIDGE
CROSS SECTIONS

SHEET NUMBER

11

OF 13

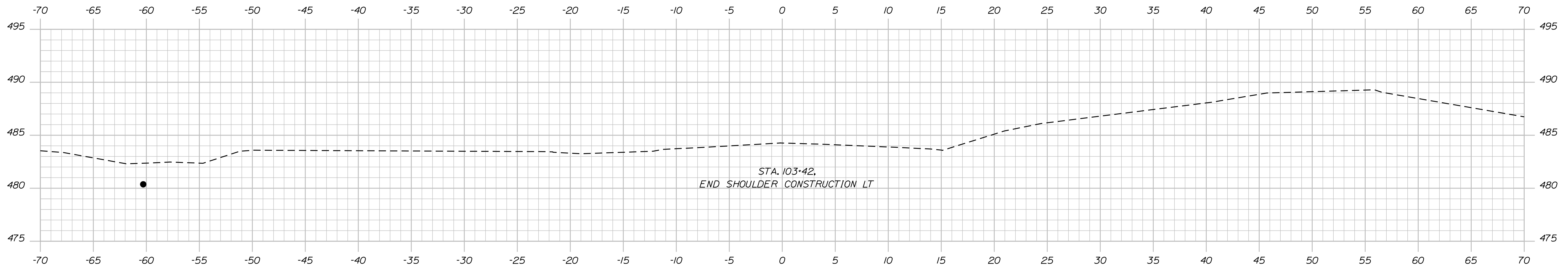

STA. 103+42,
END SHOULDER CONSTRUCTION LT

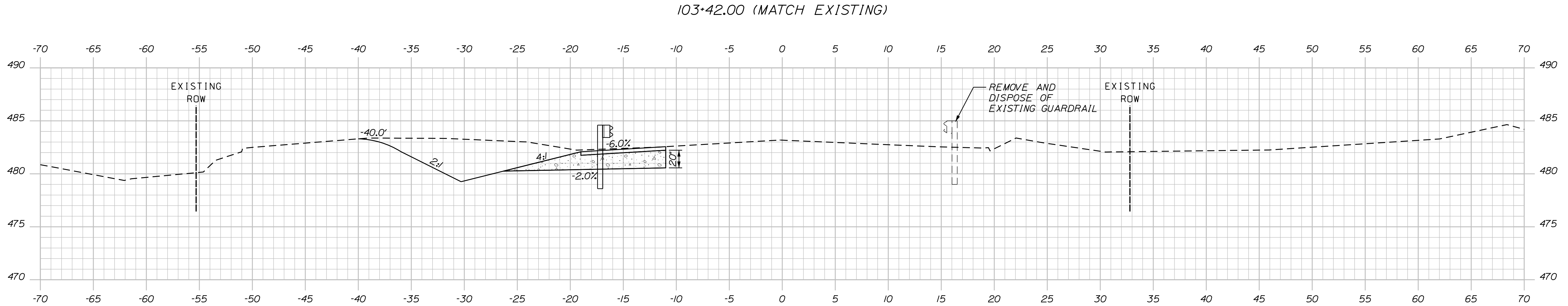

103+42.00 (MATCH EXISTING)

103+25.00

1

2

3

4

5

6

7

8

9

10

11

12

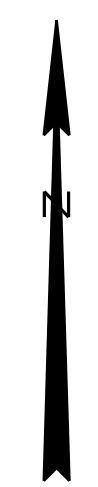
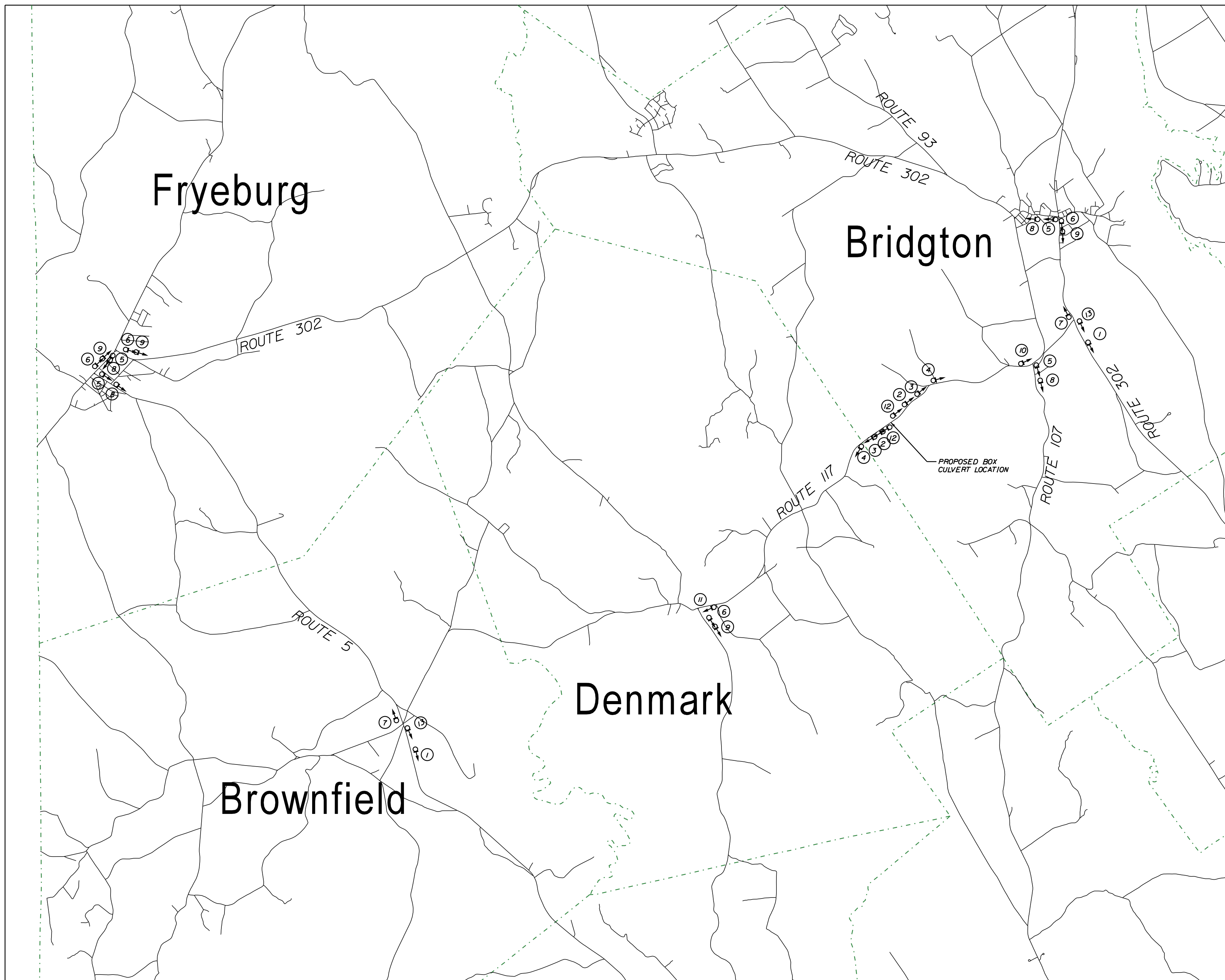

STATE OF MAINE
DEPARTMENT OF TRANSPORTATION

BRIDGTON
DAY BROOK BRIDGE
DETOUR PLAN

SHEET NUMBER
12
OF 13

22665.00
WIN
22665.00
HIGHWAY PLANS
BRIDGE #6554

PROF. MANAGER: L. HAMILTON
BY: S. KELLY, B. LYON
DATE: 06/24/20
SIGNATURE: SHANE C. KELLY, No. 15681
P.E. NUMBER: 06/24/2020
DATE: 06/24/2020

DESIGN DETAILED
CHECKED/REVIEWED
DESIGN DETAILED
DESIGN DETAILED
REVISIONS 1
REVISIONS 2
REVISIONS 3
REVISIONS 4
FIELD CHANGES

STATE OF MAINE
SHANE C. KELLY
No. 15681
PROFESSIONAL ENGINEER
LICENSE NUMBER

Town, County, State _____
 Approx. Property Lines _____
 Existing Right of Way _____
 Limits of Wrought Portion _____
 Control Of Access _____
 New Right of Way _____
 New Easement _____
 New Temporary Rights _____
 New R/W Within Existing R/W _____

New R/W Along Existing R/W _____
 Building _____
 Trees Conifer _____
 Tree Line _____
 Water Edge _____
 Ledge _____
 Fence _____
 Sign _____

Clearing Limit Line _____
 Deciduous _____
 Bush Line _____
 Rock/Boulder _____
 Flag Pole _____
 BARB WIRE _____
 STOCKADE _____
 WELL _____
 Mailbox _____

PLAN LEGEND

Existing Proposed

Sanitary Sewer _____
 Telephone Line _____
 Electric Line _____
 Water Line _____
 Underdrain Line _____
 Gas Line _____
 Guardrail _____
 Culvert _____

Traveled Way _____
 Ditch _____
 Catch Basin _____
 Manhole _____
 Sewer Manhole _____
 Utility Pole _____
 Fire Hydrant _____
 Curbing _____

Cut Line _____
 Stonewall _____
 Baseline _____
 Monument _____
 Iron Rod Found _____
 Replacement Pin Set _____

Fill Line _____
 Retaining Wall _____
 Traverse Point _____
 Pipe Found _____

THIS PLAN WAS PREPARED IN CONNECTION WITH THE DEPARTMENT'S ACQUISITION OF REAL PROPERTY FOR TRANSPORTATION PURPOSES. IT CANNOT BE USED TO ESTABLISH LEGAL BOUNDARIES BETWEEN ABUTTING PROPERTY OWNERS.

Scale of Feet: 0, 25, 50, 75, 100

STATE OF MAINE
 REGISTRY OF DEEDS

COUNTY OF _____
 RECEIVED _____, 20____
 AT _____ HRS. _____ MINS. _____ M.
 AND RECORDED IN _____
 PLAN BOOK _____
 (OR FILE NO.) _____, PAGE _____
 ATTEST: _____ REGISTRAR

NOTE: CONTROL INFORMATION
 HORIZONTAL DATUM - US STATE PLANE NAD83 (2011)
 ZONE - MAINE 2000 WEST ZONE
 VERTICAL DATUM - NAVD 88
 COMBINED SCALE FACTOR - 0.9999805

NOTE:
 THIS SECTION OF OLD ROUTE 117, VOL 13, PAGE 181, 1795
 PRESUMED DISCONTINUED AFTER REALIGNMENT IN 1931.

DOROTHY I. SNOW

KAREN M. HAWKINS

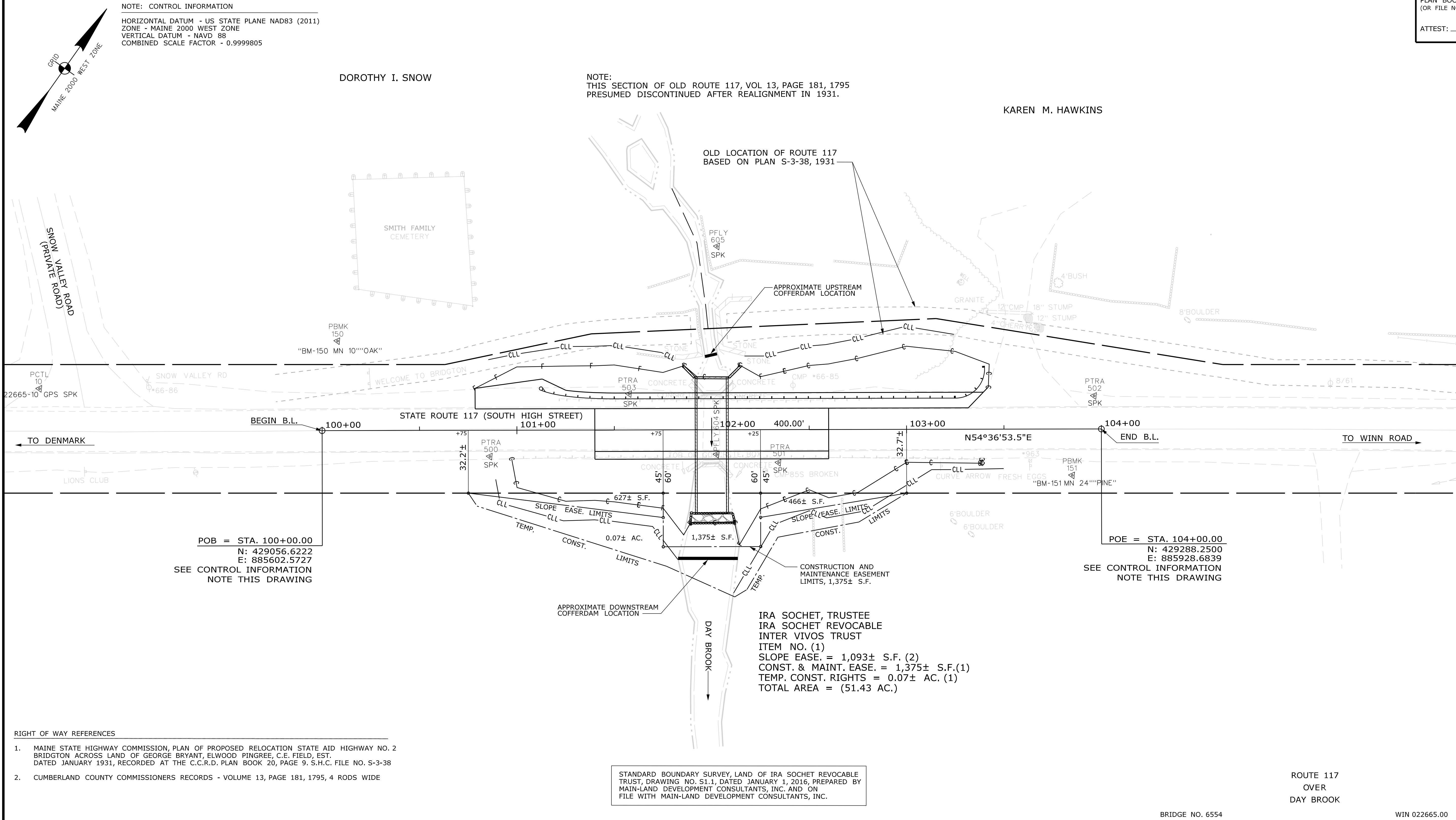

POB = STA. 100+00.00
 N: 429056.6222
 E: 885602.5727
 SEE CONTROL INFORMATION
 NOTE THIS DRAWING

POE = STA. 104+00.00
 N: 429288.2500
 E: 885928.6839
 SEE CONTROL INFORMATION
 NOTE THIS DRAWING

IRA SOCHET, TRUSTEE
 IRA SOCHET REVOCABLE
 INTER VIVOS TRUST
 ITEM NO. (1)
 SLOPE EASE. = 1,093± S.F. (2)
 CONST. & MAINT. EASE. = 1,375± S.F. (1)
 TEMP. CONST. RIGHTS = 0.07± AC. (1)
 TOTAL AREA = (51.43 AC.)

STANDARD BOUNDARY SURVEY, LAND OF IRA SOCHET REVOCABLE TRUST, DRAWING NO. S1.1, DATED JANUARY 1, 2016, PREPARED BY MAIN-LAND DEVELOPMENT CONSULTANTS, INC. AND ON FILE WITH MAIN-LAND DEVELOPMENT CONSULTANTS, INC.

- RIGHT OF WAY REFERENCES
1. MAINE STATE HIGHWAY COMMISSION, PLAN OF PROPOSED RELOCATION STATE AID HIGHWAY NO. 2 BRIDGTON ACROSS LAND OF GEORGE BRYANT, ELWOOD PINGREE, C.E. FIELD, EST. DATED JANUARY 1931, RECORDED AT THE C.C.R.D. PLAN BOOK 20, PAGE 9. S.H.C. FILE NO. S-3-38
 2. CUMBERLAND COUNTY COMMISSIONERS RECORDS - VOLUME 13, PAGE 181, 1795, 4 RODS WIDE

ROUTE 117
 OVER
 DAY BROOK

BRIDGE NO. 6554 WIN 022665.00

REVISIONS			PLAN FILED IN PLAN BOOK				PAGE COUNTY RECORD				BRUCE A. VAN NOTE	
NO.	DATE	DESCRIPTION	NO.	GRANTOR	INSTRUMENT	DATE	BOOK	PAGE	COND.	DATE		BOOK
						10/21/19	36090	107				

STATE AID HIGHWAY NO. 2
 SOUTH HIGH STREET
 BRIDGTON CUMBERLAND COUNTY
 STATE PROJECT NO. 22665.00

JUNE 2019
 SCALE 1" = 25'

RIGHT-OF-WAY MAP
 SHEET 1 OF 1

D.O.T. FILE NO. 3-640

SHEET NUMBER
13
 OF 13

ITEM	TECH	CHECKED	EXISTING CONDITION PLAN			FINAL RIGHT OF WAY		
			R.M.C.	R.M.C.	R.M.C.	R.M.C.	R.M.C.	J.D.

STATE OF MAINE
 DEPARTMENT OF TRANSPORTATION
 16 STATE HOUSE STATION - AUGUSTA, ME 04333-0016 - 207-624-3460
 BRIDGTON
 RIGHT OF WAY MAP

Date: 6/25/2020

Username: Ewa.Swinton

Division: ROW

Filename: ... \00\ROW\MSTA001_RWP\LAN1.dgn