

STATE OF MAINE DEPARTMENT OF TRANSPORTATION



LYMAN YORK COUNTY ROUTE III & KENNEBUNK POND ROAD NHPP-2250(100) PROJECT LENGTH: 0.04 MILES (INTERSECTION IMPROVEMENTS)

PLAN LEGEND	
Town, County, State	Centerline-Existing
Property Lines	Centerline-Proposed
R/W Lines-Existing	Travelway-Existing
R/W Lines-Proposed	Travelway-Proposed
Culvert-Existing	Railroad
Culvert-Proposed	Catch Basins
Curbing Existing	Manholes
Curbing Proposed	Proposed Underdrain
Type 1	Proposed Ditch
Type 3	Existing Ditch
Type 5	Utility Poles
Outline of Bodies of Water	Fire Hydrants
Exposed Bedrock	Existing Water Line
Buildings	Existing San. Sewer
Trees	Existing San. Sewer Manhole
Tree Line	Guardrail-Existing
Clearing Limit Line	Guardrail-Proposed
Boring	Guardrail-Cable, Other
Probe	
### = Depth	
X = W (Weathered Rock)	
R (Refusal)	
NR (No Refusal)	
Pavement Core	
Test Pit	

INDEX OF SHEETS	
Description	Sheet No.
Title Sheet	1
General Notes	2
Details	3
General Plan	4
Profile	5
Signing and Striping Plan	6
Curbing Plan	7
Cross Sections	8-9

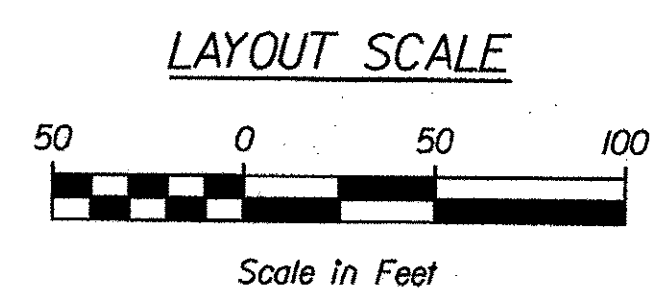
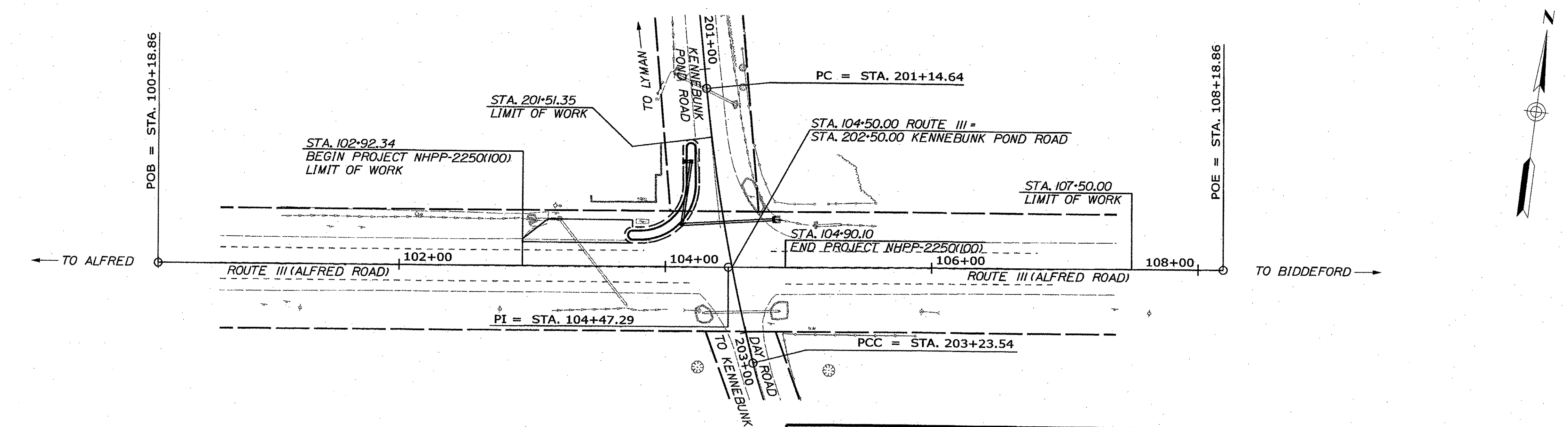

PROJECT LOCATION:	Intersection of Route 111 (Alfred Road), Day Road and Kennebunk Pond Road, in Lyman
PROGRAM AREA:	Multimodal Program
SCOPE OF WORK:	Safety and spot improvements including installation of a curbed island, drainage and solar powered LED flashing stop signs.

STATE OF MAINE DEPARTMENT OF TRANSPORTATION	APPROVED	DATE
COMMISSIONER: <i>[Signature]</i>		8/5/18
CHIEF ENGINEER: <i>[Signature]</i>		2-5-18

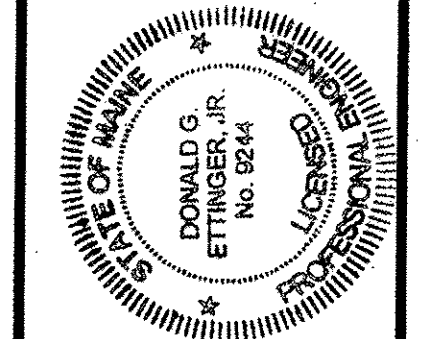

<i>[Signature]</i>	SIGNATURE	9244	P.E. NUMBER	1-11-18	DATE
B. KEIZER	PROJECT MANAGER	DONALD C. ETTINGER, JR.	DESIGNER	CORRILL PALMER	CONSULTANT
	PROJECT RESIDENT		CONTRACTOR		PROJECT COMPLETION DATE

PROGRAM	MULTIMODAL
PROJECT MANAGER	B. KEIZER
DESIGNER	DONALD C. ETTINGER, JR.
CONSULTANT	CORRILL PALMER
PROJECT RESIDENT	
CONTRACTOR	
PROJECT COMPLETION DATE	

LYMAN
ROUTE 111 & KENNEBUNK POND ROAD
INTERSECTION IMPROVEMENTS
TITLE SHEET

WIN 22501.00

SHEET NUMBER	1
	OF 9



Relationships. Responsiveness. Results.
www.gorrillpalmer.com
207.772.2515

Filename: ... \00\Highway\001_Title.dgn
Division: HIGHWAY
Username: jared.wirchenbach
Date: 1/11/2018

GENERAL NOTES:

1. THE UTILITIES INVOLVED IN THIS CONTRACT ARE NOTED IN SPECIAL PROVISION 104.
2. ALL UTILITY FACILITIES SHALL BE ADJUSTED BY THE RESPECTIVE UTILITIES UNLESS OTHERWISE NOTED.
3. THE CONTRACTOR SHALL CONTACT DIG-SAFE AND APPROPRIATE AUTHORITIES PRIOR TO ANY SUBSURFACE ACTIVITIES.
4. THE LOCATION OF THE EXISTING UTILITIES AND DRAINAGE SHOWN ON THE PLANS AND CROSS SECTIONS WERE COMPILED FROM FIELD SURVEY. LOCATIONS ARE APPROXIMATE AND NOT GUARANTEED TO BE ACCURATE NOR IS IT GUARANTEED THAT ALL UTILITIES ARE SHOWN. NO SEPARATE OR ADDITIONAL COMPENSATION WILL BE ALLOWED TO THE CONTRACTOR DUE TO ANY VARIANCE BETWEEN THE DATA SHOWN ON THE PLANS AND THE ACTUAL FIELD CONDITIONS ENCOUNTERED.
5. PROPERTY LINE AND R.O.W. MONUMENTS SHALL NOT BE DISTURBED BY CONSTRUCTION. IF DISTURBED, THEY SHALL BE RESET TO THEIR ORIGINAL LOCATIONS AT THE CONTRACTOR'S EXPENSE, BY A MAINE PROFESSIONAL LAND SURVEYOR.
6. THE CONTRACTOR SHALL COMPLETE THE WORK WITHIN THE RIGHT-OF-WAY, AND WILL BE RESPONSIBLE IF THEY TRESPASS ON PRIVATE PROPERTY, UNLESS WORK IS SHOWN OTHERWISE ON THE PLANS.
7. CONTRACTOR SHALL NOT PARK, IMPEDE ACCESS OR STORE EQUIPMENT/MATERIAL ON ADJACENT PRIVATELY OWNED LAND WITHOUT WRITTEN CONSENT FROM THE LAND OWNER.
8. ANY DAMAGE TO THE SLOPES OR PAVEMENT CAUSED BY THE CONTRACTOR'S EQUIPMENT, PERSONNEL, OR OPERATION SHALL BE REPAIRED TO THE SATISFACTION OF THE RESIDENT. ALL WORK, EQUIPMENT, AND MATERIALS REQUIRED TO MAKE REPAIRS SHALL BE AT THE CONTRACTOR'S EXPENSE.
9. ALL WASTE MATERIAL NOT USED ON THE PROJECT SHALL BE DISPOSED OF OFF THE PROJECT IN APPROVED WASTE AREAS REVIEWED BY THE RESIDENT. GRADING, SEEDING AND MULCHING OF WASTE AREAS SHALL BE CONSIDERED INCIDENTAL.
10. ALL CLEARING SHALL BE CONSIDERED INCIDENTAL TO THE CONTRACT AND NO SEPARATE PAYMENT WILL BE MADE. THE ACTUAL LINES FOR CLEARING SHALL BE ESTABLISHED IN THE FIELD BY THE CONTRACTOR AS INDICATED ON THE PLANS AND APPROVED BY THE RESIDENT.
11. DO NOT EXCAVATE FOR AGGREGATE SUBBASE COURSE WHERE EXISTING MATERIAL IS SUITABLE AS DETERMINED BY THE RESIDENT.
12. IN AREAS WHERE THE RESIDENT DIRECTS THE CONTRACTOR NOT TO EXCAVATE TO THE SUBGRADE LINE SHOWN ON THE PLANS, PAYMENT FOR REMOVING EXISTING PAVEMENT, GRUBBING, SHAPING, DITCHING, AND COMPACTING THE EXISTING SUBBASE AND LAYERS OF NEW SUBBASE 6 INCHES OR LESS THICK WILL BE MADE UNDER APPROPRIATE EQUIPMENT RENTAL ITEMS.
13. ANY NECESSARY FINE GRADING OR RECOMPACTION OF EXISTING GRAVEL SHALL NOT BE PAID FOR DIRECTLY AND SHALL BE CONSIDERED INCIDENTAL TO ITEM 304.14.
14. THE PAVEMENT SAW CUT LINES ARE DEFINED ON THE DETAILS. CONTRACTOR SHALL NOTE THE PAVEMENT SAW CUT LIMITS ARE PROVIDED FOR RECONSTRUCTION AREAS ONLY AND ARE NOT SHOWN FOR PROPOSED DRAINAGE WORK.
15. PAVEMENT CUT LINES SHALL BE NEAT, CLEAN AND STRAIGHT AS DIRECTED BY THE RESIDENT. PAYMENT FOR CUTTING OF EXISTING PAVEMENT SHALL BE INCIDENTAL TO 403 ITEMS.
16. ANY NECESSARY CLEANING OF EXISTING PAVEMENT PRIOR TO PAVING SHALL BE INCIDENTAL TO THE RELATED PAVING ITEMS.
17. B-I-C CATCH BASINS SHALL BE SHAPE I WITH HAUNCHED CONE, AS PER STANDARD DETAIL 604102), UNLESS OTHERWISE NOTED ON THE PLANS.
18. CATCH BASIN AND RIM ELEVATIONS NOTED ON THE PLANS ARE THE TOP OF GRATE ELEVATIONS AT THE CENTER OF GRATE. CATCH BASIN OFFSET LOCATIONS ARE MEASURED TO THE CENTER OF THE GRATE.
19. EXISTING CULVERTS TO REMAIN SHALL BE CLEANED AS DIRECTED BY THE RESIDENT. PAYMENT WILL BE MADE UNDER ITEM 631.32 CULVERT CLEANER (INCLUDING OPERATOR).
20. NO EXISTING DRAINAGE SHALL BE ABANDONED, REMOVED OR PLUGGED WITHOUT PRIOR APPROVAL OF THE RESIDENT.
21. INLETS AND OUTLETS OF ALL CULVERTS SHALL BE RIPRAPPED UNLESS OTHERWISE NOTED ON THE PLANS OR DIRECTED BY THE RESIDENT.
22. THE CULVERT SIZES SHOWN ON THE PLANS AND CROSS SECTIONS ARE FOR SMOOTHLINED PIPES.
23. GRANULAR BORROW USED UNDER PIPES SHALL MEET THE REQUIREMENTS FOR MATERIAL FOR UNDERWATER BACKFILL AS SPECIFIED IN STANDARD SPECIFICATION 703.19.
24. COMMERCIAL PAVED ENTRANCES SHALL BE CONSTRUCTED WITH 3" HOT MIX ASPHALT AND 1" AGGREGATE SUBBASE COURSE GRAVEL.
25. DRIVEWAY AND SIDE STREET ACCESS SHALL BE MAINTAINED AT ALL TIMES.
26. LOAM HAS BEEN ESTIMATED FOR 100% OF THE DISTURBED SLOPE AREA. ACTUAL PLACEMENT OF THE LOAM SHALL BE AS DIRECTED BY THE RESIDENT.
27. ALL DISTURBED SLOPE AREAS SHALL BE LOAMED AND SEEDED. UNLESS OTHERWISE NOTED, SEEDING METHOD NO. 3 SHALL BE UTILIZED.
28. REMOVAL OF EXISTING ROADSIDE SIGNS AND RELOCATION OF ROADSIDE SIGNS/POSTS AS NOTED ON THE SIGNING PLANS OR AS DIRECTED BY THE RESIDENT SHALL BE CONSIDERED INCIDENTAL TO THE 645 PAY ITEMS.
29. ALL NEW SIGNS SHALL HAVE HIGH INTENSITY REFLECTIVE SHEETING IN ACCORDANCE WITH MAINE DOT SPECIFICATIONS. WHEN WOOD POSTS ARE USED THEY SHALL BE PRESSURE TREATED.
30. ALL SIGNING AND STRIPING MATERIALS AND PLACEMENT SHALL CONFORM TO THE MAINE DOT STANDARD SPECIFICATIONS, SUPPLEMENTAL SPECIFICATIONS AND STANDARD DETAILS, NOVEMBER 2014, AND WITH THE FEDERAL HIGHWAY ADMINISTRATION "MANUAL ON UNIFORM TRAFFIC CONTROL DEVICES", MOST CURRENT EDITION.
31. THE CONTRACTOR SHALL BE RESPONSIBLE FOR INSTALLING 36" X 36" EMBEDDED LED FLASHING STOP SIGNS. FOR ADDITIONAL INFORMATION SEE SPECIAL PROVISION 645 (EMBEDDED LED FLASHING SIGN).
32. THE CONTRACTOR SHALL REMOVE ALL EXISTING PAVEMENT MARKINGS THAT CONFLICT WITH PROPOSED MARKINGS, BY MEANS APPROVED BY THE RESIDENT.
33. FINAL STRIPING FOR THE PROJECT SHALL BE DONE BY THE CONTRACTOR PER THE STRIPING PLAN IN THE CONTRACT DOCUMENTS. PAYMENT SHALL BE MADE UNDER APPROPRIATE CONTRACT ITEMS.
34. ALL WORK CONTEMPLATED UNDER THIS CONTRACT SHALL BE GOVERNED BY AND BE IN CONFORMITY WITH THE MAINE DOT STANDARD SPECIFICATIONS (REVISION OF NOVEMBER 2014) AND THE STANDARD DETAILS (REVISION OF NOVEMBER 2014) EXCEPT PROVISIONS AND ANY AND ALL CORRECTIONS, REVISIONS OR ADDITIONS ISSUED BY MAINE DOT.
35. ALL WORK SHALL BE DONE IN ACCORDANCE WITH THE MAINE DEPARTMENT OF TRANSPORTATION'S BEST MANAGEMENT PRACTICES FOR EROSION CONTROL AND SEDIMENT CONTROL, FEBRUARY, 2008.
36. NO SEPARATE PAYMENT FOR SUPERINTENDENT OR FOREMAN WILL BE MADE FOR THE SUPERVISION OF EQUIPMENT BEING PAID FOR UNDER THE EQUIPMENT RENTAL ITEMS.
37. "UNDETERMINED LOCATIONS" SHALL BE DETERMINED BY THE RESIDENT.
38. STATIONS REFERENCED ARE APPROXIMATE.
39. CONTRACTOR SHALL COORDINATE WITH CMP/FAIRPOINT REGARDING TEMPORARY BRACING OF UTILITY POLE NUMBER CMP47/NETT96/1 DURING DRAINAGE INSTALLATION WORK. NO SEPARATE PAYMENT WILL BE MADE FOR POLE BRACING AND RELATED COORDINATION EFFORT.
40. SIGNS FOR ITEM 645.292 SHALL BE CONSTRUCTED OF SHEET ALUMINUM.
41. LOAM SHALL BE TO A NOMINAL DEPTH OF 4 INCHES UNLESS OTHERWISE NOTED OR DIRECTED.
42. A REVIEW BY THE MAINE DEPARTMENT OF TRANSPORTATION (MAINE DOT) SUGGESTED SOME PETROLEUM CONTAMINATION ISSUES IN THE VICINITY OF THE PROJECT. IN PARTICULAR BOUCHERS RV LOCATED AT THE NORTHWEST CORNER OF THE INTERSECTION WHICH WAS A FORMER RETAIL GASOLINE STATION. HOWEVER, THE SCOPE OF WORK FOR THIS PROJECT SUGGESTS PETROLEUM OR HAZARDOUS WASTE SHOULD NOT BE ENCOUNTERED. BASED ON MAINE DOT'S FINDINGS, THE CONTRACTOR SHALL EMPLOY APPROPRIATE HEALTH AND SAFETY MEASURES TO PROTECT ITS WORKERS AGAINST HAZARDS ASSOCIATED WITH WORKING NEAR PETROLEUM-IMPACTED SOILS. FURTHERMORE, THE CONTRACTOR SHALL REMAIN ALERT FOR ANY EVIDENCE OF CONTAMINATION. IF THE CONTRACTOR ENCOUNTERS EVIDENCE OF SOIL OR GROUNDWATER CONTAMINATION, THE CONTRACTOR SHALL SECURE THE EXCAVATION, STOP WORK IN THE CONTAMINATED AREA, AND IMMEDIATELY NOTIFY THE RESIDENT. THE RESIDENT SHALL CONTACT THE SENIOR GEOLOGIST IN MDOT'S OFFICE OF SAFETY AND COMPLIANCE (MAINE DOT-OSC) AT 207-624-3004 AND THE MAINE DEPARTMENT OF ENVIRONMENTAL PROTECTION (MDEP) AT 800-482-0777. WORK MAY ONLY CONTINUE WITH AUTHORIZATION FROM THE RESIDENT.

STATE OF MAINE DEPARTMENT OF TRANSPORTATION	1 WIN 22501.00
LYMAN ROUTE 111 & KENNEBUNK POND ROAD INTERSECTION IMPROVEMENTS	GENERAL NOTES
SHEET NUMBER	2
OF 9	OF 9

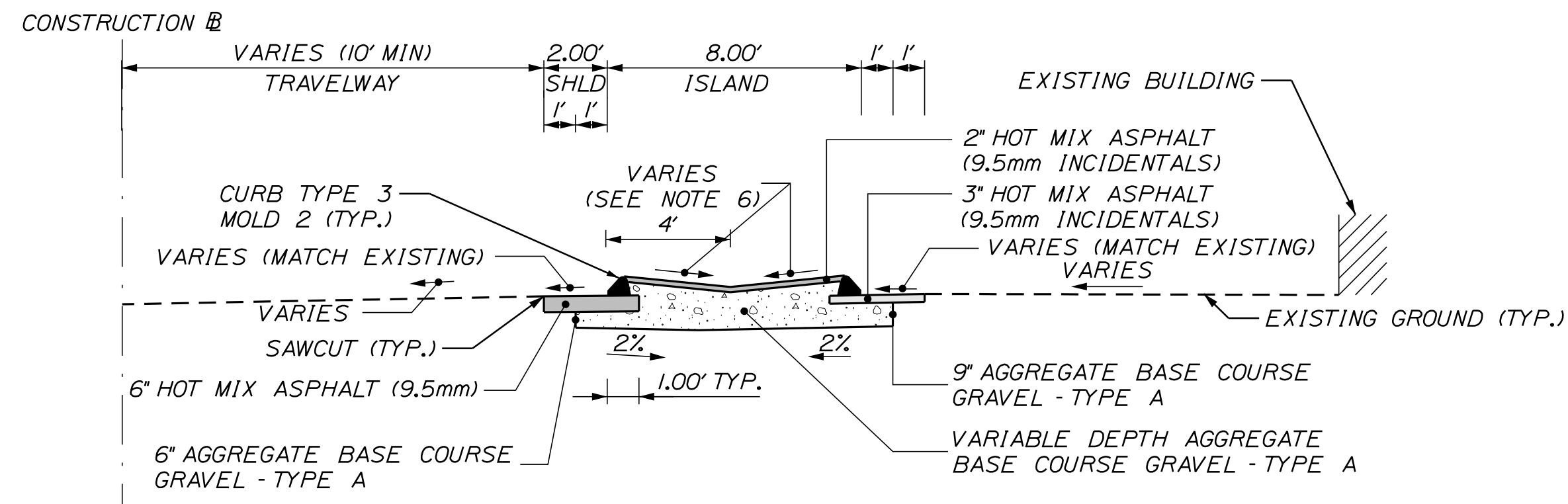

RAISED ISLAND DETAIL
(KENNEBUNK POND ROAD)
STA. 201+53 RT TO STA. 202+19 RT

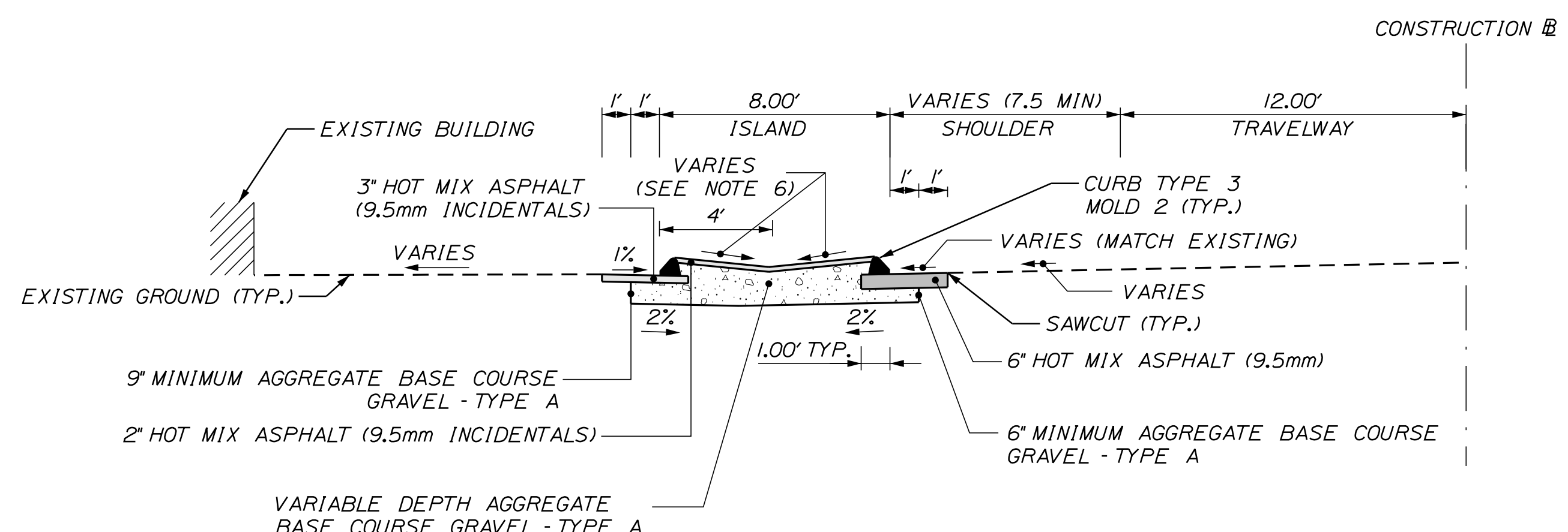

RAISED ISLAND DETAIL
(ROUTE III)
STA. 103+71 LT. TO STA. 104+23 LT.

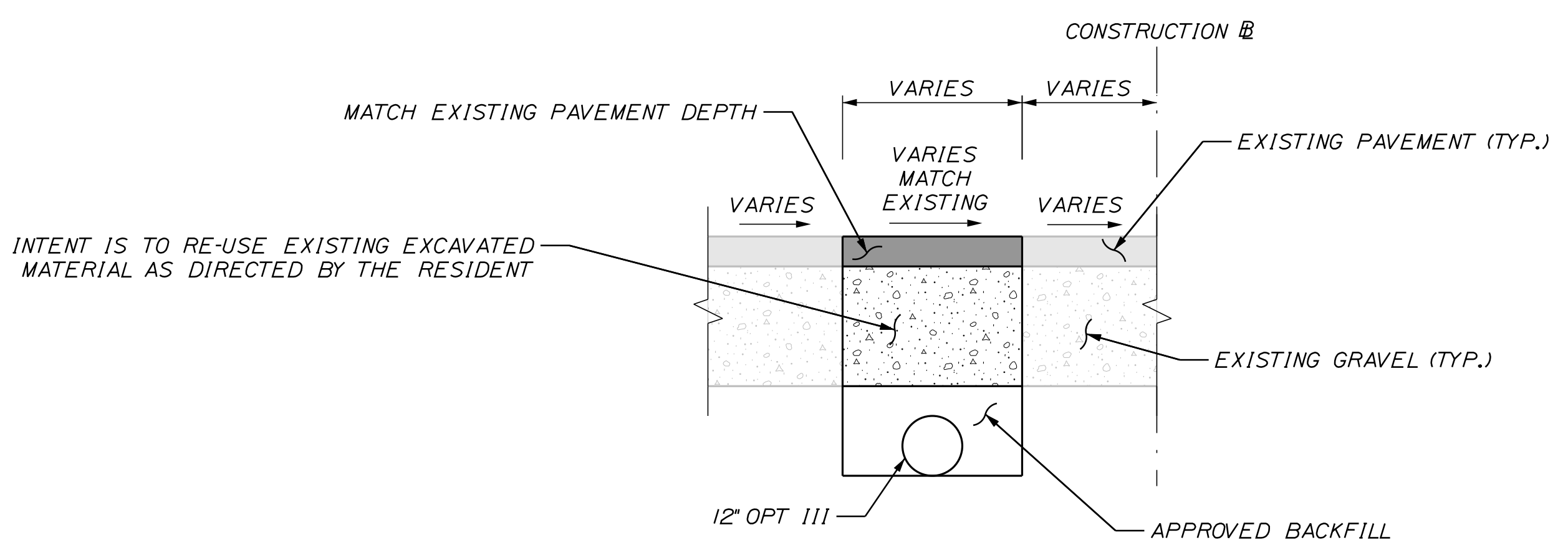

DRAINAGE TRENCH DETAIL
(ROUTE III)
STA. 104+12 LT. TO STA. 104+74 LT.

- NOTES:
1. THE PAVEMENT, BASE, AND SUBBASE DEPTHS AS SHOWN ON THE PLANS ARE INTENDED TO BE NOMINAL.
 2. CROWNS FOR BOTH NORMAL AND SUPERELEVATION SECTIONS FOR ALL COURSES OF SUBBASE AND PAVEMENT SHALL BE STRAIGHT.
 3. THE ALGEBRAIC DIFFERENCE BETWEEN THE SHOULDER AND TRAVELWAY CROSS SLOPES "ROLLOVER" SHALL NOT EXCEED 8%.
 4. THE STATIONING UNDER EACH TYPICAL IS APPROXIMATE.
 5. THE SHOULDER PAVEMENT THICKNESS SHALL BE THE SAME AS THE TRAVELWAY PAVEMENT THICKNESS FOR ALL ROADWAYS, UNLESS OTHERWISE NOTED.
 6. THE RAISED ISLAND WILL SLOPE TOWARDS THE CENTER AT A VARIABLE SLOPE THAT WILL RANGE FROM 6% TO 15% GRADE RAISED ISLAND TO PROPOSED CATCH BASIN (CB3). SEE CROSS SECTIONS FOR ADDITIONAL INFORMATION.

NOT TO SCALE

STATE OF MAINE		DEPARTMENT OF TRANSPORTATION	
PROJECT NUMBER		WIN 22501.00	
PROJ. MANAGER		DATE	
J. RODRIGUE	07/2018	SIGNATURE	
DESIGN DETAILED	07/2018	P.E. NUMBER	
CHECKED-REVIEWED		DATE	
DESIGN DETAILED			
REVISIONS 1			
REVISIONS 2			
REVISIONS 3			
REVISIONS 4			
FIELD CHANGES			
LYMAN		ROUTE 111 & KENNEBUNK POND ROAD	
ROUTE 111 & KENNEBUNK POND ROAD		INTERSECTION IMPROVEMENTS	
DETAILS		SHEET NUMBER	
		3	
		OF 9	

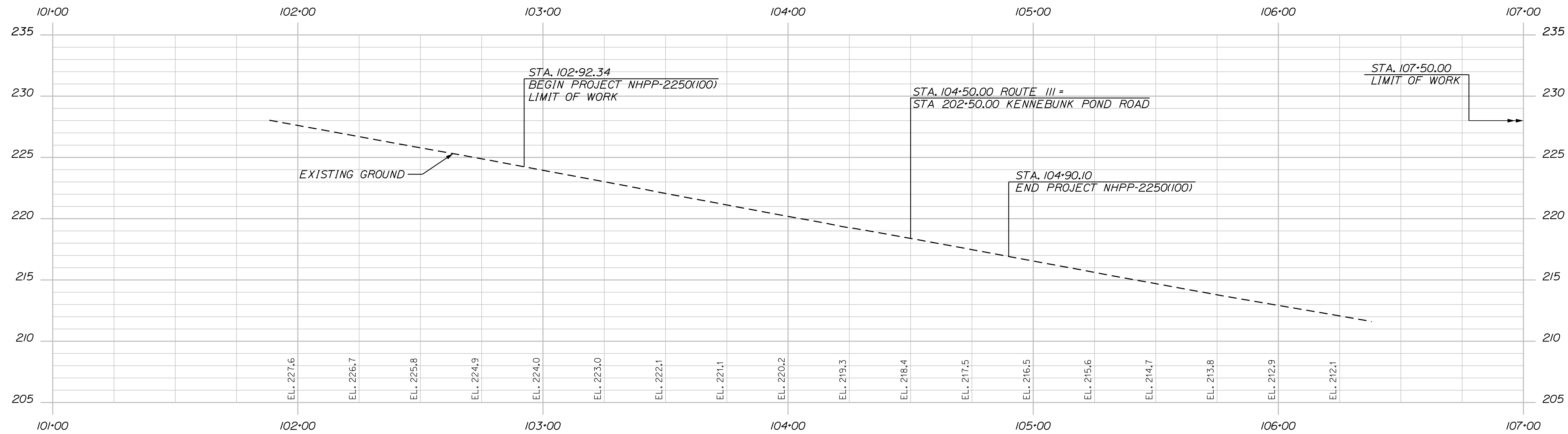

ROUTE III (ALFRED ROAD) PROFILE

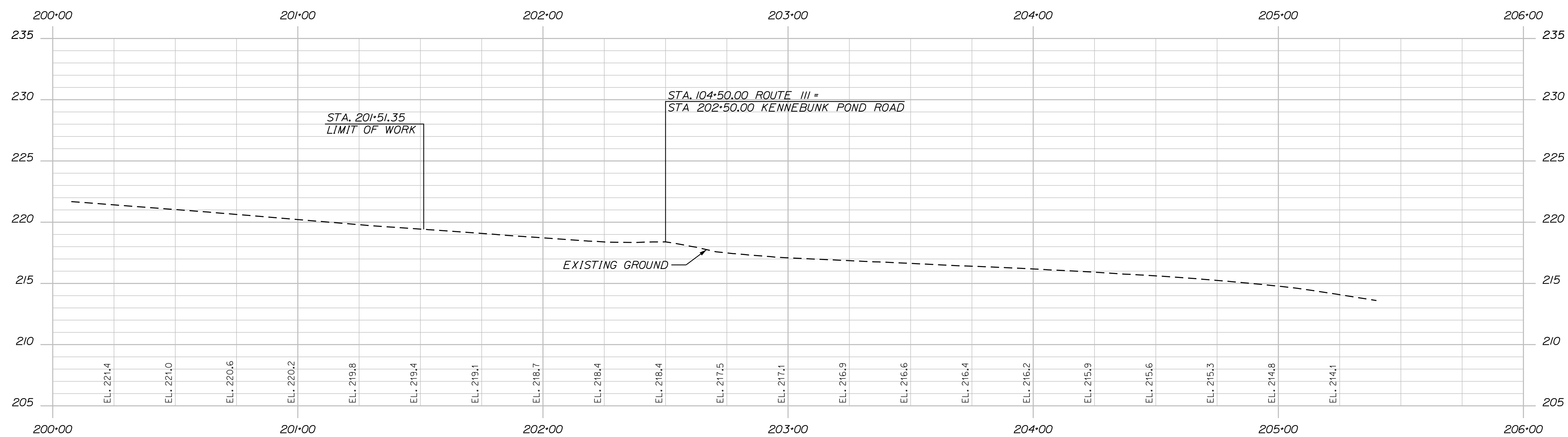

KENNEBUNK POND ROAD AND DAY ROAD PROFILE

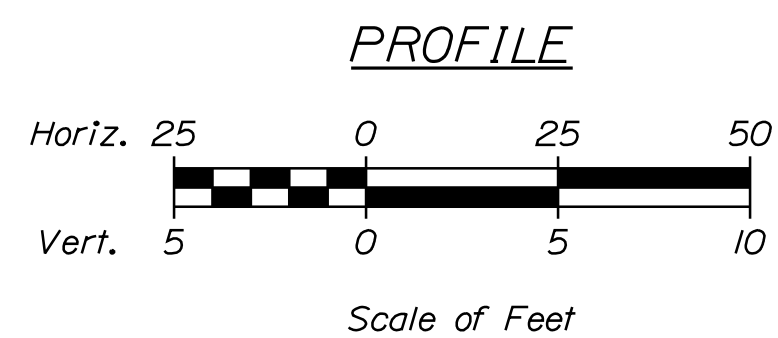

Relationships. Responsiveness. Results.
www.gorrillpalmer.com
207.772.2515

STATE OF MAINE
DEPARTMENT OF TRANSPORTATION

ROUTE 111 & KENNEBUNK POND ROAD
INTERSECTION IMPROVEMENTS

PROJ. MANAGER	J. RODRIGUE
BY	T. LAUDRY
DATE	07/2018
DESIGN DETAILED	J. WIRNENBACH
CHECKED/REVIEWED	D. DITTINGER
DESIGN DETAILED	
DESIGN DETAILED	
REVISIONS 1	
REVISIONS 2	
REVISIONS 3	
REVISIONS 4	
FIELD CHANGES	
SIGNATURE	
P.E. NUMBER	
DATE	

LYMAN
ROUTE 111 & KENNEBUNK POND ROAD
INTERSECTION IMPROVEMENTS
PROFILE

SHEET NUMBER

5
OF 9

WIN
22501.00

Filename: ... \006_Signing and Striping Plan.dgn Division: HIGHWAY Username: jared.winchenbach Date: 1/12/2018

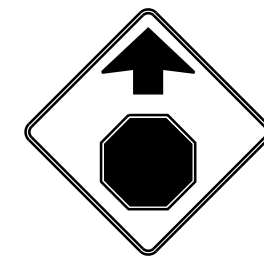
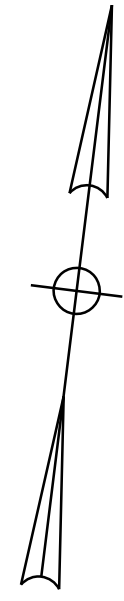

W3-1A
30"x30"



W3-1
(REMOVE)



RI-1
36"x36"
(SOLAR POWERED
LED FLASHING)



RI-1
(REMOVE)

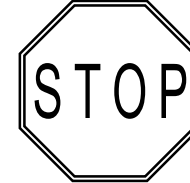

RI-1
36"x36"
(SOLAR POWERED
LED FLASHING)



RI-1
(REMOVE)

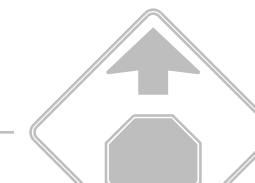

W3-1A
(REMOVE)



W3-1A
30"x30"

NOTES:

1. MATCH EXISTING STRIPING WIDTH.
2. ADDITIONAL CLEARING MAY BE REQUESTED BY THE RESIDENT IN PROPOSED W3-1A SIGN LOCATIONS, PAYMENT FOR CLEARING SHALL BE CONSIDERED INCIDENTAL TO THE 645 ITEMS.
3. ALL PROPOSED WORK SHALL BE IN CONFORMANCE WITH THE "MANUAL ON UNIFORM TRAFFIC CONTROL DEVICES FOR STREETS AND HIGHWAYS", "STANDARD HIGHWAY SIGNS", U.S.D.O.T., F.H.W.A., LATEST EDITION.
4. REMOVAL OF EXISTING ROADSIDE SIGNS AND RELOCATION ROADSIDE SIGNS/POSTS, SHALL BE CONSIDERED INCIDENTAL TO THE 645 PAY ITEMS.
5. PROPOSED SIGN LOCATIONS, OFFSET AND HEIGHT SHALL BE IN ACCORDANCE WITH THE MANUAL FOR UNIFORM TRAFFIC CONTROL DEVICES FOR STREETS AND HIGHWAYS (MUTCD), LATEST EDITION.

101+00 102+00 103+00 104+00 105+00 106+00 107+00 108+00
ROUTE III (ALFRED ROAD)

EXISTING SIGNS TO REMAIN STA. 102-92.34 BEGIN PROJECT NHPP-2250(100)

STA. 202-49 2' 10' 10' 2' STA. 202-11 STA. 202-23 STA. 104-90.10 END PROJECT NHPP-2250(100)

STA. 202-71 STA. 202-76 SL STA. 203+00 DSYL SWLL DAY ROAD

EXISTING SIGNS TO REMAIN SEE NOTE 1 FOR STRIPING DETAILS ALONG DAY ROAD

VARIES VARIES STA. 205+00.00 MATCH EXISTING STRIPING

25' 25' 205+00 205+54

LEGEND	
SWLL - 4" SOLID WHITE LANE LINE	
DSYL - 4" DOUBLE SOLID YELLOW LINE	
SL - WHITE STOP LINE (24" WIDE)	

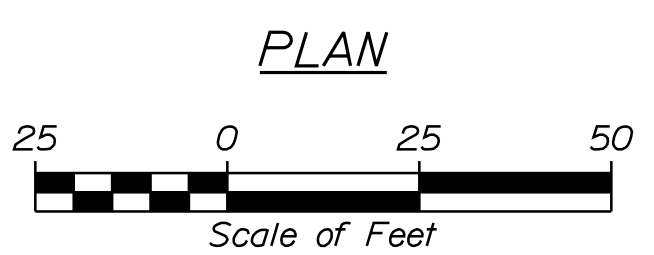

Relationships. Responsiveness. Results.
www.gorillpalmer.com
207.772.2515

STATE OF MAINE		DEPARTMENT OF TRANSPORTATION	
LYMAN		ROUTE 111 & KENNEBUNK POND ROAD	
INTERSECTION IMPROVEMENTS		SIGNING AND STRIPING PLAN	
PROJ. MANAGER	J. RODRIGUE	BY	T. LAUDRY
DESIGN DETAILED	J. WINCHENBACH	DATE	07/2018
CHECKED/REVIEWED	D. TETTINGER	DATE	07/2018
DESIGNS DETAILED		SIGNATURE	
REVISIONS 1		P.E. NUMBER	
REVISIONS 2		DATE	
REVISIONS 3			
REVISIONS 4			
FIELD CHANGES			
SHEET NUMBER		WIN 22501.00	
6		OF 9	

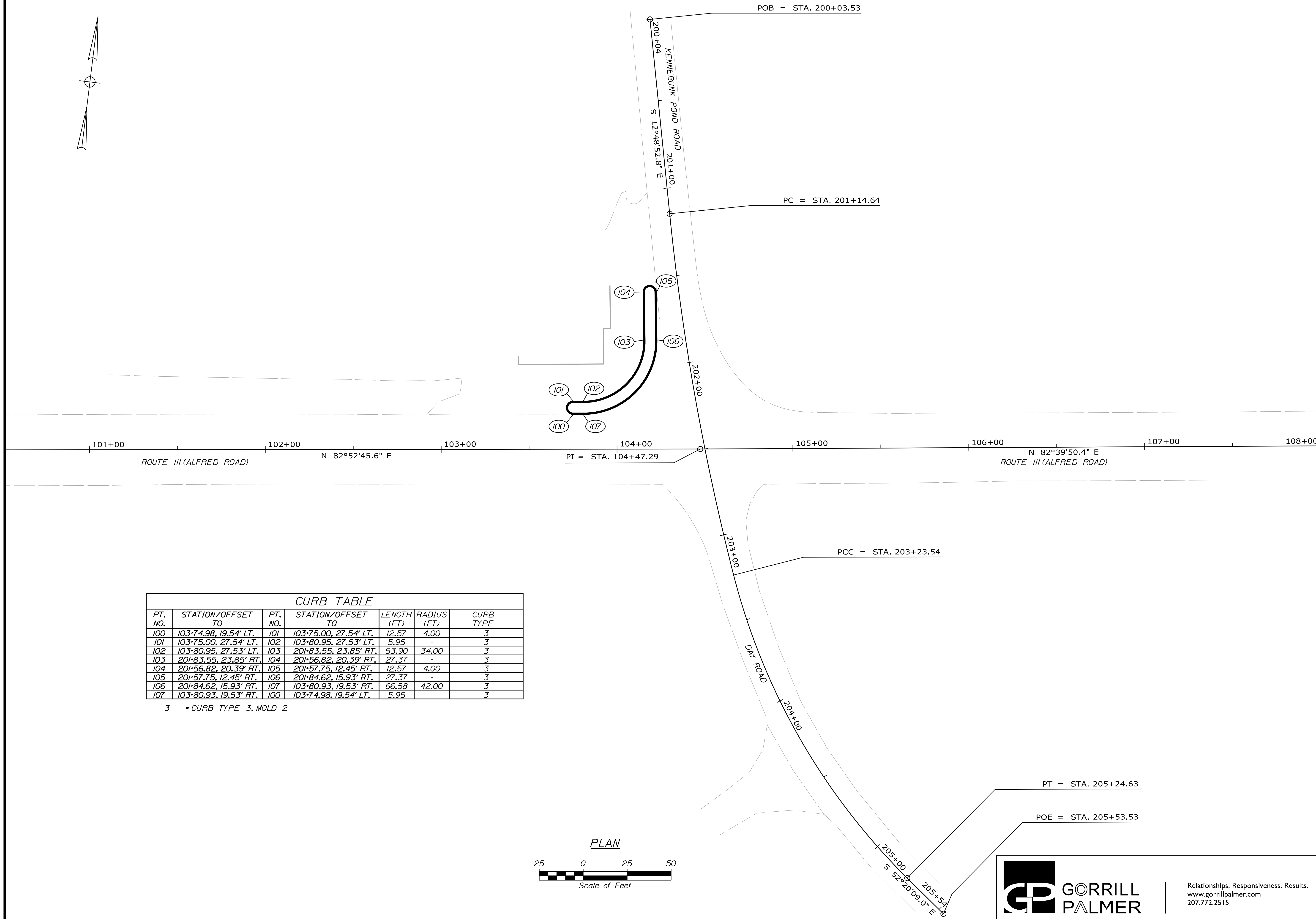
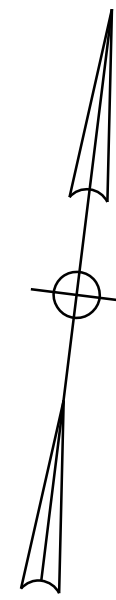

CURB TABLE						
PT. NO.	STATION/OFFSET TO	PT. NO.	STATION/OFFSET TO	LENGTH (FT)	RADIUS (FT)	CURB TYPE
100	103+74.98, 19.54' LT.	101	103+75.00, 27.54' LT.	12.57	4.00	3
101	103+75.00, 27.54' LT.	102	103+80.95, 27.53' LT.	5.95	-	3
102	103+80.95, 27.53' LT.	103	201+83.55, 23.85' RT.	53.90	34.00	3
103	201+83.55, 23.85' RT.	104	201+56.82, 20.39' RT.	27.37	-	3
104	201+56.82, 20.39' RT.	105	201+57.75, 12.45' RT.	12.57	4.00	3
105	201+57.75, 12.45' RT.	106	201+84.62, 15.93' RT.	27.37	-	3
106	201+84.62, 15.93' RT.	107	103+80.93, 19.53' RT.	66.58	42.00	3
107	103+80.93, 19.53' RT.	100	103+74.98, 19.54' LT.	5.95	-	3

3 = CURB TYPE 3, MOLD 2

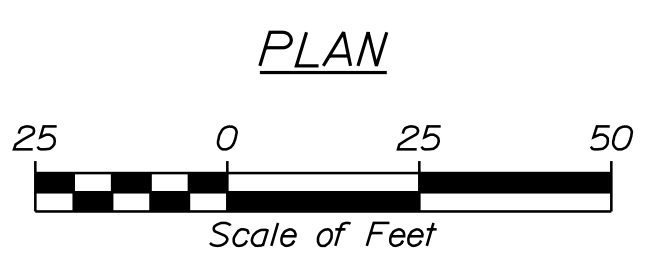

Relationships. Responsiveness. Results.
www.gorrillpalmer.com
207.772.2515

STATE OF MAINE		DEPARTMENT OF TRANSPORTATION	
LYMAN		ROUTE 111 & KENNEBUNK POND ROAD	
INTERSECTION IMPROVEMENTS		CURBING PLAN	
SHEET NUMBER		2	
OF 9		WIN 22501.00	
PROJ. MANAGER	J. RODRIGUE	BY	T. LAUDRY
DESIGN DETAILED	J. WIRCHENBOCH	DATE	07/2018
CHECKED/REVIEWED	D. TETINGER	DATE	07/2018
DESIGN DETAILED	-	SIGNATURE	-
REVISIONS 1	-	P.E. NUMBER	-
REVISIONS 2	-	DATE	-
REVISIONS 3	-	-	-
REVISIONS 4	-	-	-
FIELD CHANGES	-	-	-

STA. 107+50.00
LIMIT OF WORK

STA. 104+90.10
END PROJECT NHPP-2250(100)

STA. 104+50.00 ROUTE III -
STA. 202+50.00 KENNEBUNK POND ROAD

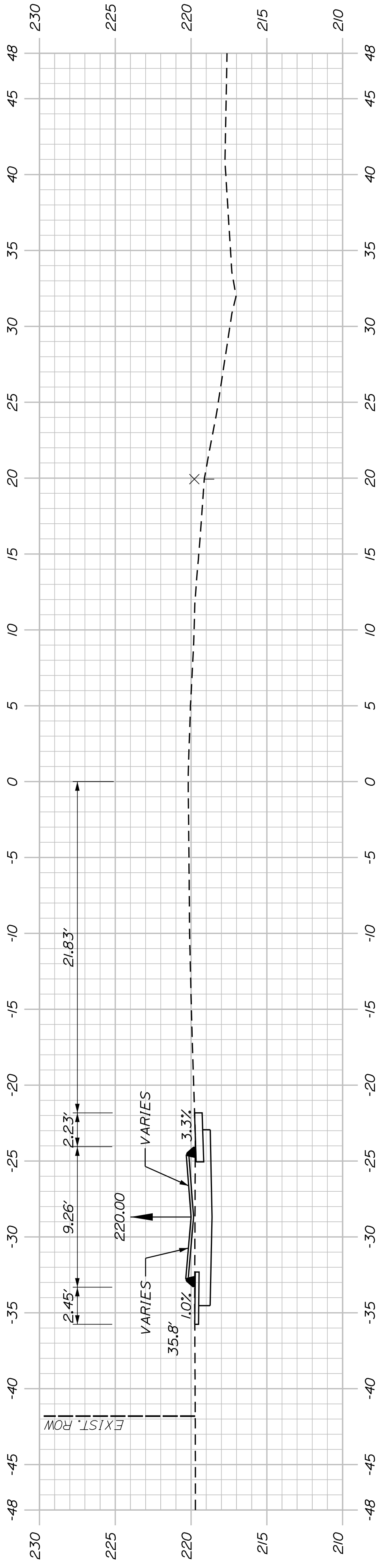

104+00.00

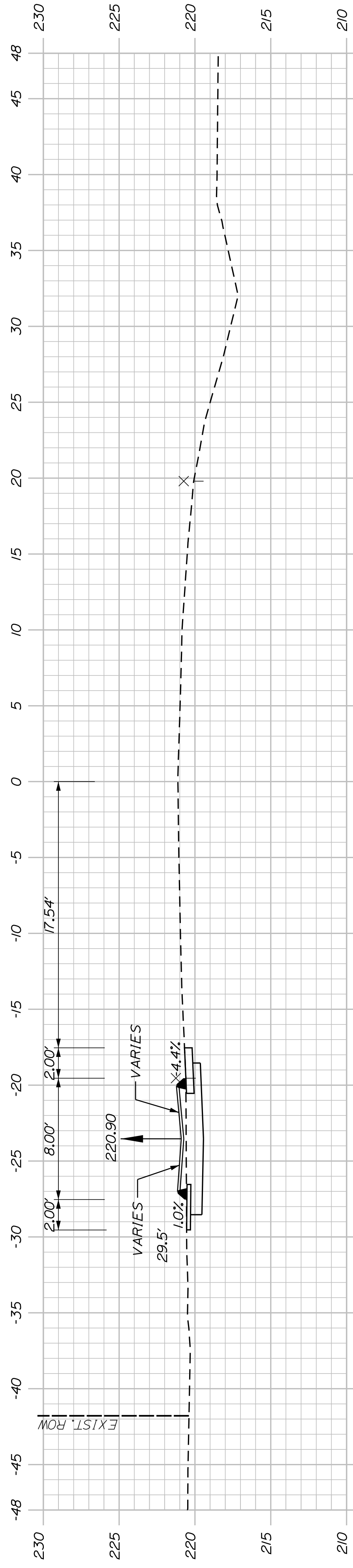

103+75.00

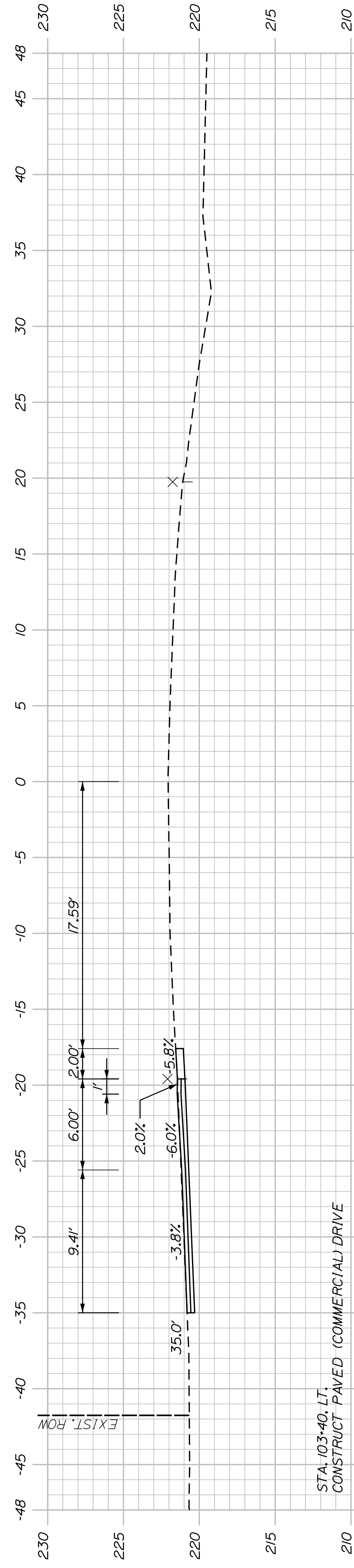

STA. 103+40.00 LT.
CONSTRUCT PAVED (COMMERCIAL) DRIVE

103+50.00

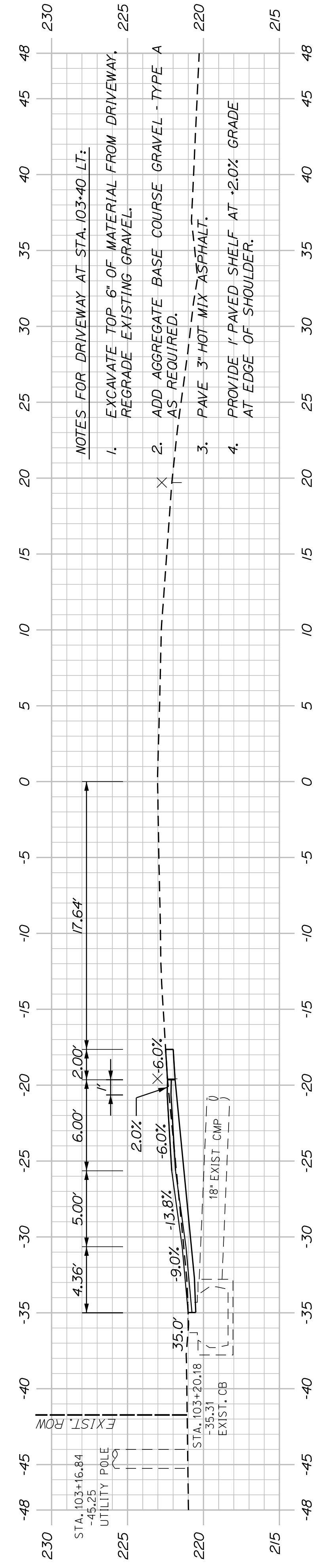

NOTES FOR DRIVEWAY AT STA. 103+40.00 LT.

1. EXCAVATE TOP 6" OF MATERIAL FROM DRIVEWAY, REGRADE EXISTING GRAVEL.
2. ADD AGGREGATE BASE COURSE GRAVEL - TYPE A AS REQUIRED.
3. PAVE 3" HOT MIX ASPHALT.
4. PROVIDE 1' PAVED SHELF AT -2.0% GRADE AT EDGE OF SHOULDER.

103+25.00

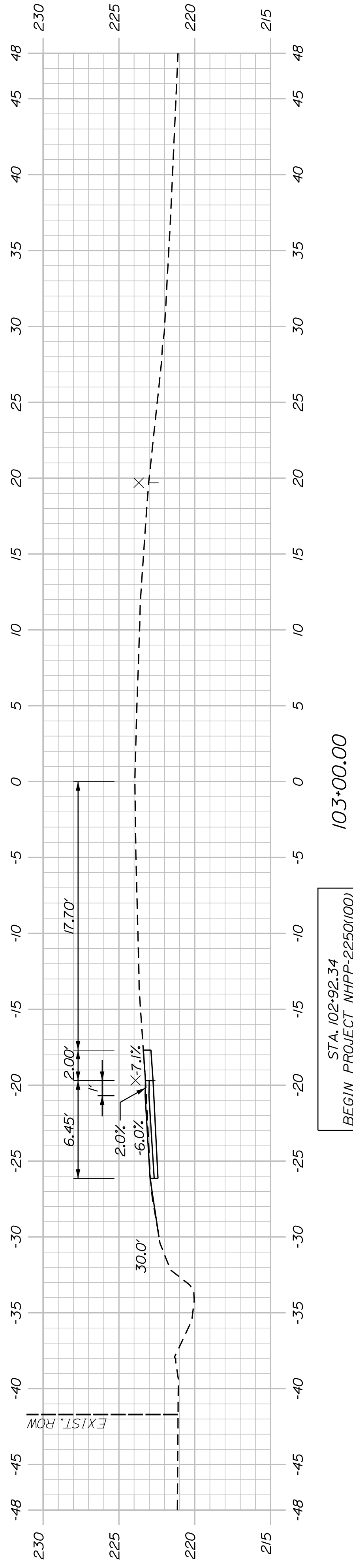

STA. 102+92.34
BEGIN PROJECT NHPP-2250(100)
LIMIT OF WORK

SHEET NUMBER

8

LYMAN
ROUTE 111 & KENNEBUNK POND ROAD
INTERSECTION IMPROVEMENTS
CROSS SECTIONS

PROJ. MANAGER	J. RODRIGUE	BY	J. RODRIGUE	DATE	07/2018
DESIGN DETAILED	J. WINCHENBOCH	CHECKED/REVIEWED	J. LAUDRY	DATE	07/2018
DESIGNED/REVIEWED	J. DIETINGER	DESIGNED/REVIEWED		SIGNATURE	
REVISIONS 1		REVISIONS 1		P.E. NUMBER	
REVISIONS 2		REVISIONS 2		DATE	
REVISIONS 3		REVISIONS 3			
REVISIONS 4		REVISIONS 4			
FIELD CHANGES					

STATE OF MAINE
DEPARTMENT OF TRANSPORTATION
WIN
22501.00

STA. 104+50.00 ROUTE III =
STA. 202+50.00 KENNEBUNK POND ROAD

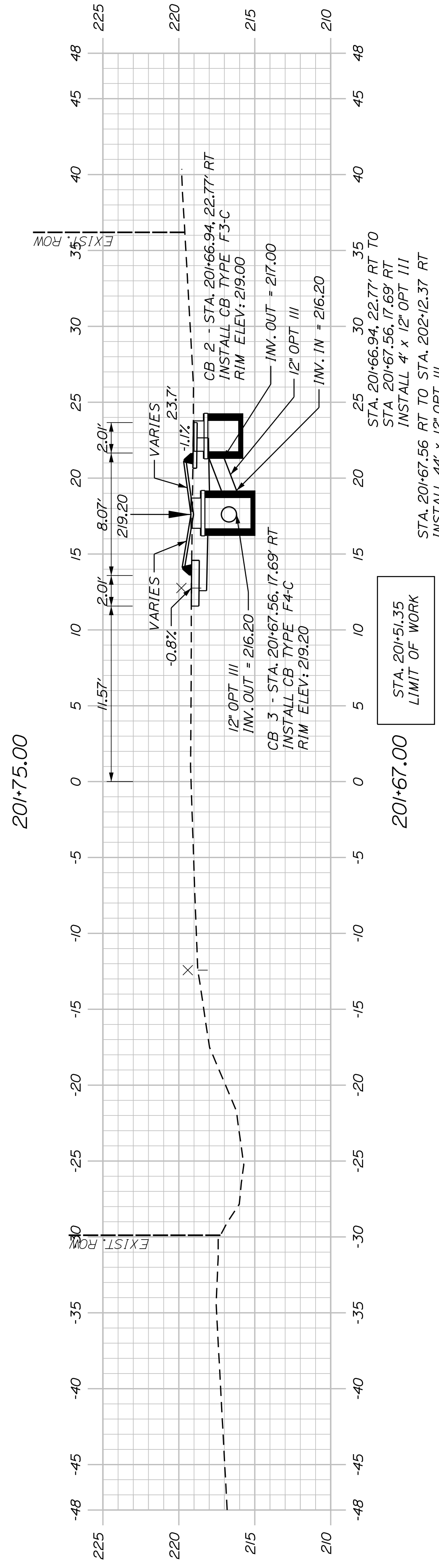
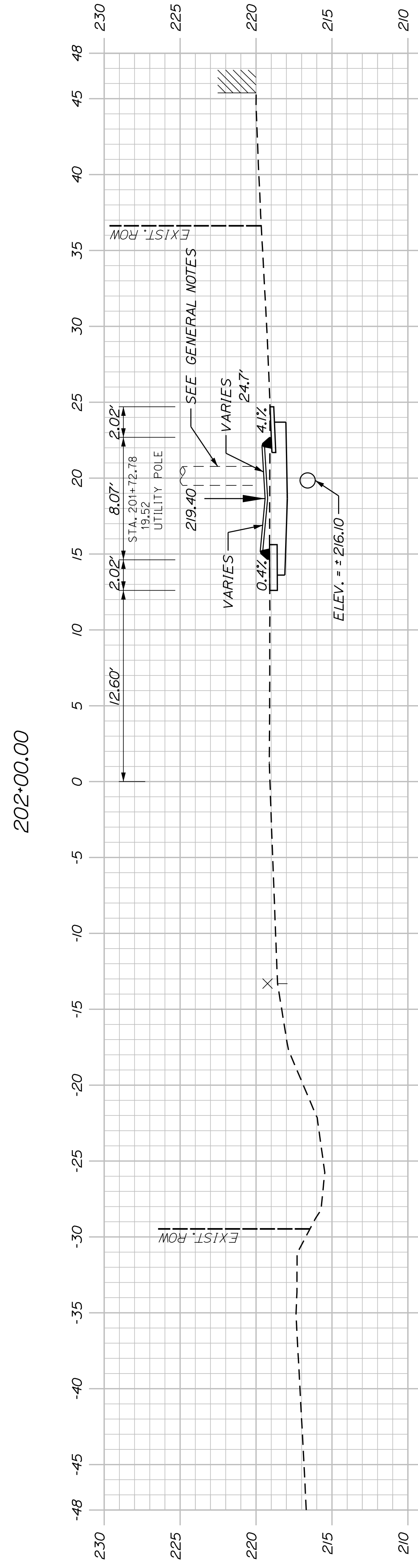
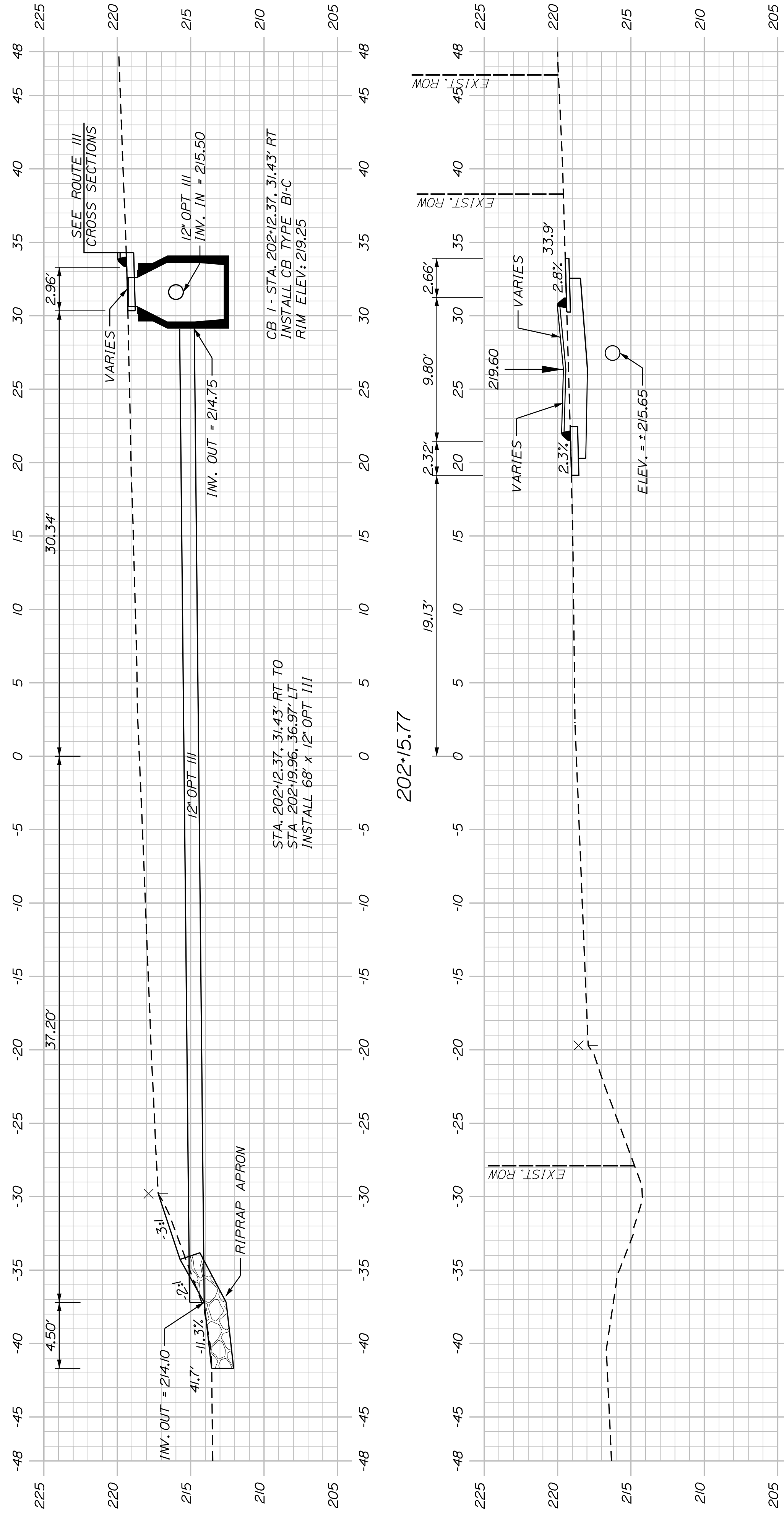

STA. 201+51.35
LIMIT OF WORK

STATE OF MAINE		DEPARTMENT OF TRANSPORTATION	
LYMAN		ROUTE 111 & KENNEBUNK POND ROAD	
INTERSECTION IMPROVEMENTS		CROSS SECTIONS	
SHEET NUMBER	9	DATE	WIN
22501.00	-	-	-