

STATE OF MAINE DEPARTMENT OF TRANSPORTATION



WATERFORD

OXFORD COUNTY

ROUTE 118

STATE PROJECT NO. 21838.00

PROJECT LENGTH : 0.04 MILES

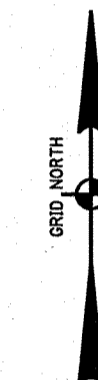

INDEX OF SHEETS

Description	Sheet No.
Title Sheet	1
Typical Sections	2
Estimated Quantities - General Notes	3
Culvert Details - Precast Concrete Box Culvert	4
Boring Location Plan & Interpretive Subsurface	5
Profile with Boring Logs	6
Plan and Profile	7-10
Cross - Sections	11
Detour Plan	12
Right of Way Map	12

PLAN LEGEND

Town, County, State	-----	Catch Basins	Existing	Proposed
Property Lines	-----	Manholes	Existing	Proposed
R/W Lines-Existing	-----	Proposed Underdrain	-----	
R/W Lines-Proposed	-----	Proposed Ditch	-----	
Culvert-Existing	-----	Existing Ditch	-----	
Culvert Proposed	-----	Utility Poles	Existing	Proposed
Curbing	Existing Proposed	Fire Hydrants	Existing	Proposed
Type 1	-----	Existing Water Line	-----	
Type 3	-----	Existing San. Sewer	-----	
Type 5	-----	Existing San. Sewer Manhole	-----	
Outline of Bodies of Water	-----	Guardrail-Existing	-----	
Exposed Bedrock	-----	Guardrail-Proposed	-----	
Buildings	-----	Guardrail-Cable, Other	-----	
Trees	Conifer Deciduous	Centerline-Existing	-----	
Tree Line	-----	Centerline-Proposed	-----	
Clearing Limit Line	-----	Travelway-Existing	-----	
Railroad	-----	Travelway-Proposed	-----	
Boring	HB-XXX-###	Probe	P-#. #X	
Pavement Core	PC-#	#.# = Depth		
Test Pit	TP-XXX-###	X = W (Weathered Rock)		
		R (Refusal)		
		NR (No Refusal)		

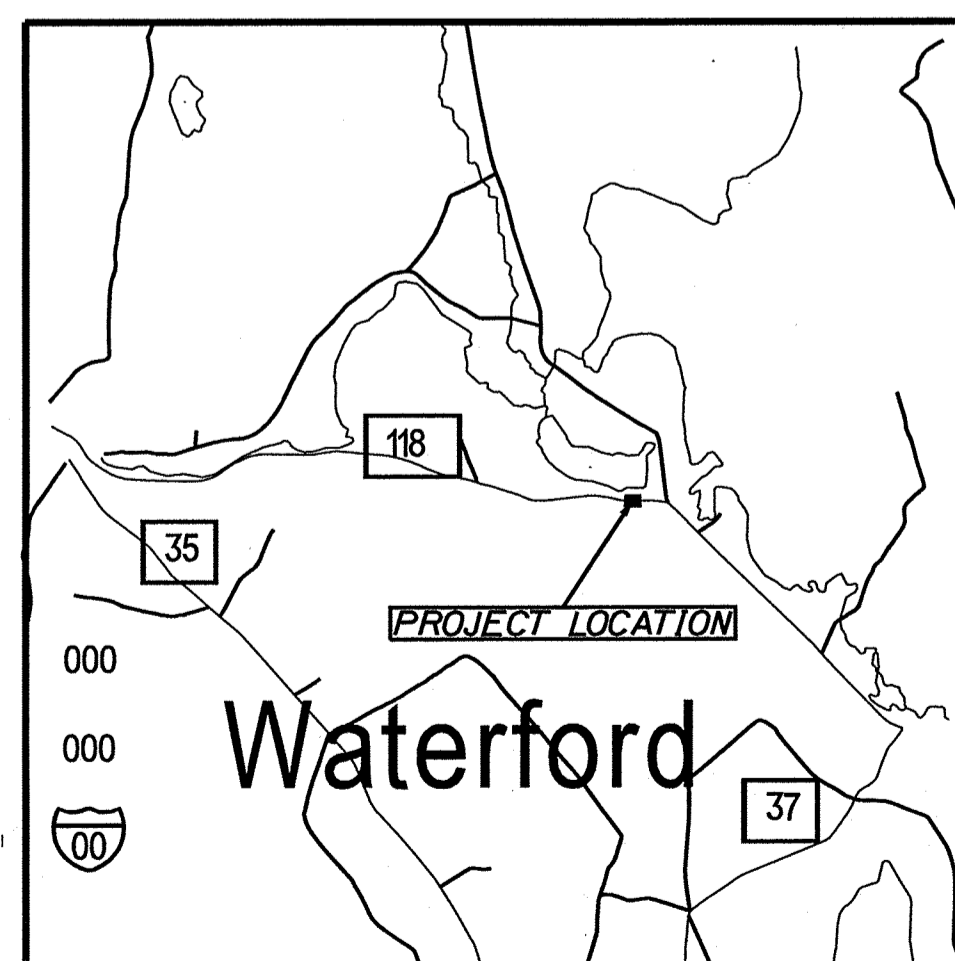
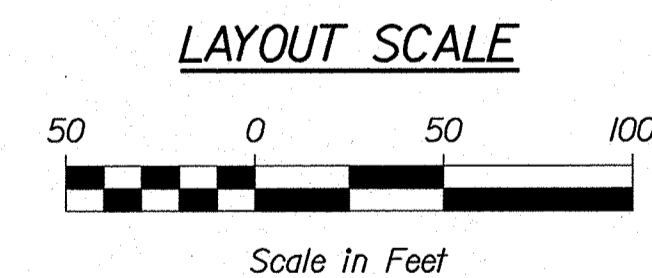
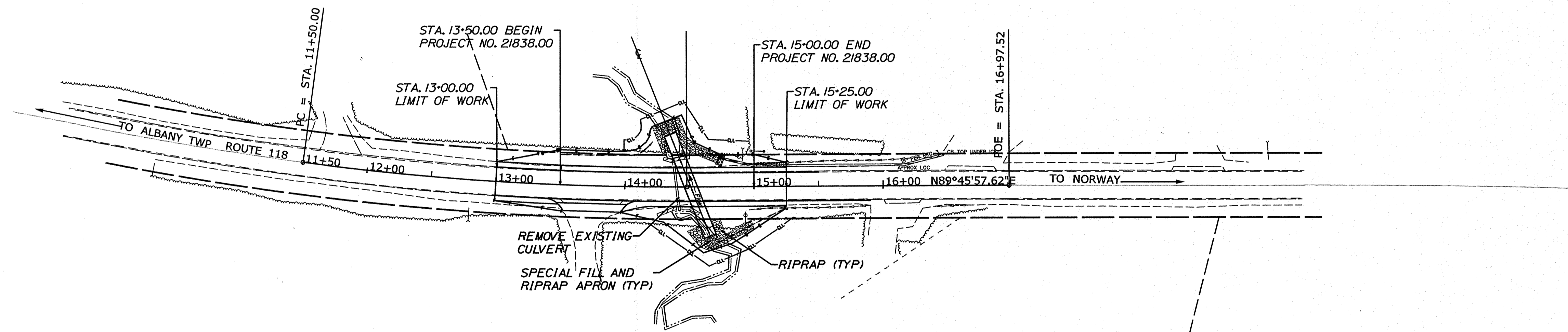

TRAFFIC DATA	
Current (2019) AADT	1150
Future (2031) AADT	1290
DHV - % of AADT	10
Design Hour Volume	129
% Heavy Trucks (AADT)	7
Directional Distribution (DHV)	61
Design Speed (mph)	40
Functional Class:	Major Collector
Corridor Priority	3

PROJECT LOCATION:	LARGE CULVERT (#940780) LOCATED 0.25 OF A MILE WEST OF HUNTS CORNER ROAD
PROGRAM AREA:	HIGHWAY PROGRAM
SCOPE OF WORK:	LARGE CULVERT REPLACEMENT

STATE OF MAINE DEPARTMENT OF TRANSPORTATION	APPROVED	DATE
	<i>[Signature]</i>	4-15-2020
	COMMISSIONER	
	<i>[Signature]</i>	4-15-2020
	CHIEF ENGINEER	
	<i>[Signature]</i>	4-15-2020

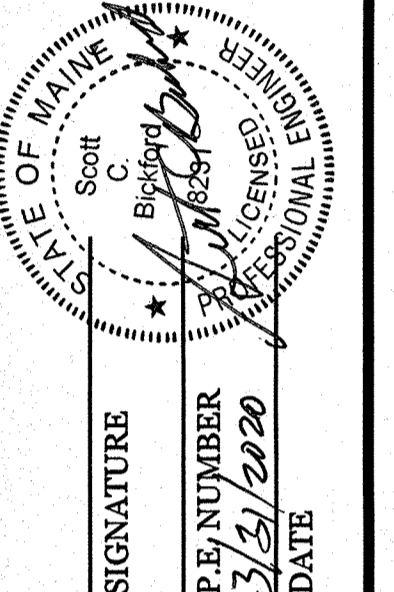

PROGRAM	HIGHWAY
PROJECT MANAGER	LARRY HAMILTON
DESIGNER	EYTAYO ADANDEKINTI
CONSULTANT	
PROJECT RESIDENT	
CONTRACTOR	
PROJECT COMPLETION DATE	

WATERFORD
ROUTE 118
TITLE SHEET

SHEET NUMBER
1
OF 12

Filename: ... \00\HIGHWAY\MSTA\001_Title.dgn Division: HIGHWAY User: Eytayo.Adandekinti Date: 3/30/2020

WIN 21838.00

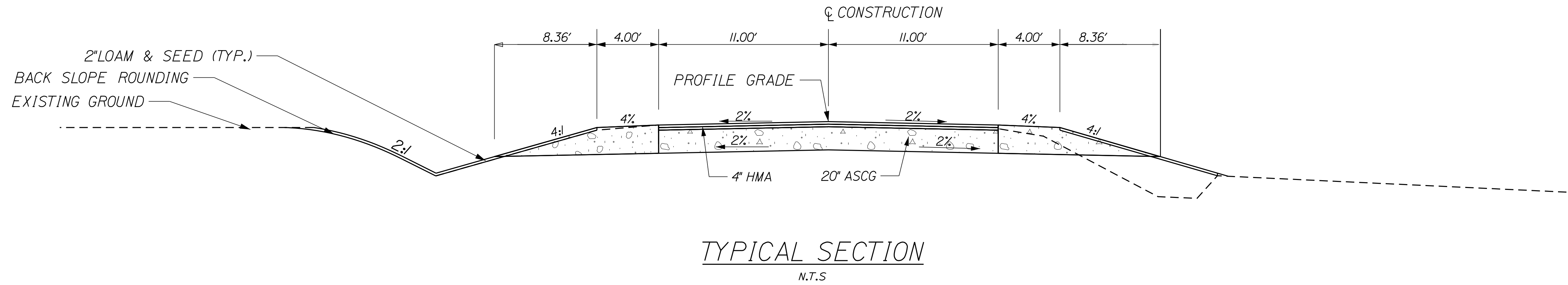

NOTE:

1. THE PAVEMENT, BASE AND SUBBASE DEPTHS AS SHOWN ON THE PLANS ARE INTENDED TO BE NOMINAL.
2. WHEN SUPERELEVATION EXCEEDS THE SLOPE OF THE LOW SIDE SHOULDER, THE LOW SIDE SHOULDER SHALL HAVE THE SAME SLOPE AS THE TRAVELWAY.
3. CROWNS FOR BOTH NORMAL AND SUPERELEVATION SECTIONS FOR ALL COURSES OF SUBBASE AND PAVEMENT SHALL BE STRAIGHT.
4. THE GRAVEL QUANTITY CALCULATION IS BASED ON A 2" LOAM OR DIRTY BORROW DEPTH. THE ACTUAL DEPTH MAY VARY. SEE THE GENERAL NOTES.
5. THE ALGEBRAIC DIFFERENCE BETWEEN THE SHOULDER AND TRAVEWAY CROSS SLOPES "ROLLOVER" SHALL NOT EXCEED 8%.

HMA: HOT MIXED ASPHALT
 ASCG: AGGREGATE SUBBASE COURSE GRAVEL
 N.T.S: NOT TO SCALE

STATE OF MAINE
 DEPARTMENT OF TRANSPORTATION

PROJ. MANAGER	LARRY, HAMILTON	BY		DATE	
DESIGN DETAILED	EYTAYO AD	CHECKED-REVIEWED			
DESIGN DETAILED		DESIGN DETAILED		MAR 2018	SIGNATURE
REVISIONS 1		REVISIONS 1			P.E. NUMBER
REVISIONS 2		REVISIONS 2			DATE
REVISIONS 3		REVISIONS 3			
REVISIONS 4		REVISIONS 4			
FIELD CHANGES					

WATERFORD
 ROUTE 118
 TYPICAL SECTIONS

SHEET NUMBER

2

OF 12

WIN
 21838.00

HIGHWAY PLANS

ESTIMATED QUANTITIES			
ITEM NO.	DESCRIPTION	QUANTITY	UNIT
203.20	COMMON EXCAVATION	621	CY
203.25	GRANULAR BORROW	115	CY
203.33	SPECIAL FILL	43	CY
304.10	AGGREGATE SUBBASE COURSE - GRAVEL	674	CY
403.208	HOT MIX ASPHALT 12.5 MM NOMINAL MAXIMUM HMA SURFACE	59	T
403.209	HOT MIX ASPHALT 9.5 MM HMA (SIDEWALK, DRIVE, ISLANDS & INCIDENTALS)	5	T
403.213	HOT MIX ASPHALT 12.5 MM NOMINAL MAXIMUM BASE	97	T
409.15	BITUMINOUS TACK COAT APPLIED	18	GA
508.13	SHEET WATERPROOFING MEMBRANE	1	LS
511.07	COFFERDAM UPSTREAM	1	LS
511.07	COFFERDAM DOWNSTREAM	1	LS
526.301	TEMPORARY CONCRETE BARRIER TYPE I	1	LS
534.71	PRECAST CONCRETE BOX CULVERT	1	LS
610.08	PLAIN RIPRAP	44	CY
610.210	STREAM CHANNEL ROCK	80	CY
613.319	EROSION CONTROL BLANKET	87	SY
615.07	LOAM	30	CY
618.14	SEEDING METHOD NUMBER 2 - PLAN QUANTITY	5	UN
619.12	MULCH - PLAN QUANTITY	5	UN
620.58	EROSION CONTROL GEOTEXTILE	148	SY
627.733	4 INCH WHITE OR YELLOW PAINTED PAVE MARK LINE	1,425	LF
627.78	TEMPORARY 4" PAINTED PAVEMENT MARKING LINE, WHITE, YELLOW	475	LF
629.05	HAND LABOR, STRAIGHT TIME	15	HR
631.12	ALL PURPOSE EXCAVATOR (INCLUDES OPERATOR)	10	HR
631.172	TRUCK - LARGE (INCLUDES OPERATOR)	10	HR
639.19	FIELD OFFICE TYPE B	1	EA
652.311	TYPE II BARRICADE	2	EA
652.312	TYPE III BARRICADE	8	EA
652.33	DRUM	10	EA
652.34	CONE	75	EA
652.35	CONSTRUCTION SIGNS	800	SF
652.36	MAINTENANCE OF TRAFFIC CONTROL DEVICES	30	CD
652.38	FLAGGERS	240	HR
652.41	PORTABLE CHANGEABLE MESSAGE SIGN	2	EA
656.75	TEMPORARY SOIL EROSION & WATER POLLUTION CONTROL	1	LS
659.10	MOBILIZATION	1	LS

GENERAL NOTES

- ALL CLEARING SHALL BE CONSIDERED INCIDENTAL TO THE CONTRACT AND NO SEPARATE PAYMENT WILL BE MADE. THE ACTUAL LINES FOR CLEARING SHALL BE ESTABLISHED IN THE FIELD BY THE CONTRACTOR AS INDICATED ON THE PLANS AND APPROVED BY THE RESIDENT.
- THE CONTRACTOR SHALL PLAN AND CONDUCT THEIR WORK ACCORDINGLY SO THAT UPON COMPLETION OF THE PROJECT THERE IS NO DROP-OFF FROM THE EDGE OF SHOULDER PAVEMENT.
- ALL WASTE MATERIAL NOT USED ON THE PROJECT SHALL BE DISPOSED OF OFF THE PROJECT IN ACCEPTABLE WASTE AREAS REVIEWED BY THE RESIDENT. GRADING, SEEDING AND MULCHING OF WASTE AREAS SHALL BE CONSIDERED INCIDENTAL.
- REQUIRED DITCH PROTECTION SHOWN ON THE PLANS OR IN THE CONSTRUCTION NOTES IS FOR ESTIMATING PURPOSES ONLY. THE ACTUAL TYPE AND LOCATION OF DITCH PROTECTION MAY BE ALTERED BY THE RESIDENT.
- GRANULAR BORROW USED TO BACKFILL IN LOW WET AREAS TO 1 FOOT ABOVE WATER LEVEL OR OLD GROUND SHALL MEET REQUIREMENTS FOR GRANULAR BORROW MATERIAL FOR UNDERWATER BACKFILL SPECIFIED IN STANDARD SPECIFICATION 703.19.
- EXISTING INSLOPES IN PROPOSED FILL AREAS SHALL BE BENCHED BY EXCAVATING STEPS OF SUFFICIENT WIDTH TO PERMIT PLACING AND COMPACTING THE FILL MATERIAL ALONG WITH THE MATERIAL REMOVED.
- DRIVEWAY FILL SIDE SLOPES SHALL BE THE SAME AS THE NON-GUARDRAIL FILL SLOPES UNLESS OTHERWISE NOTED ON THE PLANS.
- GRAVEL ENTRANCES SHALL BE CONSTRUCTED WITH 14 INCHES AGGREGATE SUBBASE COURSE - GRAVEL OR 11 INCHES AGGREGATE SUBBASE COURSE - GRAVEL AND 3 INCHES UNTREATED AGGREGATE SURFACE COURSE UNLESS OTHERWISE NOTED IN THE PLANS OR DIRECTED BY THE RESIDENT.
- A 3 FOOT PAVED LIP SHALL BE PLACED AT ALL UNPAVED ENTRANCES UNLESS OTHERWISE NOTED IN THE PLANS OR DIRECTED BY THE RESIDENT.
- ANY NECESSARY CLEANING OF EXISTING PAVEMENT PRIOR TO PAVING (OR MILLING) SHALL BE INCIDENTAL TO THE RELATED PAVING (OR MILLING) ITEM.
- NO EXISTING DRAINAGE SHALL BE ABANDONED, REMOVED OR PLUGGED WITHOUT PRIOR APPROVAL OF THE RESIDENT.
- INLETS AND OUTLETS OF ALL CULVERTS SHALL BE RIPRAPPED UNLESS OTHERWISE NOTED ON THE PLANS OR DIRECTED BY THE RESIDENT.
- UNLESS OTHERWISE NOTED SEEDING METHOD NO. 1 SHALL BE UTILIZED ON ALL LAWNS AND DEVELOPED AREAS; SEEDING METHOD NO. 2 SHALL BE UTILIZED ON ALL OTHER AREAS.
- LOAM SHALL BE PLACED TO A NOMINAL DEPTH OF 4 INCHES IN LAWN AREAS AND 2 INCHES IN ALL OTHER AREAS UNLESS OTHERWISE NOTED OR DIRECTED.
- THE CONTRACTOR WILL BE RESPONSIBLE FOR MAINTAINING ALL EXISTING MAILBOXES TO ENSURE THAT THE MAIL WILL BE DELIVERABLE. PAYMENT FOR THIS WORK WILL BE MADE UNDER THE APPROPRIATE RENTAL ITEMS.
- ANY DAMAGE TO THE SLOPES CAUSED BY THE CONTRACTOR'S EQUIPMENT, PERSONNEL, OR OPERATION SHALL BE REPAIRED TO THE SATISFACTION OF THE RESIDENT. ALL WORK, EQUIPMENT, AND MATERIALS REQUIRED TO MAKE REPAIRS SHALL BE AT THE CONTRACTOR'S EXPENSE.
- THE PROJECT GEOTECHNICAL REPORT TITLED GEOTECHNICAL DESIGN REPORT FOR THE REPLACEMENT OF LARGE CULVERT *940780, SOILS REPORT 2019 - 06, APRIL 2019 CAN BE ACCESSED AT MAINEDOT WEBSITE.
- GEOTECHNICAL INFORMATION FURNISHED OR REFERRED TO IN THE BID DOCUMENTS IS FOR THE USE OF THE BIDDERS. NO ASSURANCE IS GIVEN THAT THE INFORMATION OR INTERPRETATIONS WILL BE REPRESENTATIVE OF THE ACTUAL SUBSURFACE CONDITIONS THROUGHOUT THE CONSTRUCTION SITE. MAINEDOT WILL NOT BE RESPONSIBLE FOR ANY INTERPRETATIONS OR CONCLUSION DRAWN FROM THE GEOTECHNICAL INFORMATION. THE BORING LOGS PROVIDED IN THE BID DOCUMENTS (IF ANY) PRESENT FACTUAL AND INTERPRETIVE SUBSURFACE INFORMATION COLLECTED AT DISCRETE LOCATIONS. DATA PROVIDED MAY NOT BE REPRESENTATIVE OF THE SUBSURFACE CONDITIONS BETWEEN BORING LOCATIONS.
- AREAS REQUIRING FILL ON THE PROJECT WILL COME FROM SUITABLE EXCAVATION FROM EXCAVATION, DITCH AND INSLOPE OR EQUIPMENT RENTAL AREAS.
- NO SEPARATE PAYMENT FOR SUPERINTENDENT OR FOREMAN WILL BE MADE FOR THE SUPERVISION OF EQUIPMENT AND LAYOUT OF WORK BEING PAID FOR UNDER THE EQUIPMENT RENTAL ITEMS.
- FINAL STRIPING FOR THE PROJECT SHALL BE DONE BY THE CONTRACTOR PER THE STRIPING LAYOUT IN THE CONTRACT DOCUMENTS OR AS PROVIDED BY THE DEPARTMENT. PAYMENT SHALL BE MADE UNDER APPROPRIATE CONTRACT ITEMS.

STATE OF MAINE DEPARTMENT OF TRANSPORTATION	SIGNATURE	DATE	P.E. NUMBER	DATE
WATERFORD ROUTE 118	DESIGN-REVIEWED	E. ADONDE KINTU	FEB 2019	
	DESIGN-DETAILED 2			
ESTIMATED QUANTITIES	DESIGN-DETAILED 3			
	REVISIONS 1			
	REVISIONS 2			
	REVISIONS 3			
	REVISIONS 4			
	FIELD CHANGES			
SHEET NUMBER	3			
	OF 12			

WIN
21838.00
HIGHWAY PLANS

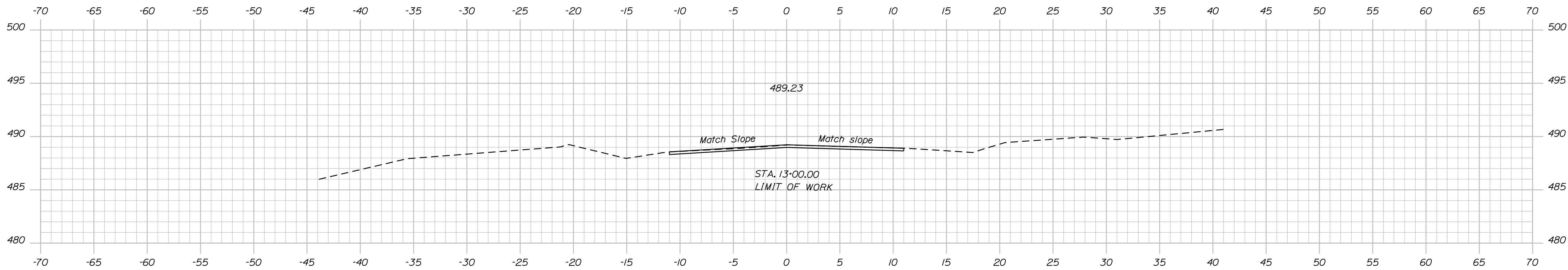
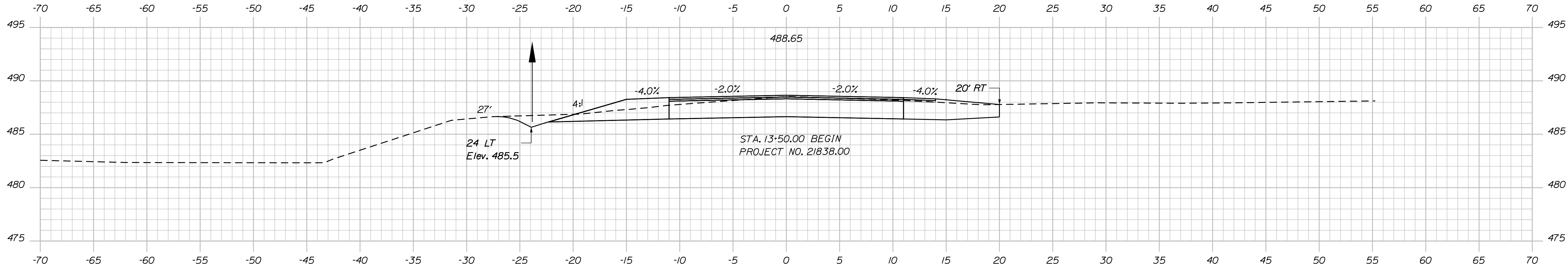

STATE OF MAINE
DEPARTMENT OF TRANSPORTATION

SIGNATURE
P.E. NUMBER
DATE

PROJ. MANAGER	BY	DATE
DESIGN DETAILED	DESIGNER	DATE
CHECKED/REVIEWED	CHECKER	DATE
DESIGN DETAILED	DESIGNER	DATE
DESIGN DETAILED	DESIGNER	DATE
REVISIONS 1	REVISOR	DATE
REVISIONS 2	REVISOR	DATE
REVISIONS 3	REVISOR	DATE
REVISIONS 4	REVISOR	DATE
FIELD CHANGES	FIELD	DATE

CROSS SECTIONS

SHEET NUMBER
7
OF 12

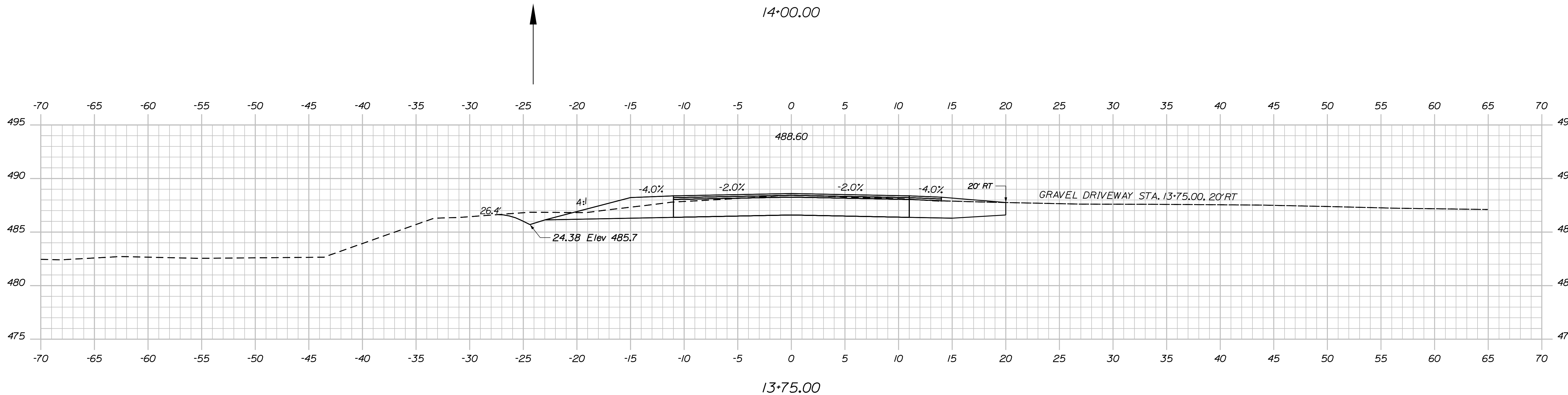
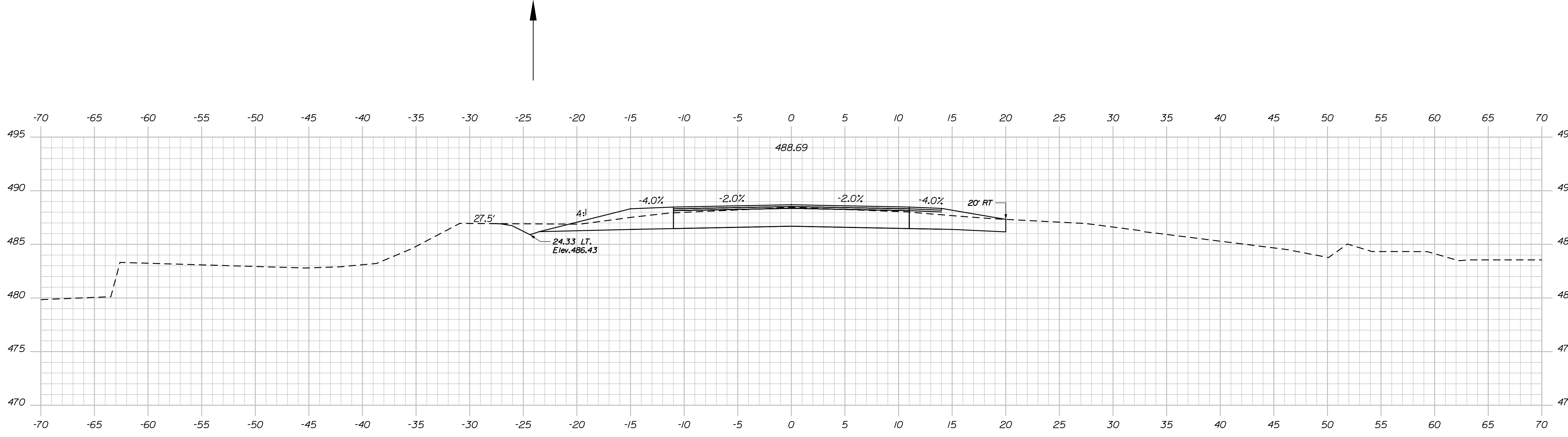

STATE OF MAINE
DEPARTMENT OF TRANSPORTATION

PROJ. MANAGER	DESIGN-DETAILED	CHECKED-REVIEWED	DESIGN-DETAILED	DESIGN-DETAILED	REVISIONS 1	REVISIONS 2	REVISIONS 3	REVISIONS 4	FIELD CHANGES
\$ProjectMgr\$	\$Designer\$	\$Designer\$	\$Designer\$	\$Designer\$	\$RevDate\$	\$RevDate\$	\$RevDate\$	\$RevDate\$	\$FieldChng\$
BY	DATE	SIGNATURE							
\$Designer\$	\$ProjectMgr\$	P.E. NUMBER							
\$Designer\$	\$ProjectMgr\$	DATE							

CROSS SECTIONS

SHEET NUMBER
8
OF 12

Filename: ... \MSTAD09_XSECT_14+50_003.dgn Division: HIGHWAY Username: Eytayo.Adandekini Date: 3/27/2020

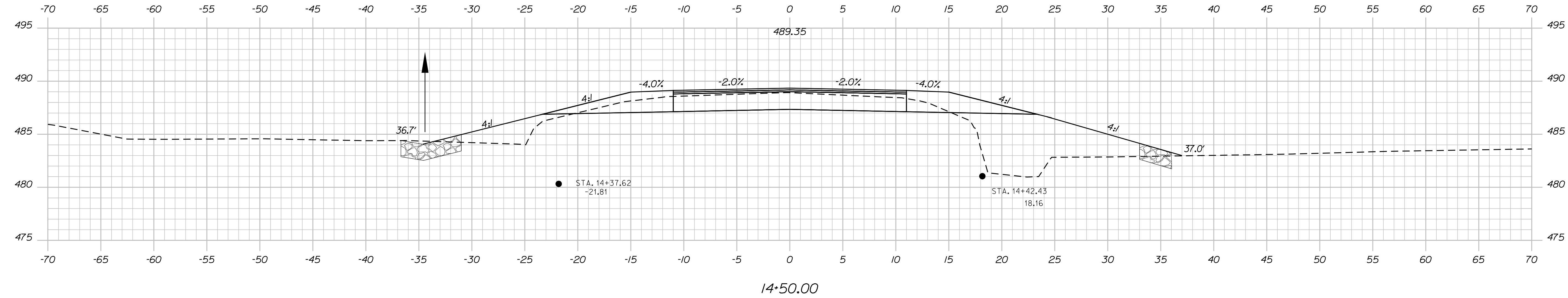
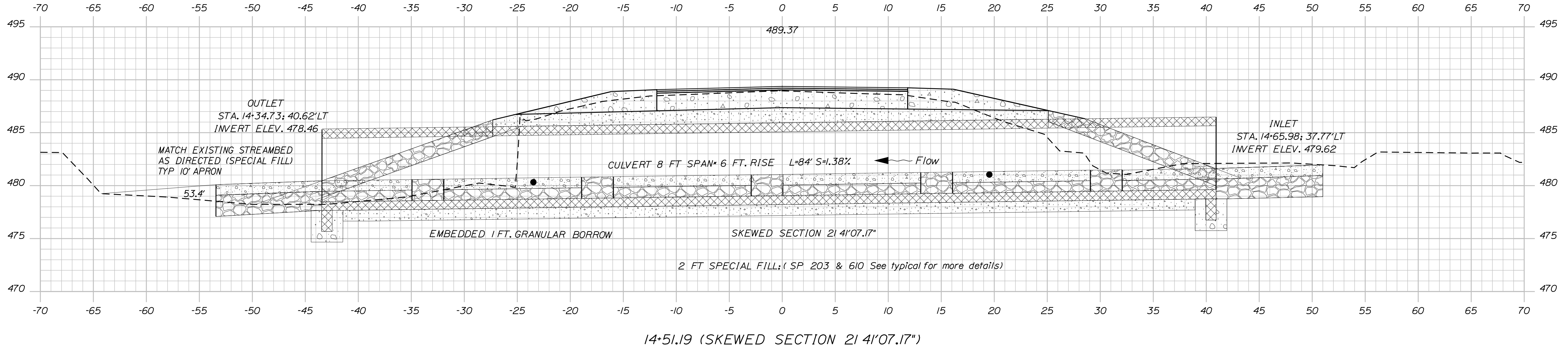
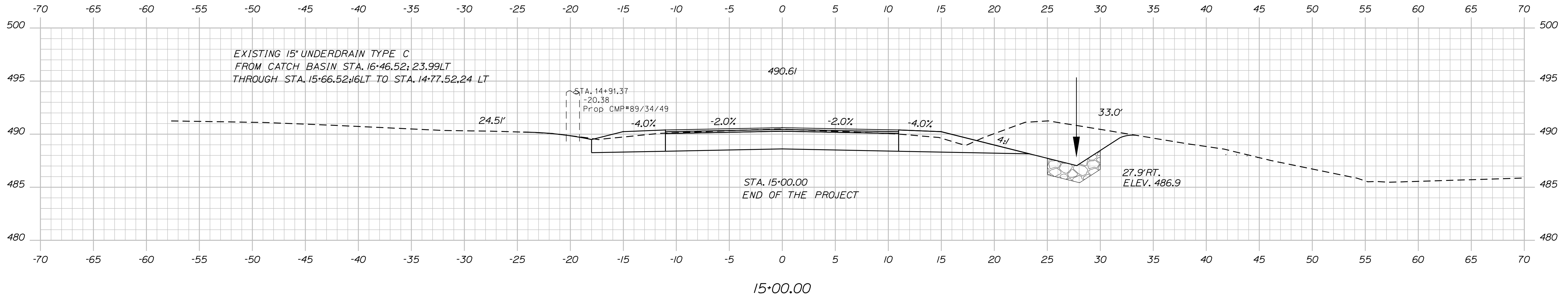

STATE OF MAINE DEPARTMENT OF TRANSPORTATION		SIGNATURE	
WIN		P.E. NUMBER	
WIN		DATE	
HIGHWAY PLANS			
DESIGN-DETAILED	BY	DATE	
CHECKED-REVIEWED	DESIGNER		
DESIGN-DETAILED	DESIGNER		
DESIGN-DETAILED	DESIGNER		
REVISIONS 1	REVISION		
REVISIONS 2	REVISION		
REVISIONS 3	REVISION		
REVISIONS 4	REVISION		
FIELD CHANGES	FIELD		
CROSS SECTIONS			
SHEET NUMBER			
9			
OF 12			

Username: Eytayo.Adandekinti Date: 3/27/2020

Division: HIGHWAY

Filename: ... \MSTAD012_ Right of Way Map.dgn

<p>Town, County, State _____</p> <p>Approx. Property Lines _____ P.L.</p> <p>Existing Right of Way _____</p> <p>Limits of Wrought Portion _____ L.O.W.P.</p> <p>Control Of Access _____ C.O.A.</p> <p>New Right of Way _____</p> <p>New Easement _____</p> <p>New Temporary Rights _____</p> <p>New R/W Within Existing R/W _____</p>	<p>PLAN LEGEND</p> <table border="0"> <tr> <td>Existing</td> <td>Proposed</td> <td>Existing</td> <td>Proposed</td> </tr> <tr> <td>Sanitary Sewer</td> <td>Telephone Line</td> <td>Traveled Way</td> <td>Ditch</td> </tr> <tr> <td>Electric Line</td> <td>Water Line</td> <td>Catch Basin</td> <td>Manhole</td> </tr> <tr> <td>Underdrain Line</td> <td>Gas Line</td> <td>Sewer Manhole</td> <td>Utility Pole</td> </tr> <tr> <td>Guardrail</td> <td>Culvert</td> <td>Fire Hydrant</td> <td>Curbing</td> </tr> </table>	Existing	Proposed	Existing	Proposed	Sanitary Sewer	Telephone Line	Traveled Way	Ditch	Electric Line	Water Line	Catch Basin	Manhole	Underdrain Line	Gas Line	Sewer Manhole	Utility Pole	Guardrail	Culvert	Fire Hydrant	Curbing	<p>STATE OF MAINE REGISTRY OF DEEDS</p> <p>COUNTY _____</p> <p>RECEIVED _____</p> <p>at _____ h _____ m _____ M and recorded in _____</p> <p>Plan Book _____, Page _____</p> <p>Attest: _____ REGISTER</p>	<p>THIS PLAN WAS PREPARED IN CONNECTION WITH THE DEPARTMENT'S ACQUISITION OF REAL PROPERTY FOR TRANSPORTATION PURPOSES. IT CANNOT BE USED TO ESTABLISH LEGAL BOUNDARIES BETWEEN ADJUTING PROPERTY OWNERS.</p> <p style="text-align: center;">25 0 25 50 75 100 Scale of Feet</p>
Existing	Proposed	Existing	Proposed																				
Sanitary Sewer	Telephone Line	Traveled Way	Ditch																				
Electric Line	Water Line	Catch Basin	Manhole																				
Underdrain Line	Gas Line	Sewer Manhole	Utility Pole																				
Guardrail	Culvert	Fire Hydrant	Curbing																				

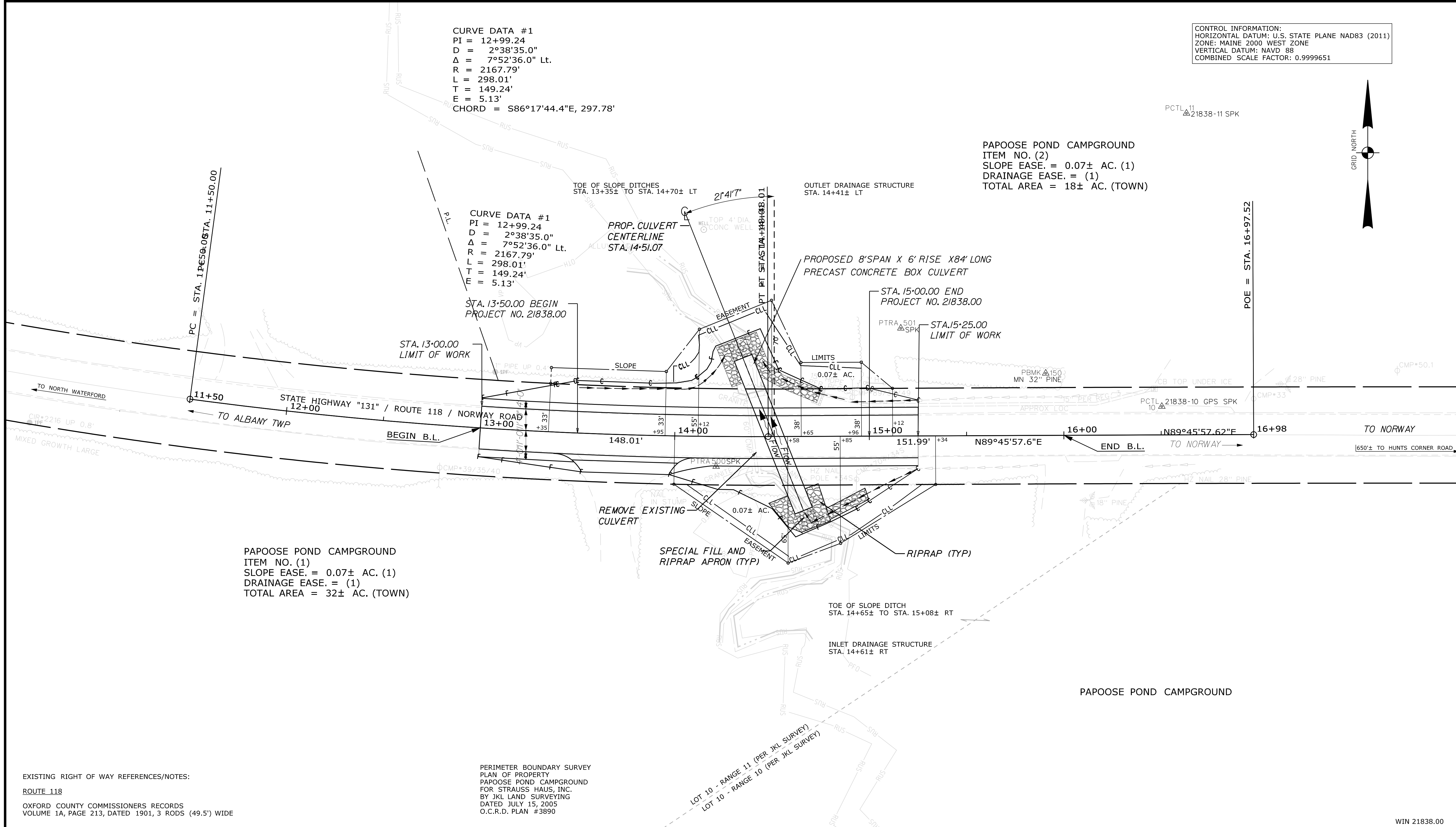

PRELIMINARY PLAN

ITEM	TECH	CHECKED
EXISTING CONDITION PLAN	N.T.A.	
FINAL RIGHT OF WAY		
AREAS		

STATE OF MAINE
DEPARTMENT OF TRANSPORTATION
16 STATE HOUSE STATION - AUGUSTA, ME 04333-0016 - 207-624-3460
WATERFORD
RIGHT OF WAY MAP

REVISIONS	PLAN FILED IN PLAN BOOK	PAGE	COUNTY RECORD	BRUCE A. VAN NOTE	STATE HIGHWAY "131"
NO. DATE DESCRIPTION BY	NO. GRANTOR	INSTRUMENT	DATE BOOK PAGE	COMMISSIONER JOYCE NOEL TAYLOR CHIEF ENGINEER	ROUTE 118
				DATE	WATERFORD CUMBERLAND COUNTY
					02183800
					SHEET NUMBER
					12
					OF 12
					JUNE 2018 RIGHT-OF-WAY MAP SCALE 1" = 25' SHEET XX OF XX
					D.O.T. FILE NO. 9-TBD