

# STATE OF MAINE DEPARTMENT OF TRANSPORTATION



## KINGSBURY PISCATAQUIS COUNTY

ROUTE 16

**FEDERAL PROJECT NO. 2179400**

WORCESTER HIGHWAY BRIDGE  
BRIDGE NUMBER: 6770

PLAN LEGEND	
Town, County, State	-----
Property Lines	-----
R/W Lines-Existing	-----
R/W Lines-Proposed	-----
Culvert-Existing	-----
Culvert Proposed	-----
Curbing Existing	-----
Curbing Proposed	-----
Type 1	-----
Type 3	-----
Type 5	-----
Outline of Bodies of Water	-----
Exposed Bedrock	-----
Buildings	-----
Trees	-----
Tree Line	-----
Clearing Limit Line	-----
Railroad	-----
Catch Basins	Existing Proposed
Manholes	Existing Proposed
Proposed Underdrain	-----
Proposed Ditch	-----
Existing Ditch	-----
Utility Poles	Existing Proposed
Fire Hydrants	Existing Proposed
Existing Water Line	-----
Existing San. Sewer	-----
Existing San. Sewer Manhole	-----
Guardrail-Existing	-----
Guardrail-Proposed	-----
Guardrail-Cable, Other	-----
Centerline-Existing	-----
Centerline-Proposed	-----
Travelway-Existing	-----
Travelway-Proposed	-----
Boring	HB-XXX-###
Pavement Core	PC-#
Test Pit	TP-XXX-###
Probe	P-#. #X
	#, # = Depth
	X = W (Weathered Rock)
	R (Refusal)
	NR (No Refusal)

INDEX OF SHEETS	
Description	Sheet No.
Title Sheet	1
Typical Section / Estimated Quantities	2
General Notes / Construction Notes	3
Culvert Details	4
Streambed Details	5
Boring Location Plan and Interpretive Subsurface Profile	6
Plan / Profile	7
Cross - Sections	8-14
Detour Map	15
Right of Way Map	16

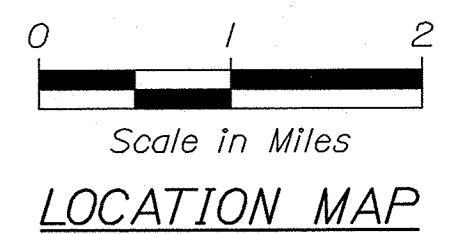
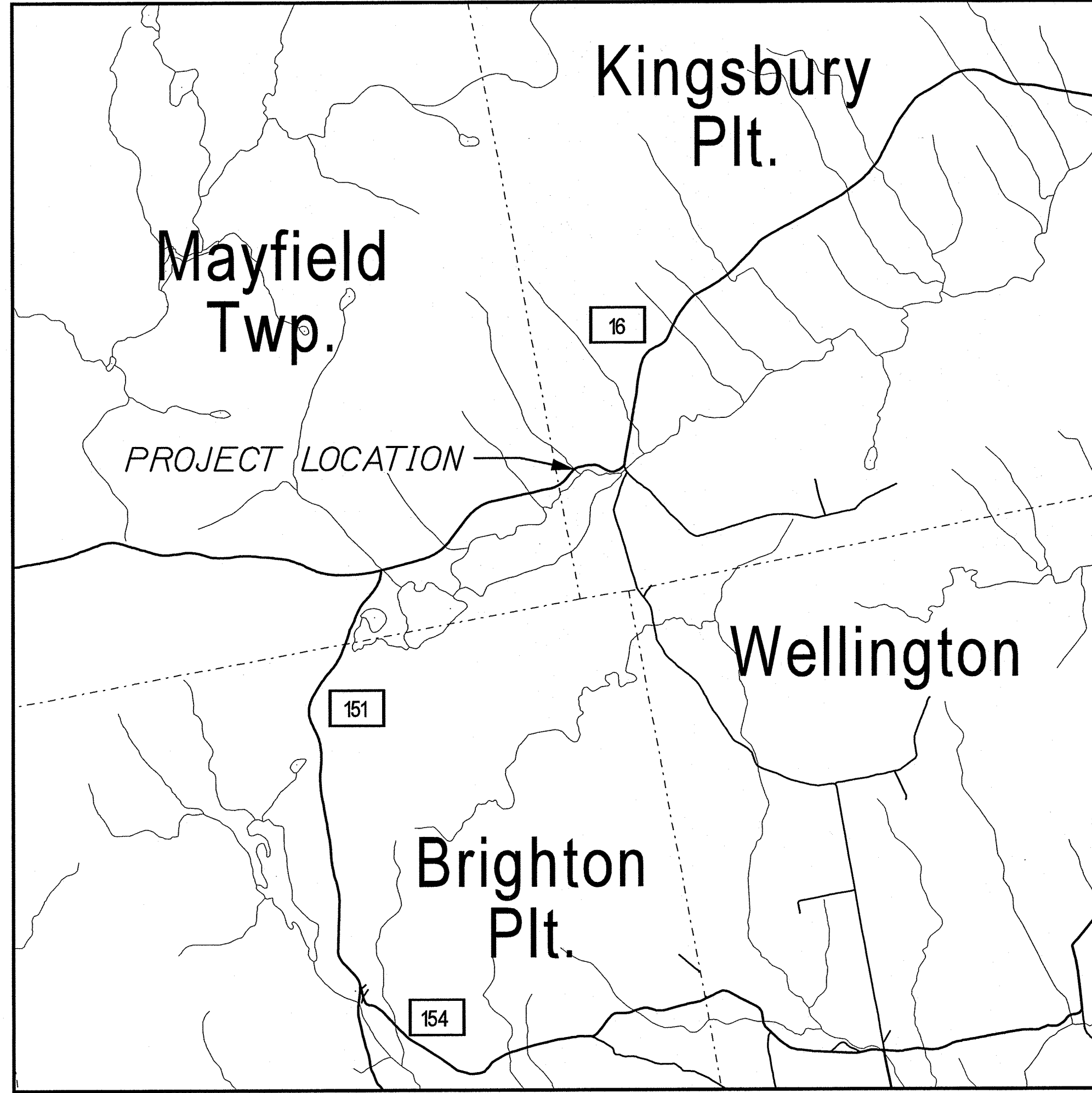

TRAFFIC DATA	
Current (2026) AADT	420
Future (2046) AADT	460
DHV - % of AADT	14%
Design Hour Volume	64
% Heavy Trucks (AADT)	9%
% Heavy Trucks (DHV)	6%
Directional Distribution (DHV)	51%
Design Speed (mph)	45
18-KIP Equivalent 2.0	19
18-KIP Equivalent 2.5	18
Functional Class	Major Collector
Corridor Priority	4

<b>PROJECT LOCATION:</b>	0.22 OF A MILE EAST OF THE MAYFIELD/KINGSBURY TOWN LINE
<b>PROGRAM AREA:</b>	REGIONAL PROGRAM
<b>SCOPE OF WORK:</b>	LARGE CULVERT REPLACEMENT

STATE OF MAINE DEPARTMENT OF TRANSPORTATION	APPROVED	DATE
COMMISSIONER: <i>[Signature]</i>	<i>[Signature]</i>	5-7-24
CHIEF ENGINEER: <i>[Signature]</i>	<i>[Signature]</i>	5-6-26

PROJECT INFORMATION	REGIONAL PROGRAM
PROJECT MANAGER	A. MOUSSEAU
DESIGNER	C. VANDENBOSSCHE
CONSULTANT	
PROJECT RESIDENT	
CONTRACTOR	
PROJECT COMPLETION DATE	

SIGNATURE	10/15
P.E. NUMBER	4-23-26
DATE	

PROGRAM	REGIONAL PROGRAM
PROJECT MANAGER	A. MOUSSEAU
DESIGNER	C. VANDENBOSSCHE
CONSULTANT	
PROJECT RESIDENT	
CONTRACTOR	
PROJECT COMPLETION DATE	

SHEET NUMBER	1
OF 16	

WIN 21794.00 FEDERAL PROJECT NO. 2179400

KINGSBURY  
ROUTE 16  
TITLE SHEET

Username: Casey.VanDenBoschDate:4/23/2026

Division: HIGHWAY

Filename: ... \001\_Title\_superelevation.dgn

Filename: ... \MSTA\002\_Typical\_Section.dgn Division: HIGHWAY Username: Casey.VanDenBossch@Date:5/1/2026

ESTIMATED QUANTITIES			
ITEM NO.	DESCRIPTION	QUANTITY	UNIT
203.20	COMMON EXCAVATION	1440	CY
203.25	GRANULAR BORROW	260	CY
203.33	SPECIAL FILL	84	CY
304.10	AGGREGATE SUBBASE COURSE - GRAVEL	1220	CY
403.208	HOT MIX ASPHALT 12.5 MM SURFACE	160	T
403.213	HOT MIX ASPHALT 12.5 MM BASE	270	T
409.15	BITUMINOUS TACK COAT - APPLIED	170	G
508.13	SHEET WATERPROOFING MEMBRANE (160 SY)	1	LS
511.07	COFFERDAM: DOWNSTREAM	1	LS
511.07	COFFERDAM: UPSTREAM	1	LS
534.7101	PRECAST CONCRETE BOX CULVERT - STATE SUPPLIED (155 CY)	1	LS
606.1301	3" W-BM GR, MID-WAY SPLICE - SINGLE FACED	415	LF
606.1303	3" W-BM GR, MID-WAY SPLICE - 15' RAD AND LESS	25	LF
606.1305	3" W-BM GR, MID-WAY SPLICE FLARED TERMINAL	3	EA
606.2602	TERMINAL END - TRAILING END	1	EA
606.353	REFLECTORIZED FLEXIBLE GUARDRAIL MARKER	7	EA
610.08	PLAIN RIPRAP	60	CY
610.210	STREAM CHANNEL ROCK	70	CY
610.212	STREAMBED ROCK FEATURES	20	CY
613.319	EROSION CONTROL BLANKET	90	SY
615.10	DIRTY BORROW	1500	CY
618.14	SEEDING METHOD NUMBER 2	17	UN
619.12	MULCH	17	UN
619.14	EROSION CONTROL MIX	10	CY
620.58	EROSION CONTROL GEOTEXTILE	200	SY
627.733	4" WHITE OR YELLOW PAINTED PAVEMENT MARKING LINE	1350	LF
629.05	HAND LABOR, STRAIGHT TIME	20	HR
631.12	ALL PURPOSE EXCAVATOR (INCLUDING OPERATOR)	20	HR
631.172	TRUCK - LARGE (INCLUDING OPERATOR)	20	HR
639.21	FIELD OFFICE TYPE D	1	EA
652.33	DRUM	25	EA
652.34	CONE	50	EA
652.35	CONSTRUCTION SIGNS	550	SF
652.361	MAINTENANCE OF TRAFFIC CONTROL DEVICES	1	LS
652.38	FLAGGER	40	HR
656.75	TEMPORARY SOIL EROSION AND WATER POLLUTION CONTROL	1	LS
659.10	MOBILIZATION	1	LS

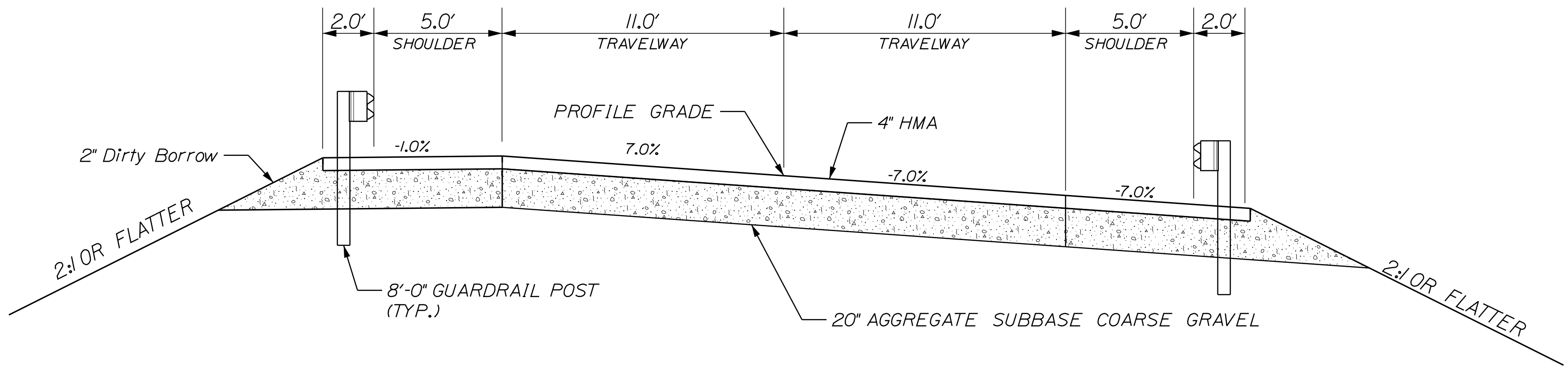

TYPICAL SECTION  
NOT TO SCALE

STATE OF MAINE DEPARTMENT OF TRANSPORTATION		2179400		WIN 21794.00		REGIONAL PLANS	
KINGSBURY ROUTE 16		TYPICAL SECTION/ ESTIMATED QUANTITIES		SHEET NUMBER		2	
PROJ. MANAGER		A. MOUSSEAU		BY		DATE	
DESIGN/DETAILED		CV0B		CV0B		5/1/2026	
CHECKED/REVIEWED						SIGNATURE	
DESIGNS/DETAILED						P.E. NUMBER	
REVISIONS 1						DATE	
REVISIONS 2							
REVISIONS 3							
REVISIONS 4							
FIELD CHANGES							

# GENERAL AND CONSTRUCTION NOTES

1. PAVEMENT THICKNESSES SHOWN ON THE TYPICAL SECTIONS ARE INTENDED TO BE NOMINAL.
2. ALL CLEARING SHALL BE CONSIDERED INCIDENTAL TO THE CONTRACT AND NO SEPARATE PAYMENT WILL BE MADE. THE ACTUAL LINES FOR CLEARING SHALL BE ESTABLISHED IN THE FIELD BY THE CONTRACTOR AS INDICATED ON THE PLANS AND APPROVED BY THE RESIDENT.
3. ALL INSLOPE AND DITCHES IN CUT AREAS SHALL BE GRADED AS SHOWN ON THE TYPICALS OR FLATTER, OR AS DIRECTED BY THE RESIDENT.
4. THE CONTRACTOR SHALL PLAN AND CONDUCT WORK SO THAT UPON COMPLETION OF THE PROJECT THERE IS NO DROP-OFF FROM THE EDGE OF THE SHOULDER PAVEMENT.
5. ALL WASTE MATERIAL NOT USED ON THE PROJECT SHALL BE DISPOSED OF OFF THE PROJECT IN ACCEPTABLE WASTE AREAS REVIEWED BY THE RESIDENT. GRADING, SEEDING AND MULCHING OF WASTE AREAS SHALL BE CONSIDERED INCIDENTAL.
6. GRANULAR BORROW USED TO BACKFILL MUCK EXCAVATION OR IN LOW WET AREAS TO 1 FOOT ABOVE WATER LEVEL OR OLD GROUND SHALL MEET REQUIREMENTS FOR GRANULAR BORROW MATERIAL FOR UNDERWATER BACKFILL AS SPECIFIED IN STANDARD SPECIFICATIONS ITEM 703.19, GRANULAR BORROW.
7. WHEN SUPERELEVATION EXCEEDS THE SLOPE OF THE LOW-SIDE SHOULDER, THE LOW-SIDE SHOULDER WILL HAVE SAME SLOPE AS THE TRAVELWAY.
8. CROSS SLOPES FOR NORMAL AND SUPERELEVATED SECTIONS WILL BE STRAIGHT UNLESS OTHERWISE DIRECTED BY THE DEPARTMENT.
9. THE ALGEBRAIC DIFFERENCE BETWEEN TRAVELWAY AND SHOULDER CROSS SLOPE SHALL NOT EXCEED 8 PERCENT.
10. GUARDRAIL END TREATMENTS SHALL BE INSTALLED CONCURRENTLY WITH THE PLACEMENT OF EACH SECTION OF BEAM GUARDRAIL.
11. ALL EXISTING GUARDRAIL REMOVED AND NOT REUSED ON THE PROJECT WILL BECOME THE PROPERTY OF THE CONTRACTOR. REMOVAL AND DISPOSAL SHALL BE CONSIDERED INCIDENTAL TO THE GUARDRAIL ITEMS.
12. TWO REFLECTORIZED FLEXIBLE GUARDRAIL MARKERS (STANDARD SPECIFICATIONS ITEM 606.353, REFLECTORIZED FLEXIBLE GUARDRAIL MARKER) WILL BE INSTALLED AT EACH GUARDRAIL END.
13. CONNECTIONS FOR PROPOSED GUARDRAIL TO EXISTING GUARDRAIL WILL BE CONSIDERED INCIDENTAL TO STANDARD SPECIFICATIONS SECTION 606, GUARDRAIL.
14. DIRTY BORROW HAS BEEN ESTIMATED FOR ALL DISTURBED SLOPE AREAS OTHER THAN LAWN AREAS. ACTUAL PLACEMENT OF THE DIRTY BORROW SHALL BE AS NOTED ON THE PLANS OR DESIGNATED BY THE RESIDENT.
15. THE CONTRACTOR WILL BE RESPONSIBLE FOR MAINTAINING ALL EXISTING MAILBOXES TO ENSURE THAT THE MAIL WILL BE DELIVERABLE. PAYMENT FOR THIS WORK WILL BE CONSIDERED INCIDENTAL TO THE CONTRACT.
16. ANY DAMAGE TO THE SLOPES CAUSED BY THE CONTRACTOR'S EQUIPMENT, PERSONNEL, OR OPERATION SHALL BE REPAIRED TO THE SATISFACTION OF THE RESIDENT. ALL WORK, EQUIPMENT, AND MATERIALS REQUIRED TO MAKE REPAIRS SHALL BE AT THE CONTRACTOR'S EXPENSE.
17. THE PROJECT GEOTECHNICAL REPORT TITLED "GEOTECHNICAL DESIGN REPORT FOR THE CONSTRUCTION OF WORCESTER HIGHWAY BRIDGE", SOILS REPORT 2026-21, MAY 20, 2026 CAN BE ACCESSED AT THE MAINEDOT WEBSITE [HTTPS://WWW.MAINE.GOV/DOING-BUSINESS/BID-OPPORTUNITIES/](https://www.maine.gov/dot/doing-business/bid-opportunities/) .

18. GEOTECHNICAL INFORMATION FURNISHED OR REFERRED TO IN THE BID DOCUMENTS IS FOR THE USE OF THE BIDDERS. NO ASSURANCE IS GIVEN THAT THE INFORMATION OR INTERPRETATIONS WILL BE REPRESENTATIVE OF THE ACTUAL SUBSURFACE CONDITIONS THROUGHOUT THE CONSTRUCTION SITE. MAINEDOT WILL NOT BE RESPONSIBLE FOR ANY INTERPRETATIONS OR CONCLUSIONS DRAWN FROM THE GEOTECHNICAL INFORMATION. THE BORING LOGS PROVIDED IN THE BID DOCUMENTS (IF ANY) PRESENT FACTUAL AND INTERPRETIVE SUBSURFACE INFORMATION COLLECTED AT DISCRETE LOCATIONS. DATA PROVIDED MAY NOT BE REPRESENTATIVE OF THE SUBSURFACE CONDITIONS BETWEEN BORING LOCATIONS.
19. AREAS ON THE PROJECT REQUIRING FILL WILL COME FROM SUITABLE SITES SUCH AS EXCAVATION, DITCH AND INSLOPE OR EQUIPMENT RENTAL AREAS.
20. NO SEPARATE PAYMENT FOR SUPERINTENDENT OR FOREMAN WILL BE MADE FOR THE SUPERVISION OF EQUIPMENT AND LAYOUT OF WORK BEING PAID FOR UNDER THE EQUIPMENT RENTAL ITEMS.
21. FINAL STRIPING FOR THE PROJECT SHALL BE DONE BY THE CONTRACTOR PER THE STRIPING LAYOUT IN THE CONTRACT DOCUMENTS OR AS PROVIDED BY THE DEPARTMENT. PAYMENT SHALL BE MADE UNDER APPROPRIATE CONTRACT ITEMS.

- ITEM 606.1301 31" W-BEAM GUARDRAIL -  
MID-WAY SPLICE, SINGLE FACED  
STA. 14+51.24, 16.00' LT TO STA. 16+44.99, 16.00' LT      LENGTH 193.75 LF  
STA. 13+72.99, 16.00' RT TO STA. 15+93.30, 16.00' RT      220.31 LF
- ITEM 606.1303 31" W-BEAM GUARDRAIL -  
MID-WAY SPLICE, 15' RADIUS AND LESS  
STA. 15+93.30, 16' RT TO STA. 16+11.52, 33.61' RT      LENGTH 25.00 LF (15' RADIUS)
- ITEM 606.1305 31" W-BEAM GUARDRAIL -  
MID-WAY SPLICE, FLARED TERMINAL  
STA. 14+51.24, 16.00' LT  
STA. 16+44.99, 16.00' LT  
STA. 13+72.99, 16.00' RT

Filename: ... \003\_General\_Construction\_Notes.dgn Division: HIGHWAY Username: Casey.VanDenBossch Date: 5/21/2026

STATE OF MAINE DEPARTMENT OF TRANSPORTATION	2179400	WIN 21794.00	REGIONAL PLANS
PROJ. MANAGER A. MOUSSEAU	BY CV0B	DATE 5/21/2026	SIGNATURE
DESIGN-DETAILED	CHECKED-REVIEWED	DESIGN-DETAILED	P.E. NUMBER
DESIGN-DETAILED	DESIGN-DETAILED	REVISIONS 1	DATE
REVISIONS 1	REVISIONS 2	REVISIONS 3	DATE
REVISIONS 2	REVISIONS 4	FIELD CHANGES	DATE
REVISIONS 3	KINGSBURY ROUTE 16 GENERAL NOTES/ CONSTRUCTION NOTES		
REVISIONS 4	SHEET NUMBER		
FIELD CHANGES	3		
OF 16			



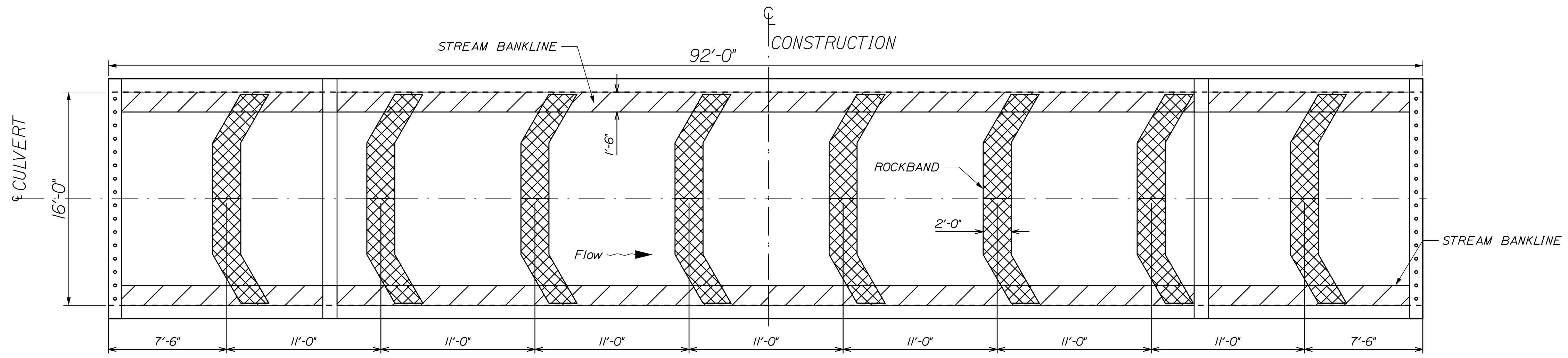

**STREAMBED PLAN**  
NOT TO SCALE

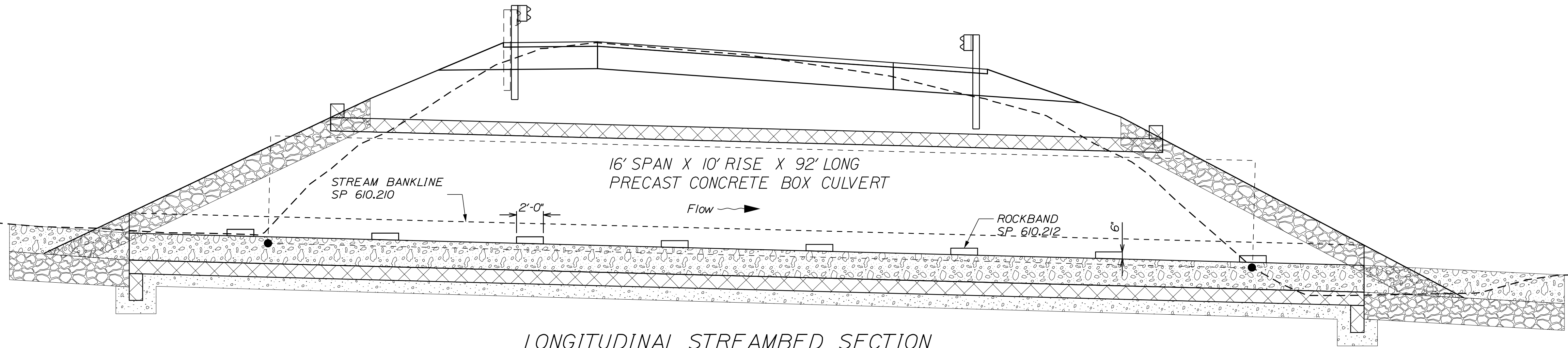

**LONGITUDINAL STREAMBED SECTION**  
NOT TO SCALE

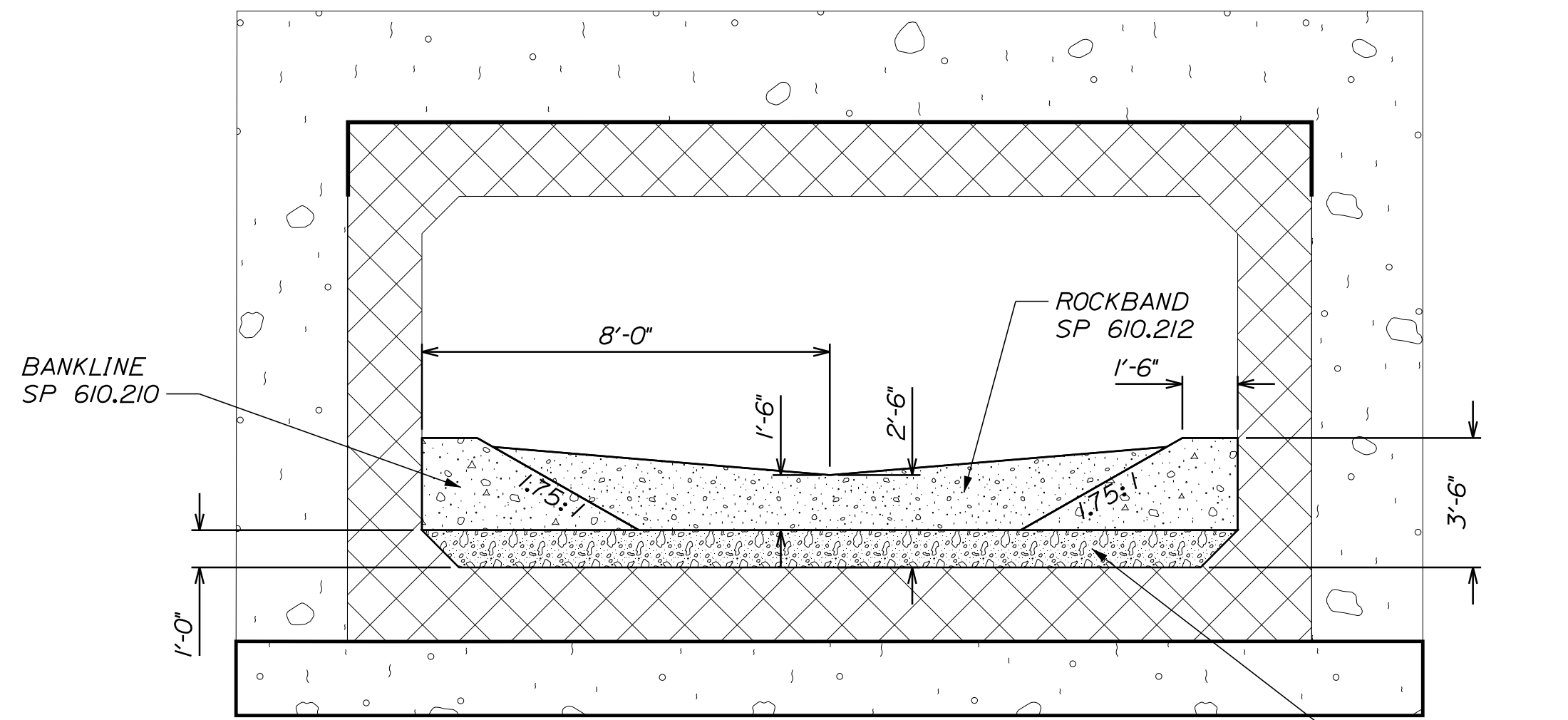

**TYPICAL ROCKBAND SECTION**  
NOT TO SCALE

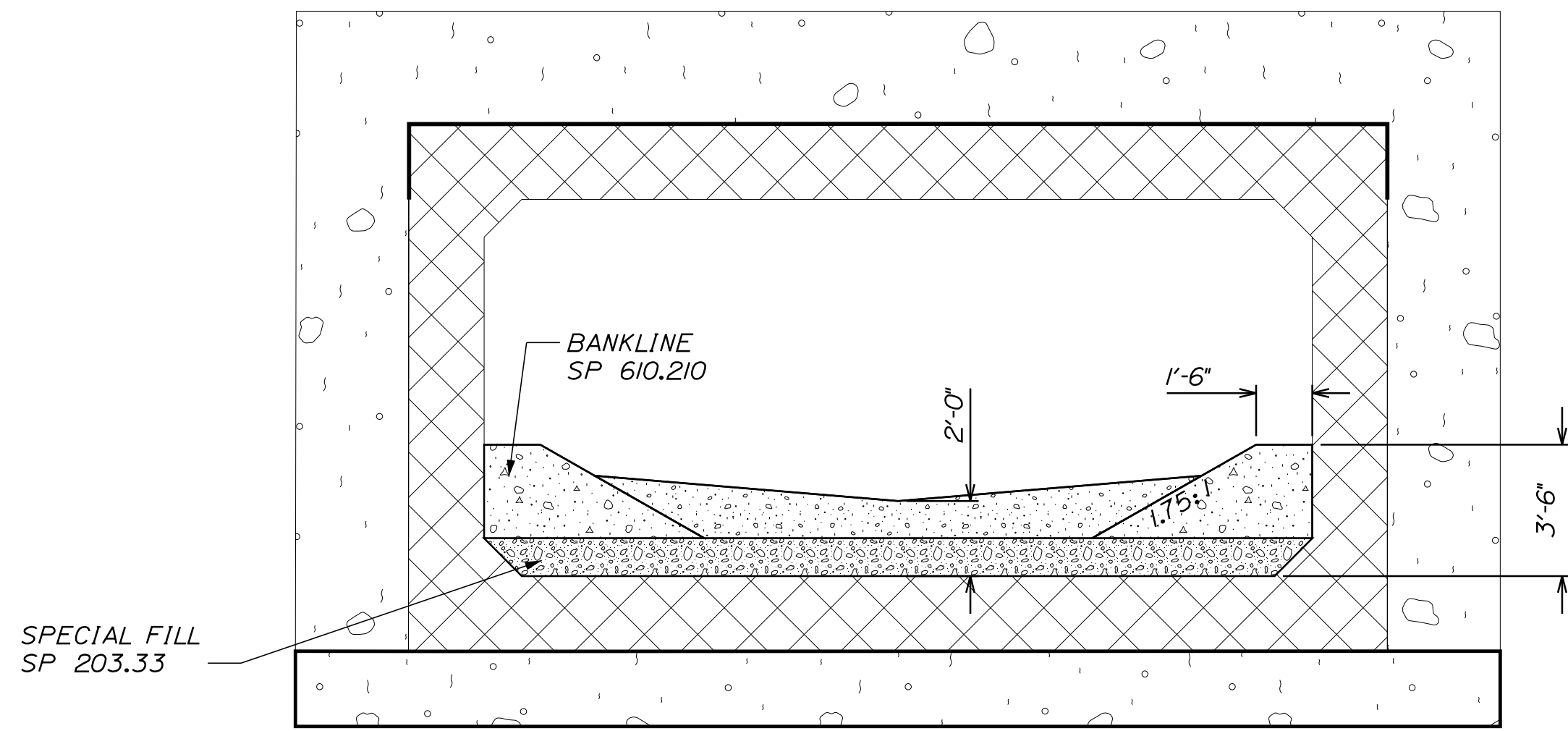

**TYPICAL STREAMBED SECTION**  
NOT TO SCALE

PROJ. MANAGER	BY	DATE
A. MOUSSEAU	CVOB	4/14/2026
CHECKED/REVIEWED		
DESIGNED/DETAILED		
REVISIONS 1		
REVISIONS 2		
REVISIONS 3		
REVISIONS 4		
FIELD CHANGES		





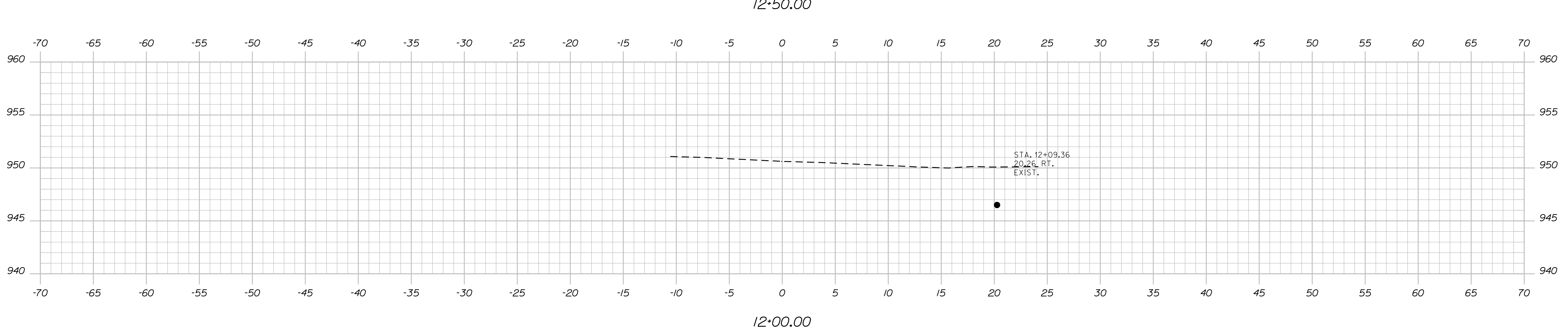
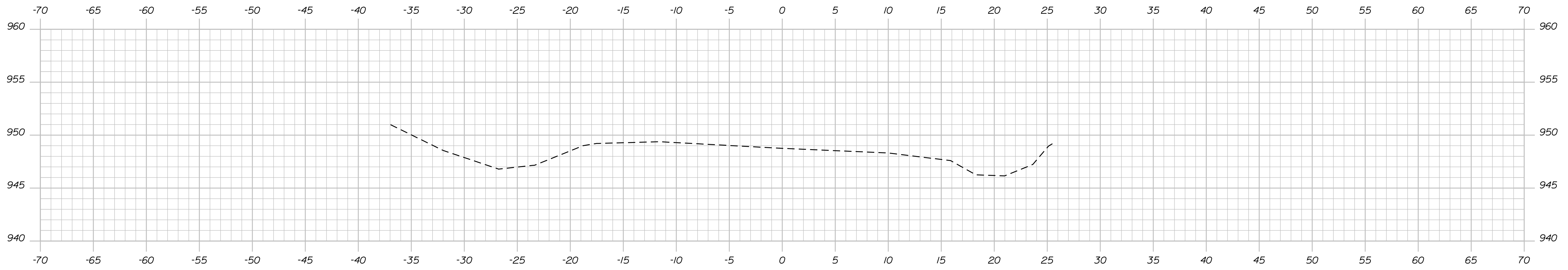
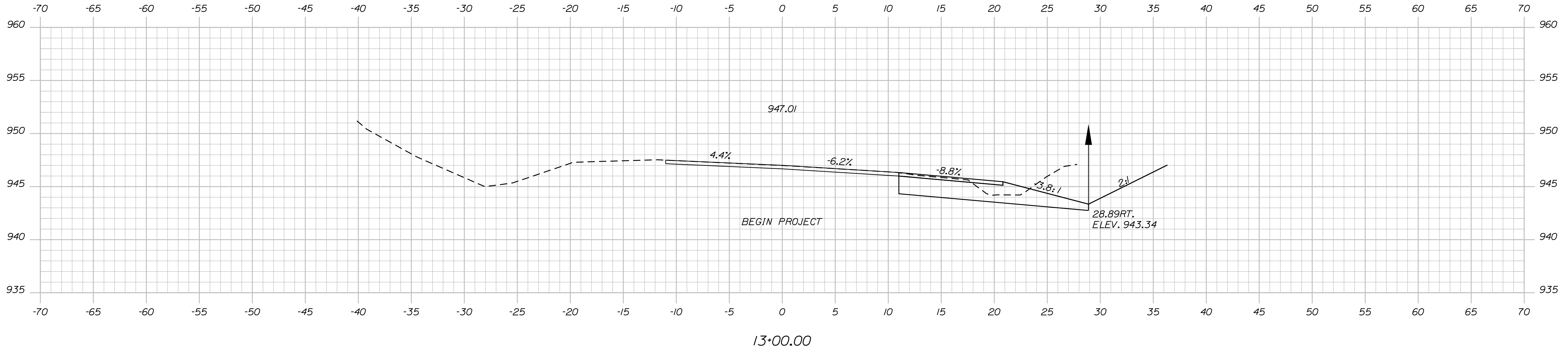

STATE OF MAINE  
DEPARTMENT OF TRANSPORTATION  
2179400  
WIN  
21794.00  
REGIONAL PLANS

PROJ. MANAGER  
A. MOUSSEAU  
BY  
CVOB  
DATE  
3/31/2026  
SIGNATURE  
P.E. NUMBER  
DATE

DESIGN-DETAILED	CHECKED-REVIEWED	DESIGNS-DETAILED	REVISIONS 1	REVISIONS 2	REVISIONS 3	REVISIONS 4	FIELD CHANGES

KINGSBURY  
ROUTE 16  
CROSS SECTIONS

SHEET NUMBER  
8  
OF 16

Username: Casey.VanDenBosschDate:4/29/2026

Division: HIGHWAY

Filename: ... \MSTAD09\_XSECT\_13+50.dgn

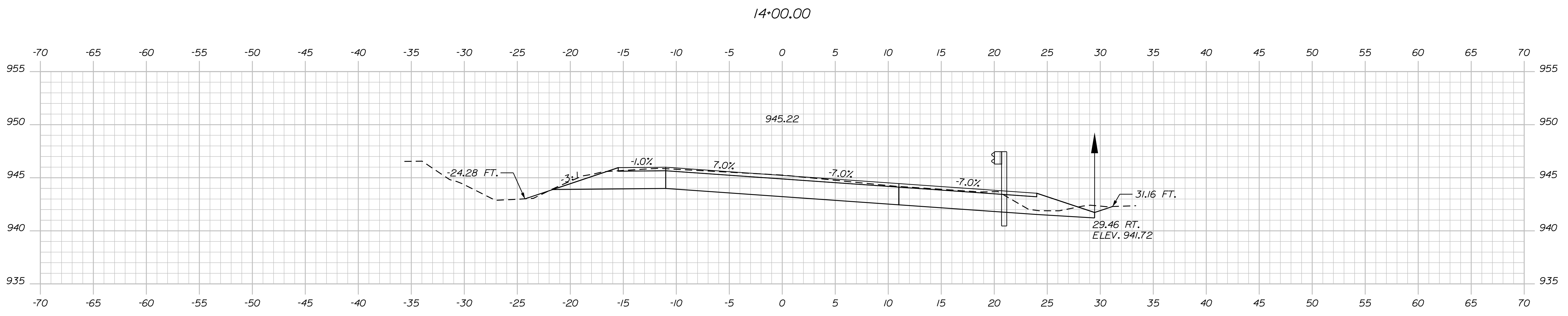
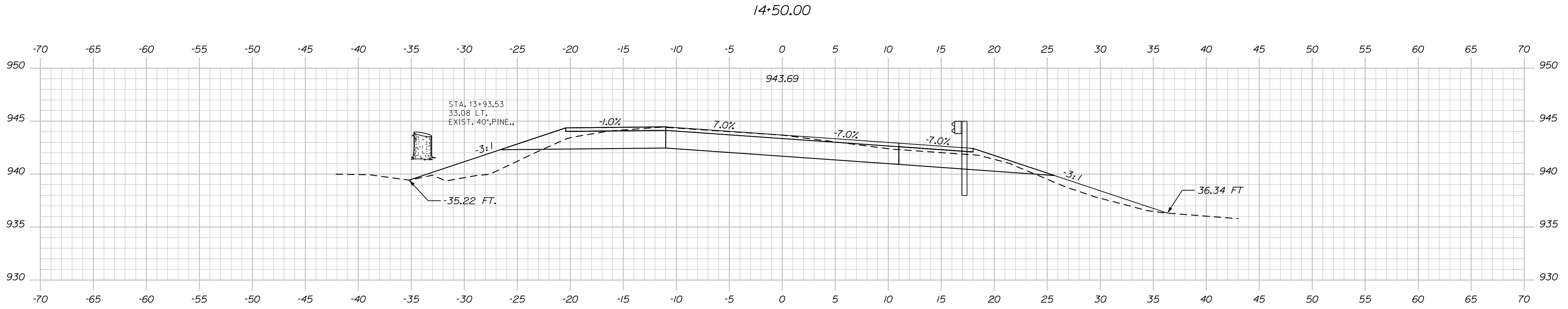
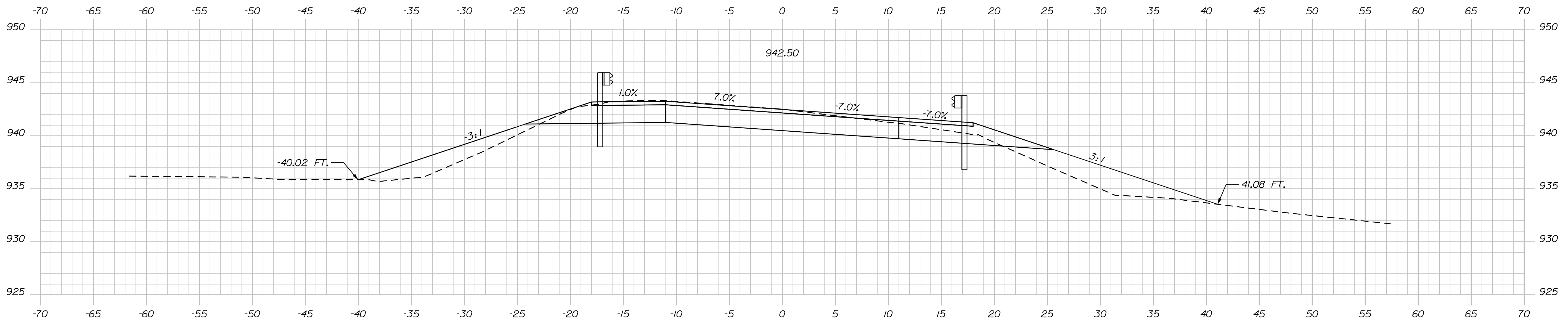

STATE OF MAINE  
DEPARTMENT OF TRANSPORTATION  
2179400  
WIN  
21794.00  
REGIONAL PLANS

SIGNATURE  
P.E. NUMBER  
DATE

PROJ. MANAGER	BY	DATE
A. MOUSSEAU	CV0B	3/31/2026
DESIGN-DETAILED	CV0B	
CHECKED-REVIEWED		
DESIGN-DETAILED		
DESIGN-DETAILED		
REVISIONS 1		
REVISIONS 2		
REVISIONS 3		
REVISIONS 4		
FIELD CHANGES		

KINGSBURY  
ROUTE 16  
CROSS SECTIONS

SHEET NUMBER  
**9**  
OF 16

Username: Casey\_VanDenBosschDate:4/29/2026

Division: HIGHWAY

Filename: ... \MSTA\010\_XSECT\_15+00.dgn

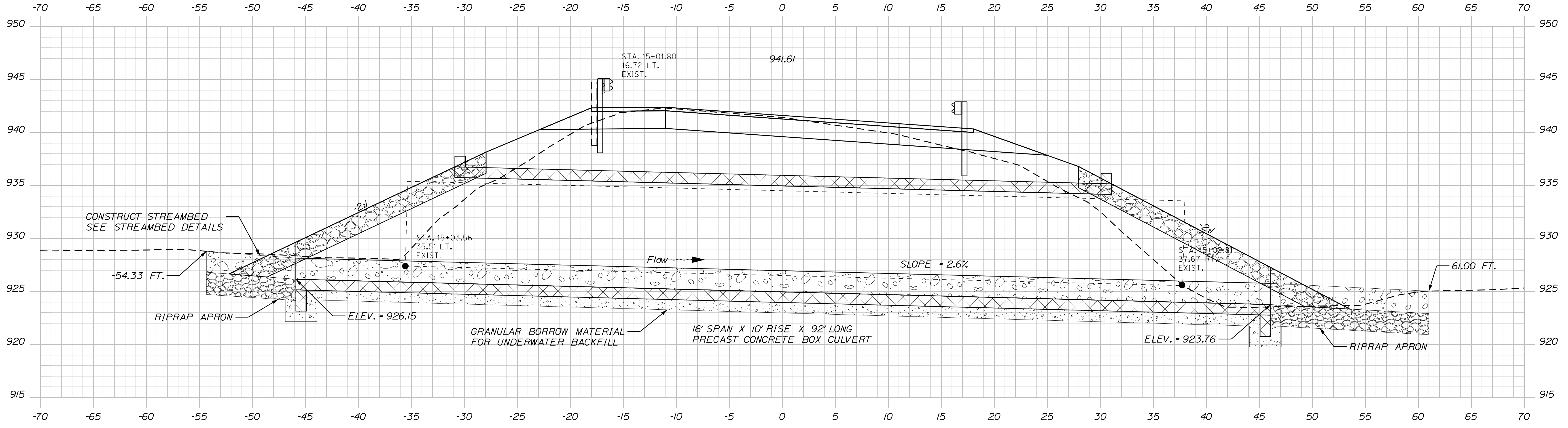

15+03.23

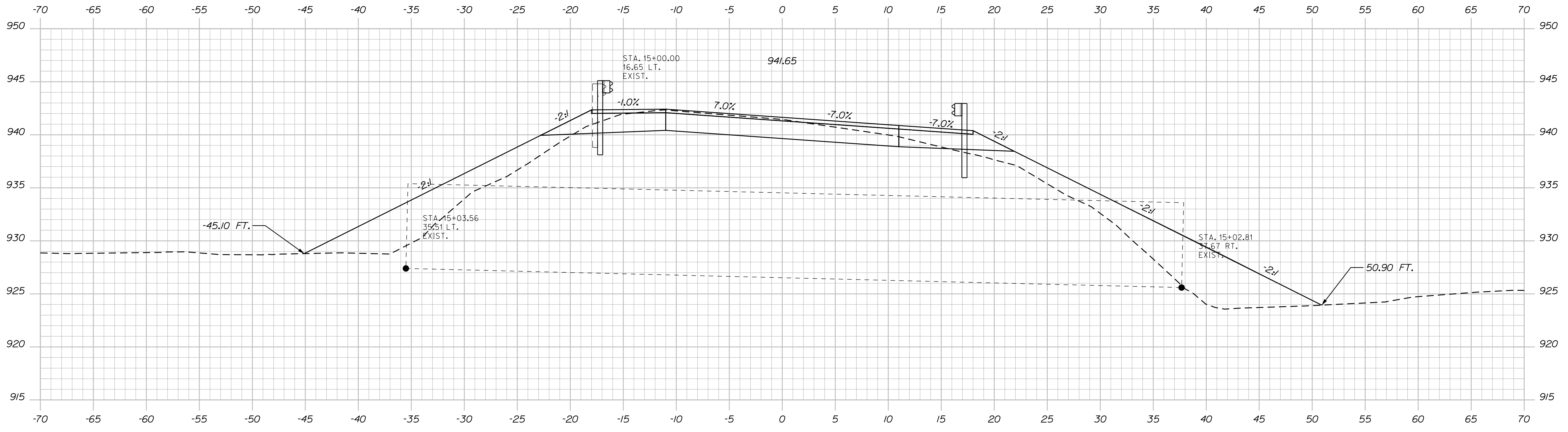

15+00.00

STATE OF MAINE  
DEPARTMENT OF TRANSPORTATION  
2179400  
WIN  
21794.00  
REGIONAL PLANS

PROJ. MANAGER	A. MOUSSEAU	DATE	4/24/2026
DESIGN-DETAILED	CV0B	BY	CV0B
CHECKED-REVIEWED			
DESIGN-DETAILED			
DESIGN-DETAILED			
REVISIONS 1		SIGNATURE	
REVISIONS 2		P.E. NUMBER	
REVISIONS 3		DATE	
REVISIONS 4			
FIELD CHANGES			

KINGSBURY  
ROUTE 16  
CROSS SECTIONS

SHEET NUMBER  
**10**  
OF 16

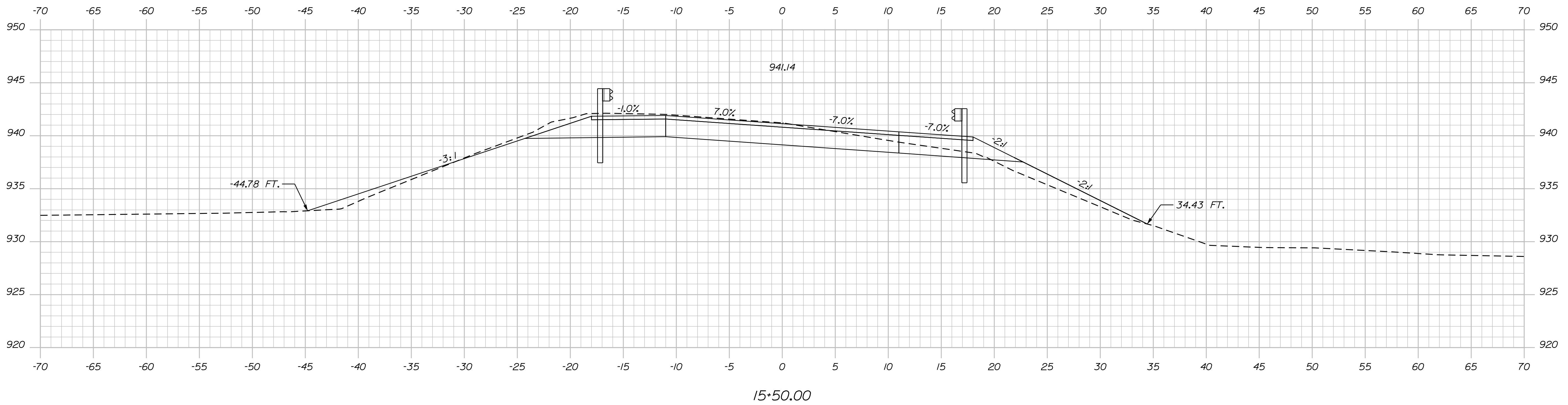
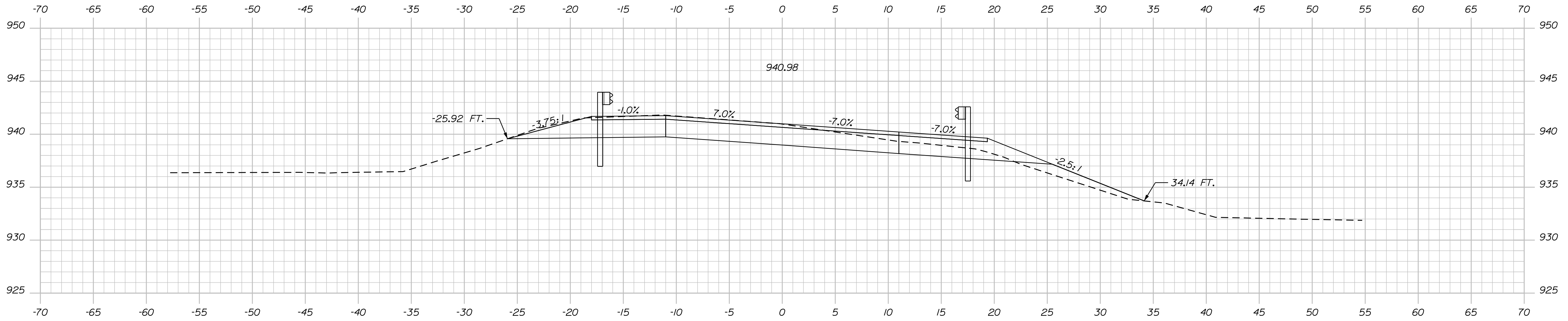

PROJ. MANAGER	DATE	BY	DATE
A. MOUSSEAU	3/18/2026	CVOB	
DESIGN-DETAILED			SIGNATURE
CHECKED-REVIEWED			P.E. NUMBER
DESIGN-DETAILED			DATE
DESIGN-DETAILED			
REVISIONS 1			
REVISIONS 2			
REVISIONS 3			
REVISIONS 4			
FIELD CHANGES			

KINGSBURY  
ROUTE 16  
CROSS SECTIONS

SHEET NUMBER

11

OF 16

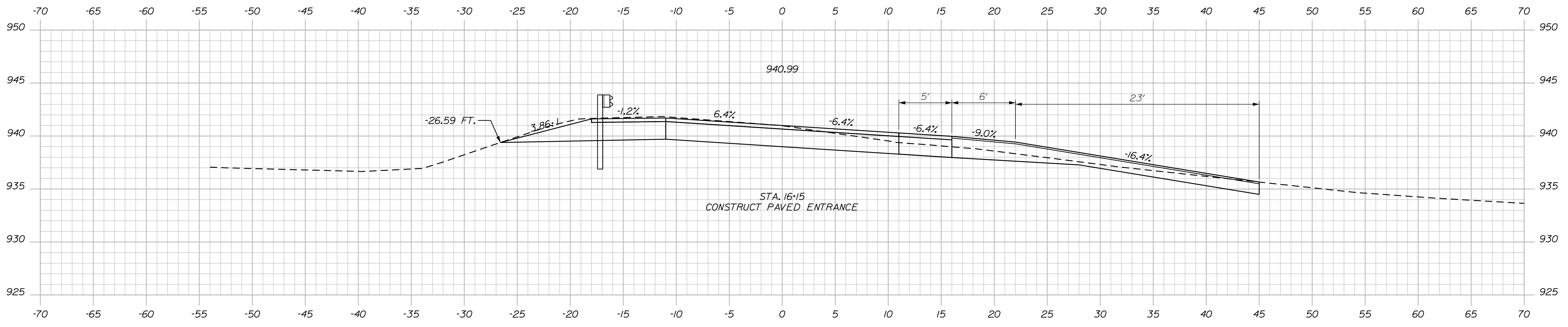

16+15.00

STATE OF MAINE  
DEPARTMENT OF TRANSPORTATION  
2179400  
WIN  
21794.00  
REGIONAL PLANS

PROJ. MANAGER	A. MOUSSEAU	BY	DATE
DESIGN-DETAILED	CVOB	CVOB	3/18/2026
CHECKED-REVIEWED			
DESIGNS-DETAILED			
REVISIONS 1			
REVISIONS 2			
REVISIONS 3			
REVISIONS 4			
FIELD CHANGES			

KINGSBURY  
ROUTE 16  
CROSS SECTIONS

SHEET NUMBER  
**12**  
OF 16

Username: Casey.VanDenBosschDate:4/29/2026

Division: HIGHWAY

Filename: ... \MSTAO13\_XSECT\_16+50.dgn

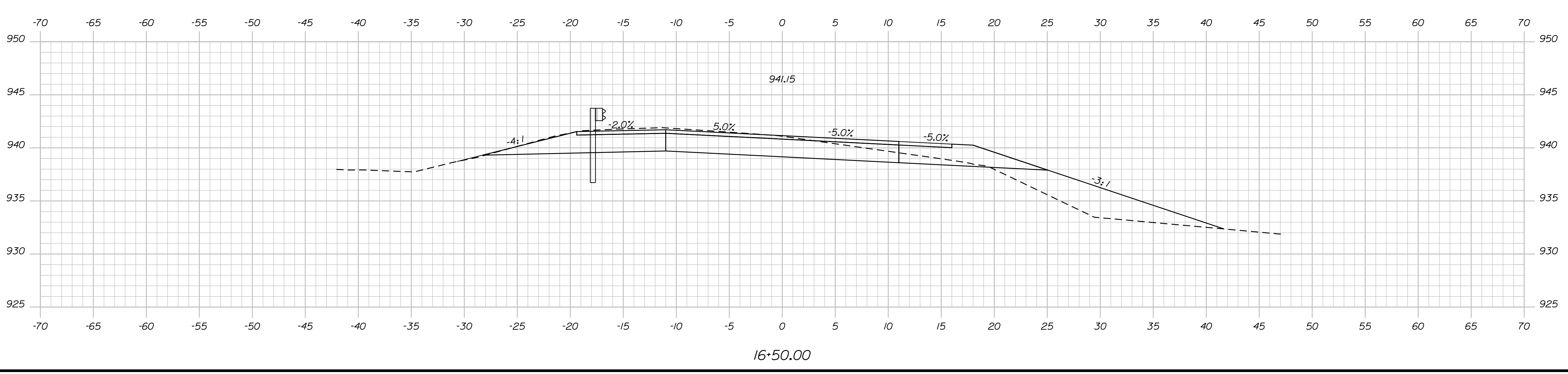
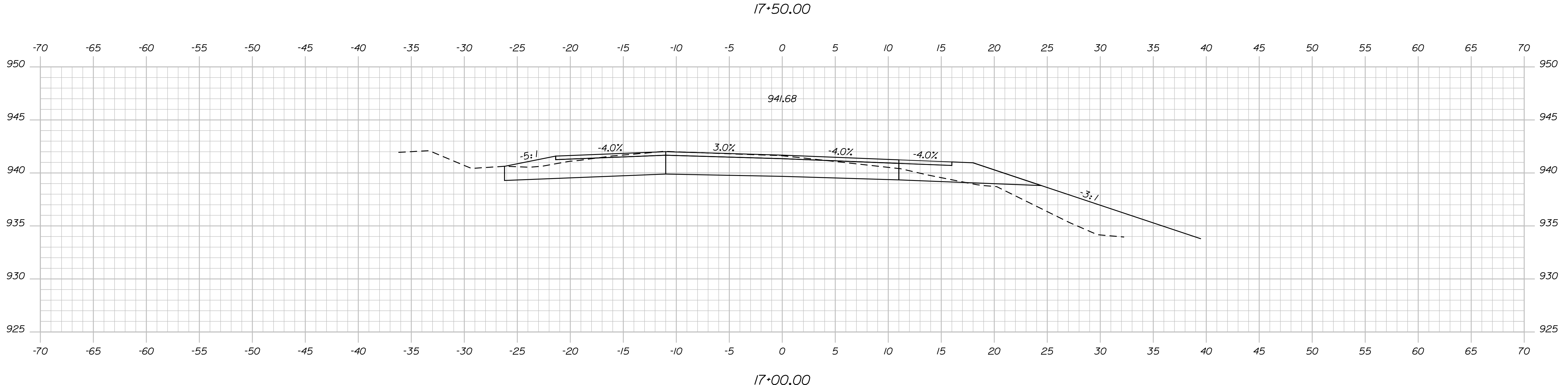
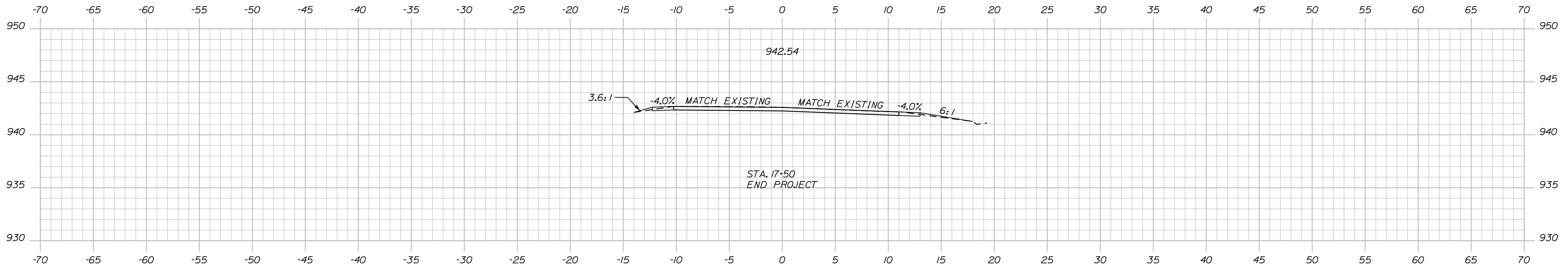

STATE OF MAINE  
DEPARTMENT OF TRANSPORTATION  
2179400  
WIN  
21794.00  
REGIONAL PLANS

SIGNATURE  
P.E. NUMBER  
DATE

PROJ. MANAGER	DATE
A. MOUSSEAU	4/7/2026
CHECKED-REVIEWED	
DESIGN-REVIEWED	
DESIGNS-DETAILED	
REVISIONS 1	
REVISIONS 2	
REVISIONS 3	
REVISIONS 4	
FIELD CHANGES	

KINGSBURY  
ROUTE 16  
CROSS SECTIONS

SHEET NUMBER  
**13**  
OF 16

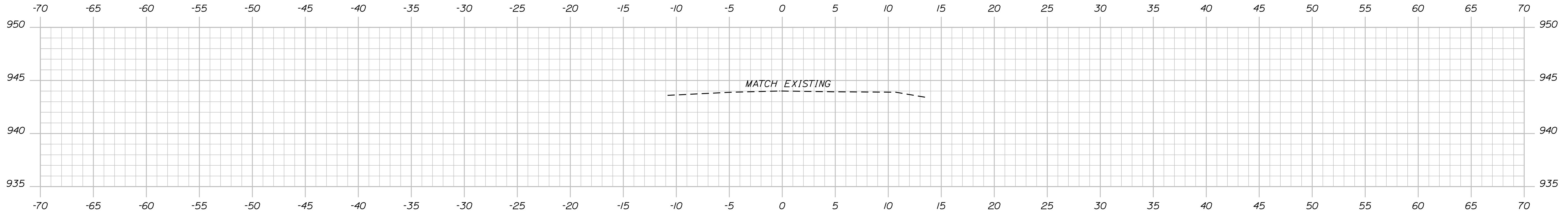

18+00.00

Sta. 18+00.00 to Sta. 18+00.00

KINGSBURY  
ROUTE 16

CROSS SECTIONS

SHEET NUMBER

14

OF 16

STATE OF MAINE  
DEPARTMENT OF TRANSPORTATION

2179400

WIN  
21794.00

REGIONAL PLANS

PROJ. MANAGER A. MOUSSEAU

CHECKED-REVIEWED CVOB

DESIGNS-DETAILED CVOB

REVISIONS 1

REVISIONS 2

REVISIONS 3

REVISIONS 4

FIELD CHANGES

DATE 3/18/2026

BY CVOB

SIGNATURE

P.E. NUMBER

DATE

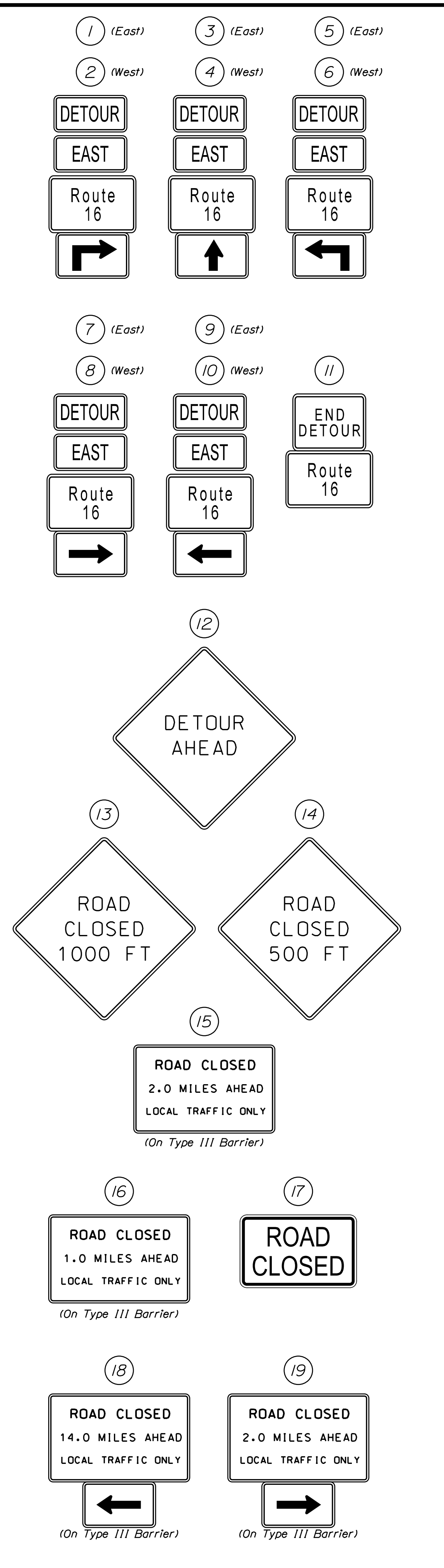
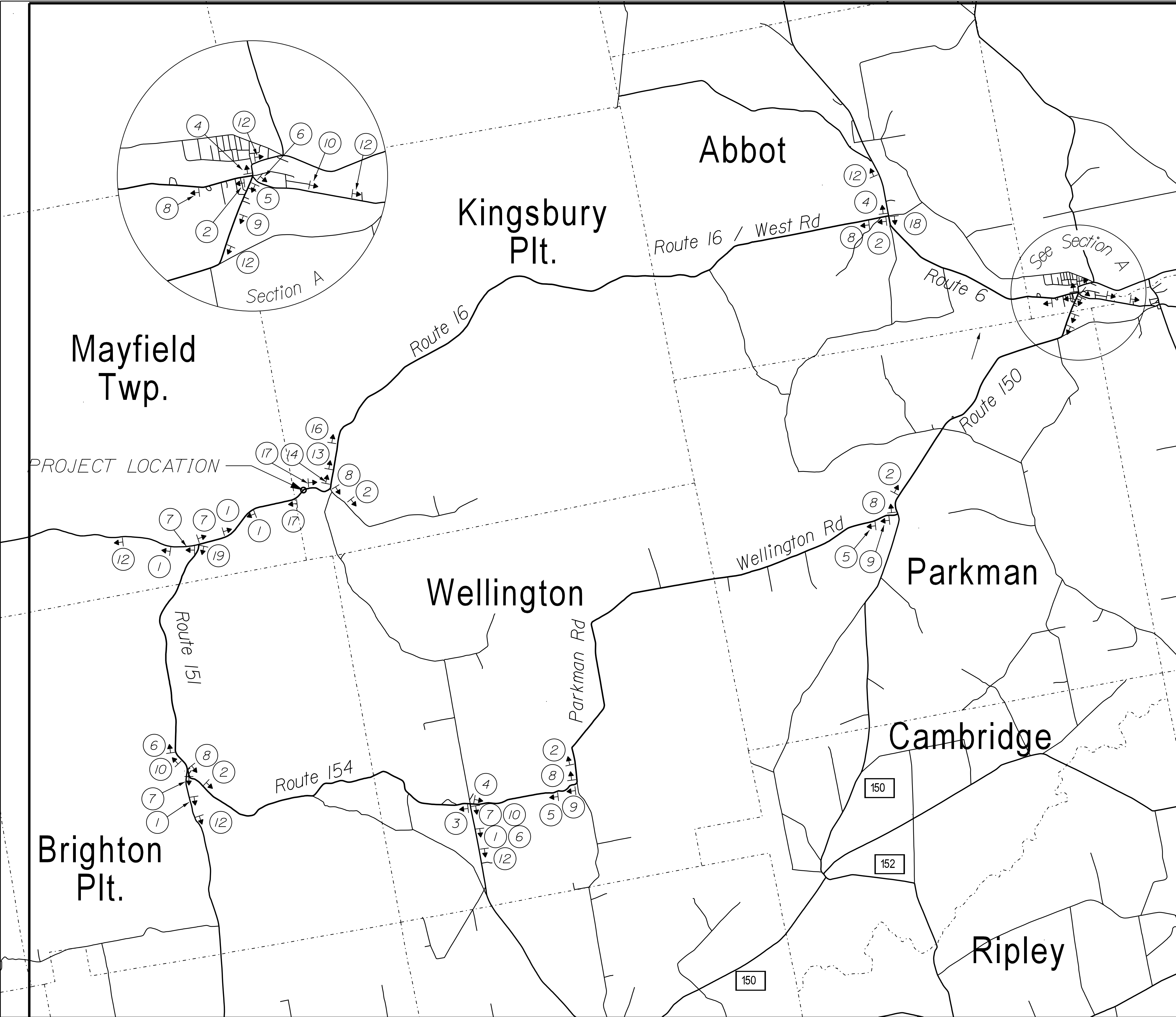

STATE OF MAINE		DEPARTMENT OF TRANSPORTATION		REGIONAL PLANS	
		2179400		WIN 21794.00	
				#6770	
PROJ. MANAGER	A. MOUSSEAU	BY	CVOB	DATE	3/31/2026
DESIGN DETAILED	CVOB	CHECKED-REVIEWED		SIGNATURE	
DESIGNS DETAILED		DESIGNS DETAILED		P.E. NUMBER	
REVISIONS 1		REVISIONS 1		DATE	
REVISIONS 2		REVISIONS 2			
REVISIONS 3		REVISIONS 3			
REVISIONS 4		REVISIONS 4			
FIELD CHANGES					
KINGSBURY ROUTE 16			DETOUR SHEET		
SHEET NUMBER			15		
			OF 16		

Username: Casey.VanDenBossch@date:4/29/2026

Division: HIGHWAY

Filename: ... \00\ROW\MSTA001\_RWP\PLANI.dgn

PLAN LEGEND	
<p>New R/W Along Existing R/W</p> <p>Building</p> <p>Trees Conifer</p> <p>Tree Line</p> <p>Water Edge</p> <p>Ledge</p> <p>Fence CHAIN LINK</p> <p>Sign</p>	<p>Clearing Limit Line</p> <p>Bush Line</p> <p>Rock/Boulder</p> <p>Flag Pole</p> <p>BARB WIRE</p> <p>WELL</p> <p>STOCKADE</p> <p>Mallbox</p>
<p>Sanitary Sewer</p> <p>Telephone Line</p> <p>Electric Line</p> <p>Water Line</p> <p>Underdrain Line</p> <p>Gas Line</p> <p>Guardrail</p> <p>Culvert</p>	<p>Existing</p> <p>Proposed</p> <p>Travelled Way</p> <p>Ditch</p> <p>Catch Basin</p> <p>Manhole</p> <p>Sewer Manhole</p> <p>Utility Pole</p> <p>Fire Hydrant</p> <p>Curbing</p>
<p>Cut Line</p> <p>Stonewall</p> <p>Baseline</p> <p>Monument</p> <p>Iron Rod Found</p> <p>Replacement Pin Set</p>	<p>Fill Line</p> <p>Retaining Wall</p> <p>10+00</p> <p>11+00</p> <p>12+00</p> <p>Traverse Point</p> <p>Pipe Found</p>

THIS PLAN WAS PREPARED IN CONNECTION WITH THE DEPARTMENT'S ACQUISITION OF REAL PROPERTY FOR TRANSPORTATION PURPOSES. IT CANNOT BE USED TO ESTABLISH LEGAL BOUNDARIES BETWEEN ABUTTING PROPERTY OWNERS.

STATE OF MAINE  
REGISTRY OF DEEDS

COUNTY \_\_\_\_\_  
RECEIVED \_\_\_\_\_,  
at \_\_\_\_\_ h \_\_\_\_\_ m \_\_\_\_\_ M and  
recorded in Plan Bk \_\_\_\_\_, Pg. \_\_\_\_\_  
Attest: \_\_\_\_\_  
REGISTER

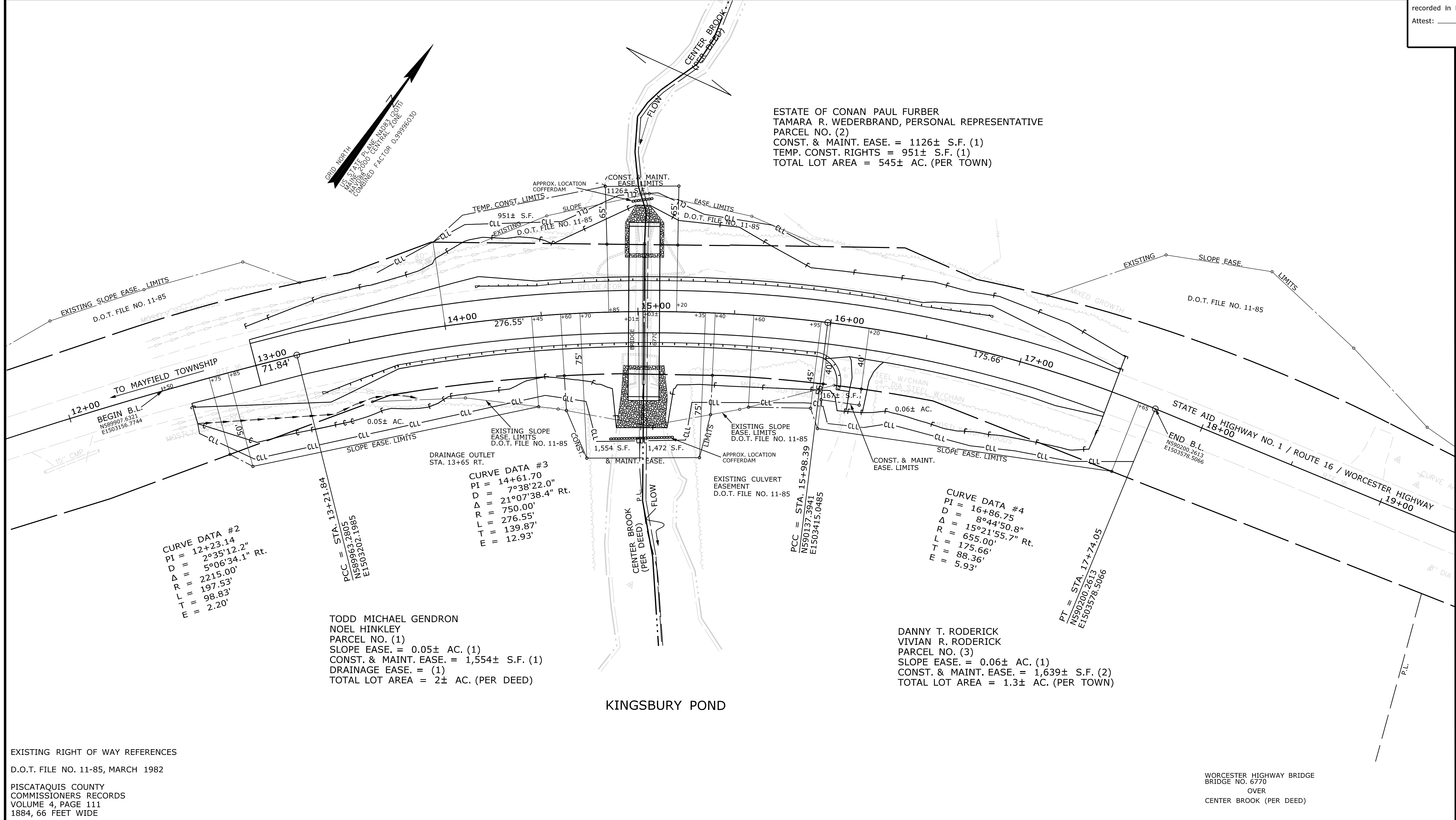

ITEM	TECH	CHECKED
EXISTING CONDITION PLAN	PNS	D.A.H.
FINAL RIGHT OF WAY AREAS	C.D.P.	P.N.S. K.D.M.

STATE OF MAINE DEPARTMENT OF TRANSPORTATION 16 STATE HOUSE STATION - AUGUSTA, ME 04333-0016 - 207-624-3460
KINGSBURY PLANTATION RIGHT OF WAY MAP

REVISIONS			PLAN FILED IN PLAN BOOK				PAGE COUNTY RECORD						
NO.	DATE	DESCRIPTION	BY	NO.	GRANTOR	INSTRUMENT	DATE	BOOK	PAGE	NO.	DATE	BOOK	PAGE
						COND.	04-13-26	3097	145				

DALE F. DOUGHTY  
COMMISSIONER  
WILLIAM A. PULVER  
CHIEF ENGINEER

DATE \_\_\_\_\_

STATE AID HIGHWAY NO. 1  
ROUTE 16 WORCESTER HIGHWAY  
KINGSBURY PLANTATION PISCATAQUIS COUNTY  
WORK IDENTIFICATION NO. (W.I.N.) 021794.00

FEBRUARY 2026  
SCALE 1" = 25'

RIGHT-OF-WAY MAP  
SHEET 1 OF 1

D.O.T. FILE NO. 11-158

SHEET NUMBER  
**16**  
OF 16