

STATE OF MAINE DEPARTMENT OF TRANSPORTATION



LIST OF DRAWINGS

Title Sheet	1
Estimated Quantities & General Notes	2
General Plan and Profile	3
Section and Profile	4

TRAFFIC DATA

Current (2012) AADT.....2190

HYDROLOGIC DATA

Drainage Area122.4 sq mi
 Design Discharge (Q50)7,193 cfs
 Check Discharge (Q100)8,181 cfs
 Headwater Elevation (Q50)462.2 ft
 Headwater Elevation (Q100)464.1 ft
 Discharge Velocity (Q100)12 fps

* Hydraulic data from POA Report 2009 - NGVD 1929

ISLAND FALLS AROOSTOOK COUNTY I-95 SB BRIDGE OVER WEST BRANCH MATTAWAMKEAG RIVER I-95 SOUTHBOUND WORK IDENTIFICATION NUMBER: 19322.00 BRIDGE NO. 6178

UTILITIES

None

MAINTENANCE OF TRAFFIC

Refer to Special Provisions, Section 107 - Time (Limitation of Operations)

PROJECT LOCATION:	I-95 SB Bridge (#6178) over the West Branch of the Mattawamkeag River on I-95 SB. Located 1.40 miles northerly of Route 159. Lat, 46° 1' 32.8" N, Long. 68° 17' 10.7" W
PROGRAM AREA:	Bridge
OUTLINE OF WORK:	Bridge Scour Countermeasures

WIN 19322.00

19322.00

ISLAND FALLS
I-95 SB BRIDGE

TITLE SHEET

SHEET NUMBER

1

OF 4

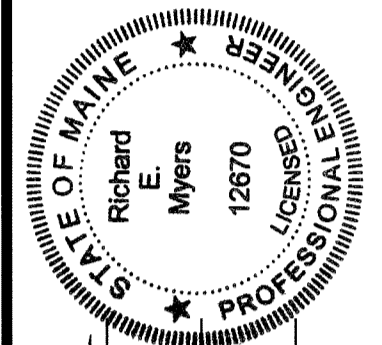

Richard E. Myers
 SIGNATURE
 12670
 P.E. NUMBER
 November 8, 2012
 DATE

PROGRAM	Bridge
PROJECT MANAGER	S. Bodge
DESIGNER	R. Myers
CONSULTANT	
PROJECT RESIDENT	
CONTRACTOR	
PROJECT COMPLETION DATE	

STATE OF MAINE
DEPARTMENT OF TRANSPORTATION
APPROVED
COMMISSIONER: *[Signature]*
CHIEF ENGINEER: *[Signature]*
DATE: 11/13/12

ESTIMATED QUANTITIES			
ITEM NO.	DESCRIPTION	QUANTITY	UNIT
203.2318	DISPOSAL OF SPECIAL WASTE	640	T
511.07	COFFERDAM: PIER No. 1	1	LS
511.07	COFFERDAM: PIER No. 2	1	LS
606.365	GUARDRAIL, REMOVE, MODIFY AND RESET - TYPE 3b to 3c	50	LF
606.366	GUARDRAIL - REMOVE AND RESET - TYPE 3c	50	LF
610.52	PIER SCM HEAVY RIPRAP	909	CY
610.521	PIER SCM PLAIN RIPRAP	228	CY
613.319	EROSION CONTROL BLANKET	200	SY
615.07	LOAM	89	CY
618.1401	SEEDING METHOD NUMBER 2 - PLAN QUANTITY	14	UN
619.1201	MULCH - PLAN QUANTITY	14	UN
619.1401	EROSION CONTROL MIX	177	CY
620.50	EROSION CONTROL FILTER LAYER	614	SY
629.05	HAND LABOR, STRAIGHT TIME	40	HR
631.121	HEAVY DUTY ALL PURPOSE EXCAVATOR (INCLUDING OPERATOR)	10	HR
631.132	SMALL BULLDOZER (INCLUDING OPERATOR)	10	HR
631.172	TRUCK - LARGE (INCLUDING OPERATOR)	10	HR
631.18	CHAIN SAW RENTAL (INCLUDING OPERATOR)	10	HR
639.19	FIELD OFFICE TYPE B	.5	EA
652.30	FLASHING ARROW	1	EA
652.33	DRUM	25	EA
652.34	CONE	25	EA
652.35	CONSTRUCTION SIGNS	310	SF
652.36	MAINTENANCE OF TRAFFIC CONTROL DEVICES	60	CD
656.75	TEMPORARY SOIL EROSION AND WATER POLLUTION CONTROL	1	LS
659.10	MOBILIZATION	1	LS

GENERAL CONSTRUCTION NOTES

- The Contractor shall plan and conduct his operations in such a manner that all work is contained within the existing right of way. There shall be no impacts outside of the existing right of way. The existing right of way map can be found at the MaineDOT web address mentioned below.
- Clearing limits will be established in the field by the Resident. Payment for clearing will be considered incidental to Contract items.
- Place loam 2 inches deep on all new or reconstructed side slopes or as directed by the Resident.
- Erosion Control Mix may be substituted in those areas normally receiving loam and seed as directed by the Resident. Placement shall be in accordance with Standard Specifications Section 619, Mulch. Payment will be made under Item No. 619.1401, Erosion Control Mix.
- Project information referred to below may be accessed at the following MaineDOT web address: <http://www.maine.gov/mdot/contractors>
- The existing bridge plans may be accessed at the MaineDOT web address. The plans are reproductions of the original drawings as prepared for the construction of the bridge. It is very unlikely that the plans will show any construction field changes or any alterations which may have been made to the bridge during its life span.
- Quantities included for pay items measured and paid for by Lump Sum are estimated quantities and are provided by MaineDOT for informational purposes only. Lump Sum pay items will be paid for at the Contract Bid amount, with no addition or reduction in payment to the Contractor if the actual final quantities are different from the MaineDOT provided estimated quantities, except as follows:
 - If a Lump Sum pay item is eliminated, the requirements of Standard Specifications Section 109.2, Elimination of Items, will take precedence.
 - If other Contract Documents specifically allow a change in payment for a Lump Sum pay item, those requirements will be followed.
 - If a design change results in changes to estimated quantities for Lump Sum pay items, price adjustments will be made in accordance with Standard Specifications Section 109.7, Equitable Adjustments to Compensation.
- The Contractor shall provide the Resident access to all portions of the work, including that which is only accessible by boat. The method, timing, and location of access shall be approved by the Resident. Payment for access will not be made separately, but will be considered incidental to the Contract.
- The pier riprap layout as shown on the General Plan is approximate. The dimensions of the pier riprap extent represent the minimum required. The final layout of the pier riprap shall adequately fill in the riverbed scour hole as directed by the Resident.
- The total compact mass of the pier scour countermeasure - heavy riprap shall consist of a maximum of 25% plain riprap. The quantity of plain riprap (item 610.521) included in this Contract shall be used as chinking stone to reduce the size and number of void spaces in the heavy riprap placed around the piers (item 610.52). The plain riprap shall be blended with the heavy riprap before or during placement in order to create a denser mass of riprap in the river.
- Stone removed during excavation may be reused as plain or heavy riprap if it satisfies the material requirements in the Specifications and is approved by the Resident.
- Contractor shall field verify stream bed elevations along the upstream bridge fascia, downstream bridge fascia and along the centerline of the bridge. Streambed elevations shall be taken every 5 feet along all three lines and provided to the Resident. Resident will determine final streambed and/or top of riprap elevation(s) based on this information. This work shall not be paid for directly and will be considered incidental to related Contract items.

STATE OF MAINE DEPARTMENT OF TRANSPORTATION 19322.00 WIN BRIDGE NO. 6178 19322.00 BRIDGE PLANS
1-95 SB BRIDGE WEST BRANCH MATTAWAMKEAG RIVER ISLAND FALLS AROOSTOOK COUNTY ESTIMATED QUANTITIES & GENERAL NOTES
SHEET NUMBER 2 OF 4

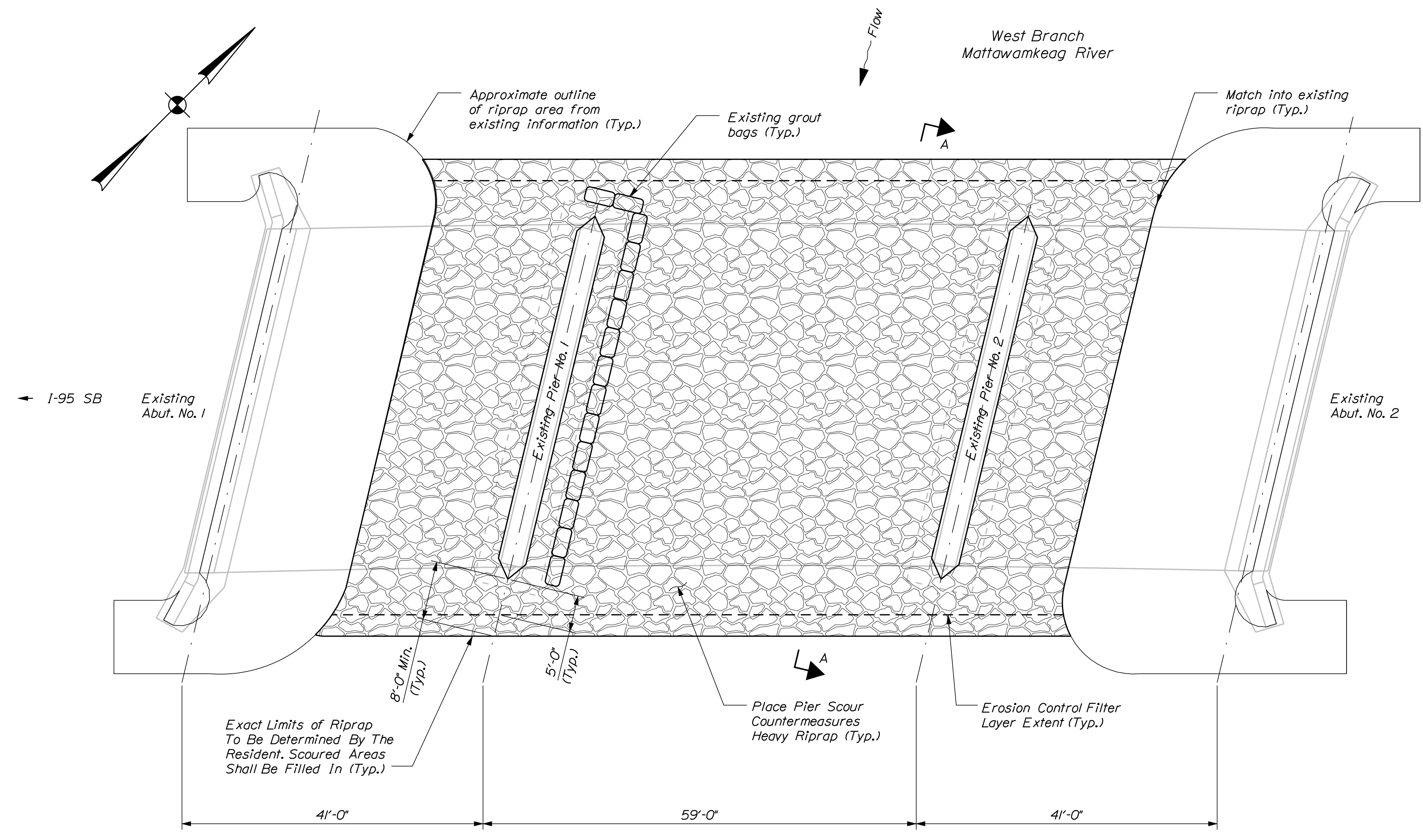

PLAN

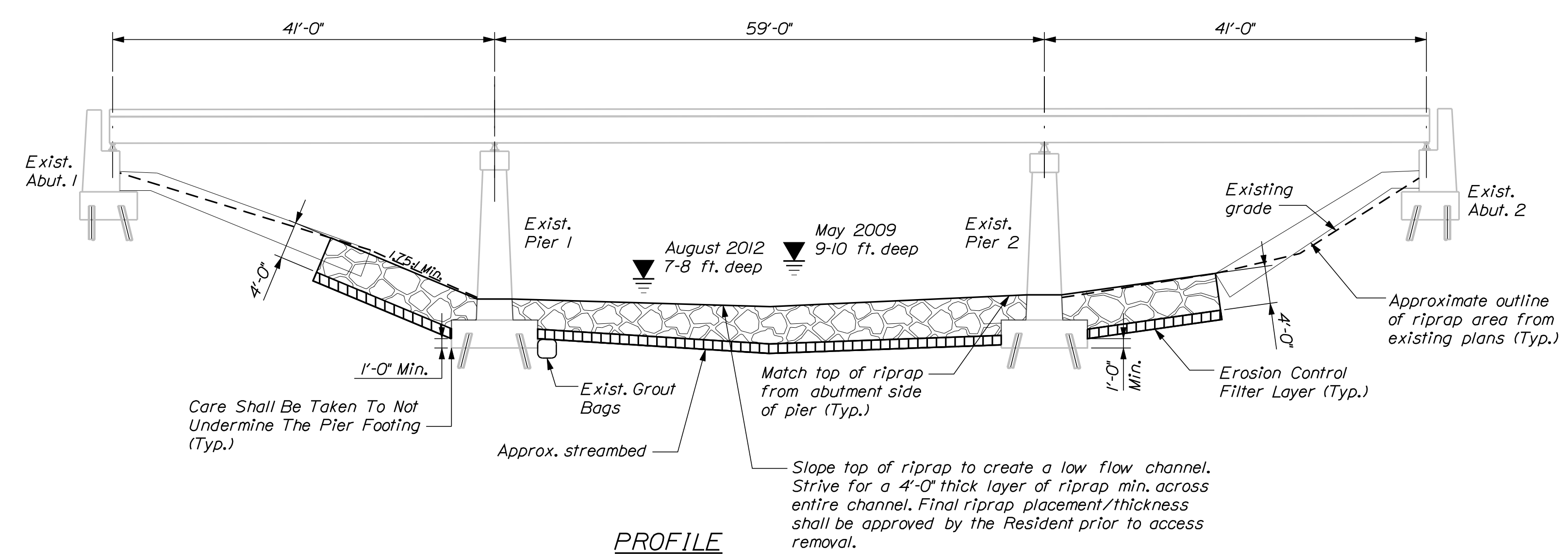

PROFILE

STATE OF MAINE		DEPARTMENT OF TRANSPORTATION		19322.00	
WEST BRANCH MATTAWAMKEAG RIVER		AROOSTOOK COUNTY		BRIDGE NO. 8178	
I-95 SB BRIDGE		GENERAL PLAN & PROFILE		PIN 19322.00	
SHEET NUMBER		3		BRIDGE PLANS	
OF 4					

PROJ. MANAGER	S. Badge	BY	DATE
DESIGN DETAILED	R. Myers	D. Sullivan	Oct. 2012
CHECKED-REVIEWED	M. Wight	M. Poulin	Oct. 2012
DESIGN DETAILED			
REVISIONS 1			
REVISIONS 2			
REVISIONS 3			
REVISIONS 4			
FIELD CHANGES			

SIGNATURE	P.E. NUMBER	DATE

Approximate top of riprap.
Place scour countermeasures to fill in scour hole. Strive for a minimum of 4'-0" of riprap. Match into existing streambed at the extents of the riprap as shown.

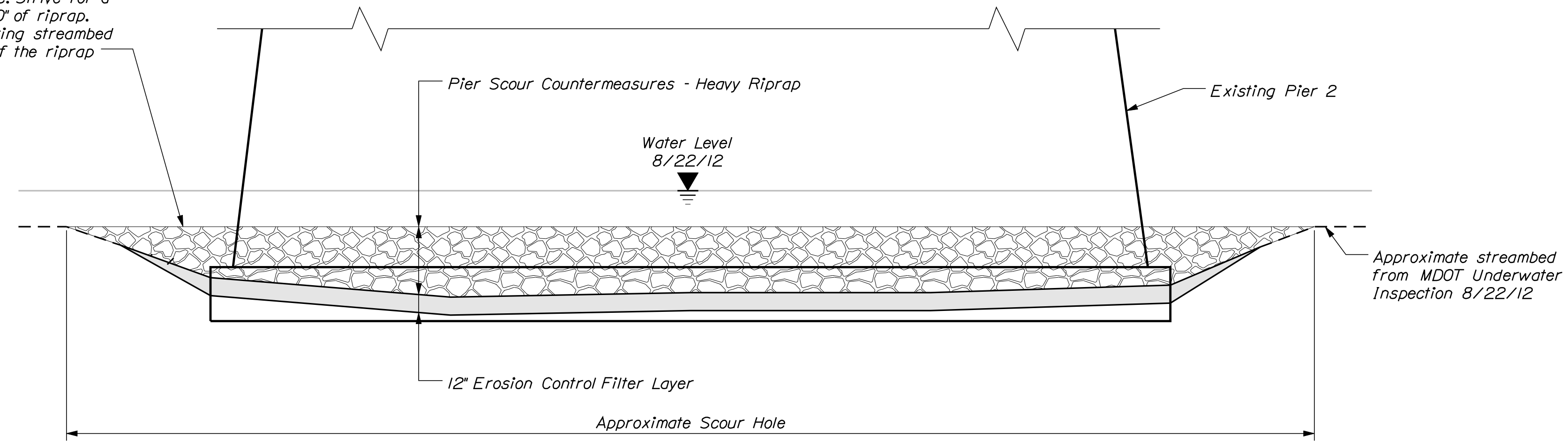

SECTION A-A

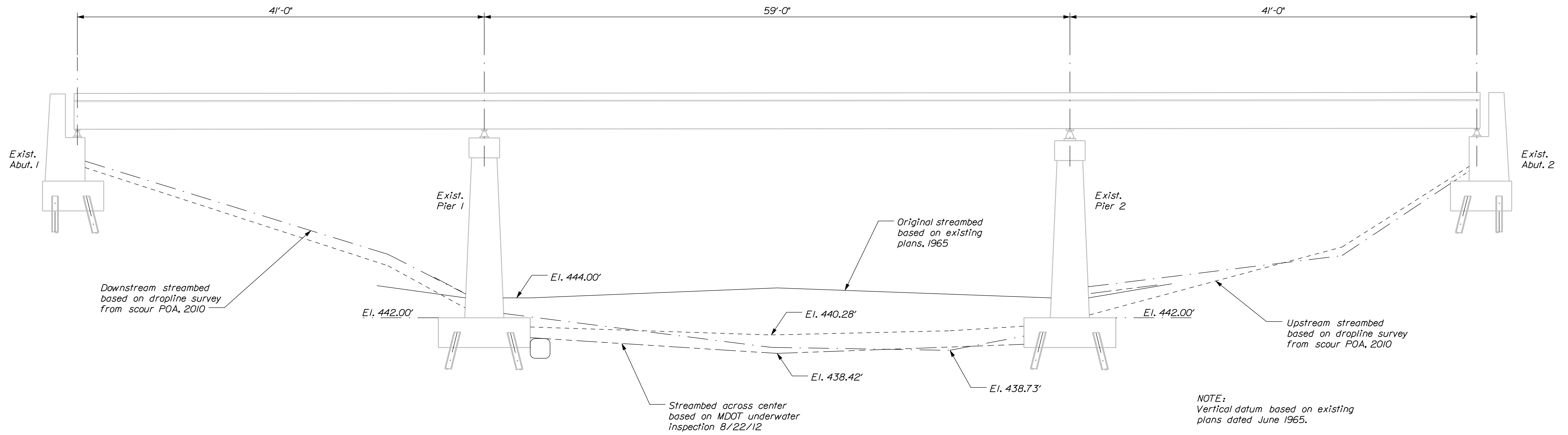

STREAMBED INFORMATION

NOTE:
Vertical datum based on existing plans dated June 1965.

PROJ. MANAGER	BY	DATE	SIGNATURE	P.E. NUMBER	DATE
S. Bodge	D. Sullivan	Oct. 2012			
R. Myers	M. Poulin	Oct. 2012			
M. Wight					
DESIGN DETAILED					
CHECKED-REVIEWED					
DESIGN DETAILED					
REVISIONS 1					
REVISIONS 2					
REVISIONS 3					
REVISIONS 4					
FIELD CHANGES					

STATE OF MAINE DEPARTMENT OF TRANSPORTATION



TRAFFIC DATA

Current (2012) AADT 2,030

HYDROLOGIC DATA

Drainage Area 122.4 sq mi
 Design Discharge (Q50) 7,193 cfs
 Check Discharge (Q100) 8,181 cfs
 Headwater Elevation (Q50) 461.7 ft
 Headwater Elevation (Q100) 463.6 ft
 Discharge Velocity (Q100) 12 fps
 *Hydraulic data from POA Report 2009 - NGVD 1929

LIST OF DRAWINGS

Title Sheet 1
 Estimated Quantities & General Notes 2
 General Plan and Profile 3
 Section and Profile 4

ISLAND FALLS AROOSTOOK COUNTY I-95 NB BRIDGE OVER WEST BRANCH MATTAWAMKEAG RIVER I-95 NORTHBOUND WORK IDENTIFICATION NUMBER: 19323.00 BRIDGE NO. 1401

UTILITIES

None

MAINTENANCE OF TRAFFIC

Refer to Special Provisions, Section 107 - Time (Limitation of Operations)

<u>PROJECT LOCATION:</u>	I-95 NB Bridge (#1401) over the West Branch of the Mattawamkeag River on I-95 NB. Located 1.4 miles northerly of Route 159. Lat, 46° 1' 30.5" N Long. 68° 17' 8.2" W
<u>PROGRAM AREA:</u>	Bridge
<u>OUTLINE OF WORK:</u>	Bridge Scour Countermeasures

WIN 19323.00

19323.00

STATE OF MAINE DEPARTMENT OF TRANSPORTATION	APPROVED	DATE
COMMISSIONER: <i>[Signature]</i>	<i>[Signature]</i>	11/13/12
CHIEF ENGINEER: <i>[Signature]</i>		11/15/12

STATE OF MAINE
PROFESSIONAL ENGINEER
Richard E. Myers
12870
LICENSE NUMBER
12 & 70
DATE
November 8, 2012

[Signature]
SIGNATURE

PROJECT INFORMATION	
PROGRAM	Bridge
PROJECT MANAGER	S. Bodge
DESIGNER	R. Myers
CONSULTANT	
PROJECT RESIDENT	
CONTRACTOR	
PROJECT COMPLETION DATE	

ISLAND FALLS
I-95 NB BRIDGE
TITLE SHEET

SHEET NUMBER
1
OF 4

ESTIMATED QUANTITIES			
ITEM NO.	DESCRIPTION	QUANTITY	UNIT
203.2318	DISPOSAL OF SPECIAL WASTE	770	T
511.07	COFFERDAM: PIER No. 1	1	LS
511.07	COFFERDAM: PIER No. 2	1	LS
606.365	GUARDRAIL, REMOVE, MODIFY AND RESET - TYPE 3b to 3c	50	LF
606.366	GUARDRAIL - REMOVE AND RESET - TYPE 3c	50	LF
610.52	PIER SCM HEAVY RIPRAP	1088	CY
610.521	PIER SCM PLAIN RIPRAP	272	CY
613.319	EROSION CONTROL BLANKET	200	SY
615.07	LOAM	89	CY
618.1401	SEEDING METHOD NUMBER 2 - PLAN QUANTITY	14	UN
619.1201	MULCH - PLAN QUANTITY	14	UN
619.1401	EROSION CONTROL MIX	177	CY
620.50	EROSION CONTROL FILTER LAYER	720	SY
629.05	HAND LABOR, STRAIGHT TIME	40	HR
631.121	HEAVY DUTY ALL PURPOSE EXCAVATOR (INCLUDING OPERATOR)	10	HR
631.132	SMALL BULLDOZER (INCLUDING OPERATOR)	10	HR
631.172	TRUCK - LARGE (INCLUDING OPERATOR)	10	HR
631.18	CHAIN SAW RENTAL (INCLUDING OPERATOR)	10	HR
639.19	FIELD OFFICE TYPE B	.5	EA
652.30	FLASHING ARROW	1	EA
652.33	DRUM	25	EA
652.34	CONE	25	EA
652.35	CONSTRUCTION SIGNS	310	SF
652.36	MAINTENANCE OF TRAFFIC CONTROL DEVICES	60	CD
656.75	TEMPORARY SOIL EROSION AND WATER POLLUTION CONTROL	1	LS
659.10	MOBILIZATION	1	LS

GENERAL CONSTRUCTION NOTES

- The Contractor shall plan and conduct his operations in such a manner that all work is contained within the existing right of way. There shall be no impacts outside of the existing right of way. The existing right of way map can be found at the MaineDOT web address mentioned below.
- Clearing limits will be established in the field by the Resident. Payment for clearing will be considered incidental to Contract items.
- Place loam 2 inches deep on all new or reconstructed side slopes or as directed by the Resident.
- Erosion Control Mix may be substituted in those areas normally receiving loam and seed as directed by the Resident. Placement shall be in accordance with Standard Specifications Section 619, Mulch. Payment will be made under Item No. 619.1401, Erosion Control Mix.
- Project information referred to below may be accessed at the following MaineDOT web address: <http://www.maine.gov/mdot/contractors>
- The existing bridge plans may be accessed at the MaineDOT web address. The plans are reproductions of the original drawings as prepared for the construction of the bridge. It is very unlikely that the plans will show any construction field changes or any alterations which may have been made to the bridge during its life span.
- Quantities included for pay items measured and paid for by Lump Sum are estimated quantities and are provided by MaineDOT for informational purposes only. Lump Sum pay items will be paid for at the Contract Bid amount, with no addition or reduction in payment to the Contractor if the actual final quantities are different from the MaineDOT provided estimated quantities, except as follows:
 - If a Lump Sum pay item is eliminated, the requirements of Standard Specifications Section 109.2, Elimination of Items, will take precedence.
 - If other Contract Documents specifically allow a change in payment for a Lump Sum pay item, those requirements will be followed.
 - If a design change results in changes to estimated quantities for Lump Sum pay items, price adjustments will be made in accordance with Standard Specifications Section 109.7, Equitable Adjustments to Compensation.
- The Contractor shall provide the Resident access to all portions of the work, including that which is only accessible by boat. The method, timing, and location of access shall be approved by the Resident. Payment for access will not be made separately, but will be considered incidental to the Contract.
- The pier riprap layout as shown on the General Plan is approximate. The dimensions of the pier riprap extent represent the minimum required. The final layout of the pier riprap shall adequately fill in the riverbed scour hole as directed by the Resident.
- The total compact mass of the pier scour countermeasure - heavy riprap shall consist of a maximum of 25% plain riprap. The quantity of plain riprap (item 610.521) included in this Contract shall be used as chinking stone to reduce the size and number of void spaces in the heavy riprap placed around the piers (item 610.52). The plain riprap shall be blended with the heavy riprap before or during placement in order to create a denser mass of riprap in the river.
- Stone removed during excavation may be reused as plain or heavy riprap if it satisfies the material requirements in the Specifications and is approved by the Resident.
- Contractor shall field verify stream bed elevations along the upstream bridge fascia, downstream bridge fascia and along the centerline of the bridge. Streambed elevations shall be taken every 5 feet along all three lines and provided to the Resident. Resident will determine final streambed and/or top of riprap elevation(s) based on this information. This work shall not be paid for directly and will be considered incidental to related Contract items.

STATE OF MAINE		DEPARTMENT OF TRANSPORTATION		19323.00		WIN		19323.00		BRIDGE NO. 1401		BRIDGE PLANS	
I-95 NB BRIDGE		WEST BRANCH MATTAWAMKEAG RIVER		ISLAND FALLS AROOSTOOK COUNTY		ESTIMATED QUANTITIES		GENERAL NOTES		SHEET NUMBER		2	
OF 4		PROJ. MANAGER		S. BODGE		BY		DATE		SIGNATURE		P.E. NUMBER	
DESIGN-DETAILED		R. MYERS		MRP		D. SULLIVAN		Oct. 2012		D. SULLIVAN		Oct. 2012	
CHECKED-REVIEWED		M. WIGHT		D. SULLIVAN		D. SULLIVAN		Oct. 2012		D. SULLIVAN		Oct. 2012	
DESIGN-DETAILED		DESIGN-DETAILED		DESIGN-DETAILED		DESIGN-DETAILED		DESIGN-DETAILED		DESIGN-DETAILED		DESIGN-DETAILED	
REVISIONS 1		REVISIONS 2		REVISIONS 3		REVISIONS 4		FIELD CHANGES		REVISIONS 1		REVISIONS 2	
REVISIONS 3		REVISIONS 4		FIELD CHANGES		REVISIONS 1		REVISIONS 2		REVISIONS 3		REVISIONS 4	

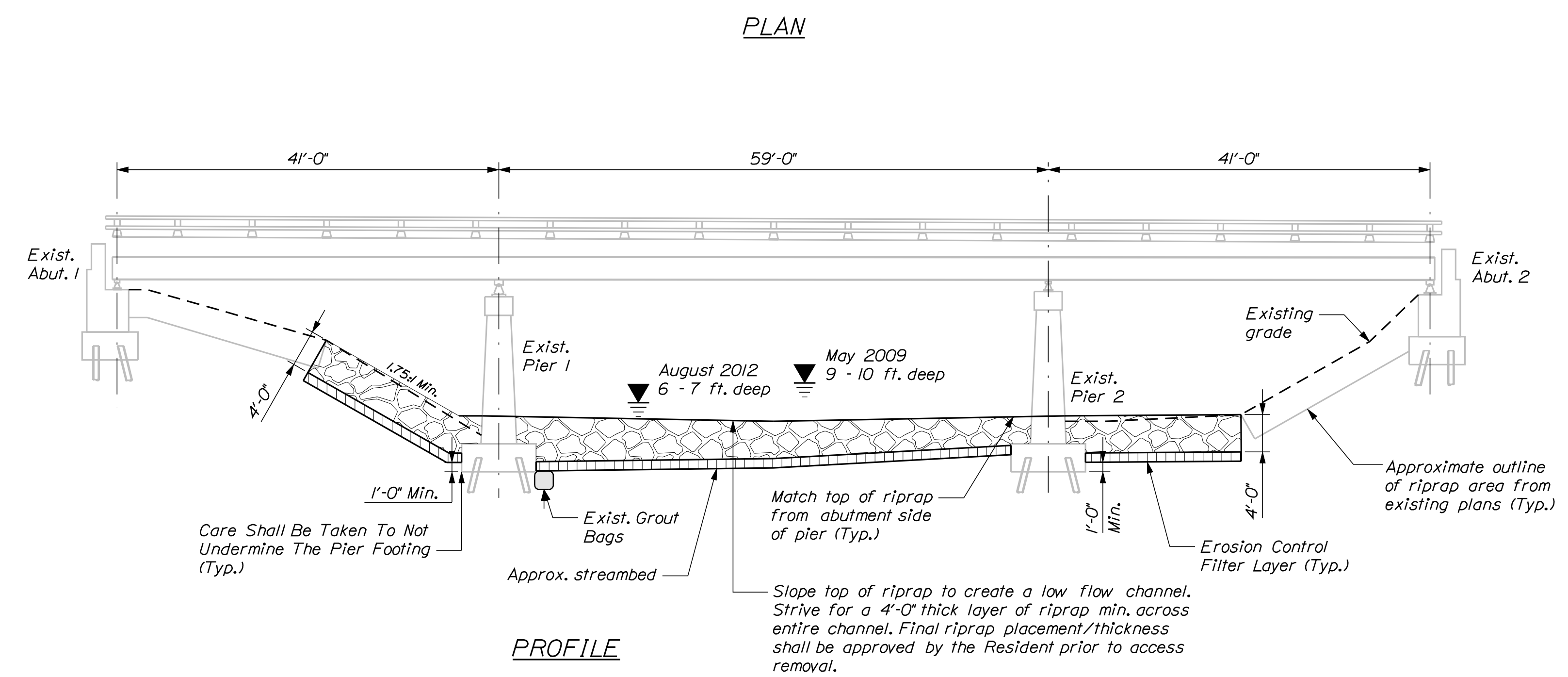
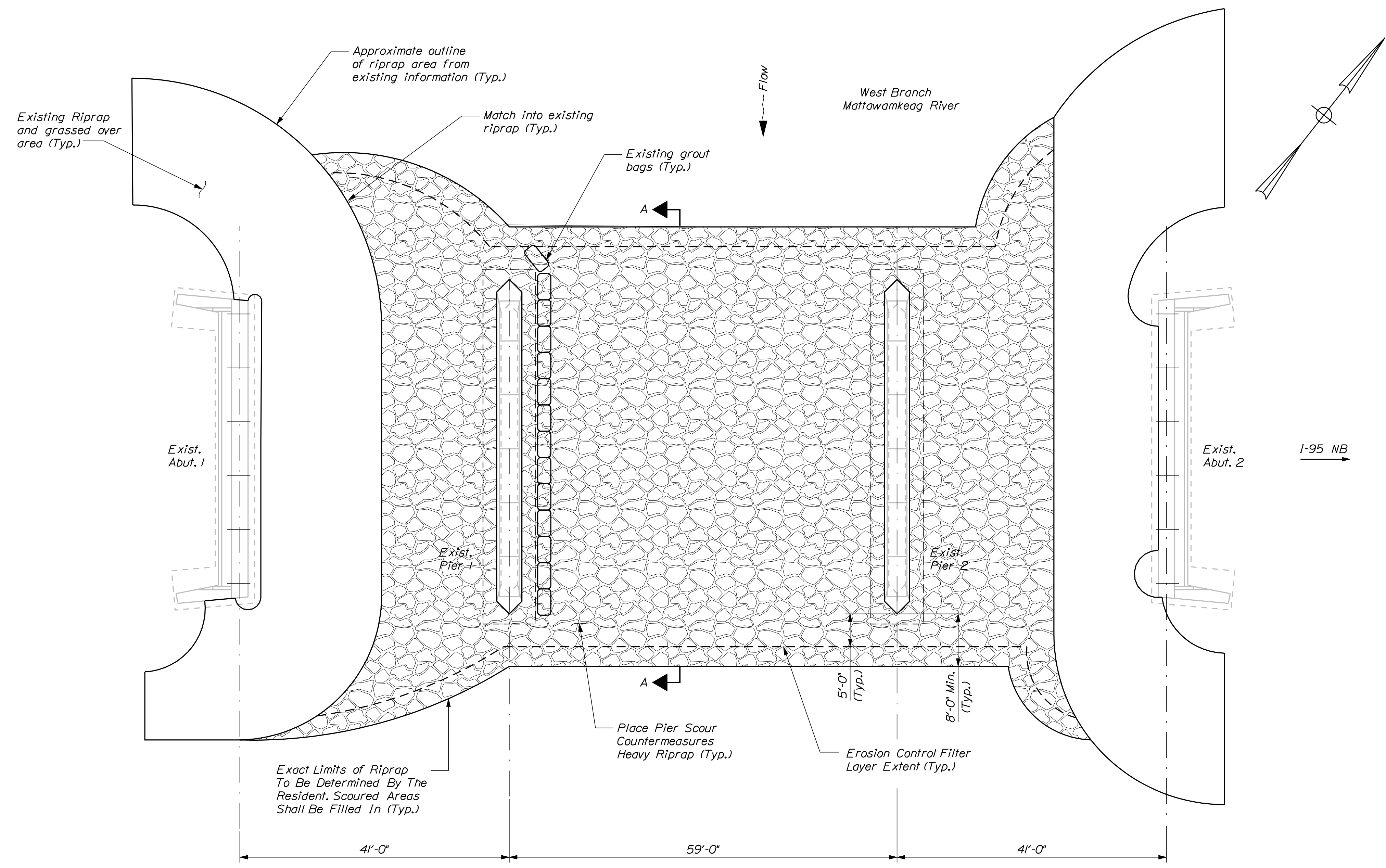

STATE OF MAINE		DEPARTMENT OF TRANSPORTATION		BRIDGE NO. 1401		BRIDGE PLANS	
19323.00		WIN		19323.00			
SIGNATURE		P.E. NUMBER		DATE			
S. Bodge		M.P.		D. Sullivan			
DESIGN-DETAILED		CHECKED-REVIEWED		DESIGNS-DETAILED		REVISIONS	
R. Myers		M. Wight				1	
						2	
						3	
						4	
						FIELD CHANGES	
I-95 NB BRIDGE				WEST BRANCH MATTAWAMKEAG RIVER			
ISLAND FALLS				AROOSTOOK COUNTY			
GENERAL PLAN & PROFILE				SHEET NUMBER			
3				OF 4			

