

STATE OF MAINE DEPARTMENT OF TRANSPORTATION

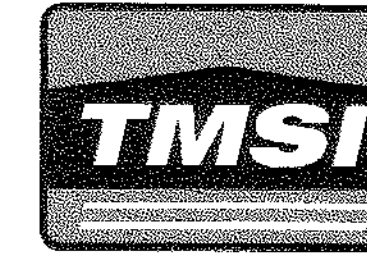

MONMOUTH KENNEBEC

INTERSECTION OF ROUTE 11/202 AND RTE 132
AC-STP-1901(300)X
PROJECT LENGTH : 0.058 MILES

PLAN LEGEND	
Town, County, State	Centerline-Existing
Property Lines	Centerline-Proposed
R/W Lines-Existing	Travelway-Existing
R/W Lines-Proposed	Travelway-Proposed
Culvert-Existing	Railroad
Culvert Proposed	Catch Basins
Carbing	Manholes
Type 1	Proposed Underdrain
Type 3	Proposed Ditch
Type 5	Existing Ditch
Outline of Bodies of Water	Utility Poles
Ledge	Fire Hydrants
Buildings	Existing Water Line
Trees	Existing San. Sewer
Tree Line	Existing San. Sewer Manhole
Clearing Limit Line	Guardrail-Existing
	Guardrail-Proposed
	Guardrail-Cable, Other

INDEX OF SHEETS	
Description	Sheet No.
Title Sheet	1
Plan	2

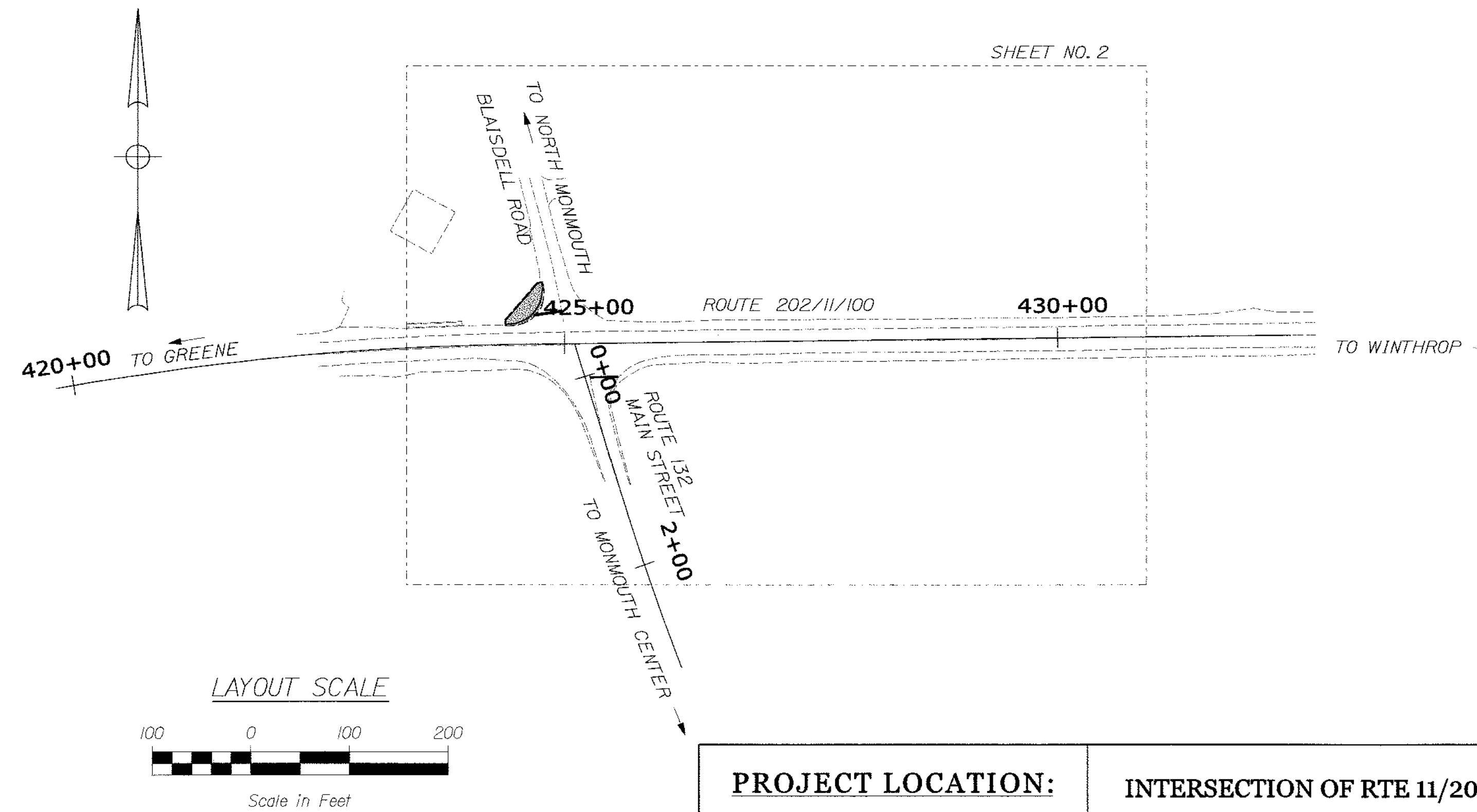

PROJECT LOCATION:	INTERSECTION OF RTE 11/202 AND RTE 132
PROGRAM AREA:	TRAFFIC
SCOPE OF WORK:	INTERSECTION IMPROVEMENTS INCLUDING FLASHING BEACON

STATE OF MAINE DEPARTMENT OF TRANSPORTATION	DATE 5/31/12
APPROVED	5/31/12
COMMISSIONER: <i>[Signature]</i>	CHIEF ENGINEER: <i>[Signature]</i>

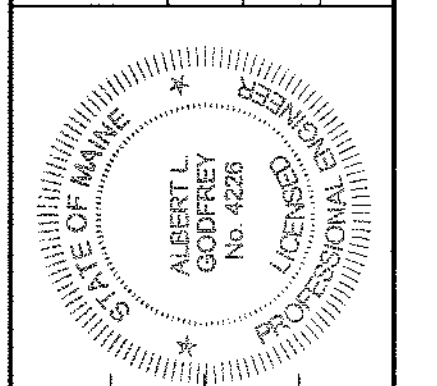

<i>[Signature]</i>	SIGNATURE
4226	P.E. NUMBER
MAY 30, 2012	DATE

PROGRAM	TRAFFIC
PROJECT MANAGER	BRIAN KEELER
DESIGNER	A. GODFREY
CONSULTANT	TERRA MAGNA SERVICES, INC.
PROJECT RESIDENT	
CONTRACTOR	
PROJECT COMPLETION DATE	

MONMOUTH RTE 202	TITLE SHEET
---------------------	-------------

SHEET NUMBER	1
	OF 2

WIN 19013.00 AC-STP-1901(300)X

Date: 5/30/2012

Username: jason

Division: HIGHWAY

Filename: ... \HIGHWAY\MTA\002_HDP\pln.dgn

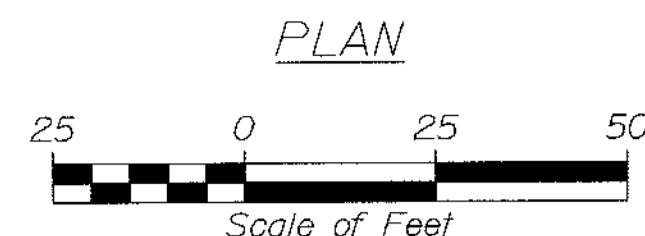

PLAN

GENERAL & CONSTRUCTION NOTES

1. THE UTILITIES LOCATED WITHIN THE PROJECT LIMITS ARE AS FOLLOWS:
CENTRAL MAINE POWER COMPANY
COMMUNITY SERVICE TELEPHONE D/B/A FAIRPOINT COMMUNICATIONS
TIME WARNER CABLE
MONMOUTH WATER ASSOCIATION
MONMOUTH SANITARY DISTRICT

NO UTILITY INVOLVEMENT IS ANTICIPATED.
2. ANY DAMAGE TO SLOPES CAUSED BY THE CONTRACTOR'S EQUIPMENT, PERSONNEL, OR OPERATIONS SHALL BE REPAIRED TO THE SATISFACTION OF THE RESIDENT, WITH NO ADDITIONAL PAYMENT.
3. NO SEPARATE PAYMENT FOR SUPERINTENDENT OR FOREMAN WILL BE MADE FOR THE SUPERVISION OF EQUIPMENT BEING PAID FOR UNDER THE EQUIPMENT RENTAL ITEMS.
4. SOIL REMOVED FOR INSTALLATION OF WOOD POLES SHALL BE DISPOSED OF AT LOCATIONS APPROVED FOR DISPOSAL OF SUCH MATERIAL. DISTURBED AREAS SHALL BE SEEDED WITH SEEDING METHOD NO. 2 AND MULCHED. PAYMENT WILL BE CONSIDERED INCIDENTAL TO THE CONTRACT.
5. ALL WASTE MATERIAL NOT USED ON THE PROJECT SHALL BE DISPOSED OF OFF THE PROJECT.
6. ALL WORK SHALL BE DONE IN ACCORDANCE WITH THE MAINE DEPARTMENT OF TRANSPORTATION'S BEST MANAGEMENT PRACTICES FOR EROSION CONTROL & SEDIMENT CONTROL, FEBRUARY, 2008. PAYMENT FOR TEMPORARY EROSION CONTROL MEASURES WILL BE INCIDENTAL TO THE CONTRACT.
7. ACRYLIC LATEX COLOR FINISH GREEN (ITEM 658.20) SHALL BE PLACED ON THE PAVED ISLAND.
8. WHITE PAVEMENT/CURB MARKING (ITEM 627.75) SHALL BE APPLIED TO ISLAND TAPERED ENDS.

9. BEACON HEADS EACH SHALL BE 12" DIAMETER, EXPANDED VIEW LED FLASHING VEHICULAR HEADS. TWO YELLOW HEADS SHALL BE INSTALLED FOR EACH APPROACH ON ROUTE 202/11/100. FOUR RED HEADS (TWO SETS OF TWO-SECTION VERTICAL PAIRS) SHALL BE INSTALLED FOR APPROACHES ON BLAISDELL ROAD AND ROUTE 132. HEADS ON EACH APPROACH SHALL FLASH ALTERNATELY. HEADS SHALL BE POLYCARBONATE WITH A DOUBLE SPAN TO MINIMIZE SAG AND STABILIZE HEADS.
10. PAYMENT UNDER ITEM 643.60 SHALL INCLUDE, BUT IS NOT LIMITED TO, BEACON HEADS, LED LAMPS, CLASS 4 WOOD BEACON POLE, SPANWIRE, GUY ANCHORAGE, GROUND RODS, METER, CONTROLLER AND CABINET, WIRING, POWER CONNECTION, AND ALL INCIDENTAL MATERIALS AND WORK NECESSARY FOR A FULLY FUNCTIONING BEACON SYSTEM, EXCEPT THOSE ITEMS INCLUDED IN OTHER BID ITEMS OF THE CONTRACT.
11. THE CONTRACTOR SHALL INSTALL A SELF-CONTAINED METER SOCKET BYPASS (SINGLE PHASE 100 OR 150 AMP) WITH A SINGLE HANDLE LEVER-OPERATED BYPASS FOR POWER SHUTOFF TO THE METER WITHOUT INTERRUPTING BEACON DISPLAYS.
12. ALL FIELD WIRING SHALL BE NEATLY BUNDLED AND CLEARLY IDENTIFIED WITH PERMANENT, LEGIBLE, WEATHERPROOF TAGS THAT ARE SECURELY ATTACHED TO EACH CABLE.
13. THE CONTRACTOR SHALL NOTIFY THE APPROPRIATE UTILITIES AT LEAST 48 HOURS IN ADVANCE OF ANY OPERATIONS WHERE POTENTIAL CONFLICT WITH OVERHEAD WIRES MAY OCCUR.
14. THE MAINTENANCE OF BEACONS SHALL REMAIN THE RESPONSIBILITY OF THE CONTRACTOR UNTIL FINAL ACCEPTANCE BY MAINEDOT.
15. A MAINE DEPARTMENT OF ENVIRONMENTAL PROTECTION (MDEP) DATA BASE REVIEW SUGGESTED SOME PETROLEUM CONTAMINATION ISSUES AT THE PROJECT, IN PARTICULAR IN THE VICINITY OF A.L.T. RV SERVICE (FORMERLY REILLY'S RETAIL GASOLINE STATION) LOCATED AT THE NORTHWEST CORNER OF THE INTERSECTION. THE SCOPE OF WORK FOR THIS PROJECT SUGGESTS PETROLEUM OR HAZARDOUS WASTE SHOULD NOT BE ENCOUNTERED. HOWEVER, IN LIGHT OF THE COMMERCIAL NATURE OF THE AREA AND REPORTED SPILLS, THE CONTRACTOR SHALL EMPLOY APPROPRIATE HEALTH AND SAFETY MEASURES TO PROTECT ITS WORKERS AGAINST HAZARDS ASSOCIATED WITH WORKING NEAR PETROLEUM-IMPACTED SOILS. FURTHERMORE, THE CONTRACTOR SHALL REMAIN ALERT FOR ANY ADDITIONAL EVIDENCE OF CONTAMINATION. IF THE CONTRACTOR ENCOUNTERS EVIDENCE OF SOIL OR GROUNDWATER CONTAMINATION, THE CONTRACTOR SHALL SECURE THE EXCAVATION, STOP WORK IN THE CONTAMINATED AREA, AND IMMEDIATELY NOTIFY THE RESIDENT. THE RESIDENT SHALL CONTACT THE HYDROGEOLOGIST IN MDT'S ENVIRONMENTAL OFFICE AT 207-624-3100 AND THE MAINE DEPARTMENT OF ENVIRONMENTAL PROTECTION AT 800-482-0777. WORK MAY ONLY CONTINUE WITH AUTHORIZATION FROM THE RESIDENT.

BLAISDELL RD. SOUTHBOUND
565'+NORTH OF RTE. 202
REMOVE EXISTING W3-1
(STOP AHEAD) SIGN. INSTALL 48"X48"
W3-1 SYMBOL-STYLE SIGN.

A.L.T.
RV SERVICE

CONSTRUCT PAVED
ISLAND WITH
CURB TYPE 3.
SEE DETAIL.

STA. 424+69.0, 38.0' LT.
INSTALL 48"X48"
R1-1 (STOP) SIGN.
REMOVE EXISTING SIGN.

X=1074668.8030
Y=523267.5460
Z=311.527

POWER SOURCE
CMP 52/62
INSTALL GUY ON EXISTING POLE
RT. 202 BLAISDELL RD
PT STA. 0+35.00 =
POT STA. 425+10.00

TO GREENE
424+00

ROUTE 202 EASTBOUND
1225'+ WEST OF ROUTE 132
REMOVE EXISTING W2-1 SIGN.
INSTALL 48"X48" W2-1 SIGN.

PT = STA. 424+57.54

425+00

426+00

427+00

428+00

429+00

430+00

CURVE DATA
PI = 416+46.26
D = 2° - 00' - 00.0"
Δ = 33° - 25' - 59.2" Rt.
R = 2864.79'
L = 1674.66'
T = 860.38'
E = 126.07'

CURVE DATA
PI = 3+68.58
D = 1° - 53' - 59.7"
Δ = 9° - 29' - 59.2" Lt.
R = 3015.71'
L = 500.01'
T = 250.58'
E = 10.39'

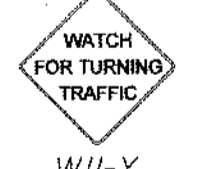

STA. 430+50
INSTALL 35' CLASS 4 WOOD POLES AT 40' LT.
AND 40' RT. WITH SPANWIRE AND GUYS.
INSTALL 48"X48" W2-1 AND 48"X48" W11-X
TYPE 1 SIGNS ON SPANWIRE FOR WESTBOUND
TRAFFIC. INSTALL BOTTOM TETHER FOR SIGNS.
MINIMUM VERTICAL CLEARANCE BELOW SIGN = 17'.
POLES AND GUY ANCHORAGES WILL BE PAID
UNDER ITEM 643.97 (2 TOTAL).
SPANWIRE AND BOTTOM TETHER WILL BE
INCIDENTAL TO ITEM 643.97.
SIGNS WILL BE PAID UNDER ITEM 645.271.

LEGEND

- VEHICULAR HEAD
- ⊠ FLASHER CONTROLLER AND CABINET
- NEW WOOD POLE
- EXISTING WOOD POLE
- GUY
- R/W
- OVERHEAD SIGN ON SPANWIRE
- ⊕ GROUND MOUNTED SIGN

TYPICAL SECTION PAVED ISLAND (NOT TO SCALE)

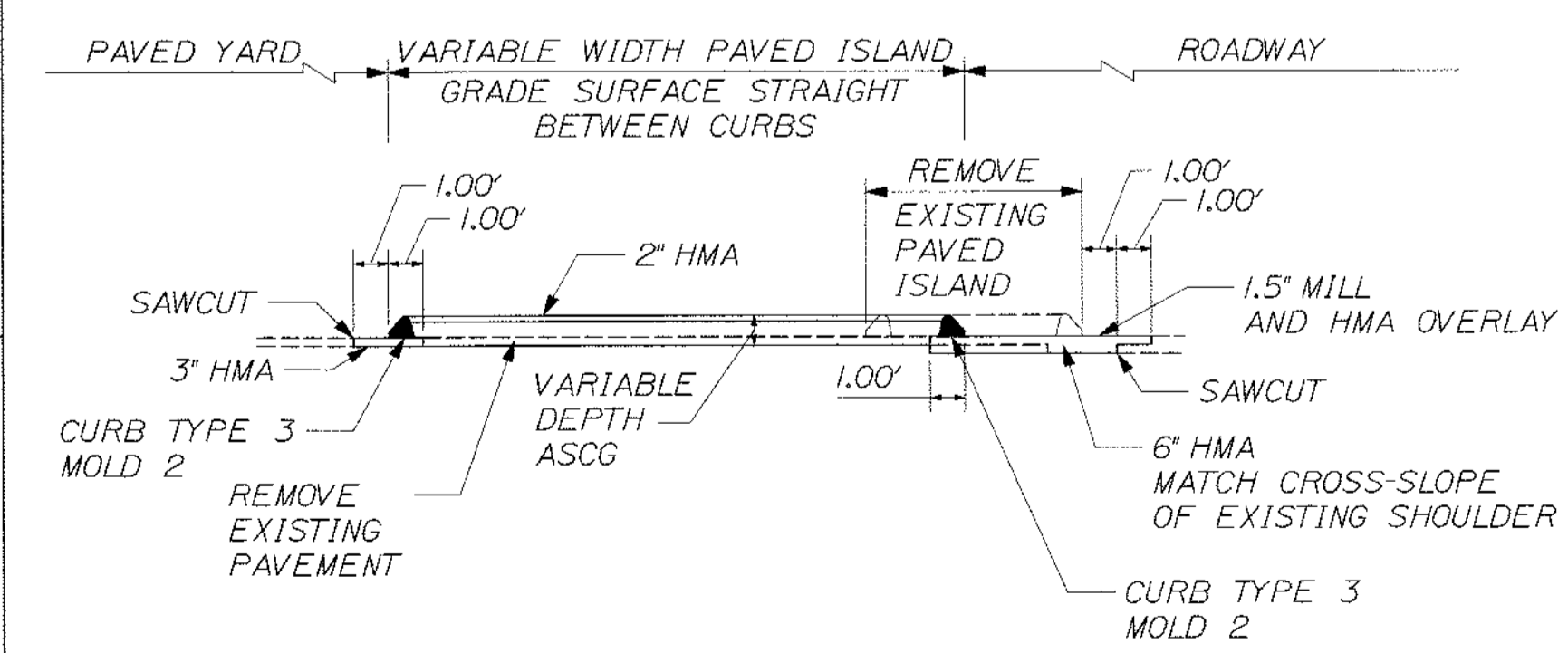

NOTES

1. PAVEMENT DEPTHS ARE INTENDED TO BE NOMINAL.
2. HMA = HOT MIX ASPHALT ASCG = AGGREGATE SUBBASE COURSE - GRAVEL
3. SAWCUTTING PAVEMENT WILL BE INCIDENTAL TO ITEM 203.2001.
4. MILLING 1.00' WIDTH AT ROADWAY PAVEMENT JOINT WILL BE PAID UNDER ITEM 202.202.
5. REMOVAL OF OTHER EXISTING PAVEMENT WILL BE PAID UNDER ITEM 203.2001.
6. MAXIMUM AGGREGATE SIZE FOR AGGREGATE SUBBASE COURSE GRAVEL SHALL BE 2".

STA. 424+83, 55' RT.
INSTALL 35' CLASS 4 WOOD POLE, GUY, METER,
FLASHER CONTROLLER AND CABINET. INSTALL SPANWIRE
AND 12 ALTERNATELY FLASHING EXPANDED VIEW LED
VEHICULAR HEADS. SEE TYPICAL DETAILS. BEACONS SHALL
FLASH YELLOW ON ROUTE 202/11/100 AND RED ON BLAISDELL ROAD
AND ROUTE 132. HEADS SHALL BE POLYCARBONATE WITH A DOUBLE
SPAN TO MINIMIZE SAG. ATTACH NORTHEAST END OF SPANWIRE TO
EXISTING CMP POLE 52/62. ATTACH SPANWIRE AT
EACH POLE AT 25.25' ABOVE GROUND. INSTALL ADDITIONAL GUY
ON CMP 52/62. PAYMENT WILL BE INCIDENTAL TO ITEM 643.60

ROUTE 132 NORTHBOUND
690'+ SOUTH OF ROUTE 202
REMOVE EXISTING W3-1 (STOP AHEAD)
SIGN. INSTALL 48"X48" W3-1
SYMBOL-STYLE SIGN. REPAINT
'STOP AHEAD' PAVEMENT MARKINGS.-

STATE OF MAINE DEPARTMENT OF TRANSPORTATION		AC-STP-1901(300)X		WIN 19013.00		HIGHWAY PLANS	
		SIGNATURE 		P.E. NUMBER 4226		DATE MAY 30, 2012	
DATE	5-12	5-12					
BY	ALC	ALC					
BAKES							
DESIGN-DETAILED	ALC						
CHECKED-REVIEWED	ALC						
DESIGN-DETAILED							
REVISIONS 1							
REVISIONS 2							
REVISIONS 3							
REVISIONS 4							
FIELD CHANGES							
MONMOUTH RTE 202		PLANS		SHEET NUMBER		2	
						OF 2	