

STATE OF MAINE DEPARTMENT OF TRANSPORTATION



HAYNESVILLE AROOSTOOK COUNTY BABCOCK BRIDGE

ROUTE 2A

STATE PROJECT NO. 18823.00

PROJECT LENGTH: 0.02 MILES

BRIDGE NO. 6566

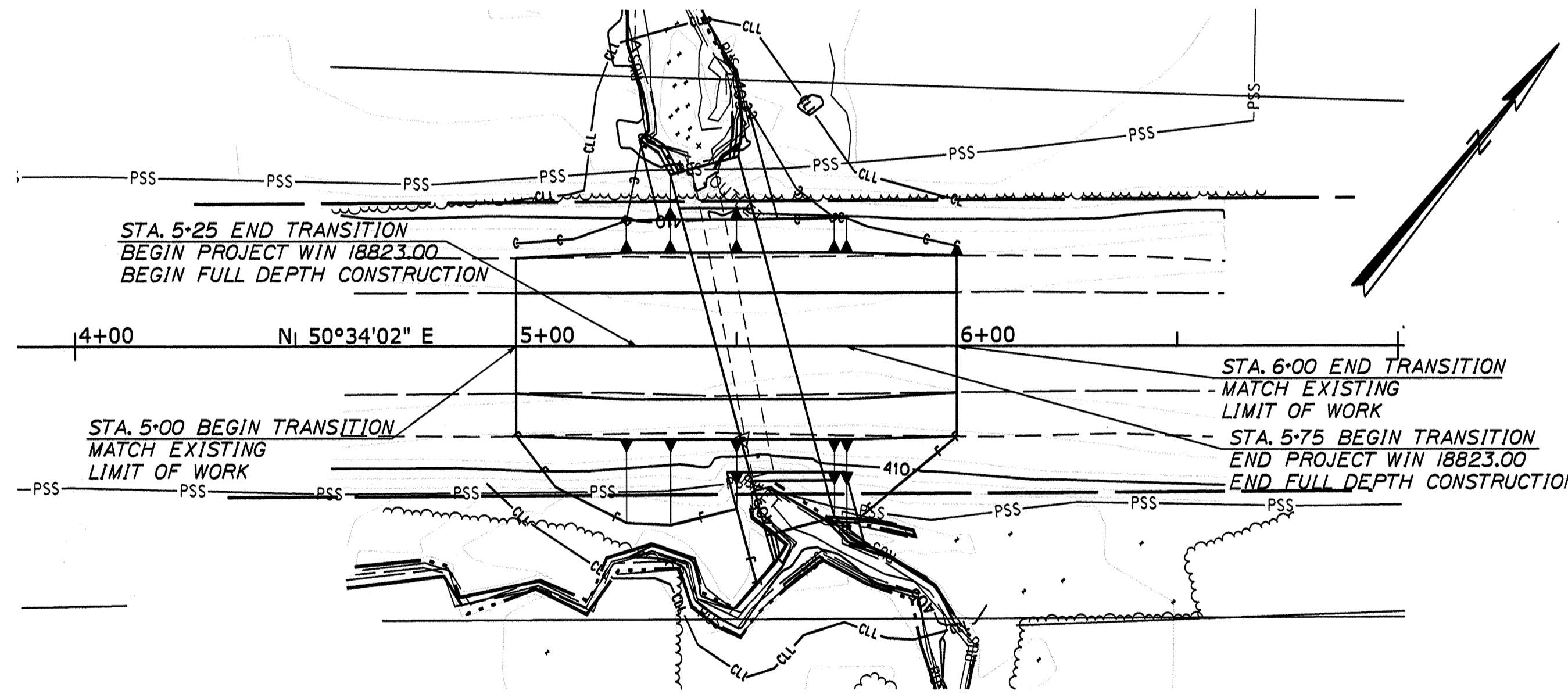

PLAN LEGEND	
Town, County, State	-----
Property Lines	-----
R/W Lines-Existing	-----
R/W Lines-Proposed	-----
Culvert-Existing	-----
Culvert Proposed	-----
Curbing Existing	-----
Curbing Proposed	-----
Type 1	-----
Type 3	-----
Type 5	-----
Outline of Bodies of Water	-----
Exposed Bedrock	-----
Buildings	-----
Tree Line	-----
Clearing Limit Line	-----
Railroad	-----
Catch Basins	Existing: Proposed:
Manholes	Existing: Proposed:
Proposed Underdrain	-----
Proposed Ditch	-----
Existing Ditch	-----
Utility Poles	Existing: Proposed:
Fire Hydrants	Existing: Proposed:
Existing Water Line	-----
Existing San. Sewer	-----
Existing San. Sewer Manhole	
Guardrail-Existing	-----
Guardrail-Proposed	-----
Guardrail-Cable, Other	-----
Centerline-Existing	-----
Centerline-Proposed	-----
Travelway-Existing	-----
Travelway-Proposed	-----
Boring	HB-XXX-###
Pavement Core	PC-#
Test Pit	TP-XXX-###
Probe	P-#. #X
	#, # = Depth
	X = W (Weathered Rock)
	R (Refusal)
	NR (No Refusal)

INDEX OF SHEETS	
Description	Sheet No.
Title Sheet	1
Typical Section	2
Estimated Quantities & General Notes	3
Special Details	4
Streambed Details	5
Boring Location Plan & Interpretive Subsurface Profile with Boring Logs	6
Plan and Profile	7
Cross Sections	8-10
Right of Way	11

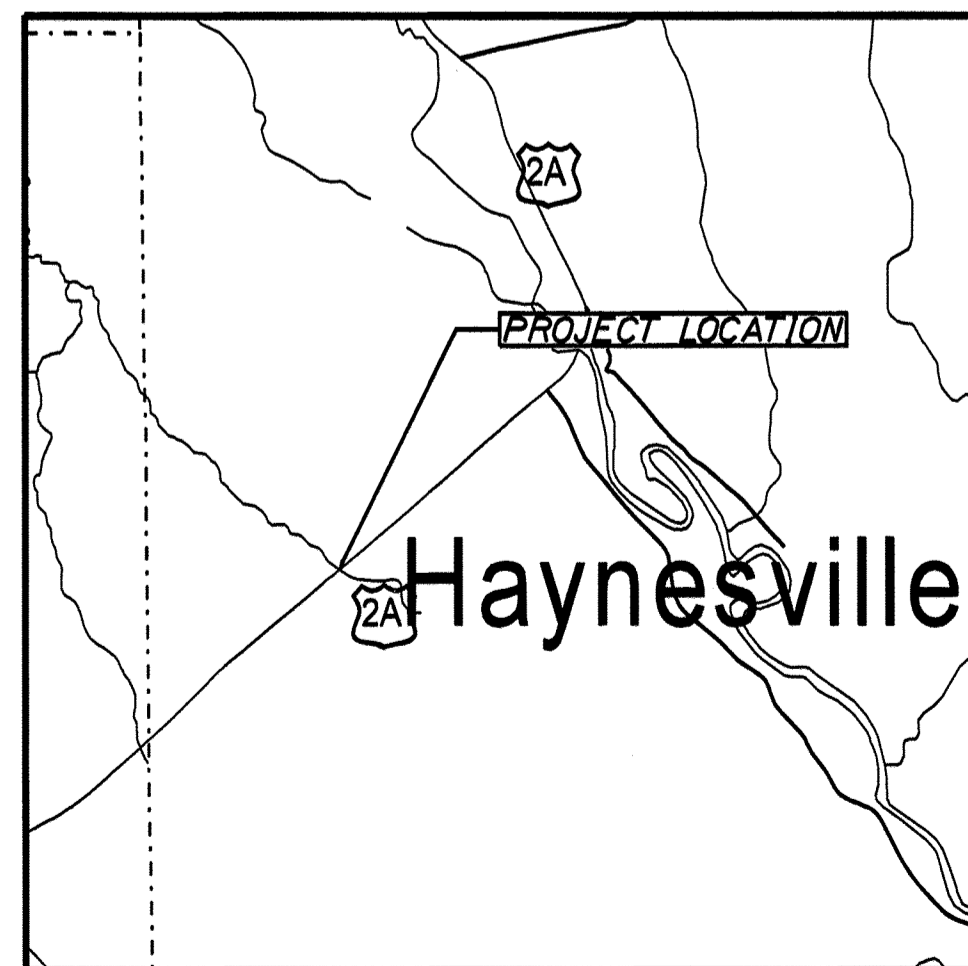

TRAFFIC DATA	
Current (2023) AADT	330
Future (2043) AADT	360
DHV - % of AADT	14%
Design Hour Volume	50
% Heavy Trucks (AADT)	33%
% Heavy Trucks (DHV)	30%
Directional Distribution (DHV)	50%
18 kip Equivalent P 2.0	181
18 kip Equivalent P 2.5	173
Design Speed (mph)	55
Functional Class:	Major Collector
Highway Corridor Priority:	4

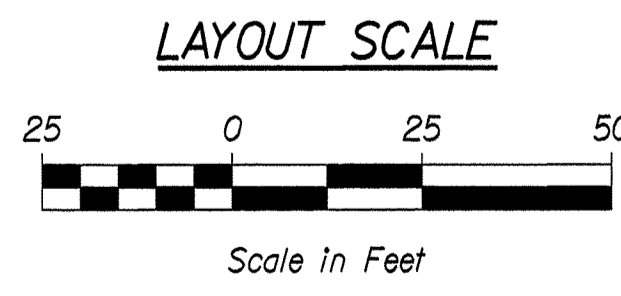

PROJECT LOCATION:	HAYNESVILLE, ROUTE 2A, LOCATED 1.33 MILES NORTH OF GLENWOOD PLT TOWN LINE.
PROGRAM AREA:	REGIONAL PROGRAM
SCOPE OF WORK:	LARGE CULVERT REPLACEMENT

STATE OF MAINE DEPARTMENT OF TRANSPORTATION	APPROVED	DATE
COMMISSIONER:		2-10-23
CHIEF ENGINEER:		2-8-2023



SIGNATURE	P.E. NUMBER	DATE
	13434	JANUARY 1, 2023

PROJECT INFORMATION	
PROGRAM	HIGHWAY
PROJECT MANAGER	R. SOUCY
DESIGNER	O. KRAUSS
CONSULTANT	HOYLE, TANNER & ASSOC.
PROJECT RESIDENT	
CONTRACTOR	
PROJECT COMPLETION DATE	

STATE PROJECT NO. 18823.00
WIN 18823.00
HAYNESVILLE
ROUTE 2A
TITLE SHEET

SHEET NUMBER	1
OF 11	

Date: 1/30/2023

Username:

Division: BRIDGE

Filename: ... \00\HIGHWAY\MSTA.001_Title.dgn

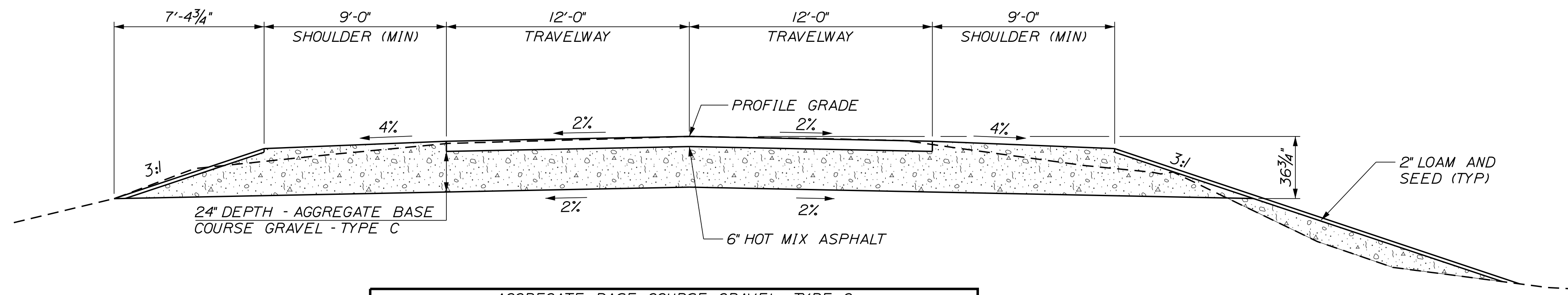

AGGREGATE BASE COURSE GRAVEL - TYPE C		
SHOULDER 80.80 CY/100 LF	TRAVEL LANE 144.50 CY/100 LF	SHOULDER 80.8 CY/100 LF
5-00 TO 6-00 LT.	5-00 TO 6-00	5-00 TO 6-00 RT.

ROADWAY TYPICAL SECTION
NORMAL

NOTES:

1. THE PAVEMENT, BASE AND SUBBASE DEPTHS AS SHOWN ON THE PLANS ARE INTENDED TO BE NOMINAL.
2. THE GRAVEL QUANTITY CALCULATION IS BASED ON A 2 INCH LOAM OR DIRTY BORROW DEPTH. THE ACTUAL DEPTH MAY VARY. SEE THE GENERAL NOTES.
3. STATIONING SHOWN UNDER EACH TYPICAL IS APPROXIMATE.
4. THE ALGEBRAIC DIFFERENCE BETWEEN THE SHOULDER AND TRAVELWAY CROSS SLOPES "ROLLOVER" SHALL NOT EXCEED 8%.
5. TRAVELWAY SHALL BE PAINTED TO MARK FOR 11 FOOT TRAVEL LANES TO MATCH EXISTING CONDITIONS.

NOT TO SCALE

STATE OF MAINE
DEPARTMENT OF TRANSPORTATION
018823-00
BRIDGE NO. 6566
WIN 18823.00
HIGHWAY PLANS

SIGNATURE
P.E. NUMBER
DATE

PROJ. MANAGER	ROGER SOUCY	BY	DATE
DESIGN-DETAILED	O. KRAUSS	B. NICHOLS	JAN 2023
CHECKED-REVIEWED	RPM	OK	JAN 2023
DESIGN-DETAILED			
REVISIONS 1			
REVISIONS 2			
REVISIONS 3			
REVISIONS 4			
FIELD CHANGES			

HAYNESVILLE
ROUTE 2A
TYPICAL SECTION

SHEET NUMBER
2
OF 11

ESTIMATED QUANTITIES			
ITEM NO.	DESCRIPTION	QUANTITY	UNIT
203.20	COMMON EXCAVATION	300	CY
203.25	GRANULAR BORROW	160	CY
203.33	SPECIAL FILL	100	CY
304.16	AGGREGATE BASE COURSE - TYPE C	300	CY
403.208	HOT MIX ASPHALT 12.5 MM HMA SURFACE	23	T
403.213	HOT MIX ASPHALT 12.5 MM HMA BASE	69	T
409.15	BITUMINOUS TACK COAT - APPLIED	16	G
508.13	SHEET WATERPROOFING MEMBRANE (140 SY)	1	LS
511.07	COFFERDAM, UPSTREAM	1	LS
511.07	COFFERDAM, DOWNSTREAM	1	LS
515.21	PROTECTIVE COATING FOR CONCRETE SURFACES (58 SY)	1	LS
534.7101	PRECAST CONCRETE BOX CULVERT - STATE SUPPLIED (150 CY)	1	LS
610.08	PLAIN RIPRAP	65	CY
610.21	STREAM CHANNEL ROCK	40	CY
610.212	STREAMBED ROCK FEATURES	4	CY
613.319	EROSION CONTROL BLANKET	45	SY
615.07	LOAM	12	CY
618.14	SEEDING METHOD NUMBER 2	2	UN
619.12	MULCH	2	UN
620.58	EROSION CONTROL GEOTEXTILE	190	SY
627.733	4" WHITE OR YELLOW PAINTED PAVEMENT MARK LINE	300	LF
627.78	TEMPORARY 4" PAINT PAVEMENT MARK LINE - WHITE OR YELLOW	300	LF
629.05	HAND LABOR, STRAIGHT TIME	10	HR
631.12	HEAVY DUTY ALL PURPOSE EXCAVATOR WITH OPERATOR	10	HR
631.172	TRUCK - LARGE (INCLUDING OPERATOR)	10	HR
639.20	FIELD OFFICE TYPE C	1	EA
643.72	TEMPORARY TRAFFIC SIGNAL	1	LS
652.33	DRUM	25	EA
652.34	CONE	25	EA
652.35	CONSTRUCTION SIGNS	100	SF
652.36	MAINTENANCE OF TRAFFIC CONTROL DEVICES	30	CD
652.38	FLAGGER	60	HR
652.61	STAGED CONSTRUCTION AND TRAFFIC CONTROL	1	LS
656.75	TEMPORARY SOIL EROSION & WATER POLLUTION CONTROL	1	LS
659.10	MOBILIZATION	1	LS

GENERAL NOTES

1. Pavement thicknesses shown on the typical sections are intended to be nominal.
2. Clearing limits shall be 10 feet beyond and parallel to the construction slope lines or as shown on the Plans unless otherwise authorized by the Resident.
3. All clearing shall be considered incidental to the Contract and no separate payment will be made. The actual lines for clearing shall be established in the field by the Contractor as indicated on the Plans and approved by the Resident.
4. Where deemed necessary by the Resident, unsuitable excess material shall be removed from the edges of shoulders and placed in designated areas or disposed of. Payment will be made under the appropriate Contract items.
5. The Contractor shall plan and conduct work so that upon completion of the project there is no drop-off from the edge of the shoulder pavement.
6. The Contractor shall place suitable existing or other material acceptable to the Resident on all pavement edges to allow a drop off no greater than the surface pavement thickness. The material shall be graded to match the existing inslope or as directed by the Resident before surface is placed. The Contractor will be paid under appropriate equipment rental items. Borrow is not authorized until all acceptable waste material has been utilized. Seed and Mulch will be paid for at the contract unit price.
7. All waste material not used on the project shall be disposed of off the project in acceptable waste areas reviewed by the Resident. Grading, seeding and mulching of waste areas shall be considered incidental.
8. Granular borrow used to backfill muck excavation or in low wet areas to 1 foot above water level or old ground shall meet requirements for granular borrow material for underwater backfill as specified in Standard Specifications Item 703.19, Granular Borrow.
9. Existing inslopes in proposed fill areas shall be benched by excavating steps of sufficient width to permit placing and compacting the fill material along with the material removed.
10. Any necessary cleaning of existing pavement prior to paving (or milling) shall be incidental to the related paving (or milling) items. This includes killing and removal of all vegetative matter.
11. Inlets and outlets of all culverts shall be rippapped unless otherwise noted on the Plans or directed by the Resident.
12. Loam has been estimated for disturbed areas. Actual placement of the loam shall be as noted on the Plans or designated by the Resident.
13. Seeding Method No. 2 shall be utilized on all areas.
14. Loam shall be placed to a nominal depth of 2 inches unless otherwise noted or directed.
15. Any damage to the slopes caused by the Contractor's equipment, personnel, or operation shall be repaired to the satisfaction of the Resident. All work, equipment, and materials required to make repairs shall be at the Contractor's expense.
16. No separate payment for superintendent or foreman will be made for the supervision of equipment and layout of work being paid for under the equipment rental items.
17. Final striping for the project shall be done by the Contractor per the striping layout in the Contract documents or as provided by the Department. Payment shall be made under appropriate Contract items.
18. Protective coating for concrete surfaces shall be applied to the following areas:
 - a. All exposed surfaces of precast concrete box culvert.
19. The Project Geotechnical Report titled "Geotechnical Design Report for the Construction of Babcock Bridge", Soils Report 2023-02, January 20, 2023 can be accessed at the MaineDOT website <http://www.maine.gov/mdot/contractors/>.
20. Geotechnical information furnished or referenced in this plan set is for the use of the Bidders and the Contractors. No assurance is given that the information or interpretations will be representative of actual subsurface conditions at the construction site. MaineDOT shall not be responsible for the Bidder's or Contractor's interpretations or conclusions drawn from the geotechnical information. The boring logs contained in the plan set present factual and interpretive subsurface information collected at discrete locations. Data provided may not be representative of the subsurface conditions between boring locations.

<p>STATE OF MAINE DEPARTMENT OF TRANSPORTATION</p> <p style="font-size: 24pt; font-weight: bold;">018823-00</p> <p style="font-size: 18pt; font-weight: bold;">WIN 18823.00</p> <p style="font-size: 12pt;">BRIDGE NO. 6566 HIGHWAY PLANS</p>	<p>HAYNESVILLE ROUTE 2A</p> <p style="font-size: 24pt; font-weight: bold;">ESTIMATED QUANTITIES & GENERAL NOTES</p>
<p>PROJ. MANAGER: ROGER SOUCY</p> <p>CHECKED-REVIEWED: L. KRAUSS</p> <p>DESIGN-DETAILED: B. NICHOLS</p> <p>DESIGN-DETAILED: ORK</p> <p>DESIGN-DETAILED: ORK</p> <p>REVISIONS 1</p> <p>REVISIONS 2</p> <p>REVISIONS 3</p> <p>REVISIONS 4</p> <p>FIELD CHANGES</p>	<p>DATE: JAN 2023</p> <p>DATE: JAN 2023</p> <p>SIGNATURE</p> <p>P.E. NUMBER</p> <p>DATE</p>
<p>SHEET NUMBER</p> <p style="font-size: 48pt; font-weight: bold;">3</p> <p>OF 11</p>	

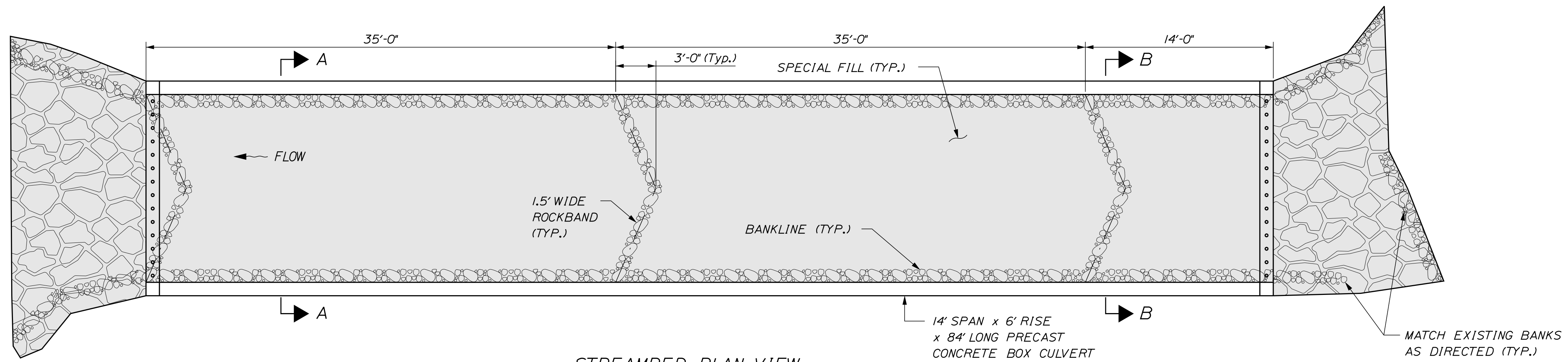

STREAMBED PLAN VIEW
N.T.S.

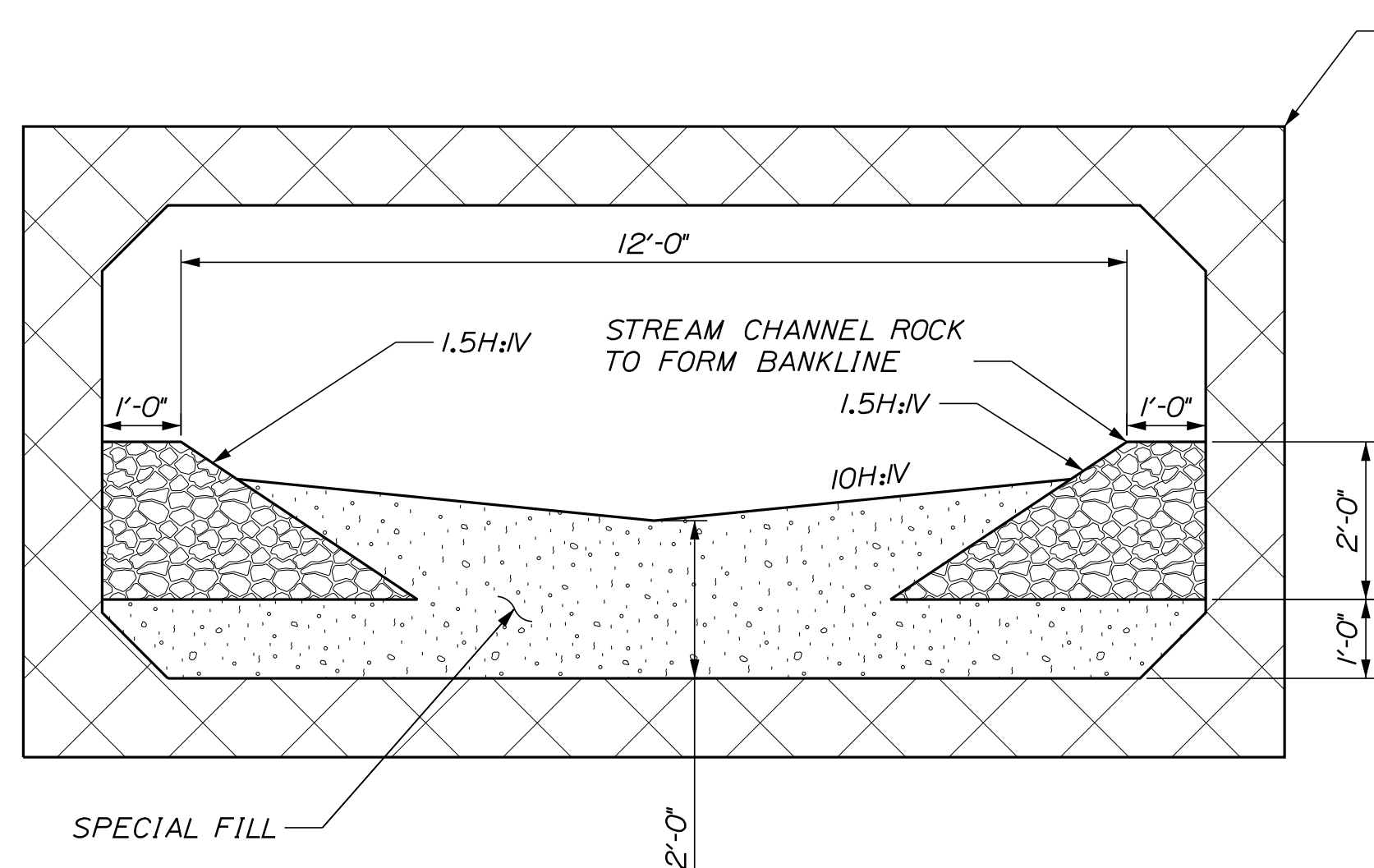

TYPICAL SECTION A-A
BETWEEN ROCK BANDS
N.T.S.

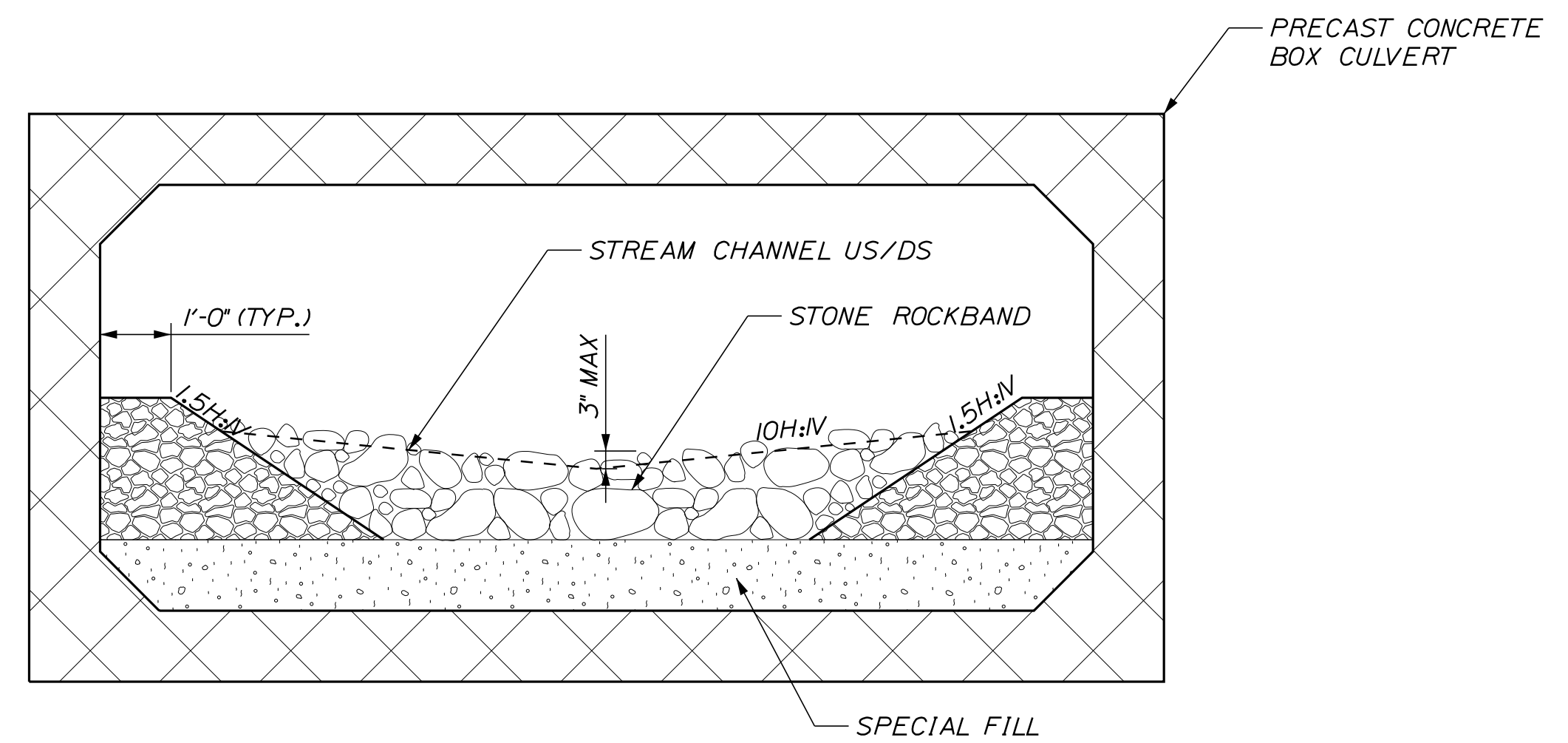

TYPICAL SECTION B-B
AT ROCK BANDS
N.T.S.

SECTION IS PROJECTED DUE TO VEE-SHAPED ROCK BAND

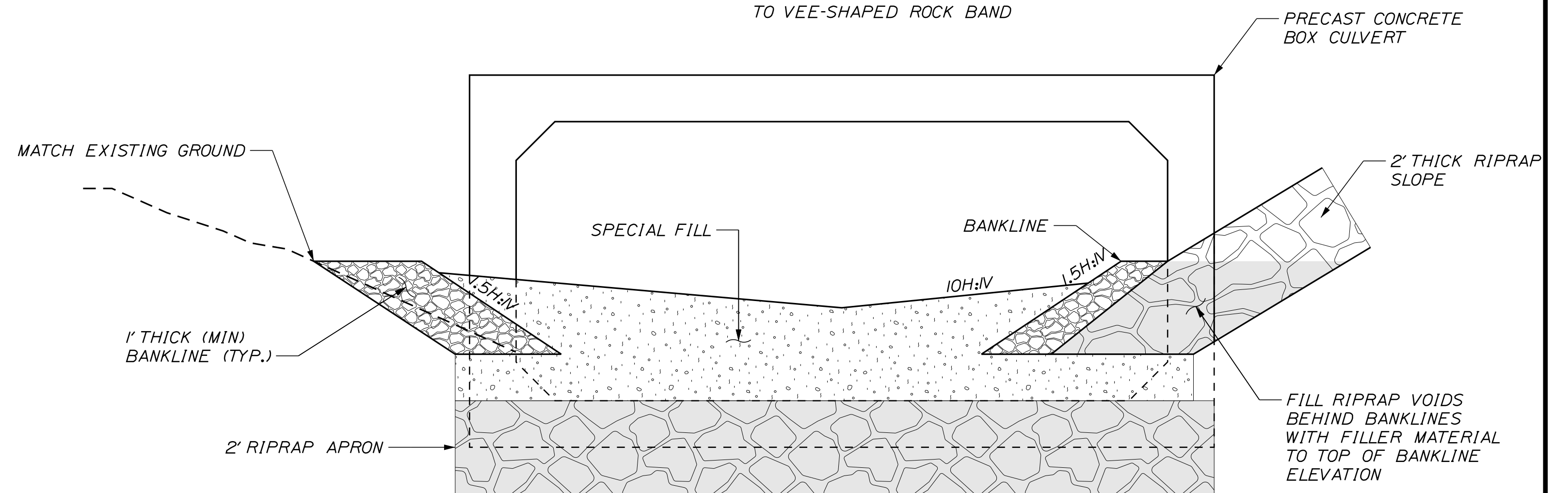

TYPICAL SECTION
NEAR INLET AND OUTLET
N.T.S.

- CULVERT IS BEYOND SECTION
- LAYOUT AND SHAPE OF BANKLINES AT INLET AND OUTLET WILL VARY WITH LOCATION

NOT TO SCALE

STREAMBED CONSTRUCTION NOTES

- LAYOUT AND CONFIGURATION FOR SPECIAL FILL, ROCK BANDS AND BANKLINES SHALL BE APPROVED BY THE RESIDENT AND MAINE DOT ENVIRONMENTAL STAFF.
- THE STREAMBED SHALL BE CONSTRUCTED IN ACCORDANCE WITH SPECIAL PROVISION 203 - SPECIAL FILL.
- BANKLINES SHALL BE CONSTRUCTED IN ACCORDANCE WITH SPECIAL PROVISION 610 - STREAM CHANNEL ROCK
- ROCKBANDS SHALL BE CONSTRUCTED IN ACCORDANCE WITH SPECIAL PROVISION 610 - STREAMBED ROCK FEATURES.
- THE ROCKBANDS SHALL BE SLIGHTLY CURVED OR VEE-SHAPED IN PLAN VIEW WITH THE BEND OR VEE POINTED UPSTREAM.
- THE TOP OF THE ROCK BANDS MAY EXTEND UP TO 3 INCHES ABOVE THE AVERAGE FINISHED GRADE OF THE STREAMBED.
- VOIDS IN THE STREAMBED MATERIAL, BANKLINE STONE AND ROCKBANDS SHALL BE FILLED AND SEALED SO THAT WATER REMAINS ON THE SURFACE OF THE CHANNEL AND STAYS BETWEEN THE BANKLINES AND DOES NOT PIPE THROUGH THE STONE. REFER TO SPECIAL PROVISIONS 203 AND 610.

Date: 1/30/2023

Username:

Division: BRIDGE

Filename: ... \MSTA\005_Streambed Details.dgn

PROJ. MANAGER	ROGER SOUCY	BY	DATE
DESIGN-DETAILED	O. KRAUSS	B. NICHOLS	JAN 2023
CHECKED-REVIEWED	RPM	DKR	JAN 2023
DESIGN-DETAILED			
REVISIONS 1			
REVISIONS 2			
REVISIONS 3			
REVISIONS 4			
FIELD CHANGES			

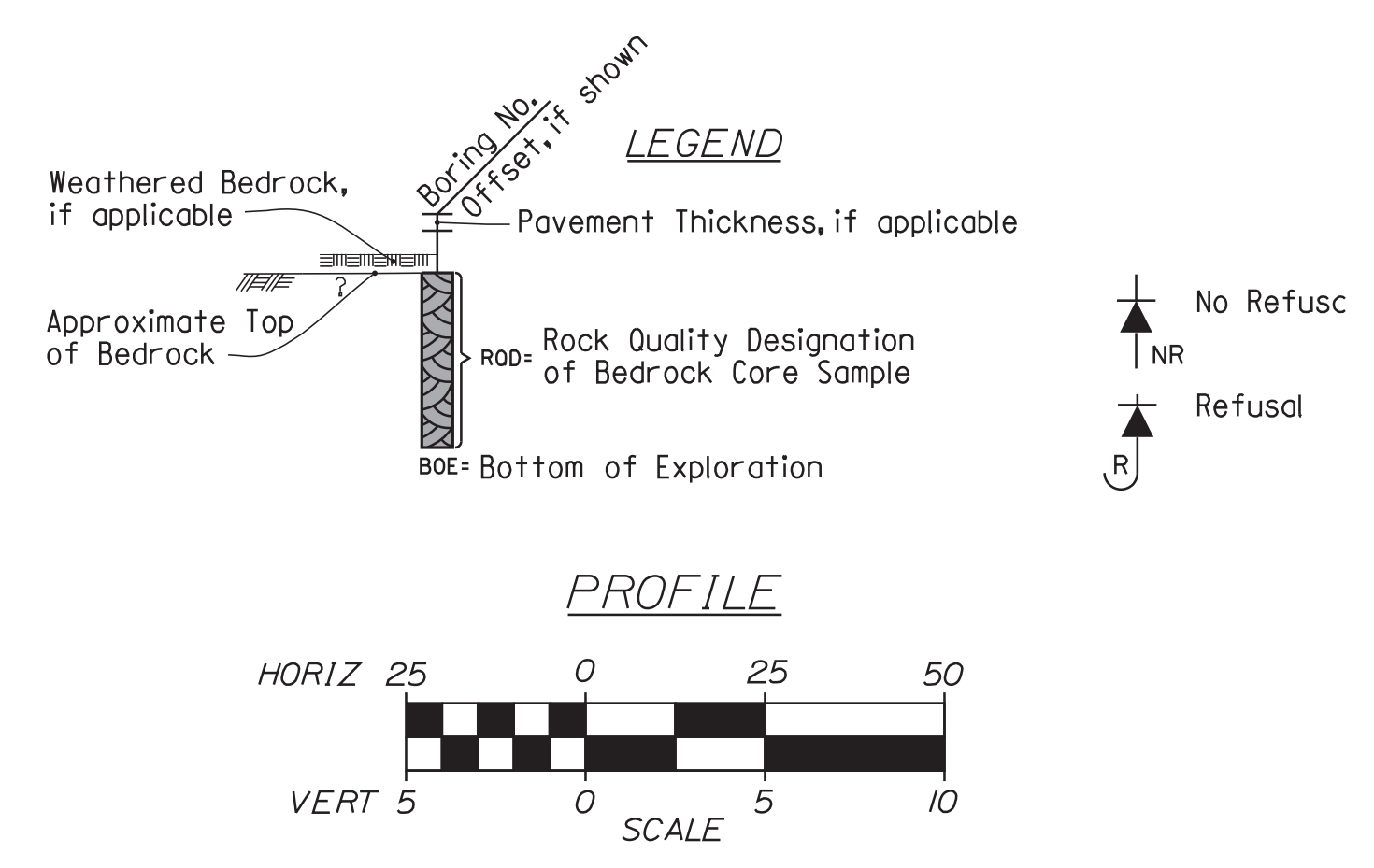
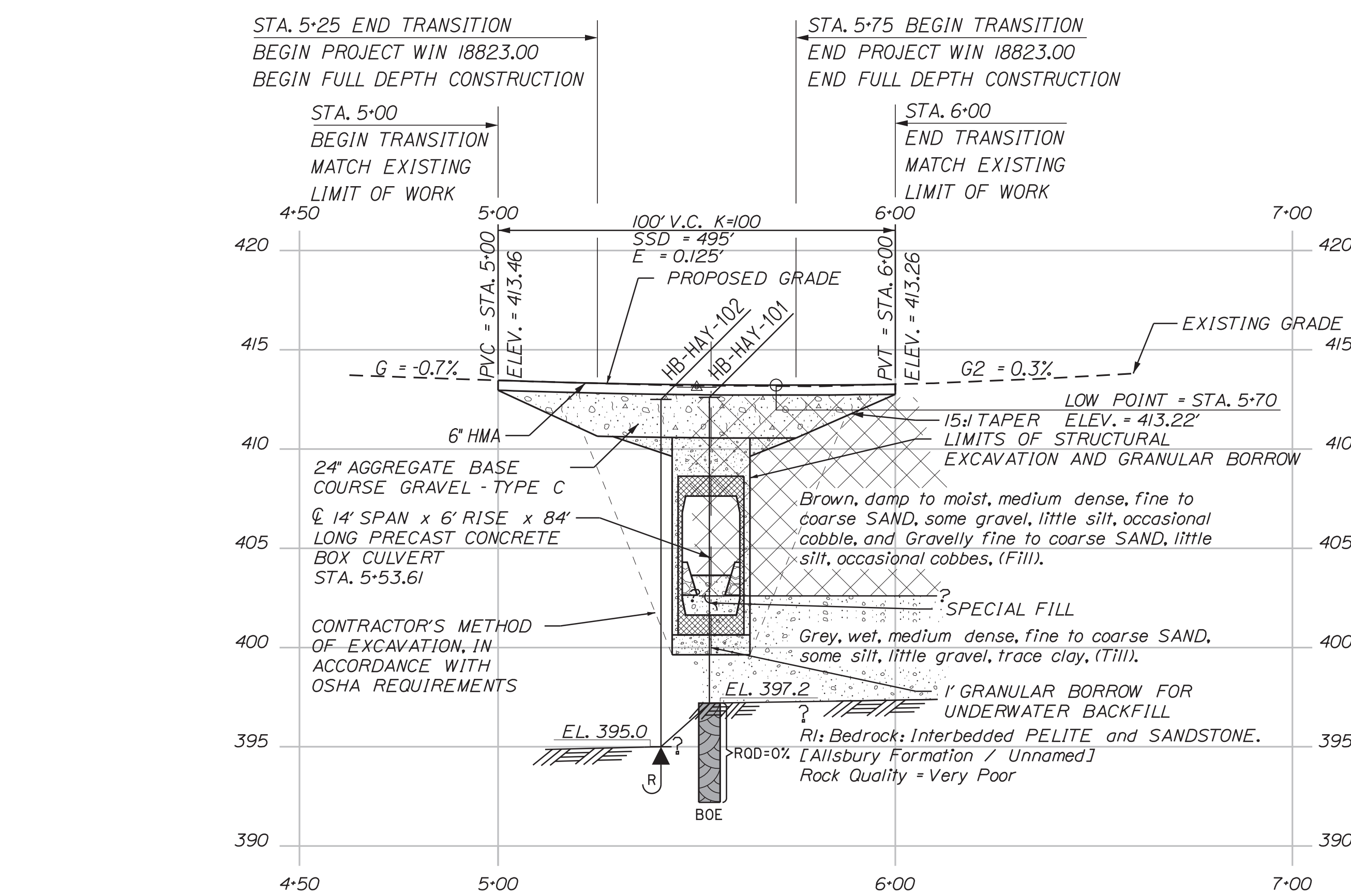
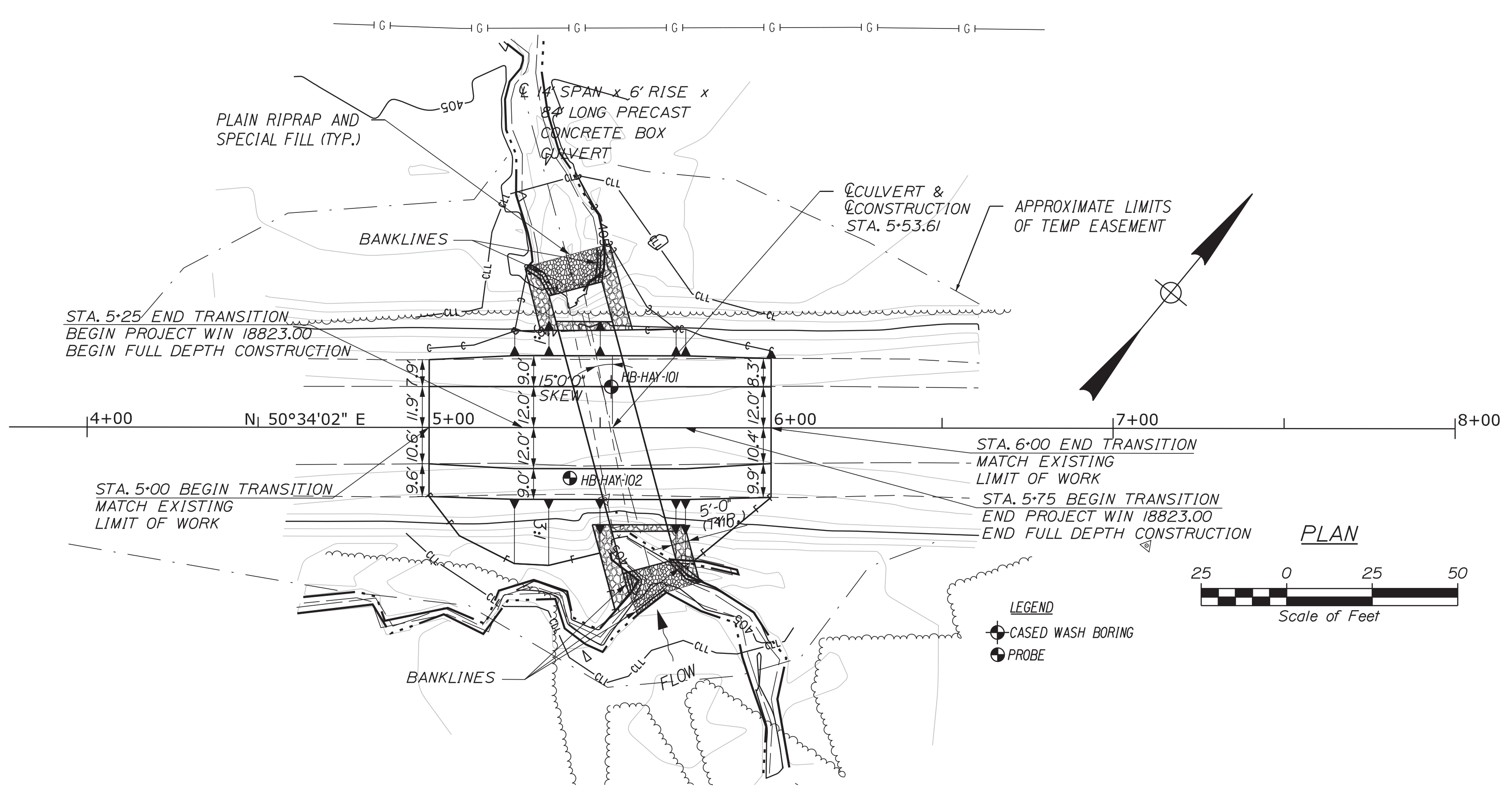

Note: This generalized interpretive soil profile is intended to convey trends in subsurface conditions. The boundaries between strata are approximate and idealized, and have been developed by interpretations of widely spaced explorations and samples. Actual soil and bedrock transitions may vary and are probably more erratic. For more specific information refer to the expl logs.

Maine Department of Transportation Soil/Bore Exploration Log US CUSTOMER UNITS		Project: Route 2A Large Culvert Replacement Location: Haynesville, Maine		Boring No.: HB-HAY-101					
Drillert: MainDOT	Elevation (ft.): 412.6	Auger ID/OD: 5" Dia.	WIN: 18823.00						
Operator: Daggett/Burpee	Date: NAVD83	Sampler: Standard Split Spoon							
Logged By: B. Wilber	Rig Type: CME 45C	Hammer Wt./Fall: 145#/30"							
Date Start/Finish: 8/4/2016: 07:30-10:00	Drilling Method: Cased Wash Boring	Core Barrel: ND-2"							
Boring Location: 5+53.21, 11.9 Ft LxL	Casing ID/OD: N/A	Water Level: None Observed							
Hammer Efficiency Factor: 0.943	Hammer Type: Automatic 88	Hydraulic: <input type="checkbox"/>	Rock & Corehead: <input type="checkbox"/>						
DEFINITIONS: S = Split Spoon Sample S ₁ = Solid Stem Auger S ₂ = Thin Wall Tube Sample S ₃ = Thick Wall Tube Sample M = Unsuccessful Split Spoon Sample Attempt SA = Solid Stem Auger SA = Solid Stem Auger SA = Solid Stem Auger W = Unsuccessful Thin Wall Tube Sample Attempt RW = Rock Core RW = Rock Core RW = Rock Core MW = Unsuccessful Thick Wall Tube Sample Attempt MW = Weight of 140lb. Hammer MW = Weight of 140lb. Hammer MW = Weight of 140lb. Hammer T = Field Vane Shear Test PP = Pocket Penetration WPT = Weight of Rod or Casing WPT = Weight of Rod or Casing WPT = Weight of Rod or Casing N = Non-Recorded N = Non-Recorded N = Non-Recorded N = Non-Recorded N = Non-Recorded N = Non-Recorded									
Depth (ft.)	Sample No.	Pen./Rec. (in)	Sample Depth (ft.)	Blows (1/6 in. Blow Count)	Remarks	Laboratory Testing Results and Unified Class			
0	10	24/16	0.00 - 2.00	4/7/10/11	17	21	SSA	Brown, damp, medium dense, fine to coarse SAND, some gravel, little silt, occasional cobble. (Ffill).	04270911 A-1-U, SM MC=6.3%
5	20	24/18	5.00 - 10.00	10/10/9/11	19	30		Brown, moist, medium dense, gravelly fine to coarse SAND, little silt, occasional cobble. (Ffill).	04270911 A-1-U, SM MC=6.6%
10	30	24/19	10.00 - 12.00	6/6/8/8	14	22	402.6	Grey, wet, medium dense, fine to coarse SAND, some silt, little gravel, trace clay (Till).	04270912 A-1-U, SM MC=11.9%
15	40	4.8/4.8 15.00 - 15.00	15.00 - 20.00	20/4.6/1 8/8/8/8/8/8	---	---	391.2	9100 blows for 0.4 ft. Grey, wet, medium dense, fine to coarse SAND, some silt, little gravel, trace clay. (Till). (Weathered Rock in tip of spoon).	04270913 A-1-U, SC-3M MC=10.0%
20	50	4.8/4.8 15.00 - 15.00	15.00 - 20.00	20/4.6/1 8/8/8/8/8/8	---	---	391.2	Top of Bedrock at Elev. 397.2 ft. R1: Bedrock: Grey/White, Interbedded PELITE and SANDSTONE. [Laboratory Information / Unnamed]. R1: Core Times (minutes): 16.4-11.4 ft (4248) 11.4-11.4 ft (4628) 11.4-11.4 ft (5348) 11.4-20.4 ft (5142) 1100% Recovery	04270913 A-1-U, SC-3M MC=10.0%
25	Bottom of Exploration at 20.4 feet below ground surface.								

Maine Department of Transportation Soil/Bore Exploration Log US CUSTOMER UNITS		Project: Route 2A Large Culvert Replacement Location: Haynesville, Maine		Boring No.: HB-HAY-102		
Drilling Contractor: MainDOT	Elevation (ft.): 412.5	Auger ID/OD: 5" Dia.	WIN: 18823.00			
Operator: Daggett/Burpee	Date: NAVD83	Sampler: N/A				
Logged By: B. Wilber	Rig Type: CME 45C	Hammer Wt./Fall: N/A				
Date Start/Finish: 8/4/2016: 07:30-10:00	Drilling Method: Solid Stem Auger	Core Barrel: N/A				
Boring Location: 5+41, 14.8 Ft R.	Casing ID/OD: N/A	Water Level: None Observed				
DEFINITIONS: S = Split Spoon Sample S ₁ = Solid Stem Auger S ₂ = Thin Wall Tube Sample S ₃ = Thick Wall Tube Sample M = Unsuccessful Split Spoon Sample Attempt SA = Solid Stem Auger SA = Solid Stem Auger SA = Solid Stem Auger W = Unsuccessful Thin Wall Tube Sample Attempt RW = Rock Core RW = Rock Core RW = Rock Core MW = Unsuccessful Thick Wall Tube Sample Attempt MW = Weight of 140lb. Hammer MW = Weight of 140lb. Hammer MW = Weight of 140lb. Hammer T = Field Vane Shear Test PP = Pocket Penetration WPT = Weight of Rod or Casing WPT = Weight of Rod or Casing WPT = Weight of Rod or Casing N = Non-Recorded N = Non-Recorded N = Non-Recorded N = Non-Recorded N = Non-Recorded N = Non-Recorded						
Depth (ft.)	Sample No.	Pen./Rec. (in)	Sample Depth (ft.)	Blows (1/6 in. Blow Count)	Remarks	Laboratory Testing Results and Unified Class
0					Probe, no soil samples taken.	
5						
10						
15						
20						
25						
30						
35						
40						
45						
50						
55						
60						
65						
70						
75						
80						
85						
90						
95						
100						
105						
110						
115						
120						
125						
130						
135						
140						
145						
150						
155						
160						
165						
170						
175						
180						
185						
190						
195						
200						
205						
210						
215						
220						
225						
230						
235						
240						
245						
250						
255						
260						
265						
270						
275						
280						
285						
290						
295						
300						
305						
310						
315						
320						
325						
330						
335						
340						
345						
350						
355						
360						
365						
370						
375						
380						
385						
390						
395						
400						
405						
410						
415						
420						
425						
430						
435						
440						
445						
450						
455						
460						
465						
470						
475						
480						
485						
490						
495						
500						
505						
510						
515						
520						
525						
530						
535						
540						
545						
550						
555						
560						
565						
570						
575						
580						
585						
590						
595						
600						
605						
610						
615						
620						
625						
630						
635						
640						
645						
650						
655						
660						
665						
670						
675						
680						
685						
690						
695						
700						
705						
710						
715						
720						
725						
730						
735						
740						
745						
750						
755						
760						
765						
770						
775						
780						
785						
790						
795						
800						
805						
810						
815						
820						
825						
830						
835						
840						
845						
850						
855						
860						
865						
870						
875						
880						
885						
890						
895						
900						
905						
910						
915						
920						
925						
930						
935						
940						
945						
950						
955						
960						
965						
970						

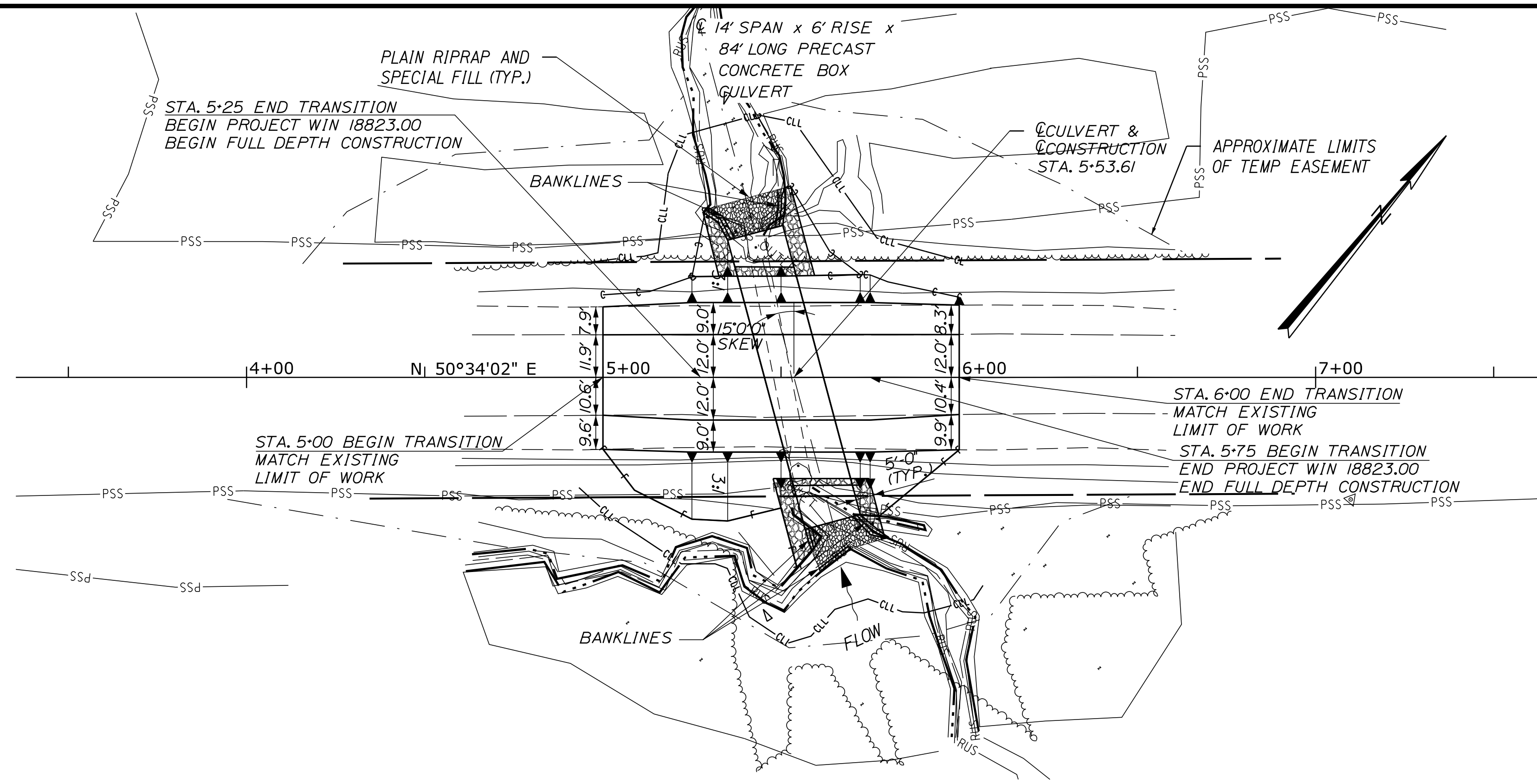

PLAN

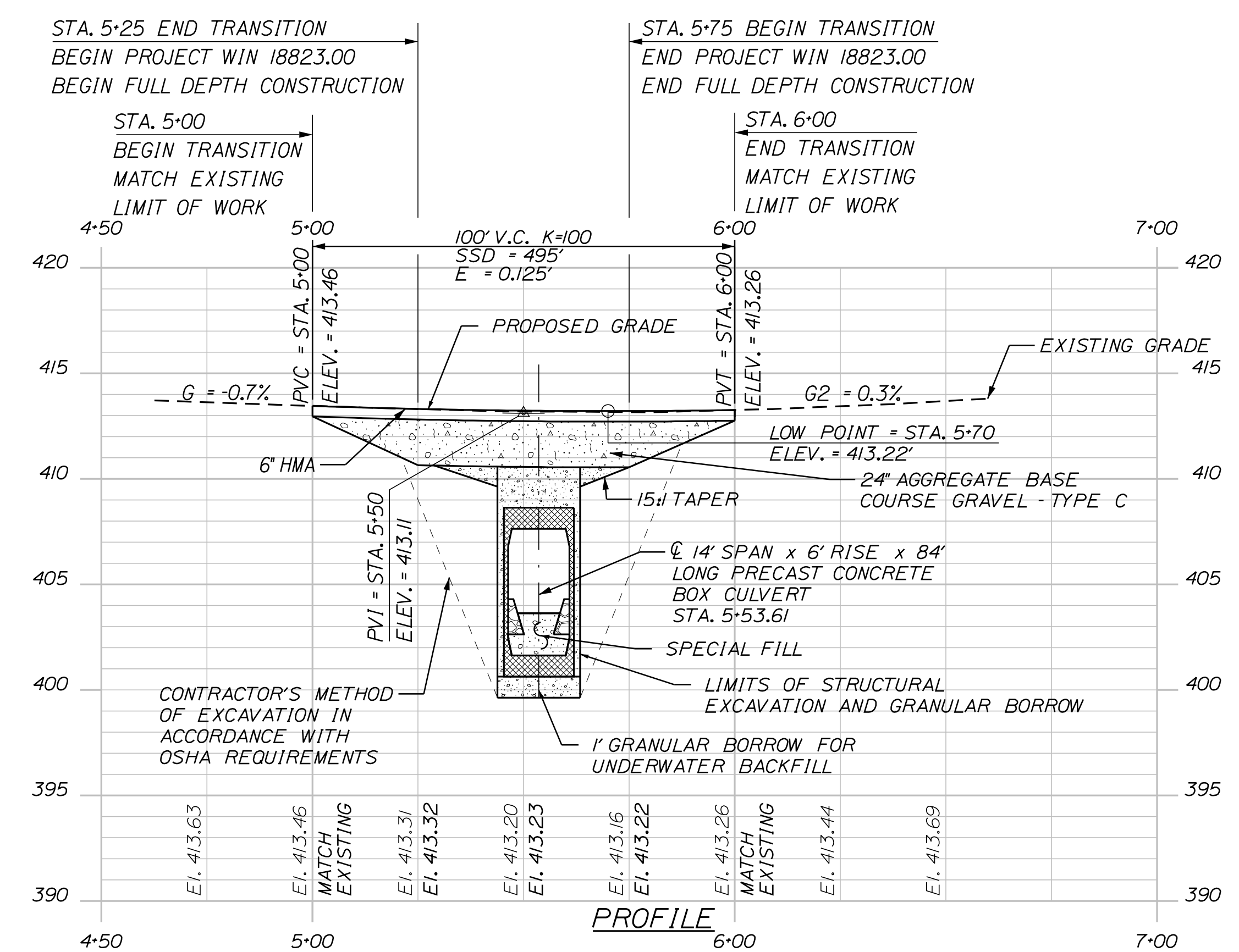
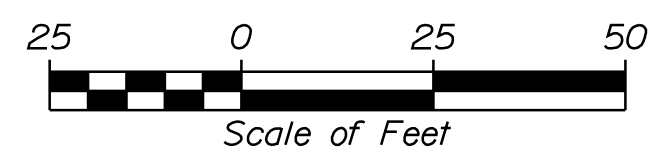

PROFILE

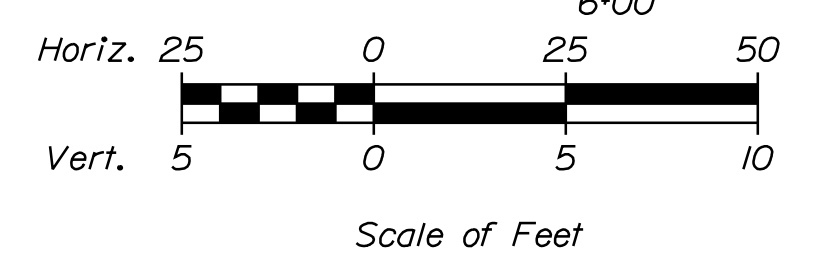

STATE OF MAINE		DEPARTMENT OF TRANSPORTATION	
018823-00		WIN 18823.00	
HIGHWAY PLANS		SIGNATURE	
DATE		P.E. NUMBER	
BY		DATE	
ROGER SOUCY		JAN 2023	
L. KRALUSS		JAN 2023	
O.K.		O.K.	
DESIGN REVIEWED		DESIGN REVIEWED	
DESIGN DETAILED		DESIGN DETAILED	
REVISIONS 1		REVISIONS 1	
REVISIONS 2		REVISIONS 2	
REVISIONS 3		REVISIONS 3	
REVISIONS 4		REVISIONS 4	
FIELD CHANGES		FIELD CHANGES	

HAYNESVILLE	
ROUTE 2A	
PLAN AND PROFILE	
SHEET NUMBER	
7	
OF 11	

Date: 1/30/2023

Username:

Division: BRIDGE

Filename: ... \MSTA008_XSECT_5+00_001.dgn

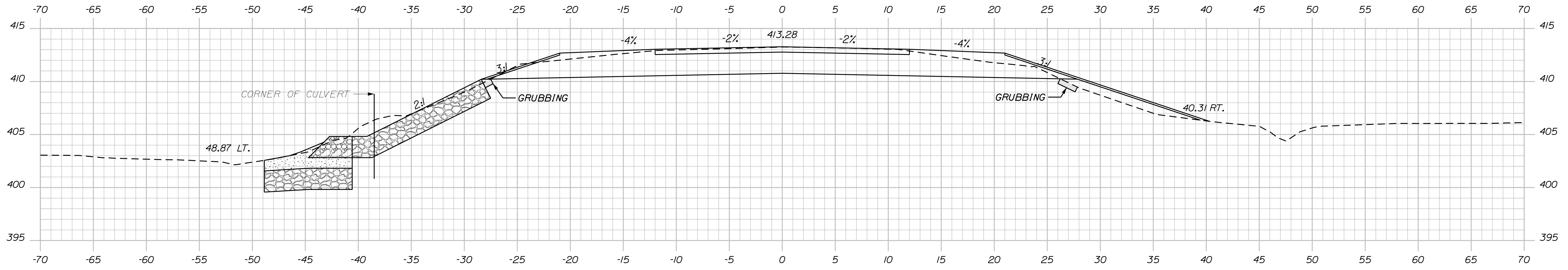

5+35.00

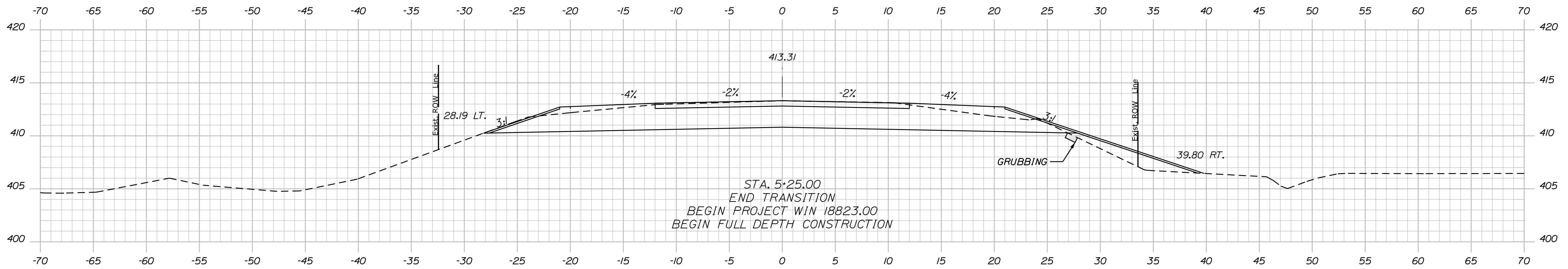

5+25.00

STA. 5+25.00
 END TRANSITION
 BEGIN PROJECT WIN 18823.00
 BEGIN FULL DEPTH CONSTRUCTION

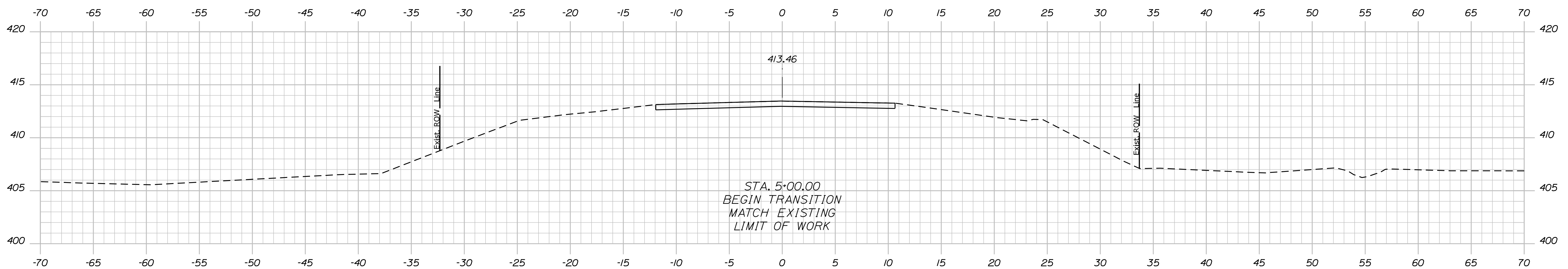

5+00.00

STA. 5+00.00
 BEGIN TRANSITION
 MATCH EXISTING
 LIMIT OF WORK

STATE OF MAINE
 DEPARTMENT OF TRANSPORTATION
 018823-00
 WIN
 18823.00
 HIGHWAY PLANS

DESIGN DETAILED	DATE	SIGNATURE
CHECKED/REVIEWED	JAN 2023	
DESIGN DETAILED	JAN 2023	
REVISIONS 1		P.E. NUMBER
REVISIONS 2		DATE
REVISIONS 3		
REVISIONS 4		
FIELD CHANGES		

PROJ. MANAGER	ROGER SOUCY
BY	B. NICHOLS
DATE	JAN 2023

HAYNESVILLE
 ROUTE 2A
 CROSS SECTIONS

SHEET NUMBER
 8
 OF 11

Date: 1/30/2023

Username:

Division: BRIDGE

Filename: ... \MSTA\09_XSECT_5+50_002.dgn

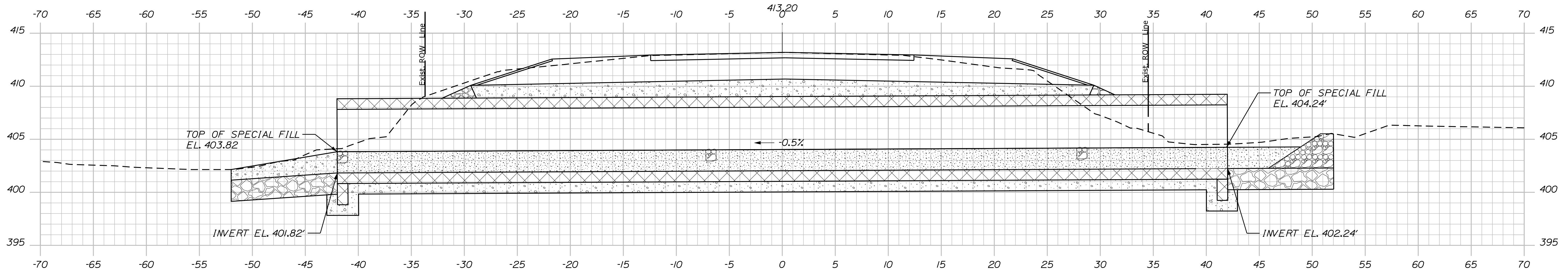
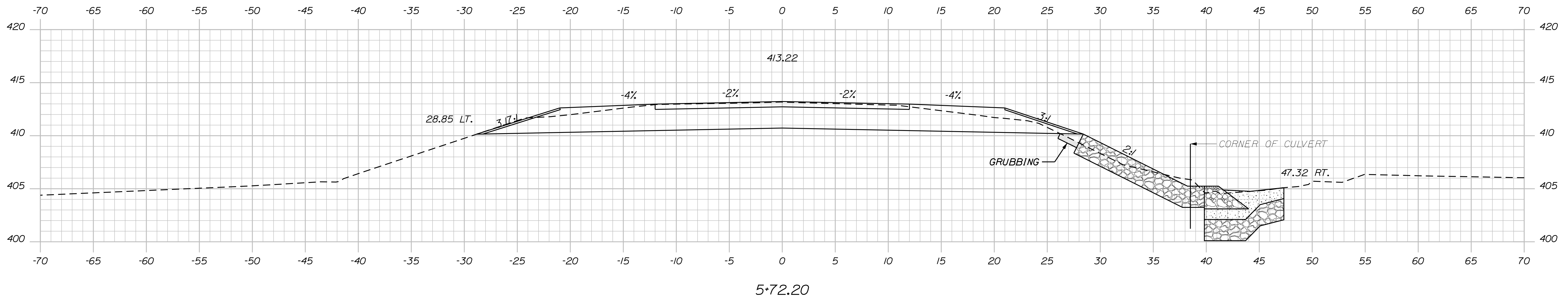

SECTION ALONG CULVERT - 15° SKEW
(STA. 5+53.61)

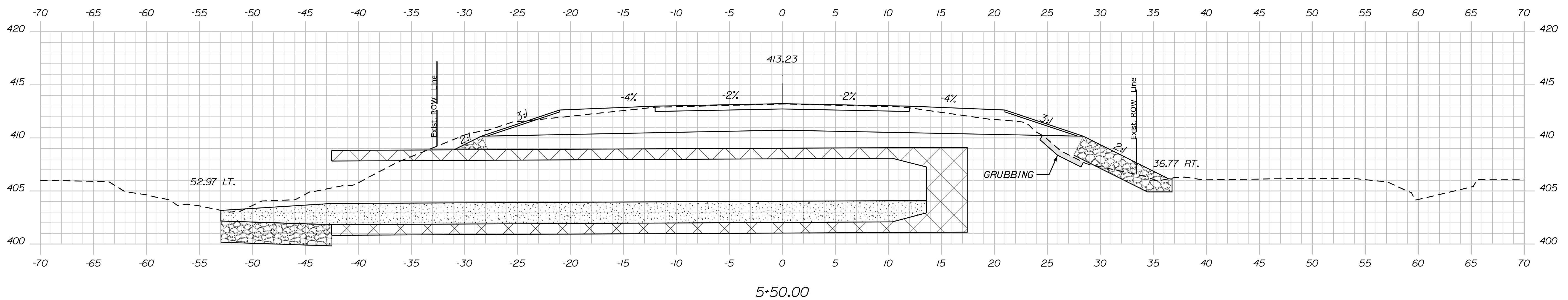

STATE OF MAINE
DEPARTMENT OF TRANSPORTATION
018823-00
WIN
18823.00
HIGHWAY PLANS

DESIGN-DETAILED	BY	DATE
CHECKED-REVIEWED	ROGER SOUCY	JAN 2023
DESIGN-DETAILED	B. NICHOLS	JAN 2023
DESIGN-DETAILED	D. KRALLUS	JAN 2023
REVISIONS 1	OKR	SIGNATURE
REVISIONS 2		P.E. NUMBER
REVISIONS 3		DATE
REVISIONS 4		
FIELD CHANGES		

HAYNESVILLE
ROUTE 2A
CROSS SECTIONS

SHEET NUMBER
9
OF 11

Date: 1/30/2023

Username:

Division: BRIDGE

Filename: ... \MSTA010_XSECT_5+75_003.dgn

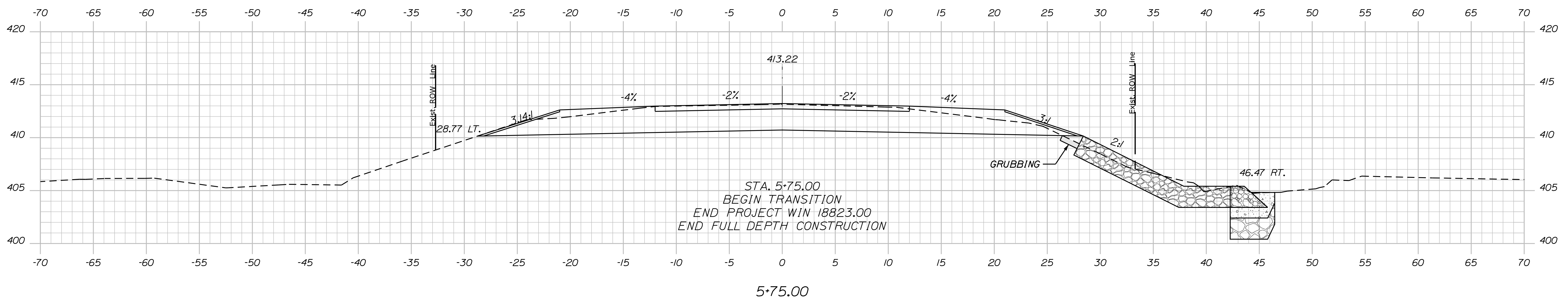
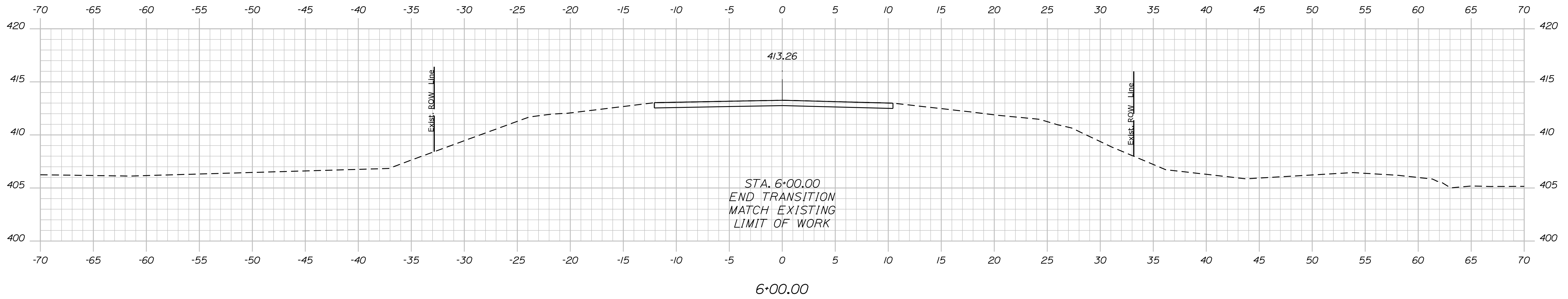

STATE OF MAINE
DEPARTMENT OF TRANSPORTATION

018823-00

WIN
18823.00

HIGHWAY PLANS

DATE
SIGNATURE

P.E. NUMBER

DATE

PROJ. MANAGER	ROGER SOUCY	BY	DATE
DESIGN/DETAILED	O. KRALUSS	B. NICHOLS	JAN 2023
CHECKED/REVIEWED	RPM	OK	JAN 2023
DESIGN/DETAILED			
REVISIONS 1			
REVISIONS 2			
REVISIONS 3			
REVISIONS 4			
FIELD CHANGES			

HAYNESVILLE
ROUTE 2A

CROSS SECTIONS

SHEET NUMBER

10

OF 11

Sta. 5+75.00 to Sta. 6+00.00

Date: 1/30/2023

Username: Terri.L.Blair

Division: ROW

Filename: ... \00\ROW\MSTA\001_RWPLAN1.dgn

Town, County, State _____
 Approx. Property Lines _____
 Existing Right of Way _____
 Limits of Wrought Portion _____
 Control Of Access _____
 New Right of Way _____
 New Easement _____
 New Temporary Rights _____
 New R/W Within Existing R/W _____

New R/W Along Existing R/W _____
 Building _____
 Trees Conifer _____
 Tree Line _____
 Water Edge _____
 Ledge _____
 Fence CHAIN LINK _____
 Sign _____

Clearing Limit Line _____
 Bush Line _____
 Rock/Boulder _____
 Flag Pole _____
 BARB WIRE _____
 STOCKADE _____
 WELL _____
 Mailbox _____

Sanitary Sewer _____
 Telephone Line _____
 Electric Line _____
 Water Line _____
 Underdrain Line _____
 Gas Line _____
 Guardrail _____
 Culvert _____

Proposed _____
 Traveled Way _____
 Ditch _____
 Catch Basin _____
 Manhole _____
 Sewer Manhole _____
 Utility Pole _____
 Fire Hydrant _____
 Curbing _____

Existing _____
 Proposed _____
 Cut Line _____
 Stonewall _____
 Baseline _____
 Monument _____
 Iron Rod Found _____
 Replacement Pin Set _____

THIS PLAN WAS PREPARED IN CONNECTION WITH THE DEPARTMENT'S ACQUISITION OF REAL PROPERTY FOR TRANSPORTATION PURPOSES. IT CANNOT BE USED TO ESTABLISH LEGAL BOUNDARIES BETWEEN ABUTTING PROPERTY OWNERS.

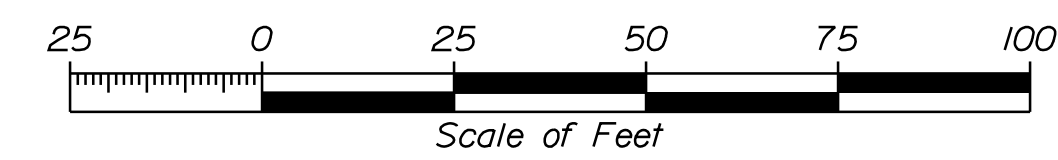

STATE OF MAINE
 REGISTRY OF DEEDS
 COUNTY _____
 RECEIVED _____,
 at _____ h _____ m _____ M and
 recorded in Plan Bk _____, Pg. _____
 Attest: _____ REGISTER

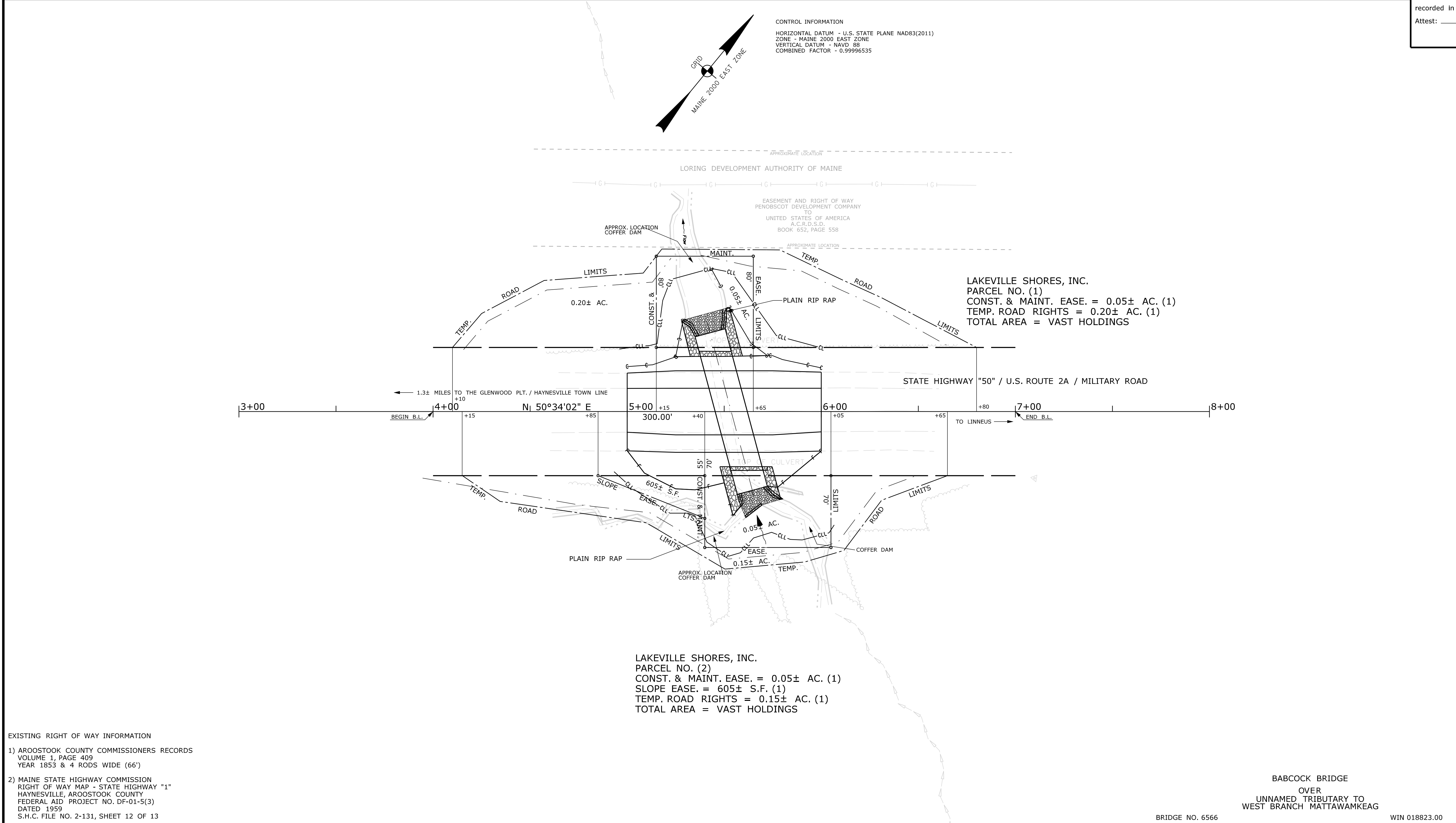

EXISTING RIGHT OF WAY INFORMATION
 1) AROOSTOOK COUNTY COMMISSIONERS RECORDS
 VOLUME 1, PAGE 409
 YEAR 1853 & 4 RODS WIDE (66')
 2) MAINE STATE HIGHWAY COMMISSION
 RIGHT OF WAY MAP - STATE HIGHWAY "1"
 HAYNESVILLE, AROOSTOOK COUNTY
 FEDERAL AID PROJECT NO. DF-01-5(3)
 DATED 1959
 S.H.C. FILE NO. 2-131, SHEET 12 OF 13

NO.	DATE	REVISIONS DESCRIPTION	BY	PLAN FILED IN PLAN BOOK				PAGE COUNTY RECORD				BRUCE A. VAN NOTE	
				NO.	GRANTOR	INSTRUMENT	DATE	BOOK	PAGE	COND.	11-07-22		6392

BRUCE A. VAN NOTE
 COMMISSIONER
 JOYCE NOEL TAYLOR
 CHIEF ENGINEER
 DATE

STATE HIGHWAY "50"
 U.S. ROUTE 2A / MILITARY ROAD
 HAYNESVILLE AROOSTOOK COUNTY
 STATE PROJECT NO. 18823.00
 SEPTEMBER 2022 RIGHT-OF-WAY MAP
 SCALE 1" = 25' SHEET 1 OF 1
 D.O.T. FILE NO. 2-595

STATE OF MAINE DEPARTMENT OF TRANSPORTATION 16 STATE HOUSE STATION - AUGUSTA, ME 04333-0016 - 207-624-3460	STATE OF MAINE REGISTRY OF DEEDS
EXISTING CONDITION PLAN	TECH CHECKED
FINAL RIGHT OF WAY	G.L.L. G.L.L. G.L.L.
AREAS	T.L.B. D.S.G.
STATE OF MAINE DEPARTMENT OF TRANSPORTATION HAYNESVILLE RIGHT OF WAY MAP	SHEET NUMBER
	11
	OF 11