

STATE OF MAINE DEPARTMENT OF TRANSPORTATION



SABATTUS ANDROSCOGGIN COUNTY ROUTE 132 FEDERAL AID PROJECT STP-1864(900) PROJECT LENGTH : 0.10 MILES

PLAN LEGEND	
Town, County, State	Centerline-Existing
Property Lines	Centerline-Proposed
R/W Lines-Existing	Travelway-Existing
R/W Lines-Proposed	Travelway-Proposed
Culvert-Existing	Railroad
Culvert Proposed	Catch Basins
Curbing Existing	Manholes
Curbing Proposed	Proposed Underdrain
Type 1	Proposed Ditch
Type 3	Existing Ditch
Type 5	Utility Poles
Outline of Bodies of Water	Fire Hydrants
Boring	Existing Water Line
Pavement Core	Existing San. Sewer
Test Pit	Existing San. Sewer Manhole
Probe	Guardrail-Existing
	Guardrail-Proposed
	Guardrail-Cable, Other
	Exposed Bedrock
	Buildings
	Trees
	Tree Line
	Clearing Limit Line

INDEX OF SHEETS	
Description	Sheet No.
Title Sheet	1
Typical Sections	2
Estimate	3
General Notes	4
Construction Notes	5
Plan	6
Cross - Sections	7-13

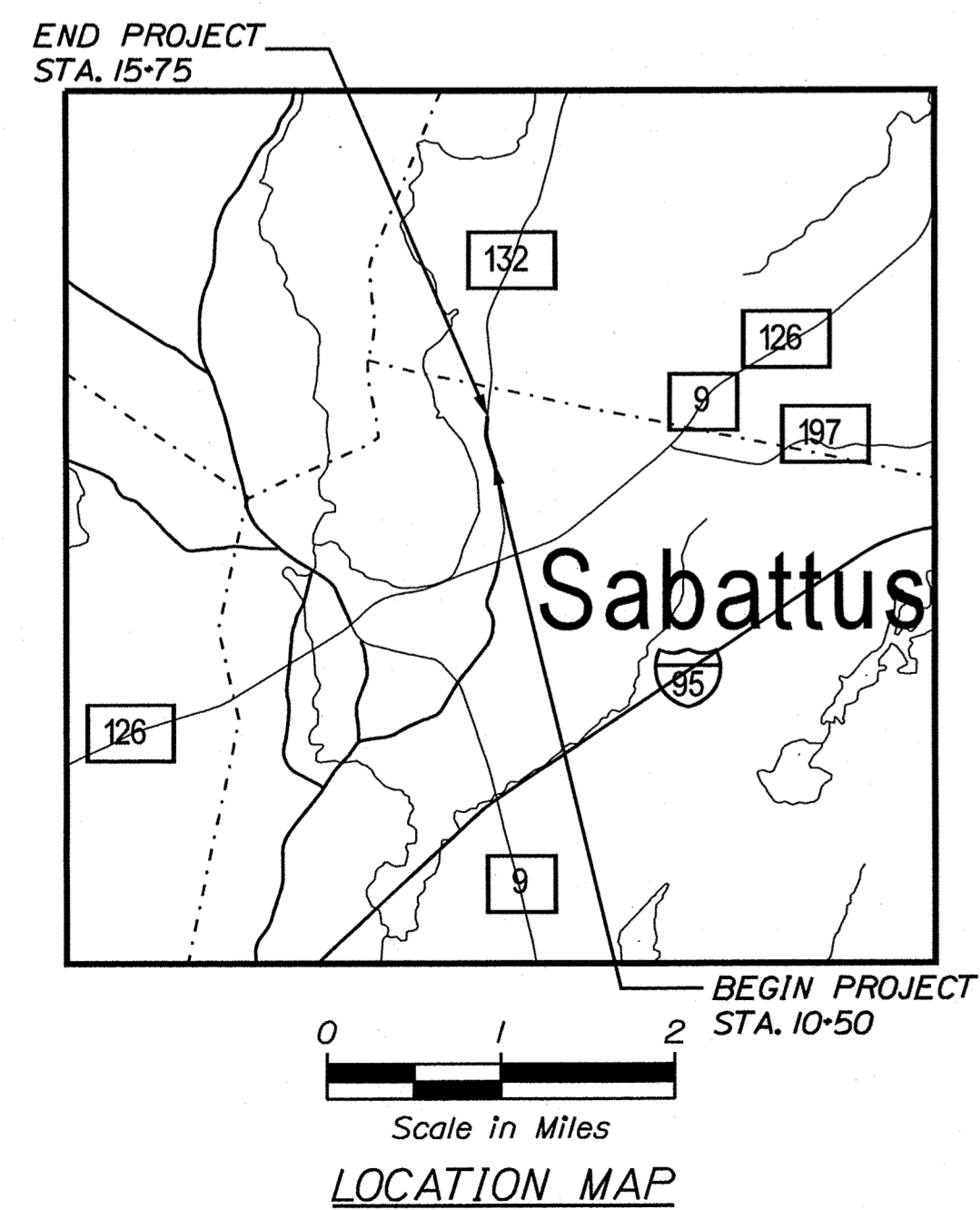
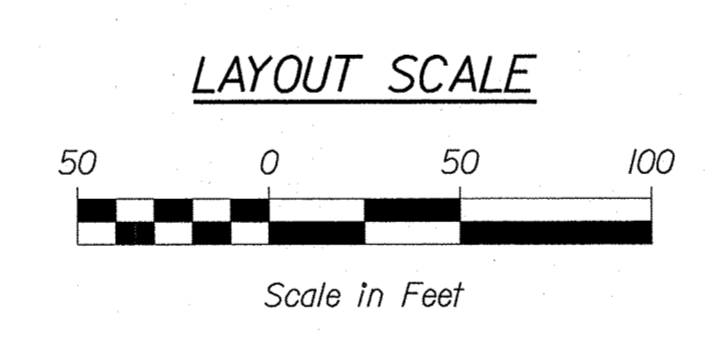
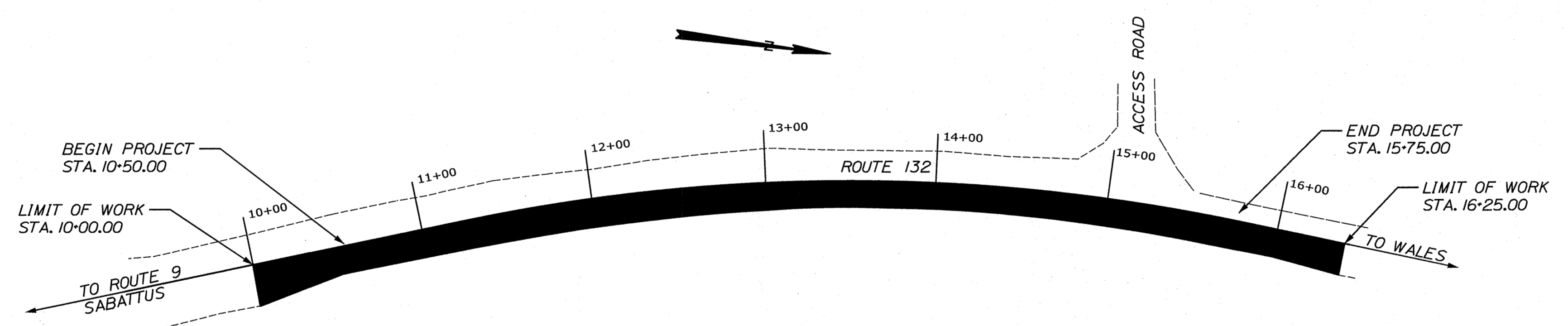

TRAFFIC DATA	
Current (2017) AADT	4060
Future (2029) AADT	4300
DHV - % of AADT	11%
Design Hour Volume	473
% Heavy Trucks (AADT)	6%
Directional Distribution (DHV)	64%
Design Speed (mph)	45
Functional Class	Urb. Maj. Collector
Corridor Priority	4

PROJECT LOCATION:	Beginning at 0.13 of a mile north of Stonewall Road and extending northerly 0.10 of a mile.
PROGRAM AREA:	Highway Program
SCOPE OF WORK:	Highway Rehabilitation / Spot Improvement

STATE OF MAINE DEPARTMENT OF TRANSPORTATION	APPROVED	DATE
	<i>[Signature]</i>	3/13/18
	COMMISSIONER	
	CHIEF ENGINEER	3-23-18

<i>[Signature]</i>	SIGNATURE	P.E. NUMBER	DATE
	R. BETZ	12896	3/14/2018
	R. ILLIAN		
	DESIGNER		
	CONSULTANT		
	PROJECT RESIDENT		
	CONTRACTOR		
	PROJECT COMPLETION DATE		

PROJECT INFORMATION	
PROGRAM	HIGHWAY
PROJECT MANAGER	R. BETZ
DESIGNER	R. ILLIAN
CONSULTANT	
PROJECT RESIDENT	
CONTRACTOR	
PROJECT COMPLETION DATE	

WIN 18649.00 STP-1864(900)
**SABATTUS
ROUTE 132
TITLE SHEET**

SHEET NUMBER
1
OF 13

Date: 3/14/2018
Username: Randy Illian
Division: HIGHWAY
Filename: ... \00\HIGHWAY\MSTA\001_Title.dgn

NOTE:

- 1. THE PAVEMENT DEPTHS AS SHOWN ON THE PLANS ARE INTENDED TO BE NOMINAL.
- 2. THE STATIONING SHOWN UNDER EACH TYPICAL IS APPROXIMATE.

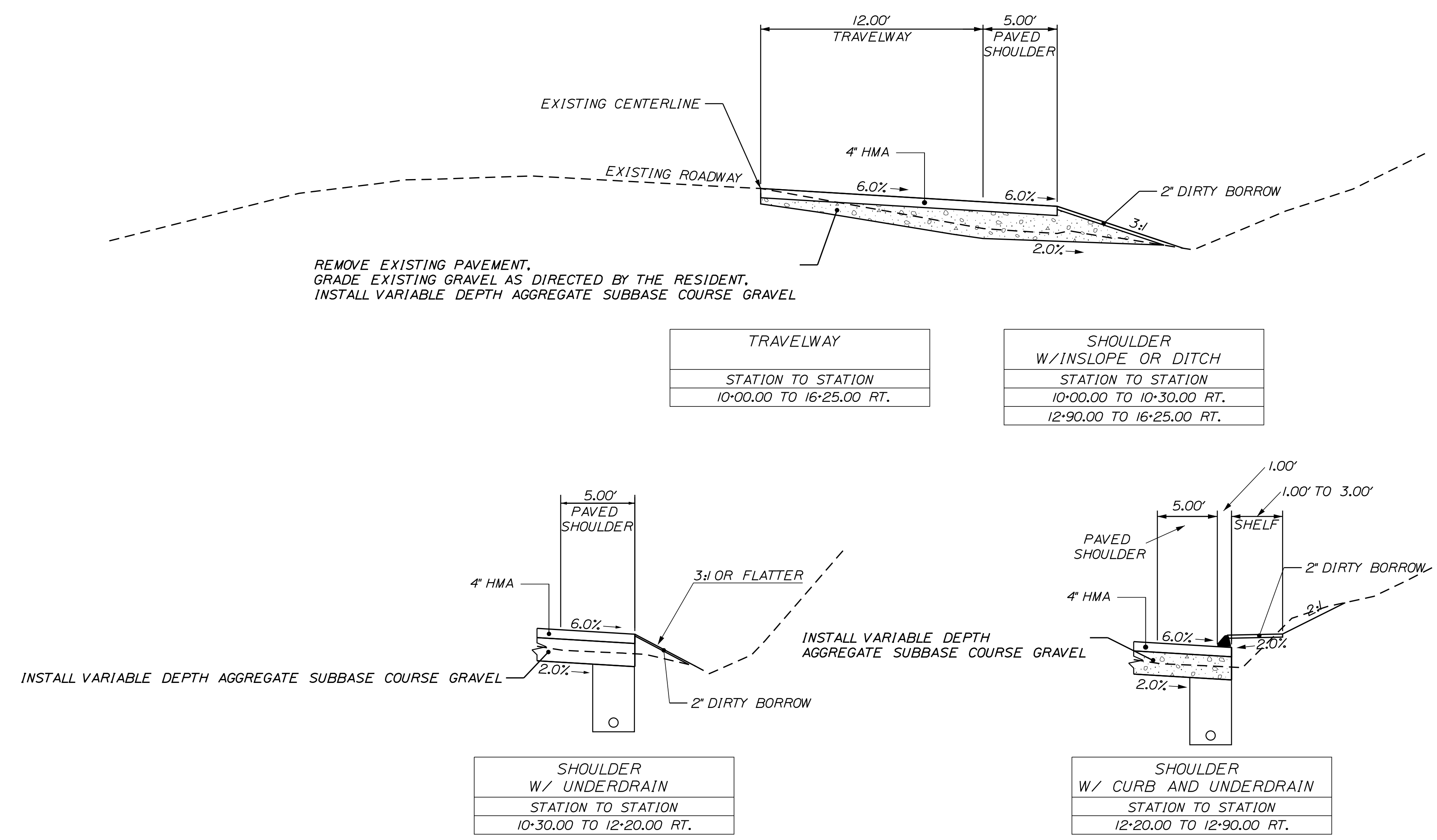

SIGNATURE	P.E. NUMBER
DATE	DATE

PROJ. MANAGER	ROB BETZ	BY	DATE
DESIGN-DETAILED	R. ILLIAN		
CHECKED-REVIEWED			
DESIGN-DETAILED			
REVISIONS 1			
REVISIONS 2			
REVISIONS 3			
REVISIONS 4			
FIELD CHANGES			

**SABATTUS
ROUTE 132
TYPICAL SECTIONS**

NOT TO SCALE

ESTIMATED QUANTITIES

Item	Item Description	Quantity	Unit
203.20	COMMON EXCAVATION	300	CY
203.21	ROCK EXCAVATION	40	CY
206.07	STRUCTURAL ROCK EXCAVATION - DRAINAGE AND MINOR STRUCTURES	30	CY
304.10	AGGREGATE SUBBASE COURSE - GRAVEL	400	CY
403.208	HOT MIX ASPHALT 12.5 MM HMA SURFACE	110	T
403.213	HOT MIX ASPHALT 12.5 MM BASE	170	T
409.15	BITUMINOUS TACK COAT - APPLIED	30	G
603.17	18 INCH CULVERT PIPE OPTION I	40	LF
604.09	CATCH BASIN TYPE B1 'W/ BEEHIVE GRATE	1	EA
605.09	6 INCH UNDERDRAIN TYPE B	260	LF
605.10	6 INCH UNDERDRAIN OUTLET	40	LF
609.31	CURB TYPE 3	70	LF
610.08	PLAIN RIPRAP	10	CY
613.319	EROSION CONTROL BLANKET	140	SY
615.10	DIRTY BORROW	30	CY
618.14	SEEDING METHOD NUMBER 2	4	UN
619.12	MULCH	4	UN
620.58	EROSION CONTROL GEOTEXTILE	5	SY
627.733	4" WHITE OR YELLOW PAINTED PAVEMENT MARKING LINE	1500	LF
627.78	TEMPORARY 4 INCH PAINTED PAVEMENT MARKING LINE, WHITE OR YEL LOW	1500	LF
629.05	HAND LABOR, STRAIGHT TIME	10	HR
631.12	ALL PURPOSE EXCAVATOR (INCLUDING OPERATOR)	5	HR
631.14	GRADER (INCLUDING OPERATOR)	5	HR
631.172	TRUCK - LARGE (INCLUDING OPERATOR)	5	HR
631.32	CULVERT CLEANER (INCLUDING OPERATOR)	1	HR
652.33	DRUM	20	EA
652.34	CONE	50	EA
652.35	CONSTRUCTION SIGNS	240	SF
652.36	MAINTENANCE OF TRAFFIC CONTROL DEVICES	8	CD
652.38	FLAGGER	140	HR
656.75	TEMPORARY SOIL EROSION AND WATER POLLUTION CONTROL	1	LS
659.10	MOBILIZATION	1	LS

EARTHWORK SUMMARY

COMMON EXCAVATION FOR ESTIMATE

COMMON EXCAVATION (FROM CROSS SECTIONS)	=	<u>250</u>	=	<u>250</u>
TOTAL COMMON EXCAVATION (for estimate)			=	<u>250</u>

FILL FOR BORROW CALCULATIONS

COMMON FILL (FROM CROSS SECTIONS)	=	<u>38</u>	=	<u>38</u>
TOTAL FILL			=	<u>38</u>

ROCK EXCAVATION FOR ESTIMATE

ROCK EXCAVATION (FROM CROSS SECTIONS)	=	<u>40</u>	=	<u>40</u>
TOTAL ROCK EXCAVATION			=	<u>40</u>

AVAILABLE COMMON EXCAVATION FOR BORROW CALCULATIONS

(1) TOTAL COMMON EXCAVATION	=	<u>250</u>		
DEDUCTIONS:				
PAVEMENT SALVAGE (CUT & FILL)	=	<u>139</u>		
(2) TOTAL DEDUCTIONS	=	<u>139</u>		
TOTAL AVAILABLE COMMON EXCAVATION (1) MINUS (2)	=	<u>111</u>		
TOTAL AVAILABLE STRUCT. EXCAVATIONS	=	<u>51</u>		
TOTAL AVAILABLE NON-ROCK EXCAVATION	=	<u>162</u>		

COMPUTATION FOR COMMON BORROW FOR ESTIMATE

(3)TOTAL FILL	=	<u>38</u>		
TOTAL AVAIL. NON-ROCK EXCAV.	<u>162</u> x 0.90 =	<u>146</u>		
TOTAL AVAIL. ROCK EXCAV.	<u>40</u> x 1.30 =	<u>52</u>		
TOTAL AVAIL. STR. ROCK EXCAV.	<u>30</u> x 1.30 =	<u>39</u>		
(4)TOTAL AVAILABLE EXCAVATION	=	<u>237</u>		
BORROW NEEDED	=	<u>-199</u>		

SURPLUS MATERIAL = 199

NOTE: ALL CALCULATIONS ARE IN CUBIC YARDS

STATE OF MAINE DEPARTMENT OF TRANSPORTATION STP-1864(900) WIN 18649.00 HIGHWAY PLANS	DESIGN-DETAILED CHECKED-REVIEWED DESIGN-DETAILED REVISIONS 1 REVISIONS 2 REVISIONS 3 REVISIONS 4 FIELD CHANGES	DATE BY ROB BETZ R. LIJIAN	SIGNATURE P.E. NUMBER DATE
SABATTUS ROUTE 132 ESTIMATED QUANTITIES	SHEET NUMBER <h1 style="margin: 0;">3</h1> OF 13		

Date: 3/14/2018

Username: Randy Illion

Division: HIGHWAY

Filename: ... \HIGHWAY\MSTA\003_Estimate.dgn

GENERAL NOTES

- 1. ALL INSLOPE AND DITCHES IN CUT AREAS SHALL BE GRADED AS SHOWN ON THE TYPICALS OR FLATTER, OR AS DIRECTED BY THE RESIDENT.
- 2. THE CONTRACTOR SHALL PLAN AND CONDUCT THEIR WORK ACCORDINGLY SO THAT UPON FINAL COMPLETION OF THE PROJECT THERE IS NO DROP-OFF FROM THE EDGE OF SHOULDER PAVEMENT.
- 3. ALL WASTE MATERIAL NOT USED ON THE PROJECT SHALL BE DISPOSED OF OFF THE PROJECT IN ACCEPTABLE WASTE AREAS REVIEWED BY THE RESIDENT. GRADING, SEEDING AND MULCHING OF WASTE AREAS SHALL BE CONSIDERED INCIDENTAL.
- 4. REQUIRED DITCH PROTECTION SHOWN ON THE PLANS OR IN THE CONSTRUCTION NOTES IS FOR ESTIMATING PURPOSES ONLY. THE ACTUAL TYPE AND LOCATION OF DITCH PROTECTION MAY BE ALTERED BY THE RESIDENT.
- 5. ANY NECESSARY CLEANING OF EXISTING PAVEMENT PRIOR TO PAVING (OR MILLING) SHALL BE INCIDENTAL TO THE RELATED PAVING (OR MILLING) ITEMS. THIS INCLUDES KILLING AND REMOVAL OF ALL VEGETATIVE MATTER.
- 6. PRIOR TO SURFACE PAVING, EXISTING CULVERTS TO REMAIN SHALL BE CLEANED AS DIRECTED BY THE RESIDENT. PAYMENT WILL BE MADE UNDER ITEM 631.32 CULVERT CLEANER (INCLUDING OPERATOR).
- 7. NO EXISTING DRAINAGE SHALL BE ABANDONED, REMOVED OR PLUGGED WITHOUT PRIOR APPROVAL OF THE RESIDENT.
- 8. INLETS AND OUTLETS OF ALL CULVERTS SHALL BE RIPRAPPED UNLESS OTHERWISE NOTED ON THE PLANS OR DIRECTED BY THE RESIDENT.
- 9. THE CULVERT SIZES SHOWN ON THE PLANS AND CROSS SECTIONS ARE FOR SMOOTHLINED PIPES. FOR COMPARABLE CORRUGATED SIZES SEE THE DRAINAGE TABULATION.
- 10. PLASTIC END CAPS SHALL BE USED ON ALL DEAD-END 6-INCH TYPE B UNDERDRAIN AND SHALL BE CONSIDERED INCIDENTAL.
- 11. ANY NECESSARY CUTTING OF EXISTING PIPES TO FIT IN AREAS OF PROPOSED CATCH BASINS WILL NOT BE PAID FOR SEPARATELY AND WILL BE CONSIDERED INCIDENTAL TO ITEM 604.
- 12. ANY NECESSARY CUTTING OF EXISTING CATCH BASINS TO ALLOW FOR PROPOSED PIPE CONNECTIONS WILL NOT BE PAID FOR SEPARATELY AND WILL BE CONSIDERED INCIDENTAL TO ITEM 603 OR 605.
- 13. AS DIRECTED BY THE RESIDENT, ALL EXISTING UNDERDRAIN OUTLETS SHALL BE LOCATED, CLEANED OUT AND DITCHED AS REQUIRED OR REPLACED AS NECESSARY. PAYMENT WILL BE MADE UNDER APPROPRIATE CONTRACT ITEMS.
- 14. ALL UNDERDRAIN NOT SHOWN ON THE CROSS SECTIONS WILL HAVE A FLOW LINE OF 5.5 FEET BELOW FINISH GRADE DIRECTLY ABOVE THE UNDERDRAIN AND UNDERDRAIN SAND BACKFILL PLACED TO AN ELEVATION EQUAL TO THE BOTTOM OF THE NEW GRAVEL LAYER. ALL UNDERDRAIN SHOWN ON THE CROSS SECTIONS WILL HAVE THE FLOW LINE SCALED FROM THE CROSS SECTIONS. ALL FLOW LINE ELEVATIONS ARE SUBJECT TO APPROVAL BY THE RESIDENT.
- 15. A 3 FT. X 3 FT. SQUARE RIPRAP PAD SHALL BE CONSTRUCTED AT UNDERDRAIN OUTLETS.

- 16. BACKING UP BITUMINOUS OR CONCRETE SLIPFORM CURB IS INCIDENTAL TO THE CURB ITEMS. IN AREAS WHERE NEW BITUMINOUS OR CONCRETE SLIPFORM CURB IS DESIGNATED TO REPLACE EXISTING, THE REMOVAL OF THE OLD BITUMINOUS OR CONCRETE SLIPFORM CURB SHALL BE INCIDENTAL TO THE NEW CURB. IF CALLED FOR ON THE PLANS OR DIRECTED BY THE RESIDENT, LOAM OR DIRTY BORROW WILL BE PAID FOR SEPARATELY.
- 17. DIRTY BORROW HAS BEEN ESTIMATED FOR ALL DISTURBED SLOPE AREAS OTHER THAN LAWN AREAS. ACTUAL PLACEMENT OF THE DIRTY BORROW SHALL BE AS NOTED ON THE PLANS OR DESIGNATED BY THE RESIDENT.
- 18. UNLESS OTHERWISE NOTED SEEDING METHOD NO. 1 SHALL BE UTILIZED ON ALL LAWNS AND DEVELOPED AREAS; SEEDING METHOD NO. 2 SHALL BE UTILIZED ON ALL OTHER AREAS.
- 19. DIRTY BORROW SHALL BE PLACED TO A NOMINAL DEPTH OF 2 INCHES UNLESS OTHERWISE NOTED OR DIRECTED.
- 20. THE CONTRACTOR WILL BE RESPONSIBLE FOR MAINTAINING ALL EXISTING MAILBOXES TO ENSURE THAT THE MAIL WILL BE DELIVERABLE. PAYMENT FOR THIS WORK WILL BE MADE UNDER THE APPROPRIATE RENTAL ITEMS.
- 21. THE CONTRACTOR IS RESPONSIBLE FOR THE CAREFUL SIDE STAKING OF EXISTING CENTERLINE AS PER STANDARD SPECIFICATION 105.6.2. SIDE STAKES SHALL BE PLACED SAFELY OUTSIDE OF THE CONSTRUCTION LIMITS AND THE EXISTING CENTERLINE GRADES SHALL BE TRANSFERRED TO THESE STAKES. THESE STAKES AND GRADES WILL BE USED TO LAYOUT CENTERLINE AND DETERMINE NEW CONSTRUCTION FINISH GRADES FROM DIFFERENTIAL ELEVATION SHEETS FURNISHED BY MAINEDOT. ALL LAYOUT, STAKES, AND GRADES WILL BE CHECKED AND MUST BE ACCEPTABLE TO THE RESIDENT.
- 22. ANY DAMAGE TO THE SLOPES CAUSED BY THE CONTRACTOR'S EQUIPMENT, PERSONNEL, OR OPERATION SHALL BE REPAIRED TO THE SATISFACTION OF THE RESIDENT. ALL WORK, EQUIPMENT, AND MATERIALS REQUIRED TO MAKE REPAIRS SHALL BE AT THE CONTRACTOR'S EXPENSE.
- 23. AREAS REQUIRING FILL ON THE PROJECT WILL COME FROM SUITABLE EXCAVATION FROM EXCAVATION, DITCH AND INSLOPE OR EQUIPMENT RENTAL AREAS.
- 24. ESTIMATED QUANTITIES FOR REQUIRED STRUCTURAL EARTH EXCAVATION, DRAINAGE AND MINOR STRUCTURES ARE INFORMATIONAL ONLY AND REPRESENT THE APPROXIMATE MINIMUM QUANTITY REQUIRED TO INSTALL DRAINAGE STRUCTURES. ADDITIONAL EXCAVATION FOR THE CONTRACTOR'S CONVENIENCE OR TO COMPLY WITH BACKSLOPING REQUIREMENTS WILL NOT BE PAID FOR DIRECTLY BUT WILL BE CONSIDERED INCIDENTAL TO THE RELATED DRAINAGE ITEMS.
- 25. NO SEPARATE PAYMENT FOR SUPERINTENDENT OR FOREMAN WILL BE MADE FOR THE SUPERVISION OF EQUIPMENT AND LAYOUT OF WORK BEING PAID FOR UNDER THE EQUIPMENT RENTAL ITEMS.
- 26. "UNDETERMINED LOCATIONS" SHALL BE DETERMINED BY THE RESIDENT.

- 27. FINAL STRIPING FOR THE PROJECT SHALL BE DONE BY THE CONTRACTOR PER THE STRIPING LAYOUT IN THE CONTRACT DOCUMENTS OR AS PROVIDED BY THE DEPARTMENT. PAYMENT SHALL BE MADE UNDER APPROPRIATE CONTRACT ITEMS.
- 28. THE CONTRACTOR WILL PLACE APPROPRIATELY MARKED STAKES AT THE FOLLOWING LOCATIONS ON THE PROJECT: STRIPING PATTERN CHANGES, CROSS-SLOPE CHANGES, AND EVERY 500' FOR STATIONING. THE CONTRACTOR WILL PAINT EVERY FULL STATION (100') ON THE EXISTING ROADWAY AND WILL TRANSFER THE PAINTED STATIONING THROUGH ALL INTERMEDIATE LIFTS (NOT SURFACE). APPROPRIATELY SIZED STRIPING PATTERN CHANGES WILL BE PAINTED ON SURFACE. STATIONING CONTROL MUST BE PLACED BEFORE WORK CAN COMMENCE. CROSS-SLOPE AND STRIPING CHANGE CONTROLS MUST BE PLACED BEFORE PAVING CAN COMMENCE.
- 29. EXCLUDING WATER AND GAS GATE VALVES, ALL HMA FOR PATCHING AROUND ADJUSTED, ALTERED, OR REBUILT UTILITY STRUCTURES SHALL MEET THE GRADATION REQUIREMENTS OF A 9.5 MM OR 12.5 MM MIXTURE. THE CONTRACTOR SHALL SAW CUT THE EXISTING PAVEMENT FOR THE PATCH AT LEAST TWO FEET AWAY FROM THE NEAREST EDGE OF THE STRUCTURE. THE CONTRACTOR SHALL PLACE HMA IN LIFTS OF 3" OR LESS, AS DIRECTED BY THE RESIDENT, AND COMPACT THE HMA USING A MINIMUM OF A 150 POUND PLATE COMPACTOR. HMA FOR PATCHING AROUND ADJUSTED, ALTERED, OR REBUILT UTILITY STRUCTURES IS CONSIDERED INCIDENTAL TO THE RESPECTIVE PAY ITEM FOR ADJUST, ALTER, OR REBUILD UTILITY STRUCTURE.

STATE OF MAINE DEPARTMENT OF TRANSPORTATION	STP-1864(900)	WIN 18649.00	HIGHWAY PLANS
PROJ. MANAGER	ROB BETZ	BY	DATE
DESIGN-DETAILED	R. JILLIAN	SIGNATURE	DATE
CHECKED-REVIEWED		P.E. NUMBER	DATE
DESIGN-DETAILED		DATE	DATE
DESIGN-DETAILED		DATE	DATE
REVISIONS 1		DATE	DATE
REVISIONS 2		DATE	DATE
REVISIONS 3		DATE	DATE
REVISIONS 4		DATE	DATE
FIELD CHANGES		DATE	DATE
SABATTUS ROUTE 132 GENERAL NOTES			
SHEET NUMBER			
4			
OF 13			

CONSTRUCTION NOTES

603.17 18 INCH CULVERT PIPE OPTION I

<u>STATION TO</u>	<u>STATION</u>	<u>SIDE</u>
13+05	13+45	RT

604.09 CATCH BASIN TYPE B1

<u>STATION</u>	<u>SIDE</u>
13+05	RT

NOTE: BEEHIVE FRAME SHALL BE CAST DIRECTLY INTO THE FLAT TOP BASIN.

605.09 6 INCH UNDERDRAIN TYPE B

<u>STATION TO</u>	<u>STATION</u>	<u>SIDE</u>
10+35	12+95	RT

605.10 6 INCH UNDERDRAIN OUTLET

<u>STATION TO</u>	<u>STATION</u>	<u>SIDE</u>
10+00	10+40	RT

609.31 CURB TYPE 3

<u>STATION TO</u>	<u>STATION</u>	<u>SIDE</u>
12+20	12+90	RT

610.08 RIP RAP

<u>STATION</u>	<u>SIDE</u>	<u>COMMENT</u>
10+00	RT	U.D. OUTLET
12+10	RT	DOWNSPOUT
13+50	RT	CULVERT END

615.10 DIRTY BORROW

EXACT LOCATIONS WILL BE DETERMINED IN THE FIELD BY THE RESIDENT.

627.733 4 INCH WHITE OR YELLOW PAINTED PAVEMENT MARKING LINE

FINAL STRIPING WILL NOT COMMENCE UNTIL 10 DAYS HAVE ELAPSED FROM THE COMPLETION OF SURFACE PAVEMENT AND MUST BE COMPLETED WITHIN 20 DAYS OF THE COMPLETION OF SURFACE PAVEMENT. UNLESS OTHERWISE DIRECTED, FAILURE TO COMPLY WILL RESULT IN A TRAFFIC CONTROL VIOLATION.

ONCE CONSTRUCTION IS COMPLETE, MAINTENANCE OF TRAFFIC CONTROL DEVICES (652.36) WILL NOT BE PAID WHILE WAITING TO FINAL STRIPE.

ONCE CONSTRUCTION IS COMPLETE, LIQUIDATED DAMAGES WILL NOT BE CHARGED WHILE WAITING TO FINAL STRIPE.

627.78 TEMPORARY PAVEMENT MARKING LINE WHITE OR YELLOW

TEMPORARY CENTER LINES SHALL BE PAINTED ON ALL MATCHED PAVEMENT WITHIN ONE WEEK. TEMPORARY EDGE LINES SHALL BE PAINTED ON ALL PAVEMENT LAYERS WITHIN FOUR WEEKS. ALL TEMPORARY LINES SHALL BE PAINTED PRIOR TO FINAL STRIPING.

MULTILANE SECTIONS, TRUCK LANES, AND MILLED SURFACES MUST BE STRIPED DAILY ON ALL MATCHED PAVEMENT LAYERS.

TOMS MUST BE USED ON ALL PAVEMENT LAYERS UNTIL TEMPORARY PAINT IS APPLIED. TOMS WILL BE REMOVED BEFORE FINAL STRIPING.

TOM REMOVAL WILL BE ADDRESSED IN THE TRAFFIC CONTROL PLAN.

ONLY PAINTED TEMPORARY LINE WILL BE PAID UNDER THIS ITEM. TOMS WILL BE CONSIDERED INCIDENTAL TO THE CONTRACT.

629 & 631 HOURLY RENTAL ITEMS

ITEMS WILL BE USED FOR GRADING THE EXISTING GRAVEL, CLEANING DRAINAGE, AND AS DIRECTED BY THE RESIDENT

GRADER ITEM WILL BE USED TO STRAIGHT GRADE THE EXISTING GRAVEL BEFORE VARIABLE GRAVEL IS ADDED.

STATE OF MAINE
DEPARTMENT OF TRANSPORTATION
STP-1864(900)
WIN
18649.00
HIGHWAY PLANS

PROJ. MANAGER	ROB BETZ	BY	DATE
DESIGN-DETAILED	R. ILLIAN		
CHECKED-REVIEWED			
DESIGN-DETAILED			
REVISIONS 1			
REVISIONS 2			
REVISIONS 3			
REVISIONS 4			
FIELD CHANGES			

SABATTUS
ROUTE 132
CONSTRUCTION NOTES

SHEET NUMBER
5
OF 13

Date: 3/14/2018

Username: Randy.illian

Division: HIGHWAY

Filename: ... \005_Construction_Notes.dgn

Date: 3/14/2018

Username: Randy Jillean

Division: HIGHWAY

Filename: ... \HIGHWAY\MSTA\006_HDPLAN1.DGN

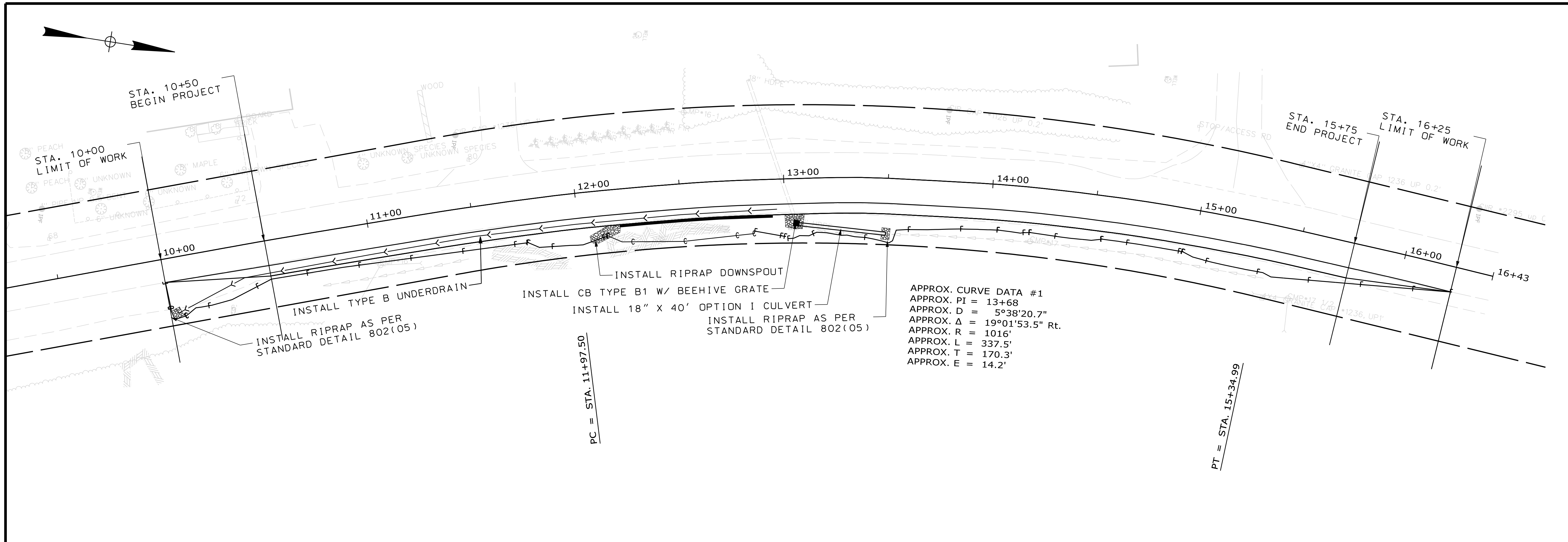

APPROX. CURVE DATA #1
 APPROX. PI = 13+68
 APPROX. D = 5°38'20.7" Rt.
 APPROX. R = 1016'
 APPROX. L = 337.5'
 APPROX. T = 170.3'
 APPROX. E = 14.2'

PC = STA. 11+97.50

PT = STA. 15+34.99

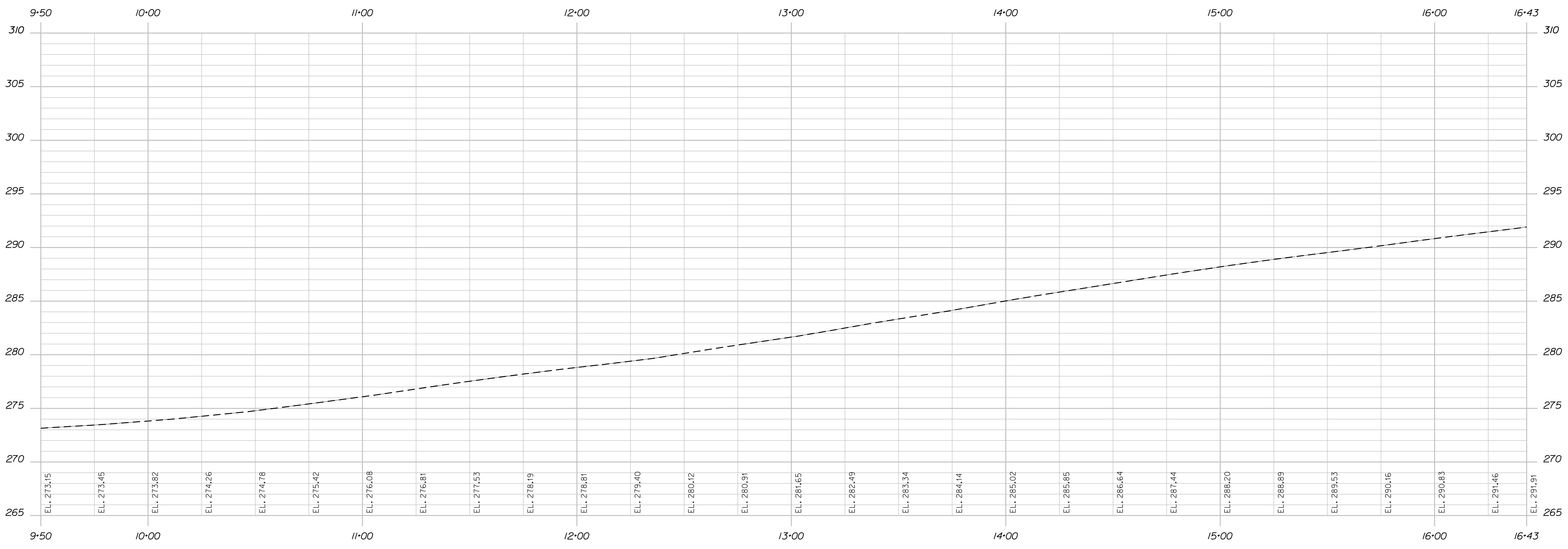

APPROXIMATE EXISTING PROFILE

STATE OF MAINE DEPARTMENT OF TRANSPORTATION		STP-1864(900)	
WIN 18649.00		HIGHWAY PLANS	
SABATTUS ROUTE 132		PLANS	
SHEET NUMBER		6	
OF 13			

PROJ. MANAGER	ROB BETZ	BY	DATE
DESIGN-DETAILED	R. JILLEAN		
CHECKED-REVIEWED			
DESIGN-DETAILED			
REVISIONS 1			
REVISIONS 2			
REVISIONS 3			
REVISIONS 4			
FIELD CHANGES			

Date: 3/14/2018

Username: Randy Illian

Division: HIGHWAY

Filename: ... \MSTAN008_XSECT_11+00_002.dgn

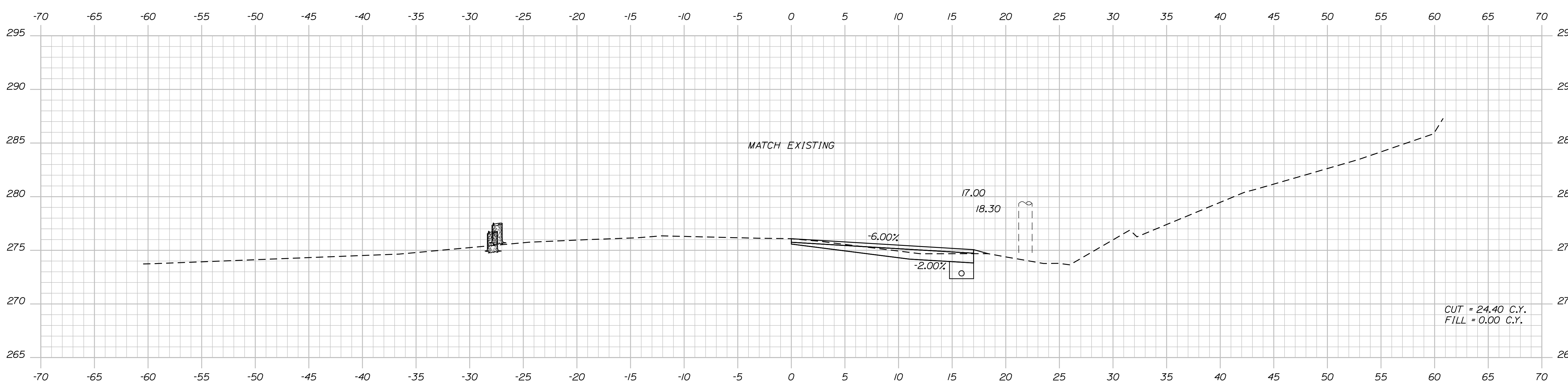
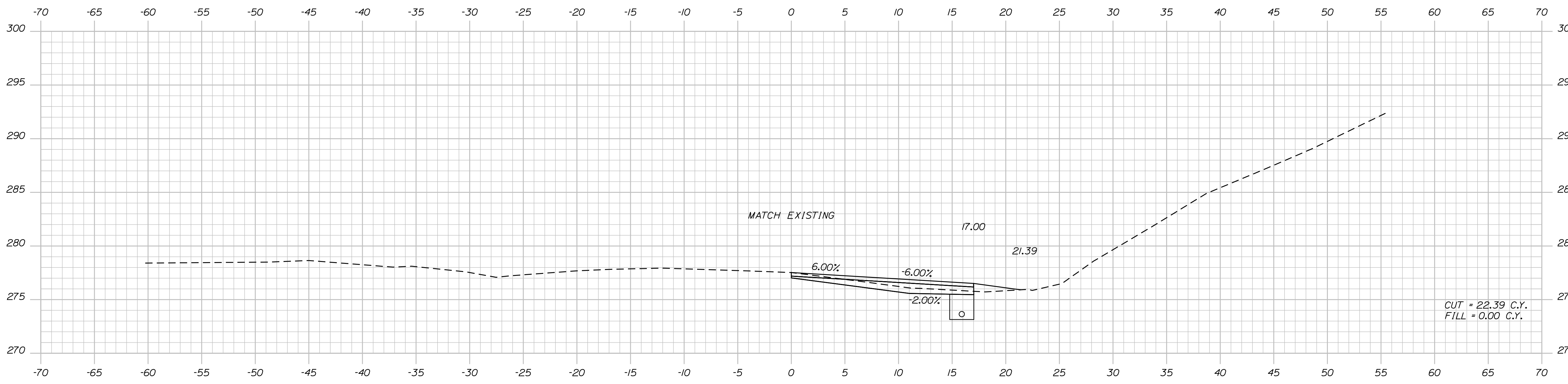

STATE OF MAINE
DEPARTMENT OF TRANSPORTATION
STP-1864(900)
WIN
18649.00
HIGHWAY PLANS

PROJ. MANAGER	ROB BETZ	BY	DATE
DESIGN DETAILED	R. ILLIAN		
CHECKED-REVIEWED			
DESIGN DETAILED			
REVISIONS 1			
REVISIONS 2			
REVISIONS 3			
REVISIONS 4			
FIELD CHANGES			

SABATTUS
ROUTE 132
CROSS SECTIONS

SHEET NUMBER
8
OF 13

Date: 3/14/2018

Username: Randy Illian

Division: HIGHWAY

Filename: ... \MSTAN009_XSECT_12+00_003.dgn

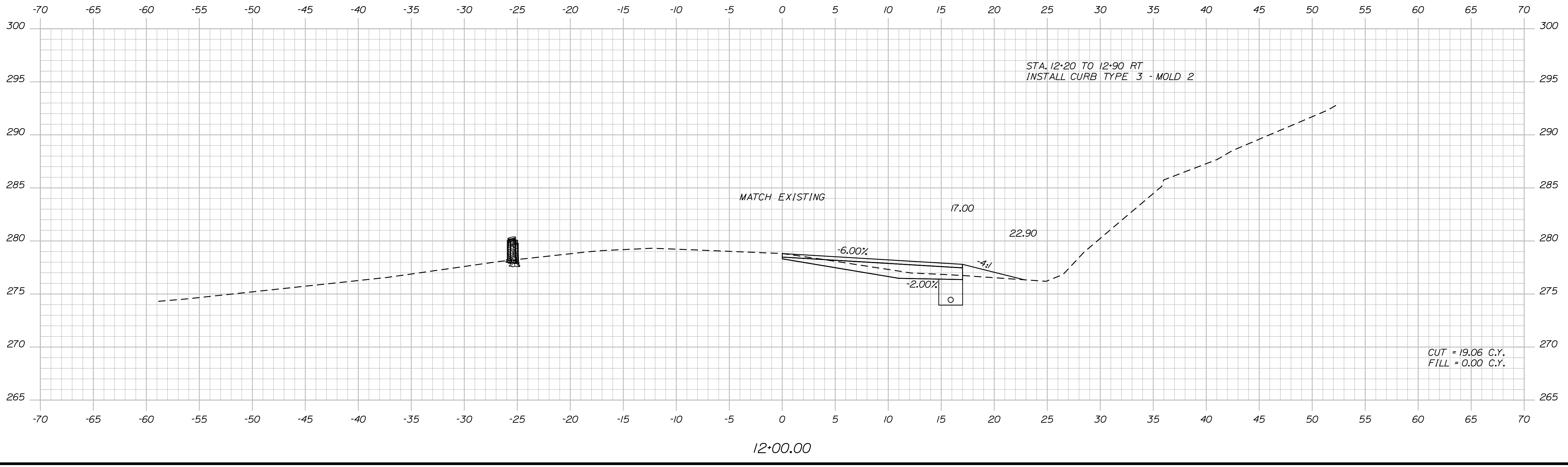
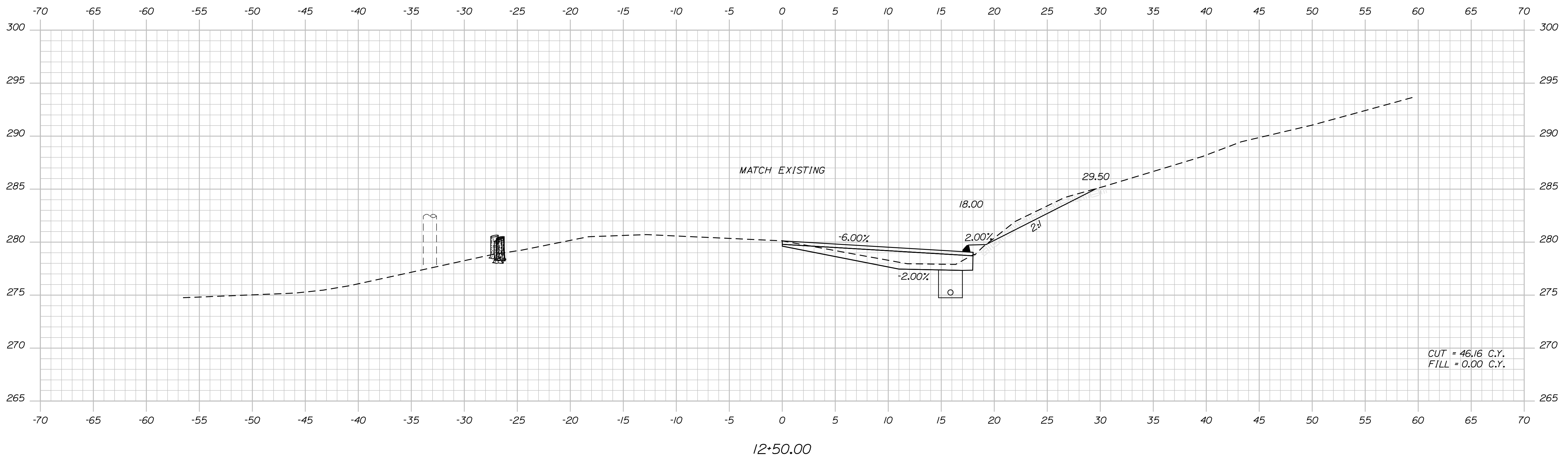

STATE OF MAINE
DEPARTMENT OF TRANSPORTATION
STP-1864(900)
WIN
18649.00
HIGHWAY PLANS

PROJ. MANAGER	ROB BETZ	BY	DATE
DESIGN DETAILED	R. ILLIAN		
CHECKED/REVIEWED			
DESIGN DETAILED			
DESIGN DETAILED			
REVISIONS 1			
REVISIONS 2			
REVISIONS 3			
REVISIONS 4			
FIELD CHANGES			

SABATTUS
ROUTE 132
CROSS SECTIONS

SHEET NUMBER
9
OF 13

Date: 3/14/2018

Username: Randy Illian

Division: HIGHWAY

Filename: ... \MSTAN010_XSECT_13+00_004.dgn

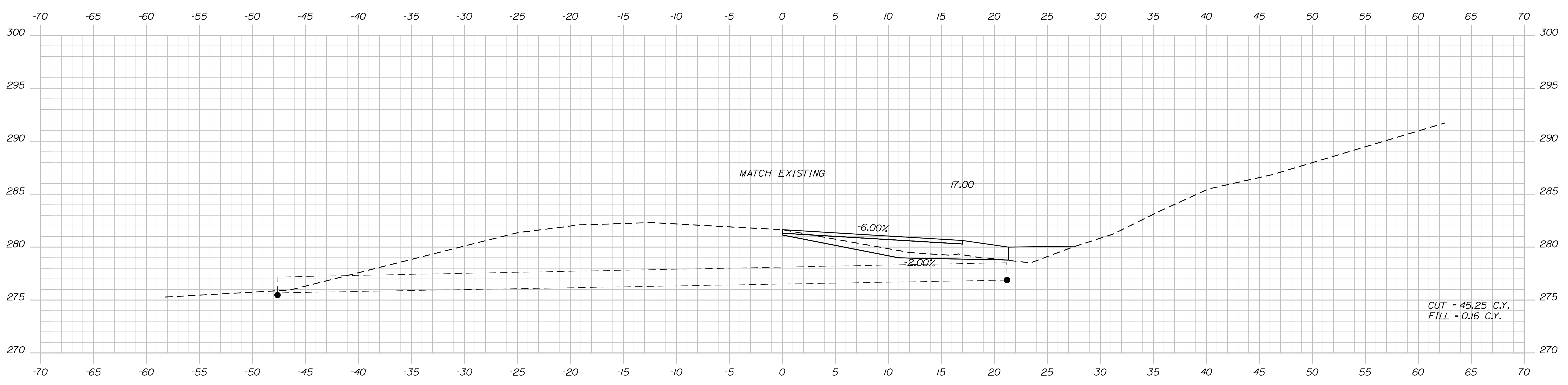
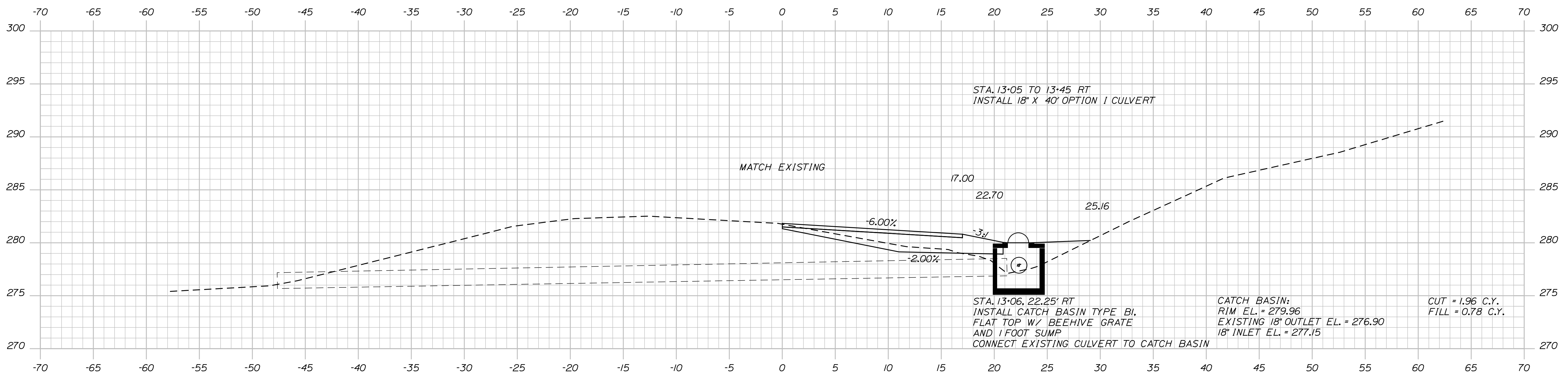

STATE OF MAINE
DEPARTMENT OF TRANSPORTATION
STP-1864(900)
WIN
18649.00
HIGHWAY PLANS

DESIGN-DETAILED	BY	DATE	SIGNATURE
CHECKED-REVIEWED	ROB BETZ		
DESIGN-DETAILED	R. ILLIAN		
DESIGN-DETAILED			
REVISIONS 1			P.E. NUMBER
REVISIONS 2			DATE
REVISIONS 3			
REVISIONS 4			
FIELD CHANGES			

PROJ. MANAGER
SABATTUS
ROUTE 132
CROSS SECTIONS

SHEET NUMBER
10
OF 13

Date: 3/14/2018

Username: Randy Jillion

Division: HIGHWAY

Filename: ... \MSTAN011_XSECT_13+50_005.dgn

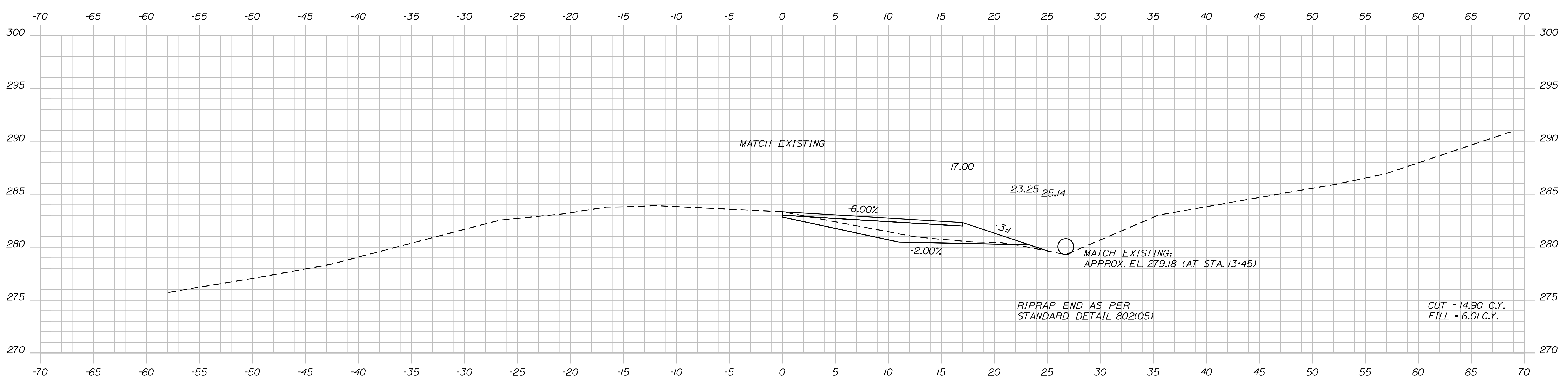
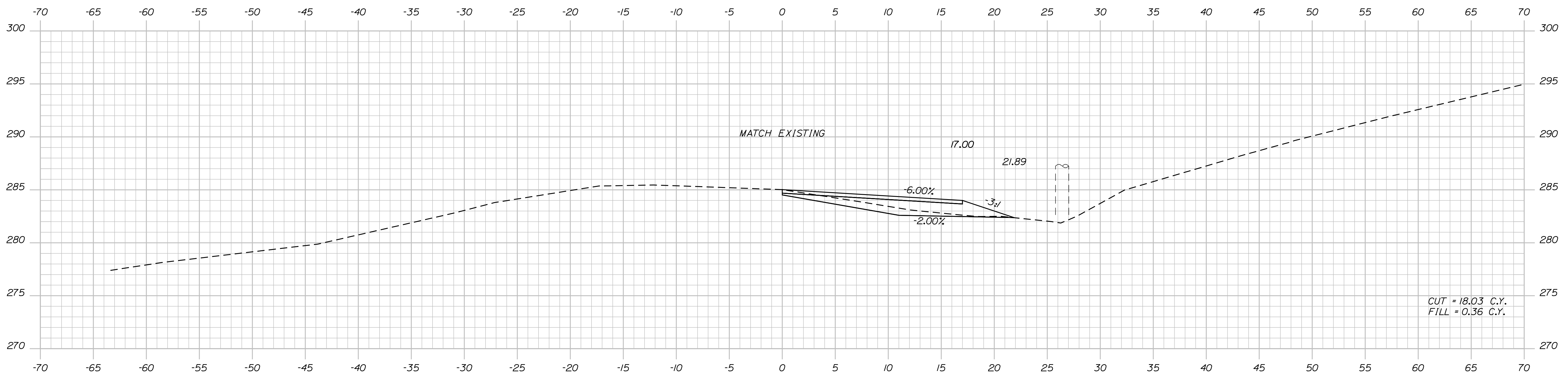

STATE OF MAINE
DEPARTMENT OF TRANSPORTATION
STP-1864(900)
WIN
18649.00
HIGHWAY PLANS

PROJ. MANAGER	ROB BETZ	BY	DATE
DESIGN DETAILED	R. JILLIAN		
CHECKED-REVIEWED			
DESIGN DETAILED			
REVISIONS 1			
REVISIONS 2			
REVISIONS 3			
REVISIONS 4			
FIELD CHANGES			

SABATTUS
ROUTE 132
CROSS SECTIONS

SHEET NUMBER
11
OF 13

Date: 3/14/2018

Username: Randy Illian

Division: HIGHWAY

Filename: ... \MST\A012_XSECT_14+50_006.dgn

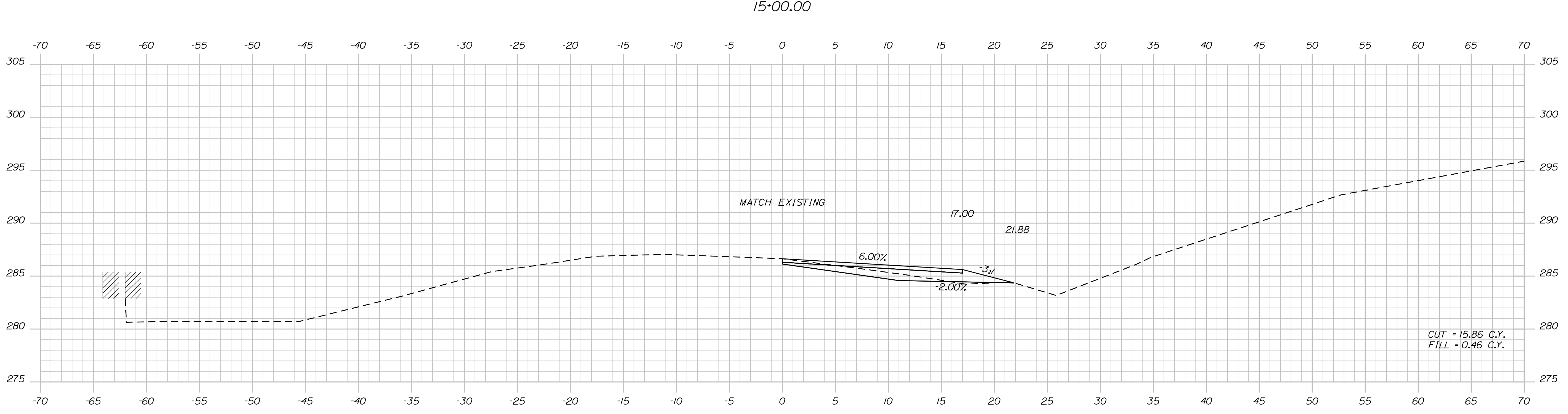
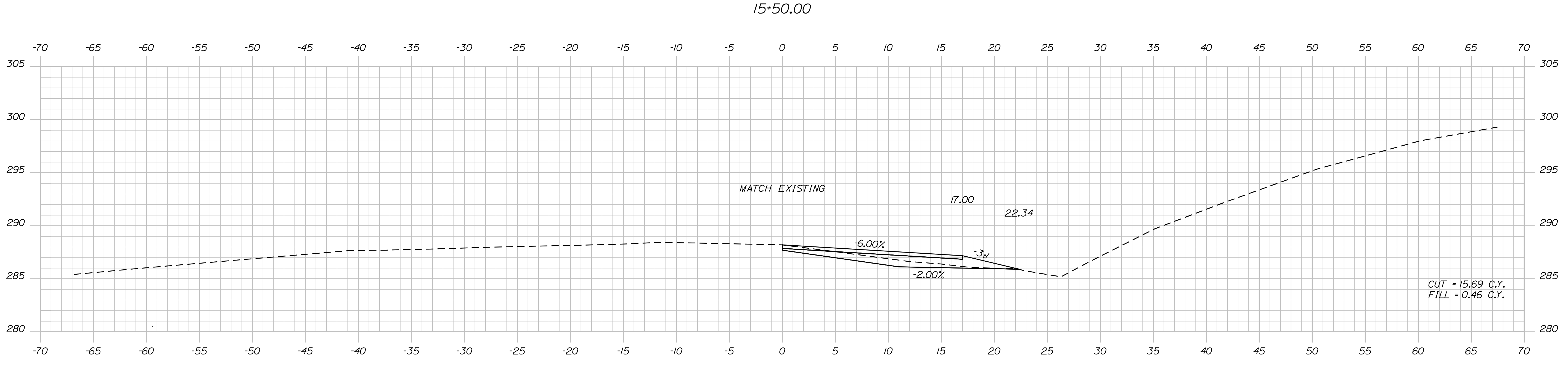
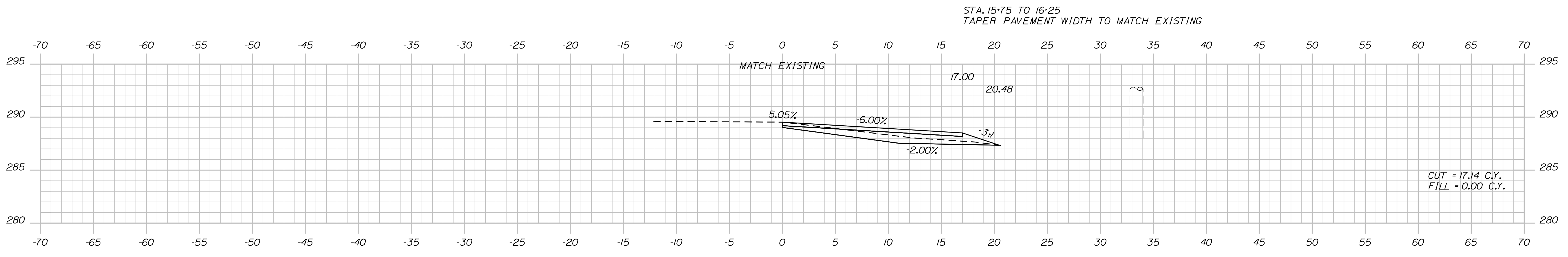

STATE OF MAINE
DEPARTMENT OF TRANSPORTATION
STP-1864(900)
WIN
18649.00
HIGHWAY PLANS

PROJ. MANAGER	ROB. BETZ	BY	DATE
DESIGN-DETAILED	R. ILLIAN		
CHECKED-REVIEWED			
DESIGN-DETAILED			
REVISIONS 1			
REVISIONS 2			
REVISIONS 3			
REVISIONS 4			
FIELD CHANGES			

SABATTUS
ROUTE 132
CROSS SECTIONS

SHEET NUMBER
12
OF 13

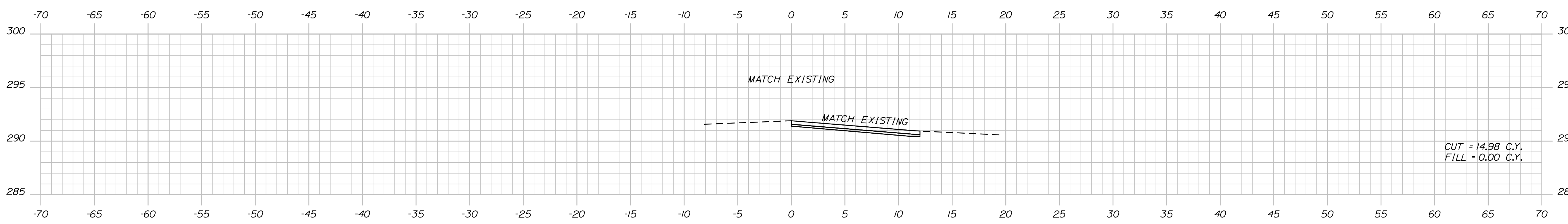

16+25.00

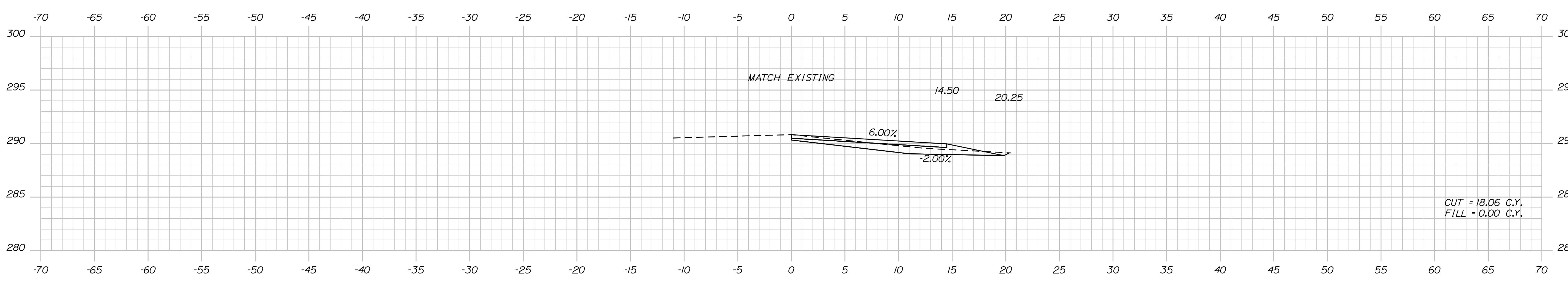

16+00.00

STATE OF MAINE
DEPARTMENT OF TRANSPORTATION
STP-1864(900)
WIN
18649.00
HIGHWAY PLANS

PROJ. MANAGER	ROB BETZ	BY	DATE
DESIGN DETAILED	R. ILLIAN		
CHECKED-REVIEWED			
DESIGN DETAILED			
REVISIONS 1			
REVISIONS 2			
REVISIONS 3			
REVISIONS 4			
FIELD CHANGES			

SABATTUS
ROUTE 132
CROSS SECTIONS

SHEET NUMBER
13
OF 13