

STATE OF MAINE DEPARTMENT OF TRANSPORTATION



LUBEC WASHINGTON COUNTY SOUTH LUBEC ROAD

18317.00

PROJECT LENGTH : 0.26 MILES

PLAN LEGEND

Town, County, State	-----	Centerline-Existing	-----
Property Lines	-----	Centerline-Proposed	-----
R/W Lines-Existing	-----	Travelway-Existing	-----
R/W Lines-Proposed	-----	Travelway-Proposed	-----
Culvert-Existing	=====	Railroad	=====
Culvert Proposed	=====	Catch Basins	Existing ■ Proposed
Curbing Existing	=====	Manholes	Existing ○ Proposed ●
Curbing Proposed	=====	Proposed Underdrain	----->
Type 1	=====	Proposed Ditch	----->
Type 3	=====	Existing Ditch	----->
Type 5	=====	Utility Poles	Existing ◆ Proposed ◆
Outline of Bodies of Water	=====	Fire Hydrants	Existing ⊙ Proposed ⊙
Ledge	=====	Existing Water Line	-----
Buildings	=====	Existing San. Sewer	----->
Trees	Conifer ⊙ Deciduous ⊙	Existing San. Sewer Manhole	⊙
Tree Line	=====	Guardrail-Existing	-----
Clearing Limit Line	CLL -----	Guardrail-Proposed	-----
		Guardrail-Cable, Other	-----

INDEX OF SHEETS

Description	Sheet No.
Title Sheet	1
Typical Sections	2
Plan / Profile	3-4
Cross - Sections	5-8
Right of Way Map	9

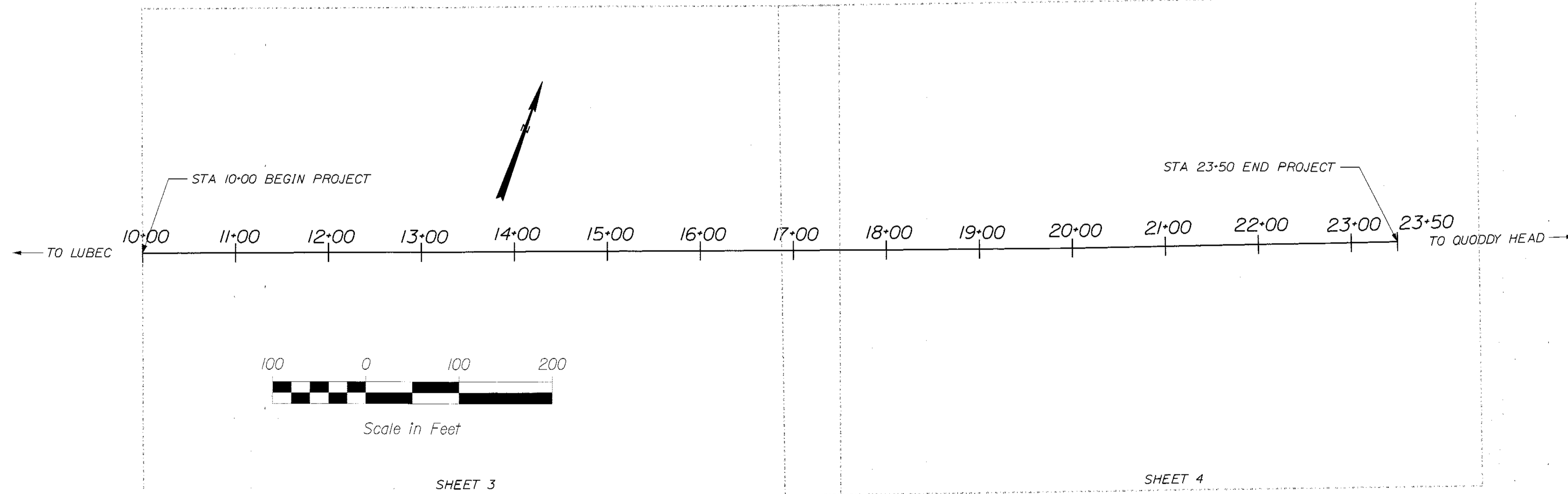

TRAFFIC DATA

Current (2012) AADT 460

PROJECT LOCATION:	CAUSEWAY ON SOUTH LUBEC ROAD IN LUBEC
PROGRAM AREA:	HIGHWAY PROGRAM
SCOPE OF WORK:	Miscellaneous Safety Improvements

WIN 18317.00 01831700

LUBEC
SOUTH LUBEC ROAD
TITLE SHEET

SHEET NUMBER
1
OF 9

PROJECT INFORMATION	
PROGRAM	
PROJECT MANAGER	
DESIGNER	
CONSULTANT	
PROJECT RESIDENT	
CONTRACTOR	
PROJECT COMPLETION DATE	

Signature
SIGNATURE
P.E. NUMBER
12-20-11
DATE

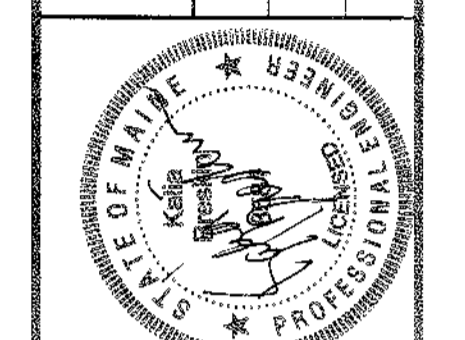

STATE OF MAINE DEPARTMENT OF TRANSPORTATION	
APPROVED	<i>Signature</i>
DATE	12/20/11
COMMISSIONER	<i>Signature</i>
CHIEF ENGINEER	<i>Signature</i>

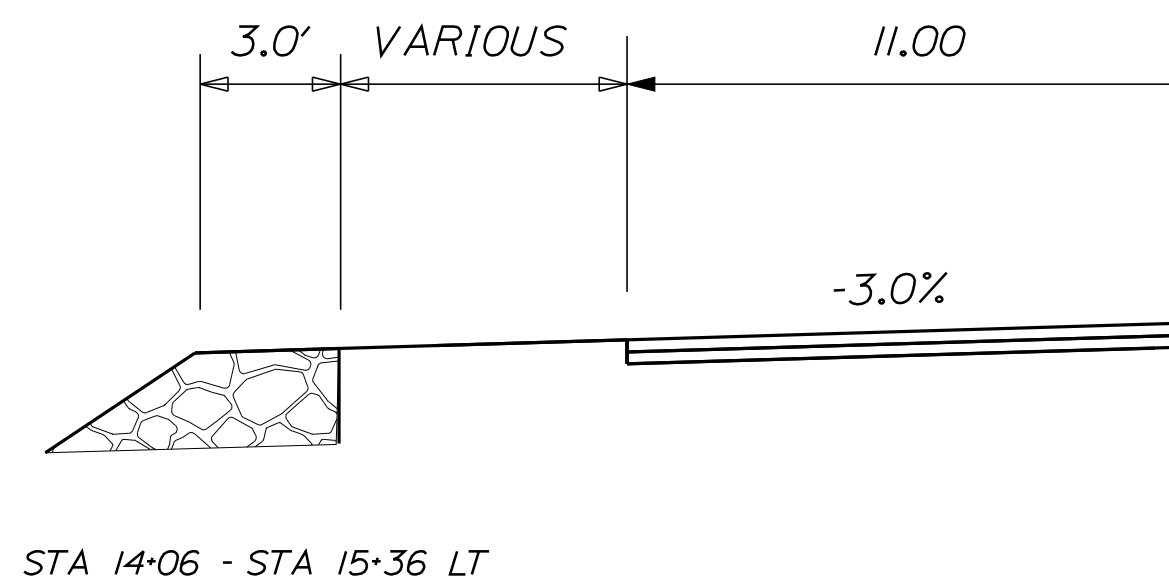
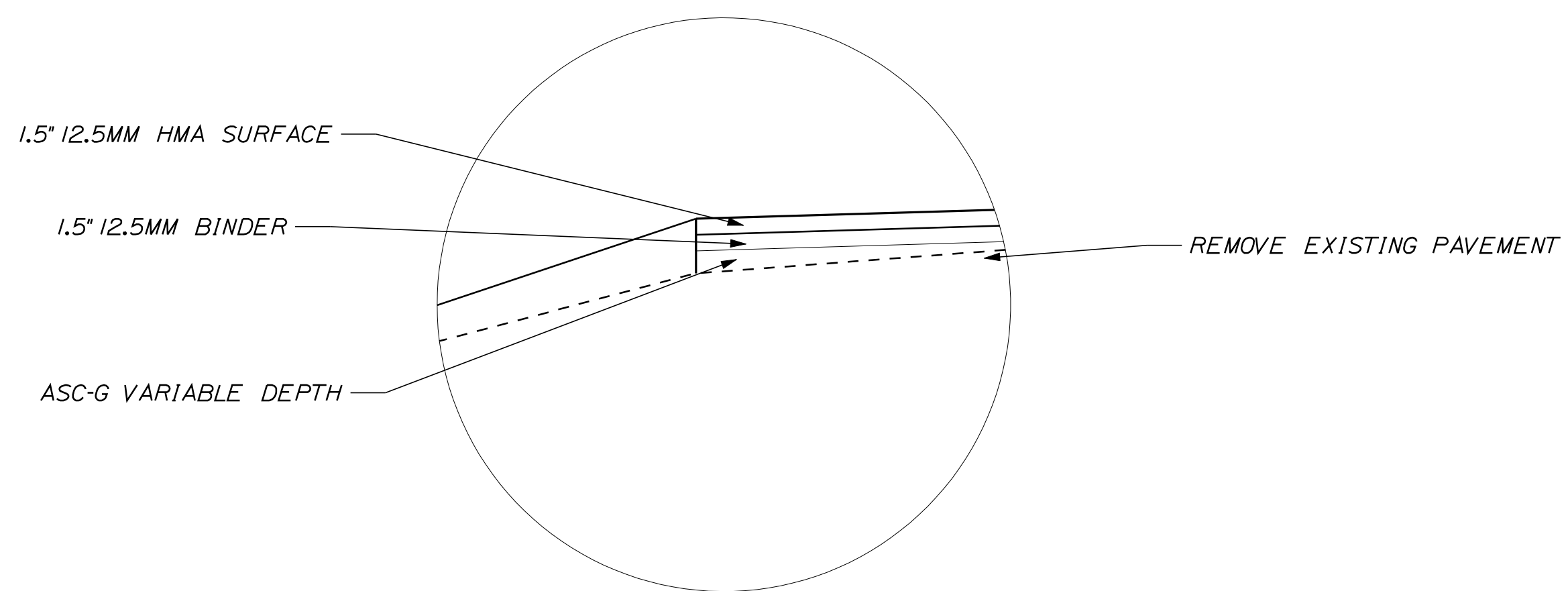
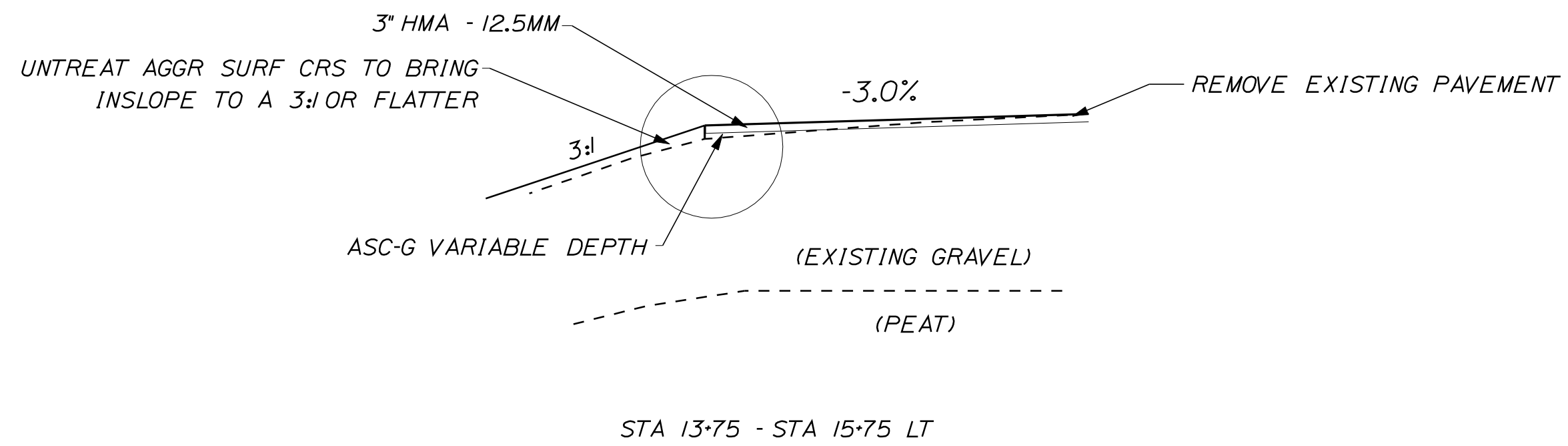

NOTE:

1. THE PAVEMENT, BASE AND SUBBASE DEPTHS AS SHOWN ON THE PLANS ARE INTENDED TO BE NOMINAL.
2. WHEN SUPERELEVATION EXCEEDS THE SLOPE OF THE LOW SIDE SHOULDER, THE LOW SIDE SHOULDER SHALL HAVE THE SAME SLOPE AS THE TRAVELWAY.
3. CROWNS FOR BOTH NORMAL AND SUPERELEVATION SECTIONS FOR ALL COURSES OF SUBBASE AND PAVEMENT SHALL BE STRAIGHT.
4. THE GRAVEL QUANTITY CALCULATION IS BASED ON A 2" LOAM OR DIRTY BORROW DEPTH. THE ACTUAL DEPTH MAY VARY. SEE THE GENERAL NOTES.
5. THE ALGEBRAIC DIFFERENCE BETWEEN THE SHOULDER AND TRAVELWAY CROSS SLOPES "ROLLOVER" SHALL NOT EXCEED 8%.
6. THE STATIONING SHOWN UNDER EACH TYPICAL IS APPROXIMATE.

STATE OF MAINE
 DEPARTMENT OF TRANSPORTATION

01831700

PIN
 18317.00

HIGHWAY PLANS

PROJ. MANAGER	BY	DATE	SIGNATURE	P.E. NUMBER	DATE
DESIGN DETAILED					
CHECKED-REVIEWED					
DESIGN DETAILED					
REVISIONS 1					
REVISIONS 2					
REVISIONS 3					
REVISIONS 4					
FIELD CHANGES					

LUBEC
 SOUTH LUBEC ROAD
 TYPICAL SECTIONS

SHEET NUMBER

2

OF 9

NOT TO SCALE

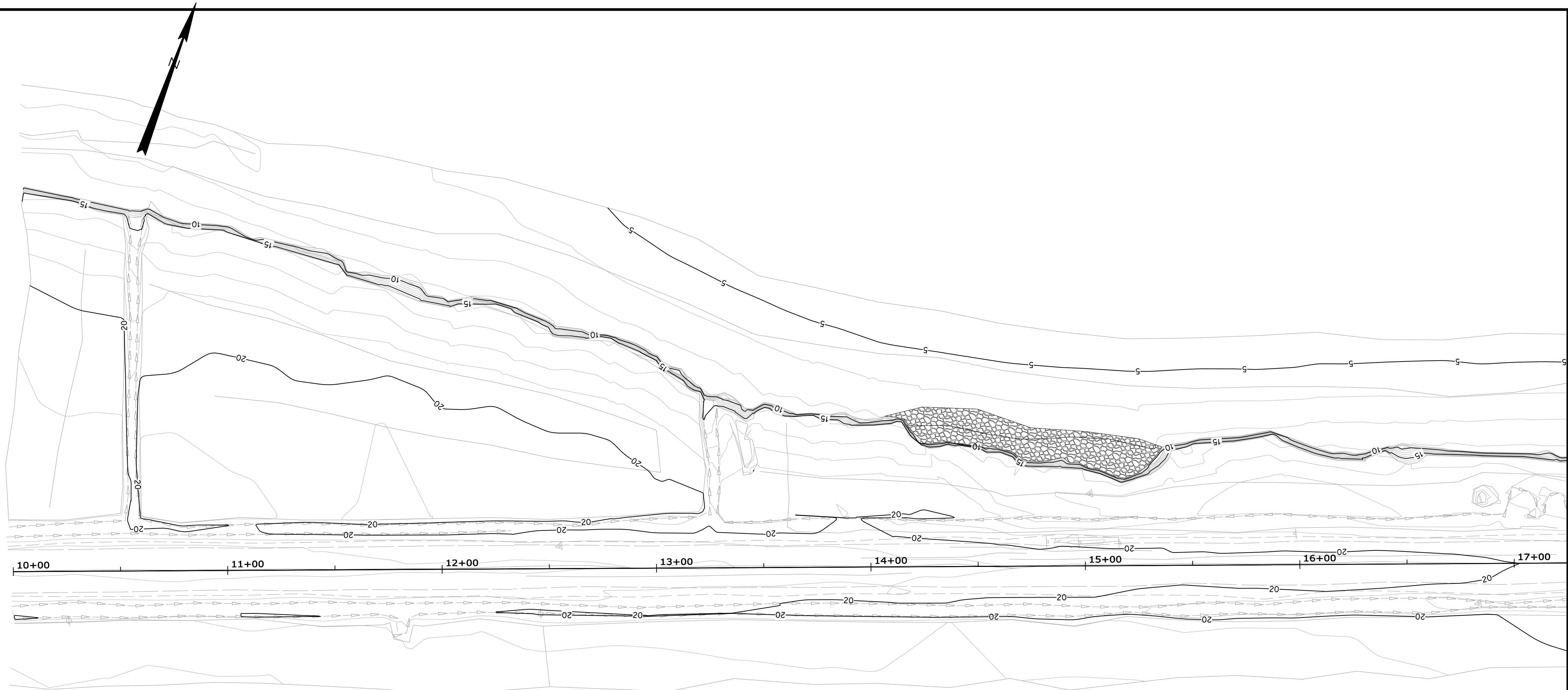

STATE OF MAINE
DEPARTMENT OF TRANSPORTATION
01831700
PIN
18317.00
HIGHWAY PLANS

PROJ. MANAGER	BY	DATE	SIGNATURE
DESIGN DETAILED			
CHECKED-REVIEWED			
DESIGN DETAILED			
DESIGN DETAILED			
REVISIONS 1			
REVISIONS 2			
REVISIONS 3			
REVISIONS 4			
FIELD CHANGES			

LUBEC
SOUTH LUBEC ROAD
PLANS

SHEET NUMBER
3
OF 9

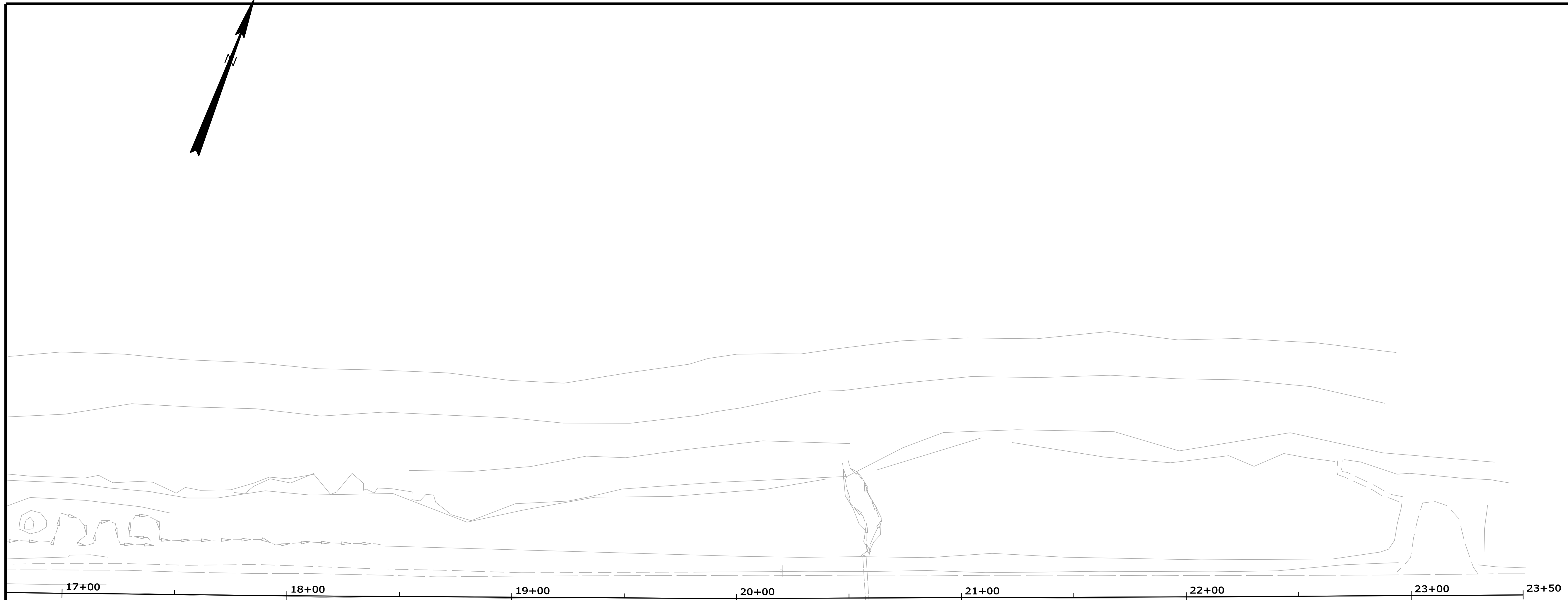

STATE OF MAINE
DEPARTMENT OF TRANSPORTATION
01831700
PIN 18317.00
HIGHWAY PLANS

PROJ. MANAGER	BY	DATE
DESIGN-DETAILED		
CHECKED-REVIEWED		
DESIGN-DETAILED		
DESIGN-DETAILED		
REVISIONS 1		
REVISIONS 2		
REVISIONS 3		
REVISIONS 4		
FIELD CHANGES		

LUBEC
SOUTH LUBEC ROAD
PLANS

SHEET NUMBER
4
OF 9

Username: joshua.n.mallman Date: 12/28/2011

Division: HIGHWAY

Filename: ... \msta\005_Xsect_14+00_001.dgn

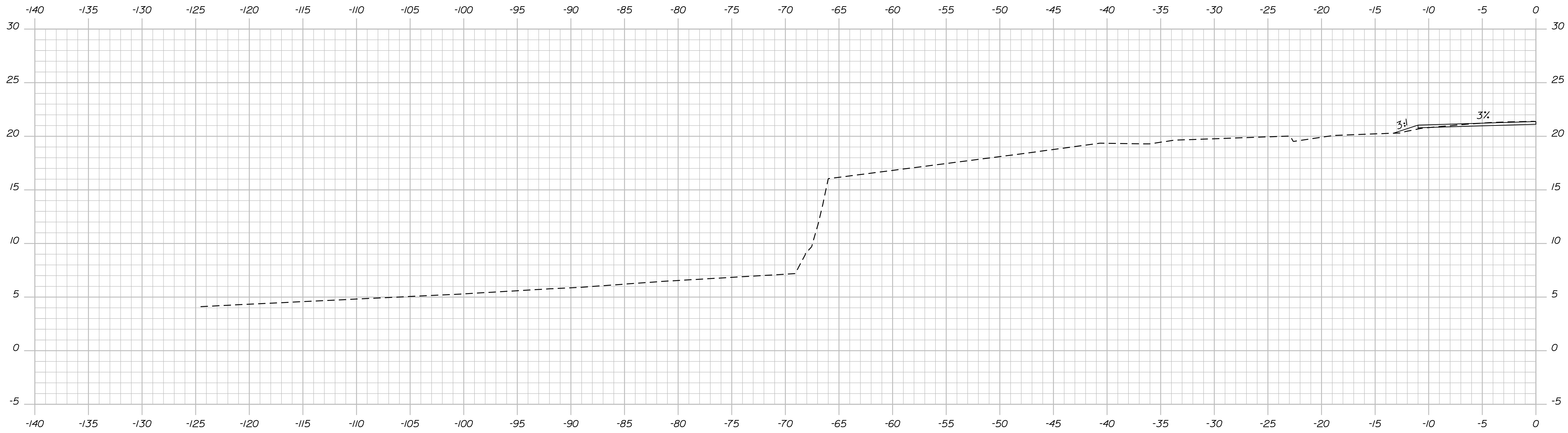
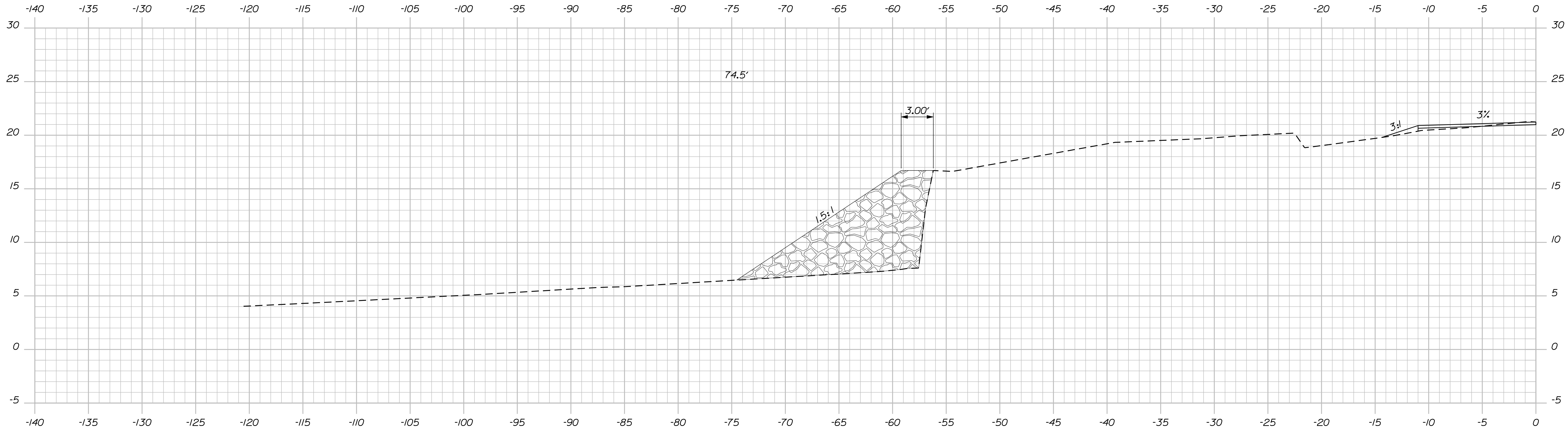

STATE OF MAINE
DEPARTMENT OF TRANSPORTATION

01831700

PIN
18317.00

HIGHWAY PLANS

SIGNATURE

P.E. NUMBER

DATE

PROJ. MANAGER

BY

DATE

DESIGN DETAILED

CHECKED/REVIEWED

DESIGNS DETAILED

REVISIONS 1

REVISIONS 2

REVISIONS 3

REVISIONS 4

FIELD CHANGES

LUBEC
LUBEC ROAD

CROSS SECTIONS

SHEET NUMBER

5

OF 9

Username: joshua.n.mallman Date: 12/28/2011

Division: HIGHWAY

Filename: ... \msta\006_Xsect_14+50_002.dgn

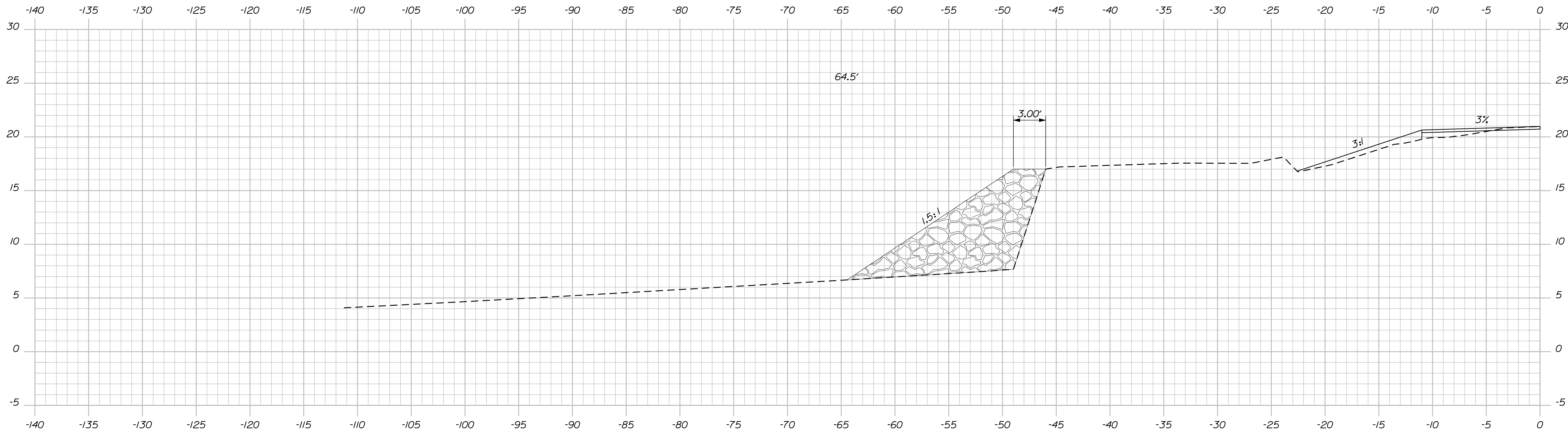

14+75.00

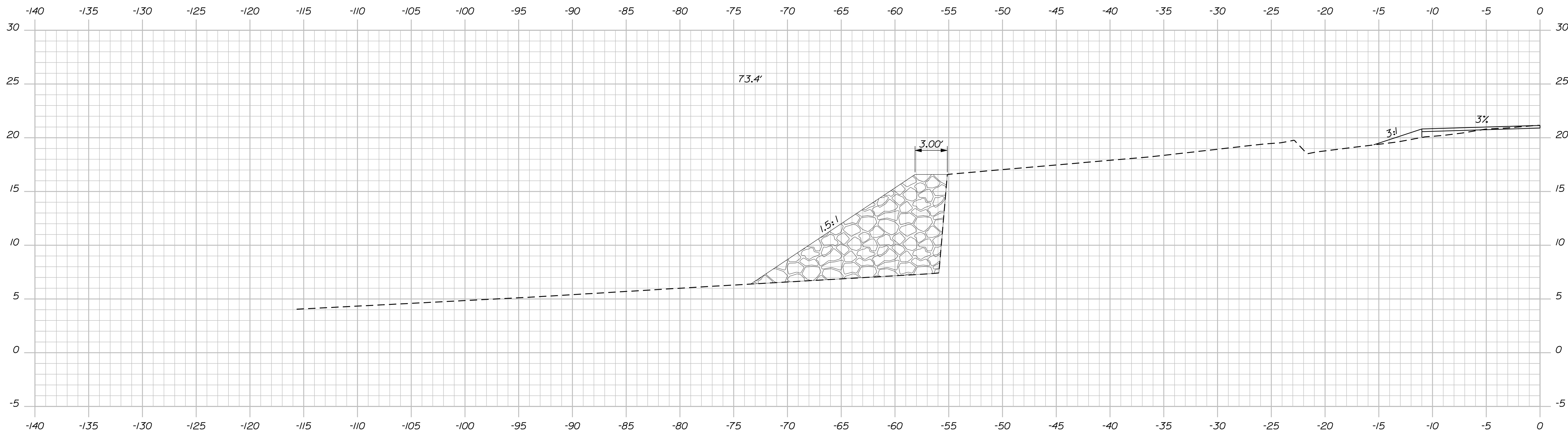

14+50.00

STATE OF MAINE
DEPARTMENT OF TRANSPORTATION

01831700

PIN
18317.00

HIGHWAY PLANS

SIGNATURE

P.E. NUMBER

DATE

BY

DATE

PROJ. MANAGER

DESIGN DETAILED

CHECKED/REVIEWED

DESIGNS DETAILED

REVISIONS 1

REVISIONS 2

REVISIONS 3

REVISIONS 4

FIELD CHANGES

LUBEC
LUBEC ROAD

CROSS SECTIONS

SHEET NUMBER

6

OF 9

Username: joshua.n.mallman Date: 12/28/2011

Division: HIGHWAY

Filename: ... \msta\007_Xsect_15+00_003.dgn

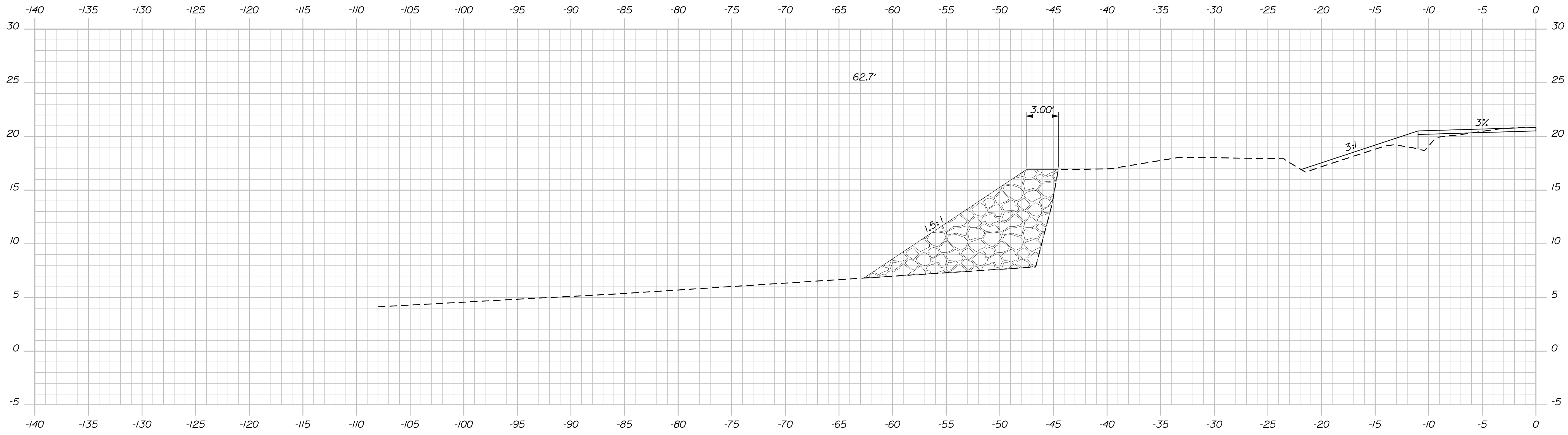
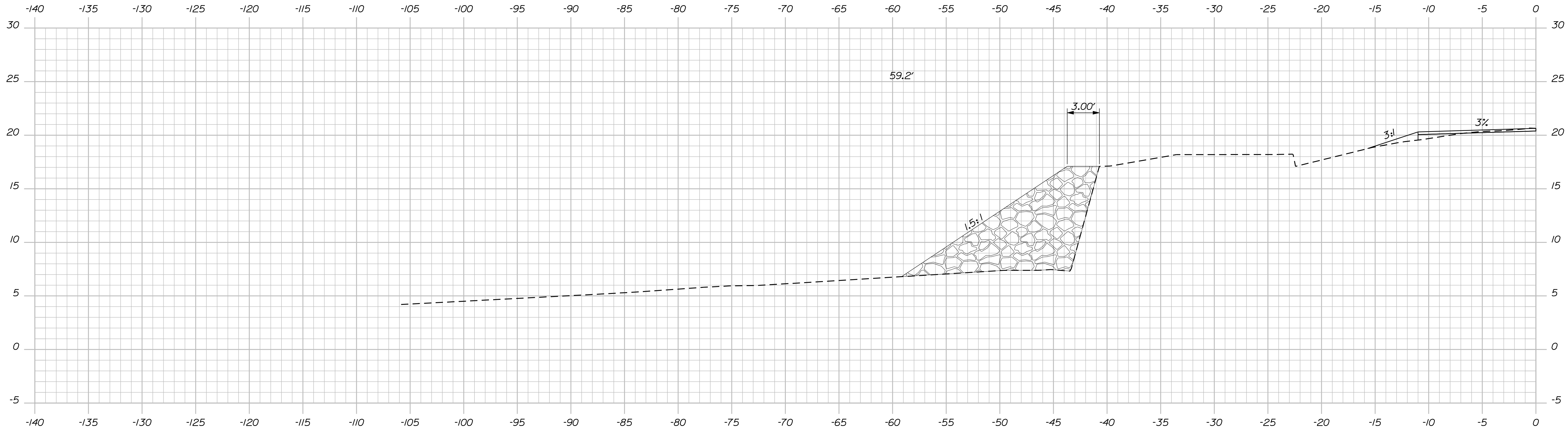

STATE OF MAINE
DEPARTMENT OF TRANSPORTATION

01831700

PIN
18317.00

HIGHWAY PLANS

SIGNATURE

P.E. NUMBER

DATE

DATE

BY

DATE

DESIGN DETAILED

CHECKED/REVIEWED

DESIGNS DETAILED

DESIGNS DETAILED

REVISIONS 1

REVISIONS 2

REVISIONS 3

REVISIONS 4

FIELD CHANGES

LUBEC
SOUTH LUBEC ROAD

CROSS SECTIONS

SHEET NUMBER

7

OF 9

Sta. 15+00.00 to Sta. 15+25.00

Filename: ... \00\ROW\MSTA001_RWPLAN1.dgn
 Division: HIGHWAY
 Username: joshua.n.mallman
 Date: 1/3/2012

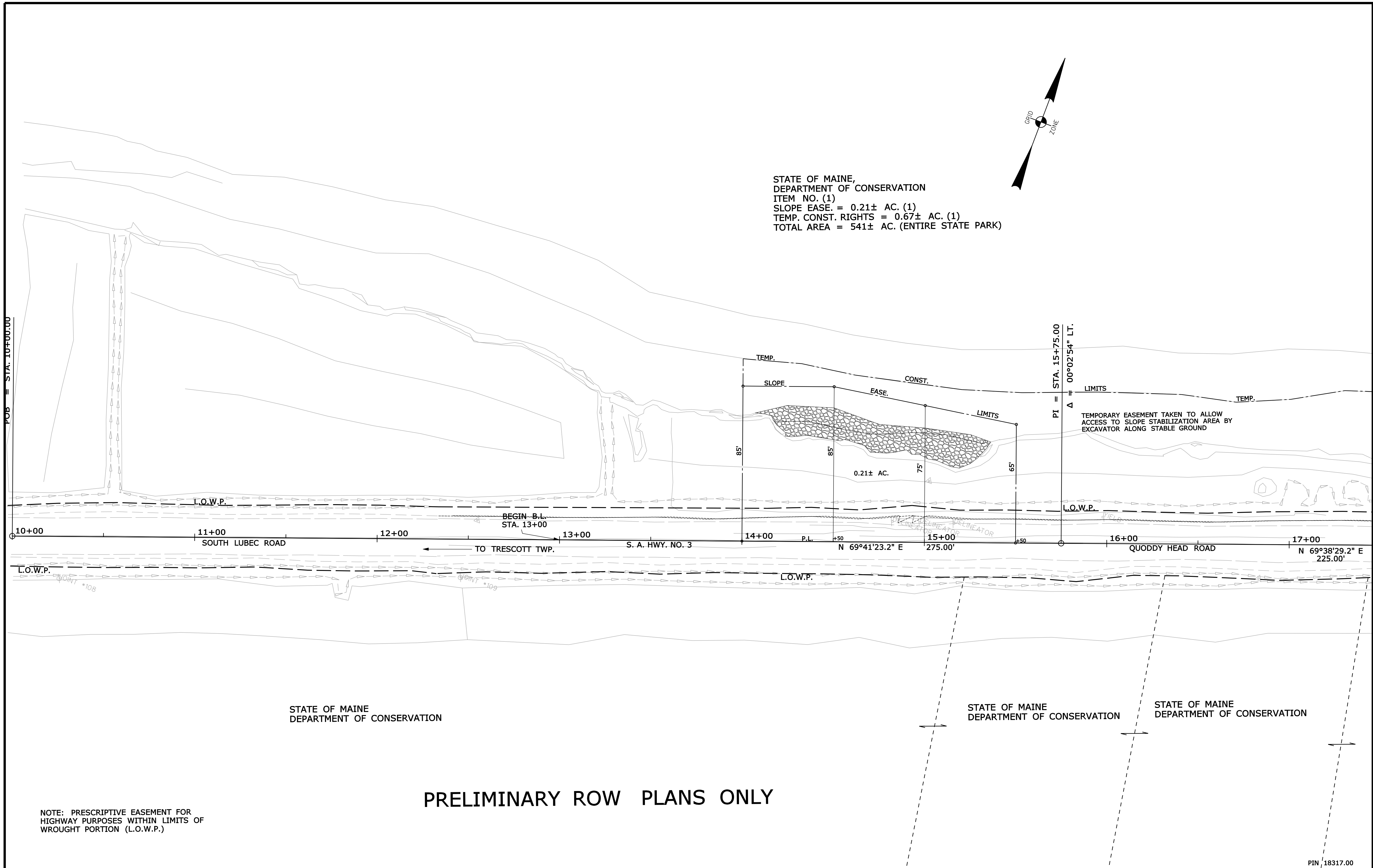

STATE OF MAINE,
 DEPARTMENT OF CONSERVATION
 ITEM NO. (1)
 SLOPE EASE. = 0.21± AC. (1)
 TEMP. CONST. RIGHTS = 0.67± AC. (1)
 TOTAL AREA = 541± AC. (ENTIRE STATE PARK)

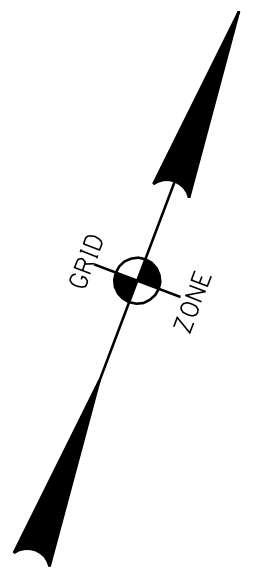

SYMBOLS

●	PI or PIP (IRON PIPE or PIN FOUND)
□	S.T. (SEPTIC TANK)
△	TRAVEL POINT
—	GRADING LIMIT LINE
- - -	CONSTRUCTION LIMIT LINE
—	PROPERTY LINE
—	LIMITS OF WROUGHT PORTION (L.O.W.P.)
—	EXISTING RIGHT OF WAY
—	NEW RIGHT OF WAY
—	NEW ROW WITHIN EXIST. ROW
—	CONTROL OF ACCESS
○	(WELL)
—	WATER LINE
—	GAS LINE
—	ELECTRIC LINE
—	TELEPHONE LINE
—	SEWER LINE

ITEM	TECH	CHECKED
BASE MAP	BDM	
EXIST. R/W	BDM	
PROP. LINES	BDM	
AREAS	BDM	

STATE OF MAINE
 DEPARTMENT OF TRANSPORTATION
 16 STATE HOUSE STATION - AUGUSTA, ME. 04333-0016
 LUBEC
 RIGHT OF WAY MAP

NOTE: PRESCRIPTIVE EASEMENT FOR HIGHWAY PURPOSES WITHIN LIMITS OF WROUGHT PORTION (L.O.W.P.)

PRELIMINARY ROW PLANS ONLY

NO.	DATE	REVISIONS DESCRIPTION	BY	PLAN FILED IN PLAN BOOK		COUNTY RECORD				
				NO.	GRANTOR	INSTRUMENT	DATE	BOOK	PAGE	

DAVID BERNHARDT
 COMMISSIONER
 KENNETH L. SWEENEY
 CHIEF ENGINEER
 DATE

STATE AID HIGHWAY NO. 3
 SOUTH LUBEC ROAD QUODDY HEAD ROAD
 LUBEC WASHINGTON COUNTY
 CAPITAL IMPROVEMENTS PROJ. NO. 018317.00

SHEET NUMBER
9A
 OF 10

Filename: ... \00\row\msto\002_RWPLAN2.dgn Division: HIGHWAY Username: joshua.n.mallman Date: 1/3/2012

STATE OF MAINE,
DEPARTMENT OF CONSERVATION
ITEM NO. (1)
SLOPE EASE. = 0.22± AC. (1)
TEMP. CONST. RIGHTS = 0.67± AC. (1)
TOTAL AREA = 541± AC. (ENTIRE STATE PARK)

STATE OF MAINE,
DEPARTMENT OF CONSERVATION
ITEM NO. (2)
TEMP. CONST. RIGHTS = 0.64± AC. (1)
TOTAL AREA = 541± AC. (ENTIRE STATE PARK)

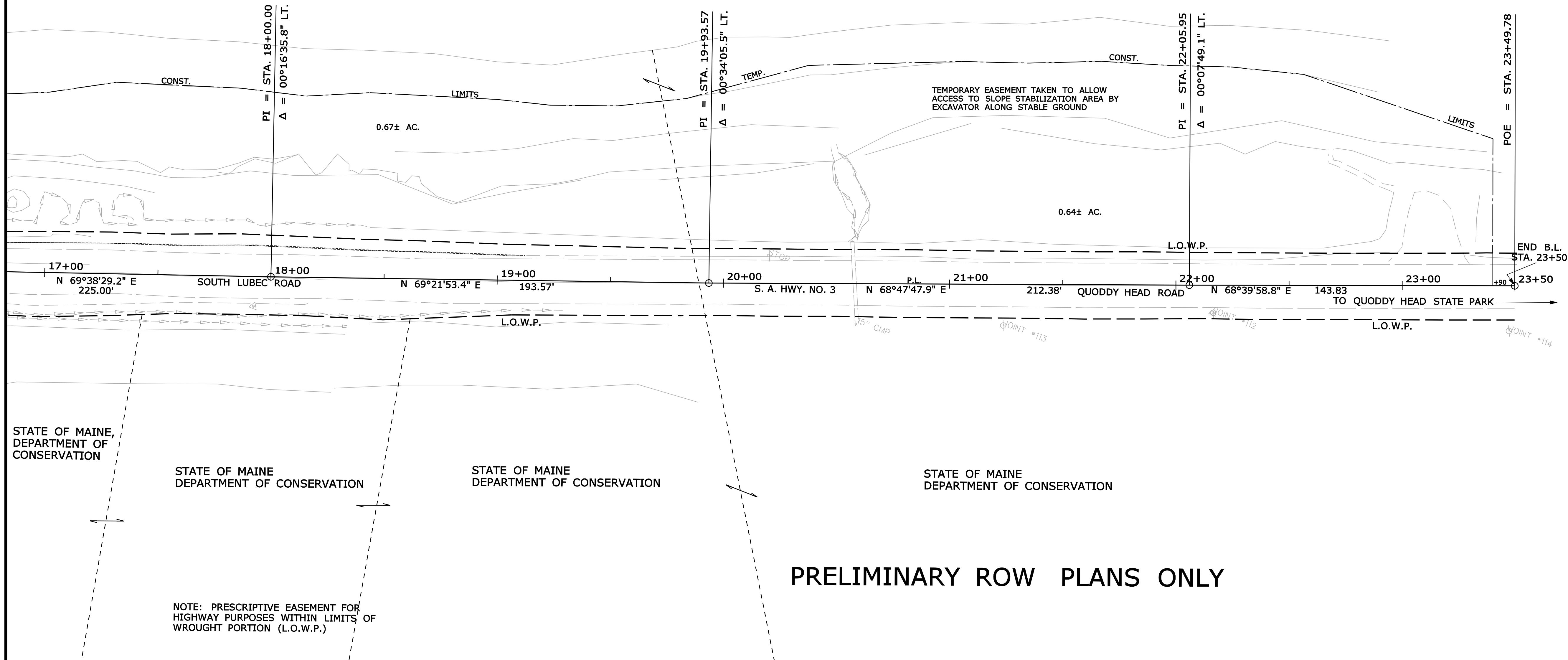
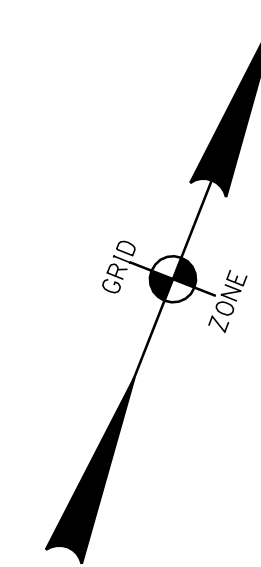

PRELIMINARY ROW PLANS ONLY

SYMBOLS

PI or PIP (IRON PIPE or PIN FOUND)	WELL
GRADING LIMIT LINE	CONSTRUCTION LIMIT LINE
PROPERTY LINE	LIMITS OF WROUGHT PORTION (L.O.W.P.)
EXISTING RIGHT OF WAY	NEW RIGHT OF WAY
NEW ROW WITHIN EXIST. ROW	CONTROL OF ACCESS
WATER LINE	GAS LINE
ELECTRIC LINE	TELEPHONE LINE
SEWER LINE	

ITEM	TECH	CHECKED
BASE MAP	BDM	
EXIST. R/W	BDM	
PROP. LINES	BDM	
AREAS	BDM	

STATE OF MAINE
DEPARTMENT OF TRANSPORTATION
16 STATE HOUSE STATION - AUGUSTA, ME. 04333-0016
LUBEC
RIGHT OF WAY MAP

NO.	DATE	REVISIONS DESCRIPTION	BY

PLAN NO.	FILED IN	PLAN BOOK	PAGE	COUNTY	RECORD
NO.	GRANTOR	INSTRUMENT	DATE	BOOK	PAGE

DAVID BERNHARDT
COMMISSIONER
KENNETH L. SWEENEY
CHIEF ENGINEER
DATE

STATE AID HIGHWAY NO. 3
SOUTH LUBEC ROAD QUODDY HEAD ROAD
LUBEC WASHINGTON COUNTY
CAPITAL IMPROVEMENTS PROJ. NO. 018317.00
JANUARY 2012 RIGHT-OF-WAY MAP
SCALE 1" = 25' SHEET 2 OF 2

SHEET NUMBER
9B
OF 10

PIN 18317.00