

# STATE OF MAINE DEPARTMENT OF TRANSPORTATION



## SPECIFICATIONS

Design: Load and Resistance Factor Design per AASHTO LRFD Bridge Design Specifications, Fifth Edition 2010.

## DESIGN LOADING

Live Load ..... HL - 93 Modified

## TRAFFIC DATA

Current (2011) AADT ..... 1490  
 Future (2031) AADT ..... 1790  
 DHV - % of AADT ..... 10  
 Design Hour Volume ..... 179  
 Heavy Trucks (% of AADT) ..... 18  
 Heavy Trucks (% of DHV) ..... 17  
 Directional Distribution (% of DHV) ..... 53  
 18 kip Equivalent P 2.0 ..... 415  
 18 kip Equivalent P 2.5 ..... 395  
 Design Speed (mph) ..... 55

## HYDROLOGIC DATA

Drainage Area ..... 2.63 sq mi  
 Design Discharge (Q50) ..... 80.7 cfs  
 Check Discharge (Q100) ..... 92.4 cfs  
 Headwater Elevation (Q50) ..... 441.19 ft  
 Headwater Elevation (Q100) ..... 441.36 ft  
 Discharge Velocity (Q50) ..... 5.10 fps  
 Discharge Velocity (Q100) ..... 5.37 fps  
 Headwater Elevation (Q1.1) ..... 440.00 ft  
 Discharge Velocity (Q1.1) ..... 3.31 fps  
 Headwater Elevation (Q25) ..... 441.04 ft

## MATERIALS

Concrete:  
 Precast ..... Class "P"  
 All Other ..... Class "A"  
 Reinforcing Steel ..... ASTM A 615/A 615M, Grade 60

## BASIC DESIGN STRESSES

Concrete .....  $f'c = 4,350$  psi  
 Precast Concrete .....  $f'c = 5,000$  psi  
 Reinforcing Steel .....  $f_y = 60,000$  psi

## LIST OF DRAWINGS

Title Sheet .....	1
Estimate and General Notes .....	2
Plan & Profile .....	3
Boring Locations .....	4
Interpretive Subsurface Profile .....	5
Boring Logs .....	6
Cross Sections .....	7-13
Concrete Box Details .....	14
Stage Construction .....	15
Right of Way Map .....	16

## ORIENT AROOSTOOK COUNTY SKAGROCK BRIDGE OVER SKAGROCK BROOK U.S. ROUTE 1 PROJECT NO. BR-1787(700)X PROJECT LENGTH 0.019 mi. BRIDGE NO. 2772

## UTILITIES

Eastern Maine Electrical Coop., Inc.    Maine Fiber Company  
 Fairpoint Communications            Pioneer Wireless Inc.

## MAINTENANCE OF TRAFFIC

Maintain one 14'-0" wide lane of alternating two - way traffic using traffic signals.

<b>PROJECT LOCATION:</b>	Located on U.S. Route 1; 0.80 of a mile southerly of the Amity town line. Lat.: 45°50'09", Long.: 67°50'54"
<b>PROGRAM AREA:</b>	Bridge Program
<b>OUTLINE OF WORK:</b>	Bridge Replacement: Skagrock Bridge (#2772) over Skagrock Brook.

STATE OF MAINE DEPARTMENT OF TRANSPORTATION	DATE 12/10/12
APPROVED	DATE 12/10/12
COMMISSIONER: <i>[Signature]</i>	CHIEF ENGINEER: <i>[Signature]</i>

*Michael Wight*  
SIGNATURE  
8089  
P.E. NUMBER  
12/10/2012  
DATE

PROJECT INFORMATION	
PROGRAM	BRIDGE PROGRAM
PROJECT MANAGER	STEVE BOOSE
DESIGNER	BRIAN REEVES
CONSULTANT	
PROJECT RESIDENT	
CONTRACTOR	
PROJECT COMPLETION DATE	

WIN 17877.00

BR-1787(700)X

ORIENT  
SKAGROCK BRIDGE  
TITLE SHEET

SHEET NUMBER  
**1**  
OF 16



ESTIMATED QUANTITIES			
ITEM NO.	DESCRIPTION	QUANTITY	UNIT
202.19	REMOVING EXISTING BRIDGE (210 CY)	1	LS
202.127	REMOVE EXISTING BITUMINOUS PAVEMENT (144 SY)	1	LS
203.20	COMMON EXCAVATION	245	CY
203.24	COMMON BORROW	5	CY
203.25	GRANULAR BORROW	39	CY
203.33	SPECIAL FILL	79	CY
206.061	STRUCTURAL EARTH EXCAVATION - DRAINAGE MINOR STRUCTURES BELOW GRADE	224	CY
304.10	AGGREGATE SUBBASE COURSE - GRAVEL	227	CY
403.208	HOT MIX ASPHALT 12.5 MM HMA SURFACE	114	T
403.213	HOT MIX ASPHALT 12.5 MM BASE	206	T
409.15	BITUMINOUS TACK COAT - APPLIED	103	G
508.14	HIGH PERFORMANCE WATERPROOFING MEMBRANE (115 SF)	1	LS
511.07	COFFERDAM: UPSTREAM	1	LS
511.07	COFFERDAM: DOWNSTREAM	1	LS
513.22	CRUSHED STONE SLOPE PROTECTION	6	SY
526.301	TEMPORARY CONCRETE BARRIER - TYPE I (200 LF)	1	LS
527.34	WORK ZONE CRASH CUSHIONS	4	UN
534.71	PRECAST CONCRETE BOX CULVERT (125 CY)	1	LS
606.23	GUARDRAIL TYPE 3C - SINGLE RAIL	315	LF
606.231	GUARDRAIL TYPE 3C - 15 FOOT RADIUS AND LESS	25	LF
606.265	TERMINAL END-SINGLE RAIL - GALVANIZED STEEL	1	EA
606.353	REFLECTORIZED FLEXIBLE GUARDRAIL MARKER	8	EA
606.754	WIDEN SHOULDER FOR GUARDRAIL 350 FLARED TERMINAL	3	EA
606.79	GUARDRAIL 350 FLARED TERMINAL	3	EA
610.08	PLAIN RIPRAP	100	CY
613.329	EXTENDED USE EROSION CONTROL BLANKETS	50	SY
615.07	LOAM	26	CY
618.1401	SEEDING METHOD NUMBER 2 - PLAN QUANTITY	3	UN
618.143	SPECIAL SEEDING	1	UN
619.1401	EROSION CONTROL MIX	58	CY
620.58	EROSION CONTROL GEOTEXTILE	532	SY
627.733	4" WHITE OR YELLOW PAINTED PAVE MRK LI LF	1000	LF
629.05	HAND LABOR, STRAIGHT TIME	10	HR
631.12	ALL PURPOSE EXCAVATOR (INCLUDING OPERATOR)	20	HR
631.131	SMALL BULLDOZER-GRADER (INCLUDING OPERATOR)	10	HR
631.15	ROLLER, EARTH AND BASE COURSE (INCLUDING OPERATOR)	10	HR
631.172	TRUCK - LARGE (INCLUDING OPERATOR)	10	HR
639.19	FIELD OFFICE TYPE B	1	EA
643.72	TEMPORARY TRAFFIC SIGNAL	1	LS
652.312	TYPE III BARRICADE	4	EA
652.33	DRUM	20	EA
652.34	CONE	12	EA
652.35	CONSTRUCTION SIGNS	165	SF
652.36	MAINTENANCE OF TRAFFIC CONTROL DEVICES	90	CD
652.38	FLAGGER	100	HR
656.75	TEMPORARY SOIL EROSION AND WATER POLLUTION CONTROL	1	LS
659.10	MOBILIZATION	1	LS

**GENERAL CONSTRUCTION NOTES**

- For easements, construction limits and right of way lines, refer to Right of Way Map.
- The clearing limits as shown on the plans are approximate. The exact limits will be established in the field by the Resident. Payment for clearing will be considered incidental to Contract items.
- All utility facilities shall be adjusted by the respective utilities unless otherwise noted.
- Do not excavate for Aggregate Subbase Course where existing material is suitable as determined by the Resident.
- In areas where the Resident directs the Contractor not to excavate to the subgrade line shown on the plans, payment for removing existing pavement, grubbing, shaping, ditching, and compacting the existing subbase and layers of new subbase 6 inches or less thick will be made under appropriate equipment rental items.
- All embankment material, except as otherwise shown, placed below EL. 440.00 ft shall be Granular Borrow meeting the requirements of Subsection 703.19, Material for Underwater Backfill.
- Riprap adjacent to the box culvert shall be placed so as not to damage the culvert. Any damage to the box culvert during construction shall be repaired or replaced as determined by the Resident at the Contractor's expense.
- The riprap slope protection shall be constructed as shown on MaineDOT standard detail 610(02). The protective aggregate cushion layer shall be 12 inches thick. A Class I non woven erosion control geotextile shall be used under the protective aggregate cushion layer.
- Place loam 2 inches deep on all new or reconstructed side slopes or as directed by the Resident.
- Erosion Control Mix may be substituted in those areas normally receiving loam and seed as directed by the Resident. Placement shall be in accordance with Standard Specifications Section 619, Mulch. Payment will be made under Item No. 619.1401, Erosion Control Mix.
- Place a 24-in. wide strip of Extended-use Erosion Control Blanket on the side slopes along the top of the riprap and behind the wingwalls
- Extended-use Erosion Control Blanket, seeded gutters, riprap downspouts, and other gutters lined with Stone Ditch Protection shall be constructed after paving and shoulder work is completed, where it is apparent that runoff will cause continual erosion. Payment will be made under the appropriate Contract Items.
- Project information referred to below may be accessed at the following MaineDOT web address: [http://www.maine.gov/mdot/contractors/\\*projecttbl](http://www.maine.gov/mdot/contractors/*projecttbl)
- The existing bridge plans may be accessed at the MaineDOT web address. The plans are reproductions of the original drawings as prepared for the construction of the bridge. It is very unlikely that the plans will show any construction field changes or any alterations which may have been made to the bridge during its life span.
- The hydrologic report of the bridge site may be accessed at the MaineDOT web address. The hydrologic report is based on MaineDOT's interpretation of the information obtained for the subject site. No assurance is given that the information or the conclusions of the report will be representative of actual conditions at the time of construction.
- The project geotechnical report titled: Geotechnical Design Report for the Replacement of Skagrock Brook Bridge, Soils Report No. 2011-22, Dated December 8, 2011 may be accessed at the MaineDOT web address.
- Geotechnical information furnished or referred to in this plan set is for the use of the Bidders and the Contractor. No assurance is given that the information or interpretations will be representative of actual subsurface conditions at the construction site. MaineDOT will not be responsible for the Bidders' or Contractor's interpretations of, or conclusions drawn from, the geotechnical information. The boring logs contained in the plan set present factual and interpretive subsurface information collected at discrete locations. Data provided may not be representative of the subsurface conditions between the boring locations.

- Quantities included for pay items measured and paid for by Lump Sum are estimated quantities and are provided by MaineDOT for informational purposes only. Lump Sum pay items will be paid for at the Contract Bid amount, with no addition or reduction in payment to the Contractor if the actual final quantities are different from the MaineDOT provided estimated quantities, except as follows:
  - If a Lump Sum pay item is eliminated, the requirements of Standard Specifications Section 109.2, Elimination of Items, will take precedence.
  - If other Contract Documents specifically allow a change in payment for a Lump Sum pay item, those requirements will be followed.
  - If a design change results in changes to estimated quantities for Lump Sum pay items, price adjustments will be made in accordance with Standard Specifications Section 109.7, Equitable Adjustments to Compensation.
- Site excavated dredge material, or if needed, granular borrow, material for underwater backfill shall be mixed in with the riprap used for the riprap aprons so that the apron is one solid mass with no voids. Payment shall be included under Pay Item No. 203.33, Special Fill.
- To identify weak zones and densify the box culvert subgrade, the Contractor shall compact the excavated subgrade with a minimum of 4 passes with a vibratory compactor that has a minimum static weight of 500 lbs. The Contractor shall remove and replace weak or unsuitable soils found at the subgrade level with compacted Granular Borrow.

STATE OF MAINE		DEPARTMENT OF TRANSPORTATION	
SKAGROCK BRIDGE		STP-1787(700)X	
SKAGROCK BROOK		WIN 17877.00	
ORIENT		BRIDGE NO. 2772	
AROOSTOOK COUNTY		BRIDGE PLANS	
ESTIMATED QUANTITIES		SIGNATURE	
SHEET NUMBER		P.E. NUMBER	
2		DATE	
OF 16		FIELD CHANGES	

Username: daniel.boissoneau Date: 12/10/2012

Division: BRIDGE

Filename: ... \00\bridge\msta\003\_Plan1.dgn

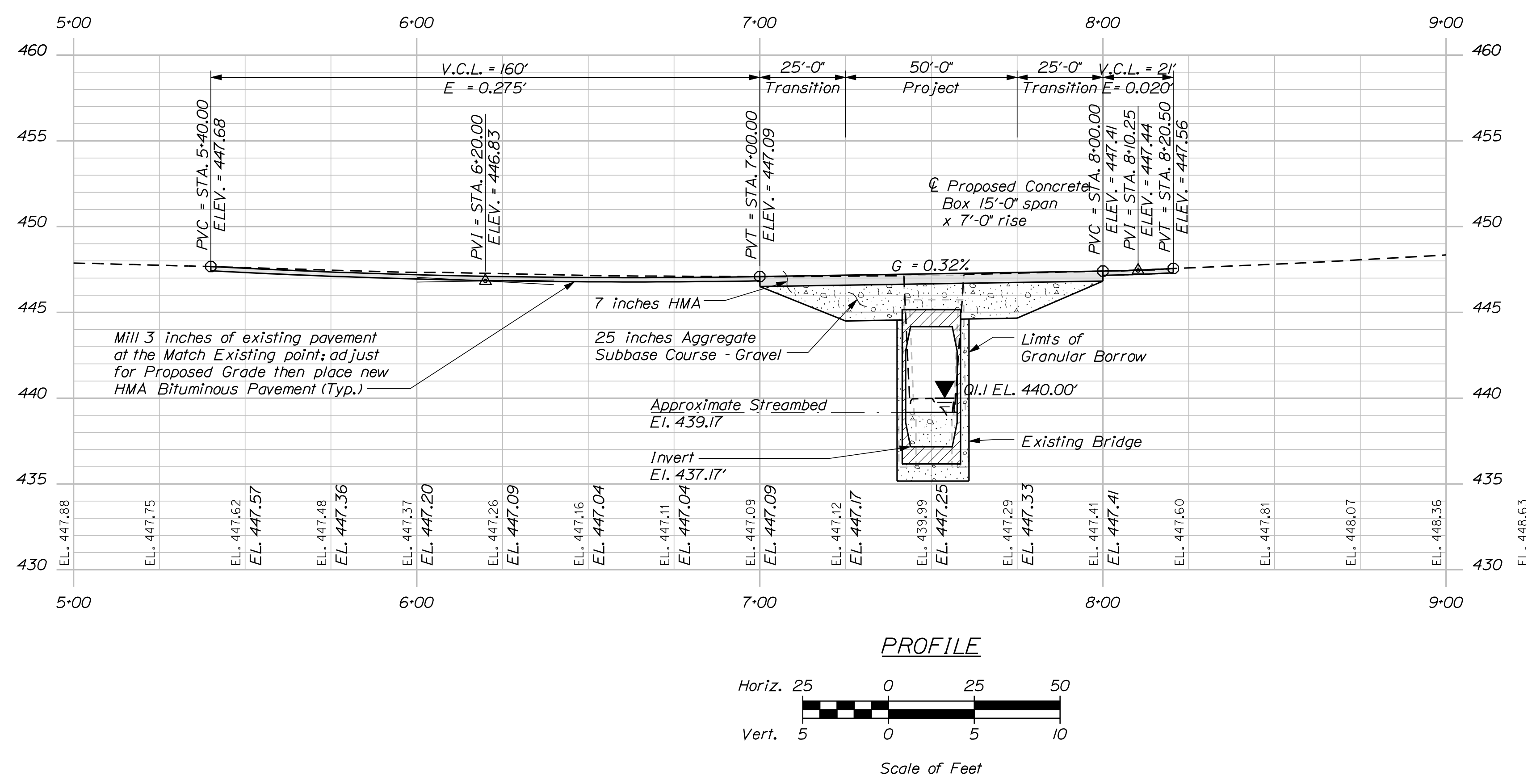
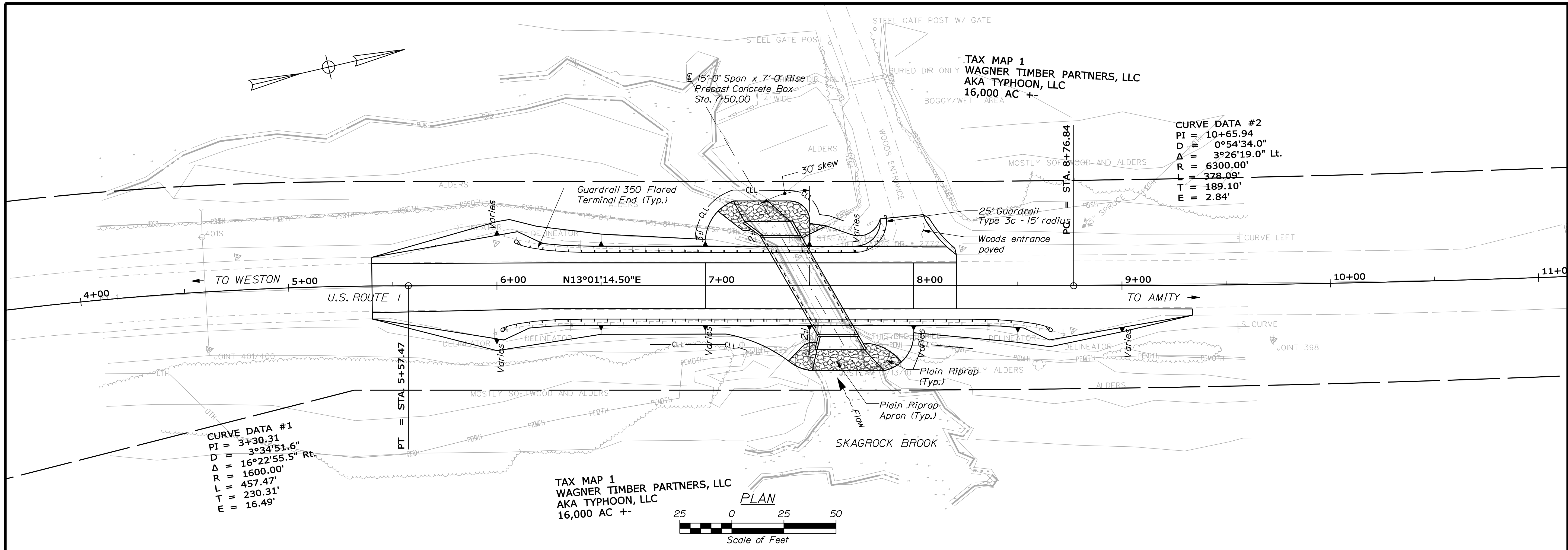

STATE OF MAINE		DEPARTMENT OF TRANSPORTATION	
BR-1787(700)X		BRIDGE NO. 2772	
WIN		17877.00	
BRIDGE PLANS			
PROJ. MANAGER	S. Dodge	BY	D. Sullivan
CHECKED/REVIEWED	B. Reeves	DATE	JUN 2011
DESIGN/REVIEWED		SIGNATURE	
DESIGN/REVIEWED		P.E. NUMBER	
REVISIONS 1		DATE	
REVISIONS 2			
REVISIONS 3			
REVISIONS 4			
FIELD CHANGES			
SKAGROCK BRIDGE		AROOSTOOK COUNTY	
SKAGROCK BROOK		PLAN & PROFILE	
ORIENT		SHEET NUMBER	
		3	
		OF 16	

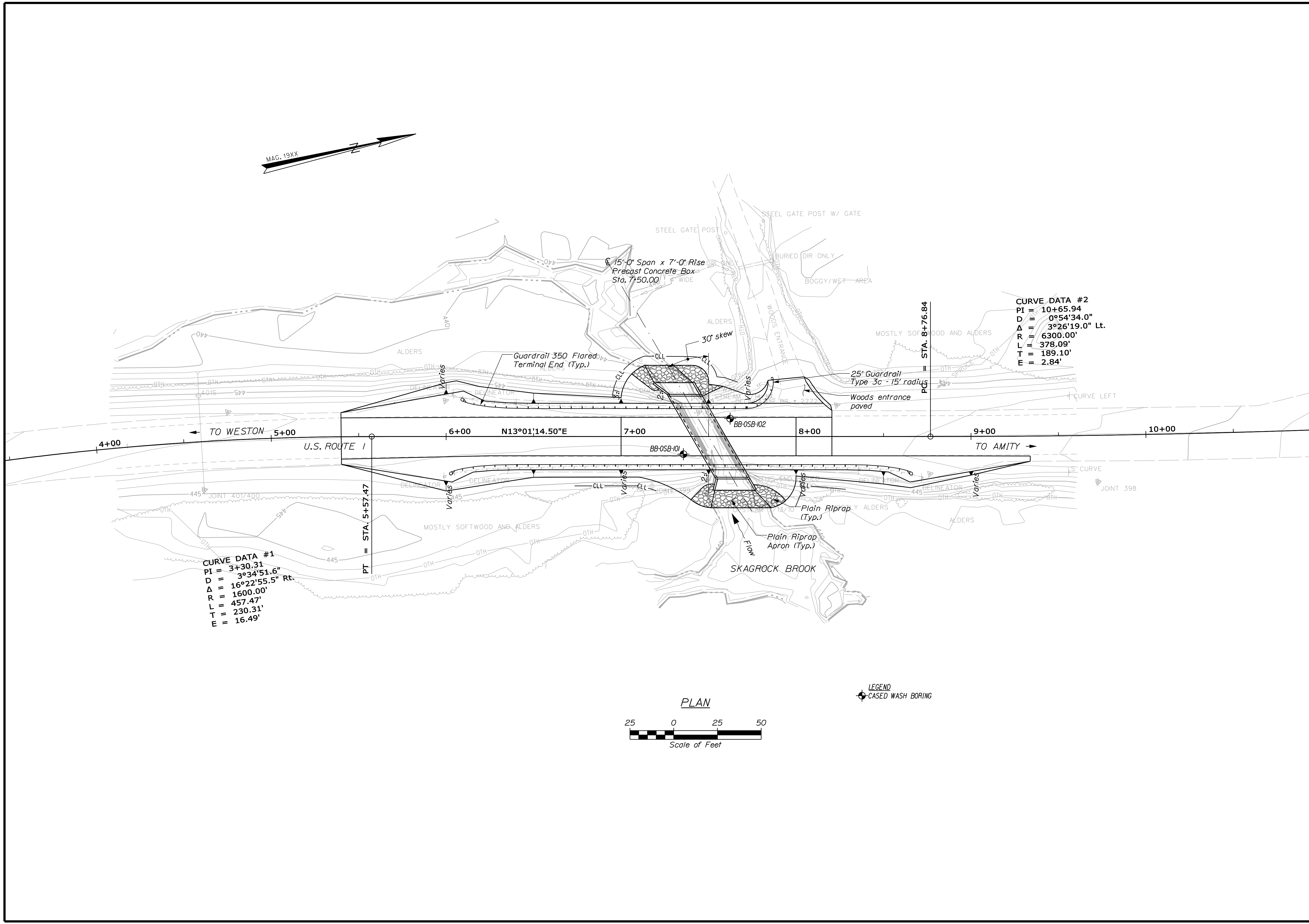

STATE OF MAINE		DEPARTMENT OF TRANSPORTATION	
BR-1787(700)X		BRIDGE NO. 2772	
WIN		17877.00	
BRIDGE PLANS			
PROJ. MANAGER	S. Dodge	BY	T. WHITE
CHECKED/REVIEWED	M. MOREAU	DATE	JUN 2011
DESIGN DETAILER		SIGNATURE	
DESIGN DETAILER		P.E. NUMBER	
REVISIONS 1		DATE	
REVISIONS 2			
REVISIONS 3			
REVISIONS 4			
FIELD CHANGES			
SKAGROCK BRIDGE		AROOSTOOK COUNTY	
SKAGROCK BROOK		BORING LOCATION PLAN	
ORIENT		SHEET NUMBER	
		4	
		OF 16	



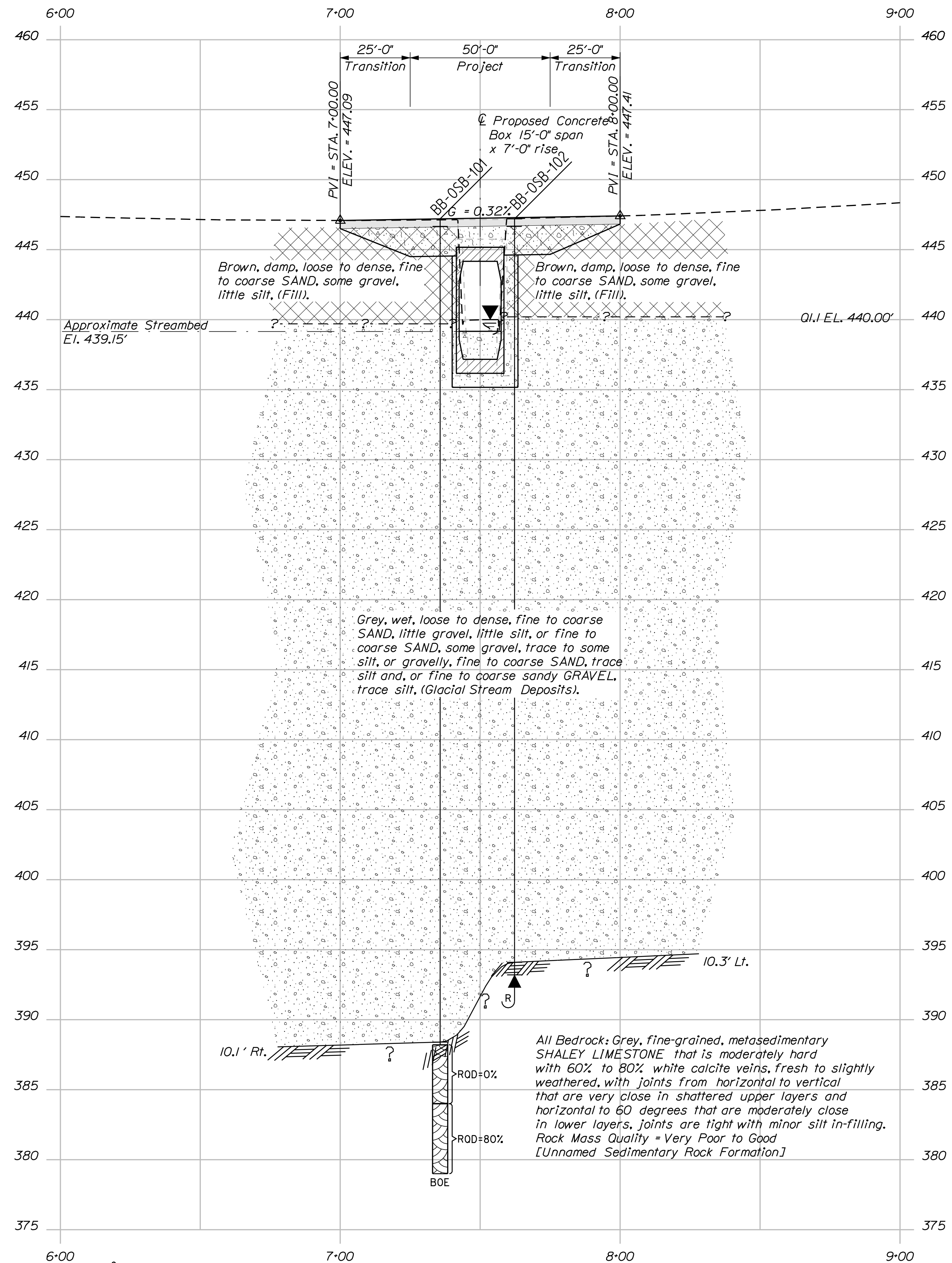

**LEGEND**

Boring No. shown  
Offset 1 ft

Pavement Thickness if applicable  
Strata Interface

Rock Quality Designation  
For Rock Core Sample

BOE = Bottom Of Exploration

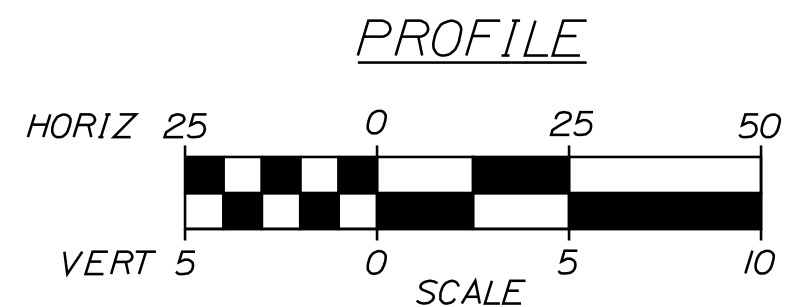

Note: This generalized interpretive soil profile is intended to convey trends in subsurface conditions. The boundaries between strata are approximate and idealized, and have been developed by interpretations of widely spaced explorations and samples. Actual soil transitions may vary and are probably more erratic. For more specific information refer to the exploration logs.

STATE OF MAINE  
DEPARTMENT OF TRANSPORTATION  
**BR-1787(700)X**

SIGNATURE  
P.E. NUMBER  
DATE

PROJ. MANAGER	S. Badge	BY	DATE
CHECKED-REVIEWED	M.MOREAU	T.WHITE	JUN 2011
DESIGN-DETAILED			
DESIGNS DET AILED			
REVISIONS 1			
REVISIONS 2			
REVISIONS 3			
REVISIONS 4			
FIELD CHANGES			

SKAGROCK BRIDGE  
SKAGROCK BROOK  
AROOSTOOK COUNTY  
ORIENT  
**INTERPRETIVE SUBSURFACE PROFILE**

SHEET NUMBER

**5**

OF 16

BRIDGE NO. 2772  
WIN  
17877.00  
BRIDGE PLANS



Username: daniel.p.boissomeau Date:12/10/2012

Division: BRIDGE

Filename: ... \msta\007\_Xsect\_5+00\_001.dgn

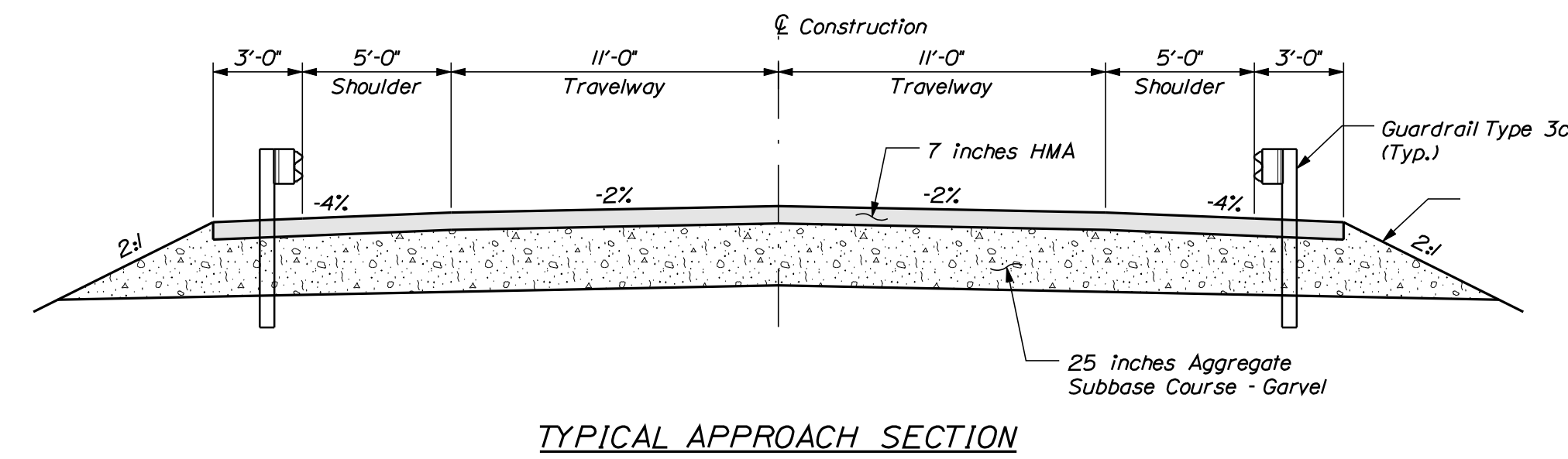
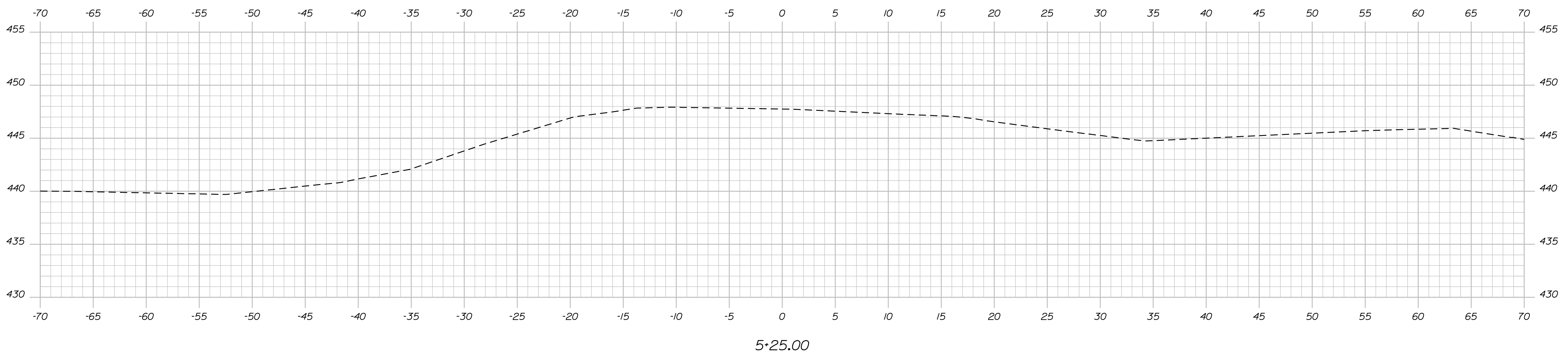
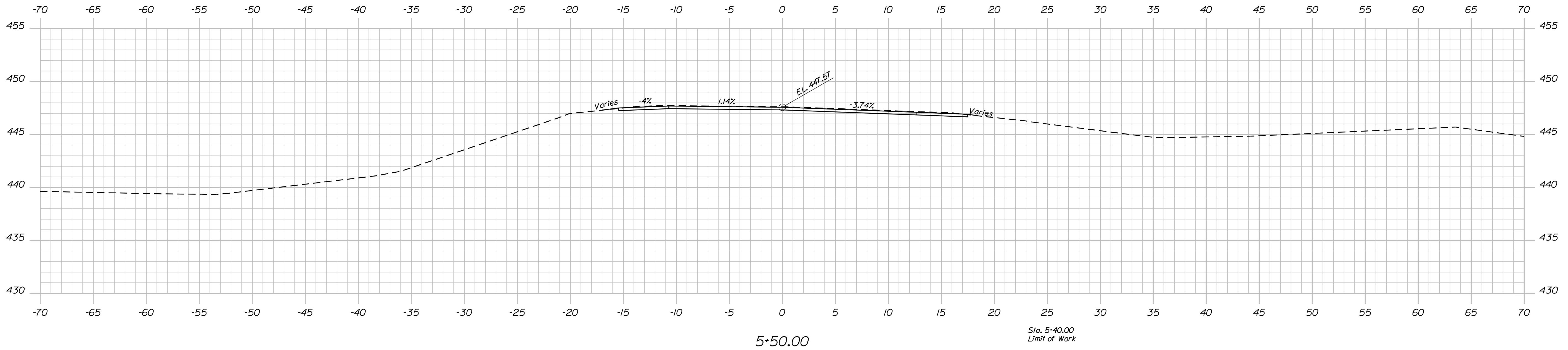

TYPICAL APPROACH SECTION

STATE OF MAINE  
DEPARTMENT OF TRANSPORTATION  
STP-1787(700)X  
BRIDGE NO. 2772 PIN 17877.00  
BRIDGE PLANS

PROJ. MANAGER	BY	DATE
DESIGNER: M. WIGHT	DATE: NOV 2012	SIGNATURE
CHECKED: M. WIGHT	DATE: NOV 2012	P.E. NUMBER
DESIGNED: M. WIGHT	DATE: NOV 2012	DATE
REVISIONS 1		
REVISIONS 2		
REVISIONS 3		
REVISIONS 4		
FIELD CHANGES		

SKAGROCK BRIDGE  
SKAGROCK BROOK  
ARROSTOCK COUNTY  
ORIENT  
CROSS SECTIONS

SHEET NUMBER  
7  
OF 16

Username: daniel.p.boissoneau Date:12/10/2012

Division: BRIDGE

Filename: ... \msto\008\_Xsect\_5+75\_002.dgn

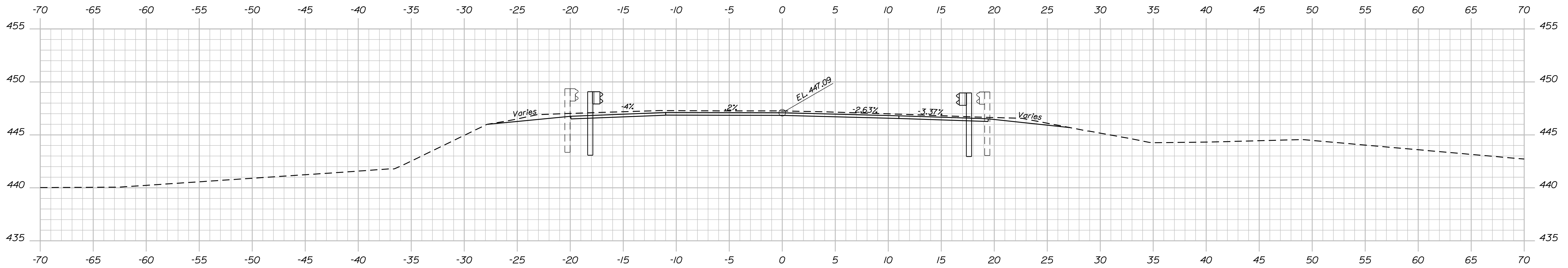

6+25.00

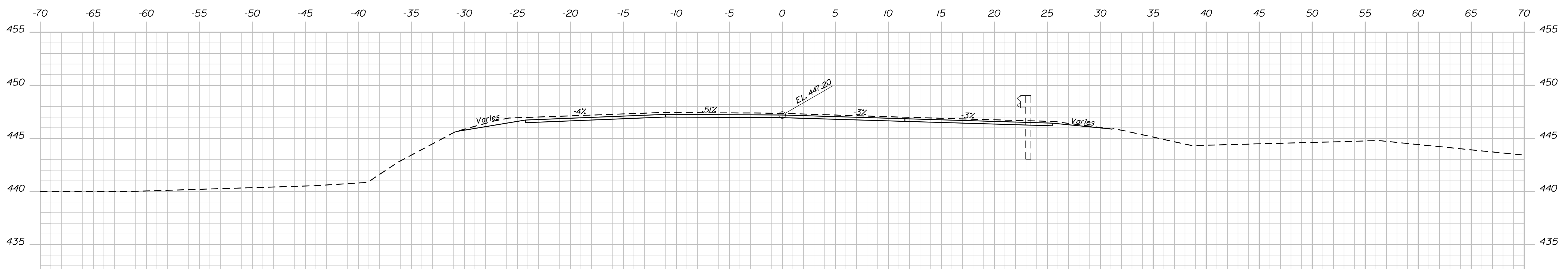

6+00.00

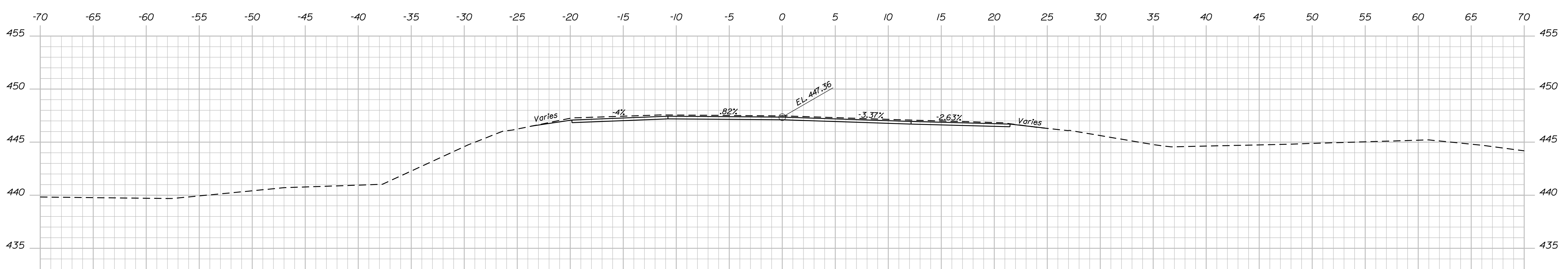

5+75.00

STATE OF MAINE  
 DEPARTMENT OF TRANSPORTATION  
 STP-1787(700)X  
 BRIDGE NO. 2772  
 PIN  
 PIN 17877.00  
 BRIDGE PLANS

PROJ. MANAGER	DESIGN-DETAILED	CHECKED-REVIEWED	DESIGN-DETAILED	DESIGN-DETAILED	REVISIONS 1	REVISIONS 2	REVISIONS 3	REVISIONS 4	FIELD CHANGES	BY	DATE	SIGNATURE	P.E. NUMBER	DATE

SKAGROCK BRIDGE  
 SKAGROCK BROOK  
 AROOSTOOK COUNTY  
 ORIENT  
 CROSS SECTIONS

SHEET NUMBER  
 8  
 OF 16

Sta. 5+75.00 to Sta. 6+25.00



Username: daniel.p.boissoneau Date:12/10/2012

Division: BRIDGE

Filename: ... \msta\009\_Xsect\_6-50\_003.dgn

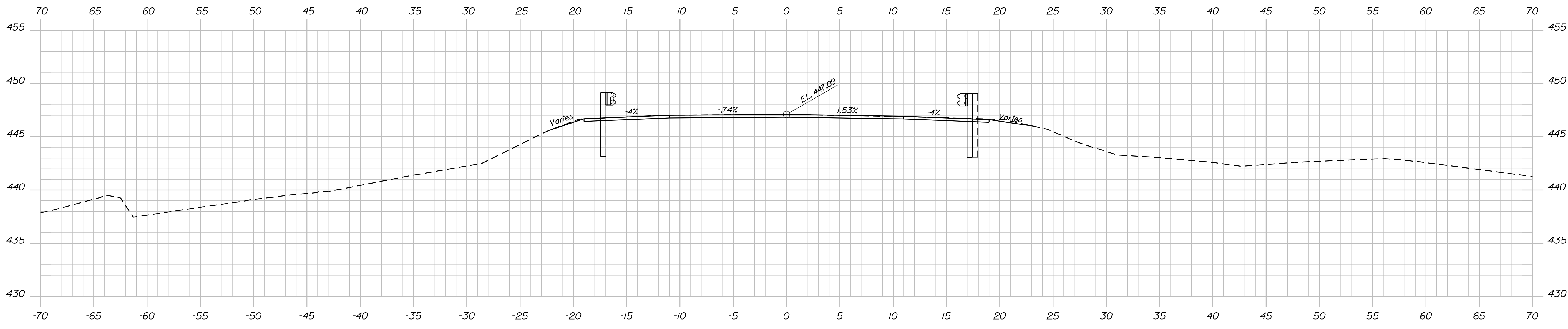

7+00.00

MATCH EXISTING  
BEGIN TRANSITION

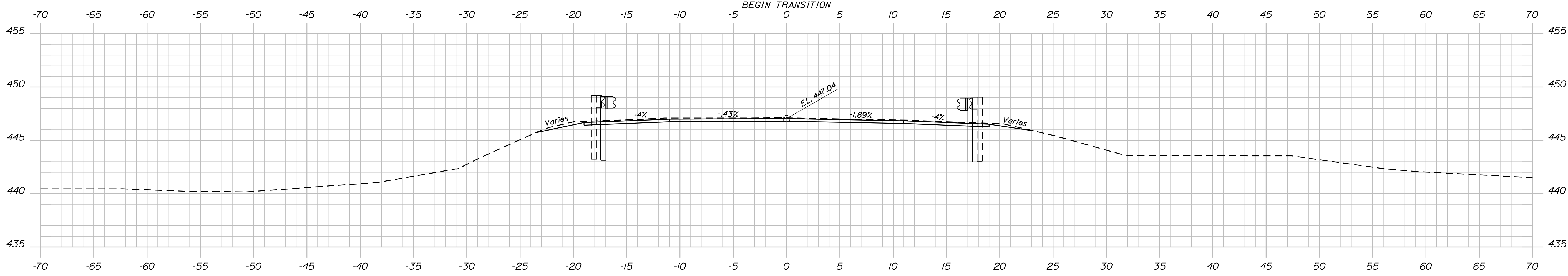

6+75.00

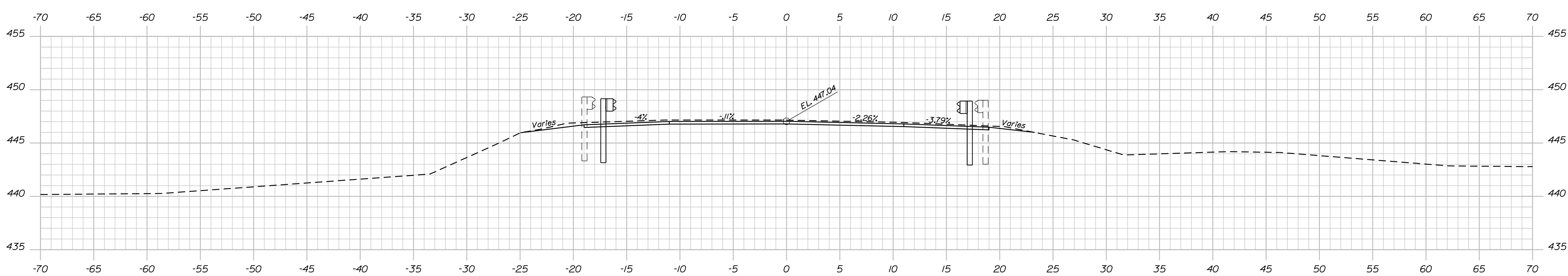

6+50.00

STATE OF MAINE DEPARTMENT OF TRANSPORTATION <b>STP-1787(700)X</b>	PIN PIN 17877.00 BRIDGE NO. 2772	BRIDGE PLANS
SIGNATURE	P.E. NUMBER	DATE
DESIGNER	CHECKED	DATE
DESIGNED	DESIGNED	DATE
REVISIONS 1	REVISIONS 2	REVISIONS 3
REVISIONS 4	REVISIONS 5	REVISIONS 6
FIELD CHANGES	FIELD CHANGES	FIELD CHANGES
SKAGROCK BRIDGE SKAGROCK BROOK ORIENT	ARROSTOCK COUNTY	CROSS SECTIONS
SHEET NUMBER		
9		
OF 16		

Username: daniel.p.boissoneau Date:12/10/2012

Division: BRIDGE

Filename: ... \msta\010\_Xsect\_7-25\_004.dgn

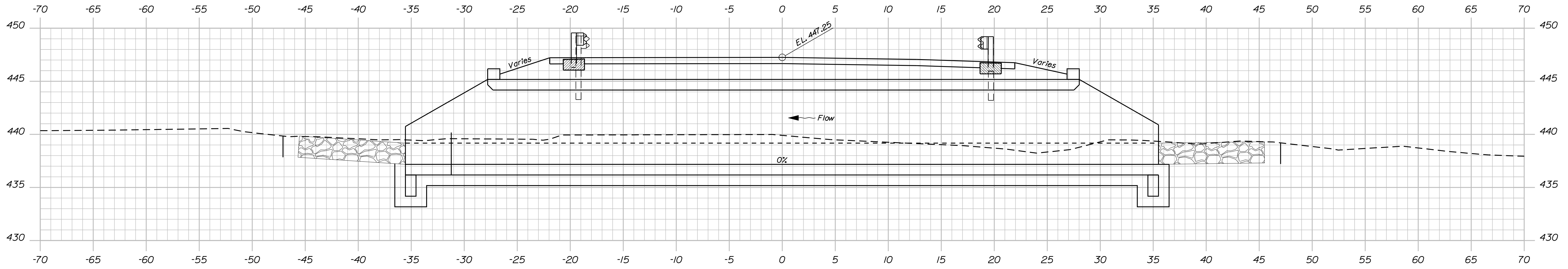

7+50.50  
30° Skew Left, Behind

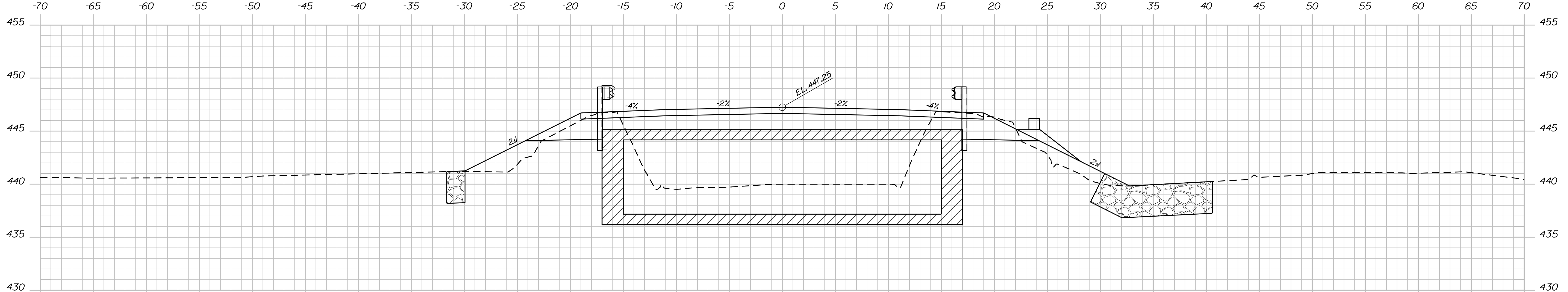

Sta. 7+72.02 to Sta. 7+86.87  
Install 15 ft. radius Guardrail Type 3c Left

7+50.00  
BRIDGE

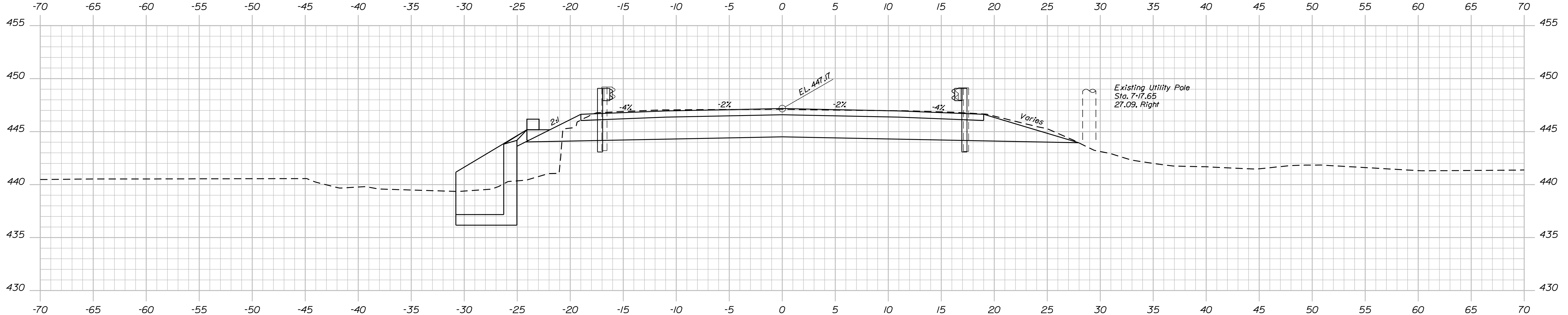

7+25.00  
END TRANSITION  
BEGIN PROJECT

STATE OF MAINE  
DEPARTMENT OF TRANSPORTATION  
STP-1787(700)X  
BRIDGE NO. 2772  
PIN 17877.00  
BRIDGE PLANS

PROJ. MANAGER	BY	DATE
DESIGN-DETAILED	DESIGNER	DATE
CHECKED-REVIEWED	BY	DATE
DESIGN-DETAILED	DESIGNER	DATE
DESIGN-DETAILED	DESIGNER	DATE
REVISIONS 1	BY	DATE
REVISIONS 2	BY	DATE
REVISIONS 3	BY	DATE
REVISIONS 4	BY	DATE
FIELD CHANGES	BY	DATE

SKAGROCK BRIDGE  
SKAGROCK BROOK  
ARROSTOCK COUNTY  
ORIENT  
CROSS SECTIONS

SHEET NUMBER  
**10**  
OF 16

Username: daniel.p.boissoneau Date:12/10/2012

Division: BRIDGE

Filename: ... \msta\011\_xsect\_7+75\_005.dgn

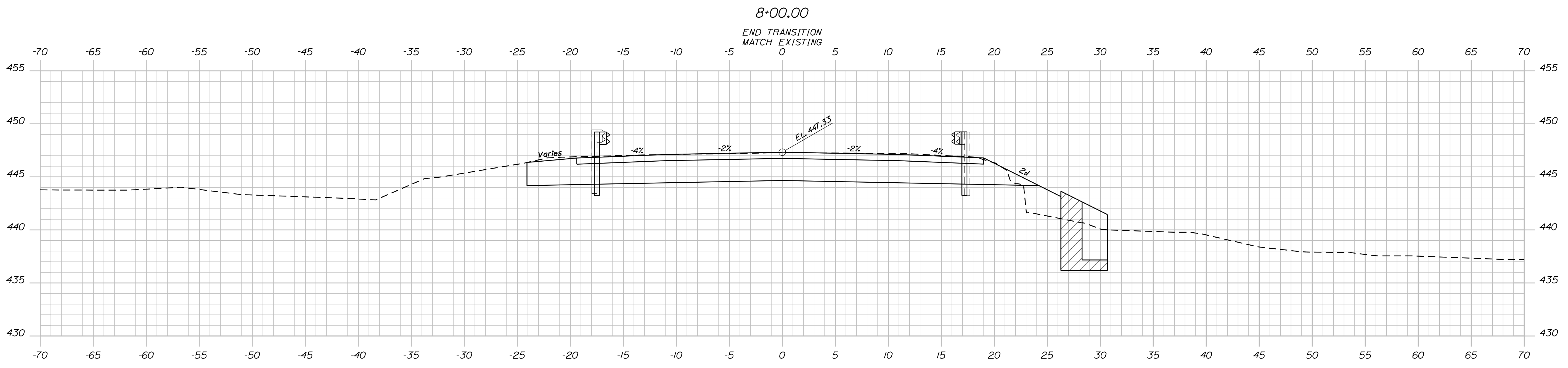
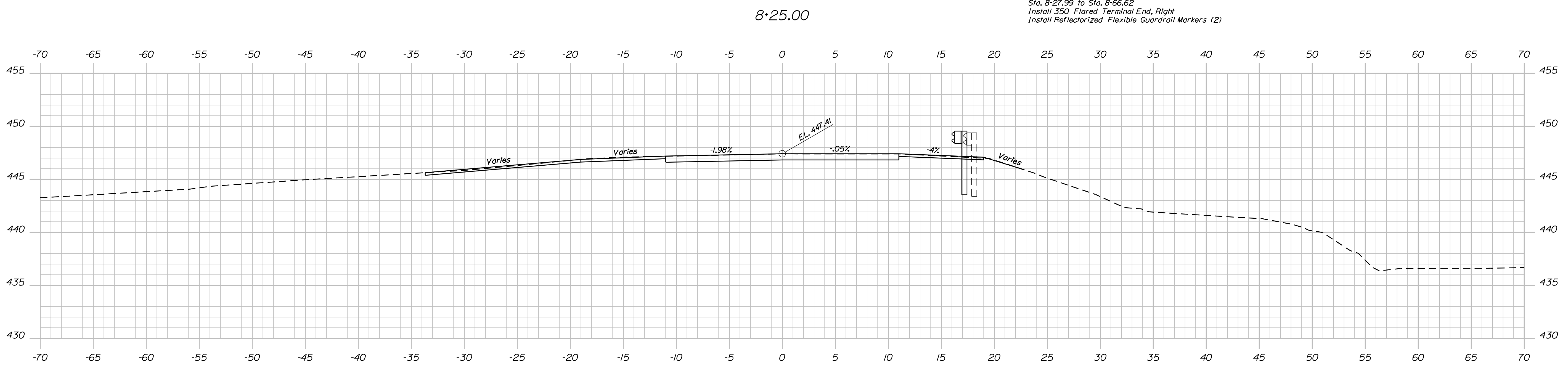
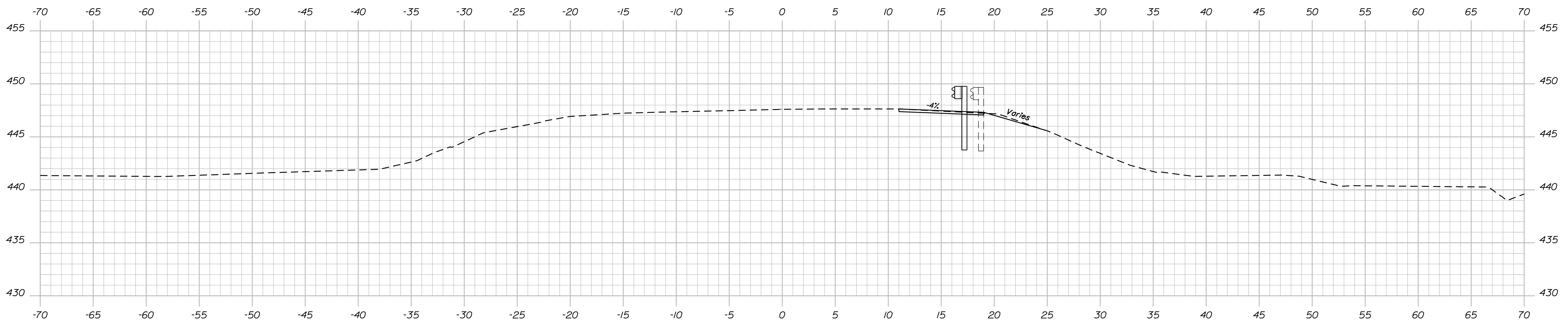

STATE OF MAINE  
 DEPARTMENT OF TRANSPORTATION  
 STP-1787(700)X  
 BRIDGE NO. 2772  
 PIN 17877.00  
 BRIDGE PLANS

PROJ. MANAGER	DESIGN-DETAILED	CHECKED-REVIEWED	DESIGN-DETAILED	BY	DATE
\$Revision:1\$	\$Revision:1\$	\$Revision:1\$	\$Revision:1\$	\$Author:1\$	\$Date:1\$
\$Revision:2\$	\$Revision:2\$	\$Revision:2\$	\$Revision:2\$	\$Author:2\$	\$Date:2\$
\$Revision:3\$	\$Revision:3\$	\$Revision:3\$	\$Revision:3\$	\$Author:3\$	\$Date:3\$
\$Revision:4\$	\$Revision:4\$	\$Revision:4\$	\$Revision:4\$	\$Author:4\$	\$Date:4\$
\$Revision:5\$	\$Revision:5\$	\$Revision:5\$	\$Revision:5\$	\$Author:5\$	\$Date:5\$
\$Revision:6\$	\$Revision:6\$	\$Revision:6\$	\$Revision:6\$	\$Author:6\$	\$Date:6\$
\$Revision:7\$	\$Revision:7\$	\$Revision:7\$	\$Revision:7\$	\$Author:7\$	\$Date:7\$
\$Revision:8\$	\$Revision:8\$	\$Revision:8\$	\$Revision:8\$	\$Author:8\$	\$Date:8\$
\$Revision:9\$	\$Revision:9\$	\$Revision:9\$	\$Revision:9\$	\$Author:9\$	\$Date:9\$
\$Revision:10\$	\$Revision:10\$	\$Revision:10\$	\$Revision:10\$	\$Author:10\$	\$Date:10\$

SKAGROCK BRIDGE  
 SKAGROCK BROOK  
 AROOSTOOK COUNTY  
 ORIENT  
 CROSS SECTIONS

SHEET NUMBER  
 11  
 OF 16



Username: daniel.p.boissoneau Date:12/10/2012

Division: BRIDGE

Filename: ... \msta\012\_Xsect\_8-50\_006.dgn

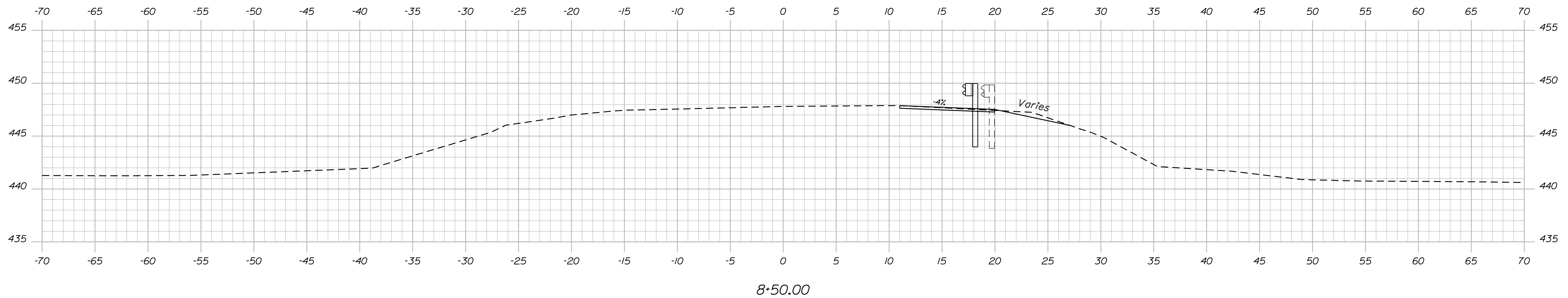
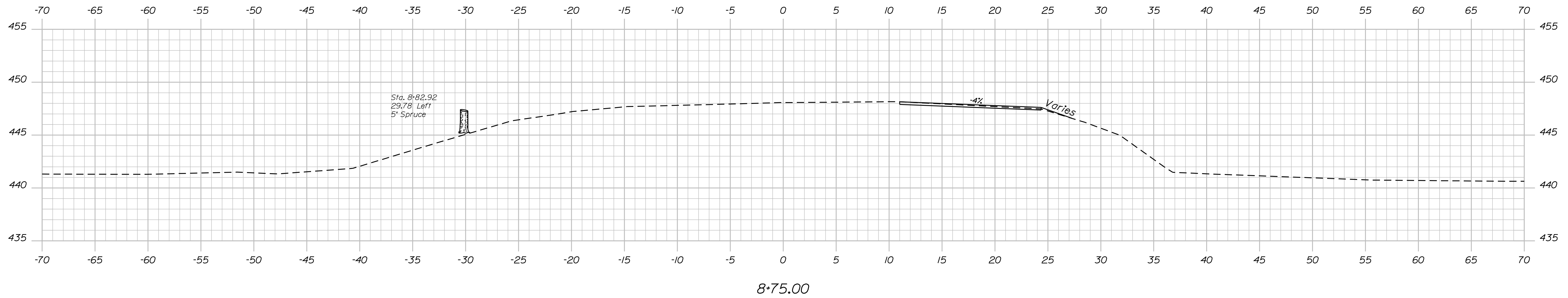
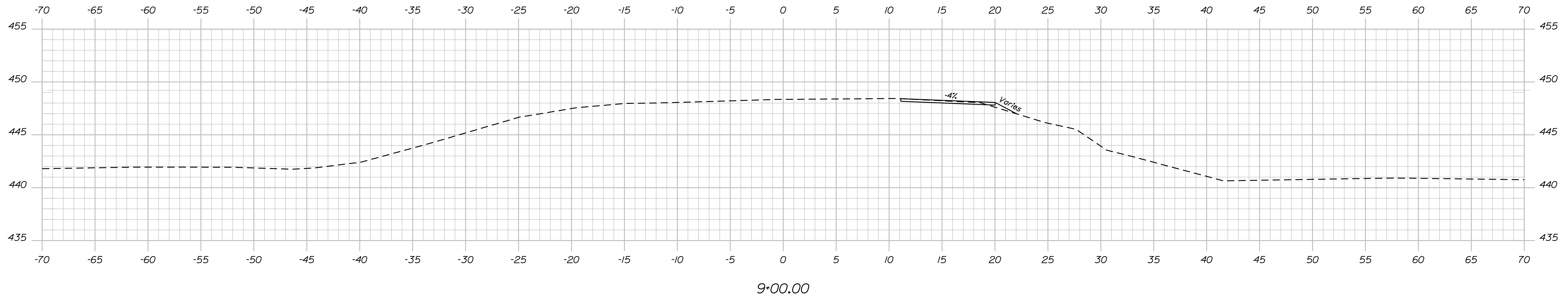

STATE OF MAINE  
DEPARTMENT OF TRANSPORTATION  
STP-1787(700)X  
BRIDGE NO. 2772  
PIN  
PIN 17877.00  
BRIDGE PLANS

PROJ. MANAGER  
DESIGN-DETAILED  
CHECKED-REVIEWED  
DESIGN-DETAILED  
DESIGN-DETAILED  
REVISIONS 1  
REVISIONS 2  
REVISIONS 3  
REVISIONS 4  
FIELD CHANGES

BY  
DATE

SIGNATURE  
P.E. NUMBER  
DATE

SKAGROCK BRIDGE  
SKAGROCK BROOK  
ARROSTOCK COUNTY  
ORIENT

CROSS SECTIONS

SHEET NUMBER  
12  
OF 16

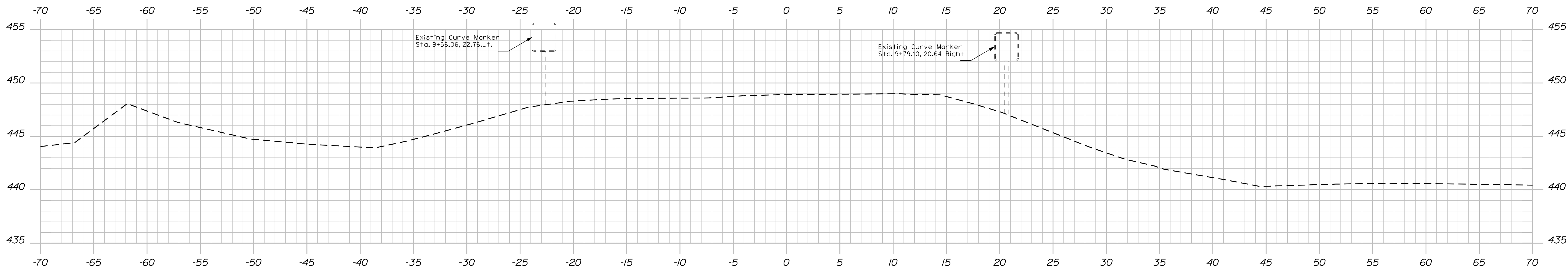

9+50.00  
Sta. 9+33.76  
Limit of Work

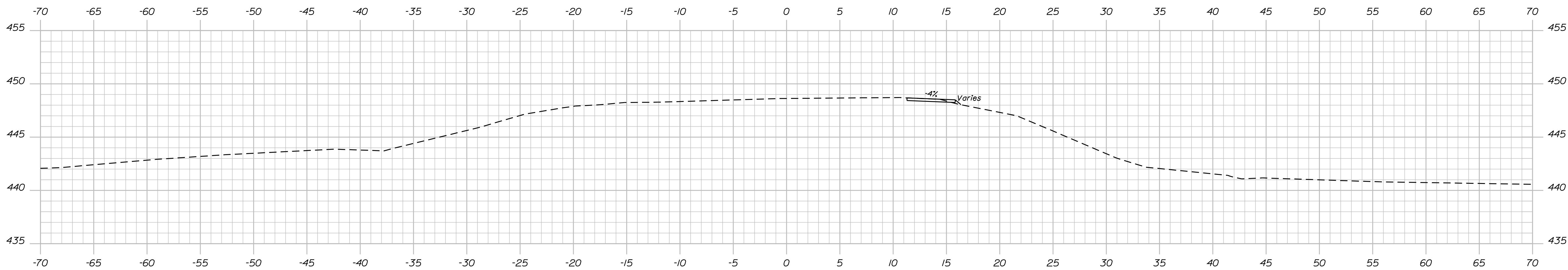

9+25.00  
Sta. 7+72.02 to Sta. 7+86.87  
Install 15 ft. radius Guardrail Type 3c Left

STATE OF MAINE		DEPARTMENT OF TRANSPORTATION	
STP-1787(700)X		BRIDGE NO. 2772	
PIN		PIN 17877.00	
BRIDGE PLANS		BRIDGE PLANS	
PROJ. MANAGER	BY	DATE	
DESIGN-REVIEWED	DESIGNER	DATE	
CHECKED-REVIEWED	CHECKER	DATE	
DESIGN-DET-REVIEWED	DESIGNER	DATE	
DESIGN-DET-REVIEWED	DESIGNER	DATE	
REVISIONS 1	REVISIONS 1	REVISIONS 1	REVISIONS 1
REVISIONS 2	REVISIONS 2	REVISIONS 2	REVISIONS 2
REVISIONS 3	REVISIONS 3	REVISIONS 3	REVISIONS 3
REVISIONS 4	REVISIONS 4	REVISIONS 4	REVISIONS 4
FIELD CHANGES	FIELD CHANGES	FIELD CHANGES	FIELD CHANGES
SKAGROCK BRIDGE		SIGNATURE	
SKAGROCK BROOK		P.E. NUMBER	
ORIENT		DATE	
ARROSTOCK COUNTY			
CROSS SECTIONS			
SHEET NUMBER			
13			
OF 16			

Username: daniel.p.boissoneau Date:12/10/2012

Division: BRIDGE

Filename: ... \msta\014\_Box\_Details.dgn

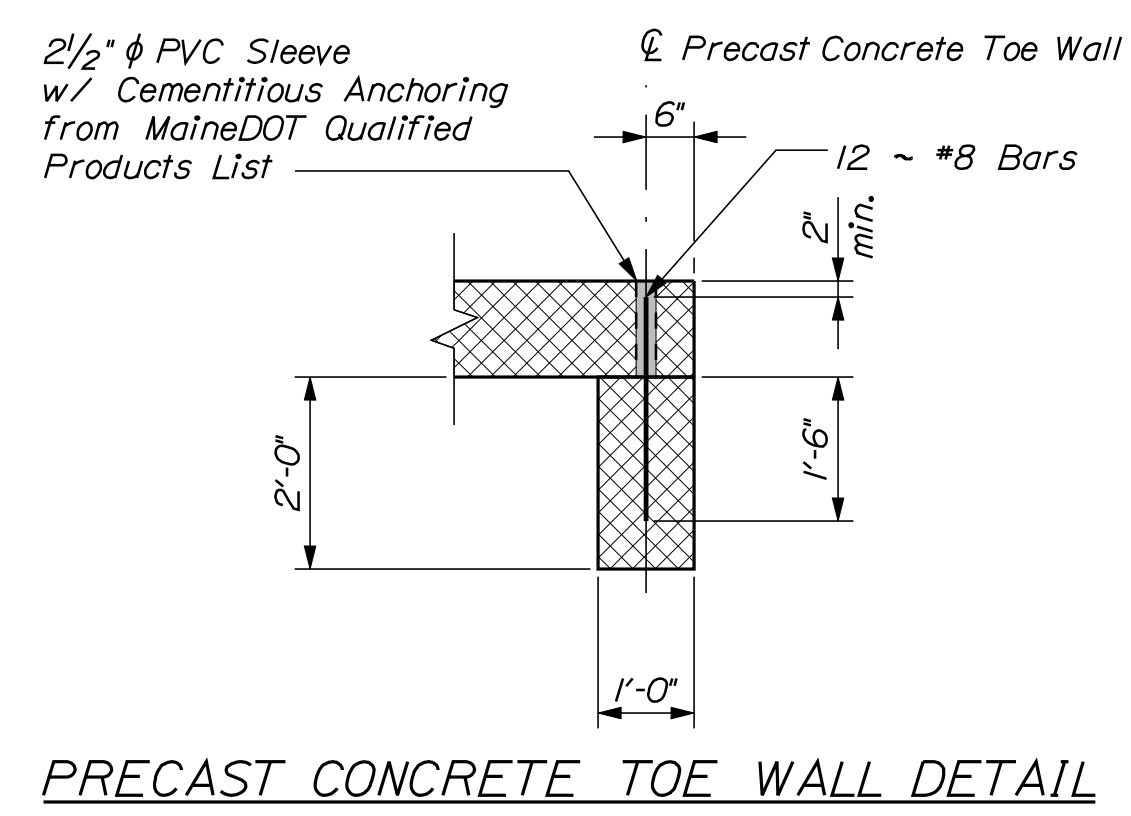
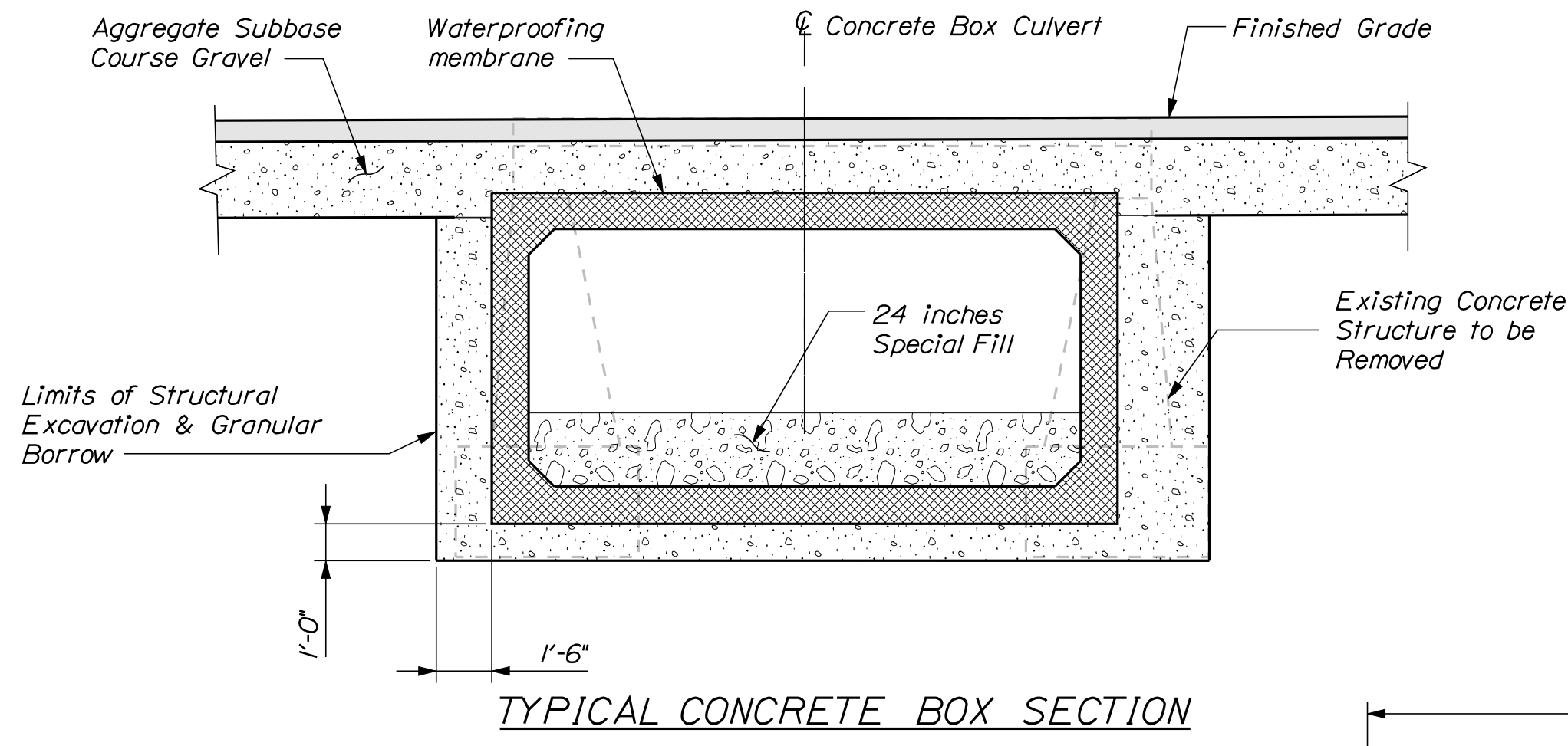

**PRECAST CONCRETE ARCHES OR BOXES NOTES**

1. The construction, handling, and assembly of the precast units shall be in accordance with Special Provisions Section 534, Precast Structural Concrete, and with the manufacturer's specifications as applicable.
2. Install high performance membrane waterproofing over the top and to 12 inches down the exterior sides of the precast units.

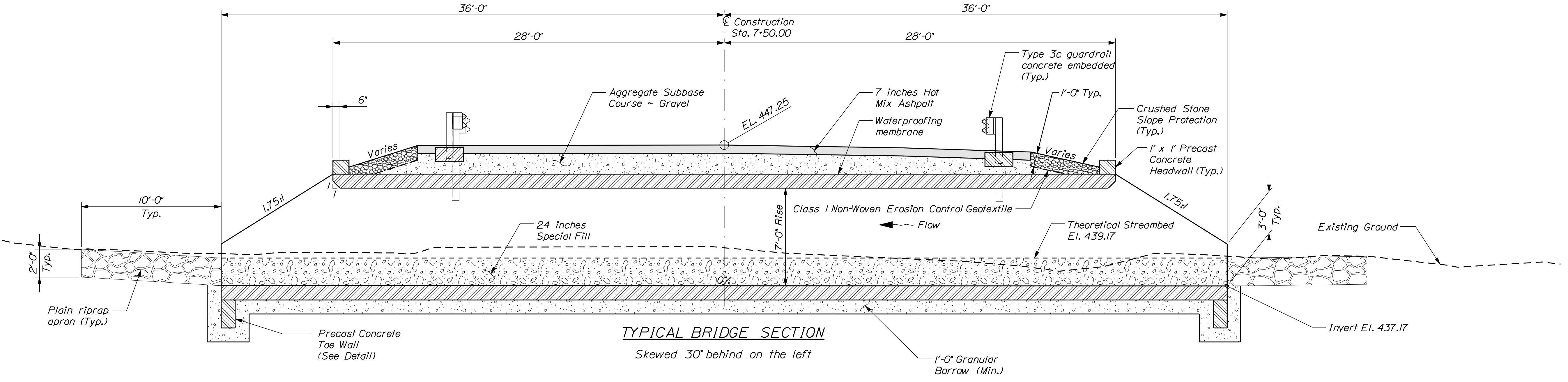
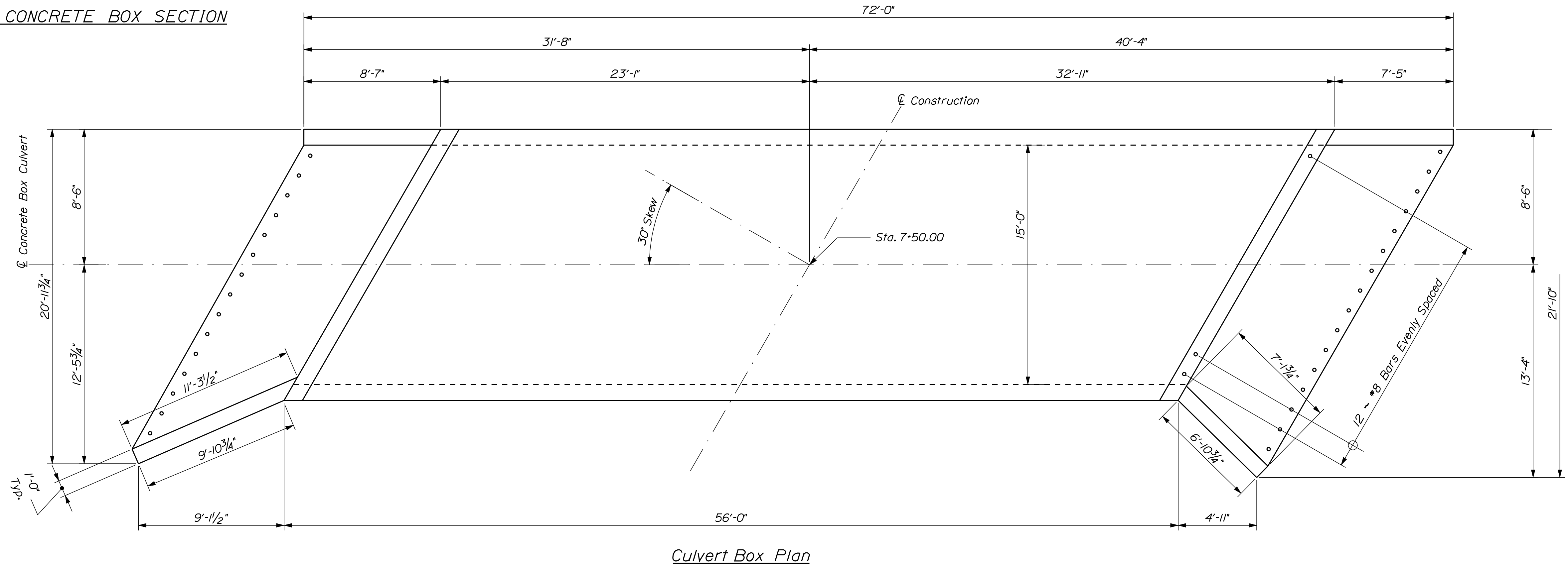

STATE OF MAINE		DEPARTMENT OF TRANSPORTATION		BRIDGE NO. 2772		BRIDGE PLANS	
		BR-1787(700)X		WIN		17877.00	
SKAGROCK BRIDGE		SKAGROCK BROOK		AROOSTOOK COUNTY		CONCRETE BOX DETAILS	
ORIENT						SHEET NUMBER	
						14	
						OF 16	
PROJ. MANAGER	S. Dodge	BY	D. Sullivan	DATE	JUN 2011	SIGNATURE	
DESIGN DETAILED	B. Reeves	CHECKED/REVIEWED		DESIGN DETAILED		P.E. NUMBER	
DESIGN DETAILED		DESIGN DETAILED		DESIGN DETAILED		DATE	
REVISIONS 1		REVISIONS 1		REVISIONS 1			
REVISIONS 2		REVISIONS 2		REVISIONS 2			
REVISIONS 3		REVISIONS 3		REVISIONS 3			
REVISIONS 4		REVISIONS 4		REVISIONS 4			
FIELD CHANGES							



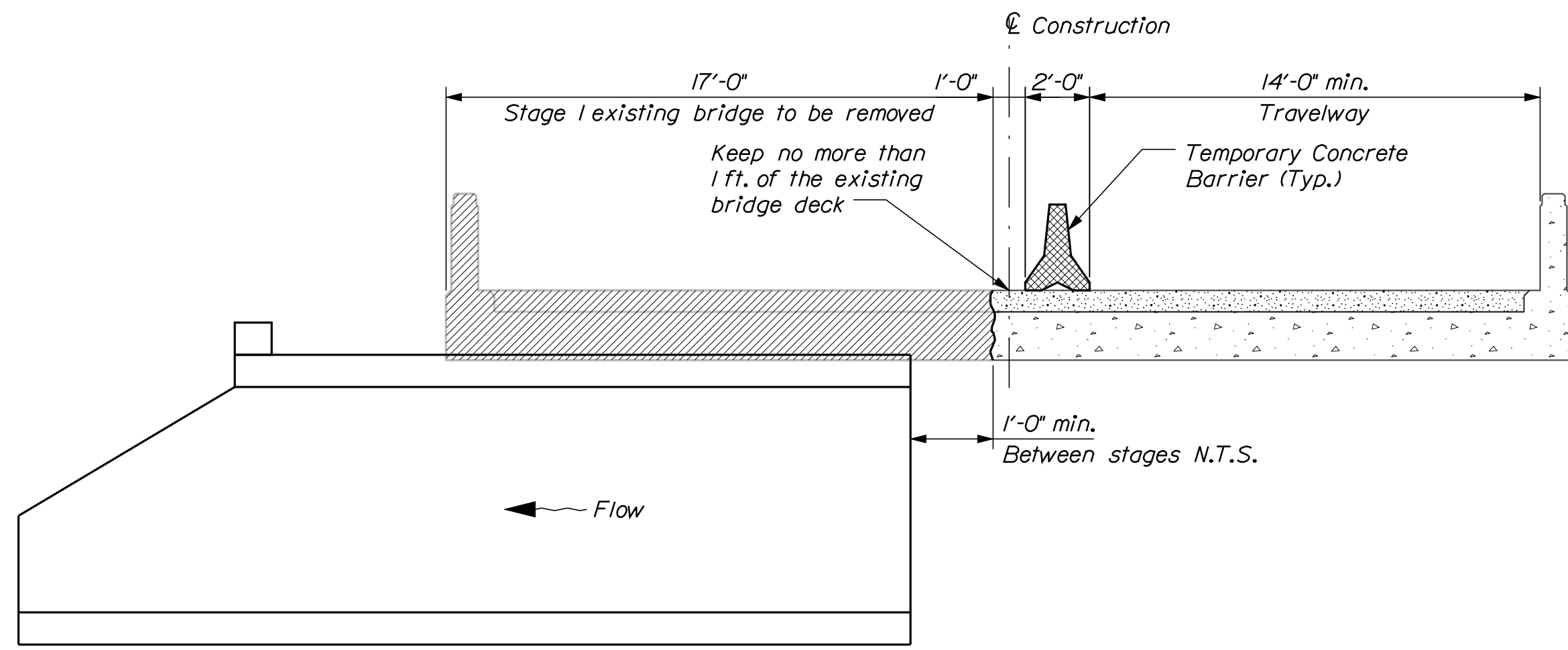

STAGE 1

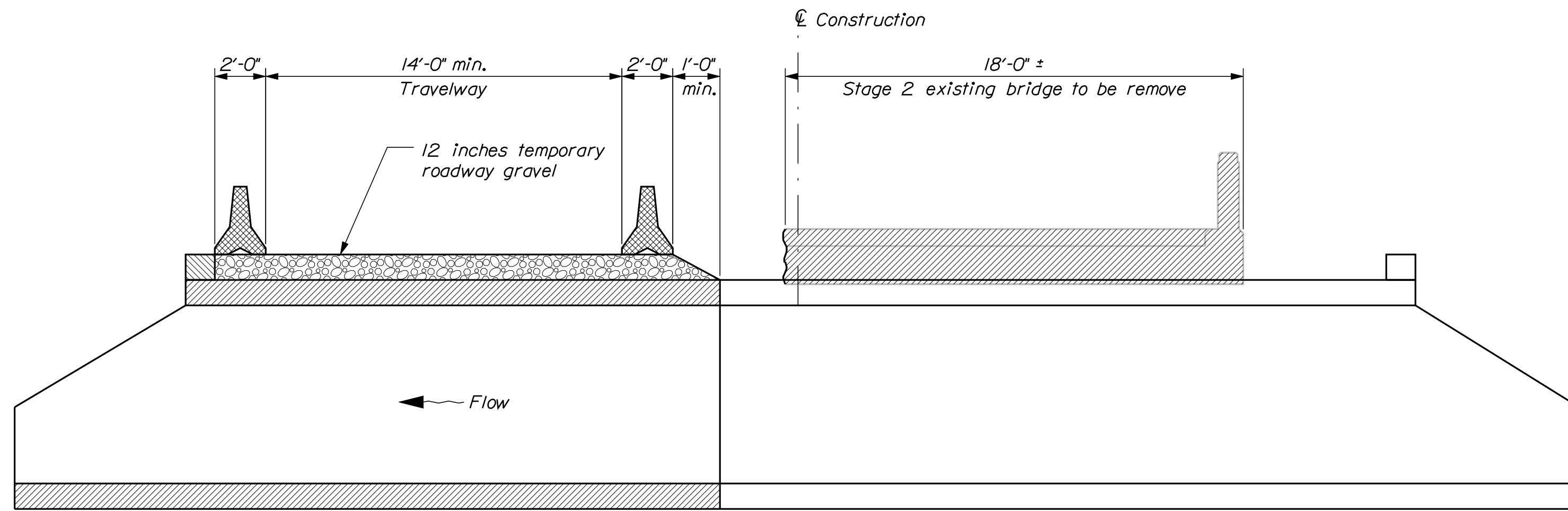

STAGE 2

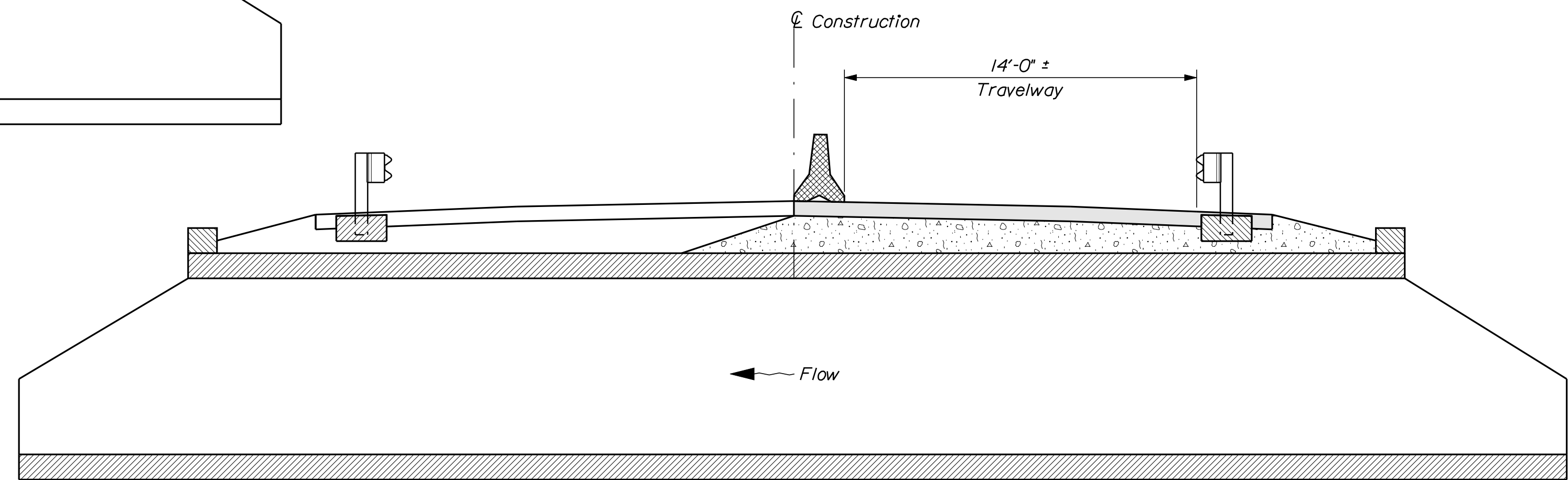

STAGE 3

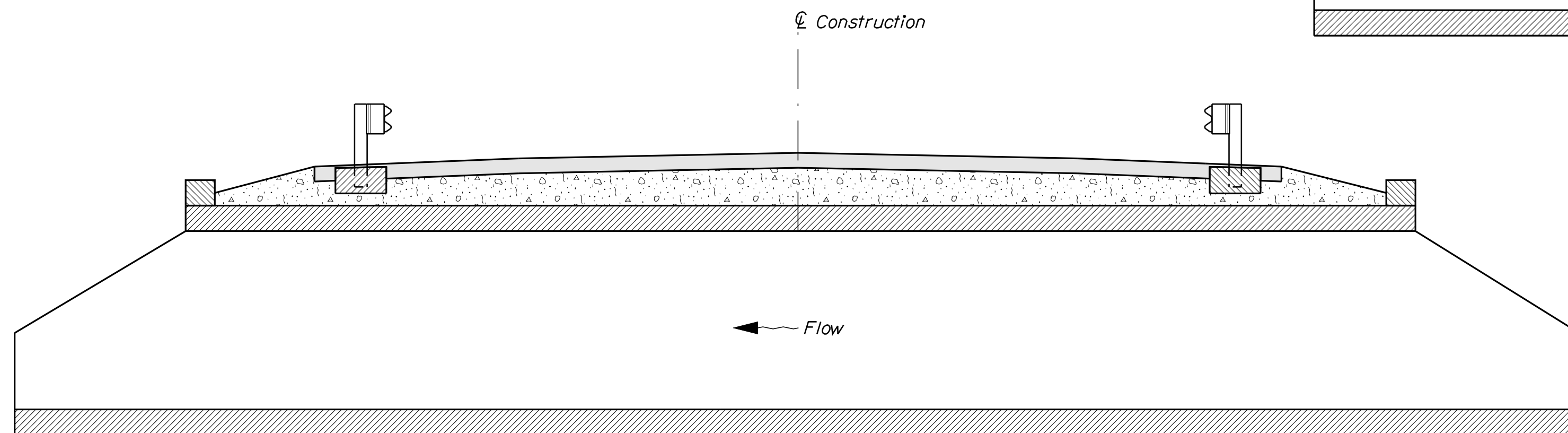

STAGE 4

STAGE CONSTRUCTION NOTES:

- Stage 1 - Maintain one 14'-0" min. wide lane of alternating traffic using traffic signals on upstream side. Remove the existing bridge as shown on the plans. Construct downstream portion of concrete box culvert.
- Stage 2 - Place 12 inches of temporary roadway gravel with two temporary concrete barriers. Provide one 14'-0" wide lane of alternating traffic using traffic signals over the newly installed concrete box culvert on downstream end. Remove remaining existing bridge. Construct upstream portion of concrete box culvert.
- Stage 3 - On upstream side provide aggregate subbase, concrete embedded guardrail type 3c and Base Pavement. Set up one lane of alternating traffic on the upstream side. Maintain one lane of traffic at all times with traffic signals.
- Stage 4 - Remove temporary concrete barriers and 6 inches of temporary roadway gravel. Place aggregate subbase, concrete embedded guardrail type 3c, Base Pavement and Surface Pavement. Upon completion of Surface Pavement open to traffic.

1. Temporary concrete barrier on the existing and new bridge deck shall be positively attached to the bridge deck. Attachments shall meet the requirements of AASHTO LRFD for a TL-4 loading condition. The method of attachment shall be designed and stamped by a Professional Engineer licensed in the State of Maine and approved by the Resident. Payment for attachment shall be considered incidental to Item 526.301.

STATE OF MAINE	BRIDGE NO. 2772	BRIDGE PLANS
DEPARTMENT OF TRANSPORTATION	WIN	17877.00
BR-1787(700)X		

PROJ. MANAGER	DATE
DESIGN-DETAILED	JUN 2011
CHECKED-REVIEWED	
DESIGN-DETAILED	
REVISIONS 1	
REVISIONS 2	
REVISIONS 3	
REVISIONS 4	
FIELD CHANGES	

SKAGROCK BRIDGE	ORIENT
SKAGROCK BROOK	SKAGROCK COUNTY
AROOSTOOK COUNTY	STAGE CONSTRUCTION

SHEET NUMBER
15
OF 16

Username: daniel.boissoneau Date: 12/10/2012

Division: BRIDGE

Filename: ... \00\ROW\MSTA001\_RWPLAN1.dgn

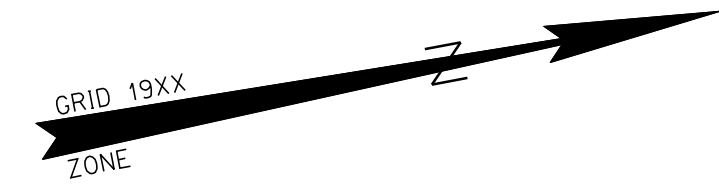

TYPHOON LLC  
ITEM NO. (1)  
TEMP. CONST. RIGHTS = 0.13± AC. (1)  
TOTAL AREA = VAST ACREAGE

TEMP. CONST. RIGHTS  
TYPHOON LLC  
TO  
STATE OF MAINE  
DATED: 10/24/12

TEMP. CONST. RIGHTS  
NEW FOREST FUND IV LLC  
TO  
STATE OF MAINE  
DATED: 10/24/12

NEW FOREST FUND IV LLC  
ITEM NO. (2)  
TEMP. CONST. RIGHTS = 0.13± AC. (1)  
TOTAL AREA = 6,066± AC. (EAST GRAND WATERSHED INITIATIVE)

CURVE DATA #1  
PI = 3+30.31  
D = 3°34'51.6"  
Δ = 16°22'55.5" Rt.  
R = 1600.00'  
L = 457.47'  
T = 230.31'  
E = 16.49'

CURVE DATA #2  
PI = 10+65.94  
D = 0°54'34.0"  
Δ = 3°26'19.0" Lt.  
R = 6300.00'  
L = 378.09'  
T = 189.10'  
E = 2.84'

R/W REFERENCES  
SHC FILE NO. 2-146 (1959)  
(SHEET NO. 8 OF 16)

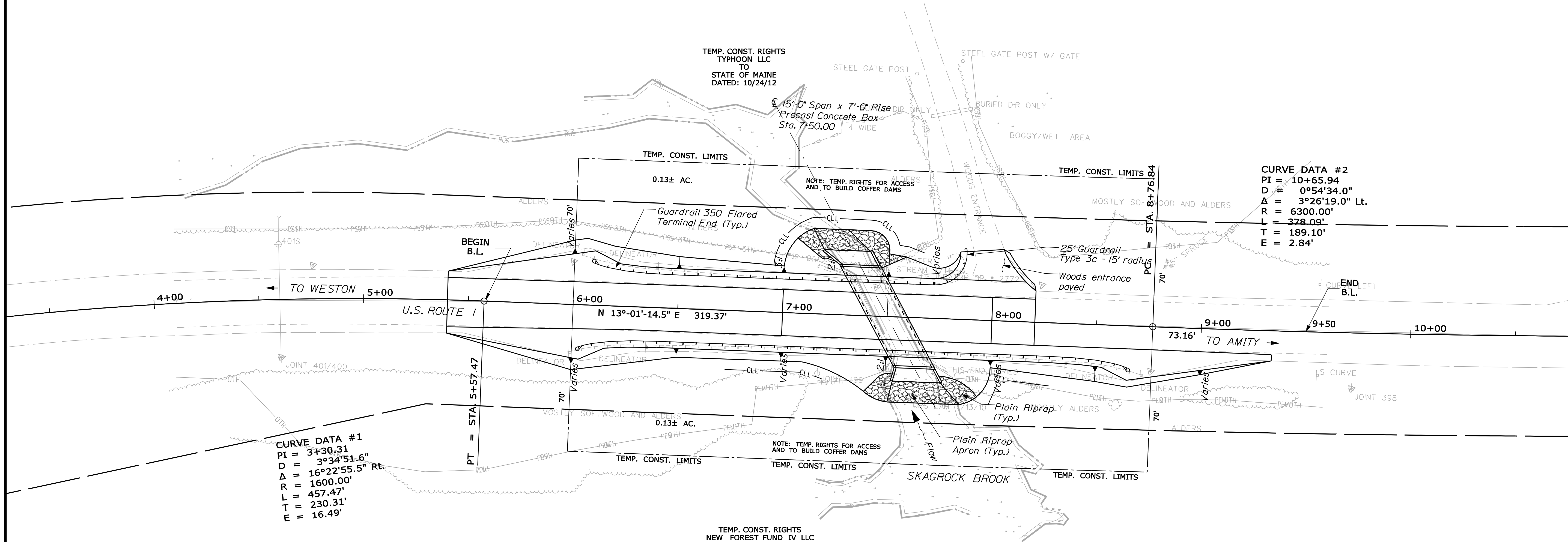

**SYMBOLS**

○	WELL
---	GRADING LIMIT LINE
---	CONSTRUCTION LIMIT LINE
---	PROPERTY LINE
---	LIMITS OF TYPHOON PORTION (L.O.P.)
---	EXISTING RIGHT OF WAY
---	NEW RIGHT OF WAY
---	NEW ROW WITHIN EXIST. ROW
---	CONTROL OF ACCESS
●	PI or RIP (IRON PIPE or PIN FOUND)
□	ST. (SEPTIC TANK)
▲	TRAVEL POINT
---	WATER LINE
---	GAS LINE
---	ELECTRIC LINE
---	TELEPHONE LINE
---	SEWER LINE

ITEM	TECH	CHECKED
BASE MAP		
EXIST. R/W		
PROP. LINES		
AREAS		

STATE OF MAINE  
DEPARTMENT OF TRANSPORTATION  
16 STATE HOUSE STATION - AUGUSTA, ME 04333-0016  
ORIENT  
RIGHT OF WAY MAP

SKAGROCK BRIDGE  
OVER  
SKAGROCK BROOK

BRIDGE NO. 2772

WIN 17877.00

NO.	DATE	REVISIONS DESCRIPTION	BY	PLAN FILED IN PLAN BOOK		COUNTY RECORD					
				NO.	GRANTOR	INSTRUMENT	DATE	BOOK	PAGE		

DAVID BERNHARDT  
COMMISSIONER  
KENNETH L. SWEENEY  
CHIEF ENGINEER  
DATE

PLAN NOT TO BE RECORDED

STATE HIGHWAY "309"  
U.S. ROUTE 1  
ORIENT AROOSTOOK COUNTY  
FEDERAL AID PROJECT NO. STP-1787(700)X  
JULY 2012  
SCALE 1" = 25'  
RIGHT-OF-WAY MAP  
SHEET 1 OF 1  
D.O.T. FILE NO. 2-544

SHEET NUMBER  
**16**  
OF 16