

STATE OF MAINE
DEPARTMENT OF TRANSPORTATION



CITY OF BIDDEFORD
YORK COUNTY
MAIN STREET
PEDESTRIAN SAFETY IMPROVEMENTS



LOCATION MAP

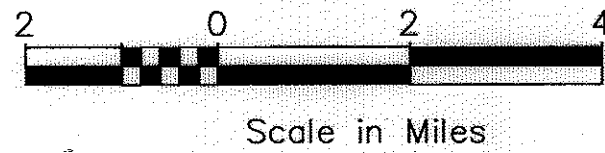

Scale in Miles

LAYOUT SCALE



Scale in Feet

PLAN LEGEND

Town, County, State	Centerline—Existing
Property Lines	Centerline—Proposed
R/W Lines—Existing	Travelway—Existing
R/W Lines—Proposed	Travelway—Proposed
Culvert—Existing	Railroad
Culvert—Proposed	Catch Basins ■ Existing ■ Proposed
Curbing	Manholes ○ Existing ● Proposed
Type 1	Proposed Underdrain
Type 2	Proposed Ditch
Type 3	Existing Ditch
Outline of Bodies of Water	Utility Poles ♦ Existing ♦ Proposed
Ledge	Fire Hydrants ● Existing ● Proposed
Buildings	Existing Water Line
Trees	Existing San. Sewer
Tree Line	Existing San. Sewer Manhole⊙
Clearing Limit Line	Guardrail—Existing
	Guardrail—Proposed
	Guardrail—Cable, Other

Description	Sheet No.
Title Sheet	1
General Notes and Details	2
Site Plan	3
Site Plan	4
Schedule of Values	5

WRIGHT-PIERCE
Engineering a Better Environment

Offices Throughout New England
888.621.8156 | www.wright-pierce.com

PROGRAM AREA:
SCOPE OF WORK:

STATE OF MAINE DEPARTMENT OF TRANSPORTATION	APPROVED	DATE
COMMISSIONER	<i>[Signature]</i>	11/9/10
CHIEF ENGINEER	<i>[Signature]</i>	11/9/10

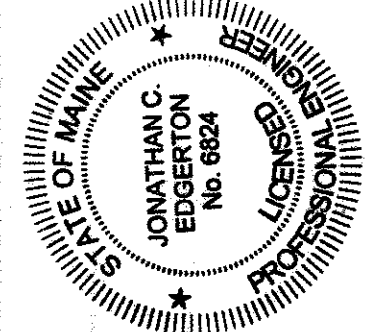

SIGNATURE	P.E. NUMBER	DATE
<i>[Signature]</i>	6824	Nov. 2, 2010

PROJECT INFORMATION	PROJECT COMPLETION DATE
PROGRAM	
PROJECT MANAGER	
DESIGNER	
CONSULTANT	
PROJECT RESIDENT	
CONTRACTOR	

PIN 17514.05

CITY OF BIDDEFORD MAIN STREET	TITLE SHEET
----------------------------------	-------------

SHEET NUMBER
1
OF 5

GENERAL NOTES

WORK ITEMS DESCRIBED IN THE GENERAL NOTES ARE INCIDENTAL TO THE CONTRACT AND ARE ACCESSORY TO OR INCORPORATED INTO THE WORK AND HAVE NO SEPARATE PAY ITEM. UNLESS OTHERWISE PROVIDED FOR IN THE CONTRACT, THE COST OF THE FOLLOWING ITEMS SHALL BE INCLUDED IN THE CONTRACTOR'S PRICES FOR THE PAY ITEMS. THERE WILL BE NO SEPARATE PAYMENTS. INCIDENTAL WORK ITEMS INCLUDE, BUT ARE NOT LIMITED TO THE FOLLOWING:

1. BELOW AND ABOVE GRADE PUBLIC UTILITY INFORMATION IS ONLY APPROXIMATE AND MAY NOT BE COMPLETE. PRIVATE UNDERGROUND UTILITIES SUCH AS, BUT NOT LIMITED TO, SEWER LINES, WATER LINES, AND BURIED ELECTRICAL SERVICE ENTRANCES ARE NOT SHOWN. THE CONTRACTOR SHALL ASCERTAIN THE LOCATION AND SIZE OF EXISTING UTILITIES IN THE FIELD WITH THE RESPECTIVE UTILITY REPRESENTATIVE PRIOR TO COMMENCING WORK. TEST PITS MAY BE REQUIRED.
- UTILITY CONTACTS ARE AS FOLLOWS:

DIG SAFE:
TEL: 1-888-344-7233

SEWER AND STORMWATER:
BIDDEFORD PUBLIC WORKS
WASTE WATER DIVISION
371 HILL STREET
BIDDEFORD, ME 04005
207-282-1579

CABLE TELEVISION:
TIME WARNER CABLE
118 JOHNSON RD
PORTLAND, ME 04102
207-253-2291

NATURAL GAS:
UNITIL
1075 FOREST AVENUE
PO BOX 3586
PORTLAND, ME 04104
207-541-2528
207-541-2504

ELECTRIC:
CENTRAL MAINE POWER
162 CANCO ROAD
PORTLAND, ME 04103
207-791-1041

WATER:
BIDDEFORD & SACO WATER COMPANY
181 ELM STREET
P.O. BOX 304
BIDDEFORD, ME 04005
207-282-1543

TELEPHONE:
FAIRPOINT/NEE TELEPHONE
645 ODJUN ROAD
BANGOR, MAINE 04401
1-207-991-6712

2. MAINE DEPARTMENT OF TRANSPORTATION PROJECT IDENTIFICATION NUMBER: 17514.05
3. DO NOT SCALE DRAWINGS UNLESS OTHERWISE NOTED. EXISTING CONDITIONS BASED ON FIELD MEASUREMENTS BY WRIGHT-PIERCE AND AERIAL PHOTOGRAPHY AS PROVIDED BY THE MAINE OFFICE OF GEOGRAPHIC INFORMATION SYSTEMS. ALL PLAN DIMENSIONS AND LOCATIONS ARE APPROXIMATE.
4. THE CONTRACTOR SHALL FIELD VERIFY LAYOUT AND LIMITS OF WORK WITH THE OWNER PRIOR TO CONSTRUCTION.
5. HE CONTRACTOR SHALL COORDINATE WITH THE OWNER, UTILITIES, AND OTHERS AS REQUIRED BY THE CONTRACT, INCLUDING RELATED QUALITY ASSURANCE INSPECTIONS.
6. THE CONTRACTOR SHALL BE RESPONSIBLE FOR RESETTling ALL EXISTING PROPERTY MONUMENTATION THAT IS DISTURBED BY HIS OPERATIONS AT NO EXPENSE TO THE OWNER. THIS WORK IS TO BE DONE BY A LAND SURVEYOR REGISTERED IN THE STATE OF MAINE.
7. THE CONTRACTOR SHALL RESET OR REBUILD WALKWAYS/STEPS, CURBS, CONCRETE SLABS, STRUCTURES AND FENCES, AND RESTORE PAINT MARKINGS, MULCH, TREES, SHRUBS AND OTHER FEATURES DISTURBED BY HIS OPERATIONS, AS IDENTIFIED ON THE DRAWINGS OR DIRECTED BY THE ENGINEER.
8. THE CONTRACTOR SHALL REPAIR AND REPLACE UTILITIES DAMAGED BY CONSTRUCTION ACTIVITIES OR FOR CONTRACTOR CONVENIENCE AND SHALL PROPERLY DISPOSE OF ANY CORRESPONDING REMOVED MATERIALS.
9. THE CONTRACTOR SHALL RESET OR REPLACE EXISTING STREET SIGNS DISTURBED BY THE WORK IN ACCORDANCE WITH THE M.U.T.C.D. NEW SIGN POSTS SHALL BE PROVIDED AS NECESSARY. THE CONTRACTOR SHALL COORDINATE HIS WORK WITH THE CITY OF BIDDEFORD'S PUBLIC WORKS DEPARTMENT.
10. THE CONTRACTOR SHALL RESTORE ALL PRIVATE PROPERTY DISTURBED DURING CONSTRUCTION TO ITS PRECONSTRUCTION CONDITION. CONTRACTOR SHALL TAKE PRECAUTIONS IN ORDER TO MINIMIZE DISTURBANCE TO PRIVATE PROPERTY. ALL REPAIRS TO PRIVATE PROPERTY SHALL BE THE RESPONSIBILITY OF THE CONTRACTOR.
11. ALL MANHOLES, VALVE BOXES AND OTHER BURIED FACILITIES WITH SURFACE ACCESS SHALL BE ADJUSTED TO MATCH FINAL GRADES, UNLESS OTHERWISE NOTED. THE TOP OF THE MANHOLE FRAMES SHALL BE SET FLUSH WITH FINISH GRADE. CONTRACTOR SHALL COORDINATE ALL UTILITY RELOCATION AND INSTALLATION WITH APPROPRIATE UTILITY COMPANIES.
12. THE CONTRACTOR IS TO TAKE SPECIAL CARE NOT TO DAMAGE TREES WITHIN OR ADJACENT TO THE CONSTRUCTION AREA.
13. THE CONTRACTOR SHALL COMPLY WITH ALL APPLICABLE REGULATIONS OF THE OCCUPATIONAL SAFETY AND HEALTH ADMINISTRATION (OSHA).
14. THE CONTRACTOR SHALL TAKE PRE-CONSTRUCTION PHOTOGRAPHS AND PROVIDE COPIES TO THE OWNER PRIOR TO CONSTRUCTION. THIS WORK SHALL INCLUDE ALL PRIVATE PROPERTY THAT MAY BE IMPACTED BY THE PROJECT.
15. THE CONTRACTOR SHALL FURNISH AND MAINTAIN A TELEPHONE NUMBER WHERE HE CAN BE REACHED 24 HOURS A DAY, 7 DAYS A WEEK, UNTIL THE PROJECT IS SUBSTANTIALLY COMPLETE.
16. LIMIT OF WORK IS AS INDICATED IN THE DRAWINGS. CONTRACTOR SHALL COORDINATE STAGING OF MATERIALS WITH THE OWNER PRIOR TO CONSTRUCTION.
17. EXCESS MATERIAL, INCLUDING REMOVED ASPHALT, SHALL BE DISPOSED OF BY THE CONTRACTOR AT NO COST TO THE OWNER. THE CONTRACTOR SHALL DISPOSE OF ALL UNSUITABLE AND EXCESS MATERIAL IN ACCORDANCE WITH THE APPLICABLE SECTIONS OF THE CONTRACT DOCUMENTS AND ALL STATE, FEDERAL AND LOCAL REGULATIONS. AT THE OWNER'S REQUEST, EXCESS MATERIAL SHALL BE TURNED OVER TO THE PUBLIC WORKS DEPARTMENT OF BIDDEFORD.
18. IN THOSE INSTANCES WHERE POWER OR TELEPHONE POLE SUPPORT IS REQUIRED, THE CONTRACTOR SHALL PROVIDE A MINIMUM 48-HOUR NOTIFICATION TO CENTRAL MAINE POWER COMPANY OR FAIRPOINT, RESPECTIVELY. NO ADDITIONAL PAYMENT WILL BE PROVIDED FOR TEMPORARY BRACING OF UTILITIES.
19. ALL BURIED FACILITIES INCLUDING STORMDRAINS, SEWERS AND ELECTRIC HANDHOLES WITH SURFACE ACCESS SHALL BE ADJUSTED TO MATCH FINAL GRADES, UNLESS OTHERWISE NOTED. CONTRACTOR SHALL COORDINATE WORK WITH RESPECTIVE UTILITIES FOR ALL OTHER FACILITIES TO BE ADJUSTED.
20. THE CONTRACTOR SHALL BE RESPONSIBLE FOR THE PREVENTION OF EROSION. ALL DISTURBED EARTH SURFACES ARE TO BE STABILIZED IN THE SHORTEST PRACTICAL TIME AND TEMPORARY EROSION CONTROL DEVICES SHALL BE EMPLOYED UNTIL SUCH A TIME AS ADEQUATE SOIL STABILIZATION HAS BEEN ACHIEVED. TEMPORARY STORAGE OF EXCAVATED MATERIAL IS TO BE IN A MANNER THAT WILL MINIMIZE EROSION. MATERIALS AND METHODS USED FOR TEMPORARY EROSION CONTROL SHALL BE AS SPECIFIED BY THE "MAINE EROSION AND SEDIMENT CONTROL BMP'S", PREPARED BY THE MAINE DEPARTMENT OF ENVIRONMENTAL PROTECTION.
21. ALL STORM DRAINAGE OUTLETS SHALL BE PROTECTED TO PREVENT ENTRY OF SEDIMENT FROM RUNOFF WATERS DURING CONSTRUCTION AND AS DIRECTED BY THE OWNER. THE CONTRACTOR SHALL BE RESPONSIBLE FOR THE REMOVAL AND DISPOSAL OF ALL COLLECTED SEDIMENT, AND THAT WHICH COLLECTS IN THE STORM DRAIN SYSTEM UNTIL THE PROJECT IS SUBSTANTIALLY COMPLETE AND READY FOR FINAL PAYMENT.
22. THE CONTRACTOR SHALL CONTROL DUST TO A TOLERABLE LIMIT. THE CONTRACTOR SHALL NOT TRACK OR SPILL EARTH OR DEBRIS ON PUBLIC STREETS OUTSIDE THE PROJECT AREA. STREETS OPENED TO THE PUBLIC SHALL BE KEPT SWEEP AND FREE OF DEBRIS DAILY.
23. THE CONTRACTOR SHALL PRODUCE OR FURNISH PROJECT RECORDS AS REQUIRED BY THE CONTRACT DOCUMENTS, INCLUDING, BUT NOT LIMITED TO CONSTRUCTION SCHEDULES, BONDS, SHOP DRAWINGS, WARRANTIES, GUARANTEES, CERTIFICATIONS, AND OTHER SUBMITTALS.
24. THE FOLLOWING ITEMS SHALL ALSO BE CONSIDERED INCIDENTAL: TEMPORARY CONSTRUCTION; TEMPORARY PAVING; WEATHER PROTECTION; VISITS TO THE PROJECT SITE OR ELSEWHERE BY PERSONNEL OR AGENTS OF THE CONTRACTOR INCLUDING MANUFACTURER'S REPRESENTATIVES, AS MAY BE REQUIRED; FACILITIES FOR THE STORAGE OF MATERIALS, SUPPLIES, AND EQUIPMENT TO BE INCORPORATED INTO THE WORK.

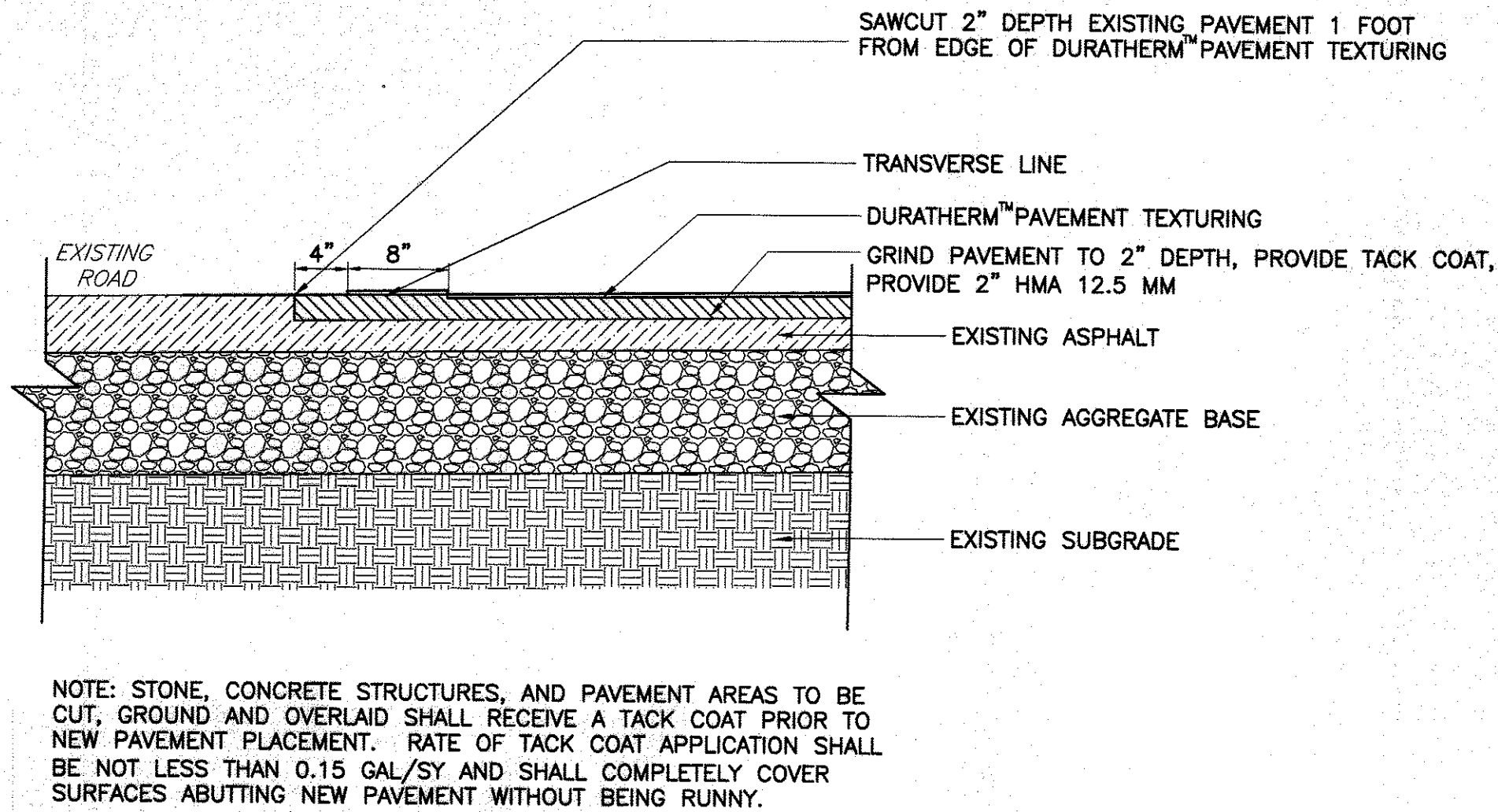
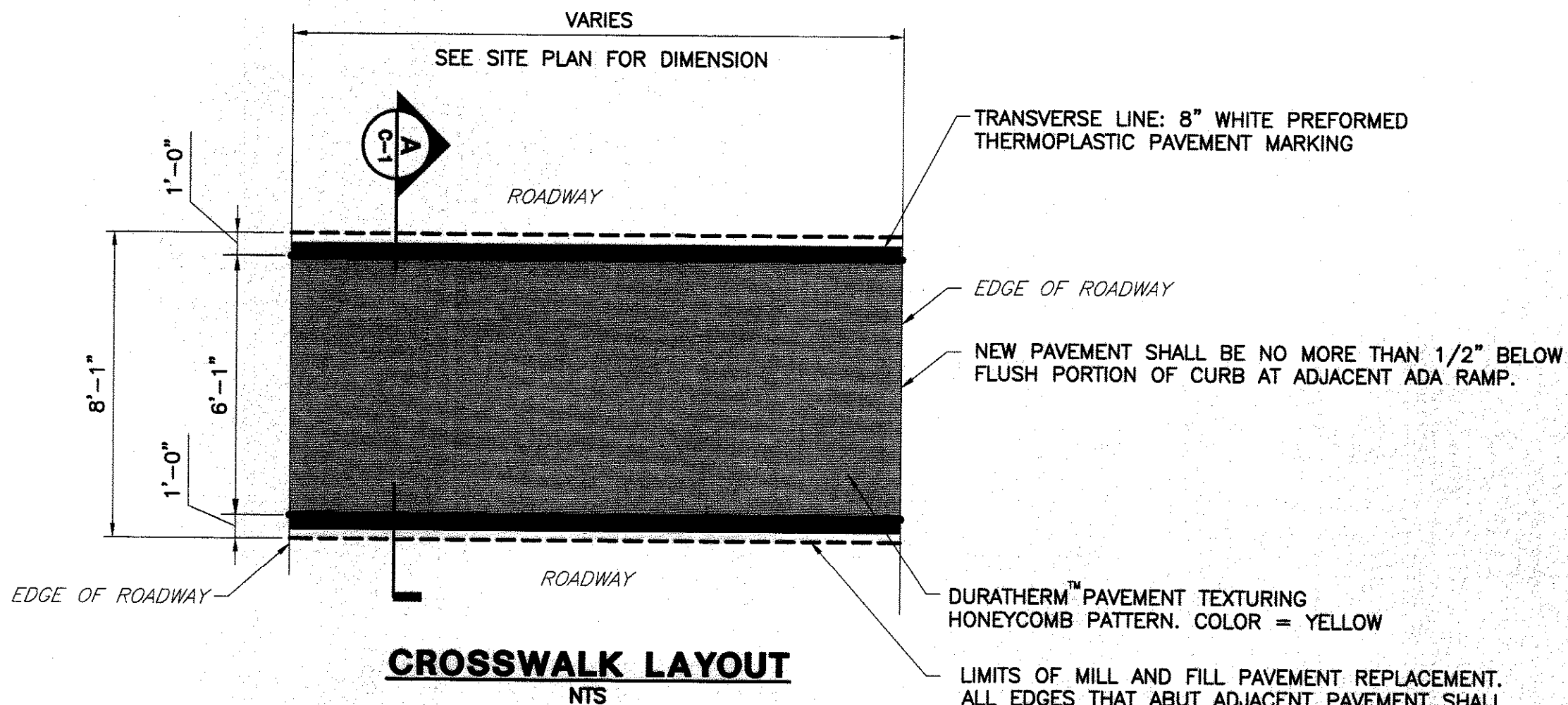

CROSSWALK SECTION
NTS

TRAFFIC CONTROL NOTES

WORK ITEMS PERTAINING TO TRAFFIC CONTROL FALL UNDER PAY ITEMS 652.39 AND 652.38 AND INCLUDE, BUT ARE NOT LIMITED TO, THE FOLLOWING:

1. THE CONTRACTOR IS RESPONSIBLE FOR MAINTAINING TRAFFIC FLOW AT ALL TIMES. THE CONTRACTOR IS REQUIRED TO SUBMIT A TRAFFIC CONTROL PLAN TO THE OWNER PRIOR TO COMMENCING CONSTRUCTION. THE WATERVILLE POLICE DEPARTMENT (207-680-4700) AND FIRE DEPARTMENT (207-680-4735) ARE TO BE NOTIFIED AT LEAST 48 HOURS IN ADVANCE OF ANY STREET CLOSING OR DETOUR.
2. THE CONTRACTOR SHALL INSTALL AND MAINTAIN TRAFFIC CONTROL DEVICES AS NECESSARY AND IN A MANNER CONSISTENT WITH THE MANUAL ON UNIFORM TRAFFIC CONTROL DEVICES (M.U.T.C.D.).

EXISTING	LEGEND	PROPOSED
PROPERTY/ROW LINE	SETBACK LINE	
EASEMENT LINE	CENTERLINE	
EDGE OF PAVEMENT	CURBING	
EDGE OF GRAVEL	EDGE OF CONCRETE	
CONTOUR	BUILDING	
STONEWALL	TREELINE	
CHAIN LINK FENCE	STOCKADE FENCE	
BARB WIRE FENCE	RETAINING WALL	
GUARDRAIL	SEWER	
SEWER FORCE MAIN	GAS	
WATER	STORM DRAIN	
UNDERDRAIN	CULVERT	
UNDERGROUND ELECTRIC	OVERHEAD ELECTRIC	
IRON PIPE/REBAR	DRILLHOLE	
MONUMENT	SURVEY CONTROL POINT	
SPOT ELEVATION	SEWER MANHOLE	
DRAINAGE MANHOLE	CATCH BASIN	
ELECTRIC MANHOLE	TELEPHONE MANHOLE	
SHUTOFF VALVE	WATER SERVICE SHUTOFF	
YARD HYDRANT	HYDRANT	
UTILITY POLE	UTILITY POLE W/ GUY	
UTILITY POLE W/ LIGHT	LIGHT POLE	
BOLLARD	FLAGPOLE	
CONIFEROUS TREE	DECIDUOUS TREE	
SHRUB	EDGE OF WATER	
STREAM	EDGE OF WETLANDS	
FLOODPLAIN	WETLANDS	
DRAINAGE FLOW	DRAINAGE SWALE	
PAVEMENT MARKINGS	SIGN	
MAILBOX	TEMPORARY BENCH MARK	
TEST PIT	TEST BORING	
TEST PROBE	MONITORING WELL	
LIMIT OF WORK	SILT FENCE	
RIPRAP	RAILROAD	
MATCHLINE	ROCK OUTCROP	

STATE OF MAINE DEPARTMENT OF TRANSPORTATION	PIN 17514.05
STATE OF MAINE DEPARTMENT OF TRANSPORTATION JONATHAN C. EDGERTON No. 6824 LICENSED PROFESSIONAL ENGINEER	DATE NOV. 2, 2010
CITY OF BIDDEFORD MAIN STREET	GENERAL NOTES AND DETAILS
SHEET NUMBER 2	OF 5

Filename:

Division:

Username:

Date:

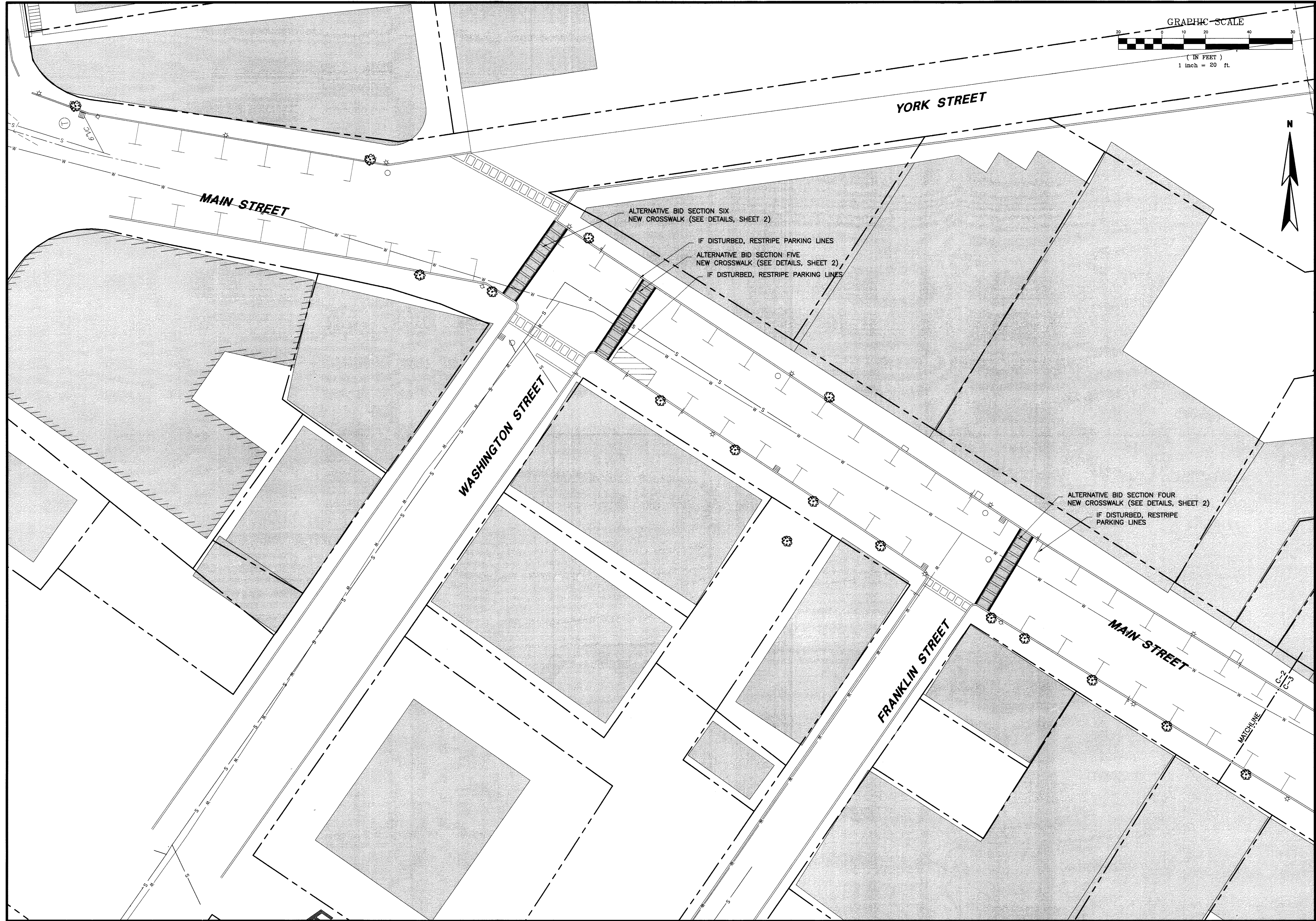

STATE OF MAINE DEPARTMENT OF TRANSPORTATION		PIN 17514.05	
CITY OF BIDDEFORD MAIN STREET		SHEET NUMBER 3 OF 5	
SITE PLAN		DATE NOV. 2, 2010	
PROJ. MANAGER DESIGN-DETAILED CHECKED-REVIEWED DESIGN-DETAILED2 DESIGN-DETAILED3 REVISIONS 1 REVISIONS 2 REVISIONS 3 REVISIONS 4 FIELD CHANGES		BY DATE	
SIGNATURE 66224		DATE NOV. 2, 2010	
P.E. NUMBER 66224		DATE NOV. 2, 2010	
STATE OF MAINE JONATHAN C. EDWARDS REGISTERED PROFESSIONAL ENGINEER NO. 6824		DATE NOV. 2, 2010	

Date:

Username:

Division:

Filename:

Estimated Quantities			
Item No.	Description	Quantity	Unit
BASE BID SECTION ONE			
202.20	REM BITUMINOUS CONC PAVEMENT	155	SY
403.208	HOT MIX ASPHALT 12.5 MM HMA SURFACE	19	Tons
409.15	BITUMINOUS TACK COAT - APPLIED	24	Gallon
627.94	PREFORMED THERMOPLASTIC PAVEMENT MARKING	200	SF
652.39	WORK ZONE TRAFFIC CONTROL	1	LS
652.38	FLAGGER	40	HR
659.10	MOBILIZATION	1	LS
940.00	SPECIAL WORK NUMBER ONE - DURATHERM™ PAVEMENT MARKING	880	SF
ALTERNATIVE BID SECTION TWO			
202.20	REM BITUMINOUS CONC PAVEMENT	45	SY
403.208	HOT MIX ASPHALT 12.5 MM HMA SURFACE	5.5	Tons
409.15	BITUMINOUS TACK COAT - APPLIED	7	Gallon
627.94	PREFORMED THERMOPLASTIC PAVEMENT MARKING	55	SF
940.00	SPECIAL WORK NUMBER ONE - DURATHERM™ PAVEMENT MARKING	240	SF
ALTERNATIVE BID SECTION THREE			
202.20	REM BITUMINOUS CONC PAVEMENT	35	SY
403.208	HOT MIX ASPHALT 12.5 MM HMA SURFACE	4	Tons
409.15	BITUMINOUS TACK COAT - APPLIED	5	Gallon
627.94	PREFORMED THERMOPLASTIC PAVEMENT MARKING	50	SF
940.00	SPECIAL WORK NUMBER ONE - DURATHERM™ PAVEMENT MARKING	230	SF
ALTERNATIVE BID SECTION FOUR			
202.20	REM BITUMINOUS CONC PAVEMENT	36	SY
403.208	HOT MIX ASPHALT 12.5 MM HMA SURFACE	4.5	Tons
409.15	BITUMINOUS TACK COAT - APPLIED	6	Gallon
627.94	PREFORMED THERMOPLASTIC PAVEMENT MARKING	55	SF
940.00	SPECIAL WORK NUMBER ONE - DURATHERM™ PAVEMENT MARKING	240	SF
ALTERNATIVE BID SECTION FIVE			
202.20	REM BITUMINOUS CONC PAVEMENT	36	SY
403.208	HOT MIX ASPHALT 12.5 MM HMA SURFACE	4.5	Tons
409.15	BITUMINOUS TACK COAT - APPLIED	6	Gallon
627.94	PREFORMED THERMOPLASTIC PAVEMENT MARKING	55	SF
940.00	SPECIAL WORK NUMBER ONE - DURATHERM™ PAVEMENT MARKING	245	SF
ALTERNATIVE BID SECTION SIX			
202.20	REM BITUMINOUS CONC PAVEMENT	37	SY
403.208	HOT MIX ASPHALT 12.5 MM HMA SURFACE	4	Tons
409.15	BITUMINOUS TACK COAT - APPLIED	6	Gallon
627.94	PREFORMED THERMOPLASTIC PAVEMENT MARKING	55	SF
940.00	SPECIAL WORK NUMBER ONE - DURATHERM™ PAVEMENT MARKING	250	SF

CITY OF BIDDEFORD
MAIN STREET
SCHEDULE OF VALUES

SHEET NUMBER
5
OF 5

STATE OF MAINE
DEPARTMENT OF TRANSPORTATION
PIN
17514.05

PROJ. MANAGER	DATE	BY	SIGNATURE	DATE
DESIGN-DRAWING				
CHECKED-REVIEWED				
DESIGN-DRAWING				
DESIGN-DRAWING				
REVISIONS 1				
REVISIONS 2				
REVISIONS 3				
REVISIONS 4				
FIELD CHANGES				