

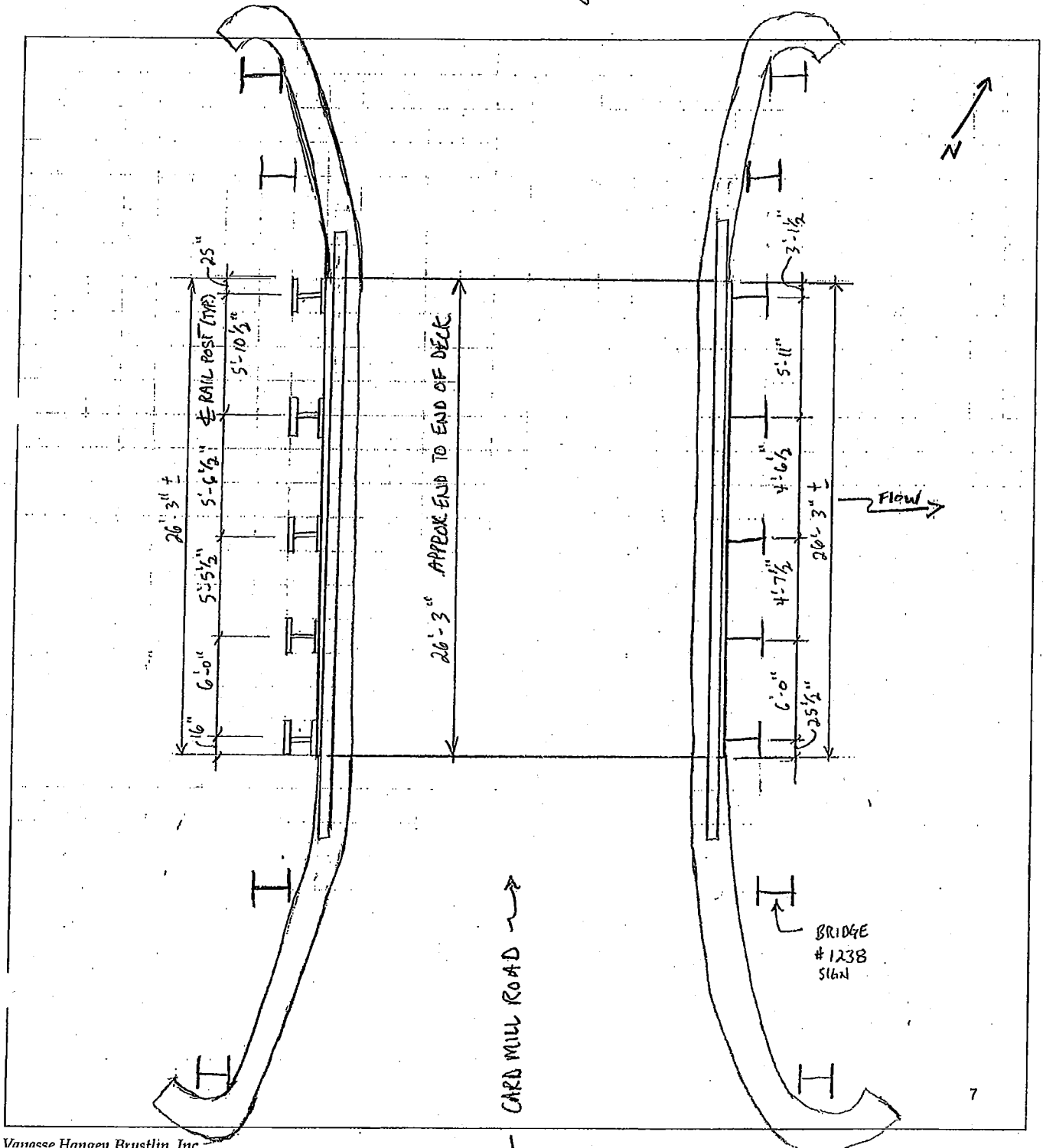

Computations

Project: MAINE LOAD Rating
 Location: Berwick, Maine
 Calculated by: KRW
 Checked by:
 Title BRIDGE Number 1238

Project # 52106.00
 Sheet 1 of 6
 Date: 10-18-11
 Date:
 Field Inspection





Computations

Project: Maine Load Rating Project # S2166-00
 Location: Berwick, Maine Sheet 2 of 6
 Calculated by: KDW Date: 10-18-11
 Checked by: Date:
 Title: Bridge ID: 1238 Field Inspection

- 10 stringers
- 5 Rail Posts supported on transverse W-beams or 1/2 Long timbers
- Transverse Timbers
- Pavement
- Timber deck planks appear to be eastern hemlock (can't tell whether it was treated - does not appear to be creosote treated)

- Railings posts appear to be W6 x 25 standard steel beam guard rail posts. Continuous W section dimensions as shown on separate sketch.
- Pipe rail marked as 3" inside dia. x 0.266" wall thickness.

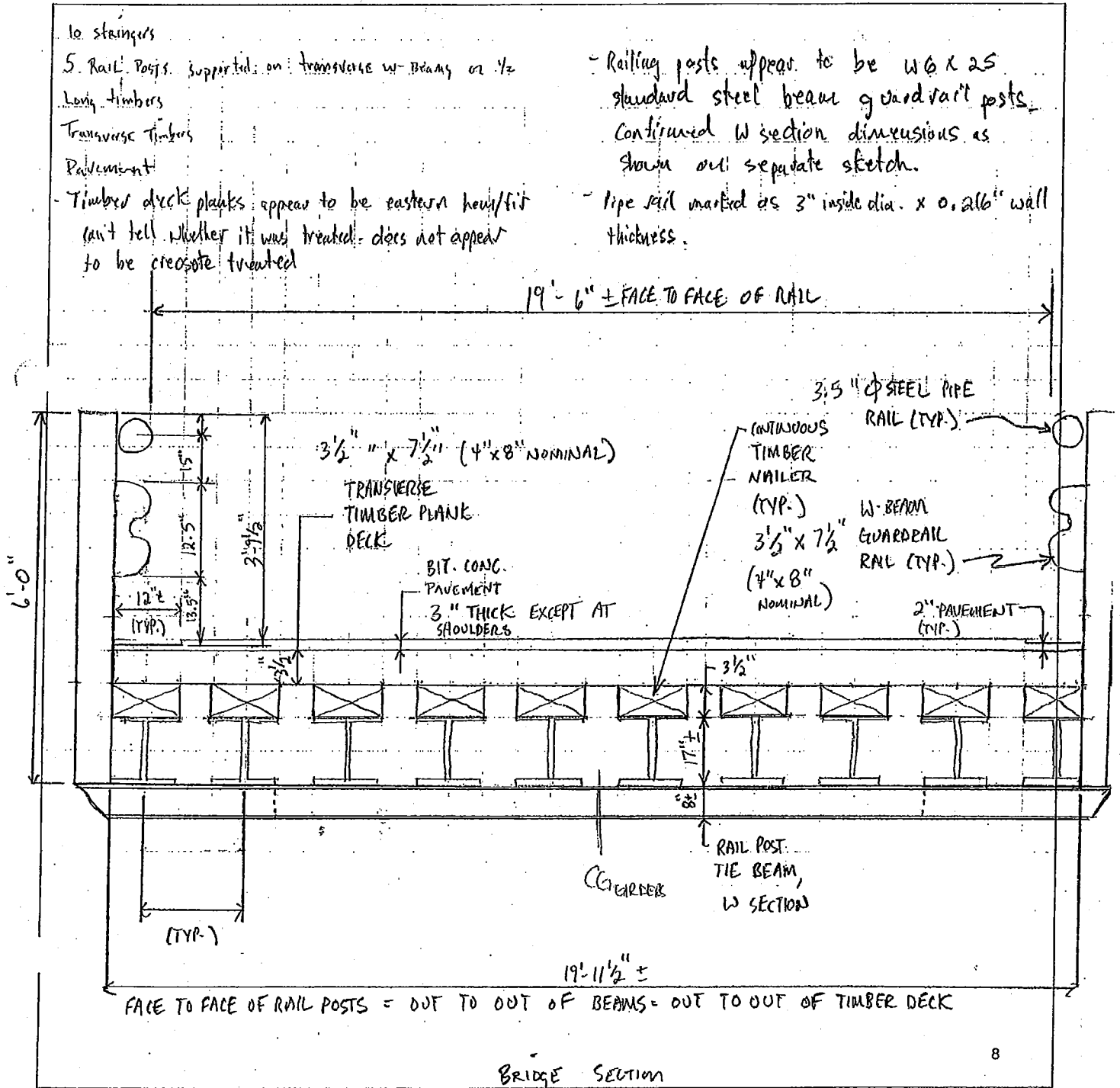

BRIDGE SECTION
(LOOKING NORTH)



Computations

Project: MAINE DOT LRFR

Project # 52166.00

Location: Berwick, ME

Sheet 3 of 6

Calculated by: T.S. Bryant

Date: 10/10/2011

Checked by:

Date:

Title Bridge # 1238 Field Inspection Notes

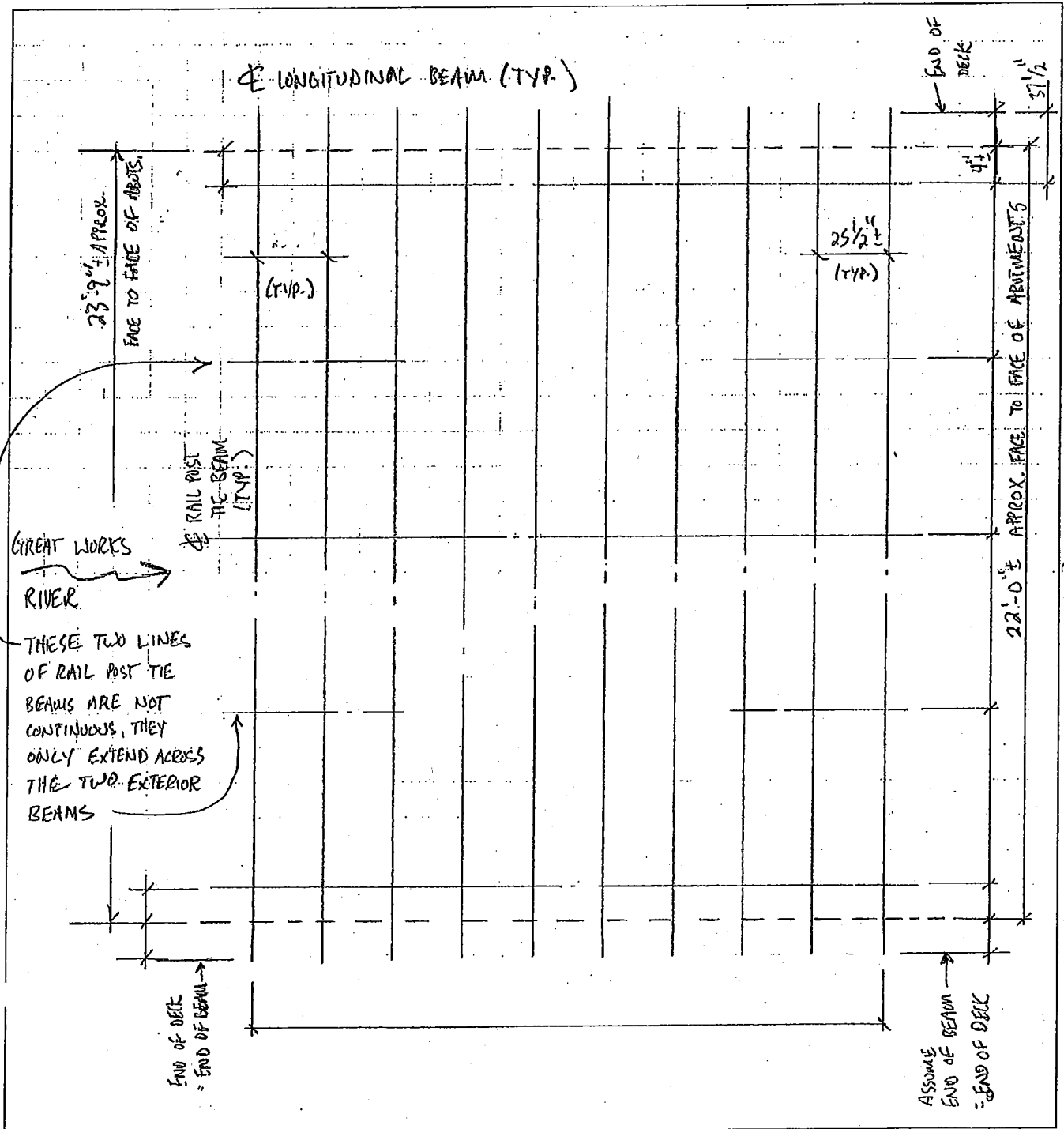



Computations

Project: Maine DOT LRFR
 Location: Berwick, ME
 Calculated by: T.S. Boycut
 Checked by:
 Title: Bridge # 1238
 Field Inspection Notes

Project # 52166.06
 Sheet 4 of 6
 Date: 10/18/2011
 Date:)
 ✓

NOTE: SEVERE CORROSION ON ALL BEAMS, HEAVY LAMINAR RUST. IN RATING USE
 1/16" SECTION LOSS FROM WEB AND BOTH FLANGE THICKNESSES.
 (TOTAL)

DIMENSIONS SHOWN ARE NOMINAL
 DIMENSIONS, SUBTRACT SECTION LOSS
 FROM THESE TO GET ACTUAL
 DIMS. TO USE IN LOAD RATING.

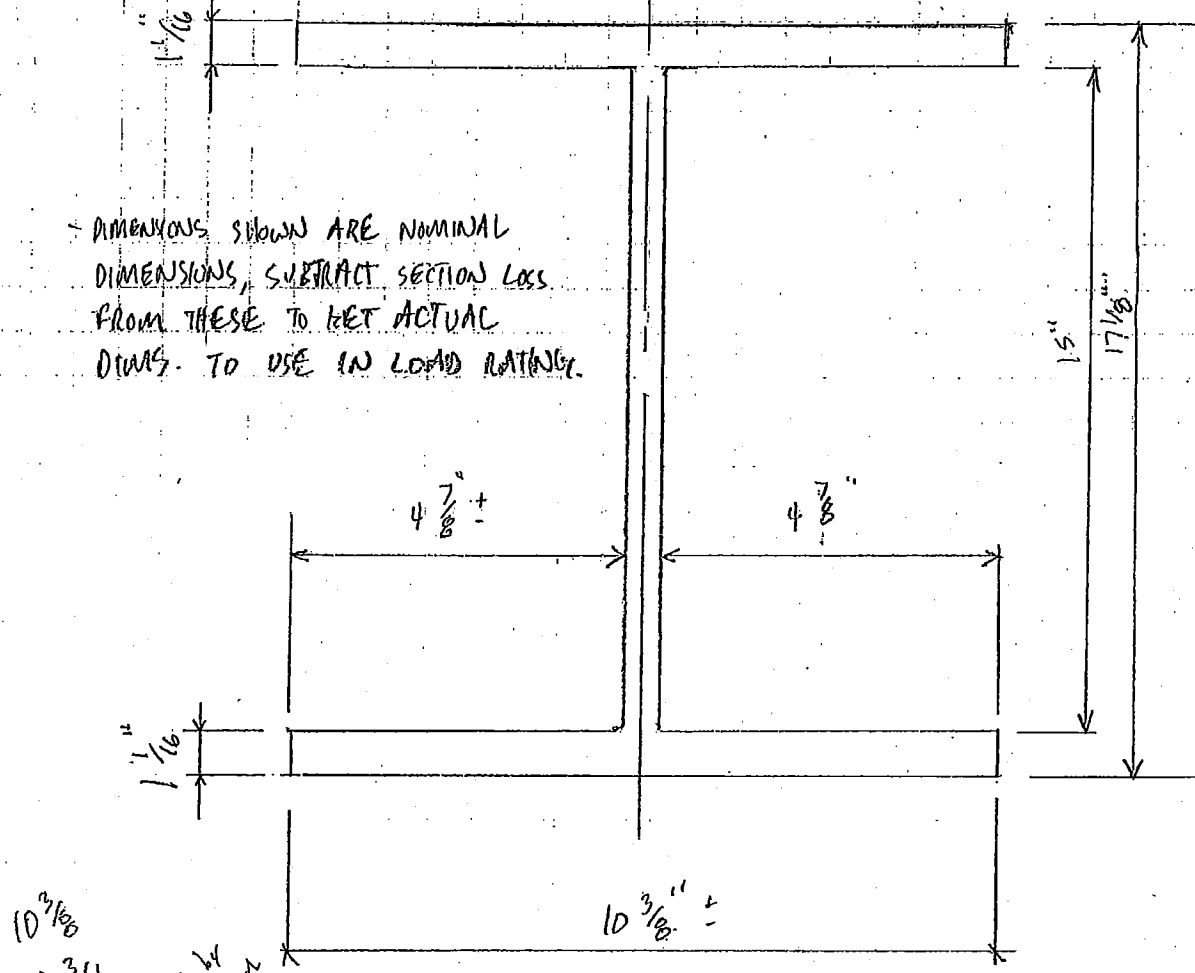

10 3/8
 - 9 3/4
 5/8 web by calculation

TYPICAL SECTION OF LONGITUDINAL BEAM

N.T.S.

This appears to be
 an HP section.



Computations

Project: MALDEN L.R.
Location: .
Calculated by: KOW
Checked by:
Title Bridge # 1238

Project # 52166.05
Sheet 5 of 6
Date: 10/18/2011
Date:

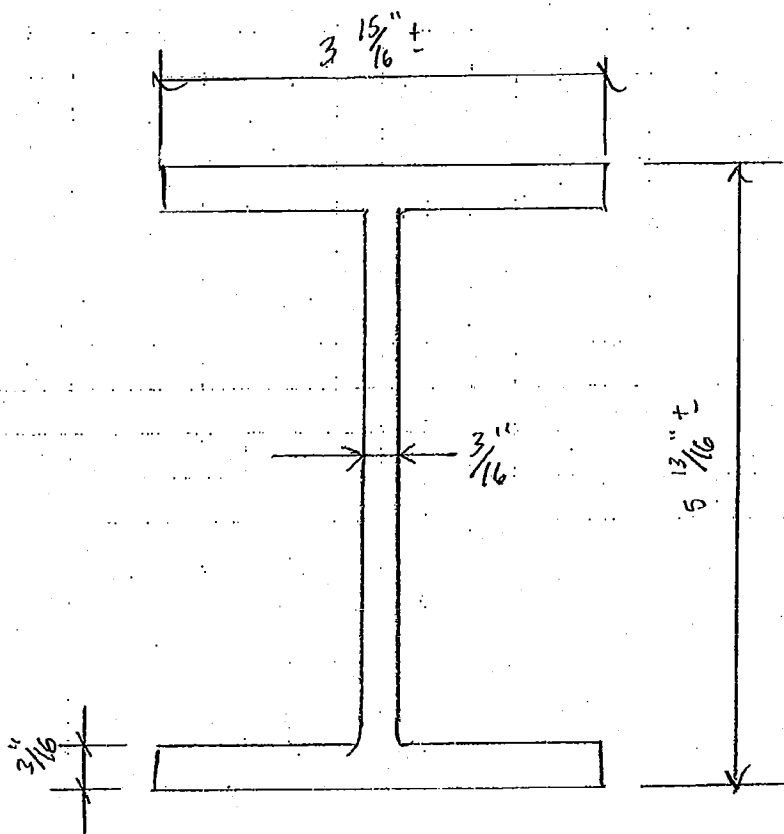

BRIDGE RAIL POST TYP. SECTION

N.T.S.



Computations

Project: MaineDOT LRFR
Location: Berwick, ME
Calculated by: T.S. Bryant
Checked by:
Title: Bridge #1238 Field Inspection Notes

Project # 52166.00
Sheet 4 of 6
Date: 10/18/2011
Date:

- THIS IS A NON-STRUCTURAL MEMBER FROM A BRIDGE LOAD RATING PERSPECTIVE

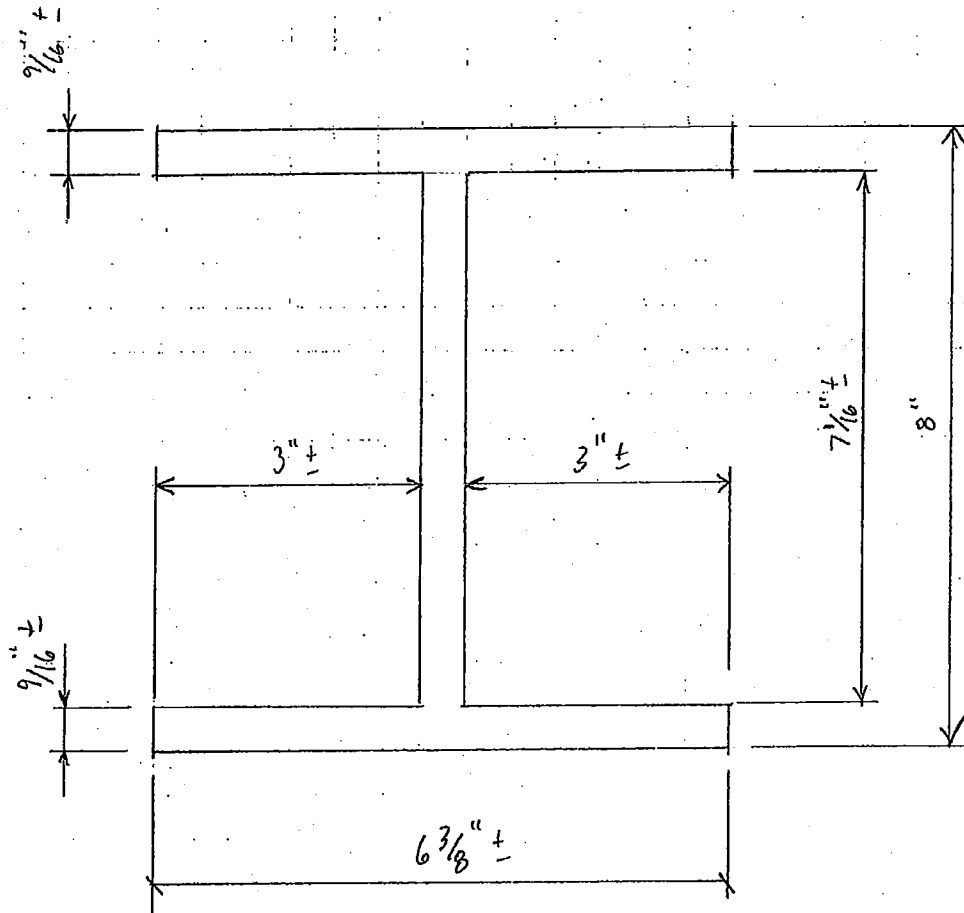

TYPICAL SECTION OF TRANSVERSE RAIL POST TIE BEAM

N.T.S.