

Stream - Fast current all stages. Streambed upstream from existing bridge @ Sta 6 - Large rocks and ledge heavily wooded east side of stream. Streambed below bridge - Sand and gravel Alder swamp with side with scattered hardwood growth.

Substructure - Mass Concrete Abuts. - Good Condition.

Superstructure - Concrete slab paved over deteriorated slabs and outside fascias - fair condition.

Rod Sounding @ Sta 76+0

- 0-1 9 blows
- 1-2 21 "
- 2-3 39 "
- 3-4 51 "
- 4-5 81 "
- 5-6 140 "
- 6-7 84 "
- 7-8 115 " not refusal

Curve Data
 PI Sta 72+14.16
 $\Delta = 12^{\circ}06'40''$ Lt.
 $D = 1^{\circ}00'$
 $T = 164.516'$
 $L = 191.115'$
 $R = 5724.578'$

Construction E

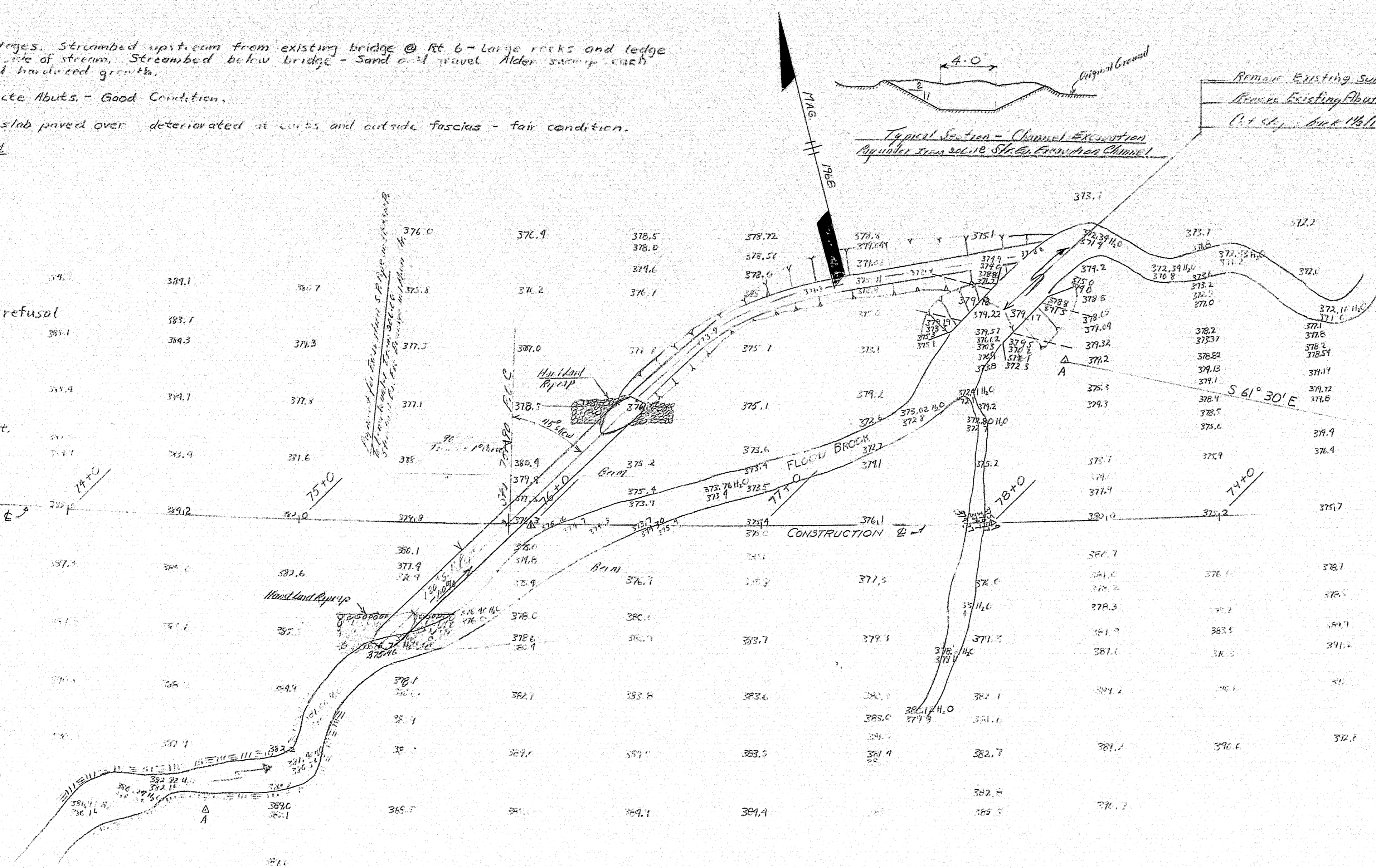

PLAN
 Scale 1" = 30'

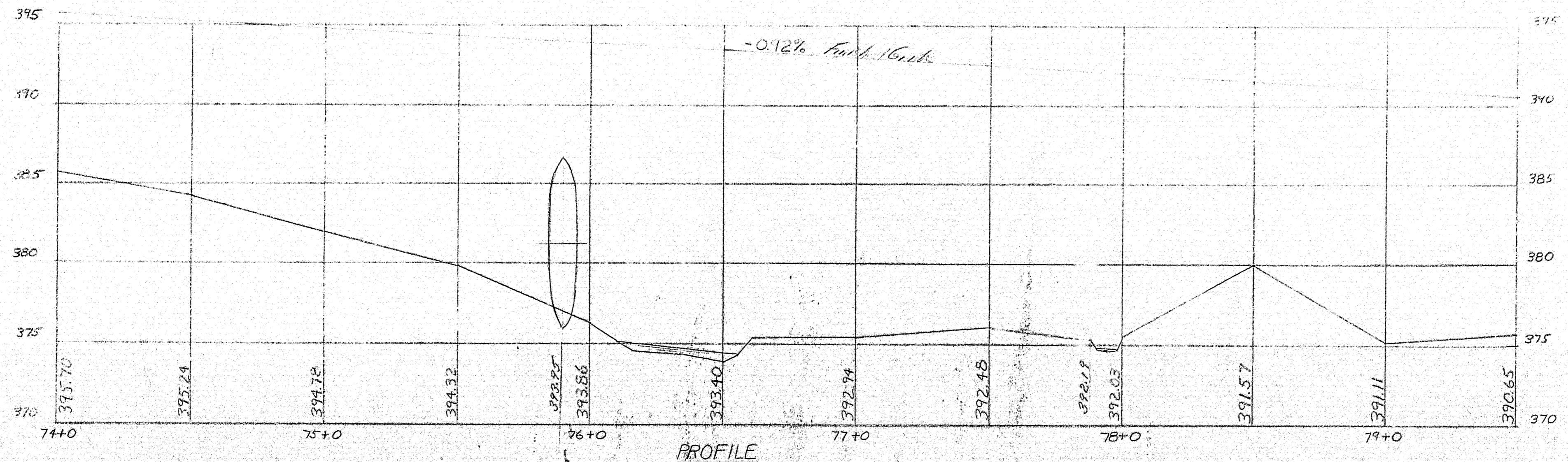

PROFILE
 Scale 1" = 30' horiz. 1" = 5' vert.

Note
 All measurements are in feet and inches.

DESIGN -	BRIDGE NO.
TRACE -	SURVEY - F. BARNES
CHECK -	PLOT - E. SPROUL
STATE HIGHWAY COMMISSION BRIDGE DIVISION	
FLOOD BROOK BRIDGE IN THE TOWN OF TOPSFIELD WASHINGTON COUNTY SURVEY	
SHEET 1 OF 2 AUGUSTA, MAINE JUNE 1968	

M-2610

