



Janet T. Mills
GOVERNOR

STATE OF MAINE
DEPARTMENT OF TRANSPORTATION
16 STATE HOUSE STATION
AUGUSTA, MAINE 04333-0016

Dale F. Doughty
COMMISSIONER

May 19, 2026
Subject: Ultra-Thin Bonded Wearing
Course
WIN:029682.00
Location: Ellsworth
Amendment No. 2

Dear Sir/Ms.:

Make the following changes to the bid book:

Remove page 17-20 titled "Proposal Schedule of Items" (4 pages) dated 4/28/2026 and **Replace** with the attached Proposal Schedule of Items (4 pages) dated 5/19/26.

Remove page 51-52 titled "General Plans" (2 pages) dated 4/28/2026 and **Replace** with the attached General Plans (2 pages) dated 5/19/2026.

Add the attached Special Provision, Section 645 (Advanced Solar Powered Flashing Warning Sign), 3 pages, dated May15, 2026.

The following questions have been received:

Question: Based on the slope sheets, is the contractor to assume that the shoulders' slopes match the travel lane slopes by station?

Response: The shoulder slope will be variable and may steeper than the slope of the travel lane. The intent is to shim the shoulder full width placing 0.5 inches loose uncompacted depth at the face of curb. The Department will determine if there are any areas that require additional shim to maintain maximum -6% cross slope on the shoulder.

Question: Reviewing the Special Provision 105 Section, can this work be done during the daytime if one lane is utilized for alternating traffic, or is it meant to be read that there must be one lane in each direction at all times?

Response: Night work shall be required as specified in the Special Provision, Section 107, unless one lane in each direction can be maintained at all times.

Consider these changes and information prior to submitting your bid on **May 20, 2026**.

Sincerely,

A handwritten signature in blue ink that reads "George Macdougall". The signature is written in a cursive style with a large initial "G" and "M".

George M. A. Macdougall P.E.
Contracts & Specifications Engineer

Maine Department of Transportation

Proposal Schedule of Items

Proposal ID: 029682.00

Project(s): 029682.00

SECTION: 1 HIGHWAY ITEMS

Alt Set ID: Alt Mbr ID:

Contractor: _____

| Proposal Line Number | Item ID Description | Approximate Quantity and Units | Unit Price | | Bid Amount | |
|----------------------|--|--------------------------------|------------|-----------|------------|-----------|
| | | | Dollars | Cents | Dollars | Cents |
| 0010 | 202.202 REMOVING PAVEMENT SURFACE | 440.000 SY | _____ | _____ | _____ | _____ |
| 0020 | 202.203 PAVEMENT BUTT JOINTS | 570.000 SY | _____ | _____ | _____ | _____ |
| 0030 | 304.10 AGGREGATE SUBBASE COURSE - GRAVEL | 80.000 CY | _____ | _____ | _____ | _____ |
| 0040 | 403.209 HOT MIX ASPHALT 9.5 MM (SIDEWALKS, DRIVES, INCIDENTALS) | 102.000 T | _____ | _____ | _____ | _____ |
| 0050 | 403.2111 9.5 MM POLYMER MODIFIED HMA (SHIM) | 1,600.000 T | _____ | _____ | _____ | _____ |
| 0060 | 403.213 HOT MIX ASPHALT 12.5 MM BASE | 100.000 T | _____ | _____ | _____ | _____ |
| 0070 | 409.15 BITUMINOUS TACK COAT - APPLIED | 1,100.000 G | _____ | _____ | _____ | _____ |
| 0080 | 411.10 UNTREATED AGGREGATE SURFACE COURSE (TRUCK MEASURE) | 20.000 CY | _____ | _____ | _____ | _____ |
| 0090 | 424.22 ASPHALT RUBBER CRACK SEALER TYPE 2, APPLIED | 1,300.000 LB | _____ | _____ | _____ | _____ |
| 0100 | 462.301 POLYMER MODIFIED ULTRATHIN BONDED WEARING COURSE | 34,800.000 SY | _____ | _____ | _____ | _____ |
| 0110 | 604.18 ADJUSTING MANHOLE OR CATCH BASIN TO GRADE | 49.000 EA | _____ | _____ | _____ | _____ |

Maine Department of Transportation

Proposal Schedule of Items

Proposal ID: 029682.00

Project(s): 029682.00

SECTION: 1 HIGHWAY ITEMS

Alt Set ID: Alt Mbr ID:

Contractor: _____

| Proposal Line Number | Item ID Description | Approximate Quantity and Units | Unit Price | | Bid Amount | |
|----------------------|---|--------------------------------|------------|-----------|------------|-----------|
| | | | Dollars | Cents | Dollars | Cents |
| 0120 | 608.26 CURB RAMP DETECTABLE WARNING FIELD | 40.000 SF | _____ | _____ | _____ | _____ |
| 0130 | 608.46 REGRAIDING SIDEWALK | 50.000 SY | _____ | _____ | _____ | _____ |
| 0140 | 609.11 VERTICAL CURB TYPE 1 | 16.000 LF | _____ | _____ | _____ | _____ |
| 0150 | 609.34 CURB TYPE 5 | 629.000 LF | _____ | _____ | _____ | _____ |
| 0160 | 609.35 CURB TYPE 5 - CIRCULAR | 33.000 LF | _____ | _____ | _____ | _____ |
| 0170 | 609.38 RESET CURB TYPE 1 | 48.000 LF | _____ | _____ | _____ | _____ |
| 0180 | 613.319 EROSION CONTROL BLANKET | 100.000 SY | _____ | _____ | _____ | _____ |
| 0190 | 618.13 SEEDING METHOD NUMBER 1 | 10.000 UN | _____ | _____ | _____ | _____ |
| 0200 | 618.14 SEEDING METHOD NUMBER 2 | 8.000 UN | _____ | _____ | _____ | _____ |
| 0210 | 619.12 MULCH | 18.000 UN | _____ | _____ | _____ | _____ |
| 0220 | 627.733 4" WHITE OR YELLOW PAINTED PAVEMENT MARKING LINE | 19,300.000 LF | _____ | _____ | _____ | _____ |
| 0230 | 627.75 WHITE OR YELLOW PAVEMENT & CURB MARKING | 2,655.000 SF | _____ | _____ | _____ | _____ |

Maine Department of Transportation

Proposal Schedule of Items

Proposal ID: 029682.00

Project(s): 029682.00

SECTION: 1 HIGHWAY ITEMS

Alt Set ID: Alt Mbr ID:

Contractor: _____

| Proposal Line Number | Item ID Description | Approximate Quantity and Units | Unit Price | | Bid Amount | |
|----------------------|--|--------------------------------|------------|-----------|------------|-----------|
| | | | Dollars | Cents | Dollars | Cents |
| 0240 | 627.78 TEMPORARY 4 INCH PAINTED PAVEMENT MARKING LINE, WHITE OR YELLOW | 38,600.00 LF | _____ | _____ | _____ | _____ |
| 0250 | 629.05 HAND LABOR, STRAIGHT TIME | 10.00 HR | _____ | _____ | _____ | _____ |
| 0260 | 631.12 ALL PURPOSE EXCAVATOR (INCLUDING OPERATOR) | 10.00 HR | _____ | _____ | _____ | _____ |
| 0270 | 631.133 SKID STEER (INCLUDING OPERATOR) | 10.00 HR | _____ | _____ | _____ | _____ |
| 0280 | 631.172 TRUCK - LARGE (INCLUDING OPERATOR) | 20.00 HR | _____ | _____ | _____ | _____ |
| 0290 | 639.19 FIELD OFFICE TYPE B | 1.00 EA | _____ | _____ | _____ | _____ |
| 0300 | 645.271 REGULATORY, WARNING, CONFIRMATION AND ROUTE MARKER ASSEMBLY SIGNS, TYPE I | 72.00 SF | _____ | _____ | _____ | _____ |
| 0305 | 645.513 ADVANCED SOLAR POWERED FLASHING WARNING SIGN | 2.00 EA | _____ | _____ | _____ | _____ |
| 0310 | 652.33 DRUM | 10.00 EA | _____ | _____ | _____ | _____ |
| 0320 | 652.34 CONE | 80.00 EA | _____ | _____ | _____ | _____ |
| 0330 | 652.35 CONSTRUCTION SIGNS | 620.00 SF | _____ | _____ | _____ | _____ |

Maine Department of Transportation

Proposal Schedule of Items

Proposal ID: 029682.00

Project(s): 029682.00

SECTION: 1 HIGHWAY ITEMS

Alt Set ID: Alt Mbr ID:

Contractor: _____

| Proposal Line Number | Item ID Description | Approximate Quantity and Units | Unit Price | | Bid Amount | |
|----------------------|--|--------------------------------|-------------------|-----------|------------|-----------|
| | | | Dollars | Cents | Dollars | Cents |
| 0340 | 652.36 MAINTENANCE OF TRAFFIC CONTROL DEVICES | 45.000 CD | _____ | _____ | _____ | _____ |
| 0350 | 652.38 FLAGGER | 1,400.000 HR | _____ | _____ | _____ | _____ |
| 0360 | 652.41 PORTABLE CHANGEABLE MESSAGE SIGN | 4.000 EA | _____ | _____ | _____ | _____ |
| 0370 | 656.75 TEMPORARY SOIL EROSION AND WATER POLLUTION CONTROL | LUMP SUM | | LUMP SUM | _____ | _____ |
| 0380 | 658.20 ACRYLIC LATEX COLOR FINISH, GREEN | 225.000 SY | _____ | _____ | _____ | _____ |
| 0390 | 659.10 MOBILIZATION | LUMP SUM | | LUMP SUM | _____ | _____ |
| Section: 1 | | | Total: | | _____ | _____ |
| | | | Total Bid: | | _____ | _____ |

NOTES:
 1. US ROUTE 1A IS A PRIORITY 1 ROADWAY WITH A POSTED SPEED LIMIT OF 35 MPH

STORAGE LENGTH:
 50' MINIMUM PER MAINE DOT DESIGN GUIDANCE - MEDIANS AND ISLANDS
 TURNING DHV: <60 VPH, T≤10%

BAY TAPER:
 9:1 FOR 35 MPH
 9 x 12' = 108' → 110'

DECELERATION:
 145' FOR 35 MPH

TURN LANE LENGTH:
 STORAGE (50') + DECEL (145') - BAY TAPER (110') = 85'

SHIFTING TAPER:
 $W(S \times S)/60 = 6'(40 \times 40)/60 = 160'$
 (POSTED SPEED IS 40 MPH ENTERING SHIFTING TAPER)

| CONTROL POINTS FOR US ROUTE 1A | | |
|--------------------------------|-----------|----------|
| POINT | STATION | OFFSET |
| 1 | 101+37.30 | 1.0' RT |
| 2 | 101+91.72 | 1.0' RT |
| 3 | 102+10.85 | 1.0' RT |
| 4 | 103+07.46 | 1.0' RT |
| 5 | 103+22.40 | 1.0' RT |
| 6 | 103+85.12 | 1.0' RT |
| 7 | 103+85.50 | 5.0' RT |
| 8 | 103+77.55 | 6.5' RT |
| 9 | 103+30.41 | 11.0' RT |
| 10 | 102+02.14 | 9.3' RT |
| 11 | 101+82.95 | 8.3' RT |
| 12 | 101+37.15 | 5.0' RT |

| ITEM 609.34 CURB TYPE 5 | | |
|-------------------------|-------------|-------------|
| POINT TO POINT | RADIUS (FT) | LENGTH (LF) |
| 1 TO 2 | - | 54 |
| 2 TO 3 | 249 | 19 |
| 3 TO 4 | - | 97 |
| 4 TO 5 | 999 | 15 |
| 5 TO 6 | - | 63 |
| 7 TO 8 | - | 8 |
| 8 TO 9 | 249 | 47 |
| 9 TO 10 | - | 128 |
| 10 TO 11 | 499 | 19 |
| 11 TO 12 | - | 46 |
| SHEET SUBTOTAL (LF) | | 496 |

| ITEM 609.35 CURB TYPE 5 - CIRCULAR | | |
|------------------------------------|-------------|-------------|
| POINT TO POINT | RADIUS (FT) | LENGTH (LF) |
| 6 TO 7 | 2 | 6 |
| 12 TO 1 | 2 | 6 |
| SHEET SUBTOTAL (LF) | | 12 |

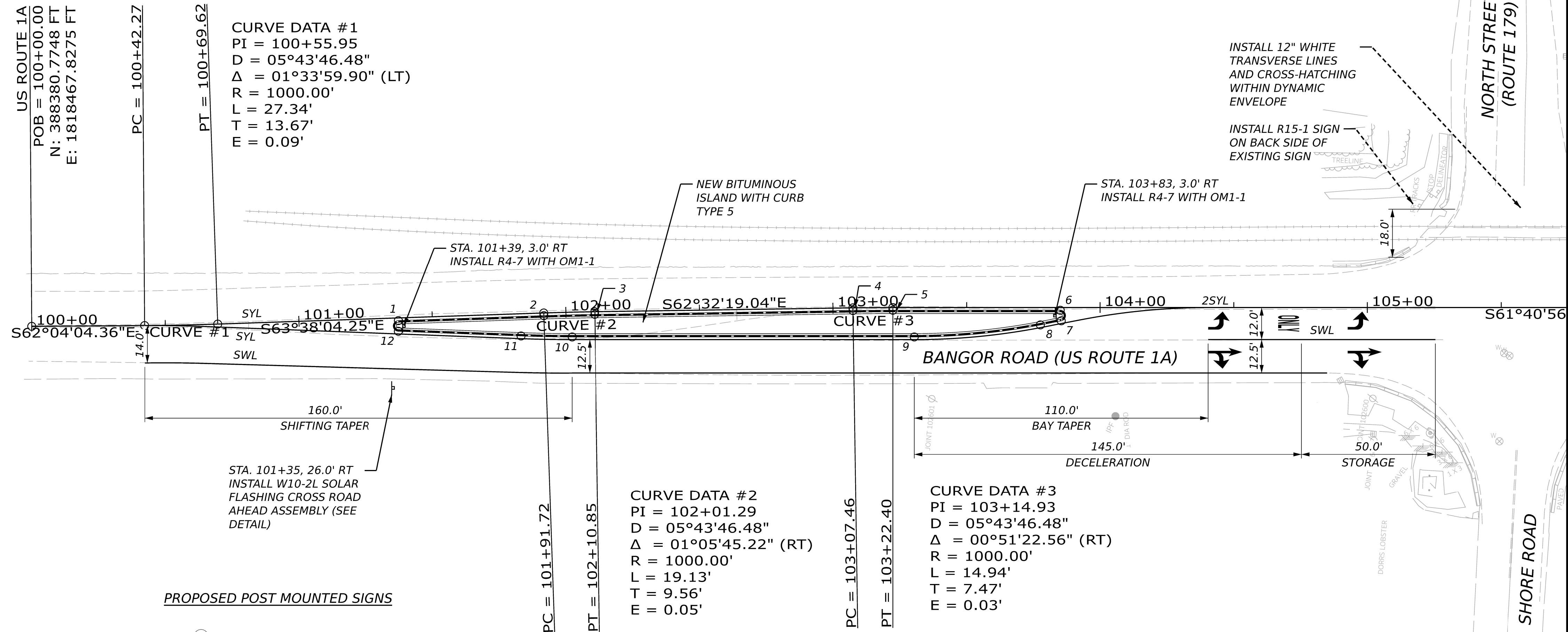

ADVANCED SOLAR POWERED FLASHING SIGN ASSEMBLY

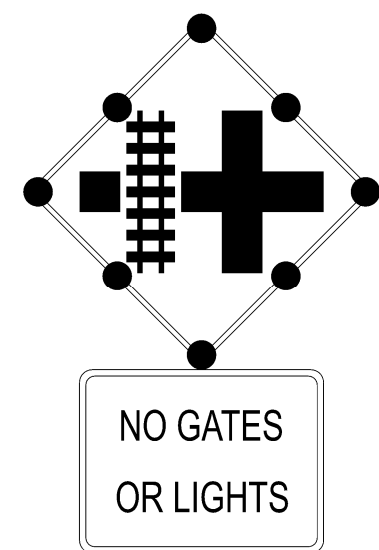

FLASHING W10-2L
 36"x36"

w/W10-13P
 30"x24"
 1-PROPOSED

PROPOSED POST MOUNTED SIGNS

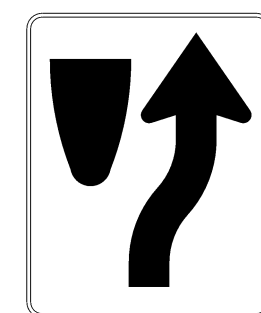

R4-7
 24"x30"
 4-PROPOSED

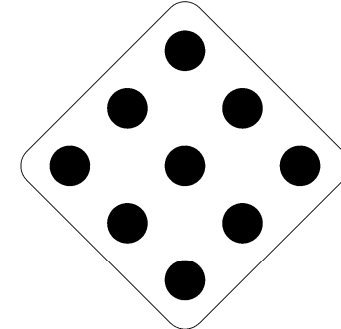

OM1-1
 18"x18"
 4-PROPOSED

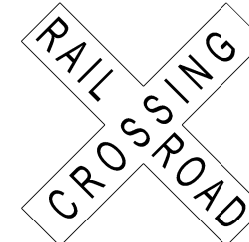

R15-1
 48"x9"
 2-PROPOSED

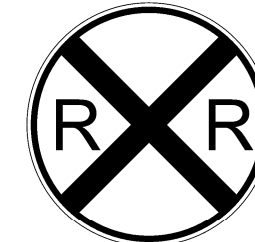

W10-1
 36" DIA.
 1-PROPOSED

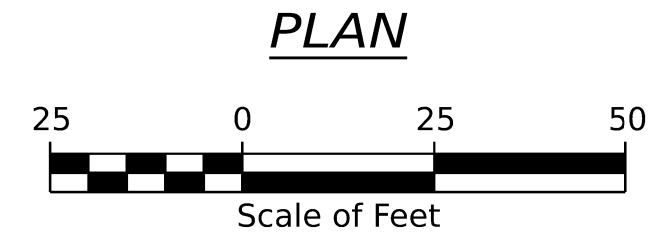

STATE OF MAINE
 DEPARTMENT OF TRANSPORTATION
 29682.00
 WIN
 29682.00
 HIGHWAY PLANS

| DATE | BY | REVISIONS | SIGNATURE | P.E. NUMBER | DATE |
|---------|----------|-----------|-----------|-------------|------|
| 5/18/26 | M. FEELY | | | | |
| 5/18/26 | B. LYON | | | | |

ELLSWORTH
 US ROUTE 1A AT ROUTE 179
 GENERAL PLAN

SHEET NUMBER
 2
 OF 3

NOTES:
 1. US ROUTE 1A IS A PRIORITY 1 ROADWAY WITH A POSTED SPEED LIMIT OF 35 MPH

STORAGE LENGTH:
 50' MINIMUM PER MAINEDOT DESIGN GUIDANCE - MEDIANS AND ISLANDS
 TURNING DHV: <60 VPH, T≤10%

BAY TAPER:
 9:1 FOR 35 MPH
 9 x 12' = 108' → 110'

DECELERATION:
 145' FOR 35 MPH

TURN LANE LENGTH:
 STORAGE (50') + DECEL (145') - BAY TAPER (110') = 85'

| CONTROL POINTS FOR US ROUTE 1A | | |
|--------------------------------|-----------|----------|
| POINT | STATION | OFFSET |
| 13 | 107+38.19 | 6.5' RT |
| 14 | 107+50.30 | 4.5' RT |
| 15 | 107+91.79 | 1.0' RT |
| 16 | 108+04.55 | 1.0' RT |
| 17 | 108+04.55 | 10.5' RT |
| 18 | 107+38.52 | 10.5' RT |

| ITEM 609.34 CURB TYPE 5 | | |
|-------------------------|-------------|-------------|
| POINT TO POINT | RADIUS (FT) | LENGTH (LF) |
| 13 TO 14 | - | 12 |
| 14 TO 15 | 249 | 42 |
| 15 TO 16 | - | 13 |
| 17 TO 18 | - | 66 |
| SHEET SUBTOTAL (LF) | | 133 |

| ITEM 609.35 CURB TYPE 5 - CIRCULAR | | |
|------------------------------------|-------------|-------------|
| POINT TO POINT | RADIUS (FT) | LENGTH (LF) |
| 16 TO 17 | 4.75 | 15 |
| 18 TO 13 | 2 | 6 |
| SHEET SUBTOTAL (LF) | | 21 |

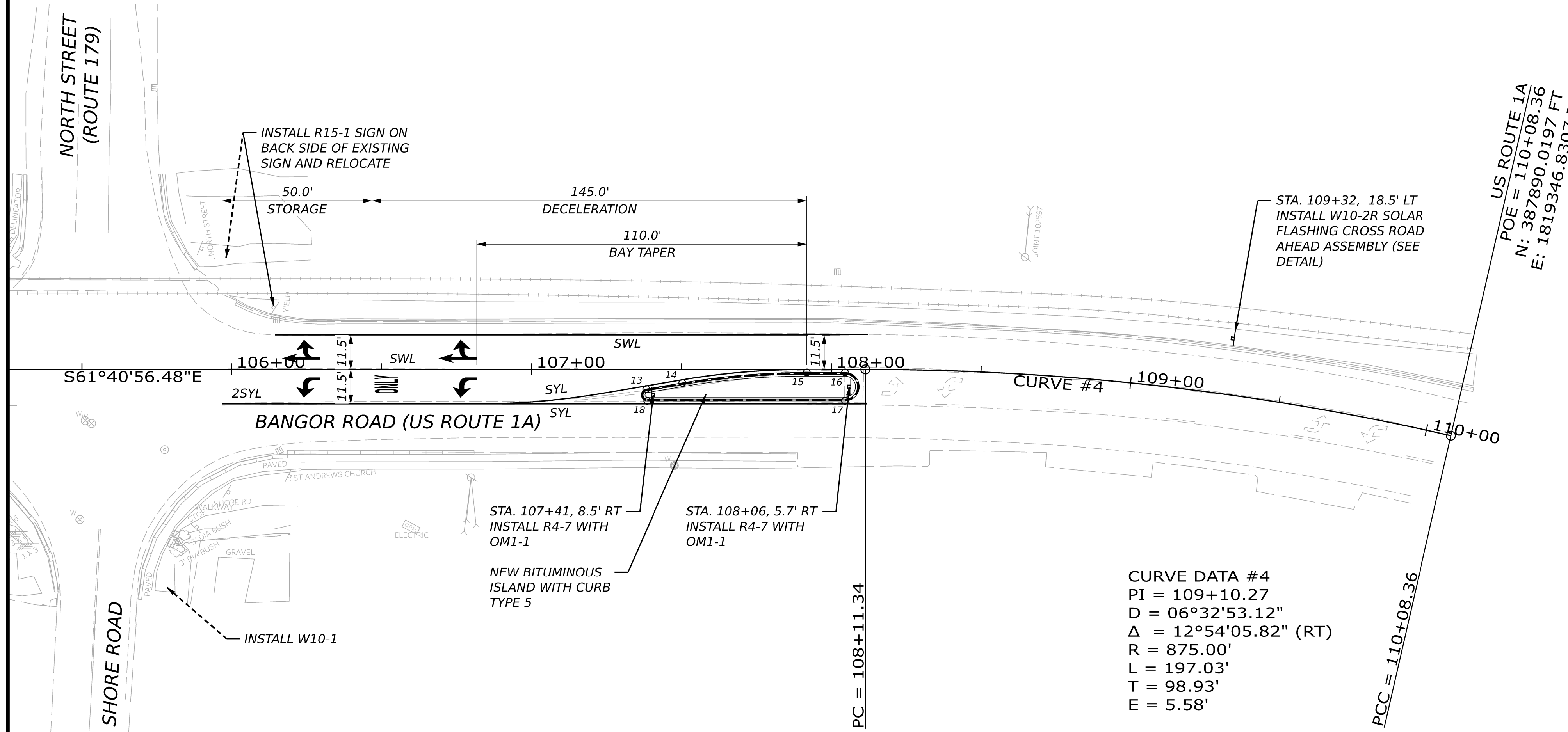
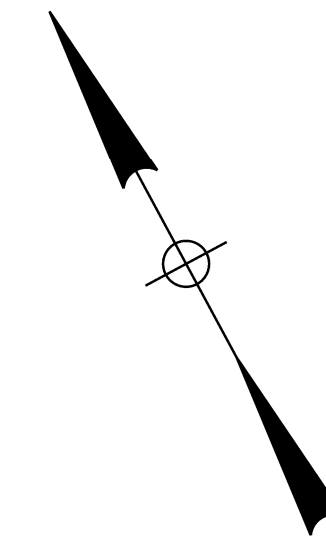

CURVE DATA #4
 PI = 109+10.27
 D = 06°32'53.12"
 Δ = 12°54'05.82" (RT)
 R = 875.00'
 L = 197.03'
 T = 98.93'
 E = 5.58'

PCC = 110+08.36

US ROUTE 1A
 POE = 110+08.36
 N: 387890.0197 FT
 E: 1819346.8307 FT

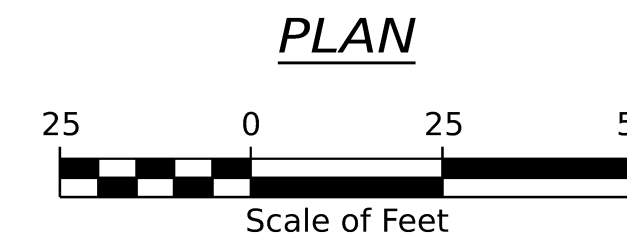

**ADVANCED SOLAR POWERED
 FLASHING SIGN ASSEMBLY**

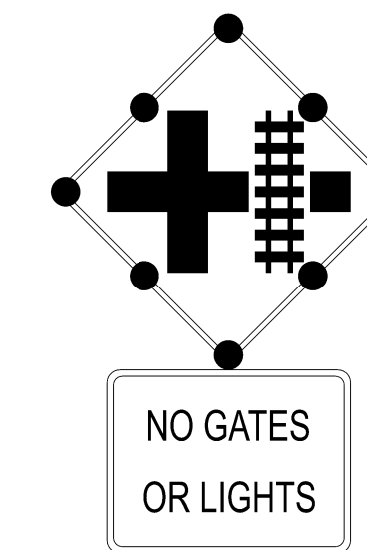

NO GATES
 OR LIGHTS
 FLASHING W10-2R
 36"x36"
 w/W10-13P
 30"x24"
 1-PROPOSED

STATE OF MAINE
 DEPARTMENT OF TRANSPORTATION
 29682.00
 WIN
 29682.00
 HIGHWAY PLANS

| PROJ. MANAGER | DATE | BY | DATE |
|------------------|---------|----------|---------|
| DESIGN-DETAILED | 5/18/26 | M. FEELY | 5/18/26 |
| CHECKED-REVIEWED | | B. LYON | |
| DESIGN-REVIEWED | | | |
| DESIGN-DETAILED | | | |
| REVISIONS 1 | | | |
| REVISIONS 2 | | | |
| REVISIONS 3 | | | |
| REVISIONS 4 | | | |
| FIELD CHANGES | | | |

ELLSWORTH
 US ROUTE 1A AT ROUTE 179
 GENERAL PLAN

SHEET NUMBER
 3
 OF 3

SPECIAL PROVISION
SECTION 645
Highway Signing
(Advanced Solar Powered Flashing Warning Sign)

This section is amended by addition of the following:

645.01 Description. This work shall consist of furnishing and installing Advanced Solar Powered Flashing Warning Sign assembly at the locations indicated on the Plan.

645.021 Materials. The Advanced Solar Powered Flashing Warning assembly shall include the following items:

1. Sign and LEDs
 - a. All signs shall conform to MUTCD section 2A.07 on retro reflectivity and illumination.
 - b. Each sign shall have a quantity of eight high power 1-watt LEDs
 - c. Each sign blank material shall be a minimum of 0.080" thick aluminum.
 - d. Each sign face shall consist of 3M™ Diamond Grade™ DG3 reflective fluorescent yellow sheeting.
 - e. Sign sheeting shall be applied to the sign blank with a 3MTM 1160 Premium Protective Overlay
 - f. The LEDs shall be embedded individually into 1" diameter holes around the perimeter of the sign and shall be ultrasonically welded to the sign assembly to provide maximum strength and rigidity
 - g. LED color shall be match sign sheeting color.
 - h. Each LED shall be sealed within a 7/8" diameter, heat-dissipating plastic enclosure to provide resistance to weather and vibration.
 - i. LEDs shall be wired in parallel electrically so that remaining LEDs continue to flash in the event of the failure of any individual LED.
 - j. LED wiring shall be encapsulated inside 1" x 3/8" aluminum extrusions secured to the back of each sign assembly, to provide weather resistance and protection.
 - k. UV-resistant label(s) shall be applied to the back of each sign assembly and shall include specific information including manufacturer, manufacturer phone number, model number, serial number, date of manufacture and any applicable regulatory compliance information
 - l. Controller shall be fully encapsulated in an IP67 rated enclosure. Enclosure shall have dimensions of 5.8" W x 1.3" H x 1.3" D.
 - m. LEDs shall automatically adjust brightness based on ambient lighting conditions.
 - n. Shall automatically provide Low Voltage Disconnect (LVD) to protect batteries
 - o. LEDs shall be independently replaceable of other components.
 - p. Shall operate between the temperatures of -40° F to +176°F (-40°C to +80°C)
 - q. All LED connectors shall conform to Ingress Protection, IP-67 rating, dust proof, and protected from temporary immersion in water up to 1 meter deep for 30 minutes.

2. Solar Panel and Battery

- a. All solar panels shall be up appropriately sized for sign power requirements and all climate and geographical locations (minimum 30 W).
- b. Solar Panel shall be constructed of an anodized aluminum frame, high-transmission 1/8" tempered glass, with silicon cells encapsulated in double-layer EVA.
- c. The Solar Panel shall be affixed to an aluminum plate and pole top bracket at a fixed angle of 45° to provide maximum insolation exposure.
- d. To ensure maximum solar isolation regardless of installation location, the post top mounting system shall provide 360° of rotational direction adjustment and upon installation, must be oriented with the collector facing South.
- e. The solar panel shall be IEC61215 and TUV certified.
- f. All solar panel connectors shall conform to Ingress Protection, IP-67 rating, dust proof, and protected from temporary immersion in water up to 1 meter deep for 30 minutes.
- g. All solar panel fasteners shall be anti-vandal pin-type set screws. Wrench shall be provided. h) Wire used shall conform to military specifications, MIL-W-16878D, Type D, vinyl nylon jacket.
- h. Battery packs shall be 12 Volt Lead Acid, sealed and maintenance free.
- i. All batteries shall be lead acid, sealed and maintenance free.
- j. All batteries shall operate between the temperatures of -40° to +176°F (-40° to +80°C).
- k. All battery connectors shall conform to Ingress Protection, IP-67 rating, dust proof, and protected from temporary immersion in water up to 1 meter deep for 30 minutes. Connectors shall be Deutsch DTM series.
- l. Warranty: Manufacturer shall offer a 3 year unconditional warranty against all defects in material and workmanship.

Construction Requirements. The Contractor shall furnish all labor, materials, cables, connectors, tools, equipment, shipping and incidental items necessary to complete the installation and make the flashing advanced warning sign assembly functional. The assembly shall be mounted on 6"x 6" wood post meeting the requirements of section 720.12.

Method of Measurement. Advanced Solar Powered Flashing Warning Sign shall be measured by each unit installed and operational. All items, including sign flashing sign assembly, solar panel, battery, support post and incidentals required to install a fully functional assembly will be considered incidental to the cost of this item.

Basis of Payment. Payment will be full compensation for furnishing, transporting, handling, installing and testing the materials and equipment specified and for furnishing all labor, tools, equipment, and incidentals necessary to complete the work.

Ellsworth
WIN 29682.00
May 15th, 2026

Payment will be made under:

| <u>Pay Item</u> | | <u>Pay Unit</u> |
|-----------------|--|-----------------|
| 645.513 | Advanced Solar Power Flashing Warning Sign | Each |