



Janet T. Mills
GOVERNOR

STATE OF MAINE
DEPARTMENT OF TRANSPORTATION
16 STATE HOUSE STATION
AUGUSTA, MAINE 04333-0016

Dale F. Doughty
COMMISSIONER

April 14, 2026
Subject: Donald V. Carter Bridge
Wearing
Surface Replacement
WIN:029528.00
Location: Winslow-Waterville
Amendment No. 1

Dear Sir/Ms.:

The following questions have been received:

Question: Item 607.181 8' high chain link security fence - The plans show the fence being mounted to the side of the concrete wall and the chain link fence fabric extending down to the bottom of the wall. For this to be installed using this design would require the use of a very large snooper truck or a helicopter and a trapeze artist. If the fence is shortened up in the section in front of the concrete wall, that i believe is not needed, this would raise the bottom rail to the top of the wall where the proper hardware could be applied without being on the backside of the bridge. See attached marked up drawing.

Response: Modifying the design plan details to reduce the height of the chain-link fence fabric and associated horizontal components is acceptable. The revised fence fabric limits shall, at a minimum, extend from the top of the existing concrete barrier. The vertical fence posts shall continue to be mounted at both the top of the barrier and the fascia (outside face of the barrier), in accordance with the design plan details.

Question: See plate mounted post marked up drawing - I believe this option would save thousands of dollars and provide the same amount of coverage. Only concern would be anchor bolts interfering with the reenforcing bar in the concrete wall

Response: Mounting the chain link security fence to the top of the concrete barrier only, will not be acceptable.

Consider these changes and information prior to submitting your bid on **April 15, 2026.**

Sincerely,

A handwritten signature in blue ink that reads "George Macdougall". The signature is written in a cursive style with a large initial "G" and "M".

George M. A. Macdougall P.E.
Contracts & Specifications Engineer

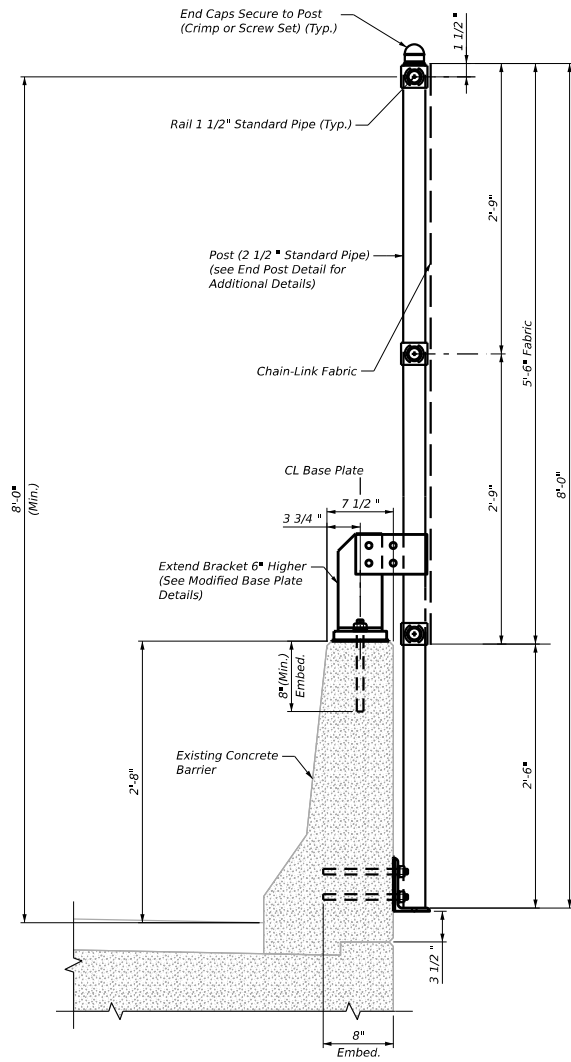

CONNECTION DETAIL - SECURITY FENCE
 (SIMILAR UPDATES REQUIRED AT ANTI-CLIMB SHIELDS)

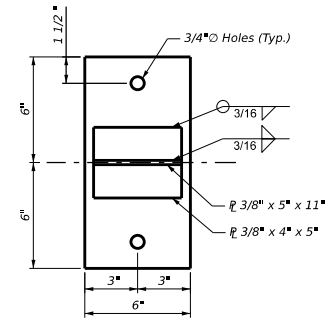

MODIFIED BASE PLATE DETAIL
 (For Snow and Security Fence)

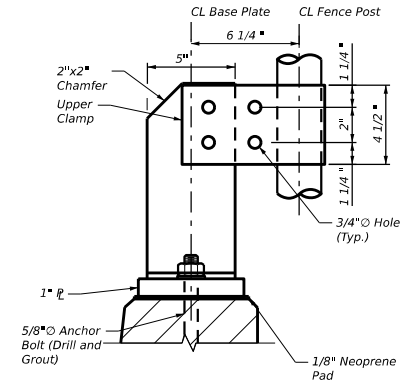

ELEVATION - MODIFIED BASE PLATE
 (For Snow and Security Fence)