



STATE OF MAINE
DEPARTMENT OF TRANSPORTATION
16 STATE HOUSE STATION
AUGUSTA, MAINE 04333-0016

Janet T. Mills
GOVERNOR

Dale F. Doughty
COMMISSIONER

March 26, 2026
Subject: Joshua Chamberlain Bridge
#5312 Bridge wearing surface
replacement project
State WIN: 025313.00
Location: **Bangor-Brewer**
Amendment No. 1

Dear Sir/Ms.:

Please make the following changes to the Bid Documents:

REMOVE, pages 16 thru 20, "Proposal Schedule of Items", 5 pages, dated 2/25/2026 and **REPLACE** with the attached, revised "Proposal Schedule of Items" 4 pages dated 3/17/2026.

In the Bid Book **REMOVE** "SPECIAL PROVISION, SECTION 520 EXPANSION DEVICES (Bridge Joint Modification-Type 5)" dated February 20, 2026.

In the Bid Book **REMOVE** "SPECIAL PROVISION, SECTION 524 TEMPORARY STRUCTURAL SUPPORTS (Protective Shield)" dated February 20, 2026.

In the Plan Set:

The plan set is being **Replaced** in its entirety. Please refer to the attached updated set of plans with 12 pages. A modular joint will not be installed at pier 11 as part of this contract.

Consider these changes and information prior to submitting your bid on **April 1, 2026**

Sincerely,

A handwritten signature in blue ink that reads "George Macdougall".

George M. A. Macdougall P.E.
Contracts & Specifications Engineer

Maine Department of Transportation

Proposal Schedule of Items

Proposal ID: 025313.00

Project(s): 025313.00

SECTION: 1 INITIAL GROUP

Alt Set ID: Alt Mbr ID:

Contractor: _____

Proposal Line Number	Item ID Description	Approximate Quantity and Units	Unit Price		Bid Amount	
			Dollars	Cents	Dollars	Cents
0010	202.127 REMOVE EXISTING BITUMINOUS PAVEMENT	LUMP SUM				
0020	202.20 REMOVING BITUMINOUS CONCRETE PAVEMENT	470.000 SY				
0030	202.202 REMOVING PAVEMENT SURFACE	730.000 SY				
0040	202.30 REMOVING EXISTING CONCRETE WEARING SURFACE	LUMP SUM				
0050	403.2081 12.5 MM POLYMER MODIFIED HOT MIX ASPHALT	450.000 T				
0060	403.209 HOT MIX ASPHALT 9.5 MM (SIDEWALKS, DRIVES, INCIDENTALS)	52.000 T				
0070	403.211 HOT MIX ASPHALT (SHIMMING)	25.000 T				
0080	403.2131 12.5 MM POLYMER MODIFIED HMA BASE	400.000 T				
0090	409.15 BITUMINOUS TACK COAT - APPLIED	330.000 G				
0100	508.14 HIGH PERFORMANCE WATERPROOFING MEMBRANE	LUMP SUM				
0110	515.21 PROTECTIVE COATING FOR CONCRETE SURFACES	LUMP SUM				

Maine Department of Transportation

Proposal Schedule of Items

Proposal ID: 025313.00

Project(s): 025313.00

SECTION: 1 INITIAL GROUP

Alt Set ID: Alt Mbr ID:

Contractor: _____

Proposal Line Number	Item ID Description	Approximate Quantity and Units	Unit Price		Bid Amount	
			Dollars	Cents	Dollars	Cents
0120	518.51 REPAIR OF UPWARD FACING SURFACES - BELOW REINFORCING STEEL < 8 IN.	430.000 SF	_____	 _____	_____	 _____
0130	518.60 REPAIR OF VERTICAL SURFACES < 8 IN.	180.000 SF	_____	 _____	_____	 _____
0140	518.61 REPAIR OF VERTICAL SURFACES >= 8 IN.	2.000 CY	_____	 _____	_____	 _____
0150	519.60 EXPANSION DEVICE - ASPHALTIC PLUG JOINT	31.000 LF	_____	 _____	_____	 _____
0160	520.241 BRIDGE JOINT MODIFICATION TYPE 1	1.000 EA	_____	 _____	_____	 _____
0170	520.243 BRIDGE JOINT MODIFICATION TYPE 3	6.000 EA	_____	 _____	_____	 _____
0200	526.301 PORTABLE CONCRETE BARRIER TYPE I	LUMP SUM		 LUMP SUM	_____	 _____
0210	527.33 TRUCK MOUNTED ATTENUATOR	1.000 EA	_____	 _____	_____	 _____
0220	527.34 WORK ZONE CRASH CUSHIONS	1.000 UN	_____	 _____	_____	 _____
0230	627.733 4" WHITE OR YELLOW PAINTED PAVEMENT MARKING LINE	4,950.000 LF	_____	 _____	_____	 _____
0240	627.75 WHITE OR YELLOW PAVEMENT & CURB MARKING	690.000 SF	_____	 _____	_____	 _____

Maine Department of Transportation

Proposal Schedule of Items

Proposal ID: 025313.00

Project(s): 025313.00

SECTION: 1 INITIAL GROUP

Alt Set ID: Alt Mbr ID:

Contractor: _____

Proposal Line Number	Item ID Description	Approximate Quantity and Units	Unit Price		Bid Amount	
			Dollars	Cents	Dollars	Cents
0250	627.77 REMOVING PAVEMENT MARKINGS	1,550.000 SF	_____	_____	_____	_____
0260	627.78 TEMPORARY 4 INCH PAINTED PAVEMENT MARKING LINE, WHITE OR YELLOW	10,500.000 LF	_____	_____	_____	_____
0270	627.811 TEMPORARY BI-DIRECTIONAL YELLOW DELINEATORS	40.000 EA	_____	_____	_____	_____
0280	627.812 TEMP. BI-DIRECTIONAL WHITE DELINEATORS	80.000 EA	_____	_____	_____	_____
0290	629.05 HAND LABOR, STRAIGHT TIME	60.000 HR	_____	_____	_____	_____
0300	631.112 WELDING MACHINE (INCLUDING OPERATOR)	20.000 HR	_____	_____	_____	_____
0310	631.12 ALL PURPOSE EXCAVATOR (INCLUDING OPERATOR)	20.000 HR	_____	_____	_____	_____
0320	631.133 SKID STEER (INCLUDING OPERATOR)	20.000 HR	_____	_____	_____	_____
0330	631.172 TRUCK - LARGE (INCLUDING OPERATOR)	20.000 HR	_____	_____	_____	_____
0340	639.19 FIELD OFFICE TYPE B	1.000 EA	_____	_____	_____	_____
0350	652.30 FLASHING ARROW BOARD	2.000 EA	_____	_____	_____	_____

Maine Department of Transportation

Proposal Schedule of Items

Proposal ID: 025313.00

Project(s): 025313.00

SECTION: 1 INITIAL GROUP

Alt Set ID: Alt Mbr ID:

Contractor: _____

Proposal Line Number	Item ID Description	Approximate Quantity and Units	Unit Price		Bid Amount	
			Dollars	Cents	Dollars	Cents
0360	652.312 TYPE III BARRICADE	8.000 EA	_____	 _____	_____	 _____
0370	652.33 DRUM	100.000 EA	_____	 _____	_____	 _____
0380	652.34 CONE	25.000 EA	_____	 _____	_____	 _____
0390	652.35 CONSTRUCTION SIGNS	1,000.000 SF	_____	 _____	_____	 _____
0400	652.361 MAINTENANCE OF TRAFFIC CONTROL DEVICES	LUMP SUM	LUMP SUM		_____	 _____
0410	652.38 FLAGGER	300.000 HR	_____	 _____	_____	 _____
0420	652.381 TRAFFIC OFFICER	80.000 HR	_____	 _____	_____	 _____
0430	652.41 PORTABLE CHANGEABLE MESSAGE SIGN	4.000 EA	_____	 _____	_____	 _____
0440	656.75 TEMPORARY SOIL EROSION AND WATER POLLUTION CONTROL	LUMP SUM	LUMP SUM		_____	 _____
0450	659.10 MOBILIZATION	LUMP SUM	LUMP SUM		_____	 _____
Section: 1			Total:		_____	 _____
			Total Bid:		_____	 _____

STATE OF MAINE DEPARTMENT OF TRANSPORTATION



BANGOR & BREWER PENOBSCOT COUNTY JOSHUA CHAMBERLAIN BRIDGE OVER PENOBSCOT RIVER BRIDGE # 5312 WIN 025313.00

LIST OF DRAWINGS

Title Sheet.....	1
Estimated Quantities & General Construction Notes.....	2
General Plan (2 Sheets).....	3-4
Staged Construction Sections.....	5
Transverse Sections.....	6
Joint Repair Details.....	7
Barrier Repair Details.....	8
Detour Plan Phase 1 (2 Sheets).....	9-10
Detour Plan Phase 2 (2 Sheets).....	11-12

UTILITIES

Bangor Gas Company	City of Brewer
Bangor Water District	Charter Communications Inc.
City of Bangor	Consolidated Communications of Northern New England Company LLC
Brewer Water Department	Firstlight
MaineCom Services	Northern Light Health
CSX Transportation Inc.	Versant Power

TRAFFIC DATA

Current (2021) AADT.....	13170
Future (2041) AADT.....	14490
DHV - % of AADT.....	11%
Design Hour Volume.....	1594
Heavy Trucks (% of AADT).....	3%
Heavy Trucks (% of DHV).....	2%
Directional Distribution (% of DHV).....	55%
18 kip Equivalent P 2.0.....	122
18 kip Equivalent P 2.5.....	116
Design Speed (mph).....	25

MAINTENANCE OF TRAFFIC

Maintain one lane of continuous westbound traffic.

SPECIFICATIONS

Design: Load and Resistance Factor Design per AASHTO LRFD Bridge Design Specifications, Ninth Edition 2020.

DESIGN LOADING

Live Load..... HS - 20 (Existing Components)

MATERIALS

Concrete:	
Joint Headers.....	Polyester Polymer Concrete
Deck, Curb and Barrier.....	Class "A1"
Reinforcing:	
Plain Reinforcing Steel.....	ASTM A615, Grade 60
Structural Steel:	
All Shapes and Plates.....	AASHTO M 270M/M 270, Grade 36
High Strength Bolts.....	ASTM F3125, Grade A325, Type 3 for Weathering Steel, Otherwise Type 1

BASIC DESIGN STRESSES

Concrete:	
Polyester Polymer Concrete.....	f'c = 3,000 psi
Class "A1".....	f'c = 4,000 psi
Reinforcing:	
Plain Reinforcing Steel.....	f y = 60,000 psi
Structural Steel:	
ASTM A709, Grade 50.....	F y = 50,000 psi
ASTM F3125, Grade A325.....	F y = 120,000 psi

<u>PROJECT LOCATION</u>	Joshua Chamberlain Bridge Bangor, Maine Lat. /Long. 44° 47' 46.4" N/ 68° 46' 5.3" W
<u>PROGRAM AREA</u>	Bridge Program
<u>OUTLINE OF WORK</u>	Joint Modifications, and Wearing Surface Replacement

STATE OF MAINE
DEPARTMENT OF TRANSPORTATION
APPROVED
DATE 3-19-26
COMMISSIONER: [Signature]
CHIEF ENGINEER: [Signature]

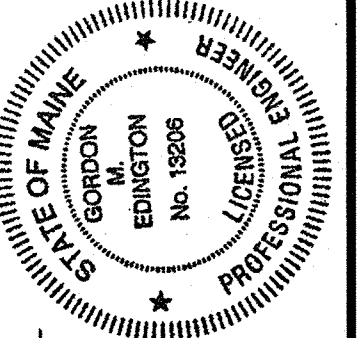

Edington
SIGNATURE
13206
P.E. NUMBER
3/18/2026
DATE

DATE	12/20/2026
BY	TSR
MICHAEL WIGHT	TSR
DESIGN-DETAILED	NJC
CHECKED-REVIEWED	BJR
DESIGN-DETAILED2	GME
DESIGN-DETAILED3	
REVISIONS 1	BRIDGE JOINT MOD AT PIER 11 3/18/2026
REVISIONS 2	
REVISIONS 3	
REVISIONS 4	
FIELD CHANGES	

JOSHUA CHAMBERLAIN BRIDGE
OVER PENOBSCOT RIVER
PENOBSCOT COUNTY
BANGOR
TITLE SHEET

SHEET NUMBER

1

OF 12

ESTIMATED QUANTITIES				
ITEM NO.	DESCRIPTION		QUANTITY	UNIT
202.127	Removing of Existing Bituminous Pavement	(4650 SY)	1	LS
202.20	Removing Bituminous Concrete Pavement		470	SY
202.202	Removing Pavement Surface		730	SY
202.30	Removing Existing Concrete Wearing Surface	(150 SY)	1	LS
403.2081	Hot Mix Asphalt - 12.5 mm (Polymer Modified)		450	T
403.209	Hot Mix Asphalt - 9.5 mm (Sidewalks, Drives, & Incidentals)		52	T
403.211	Hot Mix Asphalt - Shim		25	T
403.2131	Hot Mix Asphalt - 12.5 mm (base and intermediate course Polymer Modified)		400	T
409.15	Bituminous Tack Coat, Applied		330	GAL
508.14	High Performance Waterproofing Membrane	(4800 SY)	1	LS
515.21	Protective Coating for Concrete Surfaces	(1800 SY)	1	LS
518.51	Repair of Upward Facing Surfaces- below Reinforcing Steel < 8 inches		430	SF
518.60	Repair of Vertical Surfaces < 8 Inches		180	SF
518.61	Repair of Vertical Surfaces >= 8 Inches		2	CY
519.60	Expansion Device - Asphaltic Plug Joint		31	LF
520.241	Bridge Joint Modification Type 1		1	EA
520.243	Bridge Joint Modification Type 3		6	EA
526.301	Portable Concrete Barrier, Type 1	(1550 LF)	1	LS
527.33	Truck Mounted Attenuator		1	EA
527.34	Work Zone Crash Cushions		1	UN
627.733	4" White or Yellow Painted Pavement Marking Line		4950	LF
627.75	White or Yellow Pavement & Curb Marking		690	SF
627.77	Removing Existing Pavement Marking		1550	SF
627.78	Temporary 4" Painted Pavement Marking Line, White or Yellow		10500	LF
627.811	Temporary Bi-Directional Yellow Delineators		40	EA
627.812	Temporary Bi-Directional White Delineators		80	EA
629.05	Hand Labor, Straight Time		60	HR
631.112	Welding Machine (including operator)		20	HR
631.12	All Purpose Excavator (including operator)		20	HR
631.133	Skid Steer (including operator)		20	HR
631.172	Truck-Large (including operator)		20	HR
639.19	Field Office, Type B		1	EA
652.30	Flashing Arrow		2	EA
652.312	Type III Barricades		8	EA
652.33	Drum		100	EA
652.34	Cone		25	EA
652.35	Construction Signs		1000	SF
652.361	Maintenance of Traffic Control Devices		1	LS
652.38	Flagger		300	HR
652.381	Traffic Officers		80	HR
652.41	Portable-Changeable Message Sign		4	EA
656.75	Temporary Soil Erosion and Water Pollution Control		1	LS
659.10	Mobilization		1	LS

1

GENERAL CONSTRUCTION NOTES:

- Project information referred to below may be accessed at the following MaineDOT web address <http://www.maine.gov/dot/doing-business/bid-opportunities>
- The existing bridge plans may be accessed at the MaineDOT web address. The plans are reproductions of the original drawings as prepared for the construction of the bridge. It is very unlikely that the plans will show any construction field changes or any alterations which may have been made to the bridge during its life span.
- All dimensions, angles, and stationing shown are taken from as-built construction drawings from 1954 and 1998 and are not guaranteed to be correct. All information based on or relating to the existing bridges shall be verified in the field by the Contractor.
- All utility facilities shall be adjusted by the respective utilities unless otherwise noted.
- Existing signs within the Project Limits shall be removed and reset as directed by the Resident. Payment for removal and reinstallation of existing signs will be considered incidental to the Contract. No separate payment will be made.
- Quantities included for pay items measured and paid for by Lump Sum are estimated quantities and are provided by MaineDOT for informational purposes only. Lump Sum pay items will be paid for at the Contract Bid amount, with no addition or reduction in payment to the contractor if the actual final quantities are different from the MaineDOT provided estimated quantities, except as follows:
 - If a Lump Sum pay item is eliminated, the requirements of the Standard Specifications Section 109.2, Elimination of Items, will take precedence.
 - If other Contract Documents specifically allow a change in payment for a Lump Sum pay item, those requirements will be followed.
 - If a design change results in changes to estimated quantities for Lump Sum pay items, price adjustments will be made in accordance with Standard Specifications Section 109.7, Equitable Adjustments to Compensation and Time.
- Reinforcing steel shall have a minimum concrete cover of 2" unless otherwise noted.
- All reinforcing steel that is to be exposed and reused shall be cleaned by a method approved by the Resident. Payment shall be incidental to the related Contract Items.
- Any damage to existing concrete, reinforcing steel, joint steel, or joint seals to remain resulting from the work performed shall be repaired or replaced by a method approved by the Resident at no cost to the Department.
- If the depth of deteriorated concrete is at or below the reinforcing steel, then concrete shall be removed a minimum of 1 inch below the reinforcing steel.
- When a new joint is being installed, or an existing joint is substantially modified, and field conditions permit, the approach side of the joint shall be set 1/8" - 1/4" higher than the departure side of the joint. Under no circumstances shall the departing side of the joint be higher than the approach side of the joint.
- New seals indicated to be replaced shall extend the full width of the bridge plus a distance of 6" beyond the outside face of the barrier on each side of the bridge after all the other joint work is complete. The Resident shall approve the seals prior to ordering or fabrication of the Expansion Device.
- All surface pavement shall be full width unless otherwise noted.
- Protective Coating for Concrete Surfaces shall be applied to the following areas:
All exposed surfaces of concrete separation barriers.



PROJ. MANAGER	MICHAEL WIGHT	DATE	3/18/2026
DESIGN-DETAILED	MJC	BY	2/20/2026
CHECKED-REVIEWED	BIR	DATE	2/20/2026
DESIGN-DETAILED02		BRIDGE JOINT MOD AT THE 11	3/18/2026
DESIGN-DETAILED03			
REVISIONS 1			
REVISIONS 2			
REVISIONS 3			
REVISIONS 4			
FIELD CHANGES			

JOSHUA CHAMBERLAIN BRIDGE
OVER PENOBSCOT RIVER
BANGOR PENOBSCOT COUNTY
ESTIMATED QUANTITIES & GENERAL CONSTRUCTION NOTES

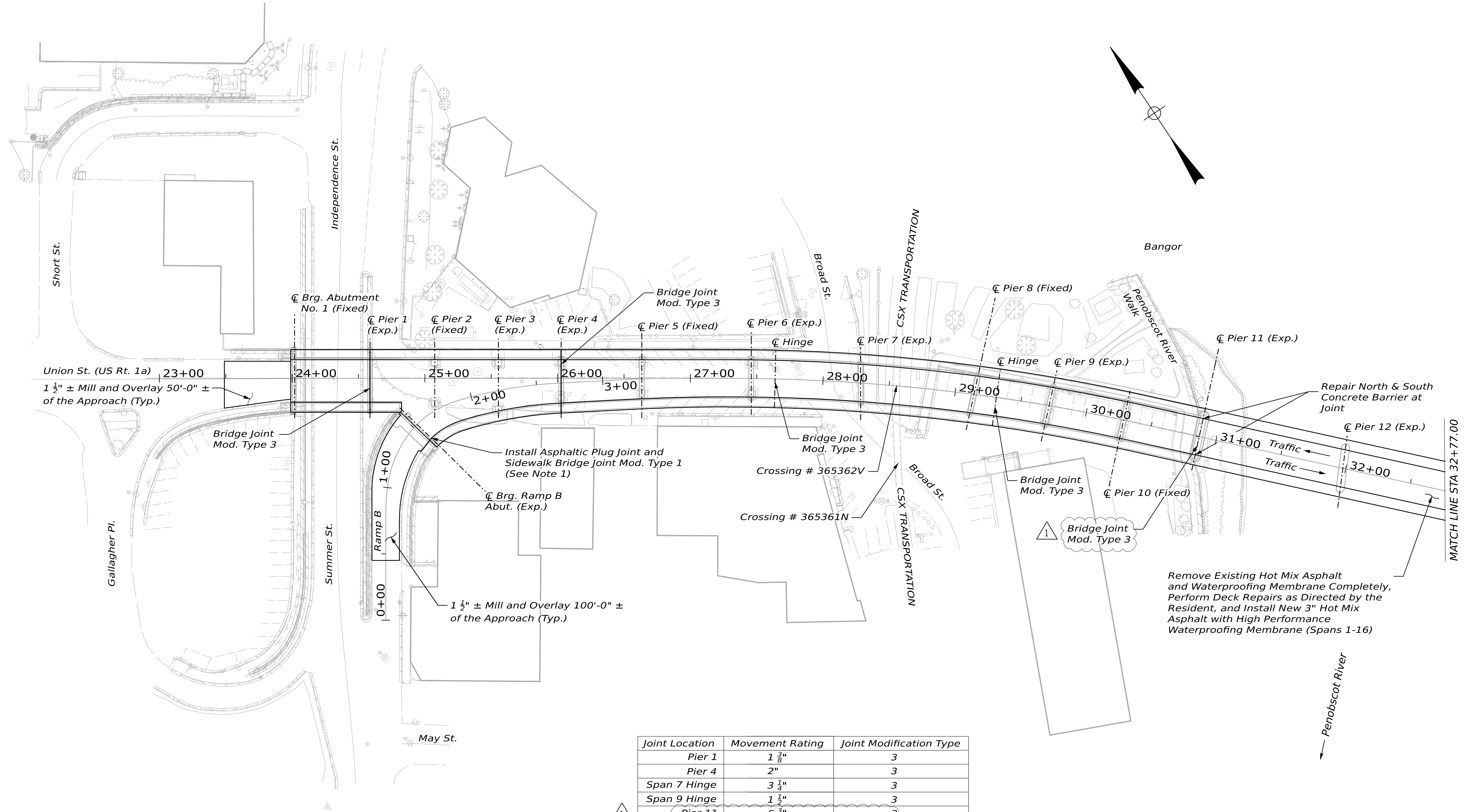

Joint Location	Movement Rating	Joint Modification Type
Pier 1	1 3/8"	3
Pier 4	2"	3
Span 7 Hinge	3 1/4"	3
Span 9 Hinge	1 1/4"	3
Pier 11	6 3/8"	3

BRIDGE JOINT NOTE:

1. The Asphaltic Plug Joint shall be placed within the limits of the roadway and be paid as Item 519.60 Expansion Device - Asphaltic Plug Joint. The Bridge Joint Modification Type 1 shall include installation of a seal within the limits of the sidewalk and be paid as Item 520.241 Bridge Joint Modification Type 1.

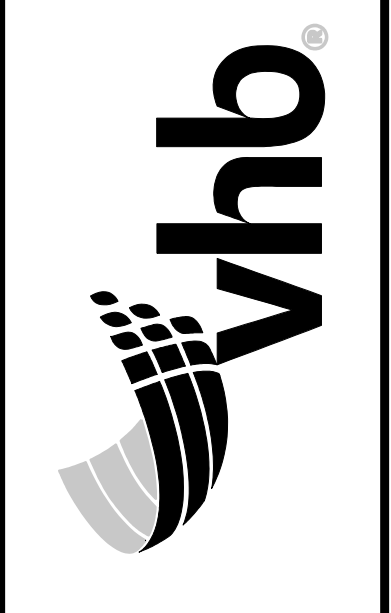

PROJ. MANAGER	MICHAEL WIGHT	DATE
DESIGNED-DETAILED	MJC	2/20/2026
CHECKED-REVIEWED	BIR	2/20/2026
DESIGNED-DETAILED		
REVISIONS 1	BRIDGE JOINT MOD AT PIER 11	3/18/2026
REVISIONS 2		
REVISIONS 3		
REVISIONS 4		
FIELD CHANGES		

JOSHUA CHAMBERLAIN BRIDGE
OVER PENOBSCOT RIVER
PENOBSCOT COUNTY
BANGOR
GENERAL PLAN (1 OF 2)

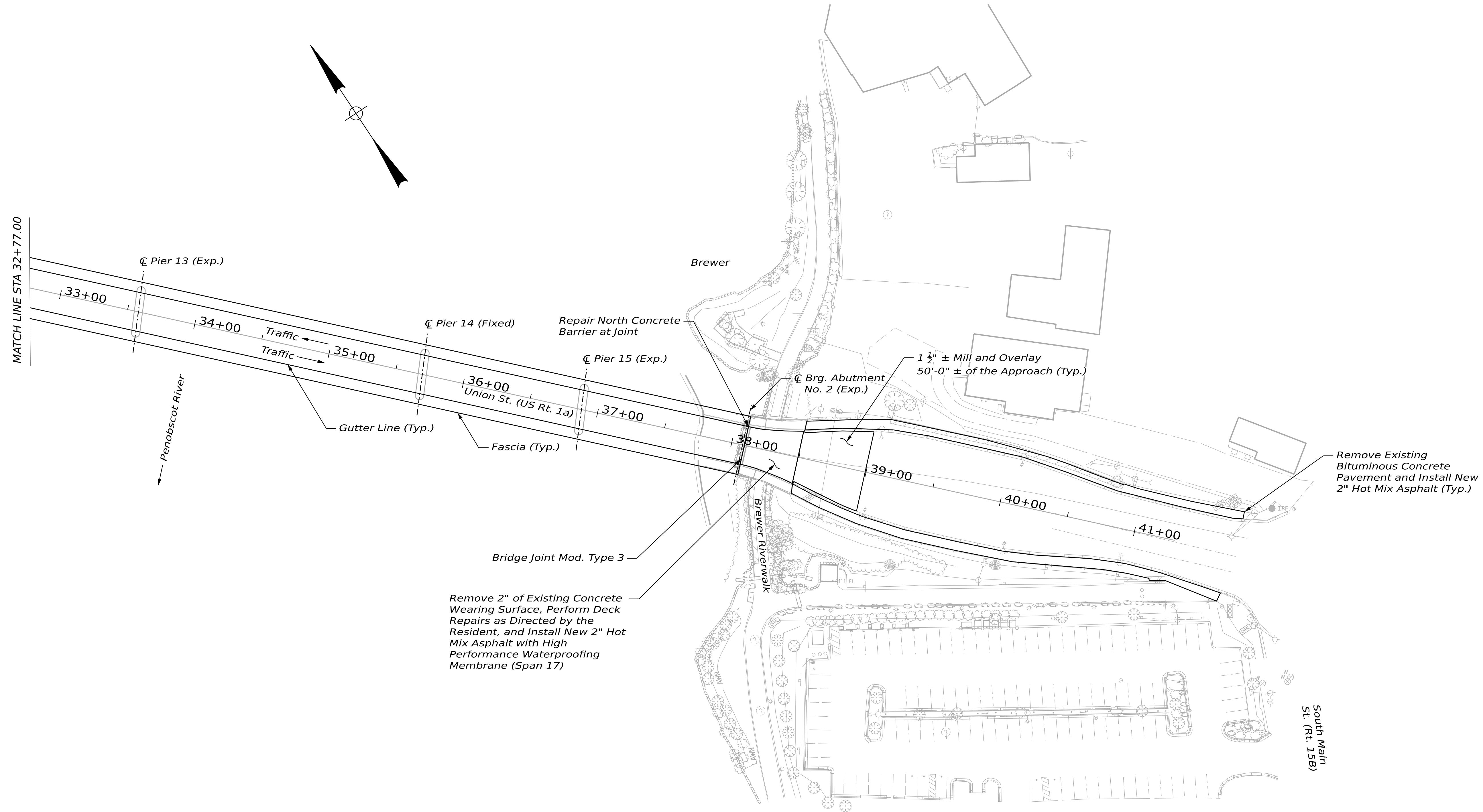

Remove 2" of Existing Concrete Wearing Surface, Perform Deck Repairs as Directed by the Resident, and Install New 2" Hot Mix Asphalt with High Performance Waterproofing Membrane (Span 17)

Joint Location	Movement Rating	Joint Modification Type
Brewer Abutment	3 ³ / ₈ "	3



PROJ. MANAGER	MICHAEL WIGHT	BY	DATE
DESIGN-DETAILED	MJC	TSR	2/20/2026
CHECKED-REVIEWED	BJR	SGM	2/20/2026
DESIGN-DETAILED			
REVISIONS 1			3/18/2026
REVISIONS 2			
REVISIONS 3			
REVISIONS 4			
			FIELD CHANGES

JOSHUA CHAMBERLAIN BRIDGE
OVER PENOBSCOT RIVER
BANGOR PENOBSCOT COUNTY
GENERAL PLAN (2 OF 2)

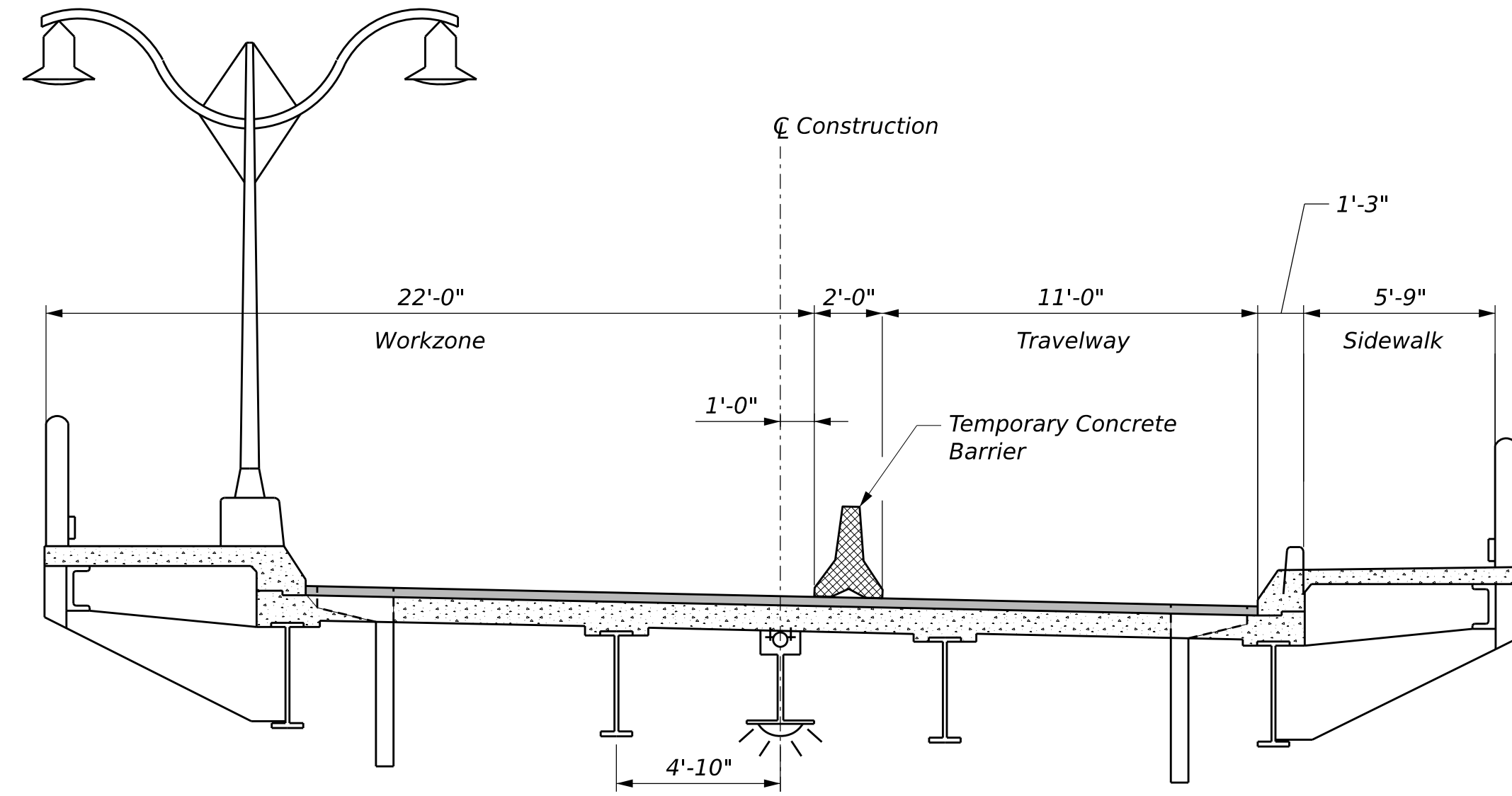

STAGE 1 STAGED CONSTRUCTION SECTION

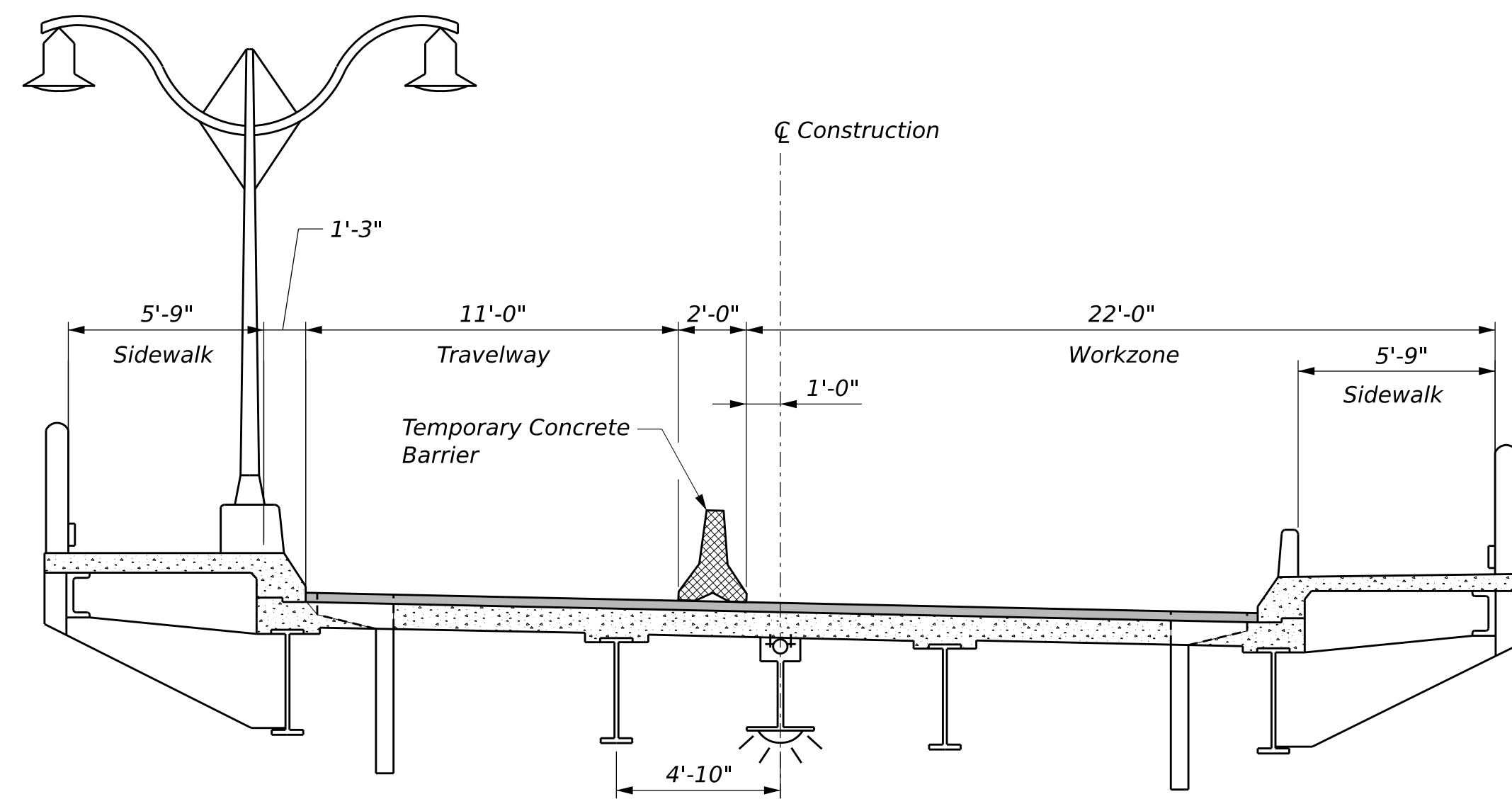

STAGE 2 STAGED CONSTRUCTION SECTION

STAGED CONSTRUCTION NOTE:

- Spans 5 through 11 are shown for minimum workzone and travelway. All other spans similar.



STATE OF MAINE
DEPARTMENT OF TRANSPORTATION
2531300
WIN
025313.00
BRIDGE #5312
BRIDGE PLANS

PROJ. MANAGER	MICHAEL WIGHT	BY	DATE
DESIGN-DETAILED	MJC	MJC	2/20/2026
CHECKED-REVIEWED	BJR	BJR	2/20/2026
DESIGN-DETAILED			
DESIGN-DETAILED			
REVISIONS 1		BRIDGE JOINT MOD AT PIER 11	3/18/2026
REVISIONS 2			
REVISIONS 3			
REVISIONS 4			
FIELD CHANGES			

JOSHUA CHAMBERLAIN BRIDGE
OVER PENOBSCOT RIVER
PENOBSCOT COUNTY
BANGOR
**STAGED CONSTRUCTION
SECTIONS**

SHEET NUMBER

5

OF 12

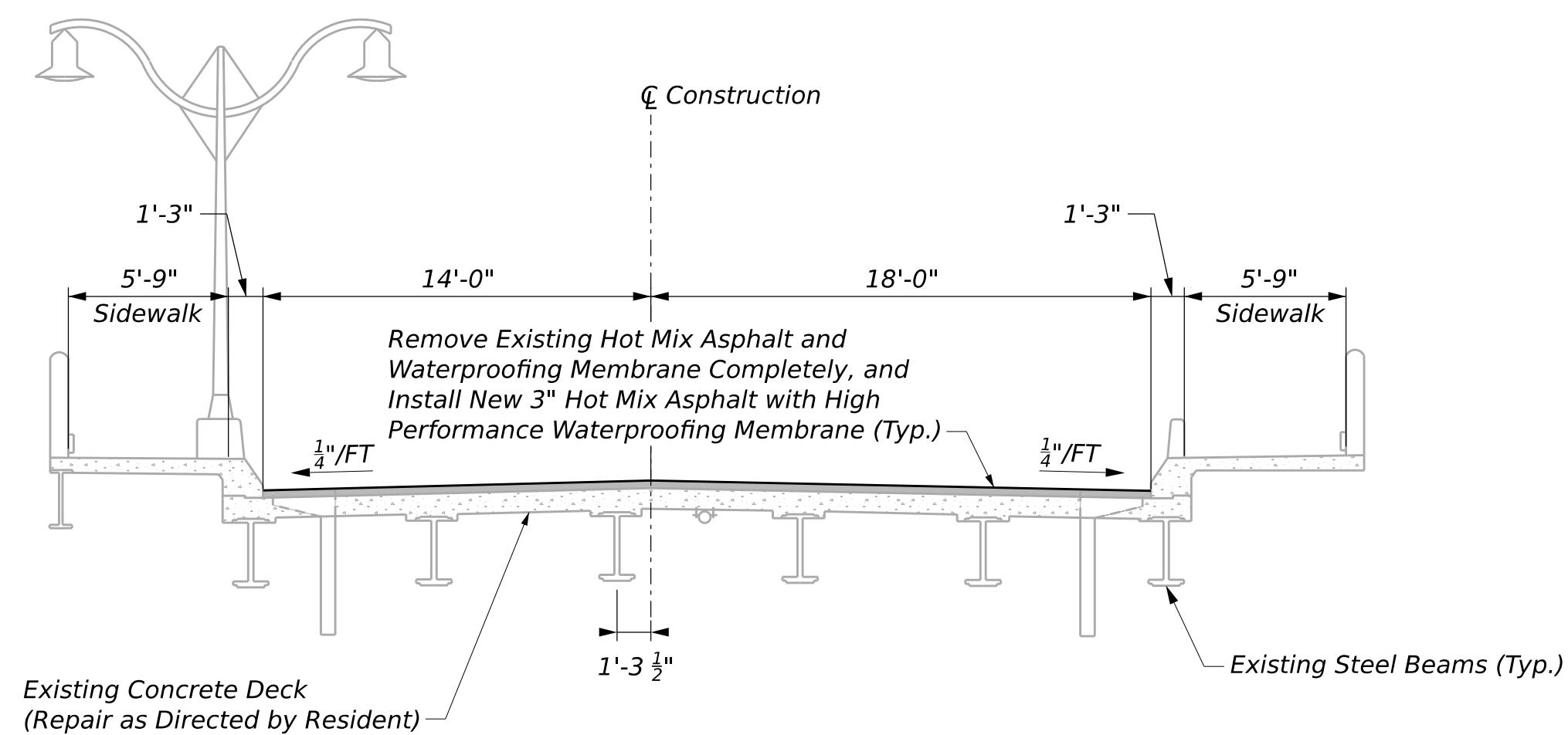

SUPERSTRUCTURE TRANSVERSE SECTION (SPAN 1)

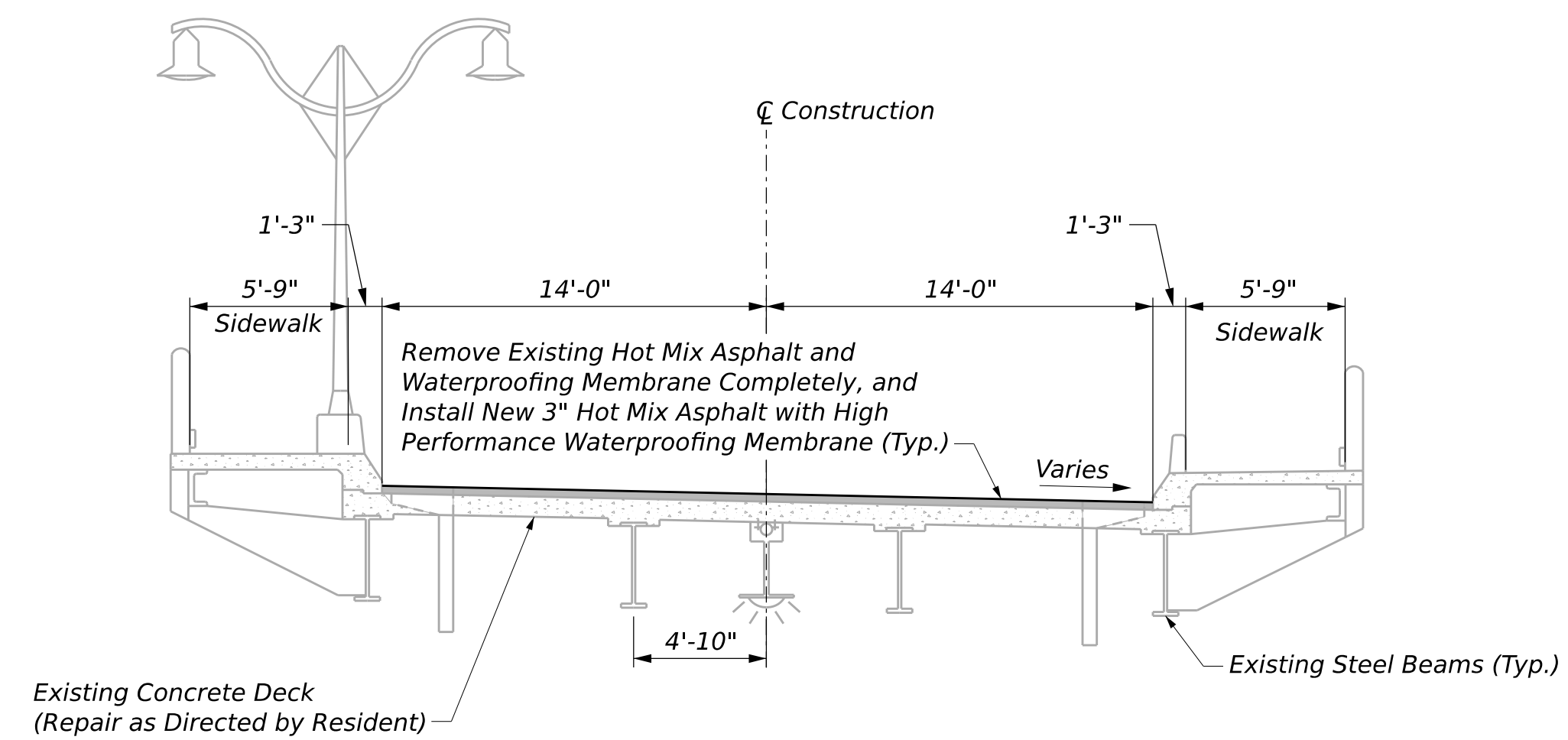

SUPERSTRUCTURE TRANSVERSE SECTION (SPANS 5-11)

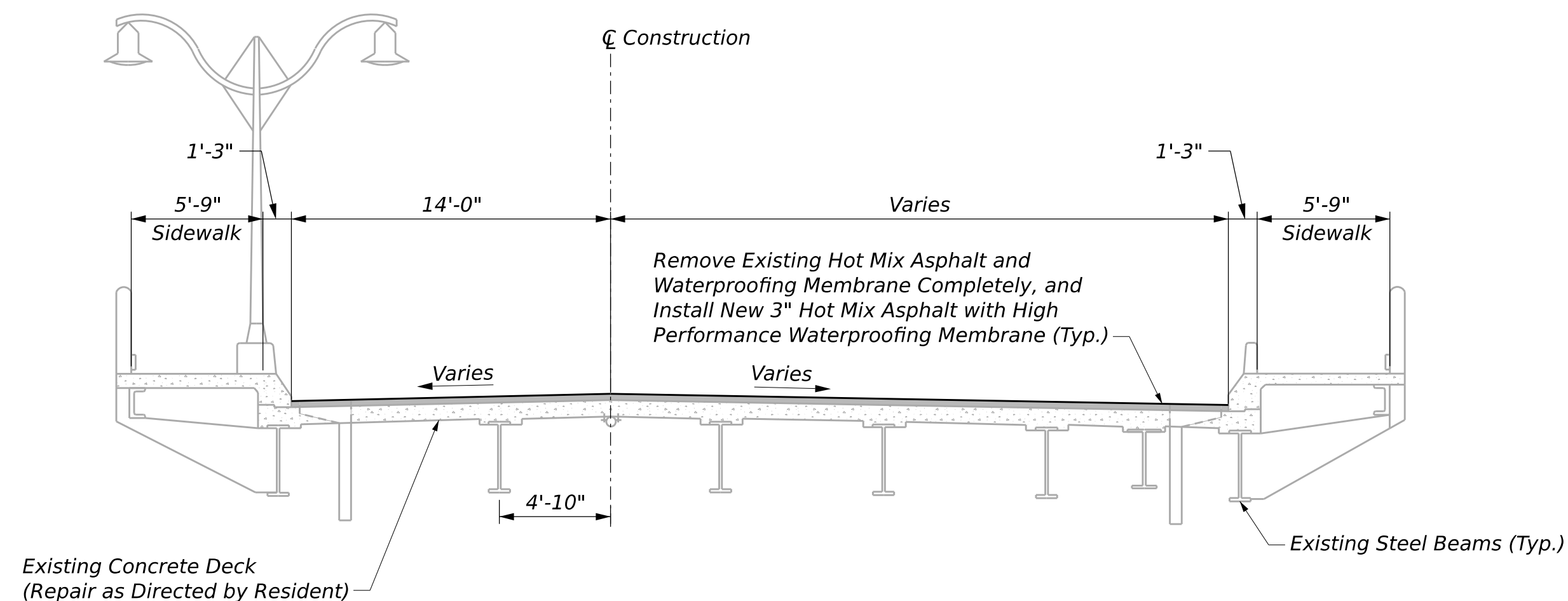

SUPERSTRUCTURE TRANSVERSE SECTION (SPANS 2-4)

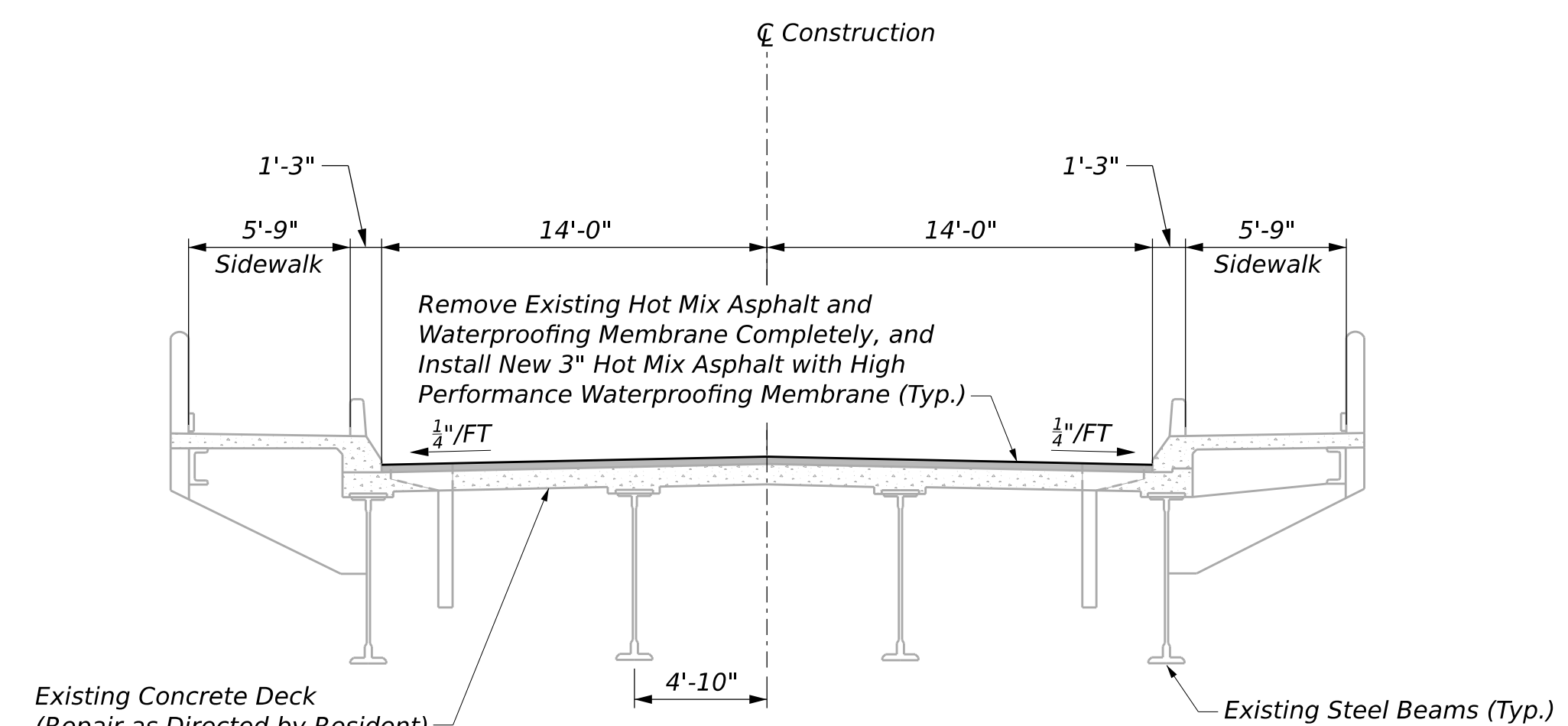

SUPERSTRUCTURE TRANSVERSE SECTION (SPANS 12-16)

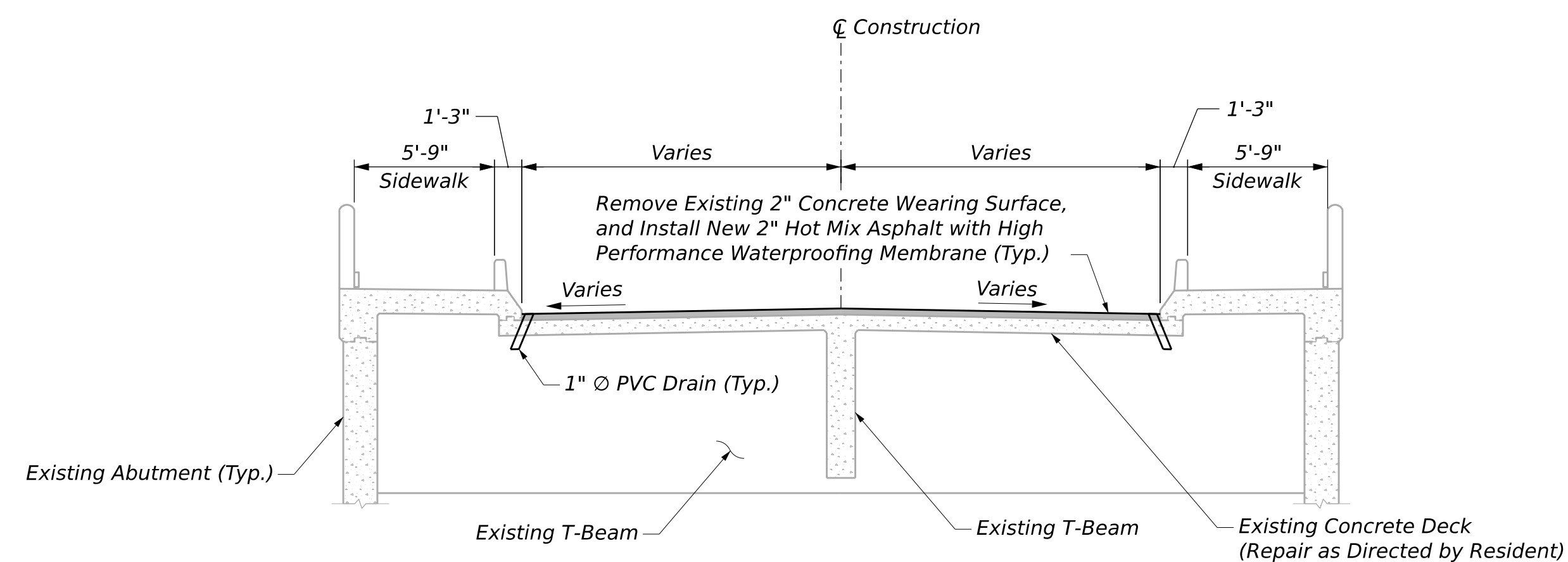

SUPERSTRUCTURE TRANSVERSE SECTION (SPAN 17)

SPAN 17 NOTES:

1. Install 4 - 1" \varnothing PVC drains per Resident's instruction.
2. Drains shall be installed in accordance with Standard Detail 502(04). Payment for labor and material for installing the proposed PVC drains in the existing deck shall not be paid for separately, and shall be considered incidental to the contract.

Username: MCHIPMAN Date: 3/17/2026

STATE OF MAINE
DEPARTMENT OF TRANSPORTATION
2531300
WIN
025313.00
BRIDGE #5312
BRIDGE PLANS



PROJ. MANAGER	BY	DATE
MICHAEL WIGHT	MJC	2/20/2026
DESIGN-DETAILED	BIR	2/20/2026
CHECKED-REVIEWED	BIR	
DESIGN-DETAILED		
DESIGN-DETAILED		
REVISIONS 1		3/18/2026
REVISIONS 2		
REVISIONS 3		
REVISIONS 4		
FIELD CHANGES		

JOSHUA CHAMBERLAIN BRIDGE
OVER PENOBSCOT RIVER
PENOBSCOT COUNTY
BANGOR
TRANSVERSE SECTIONS

SHEET NUMBER
6
OF 12

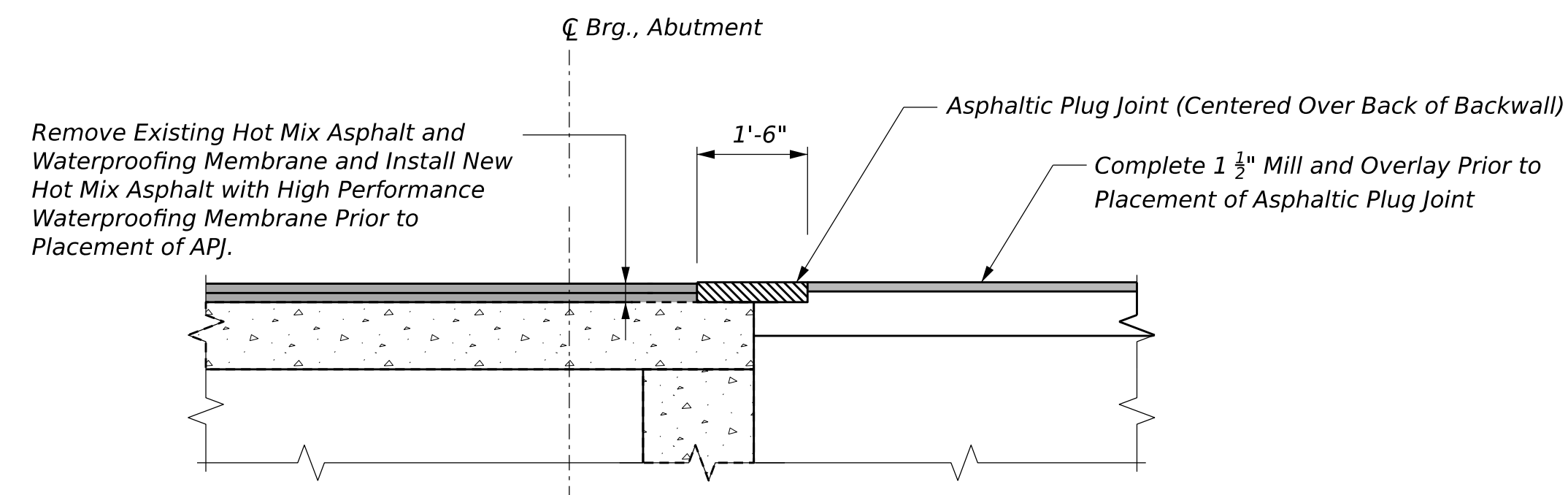

ASPHALTIC PLUG JOINT

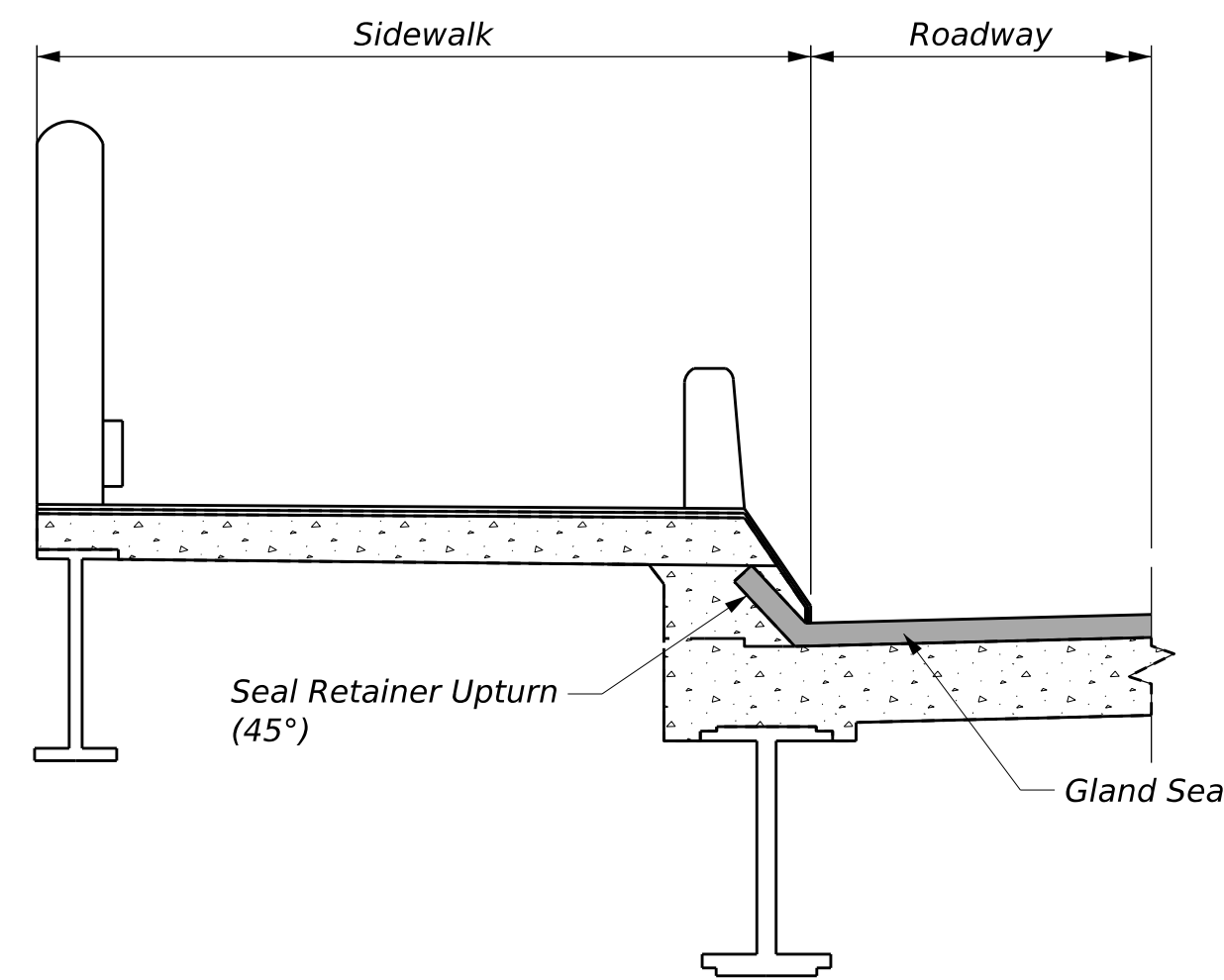

GLAND SEAL DETAIL AT SIDEWALK

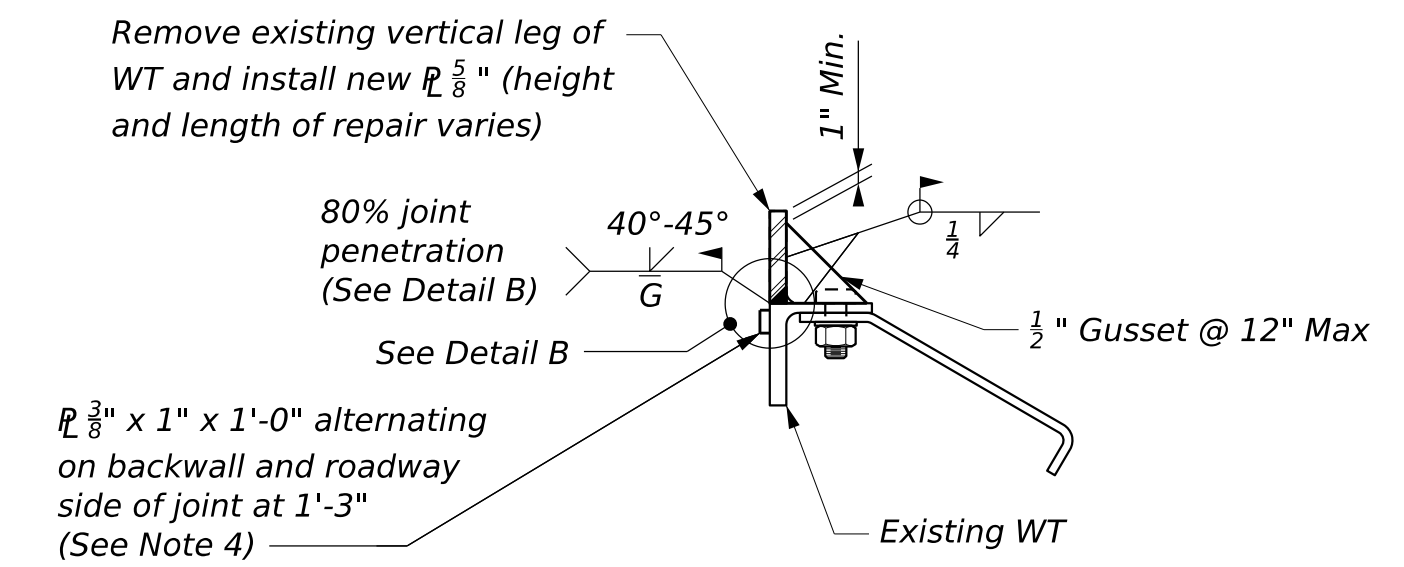

DETAIL A

NOTE:
One side of joint repair shown.
Repair detail may be required
at both sides of joint.

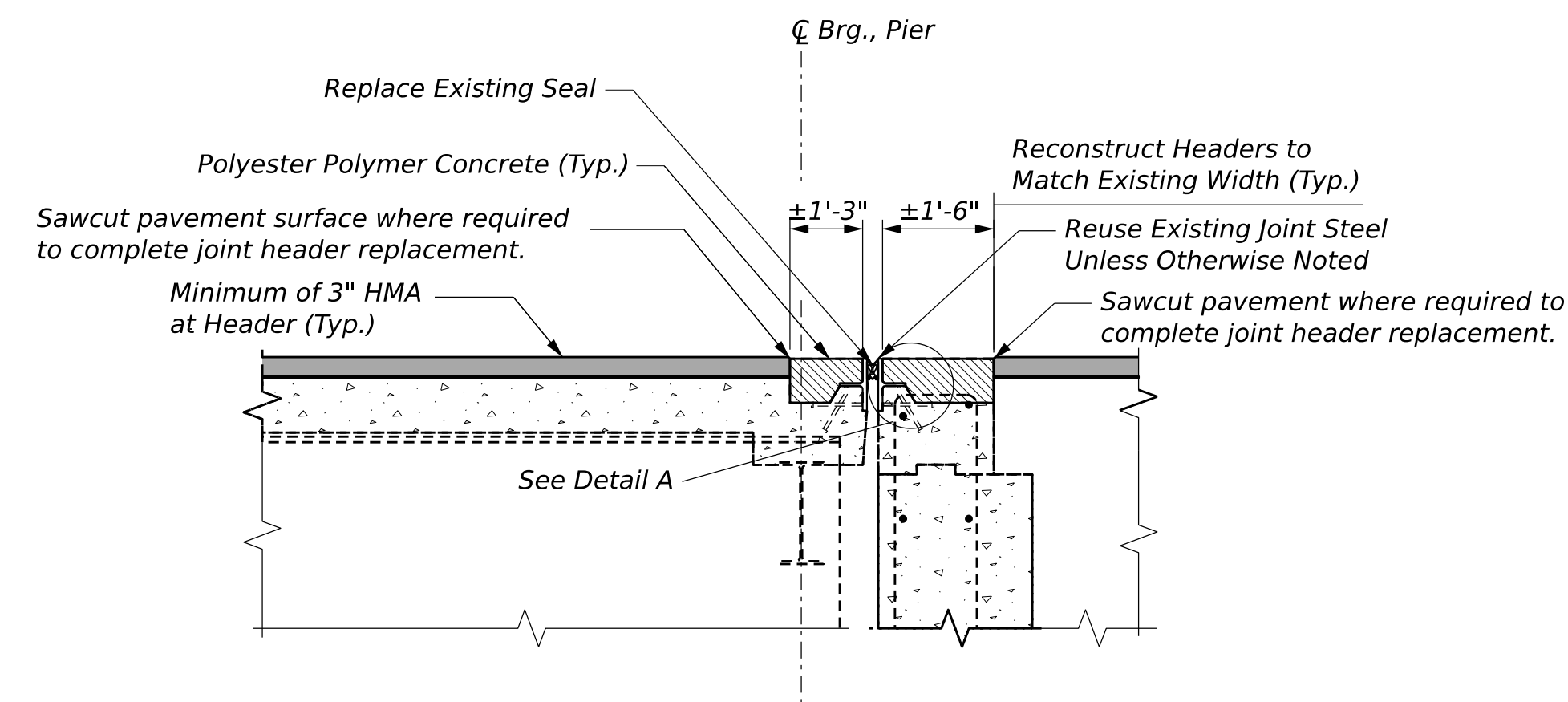

BRIDGE JOINT MODIFICATION TYPE 3

(Section of Abutment Shown, Section at Pier and Hinge Locations Similar)

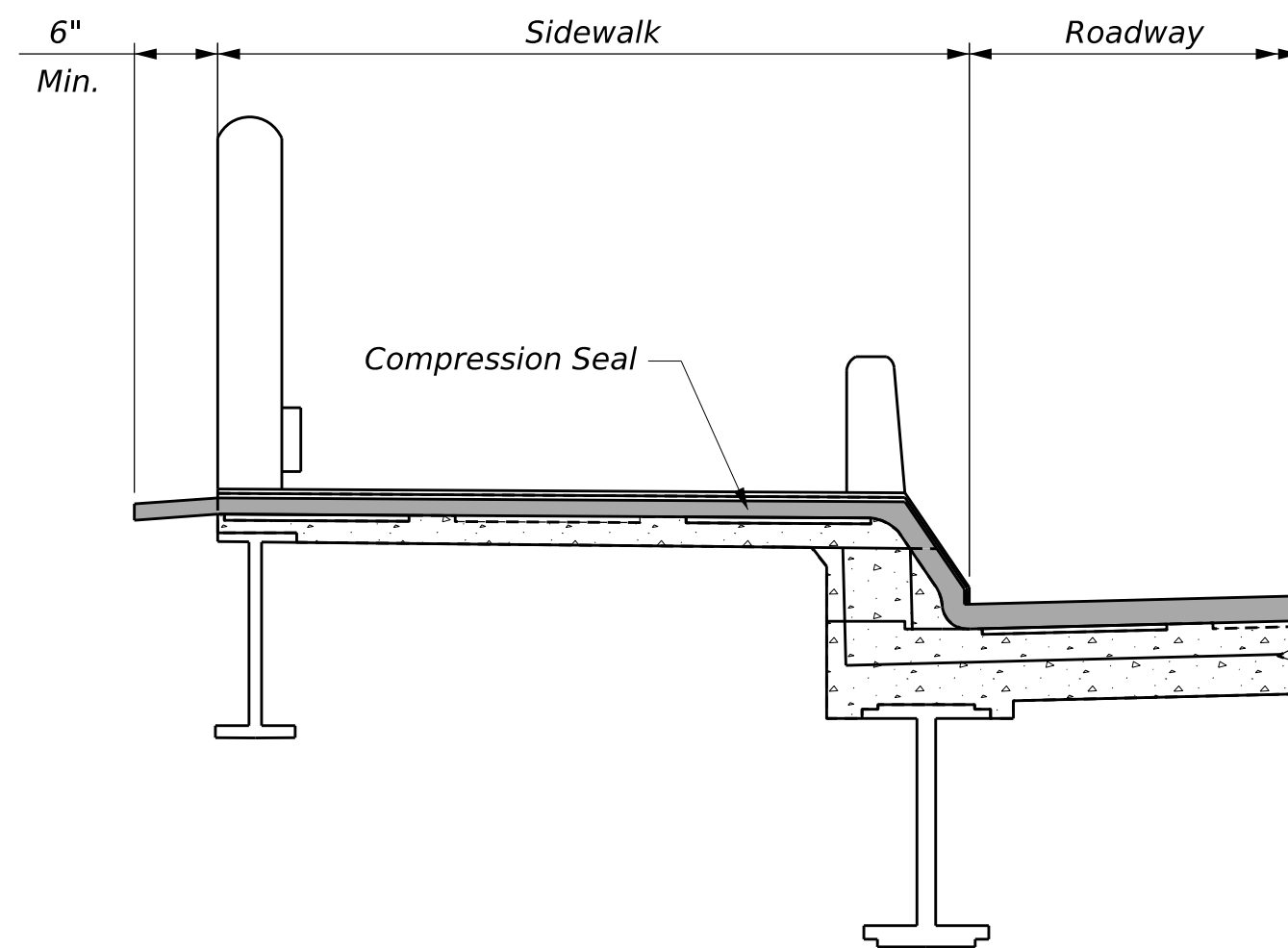

COMPRESSION SEAL DETAIL AT SIDEWALK

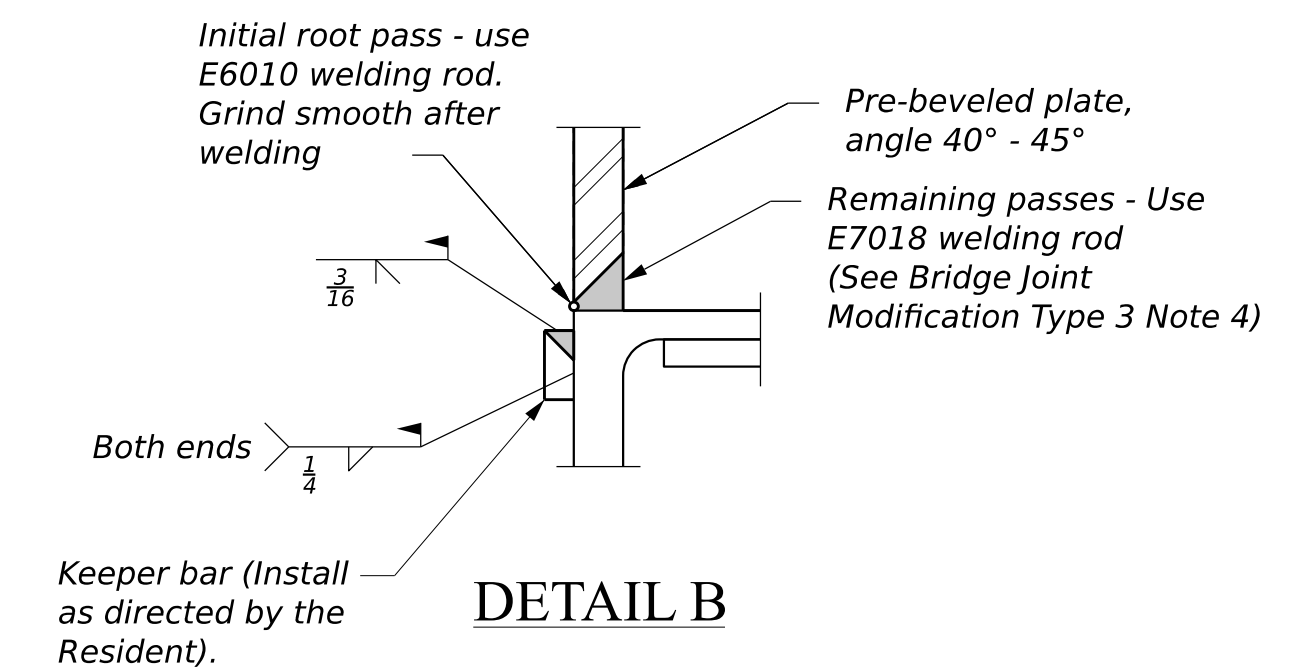

DETAIL B

BRIDGE JOINT MODIFICATION TYPE 1 NOTES:

1. Install new seal in the sidewalk at the Ramp B abutment. The seal shall be selected from the Qualified Products List.

BRIDGE JOINT MODIFICATION TYPE 3 NOTES:

1. Replace joint seal unless otherwise noted.
2. Remove and replace damaged joint armor as directed by the Resident. Selective joint armor replacement is anticipated at Pier 1, Pier 4 and Abutment 2.
3. Keeper bars shall be positioned to allow top of compression seal to sit 1/4" to 1/2" below top of armor. If existing keeper bar does not permit the seal to set at the specified depth, the Contractor shall notify the Resident.
4. If the base material temperature falls below 32 degrees Fahrenheit, the base metal shall be heated to a minimum of 80 degrees Fahrenheit before welding. If the base metal temperature falls below 50 degrees Fahrenheit, the base metal shall be heated to remove any moisture. A welding procedure and listing of proposed welding consumables shall be submitted to the Resident for approval.
5. Removal and replacement of the existing barrier sliding plates to facilitate the installation of the new joint seal shall be incidental to Item 520.243 Bridge Joint Modification Type 3.
6. Place Polyester Polymer Concrete 1/4" above joint armor.

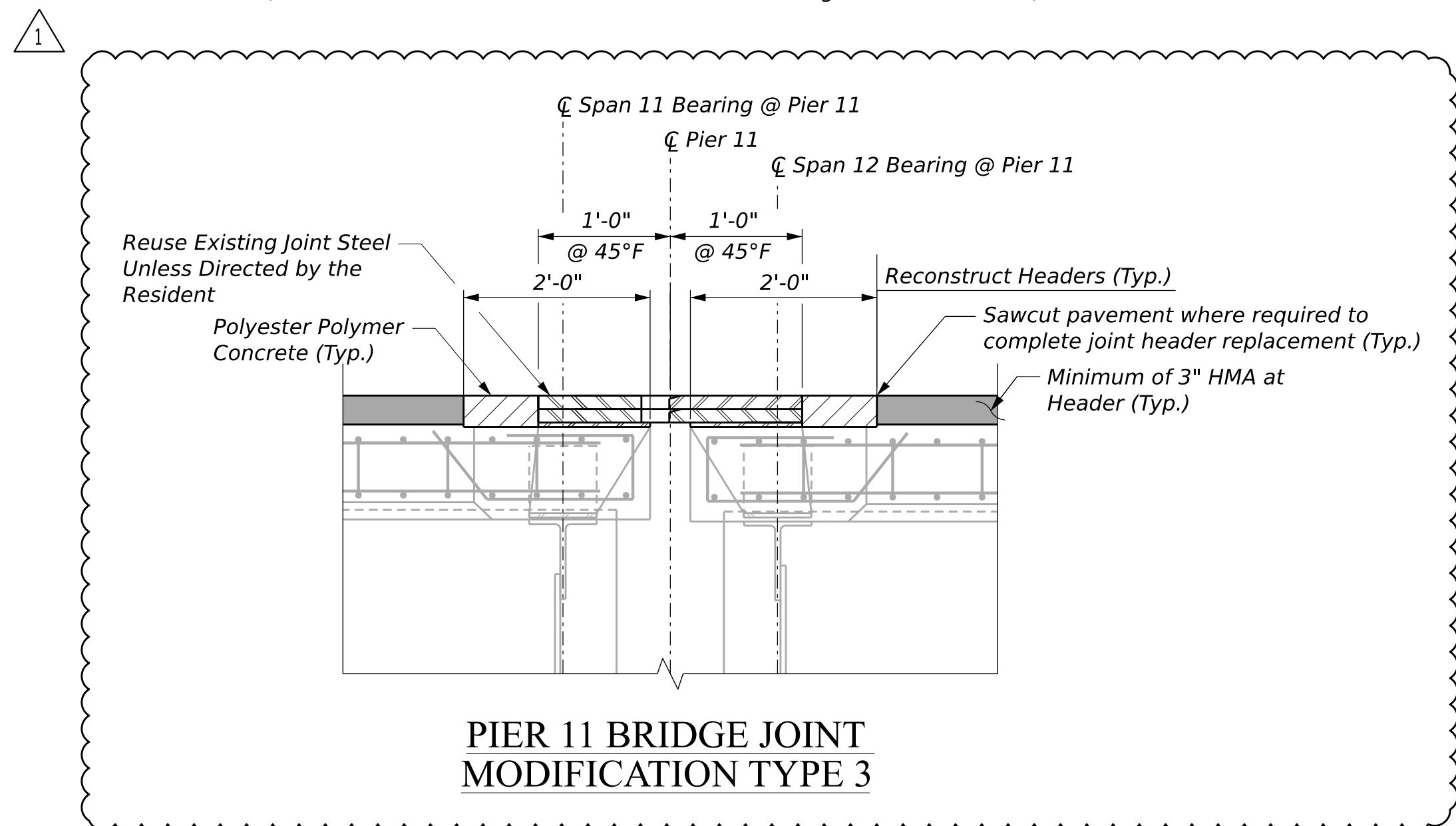

PIER 11 BRIDGE JOINT MODIFICATION TYPE 3



PROJ. MGR.	DATE	BY
MICHAEL WIGHT	2/20/2026	MJC
CHECKED/REVIEWED	2/20/2026	BIR
DESIGNED/DETAILER		
REVISIONS 1	BRIDGE JOINT MOD AT PIER 11	3/18/2026
REVISIONS 2		
REVISIONS 3		
REVISIONS 4		
		FIELD CHANGES

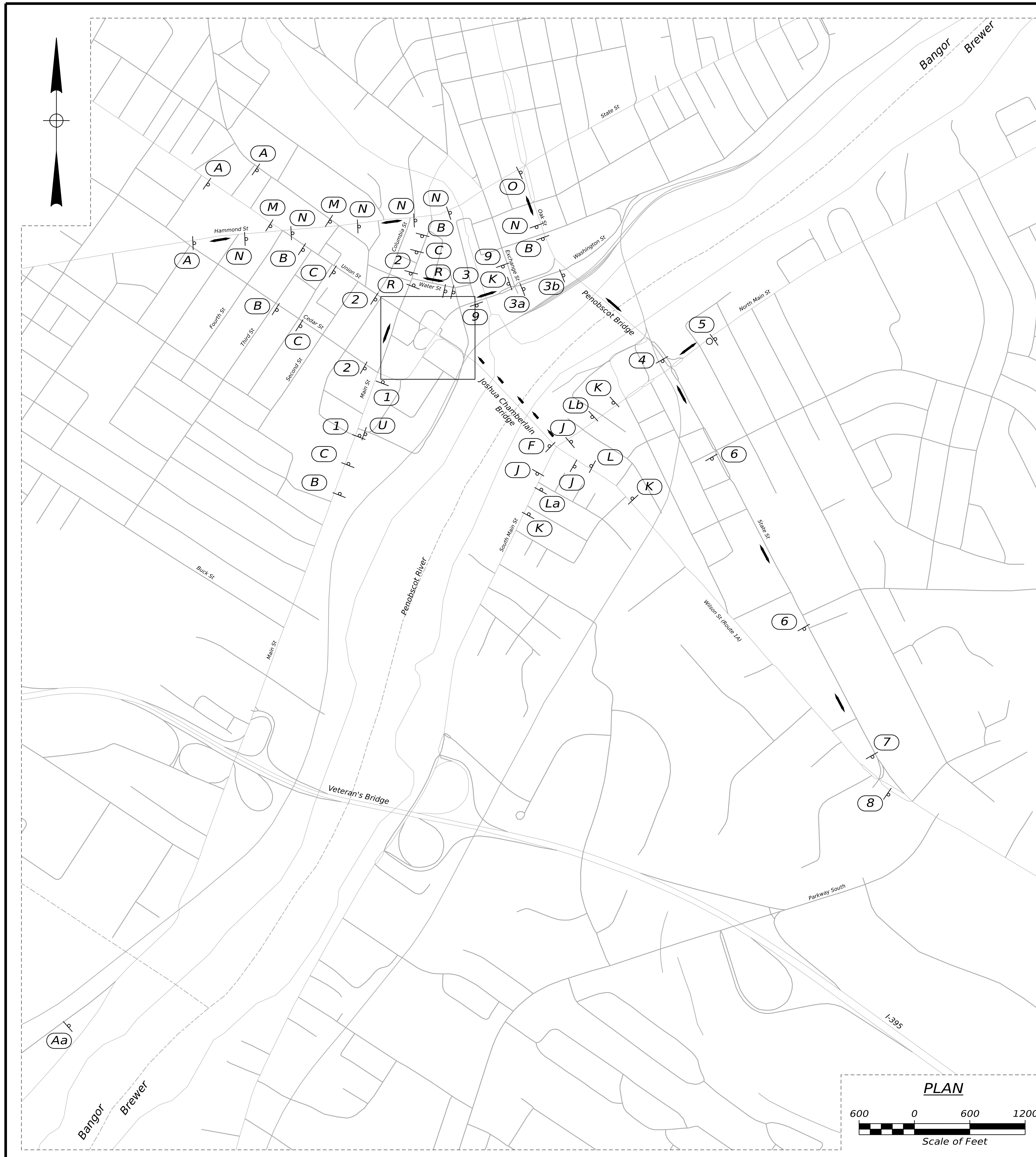

GENERAL NOTES - DETOUR PHASE 1

1. All work performed under this contract to be governed by and in conformity with Maine Department of Transportation Standard Specifications (March 2020), Standard Details Highways and Bridge (March 2020) and supplemental thereto except as modified on the plans and in the Special Provisions.
2. All temporary pavement markings shall be in accordance to MaineDOT Standard Specifications & Standard Details Section 627 & the Manual on Uniform Traffic Control Devices, 11th edition.
3. All construction signs & barriers shall be in accordance to MaineDOT Standard Specifications & Standard Details & the Manual on Uniform Traffic Control Devices, 11th edition.
4. On-street parking on south side of Water Street is to be eliminated from Main Street to the first Key Bank entrance.
5. All existing pavement markings that conflict with the temporary pavement markings shall be removed by grinding. Pavement marking removal to be paid under Item 627.77. At project completion, the original pavement markings are to be restored and the temporary pavement markings removed.
6. Exact location of signs to be field determined and approved by the Resident.

SEE DETAIL A

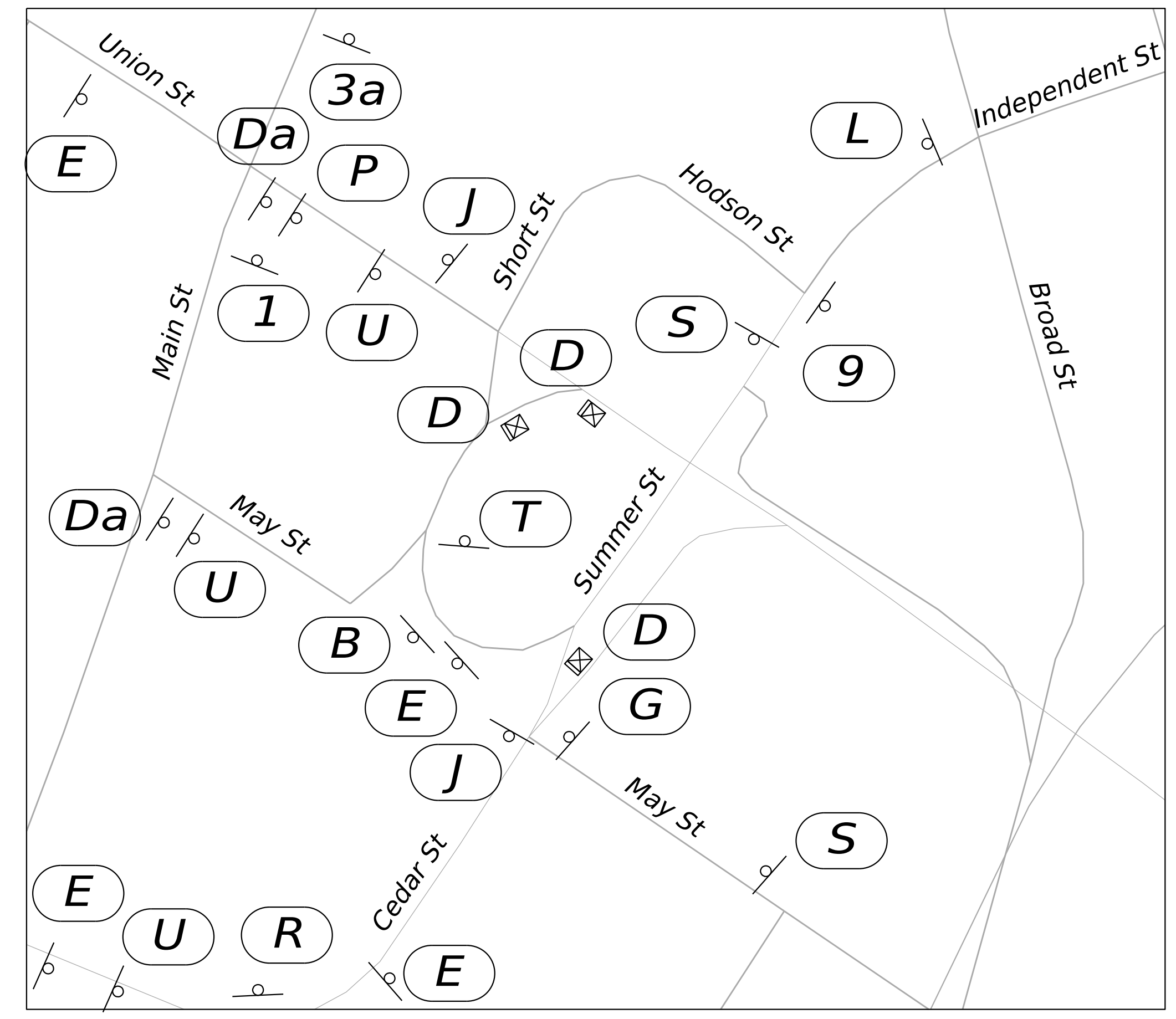

LEGEND:

- Sign Location
- Sign Description
- Traffic Direction
- Type 3 Barricade w/ sign
- Type 3 Barricade

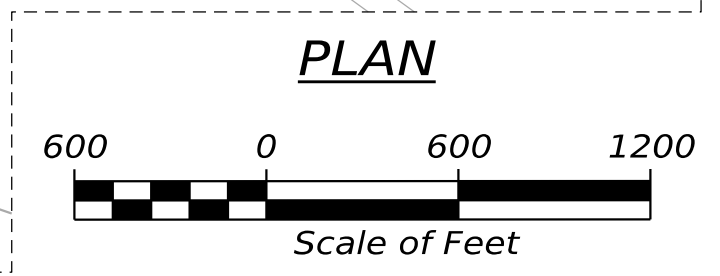

STATE OF MAINE		DEPARTMENT OF TRANSPORTATION	
2531300		WIN 025313.00	
BRIDGE #5312		BRIDGE PLANS	
PROJ. MANAGER	MICHAEL WIGHT	DATE	BY
DESIGN-DETAILED	B/W	2/20/2026	B/W
CHECKED-REVIEWED	JAR	2/20/2026	MOS
DESIGN-DETAILED			
REVISIONS 1		BRIDGE JOINT MOD AT PILE 11	3/18/2026
REVISIONS 2			
REVISIONS 3			
REVISIONS 4			
FIELD CHANGES			
JOSHUA CHAMBERLAIN BRIDGE OVER PENOBSCOT RIVER			
BANGOR PENOBSCOT COUNTY			
DETOUR PLAN PHASE 1 (1 OF 2)			
SHEET NUMBER			
9			
OF 12			

DETOUR SIGN ASSEMBLIES

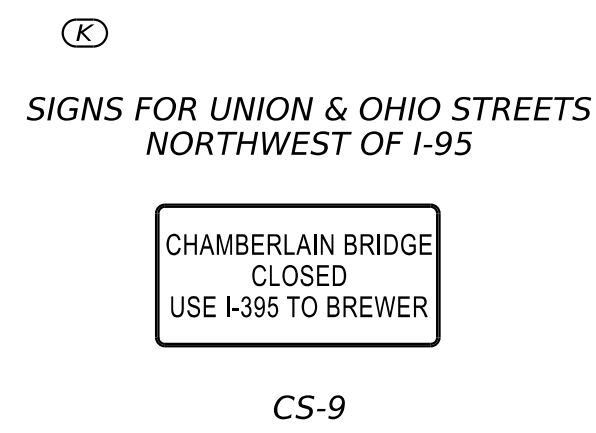
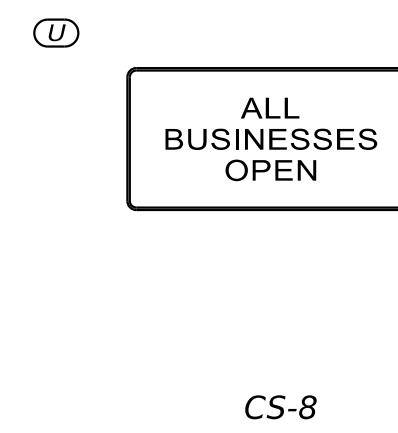
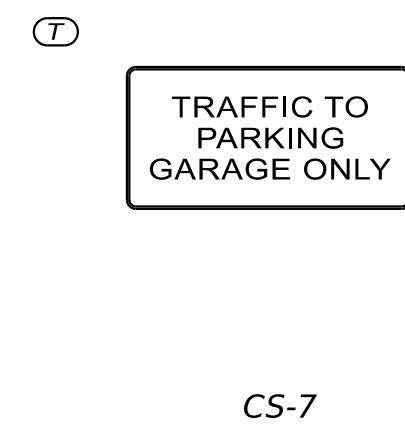
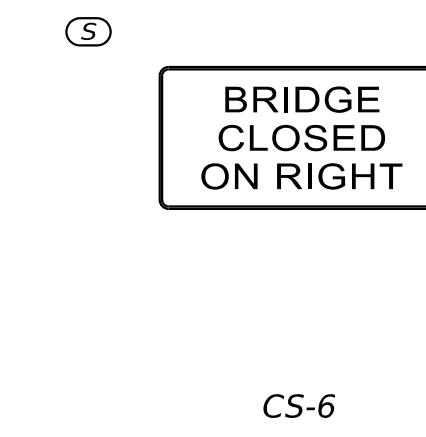
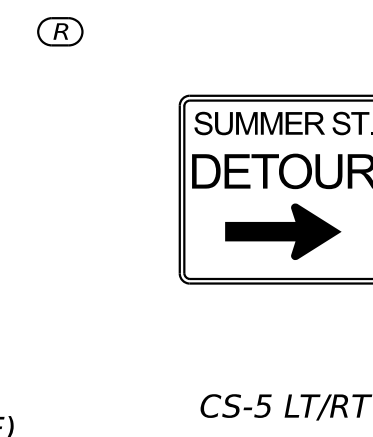
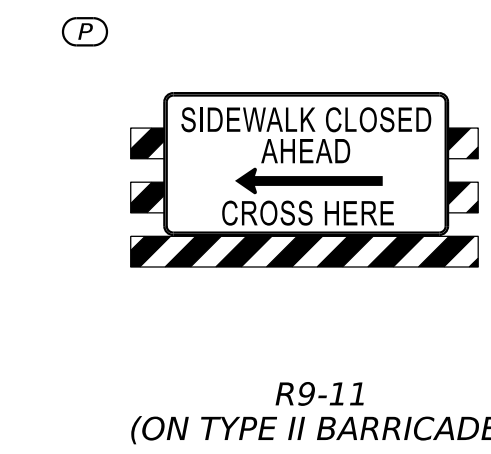
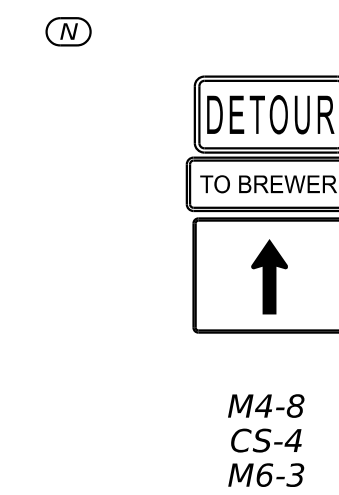
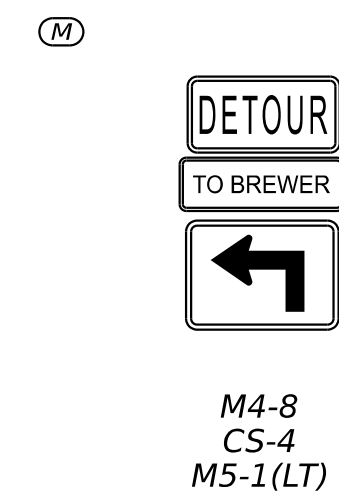
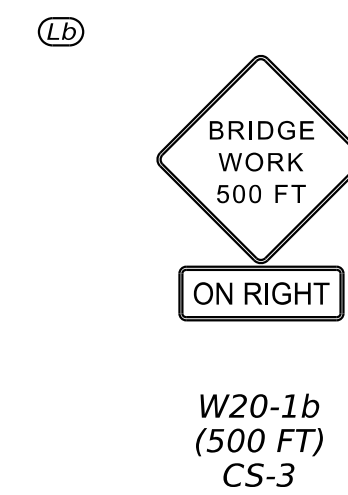
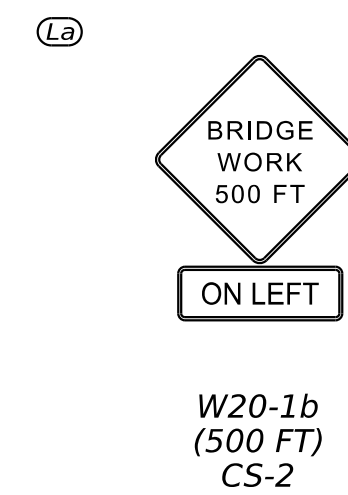
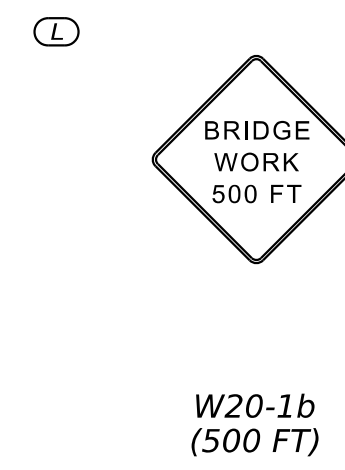
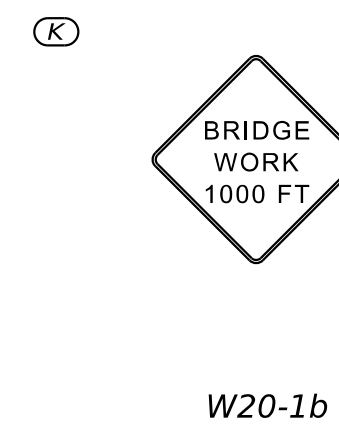
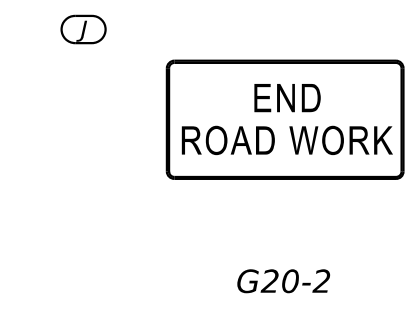
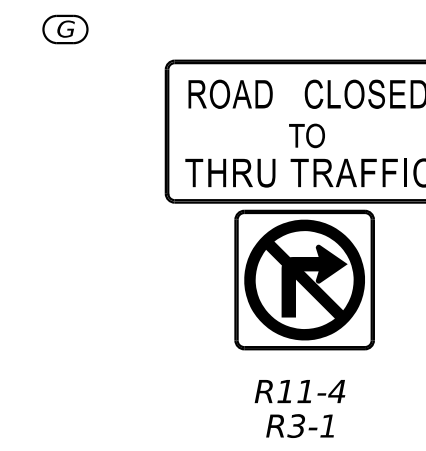
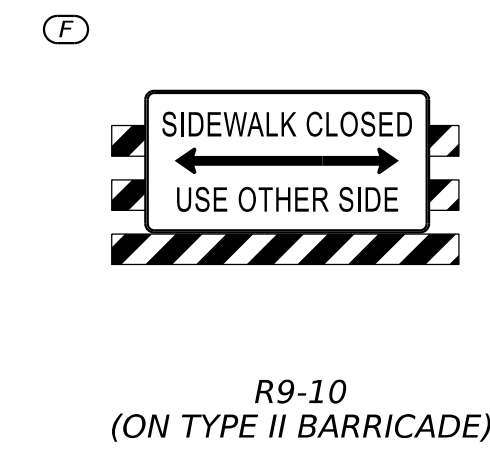
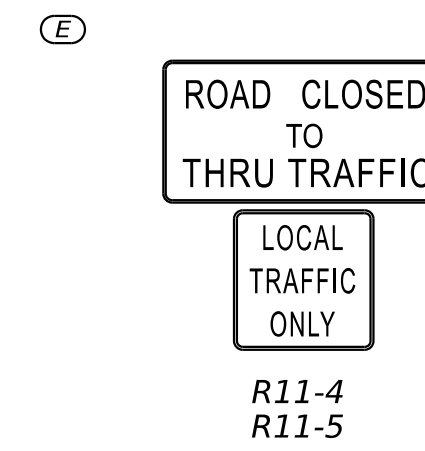
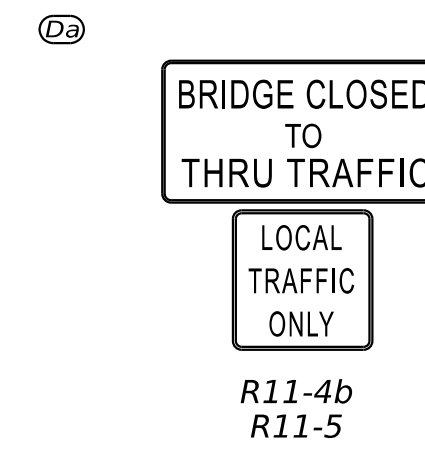
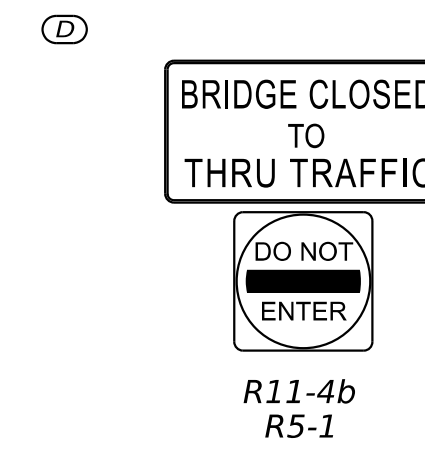
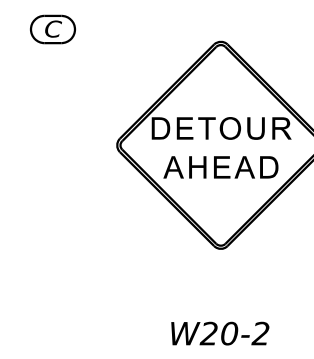
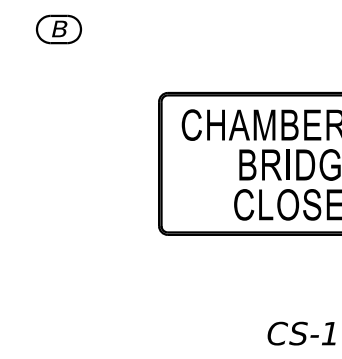
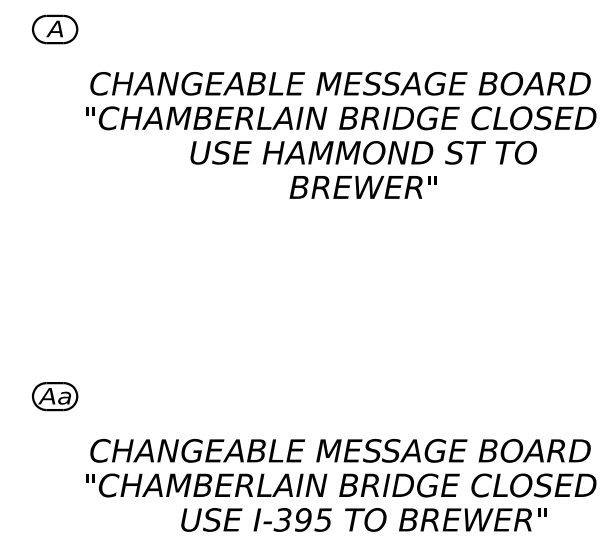
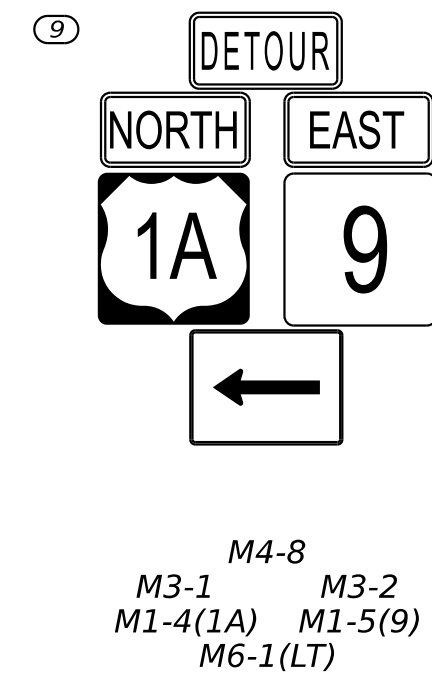
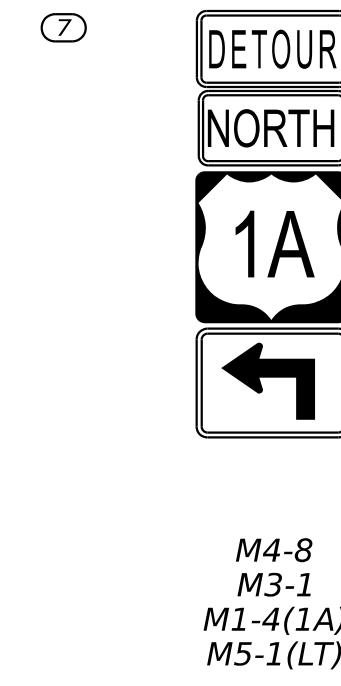
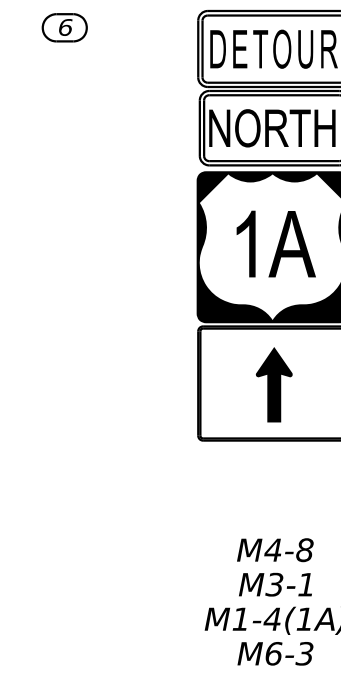
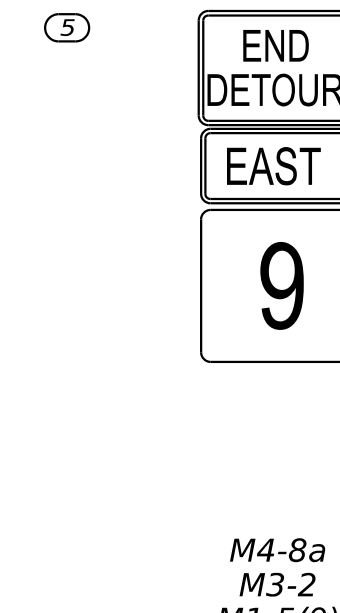
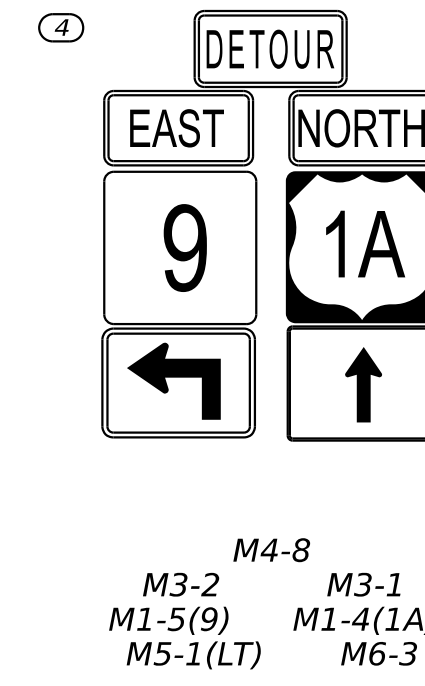
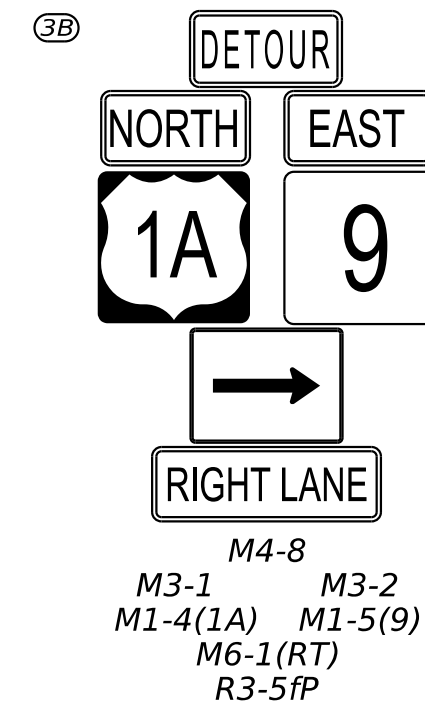
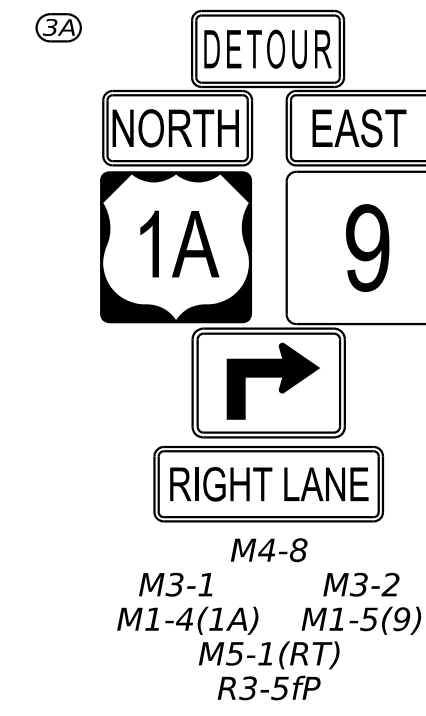
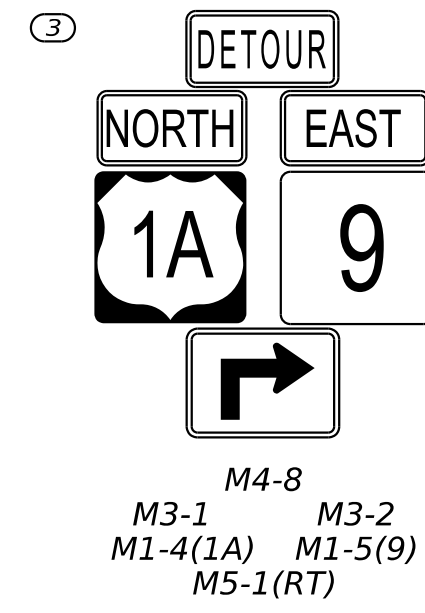
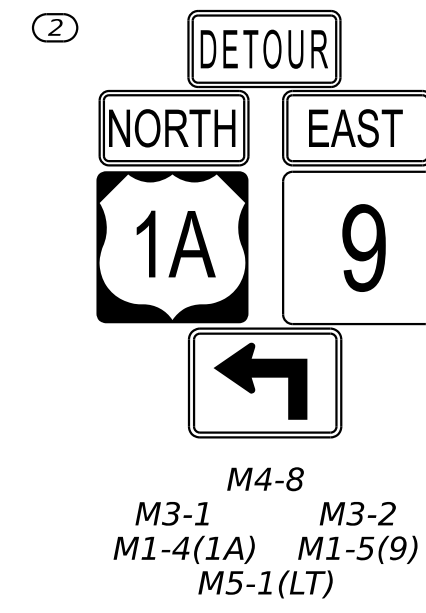
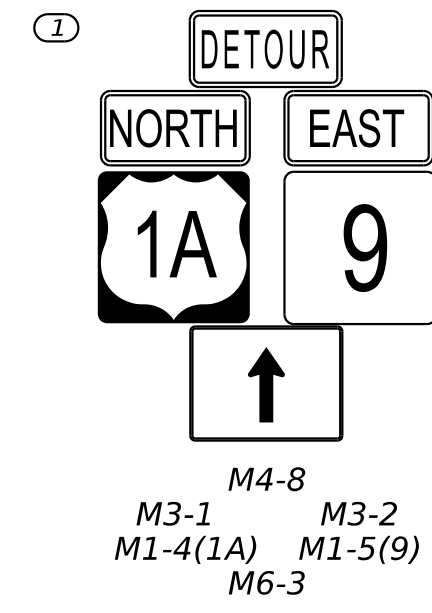

STATE OF MAINE
DEPARTMENT OF TRANSPORTATION
2531300
BRIDGE #5312
WIN
025313.00
BRIDGE PLANS



PROJ. MANAGER	MICHAEL WIGHT	BY	DATE
DESIGN-DETAILED	BLW	2/20/2026	
CHECKED-REVIEWED	JAR	2/20/2026	
DESIGN-DETAILED			
CHECKED-REVIEWED			
REVISIONS 1	BRIDGE JOINT MOD AT PILE 11	3/18/2026	
REVISIONS 2			
REVISIONS 3			
REVISIONS 4			
FIELD CHANGES			

JOSHUA CHAMBERLAIN BRIDGE
OVER PENOBSCOT RIVER
BANGOR
PENOBSCOT COUNTY
DETOUR PLAN PHASE 1 (2 OF 2)

SHEET NUMBER
10
OF 12

Username: MCHIPMAN Date: 3/17/2026

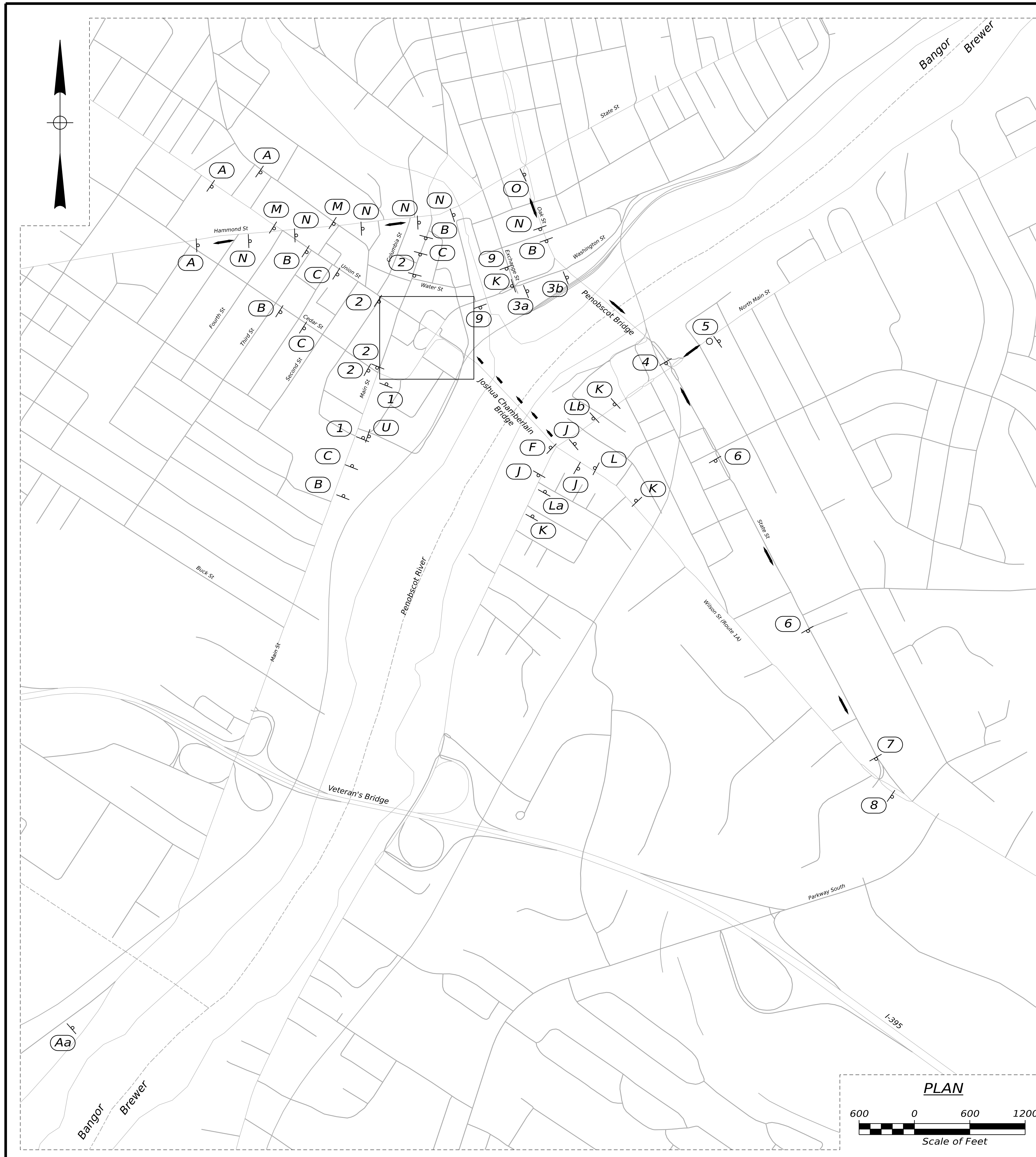

GENERAL NOTES - DETOUR PHASE 2

1. All work performed under this contract to be governed by and in conformity with Maine Department of Transportation Standard Specifications (March 2020), Standard Details Highways and Bridge (March 2020) and supplemental thereto except as modified on the plans and in the Special Provisions.
2. All temporary pavement markings shall be in accordance to MaineDOT Standard Specifications & Standard Details Section 627 & the Manual on Uniform Traffic Control Devices, 11th edition.
3. All construction signs & barriers shall be in accordance to MaineDOT Standard Specifications & Standard Details & the Manual on Uniform Traffic Control Devices, 11th edition.
4. On-street parking on south side of Water Street is to be eliminated from Main Street to the first Key Bank entrance.
5. All existing pavement markings that conflict with the temporary pavement markings shall be removed by grinding. Pavement marking removal to be paid under Item 627.77. At project completion, the original pavement markings are to be restored and the temporary pavement markings removed.
6. Exact location of signs to be field determined and approved by the Resident.

SEE DETAIL A

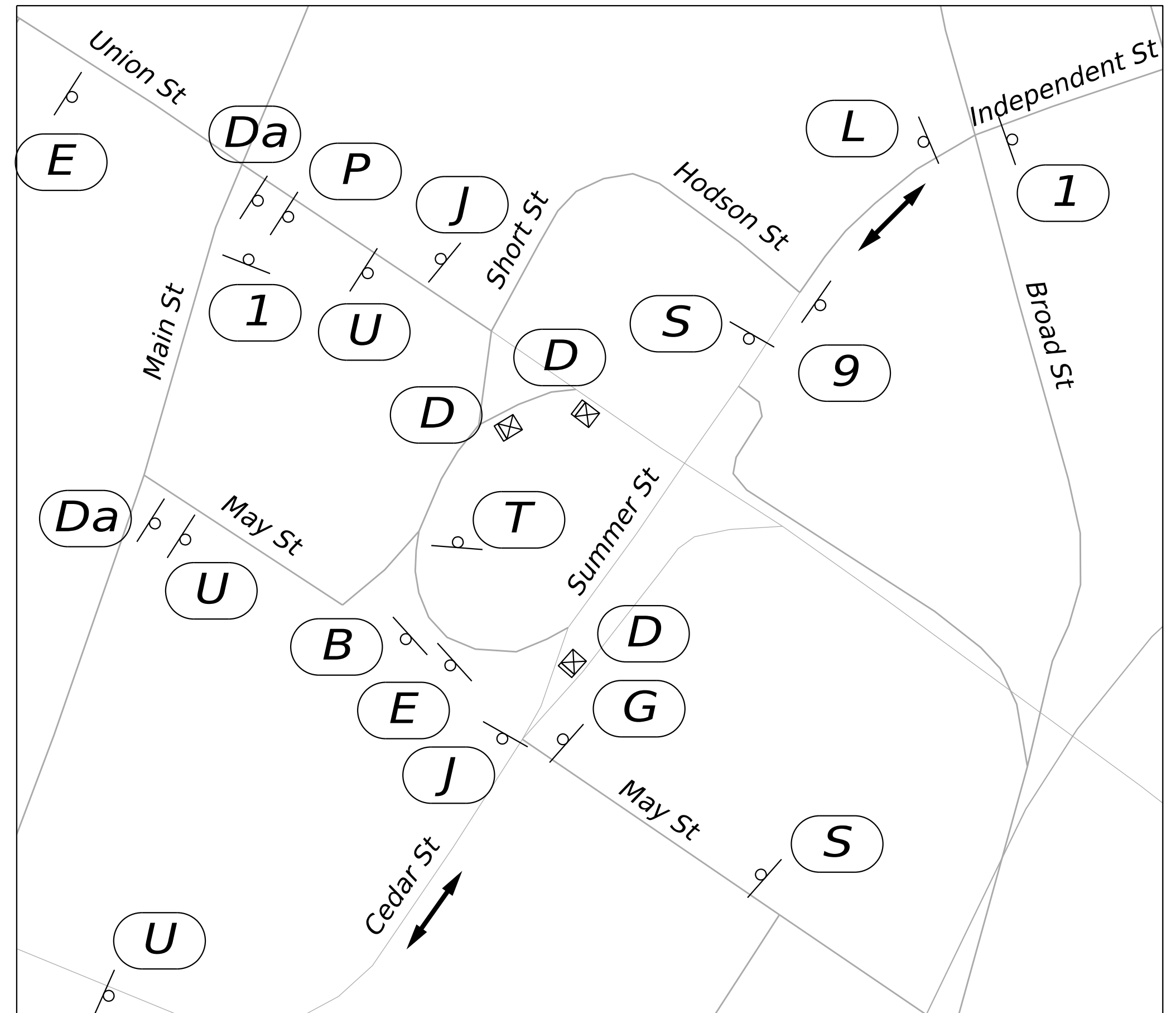

LEGEND:

- Sign Location
- Sign Description
- Traffic Direction
- Type 3 Barricade w/ sign
- Type 3 Barricade

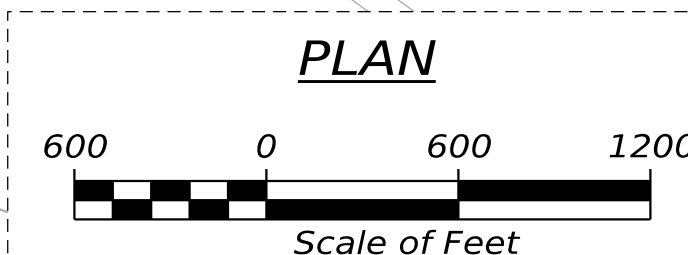

PROJ. MANAGER	BY	DATE
MICHAEL WIGHT	M/W	2/20/2026
CHECKED-REVIEWED	JAR	2/20/2026
DESIGNED-DETAILED	JAR	
DESIGNED-DETAILED	JAR	
REVISIONS 1	BRIDGE JOINT MOD AT PILE 11	3/18/2026
REVISIONS 2		
REVISIONS 3		
REVISIONS 4		
	FIELD CHANGES	

JOSHUA CHAMBERLAIN BRIDGE
OVER PENOBSCOT RIVER
PENOBSCOT COUNTY
BANGOR
DETOUR PLAN PHASE 2 (1 OF 2)

DETOUR SIGN ASSEMBLIES

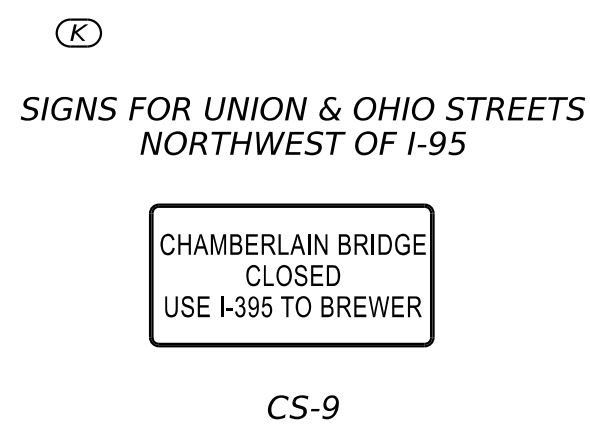
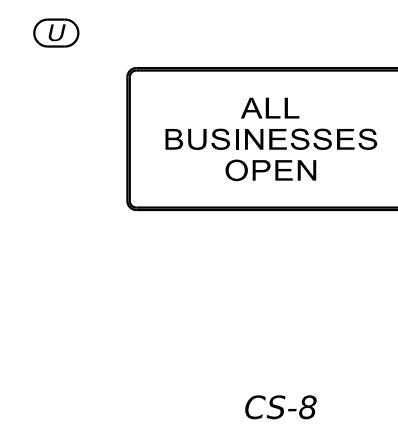
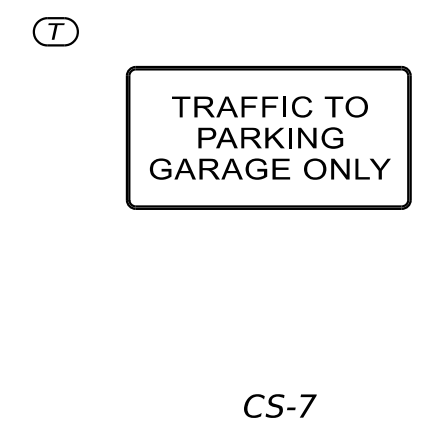
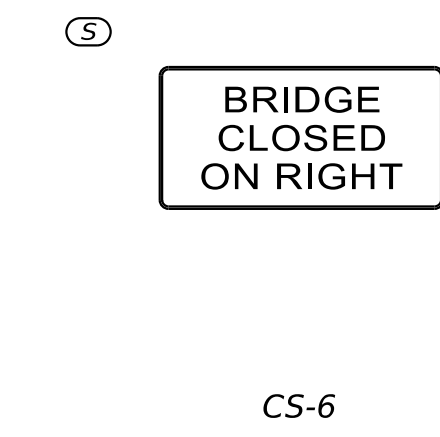
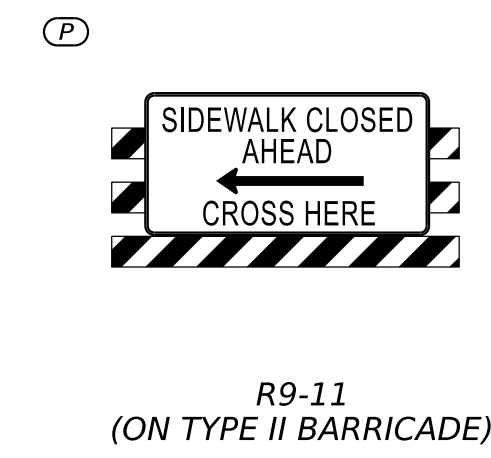
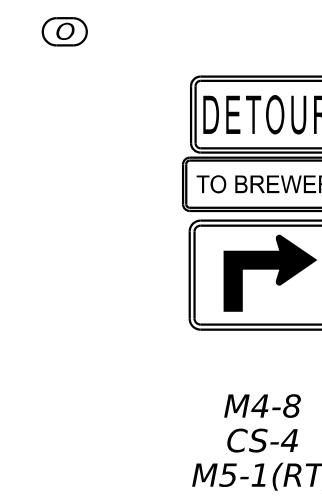
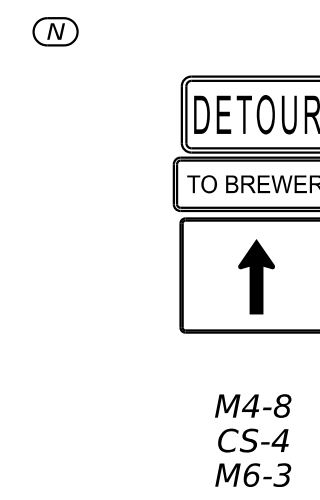
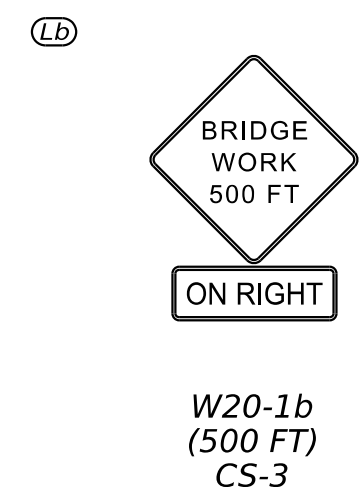
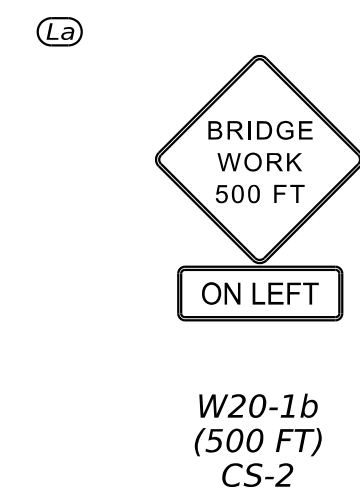
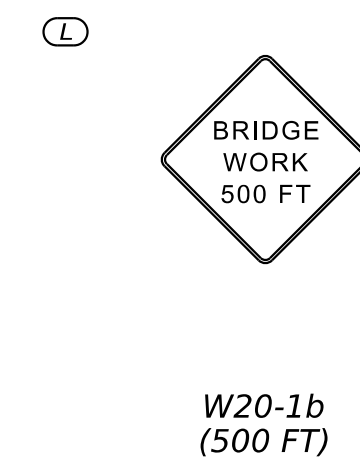
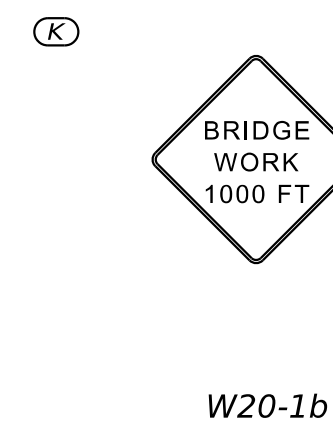
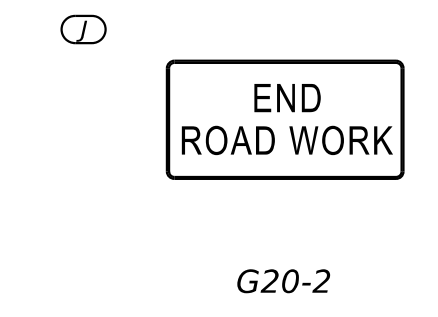
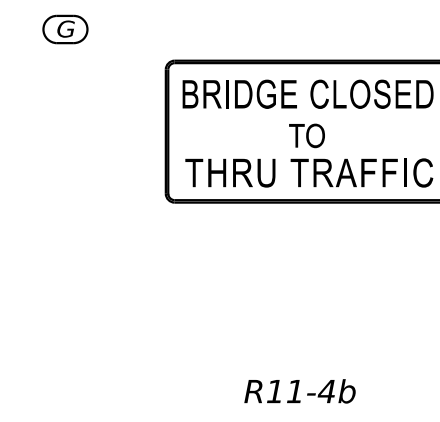
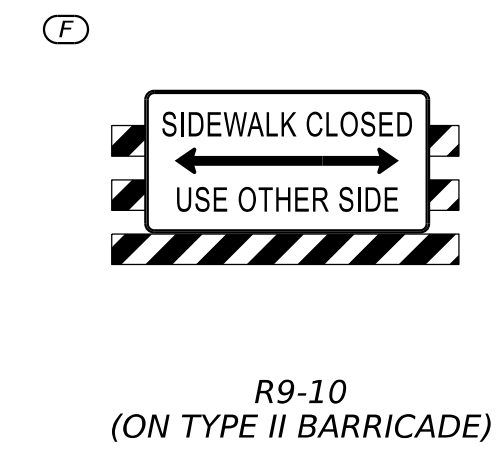
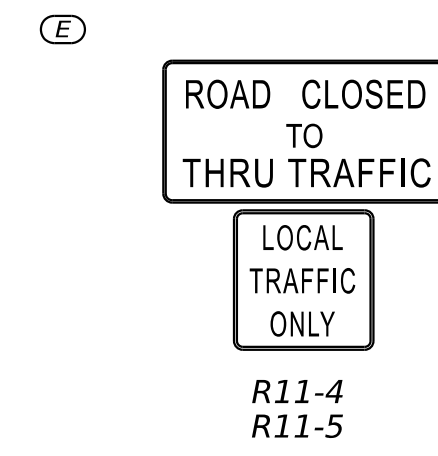
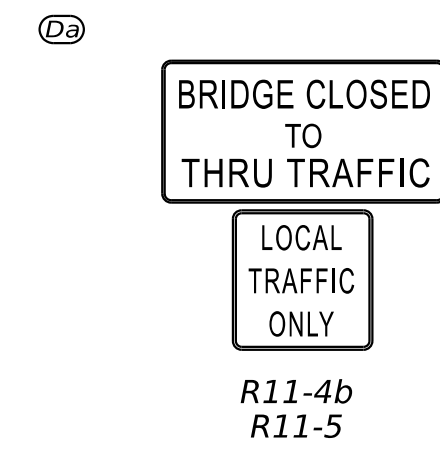
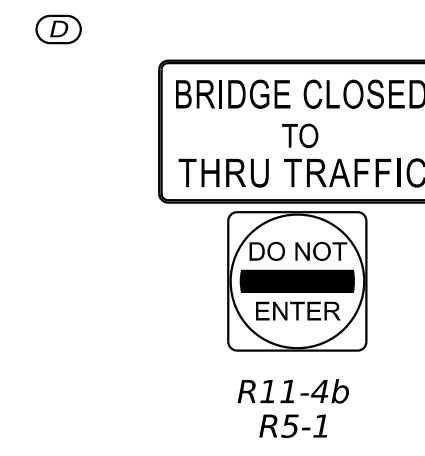
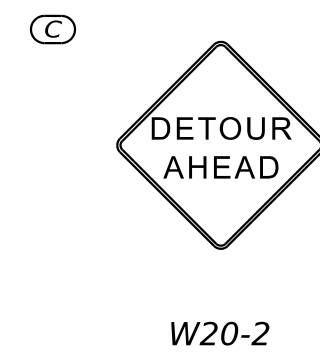
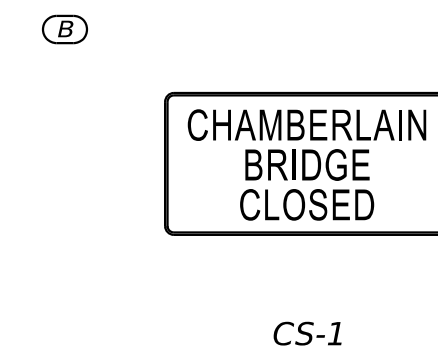
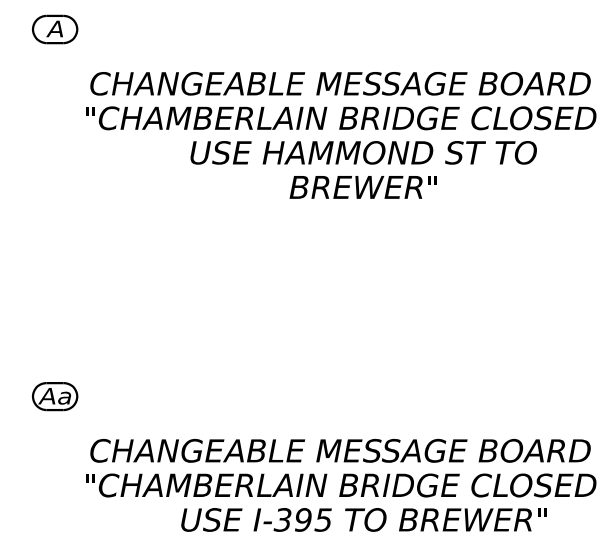
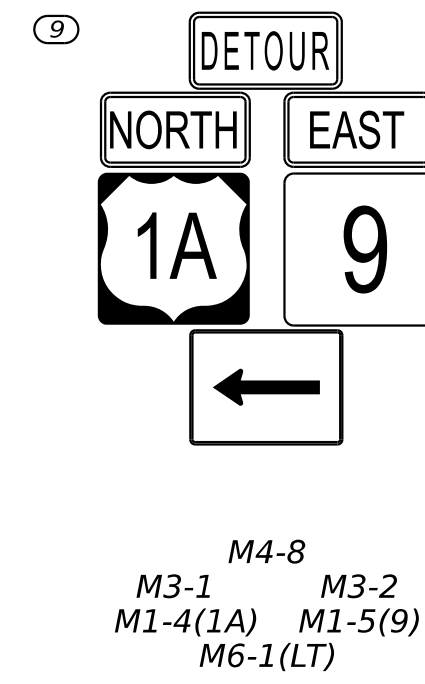
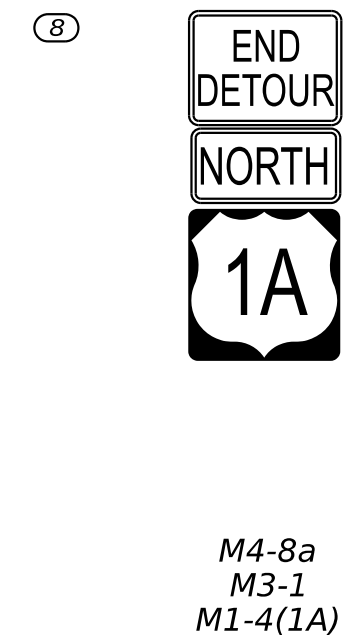
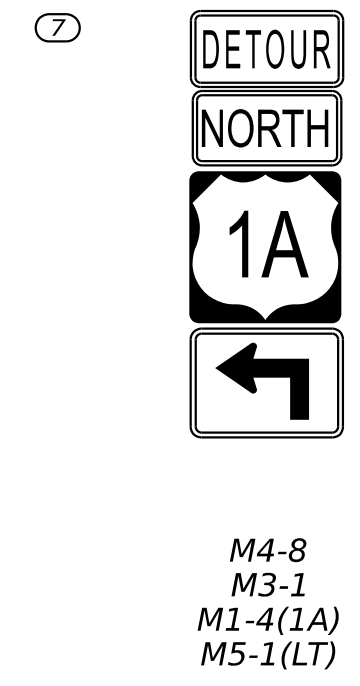
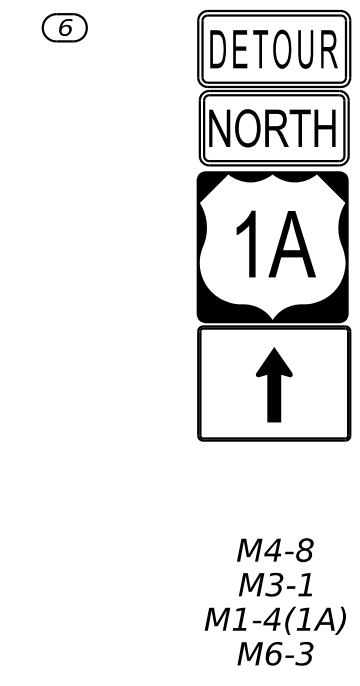
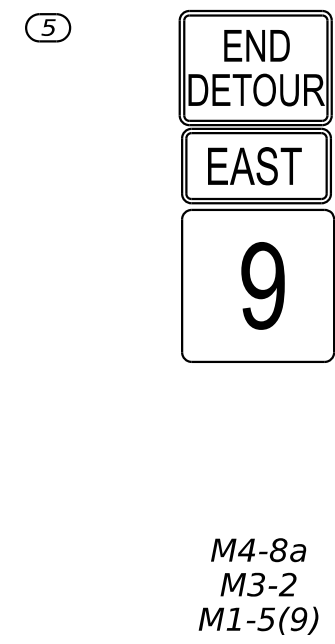
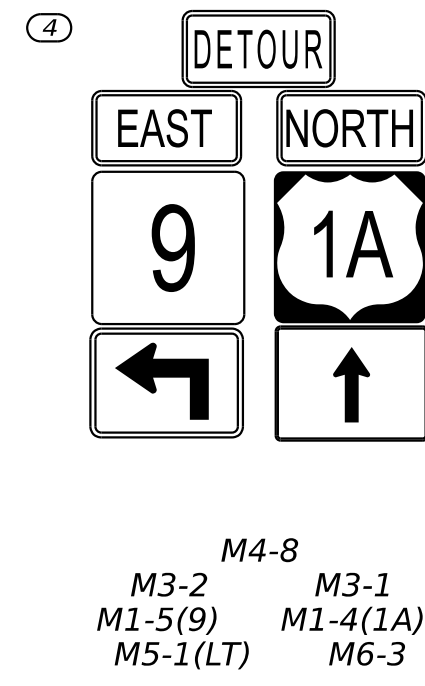
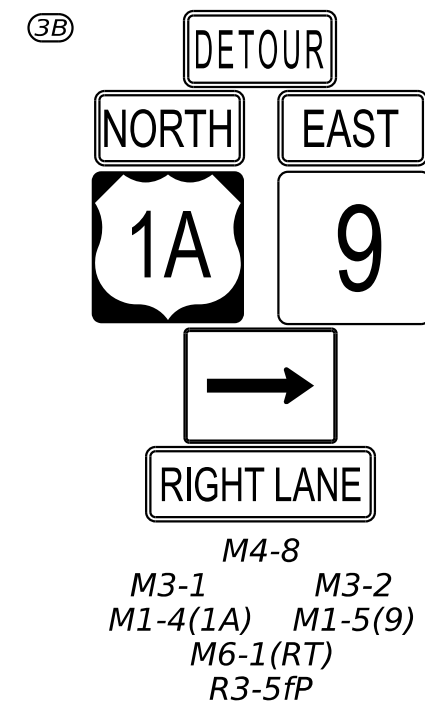
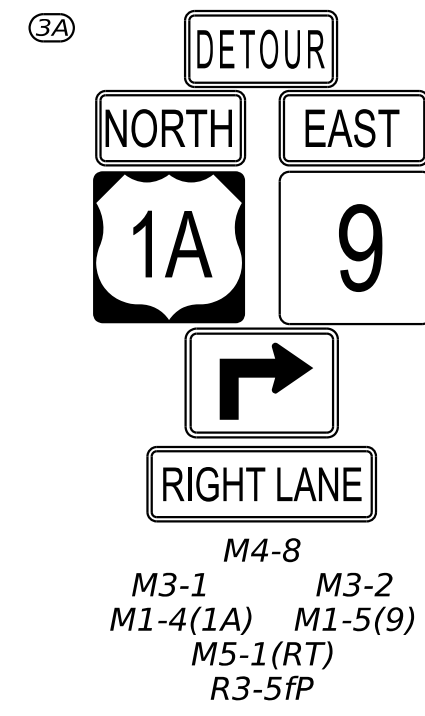
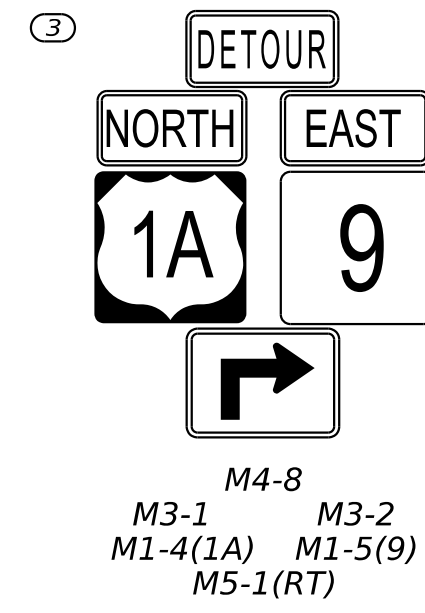
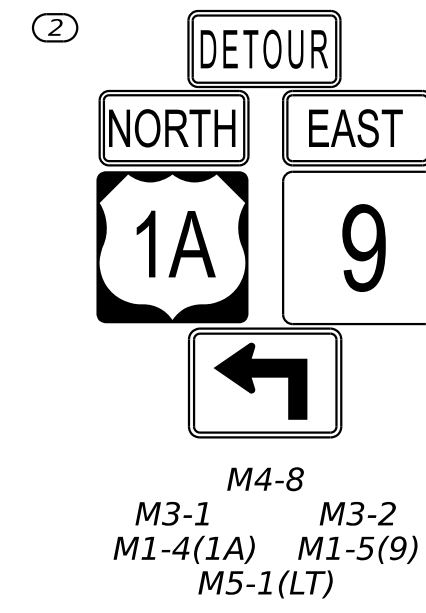
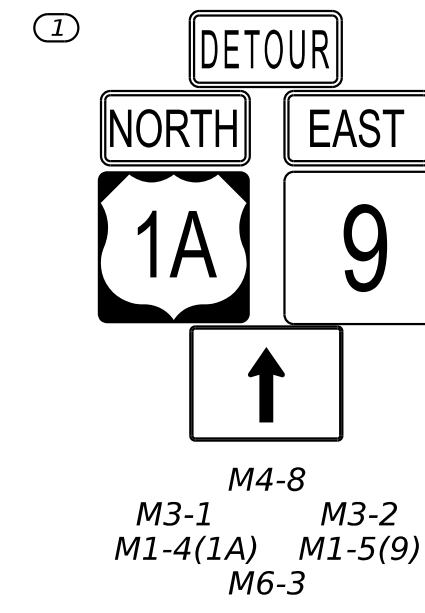

STATE OF MAINE
DEPARTMENT OF TRANSPORTATION
2531300
BRIDGE #5312
WIN
025313.00
BRIDGE PLANS

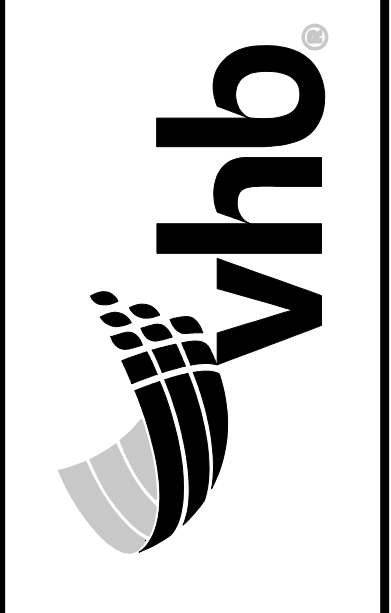

PROJ. MANAGER	MICHAEL WIGHT	DATE
DESIGN-DETAILED	BLW	2/20/2016
CHECKED-REVIEWED	JAR	2/20/2016
DESIGN-DETAILED		
DESIGN-DETAILED		
REVISIONS 1	BRIDGE JOINT MOD AT PILE 11	3/18/2016
REVISIONS 2		
REVISIONS 3		
REVISIONS 4		
FIELD CHANGES		

JOSHUA CHAMBERLAIN BRIDGE
OVER PENOBSCOT RIVER
BANGOR
PENOBSCOT COUNTY
DETOUR PLAN PHASE 2 (2 OF 2)

Username: MCHIPMAN Date: 3/17/2016