



Janet T. Mills
GOVERNOR

STATE OF MAINE
DEPARTMENT OF TRANSPORTATION
16 STATE HOUSE STATION
AUGUSTA, MAINE 04333-0016

Dale F. Doughty
ACTING COMMISSIONER

September 26, 2025
Subject: Dover Bridge
Bridge Replacement
State WIN: 023120.00
Location: **Dover Foxcroft**
Amendment No. 1

Dear Sir/Ms.:

Please make the following changes to the Bid Documents:

In the Bid Book:

On page 14, NOTICE TO CONTRACTORS, **CHANGE** the bid opening date from “October 8, 2025” to read “**October 22, 2025**”. Make this change in pen and ink. The following questions have been received:

Question: SP104 Utilities references subsurface utilities buried within the approaches. We cannot find where the locations are on the plans. Could a location be provided? There is also a pipe we saw on site located on the stream bed in the location of the temporary work trestle. Is this pipe active? If so, is it the Department’s intent for the contractor to construct a work trestle around the pipe?

Response: Regarding Utilities in approaches:

Full depth excavation in areas of approaches is expected to start at approximately station 102+05 and end at approximately station 107+00. Within this area there are some at-grade water and sewer facilities that will remain in place during construction, which are not to be damaged. See the attached file (Utilities in approach_Dover 23120 RFI .PDF) where plans show at-grade facilities, some of which have been highlighted.

Regarding Utility on Riverbed:

There is an active water main crossing the river, on the riverbed, on the upstream side of the bridge structure, which is shown on the Plans. This main shall remain in place during construction. The contractor shall design, construct, maintain and remove any temporary structures without impacting the water main.

Question: SP 105 Special Condition 28 requires existing abutment demolition to be performed within a dewatered cofferdam or outside of the water (when using a hoeram). Does this requirement pertain to the existing piers as well? If so, the allotted 800 sf of resource impact in the permit is not adequate.

Response:

SPECIAL PROVISION SECTION 105 General Scope of Work (Environmental Requirements) dated August 29, 2025 IV. Special Conditions 28 is specific to abutment demolition. Pier demolition is not required to be inside of a cofferdam, but pier demolition needs to be contained within a boom supported floating silt fence. Further review of proposed BMPs/ methods will be discussed during the review of the Soil Erosion and Water Pollution Control Plan (SEWPCP) described in Section 656.

Question: Please provide limits of bridge removal.

Response: Please see General Construction Note #28 on page 3 of the Plans.

Question: Due to the complexity of the cofferdams in the impoundment and the need for temporary structures design, please extend the bid date 3 weeks to 10/29/25?

Response: The bid opening date will be changed to October 22, 2025.

Consider these changes and information prior to submitting your bid on **October 22, 2025**

Sincerely,



George M. A. Macdougall P.E.
Contracts & Specifications Engineer

Date:8/11/2025

Username: common

Division: BRIDGE

Filename: ... \MSTAO08b_UTPlan_Perm_01.dgn

\$FILEL\$

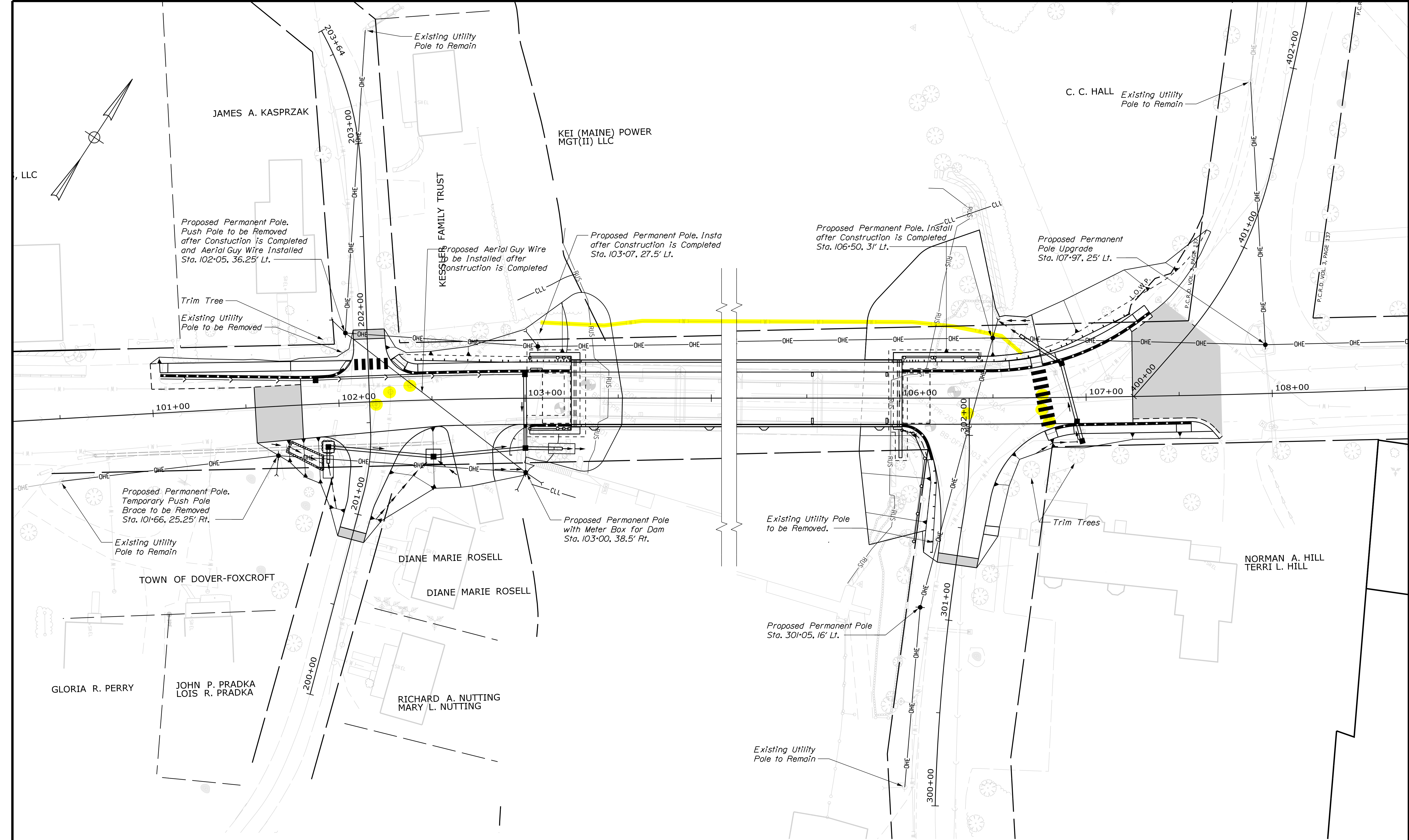

PERMANENT UTILITY RELOCATION PLAN

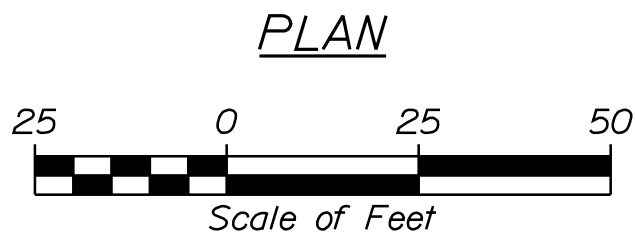

DRAFT PLAN
LOCATIONS SUBJECT
TO CHANGE

Thornton
Tomasetti

STATE OF MAINE		DEPARTMENT OF TRANSPORTATION	
2312000		WIN 023120.00	
5118		BRIDGE PLANS	
PROJ. MANAGER	JSTETSON	BY	DATE
DESIGN-DETAILED	T. LANDRY	T. WARREN	3-14-2023
CHECKED-REVIEWED	T. LANDRY	B. HAYU	3-14-2023
DESIGN-DETAILED			
DESIGN-DETAILED			
REVISIONS 1			
REVISIONS 2			
REVISIONS 3			
REVISIONS 4			
FIELD CHANGES			
DOVER BRIDGE		SIGNATURE	
PISCATAQUIS RIVER		P.E. NUMBER	
DOVER-FOXCROFT PISCATAQUIS COUNTY		DATE	
PERMANENT UTILITY RELOCATION PLAN			
SHEET NUMBER			
7			
OF 64			