



STATE OF MAINE
DEPARTMENT OF TRANSPORTATION
16 STATE HOUSE STATION
AUGUSTA, MAINE 04333-0016

Janet T. Mills
GOVERNOR

Bruce A. Van Note
COMMISSIONER

July 15, 2025
Subject: Bridge Replacement
WIN: 022382.00
Location: **Cumberland-Yarmouth**
Amendment No. 7

Dear Sir/Ms.:

In the Plan Set:

REMOVE Sheet Number 2 of 121, ESTIMATED QUANTITIES dated 7/11/2025 and
REPLACE with the attached Sheet Number 2 of 121, ESTIMATED QUANTITIES dated
7/14/2025.

REMOVE Sheet Number 24 of 121, SIGNING & STRIPING PLAN (4 OF 4) dated 5/2/2025
and **REPLACE** with the attached Sheet Number 24 of 121, SIGNING & STRIPING PLAN (4
OF 4) dated 7/14/2025.

In the contract bid book:

REMOVE pages 16 to 37 titled Proposal Schedule of Items dated 7/14/2025 (12 pages) and
REPLACE with the attached Proposal Schedule of Items dated 7/14/2025 (12 pages)

The following questions have been received:

Question: Please confirm that the relocated 40' light poles will be installed on new 24" x 7' foundations. Maine DOT standards state that the 24" foundations are designed for poles up to 30' tall.

Response: Foundations for 40' poles shall be designed by a licensed engineer per 626.036. Quantities assume 24" x 7' based on existing plans and foundations. Payment for additional length required will be paid for under unit item 626.421

Question: The schedule of items includes a quantity of three Controller Cabinet Foundations under item #626.35. The plans state that the RRFB foundations will be controller cabinet

foundations paid for under this item. Should the RRFBs be installed on 24" x 4' foundations per the standard detail?

Response: Yes, foundations for RRFB's to be installed per standard detail for Controller Cabinet Foundation.

Question: The plans show the lights on the south side of the bridge will be connected to an existing lighting cabinet, please confirm there are spare circuits in this cabinet for the new lighting circuit. The plans show the lights on the north side of the bridge will be connected to existing conduit, where is the lighting cabinet for this side of the bridge located?

Response: Existing lighting cabinet from 2012 As-Built plans indicate cabinet at Station 471+00 RT (300' north of Park and Ride intersection). The availability of spare circuits is unknown.

Question: The notes and spec for the Pedestrian Hybrid Beacon mention a separate power source that is not shown on the plans. The plans show the Pedestrian Hybrid Beacon system connected to the lighting control cabinet. Will the Hybrid Beacon be on a spare power circuit from the existing lighting control cabinet as shown on the plans or a separate metered power source?

Response: The Pedestrian Hybrid Beacon shall have a separate metered power source.

Question: Will the RRFBs be powered from the lighting circuit as shown on the plans or a separate metered power source? If from the lighting circuit, confirm there are spare circuits in the existing lighting cabinet?

Response: RRFB to be powered from the lighting circuit. The availability of spare circuits in cabinet is unknown.

Question: If these items require a new metered power source, will a new item for metallic conduit be added to the contract?

Response: No metered power source required.

Question: Under item 643.65 Pedestrian Hybrid Beacon, the specifications call for an ATC Ground Mounted M Cabinet. Please provide additional details on the design requirements of this cabinet.

Response: The Cabinet shall meet the requirements of a McCain M ATC Cabinet or equal.

Question: At approximate station #119+00 the plans show a proposed pole & overhead span wire, provide details on what will be attached to the span wire. Will one wood pole for this span be paid for under item 643.97? Will the other end be attached to an existing utility pole?

Response: Two wood poles to be included in item 643.97, 44' LT and 51' RT. MUTCD Sign R10-15L, 36"x36" to be installed over left turn lane. Please see updated sheets 2 and 24.

Question: Will under pavement conduit need to be directionally drilled? If so, will an item for this underpavement conduit be added to the contract?

Response: No directional drilling required.

Question: Lighting general notes #1, #23 and #25 mention junction box installation, the plans show only one junction box at light pole H2. Considering there is 2,280' of conduit to be installed, can more junction boxes be added along with a bid item? For instance, at light pole R2 there is a junction of conduit from four directions. If the under pavement conduit will be directionally drilled, junction boxes will be required on either end.

Response: Junction boxes are not required for the lighting system. If junction boxes are a part of the equipment and materials to be provided under Standard Specification Section 634.022, junction boxes would be incidental to item 634.160 (lighting general note 28).

Question: Item 634.2223 Remove and Reset Light Standard with Luminaire has a quantity of 9. The light pole charts on the lighting plans show a quantity of 12 poles to be relocated. Which is correct?

Response: 9 is the correct quantity. Light pole charts include information for poles on that sheet and there are a few poles that appear on multiple sheets (R-3, R-4, and R-5).

Question: Item 626.421 24" foundations has a quantity of 115LF. If the foundations are 7' tall per the standard detail, this equates to roughly 16 foundations. The light pole charts on the plans show 20 poles that will require new foundations. Which is correct?

Response: 115LF is the correct quantity. Light pole charts include information for poles on that sheet and there are a few poles that appear on multiple sheets (R-3, R-4, R-5, and MU-3).

Question: Item 634.210 Conventional Light Standards show a quantity of 7, but the light pole charts have a quantity of 8. Which is correct?

Response: 7 is the correct quantity. Light pole charts include information for poles on that sheet and there is a pole that appears on multiple sheets (MU-3).

Question: Please confirm that the relocated 40' light poles will be installed on new 24" x 7' foundations. Maine DOT standards state that the 24" foundations are designed for poles up to 30' tall.

Response: See response above.

Consider these changes and information prior to submitting your bid on **July 16, 2025.**

Sincerely,

A handwritten signature in blue ink, reading "George Macdougall". The signature is fluid and cursive, with the first name "George" and last name "Macdougall" clearly legible.

George M. A. Macdougall P.E.
Contracts & Specifications Engineer

7/14/2025

Maine Department of Transportation

Proposal Schedule of Items

Page 1 of 12

Proposal ID: 022382.00

Project(s): 022382.00

SECTION: 1 INITIAL GROUP

Alt Set ID: Alt Mbr ID:

Contractor: _____

Proposal Line Number	Item ID Description	Approximate Quantity and Units	Unit Price		Bid Amount	
			Dollars	Cents	Dollars	Cents
0010	201.11 CLEARING	2.100 AC	_____	 _____	_____	 _____
0020	202.15 REMOVING EXISTING MANHOLE OR CATCH BASIN	2.000 EA	_____	 _____	_____	 _____
0030	202.19 REMOVING EXISTING BRIDGE	LUMP SUM	LUMP SUM		_____	 _____
0040	202.202 REMOVING PAVEMENT SURFACE	1,150.000 SY	_____	 _____	_____	 _____
0050	202.205 RUMBLE STRIPS - SHOULDER	1,500.000 LF	_____	 _____	_____	 _____
0060	202.207 RUMBLE STRIPS, FILL	1,500.000 LF	_____	 _____	_____	 _____
0070	203.20 COMMON EXCAVATION	11,300.000 CY	_____	 _____	_____	 _____
0080	203.24 COMMON BORROW	41,500.000 CY	_____	 _____	_____	 _____
0090	203.25 GRANULAR BORROW	380.000 CY	_____	 _____	_____	 _____
0100	203.4338 LIGHTWEIGHT FILL FOAMED GLASS AGGREGATE	1,300.000 CY	_____	 _____	_____	 _____
0110	206.082 STRUCTURAL EARTH EXCAVATION - MAJOR STRUCTURES	196.000 CY	_____	 _____	_____	 _____
0120	304.10 AGGREGATE SUBBASE COURSE - GRAVEL	11,000.000 CY	_____	 _____	_____	 _____

7/14/2025

Maine Department of Transportation

Proposal Schedule of Items

Page 2 of 12

Proposal ID: 022382.00

Project(s): 022382.00

SECTION: 1 INITIAL GROUP

Alt Set ID: Alt Mbr ID:

Contractor: _____

Proposal Line Number	Item ID Description	Approximate Quantity and Units	Unit Price		Bid Amount	
			Dollars	Cents	Dollars	Cents
0130	403.2081 12.5 MM POLYMER MODIFIED HOT MIX ASPHALT	1,430.000 T	_____	 _____	_____	 _____
0140	403.209 HOT MIX ASPHALT 9.5 MM (SIDEWALKS, DRIVES, INCIDENTALS)	330.000 T	_____	 _____	_____	 _____
0150	403.2131 12.5 MM POLYMER MODIFIED HMA BASE	4,850.000 T	_____	 _____	_____	 _____
0160	409.15 BITUMINOUS TACK COAT - APPLIED	885.000 G	_____	 _____	_____	 _____
0170	461.131 TEMPORARY PAVEMENT	600.000 T	_____	 _____	_____	 _____
0180	501.239 DYNAMIC LOADING TESTS - PROVIDING FOR	3.000 EA	_____	 _____	_____	 _____
0190	501.50 STEEL H-BEAM PILES 89 LBS/FT, DELIVERED	1,750.000 LF	_____	 _____	_____	 _____
0200	501.501 STEEL H-BEAM PILES 89 LBS/FT, IN PLACE	1,600.000 LF	_____	 _____	_____	 _____
0210	501.90 PILE TIPS	35.000 EA	_____	 _____	_____	 _____
0220	501.91 PILE SPLICES	14.000 EA	_____	 _____	_____	 _____
0230	501.92 PILE DRIVING EQUIPMENT MOBILIZATION	LUMP SUM	LUMP SUM		_____	 _____

7/14/2025

Maine Department of Transportation

Proposal Schedule of Items

Page 3 of 12

Proposal ID: 022382.00

Project(s): 022382.00

SECTION: 1 INITIAL GROUP

Alt Set ID: Alt Mbr ID:

Contractor: _____

Proposal Line Number	Item ID Description	Approximate Quantity and Units	Unit Price		Bid Amount	
			Dollars	Cents	Dollars	Cents
0240	502.219 STRUCTURAL CONCRETE, ABUTMENTS AND RETAINING WALLS	LUMP SUM	LUMP	SUM	_____	_____
0250	502.239 STRUCTURAL CONCRETE PIERS	LUMP SUM	LUMP	SUM	_____	_____
0260	502.26 STRUCTURAL CONCRETE ROADWAY AND SIDEWALK SLABS ON STEEL BRIDGES	LUMP SUM	LUMP	SUM	_____	_____
0270	502.31 STRUCTURAL CONCRETE APPROACH SLABS	LUMP SUM	LUMP	SUM	_____	_____
0280	503.12 REINFORCING STEEL, FABRICATED AND DELIVERED	5,400.000 LB	_____	_____	_____	_____
0290	503.13 REINFORCING STEEL, PLACING	5,400.000 LB	_____	_____	_____	_____
0295	503.17 MECHANICAL WELDED SPLICE	626.000 EA	_____	_____	_____	_____
0300	503.19 LOW-CARBON, CHROMIUM REINFORCEMENT - FABRICATED & DELIVERED	189,600.000 LB	_____	_____	_____	_____
0310	503.20 LOW-CARBON, CHROMIUM REINFORCEMENT - PLACING	189,600.000 LB	_____	_____	_____	_____
0320	504.702 STRUCTURAL STEEL FABRICATED AND DELIVERED, WELDED	LUMP SUM	LUMP	SUM	_____	_____
0330	504.71 STRUCTURAL STEEL ERECTION	LUMP SUM	LUMP	SUM	_____	_____

7/14/2025

Maine Department of Transportation

Proposal Schedule of Items

Page 4 of 12

Proposal ID: 022382.00

Project(s): 022382.00

SECTION: 1 INITIAL GROUP

Alt Set ID: Alt Mbr ID:

Contractor: _____

Proposal Line Number	Item ID Description	Approximate Quantity and Units	Unit Price		Bid Amount	
			Dollars	Cents	Dollars	Cents
0340	505.08 SHEAR CONNECTORS	LUMP SUM	LUMP	SUM	_____	_____
0350	506.9104 THERMAL SPRAY COATING - SHOP APPLIED	LUMP SUM	LUMP	SUM	_____	_____
0360	507.0833 BARRIER MOUNTED BRIDGE RAIL, BICYCLE	LUMP SUM	LUMP	SUM	_____	_____
0370	507.0848 BARRIER-MOUNTED STEEL BRIDGE RAILING, 2 BAR	LUMP SUM	LUMP	SUM	_____	_____
0380	508.14 HIGH PERFORMANCE WATERPROOFING MEMBRANE	LUMP SUM	LUMP	SUM	_____	_____
0390	515.21 PROTECTIVE COATING FOR CONCRETE SURFACES	LUMP SUM	LUMP	SUM	_____	_____
0400	519.60 EXPANSION DEVICE - ASPHALTIC PLUG JOINT	110.000 LF	_____	_____	_____	_____
0410	523.52 BEARING INSTALLATION	7.000 EA	_____	_____	_____	_____
0420	523.5401 LAMINATED ELASTOMERIC BEARINGS, FIXED	7.000 EA	_____	_____	_____	_____
0430	524.301 TEMPORARY STRUCTURAL SUPPORT PIER	LUMP SUM	LUMP	SUM	_____	_____
0435	524.301 TEMPORARY STRUCTURAL SUPPORT EXISTING ABUTMENT	LUMP SUM	LUMP	SUM	_____	_____

7/14/2025

Maine Department of Transportation

Proposal Schedule of Items

Page 5 of 12

Proposal ID: 022382.00

Project(s): 022382.00

SECTION: 1 INITIAL GROUP

Alt Set ID: Alt Mbr ID:

Contractor: _____

Proposal Line Number	Item ID Description	Approximate Quantity and Units	Unit Price		Bid Amount	
			Dollars	Cents	Dollars	Cents
0440	524.40 PROTECTIVE SHIELD	LUMP SUM		LUMP SUM		
0450	526.301 PORTABLE CONCRETE BARRIER TYPE I	LUMP SUM		LUMP SUM		
0460	526.341 PERMANENT CONCRETE BARRIER	LUMP SUM		LUMP SUM		
0470	527.33 TRUCK MOUNTED ATTENUATOR	2.000 EA				
0480	527.34 WORK ZONE CRASH CUSHIONS	4.000 UN				
0490	603.169 15 INCH CULVERT PIPE OPTION III	160.000 LF				
0500	603.175 18 INCH REINFORCED CONCRETE PIPE CLASS III	192.000 LF				
0510	603.179 18 INCH CULVERT PIPE OPTION III	286.000 LF				
0520	604.092 CATCH BASIN TYPE B1-C	3.000 EA				
0530	604.16 ALTERING CATCH BASIN TO MANHOLES	1.000 EA				
0540	604.262 CATCH BASIN TYPE B5-C	14.000 EA				
0550	605.11 12 INCH UNDERDRAIN TYPE C	614.000 LF				

7/14/2025

Maine Department of Transportation

Proposal Schedule of Items

Page 6 of 12

Proposal ID: 022382.00

Project(s): 022382.00

SECTION: 1 INITIAL GROUP

Alt Set ID: Alt Mbr ID:

Contractor: _____

Proposal Line Number	Item ID Description	Approximate Quantity and Units	Unit Price		Bid Amount	
			Dollars	Cents	Dollars	Cents
0560	605.13 18 INCH UNDERDRAIN TYPE C	306.000 LF	_____	_____	_____	_____
0570	606.1301 31" W-BM GR, MID-WAY SPLICE-SGL FACED	1,275.000 LF	_____	_____	_____	_____
0580	606.1305 31" W-BM GR, MID-WAY SPLICE FLARED TERMINAL	4.000 EA	_____	_____	_____	_____
0590	606.1306 31" W-BM GR, MID-WAY SPLICE TANGENT TERMINAL	2.000 EA	_____	_____	_____	_____
0600	606.1307 BRIDGE TRANSITION (ASYMMETRICAL) - TYPE 1A	4.000 EA	_____	_____	_____	_____
0610	606.23 GUARDRAIL TYPE 3C - SINGLE RAIL	25.000 LF	_____	_____	_____	_____
0620	606.232 GUARDRAIL TYPE 3C - OVER 15 FOOT RADIUS	75.000 LF	_____	_____	_____	_____
0630	606.265 TERMINAL END - SINGLE RAIL - GALVANIZED STEEL	4.000 EA	_____	_____	_____	_____
0640	606.353 REFLECTORIZED FLEXIBLE GUARDRAIL MARKER	14.000 EA	_____	_____	_____	_____
0650	607.16 CHAIN LINK FENCE - 4 FOOT	850.000 LF	_____	_____	_____	_____
0660	607.1811 CHAIN LINK FENCE - 3 FOOT	180.000 LF	_____	_____	_____	_____
0670	607.421 SCREENING FENCE	184.000 LF	_____	_____	_____	_____

7/14/2025

Maine Department of Transportation

Proposal Schedule of Items

Page 7 of 12

Proposal ID: 022382.00

Project(s): 022382.00

SECTION: 1 INITIAL GROUP

Alt Set ID: Alt Mbr ID:

Contractor: _____

Proposal Line Number	Item ID Description	Approximate Quantity and Units	Unit Price		Bid Amount	
			Dollars	Cents	Dollars	Cents
0680	608.26 CURB RAMP DETECTABLE WARNING FIELD	150.000 SF	_____	 _____	_____	 _____
0690	609.11 VERTICAL CURB TYPE 1	475.000 LF	_____	 _____	_____	 _____
0700	609.12 VERTICAL CURB TYPE 1 - CIRCULAR	105.000 LF	_____	 _____	_____	 _____
0710	609.221 TERMINAL CURB TYPE 1	16.000 LF	_____	 _____	_____	 _____
0720	609.222 TERMINAL CURB TYPE 1 - CIRCULAR	16.000 LF	_____	 _____	_____	 _____
0730	609.31 CURB TYPE 3	1,025.000 LF	_____	 _____	_____	 _____
0740	609.34 CURB TYPE 5	2,775.000 LF	_____	 _____	_____	 _____
0750	609.35 CURB TYPE 5 - CIRCULAR	95.000 LF	_____	 _____	_____	 _____
0760	610.08 PLAIN RIPRAP	35.000 CY	_____	 _____	_____	 _____
0770	610.18 STONE DITCH PROTECTION	20.000 CY	_____	 _____	_____	 _____
0780	613.319 EROSION CONTROL BLANKET	4,750.000 SY	_____	 _____	_____	 _____
0790	615.07 LOAM	1,480.000 CY	_____	 _____	_____	 _____
0800	618.14 SEEDING METHOD NUMBER 2	120.000 UN	_____	 _____	_____	 _____

7/14/2025

Maine Department of Transportation

Proposal Schedule of Items

Page 8 of 12

Proposal ID: 022382.00

Project(s): 022382.00

SECTION: 1 INITIAL GROUP

Alt Set ID:

Alt Mbr ID:

Contractor: _____

Proposal Line Number	Item ID Description	Approximate Quantity and Units	Unit Price		Bid Amount	
			Dollars	Cents	Dollars	Cents
0810	619.12 MULCH	120.000 UN	_____	 _____	_____	 _____
0820	619.14 EROSION CONTROL MIX	2,960.000 CY	_____	 _____	_____	 _____
0830	620.58 EROSION CONTROL GEOTEXTILE	40.000 SY	_____	 _____	_____	 _____
0840	626.22 NON-METALLIC CONDUIT	2,280.000 LF	_____	 _____	_____	 _____
0850	626.35 CONTROLLER CABINET FOUNDATION	3.000 EA	_____	 _____	_____	 _____
0860	626.36 REMOVE OR MODIFY CONCRETE FOUNDATION	9.000 EA	_____	 _____	_____	 _____
0870	626.421 24 INCH DIAMETER FOUNDATION	115.000 LF	_____	 _____	_____	 _____
0880	627.18 12 " SOLID WHITE PAVEMENT MARKING	300.000 LF	_____	 _____	_____	 _____
0885	627.30 GROOVING FOR PAVEMENT MARKING	5,600.000 SF	_____	 _____	_____	 _____
0890	627.734 4" WHITE OR YELLOW POLYUREA PAVEMENT MARKING LINE (RECESSED)	9,900.000 LF	_____	 _____	_____	 _____
0900	627.745 6" WHITE OR YELLOW POLYUREA PAVEMENT MARKING LINE (RECESSED)	2,150.000 LF	_____	 _____	_____	 _____

7/14/2025

Maine Department of Transportation

Proposal Schedule of Items

Page 9 of 12

Proposal ID: 022382.00

Project(s): 022382.00

SECTION: 1 INITIAL GROUP

Alt Set ID: Alt Mbr ID:

Contractor: _____

Proposal Line Number	Item ID Description	Approximate Quantity and Units	Unit Price		Bid Amount	
			Dollars	Cents	Dollars	Cents
0910	627.75 WHITE OR YELLOW PAVEMENT & CURB MARKING	825.000 SF	_____	 _____	_____	 _____
0920	627.77 REMOVING PAVEMENT MARKINGS	500.000 SF	_____	 _____	_____	 _____
0930	627.782 TEMPORARY 4 INCH POLYUREA PAVEMENT MARKING LINE, WHITE OR YELLOW	8,000.000 LF	_____	 _____	_____	 _____
0940	627.783 TEMPORARY 6 INCH POLYUREA PAVEMENT MARKING LINE, WHITE OR YELLOW	42,000.000 LF	_____	 _____	_____	 _____
0950	629.05 HAND LABOR, STRAIGHT TIME	100.000 HR	_____	 _____	_____	 _____
0960	631.10 AIR COMPRESSOR (INCLUDING OPERATOR)	50.000 HR	_____	 _____	_____	 _____
0970	631.11 AIR TOOL (INCLUDING OPERATOR)	50.000 HR	_____	 _____	_____	 _____
0980	631.12 ALL PURPOSE EXCAVATOR (INCLUDING OPERATOR)	50.000 HR	_____	 _____	_____	 _____
0990	631.13 BULLDOZER (INCLUDING OPERATOR)	10.000 HR	_____	 _____	_____	 _____
1000	631.14 GRADER (INCLUDING OPERATOR)	50.000 HR	_____	 _____	_____	 _____
1010	631.172 TRUCK - LARGE (INCLUDING OPERATOR)	50.000 HR	_____	 _____	_____	 _____

7/14/2025

Maine Department of Transportation

Proposal Schedule of Items

Page 10 of 12

Proposal ID: 022382.00

Project(s): 022382.00

SECTION: 1 INITIAL GROUP

Alt Set ID: Alt Mbr ID:

Contractor: _____

Proposal Line Number	Item ID Description	Approximate Quantity and Units	Unit Price		Bid Amount	
			Dollars	Cents	Dollars	Cents
1020	631.21 ROAD BROOM (INCLUDING OPERATORS AND HAULER)	50.000 HR	_____	 _____	_____	 _____
1030	631.22 FRONT END LOADER (INCLUDING OPERATOR)	50.000 HR	_____	 _____	_____	 _____
1040	631.32 CULVERT CLEANER (INCLUDING OPERATOR)	10.000 HR	_____	 _____	_____	 _____
1050	634.160 HIGHWAY LIGHTING	LUMP SUM	LUMP SUM		_____	 _____
1060	634.2042 LED LUMINARIES	7.000 EA	_____	 _____	_____	 _____
1070	634.210 CONVENTIONAL LIGHT STANDARD	7.000 EA	_____	 _____	_____	 _____
1080	634.2223 REMOVE AND RESET LIGHT STANDARD WITH LUMINAIRE	9.000 EA	_____	 _____	_____	 _____
1090	639.18 FIELD OFFICE TYPE A	1.000 EA	_____	 _____	_____	 _____
1100	643.62 RECTANGULAR RAPID FLASHING BEACON	1.000 EA	_____	 _____	_____	 _____
1110	643.65 PEDESTRIAN HYBRID BEACON SIGNAL LIGHT	LUMP SUM	LUMP SUM		_____	 _____
1120	643.97 WOOD POLES WITH GUYS AND SPAN WIRE	1.000 EA	_____	 _____	_____	 _____
1130	645.103 DEMOUNT GUIDE SIGN	65.000 EA	_____	 _____	_____	 _____

7/14/2025

Maine Department of Transportation

Proposal Schedule of Items

Page 11 of 12

Proposal ID: 022382.00

Project(s): 022382.00

SECTION: 1 INITIAL GROUP

Alt Set ID: Alt Mbr ID:

Contractor: _____

Proposal Line Number	Item ID Description	Approximate Quantity and Units	Unit Price		Bid Amount	
			Dollars	Cents	Dollars	Cents
1140	645.106 DEMOUNT REGULATORY, WARNING, CONFIRMATION AND ROUTE MARKER ASSEMBLY SIGN	43.000 EA	_____	 _____	_____	 _____
1150	645.108 DEMOUNT POLE	1.000 EA	_____	 _____	_____	 _____
1160	645.113 REINSTALL GUIDE SIGN	65.000 EA	_____	 _____	_____	 _____
1170	645.116 REINSTALL REGULATORY, WARNING, CONFIRMATION AND ROUTE MARKER ASSEMBLY SIGN	43.000 EA	_____	 _____	_____	 _____
1180	645.118 REINSTALL POLE	1.000 EA	_____	 _____	_____	 _____
1190	645.271 REGULATORY, WARNING, CONFIRMATION AND ROUTE MARKER ASSEMBLY SIGNS, TYPE I	105.000 SF	_____	 _____	_____	 _____
1200	652.312 TYPE III BARRICADE	10.000 EA	_____	 _____	_____	 _____
1210	652.33 DRUM	250.000 EA	_____	 _____	_____	 _____
1220	652.34 CONE	250.000 EA	_____	 _____	_____	 _____
1230	652.35 CONSTRUCTION SIGNS	660.000 SF	_____	 _____	_____	 _____
1240	652.361 MAINTENANCE OF TRAFFIC CONTROL DEVICES	LUMP SUM	LUMP SUM		_____	 _____

7/14/2025

Maine Department of Transportation

Proposal Schedule of Items

Page 12 of 12

Proposal ID: 022382.00

Project(s): 022382.00

SECTION: 1 INITIAL GROUP

Alt Set ID:

Alt Mbr ID:

Contractor: _____

Proposal Line Number	Item ID Description	Approximate Quantity and Units	Unit Price		Bid Amount	
			Dollars	Cents	Dollars	Cents
1250	652.38 FLAGGER	3,000.000 HR	_____	_____	_____	_____
1260	652.381 TRAFFIC OFFICER	240.000 HR	_____	_____	_____	_____
1270	652.41 PORTABLE CHANGEABLE MESSAGE SIGN	4.000 EA	_____	_____	_____	_____
1280	656.75 TEMPORARY SOIL EROSION AND WATER POLLUTION CONTROL	LUMP SUM	LUMP SUM		_____	_____
1290	658.20 ACRYLIC LATEX COLOR FINISH, GREEN	1,130.000 SY	_____	_____	_____	_____
1300	659.10 MOBILIZATION	LUMP SUM	LUMP SUM		_____	_____
1310	677.20 MECHANICALLY STABILIZED EARTH RETAINING WALL	6,900.000 SF	_____	_____	_____	_____
Section: 1			Total:		_____	_____
			Total Bid:		_____	_____

ESTIMATED QUANTITIES			
ITEM NO.	DESCRIPTION	QUANTITY	UNIT
201.11	CLEARING	2.10	AC
202.15	REMOVE EXISTING MANHOLE OR CATCH BASIN	2	EA
202.19	REMOVING EXISTING BRIDGE	1	LS
202.202	REMOVING PAVEMENT SURFACE	1,150	SY
202.205	RUMBLE STRIPS - SHOULDER	1,500	LF
202.207	RUMBLE STRIPS, FILL	1,500	LF
203.20	COMMON EXCAVATION	11,300	CY
203.24	COMMON BORROW	41,500	CY
203.25	GRANULAR BORROW	380	CY
203.4338	LIGHTWEIGHT FILL FOAMED GLASS AGGREGATE	1,300	CY
206.082	STRUCTURAL EARTH EXCAVATION-MAJOR STRUCTURES	196	CY
304.10	AGGREGATE SUBBASE COURSE - GRAVEL	11,000	CY
403.2081	HOT MIX ASPHALT - 12.5 MM (POLYMER MODIFIED)	1,430	T
403.209	HOT MIX ASPHALT - 9.5 MM (SIDEWALKS, DRIVES, & INCIDENTALS)	330	T
403.2131	HOT MIX ASPHALT - 12.5 MM (BASE AND INTERMEDIATE COURSE POLYMER MOD.)	4,850	T
409.15	BITUMINOUS TACK COAT - APPLIED	885	T
461.131	TEMPORARY PAVEMENT	600	T
501.239	DYNAMIC LOADING TEST - PROVIDING FOR	3	EA
501.50	STEEL H-BEAM PILES 89 LBS/FT, DELIVERED	1,750	LF
501.501	STEEL H-BEAM PILES 89 LBS/FT, IN PLACE	1,600	LF
501.90	PILE TIPS	35	EA
501.91	PILE SPLICES	14	EA
501.92	PILE DRIVING EQUIPMENT MOBILIZATION	1	LS
502.219	STRUCTURAL CONCRETE, ABUTMENT & RETAINING WALLS (125 CY)	1	LS
502.239	STRUCTURAL CONCRETE PIERS (230 CY)	1	LS
502.26	STRUCTURAL CONCRETE ROAD & SIDEWALK SLABS ON STEEL BRIDGE (540 CY)	1	LS
502.31	STRUCTURAL CONCRETE APPROACH SLABS (40 CY)	1	LS
503.12	REINFORCING STEEL, FABRICATED AND DELIVERED	5,400	LB
503.13	REINFORCING STEEL, PLACING	5,400	LB
503.17	MECHANICAL WELDED SPLICE	626	EA
503.19	LOW-CARBON CHROMIUM REINFORCEMENT - FABRICATED AND DELIVERED	189,600	LB
503.20	LOW-CARBON CHROMIUM REINFORCEMENT - PLACING	189,600	LB
504.702	STRUCTURAL STEEL FABRICATED & DELIVERED, WELDED (791,000 LB)	1	LS
504.71	STRUCTURAL STEEL ERECTION (791,000 LB)	1	LS
505.08	SHEAR CONNECTORS (4431 EA)	1	LS
506.9104	THERMAL SPRAY COATING - SHOP APPLIED	1	LS
507.0833	BARRIER MOUNTED BRIDGE RAIL, BICYCLE (273 LF)	1	LS
507.0848	BARRIER-MOUNTED STEEL BRIDGE RAIL, 2 BAR (546 LF)	1	LS
508.14	HIGH PERFORMANCE WATERPROOFING MEMBRANE (1700 SY)	1	LS
515.21	PROTECTIVE COATING FOR CONCRETE SURFACES (1200 SY)	1	LS
519.60	EXPANSION DEVICE - ASPHALTIC PLUG JOINT	110	LF
523.52	BEARING INSTALLATION	7	EA
523.5401	LAMINATED ELASTOMERIC BEARINGS, FIXED	7	EA
524.301	TEMPORARY STRUCTURAL SUPPORT - PIER	1	LS
524.301	TEMPORARY STRUCTURAL SUPPORT - EXISTING ABUTMENT	1	LS
524.40	PROTECTIVE SHIELD	1	LS
526.301	PORTABLE CONCRETE BARRIER TYPE 1 (2800 LF)	1	LS
526.341	PERMANENT CONCRETE BARRIER, SPECIAL (820 LF)	1	LS
527.33	TRUCK MOUNTED ATTENUATOR	2	EA
527.34	WORK ZONE CRASH CUSHIONS	4	UN
603.169	15" CULVERT PIPE OPTION III	160	LF
603.175	18" RCP CLASS III	192	LF
603.179	18" CULVERT PIPE OPTION III	286	LF
604.092	CATCH BASIN TYPE B1-C	3	EA
604.16	ALTER CATCH BASIN TO MANHOLE	1	EA
604.262	CATCH BASIN TYPE B5-C	14	EA
605.11	12" UNDERDRAIN TYPE C	614	LF
605.13	18" UNDERDRAIN TYPE C	306	LF
606.1301	31" W-BEAM GUARDRAIL, MID-WAY SPLICE - SINGLE FACED	1,275	LF
606.1305	31" W-BEAM GUARDRAIL, MID-WAY SPLICE FLARED TERMINAL	4	EA
606.1306	31" W-BEAM GUARDRAIL, MID-WAY SPLICE TANGENT TERMINAL	2	EA
606.1307	BRIDGE TRANSITION TYPE 1A - ASYMMETRICAL	4	EA
606.23	GUARDRAIL TYPE 3C - SINGLE RAIL	25	LF
606.232	GUARDRAIL TYPE 3C - OVER 15' RADIUS	75	LF
606.265	TERMINAL END - SINGLE RAIL - GALVANIZED	4	EA
606.353	REFLECTORIZED FLEXIBLE GUARDRAIL MARKER	14	EA
607.16	CHAIN LINK FENCE - 4'	850	LF
607.1811	CHAIN LINK FENCE - 3'	180	LF
607.421	SCREENING FENCE	184	LF
608.26	CURB RAMP DETECTABLE WARNING FIELD	150	SF
609.11	VERTICAL CURB TYPE 1	475	LF
609.12	VERTICAL CURB TYPE 1- CIRCULAR	105	LF
609.221	TERMINAL CURB TYPE 1	16	LF
609.222	TERMINAL CURB TYPE 1- CIRCULAR	16	LF
609.31	CURB TYPE 3	1,025	LF
609.34	CURB TYPE 5	2,775	LF
609.35	CURB TYPE 5 - CIRCULAR	95	LF
610.08	PLAIN RIPRAP	35	CY
610.18	STONE DITCH PROTECTION	20	CY
613.319	EROSION CONTROL BLANKET	4,750	SY
615.07	LOAM	1,480	CY

[illegible]

SHEET NUMBER		RELOCATED US 1 BRIDGE INTERSTATE 295 CUMBERLAND-YARMOUTH CUMBERLAND COUNTY		PROJ. MANAGER		J.Brask	BY	DATE	STATE OF MAINE DEPARTMENT OF TRANSPORTATION		
				DESIGN-DETAILED	JCC	LDC	OCT. 2024	CHECKED-REVISED			GCK
2 OF 121		ESTIMATED QUANTITIES		DESIGN2-DETAILED2		RPM	SMA	OCT. 2024	2238200		
				DESIGN3-DETAILED3				P.E. NUMBER 6/27/25			
				REVISIONS 1		PAVEMENT MARKINGS					
				REVISIONS 2							
				REVISIONS 3							DATE
REVISIONS 4											
FIELD CHANGES								BRIDGE NO. 5804 WIN 22382.00 BRIDGE PLANS			

Date: 7/14/2025

Username:

Division: BRIDGE

Filename: ... \024_Signing_StripingPlan4.dgn

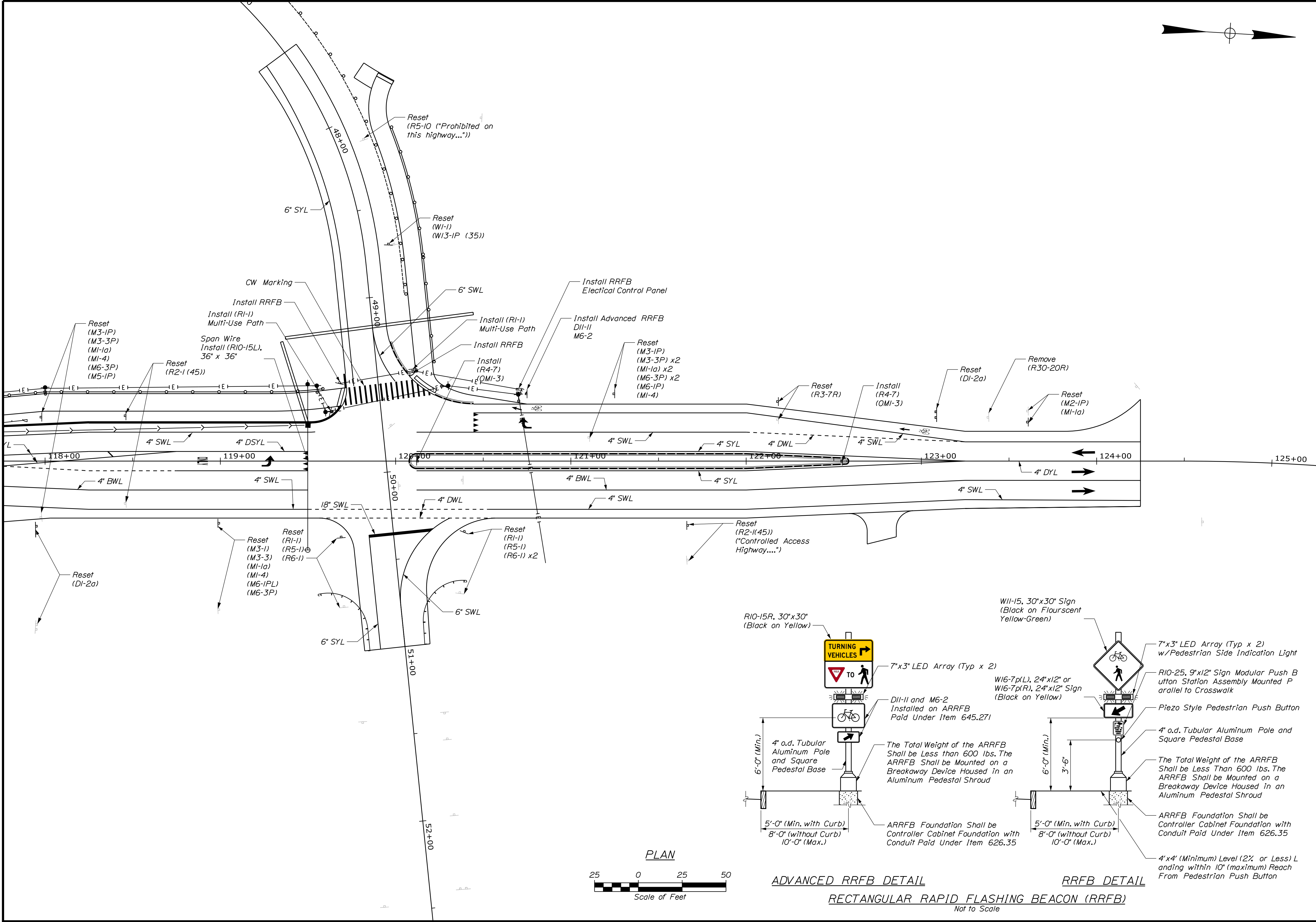

STATE OF MAINE
DEPARTMENT OF TRANSPORTATION

BRIDGE NO. 5604
WIN 22382.00
BRIDGE PLANS

PROJ. MANAGER	DATE	BY	DATE	SIGNATURE	P.E. NUMBER	DATE
DESIGN-DETAILED	JCC	LOC	OCT 2024			
CHECKED-REVIEWED	STJ	STJ	OCT 2024			
DESIGN-DETAILED	RPW	SMA	OCT 2024			
DESIGN-DETAILED						
REVISIONS 1						
REVISIONS 2						
REVISIONS 3						
REVISIONS 4						
FIELD CHANGES						

RELOCATED US 1 BRIDGE
INTERSTATE 295
CUMBERLAND-YARMOUTH CUMBERLAND COUNTY

SIGNING & STRIPING PLAN
(4 OF 4)

SHEET NUMBER
24
OF 121