



STATE OF MAINE
DEPARTMENT OF TRANSPORTATION
16 STATE HOUSE STATION
AUGUSTA, MAINE 04333-0016

Paul R. LePage
GOVERNOR

David Bernhardt
COMMISSIONER

March 27, 2018
Subject: Parking Lot Paving
State WIN: 021942.07
Location: **Portland**
Amendment No. 1

Dear Sir/Ms.:

The sign in sheet generated at the mandatory pre-bid meeting held March 21, 2018 is attached and available for Contractor review.

Please make the following changes to the Bid documents:

In the Bid Book:

CHANGE on page 14 "NOTICE TO CONTRACTORS", the bid opening date in the first paragraph from "March 28, 2018" to read "**April 4, 2018**". Make this change in pen and ink.

In the Plan Set:

REMOVE Sheet Number 8 of 8, E01 "Electrical Plan" 1 page dated 3/6/2018 and **REPLACE** with the attached new "Electrical Plan" 1 page dated 3/21/2018. Note the addition/modification of notes and an additional 1-inch conduit between the new utility pole and the 3-foot pedestrian gate.

On Sheet Number 3 of 8, Quantity Sheet, **ADD** Pay Item: 202.203, Pavement Butt Joints, with a quantity of 40 SY. Make this change in pen and ink.

On Sheet Number 5 of 8, Site Grading Plans, under Pavement Pothole Repair Procedure, **REMOVE** the word "Mill", and **REPLACE** with the phrase "Saw Cut". Make this change in pen and ink.

The following questions have been received:

Question: Is a butt joint required at the interface of the International Yard?

Response: No, only a saw cut is required. The new pavement will be placed against the saw cut.

Question: On Sheet C-02, please clarify Note 2. Is milling anticipated as part of the pothole repair?



PRINTED ON RECYCLED PAPER

Response: No, the Contractor shall saw cut the perimeter of the pothole and remove the loose pavement.

Question: Where can TWIC cards be obtained?

Response: TWIC cards can be obtained at: 175 Lancaster Street, Portland Maine. See also the following website: <https://www.tsa.gov/for-industry/twic>

Question: What is the depth of the potholes?

Response: Approximately 2 to 3 inches as measured during the pre-bid meeting.

Question: What is the voltage power for the new gate motor?

Response: The gate motor must use 120-volt power.

Question: Will the Contractor be required to work around containers, concrete barriers, cars and miscellaneous items during the project?

Response: No, the Maine Port Authority will remove these items prior to the start of construction. Truck traffic will be re-routed to Commercial Street via special permits.

Question: How will the new gate motor be powered?

Response: The Contractor will provide an in-ground junction box and extend the electrical power to the new gate location. Payment shall be incidental to the sliding gate pay item.

Question: What will happen to the six empty conduits at the base of the existing service panel near the utility pole?

Response: The Contractor will extend these to the new location of the utility pole.

Question: Will the attendance sheet for this pre-bid meeting be made available?

Response: Yes. The attendance sheet is attached hereto.

Consider these changes and information prior to submitting your bid on **April 4, 2018**.

Sincerely,

Jennifer Paul, P.E.

for George M. A. Macdougall P.E.
Contracts & Specifications Engineer

IMT Sign-in Sheet

Date	Time In	Time Out	Name	Company	Escorted By
3/21/18			ED KARPINSKI	MDOT/Kevilk	
			Matt Callahan	Glidden Paving	
			ROBERT BRADY	Shaw Brothers	
			Tom St. Onge	Gendron + Gendron	
			Ray Allard	R. J. Groudu	
			Loren Blair	Pike Industries	
			Tom Peters	Peters Construction	
			Bill Bradshaw	R.E. Coleman, Inc.	
			CRAIG MORRIS	HNTR	
			Matthew Kelly	M DOT	

Date: 3/21/2018

Username:

Filename: 008_Electrical Plan - Revision 1 (E01).dgn Division:

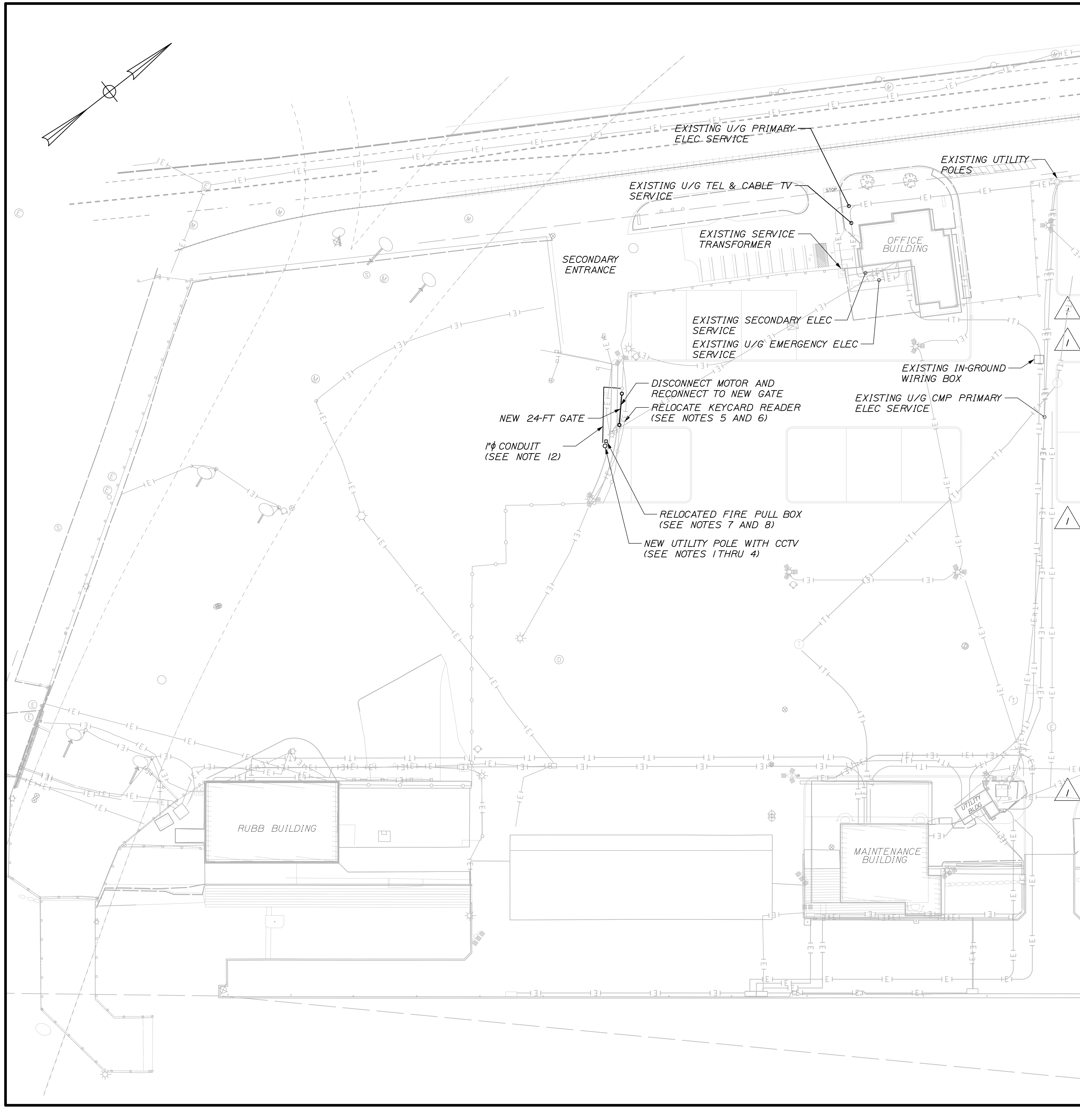

NOTES:

1. RELOCATE THE EXISTING ELECTRICAL PANELBOARD THAT IS INSTALLED ON THE UTILITY POLE TO BE DEMOLISHED. RELOCATE THE PANEL TO THE ADJACENT REPLACEMENT POLE BEING PROVIDED UNDER THIS CONTRACT.

2. PROVIDE AN EXTENSION OF THE EXISTING UNDERGROUND ELECTRICAL FEEDER THAT ORIGINATES IN THE OFFICE BUILDING AND PRESENTLY RUNS TO THE EXISTING ELECTRICAL PANEL LOCATED ON THE UTILITY POLE TO BE DEMOLISHED. EXTEND THE FEEDER UNDERGROUND TO THE RELOCATED ELECTRICAL PANELBOARD ON THE REPLACEMENT UTILITY POLE. THE FEEDER EXTENSION SHALL BE (3) #4 AWG, IN A 2" PVC SCHED 40 CONDUIT. PROVIDE AN IN-GROUND ELECTRICAL BOX TO FACILITATE THE EXTENSION OF THE EXISTING PANEL FEEDER.

3. ARRANGE WITH THE OWNER'S TELCOM/SECURITY CONSULTANT GALAXIE INTEGRATED TECHNOLOGIES TO RELOCATE THE EXISTING SURVEILLANCE CAMERAS AND TRANSMITTER FROM THE EXISTING UTILITY POLE THAT IS TO BE DEMOLISHED TO THE REPLACEMENT UTILITY POLE. PROVIDE NEW 4-PAIR CAT6 CABLE IN 1" CONDUITS AT THE REPLACEMENT UTILITY POLE AS REQUIRED BETWEEN THE RELOCATED TRANSMITTER BOX AND THE RELOCATED CAMERAS. ARRANGE WITH THE OWNER'S TELCOM/SECURITY CONSULTANT GALAXIE INTEGRATED TECHNOLOGIES TO MAKE THE CABLE CONNECTIONS.

4. PROVIDE A 2" UNDERGROUND CONDUIT BETWEEN THE EXISTING LOCATION OF THE TRANSMITTER BOX THAT IS TO BE RELOCATED AND THE RELOCATED TRANSMITTER BOX. PROVIDE A REPLACEMENT OF THE EXISTING FIBER OPTIC CABLE THAT ORIGINATES IN THE OFFICE BUILDING AND CURRENTLY EXTENDS TO THE EXISTING TRANSMITTER BOX ON THE UTILITY POLE THAT IS TO BE DEMOLISHED. THE REPLACEMENT FIBER OPTIC CABLE SHALL BE 12 STRAND MULTIMODE. PROVIDE NEW REPLACEMENT FIBER OPTIC CABLE TO BE RUN CONTINUOUSLY WITHOUT SPLICES WITHIN THE EXISTING AND NEW EXTENSION UNDERGROUND CONDUITS. ARRANGE WITH THE OWNER'S TELCOM/SECURITY CONSULTANT GALAXIE INTEGRATED TECHNOLOGIES TO MAKE THE CABLE CONNECTIONS.

5. RELOCATE THE EXISTING POST AND GATE ENTRANCE CARD READER AS INDICATED ON THE PLAN.

6. PROVIDE NEW 4-PAIR CAT6 CABLE IN 1" UNDERGROUND CONDUIT AS REQUIRED BETWEEN THE RELOCATED TRANSMITTER BOX AND THE RELOCATED GATE ENTRANCE CARD READER. ARRANGE WITH THE OWNER'S TELCOM/SECURITY CONSULTANT GALAXIE INTEGRATED TECHNOLOGIES TO MAKE THE CABLE CONNECTIONS.

7. RELOCATE THE EXISTING POST AND FIRE ALARM PULL STATION AS INDICATED ON THE PLAN.

8. PROVIDE A NEW UNDERGROUND 1" CONDUIT BETWEEN THE EXISTING LOCATION OF THE FIRE ALARM PULL STATION THAT IS TO BE RELOCATED AND THE RELOCATED FIRE ALARM PULL STATION. PROVIDE NEW REPLACEMENT FIRE ALARM CABLE TO BE RUN CONTINUOUSLY FROM THE EXISTING POST-MOUNTED FIRE ALARM PULL STATION THAT IS LOCATED IMMEDIATELY EAST OF THE OFFICE BUILDING AND THE RELOCATED FIRE ALARM PULL STATION. RUN THE NEW CABLE WITHIN THE EXISTING AND NEW EXTENSION UNDERGROUND CONDUITS.

9. PROVIDE AN IN-GROUND ELECTRICAL BOX TO FACILITATE THE EXTENSION OF THE EXISTING PANEL FEEDER (SEE NOTE 2). LOCATE THE IN-GROUND BOX IMMEDIATELY OVER THE LOCATION WHERE THE EXISTING UNDERGROUND FEEDER CONDUIT CURRENTLY RISES ABOVE GRADE AT THE UTILITY POLE THAT IS TO BE DEMOLISHED.

10. PROVIDE 120 VOLT CIRCUIT WIRING (2#12, 1#12 GND) FROM THE RELOCATED ELECTRICAL PANEL TO EACH OF THE FOLLOWING. PROVIDE NEW 1" UNDERGROUND CONDUIT AS REQUIRED FROM THE LOCATION OF THE EXISTING PANEL TO FACILITATE THE CIRCUIT EXTENSIONS. RUN THE NEW CIRCUIT WIRING WITHIN THE EXISTING AND NEW EXTENSION UNDERGROUND CONDUITS.

- * PANEL CIRCUIT #2 (20A/1P) - PEDESTRIAN GATE OPERATOR AT THE SECONDARY ENTRANCE OFF COMMERCIAL STREET
- * PANEL CIRCUIT #3 (20A/1P) - TRAFFIC CONTROL RAISE/LOWER ARM OPERATOR AT THE SECONDARY ENTRANCE OFF COMMERCIAL STREET
- * PANEL CIRCUIT #5 (20A/1P) - SLIDING GATE OPERATOR AT THE SECONDARY ENTRANCE OFF COMMERCIAL STREET AND THE NEW GATE OPERATOR

11. PROVIDE 120 VOLT CIRCUIT WIRING (2#12, 1#12 GND) FROM THE RELOCATED ELECTRICAL PANEL TO THE RELOCATED TRANSMITTER BOX. PROVIDE NEW 1" CONDUIT AS REQUIRED. CONNECT THE CIRCUIT WIRING TO PANEL CIRCUIT #4 (20A/1P).

12. PROVIDE A NEW UNDERGROUND 1" CONDUIT FOR FUTURE KEY CARD READER AT PEDESTRIAN GATE. EXTEND CONDUIT 5 FT ABOVE FINISH GRADE AND ATTACH TO GATE POST. CAP CONDUIT.

Bartlett Design
 LIGHTING & ELECTRICAL ENGINEERING
 942 WASHINGTON STREET, BATH, ME 04530
 TEL (207) 443-5447 FAX (207) 443-5560

NOTES CONT.:

STATE OF MAINE
 DEPARTMENT OF TRANSPORTATION
 STP 2194(207)
 WIN
 021942.07

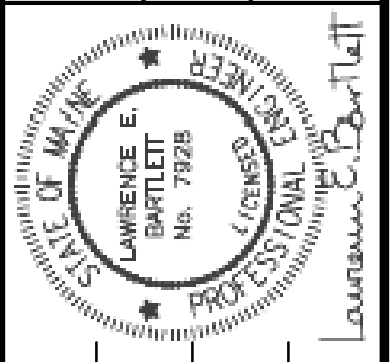

PROJ. MANAGER	DATE	BY	DATE
L. Bartlett	02/18	P. Bishop	02/18
L. Bartlett	02/18	L. Bartlett	02/18
L. Bartlett	03/18	L. Bartlett	03/18

PORTLAND INTERNATIONAL MARINE TERMINAL
 MAINE INTERMODAL PORT PRODUCTIVITY PROJECT
 TERMINAL GRADING & PAVING
 CUMBERLAND COUNTY
 PORTLAND
ELECTRICAL PLAN

SHEET NUMBER
E01
 8 OF 8