

CONST. CURVE DATA  
 PI = 594+04.10  
 $\Delta = 6^{\circ}01'57.5''$  LT.  
 D = 1^{\circ}00'  
 T = 301.91'  
 L = 603.26'  
 R = 5729.58'  
 E = 7.95'

CONST. DRIVES & ENTRANCES  
 INSTALL CULVERT PIPES (OPTION I)  

STATION	TYPE	SIZE CULV.
596+50 RT	GRAVEL	NONE
600+28 LT	GRAVEL	REMOVE & RELAY EXISTING
602+64 LT	GRAVEL	15" x 24" CULV. AS NECESSARY
	GRAVEL	NONE (SKEWED BK. 20^{\circ})

ARTHUR BURSTEIN

LOIS A. KEIM  
 CLAYTON K. HEWETT

STA. 608+0 INSTALL 30" x 76"  
 CULV. PIPE (OPT. III) RIPRAP ENDS  
 DITCH OUT AS NECESSARY LT. & RT.  
 INSTALLED 1979

MOSTLY HARDWOOD & ALDERS

SOMERVILLE ASSOCIATES

TERRY NORTON

MIXED GROWTH

STA. 598+25 TO 603+75 LT  
 EXCAVATED OLD PAVEMENT  
 LOAM & SEED AS NECESSARY

BM #605  
 RINGE NAIL IN LEDGE  
 282.27'

RI = 608+82.83  
 $\Delta = 9^{\circ}23'17.5''$  RT  
 D = 2^{\circ}00'  
 T = 235.23'  
 L = 469.41'  
 R = 2064.79'  
 E = 9.64'

BM #60  
 RINGE NAIL IN LEDGE  
 271.98'

INSTALL GUARD RAIL - TYPE 3  

STA. 600+50 RT	TERMINAL END SECTION
STA. 600+50 TO 600+62 RT	CIRCULAR 30'R
STA. 600+62 TO 605+37 RT	SINGLE RAIL
STA. 605+37 TO 606+49 RT	CIRCULAR 30'R
STA. 606+49 RT	TERMINAL END SECTION

MOSTLY HARDWOODS

HAROLD S. TURNER  
 SARAH W. TURNER

LOIS A. KEIM  
 CLAYTON K. HEWETT

PLAN  
 SURVEYED BY: [Signature]  
 PLOTTED BY: [Signature]  
 CHECKED BY: [Signature]  
 NO. 30022

PROFILE  
 SURVEYED BY: [Signature]  
 PLOTTED BY: [Signature]  
 CHECKED BY: [Signature]  
 NO. 30022

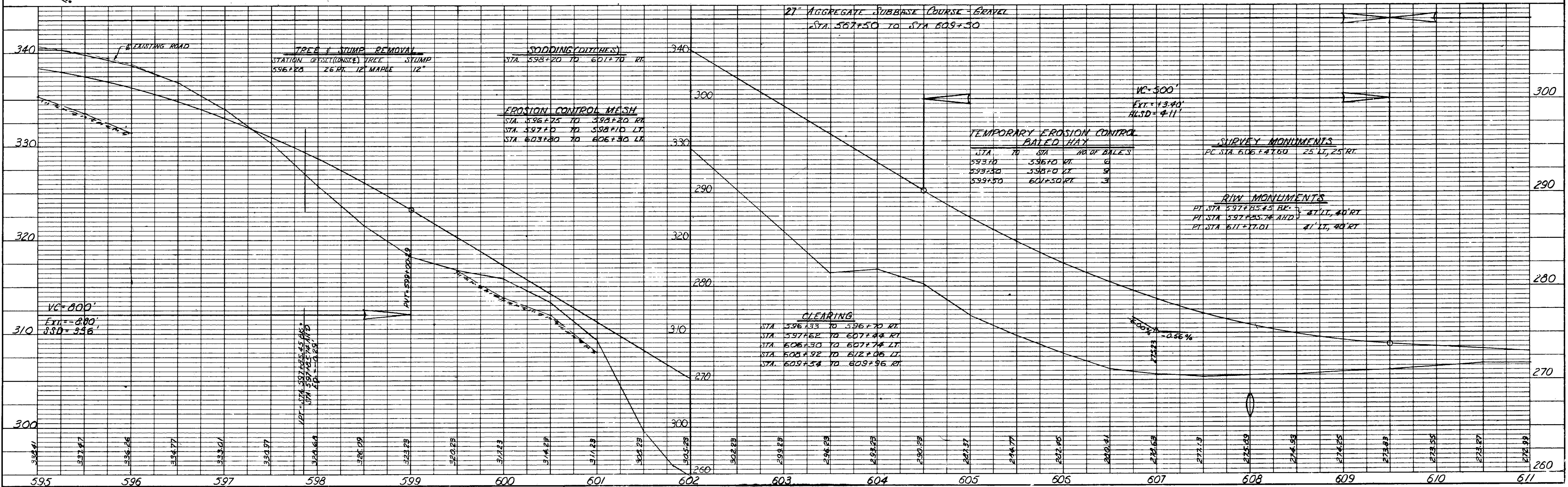
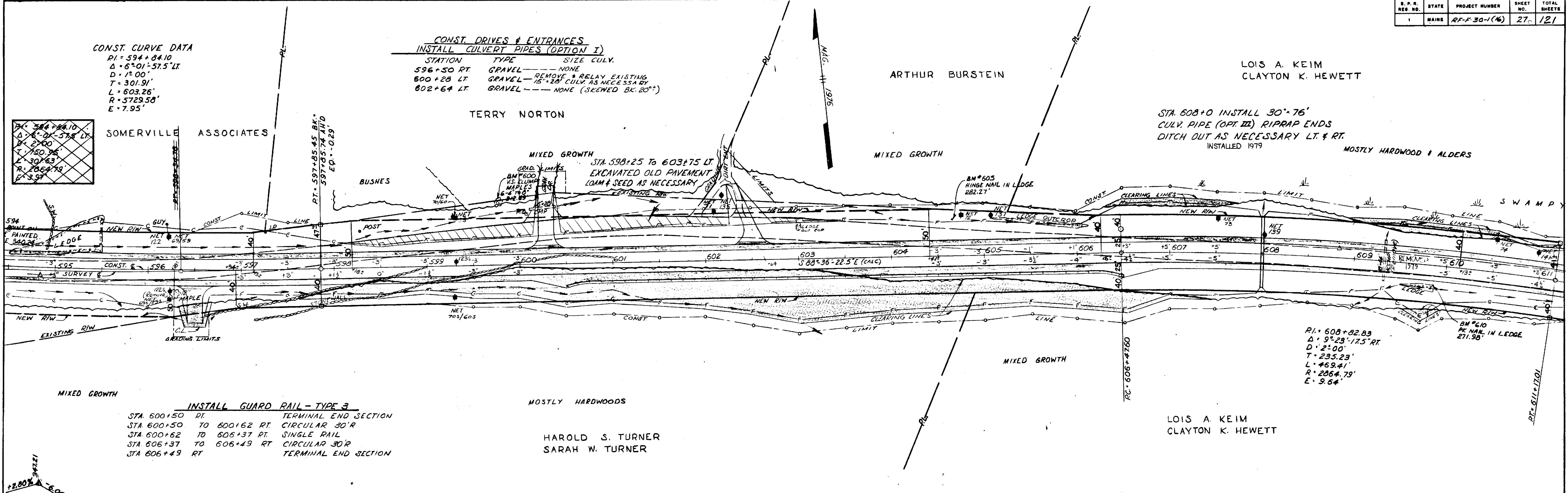

**INSTALL GUARD RAIL - TYPE 3**

STA 616+75 LT	TERMINAL END SECTION
STA 616+75 TO 616+87 LT	CIRCULAR 30'R
STA 616+87 TO 618+12 LT	SINGLE RAIL
STA 618+12 TO 618+24 LT	CIRCULAR 30'R
STA 618+24 LT	TERMINAL END SECTION

STA 616+75 RT	TERMINAL END SECTION
STA 616+75 TO 616+87 RT	CIRCULAR 30'R
STA 616+87 TO 618+12 RT	SINGLE RAIL
STA 618+12 TO 618+24 RT	CIRCULAR 30'R
STA 618+24 RT	TERMINAL END SECTION

LOIS A. KEIM  
CLAYTON K. HEWETT

**CONST. DRIVE & ENTRANCES  
INSTALL CULVERT PIPES (OPTION I)**

STATION	TYPE
614+88 RT	GRAVEL - NONE
621+00 LT	GRAVEL - 15'x36'
622+50 RT	GRAVEL - NONE
623+62 LT	GRAVEL - 15'x32'

RI = 627+74.66  
A = 38° 06' 07.5" LT  
D = 3° 55'  
T = 503.16'  
L = 972.82'  
R = 1462.87'  
E = 84.77'

STA 626+43 INSTALL 30" x 92" CULV. PIPE (OPT. III) RIPRAP ENDS  
INSTALLED 1979

**PLAN**  
SURVEYED BY: [Signature]  
DATE: 12/76  
PLOTTED BY: [Signature]  
DATE: 1/77  
NOTE BOOK NO. 30777  
ALIGNMENT CHECKED: [Signature]  
RT. OF WAY CHECKED: [Signature]  
NO. 30778

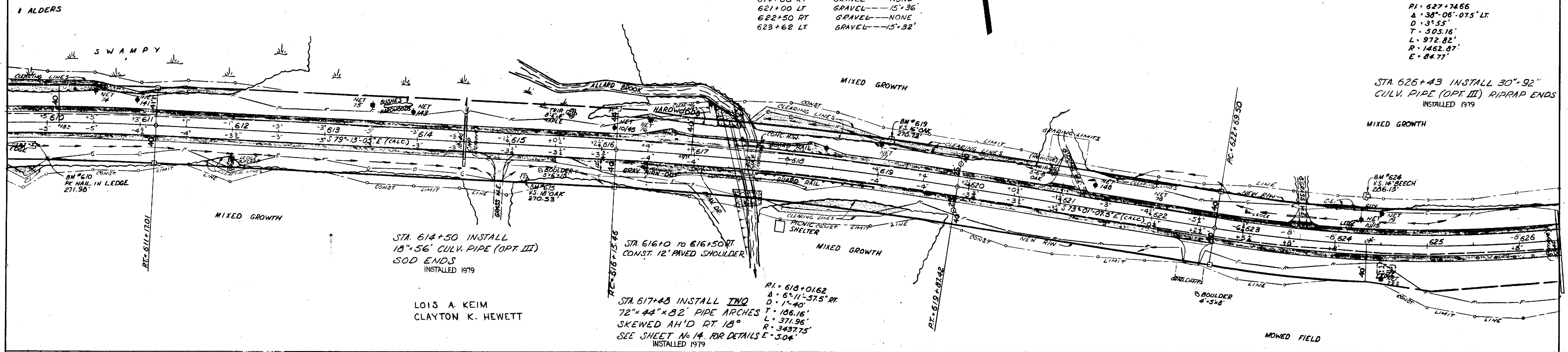

**PROFILE**  
SURVEYED BY: [Signature]  
DATE: 12/76  
PLOTTED BY: [Signature]  
DATE: 1/77  
NOTE BOOK NO. 30761  
GRADES CHECKED: [Signature]  
STRUCTURE NOTATIONS CHECKED: [Signature]

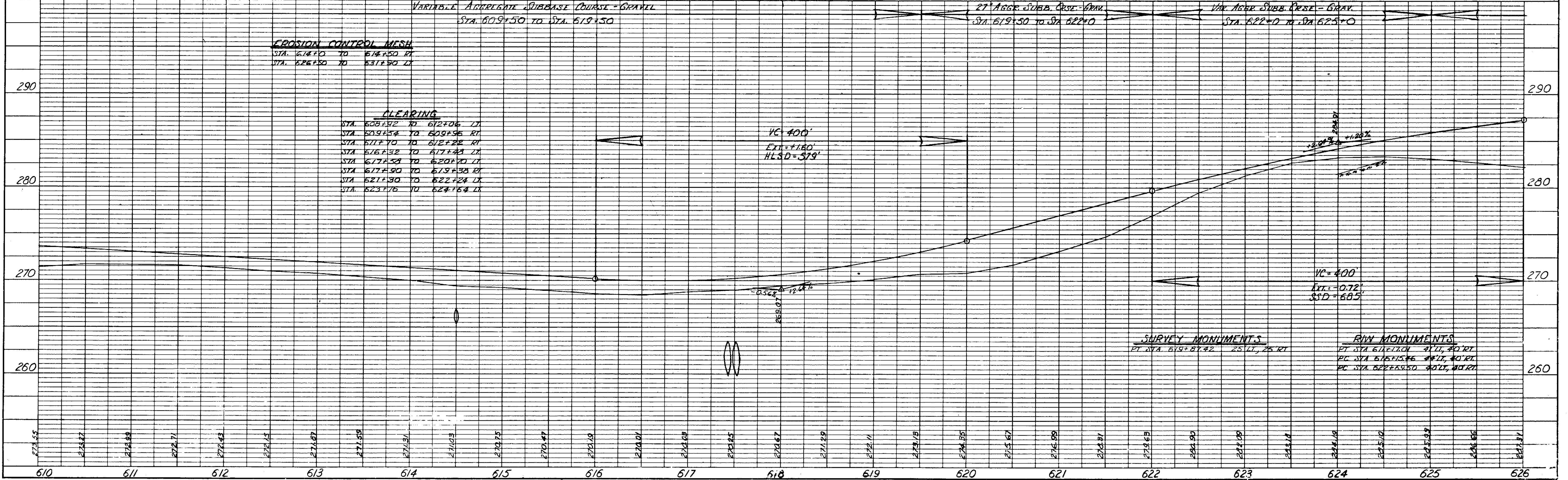

MARY SWANSON

**PLAN**  
 DATE: 12-76  
 BY: L. J. COOMBS  
 CHECKED: E. J. COOMBS  
 NOTE: BOOK GRADES CHECKED  
 NO. 30/21 STRUCTURE STATISTICS CHECKED

**PROFILE**  
 DATE: 12-76  
 BY: E. J. COOMBS  
 CHECKED: L. J. COOMBS  
 NOTE: BOOK GRADES CHECKED  
 NO. 30/21 STRUCTURE STATISTICS CHECKED

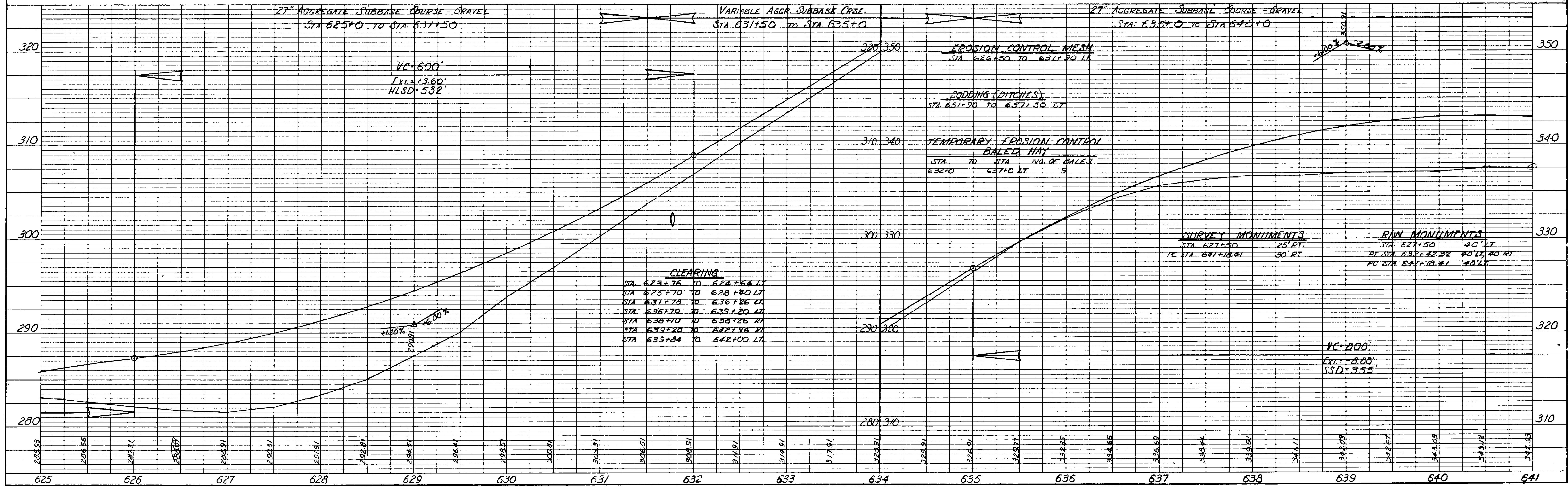
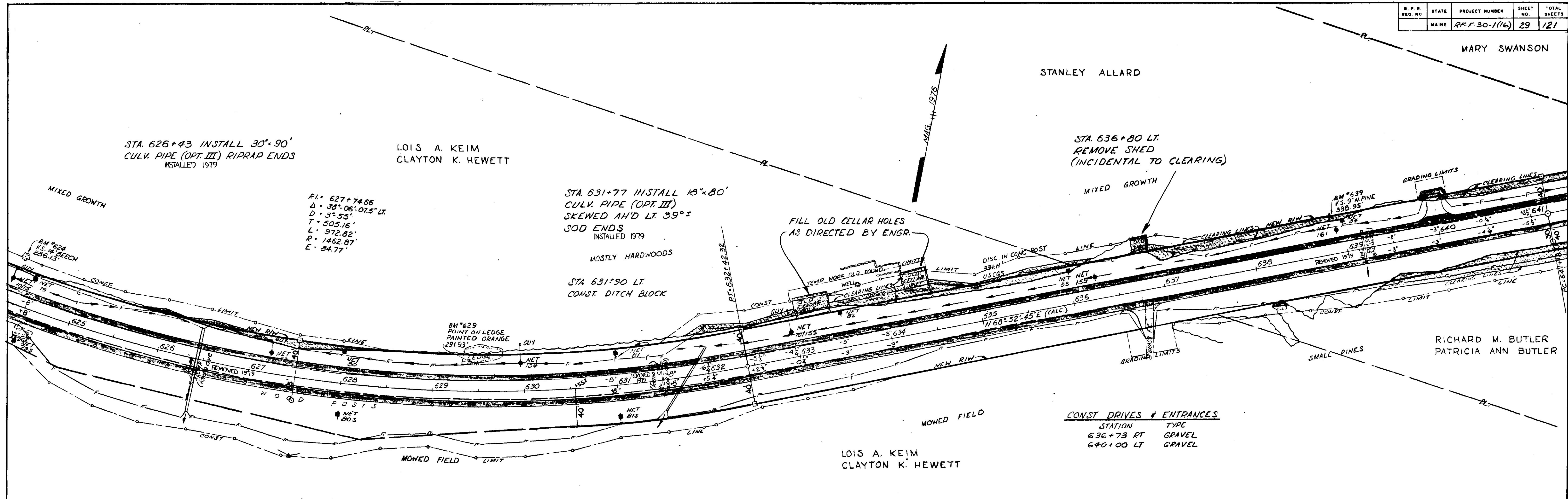

**CONST. DRIVES & ENTRANCES  
INSTALL CULVERT PIPES (OPTION I)**

STATION	TYPE	SIZE CULV.
640+00 LT	GRAVEL	NONE
642+45 RT	PAVED	NONE (SKEWED AH'D)
643+30 LT	GRAVEL	15" x 40"
645+40 LT	GRAVEL	15" x 40"
647+40 LT	GRAVEL	15" x 40"
649+93 LT	GRAVEL	15" x 38"
651+54 LT	GRAVEL	15" x 50"
653+20 LT	GRAVEL	NONE

ERNEST J. PORTER JR.  
ELAINE M. PORTER

**PLAN**  
SURVEYED  
PLOTTED  
NOTES  
NO. 3042

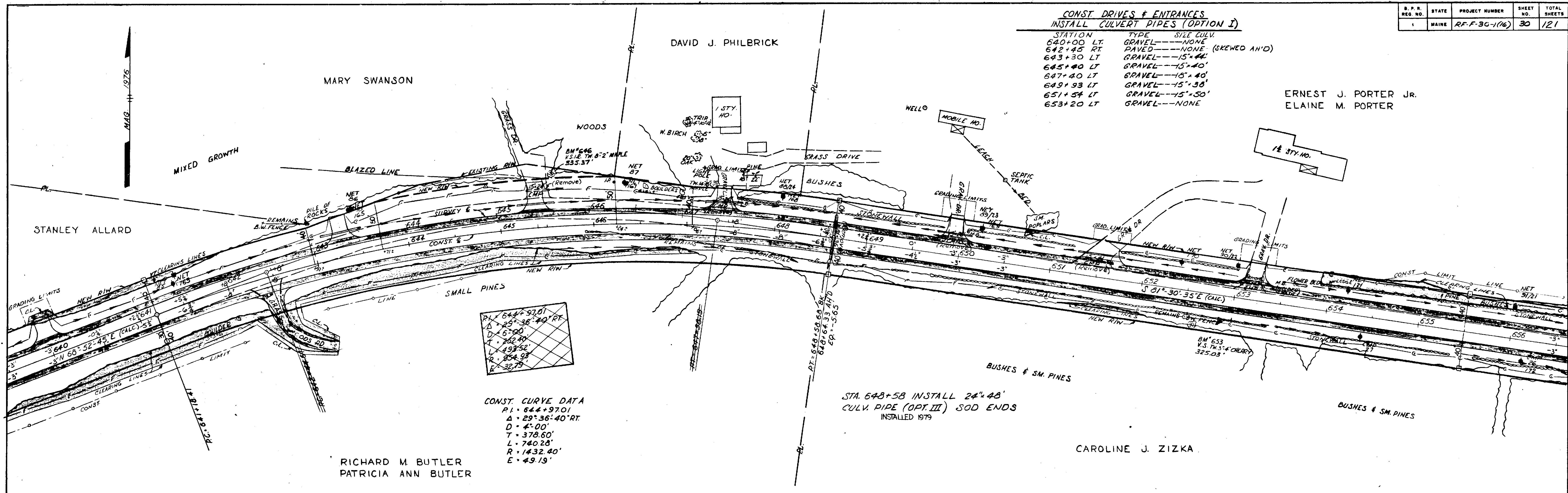

**CONST. CURVE DATA**  
 P.I. 644+97.01  
 Δ = 29° 36' 40" RT  
 D = 4' 00"  
 T = 378.60'  
 L = 740.28'  
 R = 1432.40'  
 E = 49.19'

STA. 648+58 INSTALL 24" x 48"  
CULV. PIPE (OPT. III) SOD ENDS  
INSTALLED 1979

**PROFILE**  
SURVEYED  
PLOTTED  
NOTES  
NO. 3042

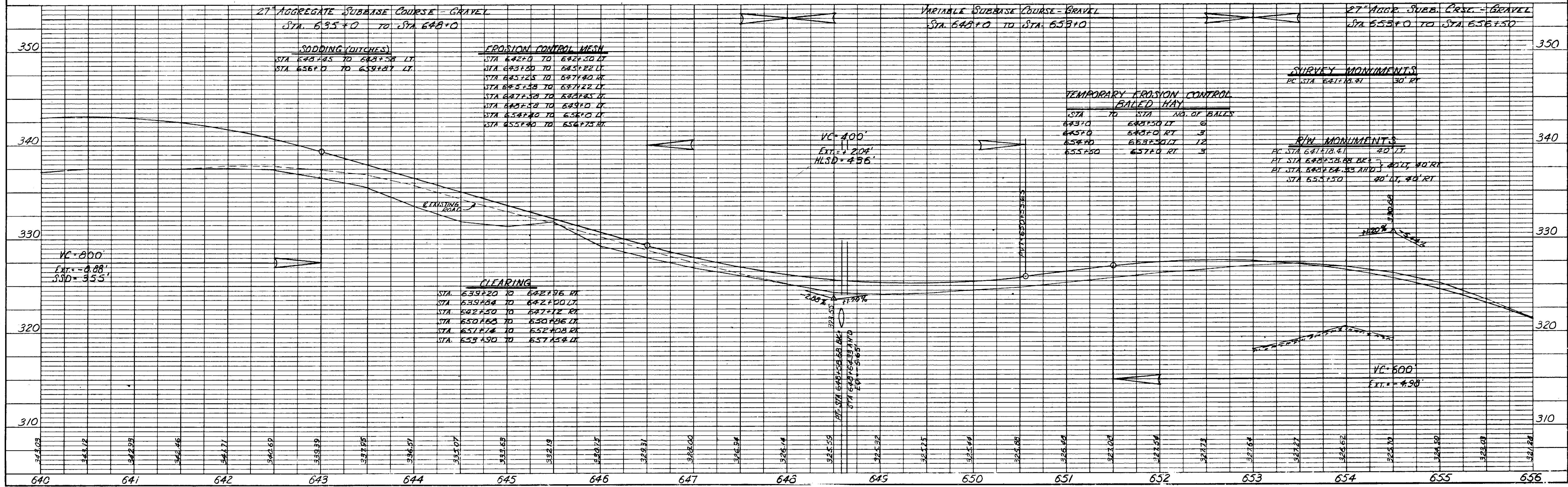

DATE 12-76  
 BY J. ST. CLAIR  
 SURVEYED  
 PLOTTED  
 CHECKED  
 RT. OF WAY CHECKED  
 NO. 3062

DATE 12-76  
 BY J. ST. CLAIR  
 SURVEYED  
 PLOTTED  
 CHECKED  
 STRUCTURE NOTATIONS CHECKED  
 NO. 3062

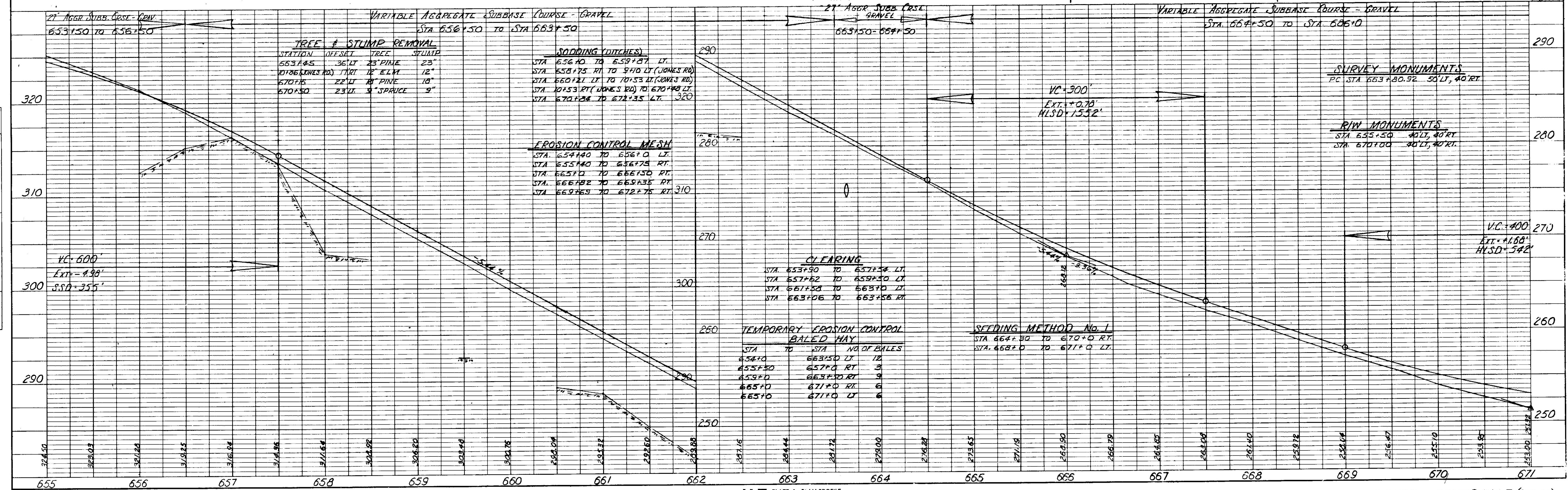
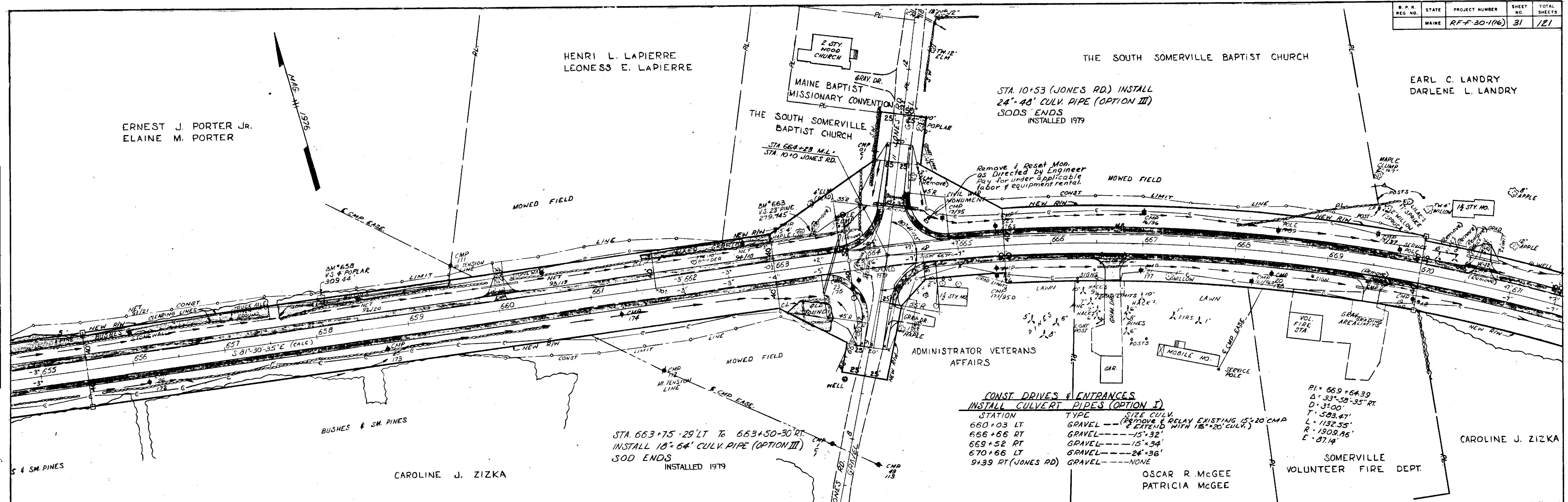

CLEBER A. COOLEY JR  
 PARKER COOLEY  
 TALBOT COOLEY  
 JUNE STIMAN  
 BETTY ORFF  
 DOROTHY MOORE  
 PATRICIA CREAMER

STA. 686+58 INSTALL 18" 68"  
 CULV. PIPE (OPT III), SOD ENDS  
 INSTALLED 1979

**CONST DRIVES & ENTRANCES  
 INSTALL CULVERT PIPES (OPTION I)**

STATION	TYPE	SIZE CULV.
670+66 LT	GRAVEL	24" x 36"
672+53 LT	GRAVEL	24" x 36"
679+00 RT	GRAVEL	NONE
680+46 LT	GRAVEL	NONE
685+50 LT	GRAVEL	NONE

EARL C. LANDRY  
 DARLENE L. LANDRY

DATE 12-76  
 BY J. ST. CLAIR  
 SURVEYED, PLOTTED, CHECKED, RT. OF WAY CHECKED.  
 NO. 30/82

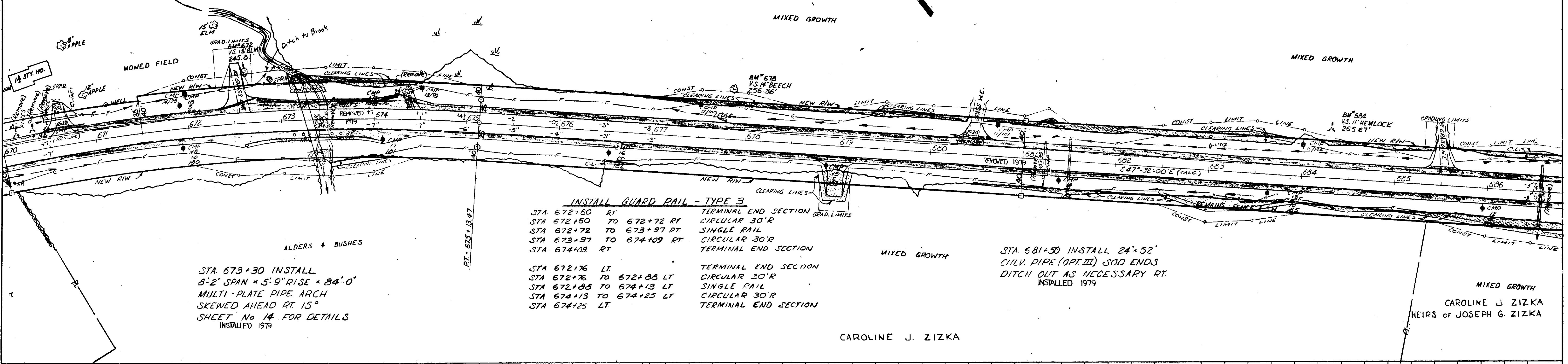

STA. 673+30 INSTALL  
 8'-2" SPAN x 5'-9" RISE x 8'-0"  
 MULTI-PLATE PIPE ARCH  
 SKEWED AHEAD RT 15°  
 SHEET No. 14 FOR DETAILS  
 INSTALLED 1979

**INSTALL GUARD RAIL - TYPE 3**

STATION	TYPE	SECTION
STA 672+60 RT	RT	TERMINAL END SECTION
STA 672+60 TO 672+72 RT	RT	CIRCULAR 30'R
STA 672+72 TO 673+97 RT	RT	SINGLE RAIL
STA 673+97 TO 674+09 RT	RT	CIRCULAR 30'R
STA 674+09 RT	RT	TERMINAL END SECTION
STA 672+76 LT	LT	TERMINAL END SECTION
STA 672+76 TO 672+88 LT	LT	CIRCULAR 30'R
STA 672+88 TO 674+13 LT	LT	SINGLE RAIL
STA 674+13 TO 674+25 LT	LT	CIRCULAR 30'R
STA 674+25 LT	LT	TERMINAL END SECTION

STA. 681+50 INSTALL 24" x 52"  
 CULV. PIPE (OPT III) SOD ENDS  
 DITCH OUT AS NECESSARY RT.  
 INSTALLED 1979

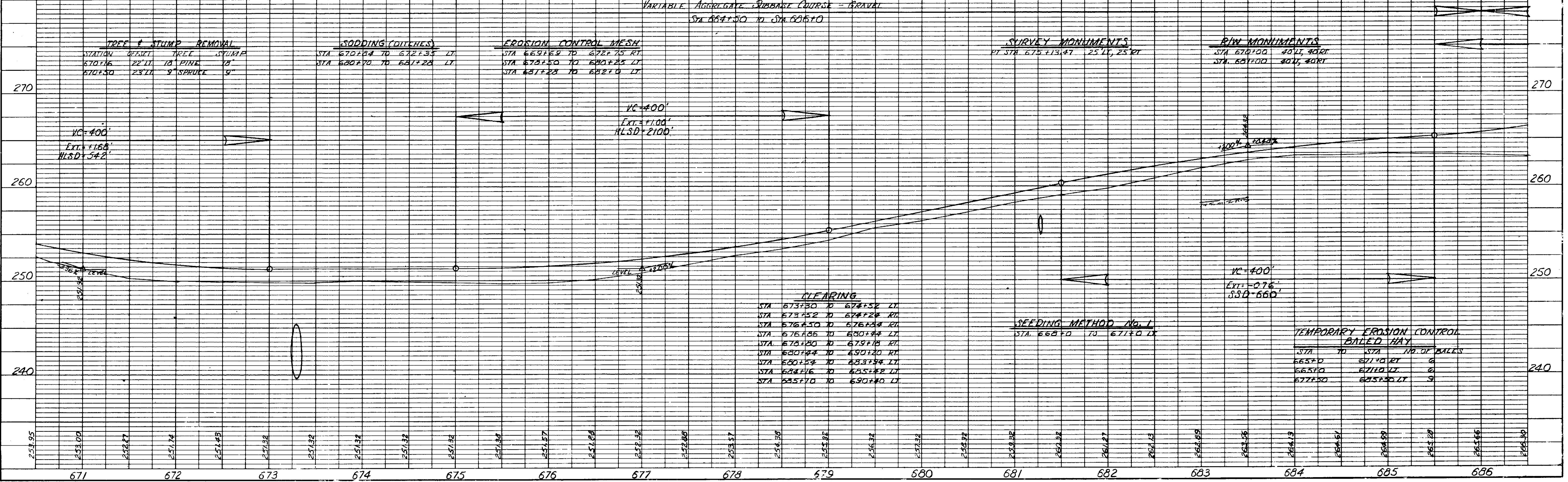

DATE 12-76  
 BY J. ST. CLAIR  
 SURVEYED, GRADES CHECKED, B. M.'S NOTED, STRUCTURE NOTATIONS CHECKED.  
 NO. 30/82

**CONST. DRIVES & ENTRANCES  
INSTALL CULVERT PIPES (OPTION I)**

STATION	TYPE	SIZE CULV.
692+70 LT	GRAVEL-NONE	
692+86 RT	GRAVEL-NONE	
693+60 RT	GRAVEL-NONE	
696+00 RT	GRAVEL-NONE	
700+00 RT	GRAVEL-NONE	
700+80 RT	GRAVEL-NONE	

STA. 694+65 INSTALL 24"x52"  
CULV. PIPE (OPT. III) SOD ENDS  
SKEWED AHEAD RT. 11°15'±  
DITCH OUT AS NECESSARY RT.  
INSTALLED 1979

**INSTALL CURB - TYPE 3**

STATION TO	STATION	LENGTH
691+50 RT	692+76 RT	126 LF
692+96 RT	693+50 RT	54 LF

STA. 697+53 INSTALL 18"x64"  
CULV. PIPE (OPT. III), SOD ENDS  
SKEWED AHEAD LT. 19°50'±  
DITCH OUT AS NECESSARY RT.  
INSTALLED 1979

MIXED GROWTH  
STA. 696+25 TO 697+25 LT  
EXCAVATE OLD PAVEMENT  
SEE X-SECTIONS

STA. 686+58 INSTALL 18"x68"  
CULV. PIPE (OPT. III) SOD ENDS  
INSTALLED 1979

STA. 688+85 INSTALL  
36"x96" CULV. PIPE (OPT. III)  
RIPRAP ENDS  
INSTALLED 1979

CAROLINE J. ZIZKA  
JOSEPH G. ZIZKA

STA. 691+50 RT  
CONST. SODDED DOWNSPOUT

FOREST E. PEASLEE SR.  
DELIA G. PEASLEE  
FREDERICK SMITH (LIFE ESTATE)

STA. 701+0 TO 702+0  
CONST. APPROACH

STA. 701+0 END  
PROJ. NO. RF-F-30-1(16)

DATE 12-76  
BY L. J. COLE  
CHECKED  
NOTED  
NO. 3042

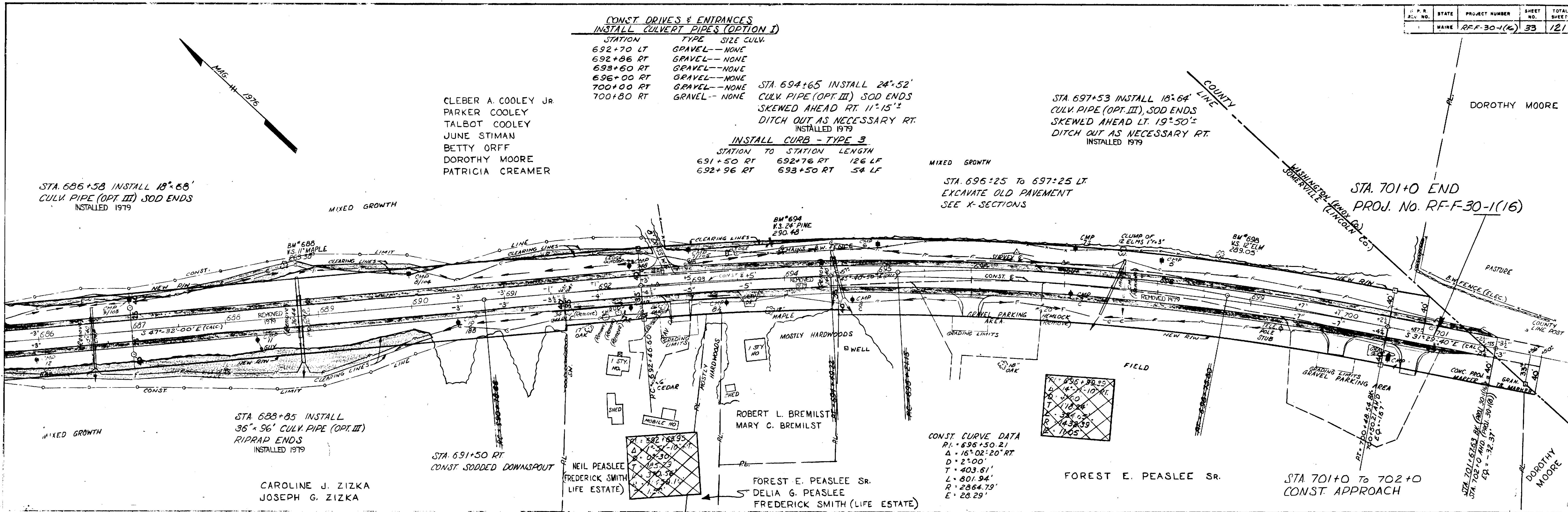

DATE 12-76  
BY L. J. COLE  
CHECKED  
NOTED  
NO. 3042

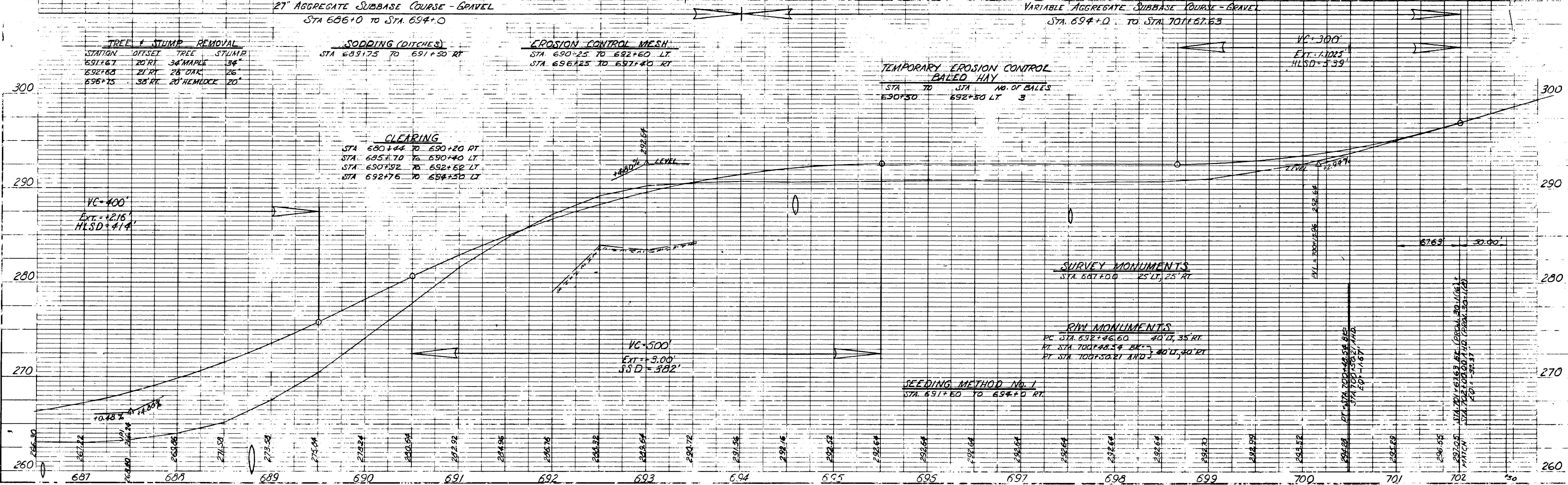
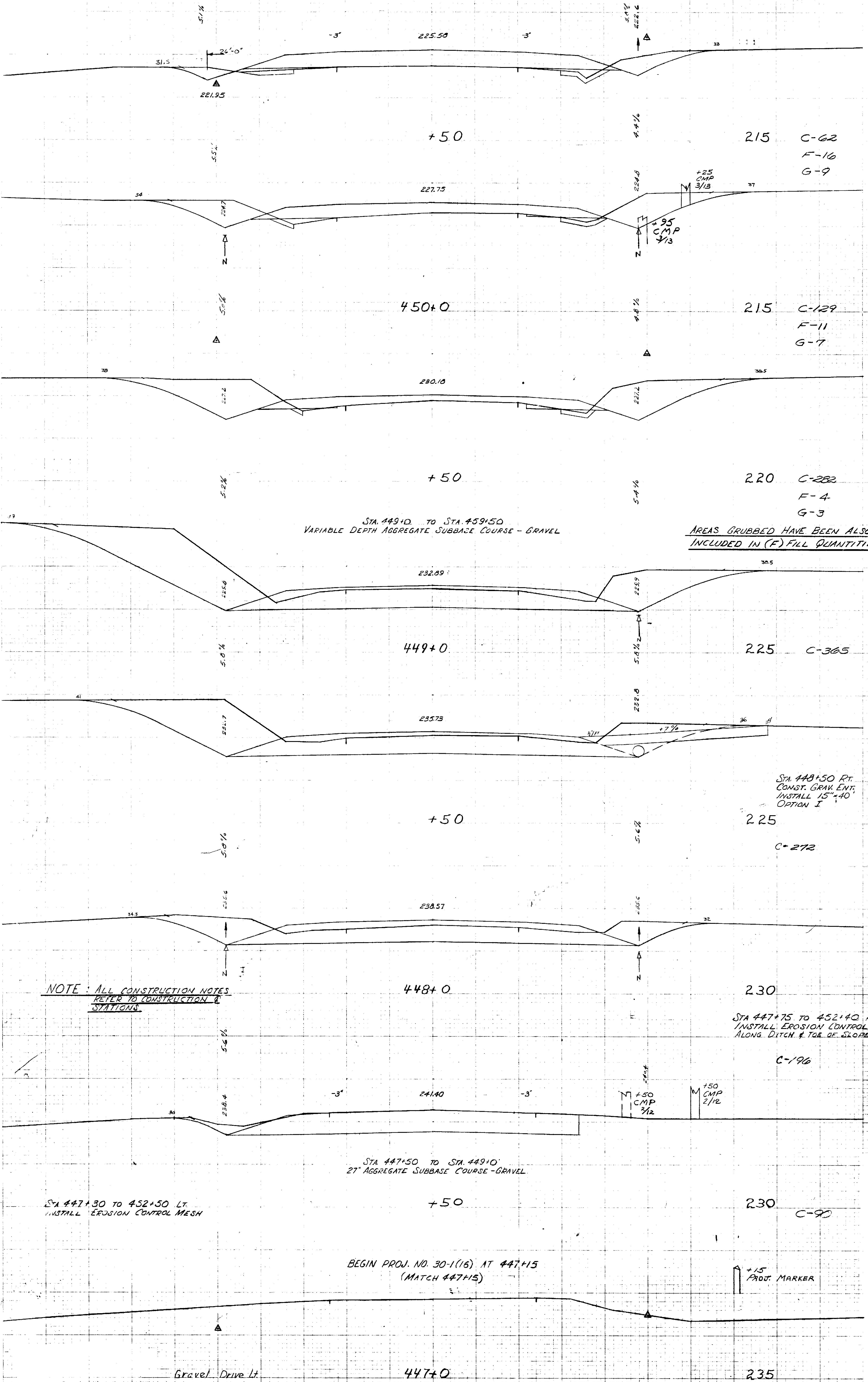

PLATE FILE

ORIGINAL SURVEY	SURVEYED	BY	DATE
NOTE BOOK	PLOTTED	F. Stacomb	12-76
NO. 39/80	TEMPLATE	A.D.	3-77
	AREAS CHECKED	L. [unclear]	12-77

FINAL SURVEY	SURVEYED	BY	DATE
NOTE BOOK	PLOTTED		
	TEMPLATE		
	AREAS CHECKED		



NOTE: ALL CONSTRUCTION NOTES REFER TO CONSTRUCTION STATIONS.

AREAS GRUBBED HAVE BEEN ALSO INCLUDED IN (F) FILL QUANTITIES

STA. 449+0 TO STA. 459+50  
VARIABLE DEPTH AGGREGATE SUBBASE COURSE - GRAVEL

STA. 448+50 RT. CONST. GRAV. ENT. INSTALL 15" x 40' OPTION I

STA. 447+75 TO 452+40 RT. INSTALL EROSION CONTROL MESH ALONG DITCH & TOE OF SLOPE

STA. 447+50 TO STA. 449+0  
27' AGGREGATE SUBBASE COURSE - GRAVEL

STA. 447+30 TO 452+50 LT. INSTALL EROSION CONTROL MESH

BEGIN PROJ. NO. 30-1(16) AT 447+15 (MATCH 447+15)

Rt. 17 447+0 to 450+50

Jefferson-Somerville

FILE NO.	STATE	PROJECT NUMBER	SHEET NO.	TOTAL SHEETS
	VA	RT. 17 (16) 37	127	