

Draft application received 3.31.20
 1st revised draft application received 4.21.20
 2nd revised draft application received 4.21.20
 Deemed ready for scoping 5.07.20
 Final application received 2.01.21
 1st revised final application received 3.09.21
 Deemed complete 3.18.21
 Contact information updated 3.29.2022

STANDARD LEASE APPLICATION: NON-DISCHARGE

1. APPLICANT CONTACT INFORMATION

Applicant	Maine Fresh Sea Farms		
Contact Person	Peter Fischer		
Address	256 Lower Round Pond Road		
City	Bristol		
State, Zip	Maine 04539		
County	Lincoln		
Telephone	207-380-6478		
Email	mainefreshseafarms@gmail.com		
Type of Application	<input type="checkbox"/> Draft Application [submitted before scoping session session] <input checked="" type="checkbox"/> Final Application [submitted after scoping session]		
Dates	Pre-Application Meeting: 1-21-2020	Draft Application Submitted: 3-28-020	Scoping Session: 11-9-2020

Note: If applicant is a corporation or a partnership, the "Corporate Applicant Information Document" available at: <http://www.maine.gov/dmr/aquaculture/forms/standard.html> must also be completed.

2. PROPOSED LEASE SITE INFORMATION

Location of Proposed Lease Site	
Town	South Bristol
Waterbody	Damariscotta River
General Description (e.g. south of B Island)	Middle of Clark Cove
Lease Information	
Total acreage requested (100-acre maximum)	3.6
Lease term requested (20-year maximum)	10
Type of culture (check all that apply)	<input type="checkbox"/> Bottom (no gear) <input checked="" type="checkbox"/> Suspended (gear in the water and/or on the bottom)
Is any portion of the proposed lease site above mean low water?	<input type="checkbox"/> Yes <input checked="" type="checkbox"/> No

Note: If you selected yes, you need to complete the steps outlined in the section titled: "19. Landowner/Municipal Permission Requirements".

3. WATER QUALITY

Directions: Water Quality Information can be found here: <http://www.maine.gov/dmr/shellfish-sanitation-management/closures/pollution.html>

Pollution Area (e.g. "19-A"):	23-C
Pollution Area Section (e.g. "B.2". or "none"):	none
Water Quality Classification (e.g. approved, restricted, etc.):	Approved

Note: If you are proposing to grow molluscan shellfish in waters classified as anything other than open/approved, you will need to contact the Bureau of Public Health to discuss your plans at the following email: DMRPublicHealthDiv@maine.gov

4. SPECIES INFORMATION

A. Please complete the table below and add additional rows as needed.

Name of species to be cultivated (include both common and scientific names):	Name and address of the source of seed stock, juveniles, and/or smolts	Maximum number (or biomass) of organisms you anticipate on the site at any given time
Please see attached list, Page 21.		
2.		
3.		
4.		
5.		

B. Do you intend to possess, transport, or sell whole or roe-on scallops? Yes No

If you answered "yes" please contact the Bureau of Public Health to discuss you plans at the following email: DMRPublicHealthDiv@maine.gov

Note: If you are proposing to grow molluscan shellfish, this application also serves as your written operational plan as required in the National Shellfish Sanitation Program (NSSP) Model Ordinance Chapter 2 and must be maintained in your files. If you wish to submit an operational plan separate from this application, please contact: DMRPublicHealthDiv@maine.gov

5. VICINITY MAP – Page 23

Note: Please label as: ‘Vicinity Map’.

Directions: Using a NOAA Chart or USGS topographic map, show the area within a minimum of one-half mile of the proposed lease site.

The map needs to display the following:

- The waters, shore lands, and lines of mean high and mean low water within the general area of the lease
- An arrow indicating true north
- A scale bar
- The approximate lease boundaries

6. BOUNDARY DRAWING – Page 24

Note: Please label as: ‘Boundary Drawing’.

Directions: Depict the boundaries of the proposed lease site. Provide a drawing with all corners, directions, and distances labeled. Provide coordinates for each corner as follows:

- Coordinate Description
Provide geographic coordinates for each corner of the lease site in latitude and longitude as accurately as possible (e.g., to the nearest second or fraction of a second). Identify the datum from the map, chart, or GPS unit used to develop these coordinates. The datum will be shown on the map or chart you are using. The Coordinate Description may be provided separately from the Boundary Drawing.

7. SITE DEVELOPMENT

Directions: If your operations require the use of cages, nets, ropes, trays, or any object (structure) other than the organism to be grown directly on the bottom or buoys to mark the corners of the lease site, you must submit gear drawings and maximum structure schematics (information below). This section is intended to provide accurate plans depicting the physical structures to be placed in the proposed area. All dimensions need to be labeled with the appropriate units (i.e. 10ft, 10in). If you are proposing a bottom lease (no gear), please skip to question “F. Marking”.

Note: You may embed the schematics within the document or attach them to the end of your application. If you attach the schematics, please label them according to the instructions provided below.

A. Gear Information

Directions: Include a drawing of an individual piece of gear for each of the gear type(s) you plan to use. Include units referenced (i.e. 10in, 10ft, etc.).

1. Gear Drawing: Please include the following for each gear type that will hold organisms to be cultured (e.g. Polar circles, marine algae longlines, oyster cages) and label as “Gear Drawing”. This view must show the following:
 - Length, width, and height of each gear type.
2. Gear Table: List and describe each individual gear type that you will use in the table below. (e.g. Polar circles, marine algae longline, oyster cages, moorings, mooring lines, buoys, etc.).

Specific Gear Type <i>(e.g. soft mesh bag)</i>	Dimensions <i>(e.g. 16"x20"x2")</i>	Time of year gear will be deployed <i>(e.g. Spring, Winter, etc.)</i>	Maximum amount of this gear type that will be deployed on the site <i>(i.e. 200 cages, 100 lantern nets, etc.)</i>	Species that will be grown using this gear type
Marine Algae Longline - Please see attached drawing and list – Page 25.	450 ft, each line 3/8 " combo line or polysteel	Year round	15 lines	Marine Algae, Please see species list

B. Maximum Structure and Mooring System Schematic

Directions: Include drawings of your maximum gear layout. Include units referenced (i.e. 10in, 10ft, etc.).

Please see Overhead View and Cross-Section View, pages 26 and 27.

1. Overhead View. Please include the following and label as “Overhead View”:
 - Maximum layout of gear, including moorings.
 - Length and width of project.
 - Approximate spacing between gear.
 - Lease boundaries and the location of proposed corner markers and any additional gear markers that would be present.

2. Cross-Section View. Please include the following and label as “Cross-Section View”:
 - The sea bottom.
 - Profile of gear in cross-section as it will be deployed.
 - Label gear with dimensions and materials.
 - Show mooring gear with mooring type, scope, hardware, and line type and size.
 - Depth of gear in relation to the water’s surface at mean low water and mean high water (if applicable).

Note: Please include an additional Cross Section View, depicting the elements listed below, if there will be seasonal changes to gear layout (i.e. over wintering).

C. On-Site Support Structures

1. Describe structures such as barges, sheds, etc., to be located on-site. Provide a schematic and indicate the dimensions, including height above sea level, materials, etc.
No support structure
2. Describe the storage and use of oil, gasoline or other hazardous materials on this facility. If petroleum products are to be stored on site, provide a spill prevention plan.
No storage

D. Gear Color

Provide the color of the gear and structures proposed to be used at the lease site.
Mooring balls will be either white or red. Line floatation will be either white or orange. Corner markers will be “high flyers” and red.

E. Equipment Layout

Please see pages 28-30

Provide schematic or photographic renderings of the generalized layout of the equipment as depicted from two vantage points on the water. Provide the locations of the two vantage points.

F. Marking

Will you be able to mark your site in accordance with DMR regulations, Chapter 2.80? <input checked="" type="checkbox"/> Yes <input type="checkbox"/> No If you answered no, explain why and suggest alternate markings.

Note: If a lease is granted, you will also be required to mark the site in accordance with appropriate US Coast Guard Regulations. If you have questions about US Coast Guard Regulations contact: 1st Coast Guard District, Aids to Navigation Office ((617)-223-3293).

8. PRODUCTION ACTIVITIES

Directions: If you are cultivating more than one species, you will need to provide information for each species. Please attach additional pages if needed.

- A.** Please explain your proposed seeding activities. What months will seeding occur and how often will you be onsite to seed during this time.

Kelp will be seeded during the period from mid-September to November. It is anticipated a maximum of five days will be required. Dulse will be seeded in the period June to September. It is anticipated that two days will be required. Other species will be seeded throughout the year but in small quantities. Maximum number of days for each species is shown in the species list. Species other than kelp will require one day one site to seed for each species.

- B.** Please explain your proposed tending/maintenance activities.

Gear preparation will begin in August (or June for Dulse) and extend through September. The majority of the work on-site will be cleaning buoys and ropes along with checking and replacing hardware as needed. Buoys and mooring balls are cleaned by hand. Ropes with any remaining crop are left to slowly disintegrate and then epibionts and any remnants of remaining seaweed is stripped off by running a loop of rope along the longline. Only small fragments are released into the water column. Final cleaning of the lines is accomplished in place by tidal currents. If lines are damaged or weakened, they are removed and discarded. If they have no further utility, discarded lines will be taken to the transfer station. If lines are retained and brought on-shore and need to be washed, this operation will be carried out on land with a hose or power washer. Longlines are left in the water throughout the year. There is no off season, only changes in the frequency and types of activities.

- C.** How frequently will you visit/tend the site for routine tending/maintenance (i.e. flipping cages, etc.)?

Once lines are seeded they will be checked every few weeks and at times (mid-winter) only on a monthly basis.

- D.** Describe the harvesting techniques you will use. If you plan on using a drag, please provide the dimensions.

Lines will be either lifted from the water in sections using hand operated or electric winches or brought over the bow of a boat, washed if needed, and harvested by hand. Tips of blades will be trimmed if needed. Kelp will be cut at the base of the blade or stipe with more or less stipe depending on the product. Harvested seaweed will be brought to the dock in totes and hoisted into the back of a truck. The seaweed is washed, if needed, using a gasoline powered deck pump, deck hose, and a two inch nozzle. The rope itself will not routinely washed on the lease. Please see section B.

E. How often will you be at the site during harvesting periods?

Kelp harvesting will take place in the period March through June. We may be on-site up to four to five times a week for a few hours each day if harvesting small quantities for drying or the fresh market. A maximum of five days of continuous daylight harvesting will be required for our largest possible order. Species other than kelp will be harvested throughout the year but in limited quantities.

F. Will gear be on the site year-round? Yes No

G. If gear will not be on the site year-round, please describe any overwintering or “off season” plans for the site. For example, will you remove gear from the site and/or deploy gear in different areas within the proposed site? Please include where gear or product will be located if removed from the site.

There is no off season. Activities outside of kelp harvest will take place year-round. All lines will remain in place throughout the year.

9. NOISE AND LIGHT

Directions: If a question does not pertain to your proposed operations, please write “not applicable” or “N/A.”

A. What type of boats will be used on the site? When and how often will these vessels be on the site?

A 19ft skiff or larger (up to a 28 ft skiff if the present boat is replaced). Presently we have a 19 ft skiff with a 115 hp four-stroke. Also, a 24 ft pontoon boat rigged with davits will be used for harvesting and the boat powered by a 40 hp four-stroke. Both outboards are quiet and efficient. Much of the time outboards will be operated at or near idle. One or both boats will be present throughout the year while work is being performed. Otherwise boats will be hauled out, at the dock, or on a mooring. Generally, we will use one boat at any given time except during large harvests.

B. What type of powered equipment (e.g. generator, power washer, grading equipment, barges, etc.) will be used on the site? When and how often will the equipment be used?

A small deck pump powered by a gas engine will be used as needed during harvesting operations and occasionally at other times. We anticipate that we will have a maximum of 15 to 20 harvest days during the spring season when kelp is harvested. The skiff is equipped with an electric winch which will be used periodically. The electric winch emits very little noise. The deck pump will be used during each harvest day for 5 to 10 minutes periods while kelp is washed. It will be used during daylight hours and primarily in the period April through May. It will only occasionally be used at other times of the year.

C. Specify how you intend to reduce noise levels from the boats and other powered equipment.

The outboards have standard exhaust and are quiet. The deck pump is in a plywood box to protect it and to reduce noise from the gas engine. The electric winch is very quiet. The four-stroke outboard emit very little noise so we feel there is no need to take any action to reduce outboard noise further.

D. Provide the number, type (whether fixtures are shielded), wattage and location of lights, other than those used for navigation or marking, that will be used at the proposed lease site.

No lights will be used.

E. Indicate under what circumstances you might work at your site beyond daylight hours.

We do not anticipate working beyond daylight hours except in the rare emergency when the lease or something or someone outside the lease is endangered.

10. CURRENT OPERATIONS

Directions: If a question does not pertain to your proposed operations, please write “not applicable” or “N/A.”

A. Describe your existing aquaculture operations.

We have been growing seaweed on longlines in Clark Cove for over eight years using gear and equipment described in this application. This activity takes place in DAM CC3x and DAM CC2. The lease in this application if approved will replace DAM CC3x.

B. What are your plans for any existing leases and/or Limited Purpose Aquaculture (LPA) licenses if the lease is granted? Will any existing leases and/or LPA licenses be relinquished if the lease is granted? If so, please indicate which ones.

No change in existing license and there no LPAs. Present lease acronyms are DAM CC3x and DAM CC2. We will continue to use a portion of DAM CC2 and the lease in this application if granted will replace DAM CC3x.

11. ENVIRONMENTAL CHARACTERIZATION

Directions: Using your knowledge of the area, describe the environment of the proposed lease site. Be sure to include units of measurement in your answers (i.e. feet, cm/s).

A. What are the approximate depths at mean low water?

20 – 45 ft

B. What are the approximate depths at mean high water?

32 – 57 ft on a spring tide

C. Provide the approximate current speed and direction during the ebb and flow.

½ to 1 knot maximum in an east-west direction (ebb-flow) with the addition of a counter clockwise gyre in Clark Cove.

D. The following questions (D.1 through D.6) may be answered in writing or by submitting a video. If you plan to submit a video, please contact the Department prior to video collection.

1. What are the bottom characteristics (mud, sand, gravel, rock, ledge or some mix, etc.)?

Primarily soft bottom (mud).

2. Describe the bottom topography (flat, steep rough, etc.).

Sloping from the inner cove to the channel.

3. Describe marine organisms by species or common names. Based on your personal observations or other sources of information, are these species abundant, common, or rare?

Occasional cancer crab, marine worms (abundant), amphipods (abundant), and no attached vegetation.

4. Are there shellfish beds or fish migration routes in the surrounding area? If so, please describe.

There are no appreciable shellfish beds in the immediate area.

It is assumed the main stem of Damariscotta River is a migratory route for alewives and that stripers may be present seasonally. This lease is well removed from the main channel.

5. Describe the presence and extent of submerged aquatic vegetation, i.e. eelgrass, within the proposed lease area. Please include the date of this observation along with the method of observation. If submerged aquatic vegetation is observed, please also describe the abundance below and sketch the limits of the beds in the vicinity map.

There is no eelgrass in the lease area. Bottom video was recorded in 2015. Mapping done in 2005 did not find eelgrass the area.

6. Describe the general shoreline and upland characteristics (rocky shoreline, forested, residential, etc.)

The shoreline is generally rocky with unconsolidated sediments in pockets around the cove. Much of the intertidal sediment is mixed fines with a preponderance of gravel and cobble. There are no large exposed flats. The uplands are mixed hard and softwood, primarily oak, fir, and spruce. There are several mowed fields (one with a long-abandoned apple orchard).

E. Is your proposed lease located within a Maine Department of Inland Fisheries and Wildlife designated Essential Habitat?

Yes No

Note: The location of Essential Habitats in the State of Maine, along with information on how projects within these areas are reviewed, can be found here: <https://www.maine.gov/ifw/fish-wildlife/wildlife/endangered-threatened-species/essential-wildlife-habitat/index.html>

If a project is located within an Essential Habitat, applicants are strongly encouraged to contact the MDIFW Environmental Review Coordinator (John.Perry@maine.gov, phone: 207-287-5254) prior to application submission.

12. EXISTING USES

A. Describe the existing uses of the proposed area in questions A.1 through A.5 below. Please include the a) type; b) time of year the activity occurs; c) frequency; and d) proximity to the lease site.

1. Commercial Fishing

<p>None, as it is an existing experimental lease.</p> <p>There are several locations near the mouth of the cove where lobster buoys have been observed. Occasionally a trap is fished near the lease. No more than half a dozen traps have been observed in Clark Cove at any one time. Seasonally, traps are estimated to be within 50 to 100 feet or more distance from the lease and are fished by a young skiff fisherman. The area actively fished is in the <u>main stem of the Damariscotta and is well removed from the lease.</u></p>
<p>2. Recreational Fishing</p>
<p>There may occasionally be recreational fishing in the cove but none has been observed in the lease area. It would not be surprising to see mackerel fishing though.</p>
<p>3. Boating Activities (please also include the distance to any navigable channel(s) from your proposed site at low water).</p>
<p>The lease is approximately 500 feet from the navigation channel and the main stem of the Damariscotta River. There are lobster boats, mussel and oyster work boats, and several sailboats that transit the cove but not the proposed lease area. The boat navigation was reviewed and approved by the harbor master as part of the experimental lease application process.</p>
<p>4. Riparian Ingress/Egress</p>
<p>The boat navigation was reviewed and approved by the harbor master as part of the experimental lease application process. No part of the lease interferes with existing moorings or docks. Please see graphic on page 30. This has been validated during the three years of the operation of the experimental lease.</p>
<p>5. Other uses (kayaking, swimming, etc.):</p>
<p>Occasionally a kayak is seen in the cove and swimming is limited to docks and floats.</p>

B. Are there private docks, moorings, or other access points within 1,000 feet of the proposed lease? If yes, please include approximate distance from the proposed lease.

There are three docks in the cove. Distances from the lease vary from 475 feet to 600 ft. There is a mooring near the lease inner boundary (Pemaquid Mussel) and others throughout the cove at distances of approximately 300 to 600 feet.

C. Are there public beaches, parks, docking facilities or federally, state, or municipally conserved lands within 1,000 feet of the proposed lease site? If yes, please describe and include approximate distances from proposed lease.

No

13. EXCLUSIVE USE

If your lease is granted, what activities would you request be excluded from occurring within the boundaries of the lease site? In your answer please address applicable commercial and recreational fishing, boating activities, and other activities you listed in the 'Existing Uses' section of this application.

We request exclusive use of the lease. As this is an existing experimental lease with a similar provision, there would be no change. We have in the past grown seaweed year round and wish to have the ability to continue on a year-round basis.

14. RIPARIAN LANDOWNERS AND SITE ACCESS

Please see Page 31 for Tax Map.

A. If your lease is within 1,000ft of shorefront land (which extends to mean low water or 1,650 ft. from shore, whichever is less), the following supporting documents are required:

1. A labeled copy of a tax map(s) depicting the location of the proposed lease site and including the following elements:
 - Label the map “Tax Map: Town of (name of town).”
 - Legible scale
 - Tax lot numbers clearly displayed
 - The boundaries of the proposed lease
2. Please use the Riparian Landowner List (included on the next page) to list the name and address of every shorefront landowner within 1,000ft of the proposed lease site. Have the tax collector or clerk of the municipality certify the list.
3. If any portion of the site is intertidal, you need to complete the steps outlined in the section titled: “19. Landowner/Municipal Permission Requirements”.

B. Will your access to the lease area be across riparian land?

Yes No

Note: If you selected yes, you will need to complete the landowner permission requirements included in “19. Landowner/Municipal Permission Requirements” of this application.

C. How will you access the proposed site?

By boat from docks and floats owned by Tom Myers.

D. How will your proposed activities affect riparian ingress and egress?

It will not affect either.

RIPARIAN LANDOWNER LIST

****THIS LIST MUST BE CERTIFIED****

On this list, please show the current landowners' names and mailing addresses as listed in the municipal tax records for all riparian shorefront parcels within 1,000 feet of the proposed lease site along with the map and lot number for each parcel. **It is the applicant's responsibility to assemble the information for the Town Clerk to certify.** The Town Clerk *only* certifies that the information is correct according to the Town's records. Once you have completed the form, ask the Town Clerk to complete the certification section below. If the parcels are within more than one municipality, provide a separate, certified riparian list for each municipality.

TOWN OF: South Bristol

MAP #	LOT #	Landowner name(s) and address(es)
28	7	University of Maine Darling Marine Center Walpole, Maine 04573
28	8	Rounds Revocable Trust (John + Peter and Joan McVickar) 7 Orchard Drive Walpole, Maine 04573
28	5	John and Athar Rounds 7 Orchard Drive Walpole, Maine 04573
28	3	David Rice P.O. Box 15 Walpole, Maine 04573
28	2	Clark Cove Enterprises, LLC c/o Thomas Myers P.O. Box 78 Walpole, Maine 04573
27	23	Dirk and Linda Brunner 331 Clarks Cove Road Walpole, Maine 04573

Please use additional sheets if necessary and attach hereto.

CERTIFICATION

I, Brenda Bartlett, Town Clerk for the Town of South Bristol certify that the names and addresses of the property owners listed above, as well as the map and lot numbers, are those listed in the records of this municipality and are current as of this date.

SIGNED: Brenda Bartlett DATE: 1/27/2021

15. TECHNICAL CAPABILITY

Provide information regarding professional expertise. Attaching resume or documentation of practical experience necessary to accomplish the proposed project would satisfy this requirement.

My Partner, Peter Fischer, and I have been growing seaweed in Clark Cove for nine years. Peter Fischer has extensive experience in the seafood industry with more than 30 years in sales and many years in mussel aquaculture. Seth Barker (applicant) has a Marine Biology background and has worked closely with Maine Sea Grant and the University of Maine on seaweed farming techniques.

16. FINANCIAL CAPABILITY

A. Financial Capability

Please provide documentation to show you have the financial resources to implement the proposal. For example, you may submit a letter from a financial institution or funding agency indicating that you have an account in good standing, or their willingness to commit funds.

Note: Any financial information you submit with your application is part of the public record. Please exercise discretion when submitting financial information.

Please see letter from our bank, page 33.

B. Cost Estimates

Please provide cost estimates of the proposed aquaculture activities.

Approximately \$10,000 per year.

17. ESCROW ACCOUNT OR PERFORMANCE BOND

Check the category that describes your operation:

Check Here	Lease Category	Amount of Required Escrow or Performance Bond
<input type="checkbox"/>	No gear/structure, no discharge	None
<input type="checkbox"/>	No gear/structure, discharge	\$500.00
<input type="checkbox"/>	≤ 400 square feet of gear/structure, no discharge	\$1,500.00
<input checked="" type="checkbox"/>	>400 square feet of gear/structure, no discharge	\$5,000.00*
<input type="checkbox"/>	Gear/Structure, discharge	\$25,000.00

*DMR may increase the bond/escrow requirements for leases with more than 2,000 square feet of structure.

I, (printed name of applicant) Seth Barker have read DMR Aquaculture Regulations Chapter 2.64(10) (D) and if this proposed lease is granted by DMR, I will either open an escrow account or obtain a performance bond, in the amount determined by the lease category.



3/3/2021

Applicant Signature

Date

Note: Add title if signing on behalf of a corporate applicant.

MANAGING PARTNER

ADDITIONAL APPLICANTS: Each applicant must sign this section indicating that they will open an escrow account or obtain a performance bond. Use the space below for additional persons listed on the application. You may attach additional pages, if necessary.

I, (printed name of applicant) Peter Fischer have read DMR Aquaculture Regulations Chapter 2.64(10) (D) and if this proposed lease is granted by DMR, I will either open an escrow account or obtain a performance bond, in the amount determined by the lease category.



3/3/21

Applicant Signature

Date

Note: Add title if signing on behalf of a corporate applicant.

18. APPLICANT SIGNATURE PAGE

I hereby state that the information included in this application is true and correct. I have also read and understand the requirements of the Department's rules governing aquaculture and the application instructions pertaining to the standard lease process.

Printed name: Seth Barker

Title (if corporate applicant): Managing Partner

Signature:  Date: 3/3/2021

18 U.S.C. Section 1001 provides that: Whoever, in any manner within the jurisdiction of any department or agency of the United States knowingly and willfully falsifies, conceals, or covers up any trick, scheme, or disguises a material fact or makes any false, fictitious or fraudulent statements or representations or makes or uses any false writing or document knowing same to contain any false, fictitious or fraudulent statements or entry, shall be fined not more than \$10,000 or imprisoned not more than five years or both.

Note:

- All applicants must sign and date this page. Please use the space below, if additional signatures are required.
- Corporate applicants, please be sure to include the title(s) (i.e. President, Treasurer, etc.) of the individual(s) signing on the company's behalf.

Additional Applicant:

Printed name: Peter Fischer

Title (if corporate applicant): Managing Partner

Signature:  Date: 3/3/21

19. LANDOWNER/MUNCIPAL PERMISSION REQUIREMENTS (if applicable)

Directions: If any portion of the site is intertidal, you need to complete the steps outlined below.

N/A

Step I: Obtain written permission from all intertidal landowners.

Pursuant to DMR Regulations Chapter 2.10(3)(G) the Department requires *written permission of every owner of intertidal land in, on, or over which the activity will occur.* It is your responsibility to obtain written permission and include it with your application materials. Please note that the Department does not provide forms for landowner permission.

N/A

Step II: Determine if the municipality where your site is located has a shellfish conservation program.

Pursuant to 12 MRSA §6072(3) *In any municipality with a shellfish conservation program under section 6671, the Commissioner may not lease areas in the **intertidal zone** within the municipality without the consent of the municipal officers.*

If the municipality where the proposed lease site is located has a shellfish conservation program, it is your responsibility to obtain consent for the proposed lease site from the municipal officers (i.e. the selectmen or councilors of the town, or the mayor and aldermen or councilors of a city.) Consent means a majority vote of the municipal officers as recorded in a public meeting.

It is your responsibility to contact the municipality and determine if they have a shellfish conservation program. Best practices would include discussing your plans with shellfish committee members, but only the consent of municipal officers is required.

Does the municipality, where the proposed site is located, have a shellfish conservation program? Yes No

N/A

If you answered yes, please attach documentation from a public meeting demonstrating that a majority of municipal officers have consented to your proposal.

4.A Species Information				
Scientific Name	Common Name	Source of Seed Stock	Biomass (lbs)	Seasonality/ Duration
<i>Saccharina latissima</i>	sugar kelp	Spring Tide, LLC, Gouldsboro, ME	40,000	September to June 300 days
<i>Saccharina angustissima</i>	skinny kelp	Spring Tide, LLC, Gouldsboro, ME	5,000	September to June 300 days
<i>Alaria esculenta</i>	winged kelp	Spring Tide, LLC, Gouldsboro, ME	5,000	October to May 240 days
<i>Laminaria digitata</i>	horsetail kelp	Spring Tide, LLC, Gouldsboro, ME	5,000	October to May 240 days
<i>Agarum cribrosum</i>	sea colander	Spring Tide, LLC, Gouldsboro, ME	100	October to May 240 days
<i>Palmaria palmata</i>	dulse	Spring Tide, LLC, Gouldsboro, ME	1,000	Year-round 365 days
<i>Porphyra umbilicalis</i>	nori	Spring Tide, LLC, Gouldsboro, ME	100	Year-round 365 days
<i>Chondrus crispus</i>	Irish sea moss	Spring Tide, LLC, Gouldsboro, ME	100	Year-round 365 days
<i>Ulva lactuca</i>	sea lettuce	Spring Tide, LLC, Gouldsboro, ME	100	Year-round 365 days
<i>Gracilaria tikvahiae</i>	gracilaria (no common name)	Spring Tide, LLC, Gouldsboro, ME	100	April to October 210 days
<i>Chorda tomentosa</i>	sea lace	Spring Tide, LLC, Gouldsboro, ME	100	October to May 240 days

Agardhiella tenera	agardiella (no common name)	Spring Tide, LLC, Gouldsboro, ME	100	October to May 240 days
Desmerestia viridis	sour weed	Spring Tide, LLC, Gouldsboro, ME	100	Year-round 365
Scytosiphon lomentaria	scytosiphon (no common name)	Spring Tide, LLC, Gouldsboro, ME	100	October to May 240 days
Petalonia fascia	sea petals	Spring Tide, LLC, Gouldsboro, ME	100	October to May 240 days

Spring Tide, LLC operates a hatchery in Gouldsboro.

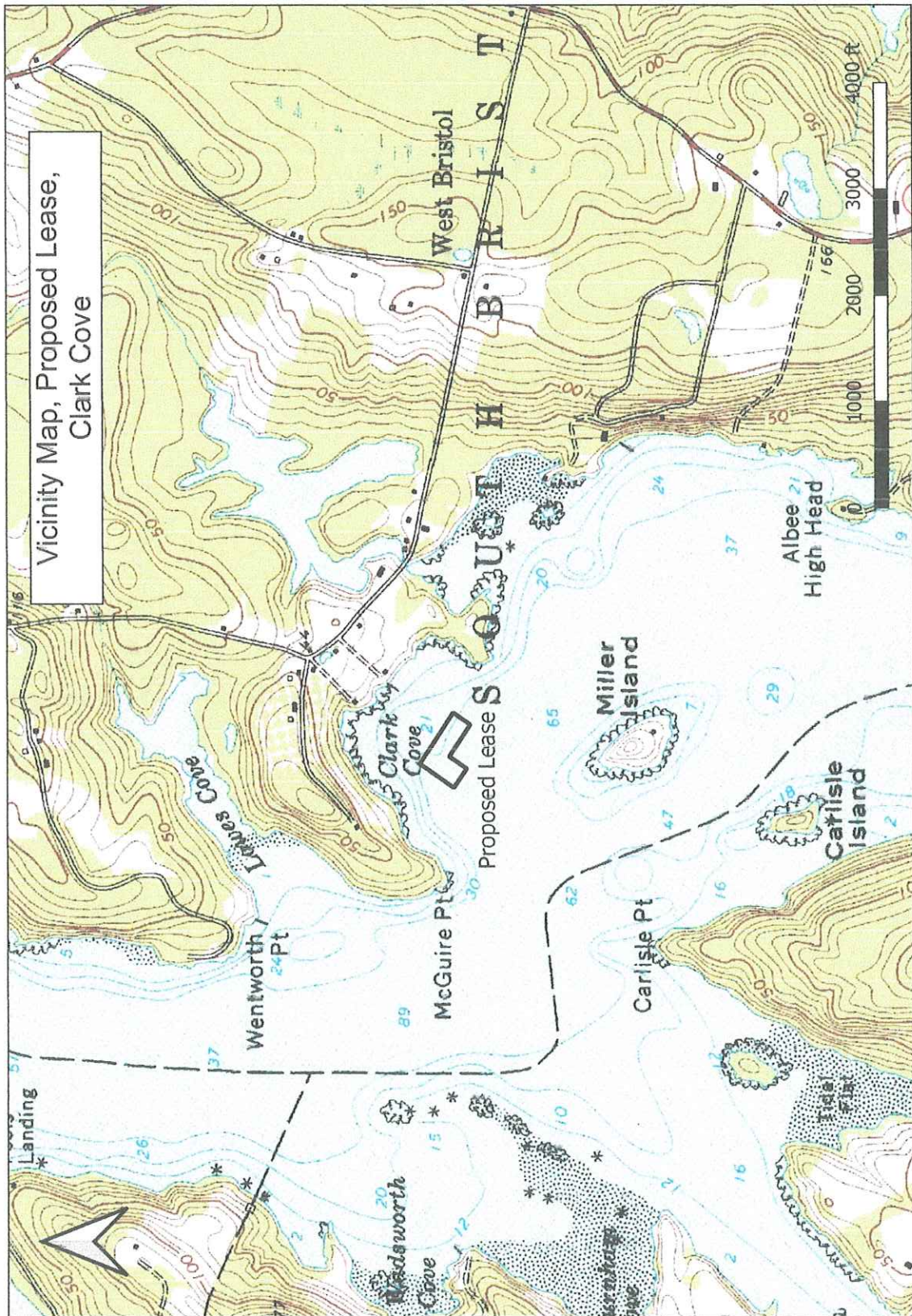



Boundary Drawing Lease Boundaries as determined by the GIS application QGIS (shape file available).

Distances (ft)	
1-2	359.9
2-3	200.4
3-4	217.9
4-5	394.5
5-6	575.9
6-1	195.8

Corner Locations (NAD83) ID, Latitude, Longitude
1, 43.928941, -69.572417
2, 43.929479, -69.573563
3, 43.929022, -69.573986
4, 43.929355, -69.574672
5, 43.930249, -69.573828
6, 43.929385, -69.571999

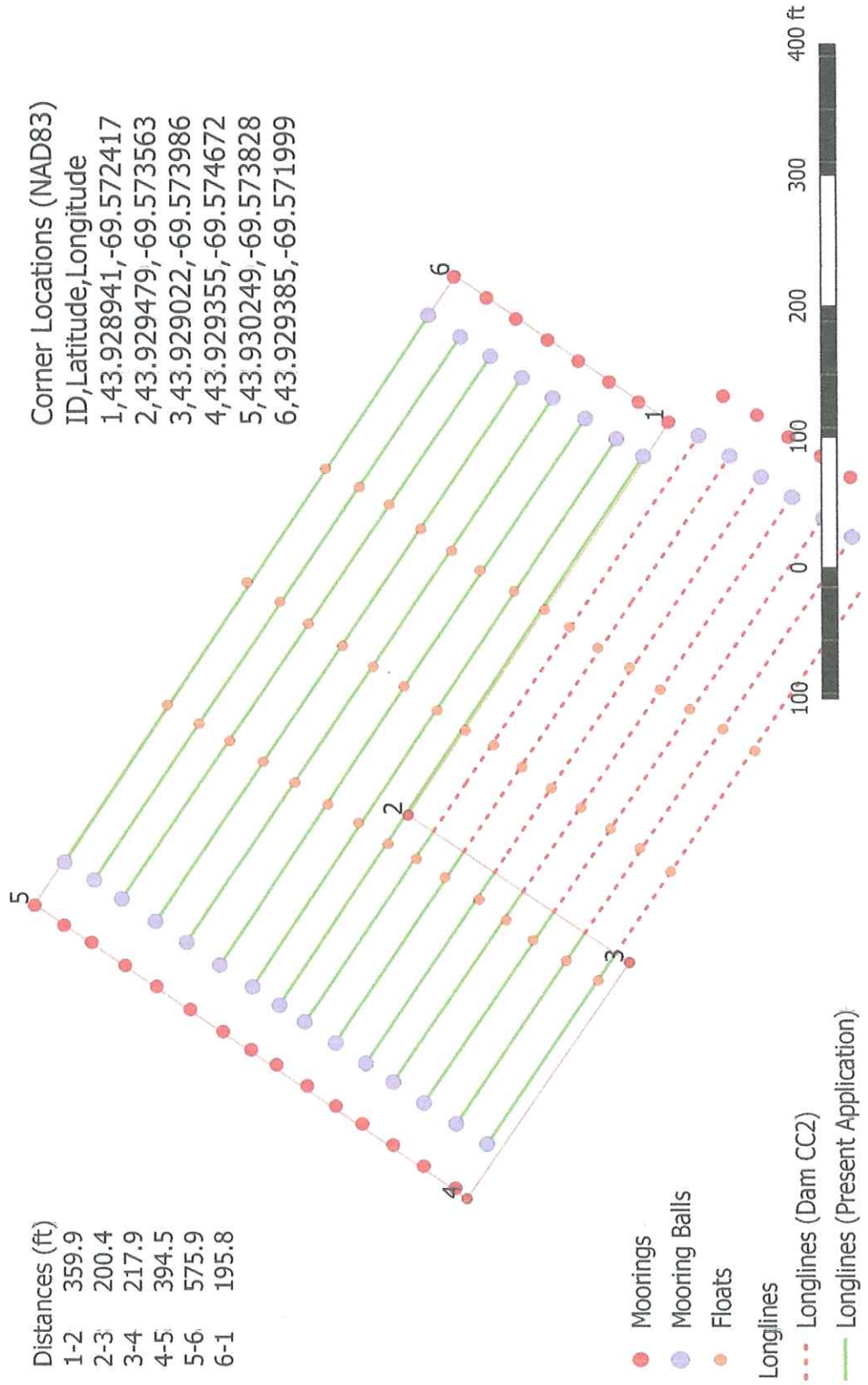

7.A.1 and 2. Gear Drawing with list of components in Gear Table,

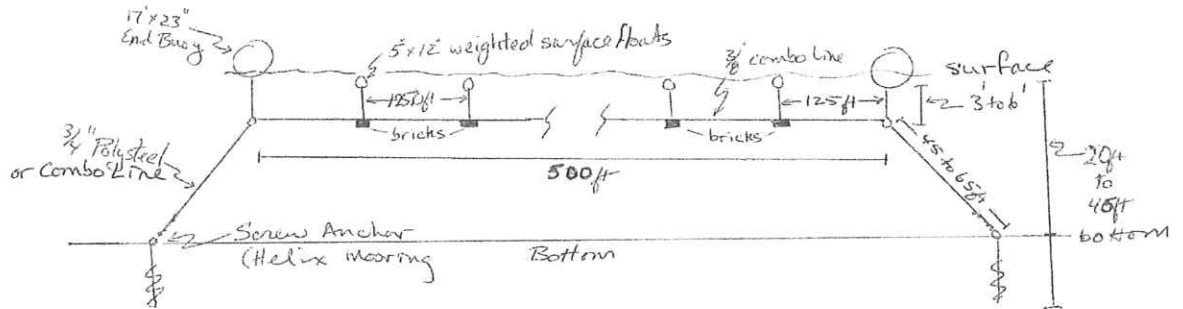

Helix Anchors - H1066 anchors (10" x 5') or larger

3/4" Anchor Chain and shackles (15' each anchor)

3/4" Polysteel or Combo rope (polyester/polypropylene strands), Anchor line and connecting legs

3/4" Thimbles

3/4" Connecting shackles

17" x 23" End floats

5" x 12" Longline floats

3" x 8" Brick - Longline weights

3/8" Neutrally buoyant longline (combo line).

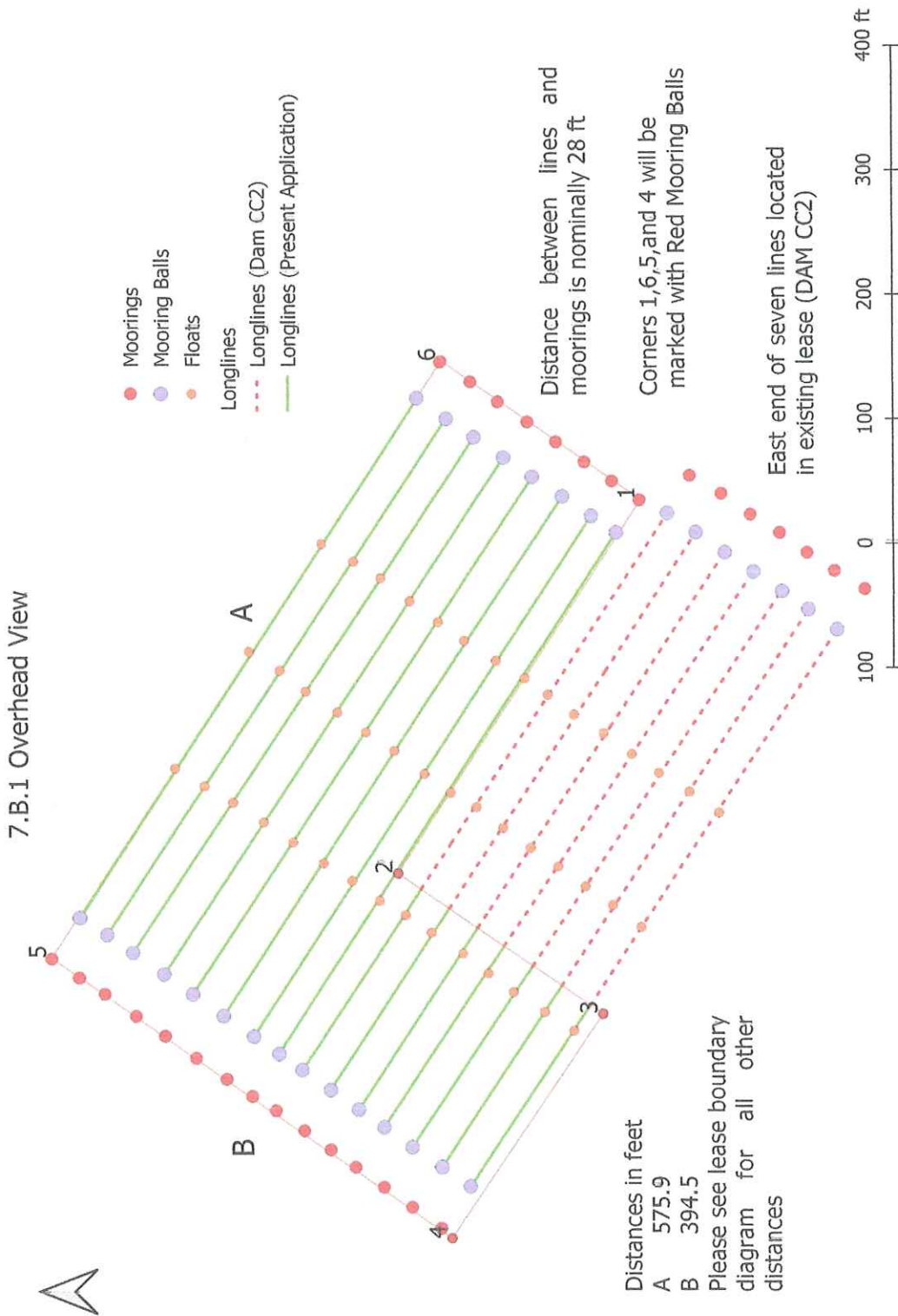

7.B.2. Cross Section View

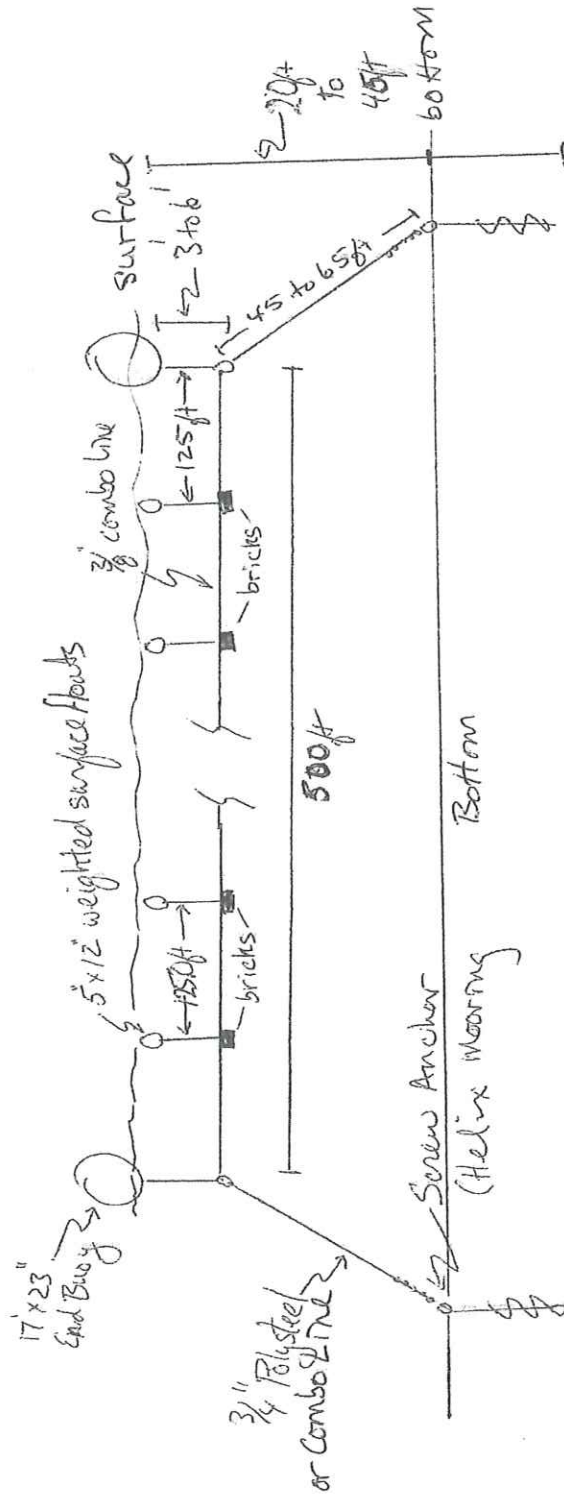

Gear Layout – Vantage Point Map.



Gear Layout – Vantage Point A

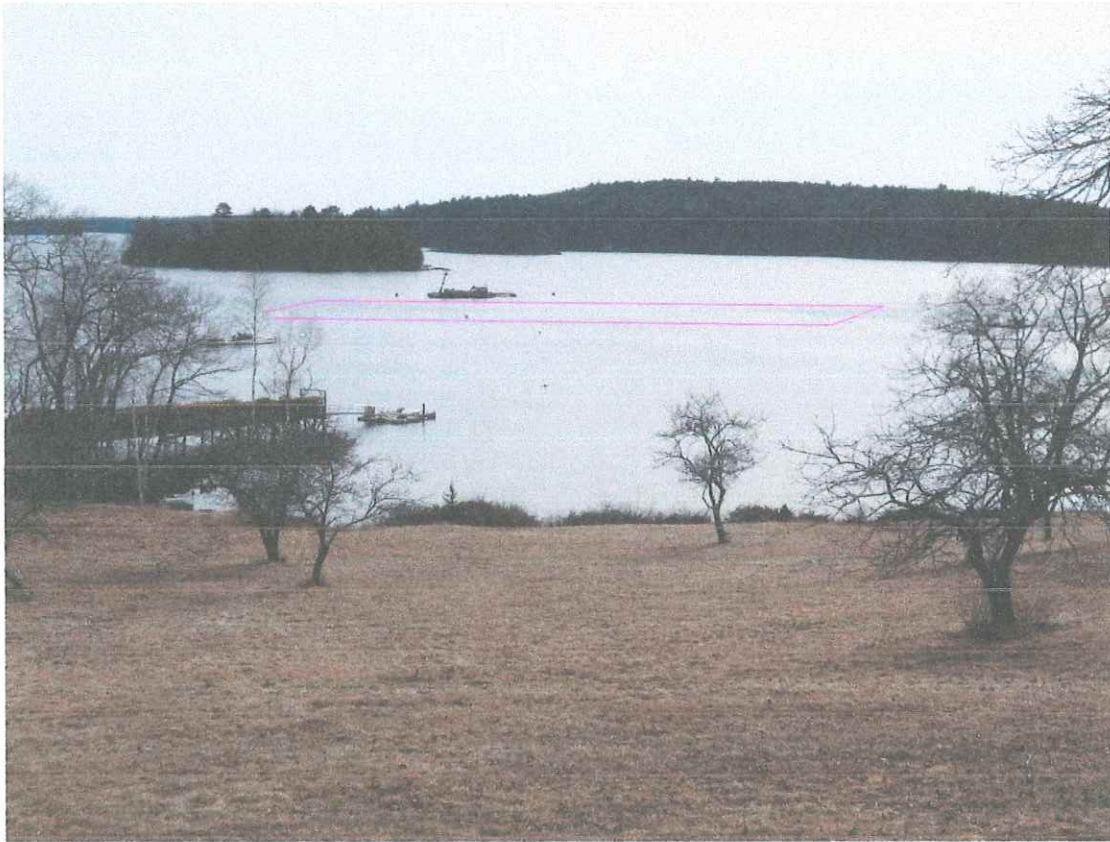

Gear located in magenta box.

Gear Layout – Vantage Point B



Gear located in magenta box?

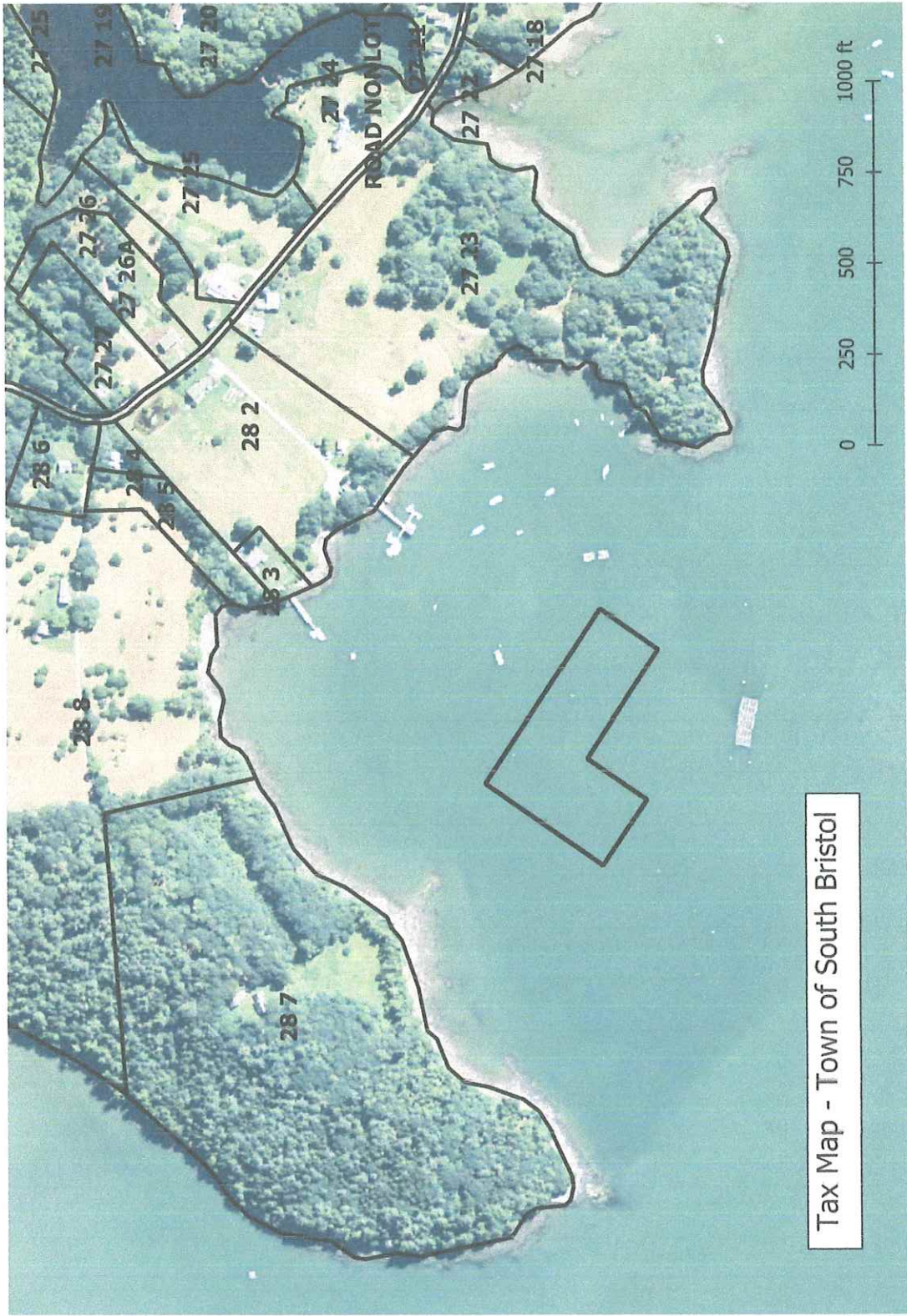

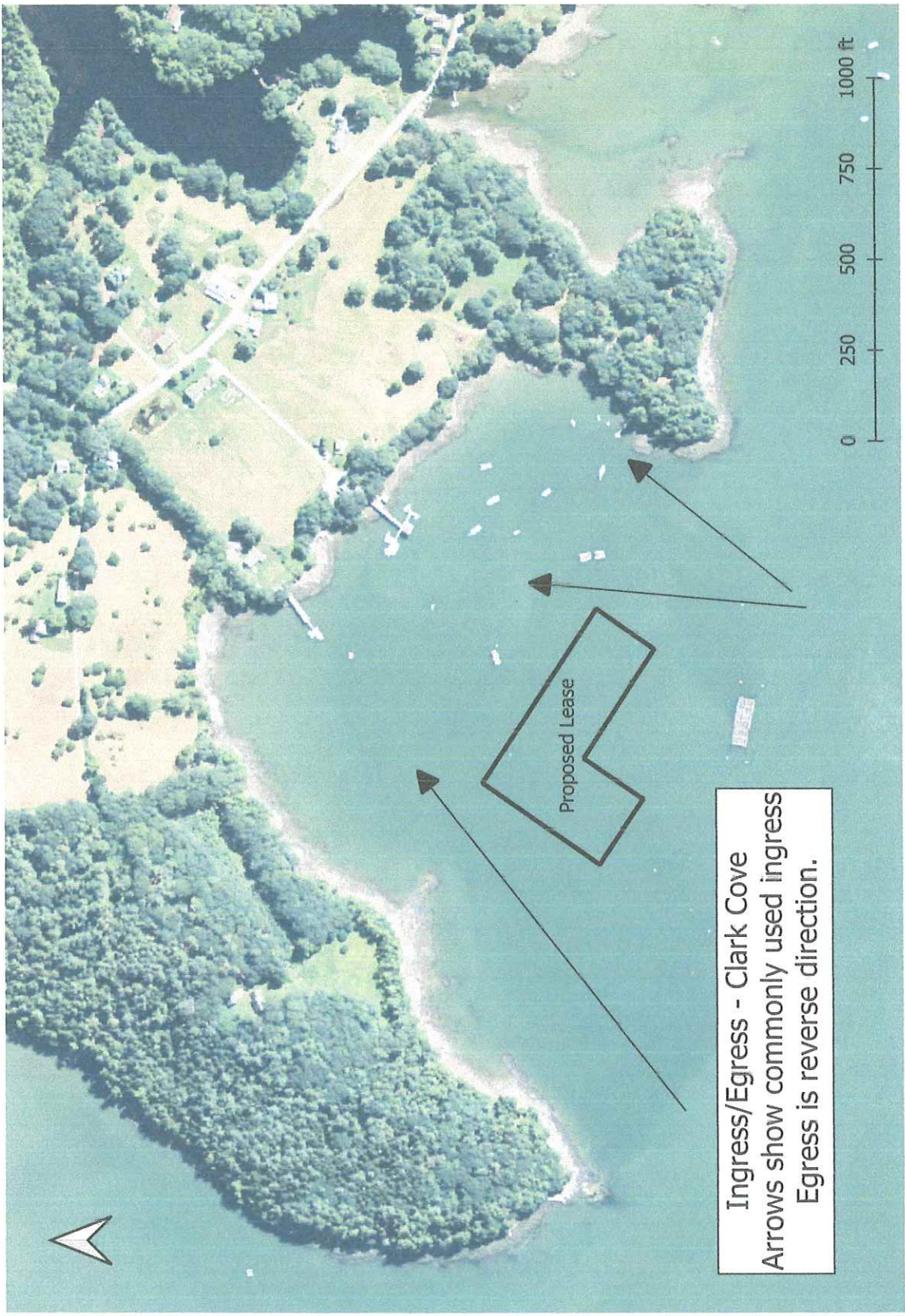

Ingress/Egress - Clark Cove
 Arrows show commonly used ingress
 Egress is reverse direction.

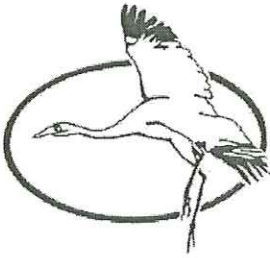

Clarks Cove Enterprises
319 Clarks Cove Road
Walpole, ME 04573
207.563.7121

April 14, 2020

To whom it may concern:

This is to certify that Maine Fresh Sea Farms LLC is current in its payments for wharfage to Clarks Cove Enterprise, located in Walpole Maine. Fresh Sea Farms LLC has shoreline access over CCE docks.

Clarks Cove Enterprises maintains the wharf and provides parking and allows product to be taken ashore across the wharf-from adjoining aquaculture leases in return for rent.

Please feel free to contact me at becky@anatomytrains.com with any questions you might have.

Kind Regards,

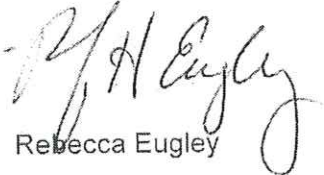
Rebecca Eugley



MAINE DEPARTMENT OF MARINE RESOURCES

Aquaculture Division, 21 State House Station, Augusta, ME 04333-0021 (207) 624-6567

CORPORATE APPLICANT FORM
For Standard and Experimental Aquaculture Lease Applications

Corporations or partnerships that apply for aquaculture leases in the State of Maine must complete this form. Corporations must submit information as requested under A. Corporate Applicant. Partnerships must submit information as requested under B. Partnership Applicant.

A. Corporate Applicant

Note: You must attach a copy of the Articles of Incorporation (Inc.) or Certificate of Formation (LLC) to your application.

- 1. Name of Corporation: Maine Fresh Sea Farms LLC
- 2. Date of incorporation: 2/20/14 State of incorporation: Maine
- 3. List the names, addresses, and titles of all officers:

Name	Address	Title
Peter Fischer	256 Lower Round Pond Road, Bristol, Maine 04539	Managing Member
Seth Barker	15 Little Pond Road, East Boothbay, Maine 04544	Managing Member

Please use additional sheets if necessary and attach to the application.

- 4. List the names and addresses of all directors/members:

Name	Address
N/A	

Please use additional sheets if necessary and attach to the application.

5. Has the corporation, or any stockholder, director, or officer applied for an aquaculture lease for Maine lands in the past? Yes No

Peter Fischer is also a Managing Member of Pemaquid Mussel Farms LLC (PMF). PMF currently manages two aquaculture leases.

1) DAM CC2 – This lease is held by Damariscove Seafood LLC. Peter Fischer is the only member of Damariscove Seafood LLC. It is managed by Pemaquid Mussel Farms LLC.

2) EAST GL – This lease is held jointly by Pemaquid Mussel Farms LLC and Timothy Levesque. It is managed by Pemaquid Mussel Farms LLC.

Seth Barker is a managing member of Maine Fresh Sea Farms (MFSF), LLC and applied for and received an experimental lease on behalf of MFSF, DAM CC3x in Clark Cove, Damariscotta River.

6. List the names and addresses of all stockholders who own or control at least 5% of the outstanding stock and the percentage of outstanding stock currently owned or controlled by each stockholder.

Name	Address	Percentage of Owned Stock
Peter Fischer	See above	50%
Seth Barker	See above	50%

Please use additional sheets if necessary and attach to the application.

7. List the names and addresses of stockholders, directors, or officers owning an interest, either directly or beneficially, in any other Maine aquaculture leases, as well as the quantity of acreage from existing aquaculture leases attributed to each such person. If none, write, "None."

Name	Address	Lease Acronym	Acreage
Peter Fischer	See above	DAM CC2	12
Peter Fischer	See above	EAST GL	8.03
Seth Barker	See above	DAM CC3x	3.62

Please use additional sheets if necessary and attach to the application.

8. Has the corporation or any officer, director, member, or shareholder listed in item 5 above ever been arrested, indicted, convicted of, or adjudicated to be responsible for any violation of any marine resources or environmental protection law, whether state or federal?

Yes No

State of Maine



Department of the Secretary of State

I, the Secretary of State of Maine, certify that according to the provisions of the Constitution and Laws of the State of Maine, the Department of the Secretary of State is the legal custodian of the Great Seal of the State of Maine which is hereunto affixed and of the records of formation, amendment, and cancellation of articles of organization of limited liability companies and annual reports filed by the same.

I further certify that MAINE FRESH SEA FARMS LLC is a duly formed limited liability company under the laws of the State of Maine and that the date of formation is February 20, 2014.

I further certify that said limited liability company has filed annual reports due to this Department, and that no action is now pending by or on behalf of the State of Maine to forfeit the articles of organization and that according to the records in the Department of the Secretary of State, said limited liability company is a legally existing limited liability company in good standing under the laws of the State of Maine at the present time.

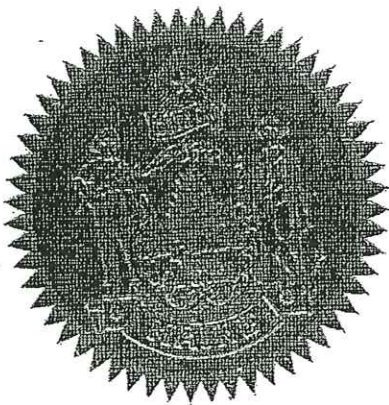

In testimony whereof, I have caused the Great Seal of the State of Maine to be hereunto affixed, given under my hand at Augusta, Maine, this twentieth day of February 2014.

A handwritten signature in cursive script, appearing to read "Matthew Dunlap".

*Matthew Dunlap
Secretary of State*

FTH:

The Registered Agent is a: (select either a Commercial or Noncommercial Registered Agent)

Commercial Registered Agent

CRA Public Number: _____

(Name of commercial registered agent)

Noncommercial Registered Agent

Peter Fischer

(Name of noncommercial registered agent)

256 Lower Round Pond Road, Bristol, Maine 04539

(physical location, not P.O. Box - street, city, state and zip code)

(mailing address if different from above)

SIXTH:

Pursuant to 5 MRSA §105.2, the registered agent listed above has consented to serve as the registered agent for this limited liability company.

SEVENTH:

Other matters the members determine to include are set forth in the attached Exhibit _____, and made a part hereof.

**Authorized person(s)

Dated 2/20/14



(Signature of authorized person)

Peter Fischer

(Type or print name of authorized person)

(Signature of authorized person)

(Type or print name of authorized person)

*Examples of professional service limited liability companies are accountants, attorneys, chiropractors, dentists, registered nurses and veterinarians. (This is not an inclusive list - see 13 MRSA §723.7)

**Pursuant to 31 MRSA §1676.1.A, Certificate of Formation MUST be signed by at least one authorized person.

The execution of this certificate constitutes an oath or affirmation under the penalties of false swearing under 17-A MRSA §453.

Please remit your payment made payable to the Maine Secretary of State.

Submit completed form to:

Secretary of State
Division of Corporations, UCC and Commissions
101 State House Station
Augusta, ME 04333-0101

Telephone Inquiries: (207) 624-7752

Email Inquiries: CEC.Corporations@Maine.gov



223 Main Street
P.O. Box 940
Damariscotta, ME 04543
Phone: 207.563.3195 Ext: 2030
Fax: 207.563.3356
Email: todd.savage@thefirst.com

March 18, 2020

Department of Maine Resources
Attention: Aquaculture Leasing
State House Station
Augusta, Maine 04333-0021

Re: Maine Fresh Sea Farms LLC / Peter R. Fischer and Seth L. Barker

To Whom It May Concern:

Please accept this letter as confirmation that Peter R. Fischer and Seth L. Barker / Maine Fresh Sea Farms LLC have been a customer of First National Bank since February of 2014. They have always kept their accounts in good standing and the Bank looks forward to continuing this relationship.

Sincerely,

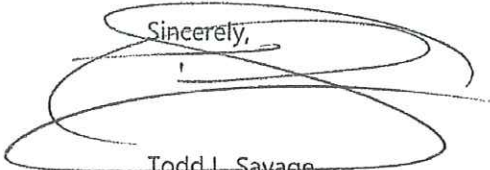

Todd L. Savage
Senior Vice President
Regional Business Relationship Officer

Bangor • Bar Harbor • Blue Hill • Boothbay Harbor • Calais • Camden • Damariscotta • Eastport
Ellsworth • Northeast Harbor • Rockland • Rockport • Southwest Harbor • Waldoboro • Wiscasset

800.564.3195 | thefirst.com | Member FDIC | 