

## STANDARD LEASE APPLICATION: NON-DISCHARGE

### 1. APPLICANT CONTACT INFORMATION

Applicant	Dirigo Marine Resources, LLC		
Contact Person	Gregory Foote		
Address	485 Mitchell Road		
City	Cape Elizabeth		
State, Zip	Maine, 04107		
County	Cumberland		
Telephone	207-200-1092		
Email	gfoote@dirigomarine.com		
Type of Application	<input checked="" type="checkbox"/> Draft Application [submitted before scoping session] <input type="checkbox"/> Final Application [submitted after scoping session]		
Dates	Pre-Application Meeting: 10/17/24	Draft Application Submitted: 1/25/2025	Scoping Session:
Payment Type	Draft Application: <input type="checkbox"/> Check (included) <input checked="" type="checkbox"/> Credit Card		Final Application: <input type="checkbox"/> Check (included) <input type="checkbox"/> Credit Card

**Note:** The email address you list here will be the primary means by which we will contact you. Please provide an email address that is checked regularly. If you do not use email, please leave this blank.

### 2. PROPOSED LEASE SITE INFORMATION

Location of Proposed Lease Site	
Town	South Freeport
Waterbody	Casco Bay
General Description (e.g. south of B Island)	Recompense Cove
Lease Information	
Total acreage requested (100-acre maximum)	6 acres
Lease term requested (20-year maximum)	20 year
Type of culture (check all that apply)	<input type="checkbox"/> Bottom (no gear) <input checked="" type="checkbox"/> Suspended (gear in the water and/or on the bottom)
Is any portion of the proposed lease site above mean low water?	<input type="checkbox"/> Yes <input checked="" type="checkbox"/> No

**Note:** If you selected yes, you need to complete the steps outlined in the section titled: "Landowner/Municipal Permission Requirements".

### 3. GROWING AREA DESIGNATION

**Directions:** Information for growing area designations can be found here:

<https://www.maine.gov/dmr/shellfish-sanitation-management/closures/index.html>

Growing Area Designation (e.g. WL):	WJ
Growing Area Section (e.g. "A1"):	A

**Note:** If you are proposing to grow molluscan shellfish in waters classified as anything other than open/approved, you will need to contact the Bureau of Public Health to discuss your plans at the following email: [DMRPublicHealthDiv@maine.gov](mailto:DMRPublicHealthDiv@maine.gov)

### 4. SPECIES INFORMATION

A. Please complete the table below and add additional rows as needed.

Name of species to be cultivated (include both common and scientific names):	Name and address of the source of seed stock or juveniles	Maximum number (or biomass) of organisms you anticipate on the site at any given time
1. Eastern/American Oyster <i>Crassostrea Virginica</i>	Mook Sea Farms 321 ME-129 Walpole, ME Muscongus Bay Aquaculture 24 Seal Ledge Lane Bremen, ME	1,200,000
2. Sugar Kelp <i>Saccharina latissima</i>	Maine Family Sea Farm 123 Even Keel Road Yarmouth, ME	100,000 lbs
3. Northern Quahog <i>Mercenaria mercenaria</i>	Muscongus Bay Aquaculture 24 Seal Ledge Lane Bremen, ME	300,000
4.		
5.		

B. Do you intend to possess, transport, or sell whole or roe-on scallops? ☐ Yes ☒ No

**If you answered "yes"** please contact the Bureau of Public Health to discuss your plans at the following email: [DMRPublicHealthDiv@maine.gov](mailto:DMRPublicHealthDiv@maine.gov)

**Note:** If you are proposing to grow molluscan shellfish, this application also serves as your written operational plan as required in the National Shellfish Sanitation Program (NSSP) Model Ordinance Chapter 2 and must be maintained in your files. If you wish to submit an operational plan separate from this application, please contact: [DMRPublicHealthDiv@maine.gov](mailto:DMRPublicHealthDiv@maine.gov)

## 5. VICINITY MAP

**Note:** Please label as: 'Vicinity Map'.

**Directions:** Using a NOAA Chart or USGS topographic map, show the area within a minimum of one-half mile of the proposed lease site.

The map needs to display the following:

- The waters, shore lands, and lines of mean high and mean low water within the general area of the lease
- An arrow indicating true north
- A scale bar
- The approximate lease boundaries

## 6. BOUNDARY DRAWING

**Note:** Please label as: 'Boundary Drawing'.

**Directions:** Depict the boundaries of the proposed lease site. Provide a drawing with all corners, directions, and distances labeled. Provide coordinates for each corner as follows:

- Coordinate Description  
Provide geographic coordinates for each corner of the lease site in latitude and longitude in decimal degrees (e.g., 43.123456 N, -69.123456 W) Identify the datum from the map, chart, or GPS unit used to develop these coordinates. The datum will be shown on the map or chart you are using. The Coordinate Description may be provided separately from the Boundary Drawing.



## 7. SITE DEVELOPMENT

**Directions:** If your operations require the use of cages, nets, ropes, trays, or any object (structure) other than the organism to be grown directly on the bottom or buoys to mark the corners of the lease site, you must submit gear drawings and maximum structure schematics (information below). This section is intended to provide accurate plans depicting the physical structures to be placed in the proposed area. All dimensions need to be labeled with the appropriate units (i.e. 10ft, 10in). If you are proposing a bottom lease (no gear), please skip to question “F. Marking”.

**Note:** You may embed the schematics within the document or attach them to the end of your application. If you attach the schematics, please label them according to the instructions provided below.

### A. Gear Information

**Directions:** Include a drawing of an individual piece of gear for each of the gear type(s) you plan to use. Include units referenced (i.e. 10in, 10ft, etc.).

1. Gear Drawing: Please include the following for each gear type that will hold organisms to be cultured (e.g. polar circles, marine algae longlines, oyster cages) and label as “Gear Drawing”. This view must show the following:
  - Length, width, and height of each gear type.
2. Gear Table: List and describe each individual gear type that you will use in the table below. (e.g. polar circles, marine algae longline, oyster cages, moorings, mooring lines, buoys, etc.).

<b>Specific Gear Type</b> (e.g. <i>soft mesh bag</i> )	<b>Dimensions</b> (e.g. <i>16"x20"x2"</i> )	<b>Time of year gear will be deployed</b> (e.g. <i>Spring, Winter, etc.</i> )	<b>Maximum amount of this gear type that will be deployed on the site</b> (i.e. <i>200 cages, 100 lantern nets, etc.</i> )	<b>Species that will be grown using this gear type</b>
See attached table				



## **B. Maximum Structure and Mooring System Schematic**

**Directions:** Include drawings of your maximum gear layout. Include units referenced (i.e. 10in, 10ft, etc.).

1. Overhead View. Please include the following and label as “Overhead View”:
  - Maximum layout of gear, including moorings.
  - Length and width of project.
  - Approximate spacing between gear.
  - Lease boundaries and the location of proposed corner markers and any additional gear markers that would be present.
2. Cross-Section View. Please include the following and label as “Cross-Section View”:
  - The sea bottom.
  - Profile of gear in cross-section as it will be deployed.
  - Label gear with dimensions and materials.
  - Show mooring gear with mooring type, scope, hardware, and line type and size.
  - Depth of gear in relation to the water’s surface at mean low water and mean high water (if applicable).

**Note:** Please include an additional Cross Section View, depicting the elements listed above, if there will be seasonal changes to gear layout (i.e. over wintering).

## **C. On-Site Support Structures**

- |  |
|--|
| 1. Describe structures such as barges, sheds, etc., to be located on-site. Provide a schematic and indicate the dimensions, including height above sea level, materials, etc.  |
| 16'x16' work float with a 12'x8'x8' structure built on it with a solar array atop the structure. Sorting table would be located underneath the structure.<br>20'x10' work float would house a solar powered oyster tumbler. These floats would be secured with nylon mooring line and 2 helical anchors. |
| 2. Describe the storage and use of oil, gasoline, or other hazardous materials on site. If petroleum products are to be stored on site, provide a spill prevention plan.   |
| No oil, gasoline, or other hazardous materials would be stored on site.  |

#### **D. Gear Color**

Provide the color of the gear and structures proposed to be used at the lease site.

Yellow corner buoys would mark the corners of the lease. Blue, Gray, or Green LD Hardshell buoys mark each longline. Black OysterGro cages and black rigid mesh bags would float on the surface. Work floats and the structure atop the work float would be brown wood and oyster tumbler would be gray metal.

#### **E. Equipment Layout**

Provide schematic or photographic renderings of the generalized layout of the equipment as depicted from two vantage points on the water. Provide the locations of the two vantage points.

#### **F. Marking**

Will you be able to mark your site in accordance with DMR regulations, Chapter 2.80? In part, this requires marker buoys which clearly display the lease ID and the words SEA FARM to be located at each corner of the lease. Effective January 1, 2023, marker buoys need to be yellow and host reflective material.

☒ Yes ☐ No

If you answered no, explain why and suggest alternate markings.

**Note:** If a lease is granted, you will also be required to mark the site in accordance with appropriate US Coast Guard Regulations. If you have questions about US Coast Guard Regulations contact: 1<sup>st</sup> Coast Guard District, Aids to Navigation Office (617-223-3293).

## 8. PRODUCTION ACTIVITIES

**Directions:** If you are cultivating more than one species, you will need to provide the following information for each species. Please attach additional pages if needed.

**A.** Please explain your proposed seeding activities. What months will seeding occur and how often will you be onsite to seed during this time.

We anticipate seeding oysters and quahogs the site in June and July. The oyster and quahog seed would be placed in 2mm mesh bags and placed in cages attached to the longlines. During the seeding process we would be on site everyday.

Kelp would be seeded in late October on 3/8 in longlines. During the seeding process we would be on site everyday.

**B.** Please explain your proposed tending/maintenance activities.

Once the oyster seeds reach approximately 8mm, they would be split and placed in floating mesh bags on the longlines or in floating cages. Oysters would be tumbled, sorted, and culled weekly May through October. Floating mesh bags and cages will be flipped weekly to prevent biofouling.

Kelp is inspected weekly throughout the growing season (Oct-May).

**C.** How frequently will you visit the site for routine tending/maintenance (i.e. flipping cages, etc.)?

We will be onsite Monday-Friday for approximately 5-9 hours per day May-October. We'll be onsite approximately 2-4 hours per week November through April.

**D.** Describe the harvesting techniques you will use. If you plan on using a drag, please provide the dimensions.

Market oysters will be sorted into rigid mesh bags that are attached to longlines and submerged to the ocean floor for two weeks prior to harvest. We will haul the market oysters up from the bottom of the ocean and bring them into the boat. We will hang the mesh bags off the side of the workfloat and wash them one bag at a time following vibrio protocols. Harvesting oysters & quahogs may take place year-round.

Kelp is harvested in May onto a harvesting vessel. It is cut into bags and transported to shore.

**E.** How often will you be at the site during harvesting periods?

Onsite daily, 8am-5pm

**F.** Will gear be on the site year-round? ☒ Yes ☐ No

**G.** Describe any overwintering or “off season” plans for the site. For example, will you remove gear from the site and/or deploy gear in different areas within the proposed site? Please include where gear or product will be located if removed from the site.

For overwintering, we would sink the cages containing the mesh bags with oysters in late December and they would remain sunk until spring. We will remove the majority of the floating surface bags in late December and store them in cold storage until early Spring. The remaining bags will stay on the longlines through the winter.

**H.** Please provide details on any predator control techniques you plan to employ.

None

- I.** Suspended culture gear can attract birds that roost on the gear and defecate, potentially creating a pollution source impacting shellfish held within the gear. In order to comply with the National Shellfish Sanitation Program (NSSP) Model Ordinance (MO), DMR is requiring that applications for the suspended culture of shellfish include a description of mitigation or deterrent measures to minimize the potential pollution impacts of birds at the proposed site. If appropriate, include sketches or photos that clearly depict those measures put into practice.

Examples may include:

- Submerging suspended gear and associated product at a depth sufficient to deter roosting for two weeks before harvest
- Attaching physical deterrents (i.e. zip ties) to gear
- The site is proposed for the culture of seed only
- The site is proposed for the culture of adductor-only scallops (i.e. no other shellfish species would be grown on the site)
- Proposed gear would always be suspended below the surface of the water at a depth sufficient to deter roosting (i.e. as is common for scallop lantern nets)

We sink market oysters to the bottom of the ocean for 2 weeks prior to harvest. We also attach zip ties to all of our floating mesh bags. Floats on the cages will have bird deterrent strips attached.

## 9. NOISE AND LIGHT

**Directions:** If a question does not pertain to your proposed operations, please write “**not applicable**” or “**N/A**”.

- A.** What type of boats will be used on the site? When and how often will these vessels be on the site?

One 14' skiff will be used on site daily 8am-5pm. There may also be a lobster boat used onsite daily 8am-5pm.

**B.** What type of powered equipment (e.g. generator, power washer, grading equipment, barges, etc.) will be used on the site? When and how often will the equipment be used?

See attached table

**C.** Specify how you intend to reduce noise levels from the boats and other powered equipment.

14' skiff has modern 4-stroke outboard motor that cannot be heard from shore. The tumbler will be powered by solar array with a gas generator used solely for back-up.

**D.** Provide the number, type (whether fixtures are shielded), wattage and location of lights, other than those used for navigation or marking, that will be used at the proposed lease site.

None

**E.** Indicate under what circumstances you might work at your site beyond daylight hours.

We would only be working on site beyond daylight hours if there was an impending natural disaster and we needed to remove or secure gear on-site.

## 10. CURRENT OPERATIONS

**Directions:** If a question does not pertain to your proposed operations, please write “**not applicable**” or “**N/A**”.

<b>A. Describe your existing aquaculture operations, including the acronyms of all active leases and/or licenses.</b>
current experimental lease for oysters, sea scallops, quahogs, and blue mussels- CAS RCx current experimental lease for kelp - CAS MOx
<b>B. What are your plans for any existing leases and/or Limited Purpose Aquaculture (LPA) licenses if the lease is granted? Will any existing leases and/or LPA licenses be relinquished if the lease is granted? If so, please indicate which ones.</b>
CAS RCx will transition from experimental to standard.

## 11. ENVIRONMENTAL CHARACTERIZATION

**Directions:** Using your knowledge of the area, describe the environment of the proposed lease site. Be sure to include units of measurement in your answers (i.e. feet, cm/s).

<b>A. What are the approximate depths at mean low water?</b>
5 feet
<b>B. What are the approximate depths at mean high water?</b>
15 feet
<b>C. Provide the approximate current speed and direction during the ebb and flow.</b>
1 knot-1.5 knot South-Southwest on Ebb 1 knot-1.5 knot North on the Flood

<b>D.</b> The following questions (D.1 through D.6) may be answered in writing or by submitting a video. If you plan to submit a video, please contact the Department prior to video collection.
<b>1.</b> What are the bottom characteristics (mud, sand, gravel, rock, ledge or some mix, etc.)?
Mud on bottom with some rocks
<b>2.</b> Describe the bottom topography (flat, steep rough, etc.).
Flat
<b>3.</b> Describe marine organisms by species or common names. Based on your personal observations or other sources of information, are these species abundant, common, or rare?
green crab - common; skeleton shrimp - abundant; rock gunnel - common; sculpin - common; sea squirts - abundant; rock crab - rare; tunicates - abundant
<b>4.</b> Are there shellfish beds or fish migration routes in the surrounding area? If so, please describe.
N/A
<b>5.</b> Describe the presence and extent of submerged aquatic vegetation, i.e. eelgrass, within the proposed lease area. Please include the date of this observation along with the method of observation. If submerged aquatic vegetation is observed, please also describe the abundance below and sketch the limits of the beds in the vicinity map.
During DMR's visit to the site on July 15, 2020 for the Experimental Lease site review the under water assessment found an eelgrass bed with moderate coverage near the northern boundary of the proposed site. Thus far, aquaculture operations seems to be encouraging additional eelgrass growth rather than damaging it.



6. Describe the general shoreline and upland characteristics (rocky shoreline, forested, residential, etc.)

Forest, residential buildings, docks, moorings and sets of stairs associated with Wolfe Neck State Park taht provide public access to the shoreline.

E. Is your proposed lease located within a Maine Department of Inland Fisheries and Wildlife designated Essential Habitat?

☐ Yes ☒ No

**Note:** The location of Essential Habitats in the State of Maine, along with information on how projects within these areas are reviewed, can be found here: <https://www.maine.gov/ifw/fish-wildlife/wildlife/endangered-threatened-species/essential-wildlife-habitat/index.html>

***If a project is located within an Essential Habitat,*** applicants are strongly encouraged to contact the MDIFW Environmental Review Coordinator ([John.Perry@maine.gov](mailto:John.Perry@maine.gov), phone: 207-287-5254) prior to application submission.

F. Describe ice formation in the winter months at the proposed site.

Ice generally forms on mud flats at low tide to the north of the proposed lease location. This ice can flow down to the lease and impact operations in cold years. Over the last 8 years, ice has been observed during 2 winters for 1 week one year and 2 weeks in the second year. Recompense cove does not freeze over anymore, so we do not see extreme ice events.

During periods of extreme cold, any bags left on the surface are pulled from the water and put in cold storage until the threat of ice has passed.

The highest risk of ice is typically the first two weeks of January.

**Note:** Description of ice should incorporate data such as water temperature or ice out date over a ten-year period or observations over several (no less than 5) recent winters from the harbormaster, a municipal official such as a shellfish warden, local harbor committee, Marine Patrol Officer, fishing/aquaculture industry members, or the applicant.

Stating “no ice observed last year” will not be accepted as a complete answer.

## 12. EXISTING USES

<b>A.</b> Describe the existing uses of the proposed area in questions A.1 through A.5 below. Please include the a) type b) time of year c) frequency and d) proximity to the lease site for each existing use.
<b>1. Commercial Fishing</b>
One lobster fisherman has singles set approximately 500'-1000' from the lease boundary and is fishing 3-4 days a week typically late May through late October; Occasional pogy fishing happens inside Recompense Cove and about 1000' from the lease boundary. Pogy fishing happens in this area 2-3 days per week between June-October.
<b>2. Recreational Fishing</b>
Recreational striped fishing happens near (50-100' from the lease site) typically 1-2 days a week in June-July.
<b>3. Boating Activities (please also include the distance to any navigable channel(s) from your proposed site at low water)</b>
Limited use; 2-3 times per month between June-late October casual boaters will come to the lease site to check out what we are doing. Daily the skiffs and workboat from nearby lease CASRC2 pass within 1000' of the lease site.  It is approximately 4,000' to nearest channel.
<b>4. Ingress and egress (i.e. coming and going) of shorefront property owners within 1,000 feet of the proposal (e.g. docks, moorings, landing boats on shore, etc.)</b>
None
<b>5. Other uses (kayaking, swimming, etc.)</b>
2-3 times per month between June-late October kayakers will stop by the lease site. Small recreational boat traffic passes the lease site (usually 500-1000' from the site) 2-3 times per week late May-late October. We have good interactions with both users.

**B.** Are there private docks, moorings, or other access points within 1,000 feet of the proposed lease? If yes, please include approximate distance from the proposed lease.

None

**C.** Are there public beaches, parks, docking facilities or federally, state, or municipally conserved lands within 1,000 feet of the proposed lease site? If yes, please describe and include approximate distances from proposed lease.

None

**D.** Are there any Limited Purpose Aquaculture (LPA) licenses or aquaculture leases within 1,000 feet of your proposed lease site? If yes, please list their acronyms below.

Current and pending aquaculture leases and active LPA licenses may be found here:  
<https://www.maine.gov/dmr/aquaculture/leases/index.html>

CAS RC2 approximately 800' SE of proposed new lease boundary we have discussed our plan with them and they have no concerns.

### 13. RIPARIAN LANDOWNERS AND SITE ACCESS

**A.** If your lease is within 1,000ft of shorefront land (**which extends to mean low water or 1,650 ft. from shore, whichever is less, according to NOAA charts**), the following supporting documents are required:

1. A labeled copy of a tax map(s) depicting the location of the proposed lease site and including the following elements:
  - Label the map “Tax Map: Town of (name of town).”
  - Legible scale
  - Tax lot numbers clearly displayed
  - The boundaries of the proposed lease
2. Please use the Riparian Landowner List (included on the next page) to list the name and address of every shorefront landowner within 1,000ft of the proposed lease site. Have the tax collector or clerk of the municipality certify the list. Refer to the riparian determination guidance document to ensure all riparian landowners are included:  
<https://www.maine.gov/dmr/aquaculture/forms/documents/RiparianDetermination.pdf>
3. If any portion of the site is intertidal, you need to complete the steps outlined in the section titled: “Landowner/Municipal Permission Requirements”.

**B.** Will your access to the lease area be across riparian land?

☐ Yes    ☒ No

**Note:** If you selected yes, you will need to complete the landowner permission requirements included in “Landowner/Municipal Permission Requirements” of this application.

**C.** How will you access the proposed site?

By boat - the skiff is docked at Freeport Town Wharf.

**D.** How will your proposed activities affect riparian ingress and egress?

No impact to riparian ingress or egress.

## RIPARIAN LANDOWNER LIST

*\*THIS LIST MUST BE **CERTIFIED**\**

On this list, please show the current landowners' names and mailing addresses as listed in the municipal tax records for all riparian shorefront parcels within 1,000 feet of the proposed lease site along with the map and lot number for each parcel. **It is the applicant's responsibility to assemble the information for the Town Clerk to certify.** The Town Clerk only certifies that the information is correct according to the Town's records. Once you have completed the form, ask the Town Clerk to complete the certification section below. If the parcels are within more than one municipality, provide a separate, certified riparian list for each municipality.

**TOWN OF:** \_\_\_\_\_

MAP #	LOT #	Landowner name(s) and address(es)
		N/A

**Please use additional sheets if necessary and attach hereto.**

### **CERTIFICATION**

I, \_\_\_\_\_, Town Clerk for the Town of \_\_\_\_\_ certify that the names and addresses of the property owners listed above, as well as the map and lot numbers, are those listed in the records of this municipality and are current as of this date.

**SIGNED:** \_\_\_\_\_ **DATE:** \_\_\_\_\_

## 14. TECHNICAL CAPABILITY

Provide information regarding professional expertise. Attaching resume or documentation of practical experience necessary to accomplish the proposed project would satisfy this requirement.

I have operated on LPAs and Experimental Leases on this site since 2016. Successfully, cultivating Eastern Oysters, sea scallops, and have assisted in growing kelp on other sites in Casco Bay. I have also been a member of the Maine Family Sea Farms Co-op and have served as the President for the past 3 years.

## 15. FINANCIAL CAPABILITY

### A. Financial Capability

Please provide a letter from a financial institution indicating the applicant has an account in good standing.

**Note:** Any financial information you submit with your application is part of the public record. Please exercise discretion when submitting financial information.

In addition to oyster farming, I have a career in renewable energy and energy efficiency sales that provides a substantial backstop for the farm financially.

### B. Cost Estimates

Please provide cost estimates of the proposed aquaculture activities.

Install new anchors & longlines: \$2,800  
Build new bags to support growth: \$18,000  
Additional cages: \$6,000  
Workfloat & Structure: \$12,000

Farm growth will be structured in a phased approach over time as the farm grows.

## 16. ESCROW ACCOUNT OR PERFORMANCE BOND

Check the category that describes your operation:

Check Here	Lease Category	Amount of Required Escrow or Performance Bond
<input type="checkbox"/>	No gear/structure, no discharge	\$500.00
<input type="checkbox"/>	No gear/structure, discharge	\$500.00
<input type="checkbox"/>	≤ 400 square feet of gear/structure, no discharge	\$1,500.00
<input checked="" type="checkbox"/>	>400 square feet of gear/structure, no discharge	\$5,000.00*
<input type="checkbox"/>	Gear/Structure, discharge	\$25,000.00

\*DMR may increase the bond/escrow requirements for leases with more than 2,000 square feet of structure.

I, (*printed name of applicant*) Gregory Foote have read DMR Aquaculture Regulations Chapter 2.64(10) (D) and if this proposed lease is granted by DMR, I will either open an escrow account or obtain a performance bond, in the amount determined by the lease category.

  
**Applicant Signature**  
*Note: Add title if signing on behalf of a corporate applicant.*

5/6/2025

**Date**

**ADDITIONAL APPLICANTS:** Each applicant must sign this section indicating that they will open an escrow account or obtain a performance bond. Use the space below for additional persons listed on the application. You may attach additional pages, if necessary.

I, (*printed name of applicant*) \_\_\_\_\_ have read DMR Aquaculture Regulations Chapter 2.64(10) (D) and if this proposed lease is granted by DMR, I will either open an escrow account or obtain a performance bond, in the amount determined by the lease category.

\_\_\_\_\_  
**Applicant Signature**  
*Note: Add title if signing on behalf of a corporate applicant.*

\_\_\_\_\_  
**Date**

## 17. APPLICANT SIGNATURE PAGE

I hereby state that the information included in this application is true and correct. I have also read and understand the requirements of the Department's rules governing aquaculture and the application instructions pertaining to the standard lease process.

Printed name: Gregory Foote

Title (*if corporate applicant*): Owner

Signature:  Date: 5/6/2025

18 U.S.C. Section 1001 provides that: Whoever, in any manner within the jurisdiction of any department or agency of the United States knowingly and willfully falsifies, conceals, or covers up any trick, scheme, or disguises a material fact or makes any false, fictitious or fraudulent statements or representations or makes or uses any false writing or document knowing same to contain any false, fictitious or fraudulent statements or entry, shall be fined not more than \$10,000 or imprisoned not more than five years or both.

### Note:

- All applicants must sign and date this page. Please use the space below, if additional signatures are required.
- Corporate applicants, please be sure to include the title(s) (i.e. President, Treasurer, etc.) of the individual(s) signing on the company's behalf.

### Additional Applicant:

Printed name: \_\_\_\_\_

Title (*if corporate applicant*): \_\_\_\_\_

Signature: \_\_\_\_\_ Date: \_\_\_\_\_



## 18. LANDOWNER/MUNCIPAL PERMISSION REQUIREMENTS *(if applicable)*

**Directions:** If any portion of the site is intertidal, you need to complete the steps outlined below.

### **Step I: Obtain written permission from all intertidal landowners.**

Obtain written permission from all intertidal landowners. Pursuant to 12 M.R.S.A. §6072(4)(F), the applicant must submit written permission of every riparian owner whose land to the low water mark will be used. The written permission needs to include the parcel and lot number of the shorefront owner(s), whose intertidal property the proposed site occupies, as recorded on the riparian landowner list.

### **Step II: Determine if the municipality where your site is located has a shellfish conservation program.**

Pursuant to 12 MRSA §6072(3) *In any municipality with a shellfish conservation program under section 6671, the Commissioner may not lease areas in the **intertidal zone** within the municipality without the consent of the municipal officers.*

If the municipality where the proposed lease site is located has a shellfish conservation program, it is your responsibility to obtain consent for the proposed lease site from the municipal officers (i.e. the selectmen or councilors of the town, or the mayor and aldermen or councilors of a city.) Consent means a majority vote of the municipal officers as recorded in a public meeting.

It is your responsibility to contact the municipality and determine if they have a shellfish conservation program. Best practices would include discussing your plans with shellfish committee members, but only the consent of municipal officers is required.

Does the municipality, where the proposed site is located, have a shellfish conservation program? <input type="checkbox"/> Yes <input checked="" type="checkbox"/> No
---

**If you answered yes**, please attach documentation from a public meeting demonstrating that a majority of municipal officers have consented to your proposal.



## **MAINE DEPARTMENT OF MARINE RESOURCES**

*Aquaculture Division, 21 State House Station, Augusta, ME 04333-0021 (207) 624-6567*

### **CORPORATE APPLICANT FORM** **For Standard and Experimental Aquaculture Lease Applications**

Corporations or partnerships that apply for aquaculture leases in the State of Maine must complete this form. Corporations must submit information as requested under A. Corporate Applicant. Partnerships must submit information as requested under B. Partnership Applicant.

#### **A. Corporate Applicant**

**Note:** You must attach a copy of the Articles of Incorporation (Inc.) or Certificate of Formation (LLC) to your application.

1. Name of Corporation: Dirigo Marine Resources, LLC

2. Date of incorporation: 7/10/17 State of incorporation: Maine

3. List the names, addresses, and titles of all officers:

<b>Name</b>	<b>Address</b>	<b>Title</b>
Gregory Foote	485 Mitchell Road, Cape Elizabeth, ME 04107	Owner

**Please use additional sheets if necessary and attach to the application.**

4. List the names and addresses of all directors/members:

<b>Name</b>	<b>Address</b>

**Please use additional sheets if necessary and attach to the application.**

5. Has the corporation, or any stockholder, director, or officer applied for an aquaculture lease for Maine lands in the past? ☒ Yes ☐ No

If you selected “yes,” please indicate who applied for the lease and the status of the application or lease.

6. List the names and addresses of all stockholders who own or control at least 5% of the outstanding stock and the percentage of outstanding stock currently owned or controlled by each stockholder.

Name	Address	Percentage of Owned Stock

**Please use additional sheets if necessary and attach to the application.**

7. List the names and addresses of stockholders, directors, or officers owning an interest, either directly or beneficially, in any other Maine aquaculture leases, as well as the quantity of acreage from existing aquaculture leases attributed to each such person based on the percentage of owned stock listed in question 6. If none, write, “None.”

Name	Address	Lease Acronym	Acreage
Gregory Foote	485 Mitchell Road, Cape Elizabeth, ME 04107	CAS RCx	2.99
Gregory Foote	485 Mitchell Road Cape Elizabeth, ME 04107	CAS MOx	3.64

**Please use additional sheets if necessary and attach to the application.**

8. Has the corporation or any officer, director, member, or shareholder listed in item 5 above ever been arrested, indicted, convicted of, or adjudicated to be responsible for any violation of any marine resources or environmental protection law, whether state or federal?

☐ Yes ☒ No

If you selected “yes”, please provide details.

**B. Partnership Applicant**

**Note:** You must attach a copy of either the Certificate of Limited Partnership or documentation of the formation of a General Partnership to your application.

1. Name of Partnership: \_\_\_\_\_

2. Date of formation: \_\_\_\_\_ State of partnership: \_\_\_\_\_

3. List the names, addresses, and ownership shares of all partners:

Name	Address	Ownership Shares

**Please use additional sheets if necessary and attach to the application.**

4. Has the partnership, or any partner applied for an aquaculture lease for Maine lands in the past? ☐ Yes ☐ No

If you selected “yes,” please indicate who applied for the lease and the status of the application or lease.

5. List the names and addresses of any partner owning an interest, either directly or beneficially, in any other Maine aquaculture leases, as well as the quantity of acreage from existing aquaculture leases attributed to each such person, based on their ownership shares from question 3.

Name	Address	Lease Acronym	Acreage

**Please use additional sheets if necessary and attach to the application.**

6. Has the partnership or any partner been arrested, indicted or convicted of or adjudicated to be responsible for any violation of marine resources or environmental protection law, whether State or Federal?

☐ Yes ☐ No

If you selected “yes”, please provide details.

MAINE  
LIMITED LIABILITY COMPANY

STATE OF MAINE

CERTIFICATE OF FORMATION

Filing Fee \$175.00

File No. 20180180DC Pages 2  
Fee Paid \$ 175  
DCN 2172001600041 DLLC  
FILED  
07/10/2017

*Julie R. Fyfe*  
Deputy Secretary of State

A True Copy When Attested By Signature

*Julie R. Fyfe*  
Deputy Secretary of State

Pursuant to 31 MRSA §1531, the undersigned executes and delivers the following Certificate of Formation:

FIRST: The name of the limited liability company is:

Dirigo Marine Resources, LLC

(A limited liability company name must contain the words "limited liability company" or "limited company" or the abbreviation "L.L.C.," "LLC," "L.C." or "LC" or, in the case of a low-profit limited liability company, "L3C" or "l3c" - see 31 MRSA 1508.)

SECOND: Filing Date: (select one)

- ☒ Date of this filing; or  
☐ Later effective date (specified here): \_\_\_\_\_

THIRD: Designation as a low profit LLC (Check only if applicable):

- ☐ This is a low-profit limited liability company pursuant to 31 MRSA §1611 meeting all qualifications set forth here:
- A. The company intends to qualify as a low-profit limited liability company;
  - B. The company must at all times significantly further the accomplishment of one or more of the charitable or educational purposes within the meaning of Section 170(c)(2)(B) of the Internal Revenue Code of 1986, as it may be amended, revised or succeeded, and must list the specific charitable or educational purposes the company will further;
  - C. No significant purpose of the company is the production of income or the appreciation of property. The fact that a person produces significant income or capital appreciation is not, in the absence of other factors, conclusive evidence of a significant purpose involving the production of income or the appreciation of property; and
  - D. No purpose of the company is to accomplish one or more political or legislative purpose within the meaning of Section 170(c)(2)(D) of the Internal Revenue Code of 1986, or its successor.

FOURTH: Designation as a professional LLC (Check only if applicable):

- ☐ This is a professional limited liability company\* formed pursuant to 13 MRSA Chapter 22-A to provide the following professional services:

\_\_\_\_\_  
(Type of professional services)

**FIFTH:** The Registered Agent is a: (select either a Commercial or Noncommercial Registered Agent)

☐

Commercial Registered Agent

CRA Public Number: \_\_\_\_\_

(Name of commercial registered agent)

☒

Noncommercial Registered Agent

Susan Hasson

(Name of noncommercial registered agent)

22 Free Street, Suite 301, Portland, Maine 04106

(physical location, not P.O. Box – street, city, state and zip code)

\_\_\_\_\_  
(mailing address if different from above)

**SIXTH:** Pursuant to 5 MRSA §105.2, the registered agent listed above has consented to serve as the registered agent for this limited liability company.

**SEVENTH:** Other matters the members determine to include are set forth in the attached Exhibit \_\_\_\_\_, and made a part hereof.

**\*\*Authorized person(s)**

Dated 6/7/2017



(Signature of authorized person)

Gregory C. Foote

(Type or print name of authorized person)

(Signature of authorized person)

(Type or print name of authorized person)

\*Examples of professional service limited liability companies are accountants, attorneys, chiropractors, dentists, registered nurses and veterinarians. (This is not an inclusive list – see 13 MRSA §723.7)

\*\*Pursuant to 31 MRSA §1676.1.A, Certificate of Formation **MUST** be signed by at least one authorized person.

The execution of this certificate constitutes an oath or affirmation under the penalties of false swearing under 17-A MRSA §453.

Please remit your payment made payable to the Maine Secretary of State.

Submit completed form to:

**Secretary of State**

**Division of Corporations, UCC and Commissions**

**101 State House Station**

**Augusta, ME 04333-0101**

**Telephone Inquiries: (207) 624-7752**

**Email Inquiries: CEC.Corporations@Maine.gov**

## 5. Vicinity Map

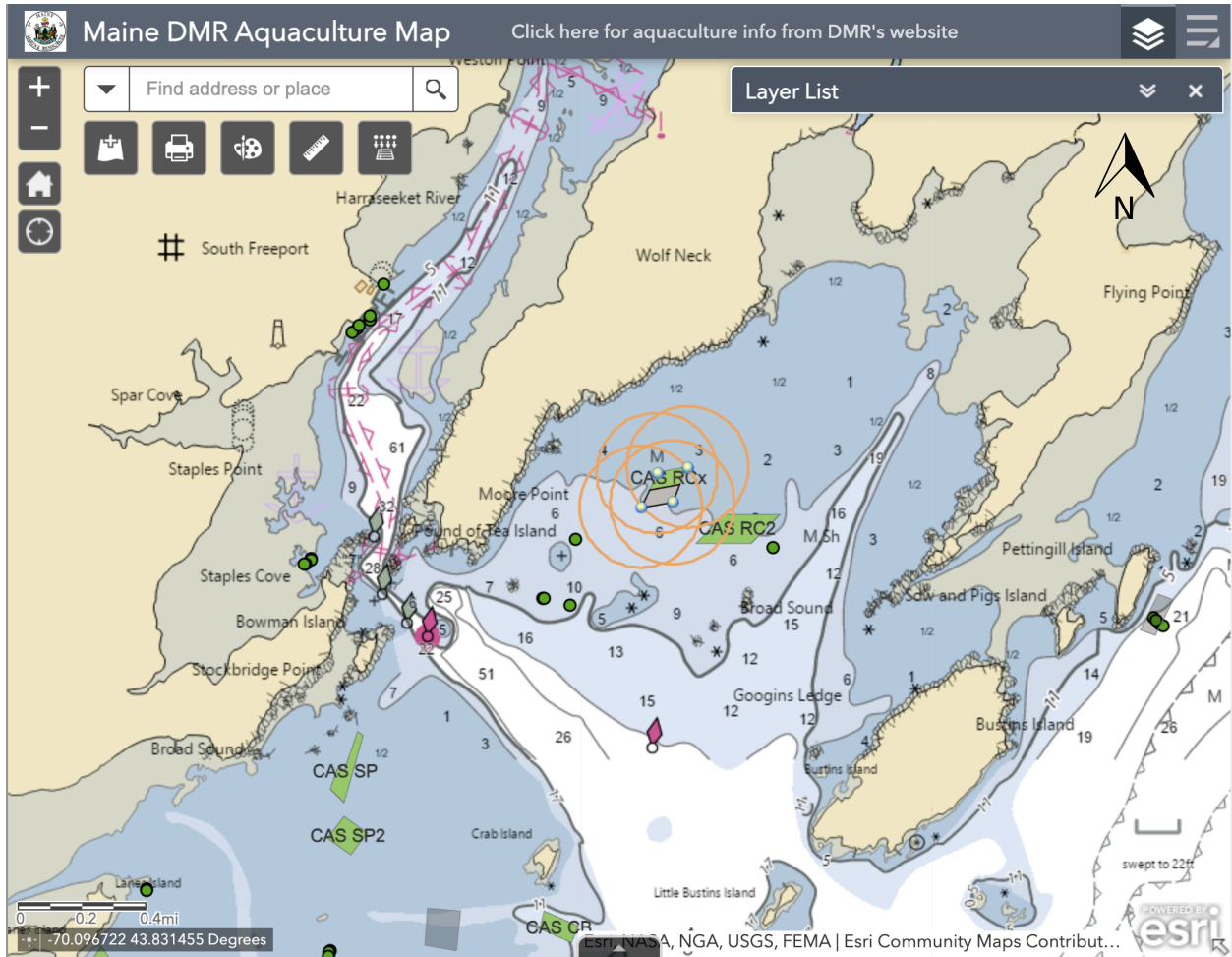



## 6. Boundary Drawing

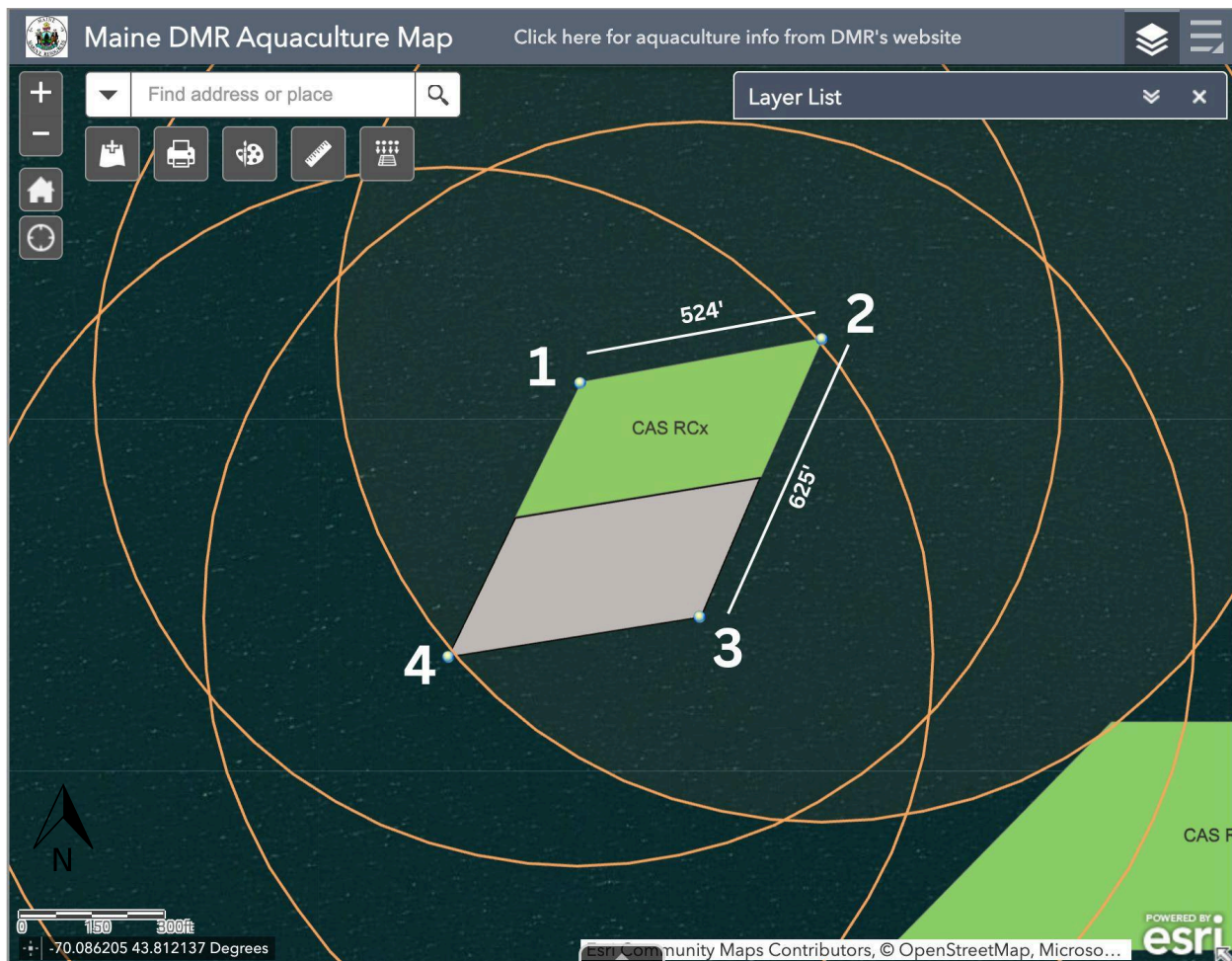

### COORDINATES:

Datum: WGS84 EGM96 Geoid

Corner Label	Latitude	Longitude
1	43.812960	-70.088040
2	43.813178	-70.086089
3	43.811609	-70.087044
4	43.811391	-70.089008

# A. 1. Gear Drawings

## Floating Oyster Cages

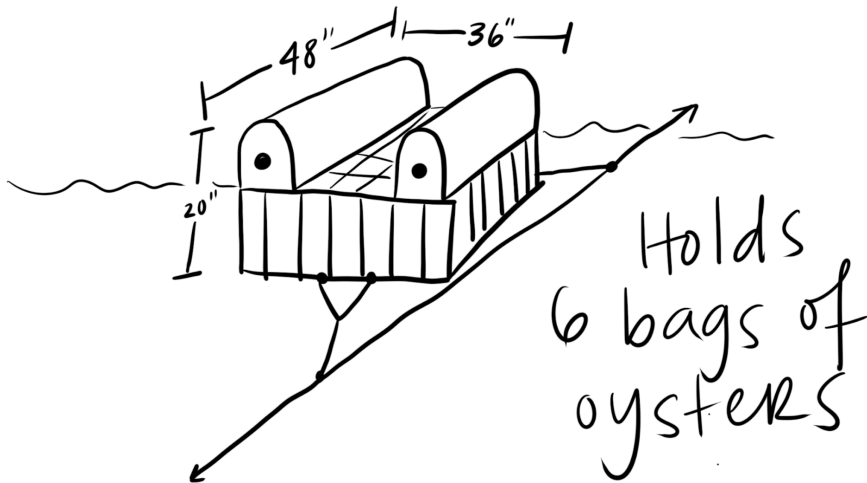

## Floating Oyster Bags

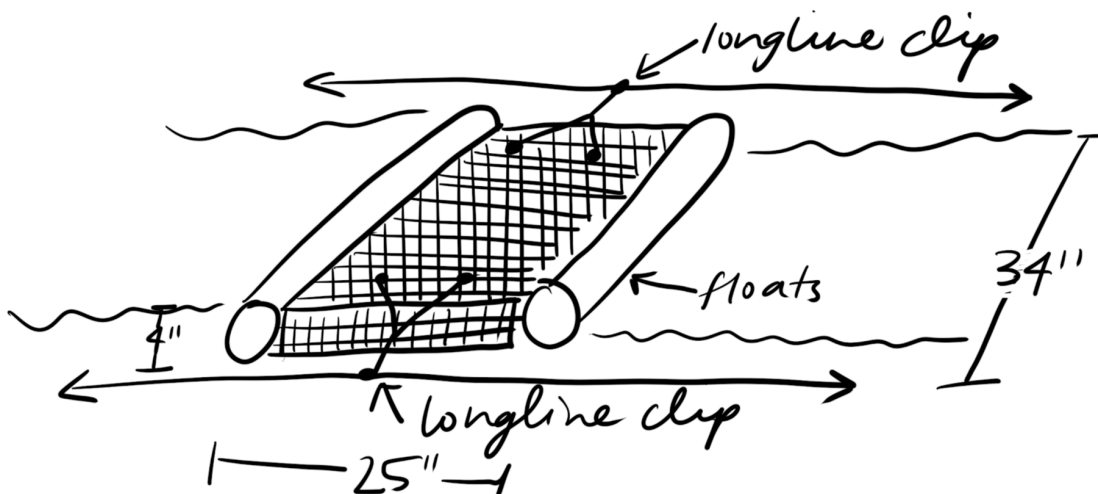

## Mussel Sock

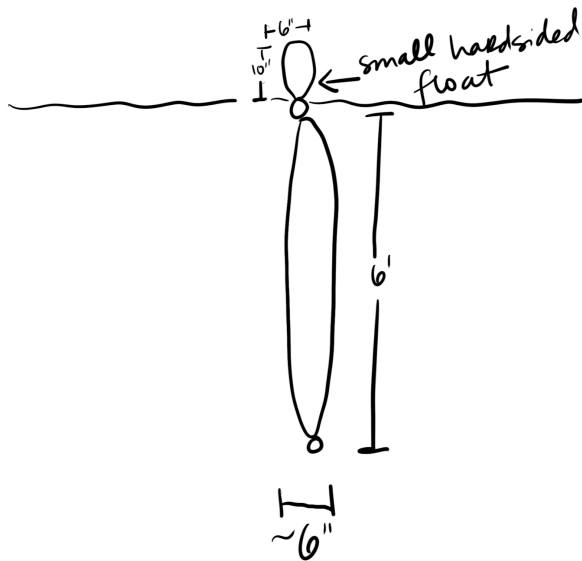

## Bottom Cage

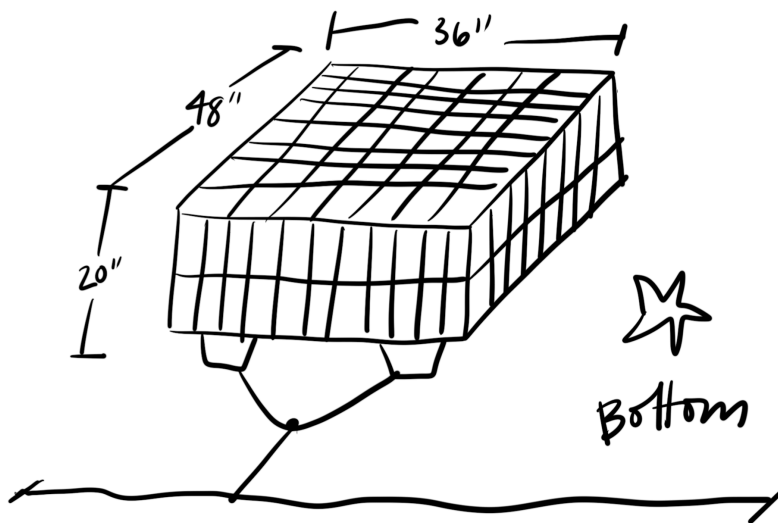

## 7.A.2. Gear Table

<b>Specific Gear Type</b> (e.g. soft mesh bag)	<b>Dimensions</b> (e.g. 16"x20"x2")	<b>Time of year gear will be deployed</b> (e.g. Spring, Winter, etc.)	<b>Maximum amount of this gear type that will be deployed on the site</b> (i.e. 200 cages, 100 lantern nets, etc.)	<b>Species that will be grown using this gear type</b>
Floating rigid mesh bags	34"x 25"x 4"	Year-round	2,000 bags	American oyster & quahogs
Floating cages	48"x 36"x 20"	May 1-December 30	40 cages	American oyster & quahogs
Submerged rigid mesh bags	34"x 25"x 4"	May 1-December 30	100 bags	American oyster & quahogs
Longlines	3/8"x120'	Year-round	36	American oyster & Kelp

## 7.B.1. Overhead View- not to scale

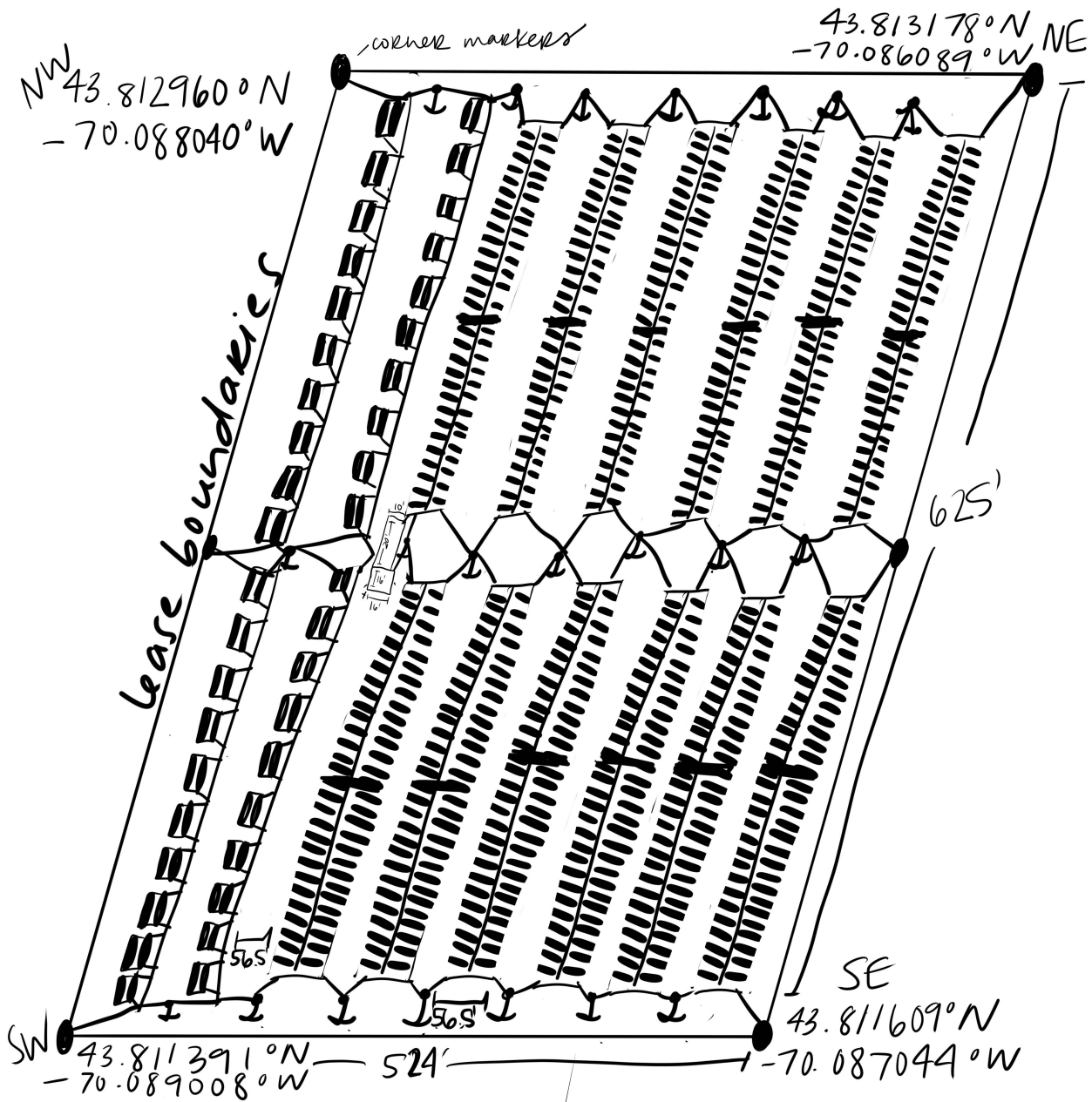

## Overhead View (detailed)

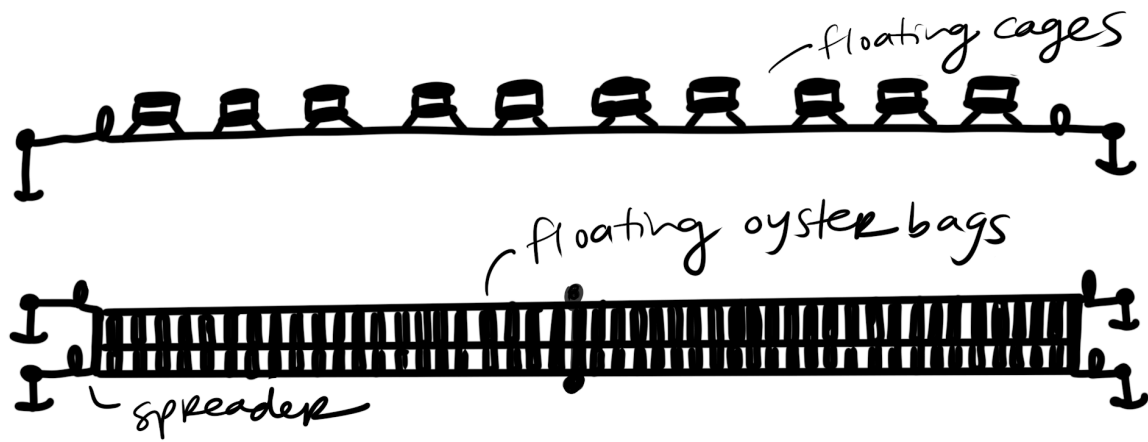

# Cross-Section View

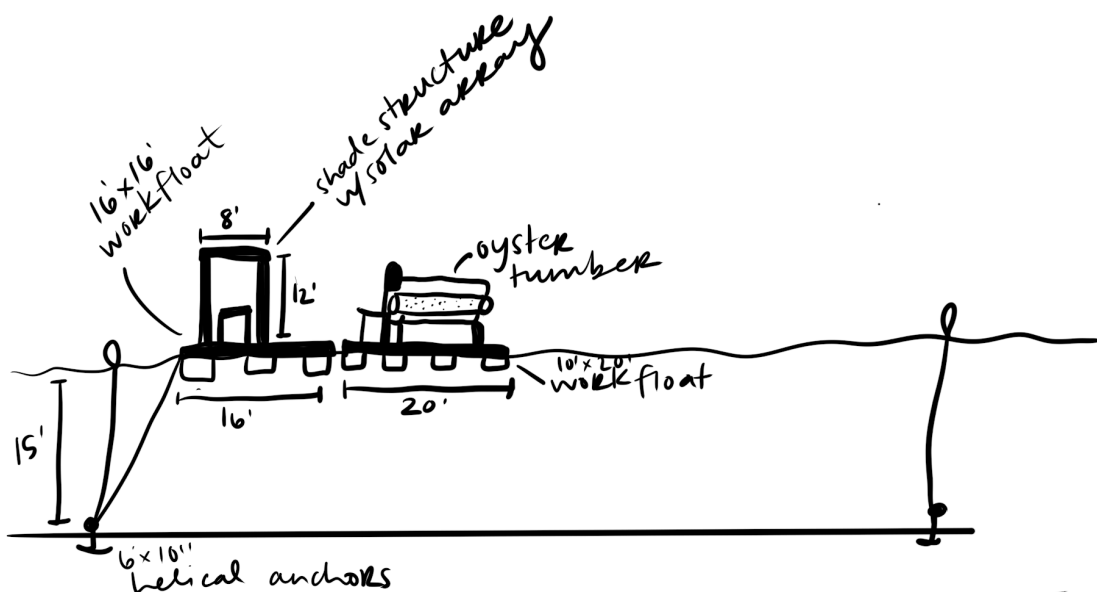
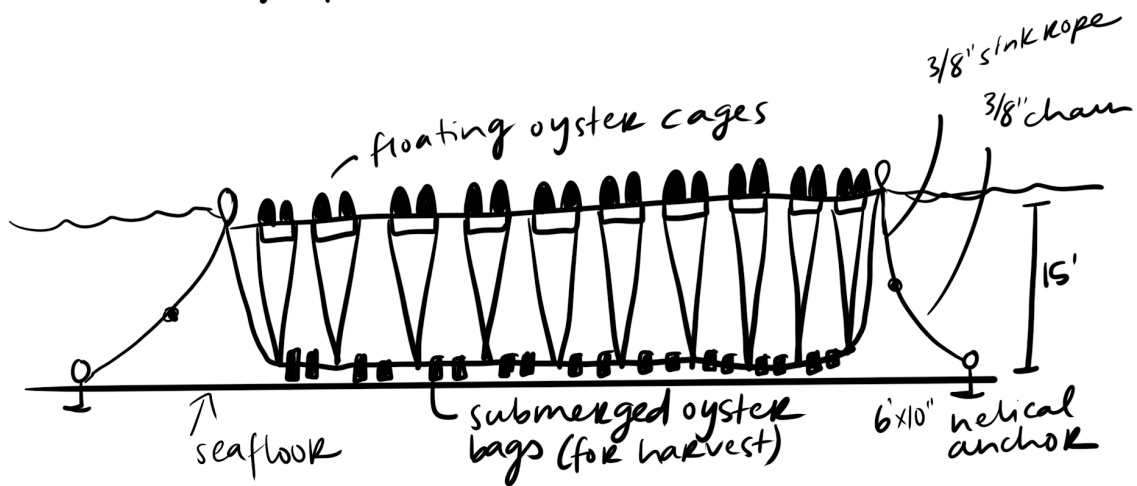
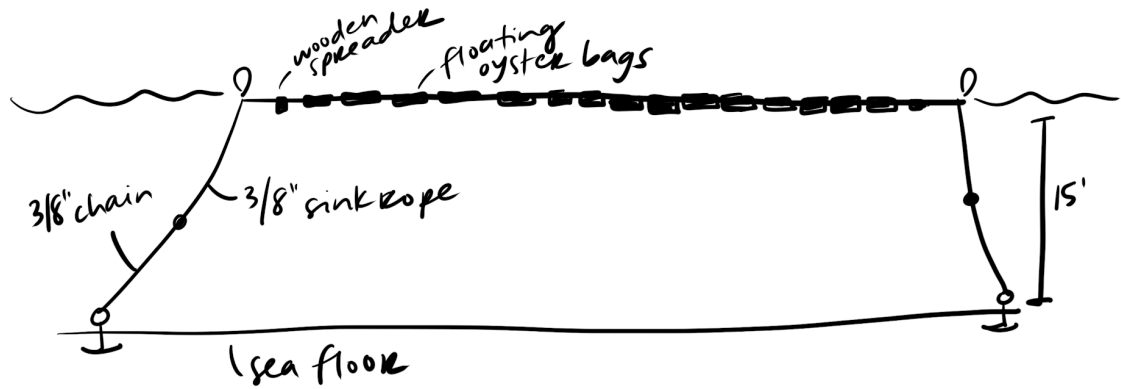

## Cross-Section View (Winter)

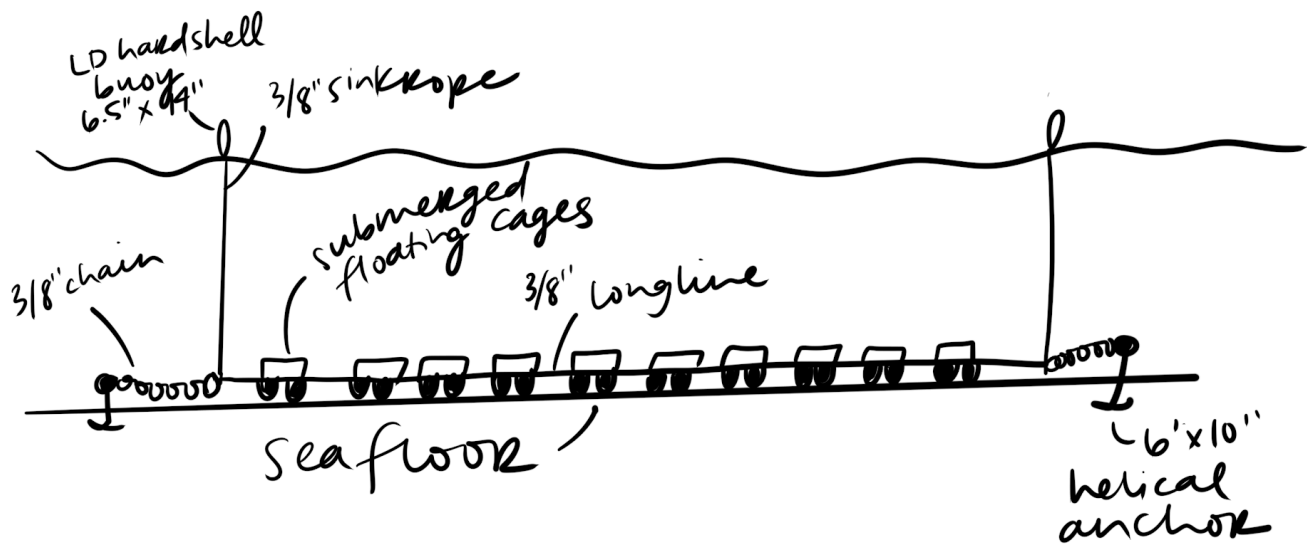



## 7.E. Equipment Layout

Map depicting vantage point locations:

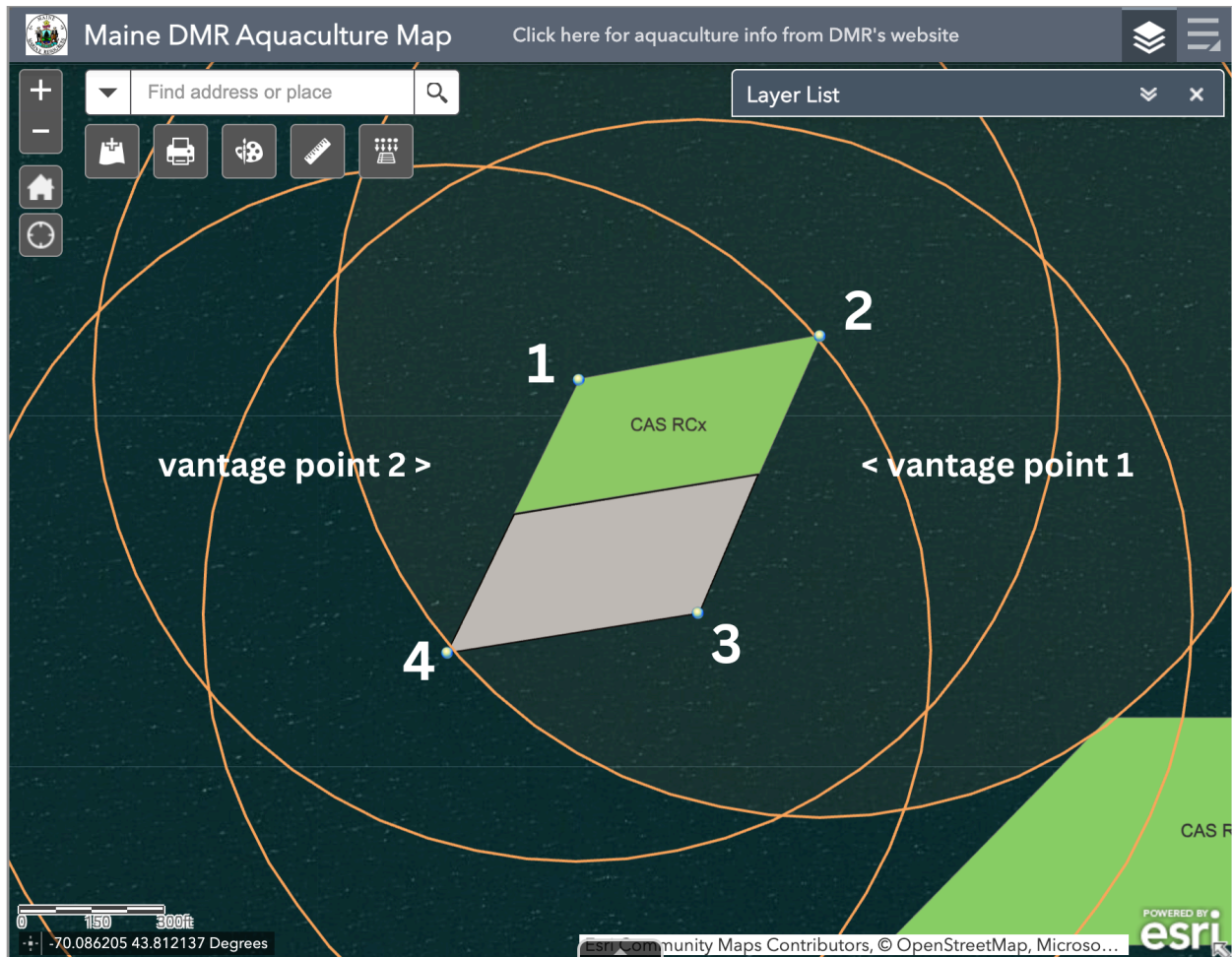

Vantage Point 1:





Vantage Point 2:



## 8.B. Powered Equipment

Equipment	Description	Months of Operation/Frequency of Use
4-stroke Yamaha engine	Motor used for 14' skiff	Skiff will be used everyday to access proposed site as well as transportation of equipment
Oyster Tumbler	Powered by solar panels or gas powered generator	April-November, Five days a week, eight hours a day.
Gas powered generator	Back-up gas powered generator may be used if solar array is not operational	April- November Five days a week, eight hours a day.
Wash down pump	Powered by solar panels connected to a battery pack	April - November, Five days a week, eight hours a day.
600 watt motor	Located on top of tumbler to spin the tumbler tube. Powered by solar panels connected to a battery pack (or back-up generator).	April-November, Five days a week, eight hours a day.
Submerged bilge pump	Powered by solar panels connected to a battery pack (or back-up generator)	April - November, Five days a week, eight hours a day.



MAIL CODE: TX1-0062  
P.O. BOX 955200  
FORT WORTH TX 76155-9200

March 20, 2025  
**Custom Letter**

Page 1 of 1

DIRIGO MARINE RESOURCES, LLC  
BSI3257388756

**Here is the information you requested:**

Document Id: CFM-20Mar25-6553

Research Date: March 20, 2025

Dear DIRIGO MARINE RESOURCES, LLC  
GREGORY FOOTE

**Thank you for contacting us. We verified the account(s) information listed below:**

**Customer Account Information**

Account Number: #####2077

Satisfactory Standing

We confirm the account has been maintained satisfactorily

**Comments:**

If you have questions, please call us at 1-800-550-8509 and refer to Document ID number CFM-20Mar25-6553. We accept operator relay calls. We're available to help Monday through Friday, from 8 a.m. to 9 p.m. Eastern Time.

PLEASE NOTE: If you have furnished us with an account number, this response is limited to information on that account. This response to your inquiry is based on a search of data contained in our centralized customer identification and account information system; that system may not capture all relevant information regarding accounts and does not take into account any other banking relationships, including lending, which the subject of the inquiry may have with us. If the subject of the inquiry is an individual and you are interested in lending information, please contact a credit reporting agency for that information. If you have any questions or require additional assistance, please do not hesitate to call. Thank you.

Sincerely,

Confirmations Department

This letter is provided to you as an accommodation. Neither JPMorgan Chase & Co. and its subsidiaries and affiliates or any of their respective officers, employees or agents shall have any liability or responsibility whatsoever in connection with this letter. The information provided is to the best of our knowledge per retrieval from JPMC owned applications and/or business records. If you have furnished us with an account number and/or identifier, this response is limited to information related to that account or identifier. Information reflected is as of the response date and is subject to change without notice and JPMorgan Chase & Co. and its subsidiaries and affiliates does not undertake to notify you of any changes. Determination of compliance with any financial or tax reporting obligation, determining net asset value, computing any tax liability or any other purpose should be made between the Client and its own financial, legal, tax, accounting and other professional advisors, except as otherwise agreed. This letter is intended for the sole use of the addressee and is furnished on the condition that it is strictly confidential. If you are not the intended recipient, you are hereby notified that retention, dissemination, distribution, or copying of this letter is strictly prohibited. If you received this in error, please notify the sender immediately and destroy the original and any copies.