

EXPERIMENTAL LEASE APPLICATION

1. APPLICANT CONTACT INFORMATION

SOUTH

Applicant	Alicia Caterina	
Contact Person	Alicia Caterina	
Address	59 Brook Rd.	
City	Falmouth	
State, Zip	Maine, 04105	
County	Cumberland	
Telephone	207-671-8084	
Email	Alicia.caterina@gmail.com	
Payment Type	<input type="checkbox"/> Check (included) <input checked="" type="checkbox"/> Credit Card	

2. PROPOSED LEASE SITE INFORMATION

Location of Proposed Lease Site	
Town	Chebeague Island
Waterbody	Casco Bay
General Description (e.g. south of B Island)	East of Stave Island Ledge
Lease Information	
Total acreage (4-acre maximum) and lease term (3-year maximum) requested	4- acres 3- years
Type of culture (check all that apply)	<input type="checkbox"/> Bottom (no gear) <input checked="" type="checkbox"/> Suspended (gear in the water and/or on the bottom) <input type="checkbox"/> Net Pen (finfish)
How many pending experimental lease applications (including this one) do you have pending?	<input type="checkbox"/> One (1) <input checked="" type="checkbox"/> Two (2) <i>Note: An applicant may have no more than two pending experimental leases at any time.</i>

Do you have a legal interest in any entity that has a pending experimental application?	<input type="checkbox"/> Yes <input checked="" type="checkbox"/> No If “Yes” provide the name of the applicant(s): _____
Is any portion of the proposed lease site above mean low water?	<input type="checkbox"/> Yes <input checked="" type="checkbox"/> No (NO) <i>Note: If you selected “Yes”, you need to complete the steps outlined in the section titled: “Landowner/Municipal Permission Requirements”.</i>

3. GROWING AREA DESIGNATION

Growing Area Designation (e.g. “WL”):	WI
Growing Area Section (e.g. “A1”):	Area “A” approved

4. GENERAL LEASE INFORMATION

A.

Name of species to be cultivated (include both common and scientific names):	Name and address of the source of seed stock or juveniles	Maximum number (or biomass) of organisms you anticipate on the site at any given time
Sugar kelp (<i>Saccharina latissima</i>)	Summit Point LLC 116 Dartmouth Street Portland, ME. 04106	6,900 linear feet Up to 34,500 lbs.
2. Skinny kelp (<i>Saccharina angustissima</i>)	Summit Point LLC 116 Dartmouth Street Portland, ME. 04106	6,900 linear feet Up to 34,500 lbs.

B. Do you intend to possess, transport, or sell whole or roe-on scallops? ☐ Yes ☒ No

A vicinity map titled "VICINITY MAP" showing a proposed site as an orange diamond. The site is located near Stave Island. Four concentric circles are drawn around the site, labeled "1,000' FROM NORTH CORNER", "1,000' FROM EAST CORNER", "1,000' FROM WEST CORNER", and "1,000' FROM SOUTH CORNER". A north arrow points upwards, labeled "NORTH". A scale bar at the bottom right indicates "SCALE: 1/2 MILE". The map includes various geographical features like islands, water bodies, and contour lines with numerical values (e.g., 16, 30, 50, 84).

6. BOUNDARY DRAWING



Coordinate Description

(Datum used: Maine Department of Marine Resources Aquaculture Web Map)

N: 43.719590
-70.079886

W: 43.718836
-70.080644

S: 43.718031
-70.079114

E: 43.718784
-70.078356

7. RESEARCH PROGRAM AND OPERATIONS

A. Type of study (check one): ☐ Scientific Research ☒ Commercial Research

B. What is the purpose of the study? If scientific, please include a detailed study design.

To determine the viability of growing kelp commercially in this area.

C. Describe the general culture process for each species proposed.

Seed will be obtained from Summit Point LLC hatchery and planted on long lines in the fall (No sooner than October 15th). Throughout the fall, winter, and spring the kelp's growth will be monitored. The kelp will be harvest in the spring (No later than May 31st).

D. What months will the proposed activities (i.e. seeding, tending, and harvesting) occur?

Seeding will take place in the fall, no earlier than October 15th. (October 15th- January 15th)

Tending or monitoring will occur in the fall, winter, and spring. (October 15th-May 31st)

Harvest will occur in the spring, no later than May 31st. (March 15th-May 31st)

E. How often will you be at the site during seeding and harvesting periods?

Seeding will begin no sooner than October 15th and could run through January 1st depending on availability of seed from the hatchery. Seeding typically takes no more than a week total for a site of this size. During the seeding it is expected that, depending on weather, the process could take up to seven days per week. Seeding will only be performed during daylight hours and could take approximately eight hours a day.

Harvest will occur during the spring months, starting as early as March 15th and ending no later than May 31st. Depending on weather, harvest will occur for up to seven days a week until completed. Harvest will only occur during daylight hours and could take approximately 12 hours per day.

F. How frequently will you visit/tend the site for routine maintenance (i.e. flipping cages, etc.)?

The site will be visited on a weekly basis throughout the fall, winter, and spring depending on weather conditions. It will be visited during daylight hours only and could be visited for approximately up to eight hours per day.

G. Describe the harvesting techniques you will use. If you plan on using a drag, please provide the dimensions.

The kelp long lines will be hauled out of the water using a lobster boat hauler. The kelp will be cut from the long lines by hand and transported to shore, by boat, in bags or bins.

H. Describe any overwintering or “off season” plans for the site. For example, will you remove gear from the site and/or deploy gear in different areas within the proposed site? Please include where gear or product will be located if moved from the site.

All gear (excluding moorings, mooring lines, and mooring balls) will be removed from the site from June 1st-October 14th.

All gear removed from the site during the summer months will be stored on land.

I. What type of machinery (e.g. generator, drag, grading equipment, etc.) will you be using on the site? When and how often will the machinery be used?

-During seeding: A lobster boat and skiff may be used up to seven days a week, during daylight hours only, until seeding is completed.

-During tending: A lobster boat and skiff may be used up to seven days a week, during daylight hours only, to maintain and tend the site.

-During harvest: A lobster boat and skiff may be used up to seven days a week, during daylight hours only, until the harvest is completed.

The lobster boat will utilize a hydraulic pot hauler to haul in the kelp lines during harvest, and occasionally during maintenance and tending.

J. Please provide details on any predator control techniques you plan to employ.

No predator control is necessary at this site.

K. Suspended culture gear can attract birds that roost on the gear and defecate, potentially creating a pollution source impacting shellfish held within the gear. In order to comply with the National Shellfish Sanitation Program (NSSP) Model Ordinance (MO), DMR is requiring that applications for the suspended culture of shellfish include a description of mitigation or deterrent measures to minimize the potential pollution impacts of birds at the proposed site. If appropriate, include sketches or photos that clearly depict those measures put into practice.

Examples may include:

- Submerging suspended gear and associated product at a depth sufficient to deter roosting for two weeks before harvest
- Attaching physical deterrents (i.e. zip ties) to gear
- The site is proposed for the culture of seed only
- The site is proposed for the culture of adductor-only scallops (i.e. no other shellfish species would be grown on the site)
- Proposed gear would always be suspended below the surface of the water at a depth sufficient to deter roosting (i.e. as is common for scallop lantern nets)

NA

8. EXISTING USES

A. Describe the existing uses of the proposed area in questions A.1 through A.5 below. Please include the a) type b) time of year c) frequency, and d) proximity to the lease site for each existing use.
1. Commercial Fishing
a. Lobstering b. June-October c. Rare d. Within
2. Recreational Fishing
a. Hook and line b. June-August c. Rare d. Within
3. Boating Activities (please also include the distance to any navigable channel(s) from your proposed site at low water)
a. Recreational boating b. June-October c. Minimal d. Within The nearest channel marker is Red “8”, which is approximately 1,700’ from the North corner of the proposed area.
4. Ingress and egress (i.e. coming and going) of shorefront property owners within 1,000 feet of the proposal (e.g. docks, moorings, landing boats on shore, etc.)
a. Small skiff, row boat, or shore landing craft. b. June-October c. Rare d. Near
5. Other uses (kayaking, swimming, etc.)
a. Kayaking b. June-October c. Rare d. Within
B. Are there private docks, moorings, or other access points within 1,000 feet of the proposed lease? If yes, please include approximate distance from proposed lease.
-The nearest exposed land is 300’ West of the Western edge of the proposed site on Stave Island Ledge. -The nearest mooring appears to be approximately 675’ W of the West corner of the proposed site on the other side of Stave Island Ledge. -The nearest dock is approximately 1,700’SW of the West corner of the proposed site on the other side of Stave Island.

C. Are there public beaches, parks, or docking facilities within 1,000 feet of the proposed lease site. If yes, please describe and include approximate distances from proposed lease.

NA

D. Are there any Limited Purpose Aquaculture (LPA) licenses or aquaculture leases within 1,000 feet of your proposed lease site? If yes, please list their acronyms below.

NA

9. CURRENT OPERATIONS

A. Describe your existing aquaculture operations, including the acronyms of all active leases and/or licenses.

NA

B. What are your plans for any existing leases and/or Limited Purposed Aquaculture (LPA) licenses if the lease is granted? Will any existing leases and/or Limited Purpose Aquaculture (LPA) licenses be relinquished if the lease is granted? If so, please indicate which ones.

NA

10. ENVIRONMENTAL CHARACTERIZATION

A. What are the approximate depths at mean low water?

The depths at approximate mean low water range from 20' on the West side of the proposed site to 16' on the East side of the proposed site.

B. What are the approximate depths at mean high water?

The depths at approximate mean high water range from 30' on the West side of the proposed site to 26' on the East side of the proposed site.

C. Provide the approximate current speed and direction during the ebb and flow.

The approximate current speed is 1.5 knots and runs in roughly a N-S direction.

D. The following questions (D.1 through D.6) may be answered in writing or by submitting a video. If you plan to submit a video, please contact the Department prior to video collection.

1. What are the bottom characteristics (mud, sand, gravel, rock, ledge or some mix, etc.)?

The bottom characteristics are primarily soft mud with some gravel mixed in.

2. Describe the bottom topography (flat, steep rough, etc.).

The proposed site is mostly flat with a gradually inclining slope from about 20' on the West side at MLW to 16' on the East side at MLW.

3. Describe marine organisms by species or common names. Based on your personal observations or other sources of information, are these species abundant, common, or rare?

Lobsters and crabs are rare at the site.

4. Are there shellfish beds or fish migration routes in the surrounding area? If so, please describe.

There are no known shellfish beds or fish migration routes in the surrounding area.

5. Describe the presence and extent of submerged aquatic vegetation, i.e. eelgrass, within the proposed lease area. Please include the date of this observation along with the method of observation. If submerged aquatic vegetation is observed, please also describe the abundance below and sketch the limits of the beds in the vicinity map.

There is no submerged aquatic vegetation or eelgrass within the proposed area. This information is based on data from the Department of Marine Resources Aquaculture Web Map. It included layers titled “Seagrass 2023 (Phippsburg to Port Clyde, Eelgrass 2010, and Eelgrass 1997”

6. Describe the general shoreline and upland characteristics (rocky shoreline, forested, residential, etc.)

The nearest shoreline is rocky and lightly forested with a small number of seasonal homes.

E. Is your proposed lease located within a Maine Department of Inland Fisheries and Wildlife designated Essential Habitat?

☐ Yes ☒ No

F. Will your operations discharge anything into the water such as feed (pellets, kelp, etc.) or chemical additives (therapeutants, chemical treatments, etc.)?

☐ Yes ☒ No

G. Describe ice formation in the winter months at the proposed site.

There is no ice formation at the proposed site during the winter months.

11. STRUCTURES

Overhead View: (October 15th- May 31st)

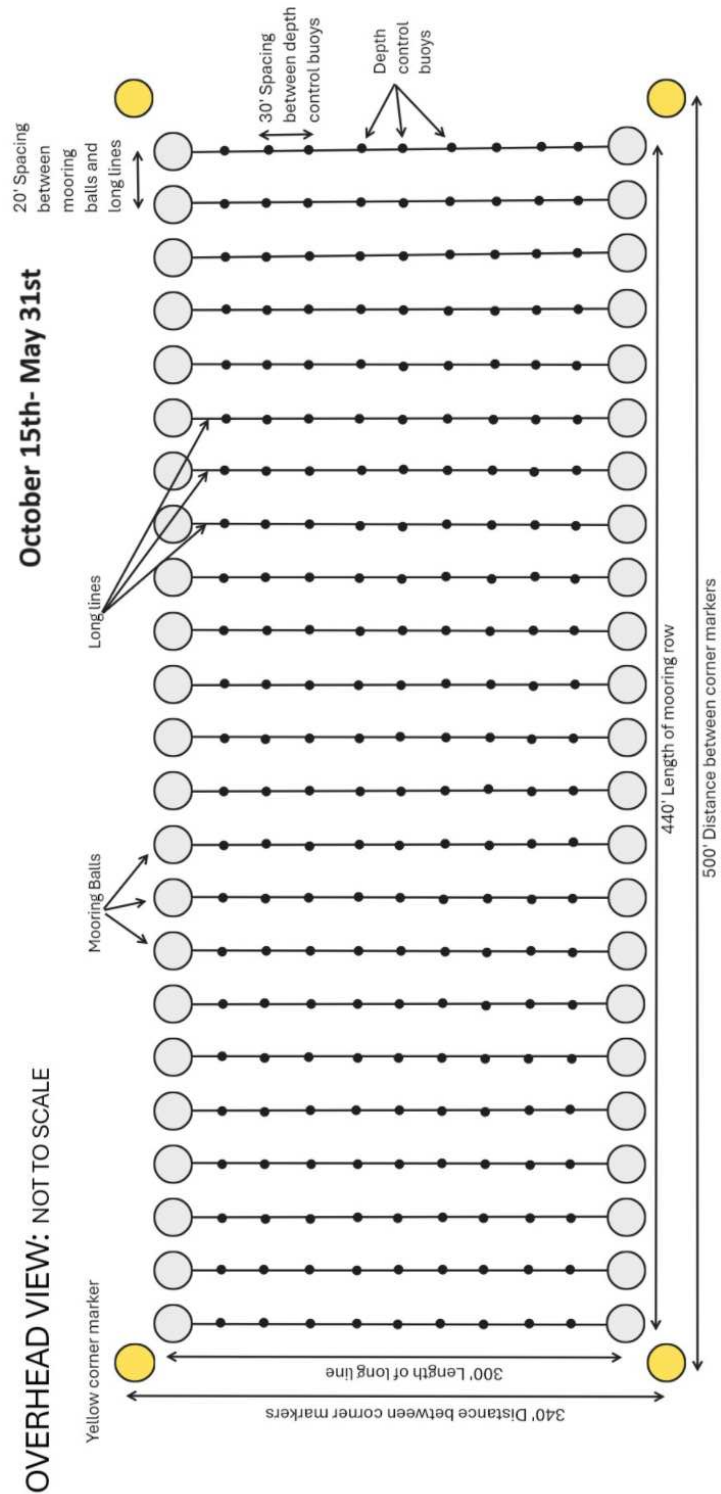

Overhead View with Seasonal Changes: (June 1st- October 14th)

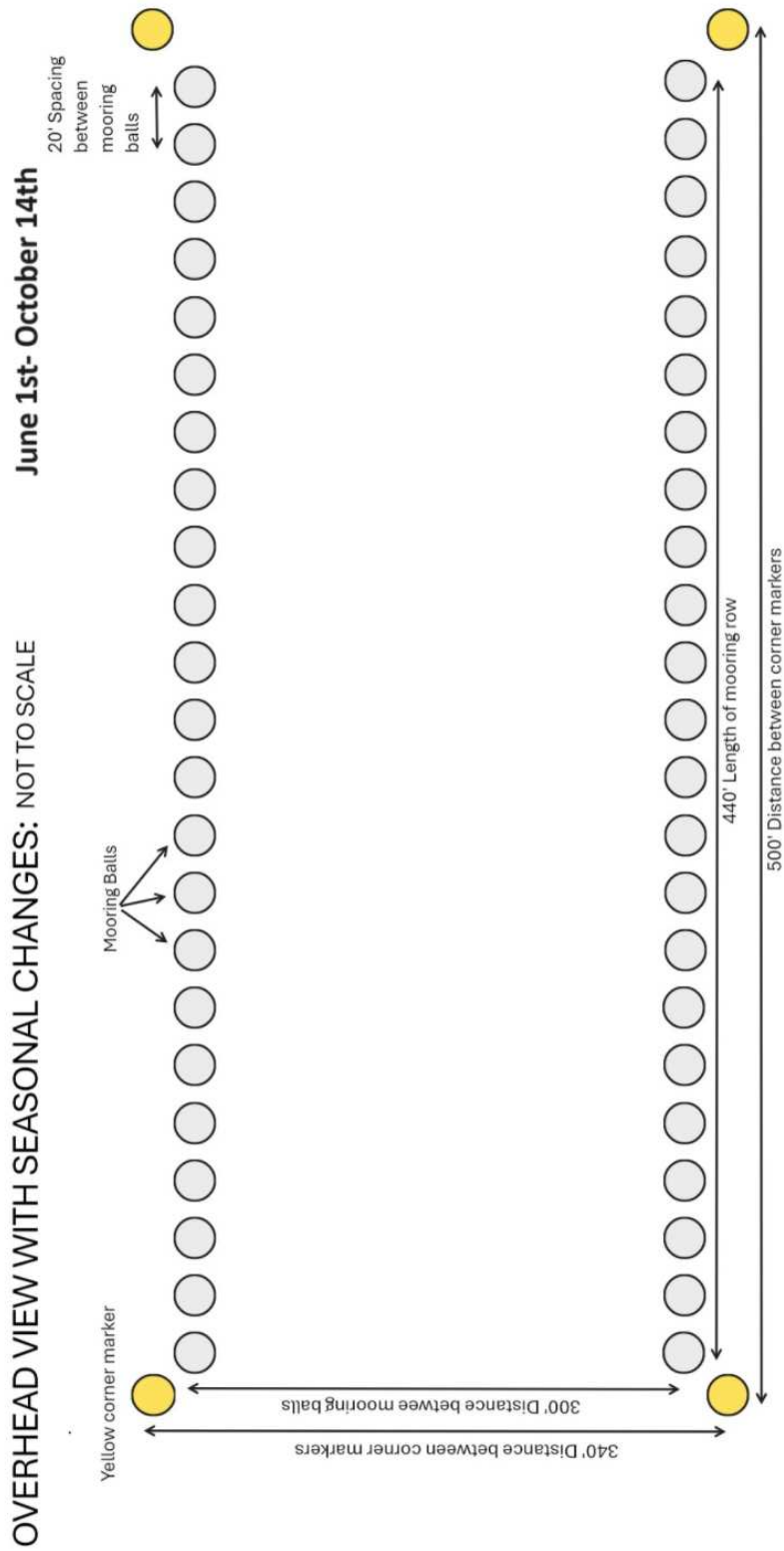

Cross-Section View: (October 15th- May 31st)

October 15th- May 31st

CROSS SECTION VIEW:

NOT TO SCALE

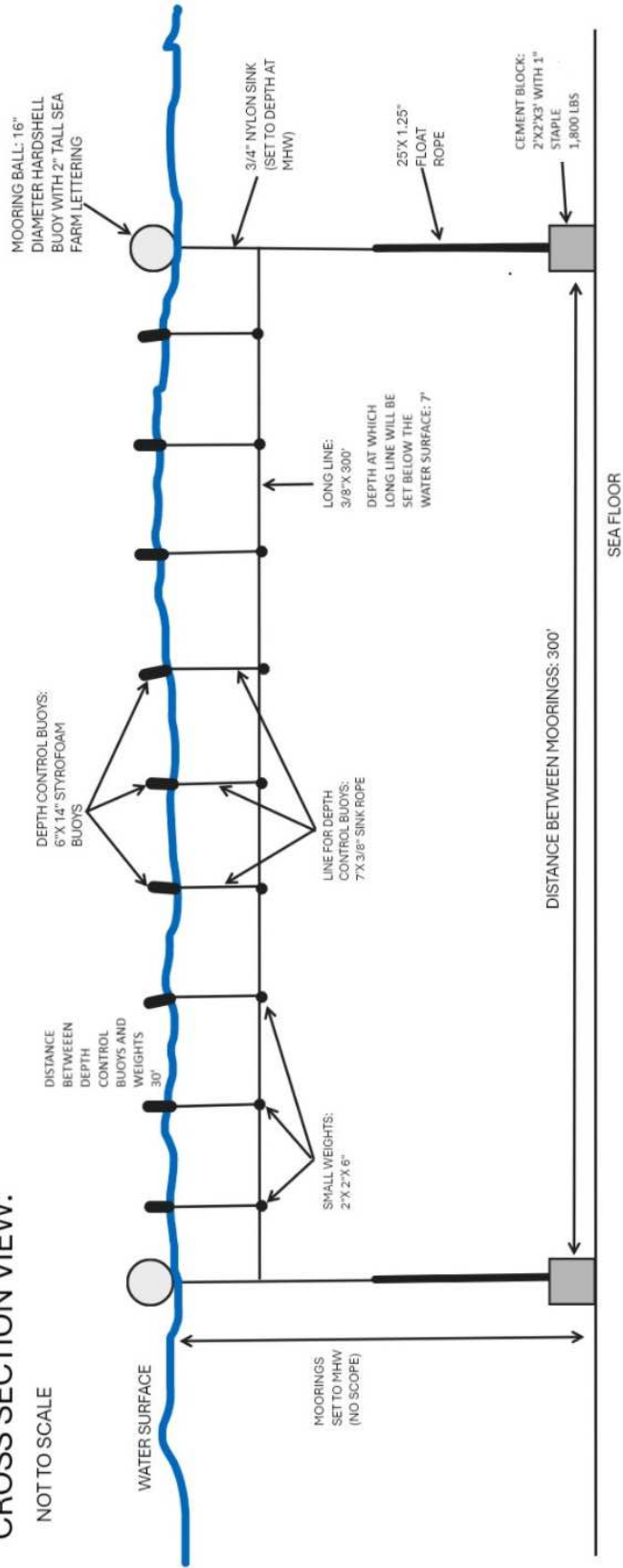

Cross-Section View with Seasonal Changes: (June 1st-October 14th)

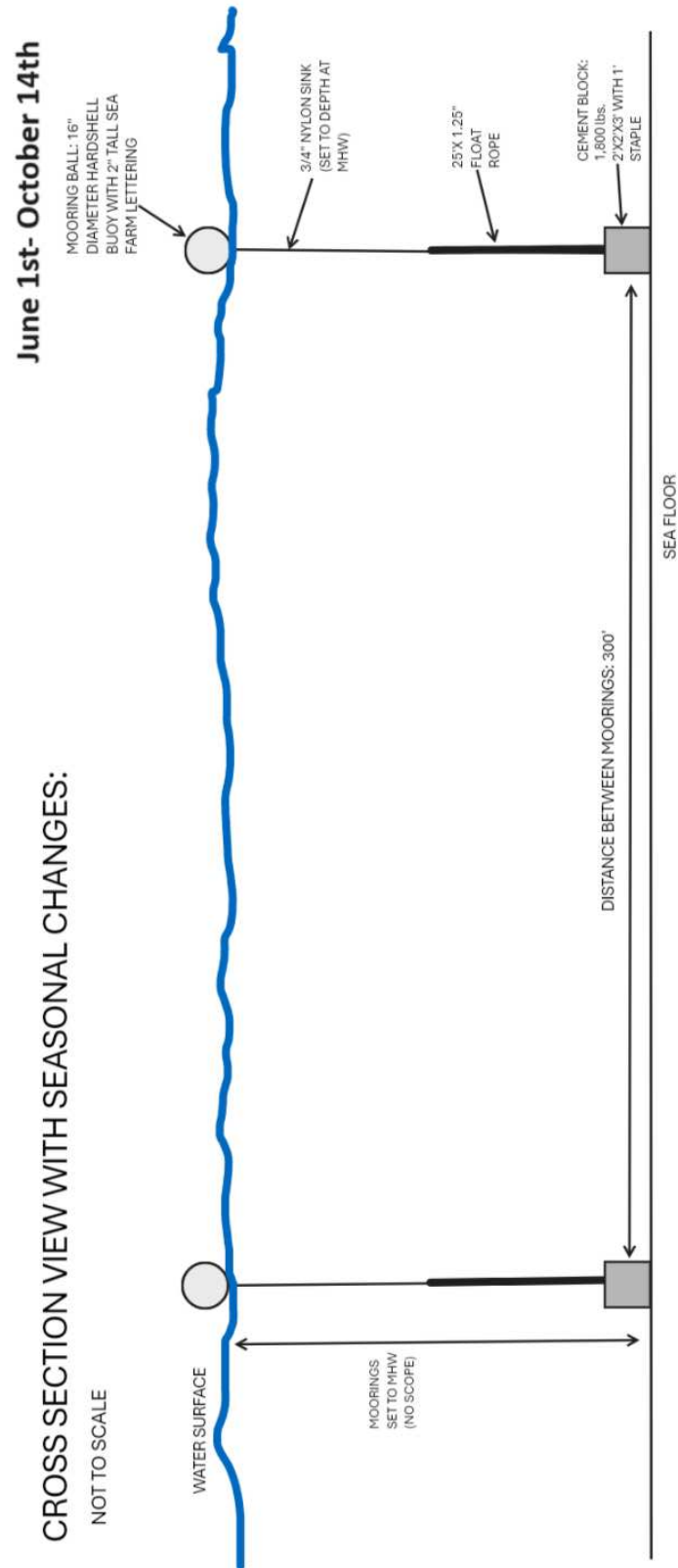

C) Gear Description

Specific Gear Type	Dimensions	Time of year gear will be deployed	Maximum amount of this gear type that will be deployed on the site	Species that will be grown using this gear type
Styrofoam buoys (depth control buoys)	6"x 14"	Oct 15 th -May 31 st	207 buoys	Sugar kelp/Skinny kelp
Sink rope for depth control buoys	3/8" diameter 7' long	Oct 15 th -May 31 st	207 lengths	Sugar kelp/Skinny kelp
Small weight for depth control buoy	2"x 2 x 6"	Oct 15 th - May 31 st	207 weights	Sugar kelp/Skinny kelp
Long line	3/8" diameter by 300' length	Oct 15 th - May 31 st	23 lines totaling 6,900 linear feet	Sugar kelp/Skinny kelp
Mooring markers (hard-shell variety)	16" diameter	Year-round	46 buoys	Sugar kelp/Skinny kelp
Mooring line	25' x 1.25" float from the block...then 3/4" sink to the mooring marker. (set to MHW)	Year-round	46 mooring lines	Sugar kelp/Skinny kelp
Mooring (cement block)	2' x 2' x 3' 1,800 Lbs.	Year-round	46 moorings	Sugar kelp/Skinny kelp
Mooring staple	3 links of 1" diameter chain	Year-round	46 staples	Sugar kelp/Skinny kelp

D) Gear Drawing

-GEAR DRAWING: DEPTH CONTROL BUOY (6"x 14" Styrofoam)



Seamaster lobster buoy. 6x14. Crush
Depth: 100'. Uniform Size. PVC
removable arommets. Sold by the



-GEAR DRAWING: SINK ROPE FOR DEPTH CONTROL BUOY (Cut to 7' lengths)



Hyliner super sink pot warp. 12 thread,
3/8". Sold by the pound in full coils only.
Coil is approximately 65lbs. and 1200-



-GEAR DRAWING: SMALL WEIGHT



Ergo brick lobster trap weight. 4 lbs. Coated green.

-GEAR DRAWING: LONG LINE (Cut to 300' lengths)



Hyliner super sink pot warp. 12 thread, 3/8". Sold by the pound in full coils only. Coil is approximately 65lbs. and 1200-

-GEAR DRAWING: MOORING MARKER (WHITE 16" diameter) Corner markers will be yellow.



-GEAR DRAWING: MOORING LINE (3/4" Sink... cut to lengths appropriate for MWH)



-GEAR DRAWING: MOORING LINE 1.25" FLOAT



-GEAR DRAWING: MOORING BLOCK (2'x 2'x 2')



-GEAR DRAWING: MOORING STAPLE (3 lengths of 1" mooring chain)



12. MARKING

Will you be able to mark your site in accordance with DMR regulations, Chapter 2.80? In part, this requires marker buoys which clearly display the lease ID and the words SEA FARM to be located at each corner of the lease. Marker buoys must be yellow and host reflective material.

☒ Yes ☐ No

If you answered no, explain why and suggest alternate markings.

NA

13. RIPARIAN LANDOWNERS AND SITE ACCESS

TAX MAP:

TAX MAP

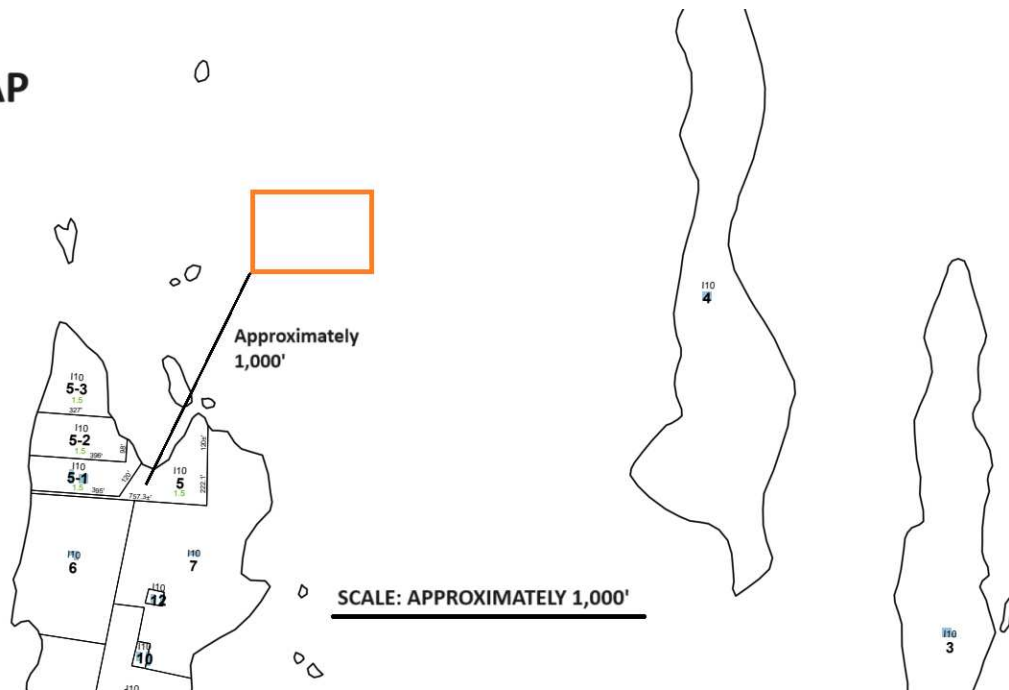

A. Will your access to the lease area be across riparian land?

☐ Yes ☒ No

B. How (i.e. where on shore) will you access the proposed site?

The proposed site will be accessed from the Portland waterfront and public boat ramps in surrounding areas.

RIPARIAN LANDOWNER LIST

THIS LIST MUST BE **CERTIFIED** BY THE TOWN CLERK

On this list, please include the map number, lot number, and the current owners' names and mailing addresses for all shorefront parcels within 1,000 feet of the lease site. It is the applicant's responsibility to assemble the information for the Town Clerk to certify. The Town Clerk only certifies that the information is correct according to the Town's records. Once you have completed the form, ask the Town Clerk to complete the certification section below. If riparian parcels are located within more than one municipality, provide a separate, tax map and certified riparian list for each municipality.

TOWN OF: Chebeague Island, Maine

MAP #	LOT #	Landowner name(s) and address(es)
110	5-3	Susan Manter 57 Silver Street Waterville, ME. 04901
110	5-2	Jean Quade 2332 Avenel Avenue SW Roanoke, VA. 24015
110	5-1	David Crowley P.O. Box 11 Cliff Island, ME. 04019
110	5	Robert Crowley 491 Auburn Pownal Rd. Durham, ME. 04222
110	7	Odessa Holdings LLC 1 Pine Grove Street Bristol, PA. 19007
110	4	Hannah Martin P.O. Box 8 East Derry, NH. 03041

CERTIFICATION

I, Krista Hayward, Town Clerk for the Town of Chebeague Island certify that the names and addresses of the property owners listed above, as well as the map and lot numbers, are those listed in the records of this municipality and are current as of this date.

SIGNED:  DATE: 6/14/24

14. ESCROW ACCOUNT OR PERFORMANCE BOND

Check the category that describes your operation:

Check Here	Lease Category	Amount of Required Escrow or Performance Bond
<input type="checkbox"/>	No gear/structure, no discharge	None
<input type="checkbox"/>	No gear/structure, discharge	\$500.00
<input type="checkbox"/>	≤ 400 square feet of gear/structure, no discharge	\$1,500.00
<input checked="" type="checkbox"/>	>400 square feet of gear/structure, no discharge	\$5,000.00*
<input type="checkbox"/>	Gear/Structure, discharge	\$25,000.00

*DMR may increase the bond/escrow requirements for leases with more than 2,000 feet of structure.

I, (*printed name of applicant*) Alicia Caterina have read DMR Aquaculture Regulations 2.64(12)(B)) and if this proposed lease is granted by DMR I will either open an escrow account or obtain a performance bond, depending on the category of lease.



Applicant Signature
Note: Add title if signing on behalf of a corporate applicant.

31 August 2025

Date

ADDITIONAL APPLICANTS: Each applicant must sign this section indicating that they will open an escrow account or obtain a performance bond. Use the space below for additional persons listed on the application. You may attach additional pages, if necessary.

I, (*printed name of applicant*) NA have read DMR Aquaculture Regulations 2.64(10)(D) and if this proposed lease is granted by DMR I will either open an escrow account or obtain a performance bond, depending on the category of lease.

NA

Applicant Signature
Note: Add title if signing on behalf of a corporate applicant.

NA

Date

15. APPLICANT SIGNATURE PAGE

I hereby state that the information included in this application is true and correct. I have also read and understand the requirements of the Department's rules governing aquaculture and the application instructions pertaining to the experimental lease process.

Printed name: _____ Alicia Caterina _____

Title (*if corporate applicant*): _____ NA _____

Signature: _____  _____ Date: _____ 31 August 2025

18 U.S.C. Section 1001 provides that: Whoever, in any manner within the jurisdiction of any department or agency of the United States knowingly and willfully falsifies, conceals, or covers up any trick, scheme, or disguises a material fact or makes any false, fictitious or fraudulent statements or representations or makes or uses any false writing or document knowing same to contain any false, fictitious or fraudulent statements or entry, shall be fined not more than \$10,000 or imprisoned not more than five years or both.

16. LANDOWNER/MUNCIPAL PERMISSION REQUIREMENTS

NA. Proposed site is not intertidal