

**APPLICATION FOR LEASE RENEWAL**

Lease Acronym	COB HP
Name of Leaseholder	Cooke Aquaculture USA, Inc.
Name of Contact Person	Jennifer Robinson
Address	40 Barron Road
City	Eastport
State, Zip	ME 04631
Telephone	207-214-6009
Email	jennifer.robinson@cookeaqua.com
Term Requested	20 years

1. Describe the type and amount of aquaculture to be conducted during the new lease term:

Net pen aquaculture of Atlantic Salmon
on a 3 year rotation with periods of
fallowing between harvesting and stocking.

2. Describe the amount of aquaculture conducted on the lease site during the previous lease term, including but not limited to seeding, cultivation or harvest of organisms:

This lease site was not utilized during this last term of the lease.

3. Suspended culture gear can attract birds that roost on the gear and defecate, potentially creating a pollution source impacting shellfish held within gear. In order to comply with the National Shellfish Sanitation Program (NSSP) Model Ordinance (MO), if the lease site is permitted for the culture of shellfish in suspended gear, please include a description of mitigation or deterrent measures to minimize the potential pollution impacts of birds at the lease site. If appropriate, include Sketches or photos that clearly depict those measures put into practice.

Examples may include:

- Suspended gear submerged at depth sufficient to deter roosting for at least two weeks before harvest
- Attaching physical deterrents (i.e. zip ties) to gear
- The lease site is used to culture shellfish seed only
- Only adductor-only shellfish are cultured on the lease site

There is no intention to stock shellfish at this site.

4. Tax Maps and Riparian List

Is your existing lease within 1,000ft of shorefront land (which extends to mean low water or 1,650 ft. from shore, whichever is less, according to NOAA charts)?

☒ Yes ☐ No

If yes, the following supporting documents are required:

A. Tax Map.

A labeled copy of the appropriate tax map(s) depicting the location of the proposed lease site.

The map(s) needs to include the following elements:

- Label the map "Tax Map: Town of (name of town)."
- Legible scale
- Tax lot numbers clearly displayed
- The boundaries of the existing lease

B. Riparian List.

Please use the Riparian Landowner List (included on the next page) to list the name and address of every shorefront landowner within 1,000 feet of your existing lease. Have the tax collector or clerk of the municipality certify the riparian list. Refer to the Riparian Determination guidance document to ensure all riparian landowners are included: <https://www.maine.gov/dmr/aquaculture/forms/documents/RiparianDetermination.pdf>

C. Check for \$1500 application fee

Signature of Leaseholder: Jennifer Roberson Date: 8/6/25

RIPARIAN LANDOWNER LIST****THIS LIST MUST BE CERTIFIED****

On this list, please show the current landowners' names and mailing addresses as listed in the municipal tax records for all riparian shorefront parcels within 1,000 feet of the existing lease site along with the map and lot number for each parcel. **It is the applicant's responsibility to assemble the information for the Town Clerk to certify.** The Town Clerk only certifies that the information is correct according to the Town's records. Once you have completed the form, ask the Town Clerk to complete the certification section below. If the parcels are within more than one municipality, provide a separate, certified riparian list for each municipality.

TOWN OF:

MAP #	LOT #	Landowner name(s) and address(es)
G6	D5-1	Cemetery 22 Washington Street City of Eastport Eastport ME 04631
G6	D4-1	Stephan Manly 67 Clark Street Eastport ME 04631
G6	C4-2	Reginald S Baskerville 77 Clark Street Eastport ME 04631
G6	C4-1	Joane Lloyd 85 Clark Street Eastport ME 04631
G6	C3-2	Glenn Reed Inc. 123 Johnsneck Rd Shirley NY 11967
G6	B3-3	Glenn Reed Inc. 123 Johnsneck Rd Shirley NY 11967

Please use additional sheets if necessary and attach hereto.**CERTIFICATION**

I, Wes Farley ^{Assessor} ~~Town Clerk~~ for the Town of Eastport certify that the names and addresses of the property owners listed above, as well as the map and lot numbers, are those listed in the records of this municipality and are current as of this date.

SIGNED: Lenneth W. Farley DATE: 8/5/2025

RIPARIAN LANDOWNER LIST****THIS LIST MUST BE CERTIFIED****

On this list, please show the current landowners' names and mailing addresses as listed in the municipal tax records for all riparian shorefront parcels within 1,000 feet of the existing lease site along with the map and lot number for each parcel. **It is the applicant's responsibility to assemble the information for the Town Clerk to certify.** The Town Clerk only certifies that the information is correct according to the Town's records. Once you have completed the form, ask the Town Clerk to complete the certification section below. If the parcels are within more than one municipality, provide a separate, certified riparian list for each municipality.

TOWN OF:

MAP #	LOT #	Landowner name(s) and address(es)
G6	B2-4	Susan Ruth Garnett 115 King Street Dennysville ME 04628
G6	B2-1	John Karlin 290 Rutherford Rd Oakham MA 01068
G6	C1-4	Laura Prati 33 Mermaids Way Eastport ME 04631
G6	A1-1	Dyer Island (city) 22 Washington Street Eastport ME 04631
G6	A1-2	Monument Island Seaview RV Resort 16 Norwood Road Eastport ME 04631
G5	B5-1	Seaview RV Resort LLC 16 Norwood Road Eastport ME 04631

Please use additional sheets if necessary and attach hereto.**CERTIFICATION**

I, Wes Farley, Assessor, Town Clerk for the Town of Eastport certify that the names and addresses of the property owners listed above, as well as the map and lot numbers, are those listed in the records of this municipality and are current as of this date.

SIGNED: Kenneth W Farley DATE: 8/5/2025

RIPARIAN LANDOWNER LIST

THIS LIST MUST BE CERTIFIED

On this list, please show the current landowners' names and mailing addresses as listed in the municipal tax records for all riparian shorefront parcels within 1,000 feet of the existing lease site along with the map and lot number for each parcel. **It is the applicant's responsibility to assemble the information for the Town Clerk to certify.** The Town Clerk only certifies that the information is correct according to the Town's records. Once you have completed the form, ask the Town Clerk to complete the certification section below. If the parcels are within more than one municipality, provide a separate, certified riparian list for each municipality.

TOWN OF:

MAP #	LOT #	Landowner name(s) and address(es)
G6	C3-1	Drew Donald 23896 Sanctuary Lakes Ct Bonita Springs FL 34134
G6	C2-4	Anthony Newcomb 9 Harris Point Road Eastport ME 04631
G6	C2-6	Anthony Newcomb 9 Harris Point Road Eastport ME 04631
G6	B2-2	Douglas SR Murphy 539 Turner Street Auburn ME 04210
G6	B2-5	Irving J JR Harris 17 Harris Point Drive Eastport ME 04631
G6	A3-1	Harris Point LLC 24 Harris Point Road Eastport ME 04631

Please use additional sheets if necessary and attach hereto.

CERTIFICATION

I, Wes Farley, ^{Assessor} ~~Town Clerk~~ for the Town of Eastport certify that the names and addresses of the property owners listed above, as well as the map and lot numbers, are those listed in the records of this municipality and are current as of this date.

SIGNED: Benneth W Farley DATE: 8/5/2025

RIPARIAN LANDOWNER LIST****THIS LIST MUST BE CERTIFIED****

On this list, please show the current landowners' names and mailing addresses as listed in the municipal tax records for all riparian shorefront parcels within 1,000 feet of the existing lease site along with the map and lot number for each parcel. **It is the applicant's responsibility to assemble the information for the Town Clerk to certify.** The Town Clerk only certifies that the information is correct according to the Town's records. Once you have completed the form, ask the Town Clerk to complete the certification section below. If the parcels are within more than one municipality, provide a separate, certified riparian list for each municipality.

TOWN OF:

MAP #	LOT #	Landowner name(s) and address(es)
G7	A2-1	US Gov Coast Guard (Dog Island)
G7	B1-5	Robert C Leatherman 2175 S. Pram Street Seaside OR 97138
G7	B1-6	Robert C Leatherman 2175 S. Pram St Seaside OR 97138
G7	B1-7	Tim Johnson 668 Geneva Place Tampa FL 33606
G7	C1-1	Christine Cox 3 Sunrise Drive Eastport ME 04831
G7	C1-9	Jane Smith 8 Redoubt Hill Eastport ME 04831

Please use additional sheets if necessary and attach hereto.**CERTIFICATION**

I, Wes Farley, ^{assessor} Town Clerk for the Town of Eastport certify that the names and addresses of the property owners listed above, as well as the map and lot numbers, are those listed in the records of this municipality and are current as of this date.

SIGNED: Kenneth W Farley DATE: 8/5/2025

RIPARIAN LANDOWNER LIST****THIS LIST MUST BE CERTIFIED****

On this list, please show the current landowners' names and mailing addresses as listed in the municipal tax records for all riparian shorefront parcels within 1,000 feet of the existing lease site along with the map and lot number for each parcel. **It is the applicant's responsibility to assemble the information for the Town Clerk to certify.** The Town Clerk only certifies that the information is correct according to the Town's records. Once you have completed the form, ask the Town Clerk to complete the certification section below. If the parcels are within more than one municipality, provide a separate, certified riparian list for each municipality.

TOWN OF:

MAP #	LOT #	Landowner name(s) and address(es)
G5	BH-1	Seaview RV Resort LLC 110 Norwood Road Eastport ME 04831
G6	C3-5	Glenn Reed Inc. 123 Johnsneck Rd Shirley NY 11967

Please use additional sheets if necessary and attach hereto.

CERTIFICATION

I, Wes Farley, Town Assessor, Town Clerk for the Town of Eastport certify that the names and addresses of the property owners listed above, as well as the map and lot numbers, are those listed in the records of this municipality and are current as of this date.

SIGNED: Benneth W Farley DATE: 8/5/2025

TOWN OF EASTPORT
PROPERTY MAP
WASHINGTON COUNTY, MAINE

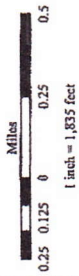

FOR ASSESSMENT PURPOSES ONLY
 NOT TO BE USED FOR CONVEYANCES
 Prepared By:
 Christopher Feldner - 2015
 christopher.feldner@gmail.com

INDEX

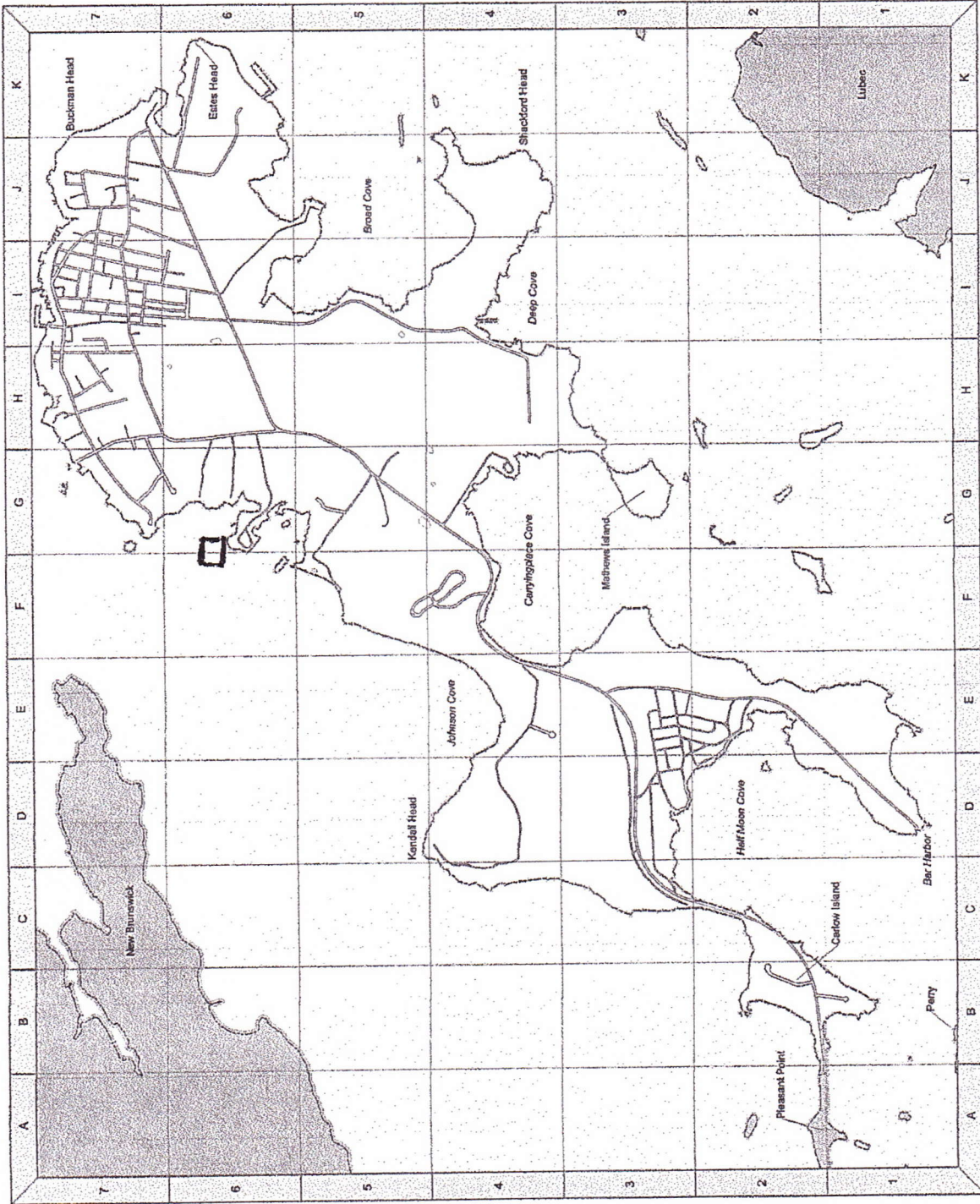



Prepared By:
Christopher Federico ~ 2013
christopher.m.federico@gmail.com

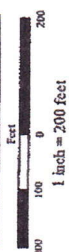
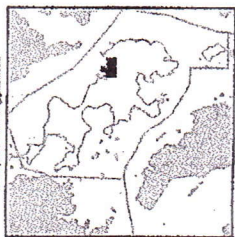

MAP G-6

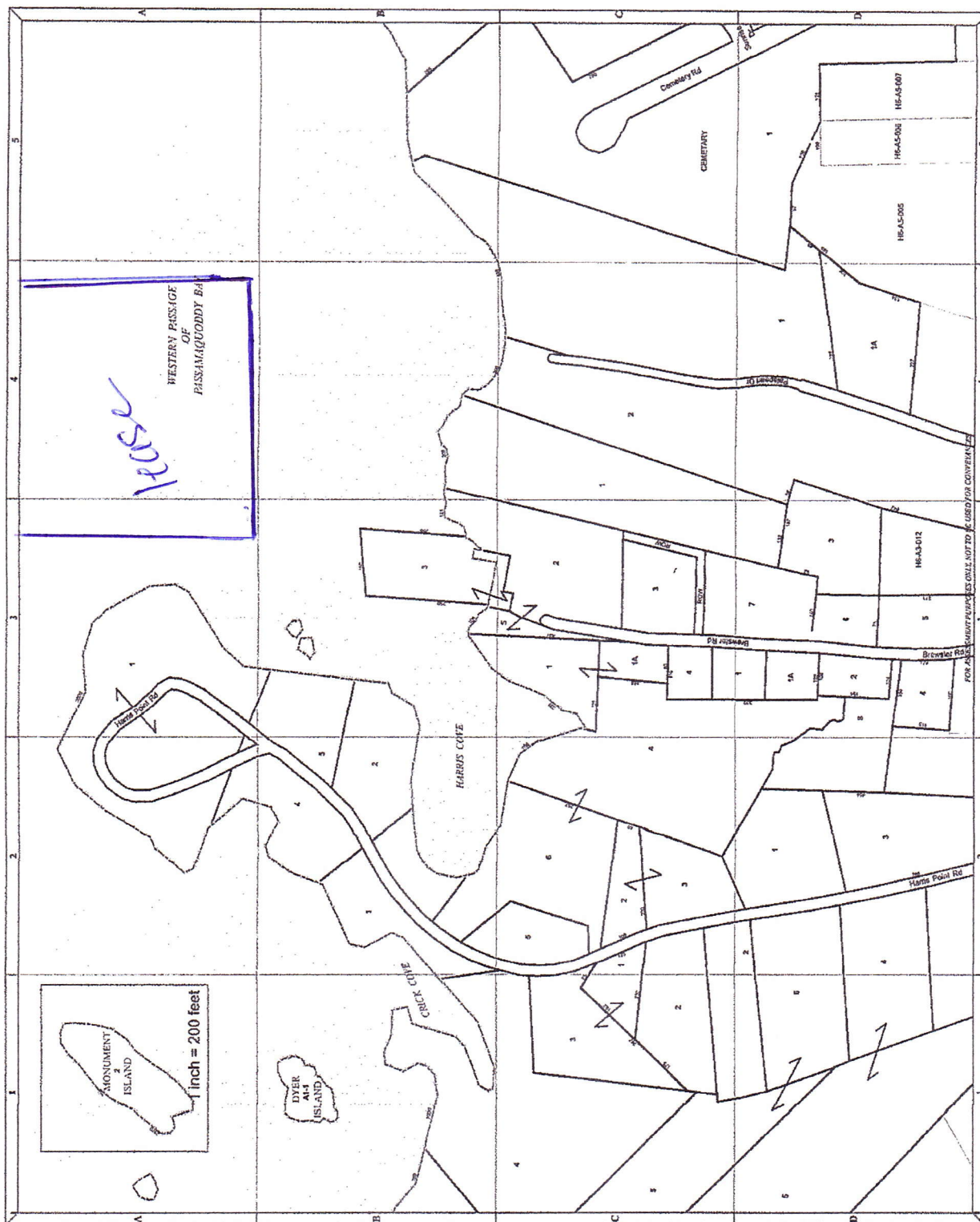

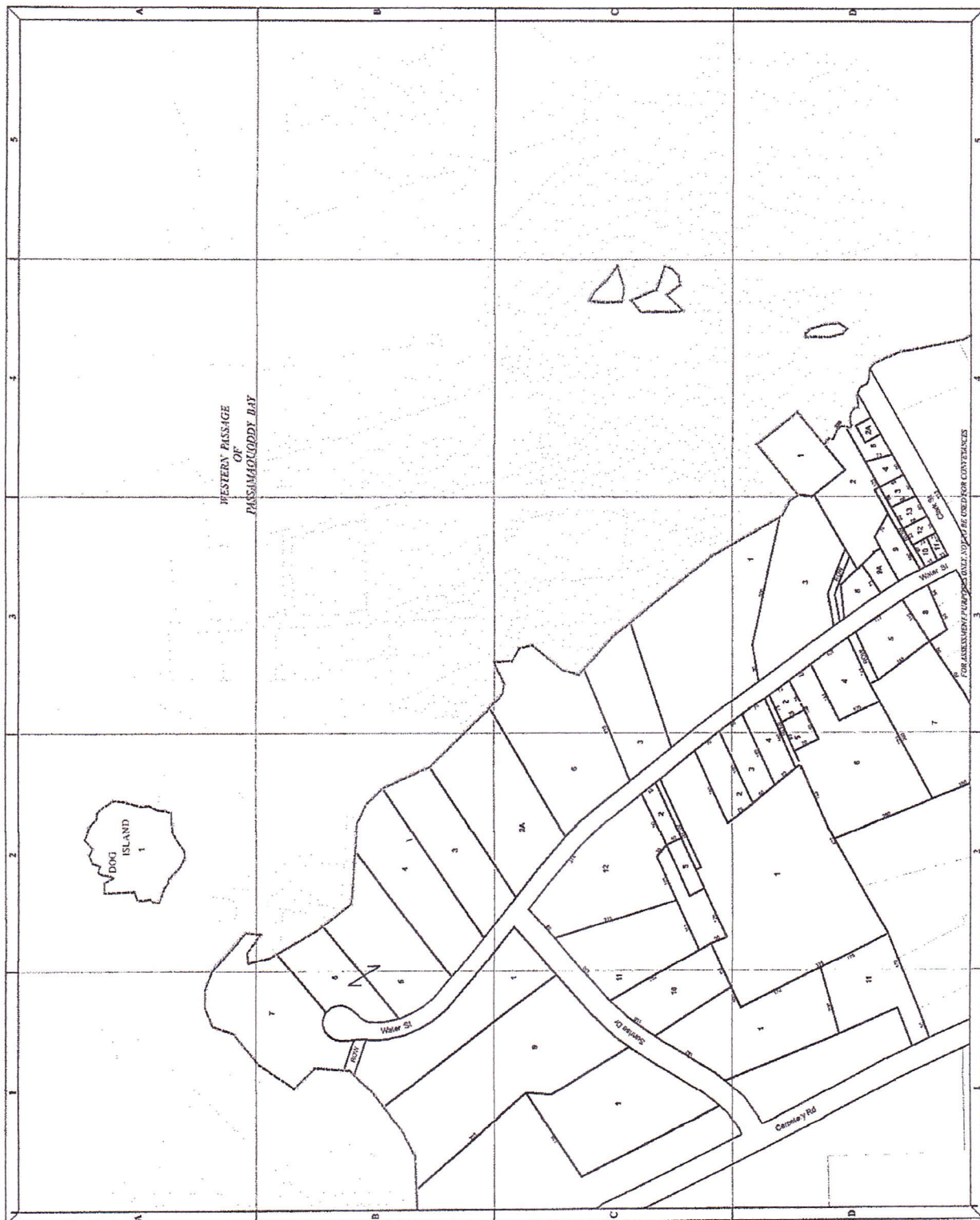
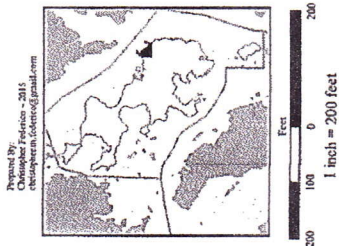
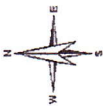

TOWN OF EASTPORT
PROPERTY MAP
WASHINGTON COUNTY, MAINE

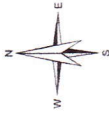

Prepared By:
Christopher Federico - 2015
christopher@federicogeomatic.com



Feet
0 100 200
1 inch = 200 feet

