



### APPLICATION FOR LEASE RENEWAL



<b>Lease Acronym</b>	DAM BN
<b>Name of Leaseholder</b>	Johns River Shellfish LLC
<b>Name of Contact Person</b>	David P. Cheney
<b>Address</b>	1 Chickadee Way
<b>City</b>	New Harbor
<b>State, Zip</b>	ME 04554
<b>Telephone</b>	(207) 350 - 0847
<b>Email</b>	johnsriveroyster@tidewater.net
<b>Term Requested</b>	20 years

**1. Describe the type and amount of aquaculture to be conducted during the new lease term:**

During the new lease term, we will continue to grow oyster seed from hatchery to near market size with surface culture. We occasionally harvest hard clams from scuba and snorkel under the cages on the lease bottom. We buy 2 million oyster seed at 2mm every May and grow them to 1-3" before relaying them to JOHN NB3. We manage 3 connected floats, 3 boats, 2-6 employees and we manage longlines of oyster grow 6 pack cages and Flip Farm Hexcyl Baskets yearround. We request a 20 year term.



2. Describe the amount of aquaculture conducted on the lease site during the previous lease term, including but not limited to seeding, cultivation or harvest of organisms:

During our previous lease term we gave up on bottom culture after the oyster drills consumed all of the oysters. We are transitioning from wire oyster grow cages to plastic Flip Farm baskets in the same footprint with the same longlines. Last season, after the noncompliance letter, I relocated the lease boundary anchors and revamped the longlines so that all of the surface gear would remain in the lease boundaries during all tidal stages. Currently, the lease is marked with yellow sea farm bouys meeting USACOE requirements. Dec-Mar oyster gear is wintering on the river bottom, rafts and boats are removed until April when we raise Oyster Gro Cages and replace air caps, Flip Farm 12 liter floats are replaced and all gear (floats & boats) by May 1st. May-Nov. we manage this site Mon - Friday 7-5 and weekends Jun- Aug. Around the 20th of May, we purchase 1-2 million seed oysters from local hatcheries. We systematically air dry gear on longlines biweekly and tumble monthly to sort and restock with similar sized oysters. We operate a hydraulic tumbler, wash down hose, under a shade tent and grow oysters in stackable cages on the raft complex where we also air dry the same gear when not in use.

3. Suspended culture gear can attract birds that roost on the gear and defecate, potentially creating a pollution source impacting shellfish held within gear. In order to comply with the National Shellfish Sanitation Program (NSSP) Model Ordinance (MO), if the lease site is permitted for the culture of shellfish in suspended gear, please include a description of mitigation or deterrent measures to minimize the potential pollution impacts of birds at the lease site. If appropriate, include Sketches or photos that clearly depict those measures put into practice.

Examples may include:

- Suspended gear submerged at depth sufficient to deter roosting for at least two weeks before harvest
- Attaching physical deterrents (i.e. zip ties) to gear
- The lease site is used to culture shellfish seed only

Times New Roman 14 B I cultured on the lease site

This lease site is a nursery farm only. We would reserve the right to harvest if our other lease was closed due to PSP. The oysters grow in wire cages and Flip Farm baskets. We systematically tumble with FIFO inventory, the largest are retained in stackable cages in the raft complex. These oysters will be relayed to JOHN NB3, they are the most protected from bird waste pollution because they are 2' below the water surface covered by 2" solid hatch doors. After 7-21 days on the rafts, they are transported by boat to Johns River where they are retumbled and restocked in similar rafts with bird protection ie roofs, wooden hatches and the deck is washed down twice daily. The product is held in JOHN NB3 for 3 weeks - 3 years and harvested under HACCAP, dealer, bulk, Vibrio. regulations and my brand has not been linked to any public health infections although we have sold more than 600,000 oysters per season over the past 6 years.

### Section 3

We grow oysters in floating cages, occasionally birds roost and defecate on cages and oysters are just under the surface filtering water, this can cause Campylobacteria ; Because this is possible, all pre market oysters are removed from floating gear (flip farm & oyster gro) and put into stackable cages in the shellfish rafts for several weeks to purge. For 3 years' time all DAM BN oysters are relocated to another lease for weeks, months and years prior to selling. My custom raft grow method protects oysters from birds because these pre mkt oysters are 1 foot underwater, 2 feet below raft deck height & beneath a solid 2" wooden hatch. This prevents any bird waste contamination. This has passed wet storage inspection and been viewed by Kohl Kanwit.

## 4. Tax Maps and Riparian List

Is your existing lease within 1,000ft of shorefront land (which extends to mean low water or 1,650 ft. from shore, whichever is less, according to NOAA charts)?

Yes    No

If yes, the following supporting documents are required:

**A. Tax Map.**

A labeled copy of the appropriate tax map(s) depicting the location of the proposed lease site.

The map(s) needs to include the following elements:

- Label the map "Tax Map: Town of (name of town)."
- Legible scale
- Tax lot numbers clearly displayed
- The boundaries of the existing lease

**B. Riparian List.**

Please use the Riparian Landowner List (included on the next page) to list the name and address of every shorefront landowner within 1,000 feet of your existing lease. Have the tax collector or clerk of the municipality certify the riparian list. Refer to the Riparian Determination guidance document to ensure all riparian landowners are included: <https://www.maine.gov/dmr/aquaculture/forms/documents/RiparianDetermination.pdf>

**C. Check for \$1500 application fee**

Signature of Leaseholder: Daniel Chay President Date: 12/31/24



# Property Map Damariscotta Maine



0 500 1,000

Scale:  
1" = 500 ft.

### Legend

- Powerline
- Sub-parcel lines
- Easements
- NG911 Roads
- Secondary
- Local
- Private
- Paper Street
- Streams
- Parcels shown on this Tax Map
- Parcels shown on other Tax Maps

- Wetlands
- Forested Wetlands
- Ponds
- Road ROW
- Tidal
- Tidal Flats
- Cemeteries

### Source Documents:

Damariscotta Property Maps by James W. Sewall Co. and updated through 2009 by Maine Coast Surveying

Digital Property Maps provided by Maine Coast Surveying in 2009 and updated through 2018.

Digital Property Map updates by Maine Coast Surveying & Flood Consulting 2017 & 2018.

Digital Property Map updates by Roderick H. Crabb, Jr. (PLS 1191) 2019.

Maine Office of Geographic Information Systems digital data layers include:

High resolution digital orthophoto imagery produced from aerial photos collected in the Spring of 2013 and 2018.

Road Type contains Next Generation 5-1-1 road centerline and road name data last updated June 20, 2022.

Streams depicts single line streams of Maine from USGS 1:25,000 scale quadrangles.

Wetlands (NW1) contains LSPW National Wetland Inventory polygon data for Maine at 1:24,000 scale.

The tide shore was developed from two foot contours derived from 2010-2011 LIDAR data courtesy of the USGS and the Maine Office of GIS.

The revision is based only on plans, deeds and other data supplied by the Town of Damariscotta.

Owner's names may be abbreviated, simplified, or omitted to save space. See Damariscotta Tax Reports for complete names.

The dimensions and areas shown were derived from this map for assessment purposes only. They may be different from previous tax maps, deeds, or surveys.

**For Assessment Purposes Only  
Not a Boundary Survey  
Not To Be Used For  
Conveyances**

prepared by:  
Roderick H. Crabb, Jr.  
P.O. Box 101  
167 Fox Hill Road  
Walpole, ME 04573

Revisions dated November 18, 2022  
based on Ownership on April 1, 2023

# Map 003

**RIPARIAN LANDOWNER LIST****\*THIS LIST MUST BE CERTIFIED\***

On this list, please show the current landowners' names and mailing addresses as listed in the municipal tax records for all riparian shorefront parcels within 1,000 feet of the existing lease site along with the map and lot number for each parcel. It is the applicant's responsibility to assemble the information for the Town Clerk to certify. The Town Clerk only certifies that the information is correct according to the Town's records. Once you have completed the form, ask the Town Clerk to complete the certification section below. If the parcels are within more than one municipality, provide a separate, certified riparian list for each municipality.

TOWN OF:

DAMARISCOTTA

MAP #	LOT #	Landowner name(s) and address(es)
003	033-001	Shields - HAAS, CAULIA J + Shields-HAAS VANESSA 34 Holmes Street, Rockland ME 04841
003	043-007	MARK Francis, KURAS + MARGARET weed, KURAS 158 Malone ROAD SAIT POINT, NY 12578
003	043-006	William H, Judd, III 12 Midden Way DAMARISCOTTA, ME 04543

Please use additional sheets if necessary and attach hereto.**CERTIFICATION**

I, Tara Oliver Dep. Town Clerk for the Town of Damariscotta certify that the names and addresses of the property owners listed above, as well as the map and lot numbers, are those listed in the records of this municipality and are current as of this date.

SIGNED:

Tara Oliver

DATE:

12/31/2024

## RIPARIAN LANDOWNER LIST

\*THIS LIST MUST BE CERTIFIED\*

On this list, please show the current landowners' names and mailing addresses as listed in the municipal tax records for all riparian shorefront parcels within 1,000 feet of the existing lease site along with the map and lot number for each parcel. It is the applicant's responsibility to assemble the information for the Town Clerk to certify. The Town Clerk only certifies that the information is correct according to the Town's records. Once you have completed the form, ask the Town Clerk to complete the certification section below. If the parcels are within more than one municipality, provide a separate, certified riparian list for each municipality.

TOWN OF:

DAMARISCOTTA

MAP #	LOT #	Landowner name(s) and address(es)
003	015	MARTHA K Lynch Revocable Living TRUST 562 Main Street DAMARISCOTTA ME 04543
003	017	Todd Savage + Heather K Savage 04543 574 Main Street, Unit 100, DAMARISCOTTA, ME <del>04543</del>
003	020	Sandra Francis 584 Main Street DAMARISCOTTA ME 04543
003	019	Maine State of Dept of Inland Fisheries / Game 41 State House Station AUGUSTA ME 04333
003	021	Maine State of Dept of Inland Fisheries / Game 41 State House Station AUGUSTA ME 04333
003	031-002	Adam C Wheeler 16 Victoria Road CAMDEN ME 04843

Please use additional sheets if necessary and attach hereto.

CERTIFICATION

I, Tara Oliver Deputy, Town Clerk for the Town of Damariscotta certify that the names and addresses of the property owners listed above, as well as the map and lot numbers, are those listed in the records of this municipality and are current as of this date.

SIGNED:



DATE:

12/31/2024



**RIPARIAN LANDOWNER LIST**

**\*THIS LIST MUST BE CERTIFIED\***

On this list, please show the current landowners' names and mailing addresses as listed in the municipal tax records for all riparian shorefront parcels within 1,000 feet of the existing lease site along with the map and lot number for each parcel. **It is the applicant's responsibility to assemble the information for the Town Clerk to certify.** The Town Clerk only certifies that the information is correct according to the Town's records. Once you have completed the form, ask the Town Clerk to complete the certification section below. If the parcels are within more than one municipality, provide a separate, certified riparian list for each municipality.

TOWN OF:

*DAMARISCOTTA*

MAP #	LOT #	Landowner name(s) and address(es)
3	043	COASTAL RIVERS CONSERVATION TRUST PO BOX 333 DAMARISCOTTA ME 04543
3	043-004	COASTAL RIVERS CONSERVATION TRUST PO BOX 333 DAMARISCOTTA ME 04543
3	043-005	GREAT SALT BAY, LLC Andrew MOSES The Maurice 145 W. 58 STREET APT PH1 NY, NY 10019
3	001-004	COASTAL RIVERS <del>TRUST</del> CONSERVATION TRUST PO BOX 333 DAMARISCOTTA ME 04543
3	001-007	Maine, State of DEPT OF FISH AND FISHERIES/BOAT 41 State House Station AUGUSTA ME 04333
3	018	Maine State of DEPT OF FISH AND FISHERIES + WILDLIFE 41 State House Station AUGUSTA ME 04333

Please use additional sheets if necessary and attach hereto.

**CERTIFICATION**

I, Tara Oliver Deputy Town Clerk for the Town of Damariscotta certify that the names and addresses of the property owners listed above, as well as the map and lot numbers, are those listed in the records of this municipality and are current as of this date.

SIGNED Tara Oliver DATE: 12/31/2024



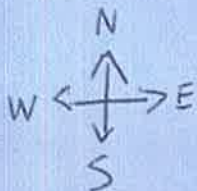
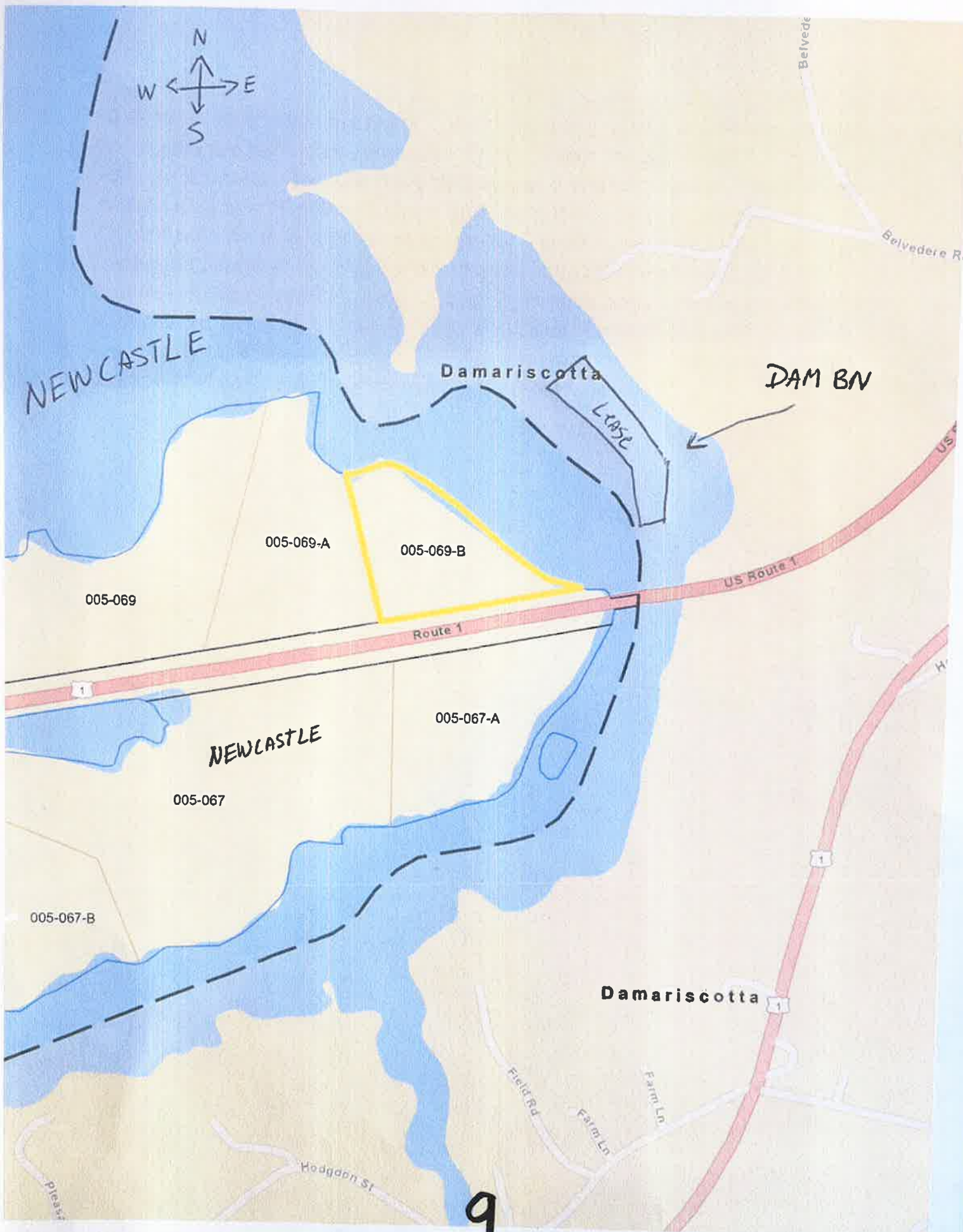

NEWCASTLE

Damariscotta

DAM BN

LEASE

005-069-A

005-069-B

005-069

Route 1

US Route 1

NEWCASTLE

005-067-A

005-067

005-067-B

Damariscotta

Field Rd

Farm Ln

Farm Ln

Hodgdon St

Pleasant

9

**RIPARIAN LANDOWNER LIST**

**\*THIS LIST MUST BE CERTIFIED\***

On this list, please show the current landowners' names and mailing addresses as listed in the municipal tax records for all riparian shorefront parcels within 1,000 feet of the existing lease site along with the map and lot number for each parcel. **It is the applicant's responsibility to assemble the information for the Town Clerk to certify.** The Town Clerk only certifies that the information is correct according to the Town's records. Once you have completed the form, ask the Town Clerk to complete the certification section below. If the parcels are within more than one municipality, provide a separate, certified riparian list for each municipality.

TOWN OF: Newcastle

MAP #	LOT #	Landowner name(s) and address(es)
005	069-A	COASTAL RIVERS TRUST Route one, PO Box 333 DAMARISCOTTA, ME 04543
005	069-B	COASTAL RIVERS TRUST, Route 1 PO Box 333, DAMARISCOTTA, ME 04543
005	067-A	COASTAL RIVERS TRUST, Route 1 PO Box 333, DAMARISCOTTA, ME 04543

Please use additional sheets if necessary and attach hereto.

**CERTIFICATION**

Emma C. McFearney Town Clerk for the Town of Newcastle certify that the names and addresses of the property owners listed above, as well as the map and lot numbers, are those listed in the records of this municipality and are current as of this date.

SIGNED: [Signature] DATE: 12/30/2024