

LEASE TRANSFER APPLICATION

1. LEASE. Identify the lease to be transferred.

Acronym of Lease Proposed for Transfer	Pen LD 2
Date Lease Expires	February 20 th 2023
Town	Deer Isle
Water Body	Long Cove
Acreage	0.50 acres
Authorized Species	American & European oysters, & blue sea mussels
Army Corps of Engineers Authorization Number	199 802 969

2. TRANSFEROR. Identify the present lessee (if multiple lessees, provide information for each one; use a separate sheet if necessary).

Applicant	DLW Enterprises INC
Contact Person	Danny Weed
Address	683 North Sedgwick Rd
City	Sedgwick
County	Hancock
State, Zip	ME 04676
Country	USA
Telephone	359-2011 office - 460-7760 cell
Email	msttweed@myfairpoint.net

Note: The email address you list here will be the primary means by which we will contact you. Please provide an email address that is checked regularly. If you do not use email, please leave this blank.

3. PAST USE OF LEASE

Has this lease been used for aquaculture during its term?	<input checked="" type="checkbox"/> Yes <input type="checkbox"/> No
---	---

A. If "Yes", describe the aquaculture activities, including but not limited to seeding, cultivation, or harvest of organisms.
<ul style="list-style-type: none">- Oysters are sunk to bottom by the end of November,- oysters are brought to the surface by mid April.- oysters are cleaned & sorted thru out the warm water season.- oysters are harvested & taken to market as they grow to size.- seed is placed on site by mid to late June and tended to as needed.

B. If "No", explain why no aquaculture has been conducted.

4. TRANSFEREE. Identify the proposed transferee (if multiple transferees, provide information for each one; use a separate sheet if necessary).

Applicant	Long Cove Sea Farm, LLC
Contact Person	Abigail Barrows
Address	396 Airport Road
City	Stonington
County	Hancock
State, Zip	Maine, 04681
Country	USA
Telephone	2077303370
Email	longcovefarm@gmail.com
Transfer Type	<input type="checkbox"/> Include transferee on lease with current leaseholder <input checked="" type="checkbox"/> Transfer entire lease to transferee

Note: The email address you list here will be the primary means by which we will contact you. Please provide an email address that is checked regularly. If you do not use email, please leave this blank.

5. TRANSFEREE'S CURRENT LEASE(S). List all Maine aquaculture leases now held by the transferee(s).

Lease Acronym	Expiration Date	Town	Water Body	Acreage	Authorized Species
PEN LD3	02/20/2023	Deer Isle	Long Cove	2.45	Crassostrea virginica, Ostrea edulis, Mytilus edulis, Saccharina latissima, Placopecten megalanicus

6. RIPARIAN LANDOWNERS AND SITE ACCESS

A. If the lease is within 1,000 ft of shorefront land (which extends to mean low water or 1,650 ft from shore, whichever is less, according to NOAA charts), the following supporting documents are required:

1. A labeled copy of a tax map(s) including the following elements:
 - Label the map "Tax Map: Town of (name of town)."
 - Legible scale
 - Tax lot numbers clearly displayed
 - The boundaries of the lease

2. Please use the Riparian Landowner List (included on the next page) to list the name and address of every shorefront landowner within 1,000 ft of the lease. Have the tax collector or clerk of the municipality certify the list. Refer to the Riparian Determination guidance document to ensure all riparian landowners are included: <https://www.maine.gov/dmr/aquaculture/forms/documents/RiparianDetermination.pdf>

Landowner name (s) and address(es)	LOT #	MAP #

Please use additional sheets if necessary and attach hereto.

CERTIFICATION

I, _____, Tax Collector/Clerk of the Town of _____, certify that the names and addresses of the property owners listed above as well as the map and tax map are listed in the records of this municipality and are current as of the date _____.



SIGNED: _____ DATE: _____

~~Map 6~~
Tax Map 6
Town of Deer Isle

Deep Hole

Long Cove

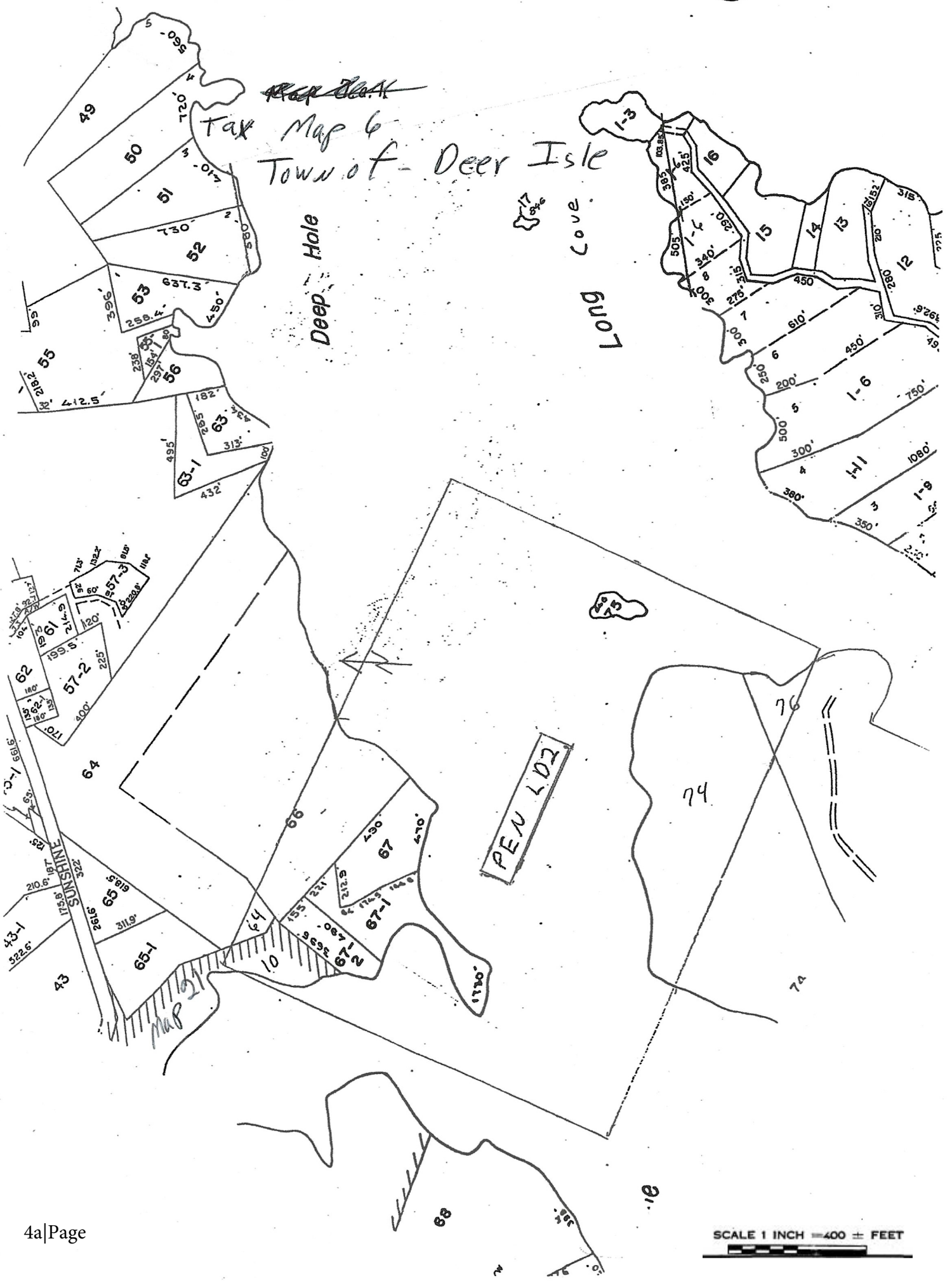

Town of Deer Isle
Tax Map 21

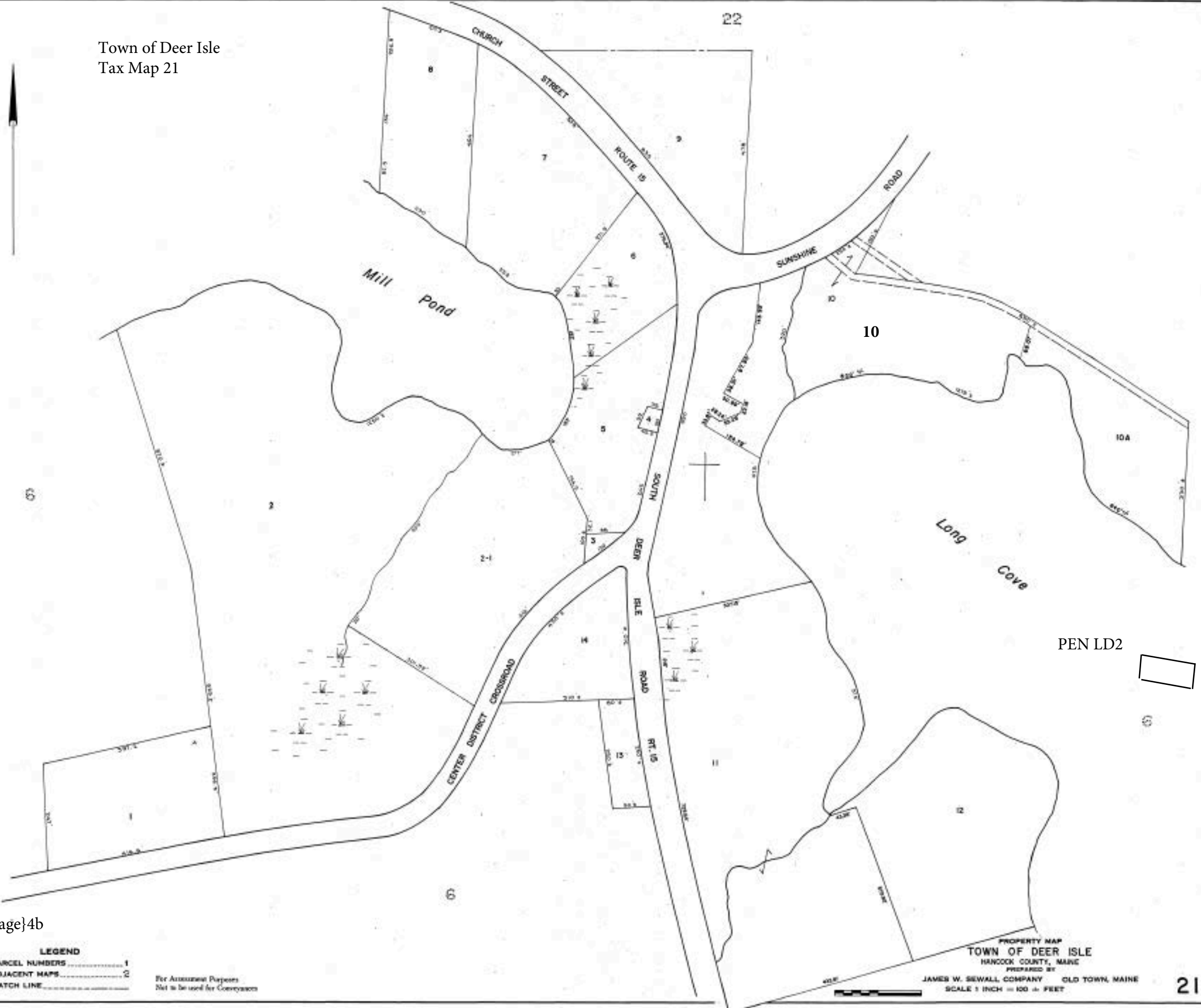

LEGEND

PARCEL NUMBERS	1
ADJACENT MAPS	2
MATCH LINE	

For Assessment Purposes
Not to be used for Conveyances

PROPERTY MAP
TOWN OF DEER ISLE
HANCOCK COUNTY, MAINE
PREPARED BY
JAMES W. SEWALL COMPANY OLD TOWN, MAINE
SCALE 1 INCH = 100 ± FEET

RIPARIAN LANDOWNER LIST

THIS LIST MUST BE CERTIFIED BY THE TOWN CLERK

On this list, please include the map number, lot number, and the current owners' names and mailing addresses for all shorefront parcels within 1,000 feet of the lease site. It is the applicant's responsibility to assemble the information for the Town Clerk to certify. The Town Clerk only certifies that the information is correct according to the Town's records. Once you have completed the form, ask the Town Clerk to complete the certification section below. If riparian parcels are located within more than one municipality, provide a separate tax map and certified riparian list for each municipality.

TOWN OF: Deer Isle

MAP #	LOT #	Landowner name(s) and address(es)
6	64	Barter Lumber P.O. Box 330 Deer Isle, ME 04627
6	66	Evergreen Garden Club P.O. Box 732 Deer Isle, ME, 04627
6	67 67-1 67-2	Jeffery C. Becton Trust do Jeffery Becton & Justin Heatter 94 French Camp Rd Deer Isle, ME, 04627
6	74 75	Carrol Woodward P.O. Box 1622 Bucksport, ME 04416
6	76	Bruce Elfstrom 112 Hemlock Valley Rd East Haddam, CT 06423
21	10	Douglas A. Coots & Amy Bernhardt P.O. Box 688 Deer Isle ME 04627

Please use additional sheets if necessary and attach hereto.

CERTIFICATION

I, Heather Cormier, Town Clerk for the Town of Deer Isle, certify that the names and addresses of the property owners listed above, as well as the map and lot numbers, are those listed in the records of this municipality and are current as of this date.

SIGNED: Heather Cormier DATE: 12/22/21



7. TECHNICAL CAPABILITY OF THE TRANSFEREE

Provide information regarding professional expertise. For each transferee, attaching a resume or documentation of practical experience necessary to undertake aquaculture activities would satisfy this requirement.

Please see attached resume (pg 11) and note that I have been working as owner/operator of Long Cove Sea Farm since 2015. Please also visit www.longcoveseafarm.com and www.abbybarrows.com for more background and my professional expertise.

8. FINANCIAL CAPABILITY OF THE TRANSFEREE

A. Please provide documentation to show that each transferee has the financial resources to undertake this aquaculture activity. For example, each transferee may submit a letter from a financial institution or funding agency indicating that the transferee has an account in good standing, or their willingness to commit funds.

Note: Any financial information you submit with your application is part of the public record. Please exercise discretion when submitting financial information.

Please see page 12 for letter from financial institution.

B. Please provide cost estimates of the aquaculture activities the transferee plans to conduct on this lease.

In the short term I do not foresee much expense, as the lease site is well set up. In the longer term there will be gear/rope/ring replacement needed estimated to run between 2-10k.

9. FORM OF OWNERSHIP

State law limits the maximum aquaculture lease acreage a lessee can hold to 1,000 acres. Lease acreage held by a corporation or partnership is attributed to the stockholders or partners in the same proportion as their ownership in the corporation or partnership. For example, a 35% shareholder in a company holding a 100-acre lease is deemed to hold 35 acres (See DMR Rule 2.12(3)).

A. Individuals. Answer the following questions if any transferees are assuming this lease as individuals.

1. Have you applied for other aquaculture leases in Maine?	<input checked="" type="checkbox"/> Yes <input type="checkbox"/> No
--	---

2. If "Yes", list the transferee's name and state the outcome and current status of each lease	
Abigail Barrows-Experimental lease, Pickering cove, retracted Abigail Barrows-Standard lease, Pickering cove, application in process	

3. How many acres of aquaculture leases do you currently hold, whether as an individual, a stockholder, a partner, or other co-owner of a lease or leases?	2.45 acres, PEN LD3
--	---------------------

4. Have you ever been arrested, indicted, or convicted of or adjudicated to be responsible for, any violation of any state or federal marine resources or environmental protection law?	<input type="checkbox"/> Yes <input checked="" type="checkbox"/> No
---	---

1. If "Yes", list all such incidents	

B. Corporations or Partnerships. Complete the following steps if any transferees are organized as corporations or partnerships, including LLCs.

1. Include a copy of corporate filing information with this application
2. Complete and submit with this application the “Corporate Applicant Information Document” available at:
<http://www.maine.gov/dmr/aquaculture/forms/standard.html>

See pages 13-16 for the Corporate Applicant Information Document
See page 17-18 for the LLC Certification of Formation.

Print name:

Title (if corporate applicant):

Transferor's Signature:

Print name:

Title (if corporate applicant):

Transferor's Signature:

10. TRANSFEROR'S STATEMENT (if multiple lessees/transferors, provide additional completed signature pages as necessary)

By signing this application, the UNDERSIGNED LESSEE hereby states that they have read and understand the requirements of the Department's statutes and rules governing aquaculture and the transfer application instructions. The undersigned lessee certifies that the following information is true and correct:

- The lease site is in good order and is in compliance with all DMR aquaculture laws and regulations;
- There are no rent bills outstanding;
- The required bond or escrow account is in place and will remain effective until the transferee obtains new coverage; and
- All required reports have been filed.

Print name: Danny Weed

Title (if corporate applicant): president/owner

Transferor's Signature: Danny Weed Date: 01-03-22

Print name: _____

Title (if corporate applicant): _____

Transferor's Signature: _____ Date: _____

11. TRANSFEREE'S STATEMENT (if multiple transferees, provide additional completed signature pages as necessary)

By signing this application, the UNDERSIGNED TRANSFEREE hereby states that they have read and understand the requirements of the Department's statutes and rules governing aquaculture and the transfer application instructions. The undersigned transferee hereby certifies that:

- The information in this application is true and correct;
- I understand that I am bound by the requirements of Maine law and DMR's statutes and rules governing aquaculture;
- I understand that I am assuming the existing lease, including any conditions; and
- Upon approval of the transfer by DMR I will either open an escrow account or obtain a performance bond, as required by DMR.

Print name: Abigail Barrows

Title (if corporate applicant): Owner

Transferee's Signature:  Date: 01-31-2022

Print name: _____

Title (if corporate applicant): _____

Transferee's Signature: _____ Date: _____

OBJECTIVE

To utilize my science and communication skills to conduct meaningful research with tangible outcomes.

EXPERIENCE

Ocean Analytics, LLC

Consulting services

Stonington, Maine

January 2017-present

- Microplastic laboratory analysis
- Public speaking engagements
- Review & dissemination of scientific publications
- Single-use plastic legislation research

Long Cove Sea Farm, LLC

Aquaculture Owner/operator

Stonington, Maine

January 2015-present

- Responsible for all aspects of business & oyster husbandry

Adventure Scientists

Principal Investigator: Global Microplastics Initiative

Stonington, Maine/Bozeman, Montana

May 2014 – March 2018

- Laboratory management and QA/QC
- Hire, train and supervise lab analyst
- Data management, analysis for use in regulatory processes
- Peer-reviewed publication
- National and international academic presentation

The Shaw Institute

Coastal Monitoring Coordinator

Blue Hill, Maine

January 2013 – November 2015

- Management and execution of water quality monitoring program & citizen science program
- Results reporting, GIS mapping
- Grant writing and program budget administration
- Hire, train and supervisor to research interns
- Maine State House research testimonies on plastic research

Ocean Classroom Foundation

Marine Educator

New England, USA

May 2010 – August 2010

- Teach 15- 23 junior high/high school students/at-risk youth on 125 ft live-aboard schooner
- Curriculum design
- Medical Officer, education/food budget and crew duties

Motupore Island Research Center

Project Manager: Seahorse Distribution, Diversity and Trade

Papua New Guinea

March 2007 – December 2007

- Organize and conduct diving and net surveys in remote waters
- Data entry and statistical analysis, GIS mapping
- Wet laboratory and field assistant manager
- Public liaison and outreach with remote island tribes/fisherman

EDUCATION

University of Tasmania

Bachelor of Science, Zoology 2006

Hobart, Tasmania, Australia

College of the Atlantic

Master of Philosophy in Human Ecology 2018

Bar Harbor, Maine

PUBLICATIONS

Lima, A.R.A., Ferreira, G.B., Barrows, A.P.W., Christiansen, K.S., Treinish, G., Toshack, M.C. (2020). **Global patterns for the spatial distribution of floating microfibers: Arctic Ocean as a potential accumulation zone.** Journal of Hazardous Materials 40, (2021) 123796.

Barrows, A.P.W., Christiansen, K.S., Bode, E.T. and Hoellein, T.J. (2018). **A watershed-scale, citizen science approach to quantifying microplastic concentration in a mixed land-use river.** Water Research 147, 382-392.

Barrows, A.P.W., Cathey, S.E., Petersen, C.W. (2018). **Marine environment microfiber contamination: Global patterns and the diversity of microparticle origins.** Environmental Pollution 237, 275-284.

Miller, R.Z., Watts, A.J.R., Winslow, B.O., Galloway, T.S., Barrows, A.P.W. (2017). **Mountains to the sea: River study of plastic and non-plastic microfiber pollution in the northeast USA.** Marine Pollution Bulletin 124, 245-251.

Barrows, A.P.W., Neumann, C.A., Berger, M.L., Shaw, S.D. (2016). **Grab vs. neuston tow net: a microplastic sampling performance comparison and possible advances in the field.** Analytical Methods. Advanced Article

Bar-Ness, Y.D., McQuillan, P.B., Whitman, M., Junker, R.R., Cracknell, M., Barrows, A. (2011). **Sampling forest canopy arthropod biodiversity with three novel minimal-cost trap designs.** Australian Journal of Entomology. 51(1):12 – 21

Baine M.S.P., Barrows A.P.W., Ganiga, G., Martin-Smith, K.M. (2009). **Residence and Movement of Pygmy Seahorses, Hippocampus bargibanti, on sea fans (Muricella spp.)** Coral Reefs. 27:2 Pp. 421.

Barrows A.P.W., Martin-Smith K.M., Baine M.S.P. (2008). **Population Parameters and Life History Characteristics of the Alligator Pipefish Syngnathoides biaculeatus (Bloch), in Papua New Guinea.** Journal of Fish Biology. 74: 4 Pp. 806-819.

CURRENT LEADERSHIP

Haystack Mountain School of Crafts Board member

Island Heritage Trust Board member

Island Workforce Housing Board member

Plastic Pollution Coalition Scientific Advisor Board member

World Ocean Observatory Board member

5 Gyres Scientific Advisory Board member



To whom it may concern,

11/18/2021

I am writing on behalf of Abigail WP Barrows, owner of Long Sea Farm LLC – to let it be known that she is in good standing account(s) wise with Camden National Bank.

Sincerely,

Katrina A Eaton

Relationship Banker

2 Atlantic Ave PO Box 65

Stonington ME 04681-0065

207-367-2201



MAINE DEPARTMENT OF MARINE RESOURCES

Aquaculture Division, 21 State House Station, Augusta, ME 04333-0021 (207) 624-6567

CORPORATE APPLICANT FORM **For Standard and Experimental Aquaculture Lease Applications**

Corporations or partnerships that apply for aquaculture leases in the State of Maine must complete this form. Corporations must submit information as requested under A. Corporate Applicant. Partnerships must submit information as requested under B. Partnership Applicant.

A. Corporate Applicant

Note: You must attach a copy of the Articles of Incorporation (Inc.) or Certificate of Formation (LLC) to your application.

1. Name of Corporation: Long Cove Sea Farm, LLC

2. Date of incorporation: 06/05/15 State of incorporation: Maine

3. List the names, addresses, and titles of all officers:

Name	Address	Title
Abigail Barrows	396 Airport Rd Stonington, ME 04681	Owner/operator

Please use additional sheets if necessary and attach to the application.

4. List the names and addresses of all directors/members:

Name	Address
Abigail Barrows	396 Airport Rd Stonington, ME 04681

Please use additional sheets if necessary and attach to the application.

5. Has the corporation, or any stockholder, director, or officer applied for an aquaculture lease for Maine lands in the past? Yes No

If you selected “yes,” please indicate who applied for the lease and the status of the application or lease. See Question 7.

6. List the names and addresses of all stockholders who own or control at least 5% of the outstanding stock and the percentage of outstanding stock currently owned or controlled by each stockholder.

Name	Address	Percentage of Owned Stock
Abigail Barrows	396 Airport Rd Stonington, ME 04681	100%

Please use additional sheets if necessary and attach to the application.

7. List the names and addresses of stockholders, directors, or officers owning an interest, either directly or beneficially, in any other Maine aquaculture leases, as well as the quantity of acreage from existing aquaculture leases attributed to each such person based on the percentage of owned stock listed in question 6. If none, write, “None.”

Name	Address	Lease Acronym	Acreage
Abigail Barrows	396 Airport Rd Stonington, ME 04681	PENLD3	2.45
Abigail Barrows	396 Airport Rd Stonington, ME 04681	Pickering Cove standard lease, draft application submitted	4.24
Abigail Barrows	396 Airport Road Stonington, ME 04681	Pickering Cove, experimental lease, application retracted	4.00

Please use additional sheets if necessary and attach to the application.

8. Has the corporation or any officer, director, member, or shareholder listed in item 5 above ever been arrested, indicted, convicted of, or adjudicated to be responsible for any violation of any marine resources or environmental protection law, whether state or federal?

Yes No

If you selected “yes”, please provide details.

B. Partnership Applicant N/A

Note: You must attach a copy of either the Certificate of Limited Partnership or documentation of the formation of a General Partnership to your application.

1. Name of Partnership: _____

2. Date of formation: _____ State of partnership: _____

3. List the names, addresses, and ownership shares of all partners:

Name	Address	Ownership Shares

Please use additional sheets if necessary and attach to the application.

4. Has the partnership, or any partner applied for an aquaculture lease for Maine lands in the past? Yes No

If you selected “yes,” please indicate who applied for the lease and the status of the application or lease.

5. List the names and addresses of any partner owning an interest, either directly or beneficially, in any other Maine aquaculture leases, as well as the quantity of acreage from existing aquaculture leases attributed to each such person, based on their ownership shares from question 3.

Name	Address	Lease Acronym	Acreage

Please use additional sheets if necessary and attach to the application.

6. Has the partnership or any partner been arrested, indicted or convicted of or adjudicated to be responsible for any violation of marine resources or environmental protection law, whether State or Federal?

Yes No

If you selected “yes”, please provide details.

MAINE
LIMITED LIABILITY COMPANY

STATE OF MAINE

CERTIFICATE OF FORMATION

File No. 20154960DC Pages 2
Fee Paid \$ 175
DCN 2151613600011 DLLC
-----FILED-----
06/05/2015

Deputy Secretary of State

A True Copy When Attested By Signature

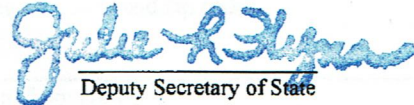
Deputy Secretary of State

Pursuant to 31 MRSA §1531, the undersigned executes and delivers the following Certificate of Formation:

FIRST: The name of the limited liability company is:

Long Cove Sea Farm LLC

(A limited liability company name must contain the words "limited liability company" or "limited company" or the abbreviation "L.L.C.," "LLC," "L.C." or "LC" or, in the case of a low-profit limited liability company, "L3C" or "l3c" - see 31 MRSA 1508.)

SECOND: Filing Date: (select one)

- Date of this filing; or
 Later effective date (specified here): _____

THIRD: Designation as a low profit LLC (Check only if applicable):

- This is a low-profit limited liability company pursuant to 31 MRSA §1611 meeting all qualifications set forth here:
- A. The company intends to qualify as a low-profit limited liability company;
 - B. The company must at all times significantly further the accomplishment of one or more of the charitable or educational purposes within the meaning of Section 170(c)(2)(B) of the Internal Revenue Code of 1986, as it may be amended, revised or succeeded, and must list the specific charitable or educational purposes the company will further;
 - C. No significant purpose of the company is the production of income or the appreciation of property. The fact that a person produces significant income or capital appreciation is not, in the absence of other factors, conclusive evidence of a significant purpose involving the production of income or the appreciation of property; and
 - D. No purpose of the company is to accomplish one or more political or legislative purpose within the meaning of Section 170(c)(2)(D) of the Internal Revenue Code of 1986, or its successor.

FOURTH: Designation as a professional LLC (Check only if applicable):

- This is a professional limited liability company* formed pursuant to 13 MRSA Chapter 22-A to provide the following professional services:

(Type of professional services)

1: The Registered Agent is a: (select either a Commercial or Noncommercial Registered Agent)

Commercial Registered Agent

CRA Public Number: _____

(Name of commercial registered agent)

Noncommercial Registered Agent

Abigail Barrows

(Name of noncommercial registered agent)

10 Tidal Cove Lane Stonington, Maine 04681

(physical location, not P.O. Box – street, city, state and zip code)

(mailing address if different from above)

SIXTH: Pursuant to 5 MRSA §105.2, the registered agent listed above has consented to serve as the registered agent for this limited liability company.

SEVENTH: Other matters the members determine to include are set forth in the attached Exhibit _____, and made a part hereof.

****Authorized person(s)**

Dated 6/3/2015



(Signature of authorized person)

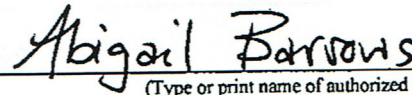

(Type or print name of authorized person)

(Signature of authorized person)

(Type or print name of authorized person)

***Examples** of professional service limited liability companies are accountants, attorneys, chiropractors, dentists, registered nurses and veterinarians. (This is not an inclusive list – see 13 MRSA §723.7)

****Pursuant to 31 MRSA §1676.1.A, Certificate of Formation MUST be signed by at least one authorized person.**

The execution of this certificate constitutes an oath or affirmation under the penalties of false swearing under 17-A MRSA §453.

Please remit your payment made payable to the Maine Secretary of State.

Submit completed form to:

**Secretary of State
Division of Corporations, UCC and Commissions
101 State House Station
Augusta, ME 04333-0101
Telephone Inquiries: (207) 624-7752**

Email Inquiries: CEC.Corporations@Maine.gov