

SLOPE CLASSIFICATION

- A** 0%–3% SLOPES
- B** 3%–8% SLOPES
- C** 8%–15% SLOPES
- D** 15%–20% SLOPES
- E** >20% SLOPES

NOTES

1. SEE ASSOCIATED SOILS REPORT TITLED "SUGARLOAF- WEST MOUNTAIN EXPANSION" FOR FURTHER DETAILS.
2. THE SOIL SURVEY WAS DONE IN ACCORDANCE WITH THE STANDARDS ADOPTED BY THE MAINE ASSOCIATION OF PROFESSIONAL SOIL SCIENTIST, MARCH 2009

LEGEND

- LN** LYMAN-TUNBRIDGE
- Sr** SURPLUS SERIES
- Pe** PERU SERIES
- HYDRIC SOILS (WETLAND AREAS)
- SOILS BOUNDARY
- STREAM (CENTERLINE)
- EDGE OF CLASS B SOIL SURVEY
- MAJOR CONTOUR LINE
- MINOR CONTOUR LINE
- SOIL TEST BORING
- SOIL TEST PIT

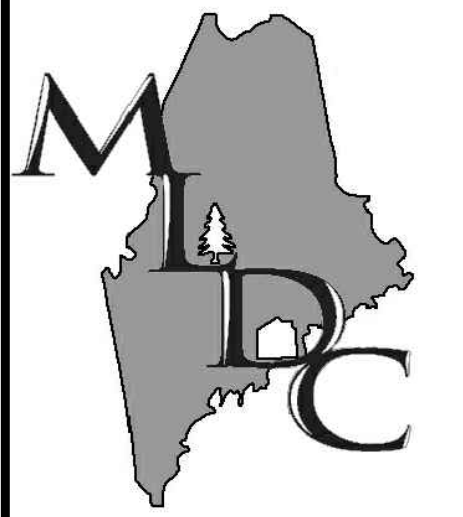
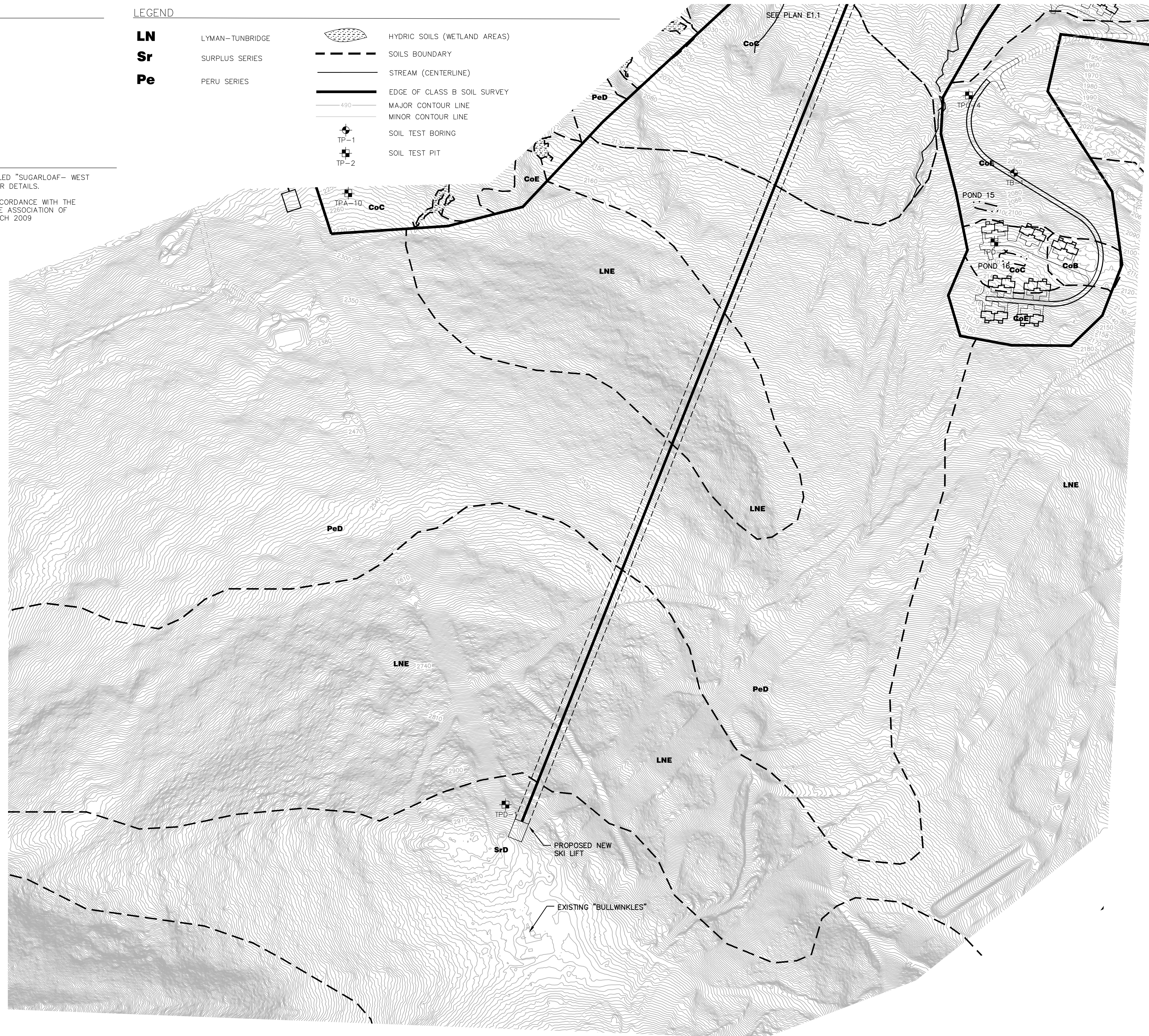

MAIN-LAND
DEVELOPMENT
CONSULTANTS, INC.

69 MAIN ST. LIVERMORE FALLS, MAINE
367 US ROUTE 1 FALMOUTH, MAINE
PH: (207) 897-6752 FAX: (207) 897-5404
WWW.MAIN-LANDDC.COM

PROJECT
**BOYNE RESORTS
WEST MOUNTAIN
EXPANSION**

NEAR WEST MOUNTAIN ROAD,
SUGARLOAF SKI RESORT

OWNER OF RECORD
BOYNE RESORTS

5092 ACCESS ROAD,
CARRABASSETT VALLEY, MAINE

MADE FOR
**VANASSE HANGEN
BRUSTLIN, INC.**

40 IDX DRIVE, BUILDING 100, SUITE
200, SOUTH BURLINGTON, VT

DRAWING SCALE:
200 0 100 200

(IN FEET)
1 INCH = 200 FT

SUBMISSION NOTES:
SUBMISSION 1: 2021-09-13 E.J.H.
REVISION FOR CLIENT REVIEW
SUBMISSION 2: 2022-02-04 E.R.T.W.
FOR PERMITTING RESUBMISSION

PROJ. MGR: RWD
DRAWN BY: ERTW & E.J.H.
CHECKED BY: ERTW
SUBMISSION NO. 2
SURVEY DATE: N/A
SUBMISSION DATE: 2022-02-04
SUBMITTED FOR: REVIEW

NOT FOR CONSTRUCTION
**CLASS B & C
HIGH INTENSITY
SOIL SURVEY**

SEAL:

Eric Whitney
ERIC R.T. WHITNEY S.S. #610

DRAWING NO.
E1.2
MLDC NO. 20-237 2 OF 2