

CGS\Projects\BE0214_Norridgewock\mxd\F01_SiteLocation_June2018.mxd; author: df:mmm; www: ProjNumTaskPhase_DocumentNumber, etc.

Source: USGS Norridgewock 7.5 Minute Quadrangle.

FIGURE 1

L:\BOSTON_JOBS\CROSSROADS\FIGURES\SITE PLAN - DEC 2016\0201_P003A (SITE PLAN)

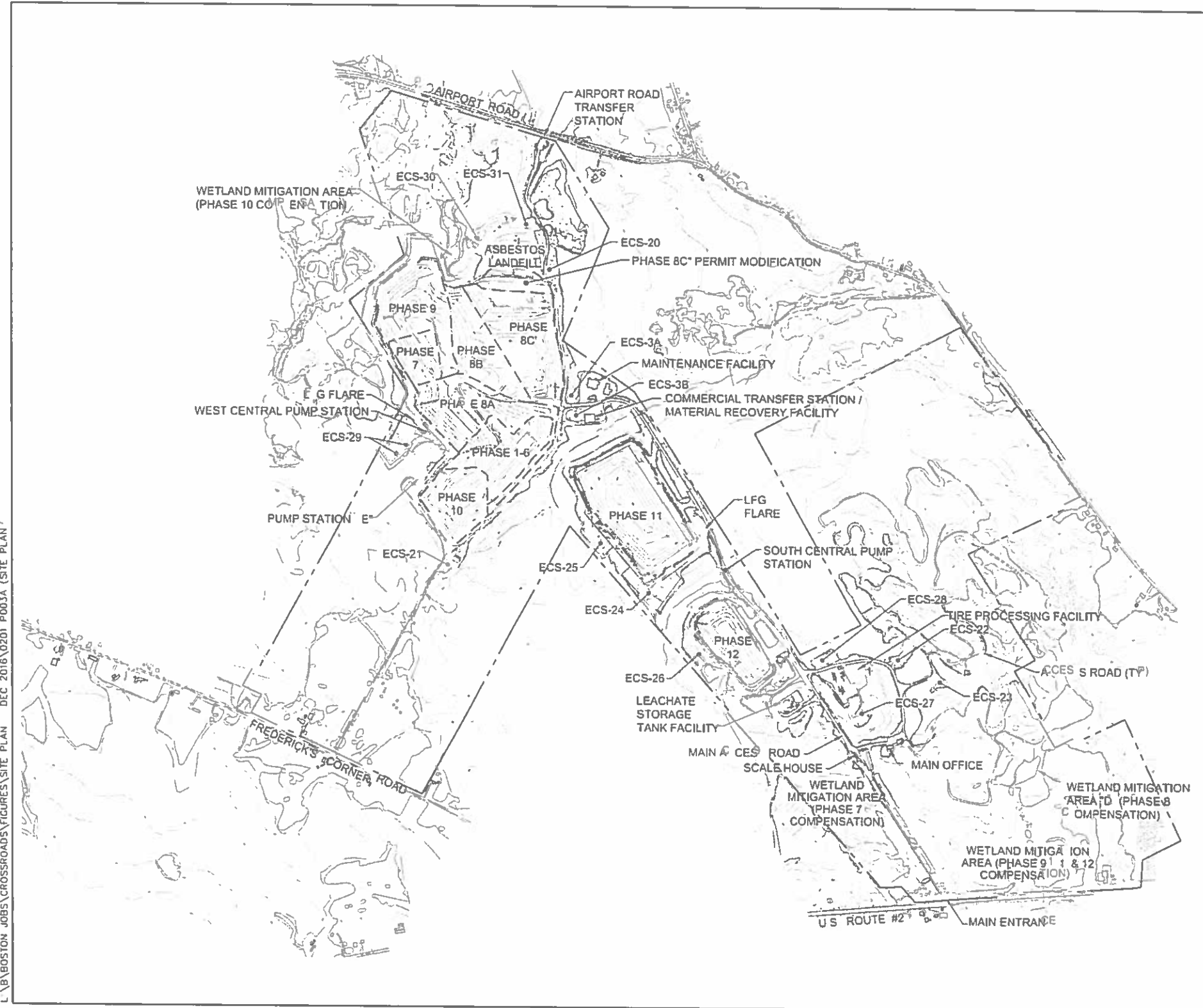

LEGEND

- GROUND SURFACE ELEVATION CONTOUR
- EXISTING BUILDINGS
- PROPERTY BOUNDARY - WASTE MANAGEMENT DISPOSAL SERVICES OF MAINE, INC.
- PHASE LIMITS

NOTES

- 1 EXISTING GROUND SURFACE AND FEATURES OBTAINED FROM AERIAL SURVEYS COMPILED BY BOYNTON AND PICKET LLC AND CONDUCTED ON 29 SEPTEMBER 2016, 31 MARCH 2016, 31 MARCH 2015 AND 29 JUNE 2014



<p>SITE PLAN CROSSROADS LANDFILL NORRIDGEWOCK, MAINE</p>	
<p>Geosyntec consultants</p>	
<p>PROJECT # BE 201</p>	<p>DECEMBER 2016</p>
<p>FIGURE 2</p>	

Municipal Solid Waste Disposal

This map shows the municipal origin of MSW and the facility or landfill where the MSW is shipped.
Last Updated June 2018

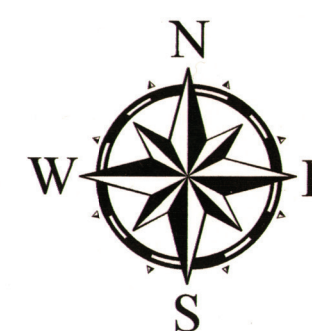

Legend

- ▲ Landfill
- △ State-Owned Landfill
- Other Facility
- ▨ Limited or No MSW Generated
- See Note 3

Landfills

- Bath Landfill
- Brunswick Landfill
- Tri-Community Landfill
- Hatch Hill Landfill
- Crossroads Landfill
- Presque Isle Landfill

Out of State Landfills

- Bethlehem Landfill, NH
- Mt. Carberry Landfill, NH
- Turnkey Landfill, NH
- Cogerno Landfill, NB
- Southwest Landfill, NB

Other Facilities

- FIBERIGHT (open October 2018)
- MMWAC, Auburn
- PERC, Orrington
- ecomaine, Portland

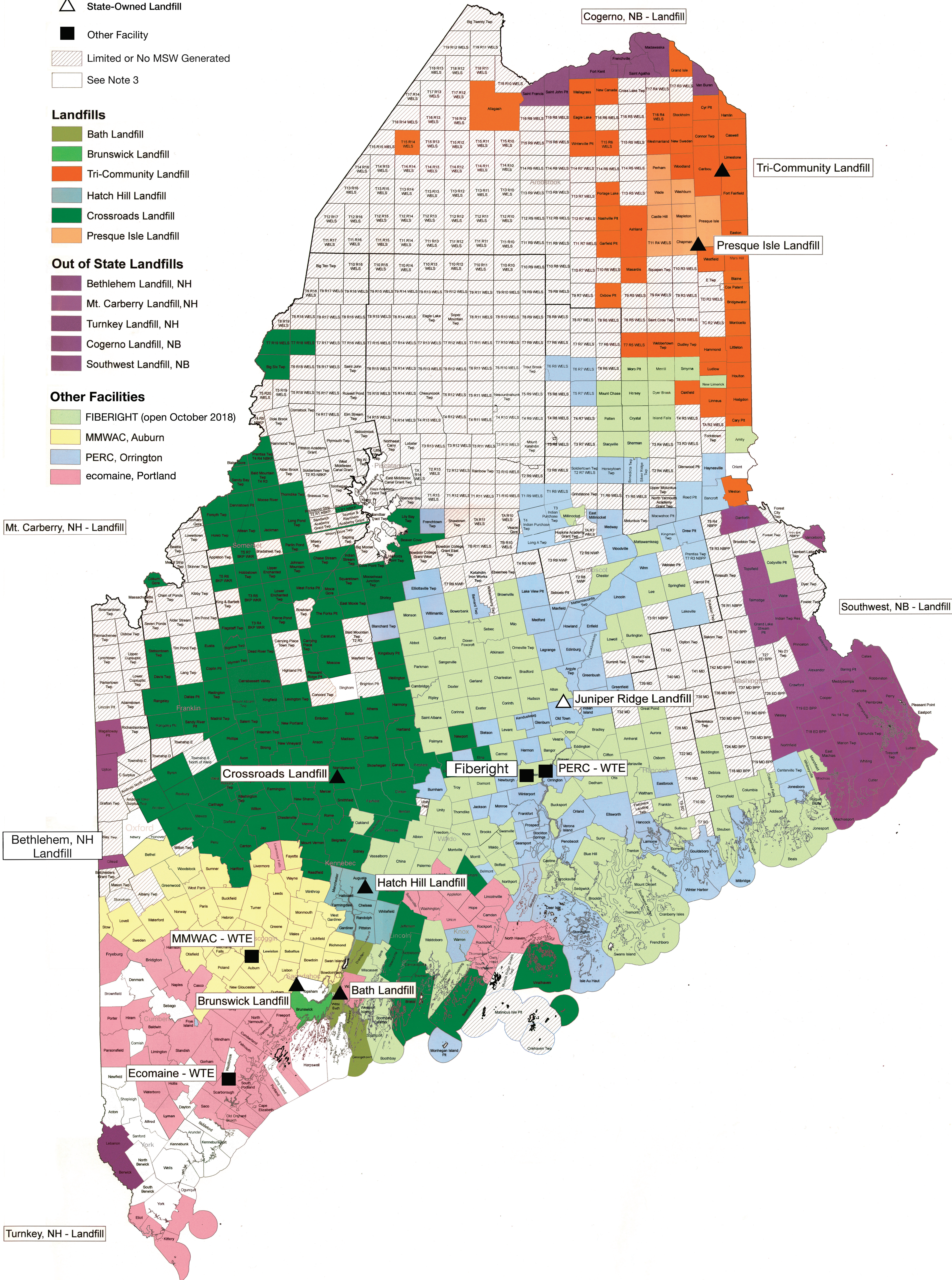

NOTES:

- (1) The disposal locations are variable. The map is based on information provided by the following sources: Maine Department of Environmental Protection, landfill or disposal facility websites and/or conversations with representatives of ecomaine, Waste Management Disposal Services of Maine, Inc. - Crossroads Landfill, Juniper Ridge Landfill, Tri-Community Landfill, Presque Isle Landfill, PERC, MRC, Hatch Hill Landfill, Brunswick Landfill, Bath Landfill and MMWAC.
- (2) The communities identified as sending their waste to Fiberight is based on commitments to do so once Fiberight becomes operational. Fiberight is currently under construction and therefore waste from the Fiberight communities is temporarily being disposed of at Crossroads Landfill, Juniper Ridge Landfill and PERC.
- (3) The MSW in these towns is hauled by contractors primarily to Juniper Ridge Landfill and secondarily to ecomaine via privately owned MSW transfer stations in Eliot, Wells, Westbrook, South Portland, Waterville, and West Bath.
- (4) Map prepared by Scott D. Collins for Waste Management Disposal Services of Maine, Inc. - Crossroads Landfill.

1:633,600

1 inch = 10 miles

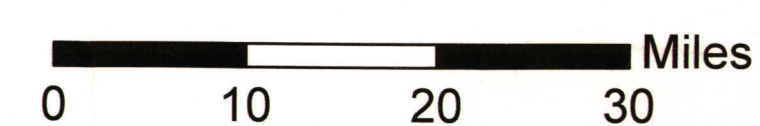
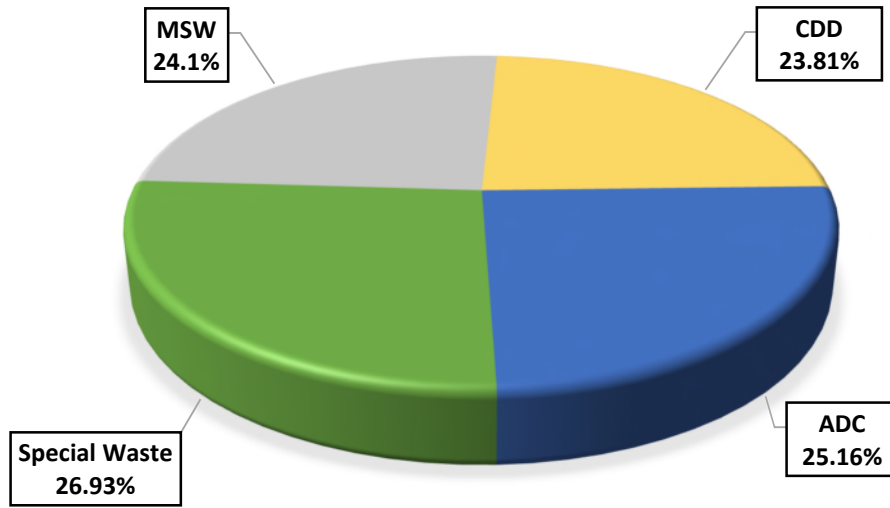
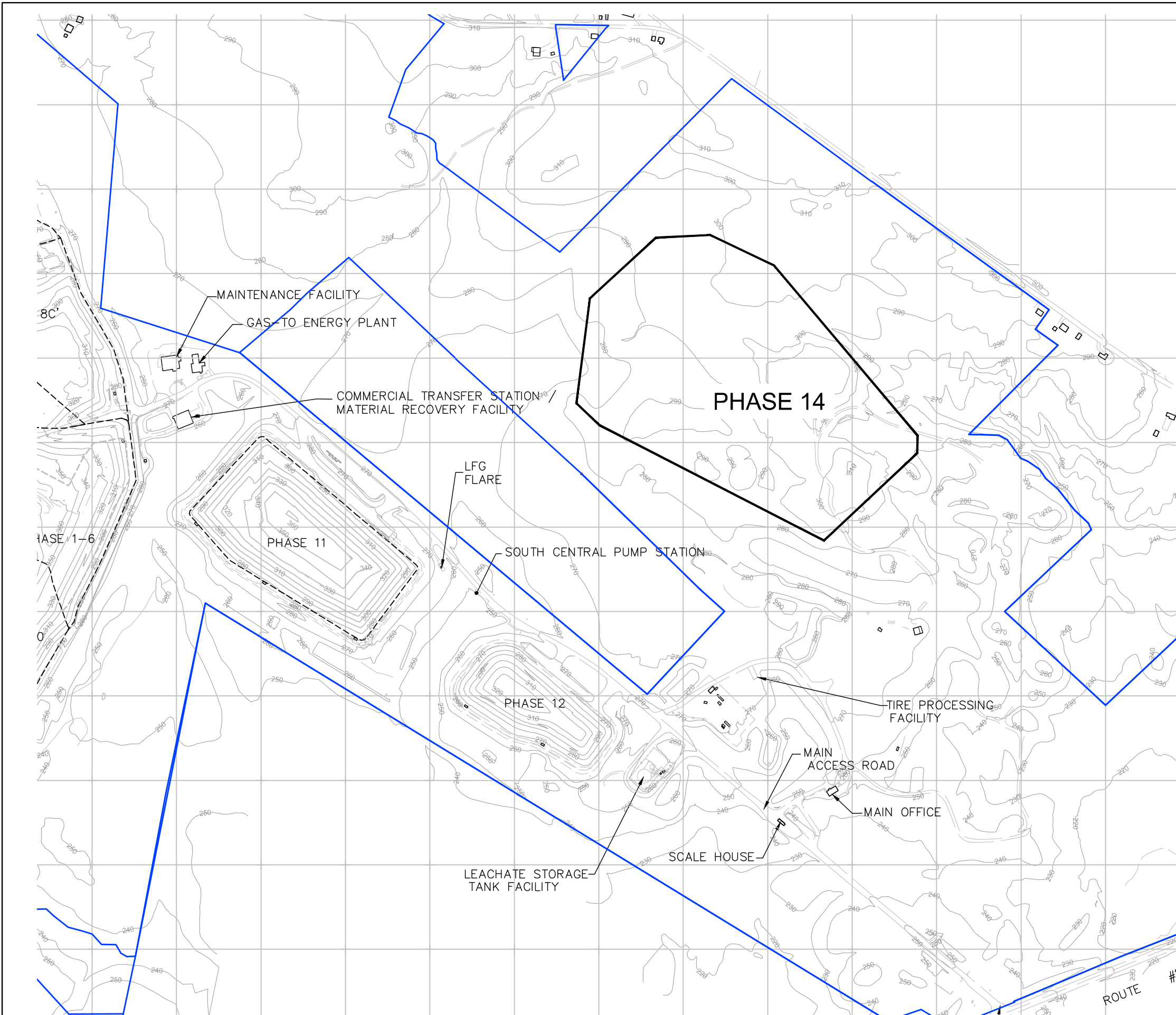

FIGURE 4: PERCENTAGE OF MATERIALS MANAGED AT CROSSROADS FROM 2004 - 2017





LEGEND

- GROUND SURFACE ELEVATION CONTOUR (NOTE 1)
- APPROXIMATE WASTE MANAGEMENT DISPOSAL SERVICES OF MAINE, INC. PROPERTY BOUNDARY (NOTE 2)
- PROPOSED WASTE BOUNDARY

NOTES:

1. EXISTING GROUND SURFACE AND FEATURES OBTAINED FROM TOPOGRAPHIC SURVEYS, DATED 2016.09.31 FULL SITE COVERAGE, AND 2017.07.03 PHASE 11; PROVIDED BY BOYNTON AND PICKET.
2. WASTE MANAGEMENT DISPOSAL SERVICES OF MAINE INC. PROPERTY BOUNDARY FROM A CAD FILE (WMDSM PROPERTY BOUNDARY 2017.DWG) PLAN TITLED "WASTE MANAGEMENT ASSUMED PROPERTIES" PREPARED BY BOYNTON & PICKET LLC DATED 8 DECEMBER 2017.



SITE PLAN PHASE 14 WASTE MANAGEMENT DISPOSAL SERVICES OF MAINE, INC. CROSSROADS LANDFILL NORRIDGEWOCK, MAINE	
	FIGURE 5
PROJECT NO: BE0232	JUNE 2018

FIGURE 6. CONSISTENCY OF PHASE 14 WITH MAINE STATE SOLID-WASTE HIERARCHY

