

NOTE: THIS SECTION OF ALIGNMENT ADJUSTED FEBRUARY 2013, AFTER SIGNIFICANT SNOW COVER. SOIL BOUNDARY LINES ARE PROJECTED FROM TEST PITS IN THE VICINITY, TOPOGRAPHY AND WETLAND INFORMATION

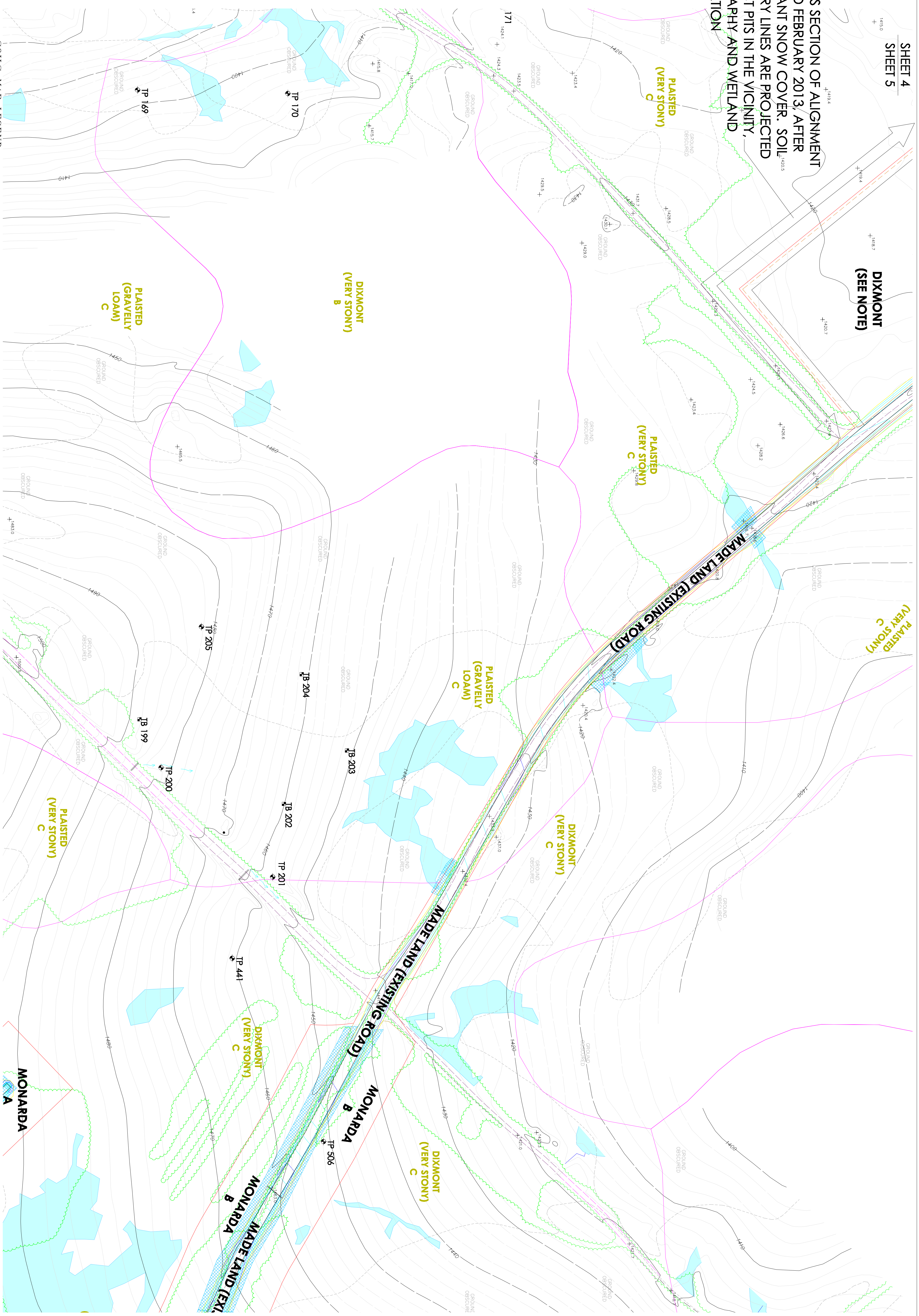

SOILS MAP LEGEND:

- SOIL TEST PIT
- WETLAND AREA
- DIKE FIELD
- SLOPE DESIGNATION A
- SLOPE DESIGNATION B
- SLOPE DESIGNATION C
- SLOPE DESIGNATION D
- NREC SOIL BOUNDARY LINE
- CLASS 1 SOIL BOUNDARY LINE
- STREAM

LIMITS OF SOIL STUDY CORRIDOR

SOIL AREA IN CORRIDOR WHICH POORLY OR SOMEWHAT POORLY DRAINED UNDER CONSERVED CONDITIONS. IF PROPOSED CONSTRUCTION IS DONE UNDER STRAIGHT ROW, BOX OF AND/OR STRAIGHT ROW, BOX OF ENGINEERING TO ADDRESS DRAINAGE ROAD ROADS

NOTE: SEE ACCOMPANYING SOIL NARRATIVE REPORT, DATED FEBRUARY 2013, OR AS REVISED.

THE ACCOMPANYING SOILS SURVEY MAP (CLASS "L"), SOIL PROFILE DESCRIPTIONS AND SOIL NARRATIVE REPORT WERE DONE IN ACCORDANCE WITH THE STANDARDS ADOPTED BY THE MAINE ASSOCIATION OF PROFESSIONAL SOIL SCIENTISTS, FEBRUARY 1995, AS AMENDED AND PREPARED BY ALBERT FRICK AND ASSOCIATES, SOIL SCIENTIST, SEALING THE PLANS AND REPORT.

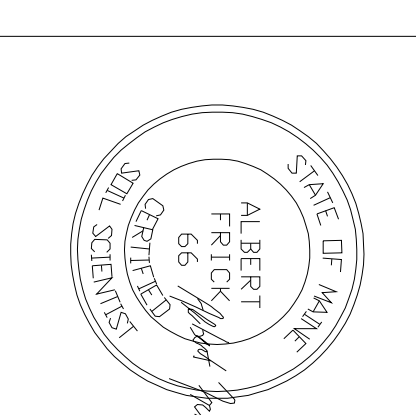

DATE:	REVISIONS:
9/17/2012	REALIGNMENT ADJUSTMENTS
11/13/2012	REALIGNMENT ADJUSTMENTS
11/29/2012	ADDITIONAL MAPPING FOR O&M
2/12/2013	REALIGNMENT ADJUSTMENTS

CLASS 1 SOILS SURVEY
PREPARED FOR
BINGHAM WIND PROJECT
(STANTEC)
BINGHAM, MAINE & PORTIONS OF
MAYFIELD AND KINGSBURY PLANTATIONS
SHEET 5 of 45

Albert Frick Associates, Inc.
Soil Scientists & Site Evaluators
Gorham, Maine 04038

Drawn by: **B.J.**
Date: **2/12/13**

Checked by: **A.F.**
Scale: **1" = 100'**