

SHOP DRAWING REVIEW**Greenlaw Building renovation - State of Maine Labs**

Project #: 15-74-00

47 Independence Drive, Augusta, ME

Division: 11

Review Date 10/21/2021

Revision: 1

REVIEW IS ONLY FOR GENERAL CONFORMANCE WITH THE DESIGN CONCEPT AND INFORMATION PROVIDED IN THE CONTRACT DOCUMENTS. THE CONTRACTOR SHALL BE SOLELY RESPONSIBLE FOR THE DETERMINATION OF ALL QUANTITIES AND DIMENSIONS, FOR COORDINATION OF THE WORK OF ALL TRADES, FOR ALL INFORMATION PERTAINING TO FABRICATION PROCESSES, TECHNIQUES OF ASSEMBLY AND CONSTRUCTION, AND FOR PERFORMING ALL WORK IN A SAFE AND WORKMAN-LIKE MANNER. REVIEW AND MARKINGS SHALL NOT BE CONSTRUED AS RELIEVING THE CONTRACTOR FROM HIS RESPONSIBILITIES FOR COMPREHENSIVE REVIEW OR FROM COMPLIANCE WITH THE CONTRACT DOCUMENTS.

Submittal No.	11 54 00-1.1
Description	Animal crematory equipment product information
Status	Note Markings & Attached Comments
Action Required	Comply w/Comments. Resubmission not Req'd.

Comments:

1. The State of Maine has reviewed and approved the revised incinerator.
2. LBA has no additional comments.

Reviewed By: John E. Adams III

PS16 Incinerator

Technical Specifications Manual

120V AND 220V

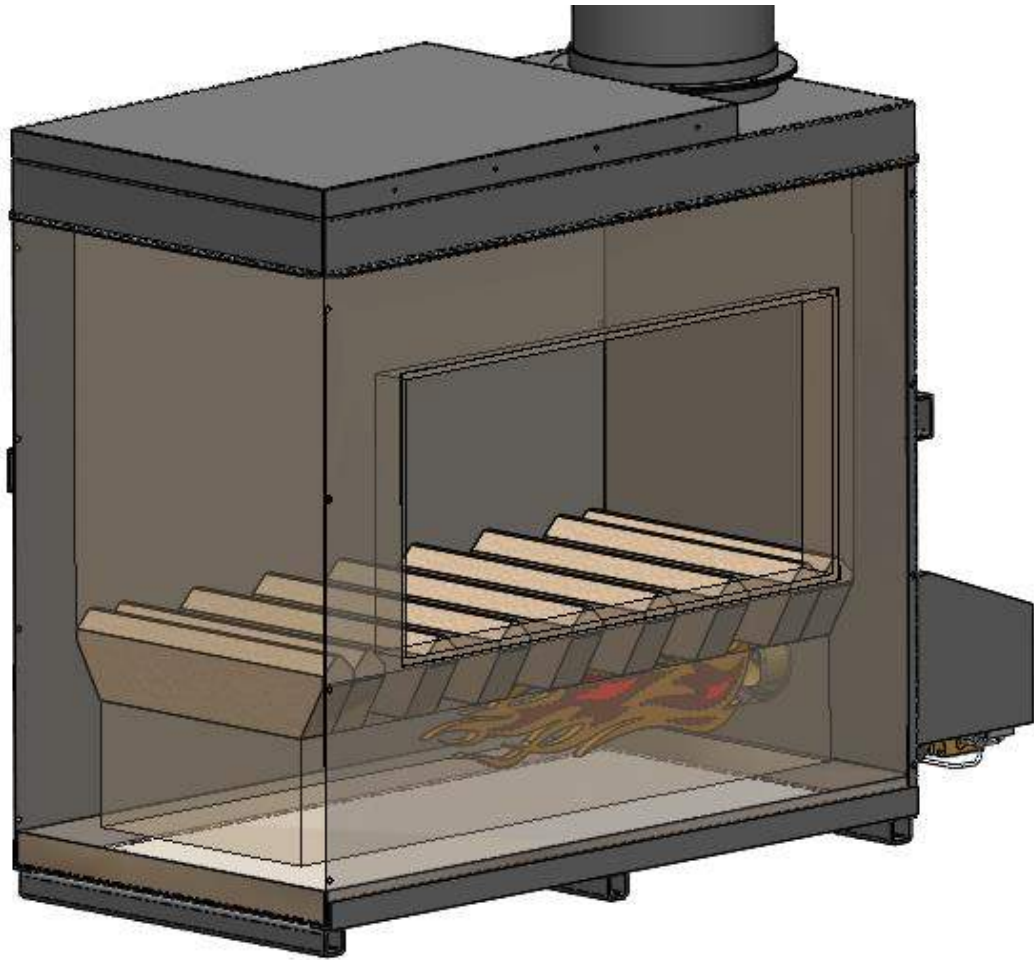

Your model and serial number are located on the lower burner cover.

www.firelakemfg.com

FIRELAKE MFG., LLC

25 Michigan St SE

Suite B

Hutchinson, MN 55350

(Tel.) 320-275-3391, (Fax) 320-275-2779

PS16-SC4

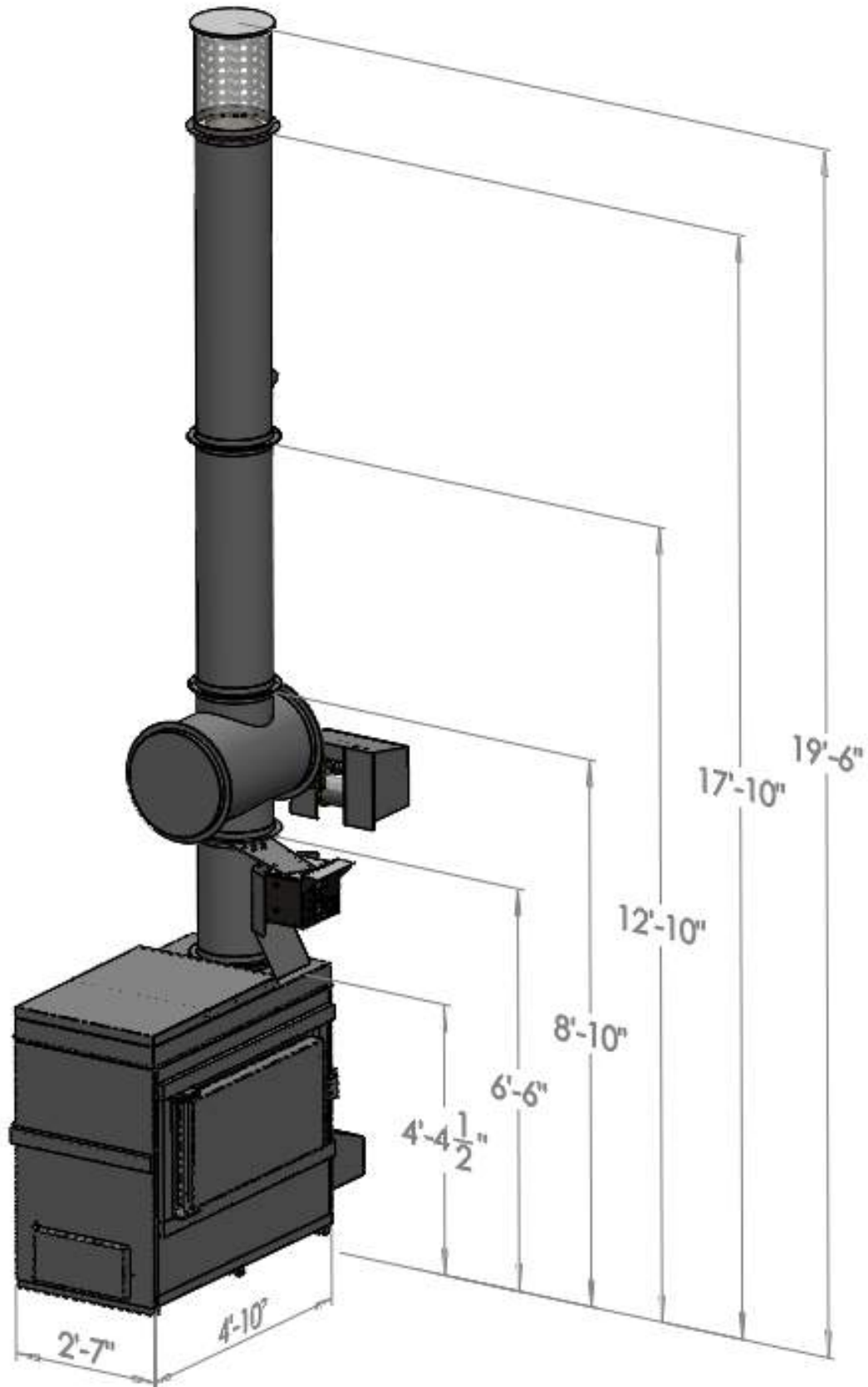

Standard Configuration shown.
Locations of control components and stacks may vary per setup ordered.

PS16-SC4

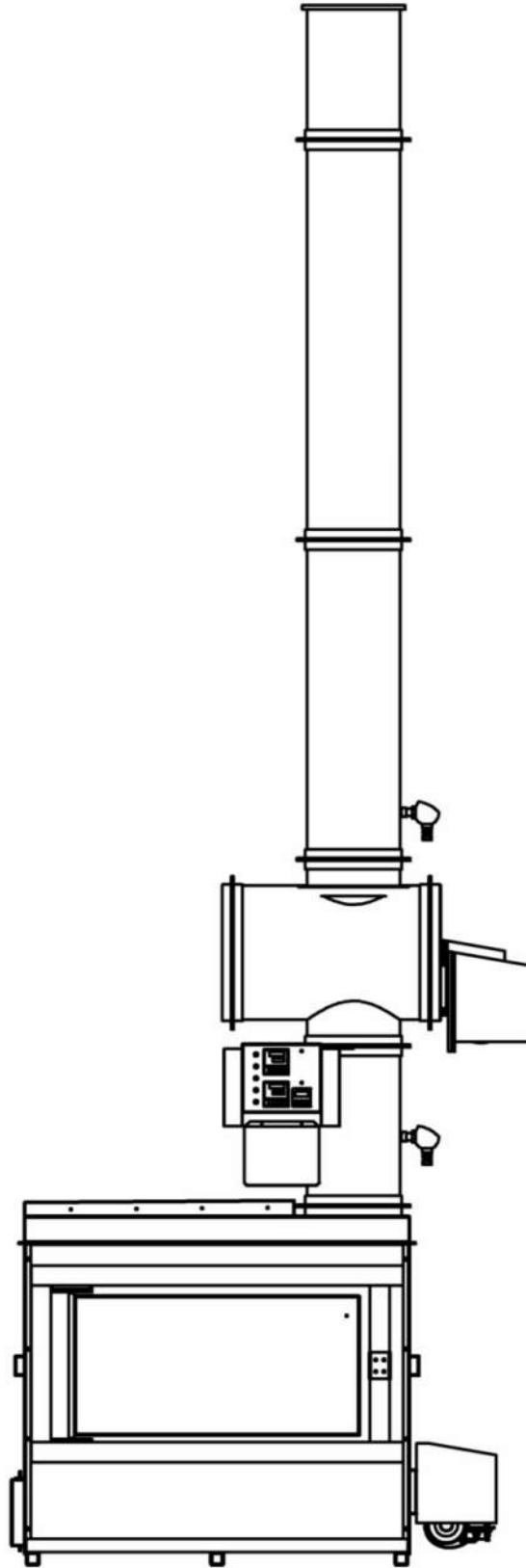

TYPICAL FINISHED SITE, SEE INSTRUCTIONS
Locations of control components may vary per setup ordered

PS16-SC4 SPECIFICATIONS

PRIMARY CHAMBER

CHAMBER CAPACITY	480 LBS WASTE AT 30 LB/FT ³
CHAMBER VOLUME	16.5 FT ³ ABOVE GRATES
DOOR DIMENSION	20" X 42"
REFRACTORY	3", 2,800°F, 126 LB/FT ³
JACKET MATERIAL	PAINTED STEEL
HEIGHT TO DOOR	20"
HEIGHT TO TOP OF CHAMBER	52"

SECONDARY CHAMBER

CHAMBER VOLUME	4 FT ³
HEIGHT TO TOP OF AFTERBURNER	8' 10"
REFRACTORY	3", 2,800°F, 126 LB/FT ³
JACKET MATERIAL	PAINTED STEEL
RETENTION AND TEMPERATURE LIMITS	UP TO ½ SECOND UP TO 1600°F (CONSULT FACTORY WITH APPLICATION DETAILS. DATA/DESIGN MAY CHANGE PER OPERATING NEEDS)

STACKS

STACK	(1) 14" DIA. 2' LONG STEEL CAST LINED (1) 14" DIA. 4' LONG STEEL CAST LINED (1) 14" DIA. 5' LONG STEEL CAST LINED
STACK CAP	(1) 14" DIA. STAINLESS STEEL

BURNERS

MODEL: GAS	(2) J83 W/ SAFETY CONTROLS
MODEL: OIL	(2) AF BECKETT BURNERS
OPERATION	DIGITAL TIMER AND TEMPERATURE CONTROLLED. CYCLES PRIMARY BURNER AS NEEDED.

GENERAL

EXTERNAL PRIMARY DIMENSIONS	2' 8" W X 4' 10" L X 4' 4" H
EXTERNAL OVERALL DIMENSIONS (STANDARD)	2' 8" W X 4' 10" L X 19' 6" H
ELECTRICAL SERVICE	STANDARD: 115 V, 60 HZ, 20 AMP EXPORT MODELS: 220 V, 50 HZ, 10 AMP
GAS SERVICE BASED ON MAXIMUM RATING OF BOTH BURNERS	1,600,000 BTU/HR NATURAL GAS 7" W.C. LIQUID PROPANE 11" W.C.
GAS/FUEL CONSUMPTION (IF CONSTANT OPERATION AND NO BURNER CYCLING ON AND OFF)	NATURAL GAS 684 CFH LIQUID PROPANE 7.19 GPH FUEL OIL 5.50 GPH
TOTAL WEIGHT	5,600 LBS (APPROXIMATELY)
PAD REQUIREMENTS (MINIMUM SUGGESTED OR CONSULT FACTORY)	12' W X 14' L X 4" THICK IF SHELTERED 6' W X 8' L X 4" THICK IF NOT SHELTERED
PAINT	1,200° PRIMER, 1,200° PAINT

CHARGING RATE

PATHOLOGICAL	VARIABLES BY WASTE PROPERTIES AND OPERATING METHODS. TYPICAL BURN RATE OF 45-75 LBS/HR
--------------	--

AIR FLOW

MINIMUM REQUIRED OPENING IN ENCLOSED BUILDING FOR AIR FLOW	22 FT ²
--	--------------------

PS16-SC4 PARTS LIST

	OPTIONAL BURNERS
23180	LOWER NAT
23187	LOWER LP
23193	UPPER NAT
23192	UPPER LP
35004	BRNR HOUSING GAS 90°

	MISCELLANEOUS PARTS
24248	GRATE BAR
32314	PAINT CHARCOAL
34034	MASTIC 1 PINT
35024	GAS PRESSURE GAUGE
102665	MASTIC 1 GAL
42200190	ARTISAN TIMER

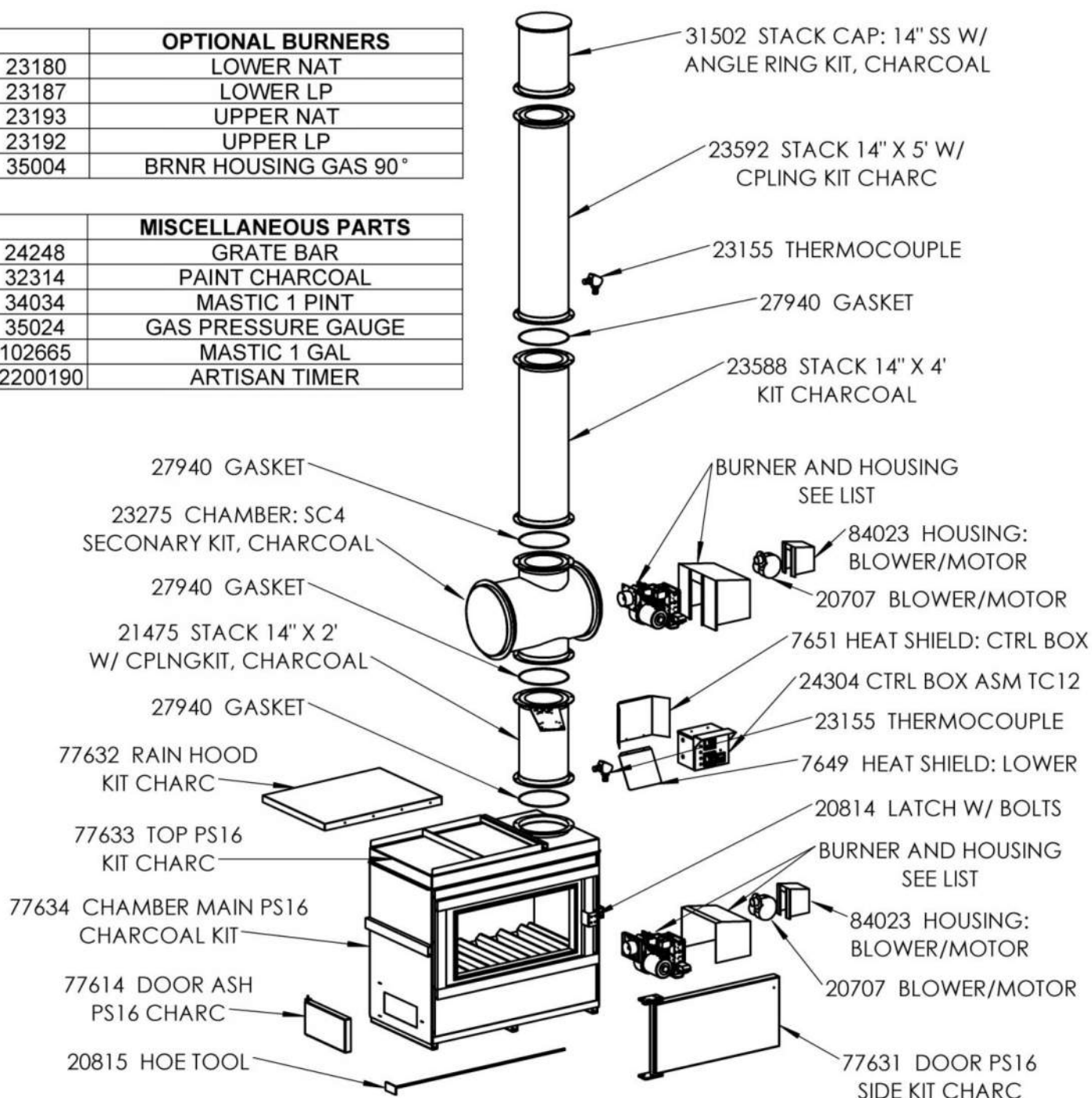

TC 12 CONTROL BOX

CONTAINS (2) 4100 FDC CONTROLLERS

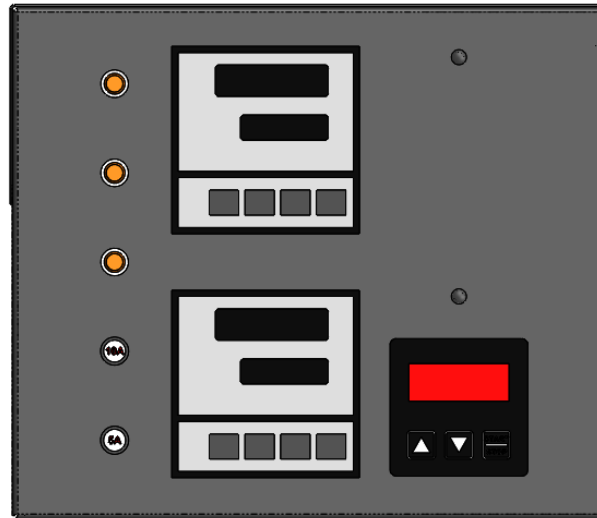

- Bottom digital controller determines the lower/primary chamber settings.
- Top digital controller determines the upper/secondary chamber settings.

TC 21 CONTROL BOX

CONTAINS (2) 4100 FDC CONTROLLERS WITH A 2-PEN DATA CHART RECORDER

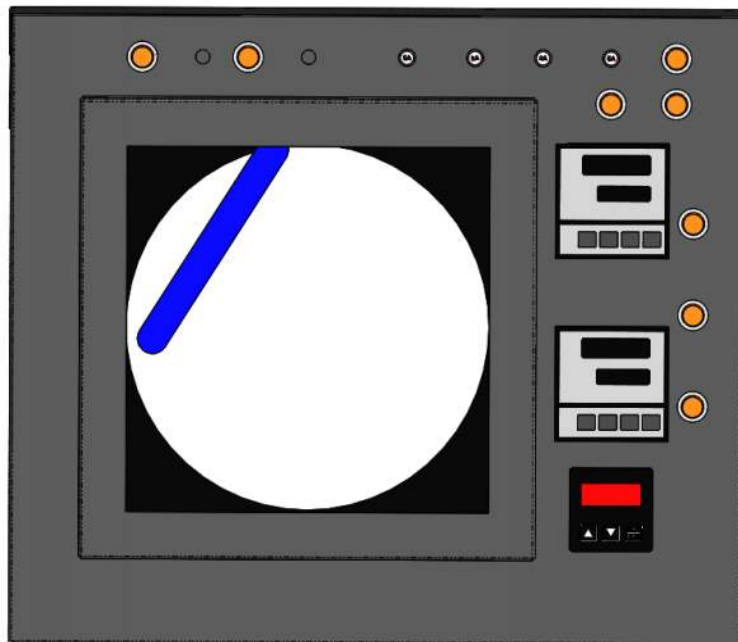

- Bottom digital controller determines the lower/primary chamber settings.
- Top digital controller determines the upper/secondary chamber settings.
 - The chart recoder records the temperatures during operation.

PS16-SC4 4100 FDC GAS WIRING DIAGRAM

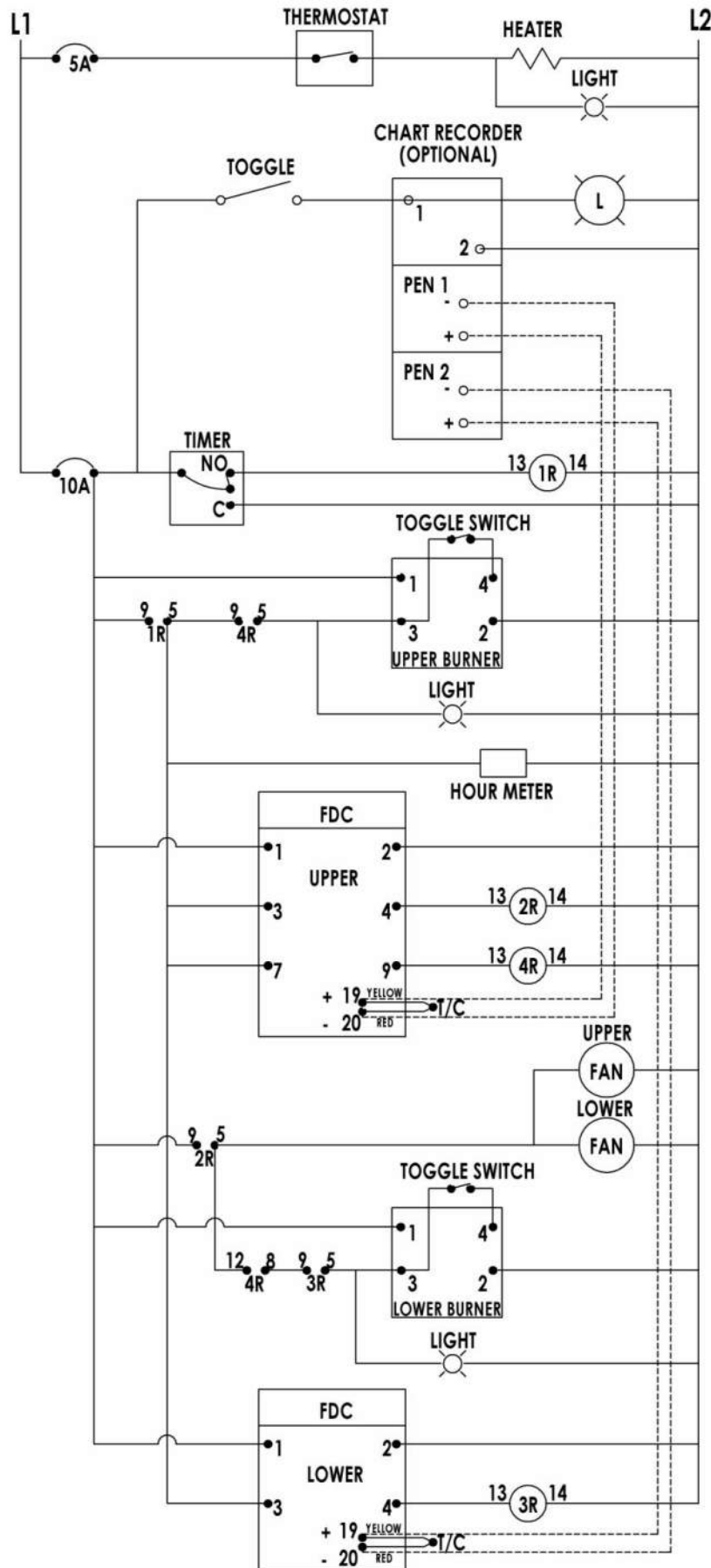

PS16-SC4 4100 FDC OIL WIRING DIAGRAM

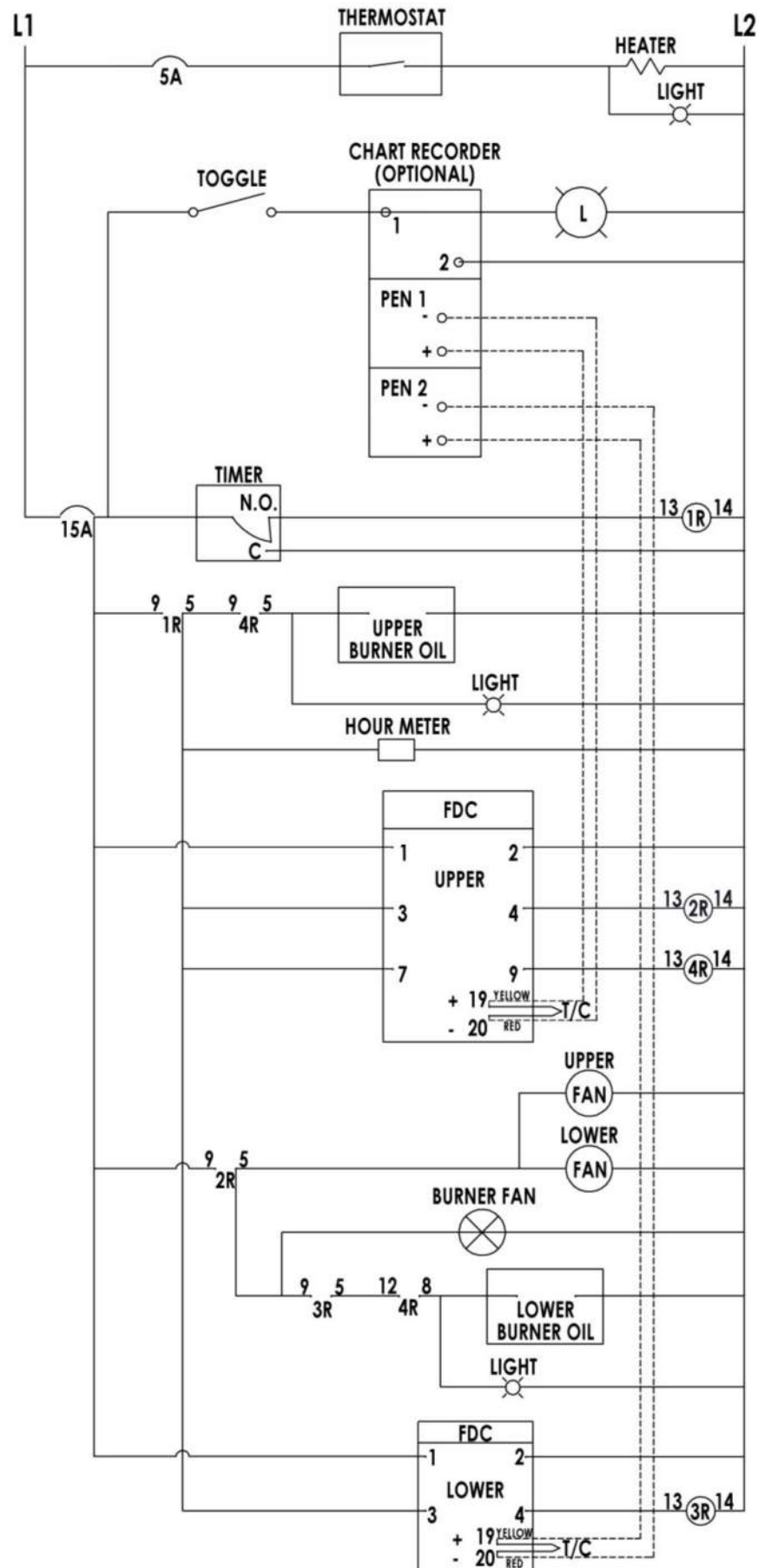

PS16-SC4 PROGRAMMING

UPPER 4100 FDC W/ PREHEAT

NOTE: SP VALUES ARE FACTORY SET AND MAY BE ADJUSTED FOR YOUR APPLICATION WITH QUALIFIED TECHNICAL HELP.

	SP1	SP2	SP3
Factory Setting	600	N/A	2000
User Setting 1			
User Setting 2			

Set	=====	<Scroll>
Lock	nonE	<Scroll>
inPt	y_tC	<Scroll>
Unit	0F	<Scroll>
dP	no.dP	<Scroll>
SP1L	0	<Scroll>
SP1H	2498	<Scroll>
SHiF	0	<Scroll>
FiLt	0.5	<Scroll>
Pb	0	<Scroll>
out1	Dirt	<Scroll>
o1.tY	rELY	<Scroll>
o1.Ft	Off	<Scroll>
o1HY	90.0	GREATER VALUE LESSENS PREHEAT CYCLING <Scroll>
rAmP	nonE	<Scroll>
out2	nonE	<Scroll>
AL.Fn	PY.Hi	<Scroll>
AL.md	norm	<Scroll>
AL.HY	90	GREATER VALUE LESSENS HI LIMIT CYCLING <Scroll>
AL.Ft	oFF	<Scroll>
Comm	nonE	<Scroll>
SEL1	nonE	<Scroll>
SEL2	nonE	<Scroll>
SEL3	nonE	<Scroll>
SEL4	nonE	<Scroll>
SEL5	nonE	<Scroll>
SEL6	nonE	<Scroll>
SEL7	nonE	<Scroll>
SEL8	nonE	<Scroll>

PS16-SC4 PROGRAMMING

LOWER 4100 FDC – LOWER BURNERS OFF

NOTE: SP VALUES ARE FACTORY SET AND MAY BE ADJUSTED FOR YOUR APPLICATION WITH QUALIFIED TECHNICAL HELP.

	SP1	SP2	SP3
Factory Setting	1250	N/A	N/A
User Setting 1			
User Setting 2			

Set	— — — —	<Scroll>
Lock	nonE	<Scroll>
inPt	y_tC	<Scroll>
Unit	0F	<Scroll>
dP	no.dP	<Scroll>
SP1L	0	<Scroll>
SP1H	2498	<Scroll>
SHiF	0	<Scroll>
FiLt	0.5	<Scroll>
Pb	0	<Scroll>
out1	rEyr	<Scroll>
o1.tY	rELY	<Scroll>
o1.Ft	oFF	<Scroll>
o1HY	90.0	<Scroll>
rAmP	nonE	<Scroll>
out2	nonE	<Scroll>
AL.Fn	nonE	<Scroll>
Comm	nonE	<Scroll>
SEL1	nonE	<Scroll>
SEL2	nonE	<Scroll>
SEL3	nonE	<Scroll>
SEL4	nonE	<Scroll>
SEL5	nonE	<Scroll>
SEL6	nonE	<Scroll>
SEL7	nonE	<Scroll>
SEL8	nonE	<Scroll>

TCDR CONTROL BOX

CONTAINS (1) MCT4 CONTROLLER

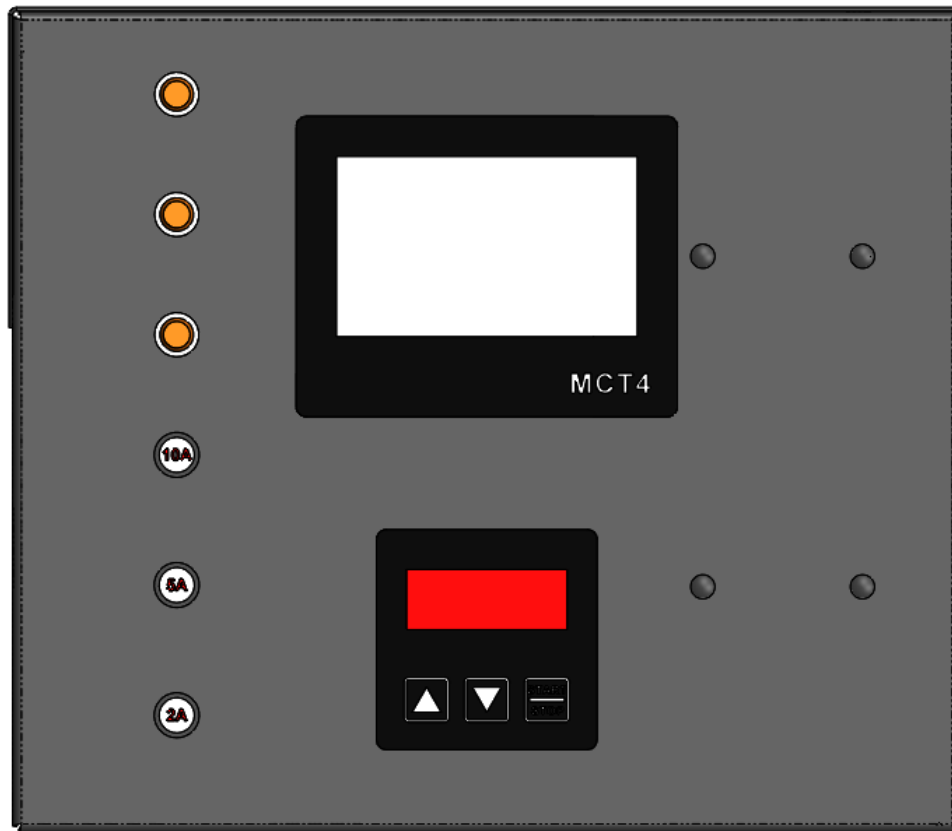

- The single digital controller determines both the lower/primary and the upper/secondary chamber settings.
- The controller can record both the set points temperatures as well as actual operating temperatures.
- The recorded data can be viewed on the controller screen, through a computer using a flash drive, or through a computer with a direct ethernet connection.

	UPPER	LOWER	ALARM
Factory Setting	600	1250	2000
User Setting 1			
User Setting 2			

Contact Factory for MCT4 Programming Instructions.

PS16-SC4 MCT4 GAS WIRING DIAGRAM

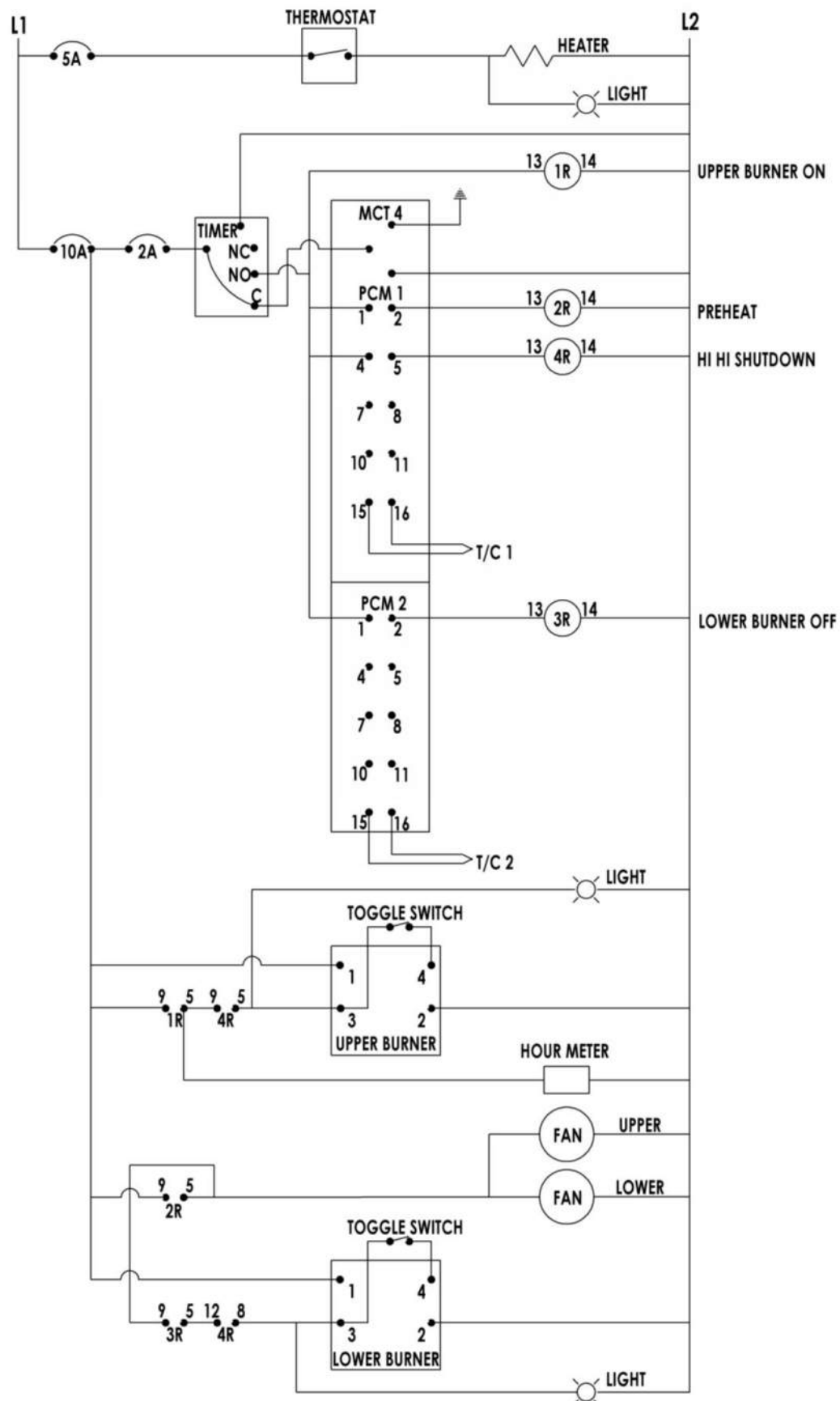

Contact Factory for MCT4 Programming Instructions.

PS16-SC8

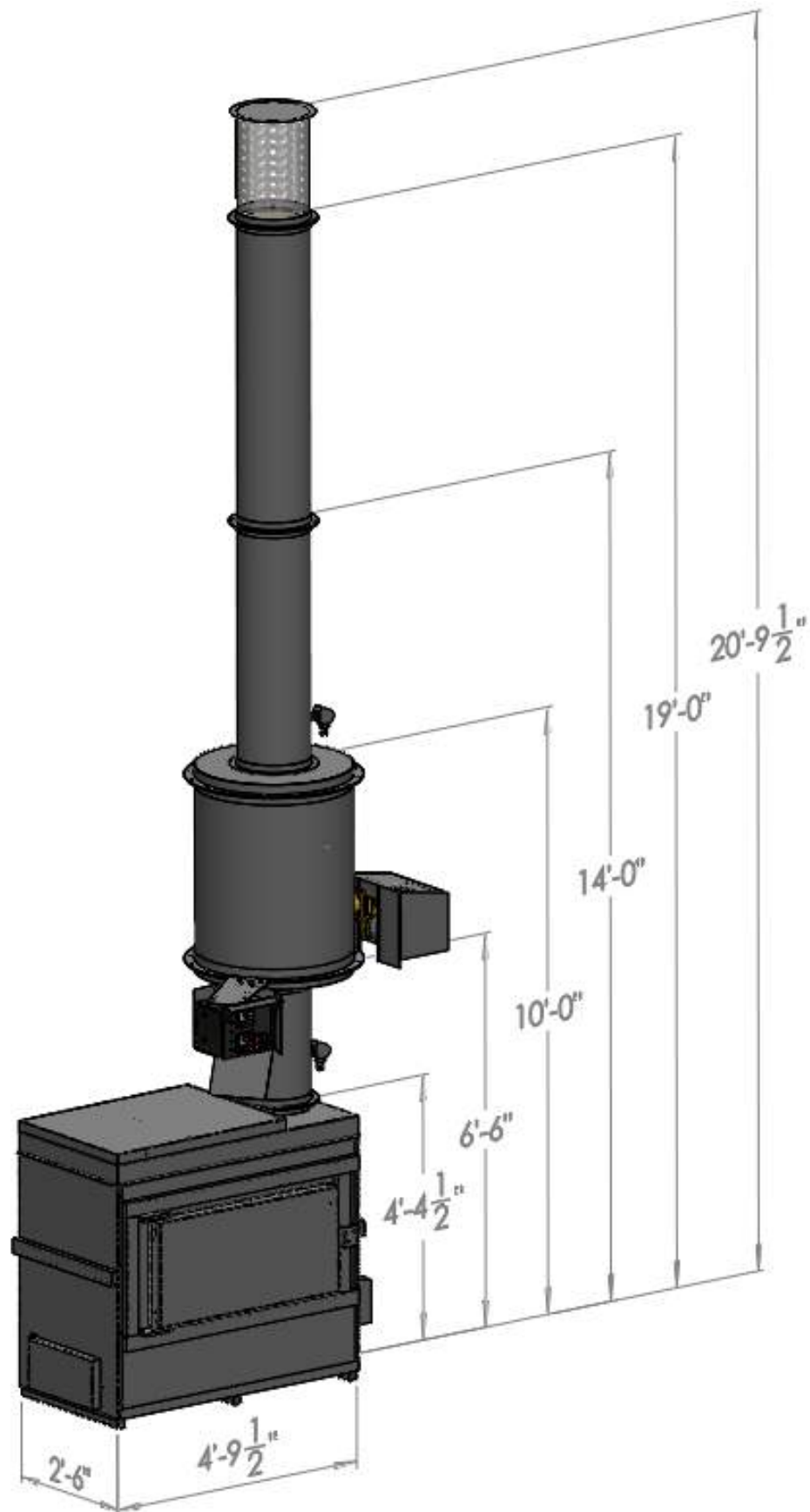

Standard Configuration shown.
Locations of control components and stacks may vary per setup ordered.

PS16-SC8



TYPICAL FINISHED SITE, SEE INSTRUCTIONS
Locations of control components may vary per setup ordered

PS16-SC8 SPECIFICATIONS

PRIMARY CHAMBER

CHAMBER CAPACITY	480 LBS WASTE AT 30 LB/FT ³
CHAMBER VOLUME	16.5 FT ³ ABOVE GRATES
DOOR DIMENSION	20" X 42"
REFRACTORY	3", 2,800°F, 126 LB/FT ³
JACKET MATERIAL	PAINTED STEEL
HEIGHT TO DOOR	20"
HEIGHT TO TOP OF CHAMBER	52"

SECONDARY CHAMBER

CHAMBER VOLUME	8 FT ³
HEIGHT TO TOP OF AFTERBURNER	10'
REFRACTORY	3", 2,800°F, 126 LB/FT ³
JACKET MATERIAL	PAINTED STEEL
RETENTION AND TEMPERATURE LIMITS	UP TO ½ SECOND UP TO 1600°F (CONSULT FACTORY WITH APPLICATION DETAILS. DATA/DESIGN MAY CHANGE PER OPERATING NEEDS)

STACKS

STACK	(1) 14" DIA. 2' LONG STEEL CAST LINED (1) 14" DIA. 4' LONG STEEL CAST LINED (1) 14" DIA. 5' LONG STEEL CAST LINED
STACK CAP	(1) 14" DIA. STAINLESS STEEL

BURNERS

MODEL: GAS	(1) J83 W/ SAFETY CONTROLS (1) J121 W/ SAFETY CONTROLS
MODEL: OIL	(1) SF BECKETT BURNER (1) AF BECKETT BURNER
OPERATION	DIGITAL TIMER AND TEMPERATURE CONTROLLED. CYCLES PRIMARY BURNER AS NEEDED.

GENERAL

EXTERNAL PRIMARY DIMENSIONS	2' 8" W X 4' 10" L X 4' 4" H
EXTERNAL OVERALL DIMENSIONS (STANDARD)	2' 8" W X 4' 10" L X 20' 10" H
ELECTRICAL SERVICE	STANDARD: 115 V, 60 HZ, 20 AMP EXPORT MODELS: 220 V, 50 HZ, 10 AMP
GAS SERVICE BASED ON MAXIMUM RATING OF BOTH BURNERS	2,000,000 BTU/HR NATURAL GAS 7" W.C. LIQUID PROPANE 11" W.C.
GAS/FUEL CONSUMPTION (IF CONSTANT OPERATION AND NO BURNER CYCLING ON AND OFF)	NATURAL GAS 929 CFH LIQUID PROPANE 9.98 GPH FUEL OIL 6.00 GPH
TOTAL WEIGHT	6,000 LBS (APPROXIMATELY)
PAD REQUIREMENTS (MINIMUM SUGGESTED OR CONSULT FACTORY)	12' W X 14' L X 4" THICK IF SHELTERED 6' W X 8' L X 4" THICK IF NOT SHELTERED
PAINT	1,200° PRIMER, 1,200° PAINT

CHARGING RATE

PATHOLOGICAL	VARIES BY WASTE PROPERTIES AND OPERATING METHODS. TYPICAL BURN RATE OF 45-75 LBS/HR
--------------	---

AIR FLOW

MINIMUM REQUIRED OPENING IN ENCLOSED BUILDING FOR AIR FLOW	28 FT ²
--	--------------------

PS16-SC8 PARTS LIST

OPTIONAL BURNERS	
23180	LOWER NAT
23187	LOWER LP
23212	UPPER NAT
23216	UPPER LP
35004	BRNR HOUSING GAS 90°

MISCELLANEOUS PARTS	
31030	GRATE BAR
32314	PAINT CHARCOAL
34034	MASTIC 1 PINT
35024	GAS PRESSURE GAUGE
102665	MASTIC 1 GAL
42200190	ARTISAN TIMER

23295 SEC CHAMBER
SC8 14" KIT CHARC

7650 MOUNT:
CONTROL BOX

7651 HEAT SHIELD:
CONTROL BOX

24304 CTRL BOX ASM
TC 1,2

7649 HEAT SHIELD:
LOWER

77632 RAIN HOOD
KIT CHARC

77633 TOP PS16
KIT CHARC

77614 DOOR ASH
PS16 CHARC

77631 DOOR PS16
SIDE KIT CHARC

31519 LATCH W/ BOLTS

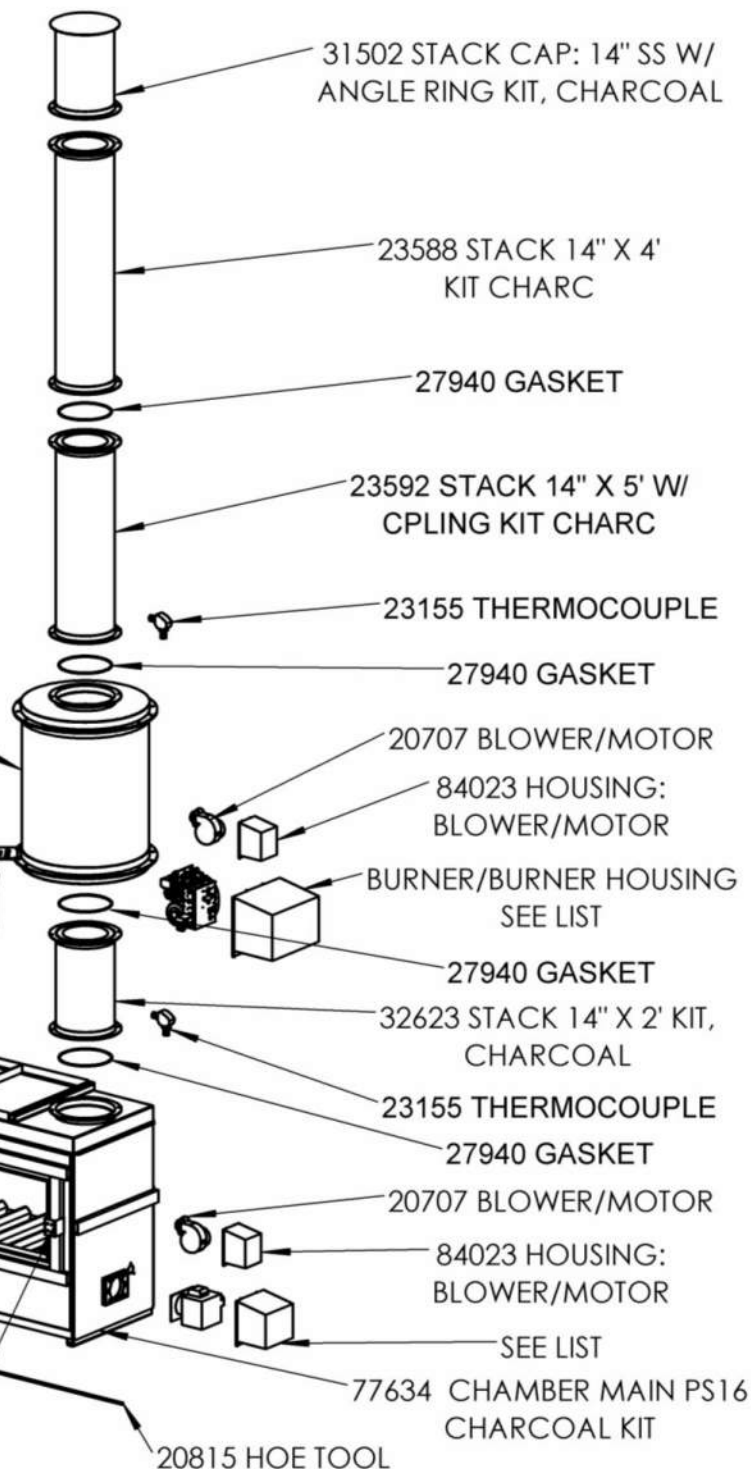

TC 12 CONTROL BOX

CONTAINS (2) 4100 FDC CONTROLLERS

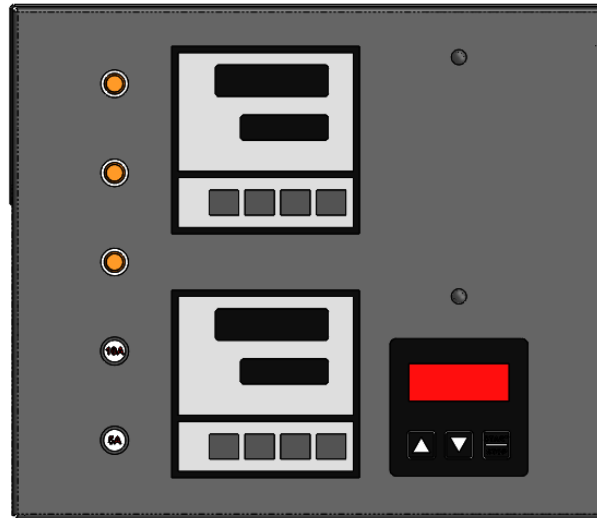

- Bottom digital controller determines the lower/primary chamber settings.
- Top digital controller determines the upper/secondary chamber settings.

TC 21 CONTROL BOX

CONTAINS (2) 4100 FDC CONTROLLERS WITH A 2-PEN DATA CHART RECORDER

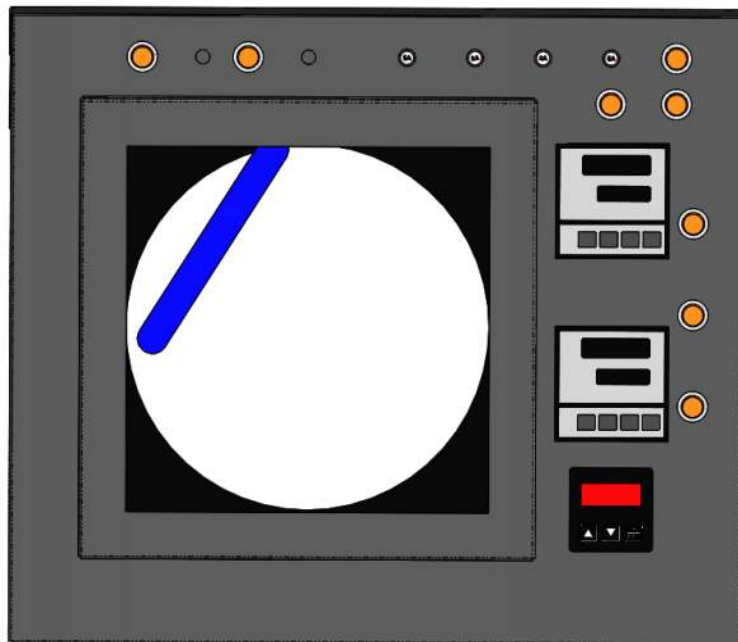

- Bottom digital controller determines the lower/primary chamber settings.
- Top digital controller determines the upper/secondary chamber settings.
 - The chart recoder records the temperatures during operation.

PS16-SC8 4100 FDC GAS WIRING DIAGRAM

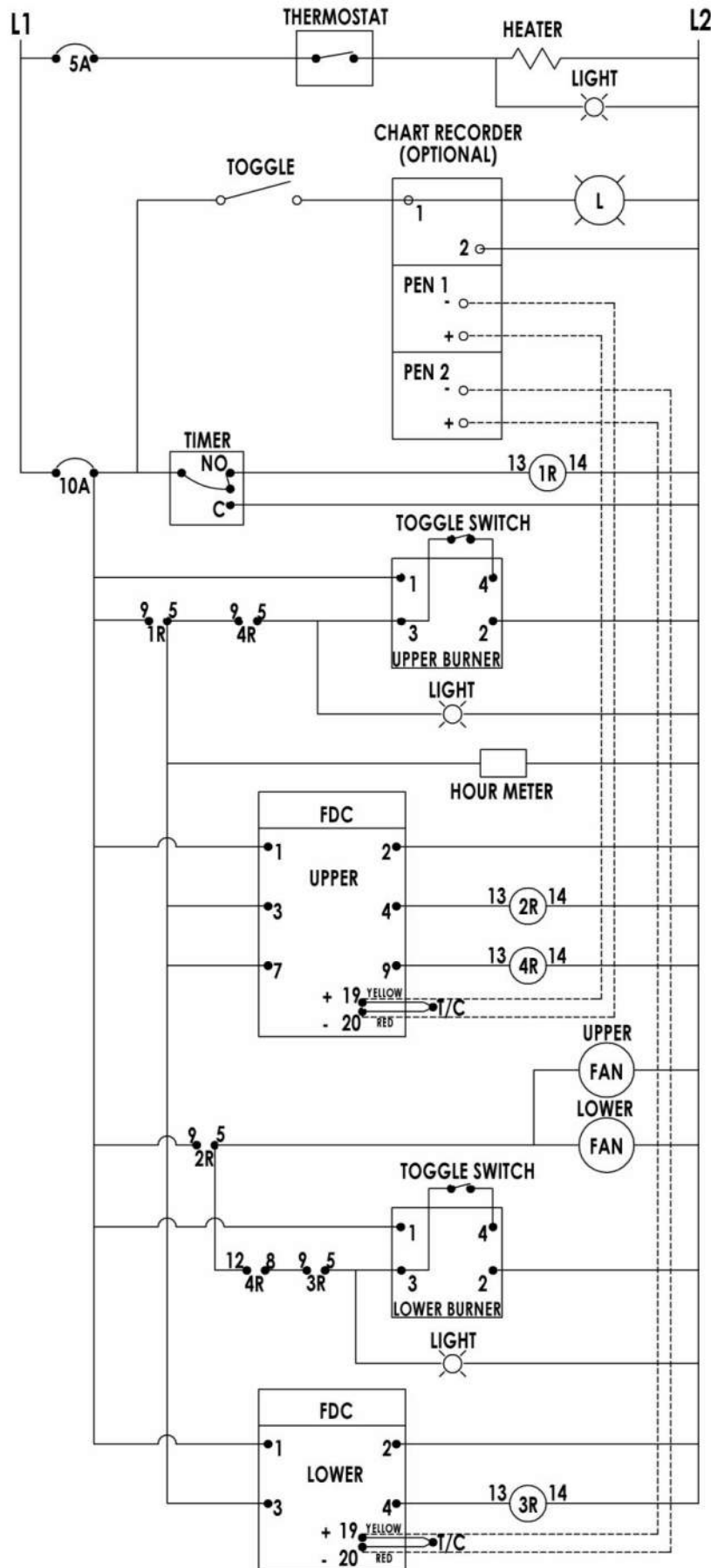

PS16-SC8 4100 FDC OIL WIRING DIAGRAM

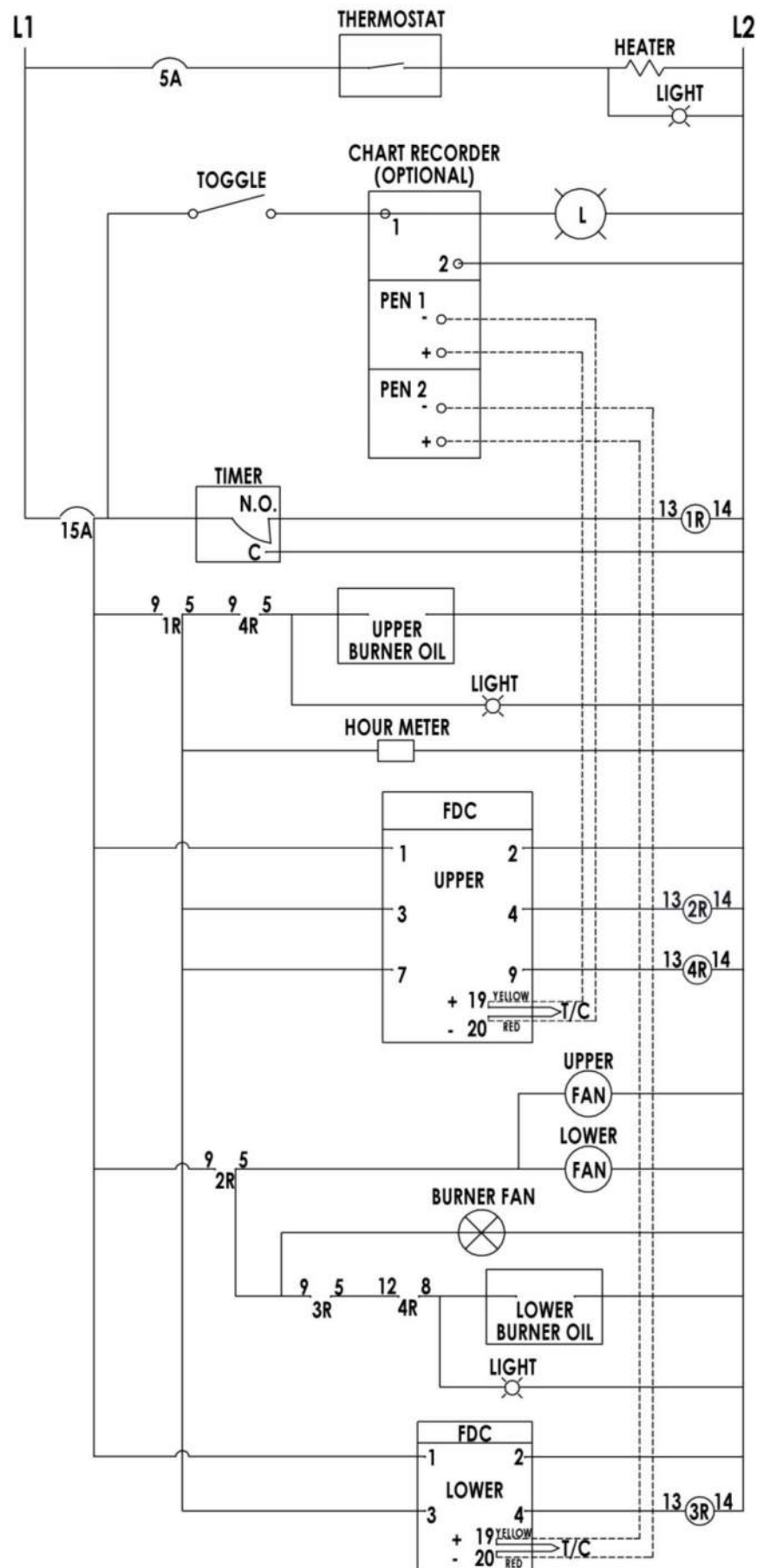

PS16-SC8 PROGRAMMING

UPPER 4100 FDC W/ PREHEAT

NOTE: SP VALUES ARE FACTORY SET AND MAY BE ADJUSTED FOR YOUR APPLICATION WITH QUALIFIED TECHNICAL HELP.

	SP1	SP2	SP3
Factory Setting	600	N/A	2000
User Setting 1			
User Setting 2			

Set	=====	<Scroll>
Lock	nonE	<Scroll>
inPt	y_tC	<Scroll>
Unit	0F	<Scroll>
dP	no.dP	<Scroll>
SP1L	0	<Scroll>
SP1H	2498	<Scroll>
SHiF	0	<Scroll>
FiLt	0.5	<Scroll>
Pb	0	<Scroll>
out1	Dirt	<Scroll>
o1.tY	rELY	<Scroll>
o1.Ft	Off	<Scroll>
o1HY	90.0	GREATER VALUE LESSENS PREHEAT CYCLING <Scroll>
rAmP	nonE	<Scroll>
out2	nonE	<Scroll>
AL.Fn	PY.Hi	<Scroll>
AL.md	norm	<Scroll>
AL.HY	90	GREATER VALUE LESSENS HI LIMIT CYCLING <Scroll>
AL.Ft	oFF	<Scroll>
Comm	nonE	<Scroll>
SEL1	nonE	<Scroll>
SEL2	nonE	<Scroll>
SEL3	nonE	<Scroll>
SEL4	nonE	<Scroll>
SEL5	nonE	<Scroll>
SEL6	nonE	<Scroll>
SEL7	nonE	<Scroll>
SEL8	nonE	<Scroll>

PS16-SC8 PROGRAMMING

LOWER 4100 FDC – LOWER BURNERS OFF

NOTE: SP VALUES ARE FACTORY SET AND MAY BE ADJUSTED FOR YOUR APPLICATION WITH QUALIFIED TECHNICAL HELP.

	SP1	SP2	SP3
Factory Setting	1250	N/A	N/A
User Setting 1			
User Setting 2			

Set	— — — —	<Scroll>
Lock	nonE	<Scroll>
inPt	y_tC	<Scroll>
Unit	0F	<Scroll>
dP	no.dP	<Scroll>
SP1L	0	<Scroll>
SP1H	2498	<Scroll>
SHiF	0	<Scroll>
FiLt	0.5	<Scroll>
Pb	0	<Scroll>
out1	rEyr	<Scroll>
o1.tY	rELY	<Scroll>
o1.Ft	oFF	<Scroll>
o1HY	90.0	<Scroll>
rAmP	nonE	<Scroll>
out2	nonE	<Scroll>
AL.Fn	nonE	<Scroll>
Comm	nonE	<Scroll>
SEL1	nonE	<Scroll>
SEL2	nonE	<Scroll>
SEL3	nonE	<Scroll>
SEL4	nonE	<Scroll>
SEL5	nonE	<Scroll>
SEL6	nonE	<Scroll>
SEL7	nonE	<Scroll>
SEL8	nonE	<Scroll>

TCDR CONTROL BOX

CONTAINS (1) MCT4 CONTROLLER

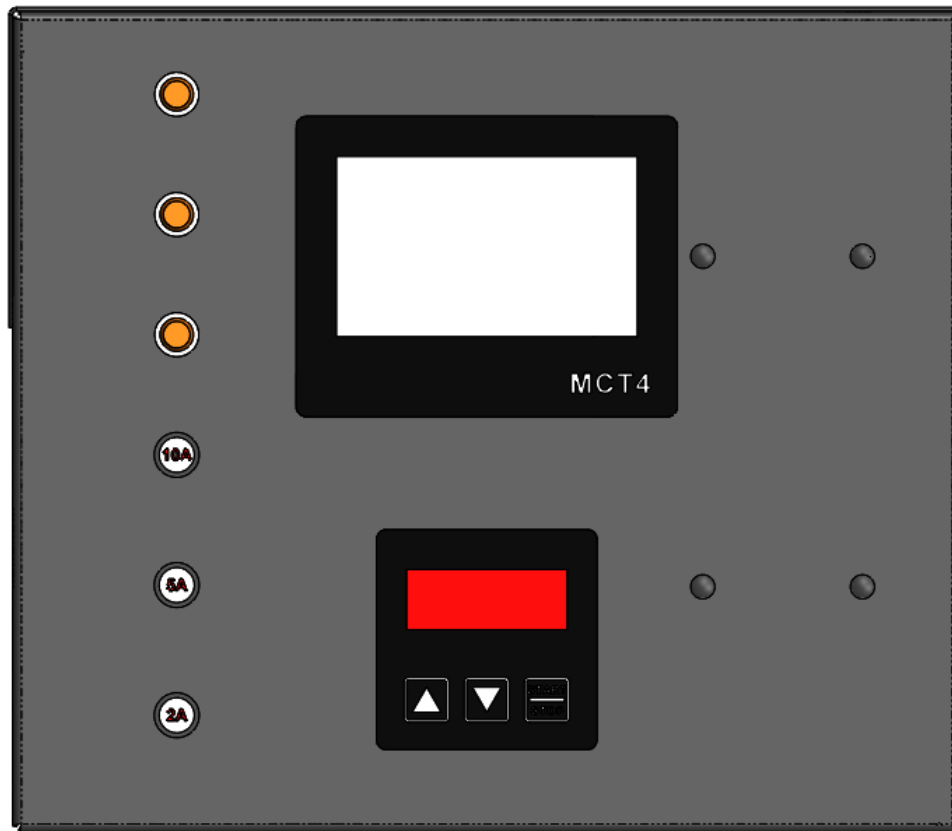

- The single digital controller determines both the lower/primary and the upper/secondary chamber settings.
- The controller can record both the set points temperatures as well as actual operating temperatures.
- The recorded data can be viewed on the controller screen, through a computer using a flash drive, or through a computer with a direct ethernet connection.

	UPPER	LOWER	ALARM
Factory Setting	600	1250	2000
User Setting 1			
User Setting 2			

Contact Factory for MCT4 Programming Instructions.

PS16-SC8 MCT4 GAS WIRING DIAGRAM

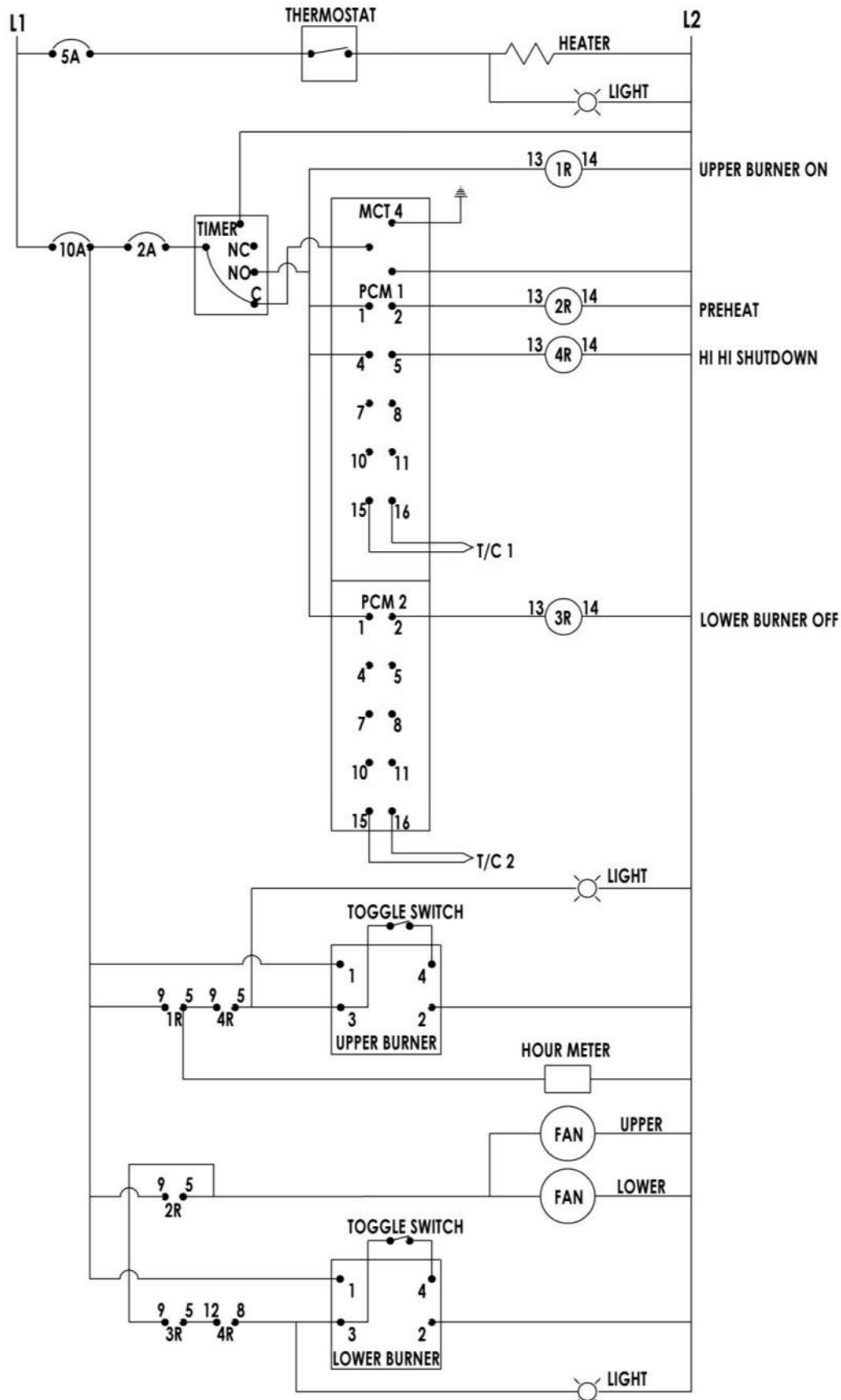

Contact Factory for MCT4 Programming Instructions.

PS16-SC30

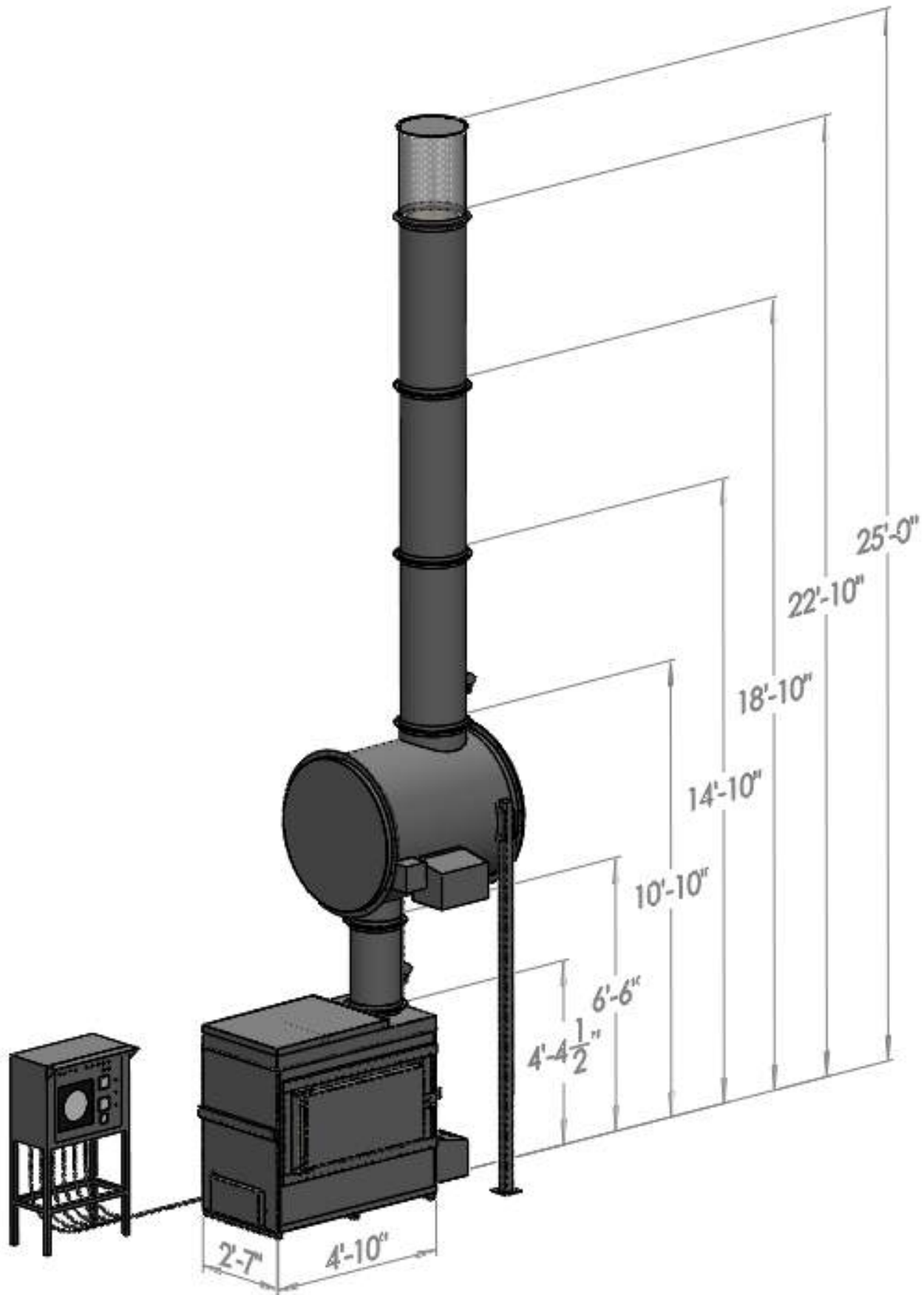

Standard Configuration shown.
Locations of control components and stacks may vary per setup ordered.

PS16-SC30

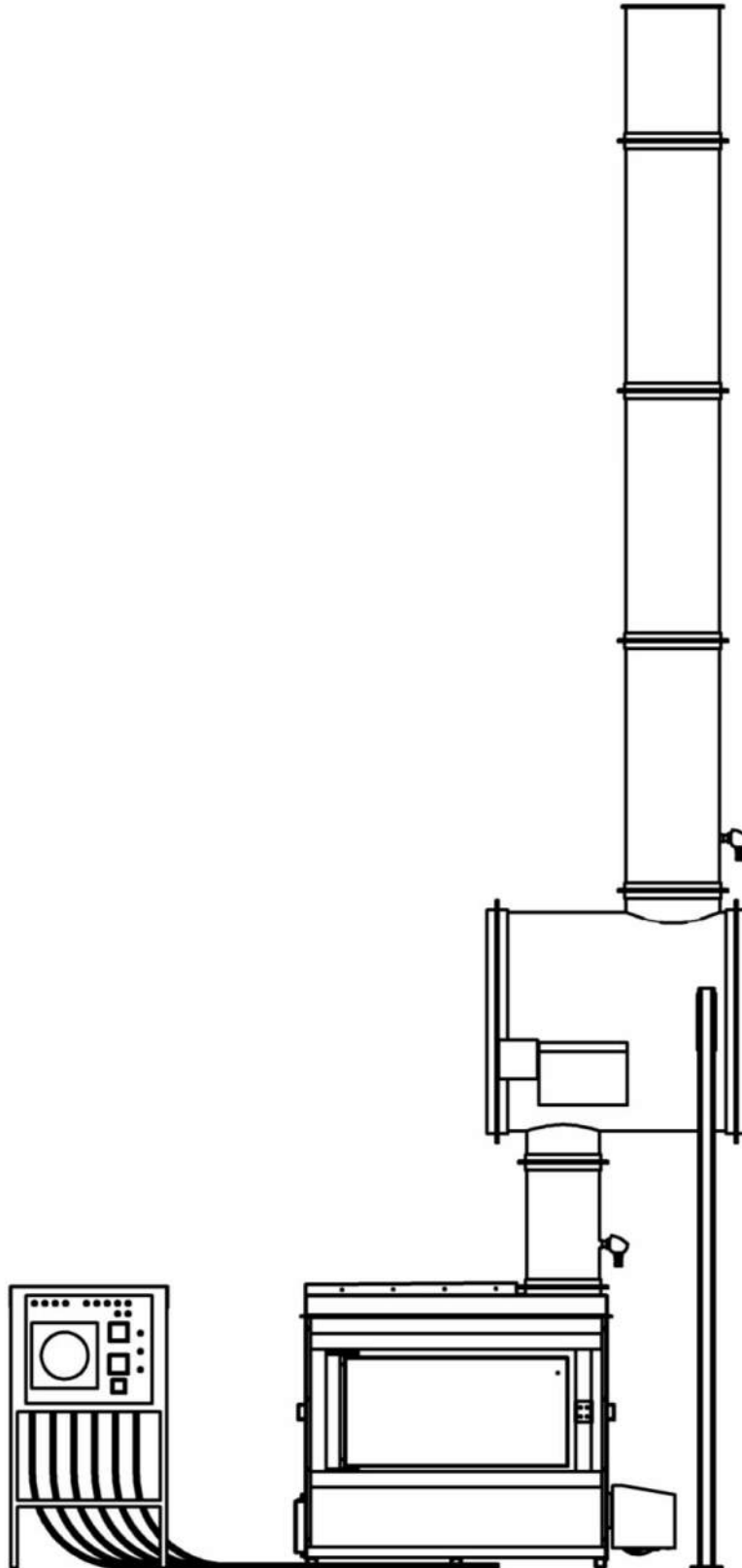

TYPICAL FINISHED SITE, SEE INSTRUCTIONS
Locations of control components may vary per setup ordered

PS16-SC30 SPECIFICATIONS

PRIMARY CHAMBER

CHAMBER CAPACITY	480 LBS WASTE AT 30 LB/FT ³
CHAMBER VOLUME	16.5 FT ³ ABOVE GRATES
DOOR DIMENSION	20" X 42"
REFRACTORY	3", 2,800°F, 126 LB/FT ³
JACKET MATERIAL	PAINTED STEEL
HEIGHT TO DOOR	20"
HEIGHT TO TOP OF CHAMBER	52"

SECONDARY CHAMBER

CHAMBER VOLUME	30 FT ³
HEIGHT TO TOP OF AFTERBURNER	10' 10"
REFRACTORY	3", 2,800°F, 126 LB/FT ³
JACKET MATERIAL	PAINTED STEEL
RETENTION AND TEMPERATURE LIMITS	UP TO ½ SECOND UP TO 1600°F (CONSULT FACTORY WITH APPLICATION DETAILS. DATA/DESIGN MAY CHANGE PER OPERATING NEEDS)

STACKS

STACK	(1) 14" DIA. 2' LONG STEEL CAST LINED (3) 18" DIA. 4' LONG STEEL CAST LINED
STACK CAP	(1) 18" DIA. STAINLESS STEEL

BURNERS

MODEL: GAS	(1) J83 W/ SAFETY CONTROLS (1) J121 W/ SAFETY CONTROLS
MODEL: OIL	(1) AF BECKETT BURNER (1) WAYNE BURNER
OPERATION	DIGITAL TIMER AND TEMPERATURE CONTROLLED. CYCLES PRIMARY BURNER AS NEEDED.

GENERAL

EXTERNAL PRIMARY DIMENSIONS	2' 8" W X 4' 10" L X 4' 4" H
EXTERNAL OVERALL DIMENSIONS (STANDARD)	2' 8" W X 4' 10" L X 25' H
ELECTRICAL SERVICE	STANDARD: 115 V, 60 HZ, 20 AMP EXPORT MODELS: 220 V, 50 HZ, 10 AMP
GAS SERVICE BASED ON MAXIMUM RATING OF BOTH BURNERS	2,000,000 BTU/HR NATURAL GAS 7" W.C. LIQUID PROPANE 11" W.C.
GAS/FUEL CONSUMPTION (IF CONSTANT OPERATION AND NO BURNER CYCLING ON AND OFF)	NATURAL GAS 1010 CFH LIQUID PROPANE 18.43 GPH FUEL OIL 13.00 GPH
TOTAL WEIGHT	8,800 LBS (APPROXIMATELY)
PAD REQUIREMENTS (MINIMUM SUGGESTED OR CONSULT FACTORY)	12' W X 14' L X 4" THICK IF SHELTERED 6' W X 8' L X 4" THICK IF NOT SHELTERED
PAINT	1,200° PRIMER, 1,200° PAINT

CHARGING RATE

PATHOLOGICAL	VARIES BY WASTE PROPERTIES AND OPERATING METHODS. TYPICAL BURN RATE OF 45-75 LBS/HR
--------------	---

AIR FLOW

MINIMUM REQUIRED OPENING IN ENCLOSED BUILDING FOR AIR FLOW	28 FT ²
--	--------------------

PS16-SC30 PARTS LIST

OPTIONAL BURNERS

23204	BURNER: P16 LOWER LP
10103020	BURNER: P16 UPPER LP
23206	BURNER: P16 LOWER NAT
10103010	BURNER: P16 UPPER NAT
35004	BRNR HSG: GAS BRNR, 90 DEG

MISCELLANEOUS PARTS

24092	GRATE BAR KIT W/ MASTIC - 5 BARS
32314	PAINT: CHARCOAL 251H, SPRAY CAN
34034	REFRACTORY: MASTIC, 1 PT - 2-1/2#
35024	GAS PRESSURE GAUGE: AG & PROF 1
102665	REFRACTORY: MASTIC, 1 GAL - 20#
101428	REFRACTORY: HIGH MOD IMPCT, 2800 DEG
42200190	ARTISAN TIMER: W/ GASKET

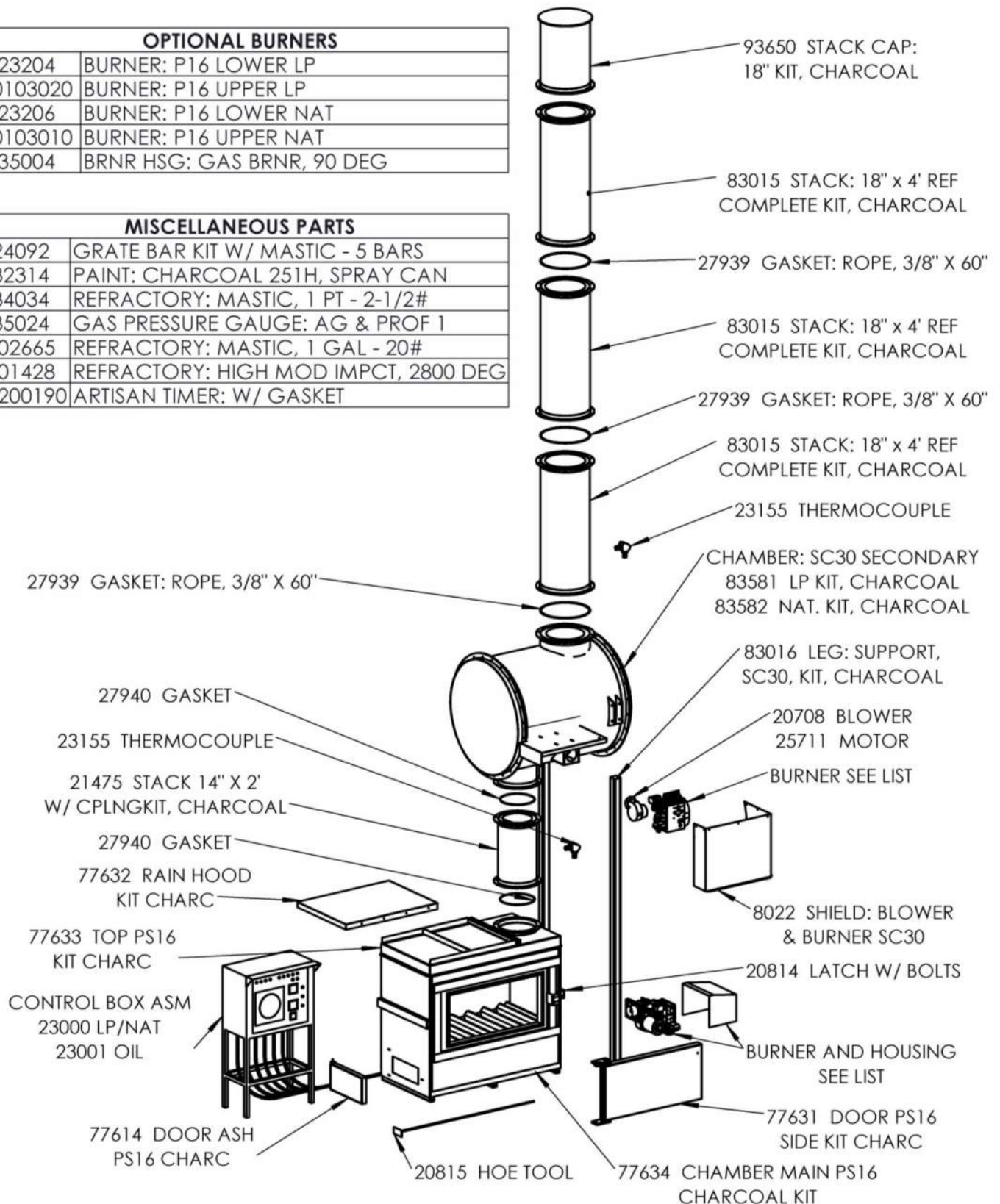

TC 12 CONTROL BOX

CONTAINS (2) 4100 FDC CONTROLLERS

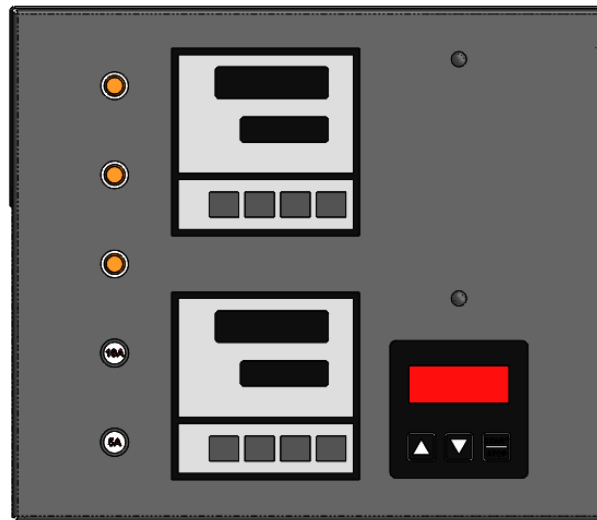

- Bottom digital controller determines the lower/primary chamber settings.
- Top digital controller determines the upper/secondary chamber settings.

TC 21 CONTROL BOX

CONTAINS (2) 4100 FDC CONTROLLERS WITH A 2-PEN DATA CHART RECORDER

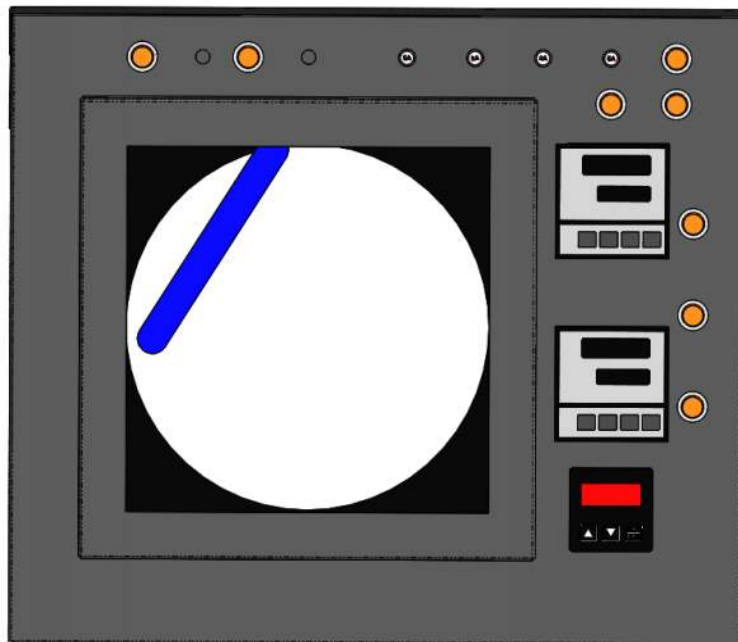

- Bottom digital controller determines the lower/primary chamber settings.
- Top digital controller determines the upper/secondary chamber settings.
 - The chart recorder records the temperatures during operation.

PS16-SC30 4100 FDC GAS WIRING DIAGRAM

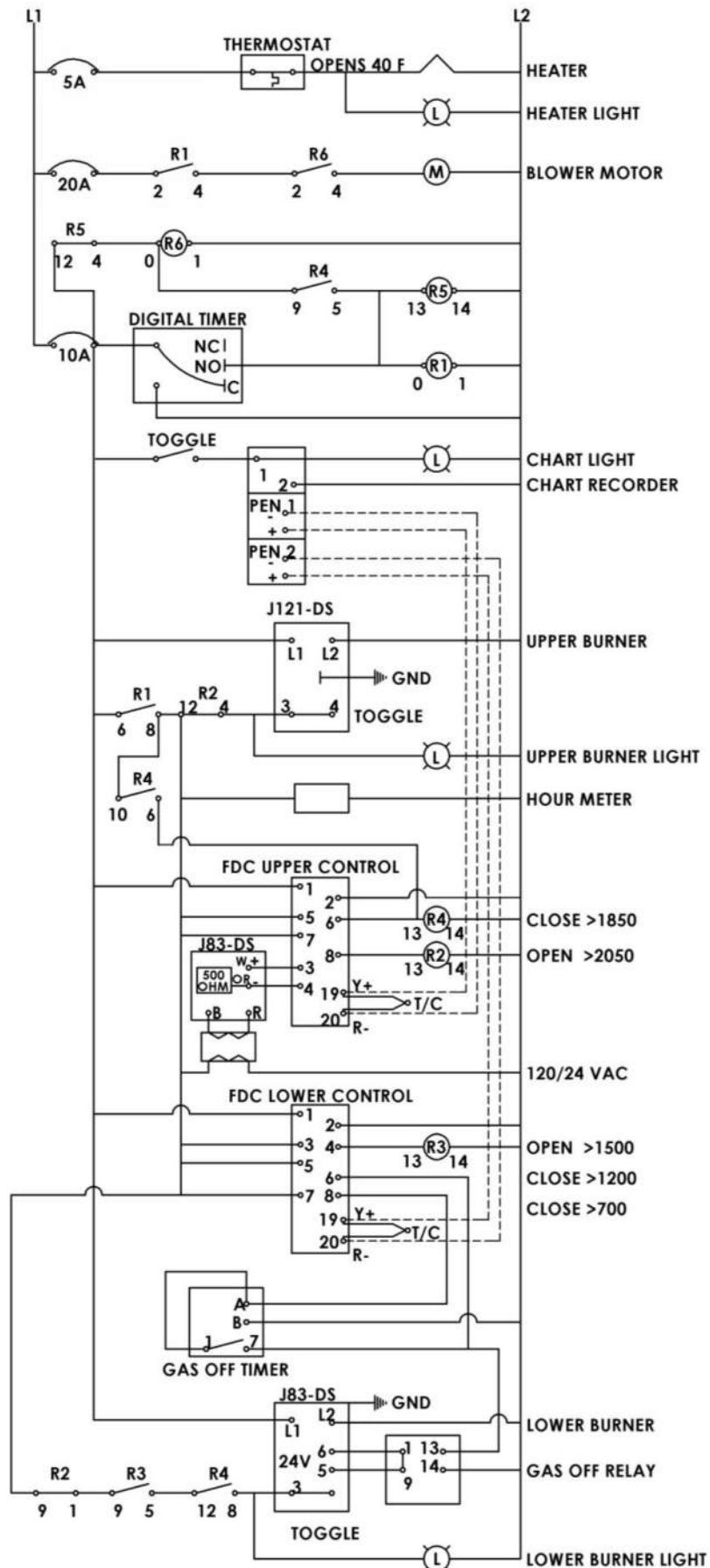

PS16-SC30 4100 FDC OIL WIRING DIAGRAM

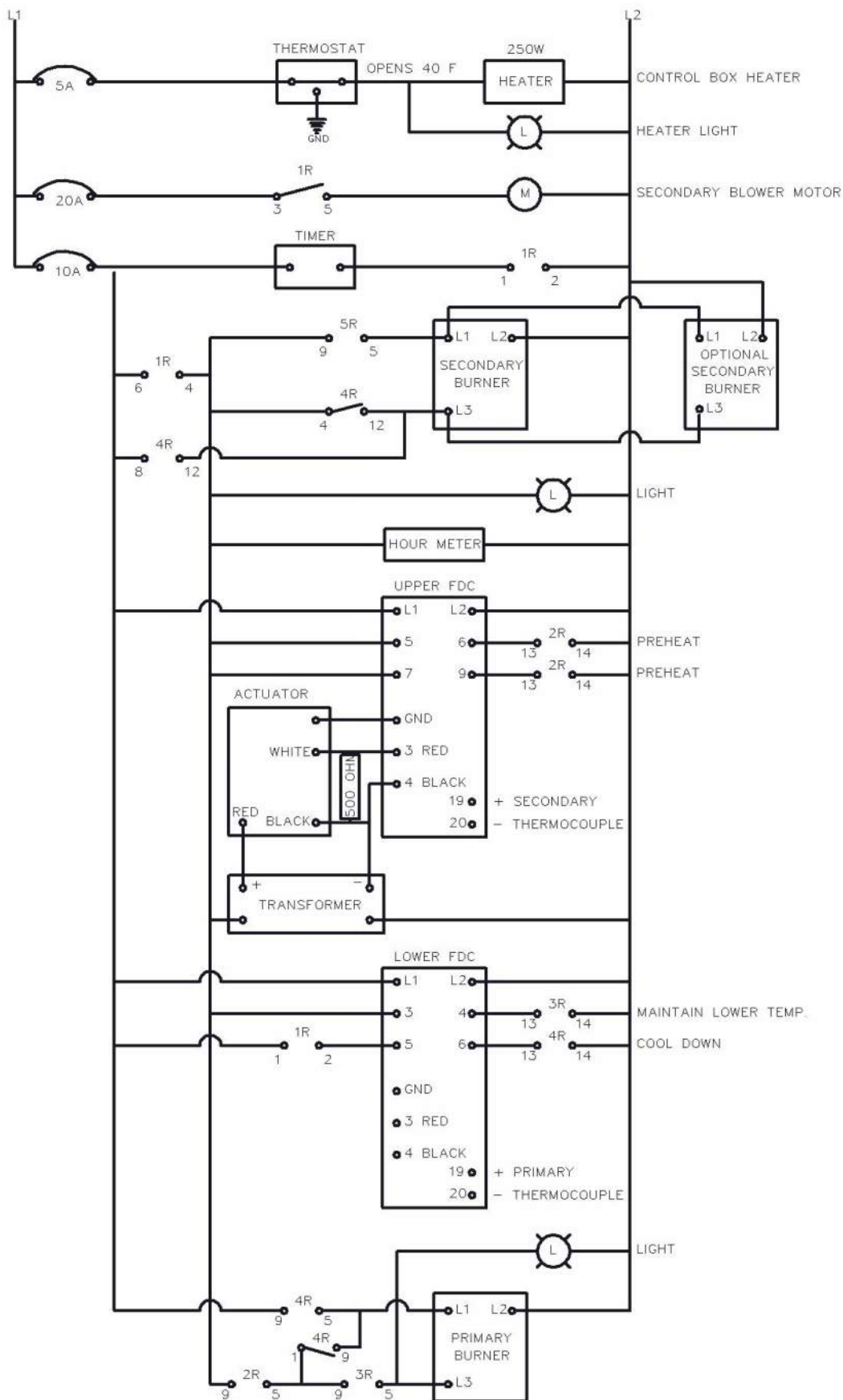

PS16-SC30 PROGRAMMING

UPPER FDC W/ PREHEAT

NOTE: SP VALUES ARE FACTORY SET AND MAY BE ADJUSTED FOR YOUR APPLICATION WITH QUALIFIED TECHNICAL HELP.

	SP1	SP2	SP3
Factory Setting	1800	1850	2050
User Setting 1			
User Setting 2			

Set	_____	<Scroll>
Lock	nonE	<Scroll>
inPt	y_tC	<Scroll>
Unit	0F	<Scroll>
dP	no.dP	<Scroll>
SP1L	0	<Scroll>
SP1H	2498	<Scroll>
SHiF	0	<Scroll>
FiLt	0.5	<Scroll>
Pb	100	<Scroll>
ti	0	<Scroll>
td	0	<Scroll>
out1	rEYr	<Scroll>
o1.tY	4-20	<Scroll>
o1.Ft	25	<Scroll>
Of.st	25	<Scroll>
rAmP	nonE	<Scroll>
out2	pyHi	<Scroll>
o2.ty	reLy	<Scroll>
o2.ft	off	<Scroll>
o2.Hy	0.2	<Scroll>
AL.Fn	pyHi	<Scroll>
ALnd	norn	<Scroll>
AL.Hy	90	<Scroll>
AL.ft	off	<Scroll>
Comm	nonE	<Scroll>
SEL1	nonE	<Scroll>
SEL2	nonE	<Scroll>
SEL3	nonE	<Scroll>
SEL4	nonE	<Scroll>
SEL5	nonE	<Scroll>
SEL6	nonE	<Scroll>
SEL7	nonE	<Scroll>
SEL8	nonE	<Scroll>

PS16-SC30 PROGRAMMING

LOWER FDC – LOWER BURNERS OFF

NOTE: SP VALUES ARE FACTORY SET AND MAY BE ADJUSTED FOR YOUR APPLICATION WITH QUALIFIED TECHNICAL HELP.

	SP1	SP2	SP3
Factory Setting	1500	1200	700
User Setting 1			
User Setting 2			

Set	_____	<Scroll>
Lock	nonE	<Scroll>
inPt	y_tC	<Scroll>
Unit	0F	<Scroll>
dP	no.dP	<Scroll>
SP1L	0	<Scroll>
SP1H	2498	<Scroll>
SHiF	0	<Scroll>
FiLt	0.5	<Scroll>
Pb	0	<Scroll>
out1	rEyr	<Scroll>
o1.tY	rELY	<Scroll>
o1.Ft	oFF	<Scroll>
o1HY	90.0	<Scroll>
rAmP	nonE	<Scroll>
out2	PyHi	<Scroll>
o2.tY	rELY	<Scroll>
o2.Ft	off	<Scroll>
o2HY	90	<Scroll>
AL.Fn	PyHi	<Scroll>
ALnd	norn	<Scroll>
ALHy	90	<Scroll>
AL.ft	off	<Scroll>
Comm	nonE	<Scroll>
SEL1	nonE	<Scroll>
SEL2	nonE	<Scroll>
SEL3	nonE	<Scroll>
SEL4	nonE	<Scroll>
SEL5	nonE	<Scroll>
SEL6	nonE	<Scroll>
SEL7	nonE	<Scroll>
SEL8	nonE	<Scroll>



25 Michigan St SE Suite B Hutchinson, MN 55350
Phone 320-275-3391
Fax 320-275-2779
www.firelakemfg.com