

YORK MIDDLE SCHOOL FLOORING REPLACEMENT

YORK, MAINE

CONSTRUCTION DOCUMENTS

MARCH 6, 2019

LIST OF DRAWINGS

G00.1 COVER SHEET

ARCHITECTURAL DRAWINGS
A10.1 FIRST FLOOR PLAN
A10.2 SECOND FLOOR PLAN
A10.3 THIRD FLOOR PLAN
A&2.1 FLOORING DETAILS

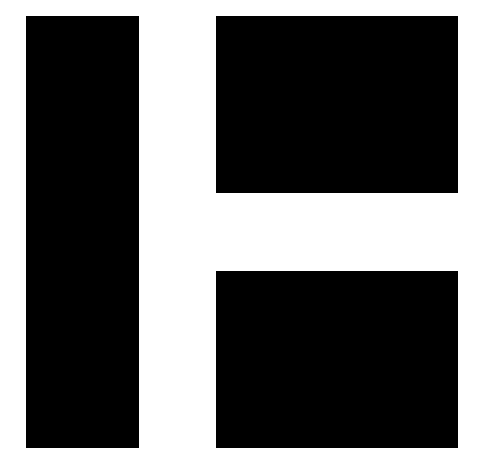

HARRIMAN

AUBURN BOSTON PORTLAND PORTSMOUTH

YORK MIDDLE SCHOOL
FLOORING REPLACEMENT

YORK, MAINE

Harriman Project No. 18427

Key Plan

CONSTRUCTION DOCUMENTS

MARCH 6, 2019

Rev Date Revision Description

PA / PE: DRE © 2019
Drawn By: DRE Harriman Associates

COVER SHEET

G00.1

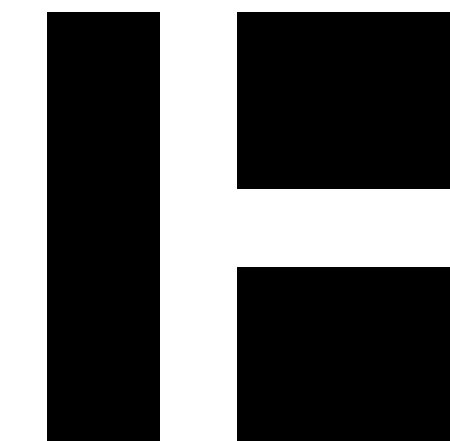

HARRIMAN

AUBURN BOSTON PORTLAND PORTSMOUTH

YORK MIDDLE SCHOOL FLOORING REPLACEMENT

YORK, MAINE

Harriman Project No. 18427

Key Plan Proj North



CONSTRUCTION DOCUMENTS

MARCH 6, 2019

Rev Date Revision Description

Rev Date	Revision Description

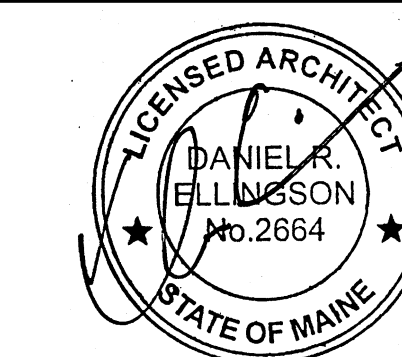

PA / PE: DRE © 2019 Harriman Associates
Drawn By: DRE

FIRST FLOOR PLAN

A10.1

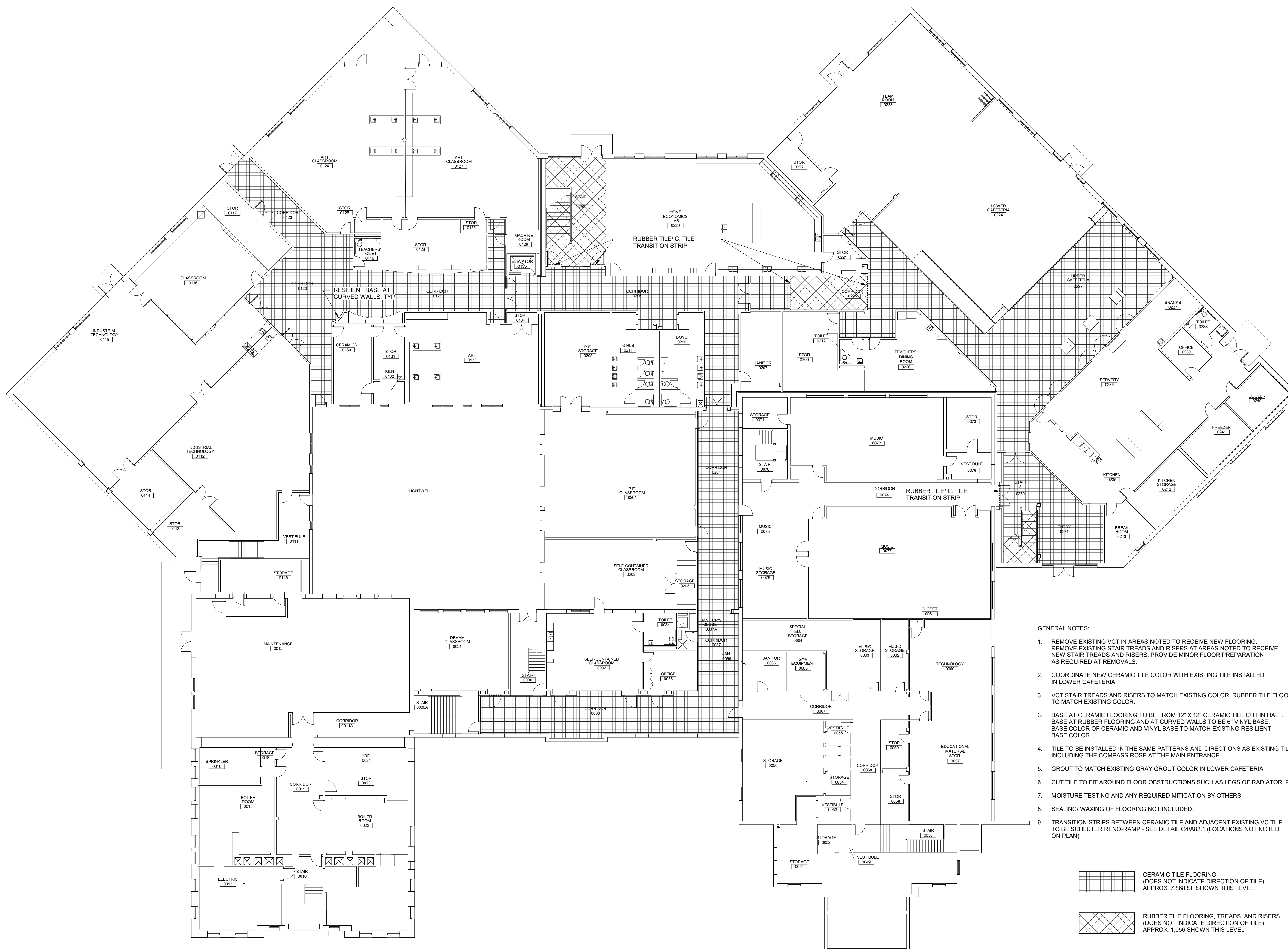

GENERAL NOTES:

- REMOVE EXISTING VCT IN AREAS NOTED TO RECEIVE NEW FLOORING. REMOVE EXISTING STAIR TREADS AND RISERS IN AREAS NOTED TO RECEIVE NEW STAIR TREADS AND RISERS. PROVIDE MINOR FLOOR PREPARATION AS REQUIRED AT REMOVALS.
- COORDINATE NEW CERAMIC TILE COLOR WITH EXISTING TILE INSTALLED IN LOWER CAFETERIA.
- VCT STAIR TREADS AND RISERS TO MATCH EXISTING COLOR. RUBBER TILE FLOORING TO MATCH EXISTING COLOR.
- BASE AT CERAMIC FLOORING TO BE FROM 12" X 12" CERAMIC TILE CUT IN HALF. BASE AT RUBBER FLOORING AND AT CURVED WALLS TO BE 6" VINYL BASE. BASE COLOR OF CERAMIC AND VINYL BASE TO MATCH EXISTING RESILIENT BASE COLOR.
- TILE TO BE INSTALLED IN THE SAME PATTERNS AND DIRECTIONS AS EXISTING TILE, INCLUDING THE COMPASS ROSE AT THE MAIN ENTRANCE.
- GROUT TO MATCH EXISTING GRAY GROUT COLOR IN LOWER CAFETERIA.
- CUT TILE TO FIT AROUND FLOOR OBSTRUCTIONS SUCH AS LEGS OF RADIATOR, PIPES.
- MOISTURE TESTING AND ANY REQUIRED MITIGATION BY OTHERS.
- SEALING/ WAXING OF FLOORING NOT INCLUDED.
- TRANSITION STRIPS BETWEEN CERAMIC TILE AND ADJACENT EXISTING VCT TO BE SCHLUTER RENO-RAMP - SEE DETAIL C4/A82-1 (LOCATIONS NOT NOTED ON PLAN).

- CERAMIC TILE FLOORING (DOES NOT INDICATE DIRECTION OF TILE) APPROX. 7,868 SF SHOWN THIS LEVEL
- RUBBER TILE FLOORING, TREADS, AND RISERS (DOES NOT INDICATE DIRECTION OF TILE) APPROX. 1,056 SF SHOWN THIS LEVEL

A1 FIRST FLOOR PLAN SCALE: NOT TO SCALE

Plot Date: 3/6/2019 10:53:22 AM

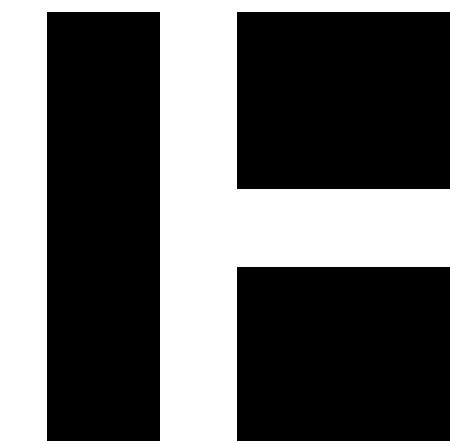

HARRIMAN

AUBURN BOSTON PORTLAND PORTSMOUTH

YORK MIDDLE SCHOOL
FLOORING REPLACEMENT

YORK, MAINE

Harriman Project No. 18427

Key Plan Proj North



CONSTRUCTION DOCUMENTS

MARCH 6, 2019

Rev Date Revision Description

Rev Date	Revision Description

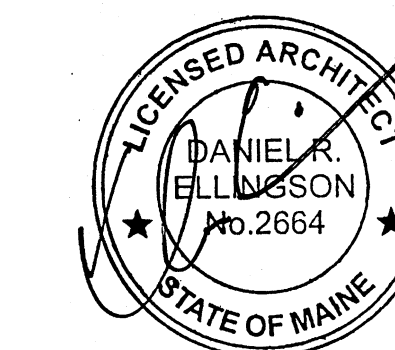

PA / PE: DRE © 2019
Drawn By: DRE Harriman Associates

SECOND FLOOR PLAN

A10.2

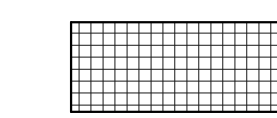
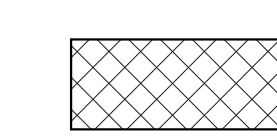

-  CERAMIC TILE FLOORING
(DOES NOT INDICATE DIRECTION OF TILE)
APPROX. 7,546 SF SHOWN THIS LEVEL
-  RUBBER TILE FLOORING, TREADS, AND RISERS
(DOES NOT INDICATE DIRECTION OF TILE)
APPROX. 750 SF SHOWN THIS LEVEL

A1 SECOND FLOOR PLAN
SCALE: NOT TO SCALE

Plot Date: 3/6/2019 10:53:47 AM

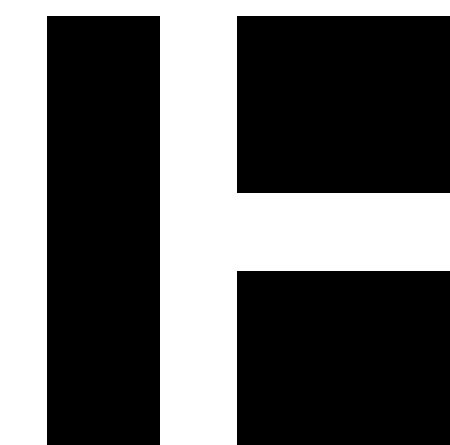

HARRIMAN

AUBURN BOSTON PORTLAND PORTSMOUTH

YORK MIDDLE SCHOOL
FLOORING REPLACEMENT

YORK, MAINE

Harriman Project No. 18427

Key Plan Proj North



CONSTRUCTION DOCUMENTS

MARCH 6, 2019

Rev Date Revision Description

Rev Date	Revision Description

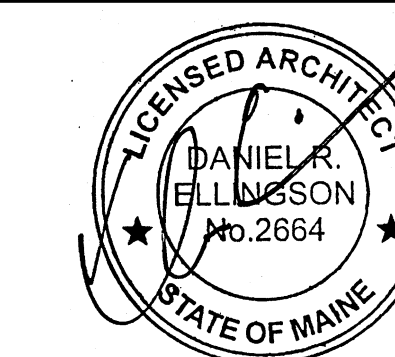



PA / PE: DRE © 2019
Drawn By: DRE Harriman Associates

THIRD FLOOR PLAN

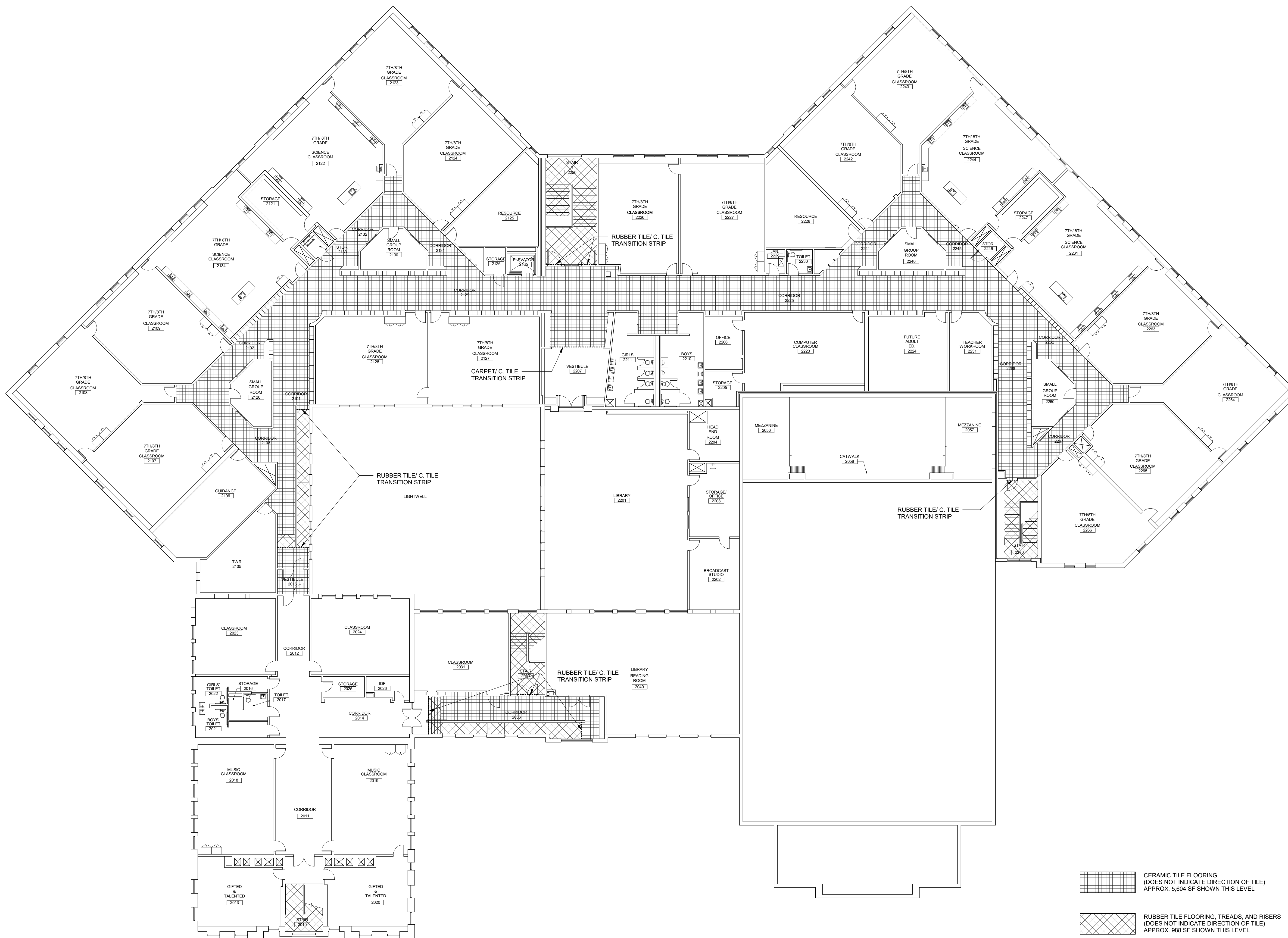
A10.3

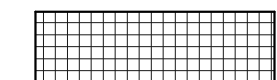

 CERAMIC TILE FLOORING
(DOES NOT INDICATE DIRECTION OF TILE)
APPROX. 5,604 SF SHOWN THIS LEVEL

 RUBBER TILE FLOORING, TREADS, AND RISERS
(DOES NOT INDICATE DIRECTION OF TILE)
APPROX. 988 SF SHOWN THIS LEVEL

A1 THIRD FLOOR PLAN
SCALE: NOT TO SCALE

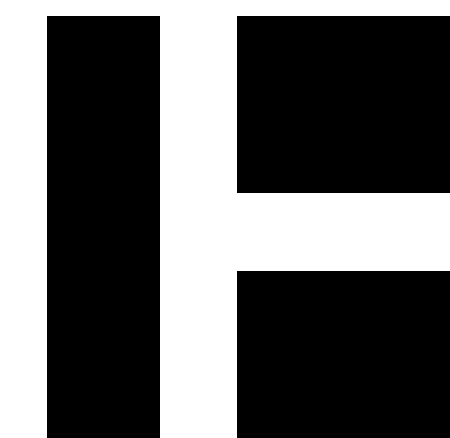

HARRIMAN

AUBURN BOSTON PORTLAND PORTSMOUTH

YORK MIDDLE SCHOOL
FLOORING REPLACEMENT

YORK, MAINE

Harriman Project No. 18427

Key Plan

CONSTRUCTION DOCUMENTS

MARCH 6, 2019

Rev Date Revision Description

Rev Date	Revision Description

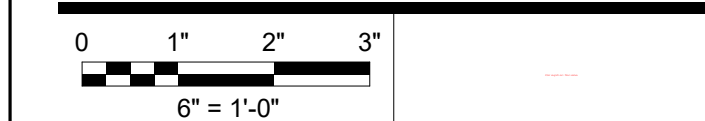
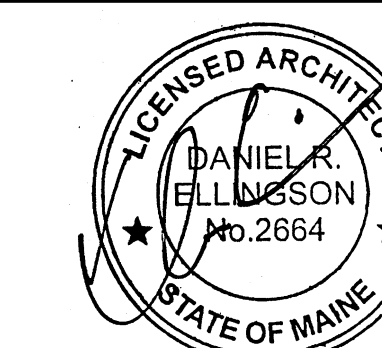

PA / PE: DRE © 2019
Drawn By: DRE Harriman Associates

FLOORING DETAILS

A82.1

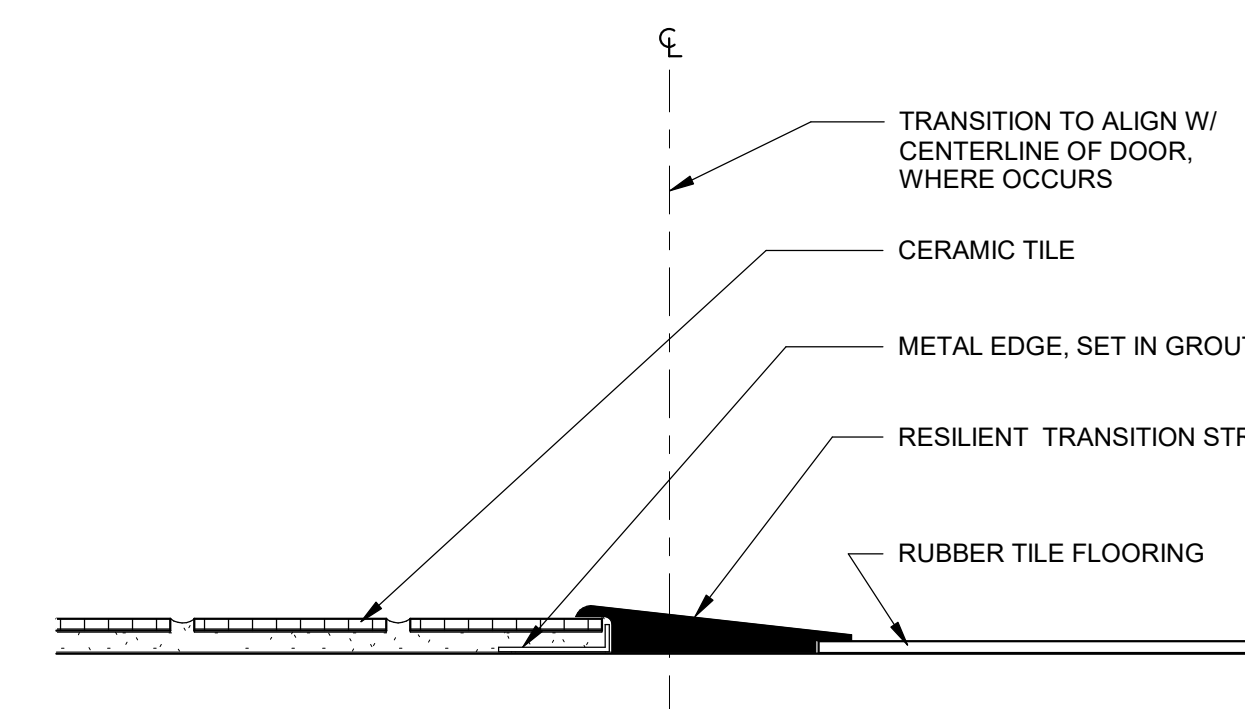

D4 CERAMIC TILE - RUBBER TILE
SCALE: 6" = 1'-0"

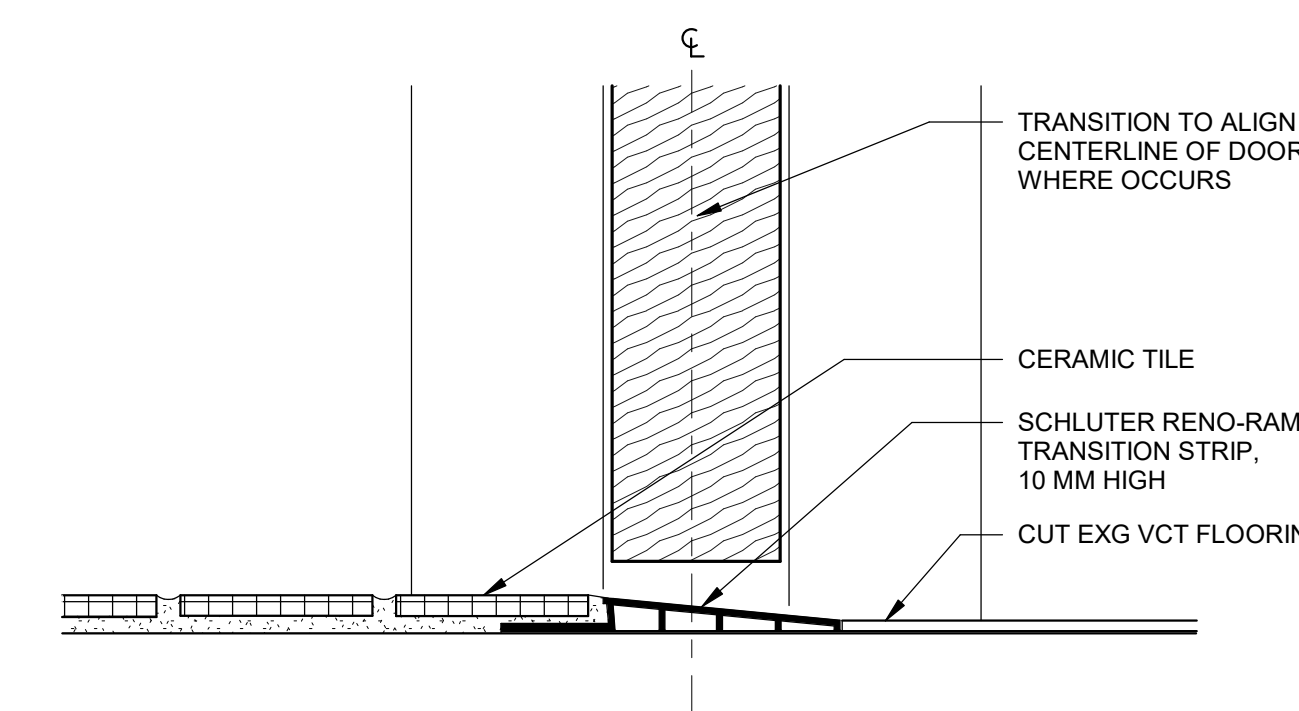

C4 CERAMIC TILE - EXISTING VCT
SCALE: 6" = 1'-0"

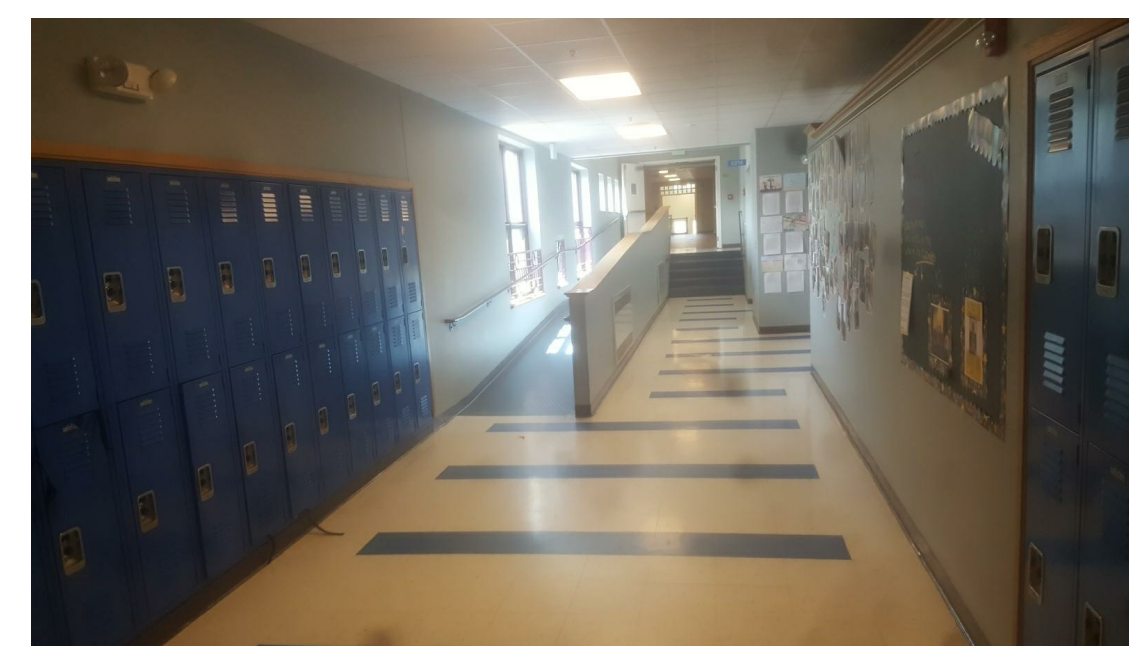

B3 SAMPLE HALLWAY PATTERN TO REPLICATE
SCALE: NTS

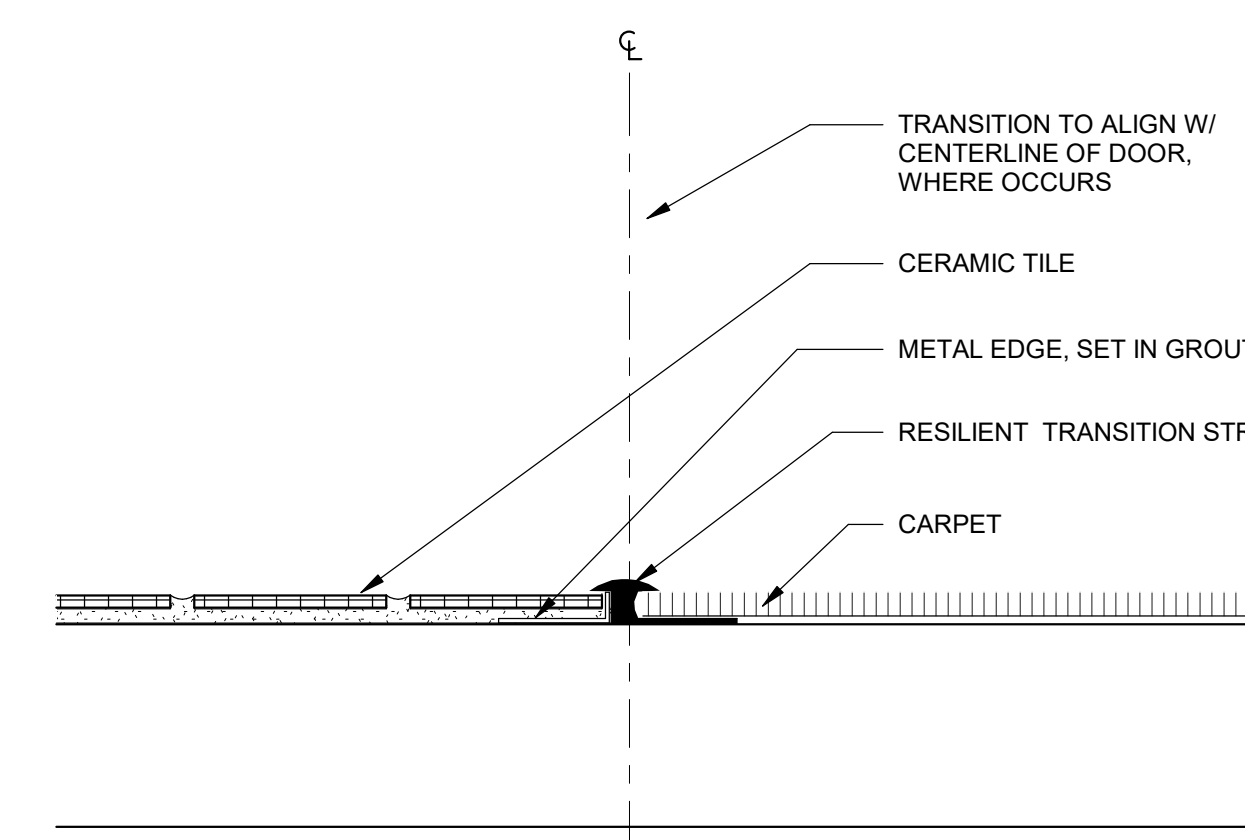

B4 CERAMIC TILE - CARPET
SCALE: 6" = 1'-0"



A3 COMPASS ROSE FLOOR PATTERN TO REPLICATE
SCALE: NTS

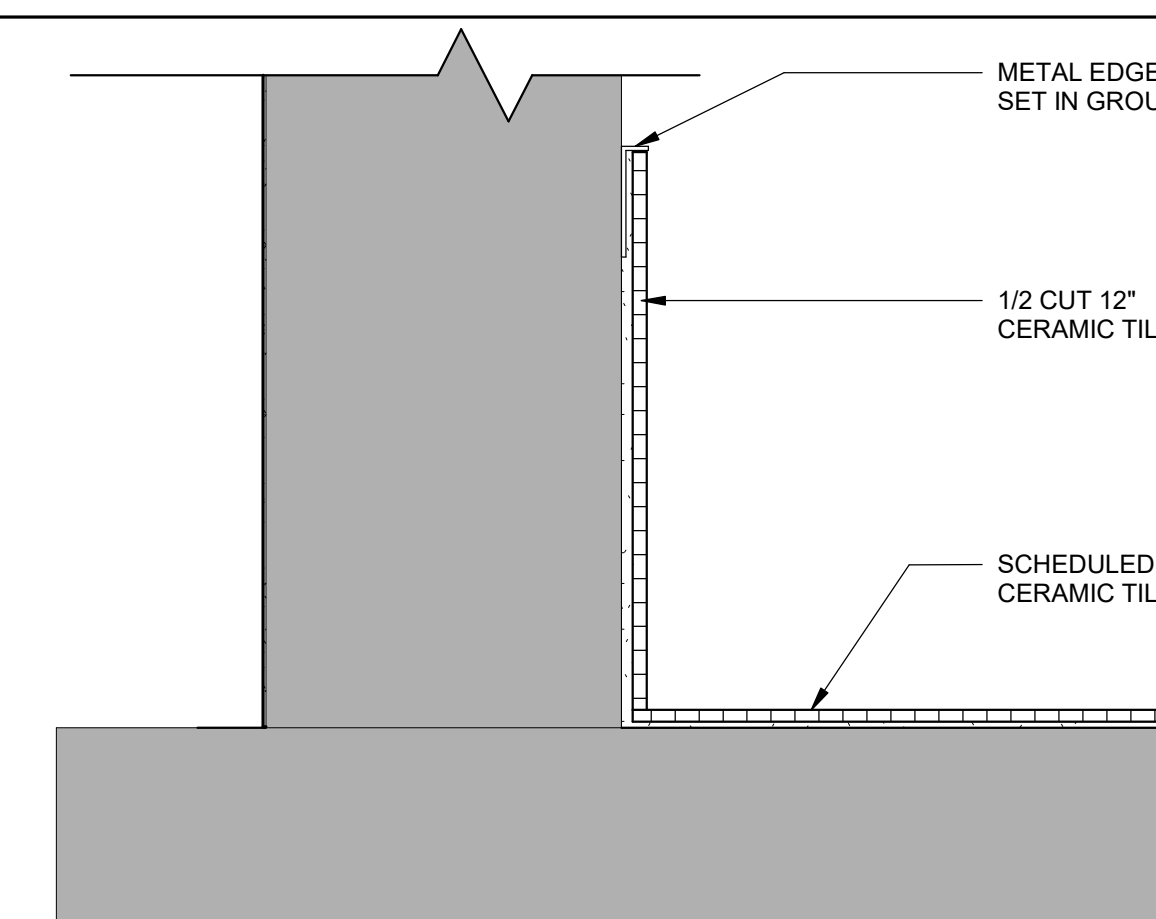

A4 COVE BASE DETAIL AT CERAMIC TILE
SCALE: 6" = 1'-0"